

# VK 45.02 (H) draft blueprint w 1461

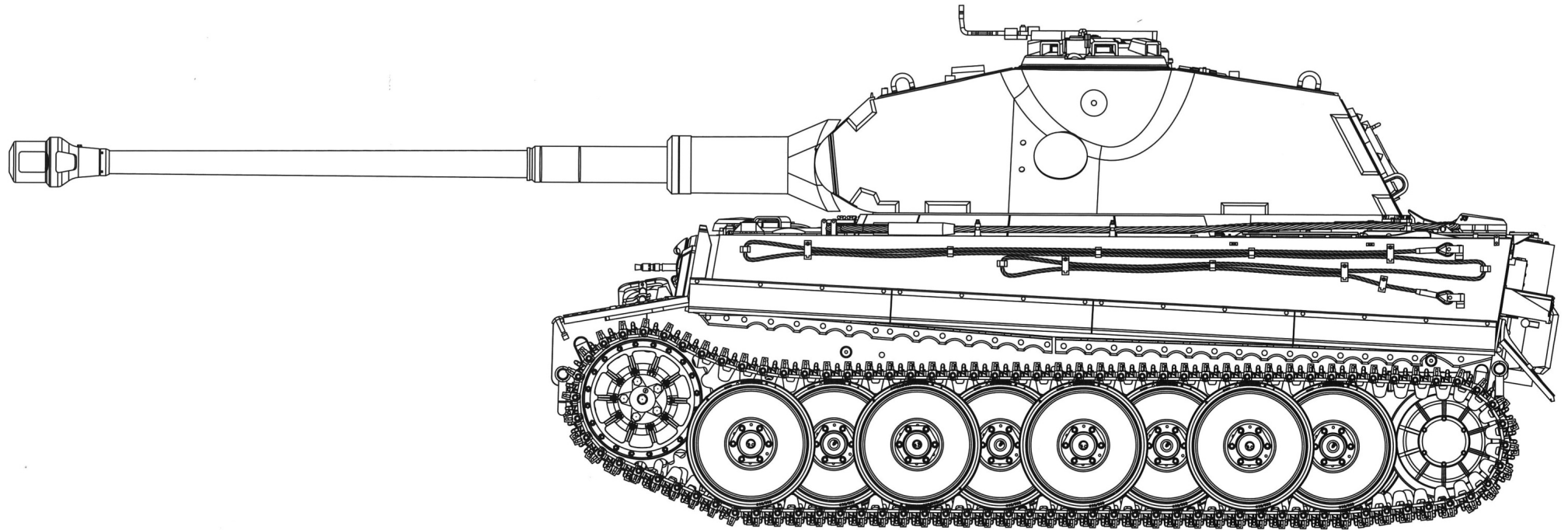

VK 45.02 (H) draft blueprint w 1461 was a short-lived second design for a 45-ton vehicle by Henschel. Originally intended to become the Tiger II, it was ultimately cancelled in favor of VK 45.03(H) taking its place in the Tiger pantheon. Nevertheless, VK.45.02(H) represents an evolutionary step between Tiger I and Tiger II.

Draft blueprint w 1461 of this conceptual design featured some changes compared to the Tiger I. The order to adapt the VK 45.01(H) for a new turret was made on March 5th, 1942. This meant that the VK 45.01(H) would use a turret developed for the VK 45.02(P) by Krupp. Like the VK 45.02(P), the turret would be installed after the 100th production vehicle. Initially, this only took the form of installing the new turret on the old hull.

The Krupp-designed turret was to be armed with the 88mm L/71, the same as VK.4503(H), with the only difference being a hydraulic drive to traverse the turret.

03.02.2191

# READ BEFORE ASSEMBLY

## CAUTION

- Read carefully and fully understand the instructions before commencing assembly. A supervising adult should also read the instructions if a child assembles the model.
- When assembling this kit, tools including knives used. Extra care should be taken to avoid personal injury.
- Keep out of reach of small children. Children must not be allowed to suck any part, or pull vinyl bag over their heads.



Be Careful



Optional



Instant Glue for Metal



Do Not Cement



Remove



Drill



Fill Holes

## APPLYING DECALS

1. Clean the model surface with a wet cloth.
2. Cut out each decal design from sheet, and dip it in tepid water for 15~20 sec.
3. Hold the backing sheet edge and slide decal onto the model.
4. Move decal into position by wetting decal with finger.
5. Press decal gently down with a soft cloth until excess water and air bubbles are gone.

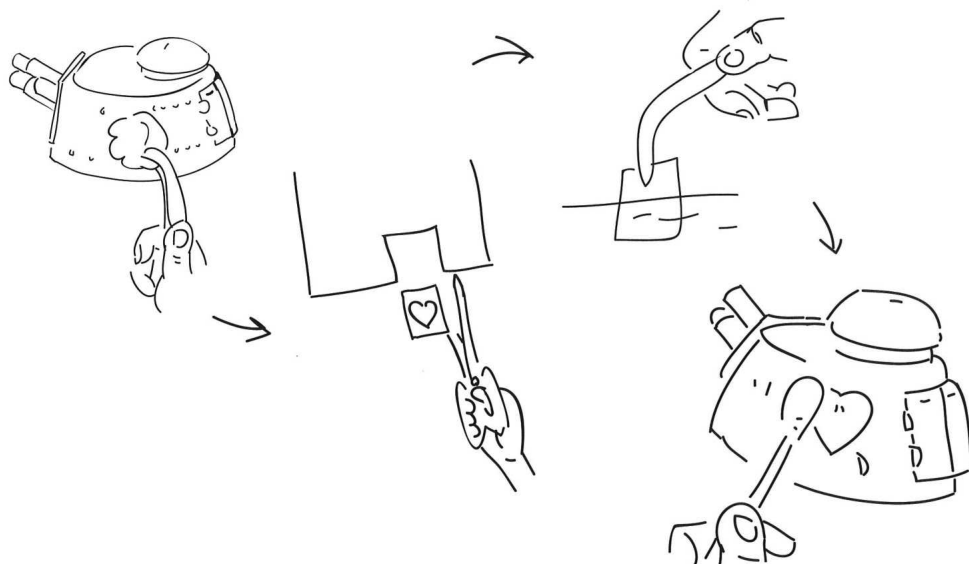

## REMOVING PE

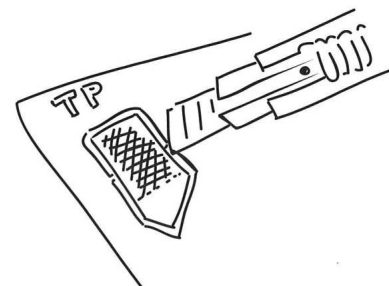

Be careful not to hurt when removing PE parts.

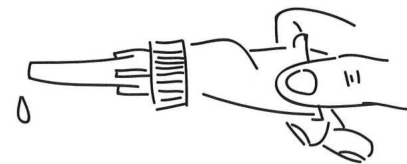

Secure using instant glue (not included).

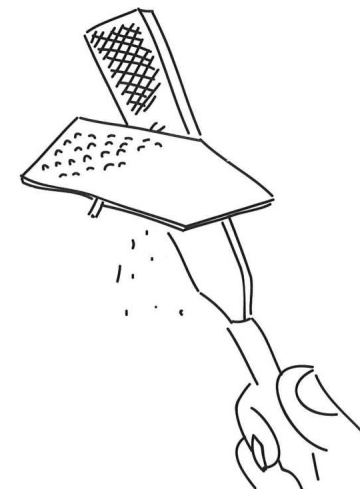

Finish using file.

# PARTS

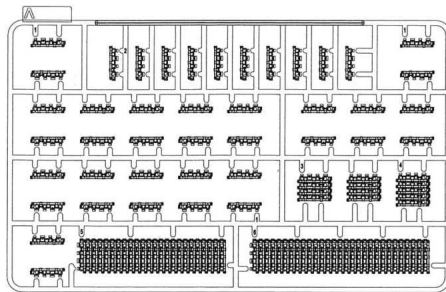

X2

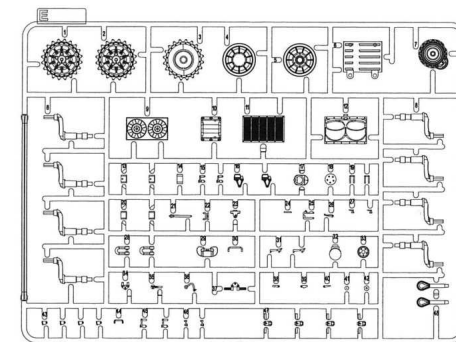
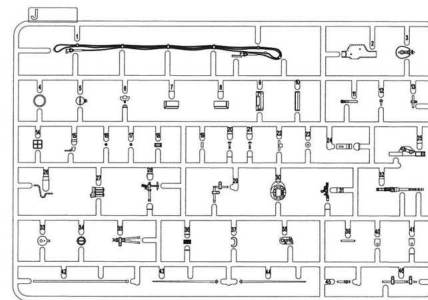
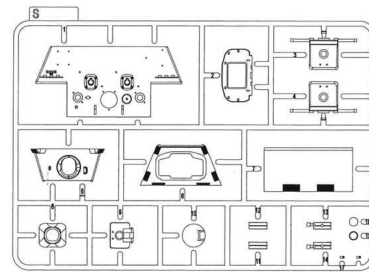

X2

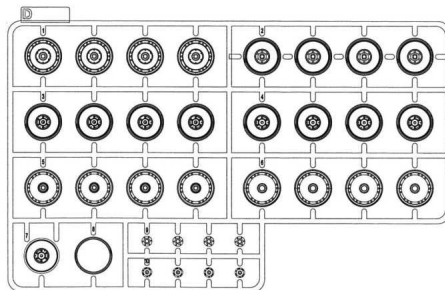
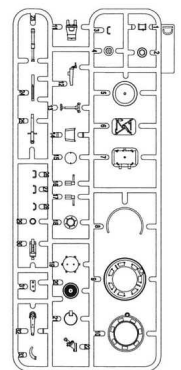
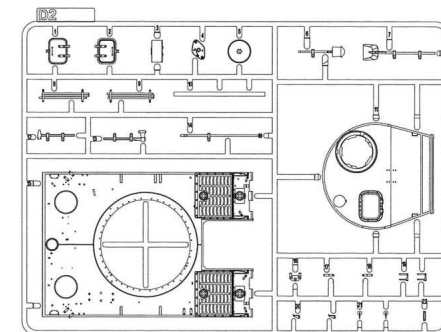
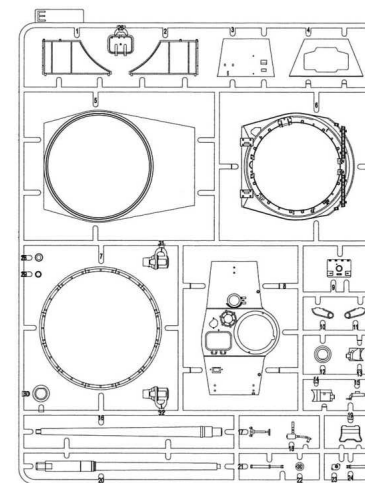
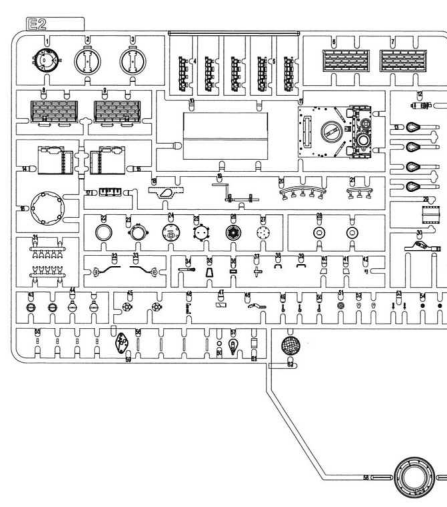
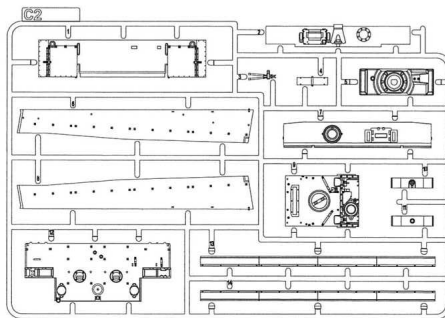
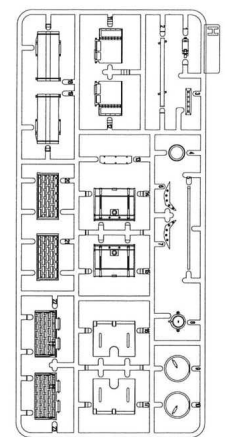

X2

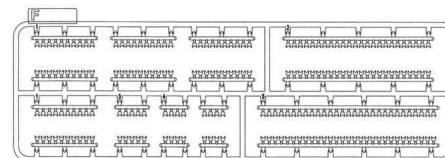

X2

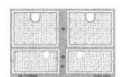
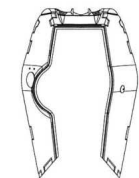
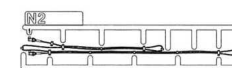
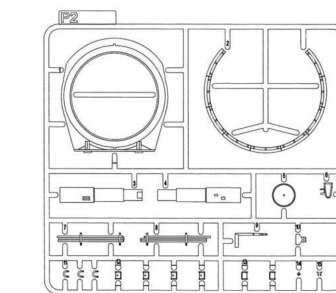

TP

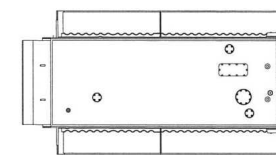
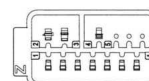
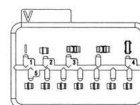
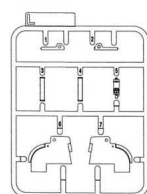
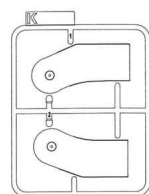

Q



Cable



Decal

1

A

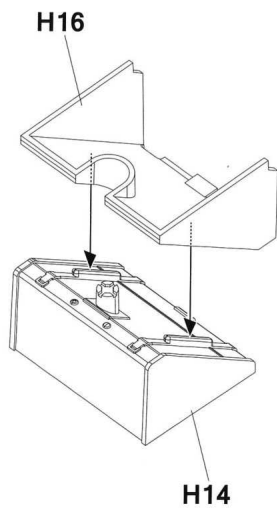

C2-10

E9

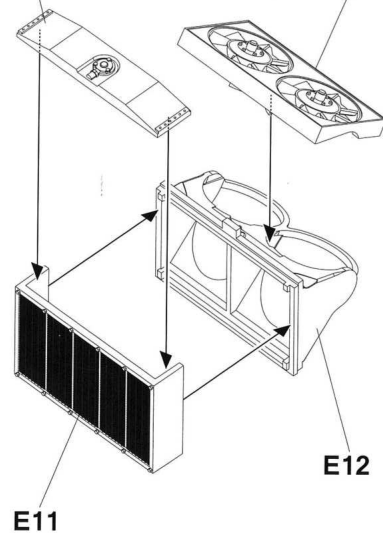

B

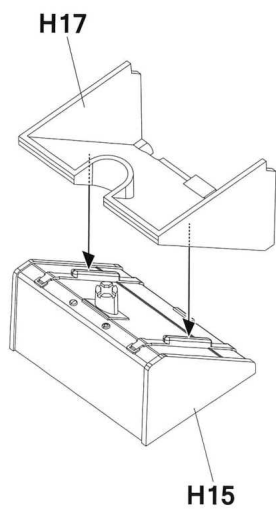

C2-11

E9

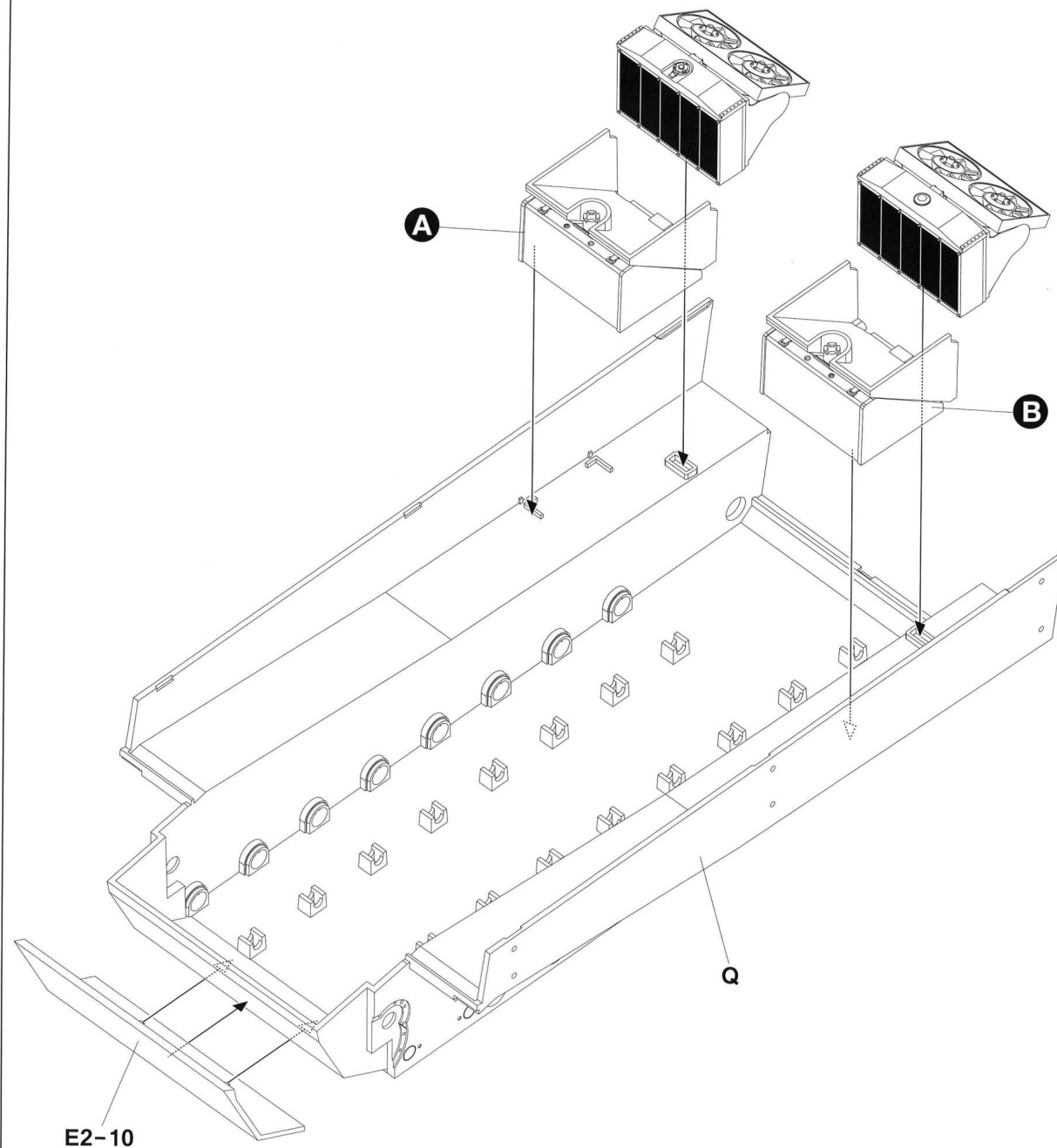
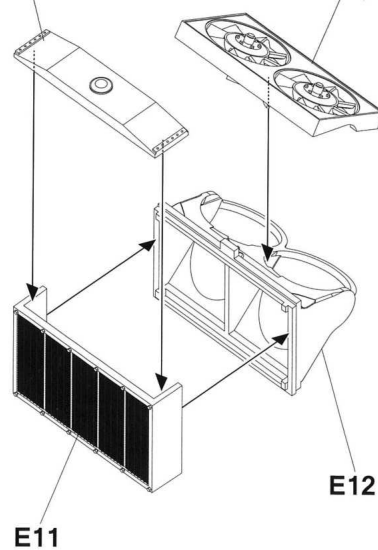

3

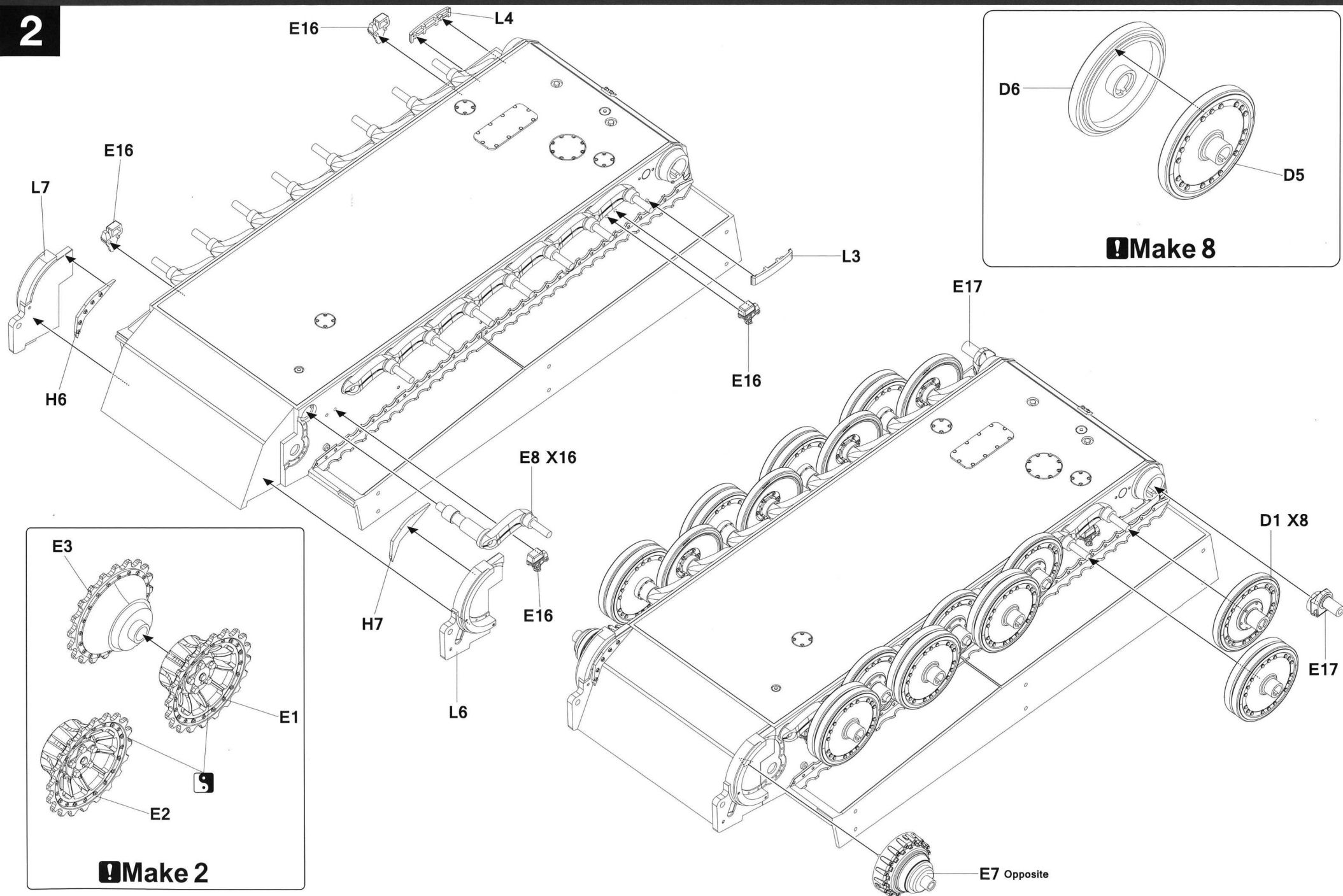

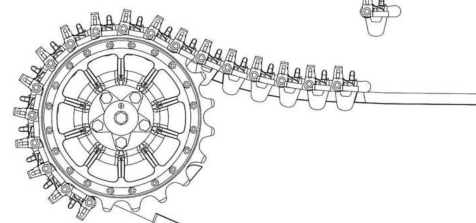
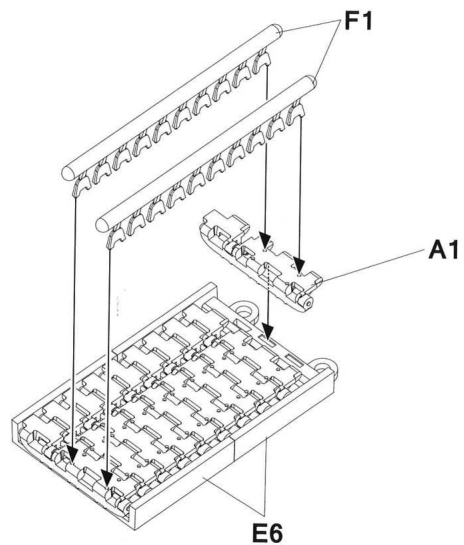
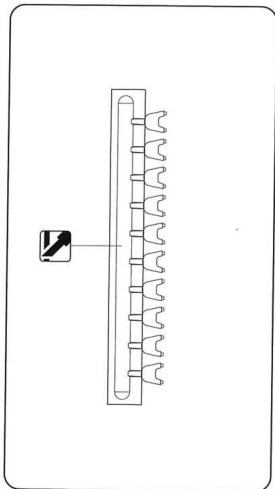

A1 X19

K1

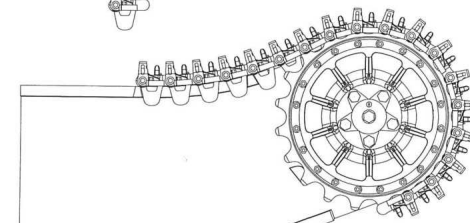

A1 X19

K2

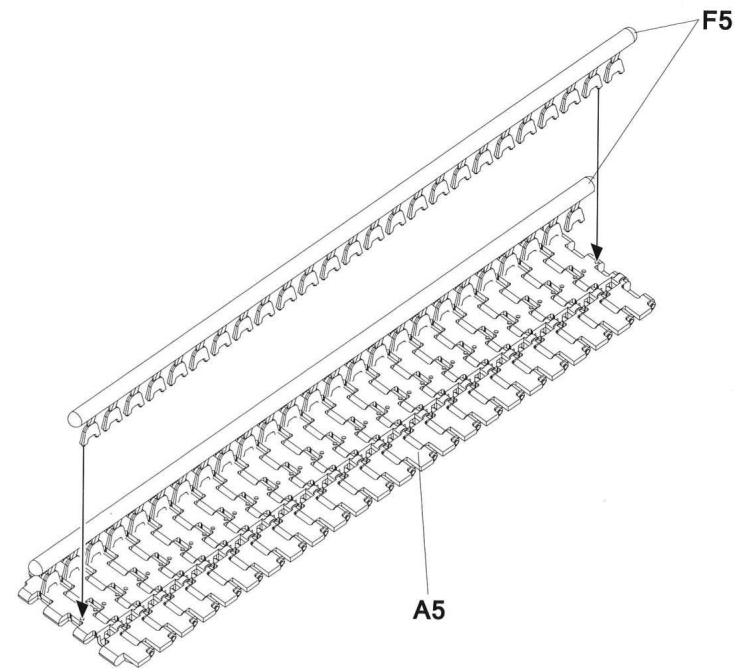
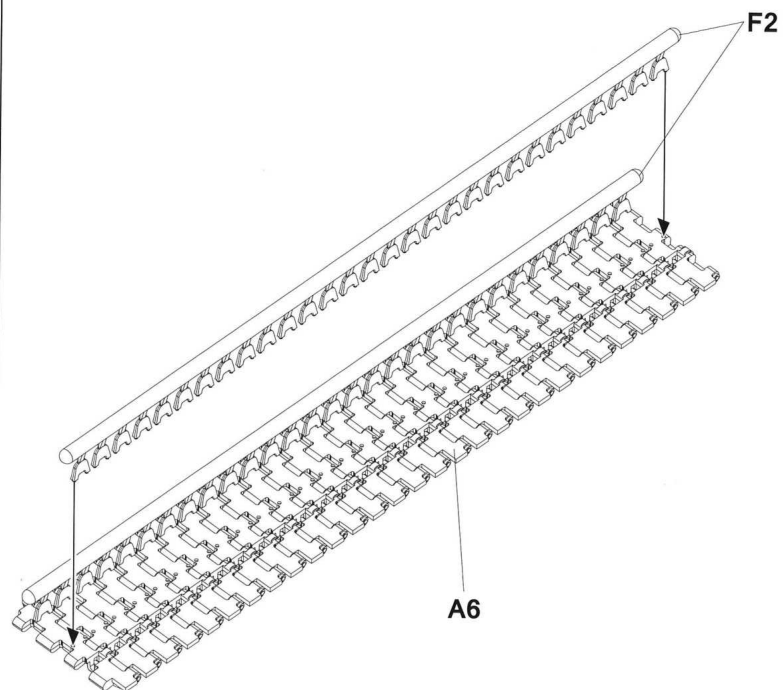
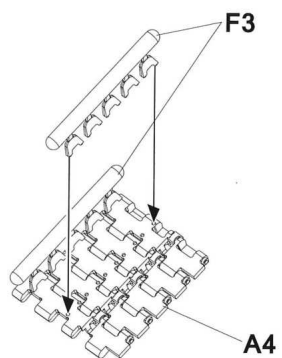
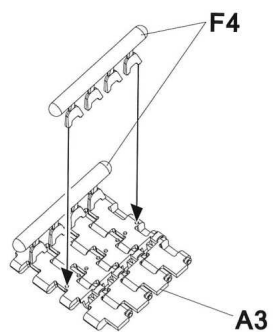

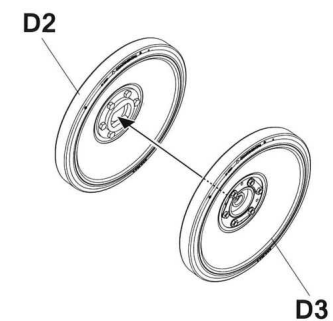
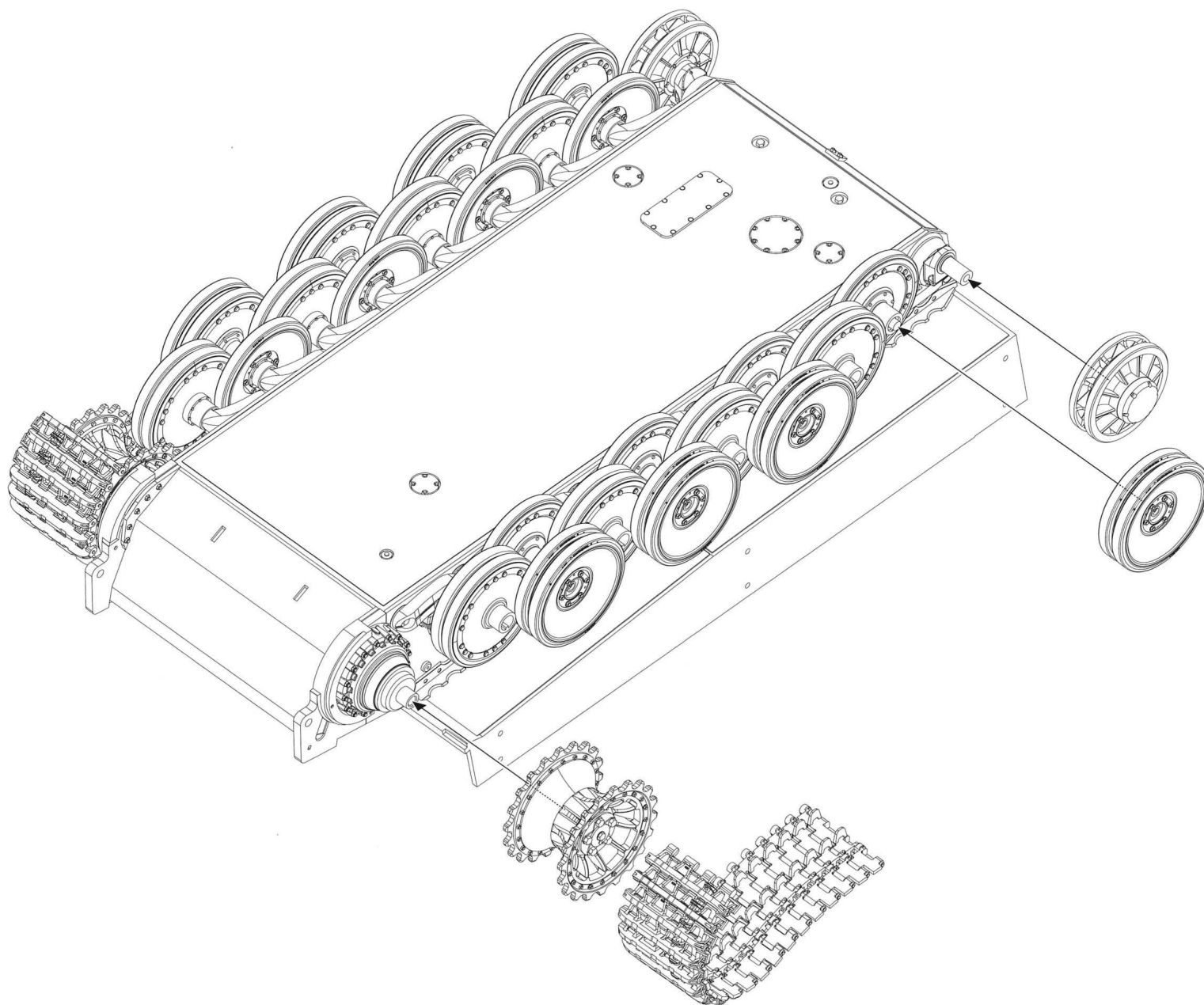

**Make 8**

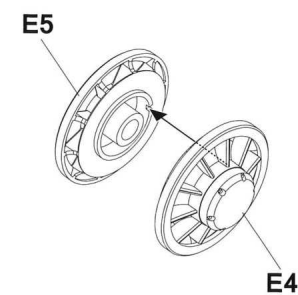

**Make 2**

5

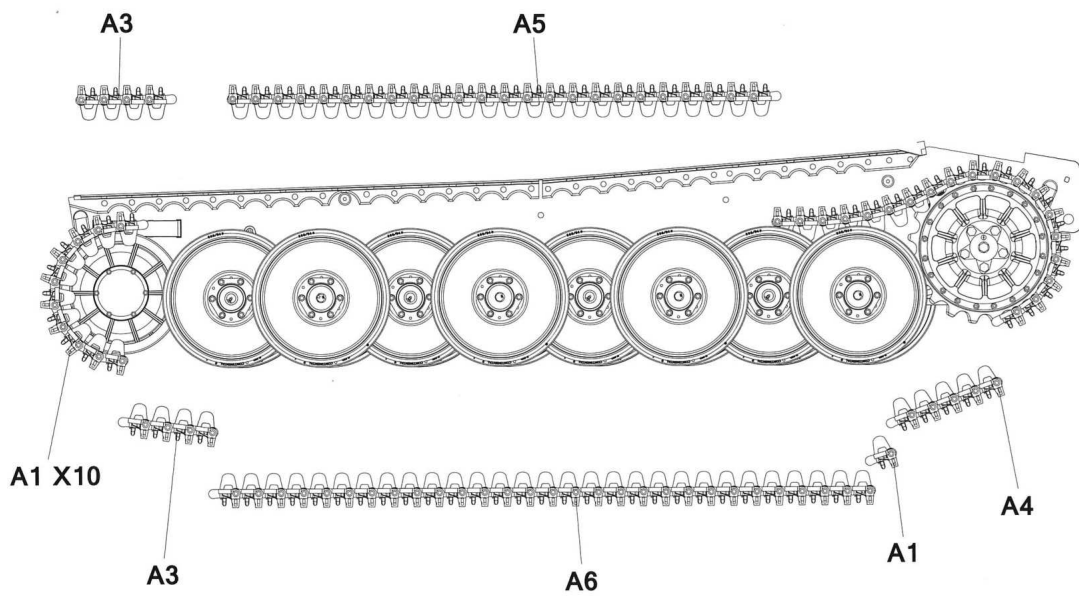
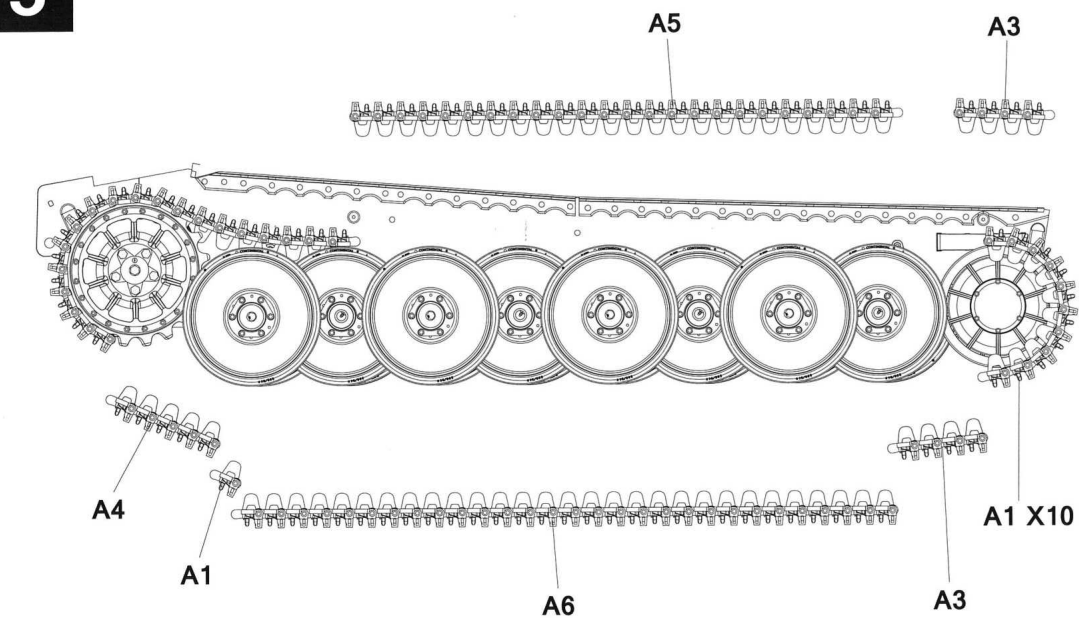

6

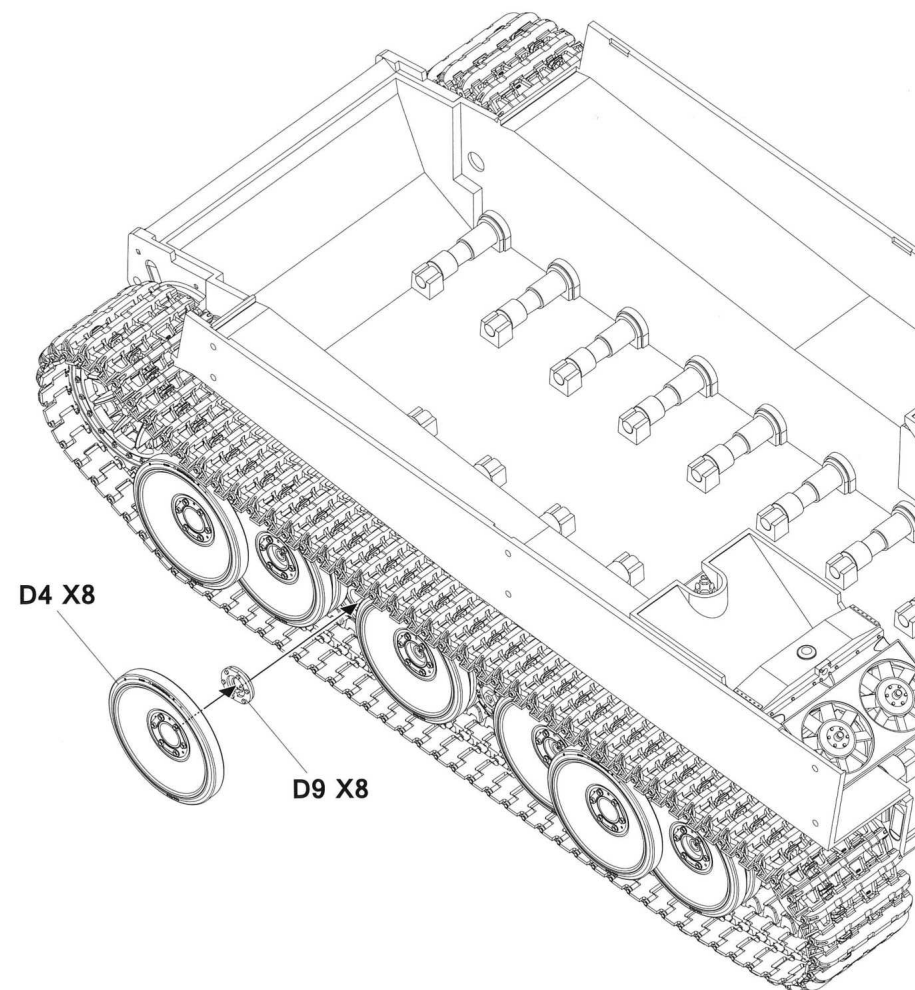

7

7

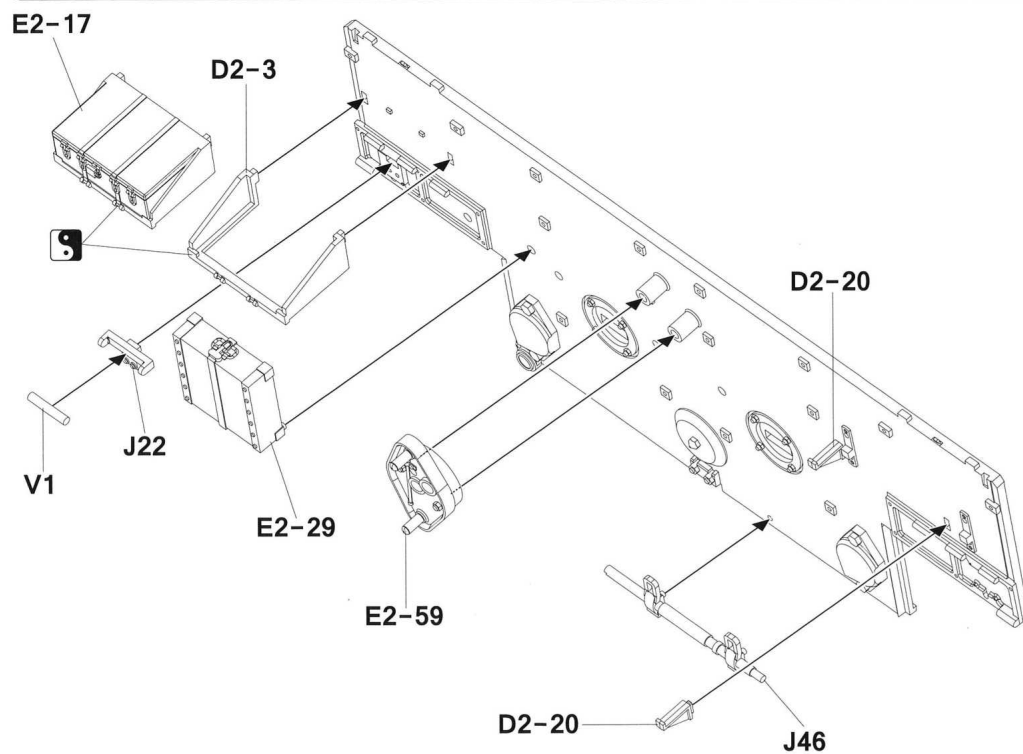
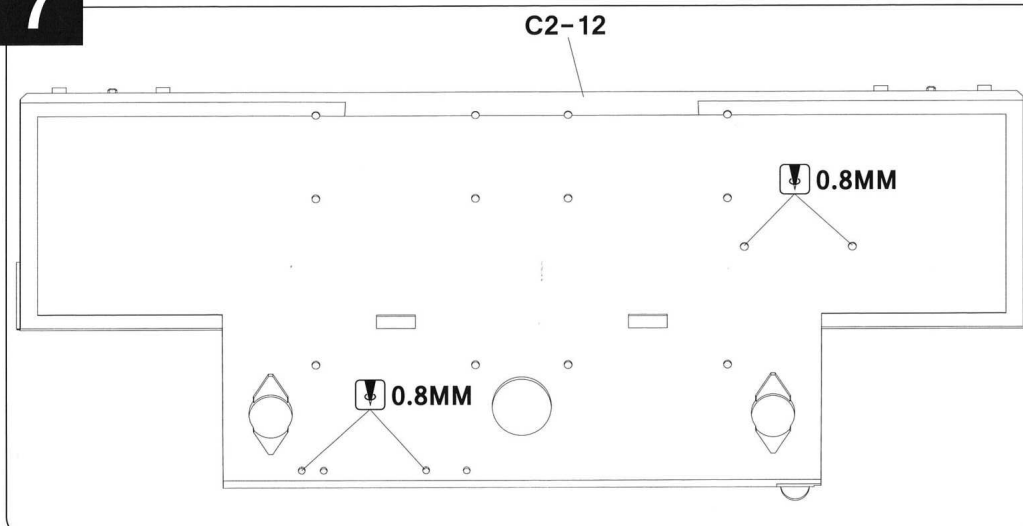

8

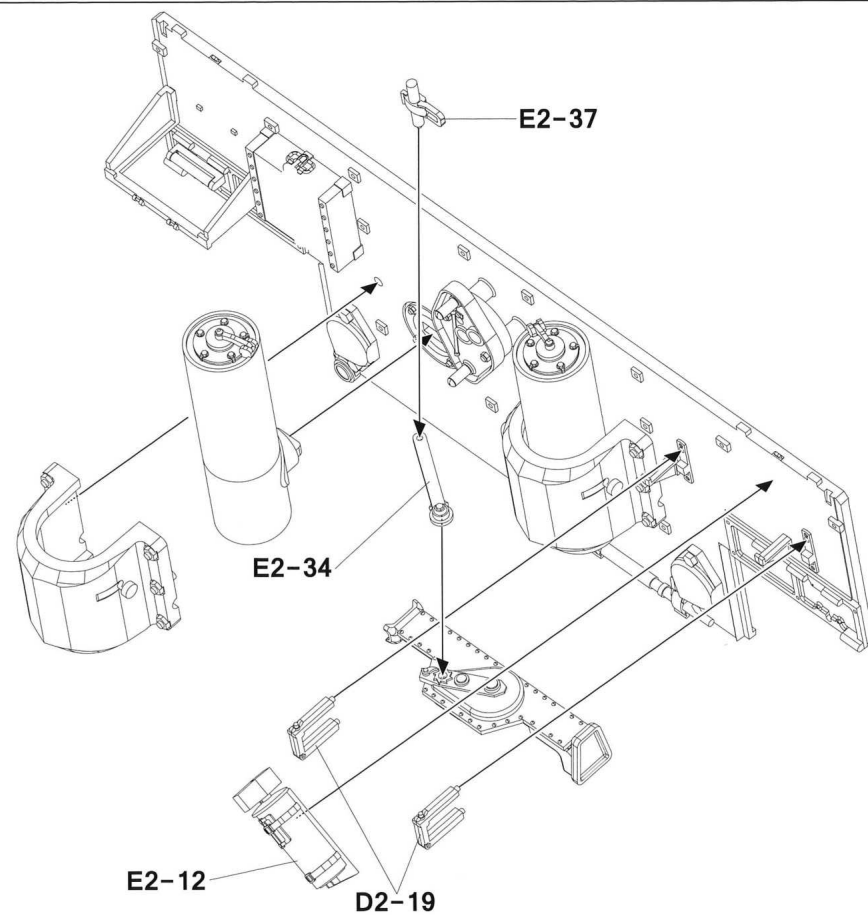
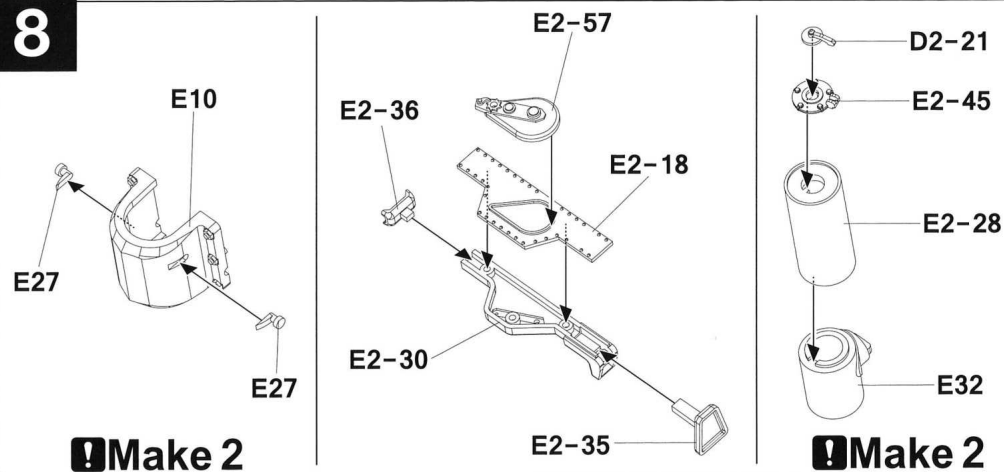

8

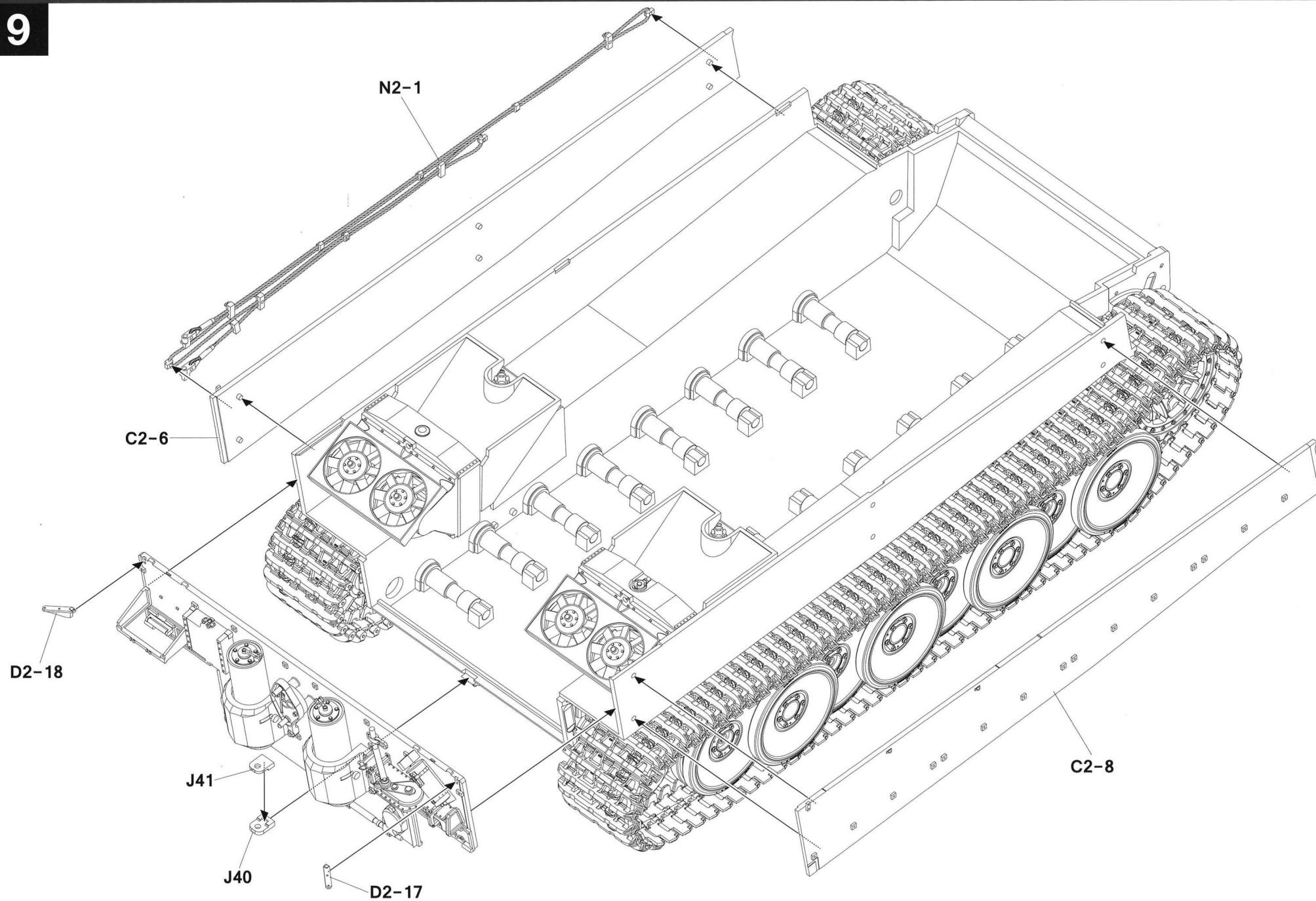

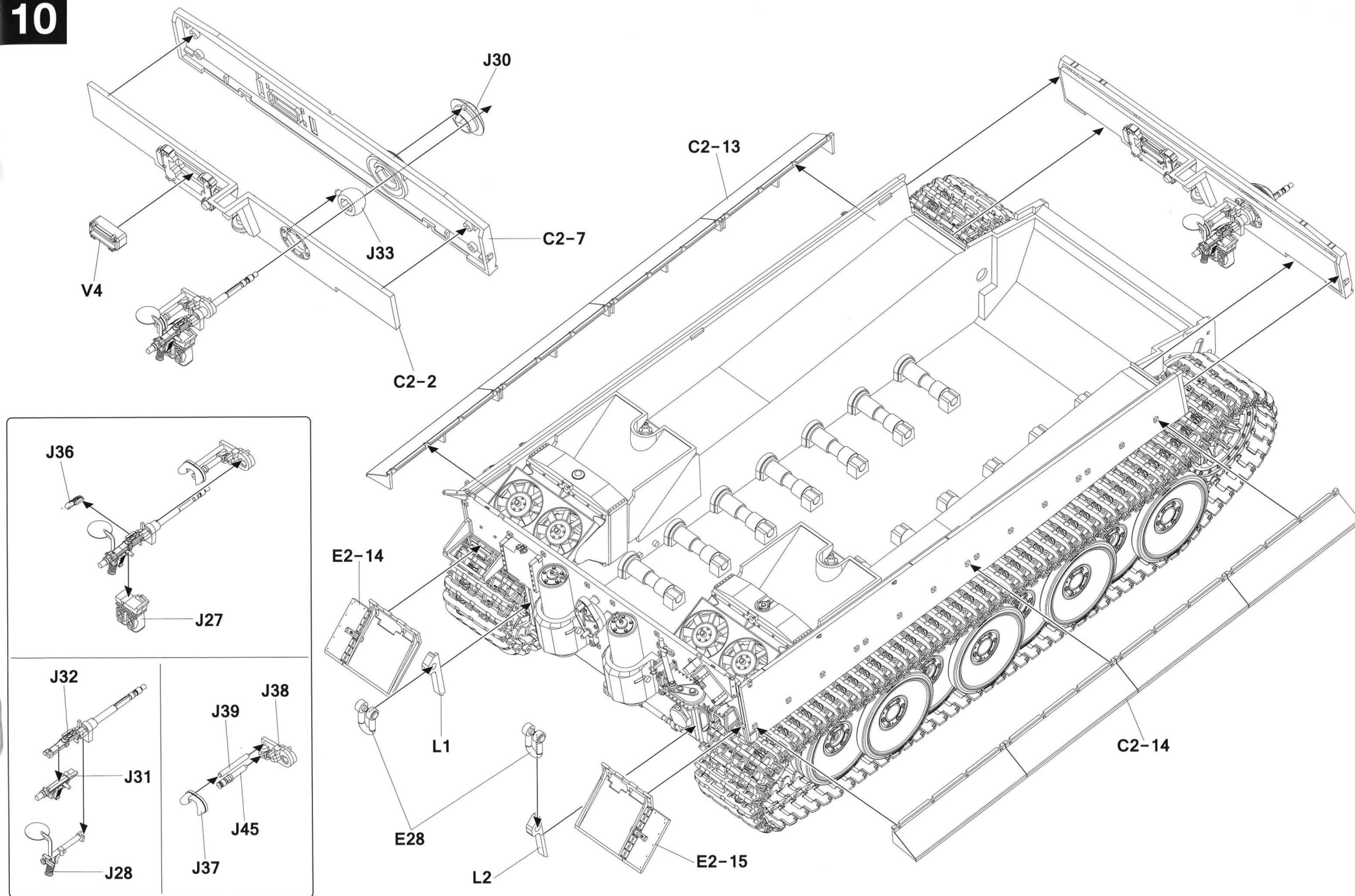

# 11

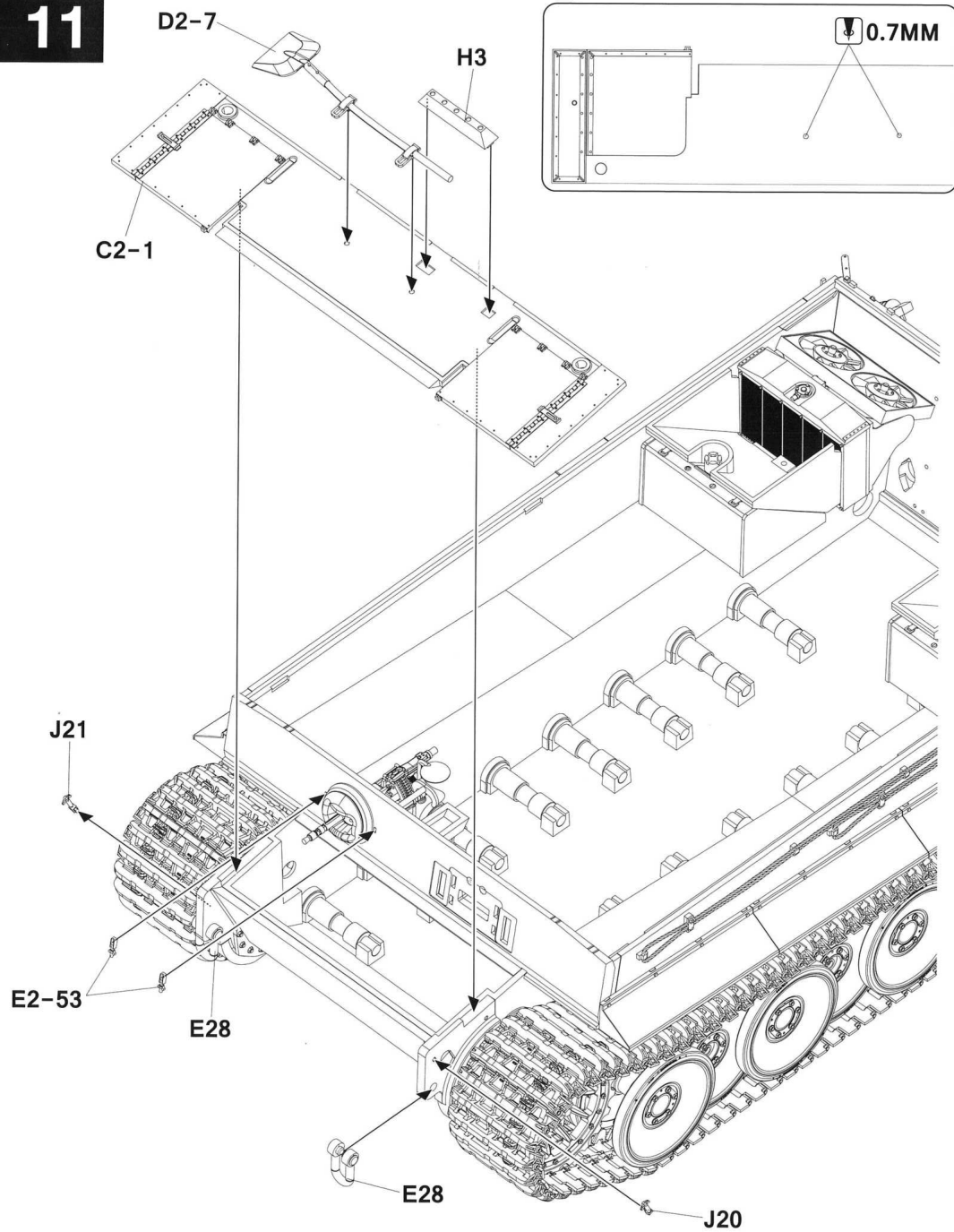

# 12

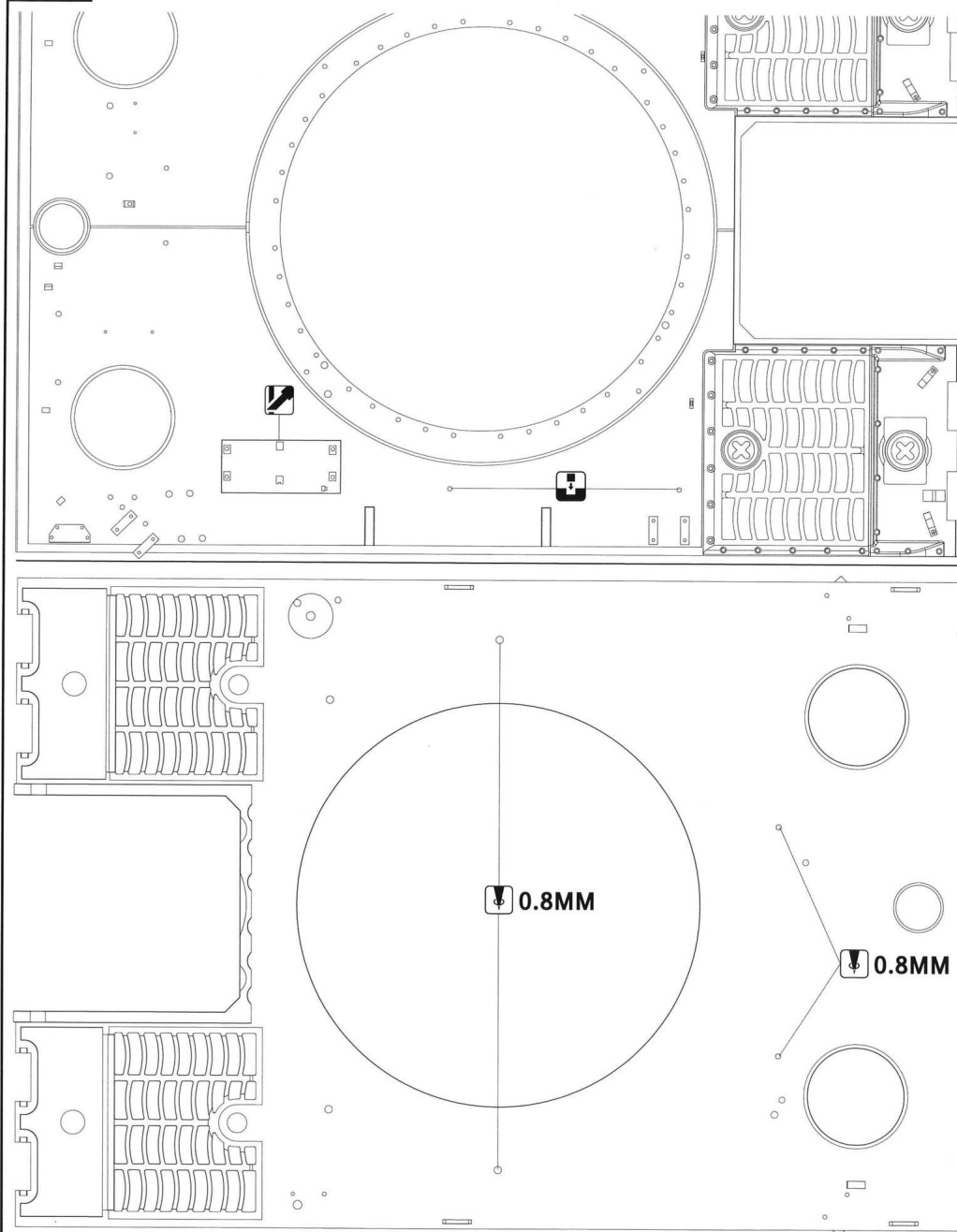

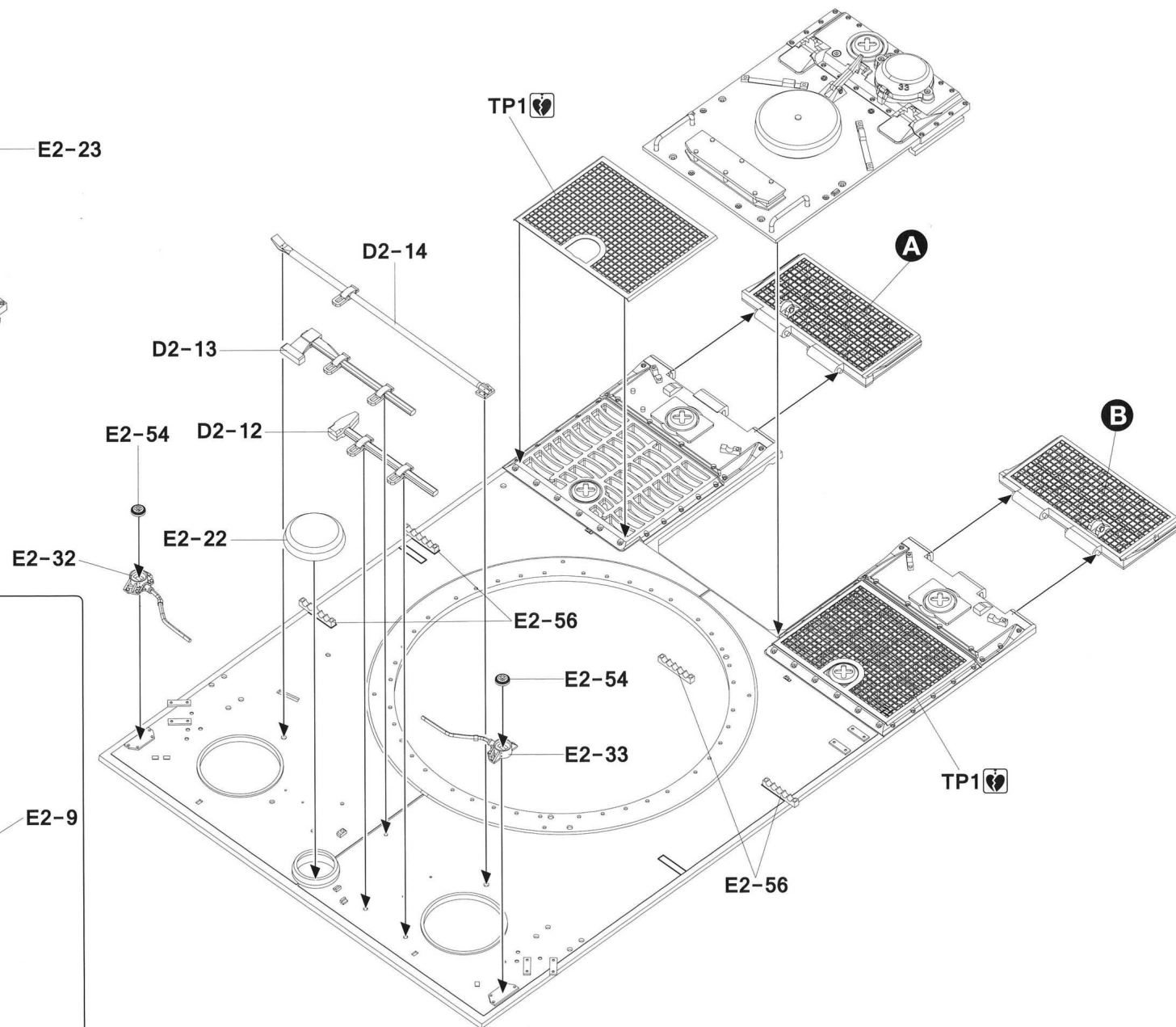
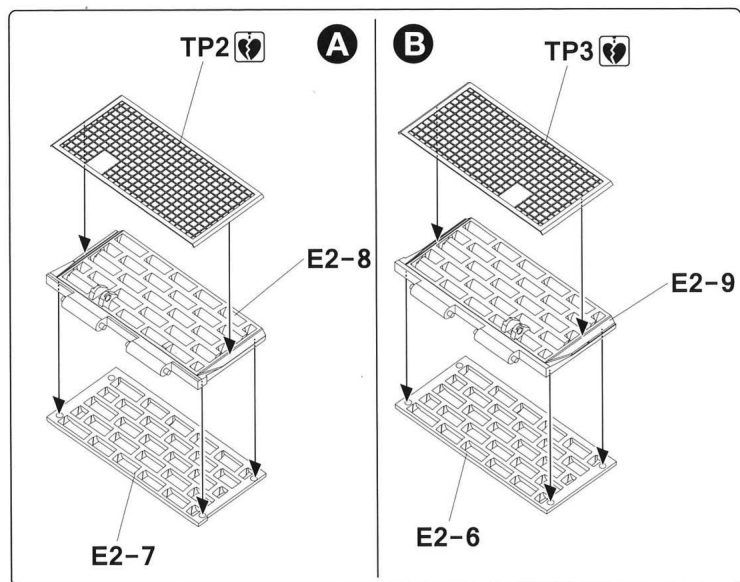
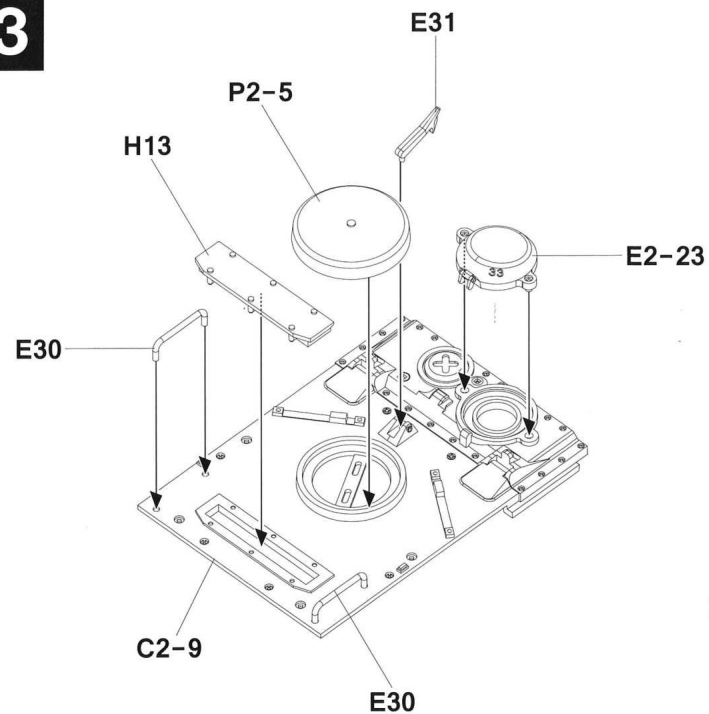

# 14

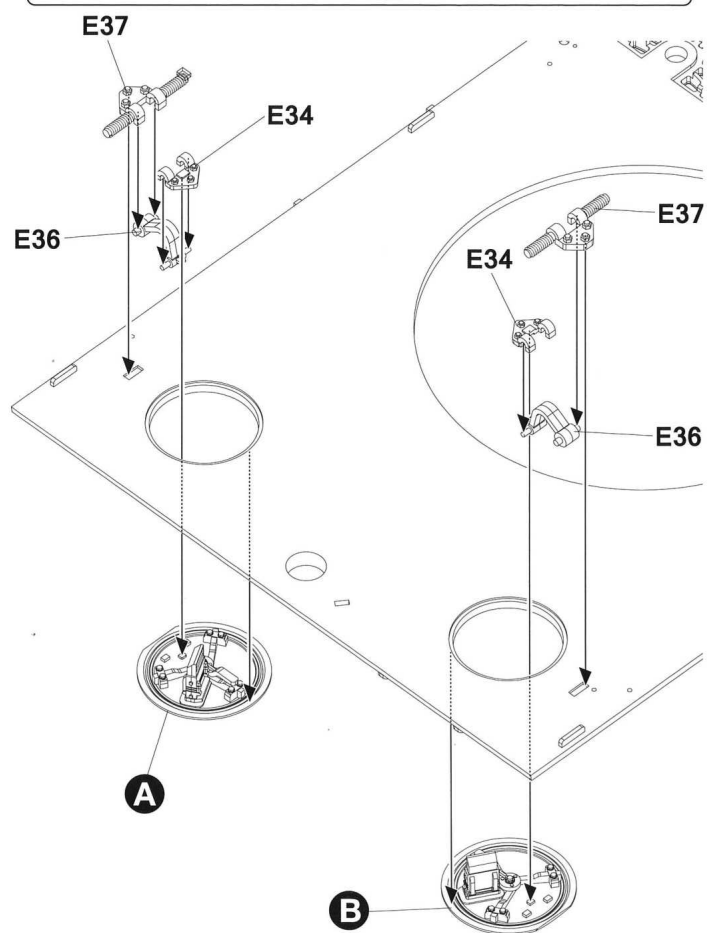
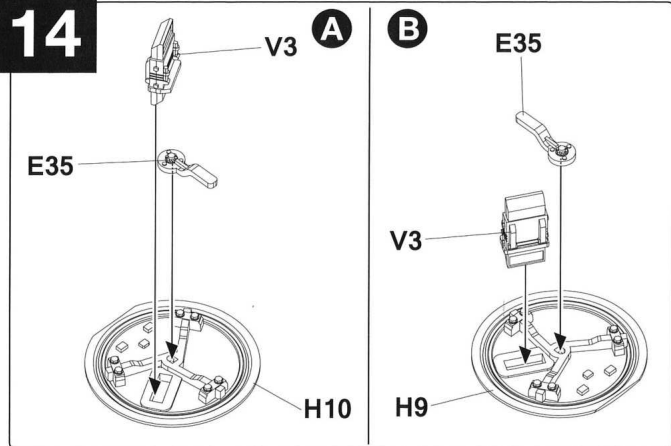

# 15

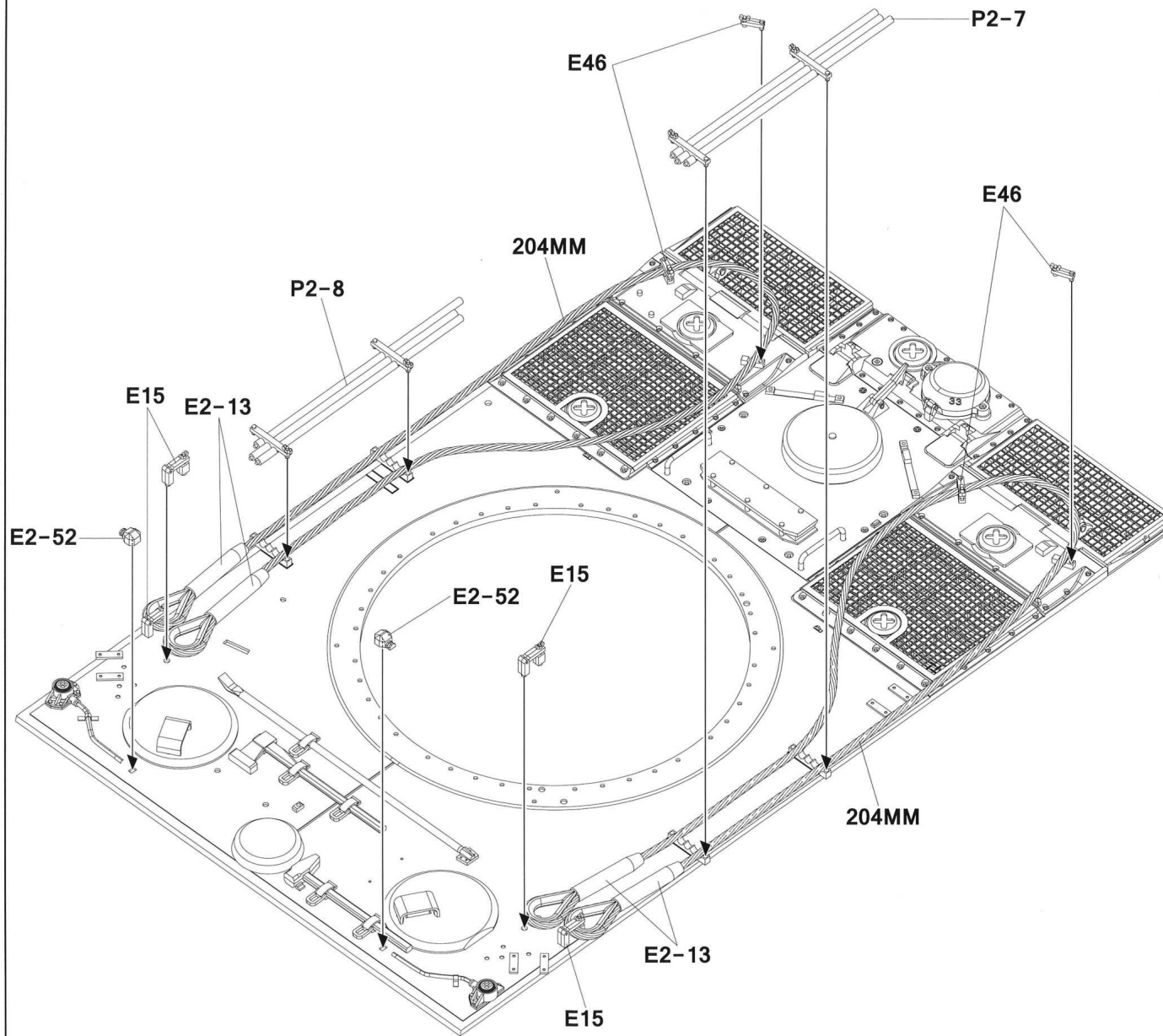

16

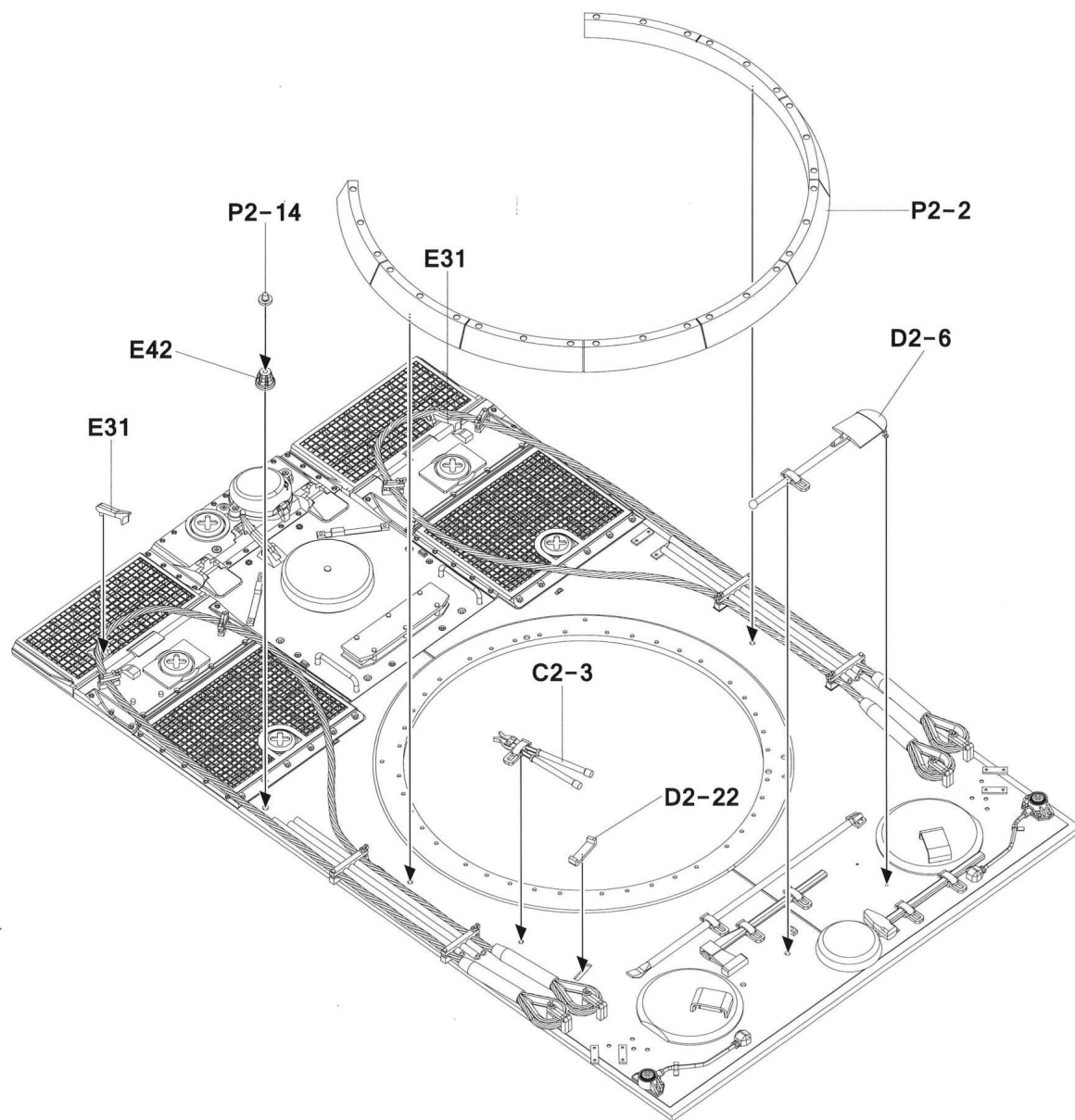

17

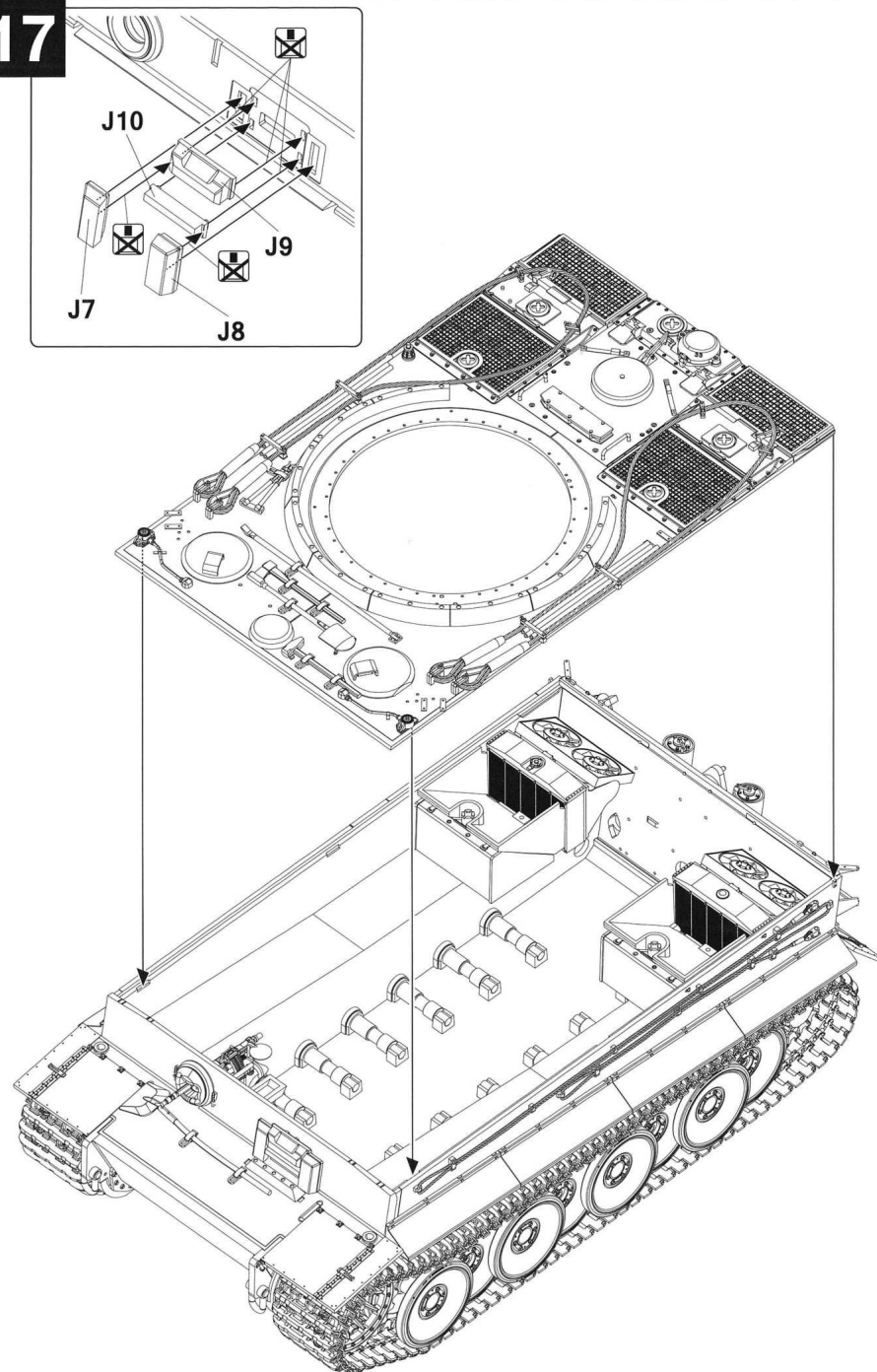

18

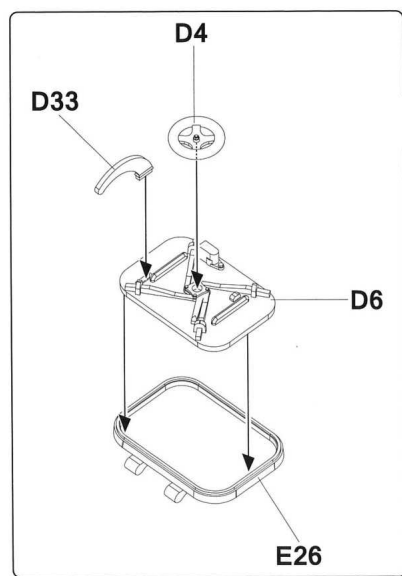
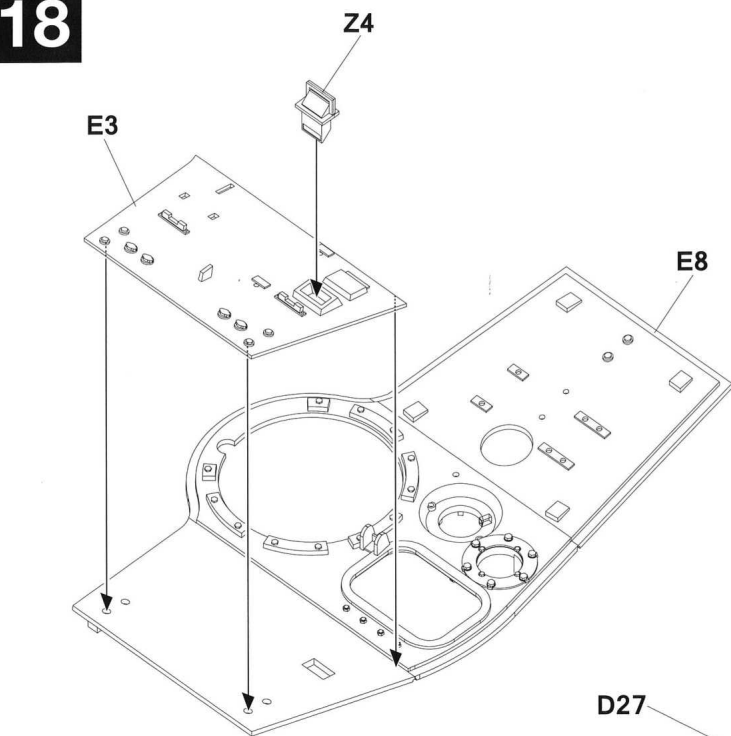

19

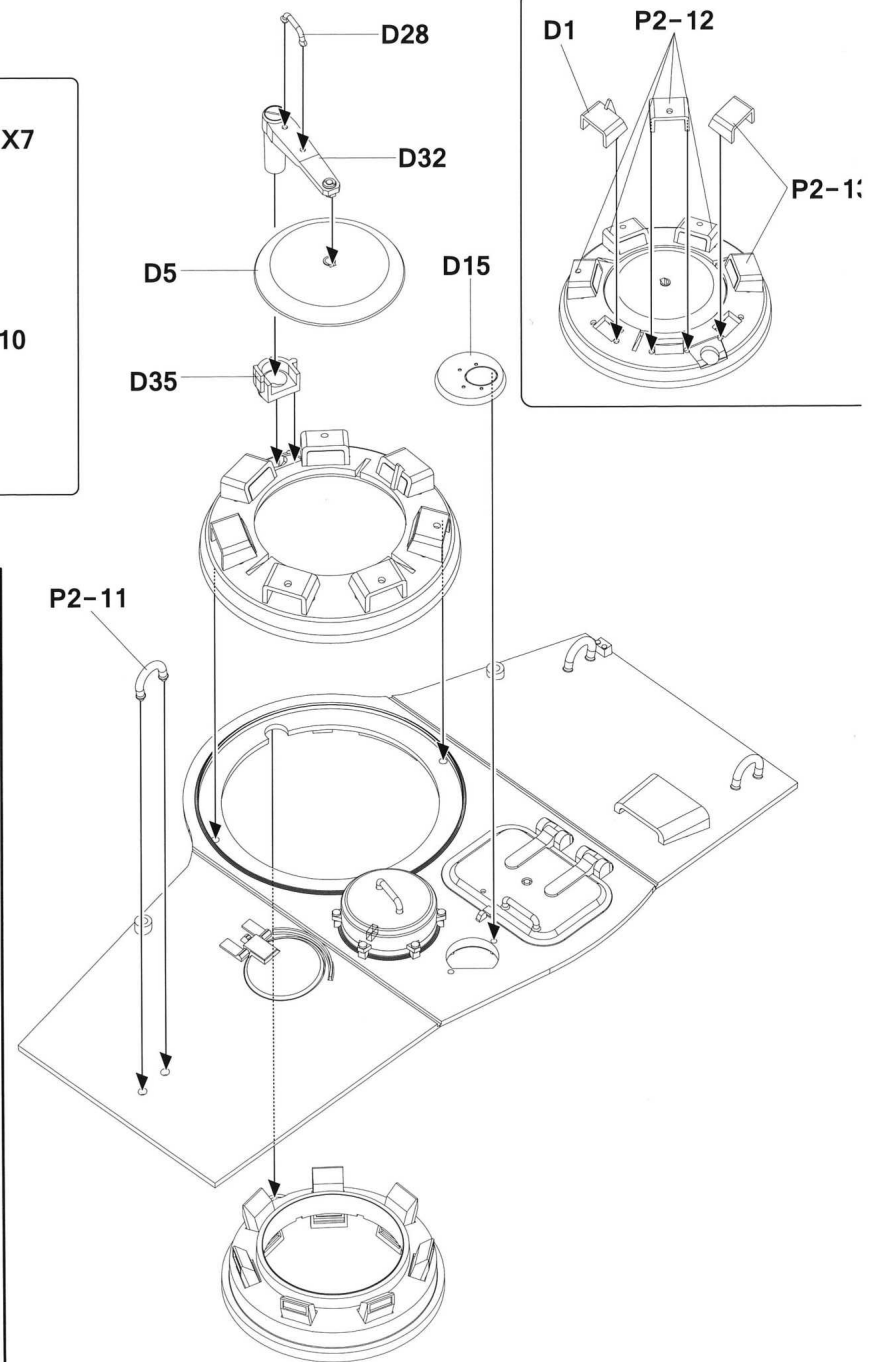
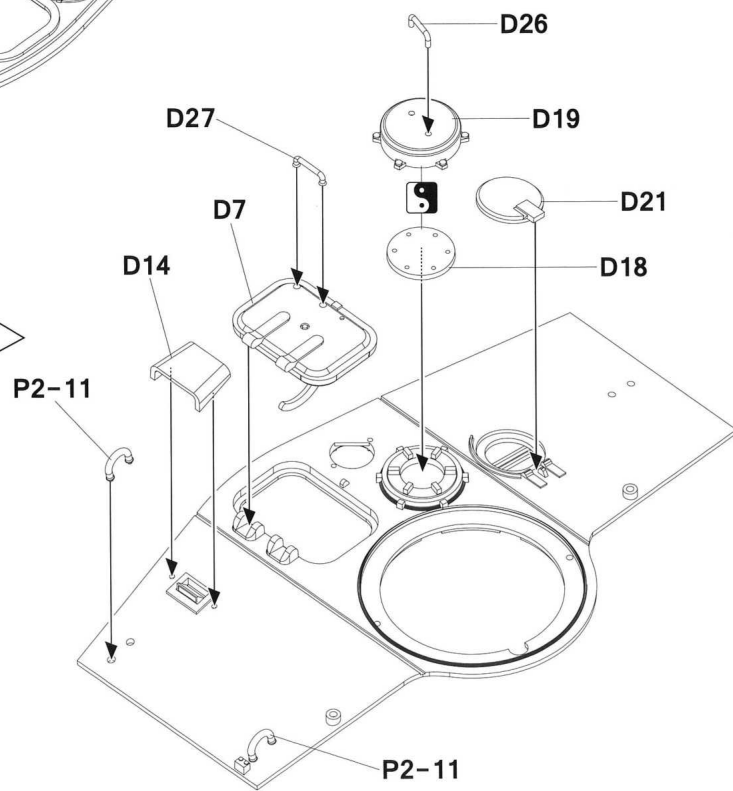
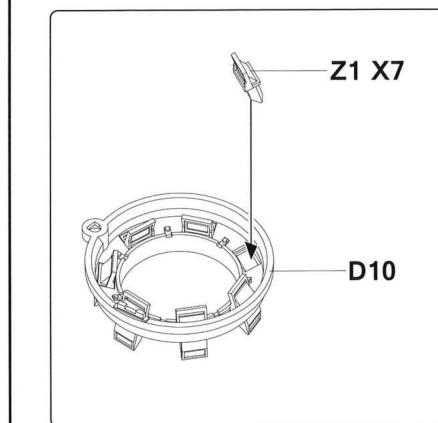

# 20

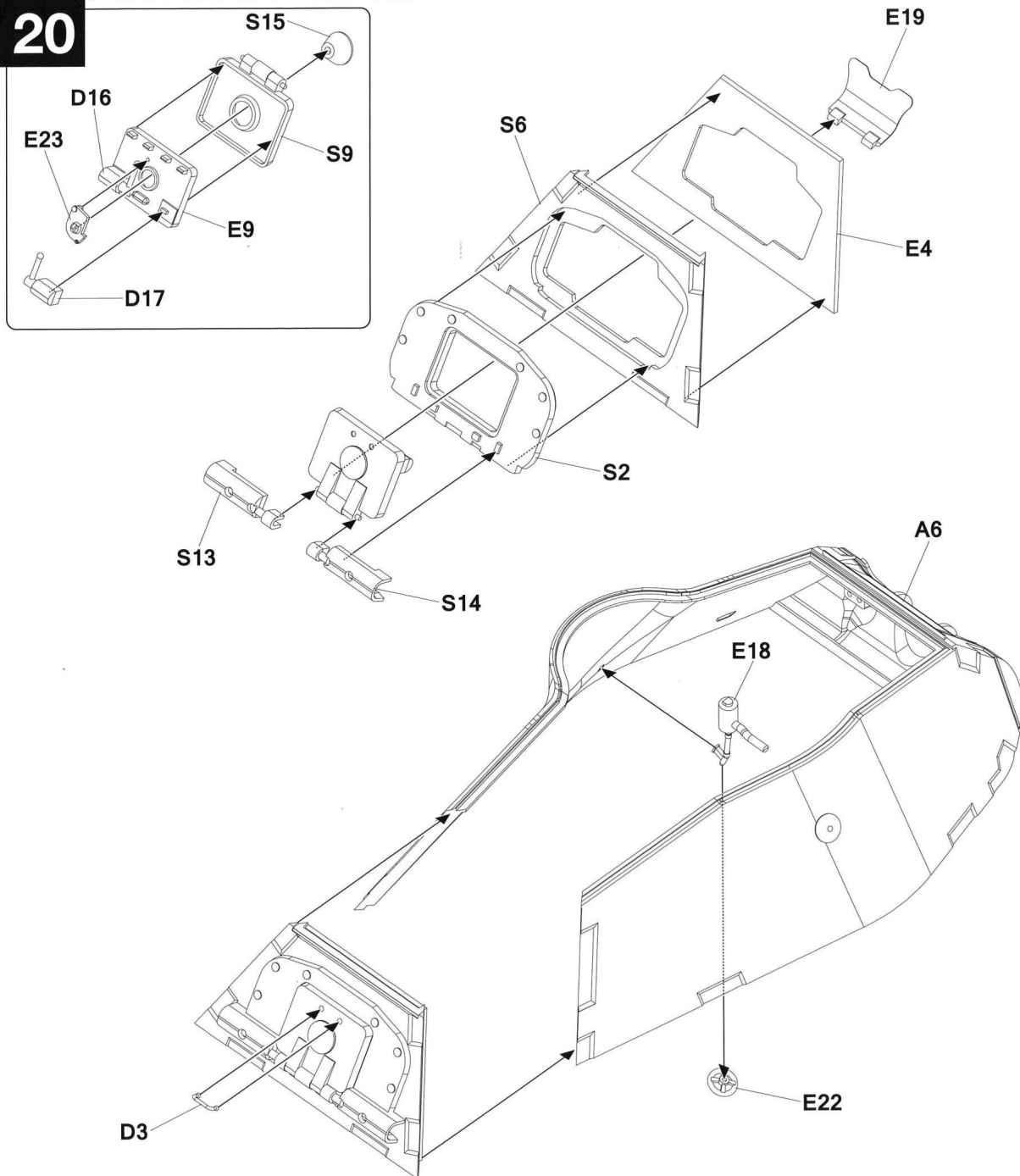

# 21

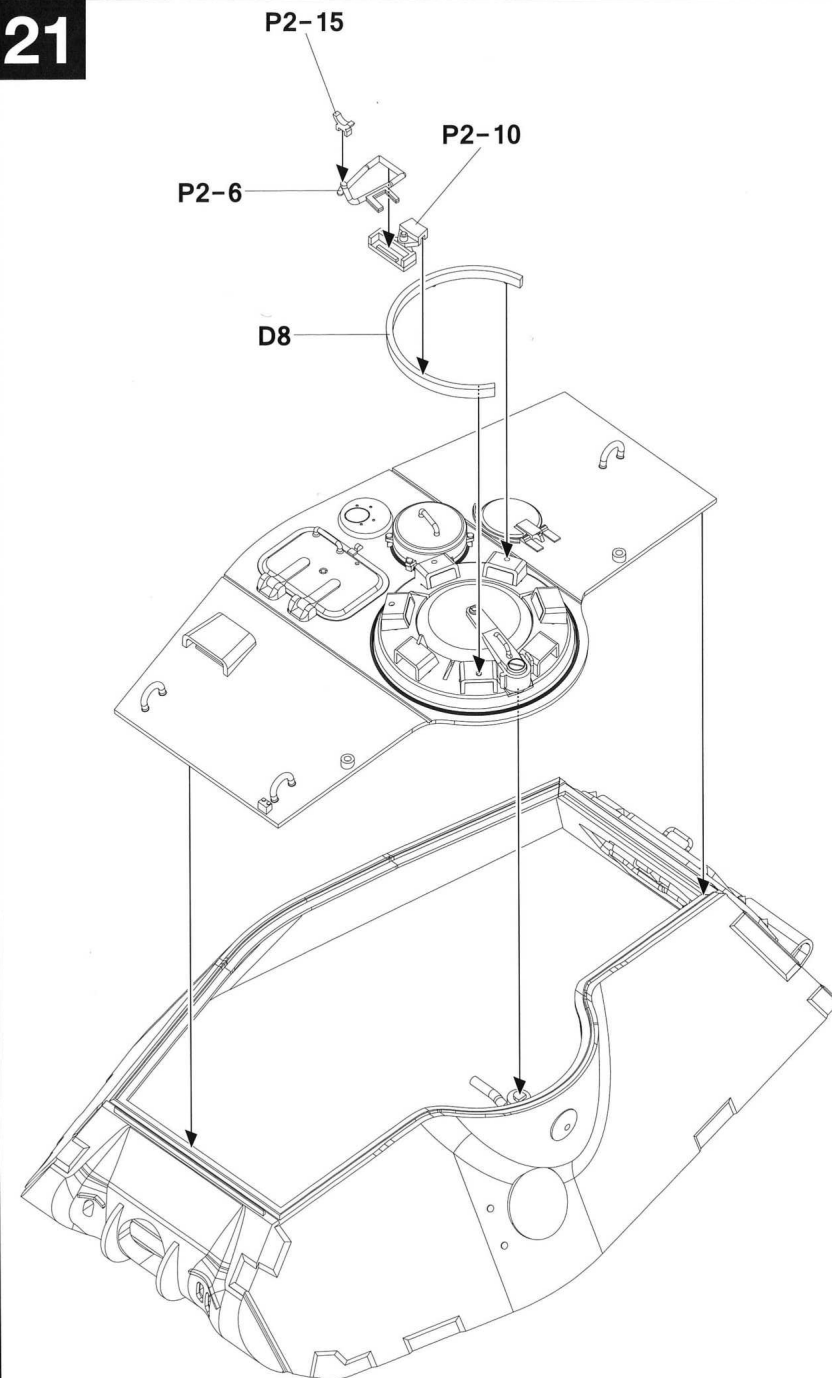

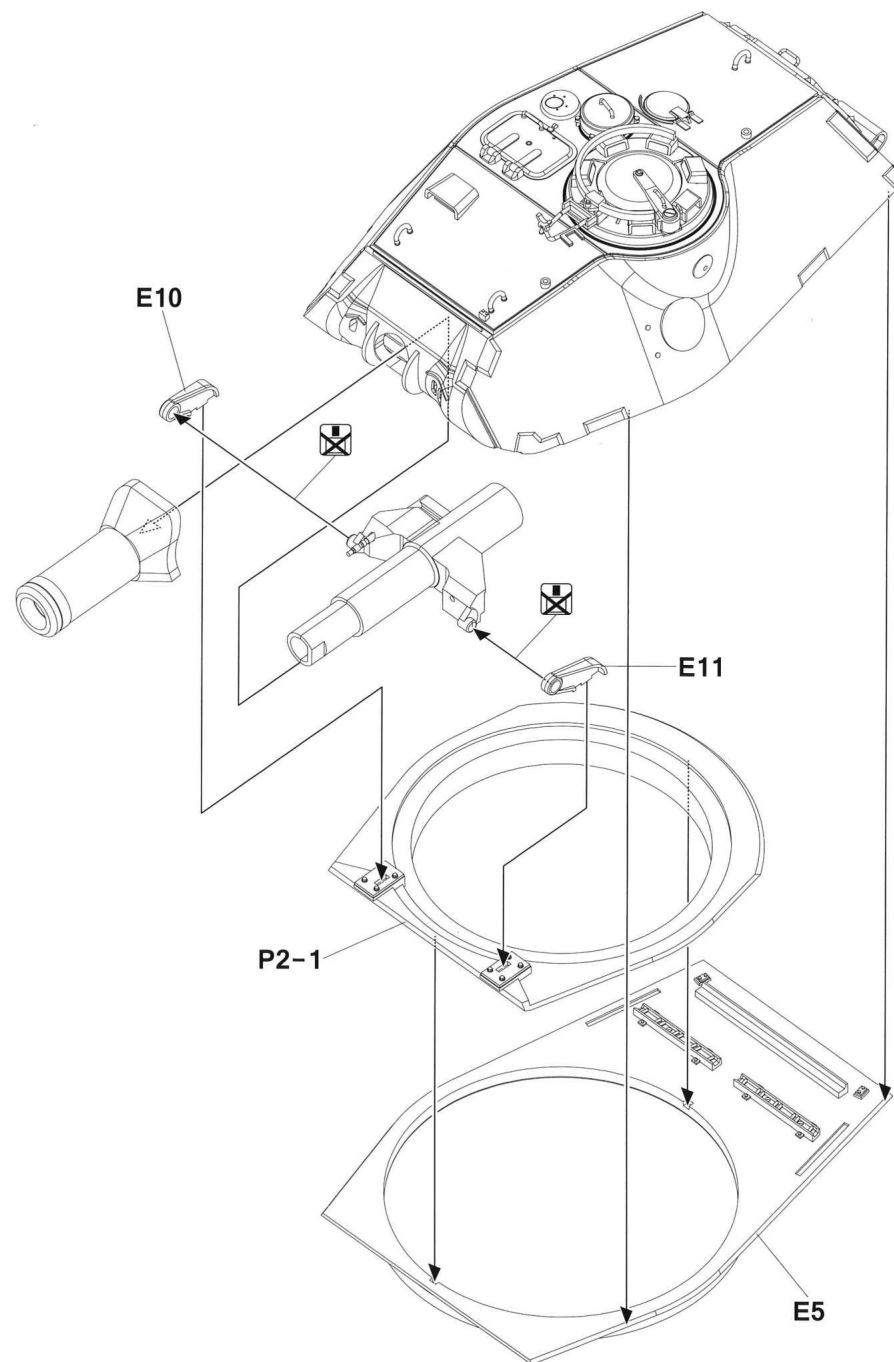
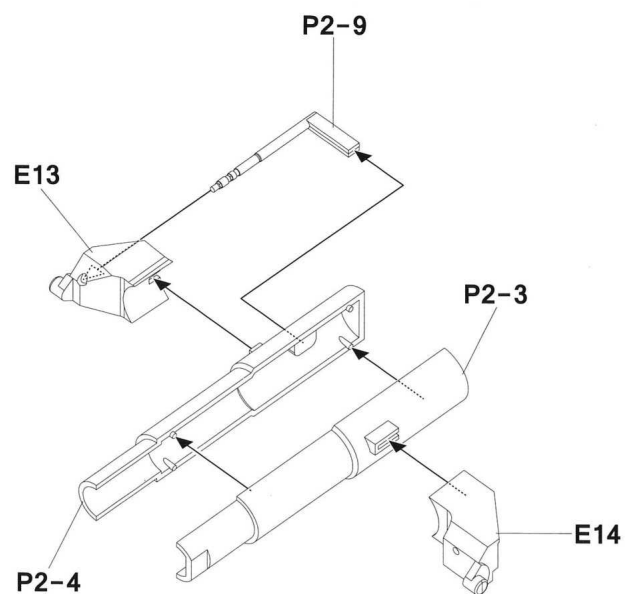
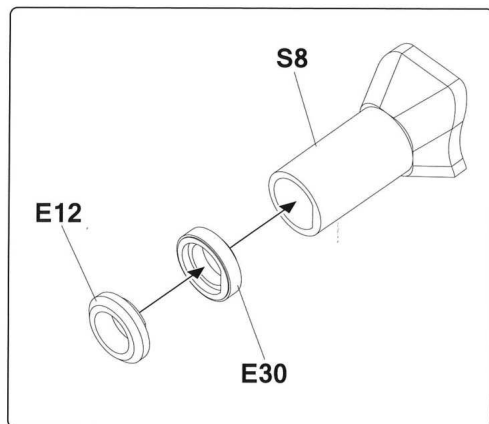

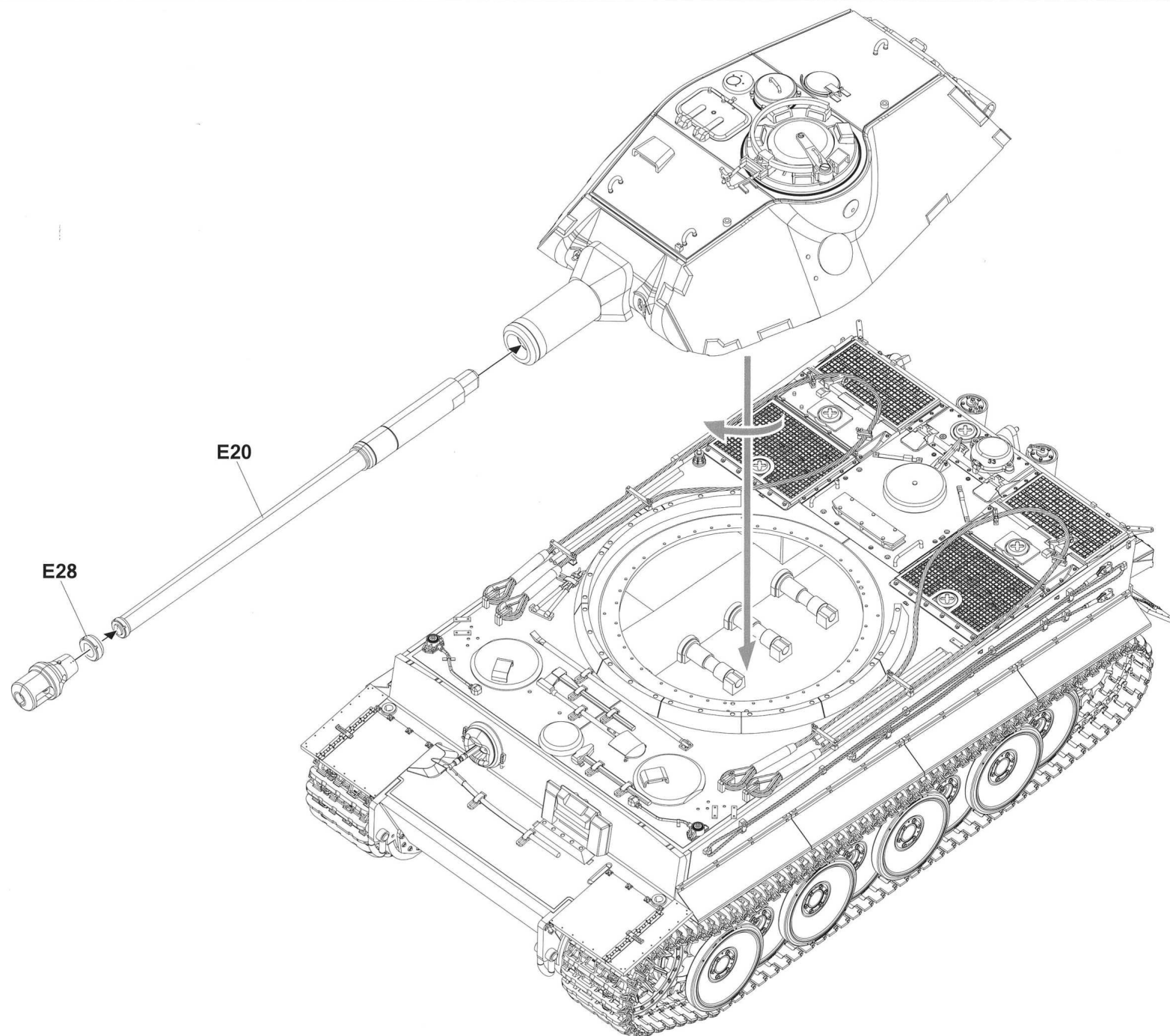

# VK 45.02(H) draft blueprint w 1461

Painting and Marking Guide

TAKOM N°: 2191

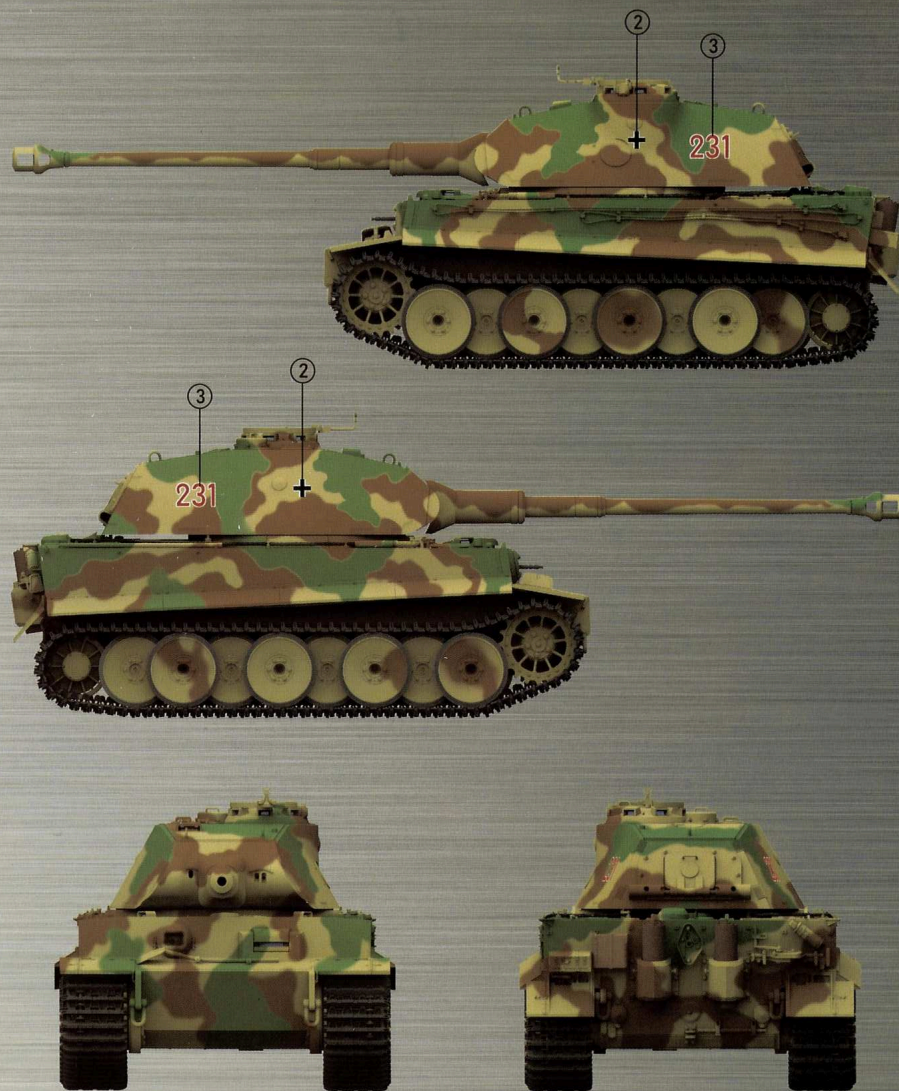

# VK 45.02(H) draft blueprint w 1461

Painting and Marking Guide

TAKOM N°: 2191

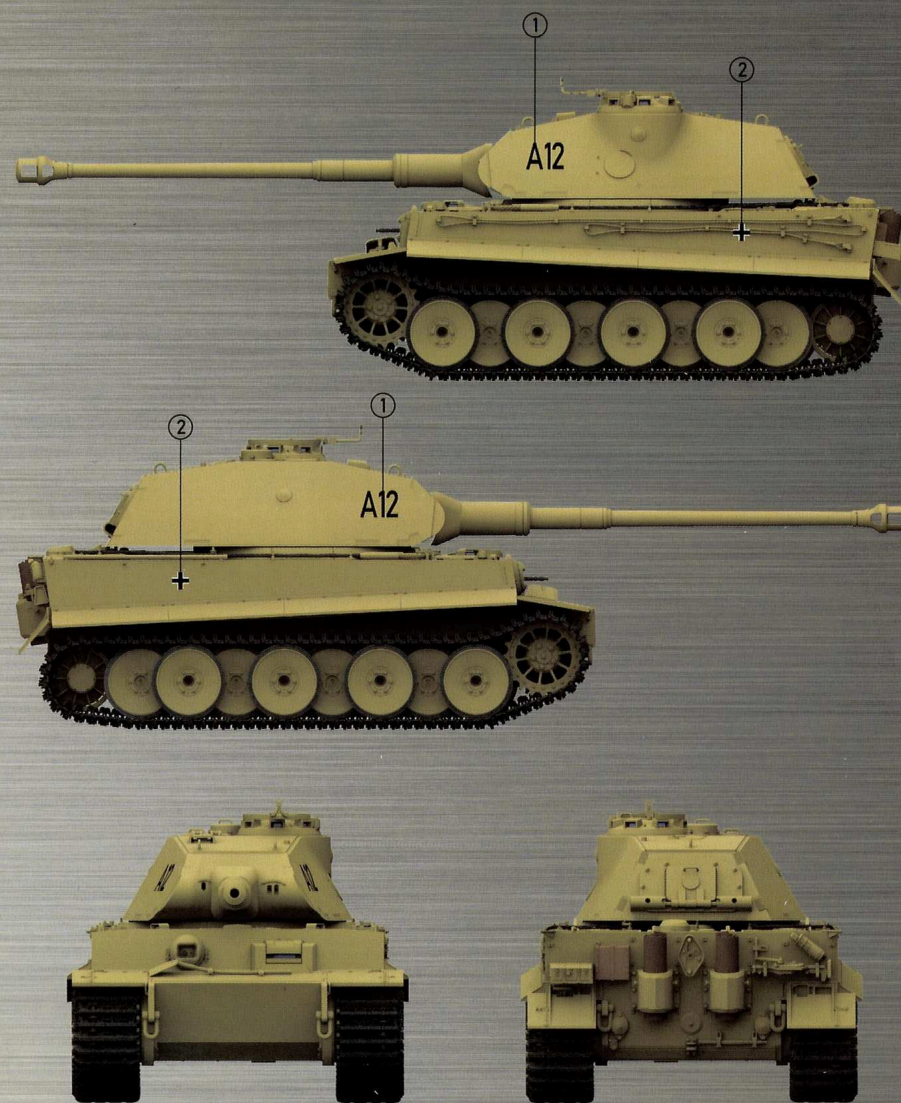

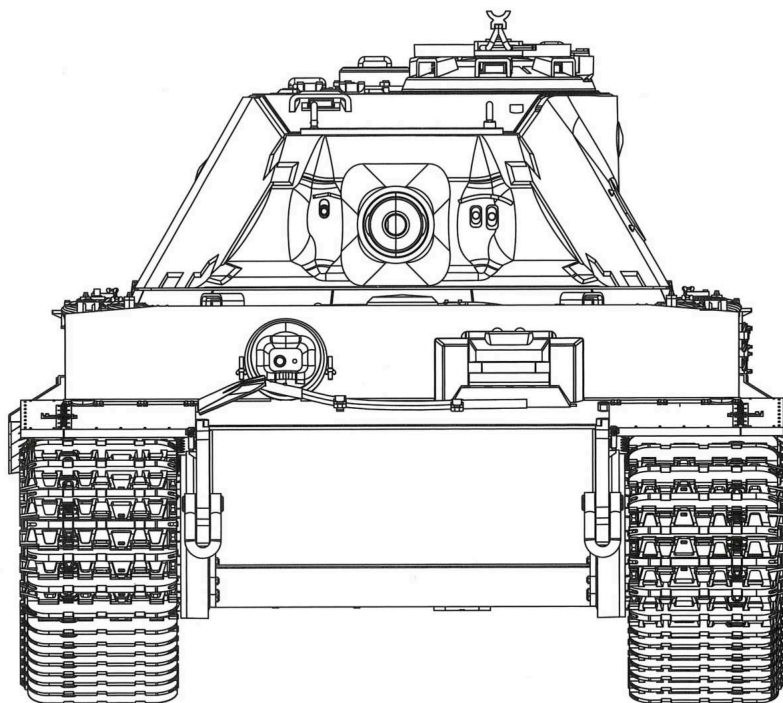

You can find TAKOM on Facebook.com