

SM K72-40



S&M Models

Scale 1:72

BAC Canberra B.2

The Canberra was developed in the late 40's as a jet bomber to replace the Mosquito. It proved to be a very adaptable design and served with British and many overseas armed forces for many years.

The B2 and the Trainer T4 were the basis for many variants and also was developed into the B57A operated by the USAF. Many preserved airframes can still be seen preserved at various museums around the world.

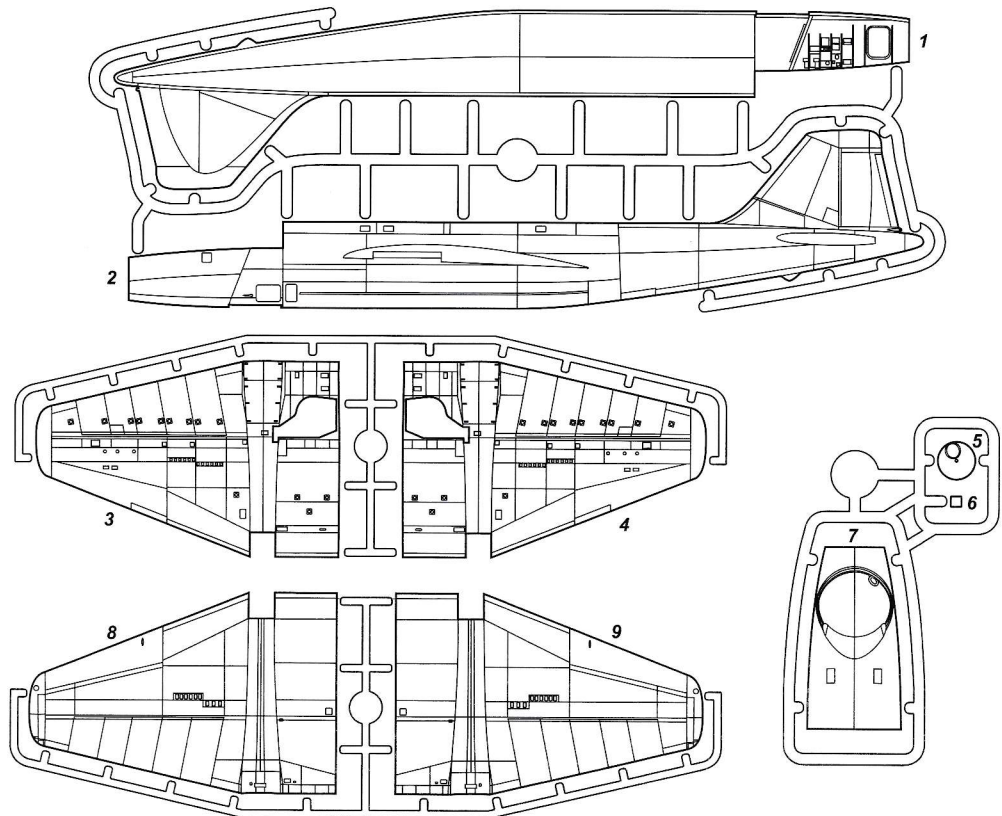

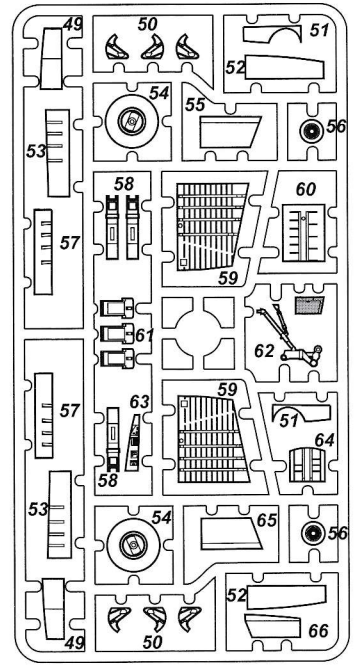
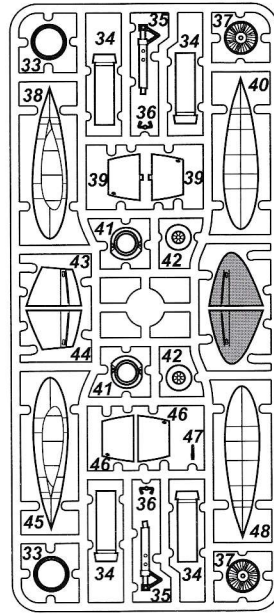
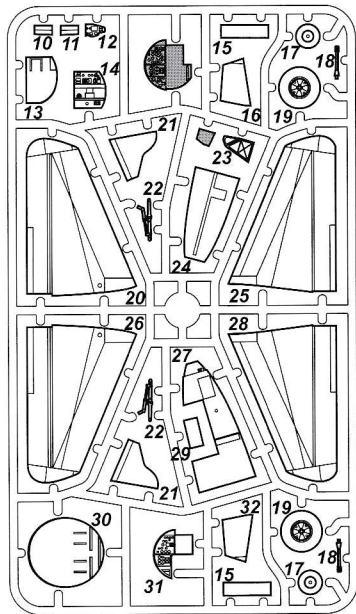

1 3x

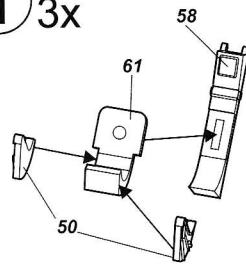

2

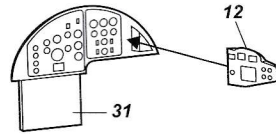

3

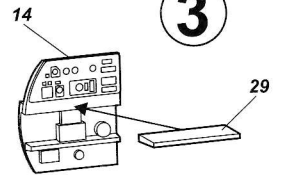

4

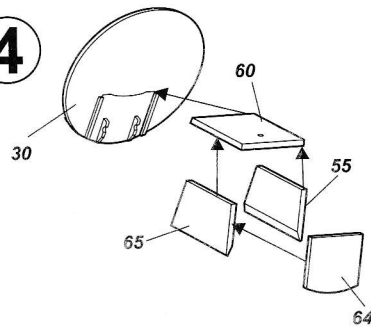

5

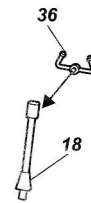

6

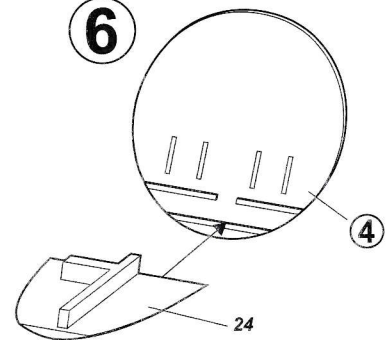

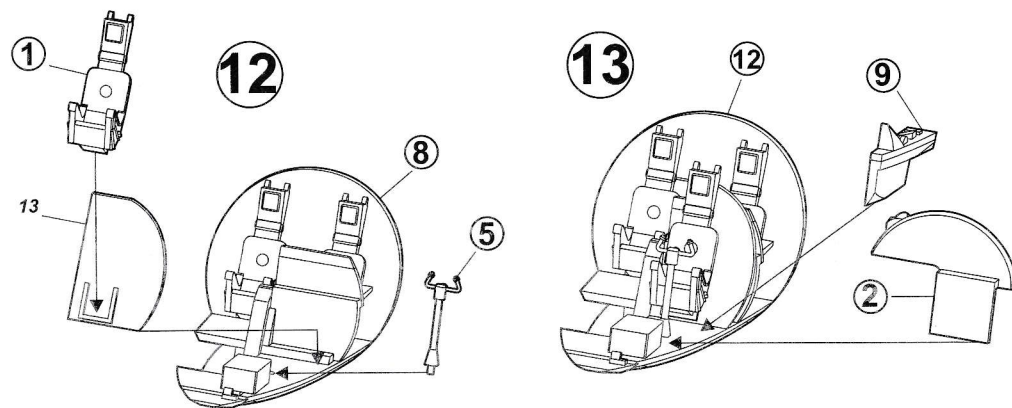
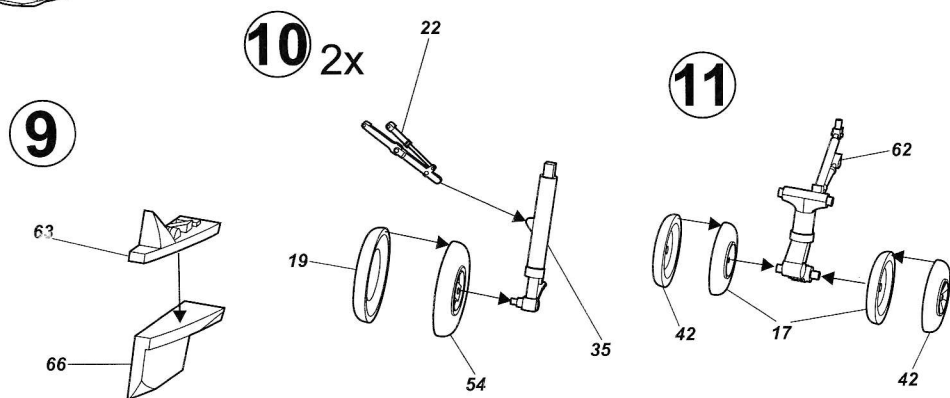
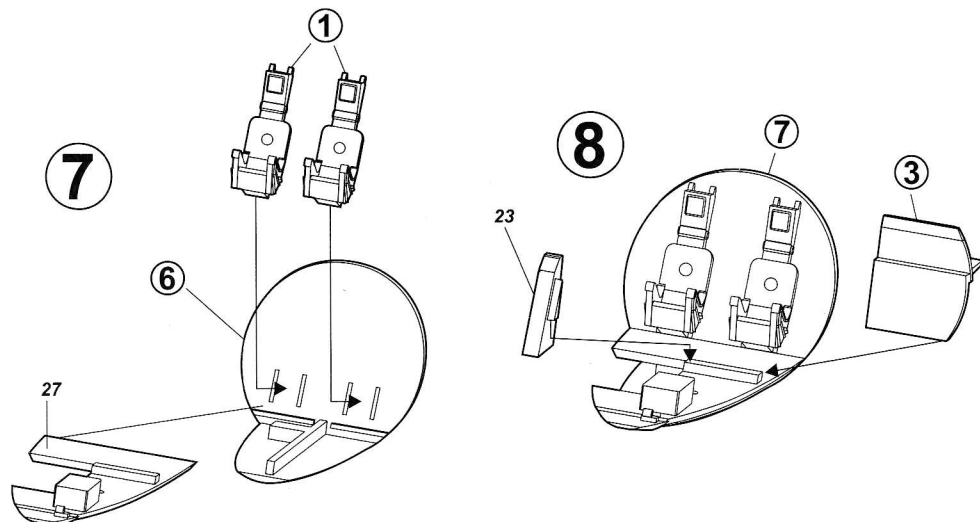

14 2x

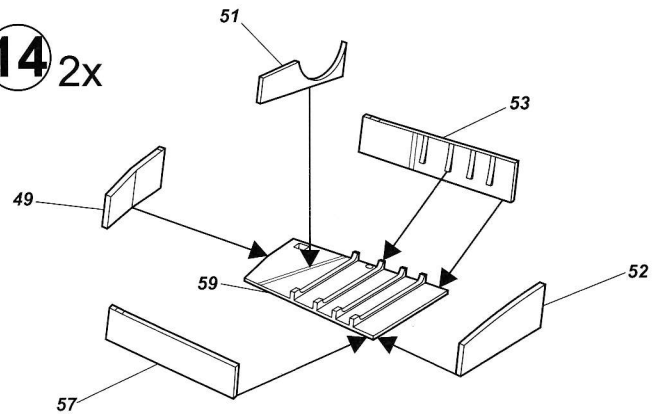

15

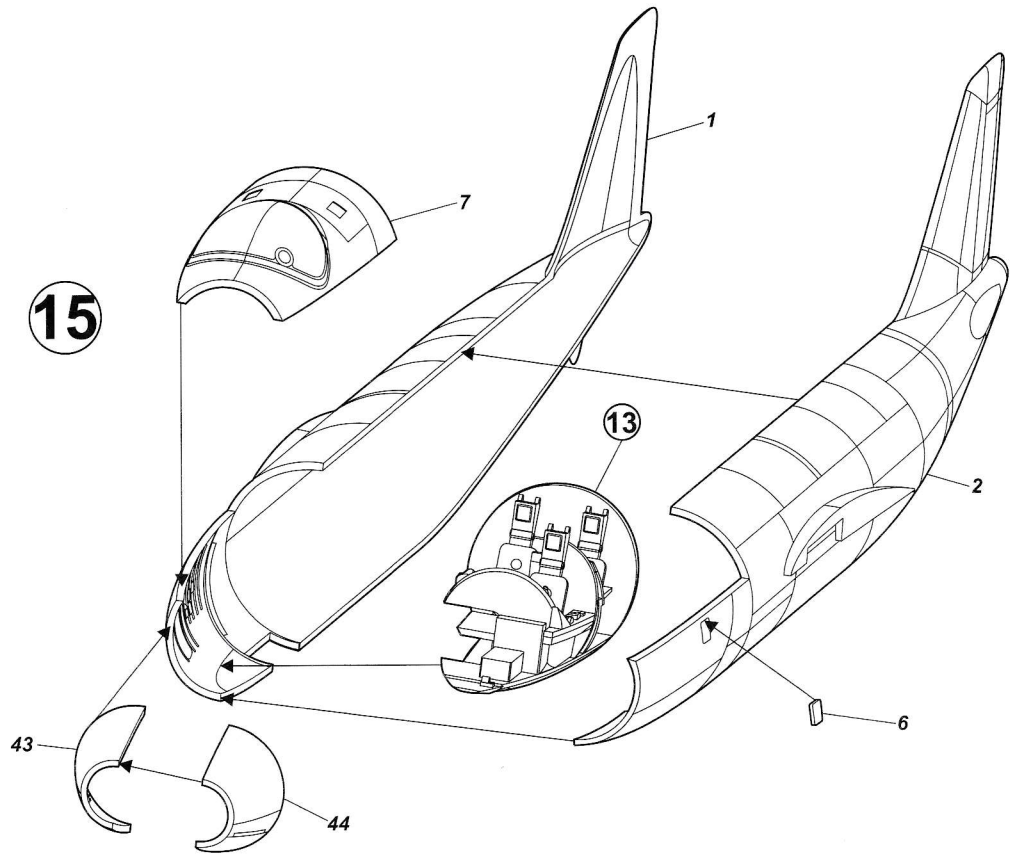

16 2x

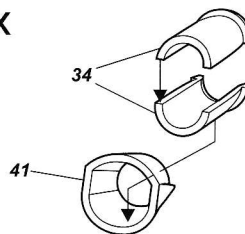

17 2x

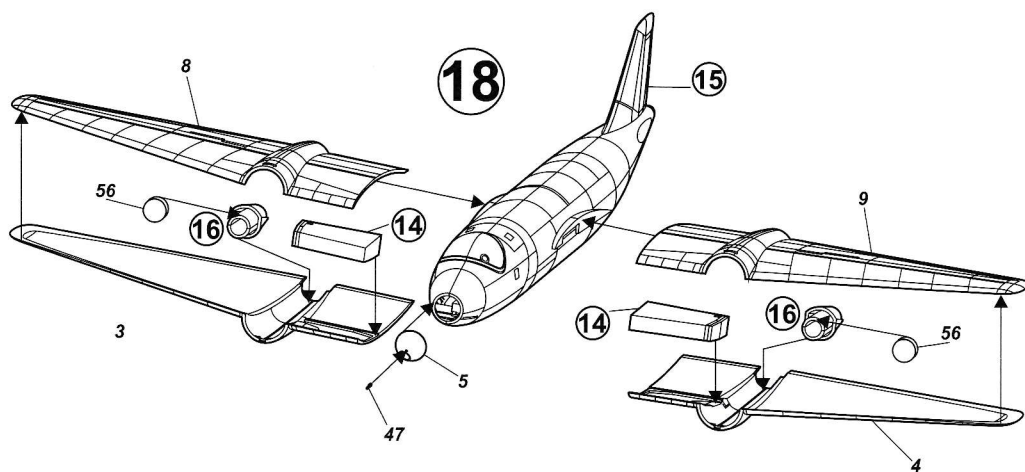
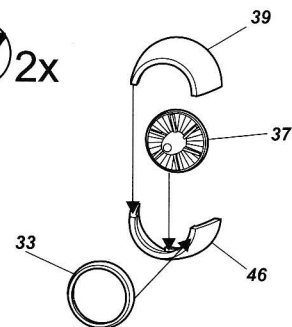

19

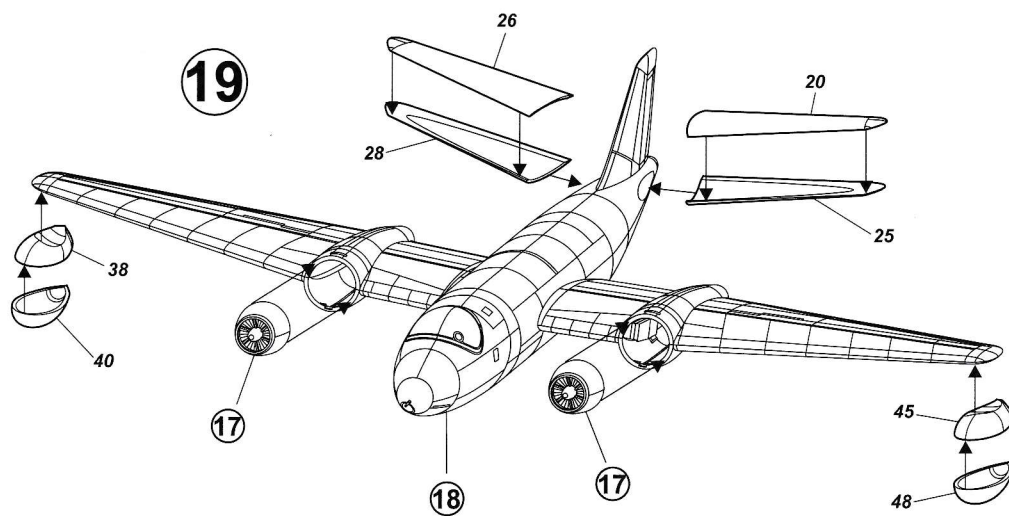

20

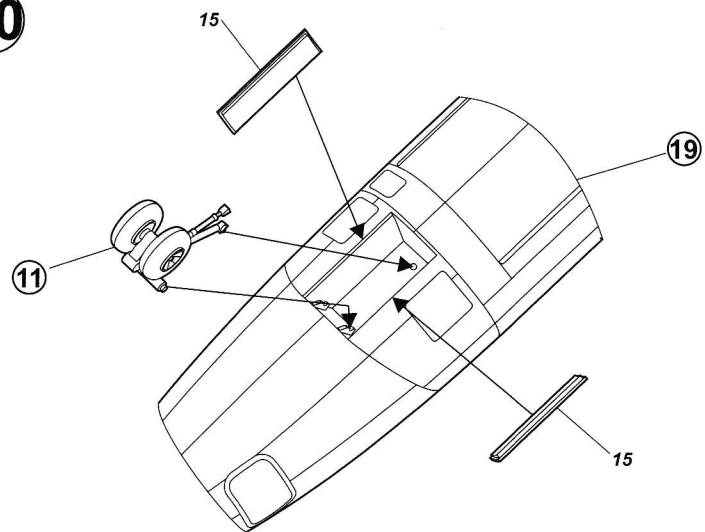

21

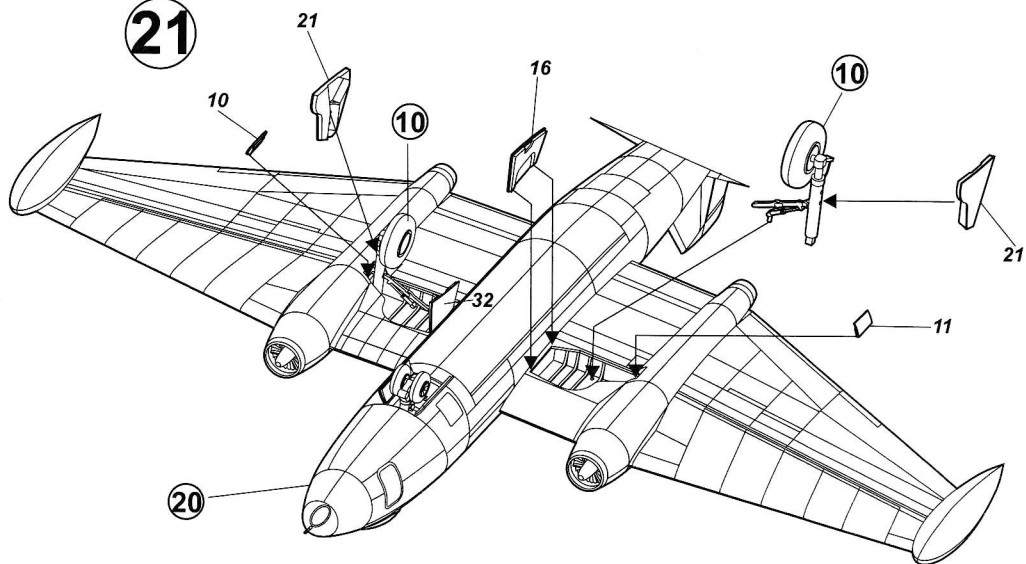

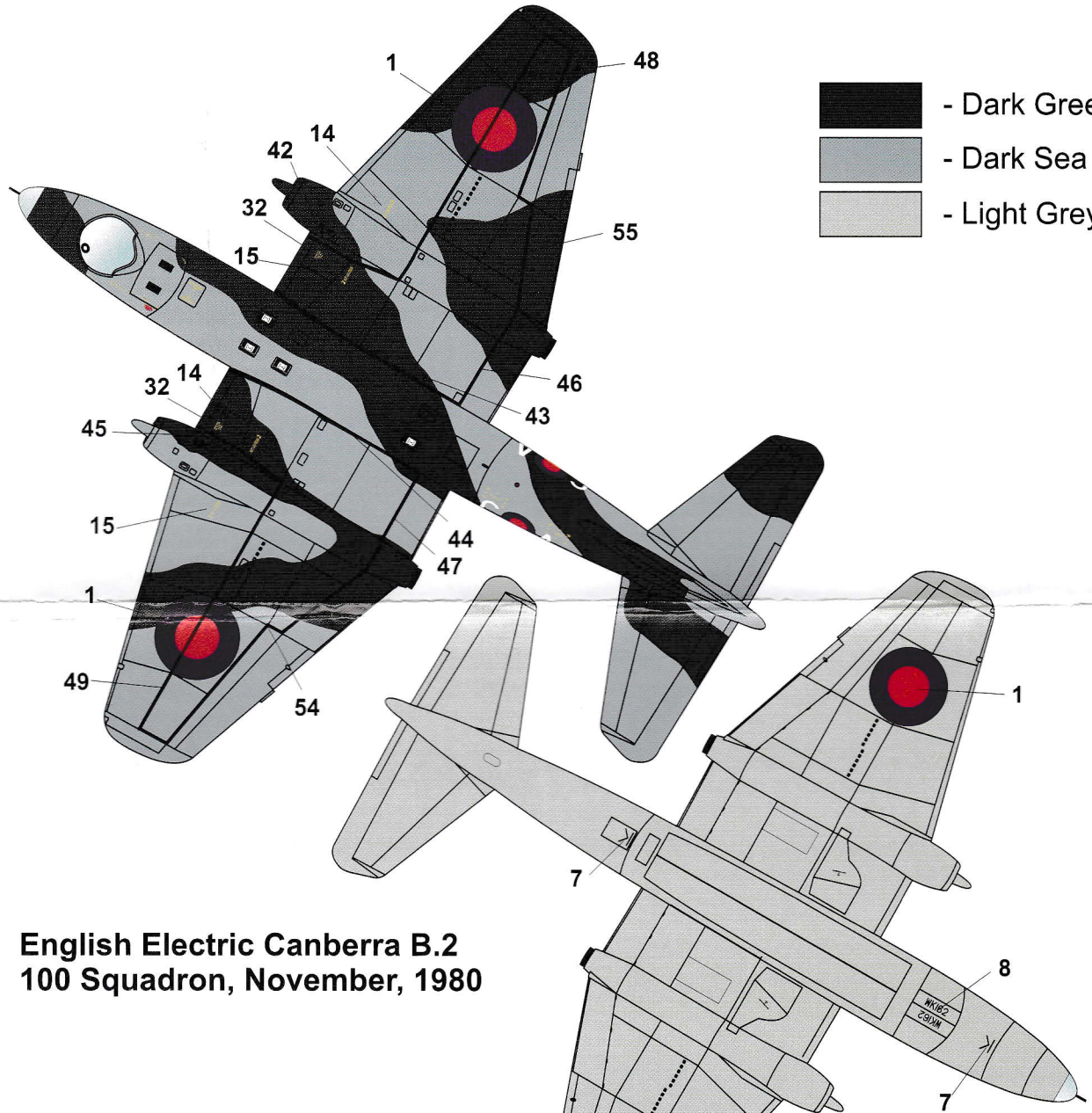
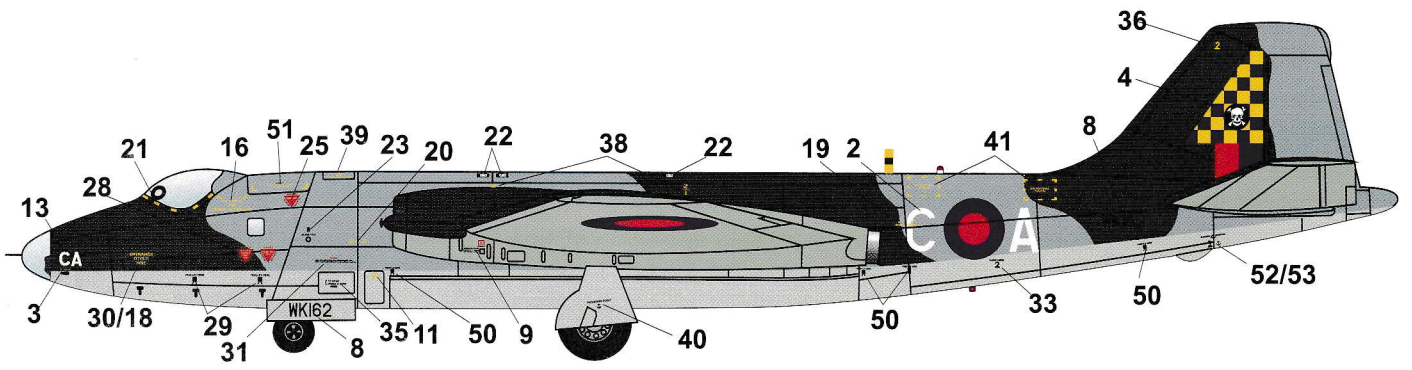

- Dark Green
- Dark Sea Grey
- Light Grey

**English Electric Canberra B.2
100 Squadron, November, 1980**

