



# Hawker HURRICANE MK.I

1/32 scale

## EARLY VERSION

### Pacific Coast Models, Inc.

613 Martin Ave., Bldg. 106  
Rohnert Park, CA, USA 94928-2000  
e-mail: [info@pacmodels.com](mailto:info@pacmodels.com)  
[www.pacmodels.com](http://www.pacmodels.com)

Hawker Aircraft Company showed great foresight in March of 1934 when their chief designer, Sidney Camm learned of a new Rolls-Royce engine under development and began the design of a new monoplane to take advantage of the new RR engine. This began as a private venture with no funds from the British Government representing a great financial risk to the company. The Air Ministry gave instructions to produce a prototype in January, 1935 which flew in November, 1935.

It was powered by a 990 hp Merlin "C" engine equipped with a two-bladed fixed pitch wooden propeller and armed with 8 Browning .303 machine guns. Top speed was 315mph at 16,200 feet. The results of the trials convinced Hawker to prepare for the production of 1000 aircraft before actually receiving a government order. Because of this preparation, when the first order for 600 aircraft was received, drawings began to reach the production shops and the first production aircraft flew on October 12, 1937. Apparently Hawker Aircraft Company had a different view of Adolph Hitler than did the Labour Government.

The fabric covered wings on the earliest version was due to the fact that Hawker did not have the experience or the equipment to make metal stressed skin wing coverings. The second order for 300 aircraft had an armored windscreen, the Merlin III engine and a 3 bladed propeller. This kit includes both types of propellers, exhaust, windscreens, lower tail section and wheels for the fabric wing versions. Various countries ordered the Hurricane MK.I including Belgium, Finland, Yugoslavia and Rumania.

These versions led to the production of the metal wing version which, during the Battle of Britain took on the German bombers while the Spitfires fought the Me.109's. It undoubtedly made a significant contribution to the defeat of the Luftwaffe over Great Britain. Later versions were used as ground attack aircraft to great effect.

We wish to thank all of those whose help we had in creating this kit. Without their help, it would not have been possible. We hope you like it. Thank you and

Best Regards,  
Ken & Mary Ellen Lawrence  
Pacific Coast Models, Inc.

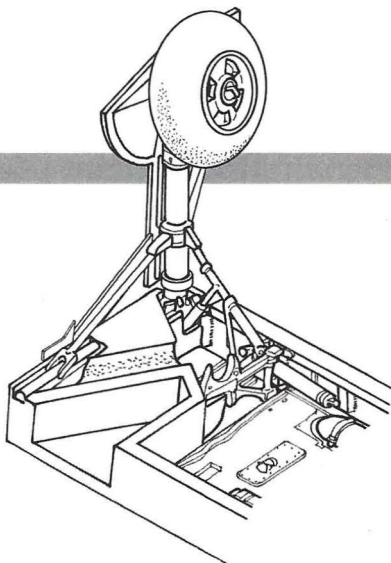
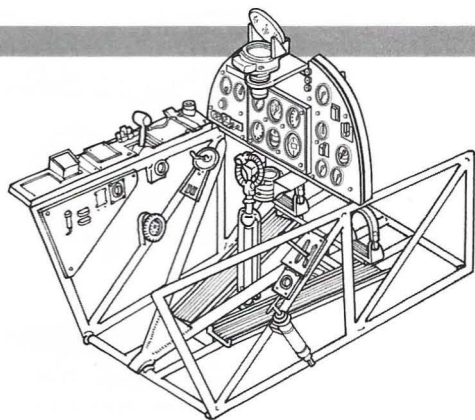

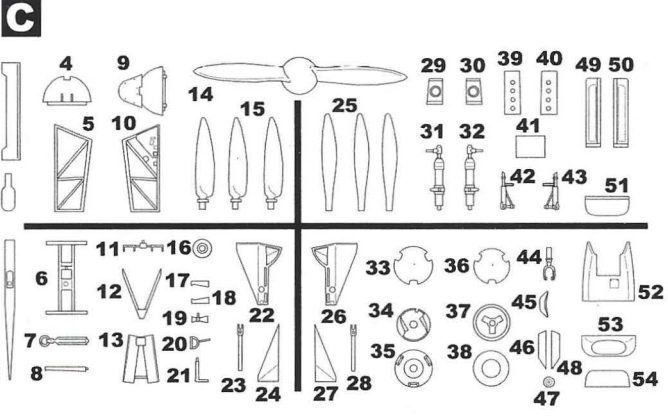
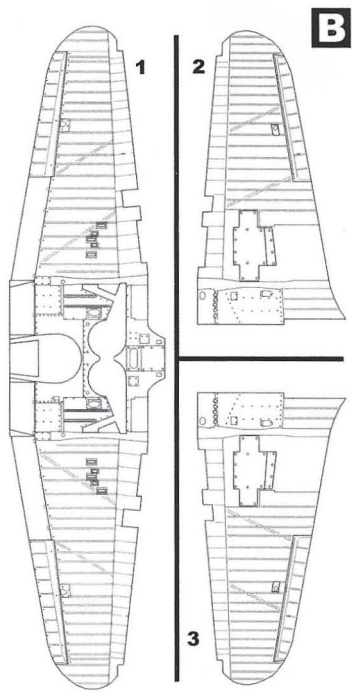
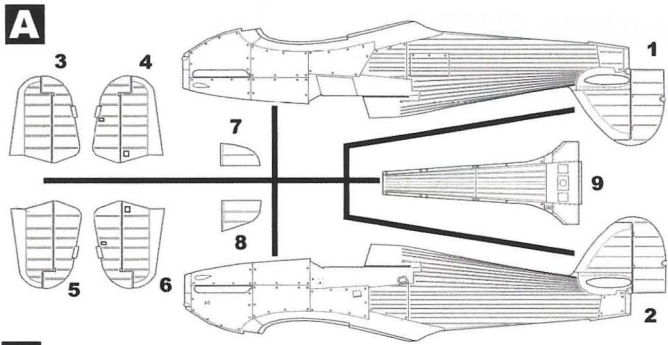

**POLYURETHAN PARTS (PUR)**

**CLEAR PARTS (CP)**

**PHOTO-ETCHED PARTS (PP)**

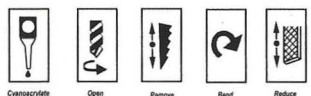
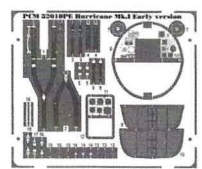
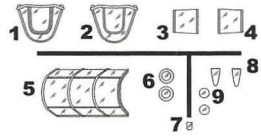
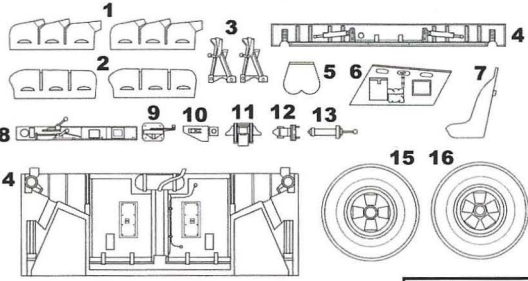

**LEGEND**

Interior Green	Black	Silver	Aluminium
Chrome	Brown	Rust	Bronze
Gun metal	Tyres Black	Medium Grey	Dark Grey

**COLOR**

Propeller: Watts Z-38  
Engine: RR Merlin II

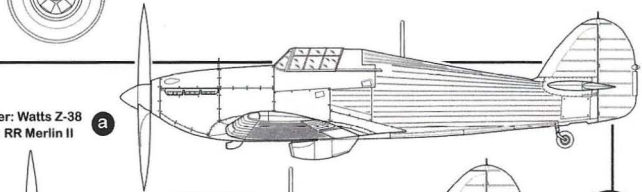

Propeller: RotoI RMS-7  
Engine: RR Merlin III

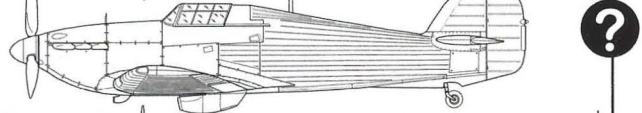

Propeller: de Havilland 5/31  
Engine: RR Merlin III

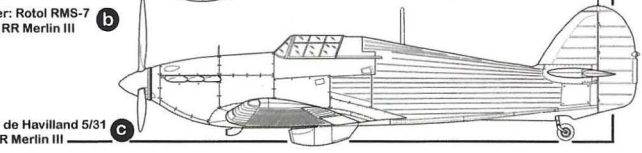

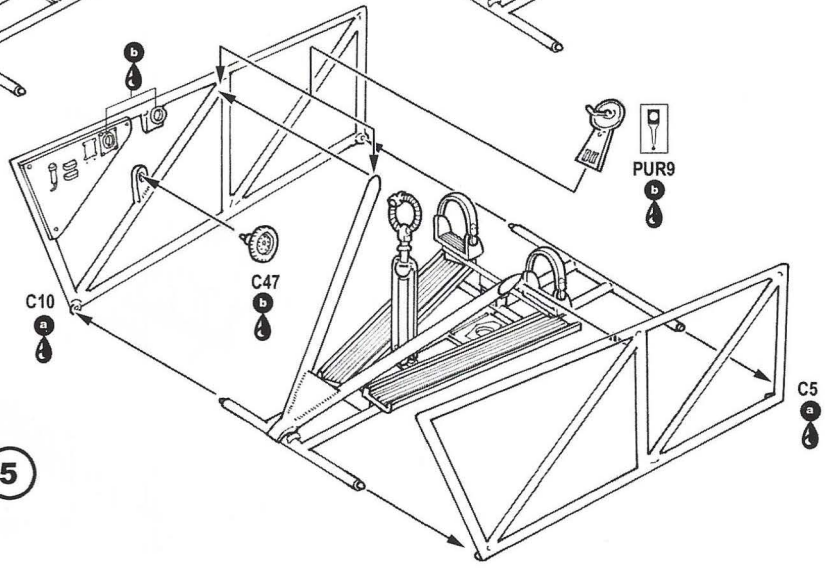
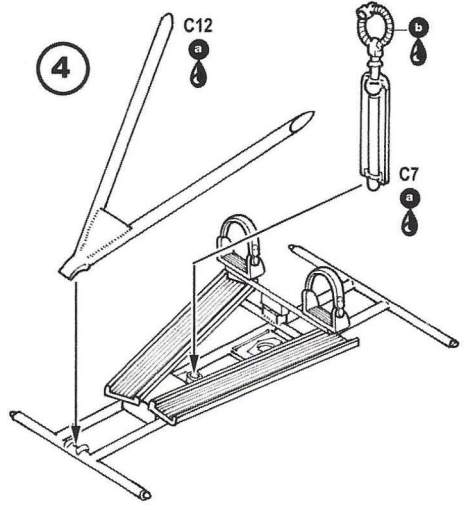
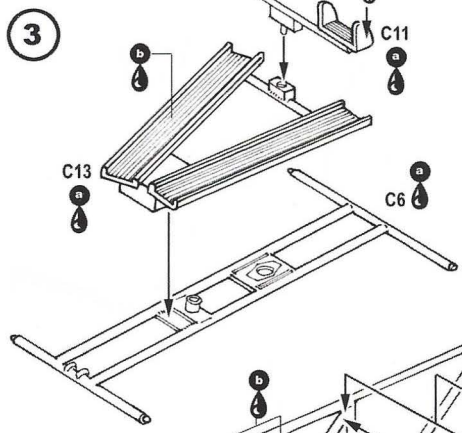
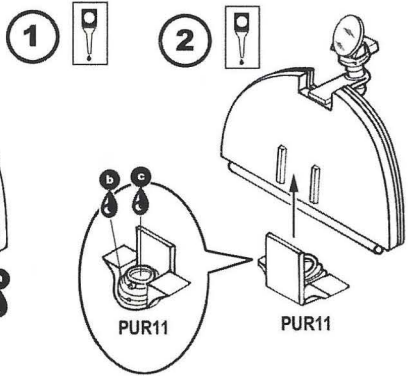
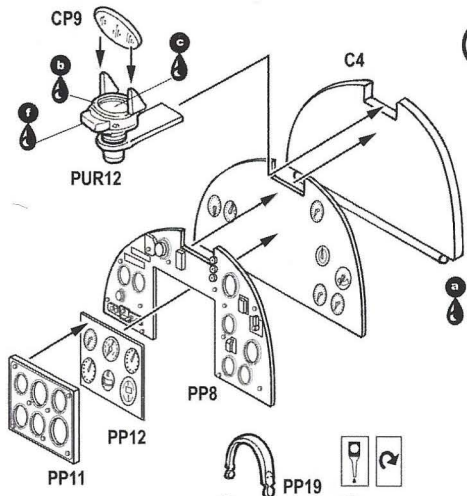

6

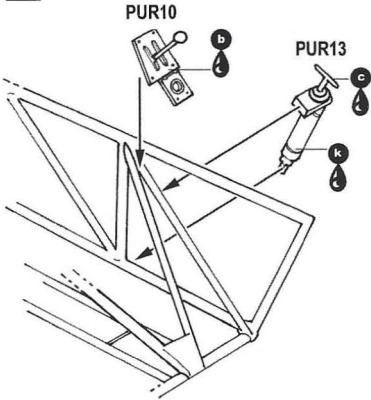

7

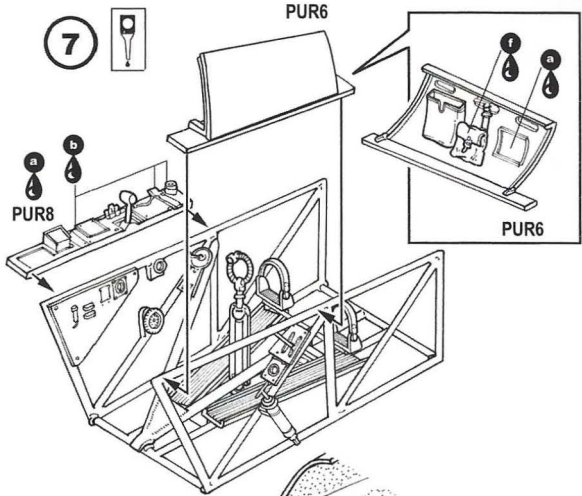

8

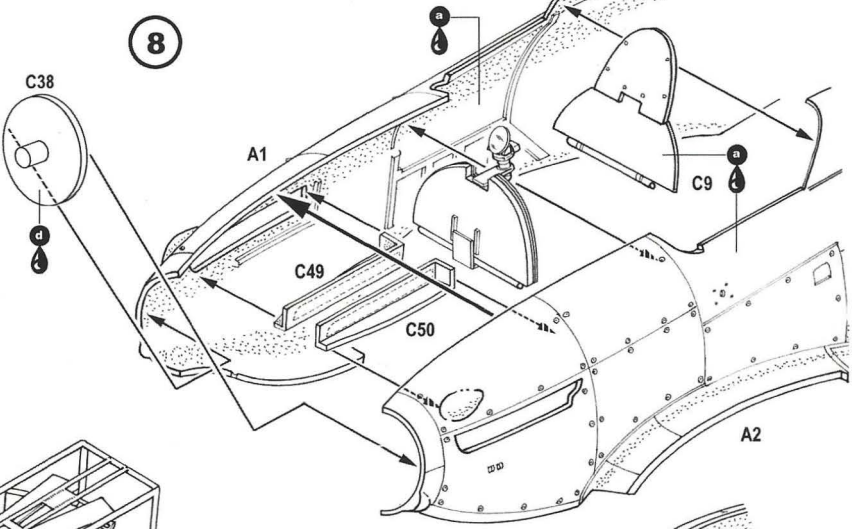

9

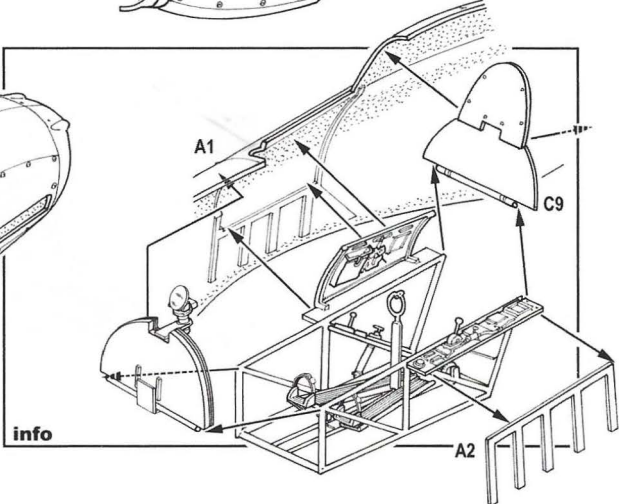
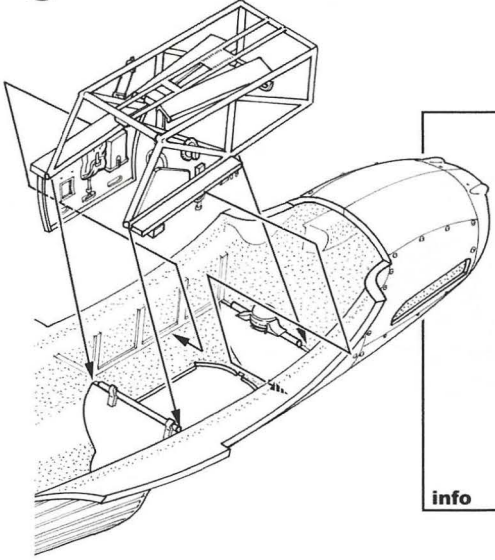

10

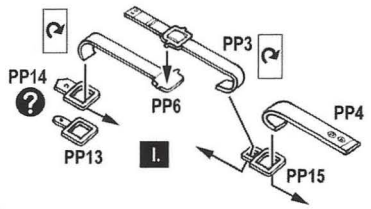
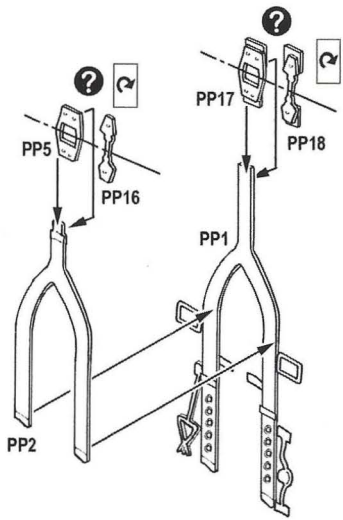

11

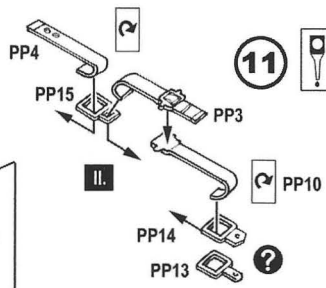

12

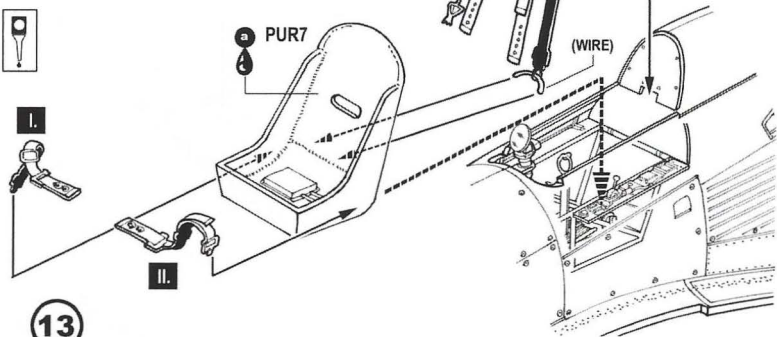

13

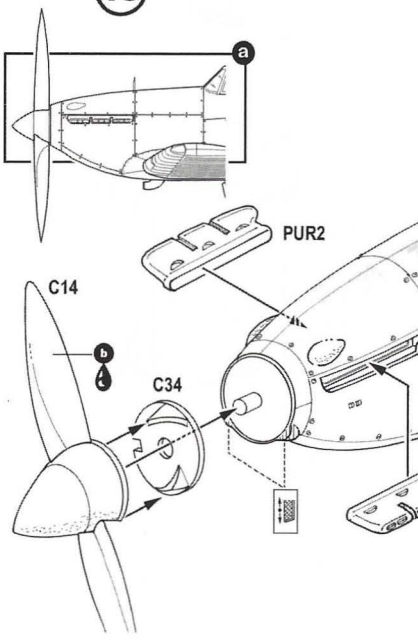

14

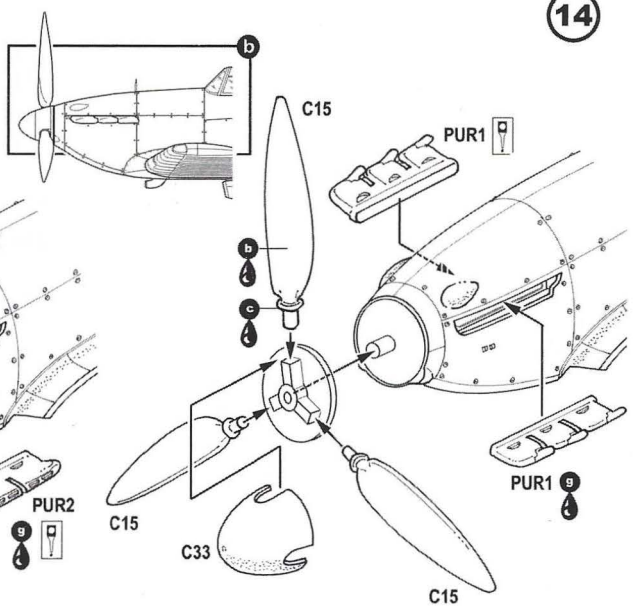

15

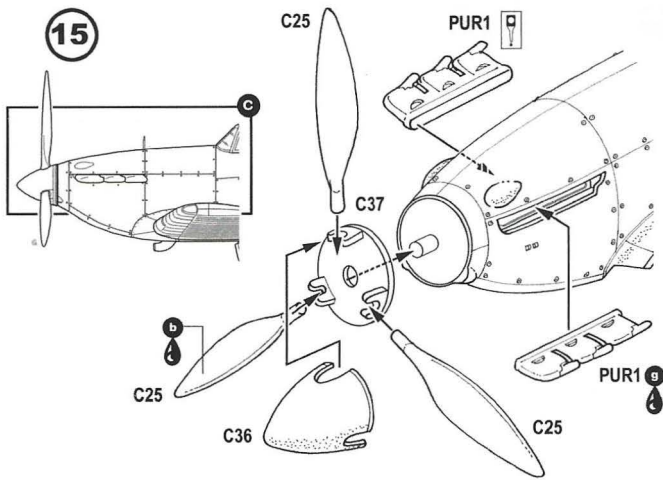

16

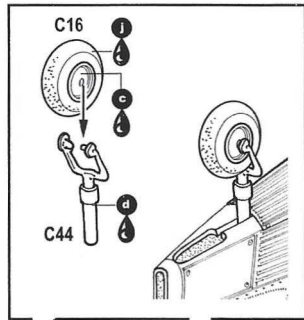

17

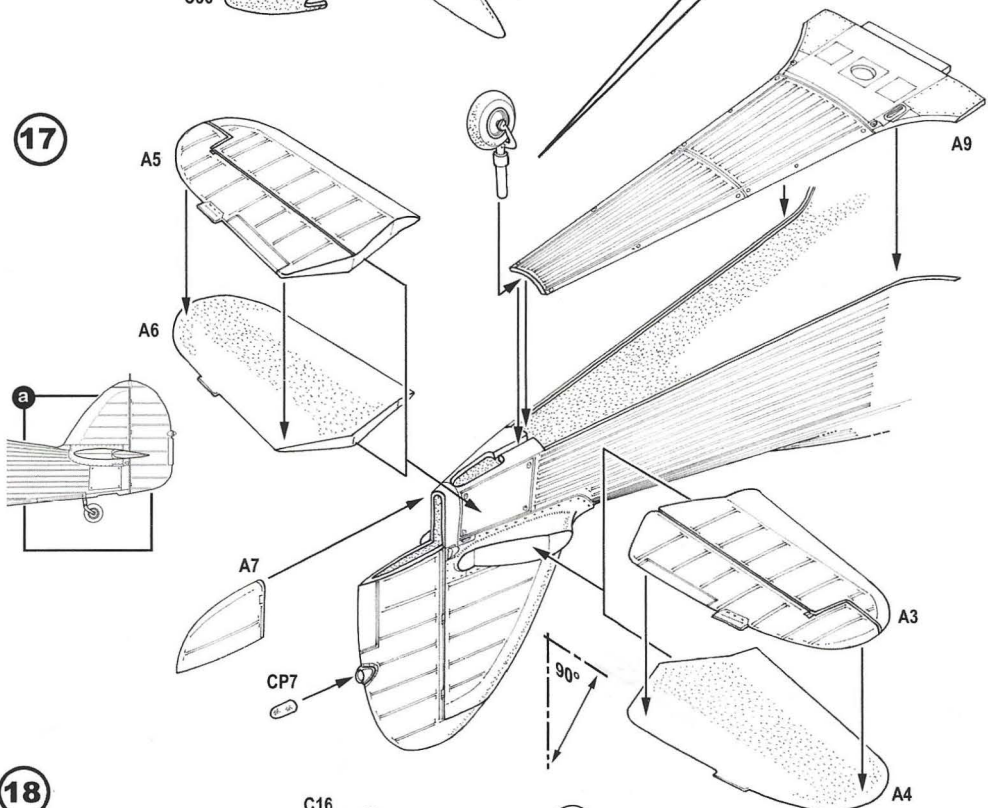

18

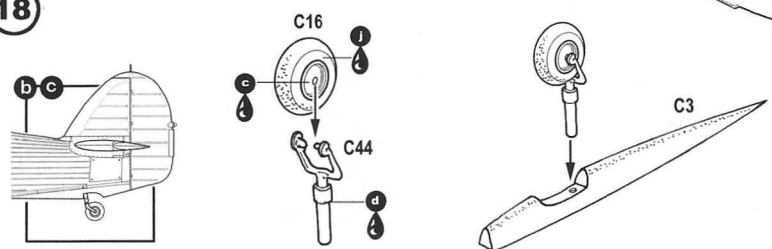

19

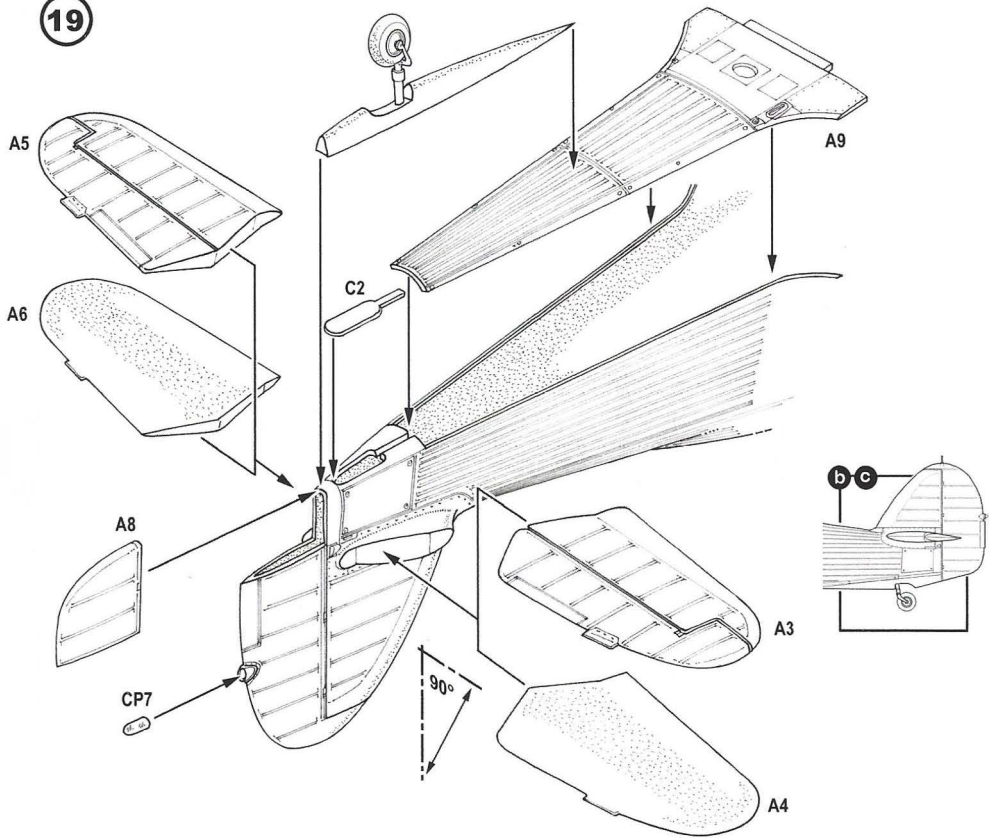

20

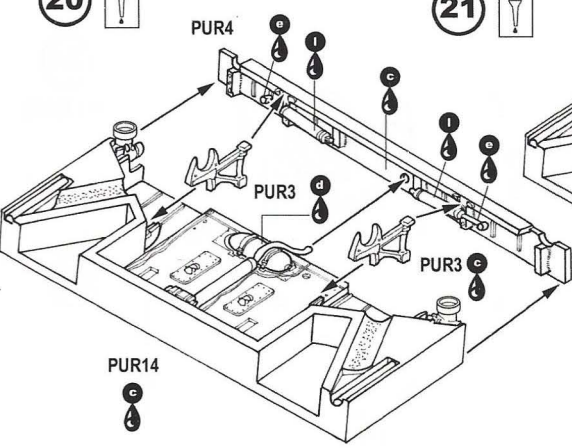

21

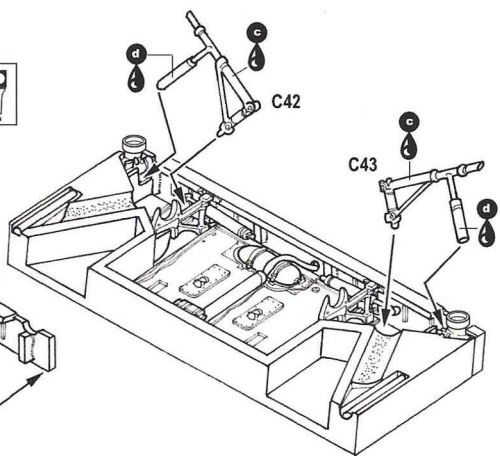

22

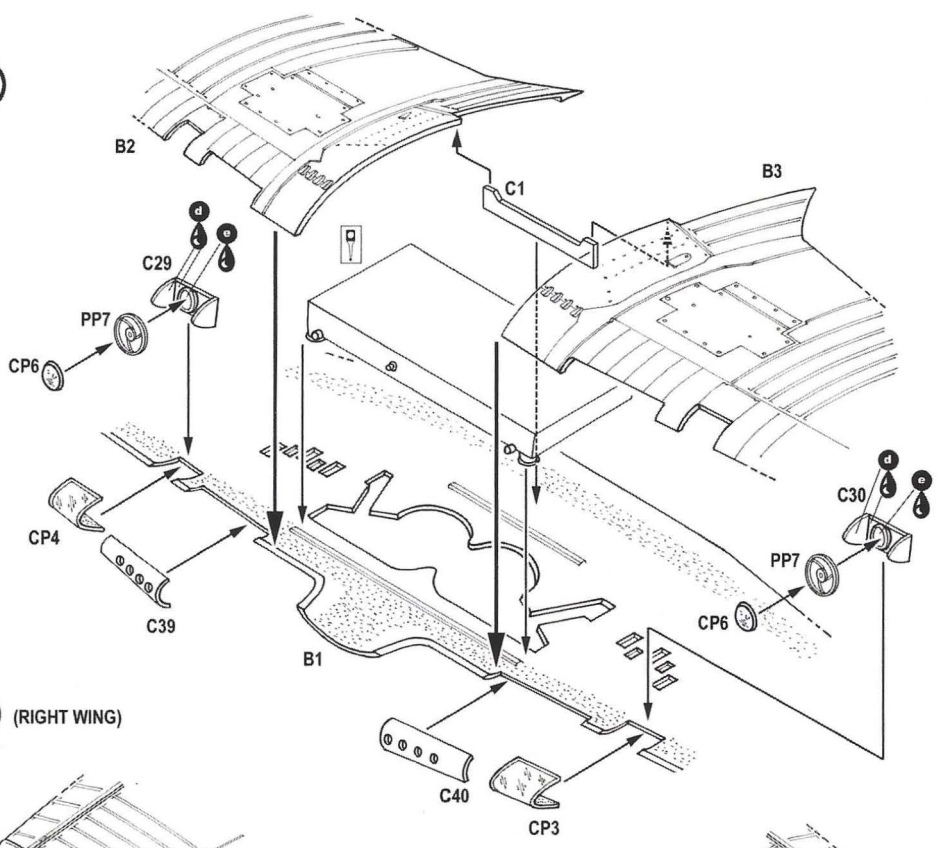

23 (RIGHT WING)

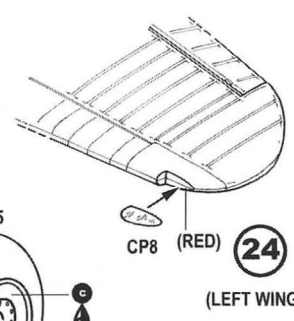
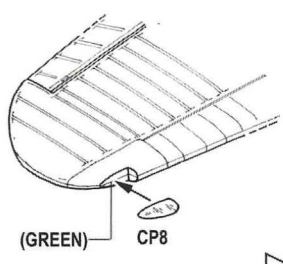

25

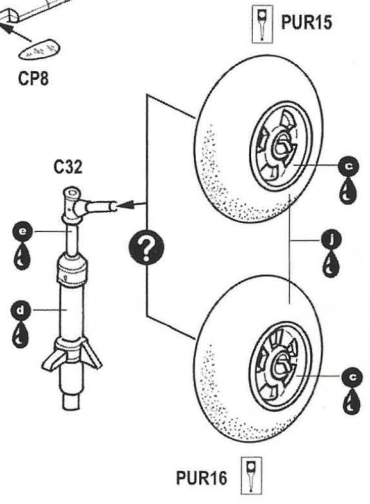

24

(LEFT WING)

26

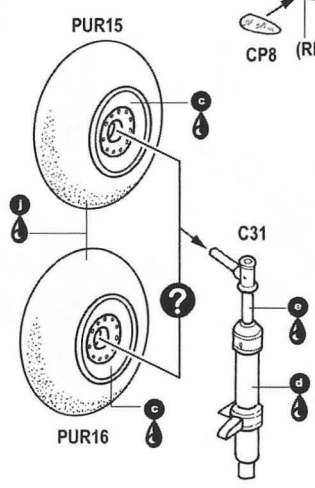



27

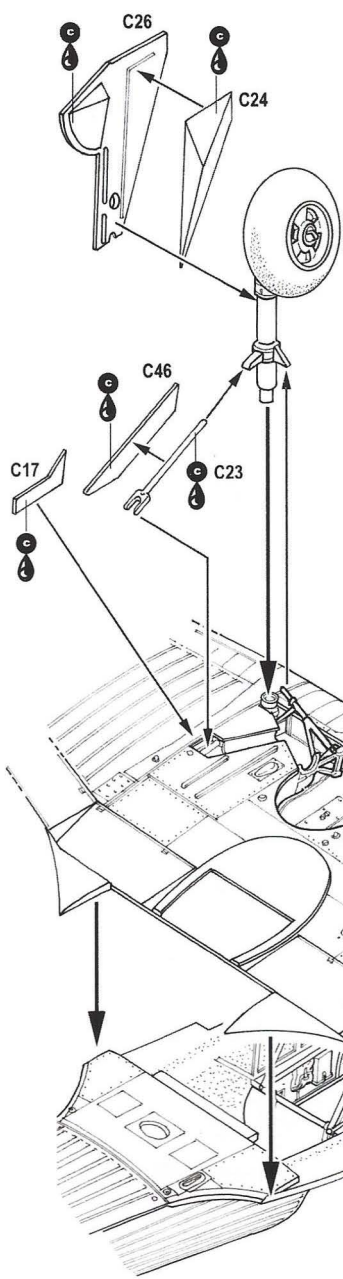

28



PUR5

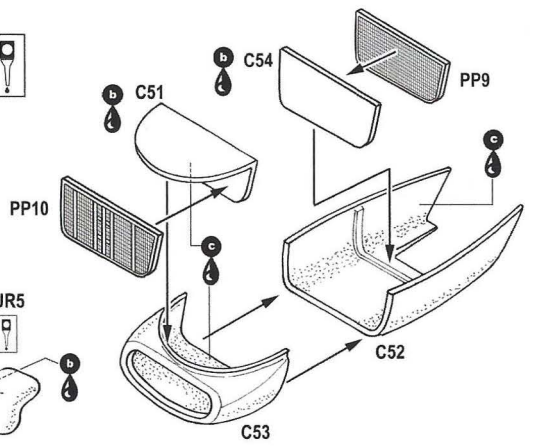

C28

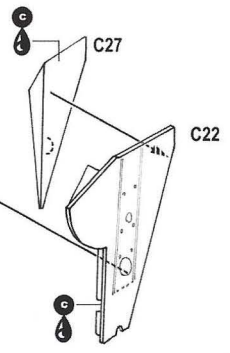

C18

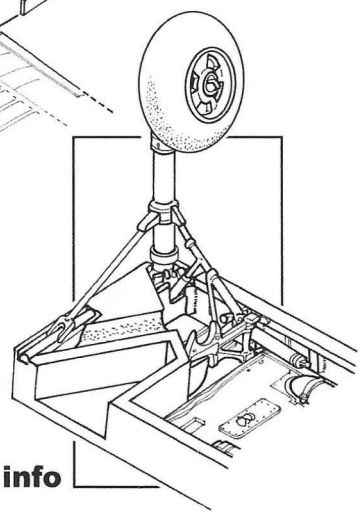

info

29

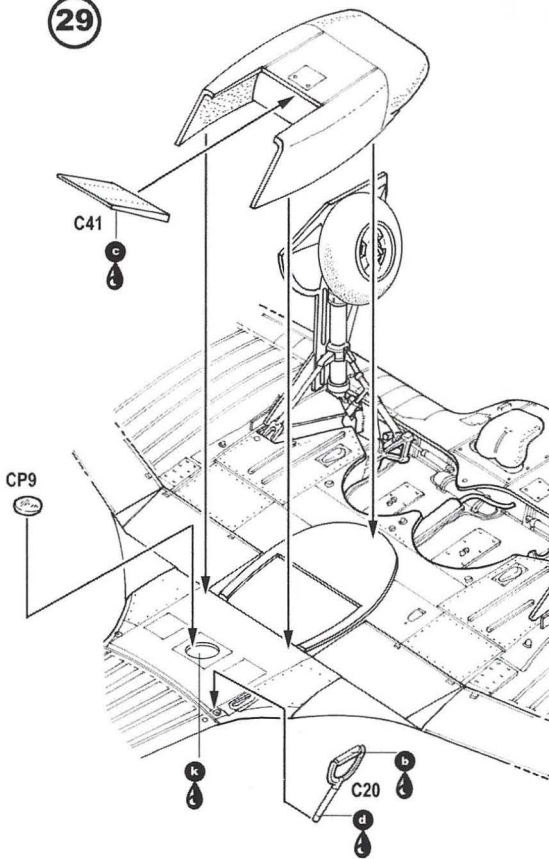

30

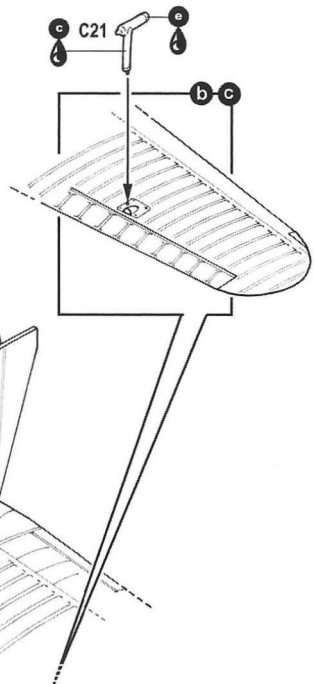

31

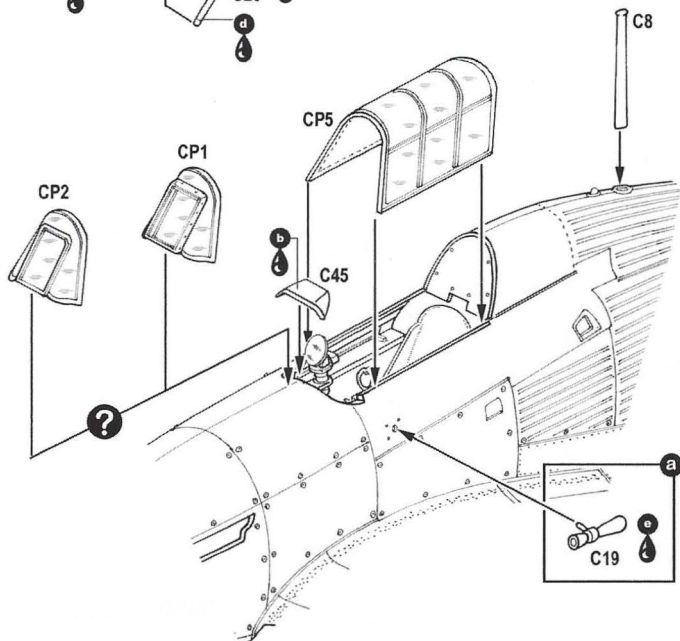

PACIFIC COAST MODELS, INC.

# Hawker Hurricane Mk.I

## 1 / 32



Illustrations by Richard J. Caruana

Hurricane Mk.1, L1909/LL-R, 56 Sqn, RAF North Weald, mid-1939

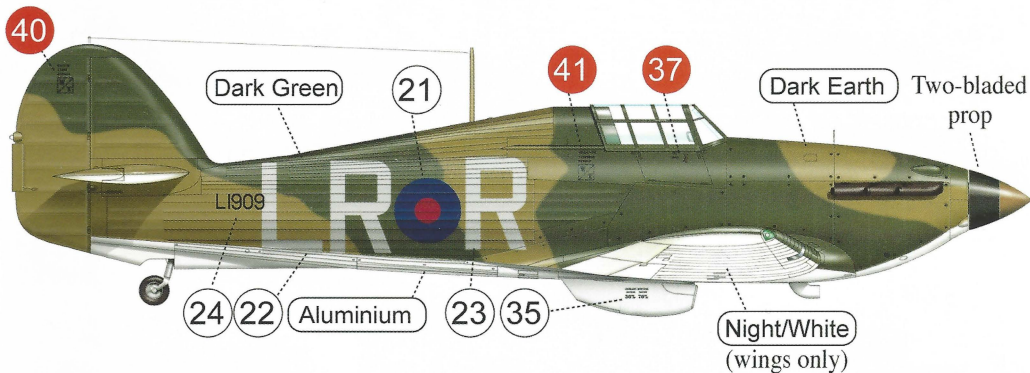

Hurricane Mk.1, L1656/SD-V, 501 (County of Gloucester) Sqn, RAF Tangmere, March 1940

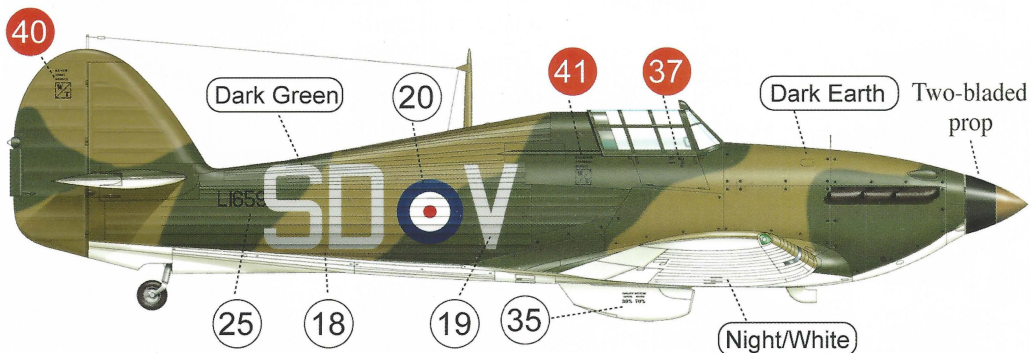

42 Left Side 00 Right Side 00 Both Sides 00 With Note

Hurricane Mk.1, GG-L, 151 Sqn, Sealand, mid-1939

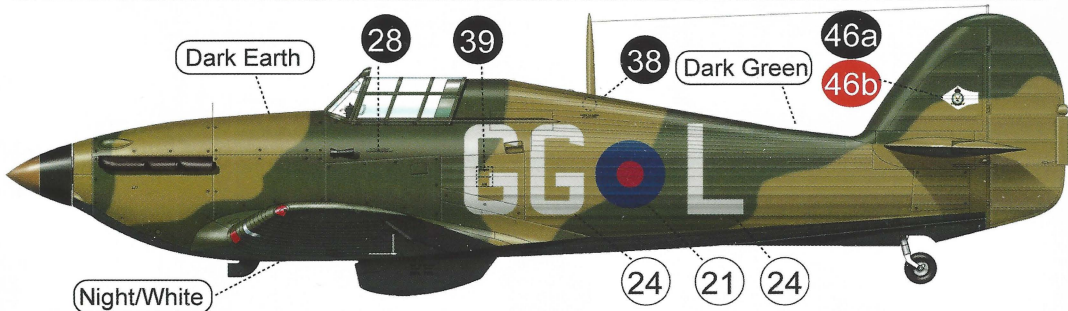

Hurricane Mk.1, 21, 2nd Esc., 1° Group, 2nd Regt de Chasse, Belgian Air Force, Diest, 1940

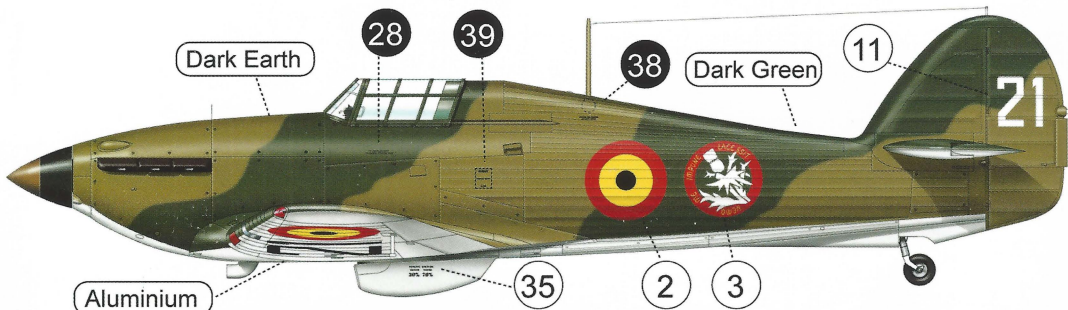

Hurricane Mk.1, HC-451, LeLv 32, Finnish Air Force, 1941

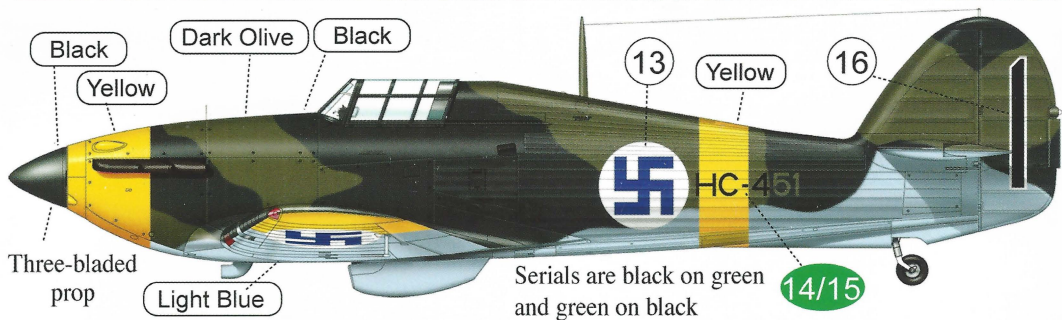

Hurricane Mk.1, Regia Aeronautica, Guidonia, 1941

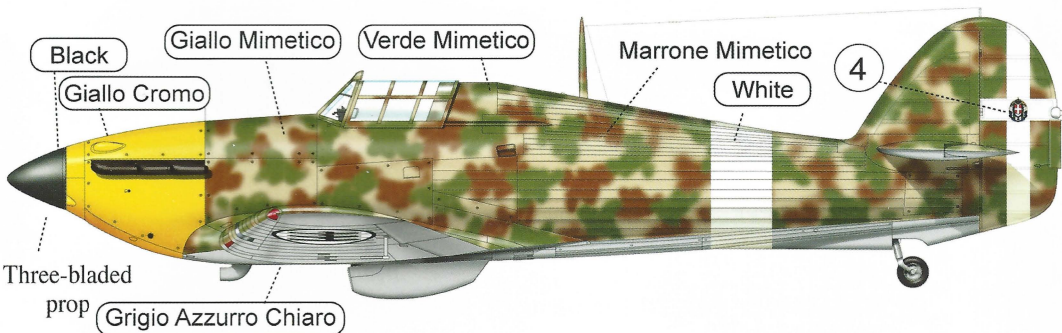



Regia Aeronautica Hurricane wing marking positions (undersides similar)

Dark Green

Dark Earth

Belgian Air Force upper and lower surfaces

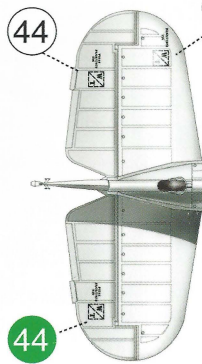

Yellow

Note that stencil markings were not always carried

Light Blue

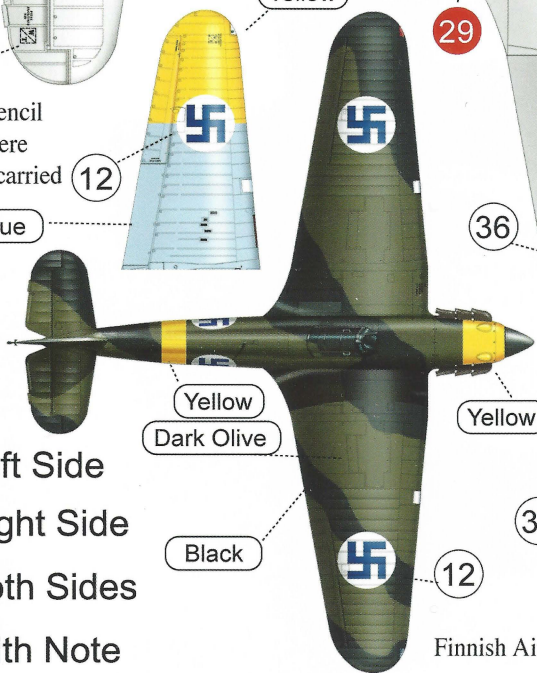

Yellow

Yellow

- 42 Left Side
- 00 Right Side
- 00 Both Sides
- 00 With Note

Finnish Air Force upper and lower surfaces

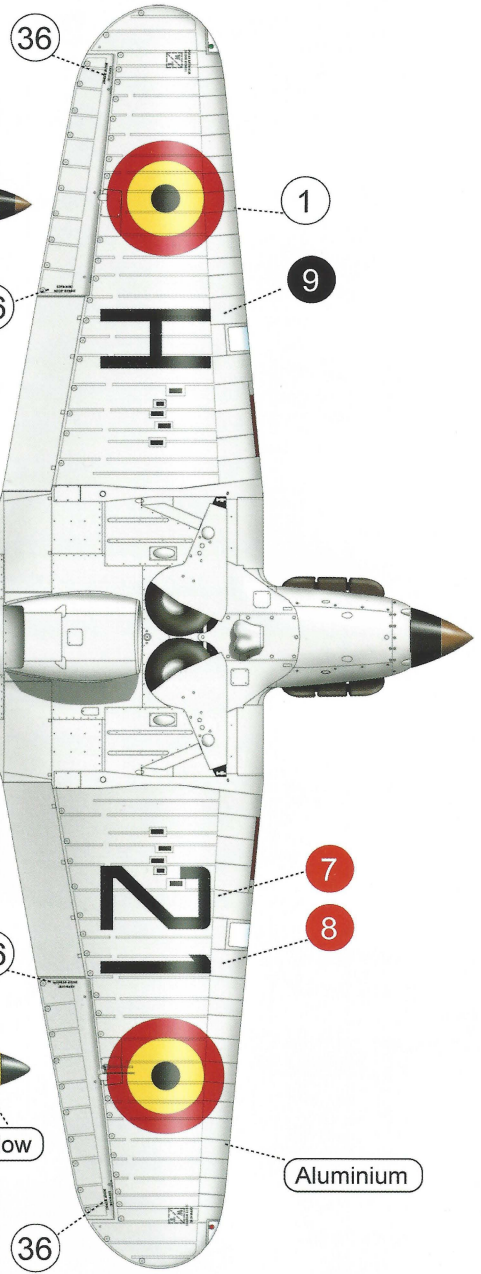

Aluminium

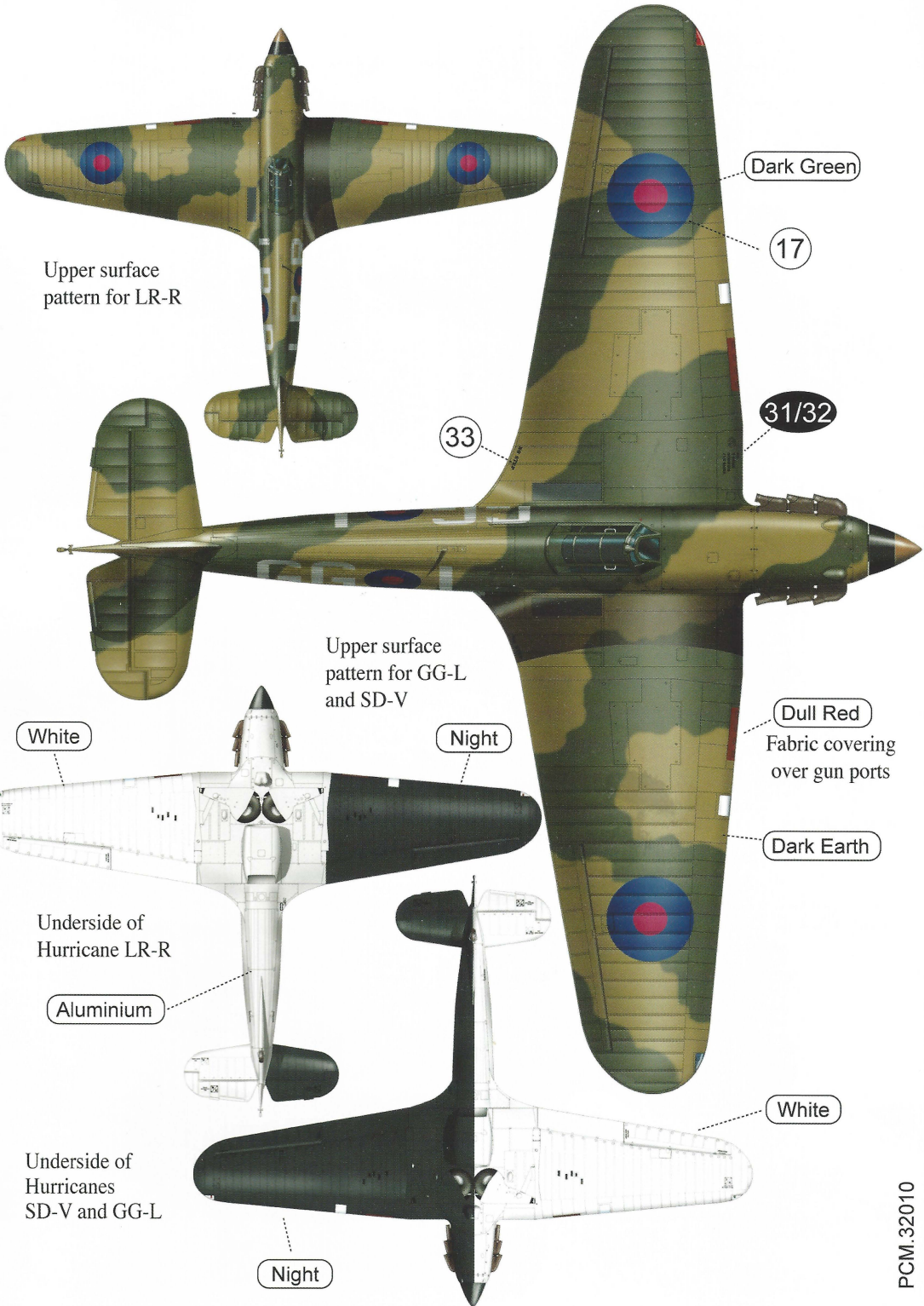

Upper surface pattern for LR-R

Upper surface pattern for GG-L and SD-V

Underside of Hurricane LR-R

Underside of Hurricanes SD-V and GG-L

Dark Green

17

33

31/32

White

Night

Dull Red

Fabric covering over gun ports

Dark Earth

Aluminium

White

Night

# PCM 32010PE Hurricane Mk.I Early version

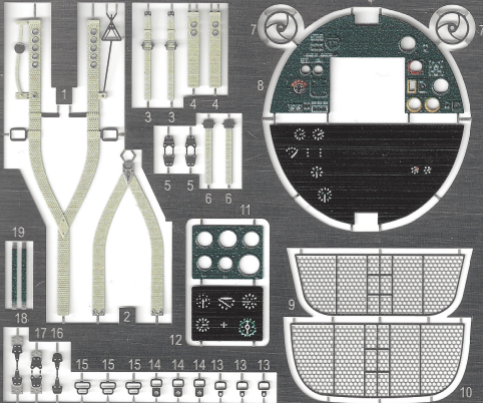



46a  
46b

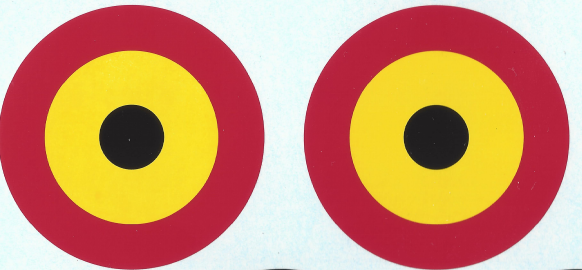
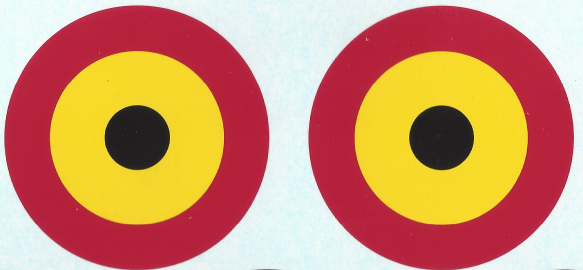
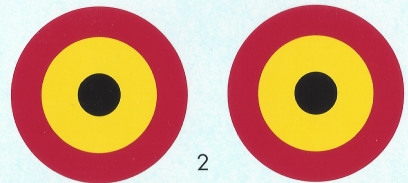
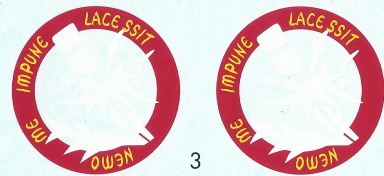

221  
221

221H

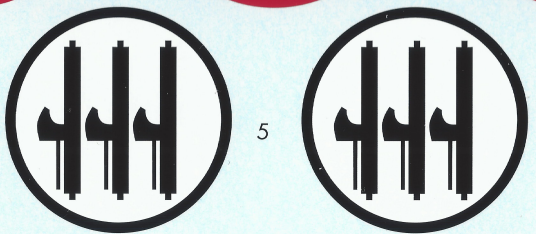
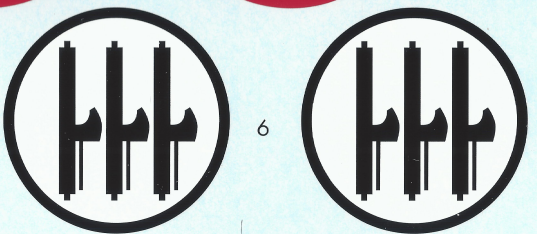

HC-45 1 2  
HC-45 1 2  
HC-45 1 2  
HC-45 1 2

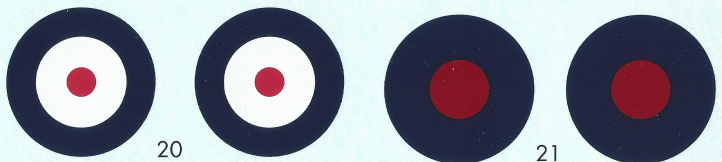
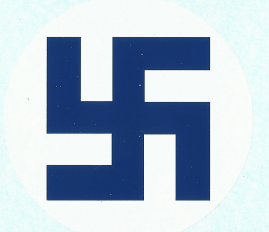

SD SDVV

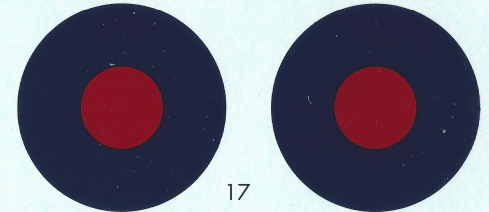

LI659  
LI659  
LI909  
LI909

LR LRR RRG GGL

