

# 1/35 R.O.K. & U.S. ARMY M48A5·K

ACADEMY

HOBBY MODEL KITS



## THE M-48 PATTON MEDIUM TANK

It is doubtful that any other tank has had such a long history of development, production and use. Based on the 1940 design of the M-26 Pershing tank, introduced late in World War II, the M-46 entered US Army service in 1948. In 1951, the "improved" M-47 was introduced, but a multitude of problems kept this tank from reaching its potential. Finally, in 1953 the first of the M-48 variants was placed into service following incorporation of numerous refinements designed to improve the reliability and performance of the M-47.

Serving with distinction in Korea and Vietnam, the M-48A and its later versions were exported to almost two dozen countries, many of which still use the M-48 as their main battle tank. As production of the M-48's continued, many modifications were made to the powertrain, fuel supply, weaponry and crew. For most countries, the M-48A3 modifications were the ultimate version, but in the Republic of Korea and the U.S., additional improvements have been added and existing inventories of M-48 Pattons have been remanufactured to bring them up to current standards. It is anticipated that the additional countries will embark on M-48 modernization programs such as the Korean operation. The ROK version features side armor skirts and the Jonell fire control/night vision targeting system. The ROK version is further distinguished by the addition of a wind sensor on the rear half of the turret.



U.S.M48A5

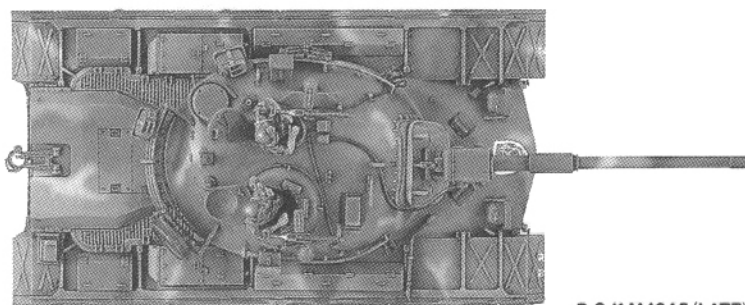
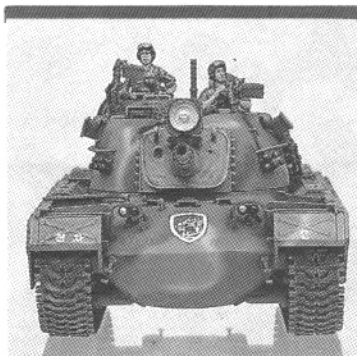

R.O.K.M48A5 (LATE)



Cement Parts  
Coller  
Kleben  
Pegar  
Incollare  
Colar  
Kleven



DO NOT cement  
Ne pas coller  
Nicht kleben  
No pegar  
Non incollare  
Nao colar  
Niet kleven



Cut away  
Couper  
Scheiden  
Cortar  
Tagliare  
Cortar  
Snijden



Optional parts  
Choix  
Auswahlmöglichkeit  
Elección  
Scelta  
Opcao  
Keuze



**3**

Repeat operation  
Répéter l'opération  
Vorgang wiederholen  
Repitir la operacion  
Ripetere  
Repitir a operação  
Herhalen

# 1 Wheel Assembly

**14**



P.V.C Tire



Poly cap



P.V.C.Tire

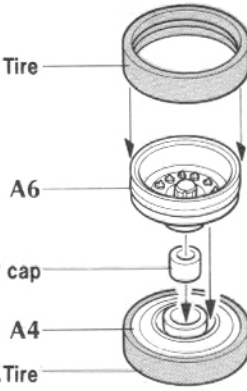

**2**

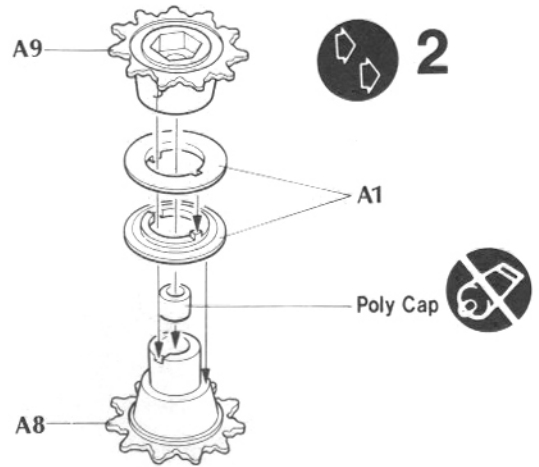

# 2 Suspension Assembly

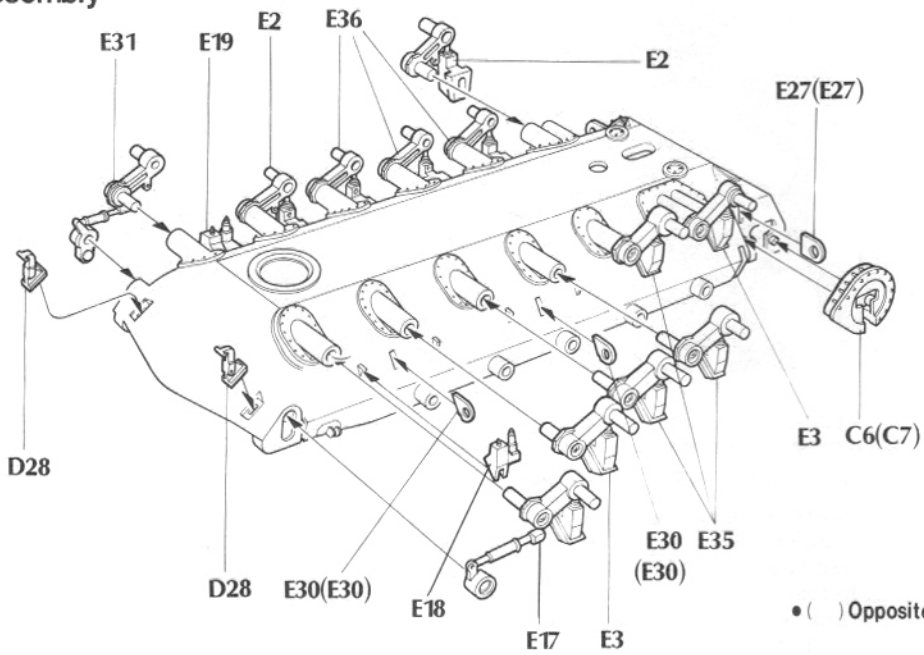

• ( ) Opposite number.

# 3 Support Rollers Assembly

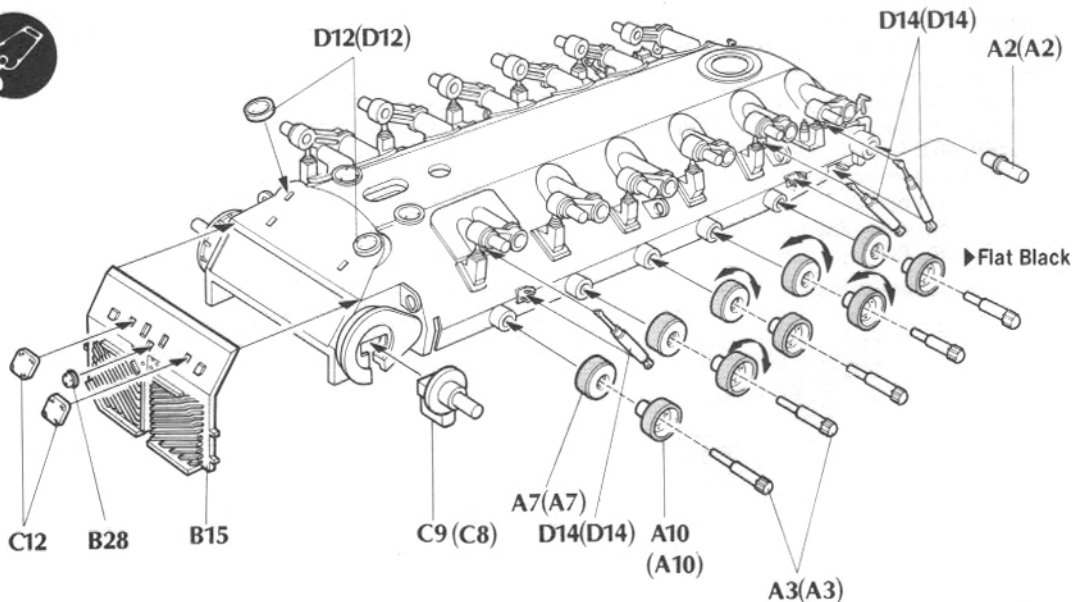

## 4 Mounting of Wheels

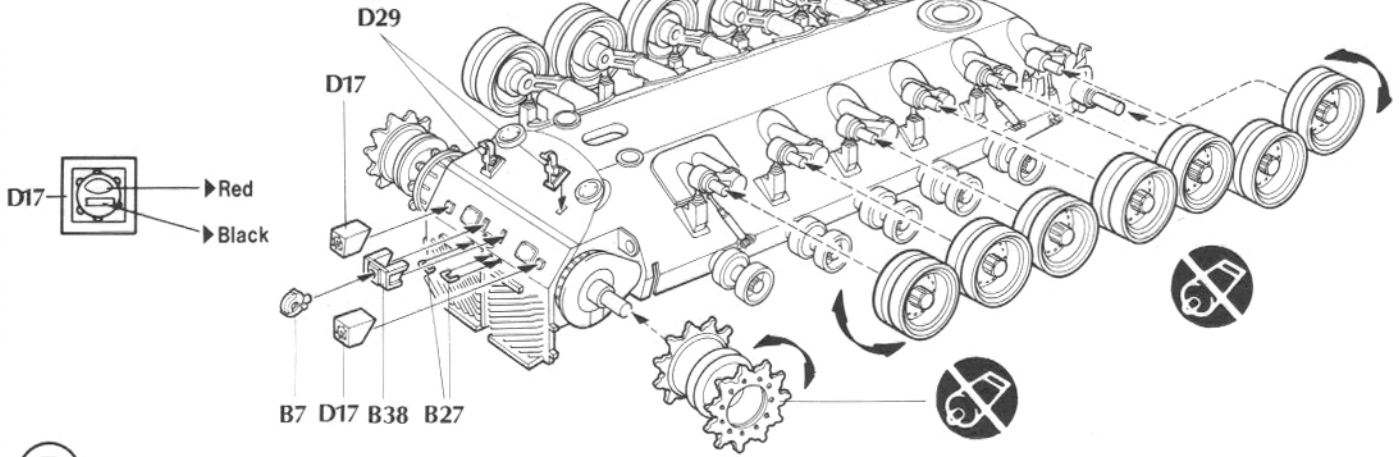

## 5 Upper Hull Assembly I

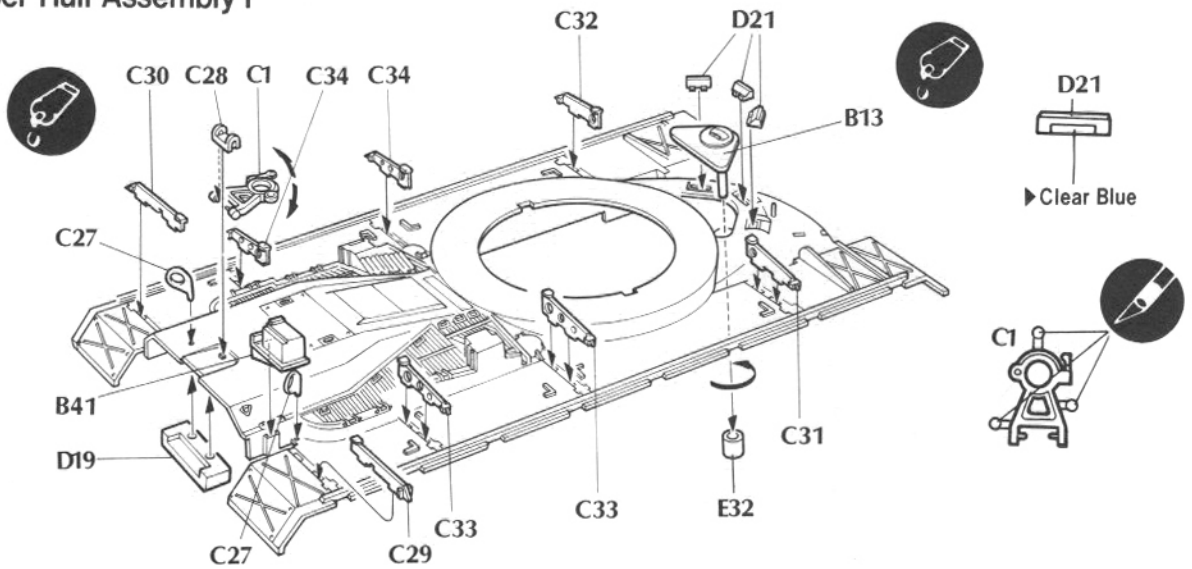

### DETAIL POINT FOR U.S.ARMY M48-A5 VERSION (WITHOUT SKIRTS)

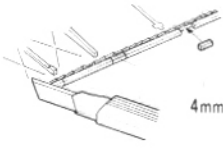

- ① Using sharp nippers, remove the standing ridges on both sides of the upper deck (Fender edges)
- ② From scrap plastic (Sprues), cut 18 pieces of flat plastic measuring 1 by 1 by 4mm to fill the notches on the fender edges. Cement in place, putty any gaps and sand to a smooth edge.

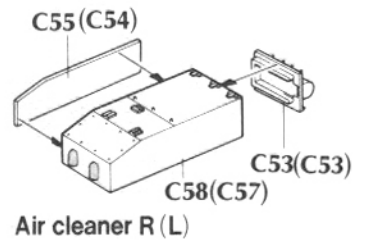

## 6 Upper Hull Assembly II

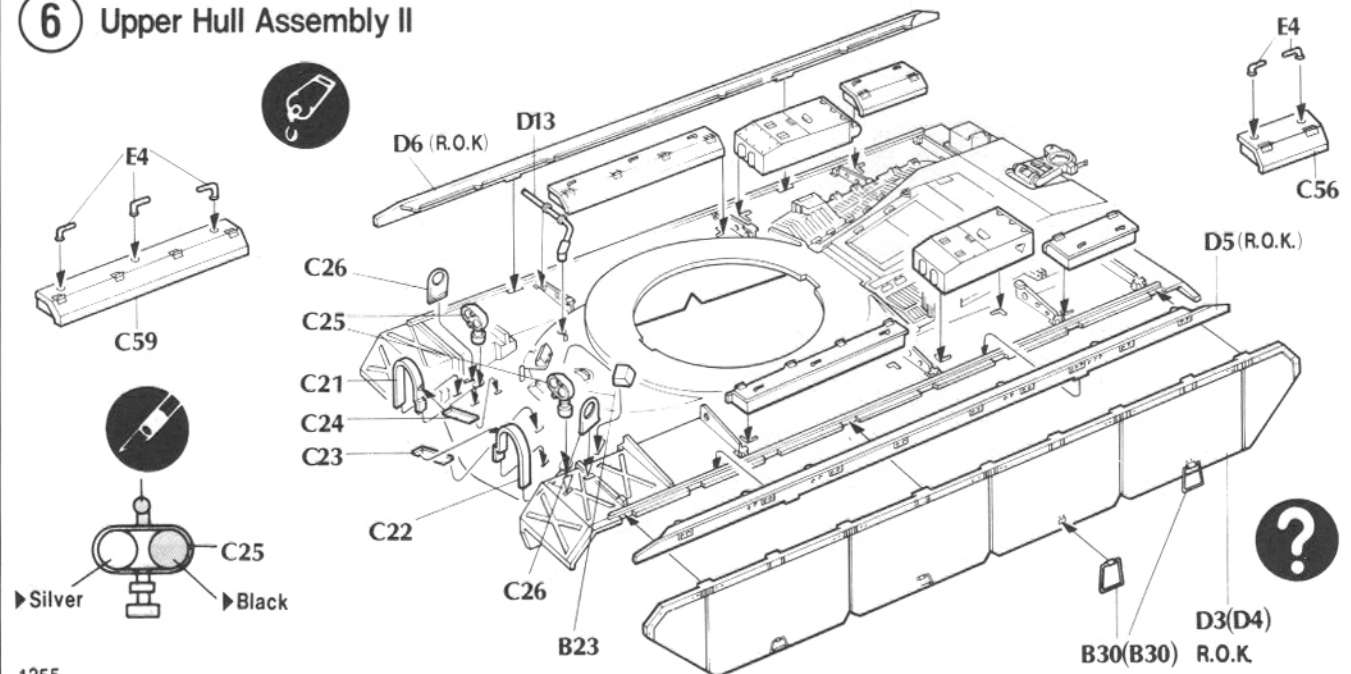

# 7 Main Barrel Assembly

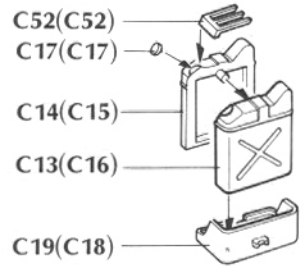
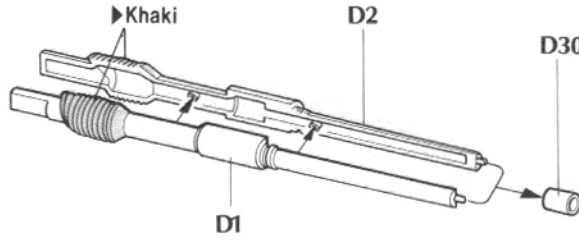
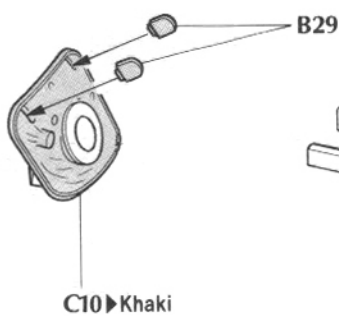

# 8 Turret Assembly I

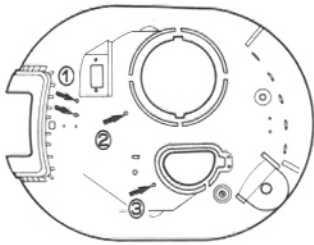

Choose a Version and make holes according to diagram:

- R.O.K. Late : ①, ②, ③
- R.O.K. Early : ①, ②
- U.S. Army : ①, ③

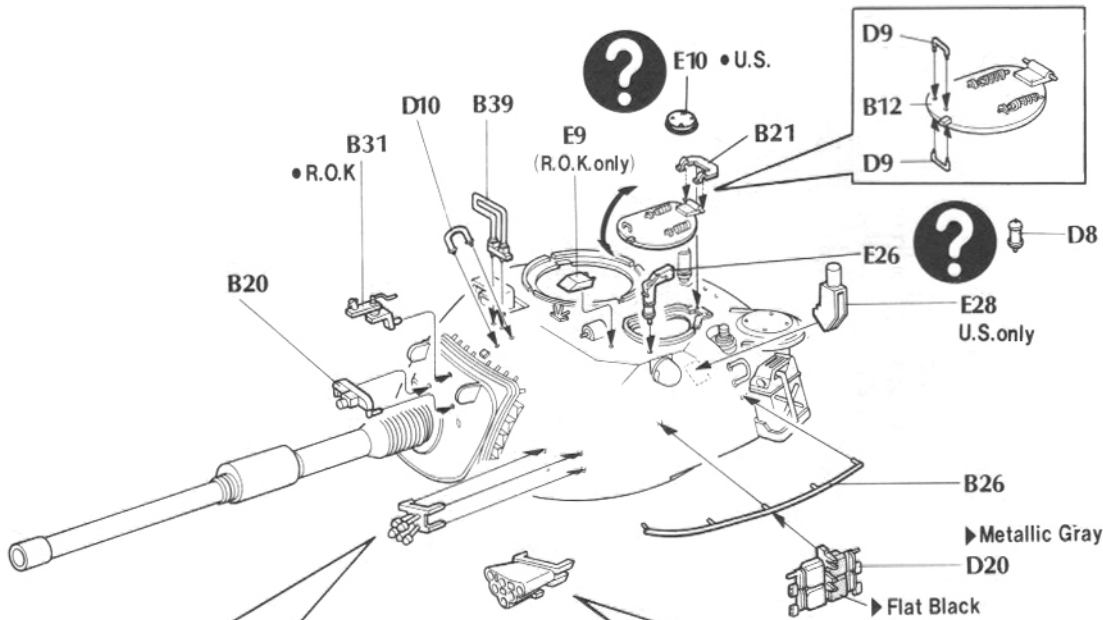
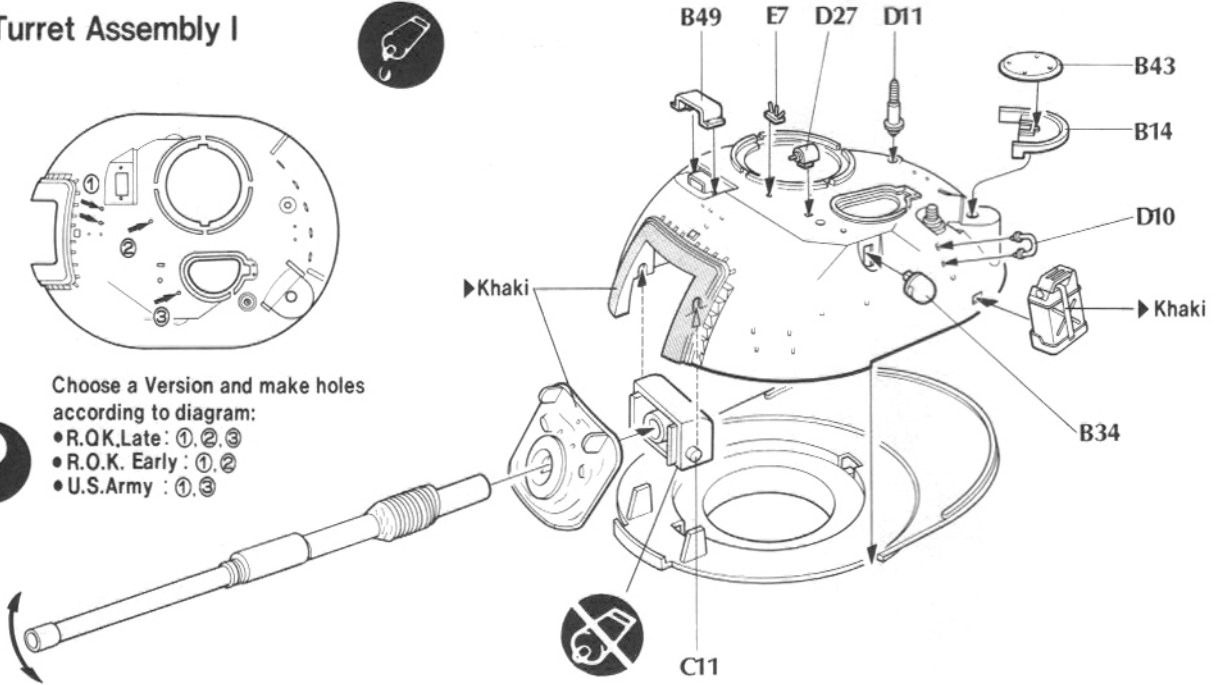

■ R.O.K. Smoke discharger left (right)

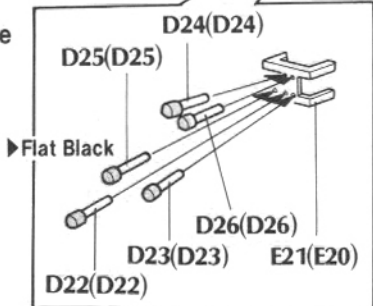

■ U.S. Smoke discharger L (R)

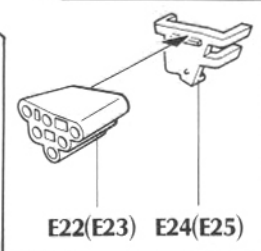

# 9 Cupola & Search Light Assembly

(R.O.K. Early)

(R.O.K. Late & U.S.)

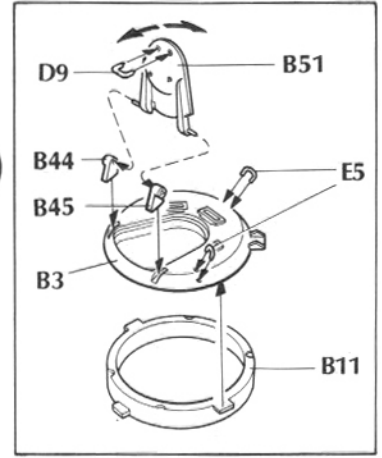
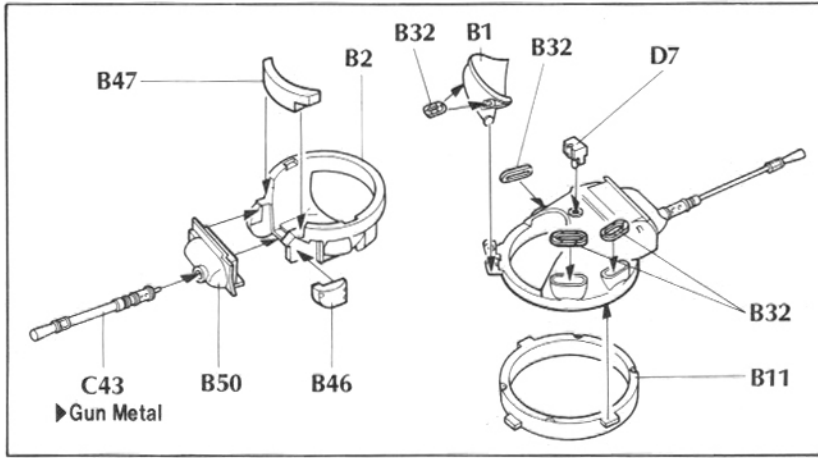

■ Search Light

(U.S.)

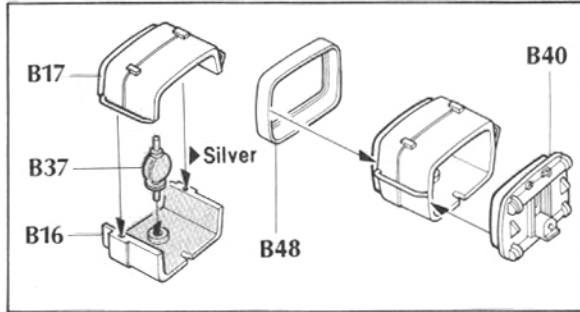

(R.O.K.)

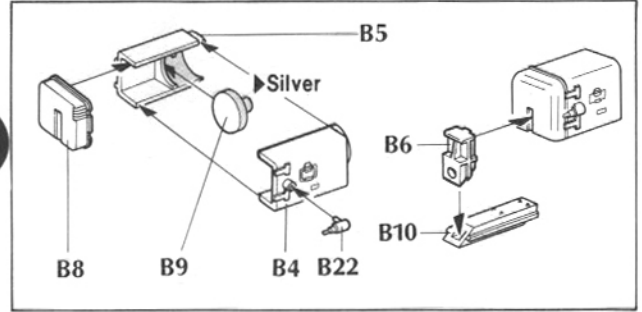

# 10 Turret Assembly II

■ C42, C44



► Red Brown C42 C48 ► Gun Metal

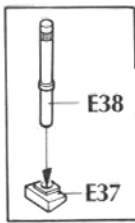

• Wind sensor: R.O.K. only

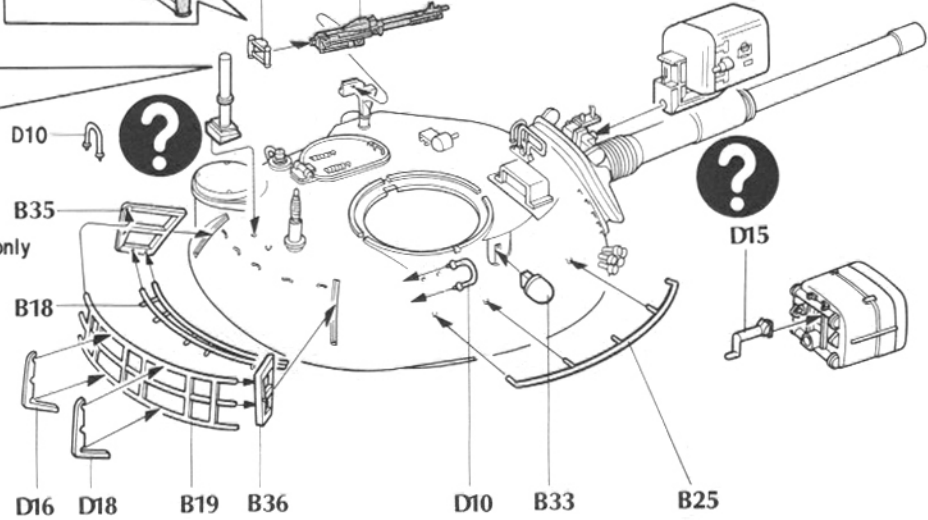

■ Cal50

■ M60D

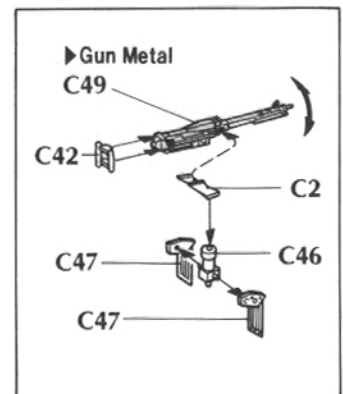
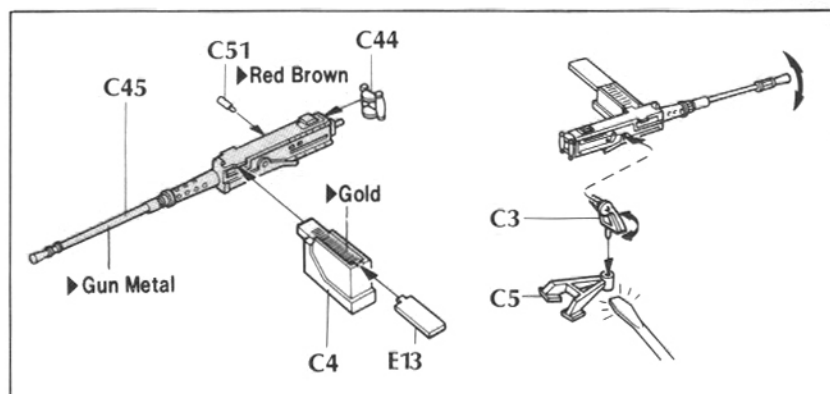

# 11 Mounting of Cupola

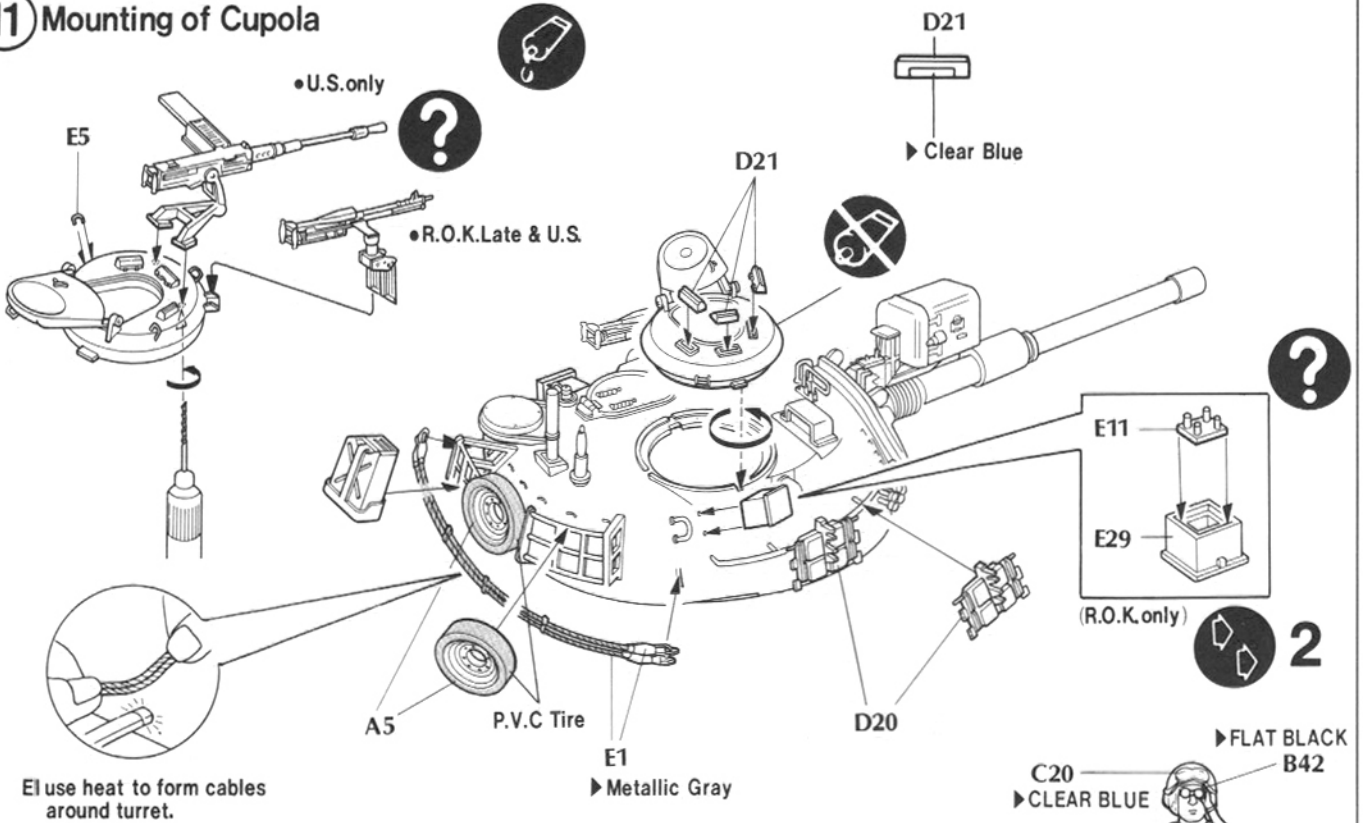

# 12 Final Assembly

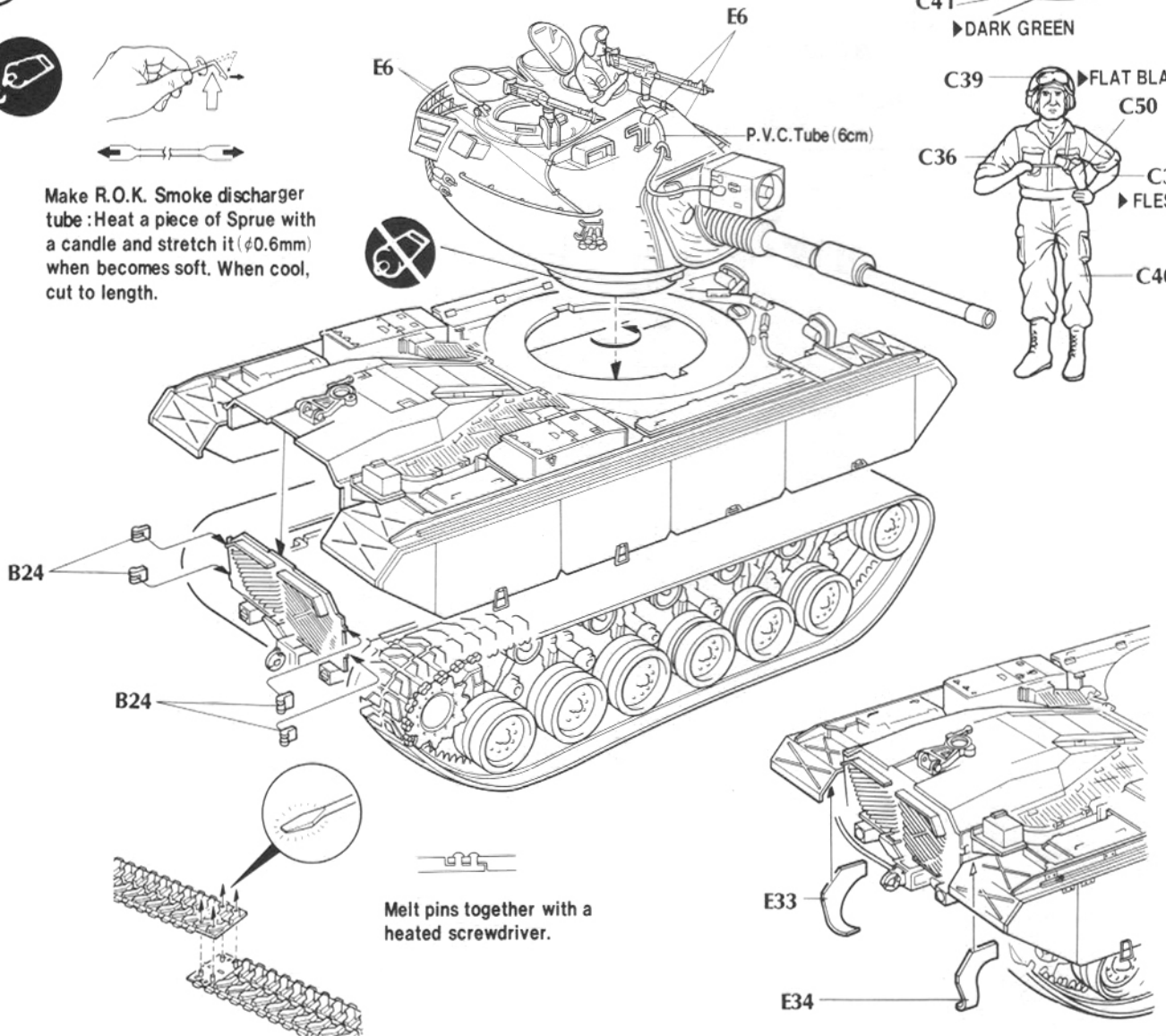

# M48A5K Painting and Decal Placement (R.O.K.Army)

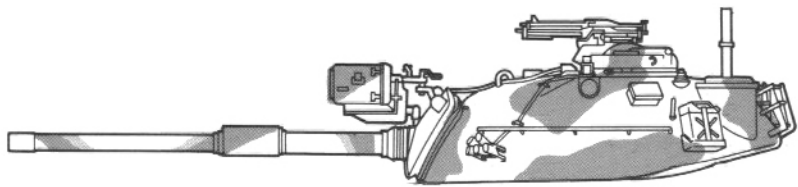

▶ Dark Green

▶ Flat Black

▶ Khaki + Flat White

▶ Flat Green  
+ Flat Yellow

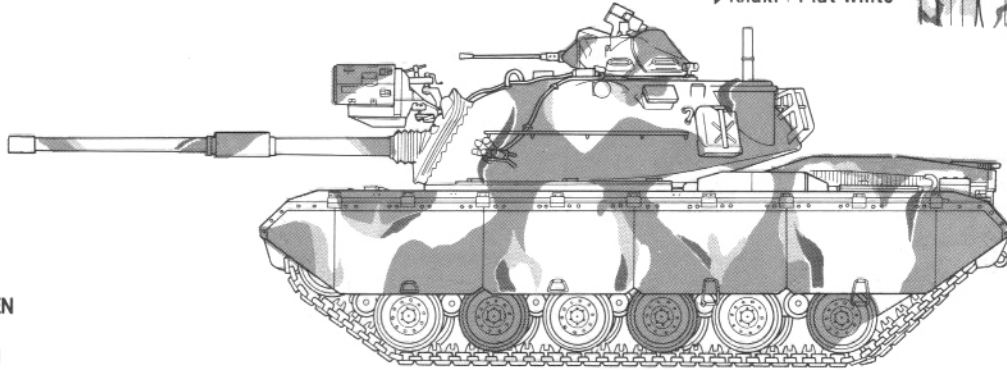

-  KHAKI GREEN
-  FLAT EARTH
-  BUFF
-  FLAT BLACK

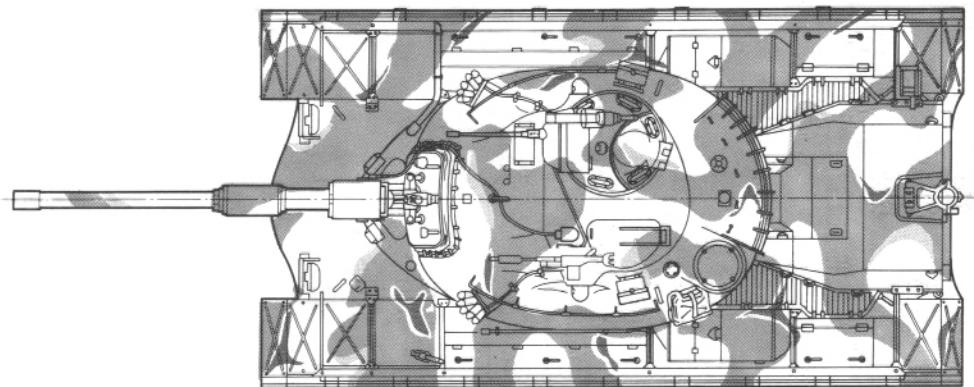
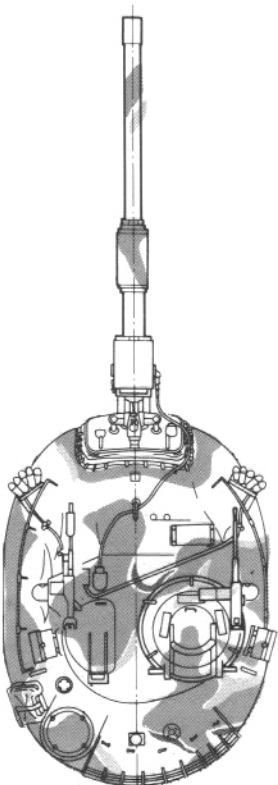
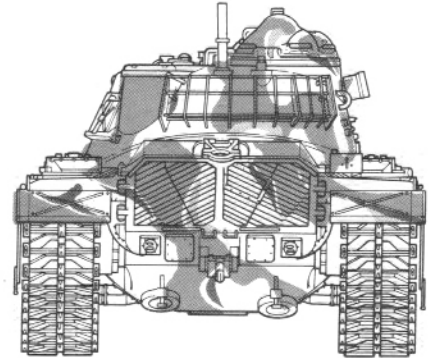
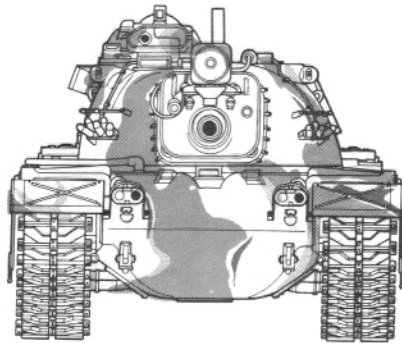
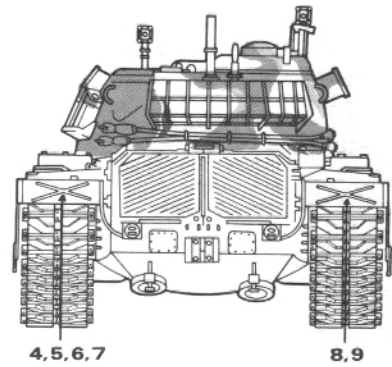
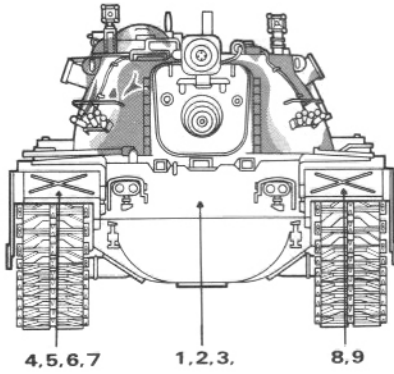

# M48-A5 Painting and Decal Placement

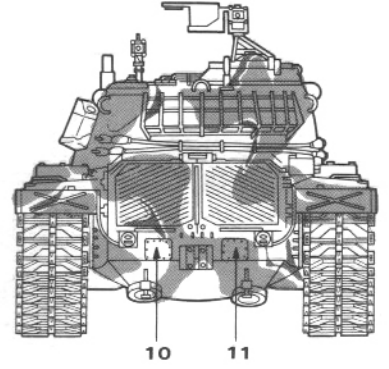
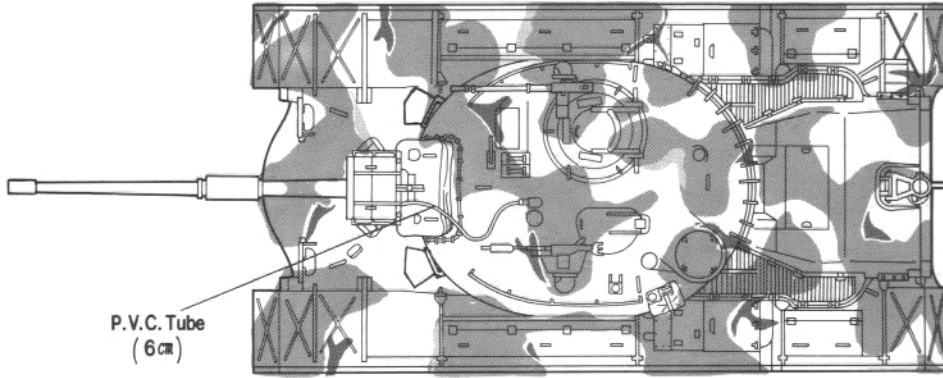
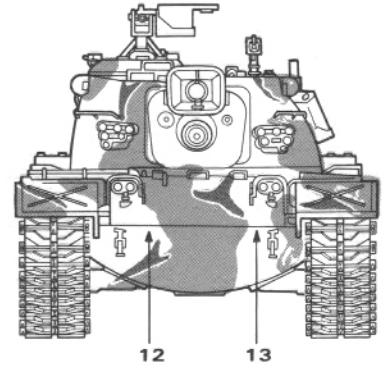
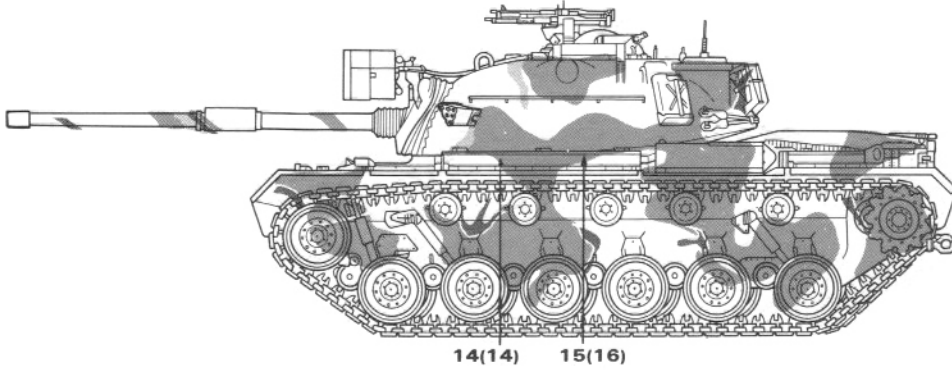

## Parts Locating Diagram

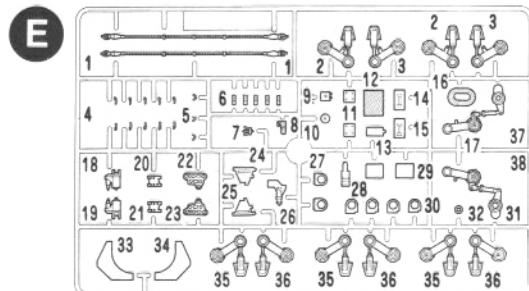
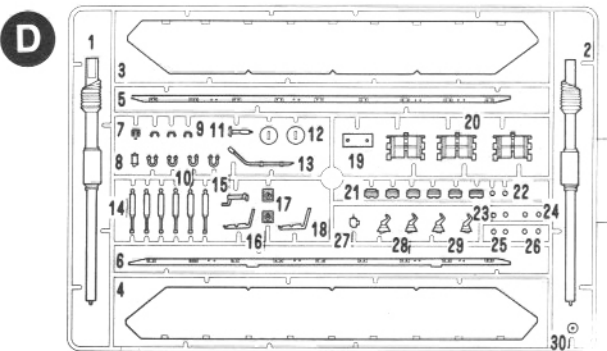
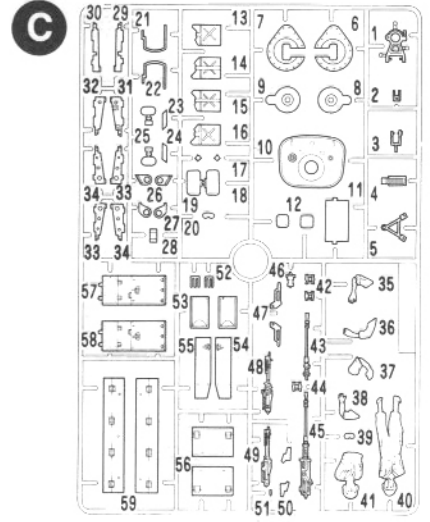
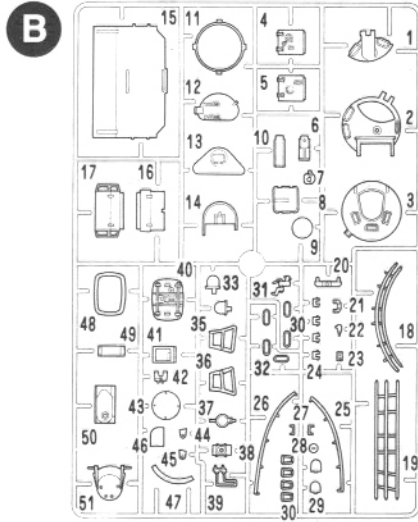
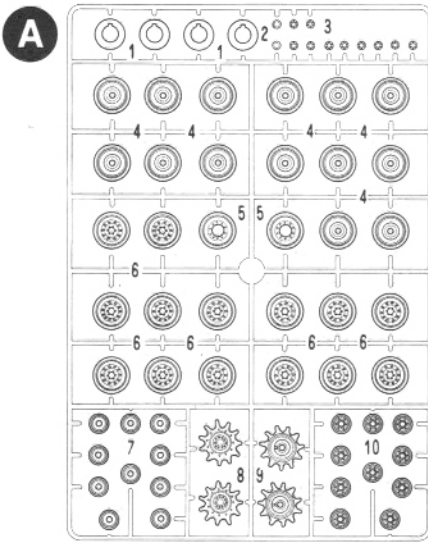

- Upper Hull
- Lower Hull
- P.V.C. Tires
- P.V.C. Tube
- Tracks
- Decal
- Instruction sheet

● Unnecessary parts : E8, 12, 16

**ACADEMY**  
ACADEMY PLASTIC MODEL CO., LTD.  
521-1, Yonghyeon-dong, Yuseong-gu si, Gyeongsang-do, Korea  
주식회사 아카데미 (080-969-7000)

**ACADEMY**  
HOBBY MODEL KITS