

BRITISH WWI FIGHTER 1:48 SCALE PLASTIC KIT



eduard

ProfiPACK



intro

The Bristol F.2B Fighter, a British two-seat biplane fighter and reconnaissance aircraft, had its roots in Frank Barnwell's design studies, dating from March 1916. His task was to design an aircraft that would replace the B.E.2c. Two studies were explored – the Type 9 R.2A which was intended to be powered by the 160 hp Beardmore engine, and the R.2B that was to be powered by the 150 hp Hispano Suiza. Neither of these types were built. In the meantime, the new 190 hp Rolls-Royce Falcon inline engine became available, and Barnwell designed a new aircraft around this engine. The new aircraft, known under designation Type 12 F.2A, was intended as a replacement for the F.E.2d and Sopwith 1½ Strutter two-seat fighters.

The new aircraft made its maiden flight on 9 September 1916. Only 52 F.2As were produced. The armament consisted of one synchronised, fixed, forward-firing 7,7mm Vickers machine gun, and one flexible 7.7 mm Lewis Gun, mounted on a Scarff ring in the observer's cockpit.

The Bristol Type 14 F.2B flew for the first time on 25 October 1916. The initial batch of approximately 150 aircraft were powered by Falcon I and Falcon II engines. The rest of serial production aircraft by Bristol were equipped with the 275 hp Falcon III engine. The F.2B could reach a maximum speed of 198 km/h, and was more than 16 km/h faster than the F.2A.

F.2B armament was the same as the F.2A, but F.2Bs often carried a second Lewis gun on the rear cockpit mounting.

The limited capability of the Bristol factory was the reason why the F.2B was manufactured under licence by Gloucestershire Aircraft Co. Ltd., Marshall & Sons, and National Aircraft Factory No. 3. Due to the shortage of Rolls Royce Falcons, these manufacturers mounted two other engines into the F.2B airframe – Hispano Suiza 8Ab (B, Ba later), and Sunbeam Arab I.

The Bristol F.2B Fighter was a manoeuvrable aircraft that was able to take on single-seat fighters in direct combat. It was flown by many Royal Flying Corps Squadrons, and remained in military service into the 1930s, and surplus aircraft were popular in the civil aviation world.

úvodem

Bristol F.2B Fighter, britský dvoumístný stíhací a průzkumný dvouplošník, má své kořeny ve studiích zkonstruovaných Frankem Barnwellem v březnu 1916. Jeho úkolem bylo navrhnout letoun, který by nahradil typ B.E.2c. Dokončeny byly dvě studie – Type 9 R.2A měl být poháněn motorem Beardmore o výkonu 150 k a R.2B měl pohánět motor Hispano Suiza o výkonu 150 k. Ani jedna z těchto pohonných jednotek nakonec nebyla k dispozici. Mezitím však přišel do výroby řadový motor Rolls Royce Falcon I o výkonu 190 k a Barnwell kolem něj zkonstruoval nový letoun. Dostal označení Type 12 F.2A a byl zamýšlen jako náhrada za dvoumístné stíhačky F.E.2d a Sopwith 1½ Strutter.

Nový letoun se poprvé dostal do vzduchu 9. září 1916. Postaveno bylo pouze 52 exemplářů F.2A. Výzbroj tvořil jeden synchronizovaný, pevný, vpřed střílející 7,7mm kulomet Vickers a jeden pohyblivý 7,7mm kulomet Lewis instalovaný v oběžném kruhu Scarff v kokpitu pozorovatele.

Bristol Type 14 F.2B poprvé vzlétl 25. října 1916. Prvních zhruba 150 letounů bylo poháněno motory Falcon I a Falcon II. Zbytek produkce pak dostal motory Falcon III o výkonu 275 k, s nimiž letouny dosahovaly maximální rychlosti 198 km/h a byly tak o 16 km/h rychlejší než F.2A.

Výzbroj zůstala stejná jako u F.2A, avšak F.2B často měly v zadním kokpitu montovaný druhý kulomet Lewis.

Omezená výrobní kapacita Bristolu byla důvodem spuštění licenční výroby u společností Gloucestershire Aircraft Co. Ltd., Marshall & Sons a National Aircraft Factory No. 3. Kvůli nedostatečným dodávkám motorů Falcon používali tyto výrobci motory Hispano Suiza 8Ab (později B, Ba) a Sunbeam Arab I.

Bristol F.2B byl obratným letounem, schopným postavit se jednomístným stíhacím letounům a sloužil u mnoha squadron Royal Flying Corps. V řadách ozbrojených sil se udržel až do 30. let a letouny z válečných přebytků se těšily popularitě v civilním letectví.

ATTENTION



UPOZORNĚNÍ



ACHTUNG



ATTENTION



注意



Carefully read instruction sheet before assembling. When you use glue or paint, do not use near open flame and use in well ventilated room. Keep out of reach of small children. Children must not be allowed to suck any part, or pull vinyl bag over the head.



Před započítím stavby si pečlivě prostudujte stavební návod. Při používání barev a lepidel pracujte v dobře větrané místnosti. Lepidla ani barvy nepoužívejte v blízkosti otevřeného ohně. Model není určen malým dětem, mohlo by dojít k požití drobných dílů.

INSTRUCTION SIGNS * INSTR. SYMBOL * INSTRUKTION SINNBILDEN * SYMBOLES * 記号の説明

OPTIONAL
VOLBABEND
OHNOUTOPEN HOLE
VYVRTAT OTVORSYMMETRICAL ASSEMBLY
SYMETRICKÁ MONTÁŽREMOVE
ODRÍZNOUTREVERSE SIDE
OTOČITAPPLY EDUARD MASK
AND PAINT
POUŽIT EDUARD MASK
NABARVIT

PARTS



DÍLY



TEILE



PIÈCES



部品

A>

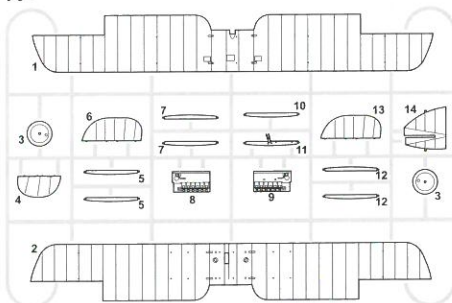

PLASTIC PARTS

B>

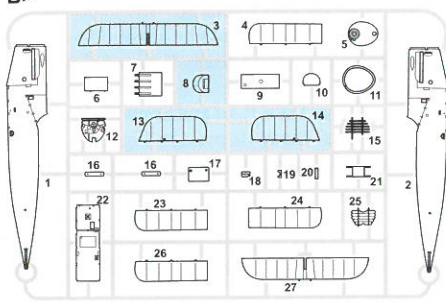

C>

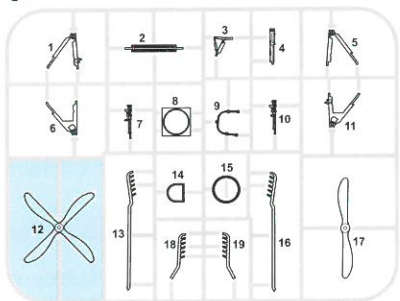

D>

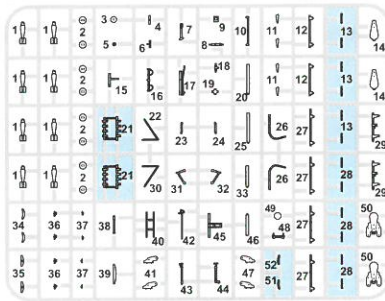
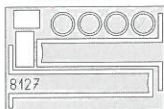
eduard
MASK

FILM



PE - PHOTO ETCHED DETAIL PARTS



-Parts not for use. -Teile werden nicht verwendet. -Pièces à ne pas utiliser. -Tylo díly nepoužívejte při stavbě. -使用しない部品

COLOURS



BARVY



FARBEN



PEINTURE



色

GSI Colors (GUNZE)		
AQUEOUS	M-COLOR	
[H 11]	C1	WHITE
[H 12]	C2	BLACK
[H 13]	C3	RED
[H 14]	C4	YELLOW
[H 33]	C81	RUSSET
[H 37]	C43	WOOD BROWN
[H 47]	C41	RED BROWN
[H 66]	C18	SANDY BROWN
[H 68]	E116	DARK GRAY

AQUEOUS	M-COLOR	
[H 05]	C45	SAIL COLOR
[H 306]	C206	GREEN
[H 313]	C313	YELLOW
[H 329]	C329	YELLOW
[H 330]	C330	LIGHT GRAY
M-METAL COLOR		
[M 213]		STAINLESS
[M 214]		DARK IRON
[M 216]		ALUMINIUM
[M 218]		BRASS

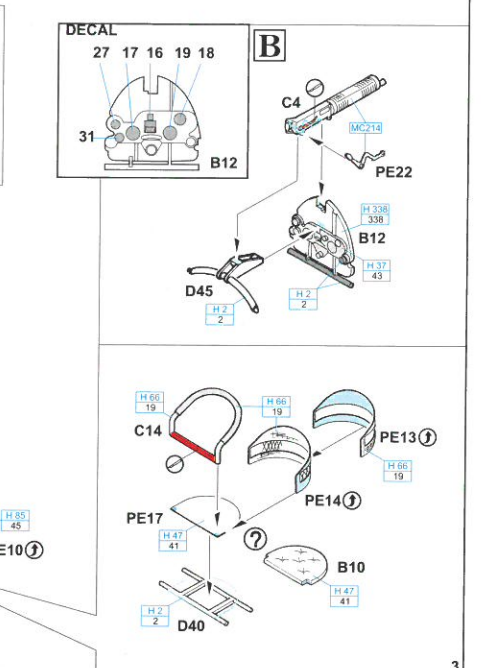
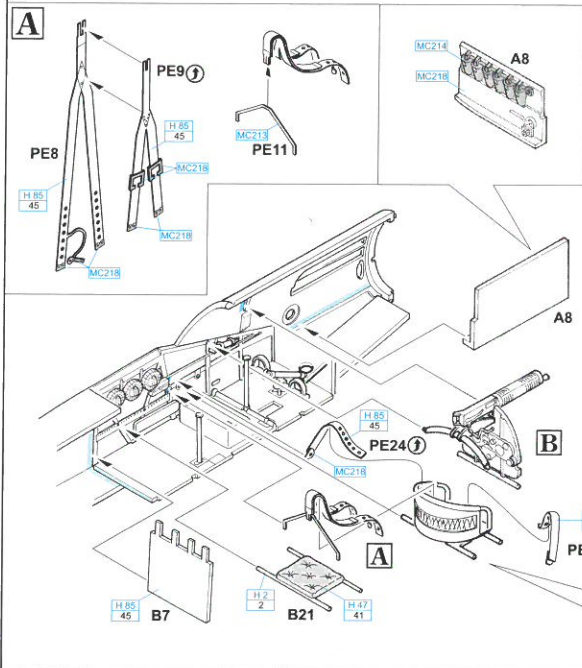
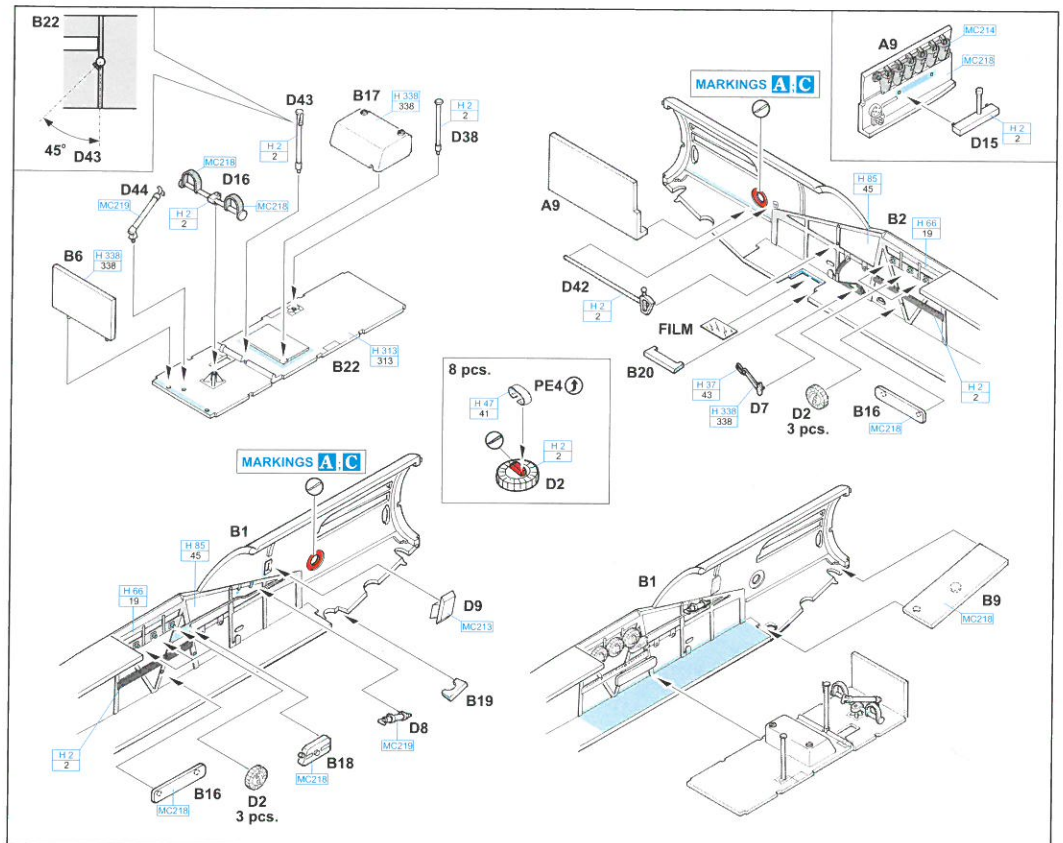

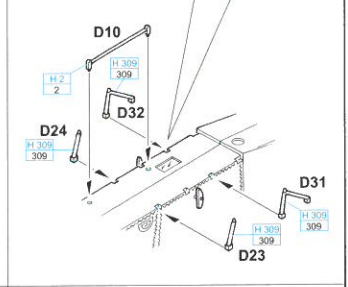
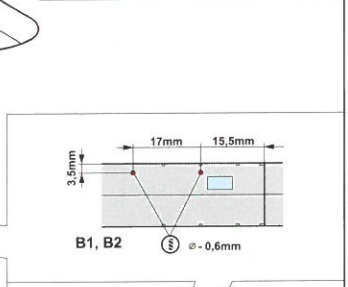
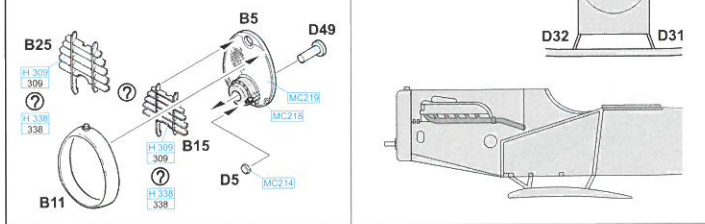
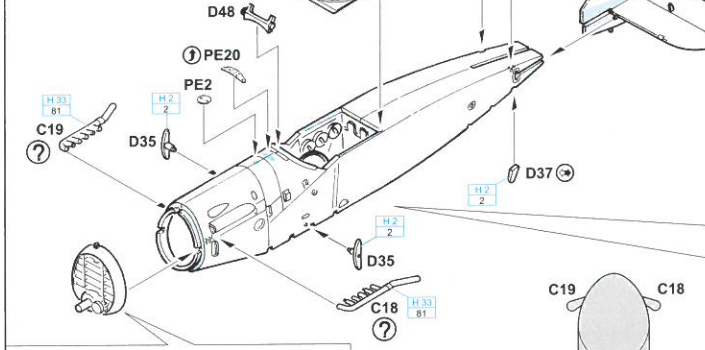
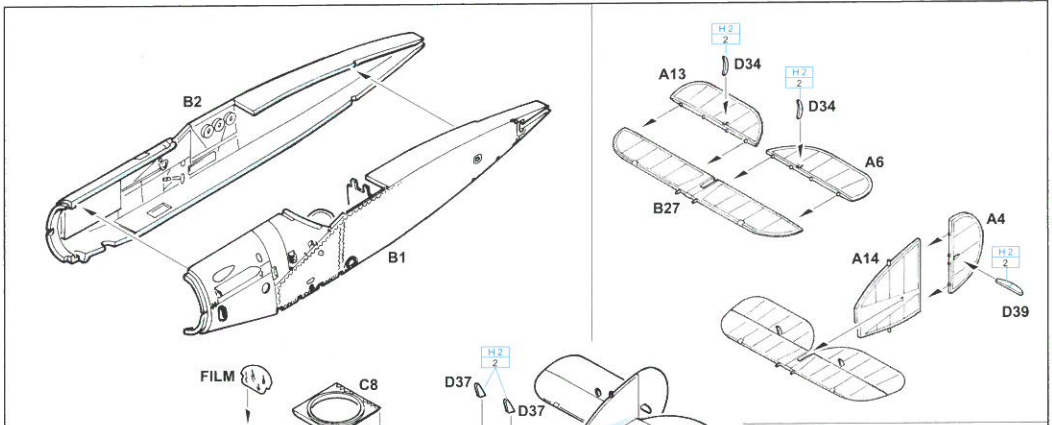

MARKING ONLY

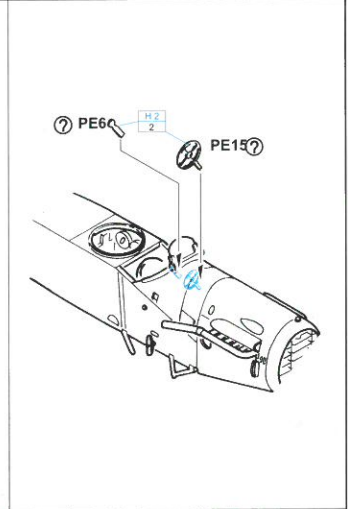
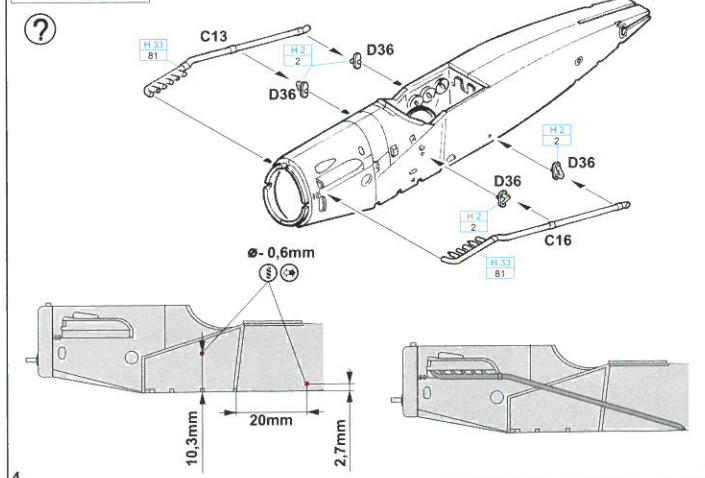

BOTTOM

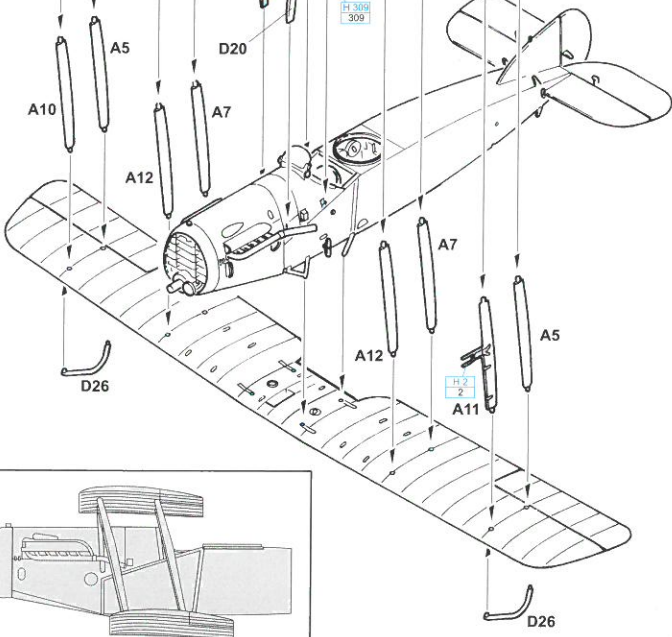
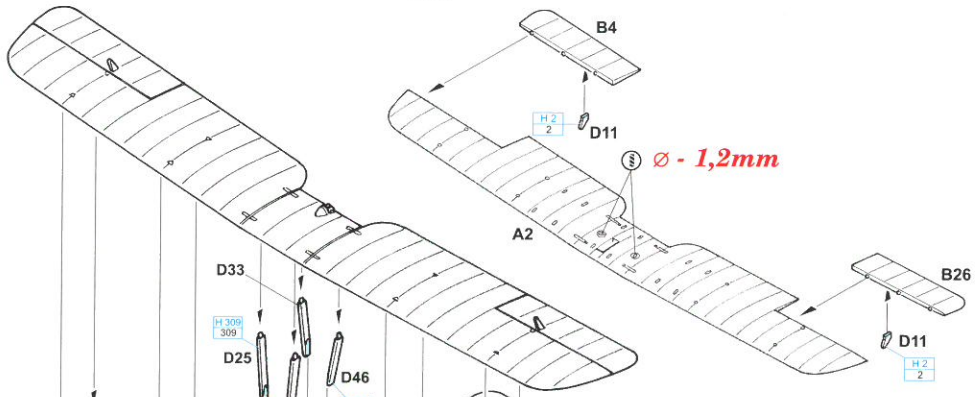
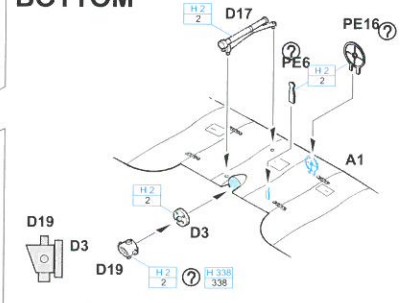
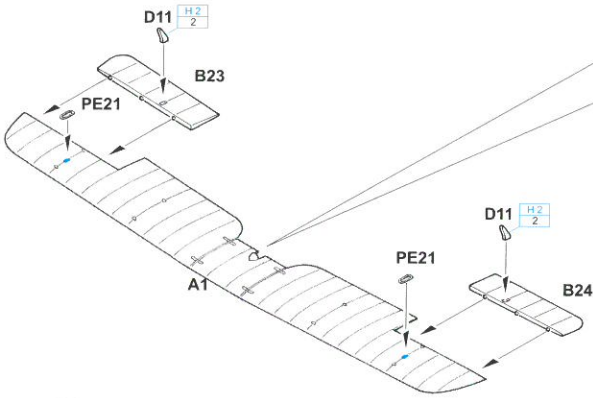

C 2 pcs.

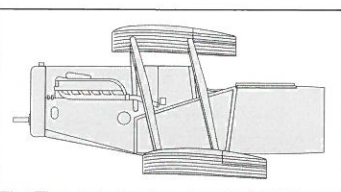
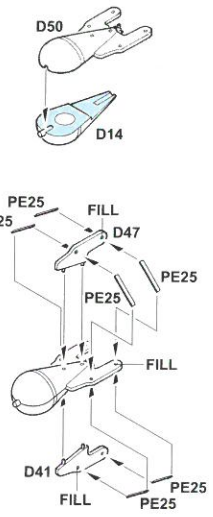

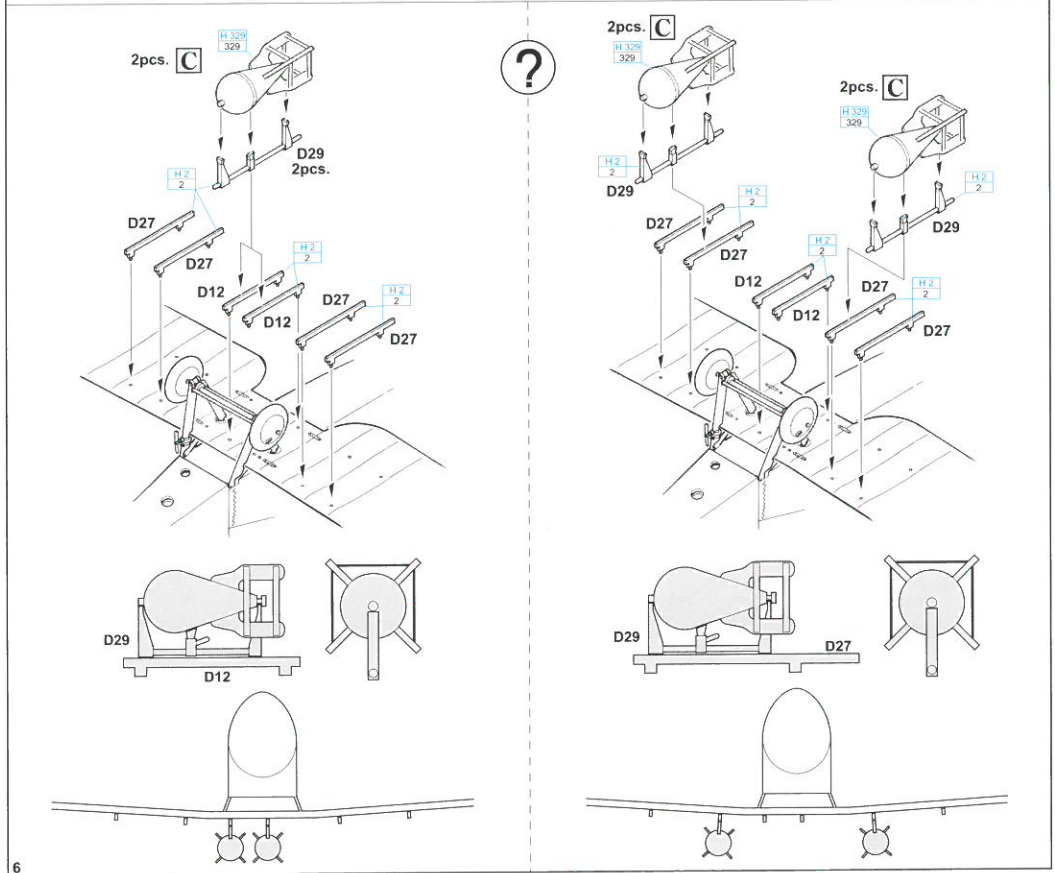
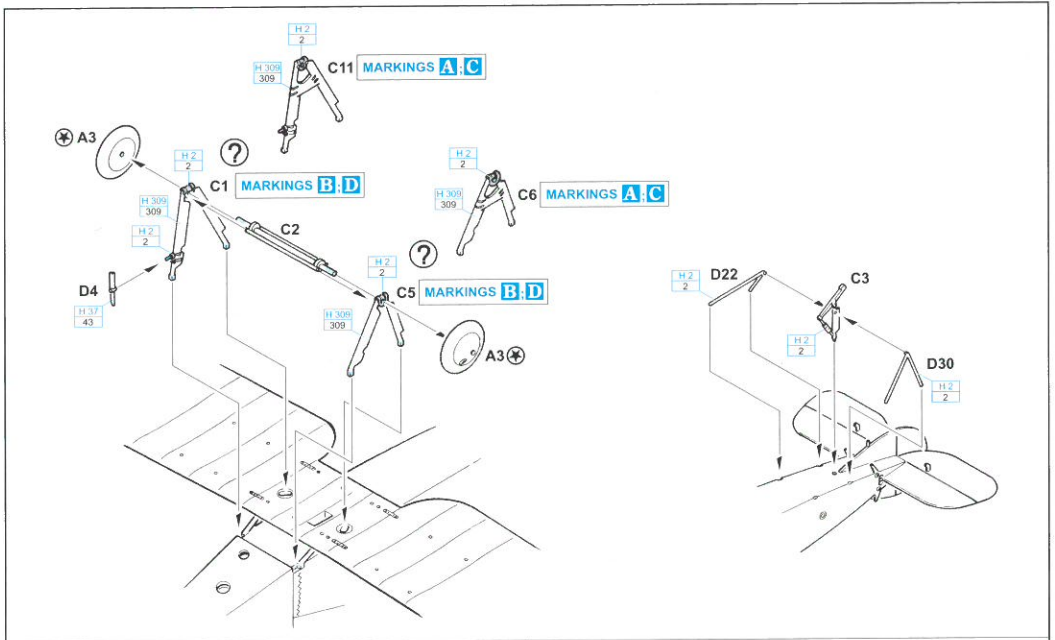

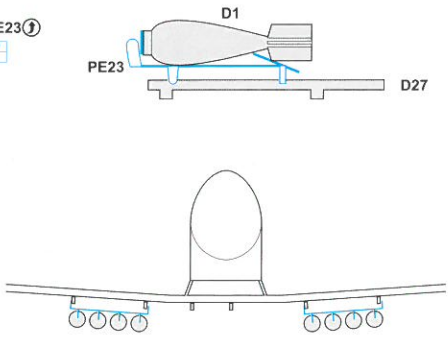
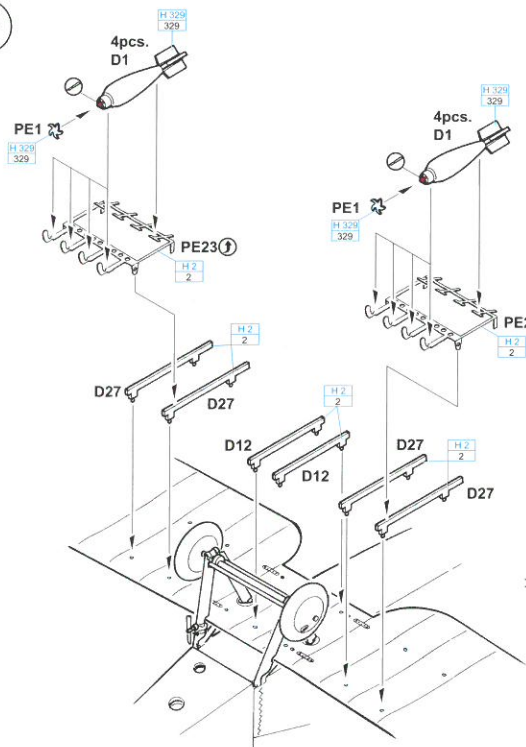

MARKINGS A, B, C

MARKING D

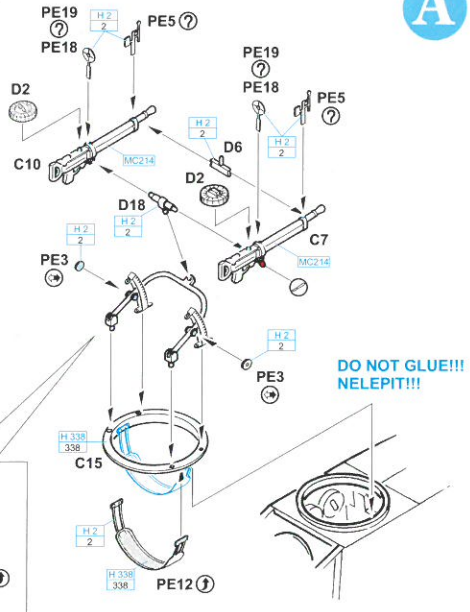
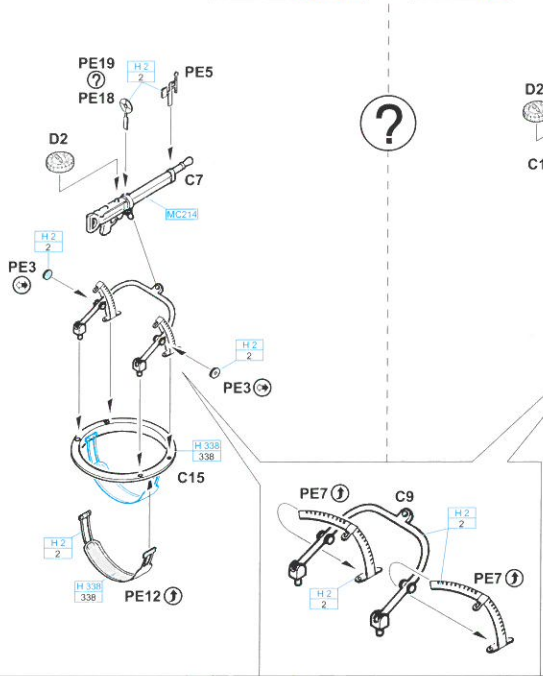

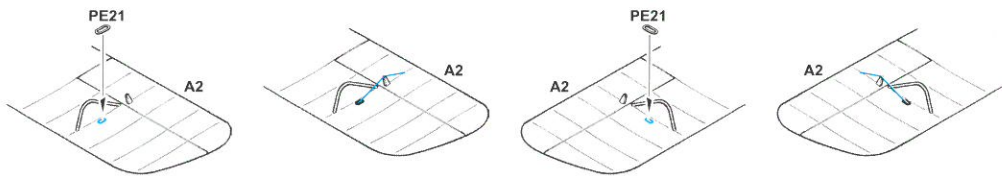

BOTTOM

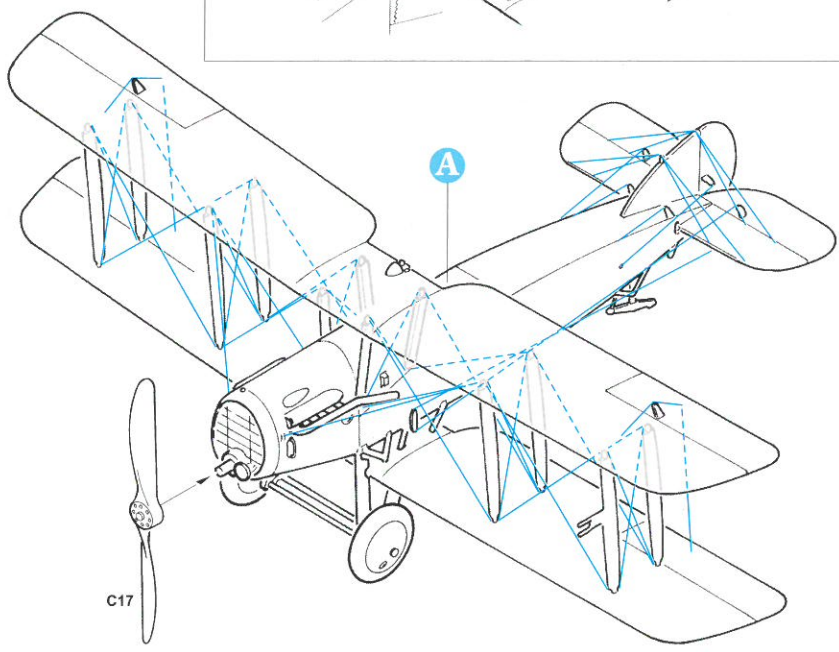
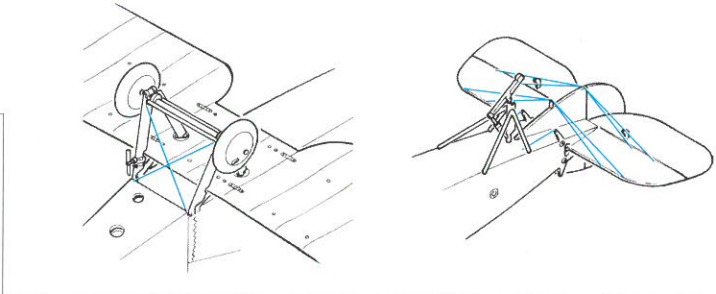

eduard
MASK

8127

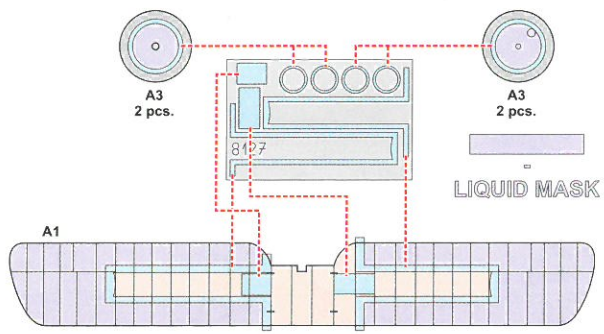
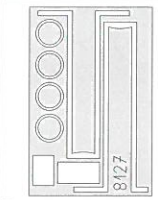

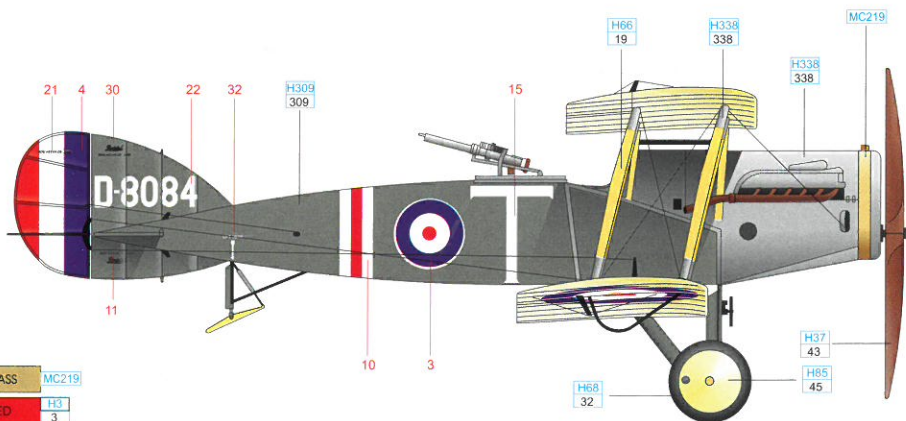
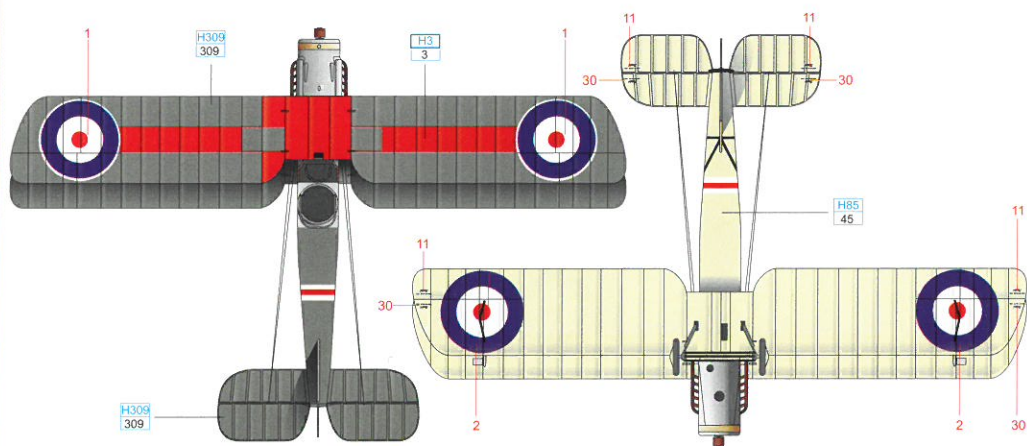
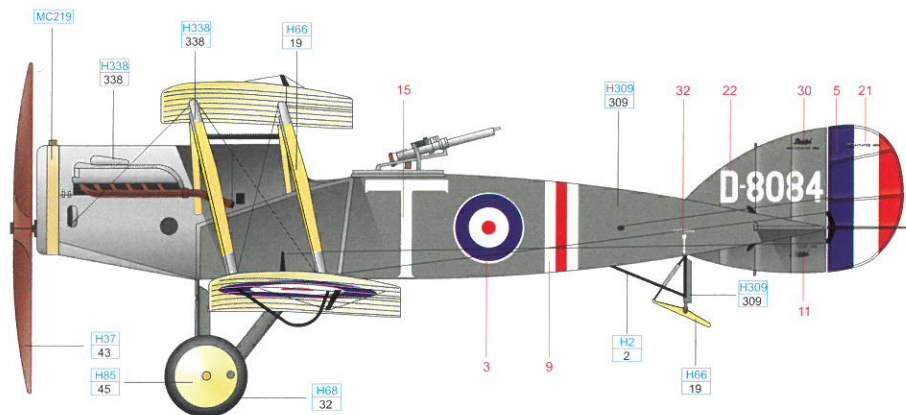

BRASS	MC219										
RED	H3										
GRAY	H68										
GREEN	H309	SAIL COLOR	H85	LIGHT GRAY	H338	SANDY BROWN	H66	WOOD BROWN	H37	BLACK	H2
	309		45		338		19		43		2

B Bristol F.2B B1134, No.34 Squadron RFC, February 1918

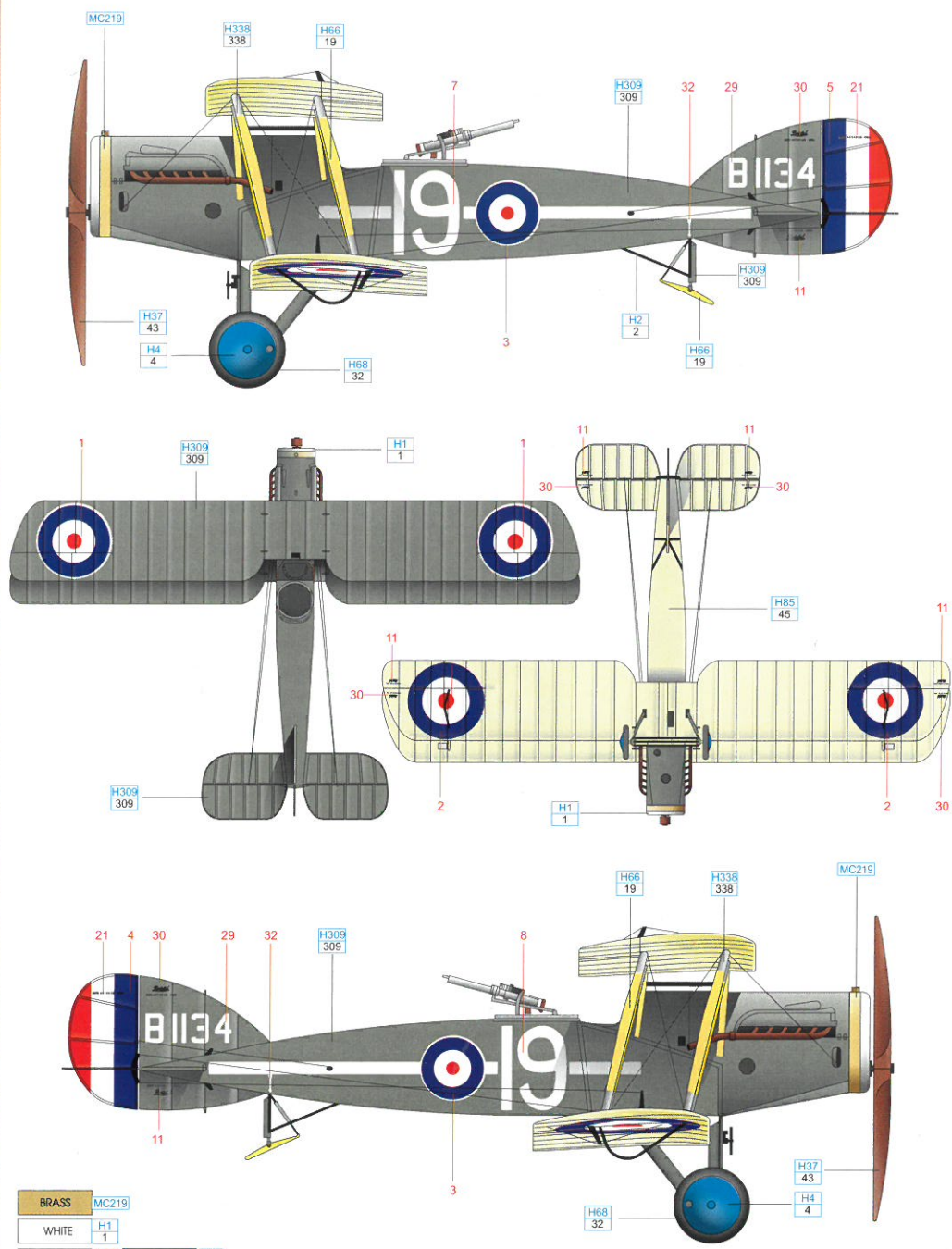

BRASS	MC219								
WHITE	H1								
GRAY	H68	BLUE	H4						
GREEN	H309	SAIL COLOR	H85	LIGHT GRAY	H338	SANDY BROWN	H66	WOOD BROWN	H37
	309		45		338		19		43
								BLACK	H2
									2

C Bristol F.2B C-4695, Gunnery Trainer, No.2 SAFG/No.4 ASAG, Marske, England, 1918

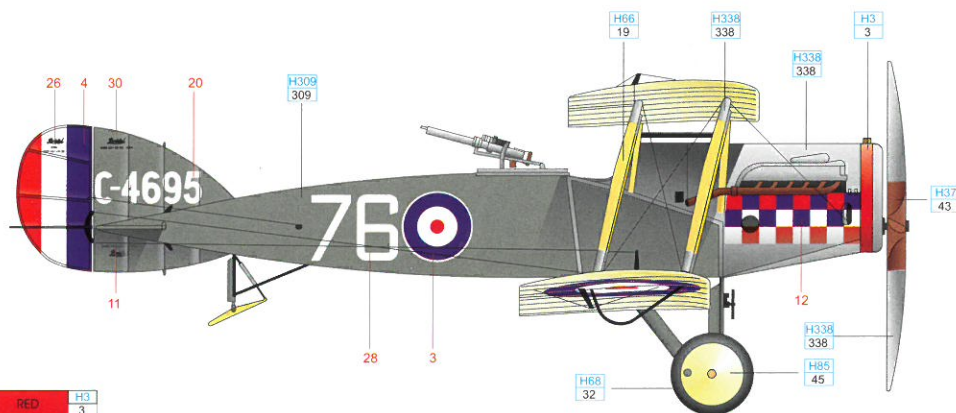
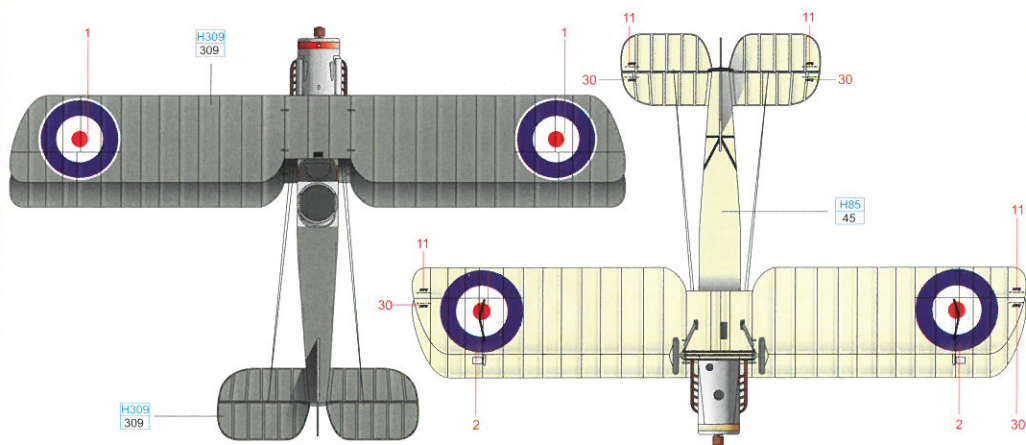
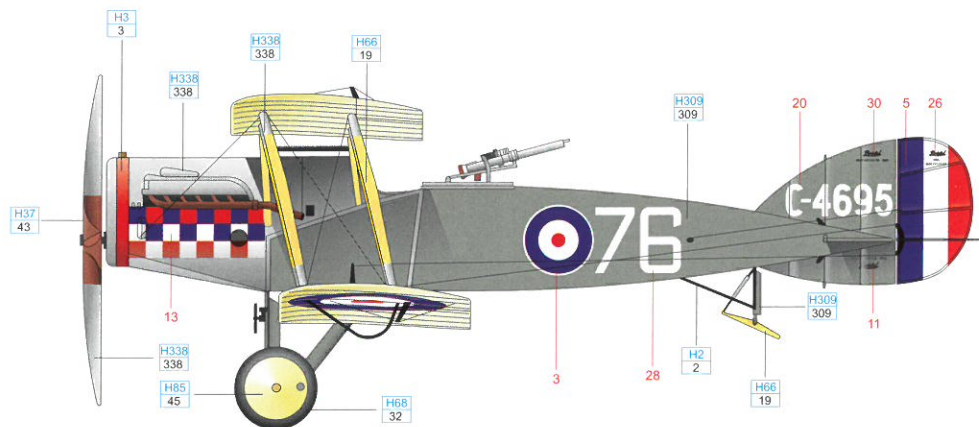

RED	H3 3								
GRAY	H68 32								
GREEN	H309 309	SAIL COLOR H85 45	LIGHT GRAY H338 338	SANDY BROWN H66 19	WOOD BROWN H37 43	BLACK H2 2			

D Bristol F.2B C-4619, No.62 SSquadron RFC, 2/Lt. PR WE Staton and Lt. HE Meritt, 25 1/2 confirmed victories, France, early 1918

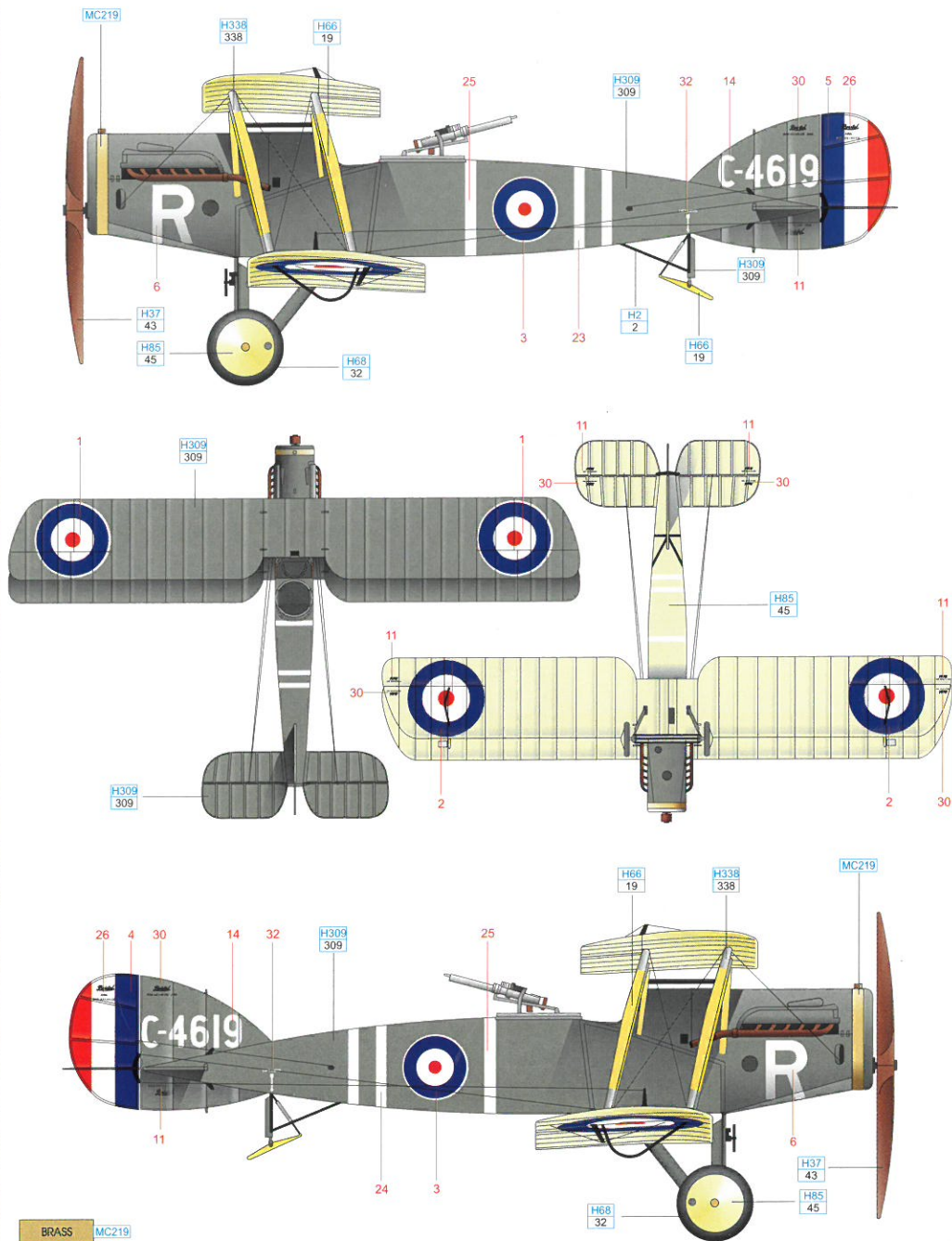

BRASS	MC219	SAIL COLOR	H85 45	LIGHT GRAY	H338 338	SANDY BROWN	H66 19	WOOD BROWN	H37 43	BLACK	H2 2
GRAY	H68 32										
GREEN	H309 309										