

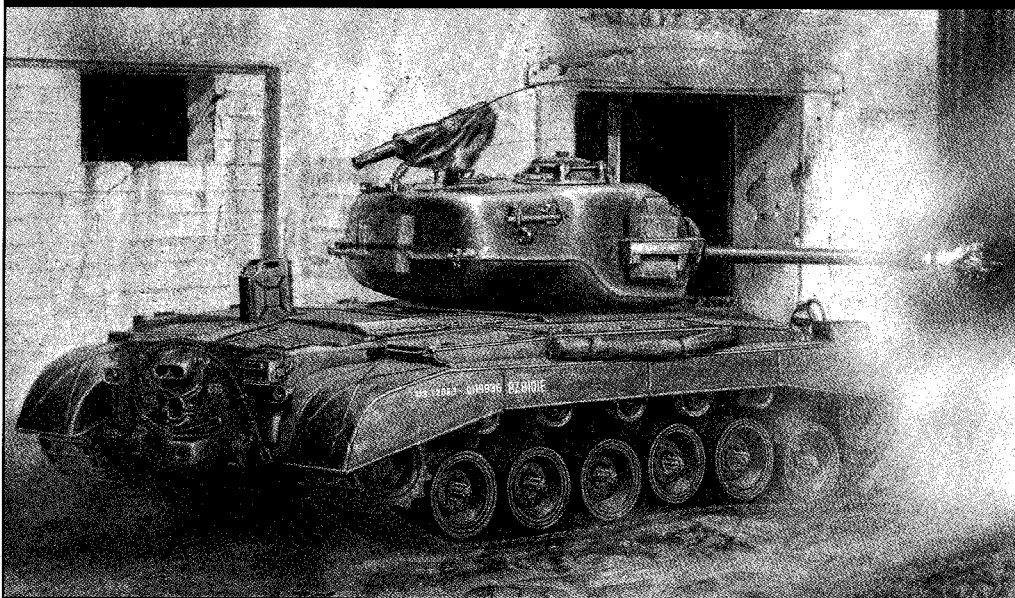

M-26 (T26E3) Pershing Heavy Tank



NO. 7505

THE MILITARY MUSEUM COLLECTION

The M-26 Pershing tank had a long and drawn out development. Army combat doctrine did not call for a heavier tank, as it was assumed that M-4 Shermans would only be fighting infantry, and the enemy tanks would be dealt with by tank destroyers like the M-10.

Combat experience showed that this was a flawed plan, but the definite conclusion on this was not reached until after the Normandy invasion in June of 1944! Something had to be done to deal with the German Panthers, as well as their heavier (although scarcer) Tigers and King Tigers. And it needed to be done quickly! The T-26 was about the best and furthest along of the various designs that the Army was working on, so it was finished off with a 90mm gun in its turret, and also equipped with a new gyro-stabilizer for firing the gun on the move.

Still going by its developmental designation T-26E3 when it entered combat at the end of February 1945, the Pershing put in sterling service during the last few months of WW2.

Parts

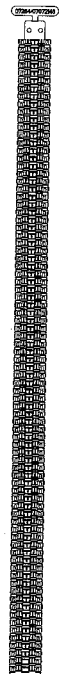
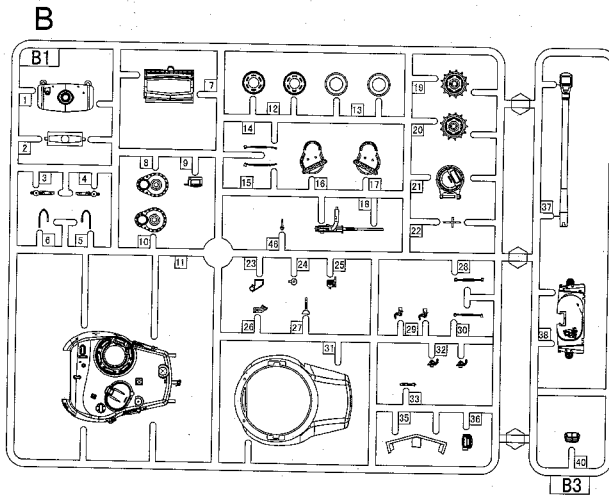
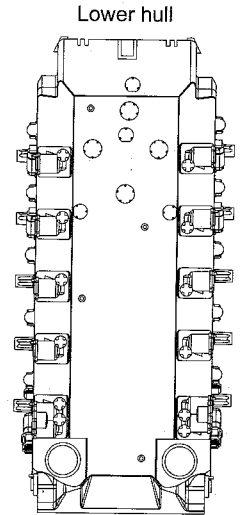
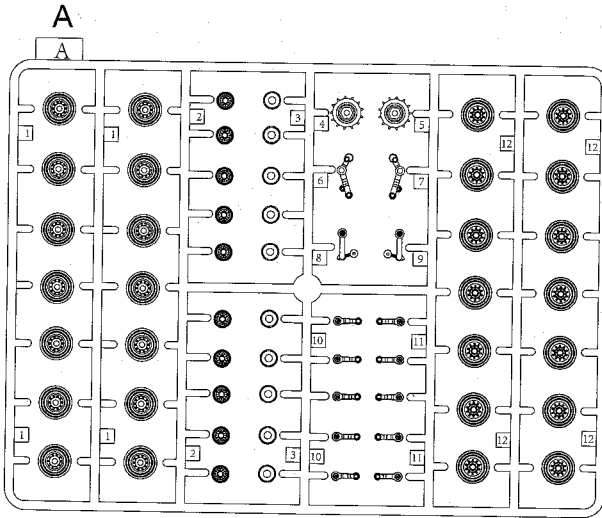

Track x 2

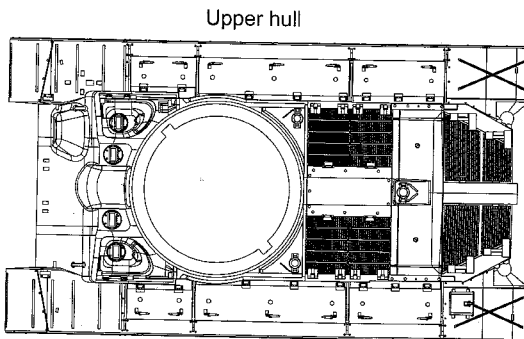

Decal

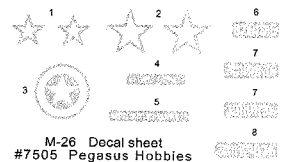

M-26 Decal sheet
#7505 Pegasus Hobbies

1 Wheels assembly

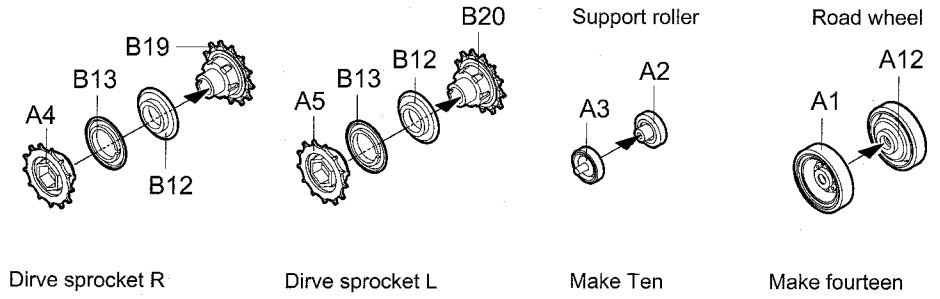

2 Attaching suspension arms

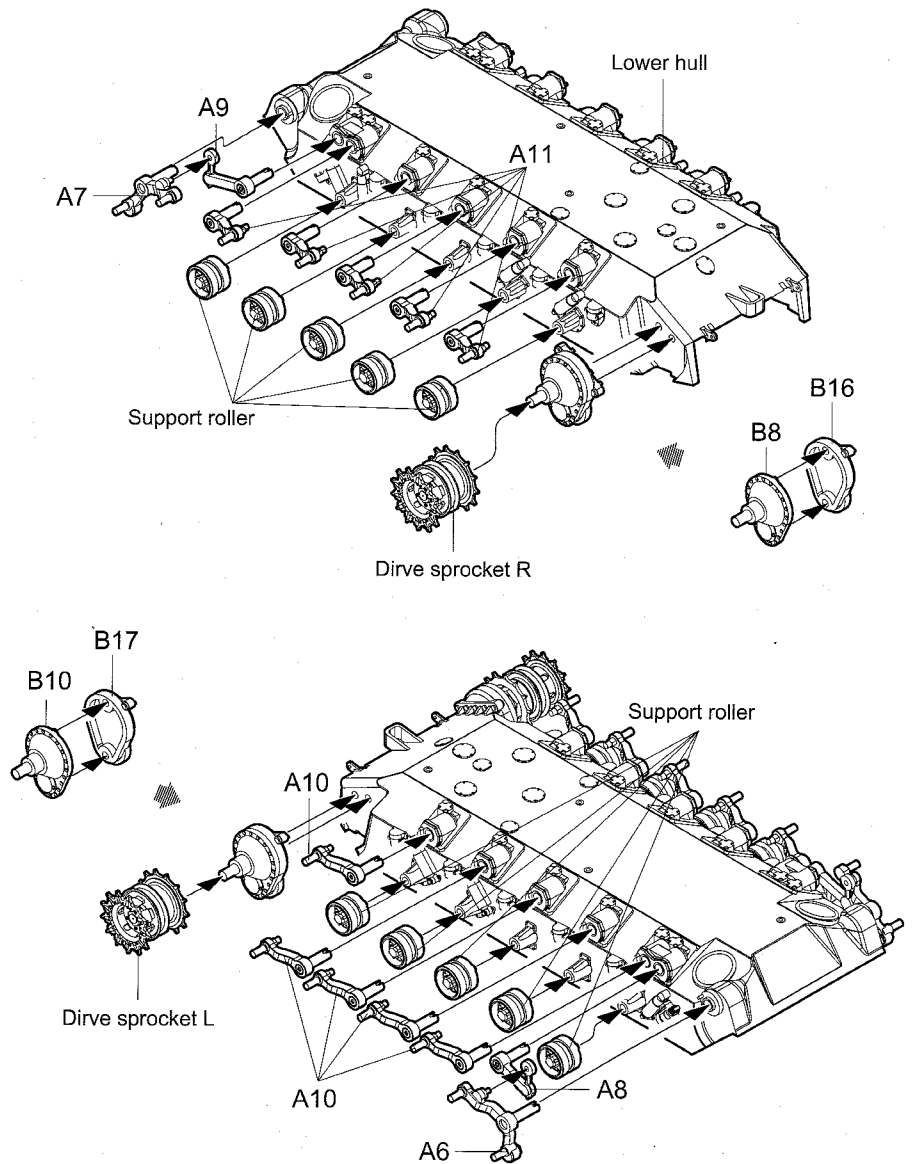

3 Attaching wheels

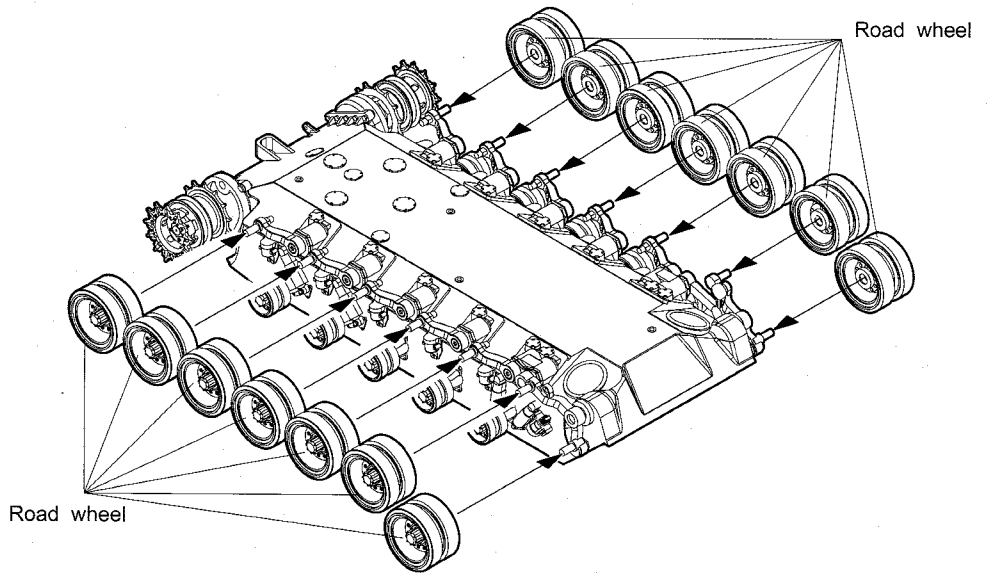

4 Track installation

- * The tracks in this kit can be glued using plastic cement.
- * The tracks can be painted using plastic paints.
- * If track is broken strengthen with staples or thread.

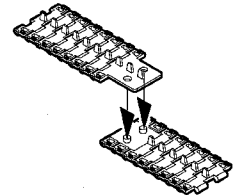

5 Track installation

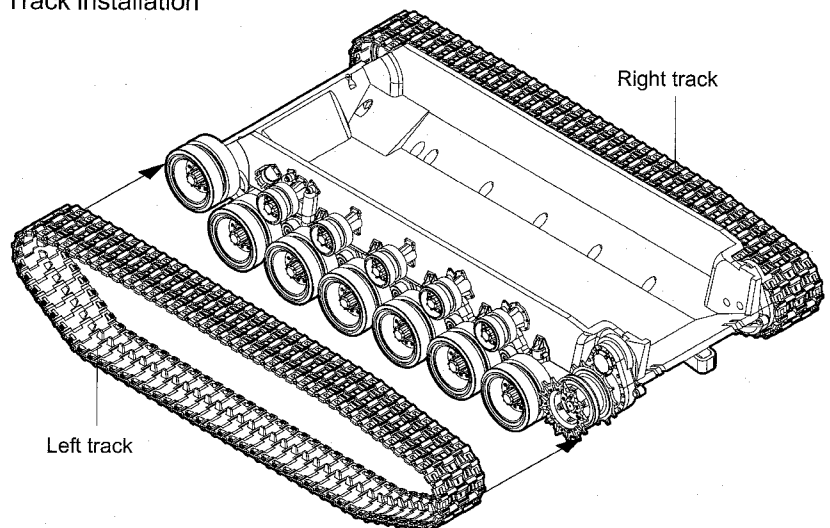

6 Upper hull installation

Upper hull

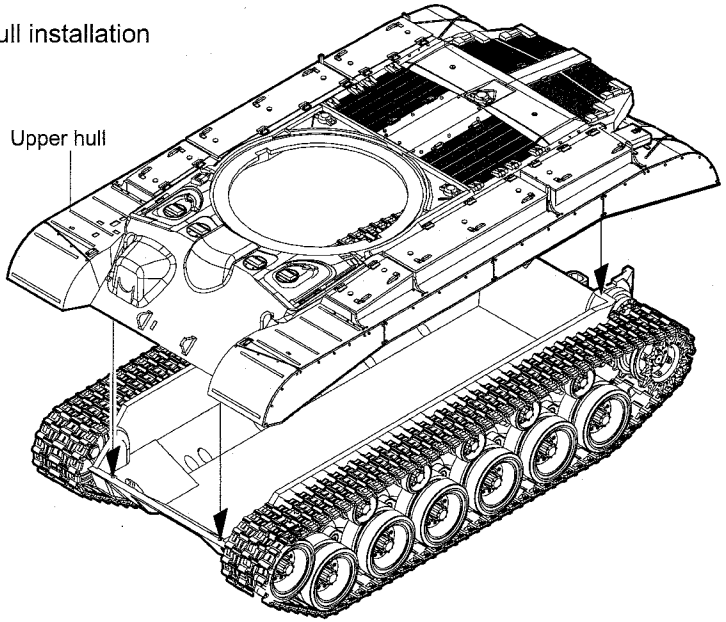

7 Rear panel assembly

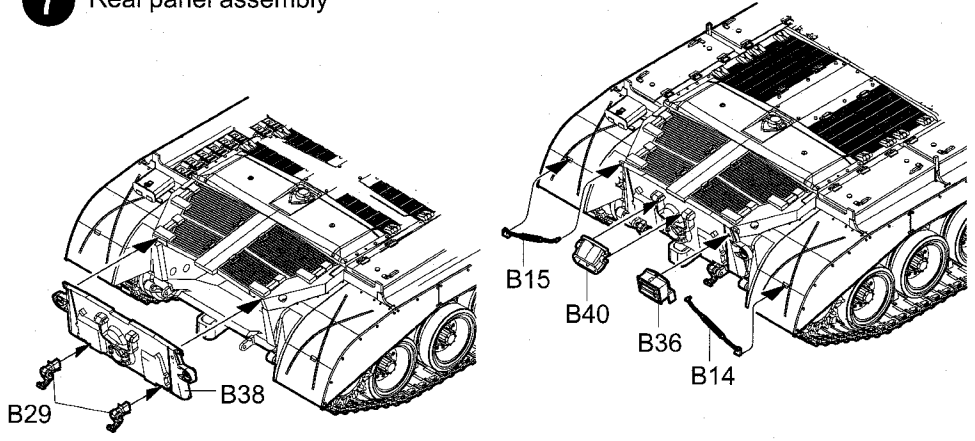

8 Upper hull assembly

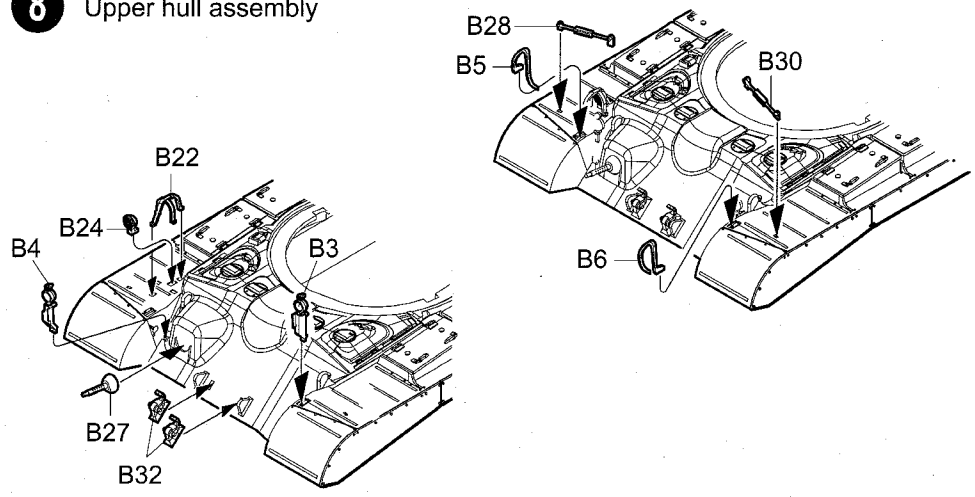

9 Turret assembly

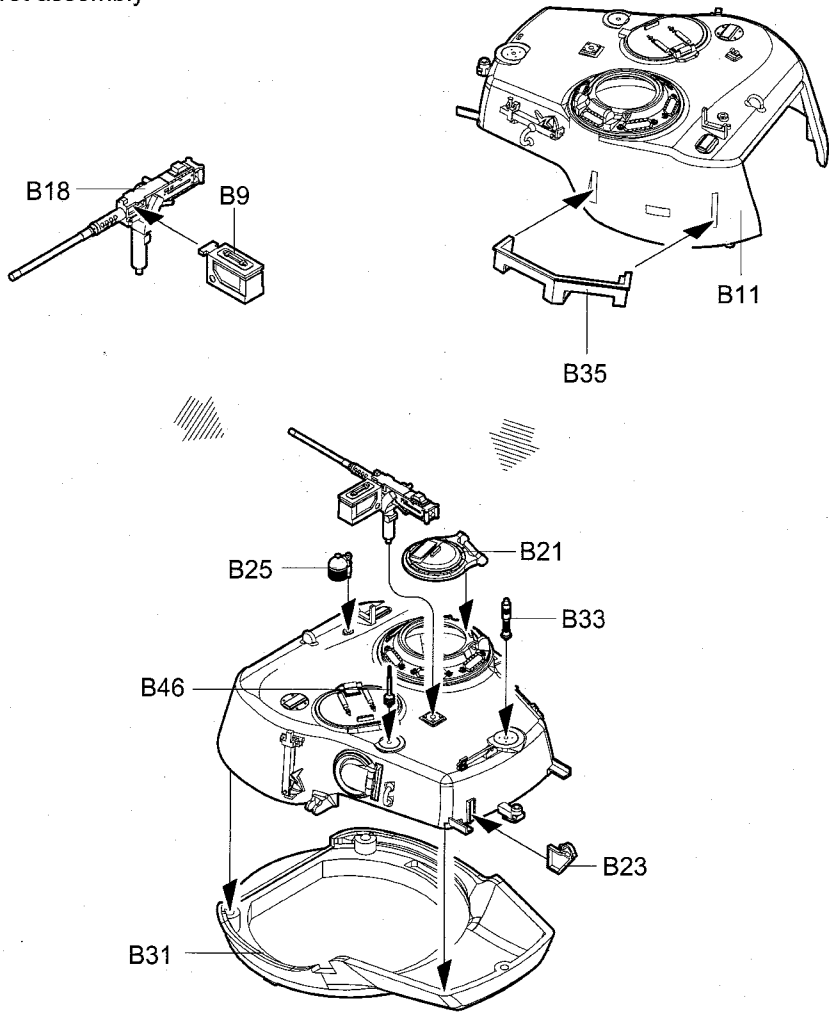

10 Turret assembly

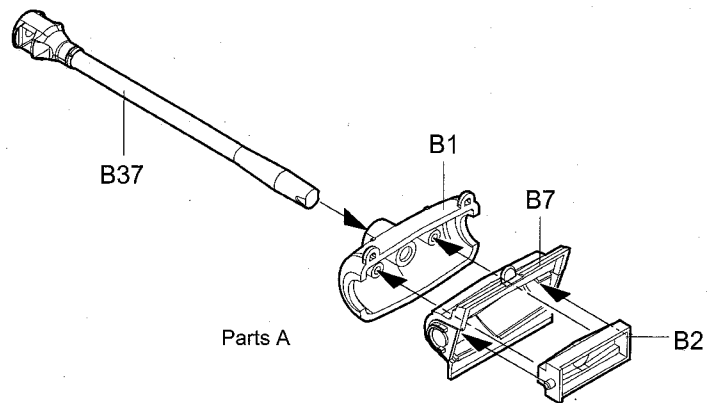

11 Turret assembly

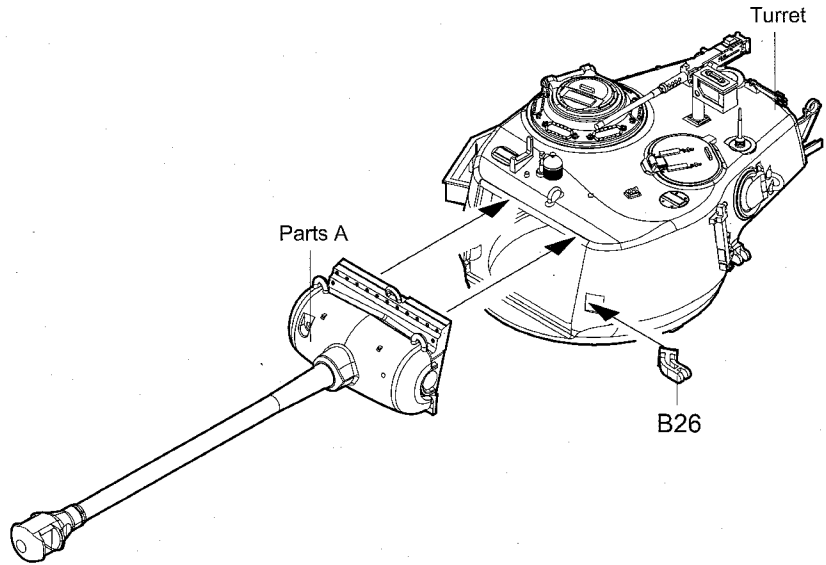

12 Attaching turret

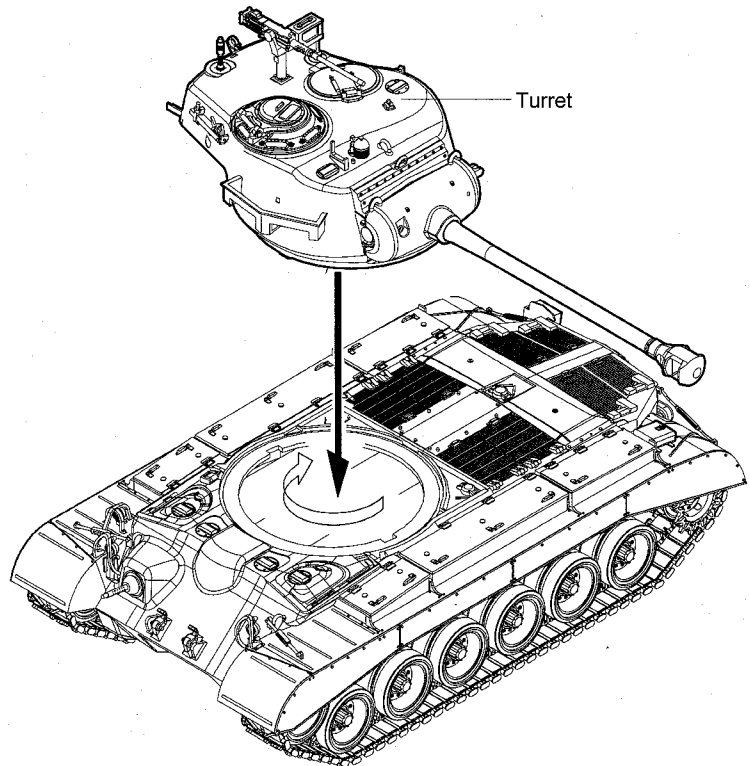

DECAL & PAINTING GUIDE

To get a really nice finish, make sure you use quality hobby paints and brushes. Take good care of your brushes and clean them well after every time you use them and they will last long time. Before you paint, be sure to lay down some newspaper in the area you plan on working. Most of the painting can be done after assembly of the tank. Some areas of the suspension however are most easily painted during assembly however, as well as the track! Use your best judgment on how you think best to paint them. Wait until all paints have dried completely before putting on the decals. Decals are best applied by the following method.

1. Cut each design out separately, only when you are ready for that one.
2. Take a paper towel and fold in half twice.
3. Dip the decal in a dish of water for only 10 seconds, and then put it on the paper towel, design side up.
4. Wait until the design moves freely around on the paper. Only touch it with a wet finger tip!
5. Slide the design from the paper onto the model and blot the excess water away with a paper towel and let dry.

Paint Color Chart

P1	OLIVE DRAB
P2	GUN METAL
P3	FLAT BLACK

