

1/35 MILITARY MINIATURE VEHICLE UPGRADE SERIES PE35701

WWII US M26 Recover Vehicle Cabin Interior

二战美国M26 龙式拖头内部改造件

[For TAMIYA 35230 35244]

推荐使用工具 RECOMMENDED TOOLS

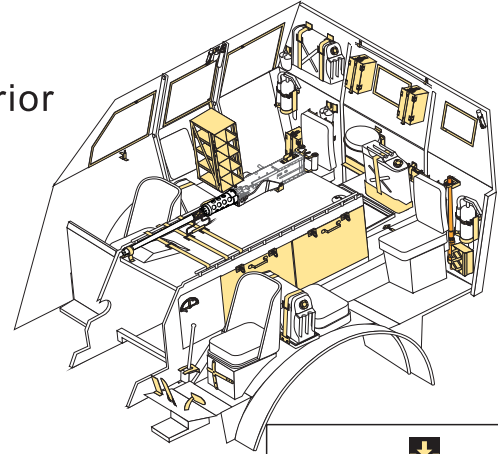
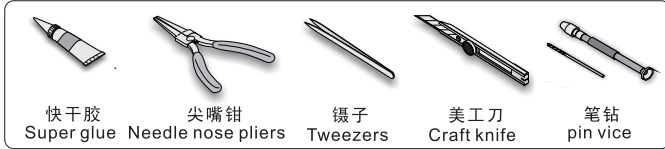

用尖端在凹槽处冲压
use penpoint to press on the dent

雕刻片零件内侧面向上
Put the part upside down

用笔尖在凹槽处刺
Use penpoint to press on the dent

↑ 安装 install
↶ 折叠 bend
A1 改造件零件编号 PE/resin part number
B12 原零件编号 kit part number
C22 被替换的原零件编号 replaced kit part number
↔ 另一侧相同制作 repeat on opposite side

✂ 切除 remove
🔪 打磨 grind off
📐 弧度卷曲 radial bending
x2 制作若干组 multiple assembly
↔ 选择安装 alternative
🔪 钻孔 drill
⚠ 注意 caution

a

b

切取自塑料件 H21
Cut from plastic part H21

自制
Scratch build

自制
Scratch build

e

f

自制
Scratch build

g

c

取自其他套件
Obtained from other kits

h

1/35 MILITARY MINIATURE VEHICLE UPGRADE SERIES PE35701

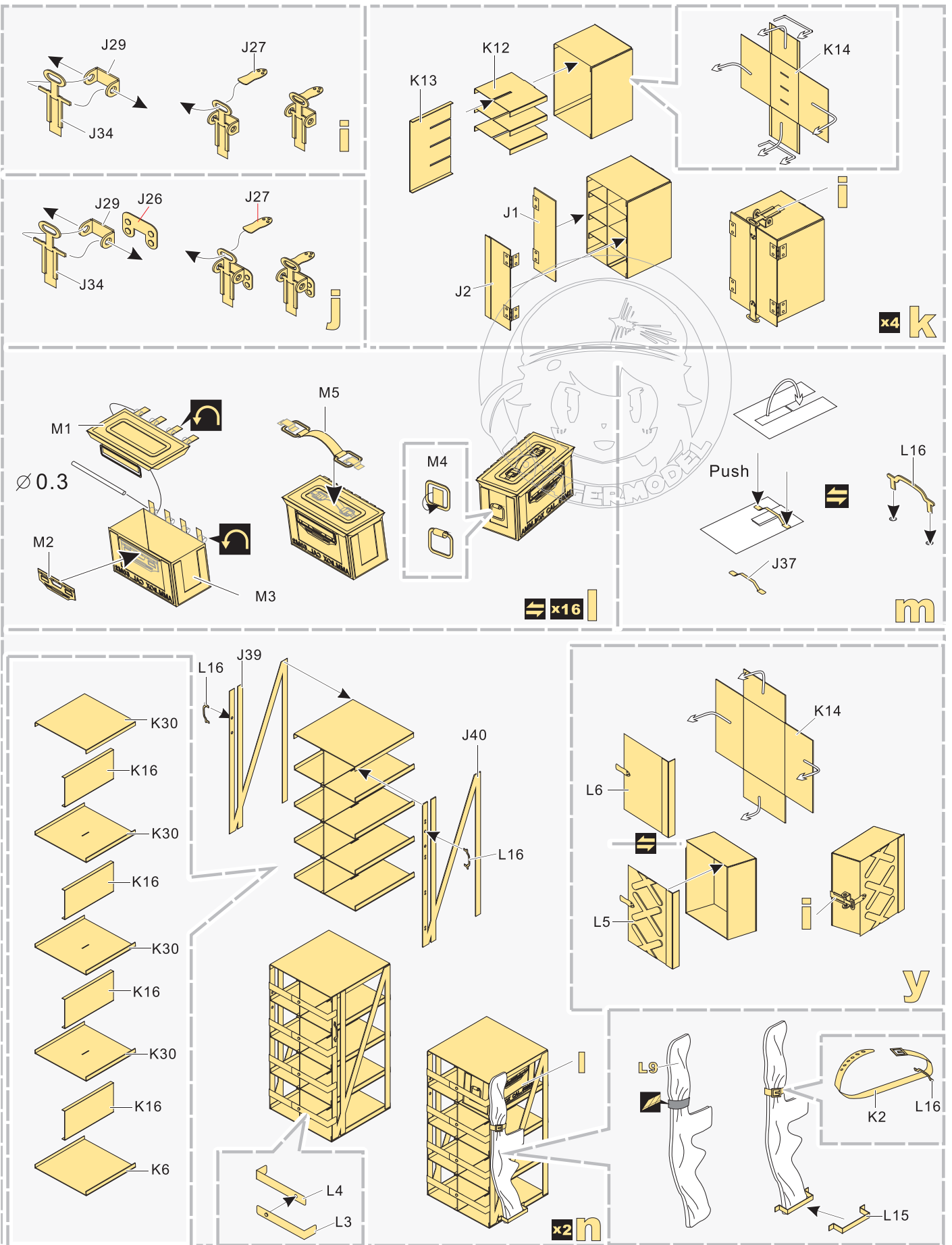

1/35 MILITARY MINIATURE VEHICLE UPGRADE SERIES PE35701

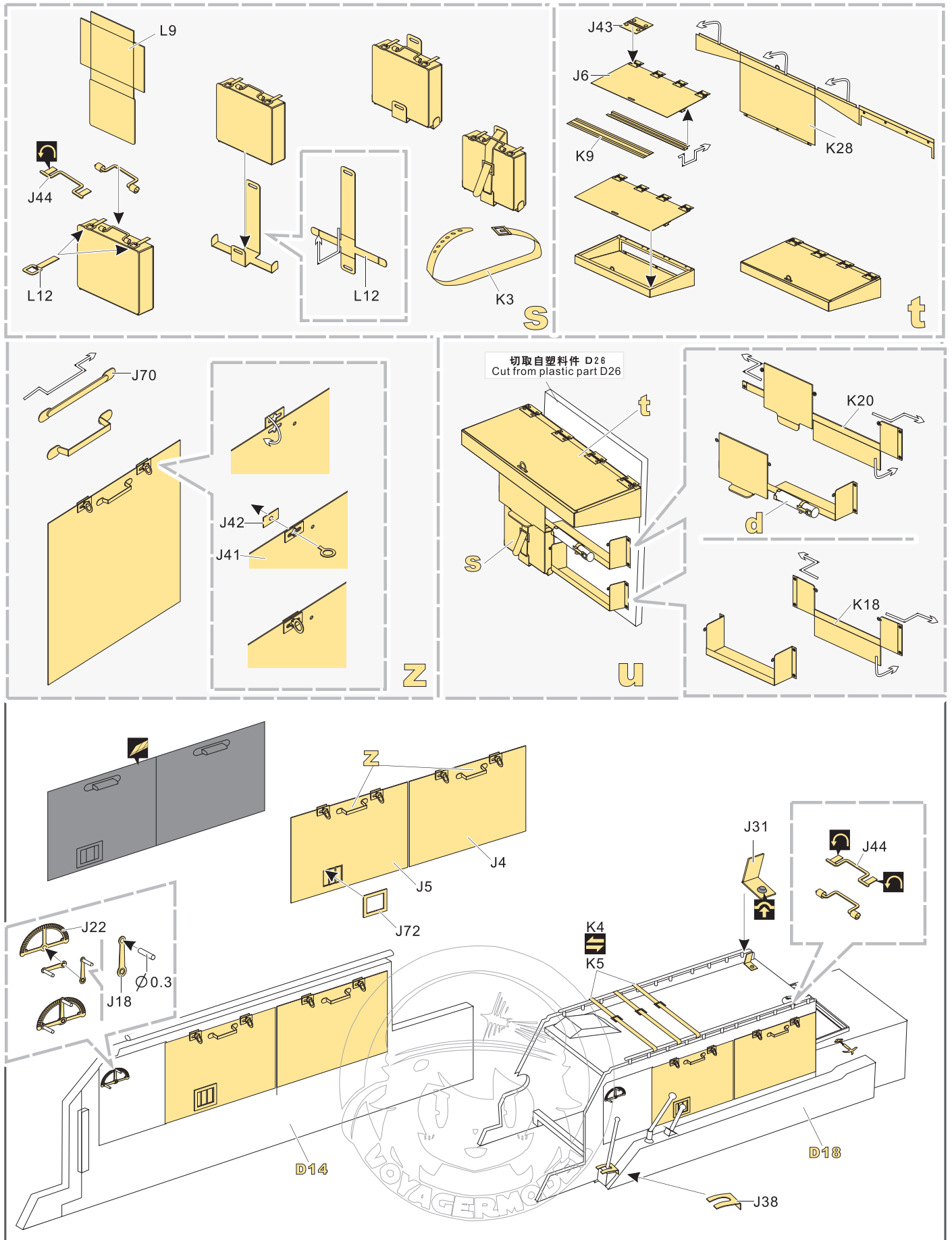

1/35 MILITARY MINIATURE VEHICLE UPGRADE SERIES PE35701

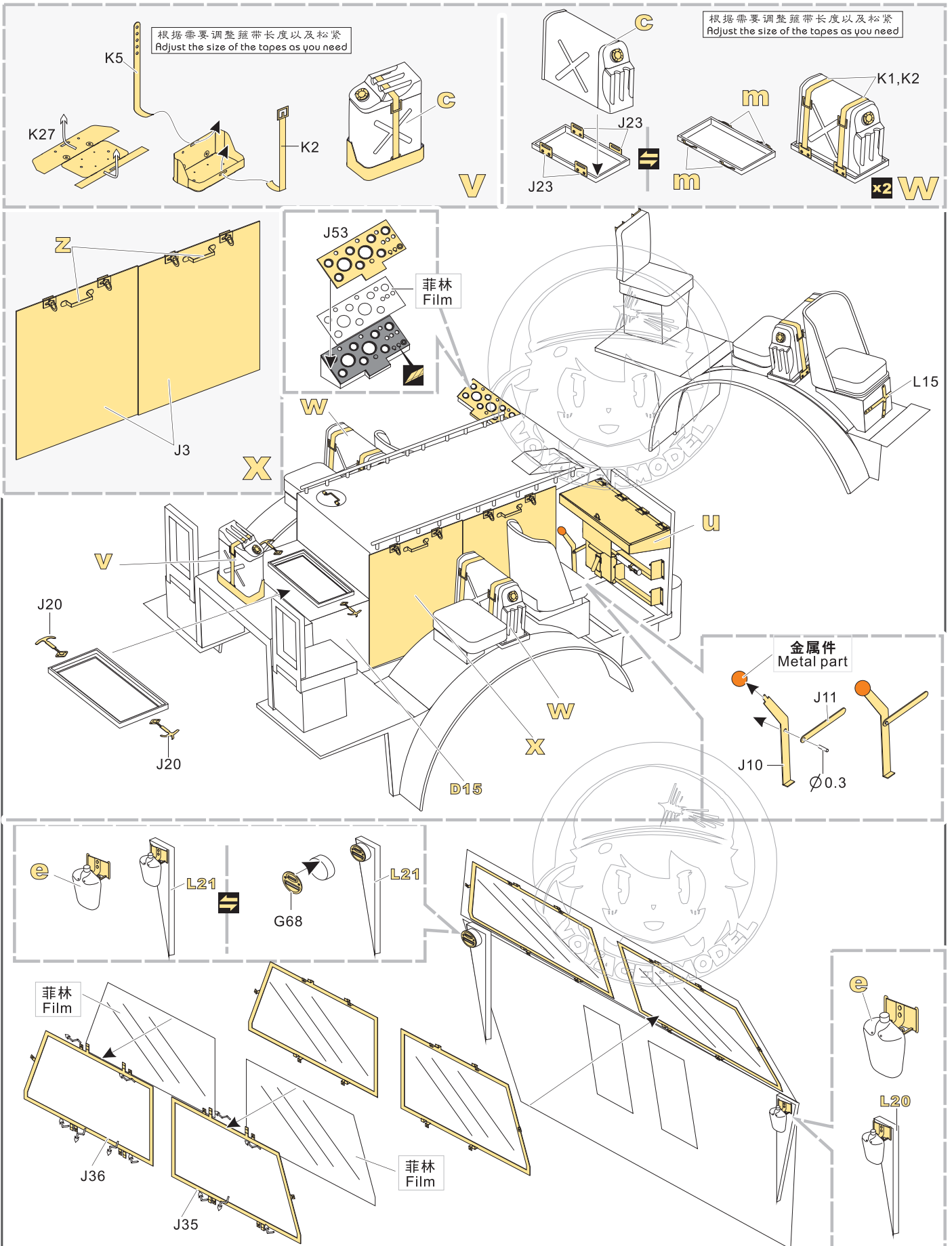

1/35 MILITARY MINIATURE VEHICLE UPGRADE SERIES PE35701

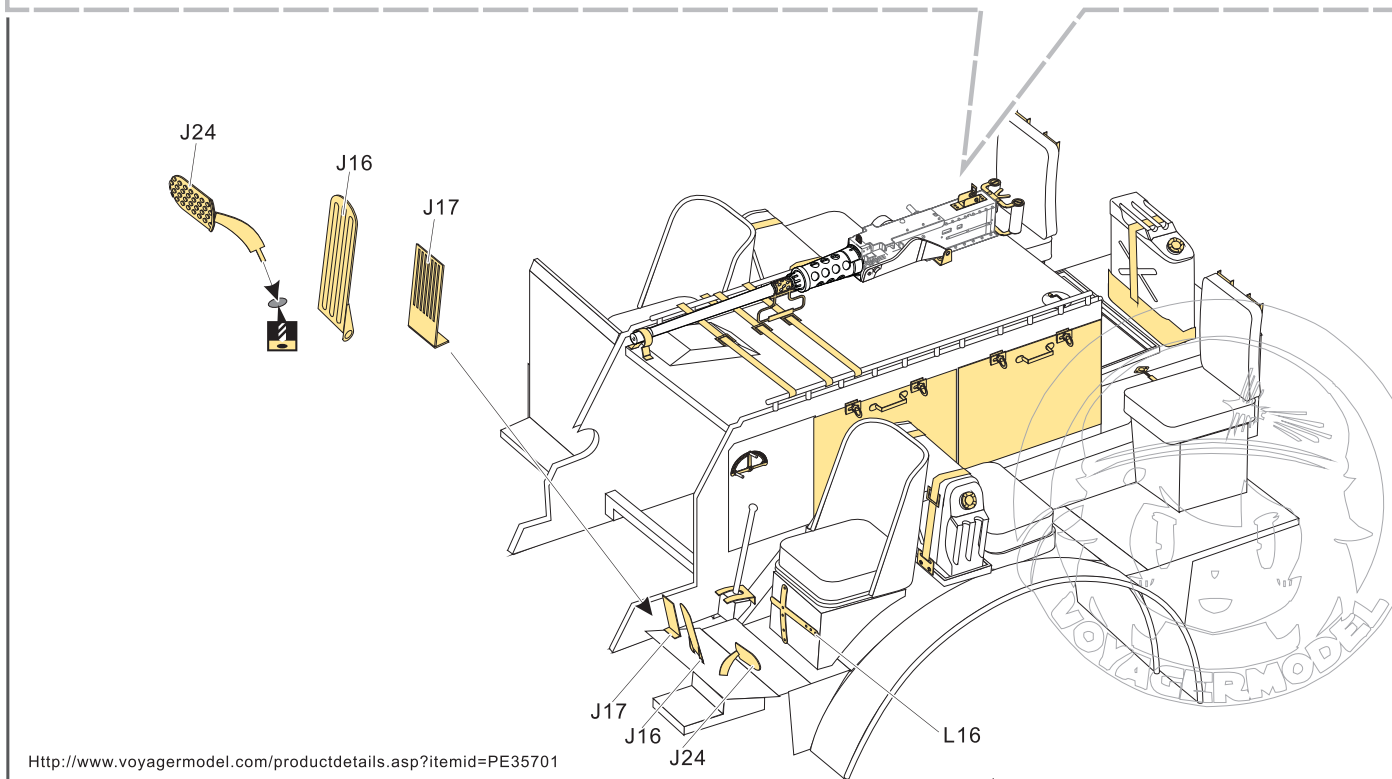
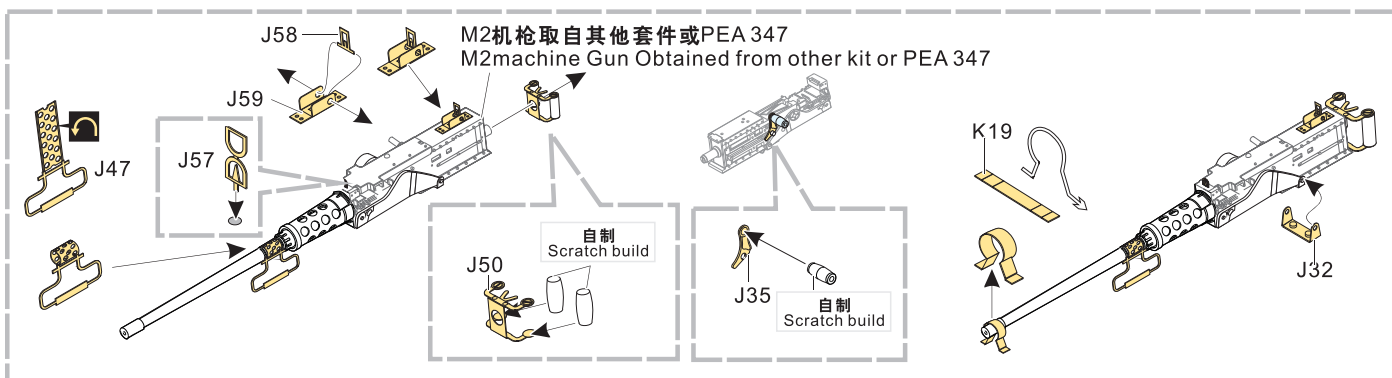

[Http://www.voyagermodel.com/productdetails.asp?itemid=PE35701](http://www.voyagermodel.com/productdetails.asp?itemid=PE35701)



**VOYAGER
MODEL**



更多PE35701样品照片参考请扫一扫
MORE PICTUER OF PE 35701
REFERENCE SCAN HERE

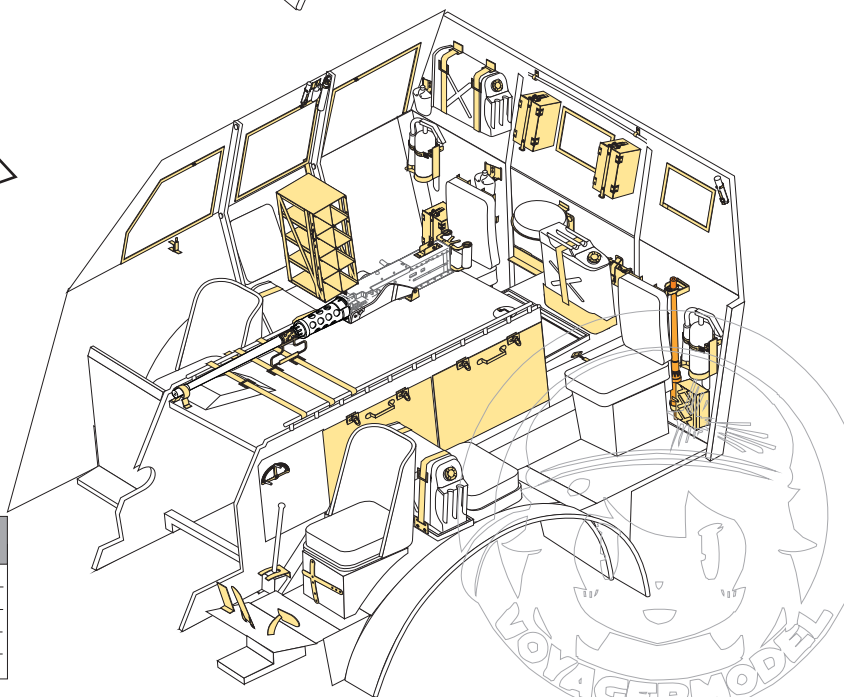

VOYAGERMODEL [®] 无限不至 极尽享受	
Recommended item	
PE 35700	WWII US M26 Recover Vehicle basic
PE 35702	WWII US M15 Trailer development basic
PEA 347	WWII US M26 Recover Vehicle additional parts
PEA 345	WWII US M26 Recover Vehicle Road wheels
PEA 346	WWII US M15 Trailer Development Road wheels