

A SHORT HISTORY

The F 86 Saber Jet, a single seat fighter, was originally a land-based version of the FJ-1 Fury with an upswept wing. This wing design was modified with the adoption of a 35° swept wing which increased maximum speed by as much as 70 MPH. The first prototype, flown in October, 1947, resulted in an order for 221 production F-86A fighters, placed by the U.S.A.F. in December of the same year. Maximum speed of this North American Jet is 660 MPH at sea level. Basic armament is twenty-four 2.75-in. Mighty Mouse Rockets in a retractable under-fuselage tray. This version is an all-weather type fully equipped with radar search and fire control equipment.

PAINTING INSTRUCTIONS:

This aircraft is generally unpainted aluminum with the following exceptions: The area immediately in front of the cockpit and extending to and including the nose radar dome is non-reflecting black; pilot seat is brown as well as interior of the cockpit; pilot's head-rest, wheels, landing gear struts, inside of air intake and exhaust ring, are generally black. The air intake tube (No.47) has a green exterior as does the cockpit floor. Personnel are painted in traditional Air Force blue.

See box cover for authentic color scheme.

GENERAL INFORMATION

STUDY INSTRUCTION CAREFULLY BEFORE STARTING ASSEMBLY!!!

1. Follow the assembly instructions step by step. Do not hurry or attempt to skip steps.
2. Paint all parts as indicated on plans. It is better to paint all parts before beginning assembly.
3. Moving parts should be coated with Grease or Vaseline before inserting into position. This insures that cement will not bind parts and also acts as a lubricant.
4. Be certain that you have all parts.
5. Always check to be certain that parts fit well before applying cement. In some cases it may be necessary to file or trim with a sharp blade to insure perfect fit. Avoid using too much cement for it will ooze out of joint and result in an unsightly finish.
6. Use only a good grade of plastic cement. Apply cement to both contact surfaces; then squeeze them together to insure good bonding.
7. Do not use lacquer for painting. Use only a good grade of enamel.

ASSEMBLY INSTRUCTIONS:

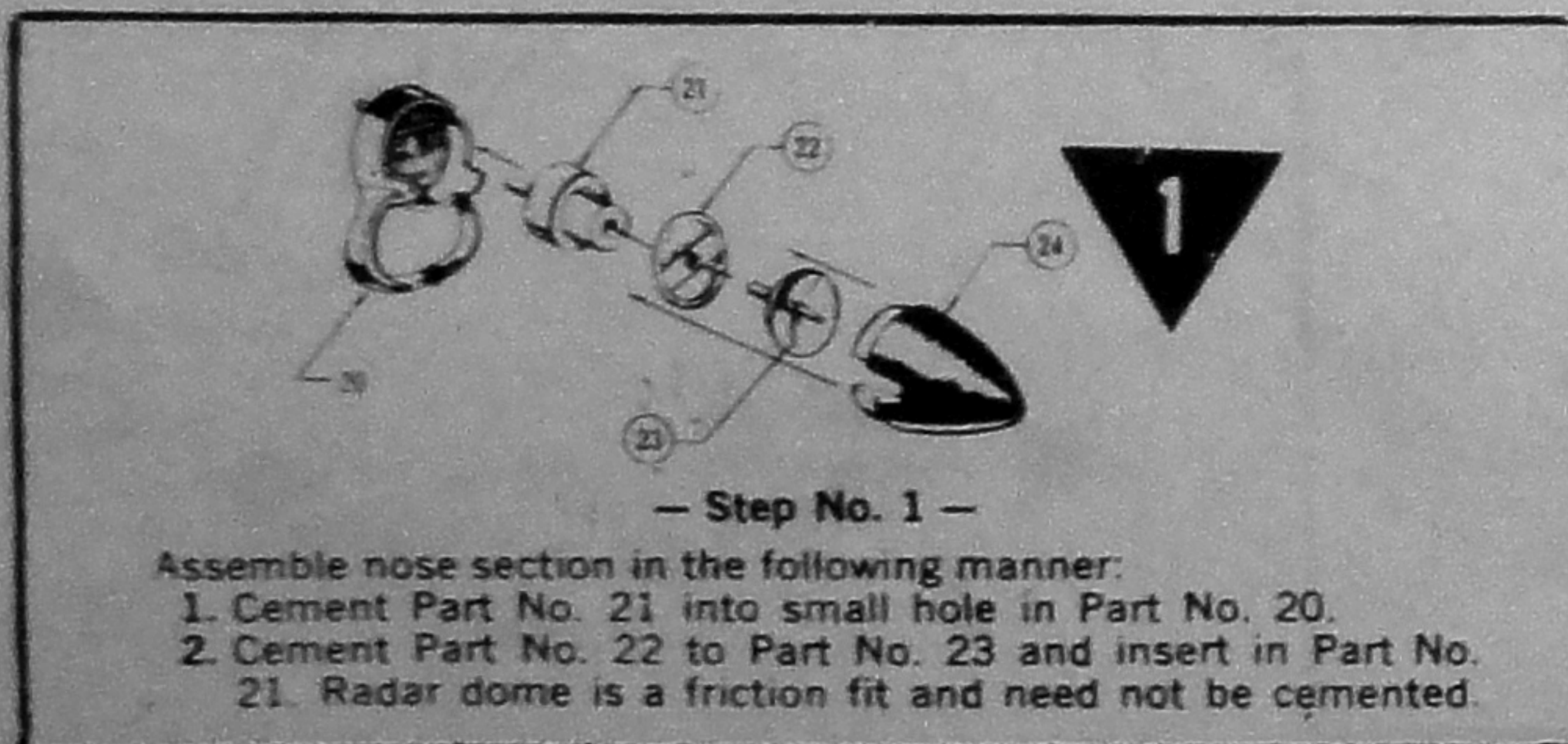

— Step No. 1 —

Assemble nose section in the following manner:

1. Cement Part No. 21 into small hole in Part No. 20.
2. Cement Part No. 22 to Part No. 23 and insert in Part No. 21. Radar dome is a friction fit and need not be cemented.



K.K. MARUSAN

SUPER DETAIL SERIES 1/50 SCALE

SABREJET

F86D FIGHTER

KIT. 425

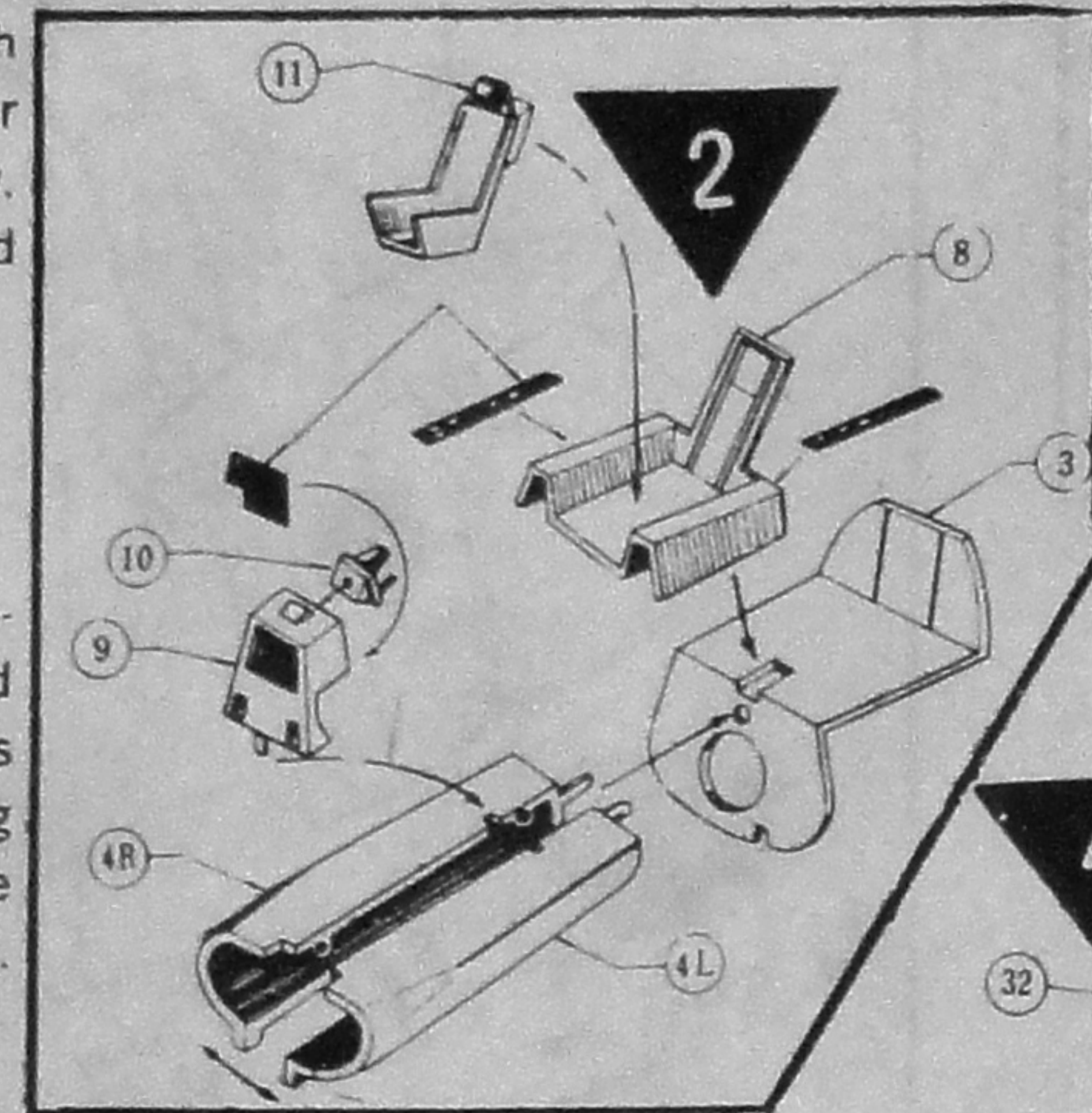

— Step No. 2 —

Assemble cockpit and flight deck in the following manner:

1. Cement air intakes (No. 4R, 4L) together and then insert and cement to floor (No. 3).
2. Cement seat holder (No. 8) onto Part No. 3. Decal Part No. 3 as illustrated. Cement seat (No. 11) into position on Part No. 8. Decal instrument panel (No. 9).
3. Cement radar scope (No. 10) to Part No. 9 and cement assembly to air intake assembly (No. 4R, 4L).
4. Note: Cockpit floor (No. 3) has a hole in lower edge. Trim this to accommodate nose wheel door hinge.

— Step No. 3 —

Assemble fuselage in the following manner:

1. Cement completed cockpit assembly into left fuselage as illustrated. Slip hinge pin of nose wheel door (No. 6) into hole in Part No. 3. Forward hinge pin on Part No. 6 is then secured to fuselage with Part No. 7. Take care that door operates freely.
2. Cement forward engine mount (No. 19) into fuselage.
3. Cement air intake cone (No. 5) into mid-section of fuselage between rocket pins.
4. Cement access door (No. 80) into fuselage.
5. Cement Part No. 81 to canopy shaft (No. 13). Cement Part No. 15 into slot in canopy (No. 13).
6. Slip wheel and tire (No. 17) onto nose wheel strut axle (No. 18). Expand axle tip with hot nail and insure that wheel turns freely. Slip nose wheel assembly pin into hole in left fuselage.
7. Put canopy assembly in position over rear cockpit with canopy shaft and Part No. 81 in slot.
8. Cement right fuselage half (No. 1) to left fuselage half (No. 2) taking care that nose wheel pin goes into hole on right fuselage and that rotating pins are in their opposite holes. Wrap several rubber bands around fuselage to insure proper drying. During drying process, work canopy, nose wheel assembly and door to be certain they are not bound.
9. Cement wind-shield (No. 16) into position on top of fuselage. Be certain that canopy (No. 13) closes snugly against it.

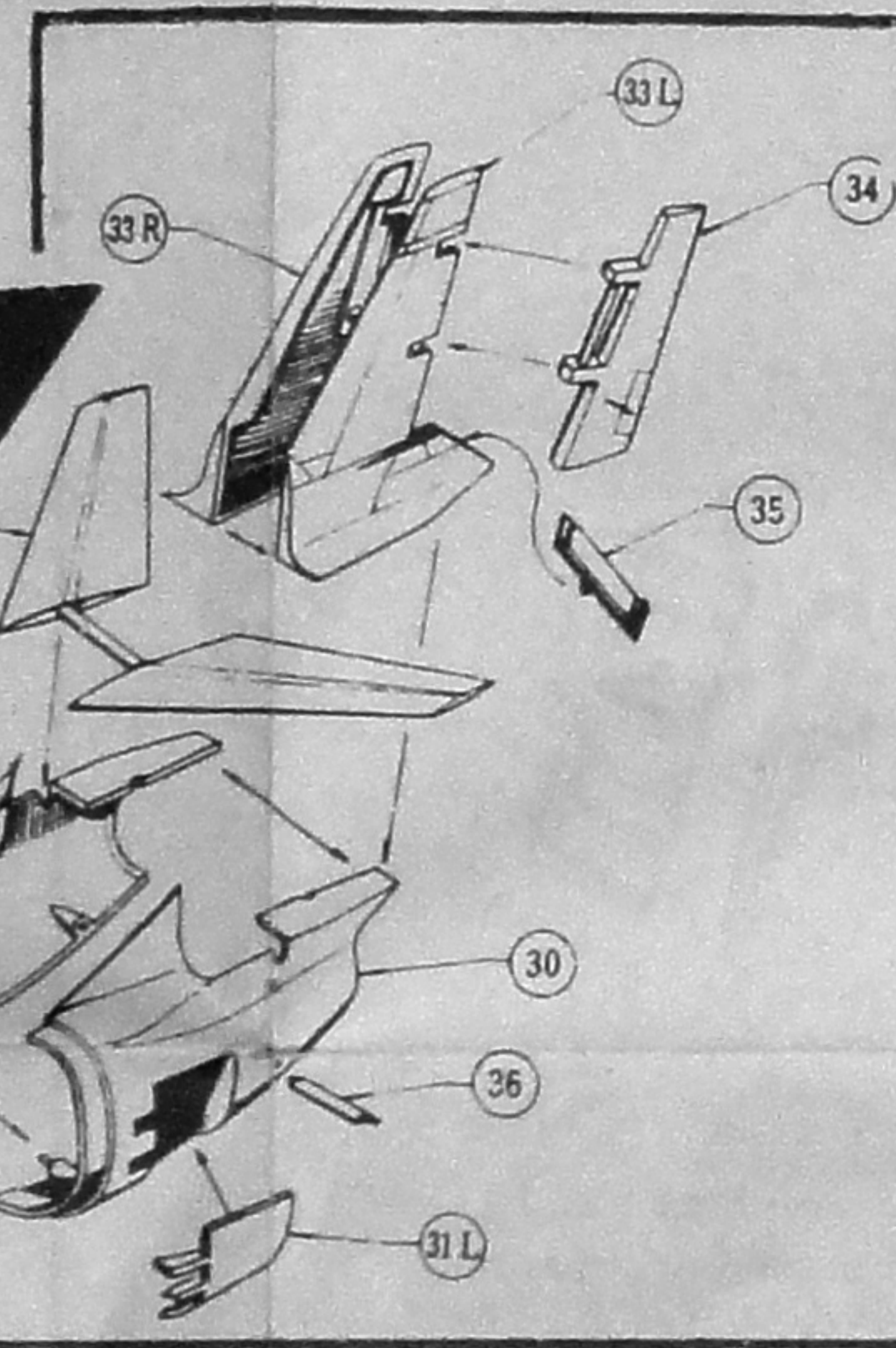

— Step No. 4 —

Assemble tail in the following manner:

1. Cement Part No. 29 and Part No. 30 together. Insert horizontal stabilizer (No. 32) as illustrated. Put a spot of UPC Wonder Grease on rudder hinge (No. 34) and insert in left vertical stabilizer (No. 33L). Cover and cement with Part No. 33R. Insure that rudder (No. 34) works freely.
2. Cement Part No. 35 as illustrated.
3. Insert speed brakes (No. 31R, 31L). These may be open or closed.
4. Cement oil discharge pipe (No. 36) into lower left tail as shown.

— Step No. 5 —

Assemble wings in the following manner:

1. Clean all flash from lower wing (No. 37) and all wing parts. It is best to assemble this portion without cementing until you are certain that parts fit and work properly.
2. Slip tire and wheel (No. 40) over landing gear strut axle (No. 38L); secure wheel hub (No. 41). Put a drop of cement in hole of hub (No. 41); slip over tip of axle. Insure that wheel turns freely.
3. Repeat this process with right wheel.
4. Drop wheel cover doors (No. 42R, 42L) into slots.
5. Grease aileron and flap hinges and lay these hinges in lower wing slots. Insert Part No. 43R and Part No. 43L in wing slots as illustrated.
6. Drop complete wheels into wells insuring that wheel pins are in the inside grooves. Drop strut covers (No. 39R, 39L) in outside grooves. Carefully cement Part No. 44R and Part No. 45L over this completed assembly taking care that none of the moving parts are cemented.
7. Hold this assembly together for several minutes before proceeding to next step.
8. Insert pitot tube (No. 48).

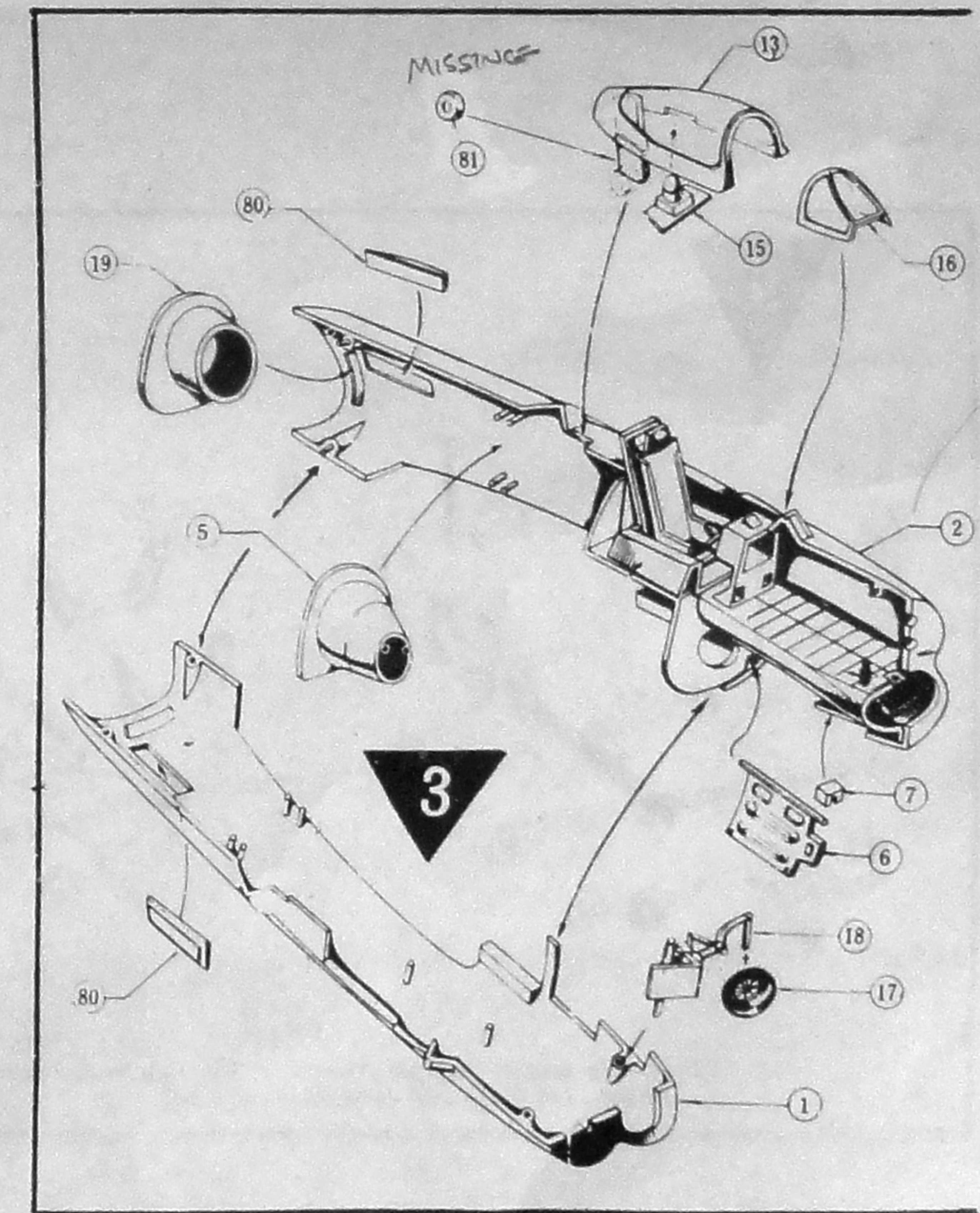
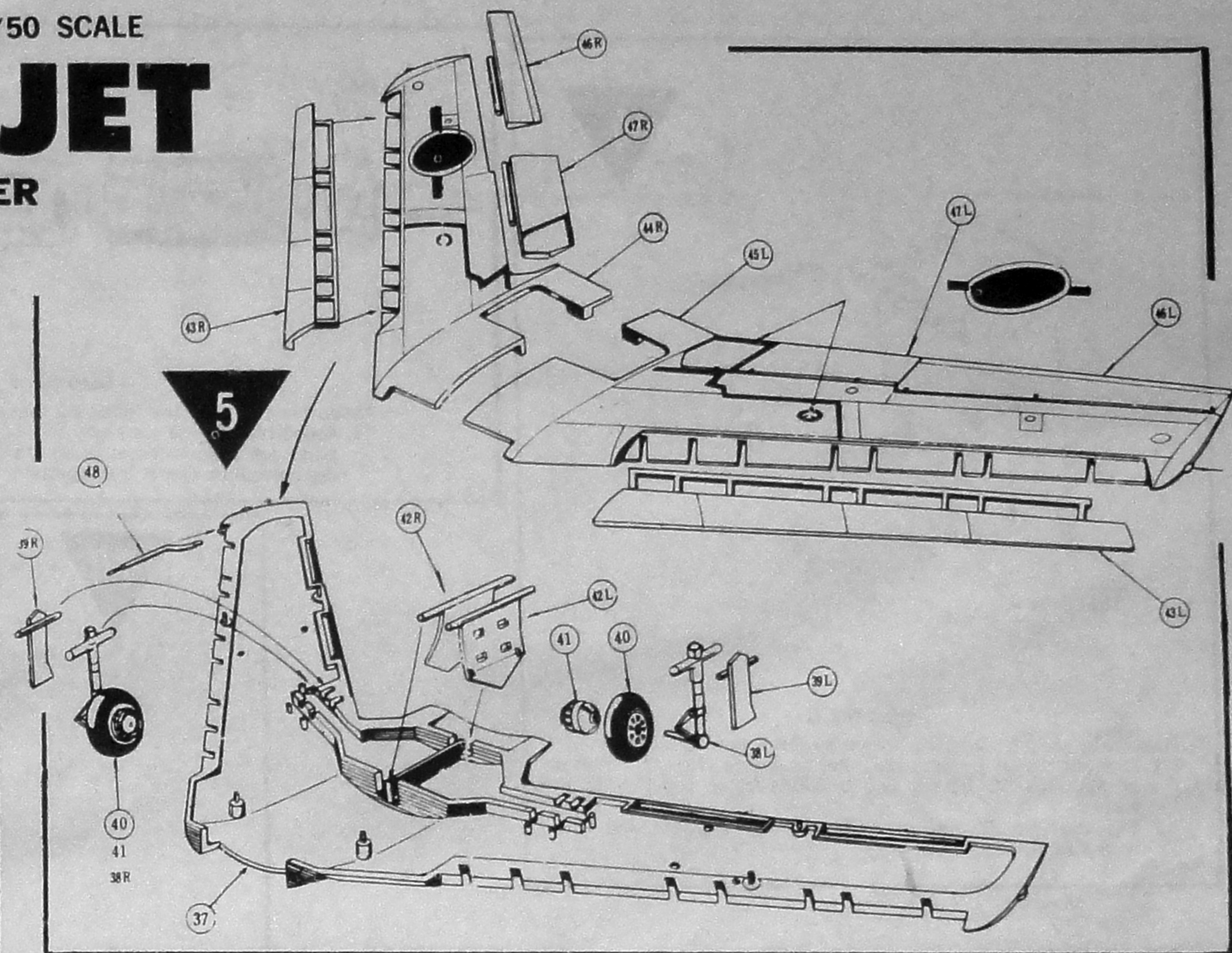

6

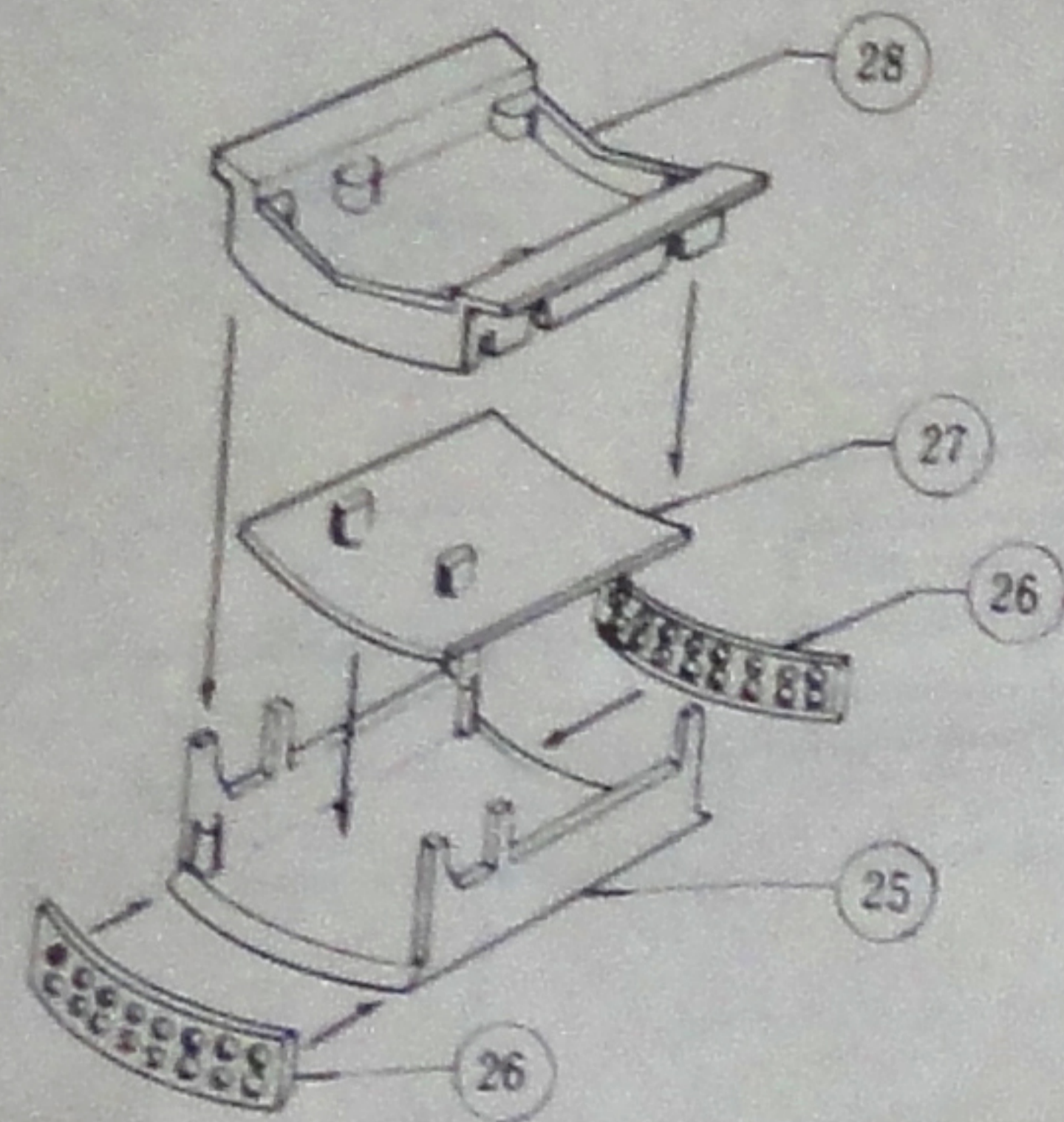

— Step No. 6 —

Assemble rocket launching frame in the following manner:
1. Cement rocket holders (No. 26) to frame (No. 25). Portion of Part No. 25 having two brackets close together is the front.
2. Slip Part No. 27 into assembly No. 25. Cement and cover with Part No. 28.

7

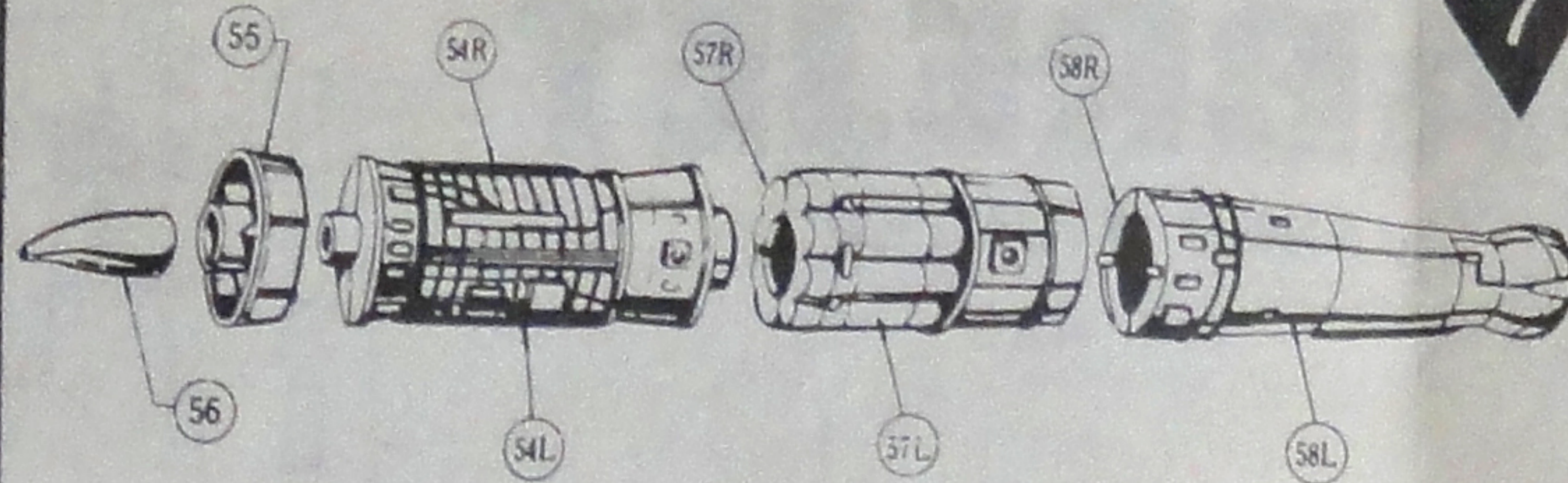

— Step No. 7 —

Assemble engine in the following manner:
1. Assemble engine carefully as illustrated taking care that parts are assembled in order from left to right after matching halves are cemented together.

10

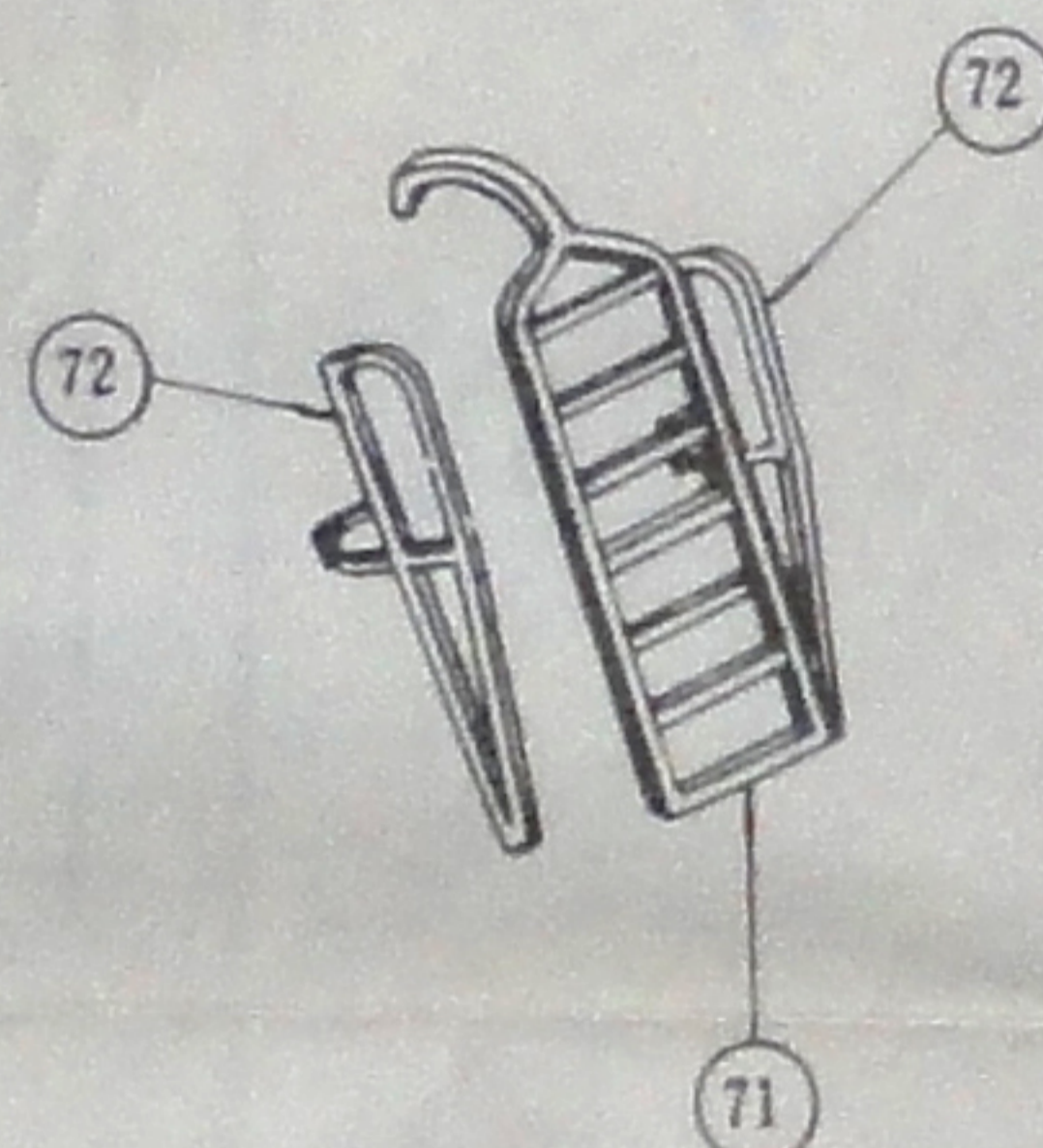

— Step No. 10 —

Assemble ladder in the following manner:
1. Cement side rails (No. 72) to ladder (No. 71).
2. Bend top of ladder into a hook over hot nail.

9

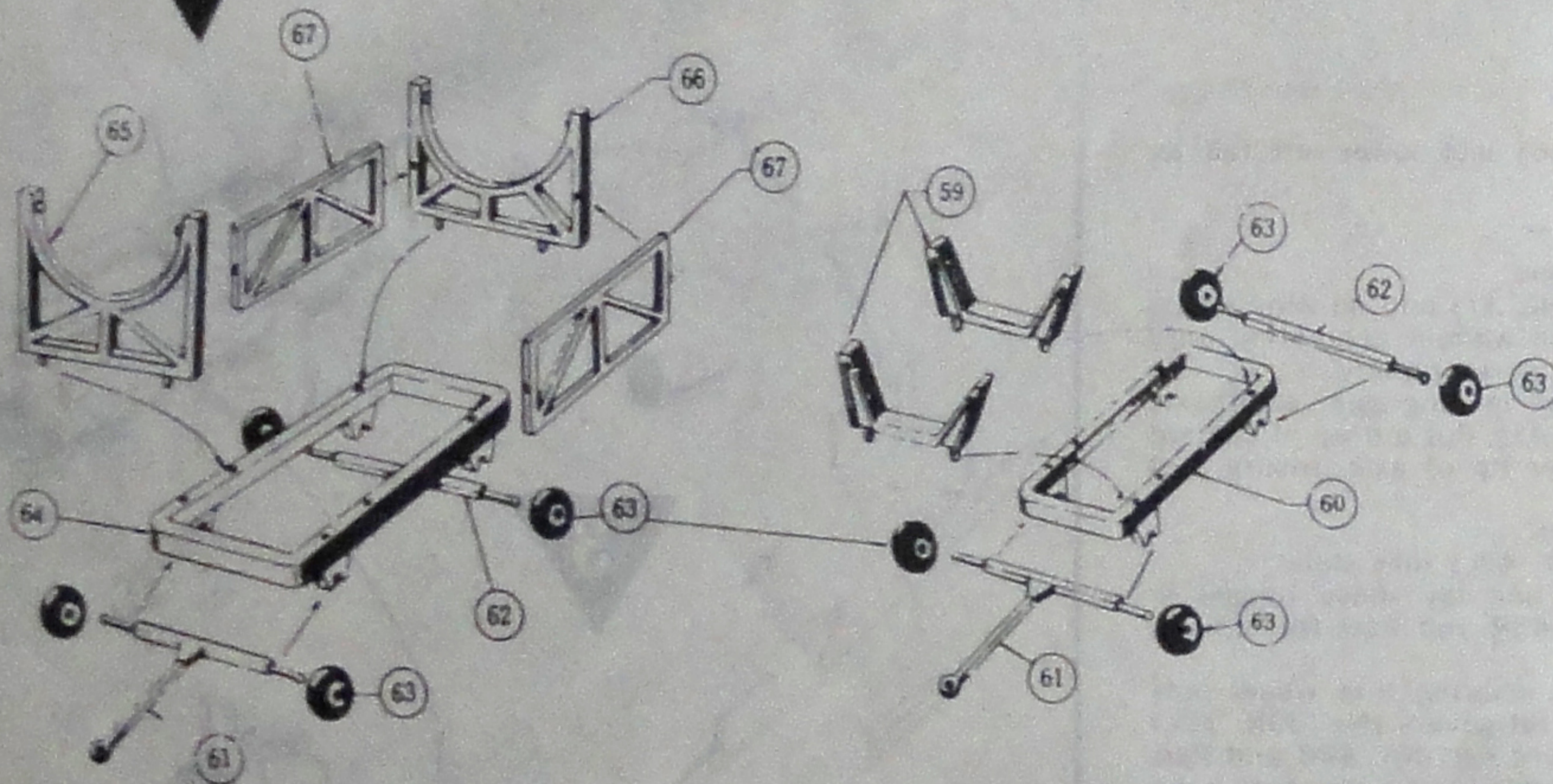

— Step No. 9 —

Assemble engine service trailers in the following manner:
1. Assemble these two carts as illustrated.

11

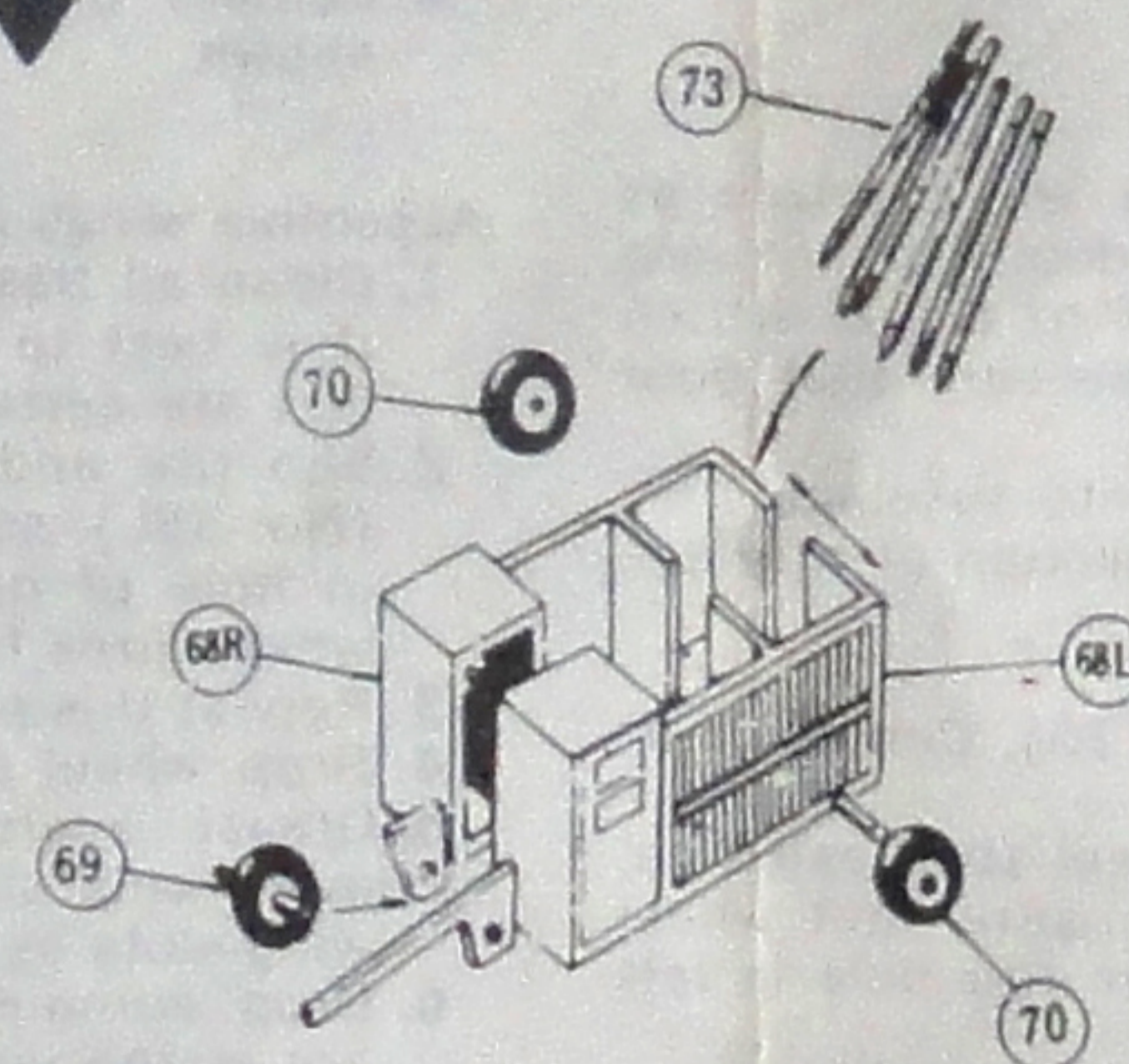

— Step No. 11 —

Assemble armament service cart in the following manner:
1. Assemble this cart as illustrated taking care that axle on front wheel (No. 69) turns freely in axle holes. Expand axle tips on rear axles with a hot nail.

12

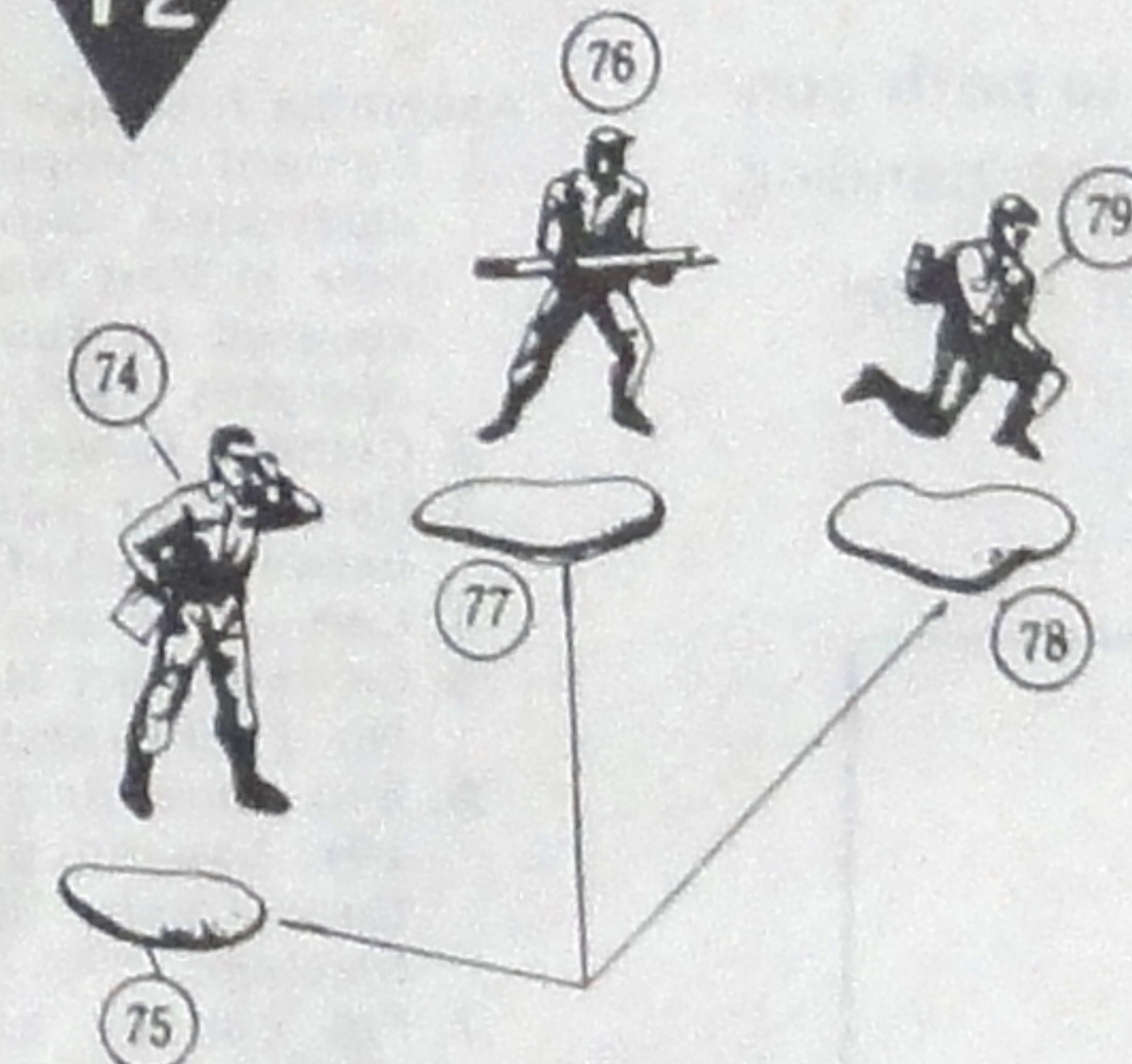

— Step No. 12

Cement personnel to appropriate bases as illustrated.

8

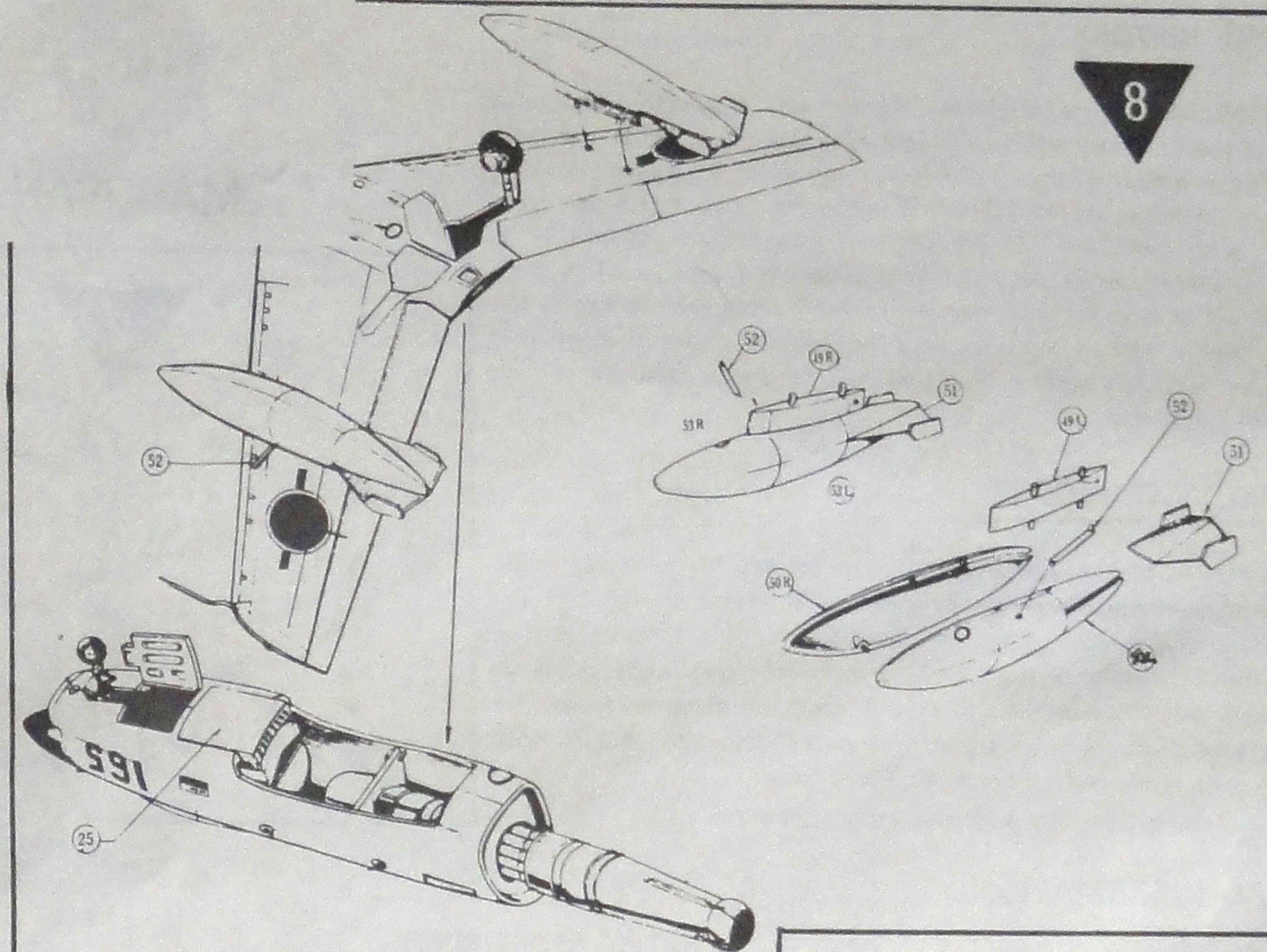

— Step No. 8 —

Assemble auxiliary fuel tanks taking care not to mis-match the right and left.

1. Cement these tanks into lower wings at appropriate holes.
2. Rocket launching assembly is then cemented to center section of wing immediately forward of landing gear doors. Take care that this assembly is mounted with bow on Part No. 26 forward.
3. Cement wing to fuselage taking care that excess cement does not ooze from joint.
4. Slip engine into fuselage as illustrated. Do not cement.
5. Push tail assembly onto rear of fuselage. This is a friction fit; do not cement.

