

**4448 Canadair CL-13 Sabre Mk.4
1/48 Airbrakes**

for Airfix kit

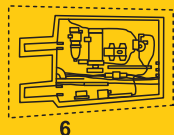
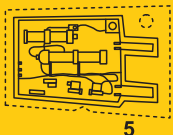
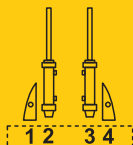

PUR - Polyurethane parts

PE - Photo-etched parts

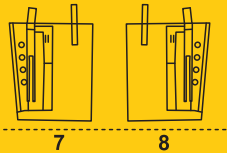
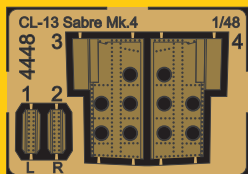

© Special Hobby 2022

Díly ohnuté popř. pokroucené vlivem teplotních změn a stárnutí materiálu, mohou být narovnaný do požadovaného tvaru pomocí proudu teplé vody nebo vzduchu (fén na vlasy). K lepení použít kyanoakrylátové lepidlo! Kontaktní plochy doporučujeme před lepením odmastit. Různé drátky a tyčinky nejsou přiloženy.

Parts slightly distorted and bent owing to temperature changes or due to material ageing can be straightened to requested shape by hot water or hot air jet (hair dryer). This process can be repeated till result is entirely satisfactory. For best result use cyanoacrylate glue! Contact areas ungrease is recommended before gluing. Wires and rods not included.

Visit our official website and e-shop at
www.cmkkits.com

www.specialhobby.eu

www.facebook.com/specialhobby/



OTHER 1/48 SETS / OSTATNÍ SETY 1/48



CMK H1010

The Razor Saw with Handle (cat. n. H1010)
is a great tool for cutting both plastic and resin.
CMK also offers a wide variety
of coarse / medium / fine saws.

Special Hobby, Mezilesí 718, Praha 9, 193 00, Czech Republic
e-mail: office@specialhobby.eu

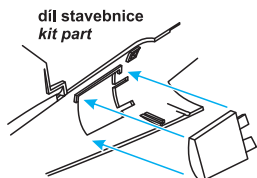

PUR6

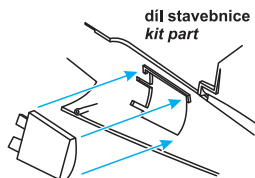

PUR5

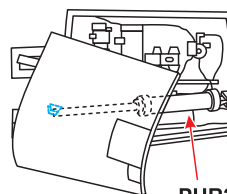

PUR2

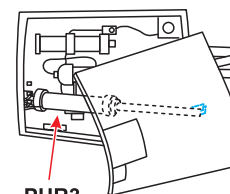

PUR3

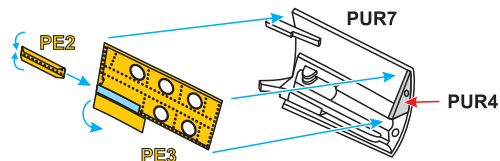

PE3

PUR4

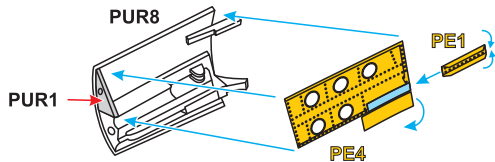

PUR1

PE4

Special Hobby

offers for 1/48 CL-13 Sabre (Airfix kit)

4446 Canadair CL-13 Sabre Mk.4 Undercarriage Bays

4447 Canadair CL-13 Sabre Mk.4 Gun Bays

4448 Canadair CL-13 Sabre Mk.4 Airbrakes sets as well

**4445 Canadair CL-13 Sabre Mk.4
1/48 Cockpit**

for Airfix kit

PUR - Polyurethane parts



Film

PE - Photo-etched parts

