

MODEL RECTIFIER CORPORATION
200 CARTER DRIVE
EDISON, NEW JERSEY 08817
©1995 Model Rectifier Corporation

UH-1C "Huey" Heavy Hog

1/35 Scale Model

"Realism in the right scale"

KIT #BA107



MRC'S 1/35th SCALE HELICOPTER SERIES

The quality of any military model is best measured by the intensity of the reality it creates; the finer the finish and more infinite the detail, the more convincing that model becomes. 1/35th scale dioramas have long provided the perfect stage for military modeling's best efforts, but the total lack of aircraft kits in this scale posed a serious problem to military helicopter enthusiasts.

At MRC, we responded to demand and created a series of topical and historical 1/35th scale military helicopter kits, each one with precisely detailed cockpit instrumentation, surface riveting and recessed panel lines, and featuring opening panels and access doors to expose the engines, ammo bays and armament.

With the arrival of this new MRC Series, there is finally a selection of precision helicopter kits to compliment the most popular scale for modeling armor, military figures and dioramas. MRC's scale model UH-1C "Huey" Heavy Hog is a museum quality kit; it brings you the highest levels of detail and the tightest fitting, flash-free parts available - *and it's in 1/35th scale!*

BELL'S UH-1C "HUEY" HEAVY HOG

The UH-1C "Huey" Heavy Hog represents the third generation of Bell's Iroquois series. Although it followed the D, E and F variants into production, the machine is directly descended from the UH-1B. "Charley" was often mistaken for the UH-1B, but closer scrutiny would reveal the UH-1C's larger fin and elevators, the new 540 "door hinge" rotor hub, and its wider chord rotor blades.

Of all Bell's UH-1C machines, the Heavy Hog was the most heavily armed. It carried an M-5 40 mm grenade launcher on its nose and the M3 Rocket System. Each of the two M3 rocket pods carried twenty-four 2.75 inch rockets and the M-5 grenade launcher held over 300 antipersonnel grenades. Used extensively as escort for "slicks," unarmed transport helicopters, the Heavy Hog was able to provide especially effective cover and offensive firepower during unloading and recovery operations.

The UH-1C "Huey" Heavy Hog saw its combat tour through to the close of the Vietnam Conflict, deadly to the enemy and essential to U.S. forces in its capacity as a most formidable gunship.

MORE ON THE "HUEY"

Bell's UH-1 series got underway in 1955, when the U.S. Army contracted the company to produce three XH-40 prototype helicopters, the first of which flew on October 22, 1956. Six more test machines followed the successful three and nine additional XH-40 machines followed the six. Ultimately, the refined XH-40 was redesignated as HU-1A Iroquois, and by Bell as the 204.

The HU-1A differed from the XH-40 prototypes in its longer fuselage, more effective placement of its twin synchronized elevators and its improved rotor head. The first HU-1As entered service in 1959 and by 1960, the helicopter's official designation had been changed to UH-1A.

The machine's nickname stuck from the first. Derived from its original HU designation, the Iroquois soon became known almost exclusively by the more familiar "Huey." The nickname eventually received the company's blessing when the UH-1's directional control pedal toolings were altered to produce the words "BELL" on the left pedal and "HUEY" on the right.

The UH-1B followed the A model in 1960, initially powered by the T53-L-5 Lycoming engine. More powerful (1,100 shaft horsepower) L-9 and L-11 engines powered later production UH-1Bs. Maximum speed at sea level at gross weight (8,500 pounds) was 95 knots, but this increased to 120 knots at less than 6,600 pounds.

THE UH-1C "HUEY" HEAVY HOG, CHAMPION OF THE VIETNAM CONFLICT

The development program for the AH-1 Cobra was already underway, but a new gunship, improved over the UH-1B, was needed in the interim. The resultant UH-1C variant had a gross weight of 9,500 pounds, which allowed for a useful load of 4,673 pounds, a marked improvement over that of the A and B machines.

The new UH-1C gunship came into service during 1965. "Charley" was similar to the B machine in every way, but featured redundant hydraulic systems, the new 540 "door hinge" rotor, and wider chord rotor blades and vertical fin. Additionally, most UH-1Cs on duty in Vietnam employed a roof-mounted dust filtering system.

From June of 1965, a total of 766 Bell UH-1C "Huey" helicopters were produced.

MRC's 1/35th SCALE UH-1C "HUEY" HEAVY HOG KIT

This is the finest, most highly detailed Heavy Hog kit available - in any scale and at any price. It is not a beginner's project, but even modelers with limited experience are not likely to encounter problems if directions are followed. We, at MRC, know you will enjoy building your UH-1C. With its every rivet and panel line, and every hatch and access panel meticulously duplicated in its correct location, the UH-1C "Huey" Heavy Hog is a deadly accurate kit. What's more, we put it where you needed it most, in 1/35th scale.

WARNINGS!

- Work only in well lit, adequately ventilated areas when using paints and/or glues.



- Most paints are highly flammable. Never paint near an open flame or pilot lights.



- Use extreme caution and care when working with hobby knives and other tools. When cutting or trimming parts, always cut "away from yourself."



- Do not use paint thinner to clean paint from your skin; thinner can be absorbed into your skin. Instead, clean your skin with a safe abrasive-type soap or pine based cleaner.

- Be careful not to remove small mounting tabs or pins when separating parts from plastic trees.

- Do not snap or twist parts from trees. Snip the part away with a diagonal cutter, then trim any rough edges with a sharp hobby knife.

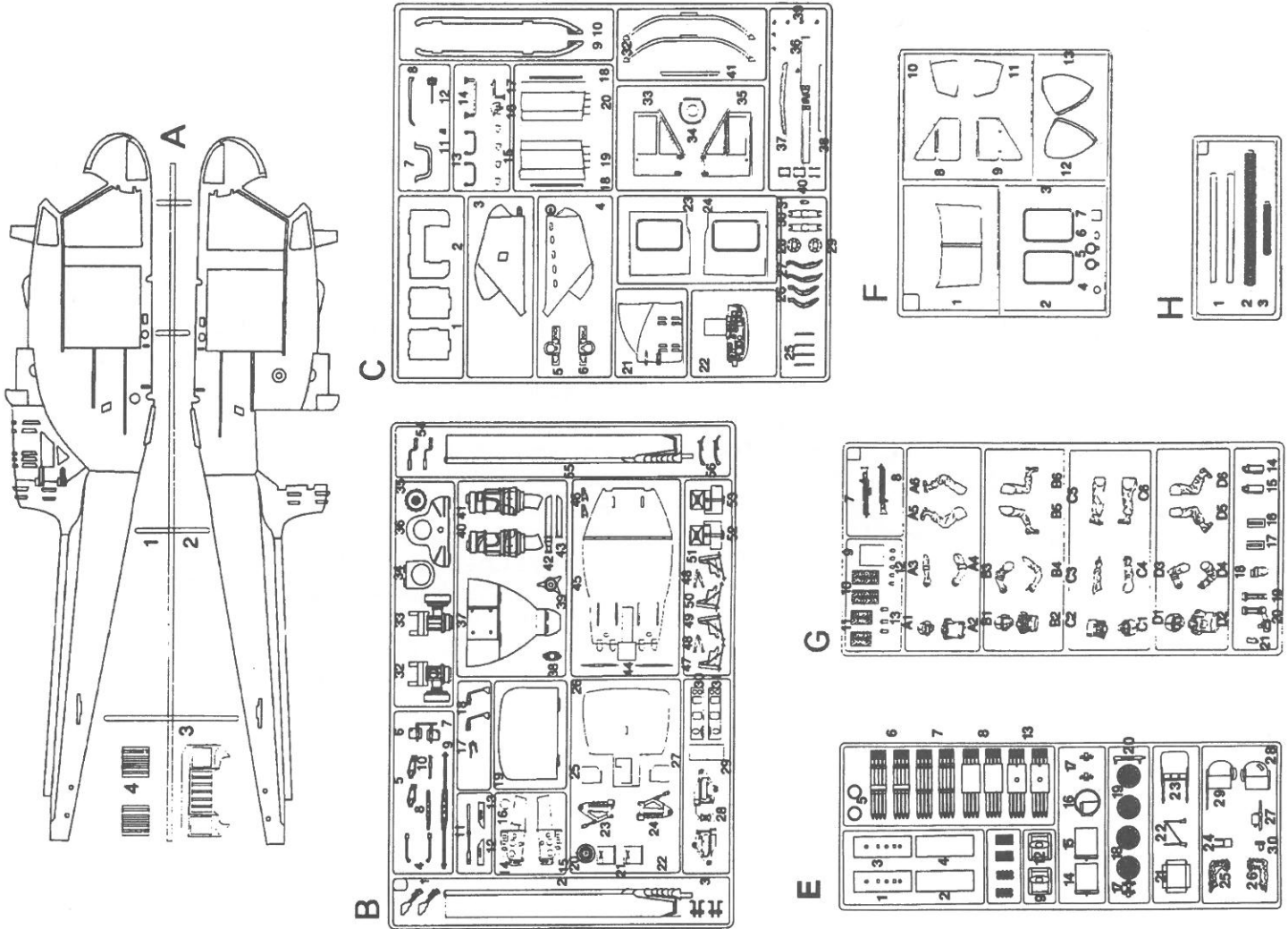

NOTE: Parts C-5, C-6, C-28, C-29, E-1, E-2, E-3, E-4, E-5, E-17 (4 pcs.), E-18, E-19, G-18, F-6 & H-1 (2 pcs.) are not required.

FINISHING SUPPLIES:

- Clean, protected work surface with adequate lighting
- Hobby Knife and #11 Blades
- Diagonal Cutter - to cut parts from parts trees
- Tweezers - to handle small parts
- Masking Tape and Rubber Bands - to hold parts while drying
- Plastic Model Cement (Testor, etc.)
- Liquid Plastic Model Cement (Micro-Weld, Testor, etc.)
- Fast Drying, Two-Part Epoxy (Devcon, Hobby epoxy 4, etc.)
- Medium Cyano-Acrylate Adhesive (Pacer Zap-A-Gap, etc.)
- White Glue (Elmer's, Titebond, etc.)

Painting Supplies:

- | | |
|---|---------------------------------|
| • Olive Drab FS 34087 | • International Orange FS 12197 |
| • Flat Red FS 11136 | • Flat Yellow FS 13538 |
| • Flat Light Gull Gray FS 36231 | • Flat Black FS 37038 |
| • Flat White FS 37875 | • Gun Metal (Steel) |
| • Zinc Chromate Green (Interior Green) FS 34151 | • Gloss White |
| • Flat Medium Brown | • Red |
| • Green | • Brass |
| • Silver | • Clear Green |
| • Clear Red | • Black India Ink |
| • Leather | • Brush Cleaner |
| • Assorted Paint Brushes | |

BEFORE YOU BEGIN:

In order to get the best results from your new UH-1C "Huey" Heavy Hog kit, we urge you to read all the Pro-Tips, Cautions, Notes and Warnings contained in this assembly manual. This UH-1C's kit design and detailed instructions are intended to make assembly easy and enjoyable, however, a degree of modeling experience is always helpful to a project such as this. You can learn more about plastic modeling by asking a friend with modeling experience, by reading modeling books and magazines available through local hobby shops, or by visiting with a local modeling club. If you have questions or suggestions specifically concerning MRC's UH-1C "Huey" Heavy Hog kit, please call our Customer Service Number, (908) 248-0730.

IF YOU HAVE A QUESTION OR PROBLEM:

Please contact Model Rectifier Corporation, 200 Carter Drive, Edison, New Jersey 08817. If you prefer, you may call us at (908) 248-0730 weekdays from 9:00 a.m. to 5:00 p.m. Eastern Standard Time.

1 CABIN DECK

Holes marked "B" on Cockpit Floor B-45 must be cut through from the underside. Use a drill, or twist gently with the tip of a hobby knife.

After drilling to start, the two bigger "A" openings at the sides of B-45 should be enlarged and cut square with the hobby knife.

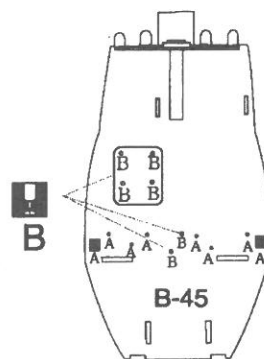

2 CABIN APPOINTMENTS

Before Painting, Cement Parts in the Following Order:

Cabin Bulkhead B-19 to Cockpit Floor B-45.
Electrical Compartment Side Walls C-1 (2 pieces) to B-45.
Electrical Compartment Rear Bulkhead to B-45 & C-2.
Front Floor Bulkheads B-12 and B-13 to B-45.
Pedestal Support Assemblies B-14 and B-15 to B-45.
Rotary Drum Right Side E-14 to Left Side E-15.
Rotary Drum Top E-16 to Sides E-14 & E-15.

Paint After Assembly:

B-45, B-14, B-15, B-12, B-13, B-19, C-1, C-2: *Flat Gull Gray*
E-14, E-15 & E-16: *Olive Drab*

Then, Paint the Following Parts Before Continuing:

Fire Extinguishers G-14 & G-15: *Refer to Step 16*
Pilot Seat Cushions B-21: *Red*
Pilot Seat Backs B-52 & 53: *Flat Gull Gray, Red Cushions*
Pilot Seat Sides B-47, 49, 50 & 51: *Flat Gull Gray*
Seat Belt Detail on Cushions: *Flat White with Silver Buckles*
Pilot Seat Armor Plates B-25 & B-27: *Flat Brown*
Gunner's Chair Seat E-21: *Flat Gull Gray, Red Cushion*
Gunner's Chair Back E-23: *Flat Gull Gray, Red Cushion*
Gunner's Chair Support E-22: *Flat Gull Gray*
Tail Rotor Pedals B-3: *Flat Black*
Collective Sticks B-1: *Flat Gull Gray, Flat Brown Grips & Boots*
Cyclic Sticks B-54: *Flat Gull Gray, Flat Brown Hand Grips*
Instrument Panel C-22 and Instrument Pedestal Top B-29: *Flat Gull Gray, with Flat Black Instrument Faces & Gloss White Characters. Top of C-22 is Flat Black*

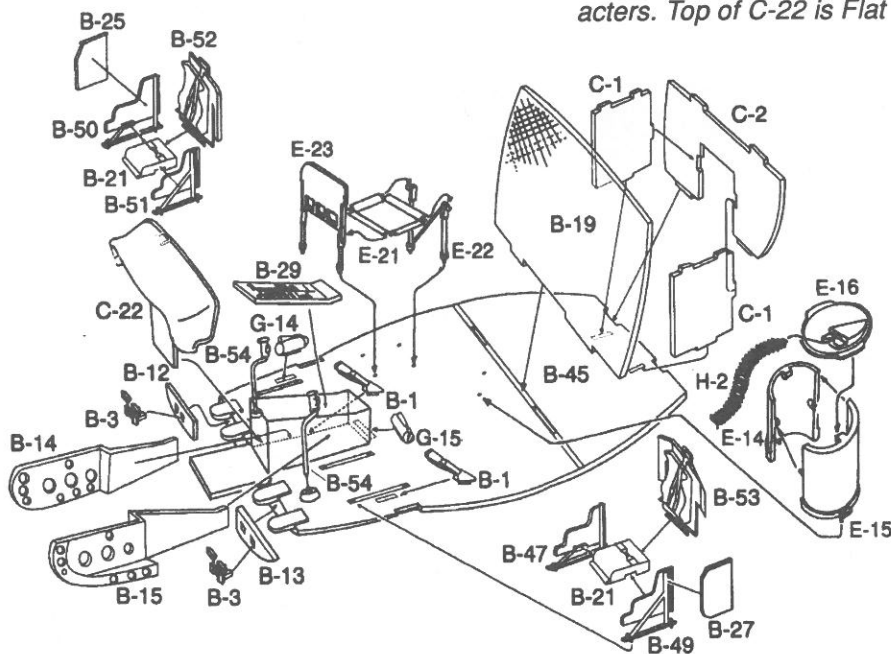

PRO-TIP: Bare metal showing through worn or weathered paint can be simulated with Silver Rub 'n' Buff.

After Completing the Above Painting and Assembly Steps, Cement Parts in the Following Order:

Sides of Right Pilot Seat B-50 and B-51 to Cushion B-21.
Right Pilot Seat Back B-52 to Left Seat Assembly.
Right Pilot Seat Armor Plate B-25 to Left Seat Assembly.
Repeat for Left Seat using B-parts 47, 49, 21, 53 & 27.
Collective Sticks B-1 (2 pcs.) to B-45.
Cyclic Sticks B-54 (2 pcs.) to B-45.
Front Floor Bulkheads (2 pcs.) B-13 to B-45.
Tail Rotor Pedals B-3 (2 pcs.) to B-45.

Pedestal Support Assemblies B-14 & 15 to B-45.
Instrument Pedestal Top B-29 to B-45.
Left and Right Seat Assemblies to B-45.
Instrument Panel C-22 to B-45.
Completed Gunner's Chair to B-45.
Completed Rotary Drum to B-45.
Ammo Chute H-2 to Rotary Drum Top E-16.

3 COMPLETING THE CABIN

Paint Before Assembly:

Roof Pillar Supports B-30 & 31: *Flay Gull Gray*
 Underside of Cabin Roof B-26: *Flat Gull Gray*
 Engine/Trans Compartment Floor B-37: *Zinc Chromate*
 Holes in Ammunition Belts H-1 & H-3 (2 pcs.): *Brass*
 First Aid Kits C-40 (3 pcs.): *Olive Drab*

After Painting, Cement Parts in the Following Order:

Two First Aid Kits C-40 to recess in B-30.
 One First Aid Kit C-40 to recess in B-31.
 Roof Pillar Supports B-30 & B-31 to notches in B-45.
 Cabin Roof B-26 to B-19, B-30 & B-31 (See Detail Drawing).
 Engine/Trans Compartment Floor B-37 to B-19, C-1 & C-2.

NOTE: Ammo Chute H-2 drops freely to floor and runs along left side of Cockpit Center Console.

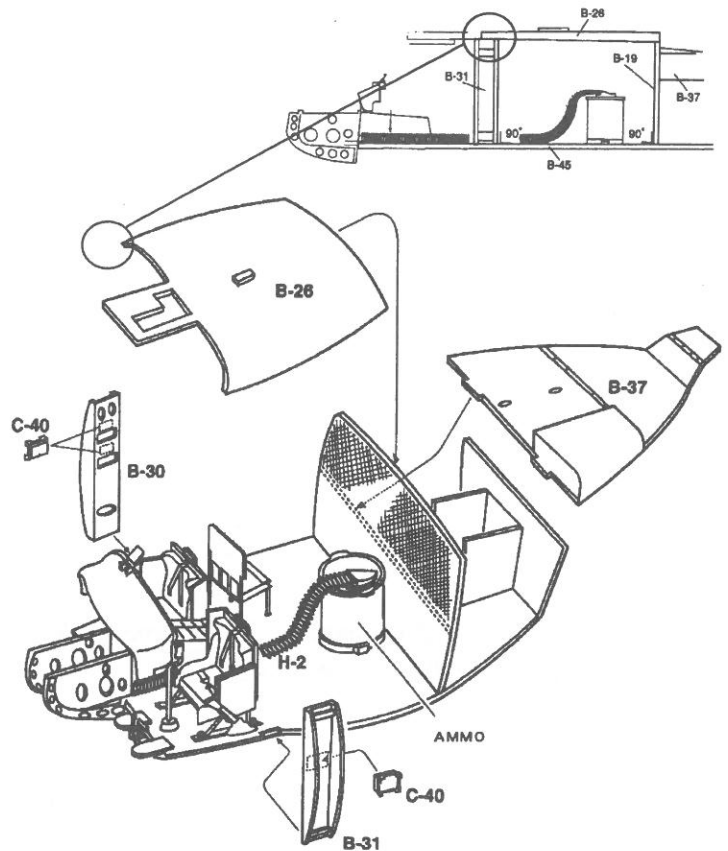

4 ENGINE AND TRANSMISSION ASSEMBLY

Before Painting, Cement Parts in the following Order:

Left and Right Transmission Assembly Halves B-32 to B-33.
 Left and Right Engine Halves B-40 to B-41.
 Left and Right Tail Rotor Driveshaft Halves B-42 to B-43

Paint After Assembly:

Transmission, Engine & Tail Rotor Shaft Assemblies: *Silver*
 Engine Compartment Firewalls B-34 & B-36: *Zinc Chromate*

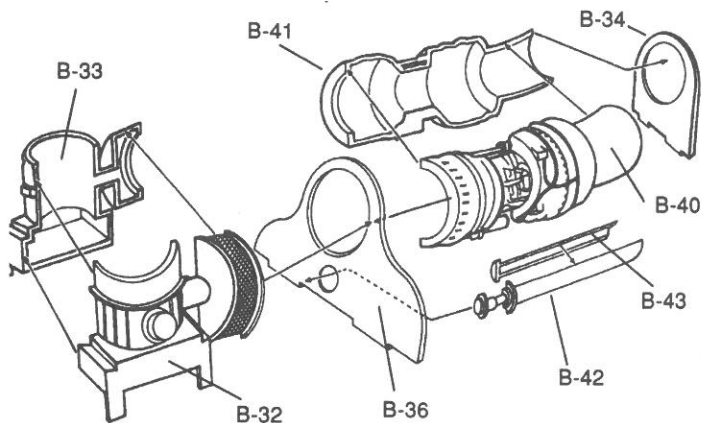

After Painting, Assemble Parts in the Following Order:

Completed Transmission to B-36.
 Completed Engine to B-36.
 Completed Tail Rotor Driveshaft to Engine & B-36.
 B-34 to Engine.

PRO-TIP: Reduce (thin) india ink with rubbing alcohol and brush the mix lightly over the engine and transmission. This "wash" technique will enhance many of the engine's engraved details.

5 MAIN ROTOR MAST ASSEMBLY

Before Painting, Cement Parts in the Following Order:

Stabilizer Damper Bars B-18 (2 pcs.) to Main Rotor Mast B-11.
 Collective Pitch Control Tube B-6 to Collective Control Lever B-7.
 Scissors Assembly B-38 to B-11. Align notch and tab.
 Swash Plate B-20 to B-38. Align notch and tab.
 Completed B-6/B-7 to Swash Plate Control Horn B-39. Align.
 Transmission Top B-35 to B-6/B-7. Align notch and tab.
 *Retainer Cap B-16 to tip of B-11 (**NOTE:** if you want your Main Rotor Assembly removable, do not install Retainer Cap B-16).
 Swash Plate Drive Links (2 pcs.) B-46 to B-38 and B-20.
 Cyclic Control Tubes B-4 to B-39.
 Elevator Control Bellcrank B-17 to B-39.
 Elevator control Tube B-10 to B-17.

HELI-FACT: The gross weight of the UH-1C was up from that of the B model, but the improved 540 rotor and wider blades gave Charley the decided advantages of reduced vibration and drag, and the superior top end speed of 140 knots.

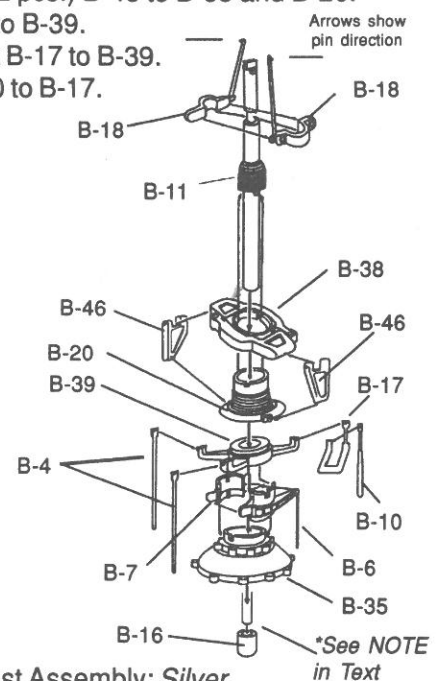

Paint After Assembly:

Completed Main Rotor Mast Assembly: *Silver*

*See NOTE in Text

Cement Parts in the Following Order:

Engine/Transmission Assembly to B-37.

Main Rotor Mast Assembly to Transmission Assembly.

Mark VIII Gun Sighting Station part E-24 to part E-30.

Lens F-7 to Mk. VIII Gun Sighting Station.

Reflex Sighting Station part G-19 to Sighting Station part G20.

Sighting Station Grip G-21 to Sighting Station Assembly.

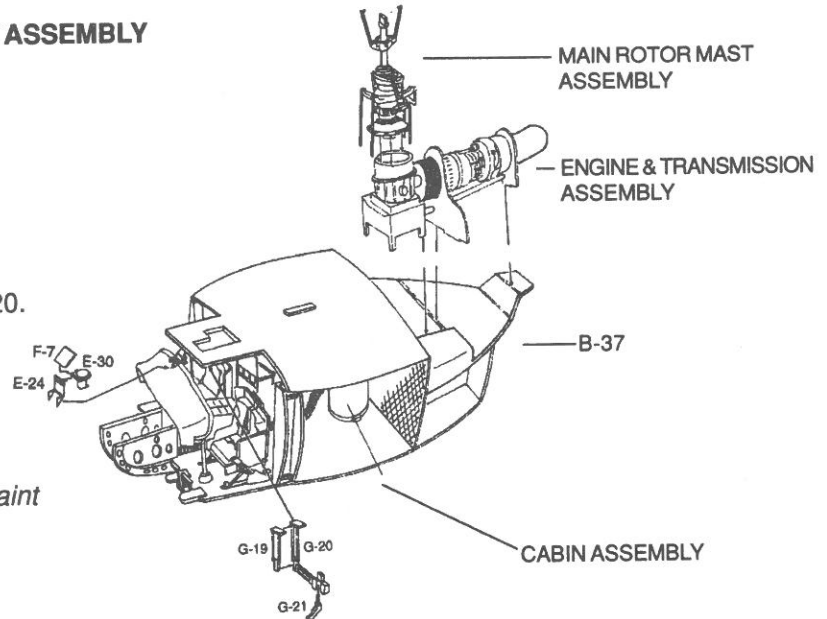
Paint After Assembly:Completed Reflex Sighting Station: *Flat Black*Mark VIII Gun Sighting Station: *Flat Black (NOTE: Do not paint Lens F-7. Lens remains clear)*

(NOTE: Mk. VIII Gun Sighting Station and Reflex Sighting Station are installed in STEP 8)

PRO-TIP: Before joining the fuselage halves, use a medium Cyano-Acrylate (CA) adhesive like Pacer's **Zap-A-Gap** to secure approximately one ounce of solder, ball bearings or old nuts and bolts under the forward floor area of the Right Fuselage Half A-1. This added balance weight allows the completed model to rest correctly on its landing skids.

Paint Before Assembly:Insides of Fuselage Halves A-1 & A-2: *Olive Drab*Elevators C-19 & C20: Upper surfaces: *International Orange*;Undersurface & tips: *Olive Drab***Cement Parts in the Following Order:**

Right Synchronized Elevator C-19 to Right Fuselage Half A-1.

Left Synchronized Elevator C-20 to Left Fuselage Half A-2.

Completed Cabin Assembly inside of Right Fuselage Half A-1.

Left Fuselage Half A-2 to Right Fuselage Half A-1.

Right Tail Fin Half C-3 to Left Tail Fin Half C-4.

Completed Tail Fin to Fuselage.

Roof Wind Fence C-37 to Fuselage (Shown in STEP 11).

Belly Wind Fences C-38 & C-41 to Fuselage (Shown in STEP 9).

IMPORTANT: If you plan to paint your UH-1C's Fuselage, do so now. Spraying is the preferred method and we suggest using an airbrush or high quality hobby spray can for application. Before painting, protect the Engine, Cockpit, Rotor Mast and other previously painted details from over spray or brushing error, then paint the following parts *Olive Drab*: Fuselage Halves, Tail Fin & Synchronized Elevators, Cabin Doors C-23 & C-24, Pilot Doors C-35 & C-33, Door Handles C-39 (6 pcs.), Tail "Stinger" C-8, VHF Omni Antenna C-13 (2 pcs.), FM Whip Antenna Mount C-31, Engine Compartment Service Door C-21, Air Intake Filter Housing A-3 & Air Intake Filters A-4.

Cut away fuselage area under Filter Housing A-3, leaving 1/8" gluing lip for Air Intake Filter Housing.

NOTE: If you choose to install the Air Intake Filter Housing and Filters, portions of the Engine Casing behind the Rotor Mast will have to be cut away as shown.

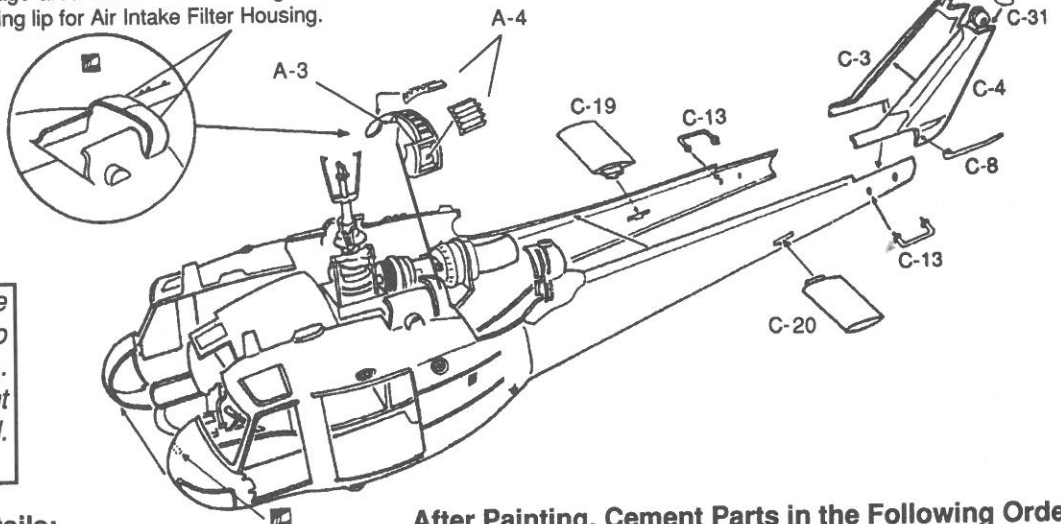

PRO-TIP: Use a thin piece of wire or stretched sprue, 2.9" long, to create an FM Whip Antenna. Mount it to the FM Antenna Mount C-31, extending straight upward. Paint Flat Black.

Then, Paint the Following Details:Anti-Glare Nose Panel: *Flat Black* (see Page 11)Insides of Pilot Doors C-33 & C-35: *Flat Gull Gray*Insides of Cabin Doors C-23 & C-24: *Flat Gull Gray*Inside of Engine Compartment Door C-21: *Zinc Chromate***After Painting, Cement Parts in the Following Order:**

VHF Omni Antenna C-13 (2 pcs.) to A-1 & A-2.

Tail "Stinger" C-8 to Tail Fin.

FM Whip Antenna Mount C-31 to Tail Fin.

Air Intake Filters A-4 (2 pcs.) to Air Intake Filter Housing A-3.

8

GUN SIGHTS & CABIN GLASS

Cement Parts in the Following Order:

- Mk. VIII Gun Sighting Station to top of Instrument Panel C-22.
- Flexible Reflex Sighting Station to roof of A-2.
- Door Handles C-39 (2 pcs.) to C-23 & C-24.

Use White Glue to Attach Glass:

- Left Greenhouse Window F-10 to A-2.
- Right Greenhouse Window F-11 to A-1.
- Right Chin Bubble F-12 to A-1.
- Left Chin Bubble F-13 to A-2.
- Left Cabin Door Window F-2 to C-23.
- Right Cabin Door Window F-3 to C-24.
- Windshield F-1 to Fuselage.

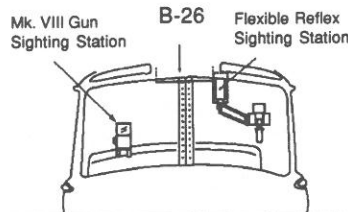
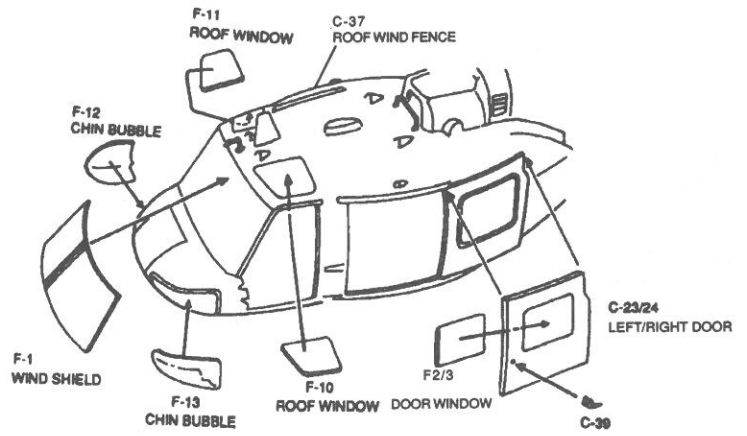

(NOTE: Cabin Doors C-23 & C-24 are not glued to Fuselage until STEP 14)

9

FUSELAGE BELLY & LANDING SKIDS

Paint Before Assembly:

- Skids C-32 (2 pcs.) and Skid Tubes C-9 & C-10: *Olive Drab*
- IFF Antenna C-11 and Hell Hole C-34: *Olive Drab*
- Cargo Hook C-16: *Silver*

Cement Parts in the Following Order:

- Head & Search Lights F-5 to Fuselage. **(NOTE: To install Search Light, hole must be cut at marked location on fuselage belly.)**
- Cargo Hook C-16 to Hell Hole C-34 to Fuselage.
- Right & Left Skid Tubes C-9 & C-10 to Cross Tubes C-32.
- Landing Skid Assembly to Fuselage.
- IFF Antenna C-11 to Fuselage.

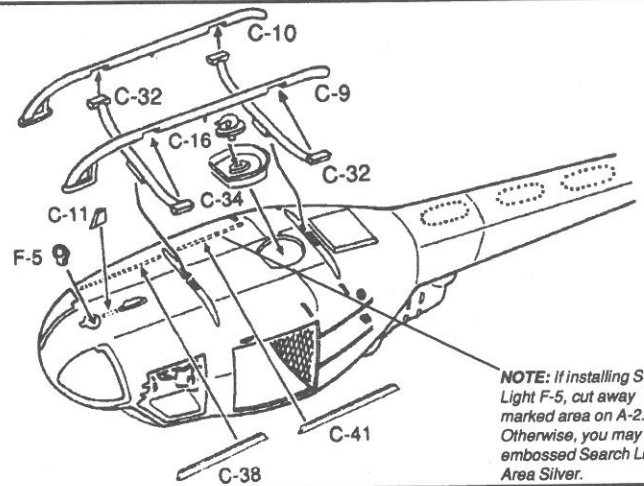

NOTE: If installing Search Light F-5, cut away marked area on A-2. Otherwise, you may paint embossed Search Light Area Silver.

10

MAIN ROTOR ASSEMBLY

Cement Parts in the Following Order:

- Lower Hub Halves B-23 & B-24 to "Door Hinge" Rotor Hub B-28.
- "Y" Mixing Levers B-48 (2 pcs.) to Stabilizer Bar B-9.
- Stabilizer Bar Half B-8 to B-9 and B-48.
- Completed Stabilizer Bar Assembly to B-28.
- Main Rotor Pitch Control Horns B-5 (2 pcs.) to B-28.

Then, Paint:

- Completed Main Rotor Hub Assembly: *Silver*
- Main Rotor Blades B-1 & B-55: *Olive Drab on the upper surfaces with Flat Black undersurfaces and the tips of the blades with a 3/16" Flat Yellow band.*

Then, Cement Parts in the Following Order:

- Main Rotor Blades B-1 & B-55 to Main Rotor Hub Assembly

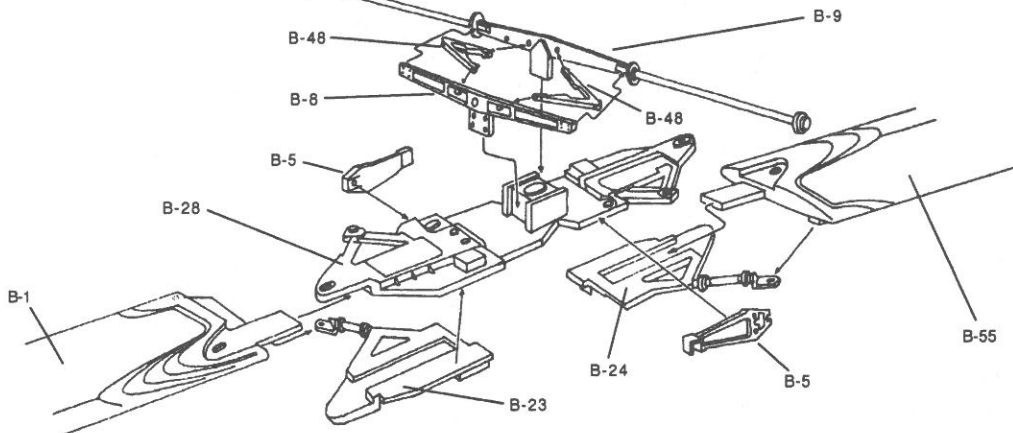

HELI-FACT: The UH-1C's "Door Hinge" Main Rotor Hub caused the Huey's Main Rotor Blades to droop noticeably when at rest. The correct droop has been authentically duplicated for you in MRC's UH-1C.

11 FUSELAGE DETAILS

Paint Before Assembly:

Transmission Fairing C-7: *Olive Drab outside, Zinc Chromate Green inside*

FM Homing Antenna C-14: *Flat Black*

Roof Air Scoops C-15 (4 pcs.): *Olive Drab*

Pitot Tube C-17: *Olive Drab with Silver Tip*

Windshield Center Post F-1: *Olive Drab*

Windshield Wipers B-56: *Olive Drab with Flat Black Blades*

Engine Compartment Service Door: *Olive Drab*

Service Door Prop B-44: *Zinc Chromate Green*

Pilot Doors C-33 & C-35: *Olive Drab*

Tail Rotor Pitch Change Linkage C-12: *Silver*

Tail Rotor Assembly C-36: *Flat Gull Gray Hub, Flat Black Blades with Red, White & Red Stripes at the Tips*

Anti-Collision Light F-4: *Clear Red*

Right Navigation Lights (above & below Cabin Door on A-1): *Green*

Left Navigation Lights (above & below Cabin Door on A-2): *Red*

After Painting, Cement Parts in the Following Order:

Tail Rotor Pitch Linkage C-12 to Tail Rotor Assembly C-36.

Completed Tail Rotor Assembly to Tail Fin.

Transmission Fairing C-7 to Fuselage.

FM Homing Antenna C-14 to Fuselage.

Roof Air Scoops C-15 (4 pcs.) to Fuselage.

Pitot Tube C-17 to Fuselage.

Engine Compartment Service Door C-21 to Fuselage.

Service Door Prop B-44 to Fuselage & C-21 (see Note 1 below).

Windshield Wipers B-56 to Fuselage & F-1.

Left Pilot Door Window F-8 to C-35.

Right Pilot Door Window F-9 to C-33.

Door Handles C-39 (2 pcs. each side) to Pilot Doors.

Left and Right Pilot Doors to Fuselage. (**NOTE: Pilot Doors C-33 & C-35 are not hinged parts. They may be glued in either their open or closed positions**)

Anti-Collision Light F-4 to Fuselage.

Completed Main Rotor Assembly to Main Rotor Mast.

B-18 (2 parts) insert pins into holes in B-8 & B-9 from outside

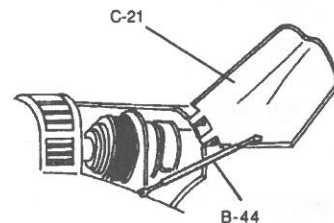
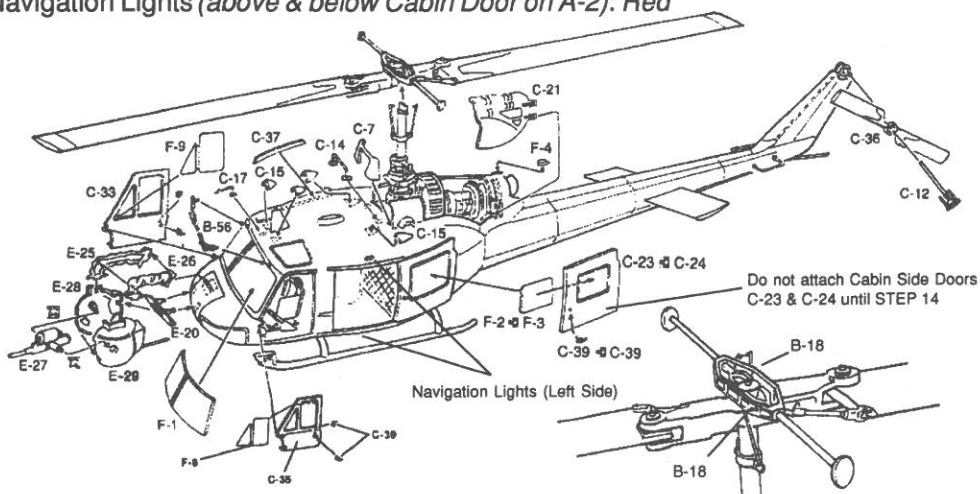

(**NOTE: Door C-21 is not a hinged part. It may be glued in either its open or closed position**)

12 CREW FIGURES

Cement Parts as Shown:

A" Parts are for Pilot (right side)

B" Parts and Ammo Belt H-3 are for Door Gunner

C" Parts are for Crew Chief

D" Parts are for Copilot (left side)

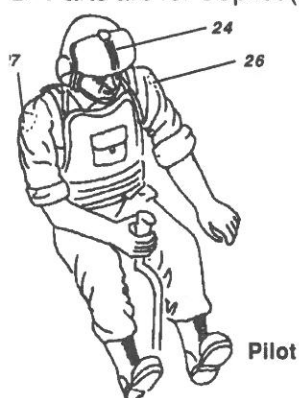

Pilot

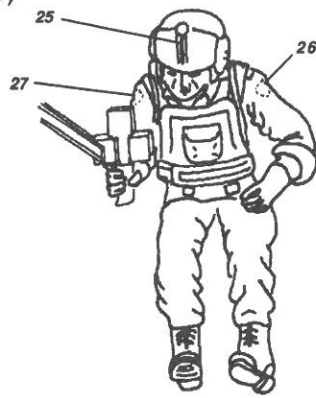

Copilot



Crew Chief

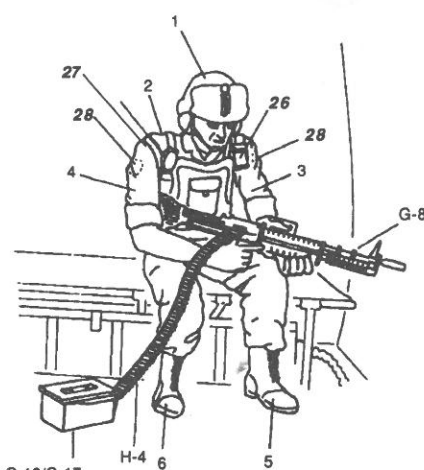

Door Gunner

Paint After Assembly:

Faces, Hands, etc.: *Flesh*

Uniforms & Helmets: *Olive Drab*

Armor Vests (called "Chicken Plates"): *Olive Drab*

Boots: *Gloss Black*

M-60 Machine Guns: *Gun Metal with Black Stocks & Grips*

Decal Placement (Refer to numbers in **bold italics**):

22: U.S. Army Patch - Above right side pocket (see 23)

23: Name Tags - Above left side pocket if not wearing Vest

24: Captain's Bars - On lapel and helmet

25: Lieutenant's Bars - On helmet and lapel

26: Brigade Patch

27: Aviation Patch

28: Specialist 4th and 5th Grade Ranks

13

M-5 40MM GRENADE LAUNCHER

Cement Parts in the Following Order (refer also to assembly drawing in Step 11):

- 40 mm Grenade Launcher Barrel E-27 to Right Launcher Half E-28 (*Do Not Glue*).
- 40 mm Grenade Launcher Right Half E-28 to Left Half E-29 (*Do Not Glue E-27*).
- Grenade Launcher Support E-20 to Fuselage.
- Grenade Launcher Assembly E-28/E-29 to Support E-20.
- Vinyl Chute Cover Right Half E-25 to Left Half E-26.
- Vinyl Chute Cover E-25/E-26 to Launcher and Fuselage.

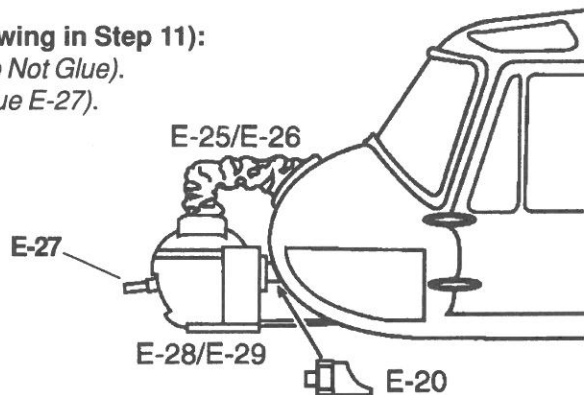

Paint After Assembly:

- Completed Grenade Launcher and Support: *Olive Drab*
- Grenade Launcher Barrel: *Silver*
- Vinyl Chute Cover: *Flat Black*

14

ROCKET LAUNCHER ASSEMBLIES

Cement Parts in the Following Order:

- Front Universal Mount Braces C-26L & C-26R to Universal Mounts C-30.
- Rear Universal Mount Braces C-27L & C-27R to C-30.
- Rocket Pod Mount E-12 to C-30 on Right Side.
- Rocket Pod Mount E-11 to C-30 on Left Side.
- Four Rocket Pod Sides E-8 to two Rocket Pod Bottoms E-6.
- Two Rocket Pod Rocket Pod Tops E-7 to Rocket Pods.
- Two Rocket Pod Rears E-9 to Rocket Pods.
- Two Rocket Pod Faces E-10 to Rocket Pods.
- Complete Rocket Pod Assemblies to E-11 and E-12.

NOTE: C-18L, C-18R and C-25 parts install in Step 15.

NOTE: C-18R, C-18L and C-25 parts install in Step 15.

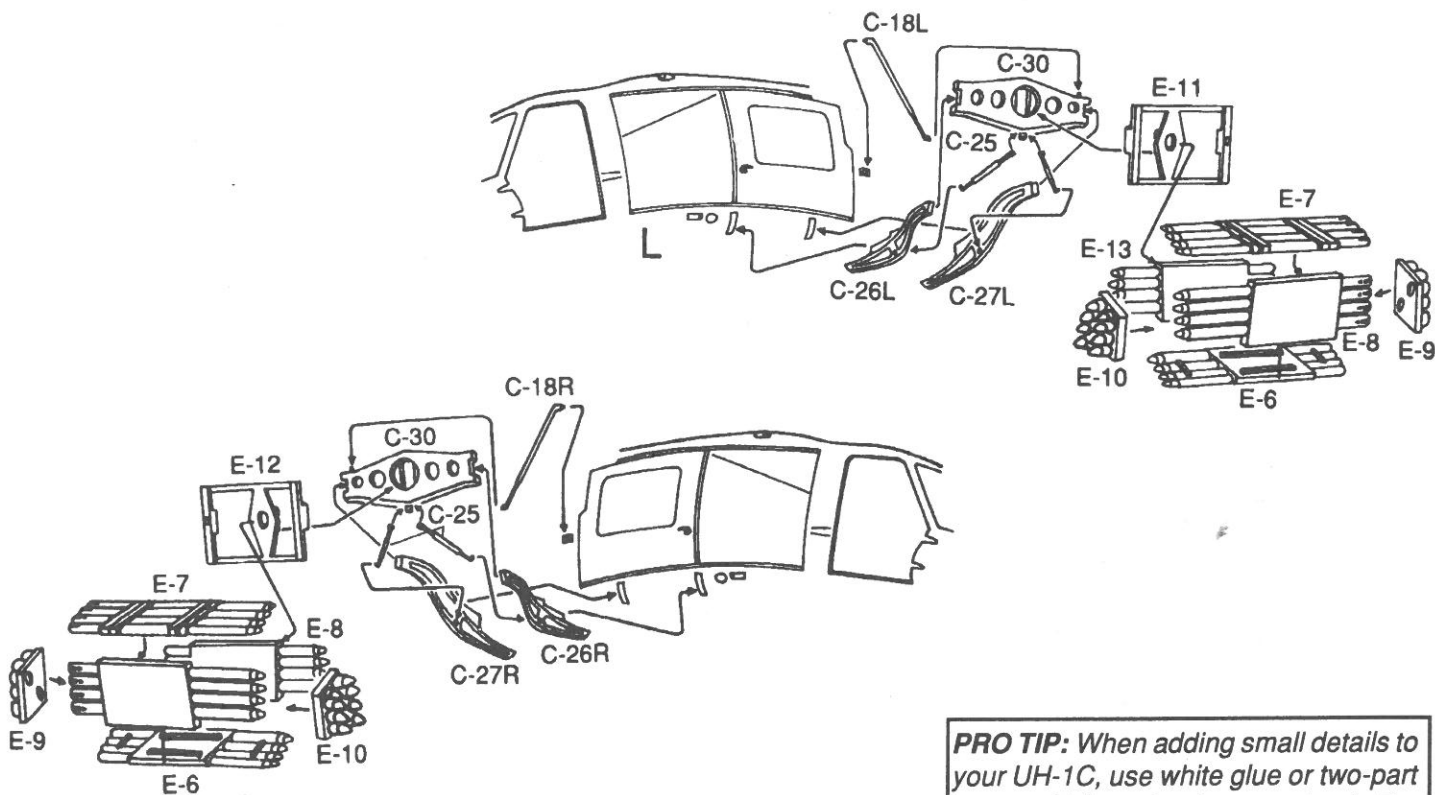

PRO TIP: When adding small details to your UH-1C, use white glue or two-part epoxy, which tend to dry more clearly. Before curing, excess white glue or epoxy can be carefully removed with a soft cloth wetted with rubbing alcohol.

Paint After Assembly:

- Completed Rocket Pod Assemblies: *Olive Drab*

Attach Decals 9, 11, 30 & 31.

Cement Parts in the Following Order:

Left and Right Rocket Pod Assemblies to Fuselage.

Universal Mount Support Rods C-25 (2 pcs. each side) to Universal Mounts C-30.

Front & Rear Mount Braces C-26L & C-26R and C-27L & C-27R.

Cabin Side Doors C-23 & C-24 to Fuselage (*Refer to PRO-TIP below*).

Universal Mount Support Braces C-18L & C-18R to Fuselage and C-30.

Paint After Assembly:

C-25 (4 pcs.): Olive Drab

C-18L & C-18R: Olive Drab

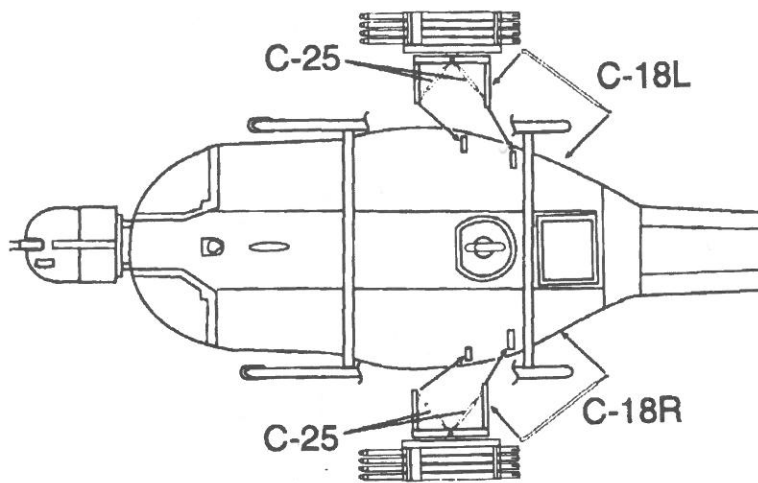
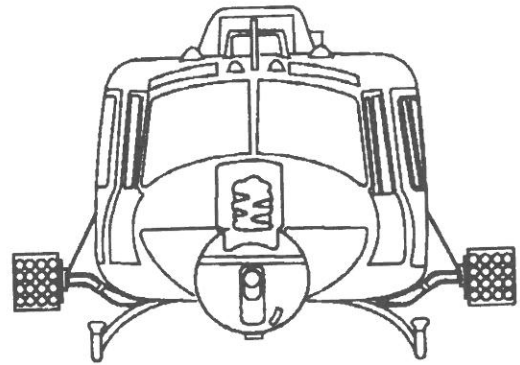

NOTE: Attach C-18L & C-18R to Small Pins.

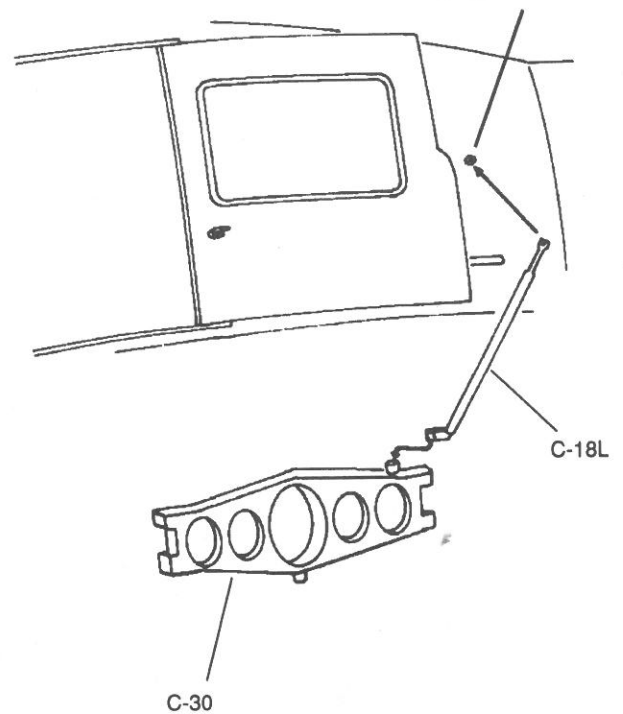

PRO-TIP: To allow best display of cabin interior detail, glue Cabin Side Doors C-23 & C-24 to fuselage in their open positions. Top and bottom edges of Cabin Side Doors should line up with top and bottom of door frames, and the rear edges of the door frames should be just visible through the Cabin Door Windows.

**BELL UH-1C HUEY HOG, COBRAS GUN PLATOON, 114TH AHC,
1ST AVIATION BRIGADE, VINH LONG, VIETNAM, 1967**

Numbers indicate decal positions

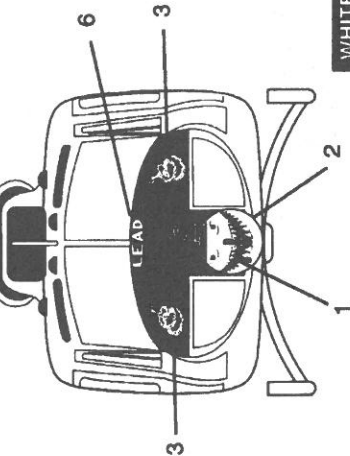
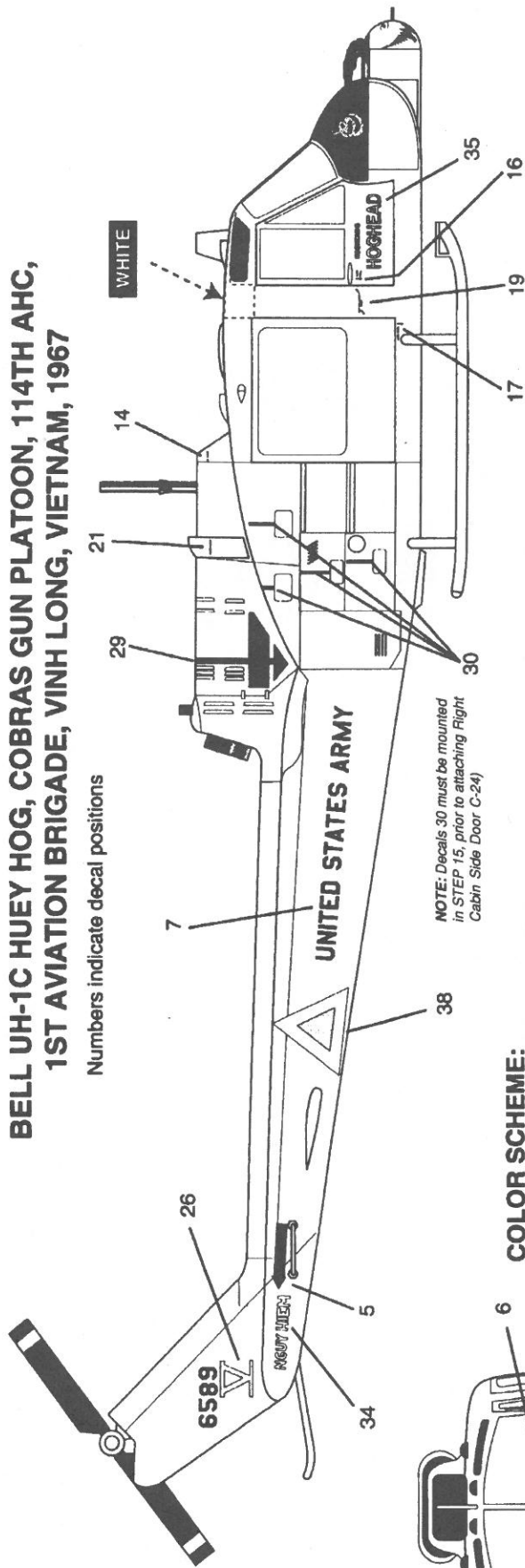

COLOR SCHEME:
 Overall olive drab FS34087.
 Roof over cockpit (indicated by dotted lines) white
 Flat black anti-glare nose panel, rotor blades.
 Tail rotor tips and root are (FS 11136) red-white-red.

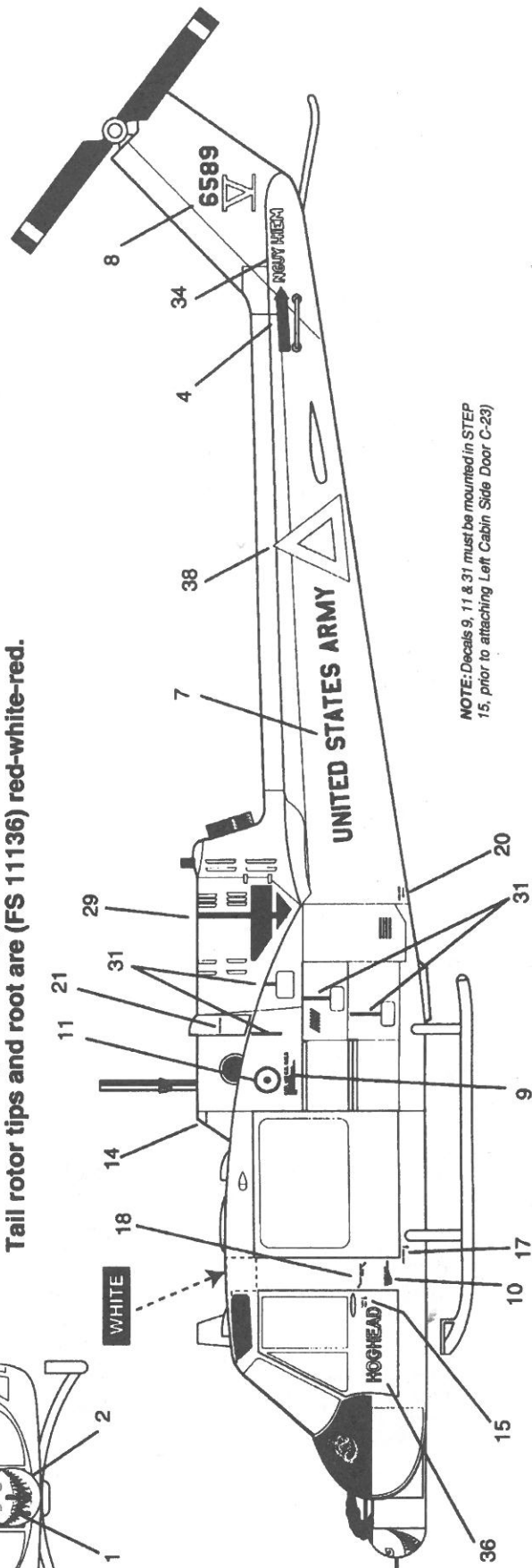

NOTE: Decals 9, 11 & 31 must be mounted in STEP 15, prior to attaching Left Cabin Side Door C-23

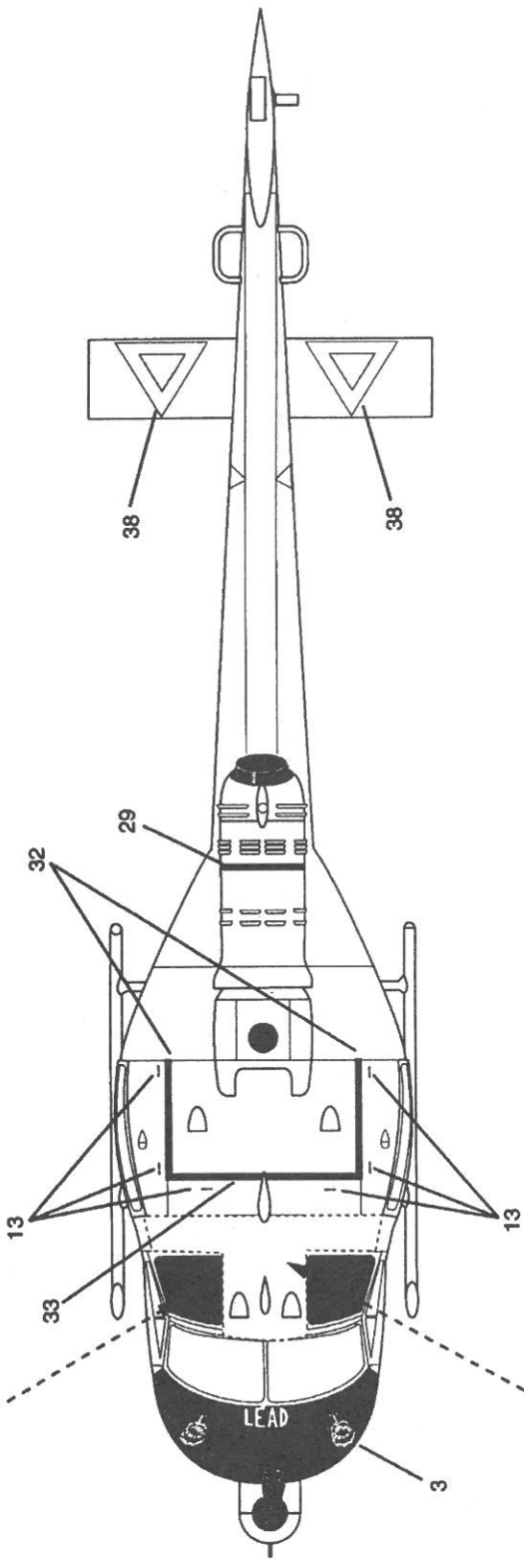

NOTE: Upper cockpit windows are tinted dark green.

Cockpit top is glossy white. Indicated by dotted lines.

TOP OF ROTOR

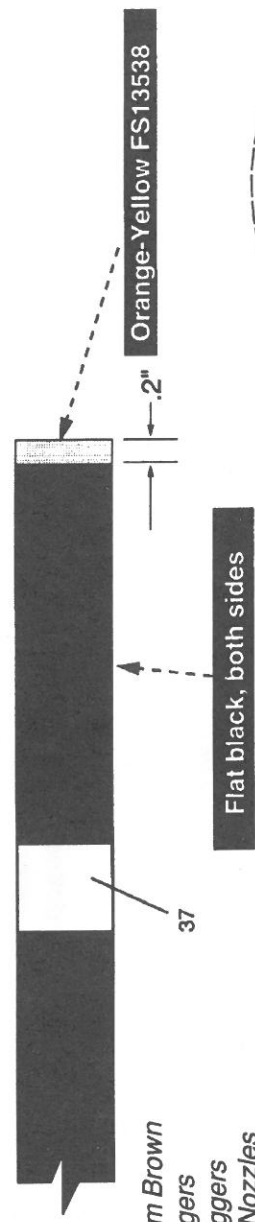

Paint Before Assembly:

- Wooden Box Parts G-9, G-10 & G-11: Flat Medium Brown
- Hand Grenades: G-12: Olive Drab with Silver Triggers
- Smoke Grenades G-13: Olive Drab with Silver Triggers
- Fire Extinguishers G-14 & G-15: Red with Black Nozzles
- Ammo Cans G-16 & G-17: Olive Drab

After Painting, Cement Parts in the Following Order:

- Wooden Box Sides G-10 to Wooden Box Bottom G-9.
- Wooden Box Ends G-11 to G-9 & G-10.
- Completed Wooden Box inside cabin, near Door Gunner.
- Hand & Smoke Grenades G-12 & G-13 inside Wooden Box.
- Ammo Cans G-16 & G-17 inside cabin, near Door Gunner.
- Fire Extinguishers G-14 & G-15 inside cabin, behind the Right Pilot's Seat and (optional) alongside the Left Pilot's Seat.

HELIFACT: Two Fire Extinguishers are provided in your kit. Although only one Fire Extinguisher was standard issue, UH-1C crews often carried a second unit.

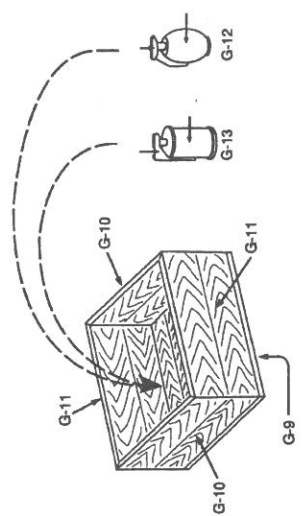

PRO-TIP: Krassal Micro-Sol (sold in better hobby shops) helps Decals conform to raised surface details like rivets and panel lines. Apply Decals in the normal manner, then, after the Decals have dried, brush a light coat of Micro-Sol over each Decal. Micro-Sol will soften the Decals and cause them to hug the surface of your UH-1C much more closely. Repeat this process, if necessary, then allow the Decals to dry thoroughly before handling.

MODEL RECTIFIER CORPORATION
200 CARTER DRIVE
EDISON, NJ 08817
Tel. (908) 248-0730

© 1995 Model Rectifier Corporation