

TWA 727-200

“Project Skinny”



The Boeing 727 was one of the most successful intermediate range airliners ever made. TWA operated 92 of the unique “T” tail tree engine airliners.

This aircraft #N64339 had the distinction of being one of several aircraft hijacked by Palestinian terrorists and damaged in the incident by bomb detonation while on the ground. The airplane was later repaired and returned to service. The aircraft continued in revenue service.

Later the N64339 was used to test fuel efficiency as “project skinny”. The test involved removing the standard TWA paint scheme and replacing it with a mostly bare metal surface with minimal Trans World markings and livery. While modestly more fuel efficient, the airplane was finally retired in 1991.

The Minicraft kit #14599 represents the airplane in its final “project skinny” configuration.

Minicraft Models, 1501 Commerce Drive, Elgin IL 60123 USA
www.minicraftmodels.com

Printed in China

PARTS LAYOUT DIAGRAM

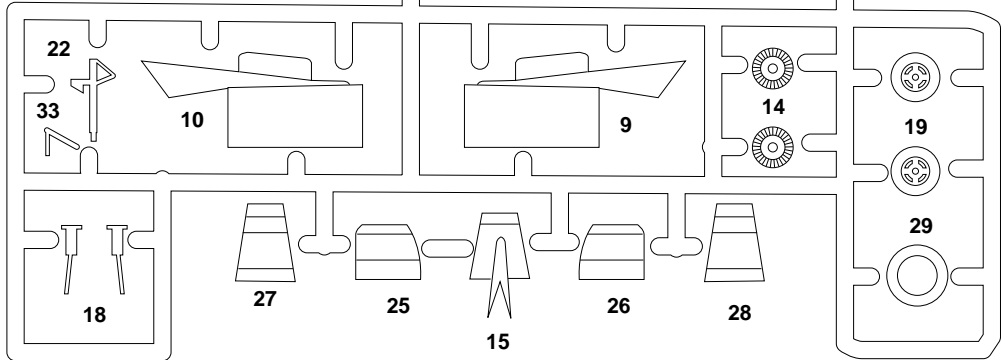
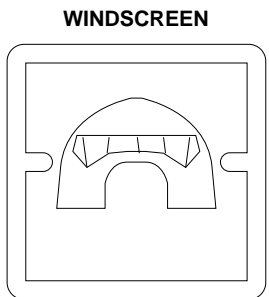
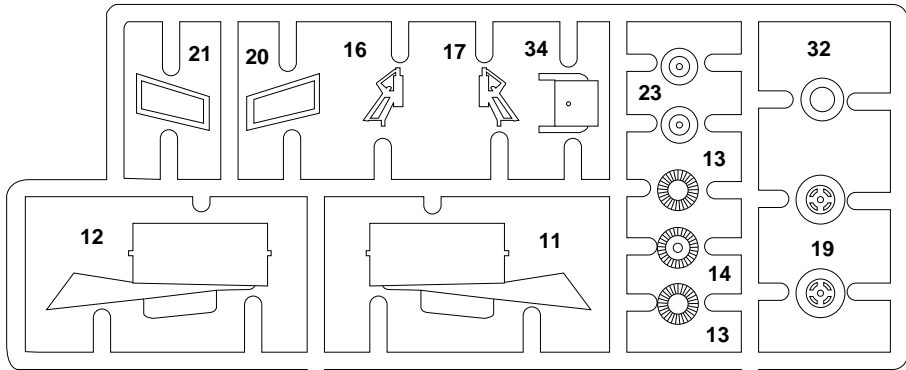
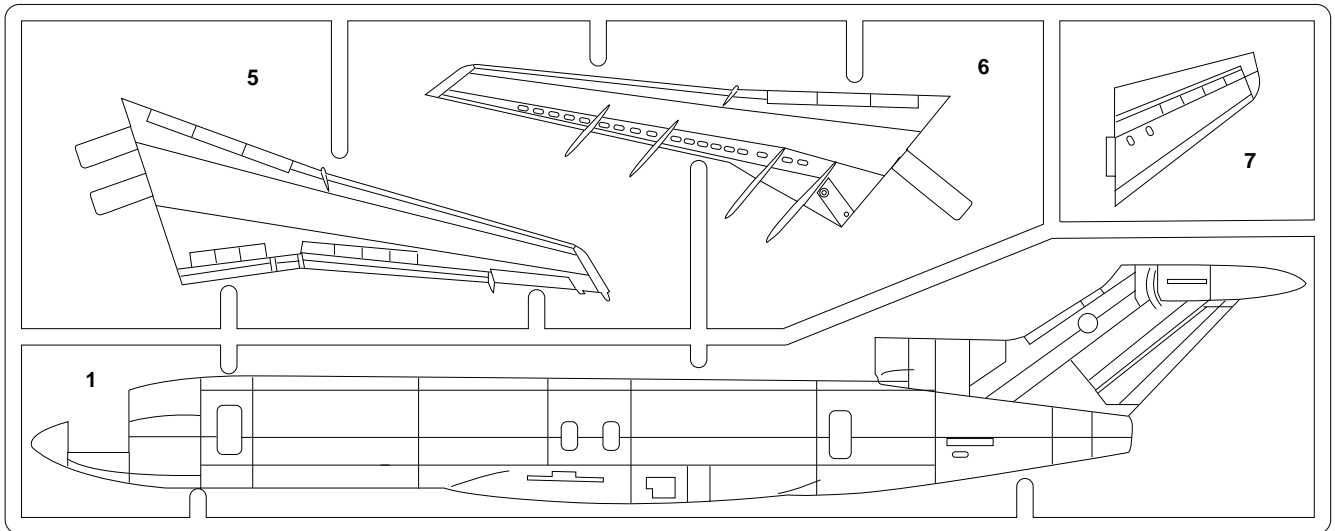
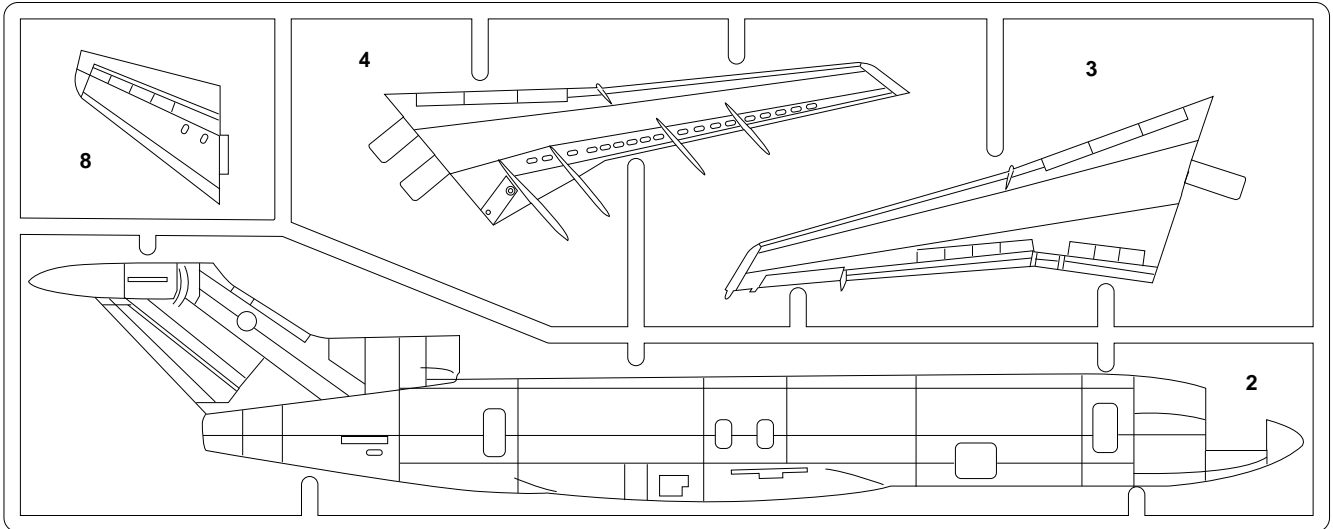



Cement
Coller
Kleben



DO NOT Cement
Ne pas Coller
Nicht Kleben



Cut away
Couper
Scheiden



Optional parts
Choix
Auswahlmöglichkeit

1 FUSELAGE ASSEMBLY

- 1 • Left (Port) Fuselage / fuselage gauche / linker rumpf
- 2 • Right (Starboard) Fuselage / fuselage droite / richtiger rumpf

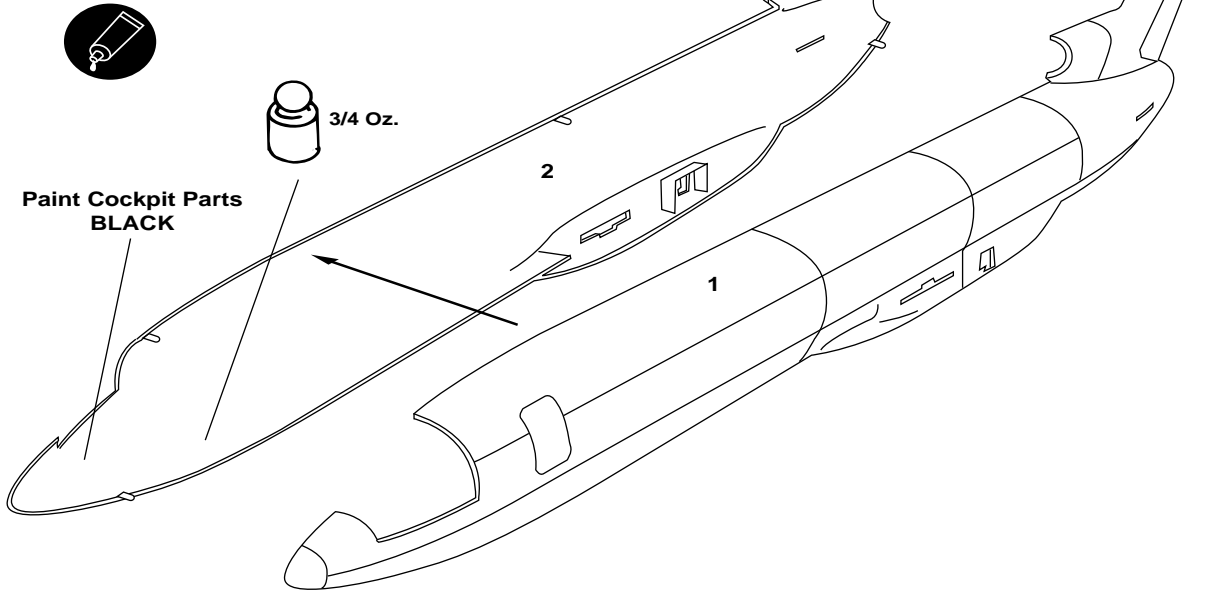

PLEASE NOTE
Wing parts are very delicate; please use care
when separating parts from the sprues to avoid damage

2 LEFT WING

- 3 • Left (Port) Upper Wing / superieur aile gauche / linker oberen flügel
- 4 • Left (Port) Lower Wing / bas aile gauche / linker läßt flugel

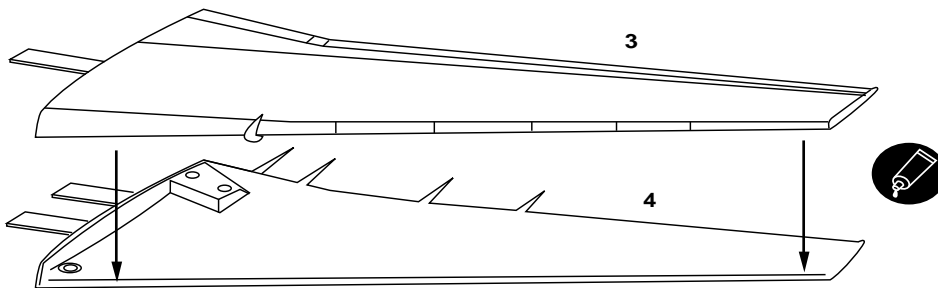

3 RIGHT WING

- 5 • Right (Starboard) Upper Wing / superieur aile droit / richter oberen flügel
- 6 • Right (Starboard) Lower Wing / bas aile droit / richter läßt flugel

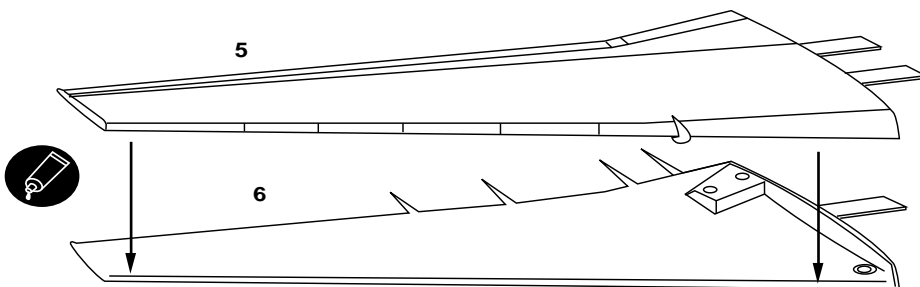

4 MAIN ASSEMBLY

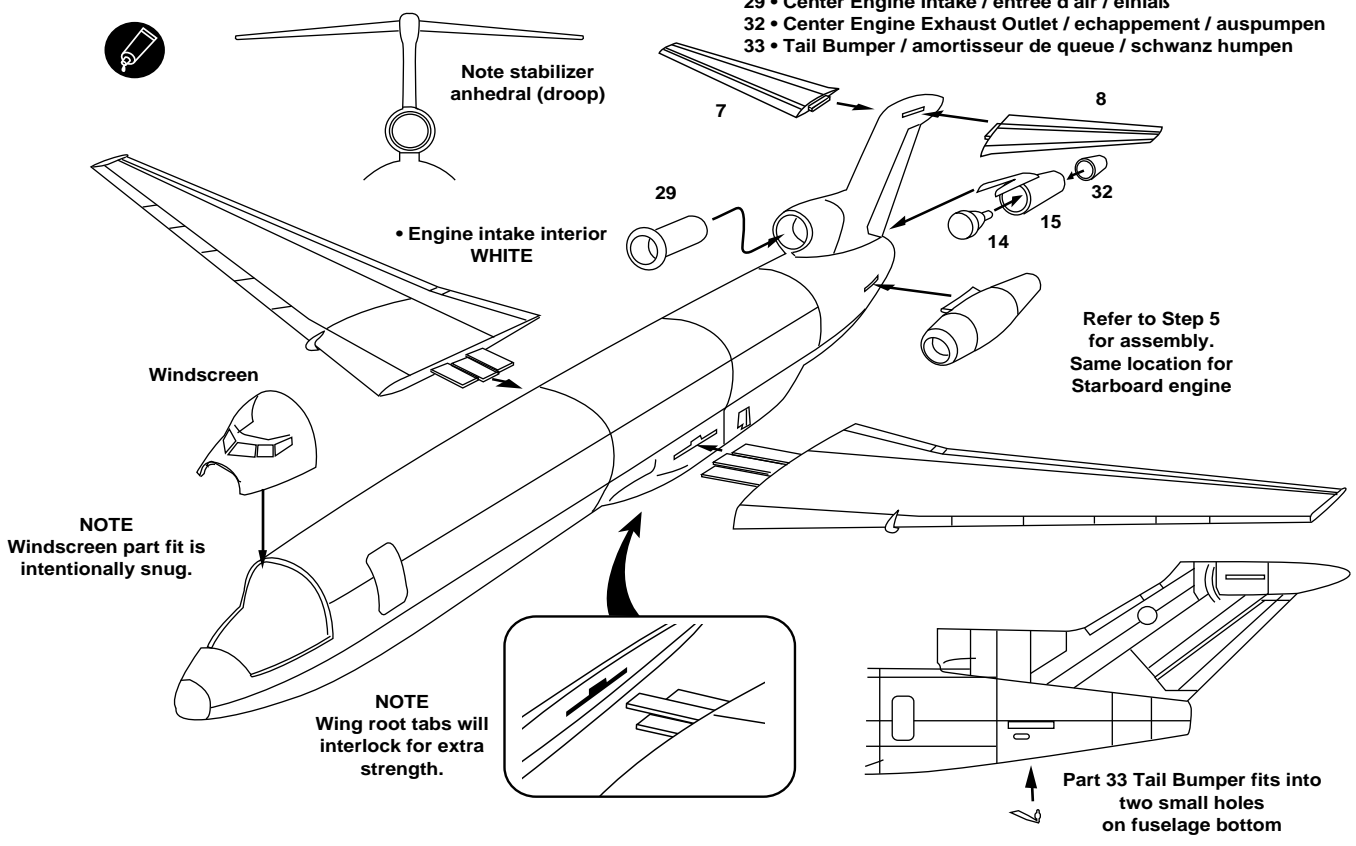

- 7 • Right Stabilizer / stabilisateur droit / rechter stabilisator
- 8 • Left Stabilizer / stabilisateur gauche / linker stabilisator
- 14 • Center Engine Turbine/Exhaust / echappement / auspumpen
- 15 • Center Engine Fuselage Fairing / carenage / fairing
- 29 • Center Engine Intake / entree d'air / einlaß
- 32 • Center Engine Exhaust Outlet / echappement / auspumpen
- 33 • Tail Bumper / amortisseur de queue / schwanz humpen

5 ENGINES

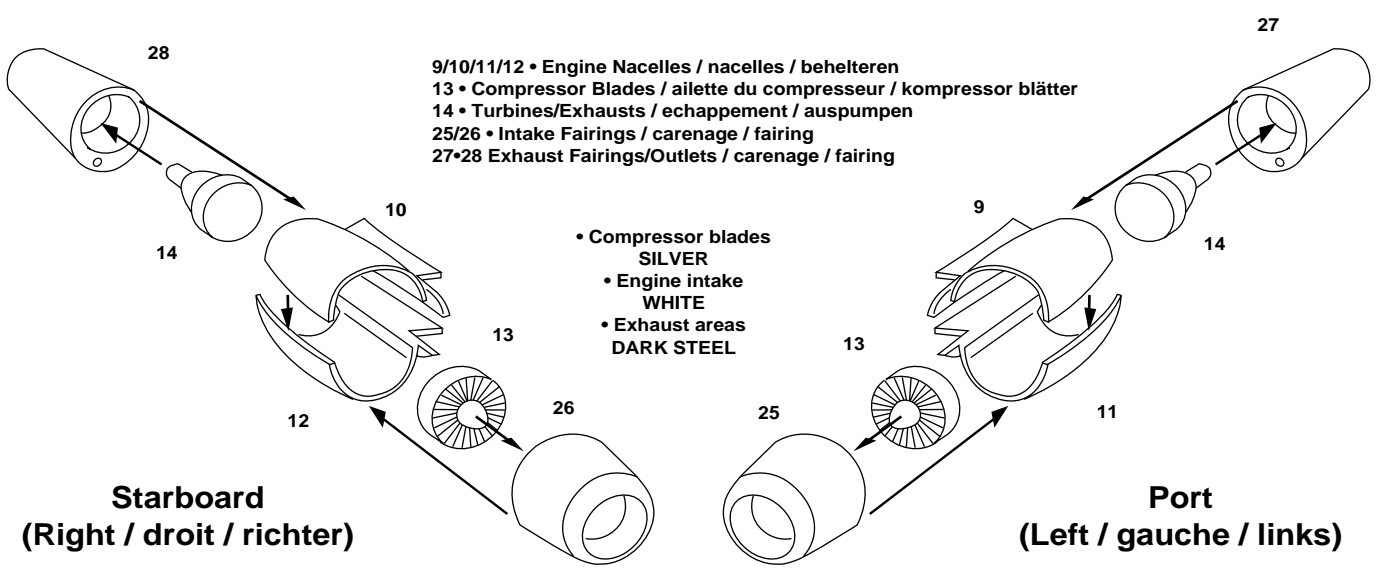

• Refer to Step 4 to locate engines to fuselage

• Note - For proper orientation of engines, Left and Right are as viewed from the rear of the aircraft.

6 LEFT MAIN LANDING GEAR

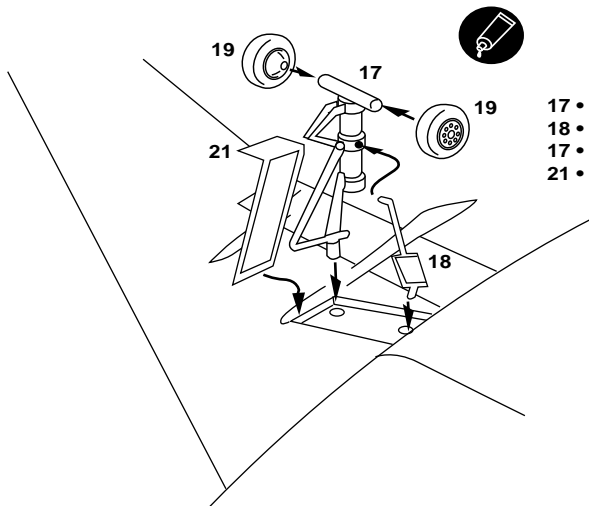

- 17 • Left (Port) Main Gear Strut / entretoise principal gauche / linker hauptlandung strut
- 18 • Retraction strut / biellette de retraction / retraction strut
- 19 • Mainwheel / roue principale / hauptrad
- 21 • Left (Port) Main Gear Door / trappe de train / linker gang türen

- Tires BLACK
- Hubs ALUMINUM
- Struts WHITE
- Gear Door Interiors and Gear Wells WHITE

7 RIGHT MAIN LANDING GEAR

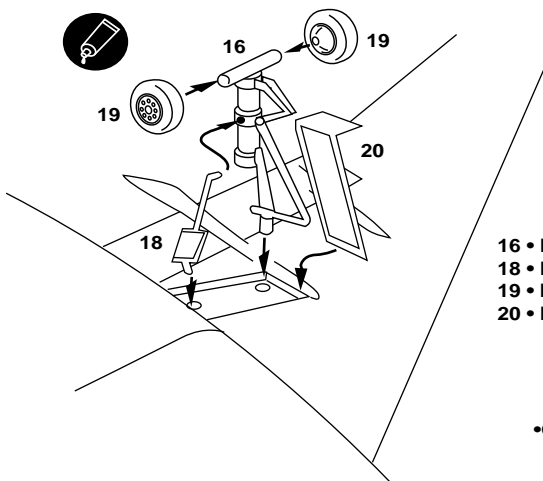

- 16 • Right (Starboard) Main Gear Strut / entretoise principal droit / richter hauptlandung strut
- 18 • Retraction strut / biellette de retraction / retraction strut
- 19 • Mainwheel / roue principale / hauptrad
- 20 • Right (Starboard) Main Gear Door / trappe de train / richter gang türen

- Tires BLACK
- Hubs ALUMINUM
- Struts WHITE
- Gear Door Interiors and Gear Wells WHITE

8 NOSE LANDING GEAR

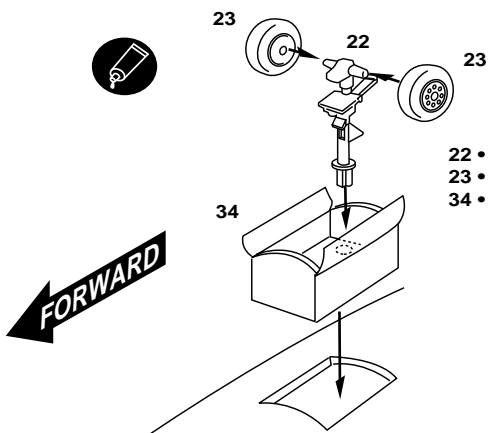

- 22 • Nose gear strut / train d'atterrissage avant / nase gang strut
- 23 • Nosewheel / roulette de nez / nase rad
- 34 • Nose gear doors / trappe de train / nase gang türen

- Tires BLACK
- Hubs ALUMINUM
- Struts WHITE
- Gear Door Interiors and Gear Wells WHITE

Paints:

- Model Master Enamel
- 1745 - White
- 1749 - Flat/Matte Black
- 1780 - Steel

- 2039 - Voodoo Grey
- 1781 - Aluminum

- Model Master Acrylic
- 4696 - White
- 4692 - Gull Grey (closest match)
- 4768 - Flat Black
- 4677 - Aluminum
- 4679 - Steel

Entire fuselage and leading edges of all wings, stabilizers and engines are bare aluminum

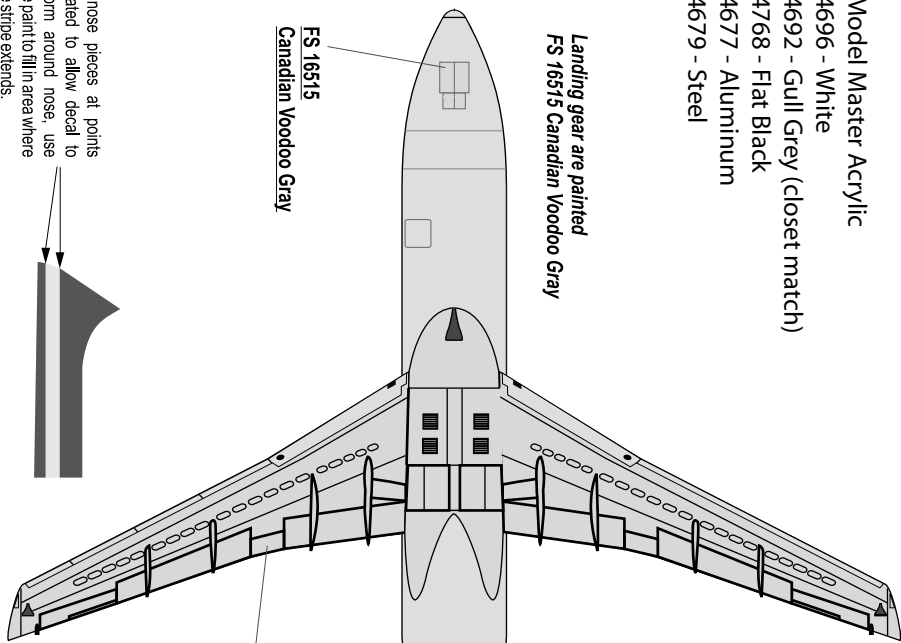

Landing gear are painted
FS 16515 Canadian Voodoo Gray

FS 16515
Canadian Voodoo Gray

Cut nose pieces at points indicated to allow decal to conform around nose, use white paint to fill in area where white stripe extends.

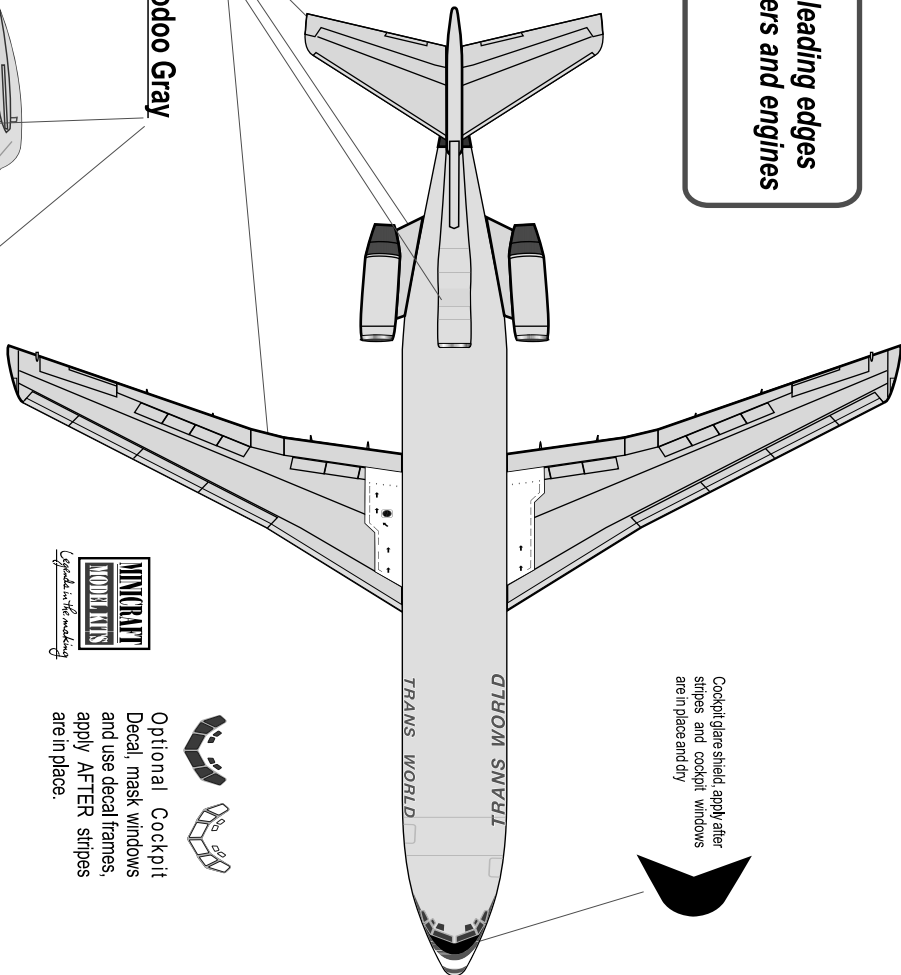

Cockpit glare shield, apply after stripes and cockpit windows are in place and dry



FS 16515
Canadian Voodoo Gray

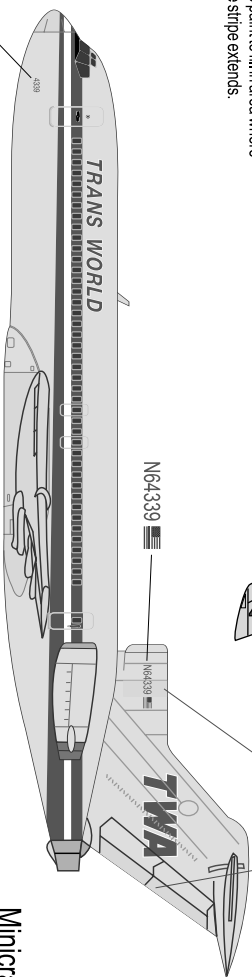

N64339

N64339

TWA

4339

Minicraft #14599

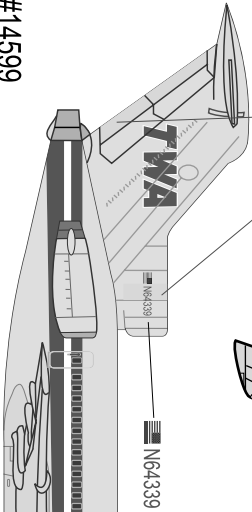

N64339

N64339

TWA

4339



Optional Cockpit Decal, mask windows and use decal frames, apply AFTER stripes are in place.



TRANS WORLD

Markings on each side apply in three pieces



TRANS WORLD