

# AIRCRAFT MAINTENANCE CRANE U.S. MILITARY, 1940s - 1950s

UNASSEMBLED RESIN MODEL KIT - DECALS NOT INCLUDED

**FOR EXPERIENCED MODELERS ONLY**

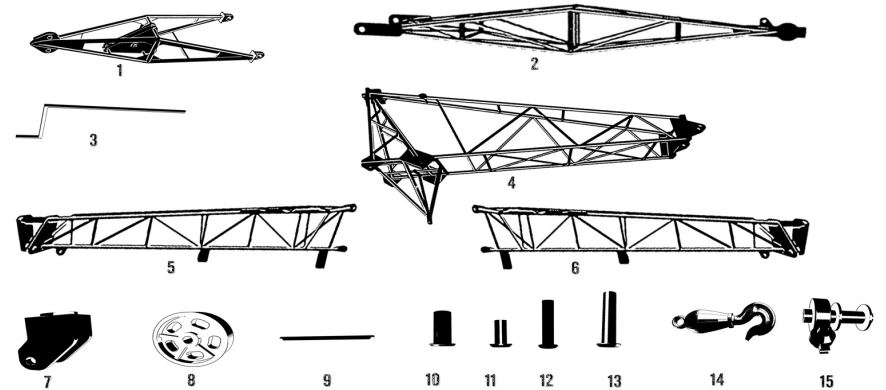
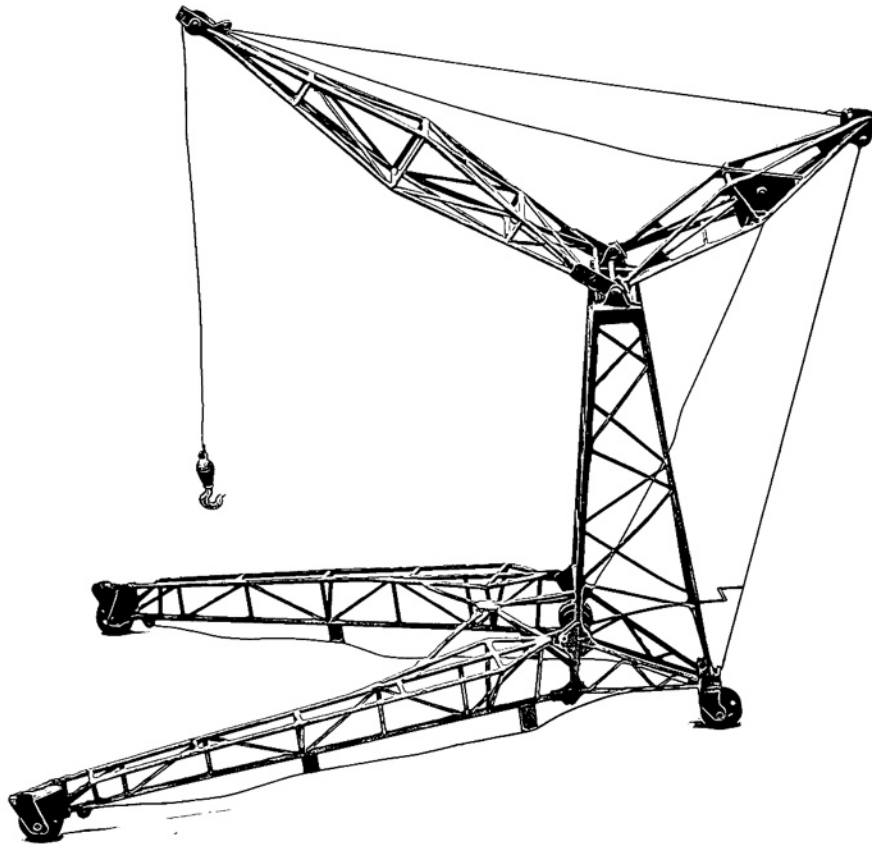

- |                       |  |
|-----------------------|--|
| 1. Support arm        | 9. Leg supports x2                       |
| 2. Lift arm           | 10. Crane arm Bolts X4 (2 will be used)  |
| 3. Crank              | 11. Leg Bolts x4                         |
| 4. Tower              | 12. Wheel bolts X4 (2 will be used)      |
| 5. Right Leg          | 13. Rear Wheel Bolts x4 (1 Will be used) |
| 6. Left Leg           | 14. Lifting hook                         |
| 7. Rear wheel support | 15. Wrench                               |
| 8. Wheels x3          |  |

During the Second World War and the Korean War years the U.S. armed forces, including the USAAC / USAF, the Navy and the Marine Corps, used this type of crane for performing maintenance on their aircraft based in theatre. These hardworking helpers, operated by hand, were essential for moving heavy parts like engines and propellers. Without these sturdy cranes, the mechanics would have had a tough time tackling maintenance tasks on their planes.

### Painting Guide:

Overall colour: - RLM04 Yellow (FS33538) for USAAC / USAF units – Atlantic/ocean Grey (FS36187) for USN & USMC units.

Wheel rims: flat black

Rigging and wires: dull metal

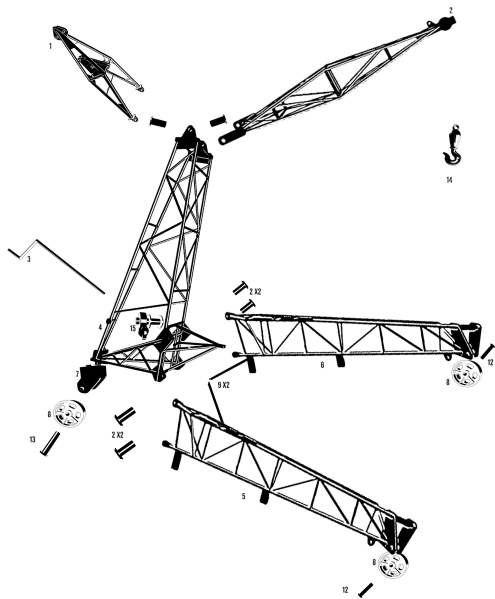

Assemble parts as instructed.  
Some holes or pins may need sanding for parts to fit perfectly.

Check the fit of each part before cementing into place.  
Use cyanoacrylate to cement parts.

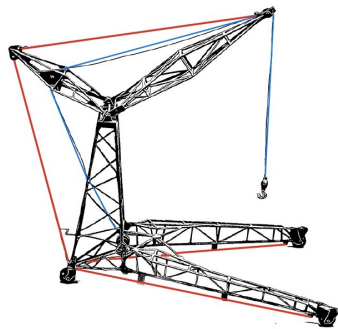

Red: Rigging for support use Soldering wire  
(1/32 - 0.4mm, 1/48 - 0.3mm 1/72 - 0.2mm)

Blue: Lifting cable, use soldering wire  
(1/32 - 0.3mm, 1/48 - 0.2mm 1/72 - 0.1mm)