



DE HAVILLAND  
Vampire FB. 5

1/72

**HISTORY**

The Vampire was the second British jet to be mass-produced and the prototype flew 20 Sept. 1943. It was supplied to the RAF and to Air Forces of the Commonwealth and around the world.

**DATA**

Wingspan \_\_\_\_\_ 11.58m  
Length \_\_\_\_\_ 9.37m  
Height \_\_\_\_\_ 1.87m  
Max speed \_\_\_\_\_ 860 kph

**REFERENCE**

- Cement parts together
- Ballast supplied

**PAINT**

Refer to decal sheet

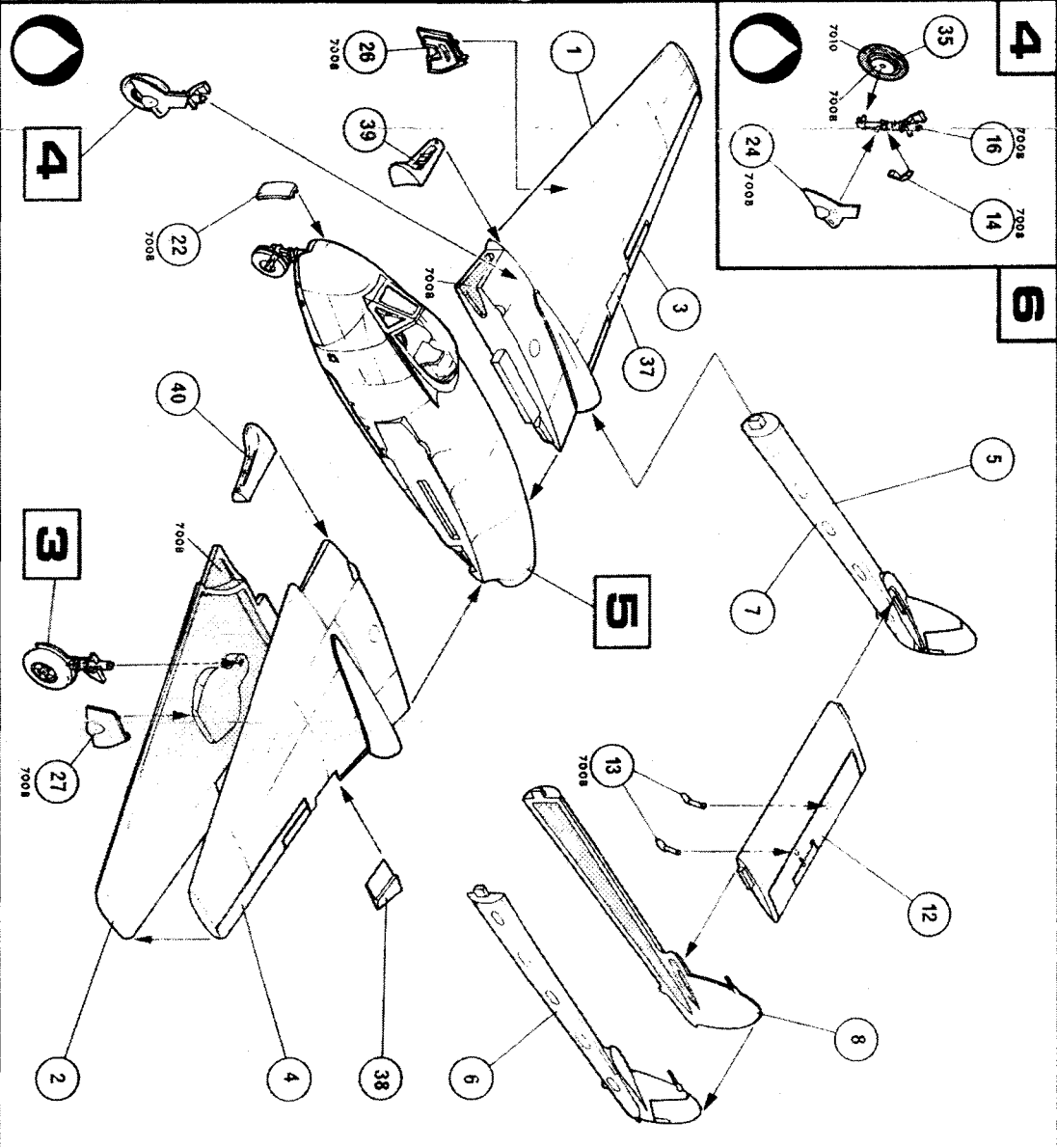
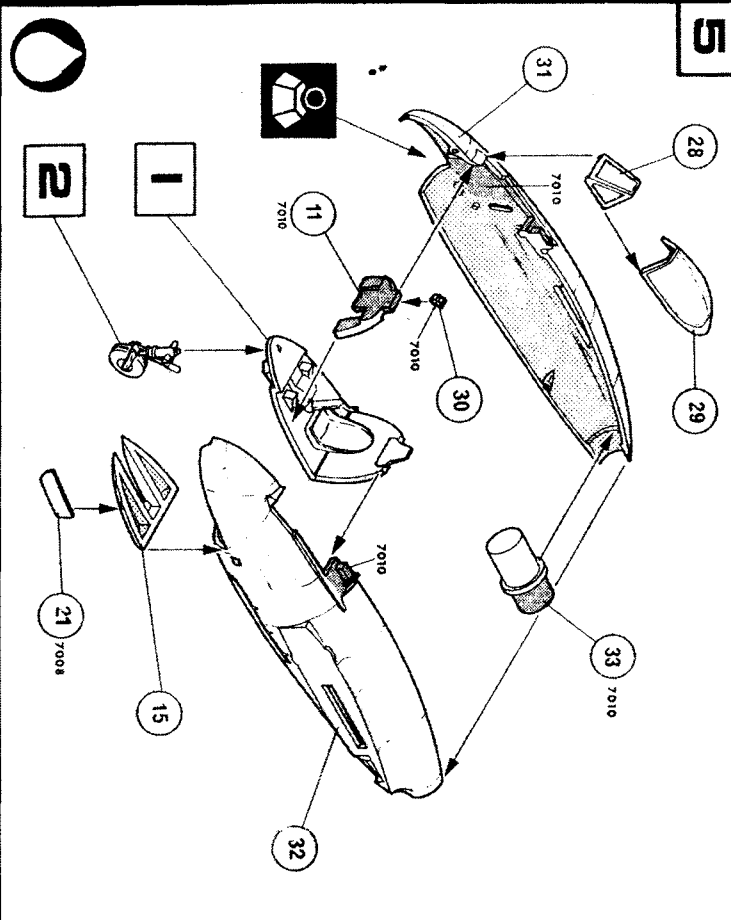
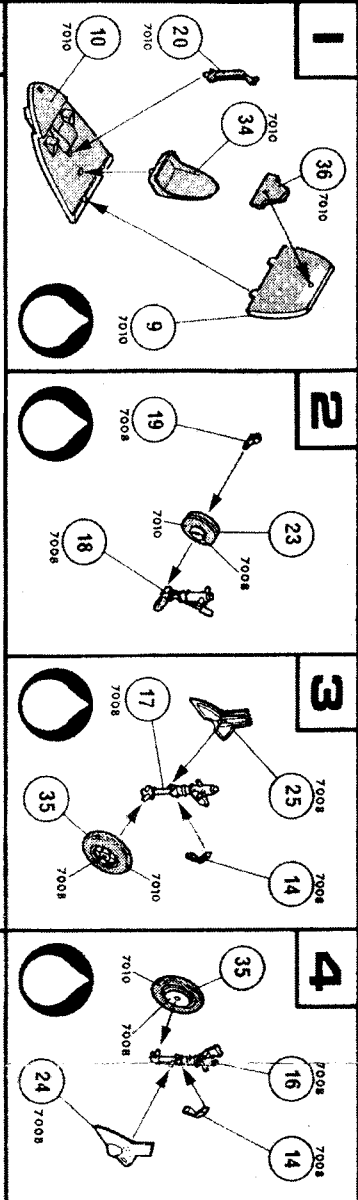

## GENERAL MODELLING ADVICE

You have before you a Heller Model Kit, each moulding, each piece of which has been carefully researched and produced to allow you to construct a model kit of which you can be justly proud.

### **Before commencing the assembly**

Study these notes and the assembly instructions before starting the model. Identify the numbered pieces on each of the mouldings with the help of the plans. Make certain you know where pieces fit.

Where there is a choice of versions make certain you know which pieces are required for your intended model.

Identify the pieces you have to paint before assembly and those that can be painted after assembly.

Follow the step-by-step instructions carefully.

### **Assembling and gluing**

Carefully cut the pieces from the sprue using a craft knife with a sharp blade. If necessary trim pieces with a file or an emery board to ensure a perfect fit.

Before applying cement, assemble pieces "dry" in order to satisfy yourself that you know where each is located and they fit perfectly together.

Use the minimum amount of polystyrene cement following the instructions for these products. Make certain that pieces are located together to give perfect symmetry in the model.

Certain pieces may need "clamping" together when cementing.

Use one or more spring-type clamps or adhesive tape to assist you to get a perfect join.

Use a pair of tweezers to assist you in assembling the smaller components. Polystyrene cement will not adhere to plated or painted plastic so carefully scrape away the plating from the points of assembly before applying cement.

Any small gaps in the model can be filled using model filler.

### **Painting**

Use enamel paints for your model.

Follow the instructions as to which pieces to paint before or after assembly.

To matt down gloss paint use matt varnish.

When intermixing paints to obtain a particular shade, make certain that you mix sufficient for the job in hand.

### **Positioning of decals**

Identify the position for each decal on the model according to the version chosen by following the plans.

Carefully cut around the decal, soak for a few seconds in lukewarm water and carefully slide from the backing paper into the correct position.

Absorb excess water with a small piece of blotting paper or soft clean rag.

\*Please note, Tasman Model Kits 'Lite' release of the Heller Vampire FB.5 kit does not come with decals.

Happy modeling.