

F4U-1D

1/72 SCALE

CORSAIR

1178

MINICRAFT MODELS, INC.
1510 W. 228TH STREET
TORRANCE, CA 90501



The F4U-1D was an improved version of the famous Vought Corsair fighter. On this model, a bubble canopy topped the cockpit and allowed the pilot's seat to be elevated for greater visibility than that afforded by the earlier framed canopy. This Corsair variant was the major production version of the type used during World War II. It could carry 2,000 pounds of bombs on underwing racks, or eight 5 inch rockets on small fittings under the outer wing panels. A trio of 50 cal. machine guns was mounted in each wing to make the Corsair a formidable machine.

After the Corsair entered combat, the demand for the big fighter increased to the point that Vought was no longer able to meet the requirements for the U.S. Navy Marines and Royal Navy so additional production lines were set up by Goodyear Aircraft and Brewster, who produced their own versions of the plane, known as the FG-1D and F3A-1D respectively although they were identical to the Vought-built planes.

By the end of the War Corsairs had accounted for the destruction of no less than 2,140 Japanese planes, while only 189 Corsairs themselves became victims of the Japanese fliers.

CHARACTERISTICS

WINGSPAN: 40 feet 11 inches

LENGTH: 33 feet 4 inches

POWERPLANT: One Pratt & Whitney R-2800-8W with water-injection, giving 2,250 hp.

PERFORMANCE: Maximum speed-425 mph @20,000 feet. Service ceiling-33,900 feet.

ARMAMENT: 2,000 lbs of bombs, 8 five-inch HVAR rockets, six 50 cal Browning machine guns.

PARTS LIST

B PARTS

- 1 Fuselage (R)
- 2 Fuselage (L)
- 3 Propeller
- 4/5 Drop tank halves

C PARTS

- 1 Wing top (R)
- 2 Wing top (L)
- 3 Wheel (2)
- 4 Main gear strut (R)

- 5 Main gear strut (R)
- 6 Engine rear
- 7 Engine front
- 8/13 Main gear covers
- 14 Horizontal stab (L)

D PARTS

- 1 Wing bottom
- 2 Horizontal stab (R)
- 3 Tail wheel
- 4 Antenna post

- 5 Control column
- 6 Tail wheel door (L)
- 7 Tail wheel door (R)
- 8 Cockpit floor
- 9 Oil Cooler (R)
- 10 Oil Cooler (L)
- 11 Instrument panel
- 12 Seat
- 13 Engine cowling

CLEAR PARTS

- 1 Canopy

PAINING AND DECAL PLACEMENT

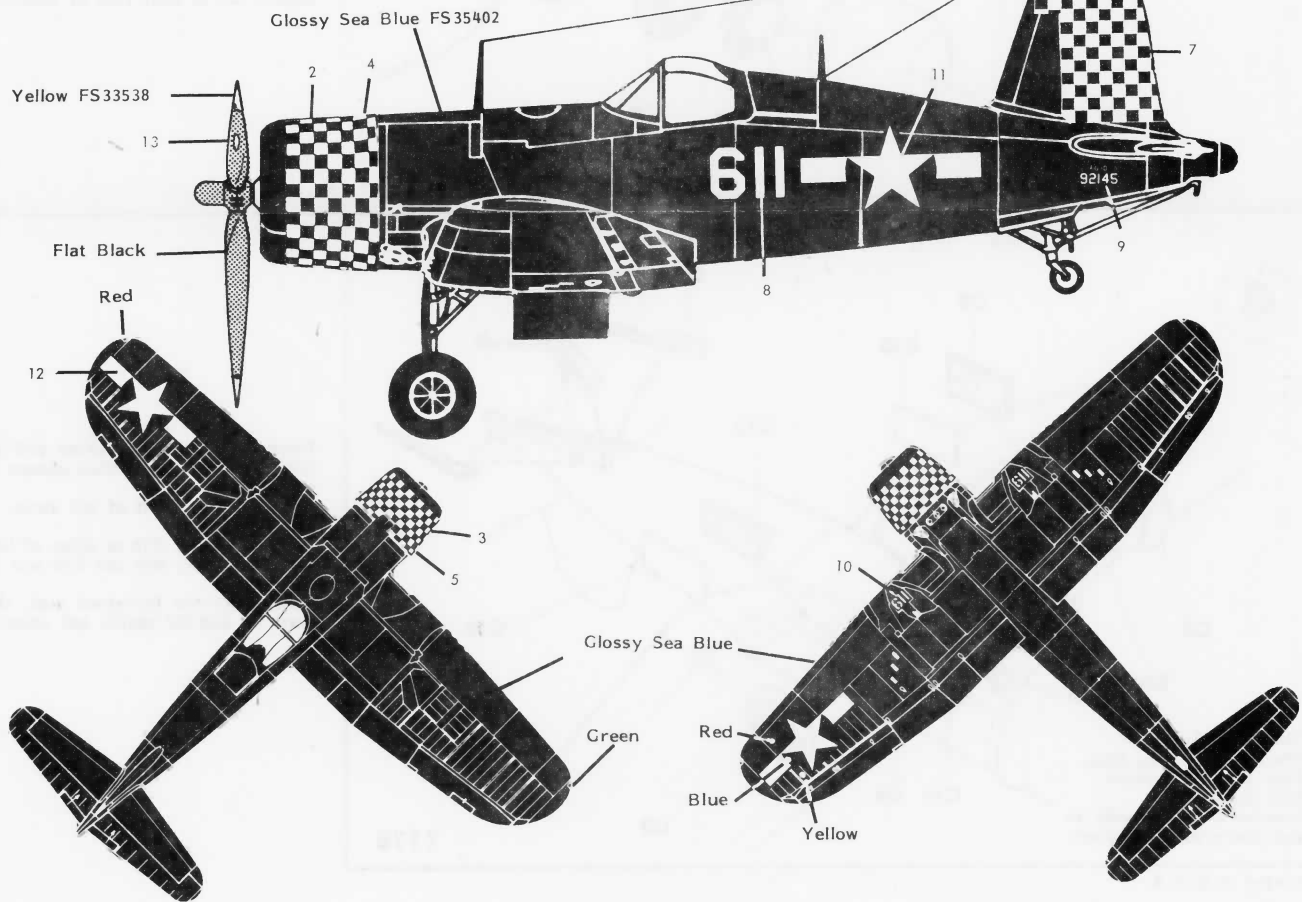

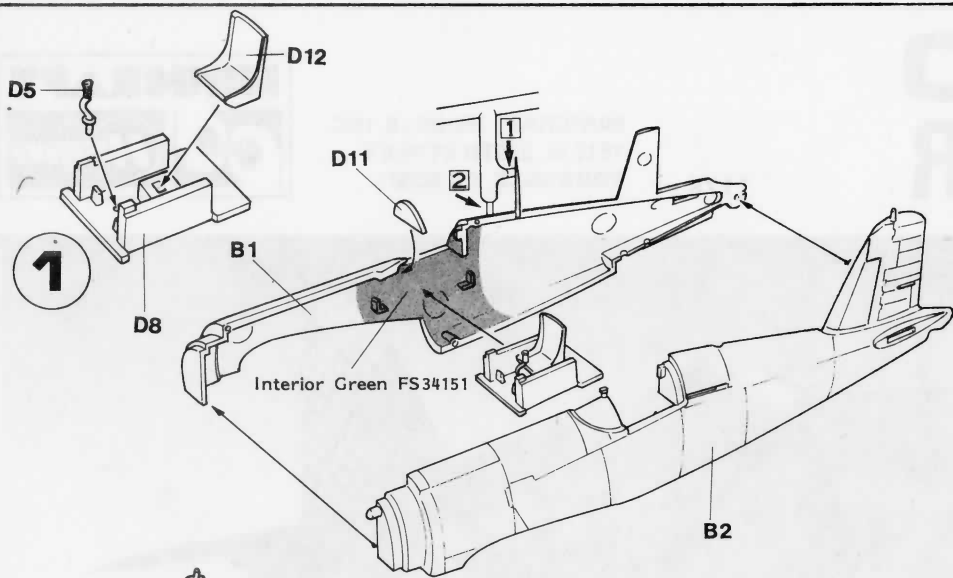

To avoid breaking antenna post from fuselage, B1, cut sprue from antenna before cutting fuselage free.
 Cement D5 and D12 to D8.
 Apply instrument decal to D11, then cement D11 and cockpit interior to B1.
 Cement B1 and B2 together.

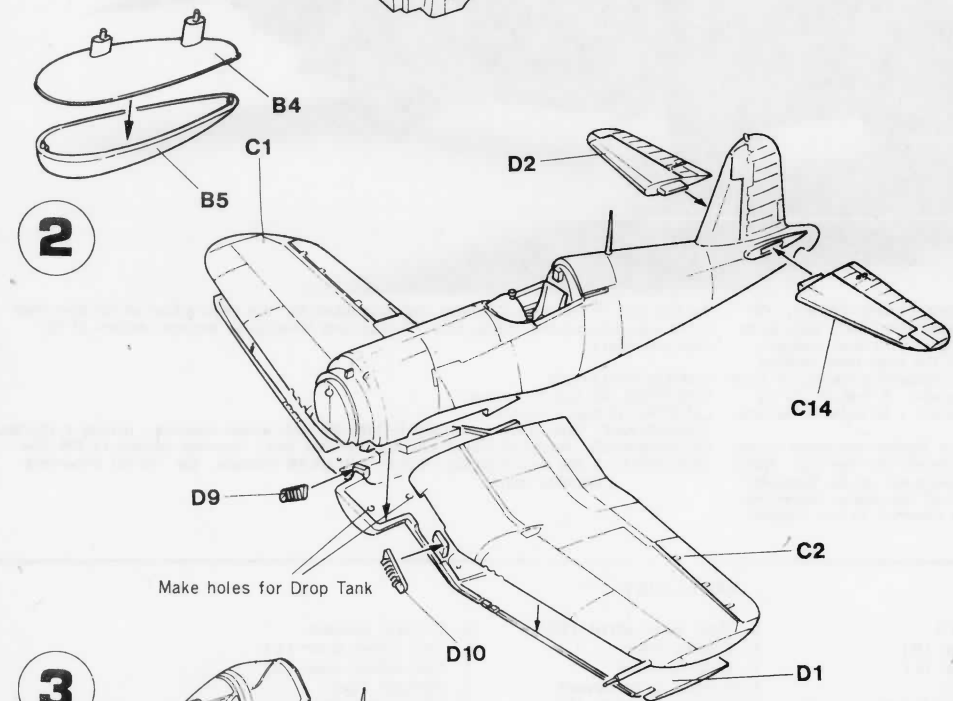

Make drop tank by cementing B4 and B5 together.
 Open holes in bottom of D1 for drop tank, then cement D9 and D10 to D1 as shown.
 Cement C1 and C2 to D1, then cement assembled wing to fuselage.
 Cement D2 and C14 to fuselage unit.

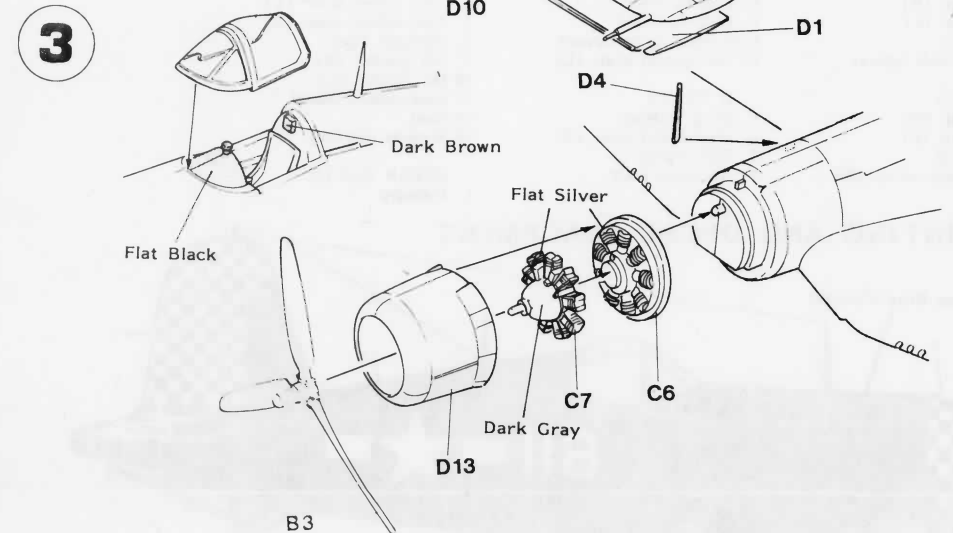

Cement C6 and C7 together, then cement assembly to fuselage nose as indicated.
 Cement D13 over engine, then cement B3 to shaft on C7.
 Cement clear canopy over cockpit.
 Cement D4 to cowl side as shown.

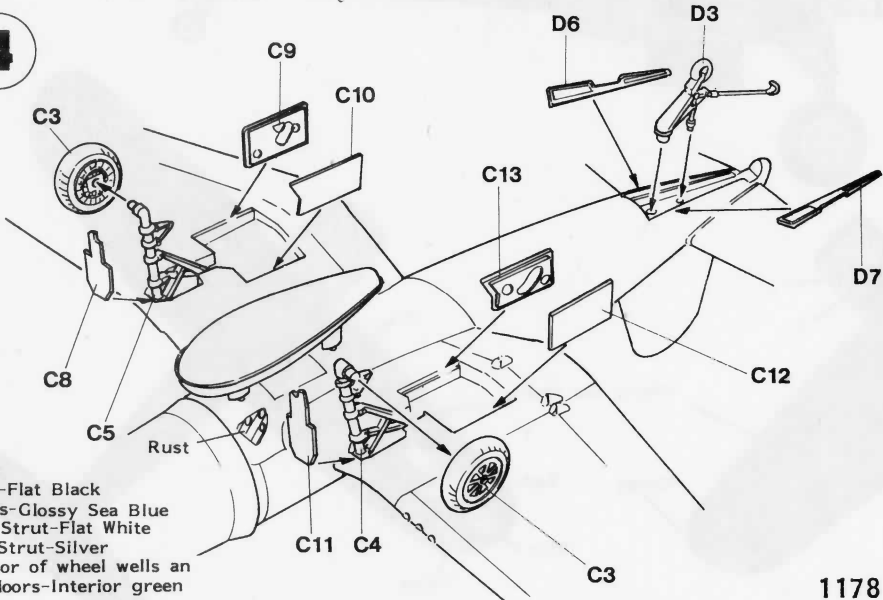
4

Tires-Flat Black
 Wheels-Glossy Sea Blue
 Gear Strut-Flat White
 Oleo Strut-Silver
 Interior of wheel wells and doors-Interior green

Cement C4 into right wheel well and C5 into left wheel well, then cement a C3 to each strut.
 Cement C8 to front of left strut, and C11 to right strut.
 Cement C9 and C10 to sides of left wheel well as shown, and use C12 and C13 for right well.
 Cement D3 into tail wheel well, then cement D6 and D7 beside tail wheel well

1178