



32009

1/32nd Scale MiG 29A  
Cockpit

For Revell® MiG 29A Kit



EDUARD PHOTO-ETCHED PARTS

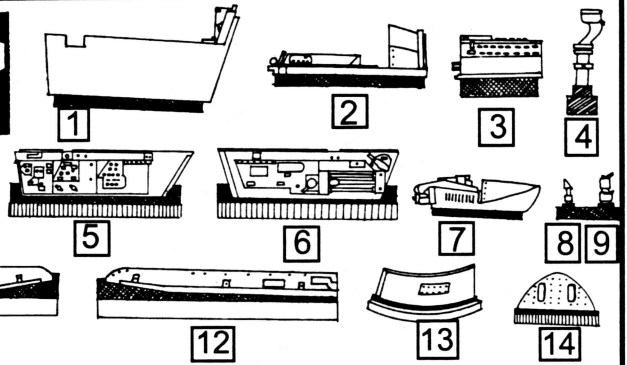

5 RESIN PARTS

5 PHOTO-ETCHED PARTS

**CAUTION!**

METAL PARTS HAVE SHARP EDGES, KEEP OUT OF REACH OF SMALL CHILDREN. PHOTO-ETCHED AND RESIN PARTS CAN ONLY BE GLUED WITH CYANOACRYLATE GLUE. WORK IN A WELL VENTILATED AREA. DO NOT INHALE VAPORS SINCE THESE CAN BE HARMFUL.

**NOTE!**

THIS MODEL IS RECOMMENDED FOR EXPERIENCED MODELERS, IT REQUIRES SOME ADJUSTING ON THE REVELL KIT IN ORDER FOR THE COCKPIT TO FIT CORRECTLY.

REMOVE RESIN BASES FROM THE PARTS WITH A RAZOR SAW, AND SAND BOTTOM FLAT. WASH PARTS WITH SOAPY WATER AND OLD TOOTHBRUSH TO REMOVE MOLD RELEASE AGENT.

TEST FIT EVERY PART BEFORE ASSEMBLY

1

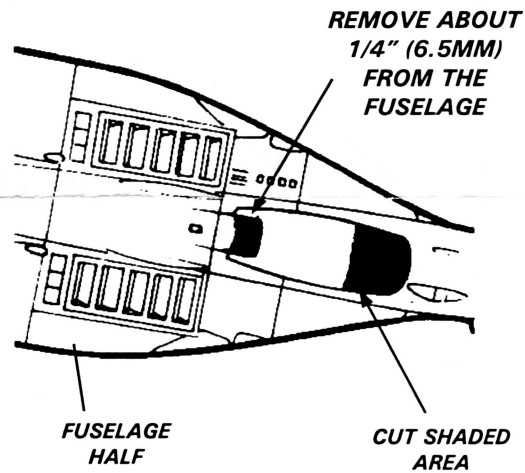

3

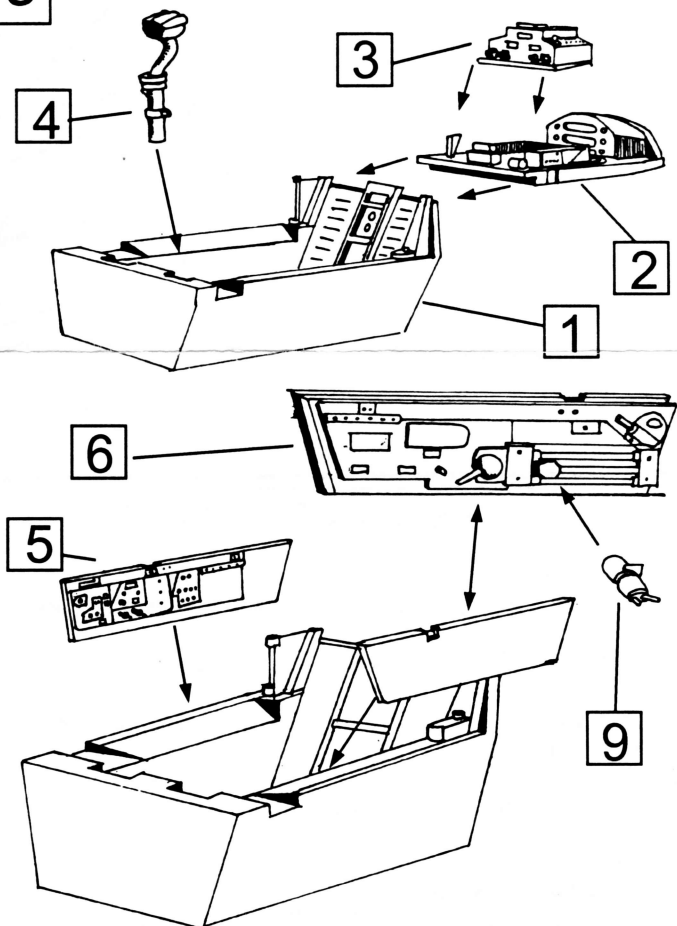

2

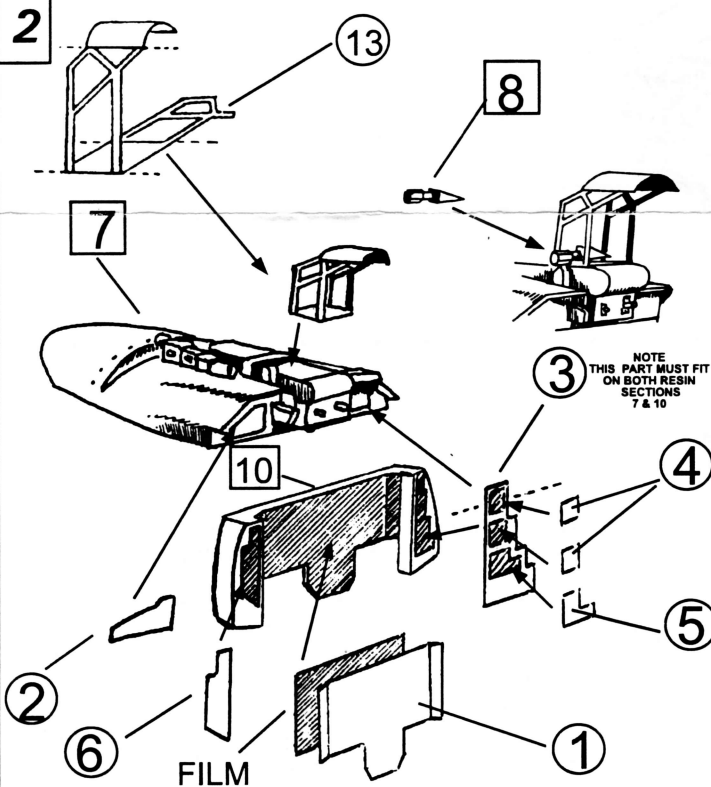

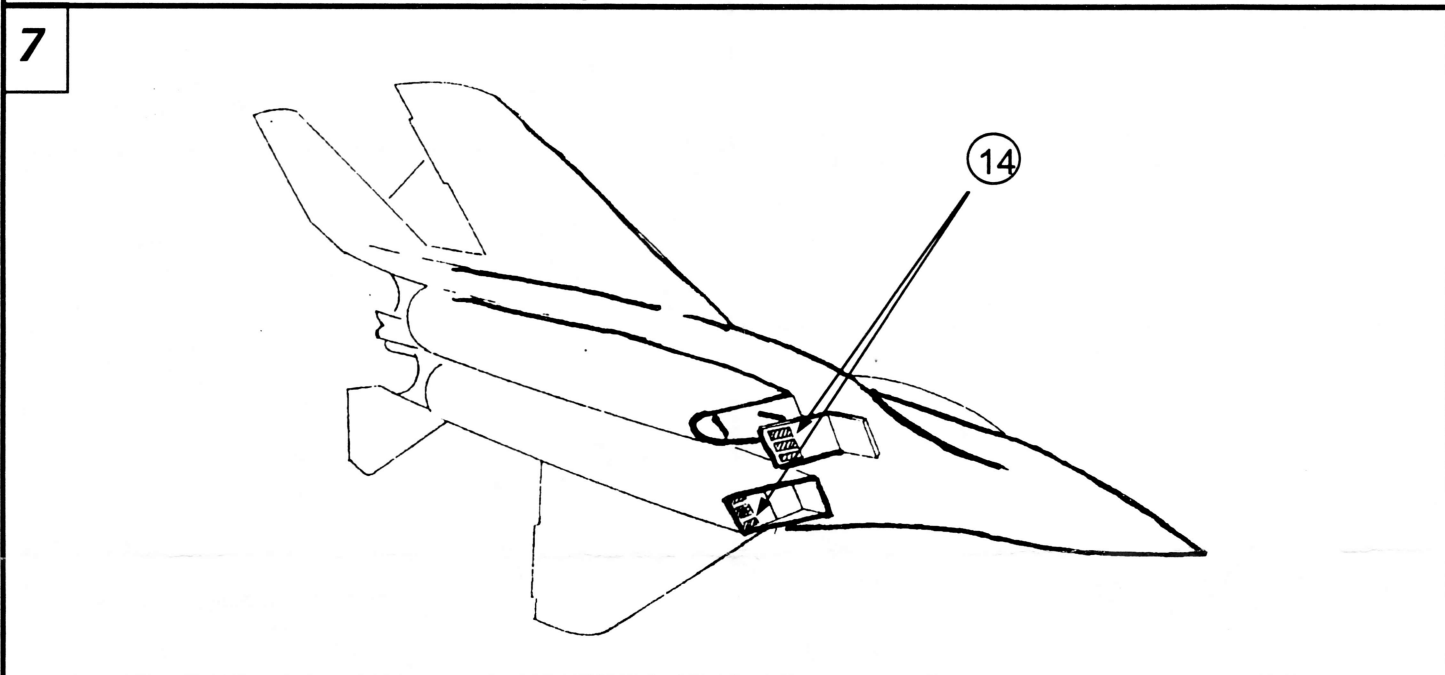
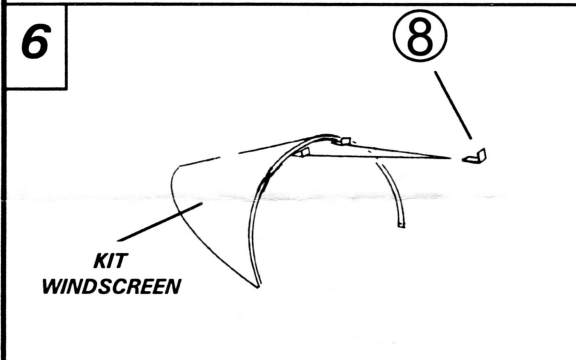
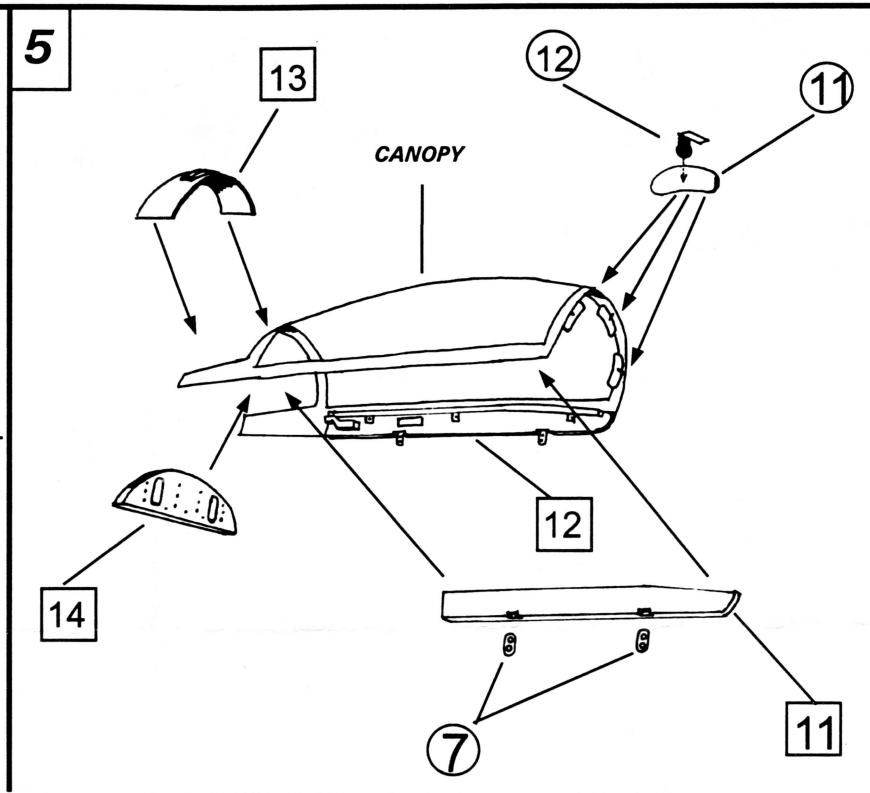
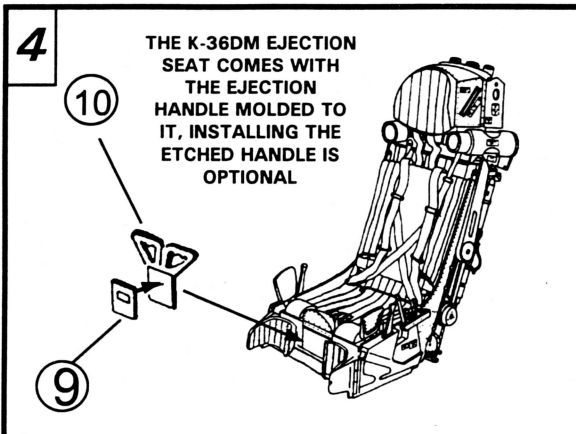

### PAINING & WIRING

FOR PAINTING & WIRING THE COCKPIT, CONSULT YOUR REFERENCES. WE RECOMMEND THE FOLLOWING BOOKS:

- \* MIG-29 ALL VARIANTS, BY 4+ PUBLICATION
- \* LOCK ON #9, MIG 29 A/C FULCRUM BY ZOLTAN BUZA VERLINDEN PUBLICATION
- \* MIG-29 FULCRUM BY JAY MILLER AEROFAX, INC.

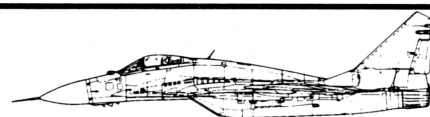

MASTER BY TALAL CHOUMAN

TAC Scale Dynamics would like to thank the following people/organization for making this project possible:

- Mr. Ron Books for providing the cockpit references.
- Eduard Model Accessories for their cooperation.
- Mr. David Sargood for lending a hand in making this instruction sheet

TAC SCALE DYNAMICS, MADE IN USA  
 EDUARD PHOTO-ETCH, MADE IN CZECH REPUBLIC

COPYRIGHT © 1996 TAC SCALE DYNAMICS  
 COPYRIGHT © 1992 EDUARD LTD.  
 REVELL® IS A REGISTERED TRADEMARK OF REVELL-MONOGRAM, INC.