

**MINICRAFT**  
**MODEL KITS**

*Plastic Model Kit Skill Level 2 1/144 Scale 14749*

*Legends in the making!*

- 4 marking options
- Clear Display Stand
- Build it "in flight" or "on the ground"

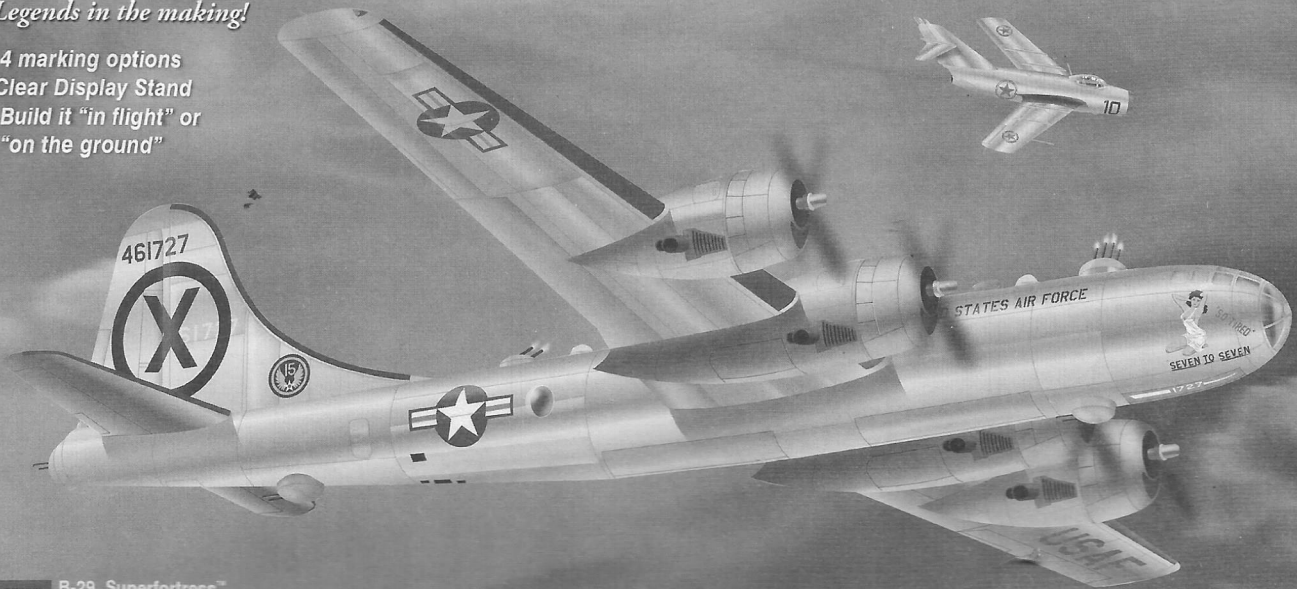

**B-29 Superfortress™**  
Produced under license Boeing B-29 Superfortress,  
the distinctive Boeing logo, product markings  
and trade dress are trademarks of The Boeing Company.

# **RB-29 Superfortress™ "Postwar"**

*The B-29 was first employed as a long-range heavy bomber to bomb the Japanese mainland from distant bases in China and the Pacific islands. The B-29 was also the first aircraft to drop the atomic bomb in 1945. The B-29 served well into the 1950's for both the United States Army Air Force and the newly organized United States Air Force after 1947.*

*The new Minicraft Models RB-29 features 4 marking options representing post-world war II aircraft with decals printed by Cartograf. This kit also includes the new Minicraft clear stand for in-flight desktop display.*

## **Painting and finishing Minicraft model kits**

Techniques for painting and finishing your model vary depending on the preferences of each model builder. Commonly most painting is recommended before assembly. Small details are best painted before assembly. Details like car and airplane interiors **MUST** be painted before assembly. Modelers may choose to paint the model kit using model paint with a paintbrush, an aerosol spray can or an airbrush. Large areas of the model like a model car a body or model airplane wings and fuselage are best painted before assembly or as a partially assembled sub-assembly. Use of an aerosol can or airbrush is recommended. Models can be painted after assembly but clear parts and some details will need to be masked to keep clear parts clear and preserve pre-painted details.

## **Decal Application:**

Your Minicraft model includes high-quality waterslide decals. These decals adhere best to a glossy surface. Use a sharp scissors or knife to cut individual decals from the carrier sheet. Do not cut into the clear film surrounding the individual decals. It is recommended that you apply one decal at a time. Place the decal section in warm water, when first inserted in the water your decal will curl, after approximately ten seconds the decal will uncurl. Remove from water and lay on a paper towel. After approximately 10 - 20 seconds the decal will slide freely from the backing paper. Use a small brush to help slide the decal from the backing paper and into position on the model. Carefully blot excess water from the decal, using care not to move the decal or tear it. If you choose to use a setting solution, apply a thin coat over the decal following the manufacturer's instruction. Allow the decal to dry overnight. Wash any adhesive residue off the model with a small wet towel.

**Minicraft Models (US) LLC 2136 12th St. Rockford, IL. 61104 Printed in China**  
**[www.minicraftmodels.com](http://www.minicraftmodels.com)**

# 1/144 Scale B-29 Superfortress

Your MINICRAFT B-29 may be assembled with various options, such as 'In-flight' features as retracted landing gear and 'spinning' propeller. Parts are also provided for a 'stationary' or 'ground' version with extended landing gear. Please review the assembly steps to become familiar with the parts before beginning assembly.

## PARTS LAYOUT DIAGRAM

**NOTE** - Aircraft used for training and operational atomic bomb missions had all turrets and sighting blisters removed and faired over. Tail guns were carried.

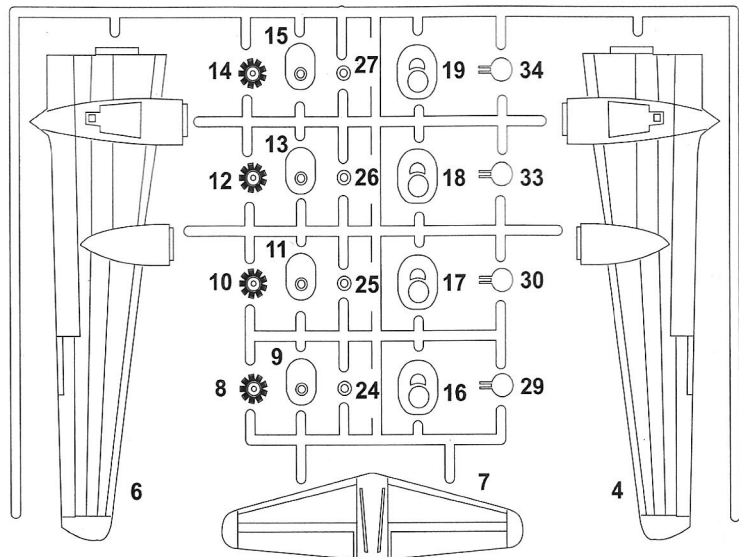
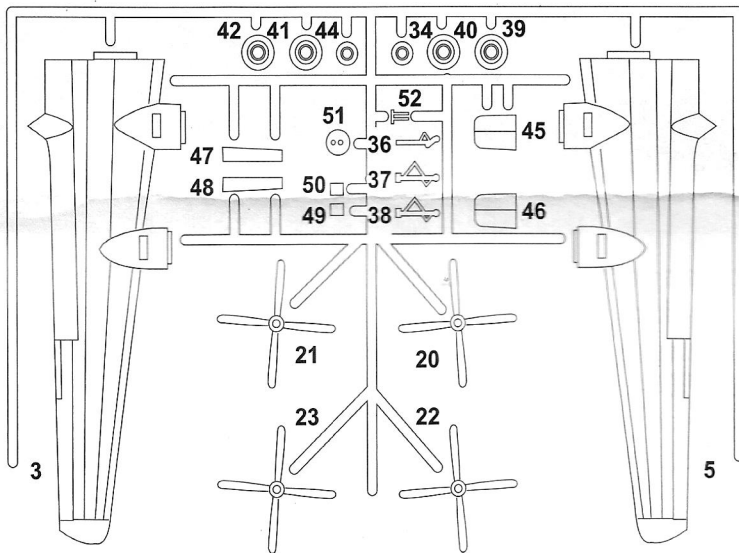
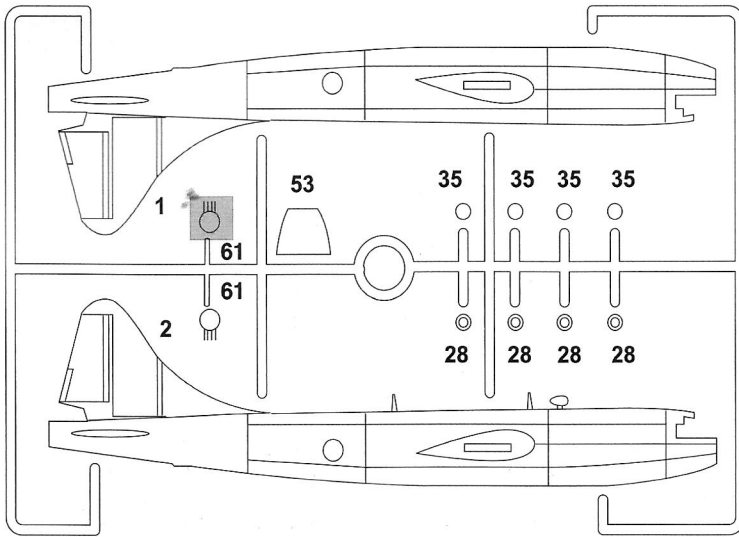

Shaded parts not for use on this build

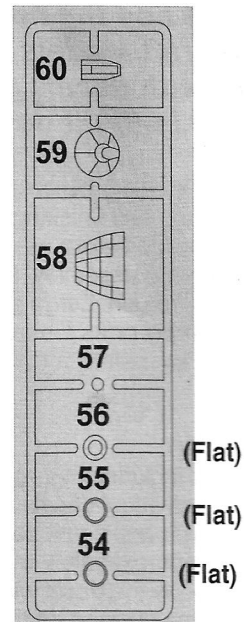
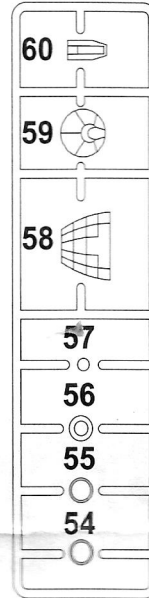

1

?



All Parts except as noted

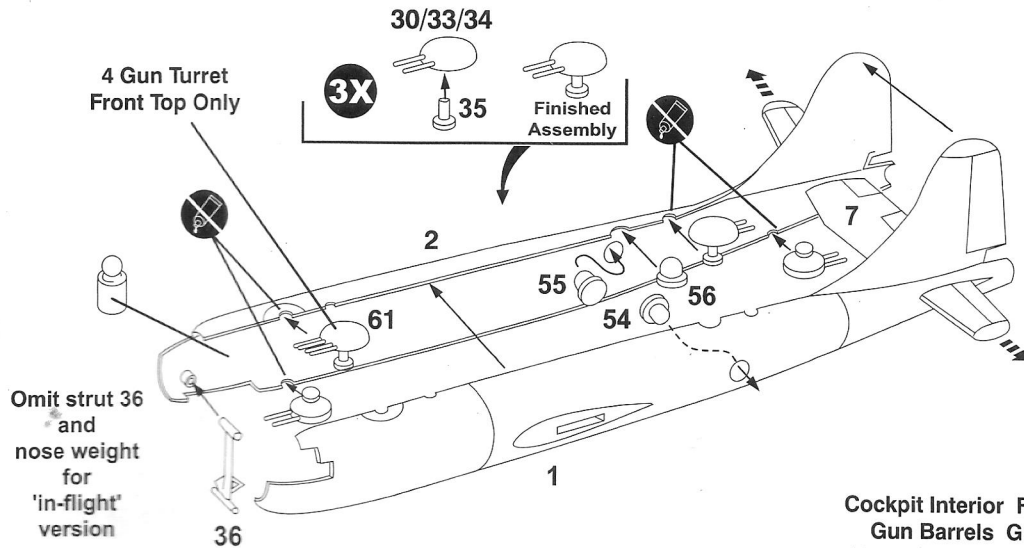

2



All Parts

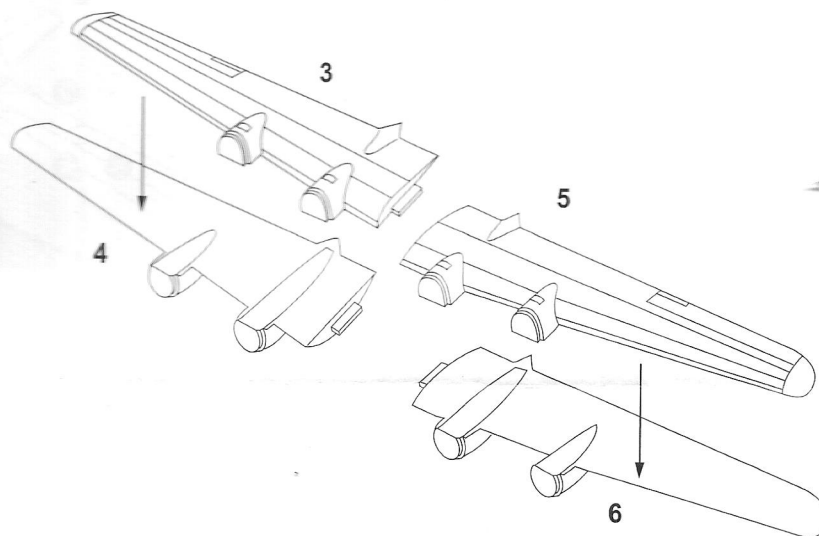

STATIONARY VERSION

?

IN-FLIGHT VERSION

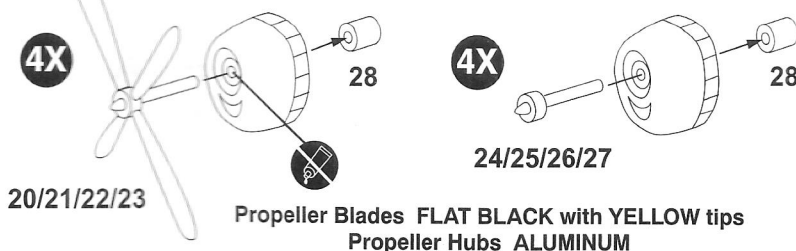

3



All Parts

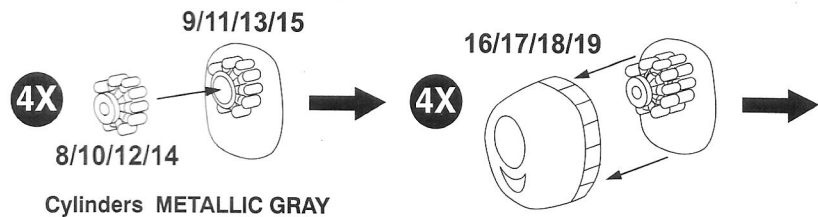

**4** All Parts

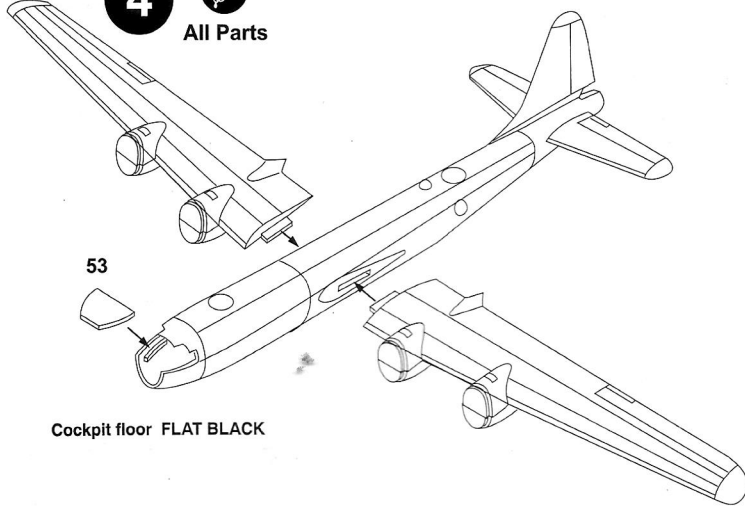

Cockpit floor FLAT BLACK

**5** All Parts

Note orientation of nose cap (part 59)

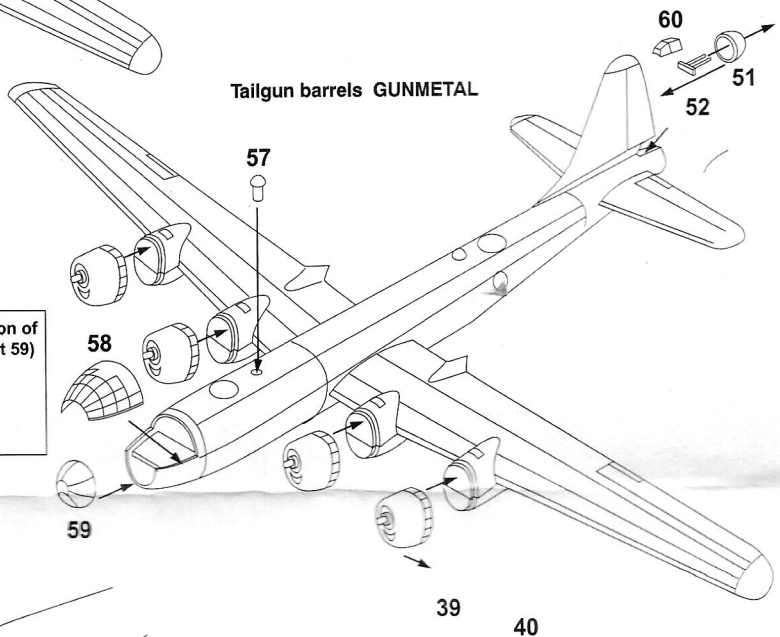

Tailgun barrels GUNMETAL

**6** All Parts

IN-FLIGHT VERSION

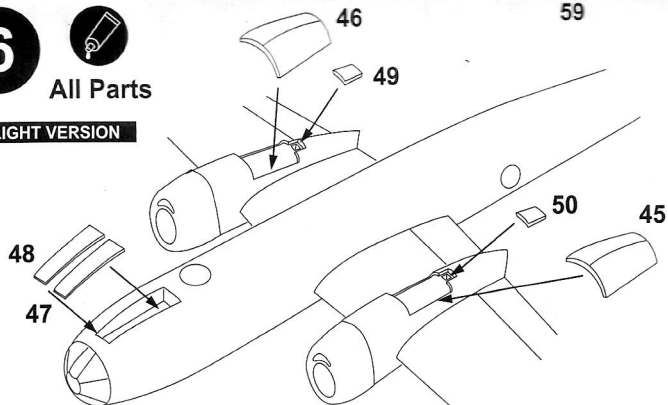

**7** All Parts

STATIONARY VERSION

Struts, hubs and wheelwells ALUMINUM  
Tires FLAT BLACK-GRAY

Cut parts 45/46 in two

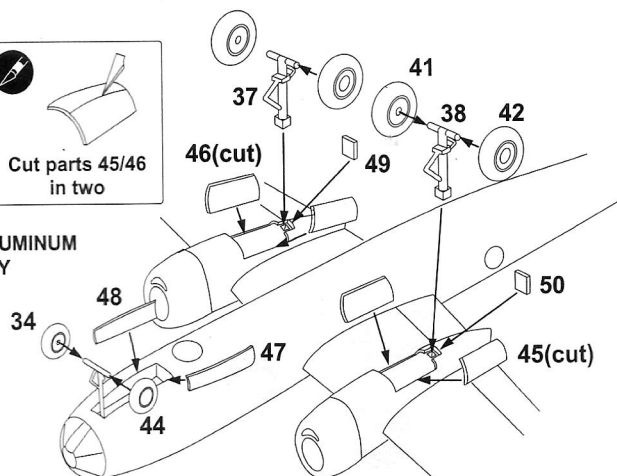

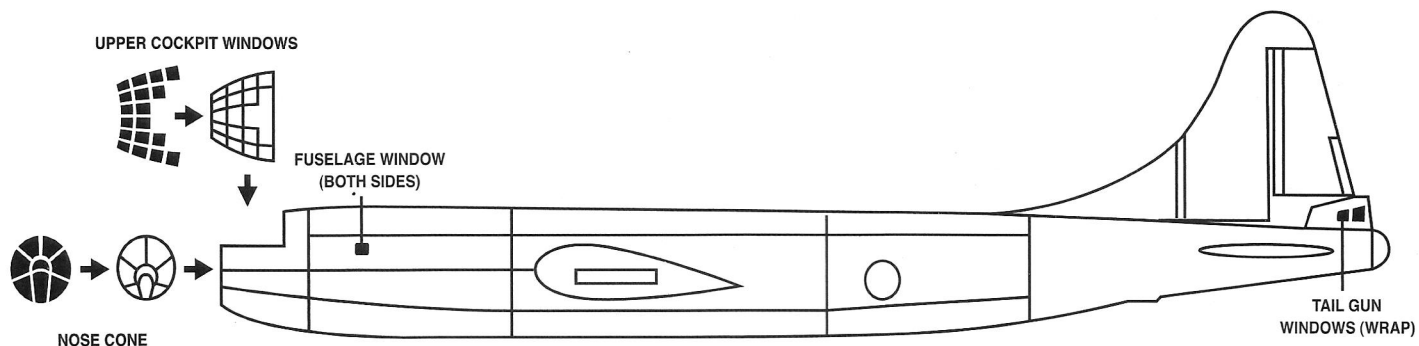

Window blackout decals are the same on all 3 versions. Cockpit windows may be left clear with window frames painted to match the fuselage. Use of "black-out" cockpit decals optional. Trim as needed. Use of decal solvent or decal set will be extremely helpful for application on these concaved surfaces.

## USAF RB-29, 44-61727, Korean War, based at Yokota Air Base, Japan, July 1952

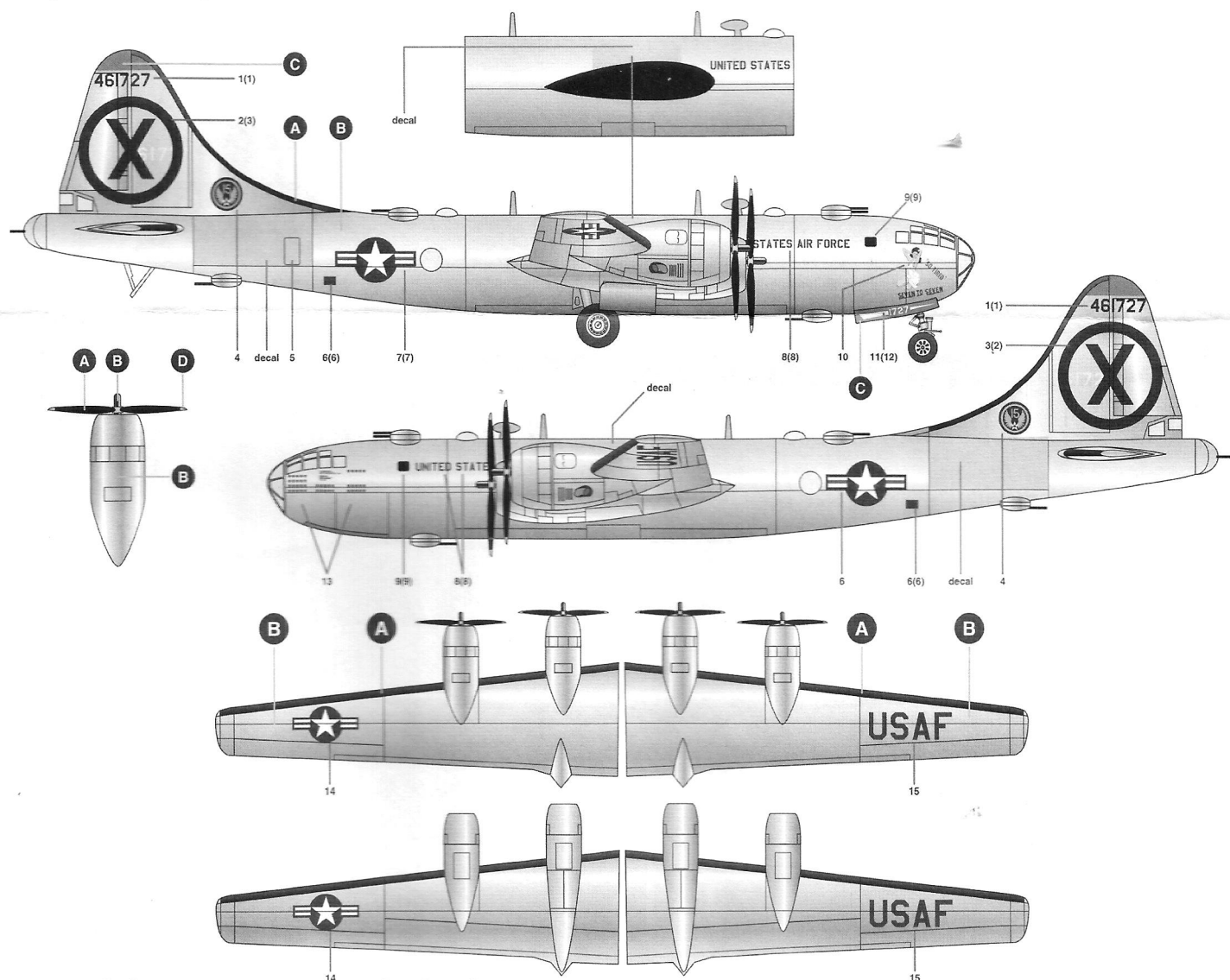

**PAINTS (Item "C" is speculative.)**

- A Black (ModelMaster 1749, Acryl 4768)**
- B Aluminum (ModelMaster 1781, Acryl 4677)**
- C Green (ModelMaster 1224, Acryl 4774)**
- D Yellow (ModelMaster 1708, Acryl 4721)**

# USAF 19BG 30BS Kadena AB, Okinawa, Fall 1950

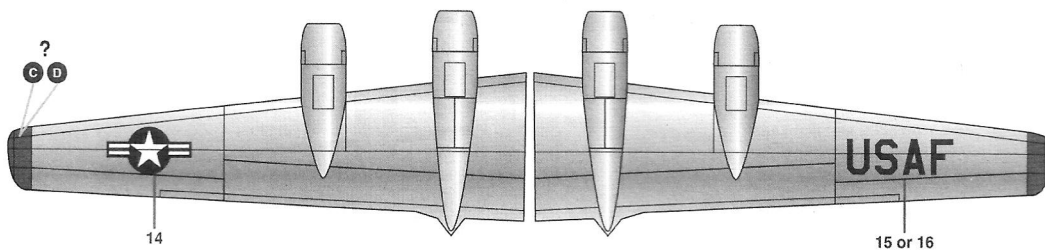
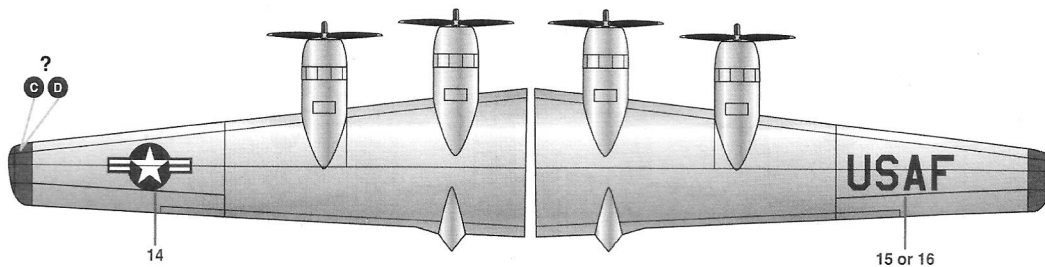
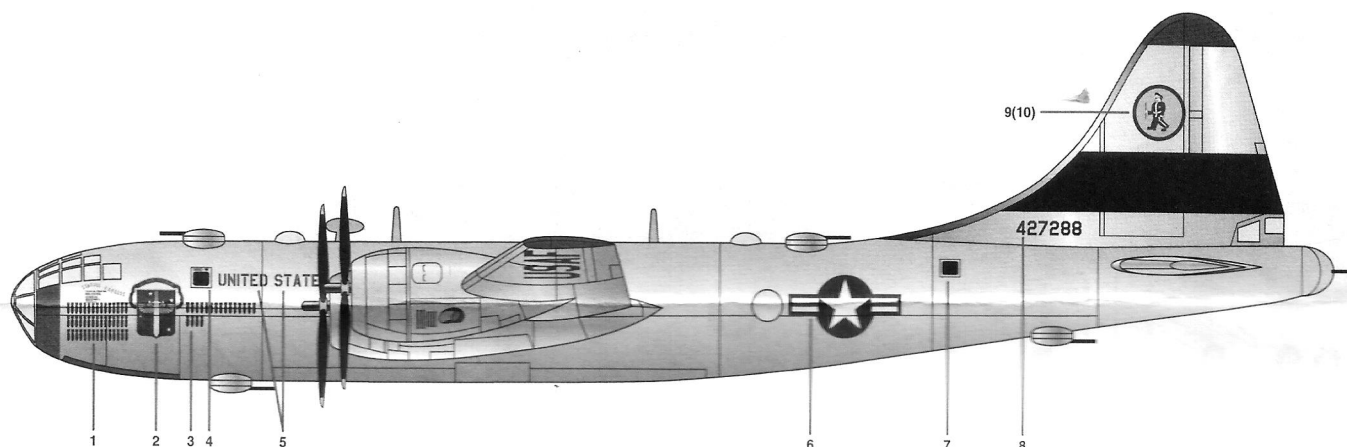
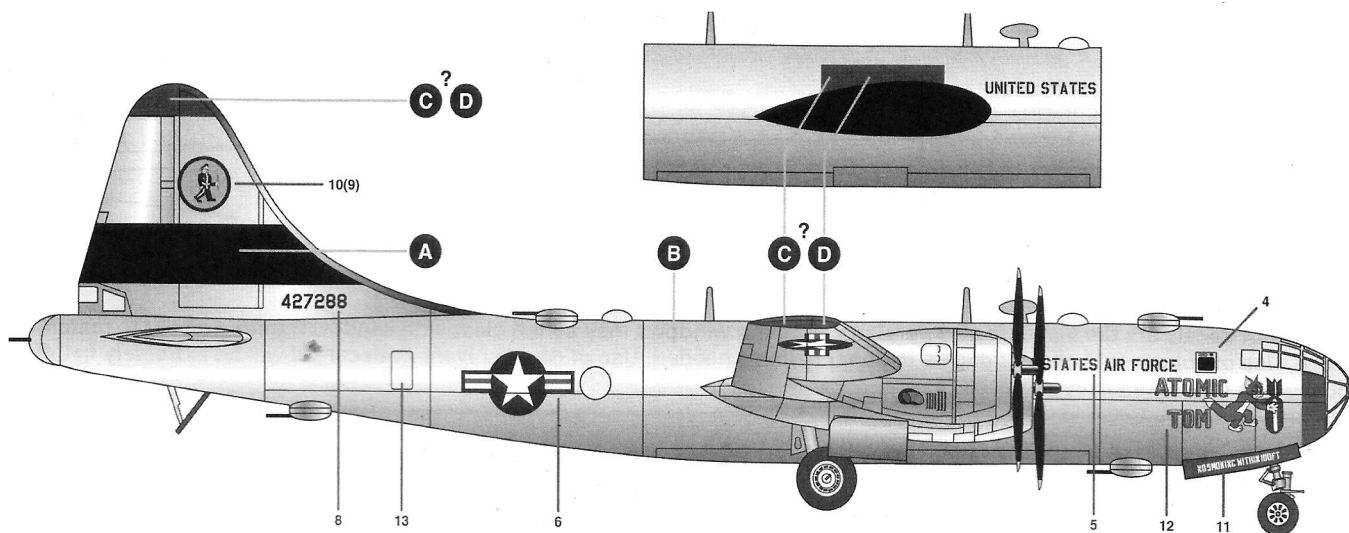

## PAINTS

- A Black (ModelMaster 1749, Acryl 4768)**
- B Aluminum (ModelMaster 1781, Acryl 4677)**
- C FS15102 True Blue (ModelMaster 2030) - or -**
- D FS35044 Insignia Blue (ModelMaster 1719, Acryl 4742)**

# Royal Air Force, No.15 SQN, Germany 1951

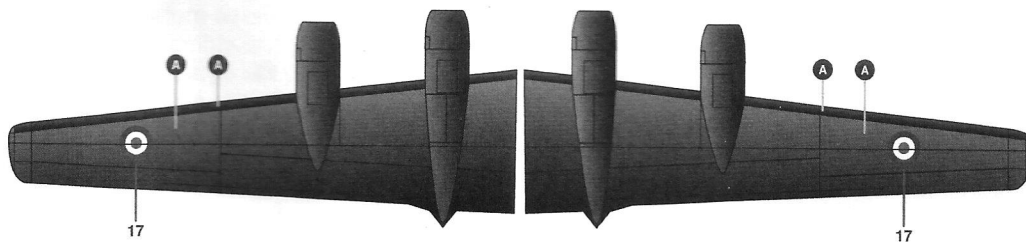
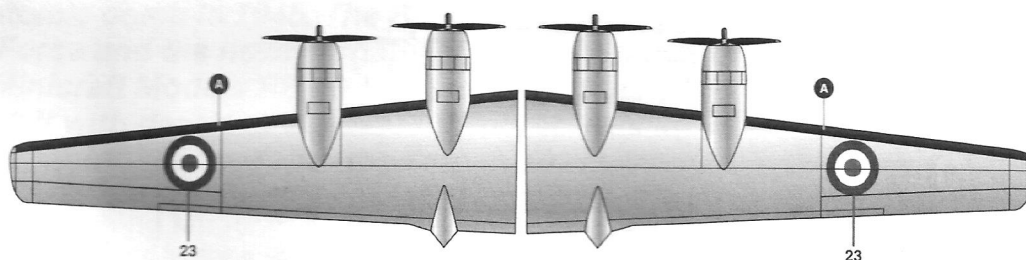
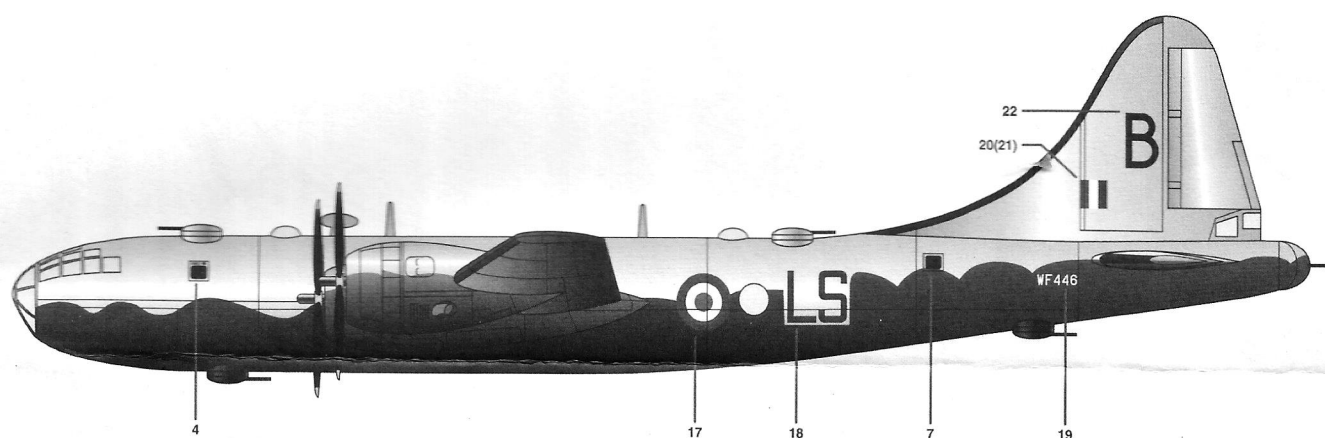
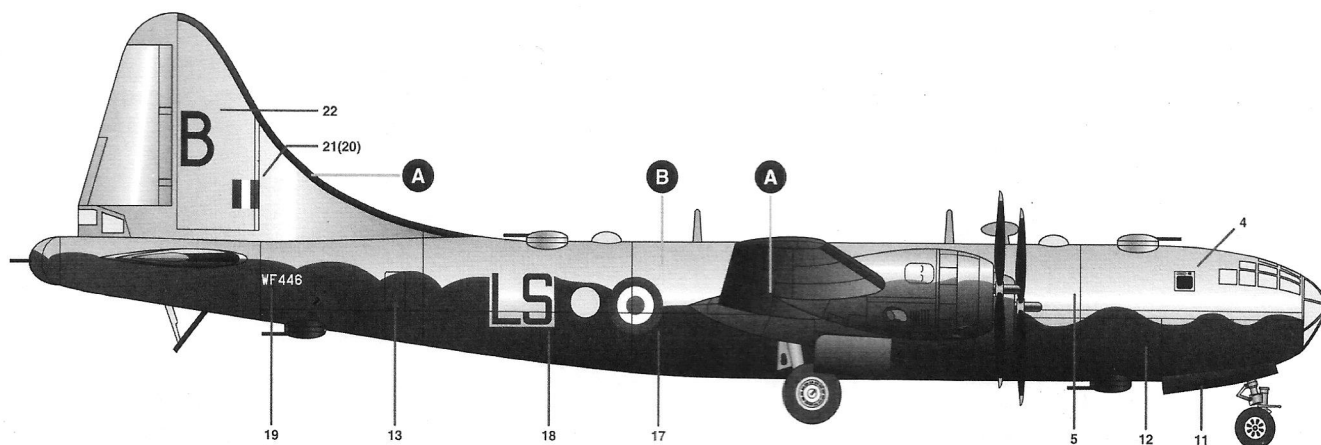

## PAINTS

**A Black (ModelMaster 1749, Acryl 4768)**

**B Aluminum (ModelMaster 1781, Acryl 4677)**

**C FS15102 True Blue (ModelMaster 2030) - or -**

**D FS35044 Insignia Blue (ModelMaster 1719, Acryl 4742)**

# Royal Australian Air Force, Australian R&D Unit, Mid-1950's

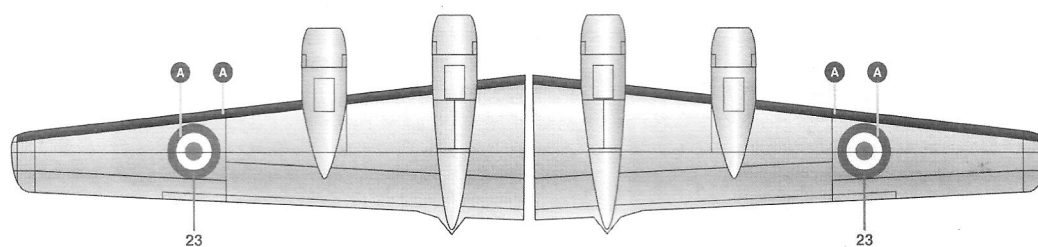
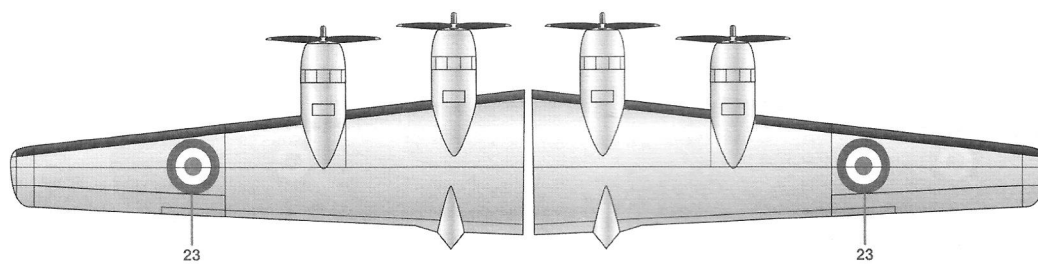
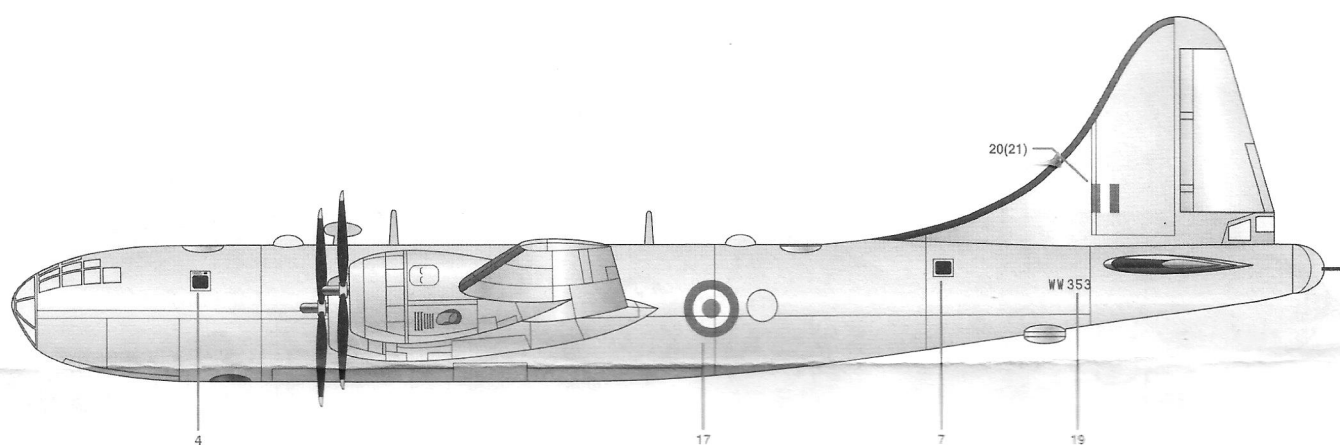
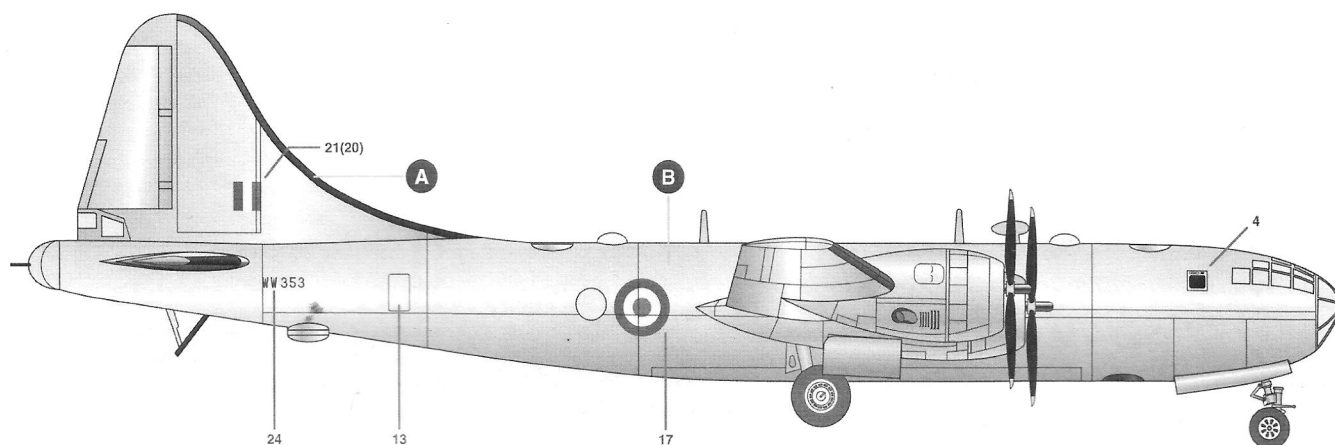

## PAINTS

**A Black (ModelMaster 1749, Acryl 4768)**

**B Aluminum (ModelMaster 1781, Acryl 4677)**

**C FS15102 True Blue (ModelMaster 2030) - or -**

**D FS35044 Insignia Blue (ModelMaster 1719, Acryl 4742)**