

Form No. 099-38592

## 38592 ASSEMBLY INSTRUCTIONS 1929 FORD STATION WAGON

One of the rare body styles for the Model A was the station wagon, less than 10% of the five million A's made were of this type. Featuring a hard rock maple body and side curtains instead of steel and glass, the '29 "Woodie" is a rare collector's item indeed. The interior was strictly functional, the car was intended to carry passengers and luggage from the train station to

their destination, usually someone's country home or town house. The Murray-built body featured a large tailgate, useful for loading large trunks and suitcases. Nicely proportioned, the Model A "Woodie" makes a sharp street and surf rod surf rod as well as a collector's showpiece

## '29 FORD PICK-UP This kit may be built in one of four versions

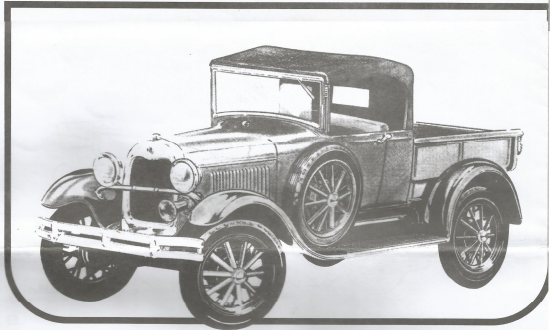

The more popular Model A pickup came both as a roadster and closed top vehicle. Our hardy grand-parents were more used to the great outdoors hence the drop-top pickup. Used on the farm then as now, the ever popular pickup was found from border to border and coast to coast fulfilling all sorts of duties. As

sporty looking as it was (and is) useful, many a roadster pickup became a hot rod of the roaring twenties as well as a street rod of today. Of course a nicely restored roadster-pickup will win a ribbon or two at any collectors meet and gladden the heart of the avid restorer.

Ford Oval and nameplates are registered trademarks owned and licensed by Ford Motor Company. Manufactured by RC2 Brands, Inc. Le logo Ford et les citations mentionnées sont des marques de commerce enregistrées appartenant à et sous licence de Ford Motor Company. Fabriqué par RC2 Brands, Inc. ©2007 RC2 Brands, Inc. Tous droits réservés. RC2 Brands, Inc. est une marque de commerce de The Goodyear Tire & Rubber Company, Akron, Ohio, USA sous licence de RC2. ©2007 RC2 Brands, Inc. Todos los derechos reservados. RC2 Brands, Inc. es una marca de comercio de The Goodyear Tire & Rubber Company, Akron, Ohio, E.U. Usado bajo licencia por RC2.



### IMPORTANT

Before you begin assembling your model kit, study the instruction sheet carefully. This will help you to familiarize yourself with the location of parts. Follow the instructions carefully and "TEST FIT" parts before cementing them into place. It may be necessary to remove excess "FLASH" from some parts in order to achieve proper fit, a sharp hobby knife or a file work best.

If you wish to paint your model, various sub-assemblies and components should be painted before any plated or "CHROME" parts are attached.

These kits are molded from the finest high-impact styrene plastic. Use only paints and cements which are specifically formulated for styrene. It is important to read all labels and warn-

### ADVANCED MODELING

For the best possible finish you should paint your model, even if it is molded in color. Several thin coats of paint will look a lot better than one heavy coat. The first coat of paint should not cover the surface completely. Instead, allow it to dry and sand with 600 emery wet or dry sandpaper that is slightly damp. Be sure to wash your parts before painting. This removes the mold release agents that may be used in manufacturing, oil from your fingers and dust that is attracted to plastic by static electricity. Use a mild solution of dishwashing detergent and water, rinse with lukewarm water and air dry. You should sand between each coat of paint except for the last which is your finish coat. Be careful not to sand off any detail. The final coat of paint may

be polished to a high luster after the paint has dried all the way through, at least for three days. Use an automotive paste cleaner/wax, not a polishing compound. Model paint is "softer" than regular automotive touch-up paint, even when dry. A clear coat may be applied over the finish coat to enhance the gloss of the finish. If you do this, be sure to wash the wax off, using a dish detergent/water solution and rinse as described above. You should also rinse the parts with lukewarm water between sanding and painting to remove residue, use a tack rag to dry, do not use paper towels or tissue. You may wish to prepare your parts before painting. Sand and file away "parting lines", sand glue joints to hide the seams and

### ENGINE ASSEMBLY

#### STOCK

Assemble the engine parts as shown.

4 200 CU. IN. CYLINDER FLATHEAD FORD ENGINE

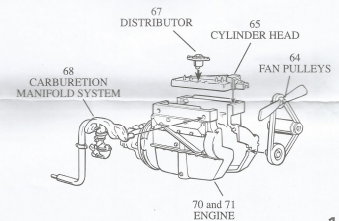

Paint the assembled engine black.

1A

### WHEEL ASSEMBLY

#### STOCK

Cement both halves of the wheels together, be careful to align the spokes as shown. Slip the tires onto the wheels. Assemble five sets.

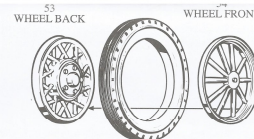

ALIGN SPOKES

2A

### CHASSIS ASSEMBLY

#### STOCK and CUSTOM

Cement the assembled engine to the chassis, and assemble the remaining parts shown.

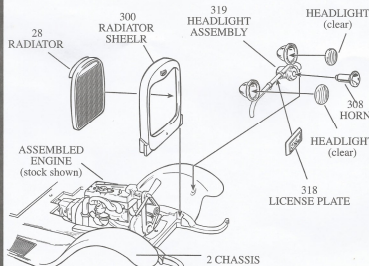

Paint the radiator and chassis gloss black

3

#### STOCK and CUSTOM

In order to allow free move using cement during this step. Slip the KING PINS to the AXLE and Cement the pins to the axle the king pins. "HEAT SWAP" Slip the BRAKE DRUM (see area) and press the assembly cement the brake drums to the

Paint all front suspension parts flat black

#### STOCK and CUSTOM

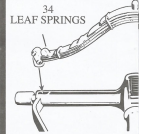

ings carefully, and put the lids back on between each use. These products should only be used in well ventilated areas.

Because these cements will only adhere to bare plastic it is necessary to remove the paint and the plating from those areas to which cement is to be applied. Use cement sparingly and avoid getting cement onto exposed surfaces.

## TIPS

lightly sand or scrape all corners and edges of parts as paint tends to draw away from sharp edges. Filler putty designed for plastic may also be used to fill small gaps and blend contours between assembled parts. A little care makes a big difference in finished appearance.

For painting two-tone bodies, paint the lightest color first and let it dry for at least 24 hours. Using frosted or "magic" tape and paper, mask the area you don't want painted. Apply the second color and remove the masking as soon as the new paint is dry to the touch. Carefully touch up the paint edges with a small brush if necessary. A gloss coat may be applied to even out the two paint surfaces after the second color is dry.

### HEAT SWAGE



When heat swage is indicated, this means to heat the tip of the knife in a candle or match flame. When touched to the plastic, plastic will soften and form a "mushroom" head.

### MODEL KNIFE



Use a good sharp model knife to trim and detach plastic parts. Some parts will appear to have extra "tabs" on them - cut these off.

CAUTION: Read all labels on cements, paints and thinners carefully before you begin.

## ASSEMBLY

### CUSTOM

Assemble the engine parts as shown.

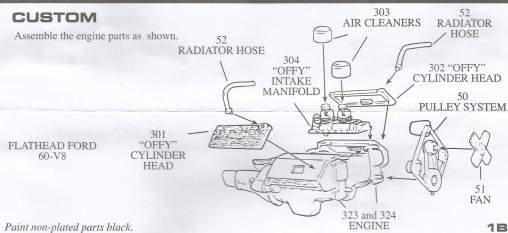

Paint non-plated parts black.

## ASSEMBLY

### CUSTOM

Cement both halves of the wheels together and slip the tires onto the wheels. Assemble two sets using wheel backs 47 (front) and the rear-

and wheelbacks 46 (rear)

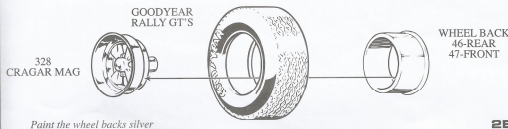

Paint the wheel backs silver.

## ASSEMBLY

### CUSTOM

ent, remember to be very careful assembly. Carefully position the slip the AXLE PINS into place. Do not allow cement to affect the TIE ROD to the king pins, the axle. (NOTE: "NOTCHED" wheels onto the axle. Carefully wheel backs.

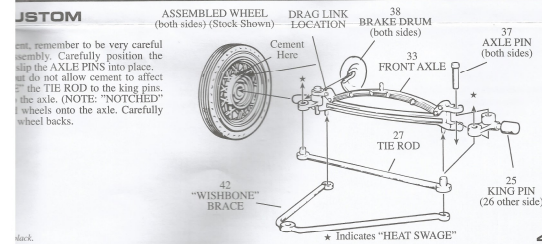

### CUSTOM

Assemble all parts as shown.

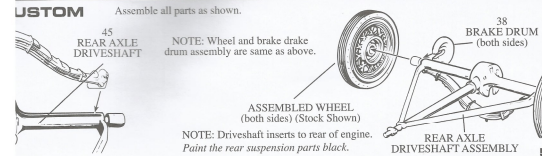

## CHASSIS ASSEMBLY

### STOCK

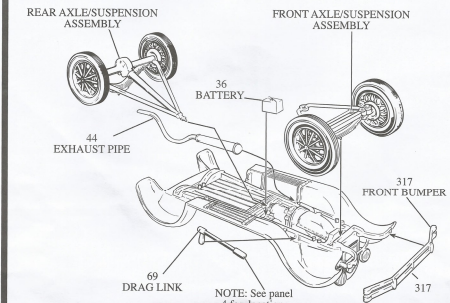

Paint all non-plated parts black.

### CUSTOM

CUSTOM

REAR A

Paint the black...

## STATION WAGON

### DASH ASSEMBLY STOCK

Assemble the parts as shown.

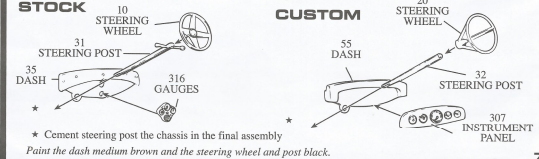

\* Cement steering post the chassis in the final assembly

Paint the dash medium brown and the steering wheel and post black.

### FLOOR PAN ASSEMBLY

Assemble the interior parts as shown.

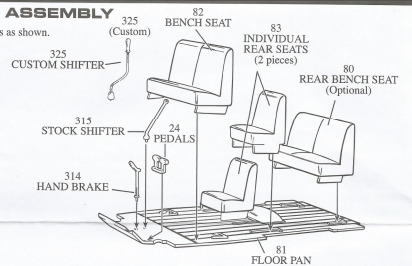

Paint the seats dark brown and pedals black.

### BODY ASSEMBLY A

Assemble the parts as shown

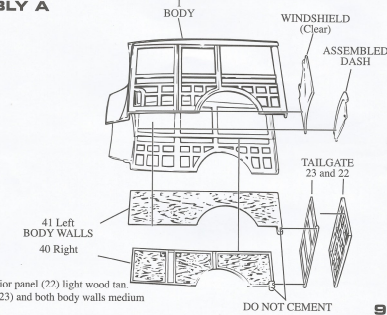

Paint the body and tailgate exterior panel (22) light wood tan. Paint the tailgate interior panel (23) and both body walls medium wood tan.

## SEMBLY [cont.]

OM

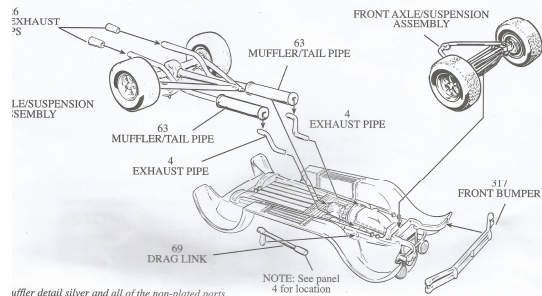

After detail silver and all of the non-plated parts

6B

## ON ASSEMBLY

### BODY ASSEMBLY B

Insert the STEERING POST through the hole in the dash before cementing the floor pan into the body.

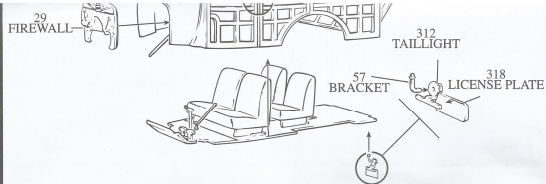
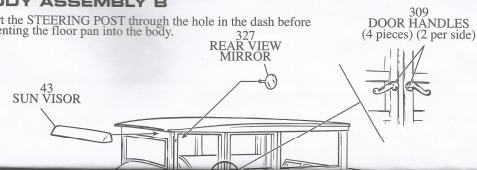

Paint the sun visor and the firewall black.

10

### FINAL ASSEMBLY

Assemble the parts as shown. Please note the spare tire and bracket are only to be used on the stock version, also the optional tailgate chains.

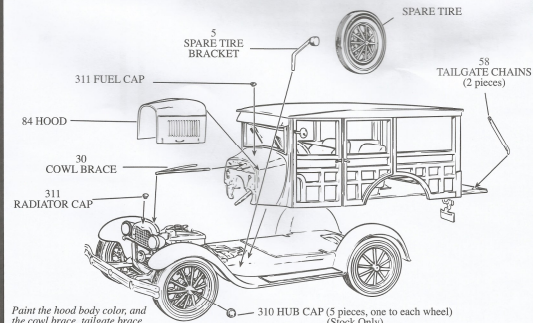

Paint the hood body color, and the cowl brace, tailgate brace and spare tire bracket black.

11

Printed in China • Imprimé en Chine

## PICKUP ASSEMBLY

### FLOOR PAN ASSEMBLY

Assemble the parts as shown

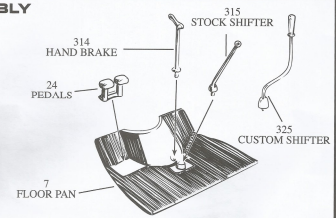

Paint the floor pan and pedals black.

7

### BODY ASSEMBLY

Assemble the parts as shown.

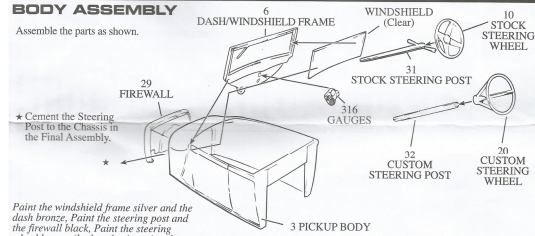

\* Cement the Steering Post to the Chassis in the Final Assembly.

Paint the windshield frame silver and the dash bronze. Paint the steering post and the firewall black. Paint the steering wheel bronze (body color is optional).

8

### FINAL ASSEMBLY

Spare tire and bracket are only used on Stock Version.

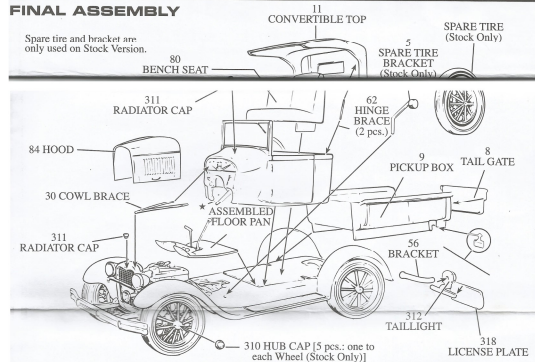

9

### BICYCLE ASSEMBLY

Assemble as shown, be careful not to get cement on the handlebar when you cement the frames together.

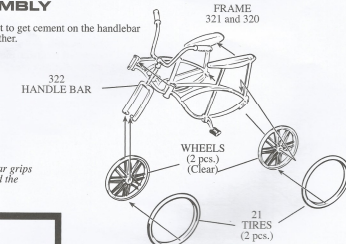

Paint the tires and the handlebar grips black. Paint the seat yellow and the frame red.

10



©2007 RC2 BRANDS INC. 2021 9th Street SE, Dyersville, IA 50540 U.S.A. All Rights Reserved. / Tous droits réservés. Made in China. / Fabriqué en Chine. Visit our website at [www.RC2RTL.com](http://www.RC2RTL.com) / Visitez notre site web au [www.RC2RTL.com](http://www.RC2RTL.com)