

1:48 SCALE P-51

ALLISON ENGINE MUSTANG

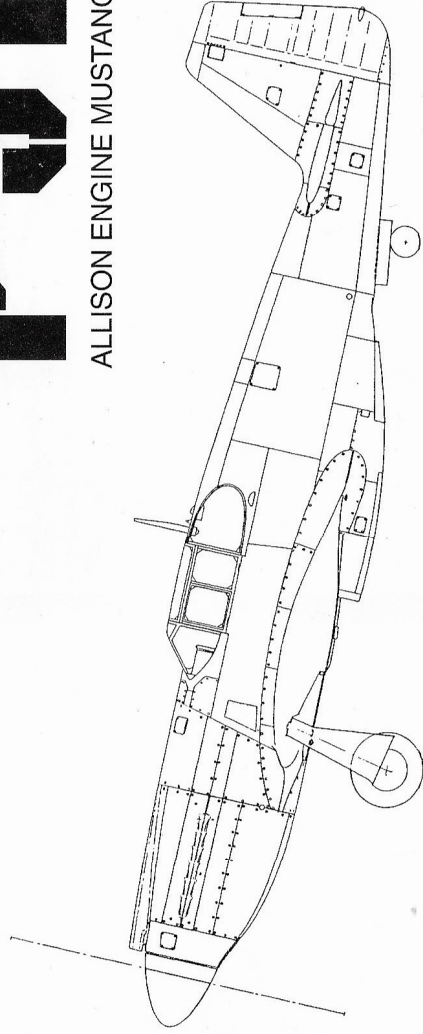

**ACCURATE
MINIATURES®**

This highly detailed replica has been extensively researched and represents the state-of-the-art in kit manufacture. In order to increase your enjoyment of the building process, we have provided instructions that are both instructive and informative. Consulting any of the many Mustang reference works will enable the builder to enhance their efforts. Now, follow along and you'll discover the workings of one of aviation's most famous aircraft.

This instruction sheet has been sequenced to help you assemble this airplane in a simple and straight-forward manner. You may wish to vary the construction and painting sequence slightly to suit your building methods, but our experience has shown the recommended sequence to work best. It also allows for small fragile parts to be added last to prevent breakage during assembly. Accurate Miniatures welcomes your comments and suggestions to make future releases even more fun. Accurate listens!

RECOMMENDED PAINTS

To help you paint your P-51 we've included a list of recommended colors. These colors are cross referenced to the Federal Standard (FS) numbers where possible. Many model paint companies match their products to this system, and the modeler may also choose to match their favorite paint to these numbers. Your local hobby shop retailer can be of assistance in helping you select the proper paint for this kit, or you may consult the listing of paints on the painting guide.

Flat Black	FS37038	Insignia Yellow	FS33538
Flat White	FS37875	Gloss Red	FS11136
Aluminum	FS17178	Gloss Green	FS14187
Olive Drab	FS34087	Gloss Orange	FS12197
Neutral Grey	FS36270	Gunmetal	No Match
Zinc Chromate	FS34227	Burnt Metal	No Match

Start the assembly with the cockpit area. Pre-paint as much as possible as there are many small parts that will be hard to get to later. Glue **Part 15** (the control stick) to **Part 19** (the cockpit floor). Glue **Part 19** (the pilot's seat) to **Part 20** (the seat frame). Set aside for later installation. Next, do the instrument panel. This piece is a little different from panels you've seen before. You have a choice as to how you finish it. We have attempted to give you the most realistic panel possible. Start by painting the front of **Part 60** (the instrument panel) as indicated in the painting instructions. Do not paint the instrument "glass" area. Allow paint to dry. Now apply the **instrument panel decal (A)** to the **back** of the painted panel. Carefully align the decal until the dials show through the "glass" areas. This piece may also be painted completely and the instrument dials highlighted with silver paint. The option is yours. Put aside for later installation.

Seat -- Zinc Chromate
 Floor -- Zinc Chromate
 Seat Frame -- Zinc Chromate
 Stick -- Olive Drab
 Handle -- Flat Black
 Instrument Panel -- Flat Black (see written instructions)
 Rudder Pedals -- Aluminum

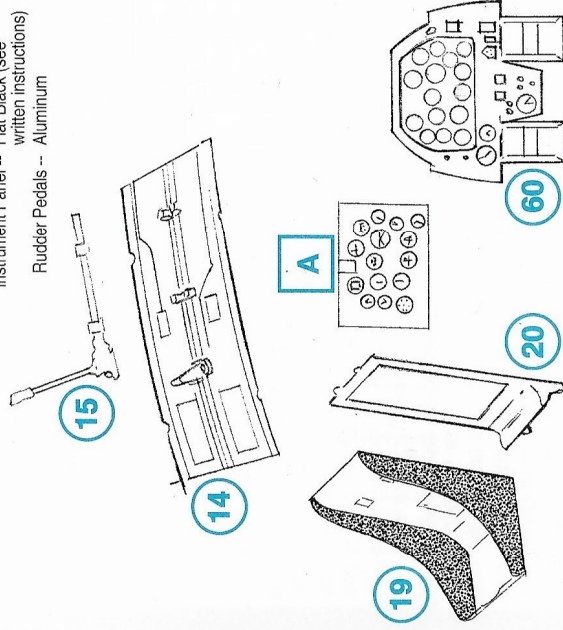

Now assemble the fuselage. Start by painting the interior of **Parts 1** and **2** (the left and right fuselage halves). Paint and install **Part 17** (the right console). Glue **Part 30** (the batteries) and **Part 31** (the radio) to the right fuselage half. Place the radio against the **bottom** of the horizontal stringer and against the **back** of the forward vertical former. Carefully align and try to keep these parts level. Glue the cockpit floor to the bottom of **Part 17**. Keep the floor level in the fuselage. Glue **Part 16** (the left console) to the left fuselage half. Add **Parts 33** (the bomb release and landing gear levers) to **Part 16** in the locating holes. Glue the assembled instrument panel to the right fuselage half. The face of the panel rests against the forward edge of the right side console and rudder pedals rest on the cockpit floor. Check alignment of all parts. Now glue **Part 32** (the radiator exhaust door) to the right fuselage half. The long side glues to the bottom of the locating shelf. Keep level. Paint and glue **Part 22** (the tail wheel) to the right fuselage half. Now, after a final check of alignment, glue the fuselage halves together. Next, carefully glue **Part 13** (the roll-over frame) to the two locating tabs on the left and right side consoles and to the forward edge of the top of the fuselage halves. The seat assembly may now be added. Locate the seat frame to the two holes in the cockpit floor. Align and glue the two tabs on the top of the seat frame to the roll-over frame. All of these parts will now line up correctly.

Now it's time to glue **Part 7** (the wing bottom) to the fuselage. **Part 5** (the top left wing) and **Part 6** (the top right wing) are now glued to the wing bottom. Apply slight pressure to all part seams to insure a tight fit. Glue **Part 50** (the radiator scoop) to the wing bottom and to the fuselage. Add **Part 3** (the left horizontal stabilizer) and **Part 4** (the right horizontal stabilizer) to the fuselage. Keep these parts horizontal and level to the fuselage. Glue **Part 53** (the left nose half) and **Part 54** (the right nose half) together. Add **Part 11** (the carburetor intake) to the nose halves. Glue the nose assembly to the completed fuselage. Painting the prop and spinner and adding it to the nose at this time is your option. You may wish to carry out this step after painting the entire airplane to make painting and assembly easier. Assemble the propeller as follows: place **Part 10** (the spinner back) on the propeller shaft. Add **Part 18** (the propeller). Do not glue these pieces. Carefully glue **Part 12** (the propeller retainer) to the propeller shaft. Don't get glue on the prop or it won't spin. You may now glue **Part 9** (the spinner) to the spinner back.

We recommend that you now paint and decal your model. Doing this now will allow you to add the smaller detail parts with less risk of damage. After allowing time for the paint and decals to dry thoroughly it's time to move on to the landing gear.

Glue **Part 27L** (the left landing gear strut) and **Part 27R** (the right landing gear strut) to the wheel wells. Check alignment from all angles. The wheels and tires have been molded as separate pieces to make painting easier. Now is the time to paint the wheels and tires. Glue **Parts 26** (the outer wheel--large spoke) and **Parts 25** (the inner wheel -- small openings) to the tires of your choice. We offer a choice of **Parts 23** (unweighted) or **Parts 24** (weighted) tires. Glue the wheels to the landing gear axles, making sure the weighted tires sit flush on your display surface. Paint and add **Part 29L** (the left landing gear door) and **Part 29R** (the right landing gear door) to the wing bottom and landing gear struts. Now paint and glue **Part 28L** (the left wheel door) and **Part 28R** (the right wheel door) to the wing bottom. Glue **Parts 42** (the wheel door actuators) to the door and into the holes in the wheel wells. Add **Parts 35** (the rear wheel door cables) to the rear of the wheel wells and the wheel well doors. The wheel doors may be glued shut or they may be placed in a near-vertical position or anywhere in between. On the full-sized airplane these doors were operated hydraulically. As this system "bled down" after the engine shutoff the doors dropped to a vertical position. When the engine was started and the hydraulic system became pressurized the doors immediately returned to the closed position.

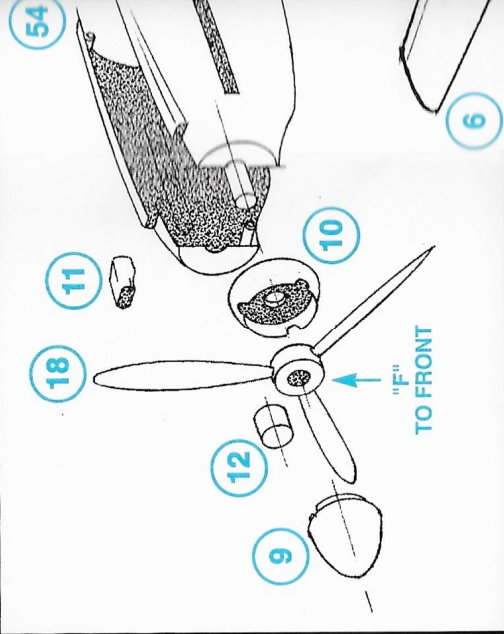
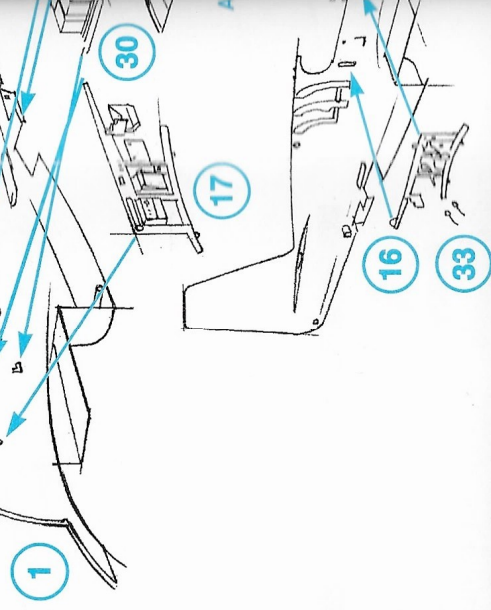

Fuselage Interior -- Zinc Chromate
 Side Consoles -- Olive Drab with Aluminum and Flat Black details
 Radio -- Zinc Chromate with Flat Black batteries
 Tail Wheel -- Aluminum with Flat Black tire
 Roll-over Frame -- Zinc Chromate
 Propeller -- Flat Black with Yellow tips
 Spinner -- Insignia Red
 Wheel Wells and Door Interiors -- Zinc Chromate
 Wheels -- Aluminum
 Tires -- Flat Black
 Landing Gear Actuators -- Aluminum

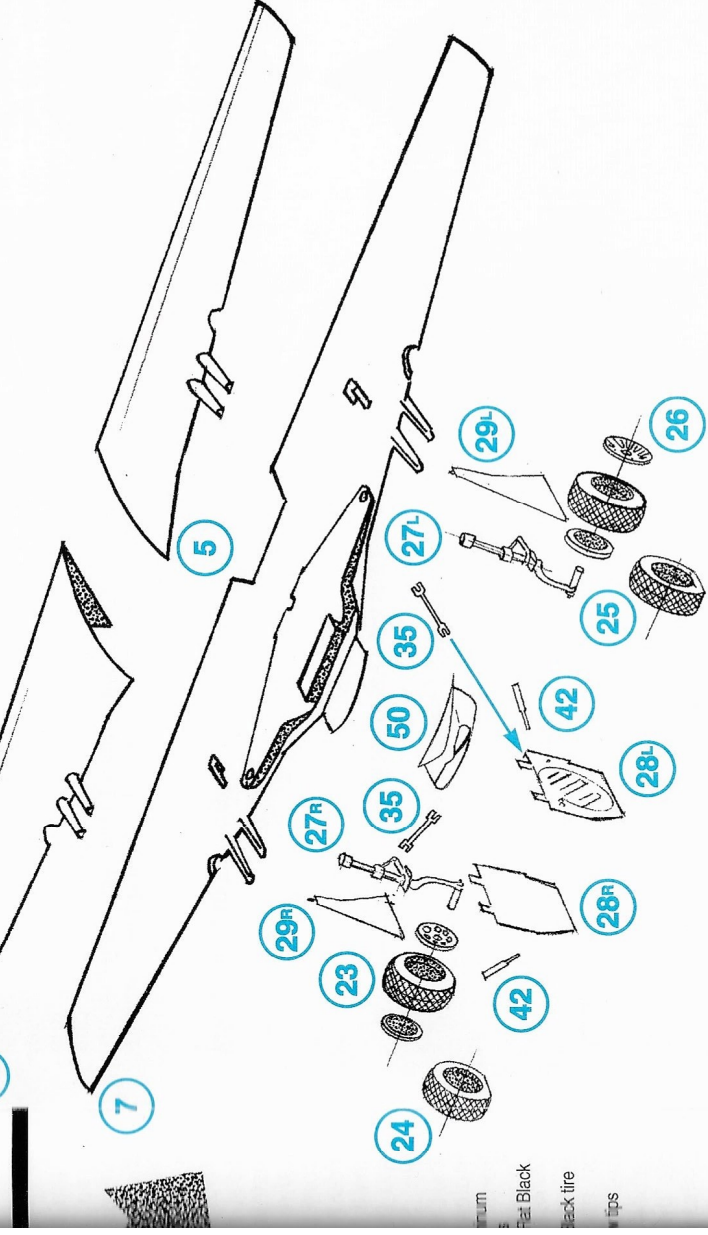
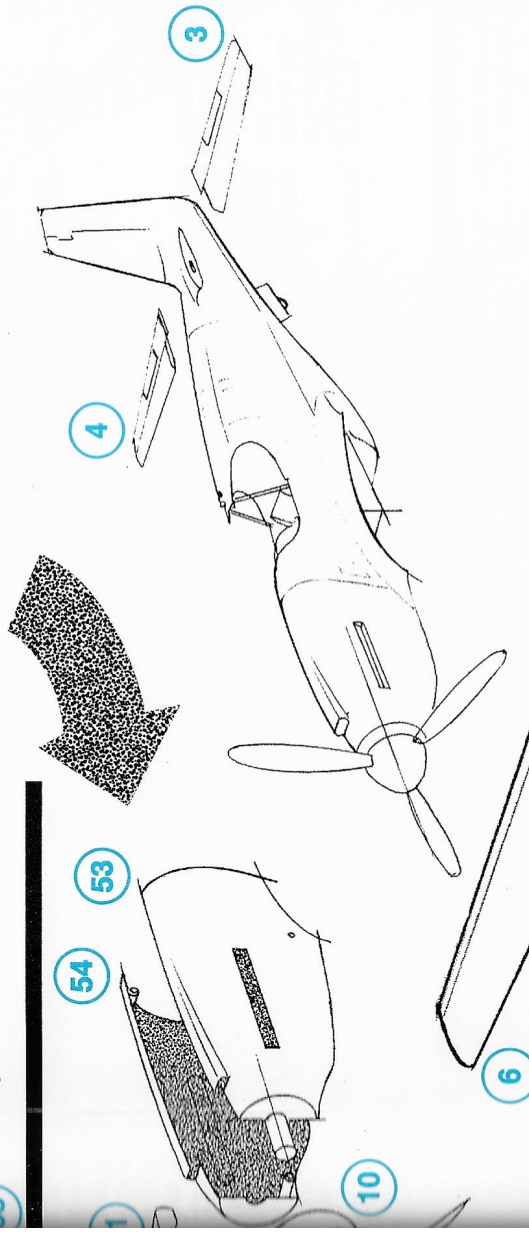
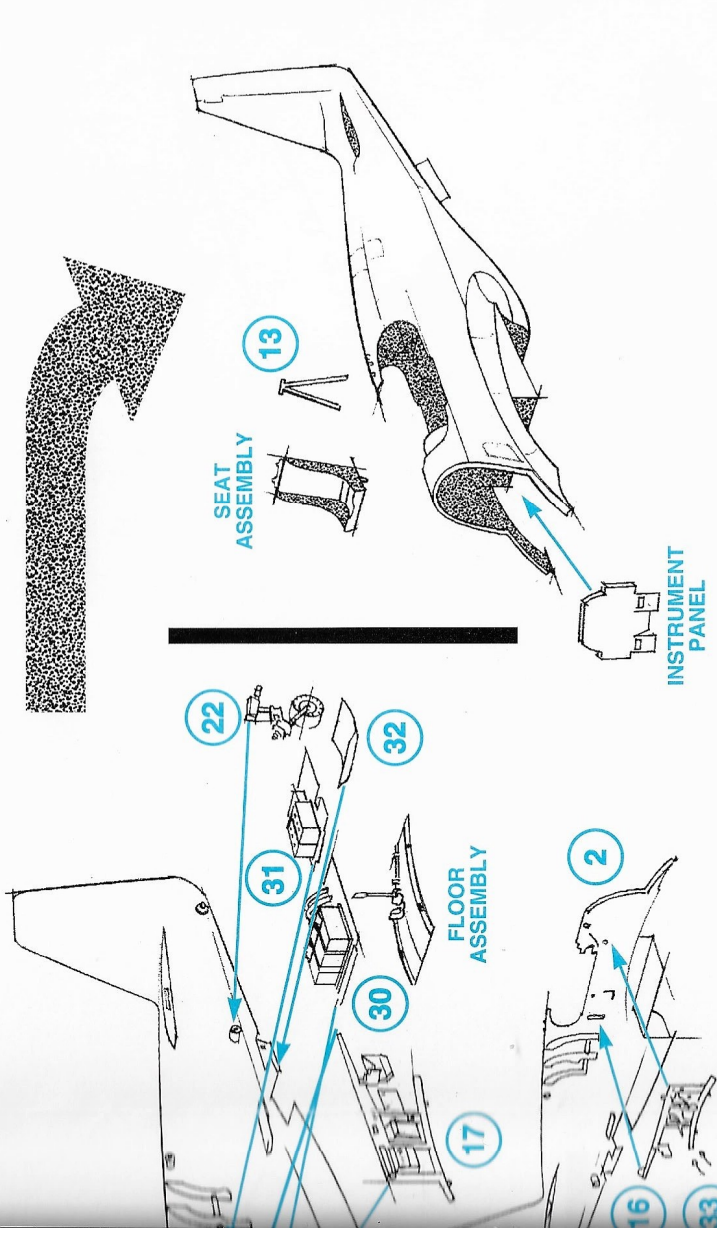

2000
 Fat Black
 Black tire
 tips

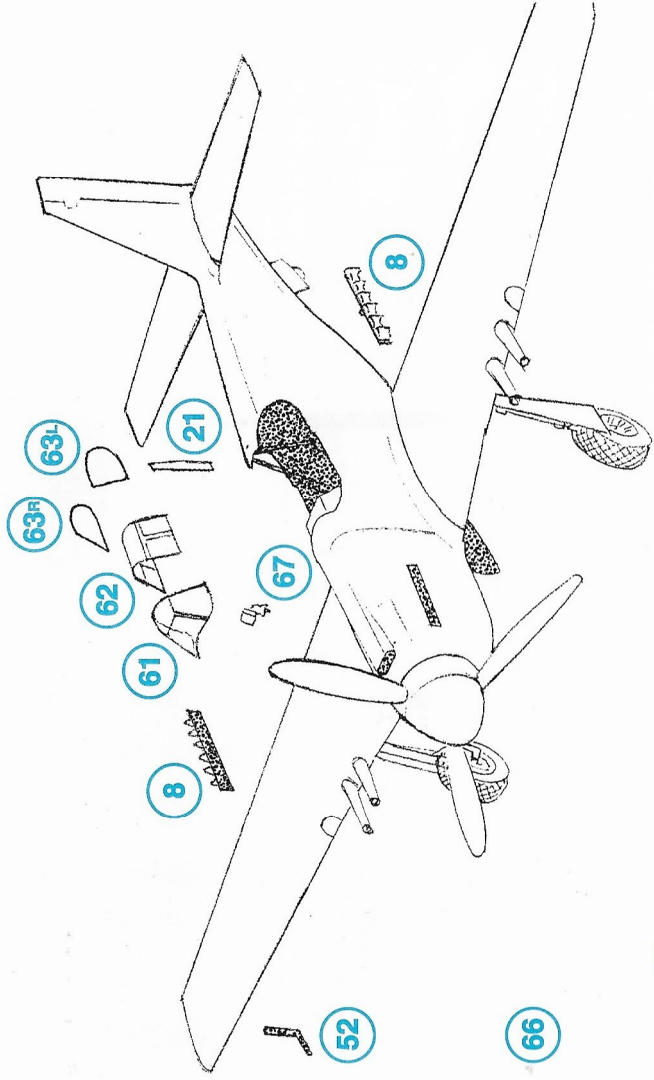

51

65

- Exhausts -- Burnt Metal/Rust Color
- Cannons -- Gunmetal
- Gunsights -- Flat Black with clear reflector portion
- Pitot Tube -- Aluminum
- Wing Tip Lights -- Red/Left, Green/Right
- Formation Lights on Bottom of Right Wing, Front to rear -- Red/Orange/Green

Now paint and glue **Parts 8** (the exhaust stacks) to the fuselage. Insert **Parts 65** and **66** (the landing lights) into the leading edge of the wings. We recommend using white glue or clear epoxy paint to prevent glue smearing or frosting. This method may be used for all of the remaining clear parts. Now add **Part 63L** (the left rear window) and **Part 63R** (the right rear window) to the fuselage. Carefully glue **Part 67** (the gunsight) to the notch at the tip of the cockpit dash. Add **Part 61** (the windshield) and **Part 62** (the canopy) to complete the cockpit area. Glue all four **Parts 51** (the 20mm cannon) to the wings. Align the guns. Glue **Part 52** (the pitot tube) to the right wing bottom. You may now glue **Part 21** (the radio antenna) to the tip of the fuselage. After this part is completely dry you may wish to add a radio antenna as shown on the box top.

Now it's time to stand back and admire your work. ACCURATE MINIATURES has done their best so you can do **your** best and make you proud of your efforts.



If you have a parts problem or questions we want to know. Identify the missing or defective part by its number and write us at:

ACCURATE MINIATURES, 100 Centre Street, Charlotte, NC 28216

This P-51 kit represents the first USAAF version of the famous Mustang fighter series. These Allison-engined airplanes were developed and flown in 1940 in an incredible 120 days after the British Purchasing Commission requested a fighter to help stave off the Nazi attacks on Great Britain. Over the years some confusion has existed over the correct name for this series of planes. The U.S. version was originally called the Apache, but these aircraft eventually adopted the British name "Mustang". The Army Air Force ordered 150 of these aircraft. They differed from the prototype and British plane by having four 20mm cannons instead of the mixed caliber British armament and carried American radio and oxygen equipment.

P-51

The P-51's served with the USAAF almost exclusively in the North African, Mediterranean and Italian campaigns. Many of these machines were flown as tactical reconnaissance aircraft. Cameras and cannons ... a lethal combination.

The P-51 was the first in the line of Mustangs. It was to be followed by the A-36 dive bomber/fighter and the P-51A. Both of these kits are available from ACCURATE MINIATURES in 1:48th scale.

This P-51 is finished in the colors of an aircraft from the 154th recon squadron in Tunisia, 1943. Photographic evidence **PAINTING AND FINISHING** shows this plane to be painted in the standard USAAF

scheme of the time period for North Africa. The plane was painted olive drab over neutral grey with 18" insignia yellow Mediterranean theater i.d. bands over the top and bottom of the wings. During the early phases of Operation Torch, the invasion of North Africa, USAAF aircraft frequently carried large American flags on both sides of the tail. This particular aircraft was flown by K. F. Bush and carried the name of his "flame" on the left nose. Spinner colors varied from aircraft to aircraft and are subject to debate, but most evidence seems to indicate a red spinner appearing on this plane. If you wish to weather this aircraft we suggest you consult your Mustang reference. The few photos that exist of this aircraft indicated rugged conditions took their toll in the form of chipped, faded paint and dust. ACCURATE MINIATURES has included additional decals for use on a display base.

AIRCRAFT SPECIFICATIONS:

Length: 32 ft. 3 in.

Span: 37 ft.

Powerplant: Allison 1150 hp

Liquid-cooled V-12

Performance: 382 mph,

31,000 ft ceiling

Armament: Four 20mm cannons
with 500 rounds

Use your favorite paints to finish your model, then apply the decals to the locations as indicated. After allowing the paint and decals to dry completely, you may now choose to use one of the many popular techniques to weather your aircraft. Consult your hobby shop.

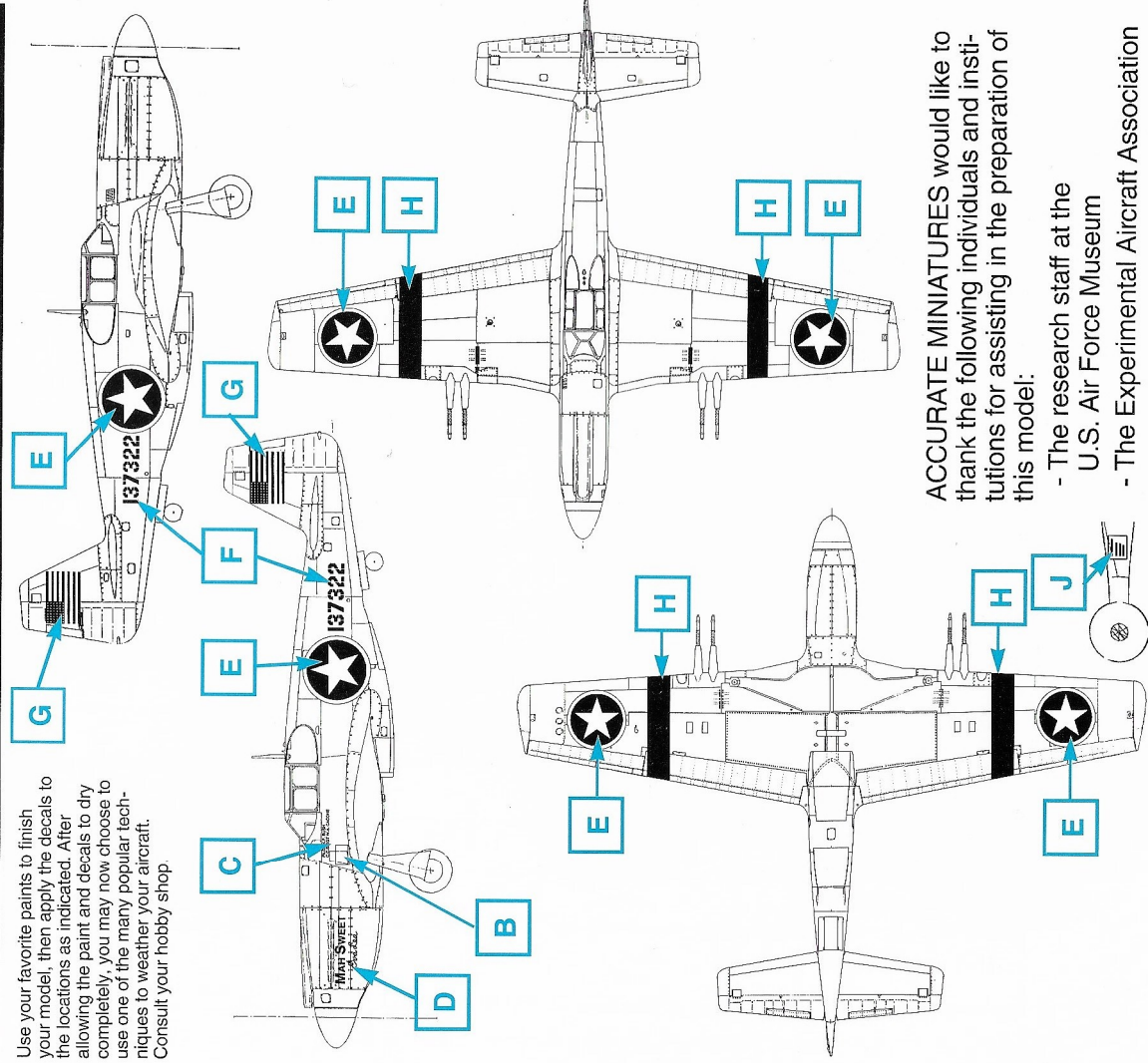

ACCURATE MINIATURES would like to thank the following individuals and institutions for assisting in the preparation of this model:

- The research staff at the U.S. Air Force Museum
- The Experimental Aircraft Association

3400-0220

MODEL PAINT REFERENCE CHART*

	Federal Standard	Model Master	Model Master Acrylic	Humbrol	Gunze Sangyo Aqueous	Gunze Sangyo Mr. Color	Tamiya	Polly S
Flat Black	37038	1749	5149	33	12	33	XF1	10
Flat White	37875	1768	5168	34	11	62	XF2	11
Aluminum	17178	1781	5181	11	8	218	XF16	1995
Olive Drab	34087	1711	5111	155	304	304	XF58	850
Neutral Grey	36270	1725	5125	176	306	306	XF20	809
Zinc Chromate	34227	1734	5134	120	312	312	XF4	802
Insignia Yellow	33538	1708	5108	154	329	329	XF3	40
Gloss Red	11136	2718	5318	19	3	3	X7	---
Gloss Green	14187	---	---	2	26	66	X5	---
Gloss Orange	12197	2731	---	18	14	85	X6	---
Gunmetal	---	1423	5195	53	18	214	X10	1999
Burnt Metal	---	1415	5169	---	76	61	---	1997

* This chart is provided only as an aid to the modeler and is the closest match possible from each paint manufacturer at time of printing