



F9F-8T/TF-9J Cougar/Twogor

1/72 Scale

SW 72101



The F9F-8 Cougar was a development of the F9F Panther carrier based fighter, having swept wings rather than straight wings.

The two seat F9F-8T trainer version of the Cougar, or 'Twogor' was a strengthened and lengthened F9F-8 with increased wing area and refuelling probe.
377 were delivered to the U.S Navy from 1956 to 1960.

The aircraft was armed with two 20mm (0.79 inch) cannons, and could carry a bomb or missile load.

In 1962 it was redesignated TF-9J and this was the only version to see combat when it served the U.S Marines Headquarters and Maintenance Squadrons at Da Nang and Chu Lai, as fast Forward Air Control in South Vietnam in 1966 and 1967.

The Cougars or 'Twogars' were replaced by the F11F Tiger and F8U Crusader in 1968-1969 although navy aircraft remained in service until 1974.

A modified version was rejected in favour of the TA-4F Skyhawk.

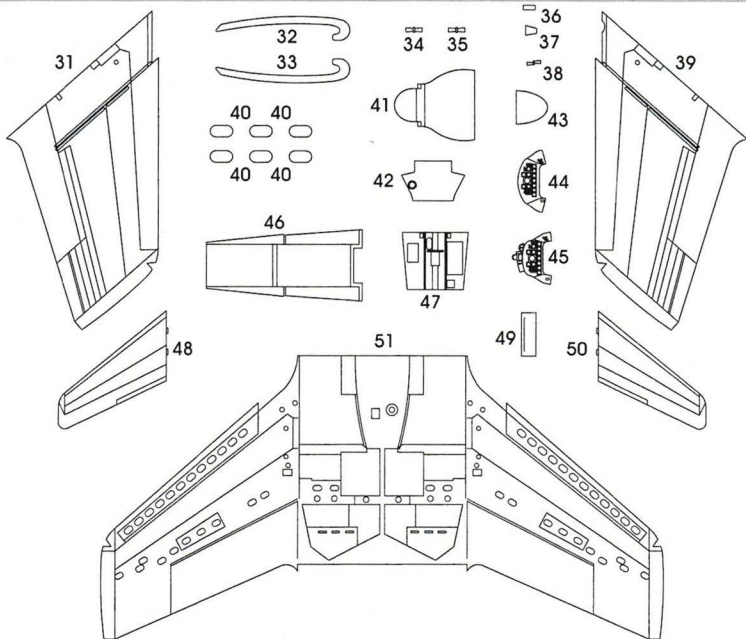
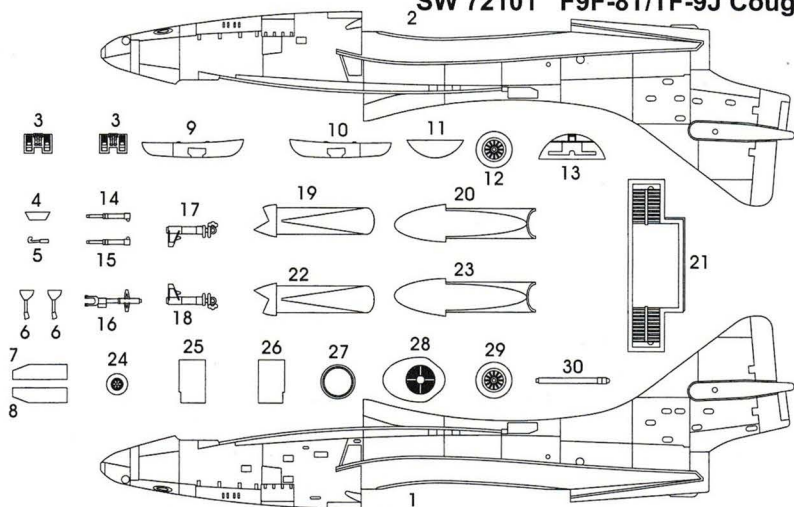

PUR díly/ PUR parts
*Lepit
 kyanoakrylátovým
 lepidlem/
 instant cyanoacrylate glue*

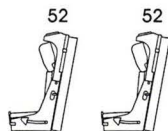

čiré díly/ clear parts

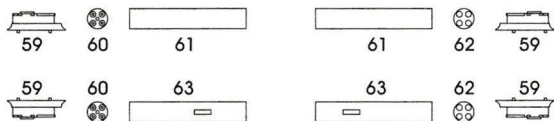
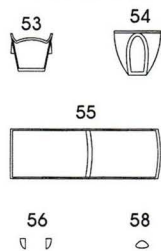

barvy/ colours

A	černá Black	F	šedočerná Tyre Black
B	bílá White	G	kovová tmavá Gun Metal
C	světle šedá Light Gray	H	opálený kov Burnt Iron
D	červená Red	I	chromová Chrome
E	hliníková Aluminium	J	hnědá kožená Brown Leather

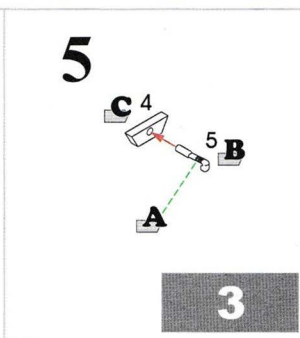
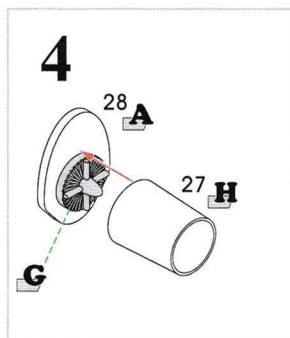
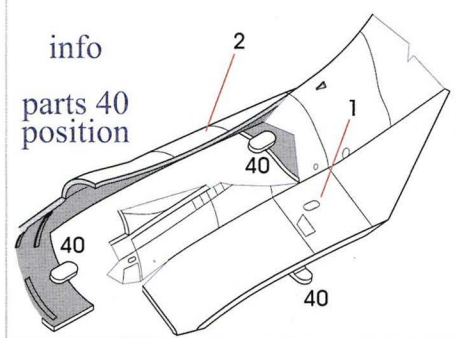
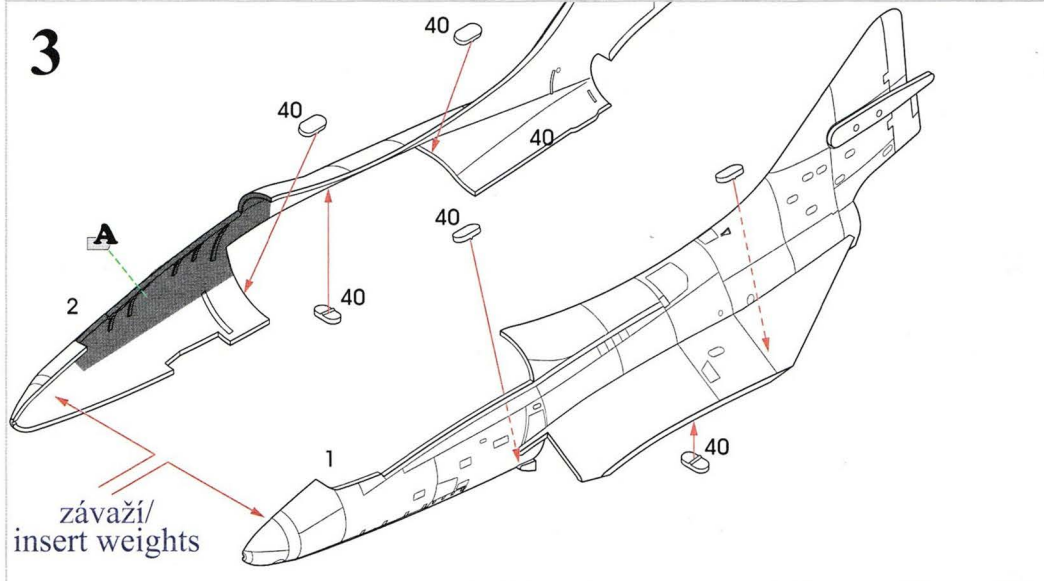
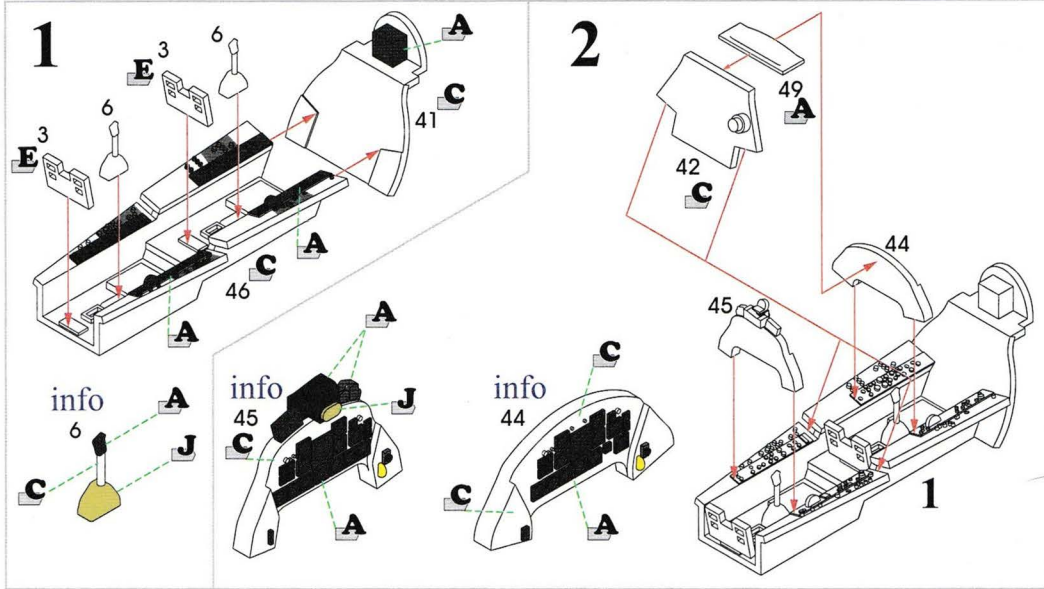

6

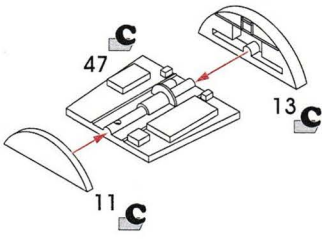

7

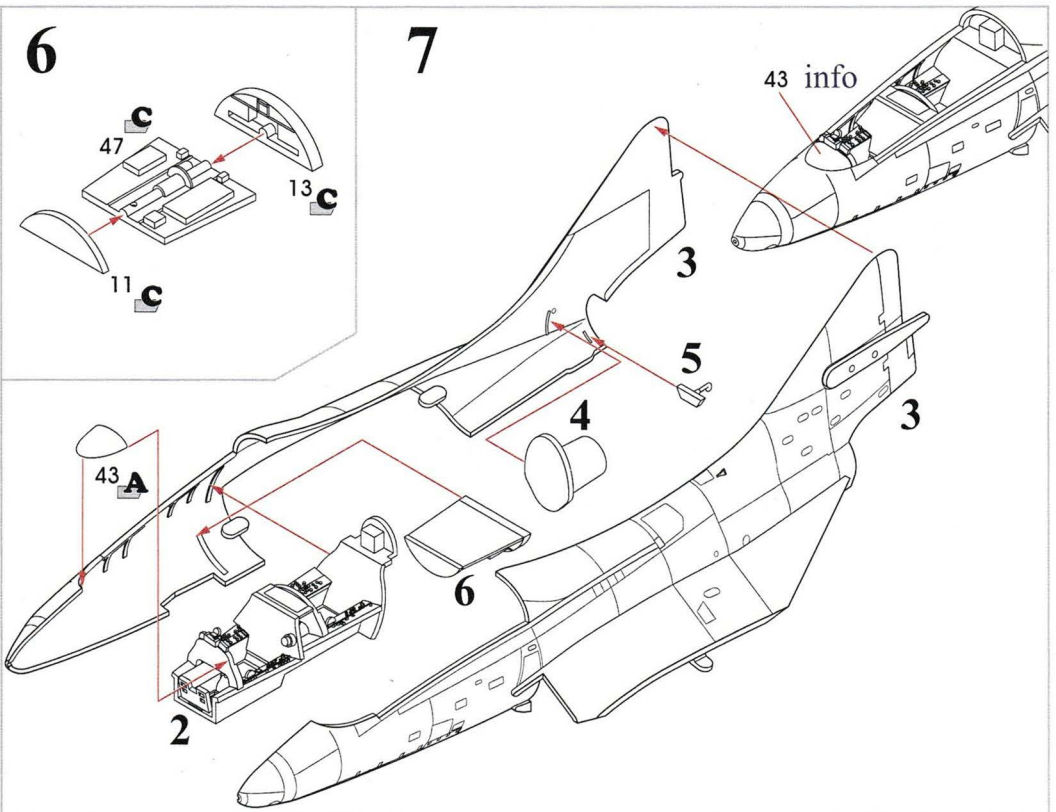

8

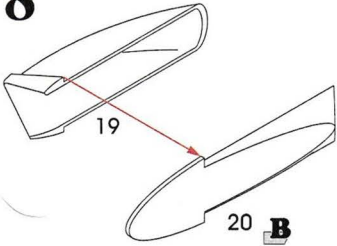

10

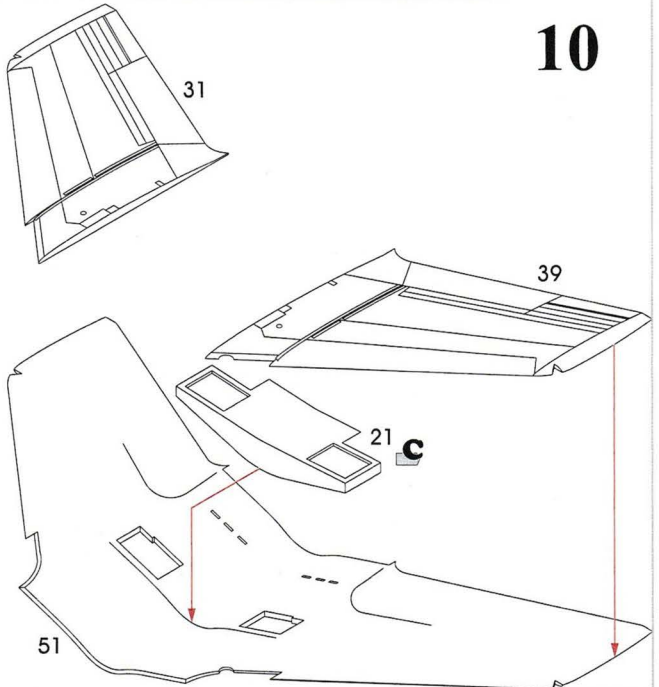

9

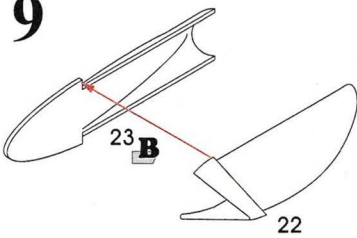

4

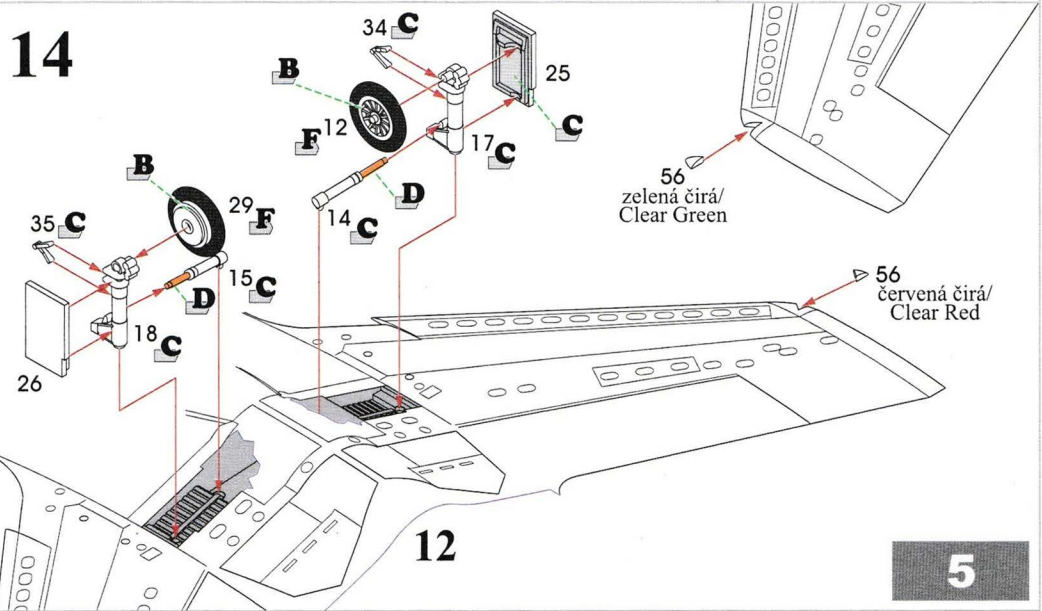
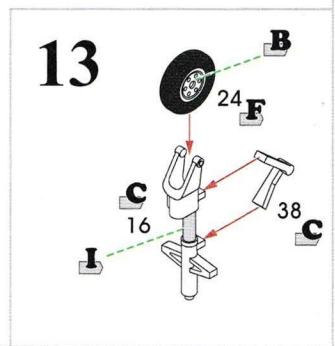
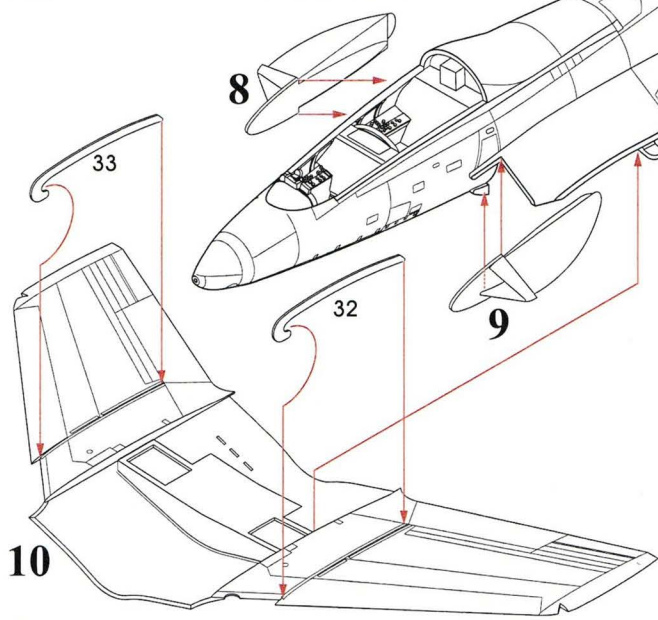
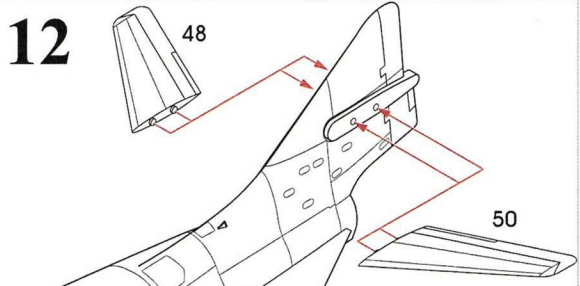
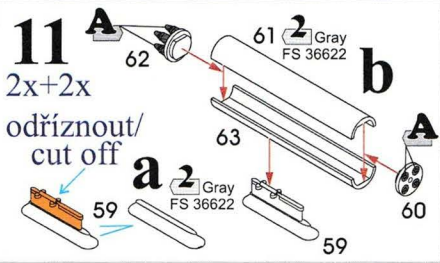

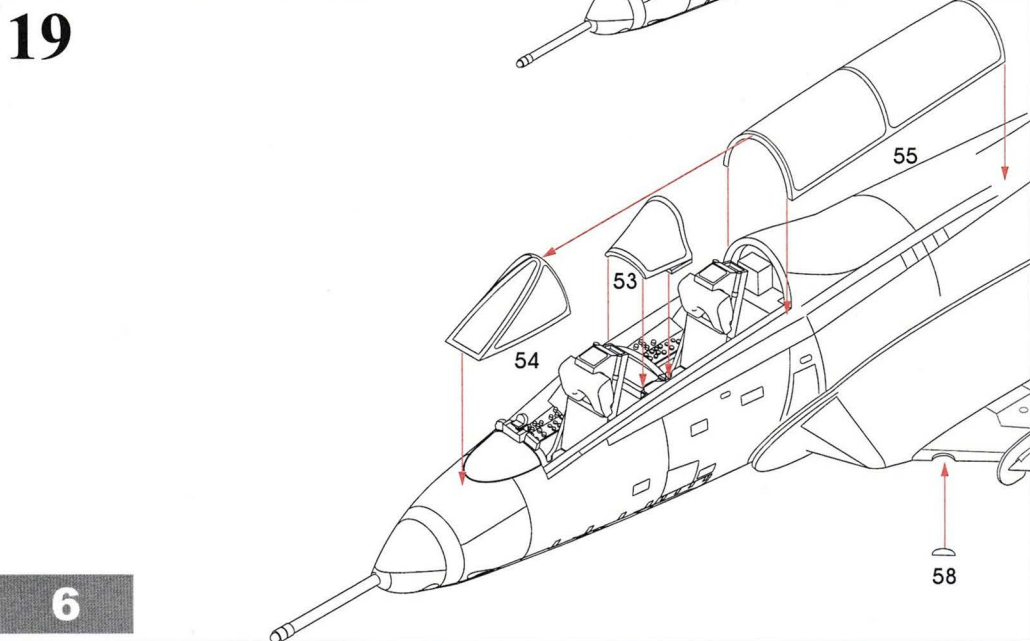
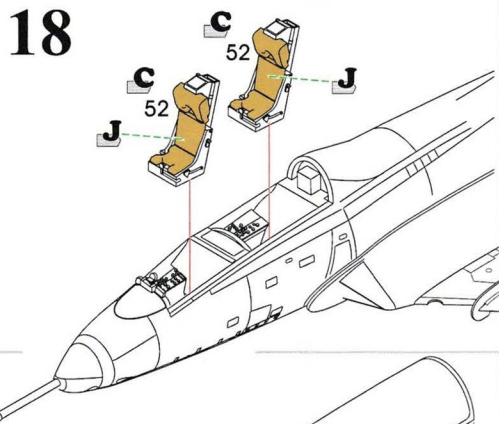
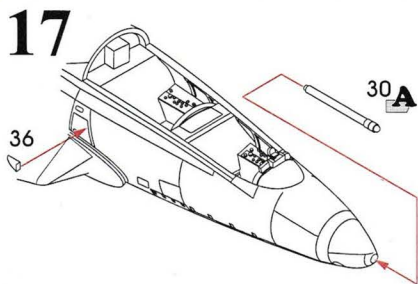
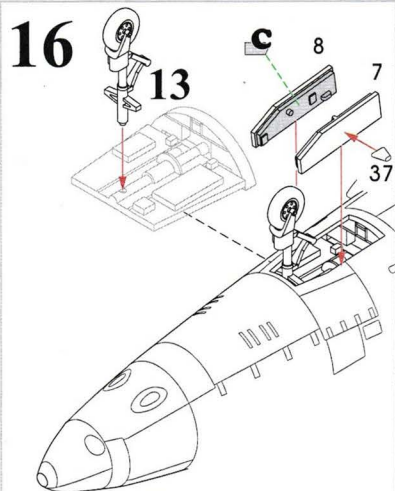
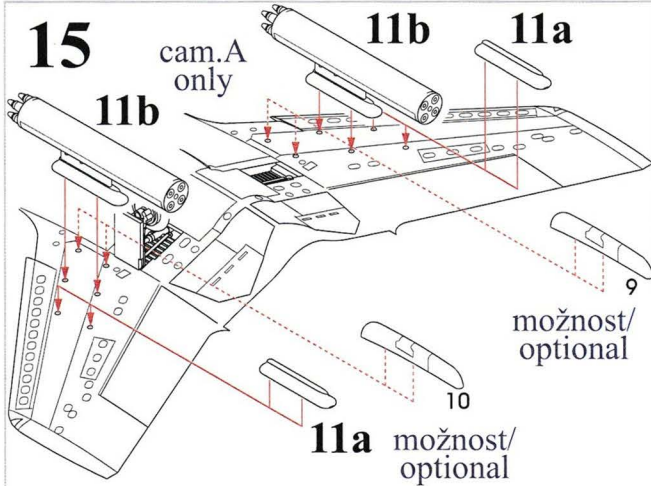

A TF-9J, 147384, H&MS-13, U.S. Marines, Vietnam 1967

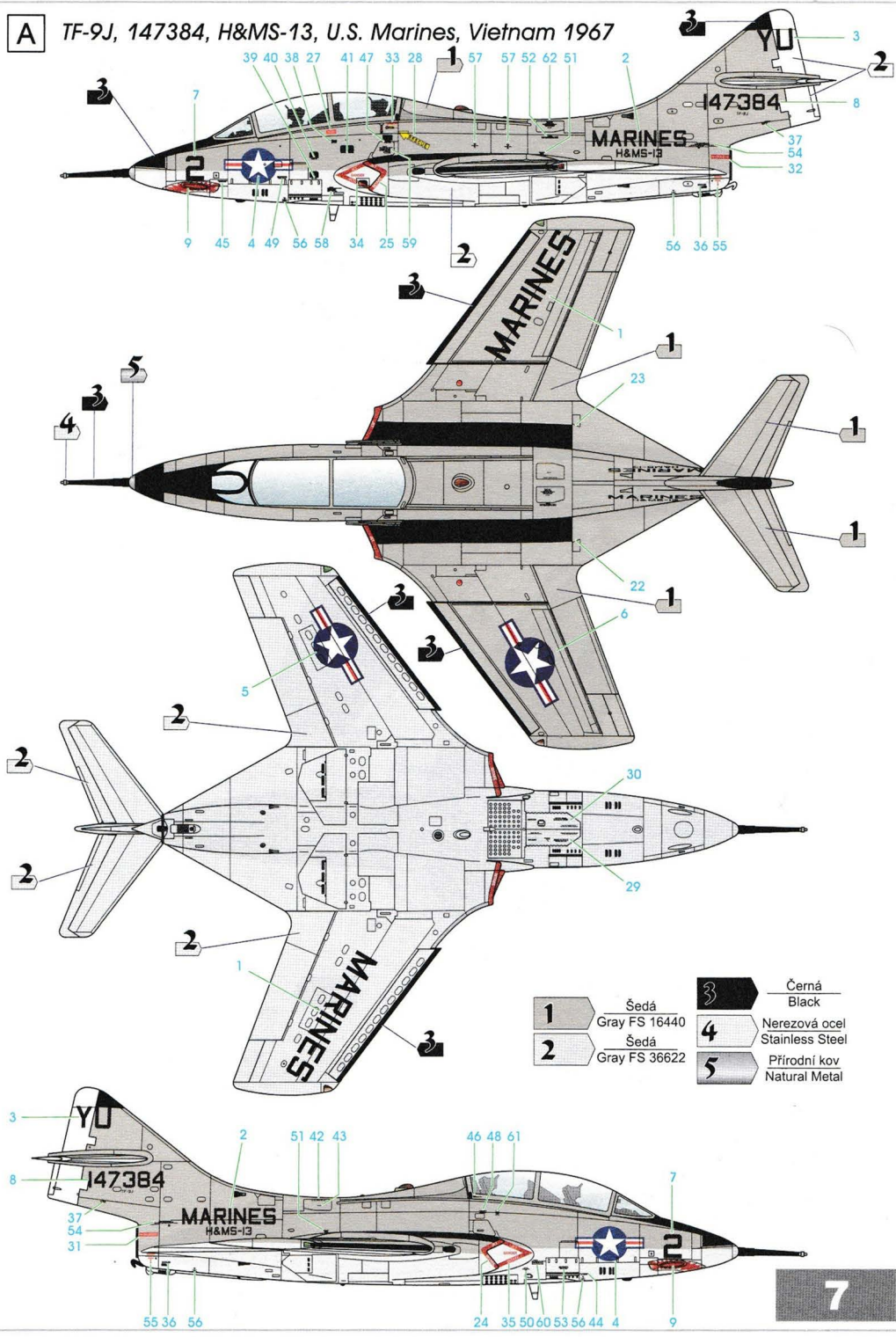

- | | | | |
|----------|-----------------------|----------|----------------------------------|
| 1 | Šedá
Gray FS 16440 | 3 | Černá
Black |
| 2 | Šedá
Gray FS 36622 | 4 | Nerezová ocel
Stainless Steel |
| | | 5 | Přírodní kov
Natural Metal |

B TF-9J, 142470, "Blue Angels", 1965

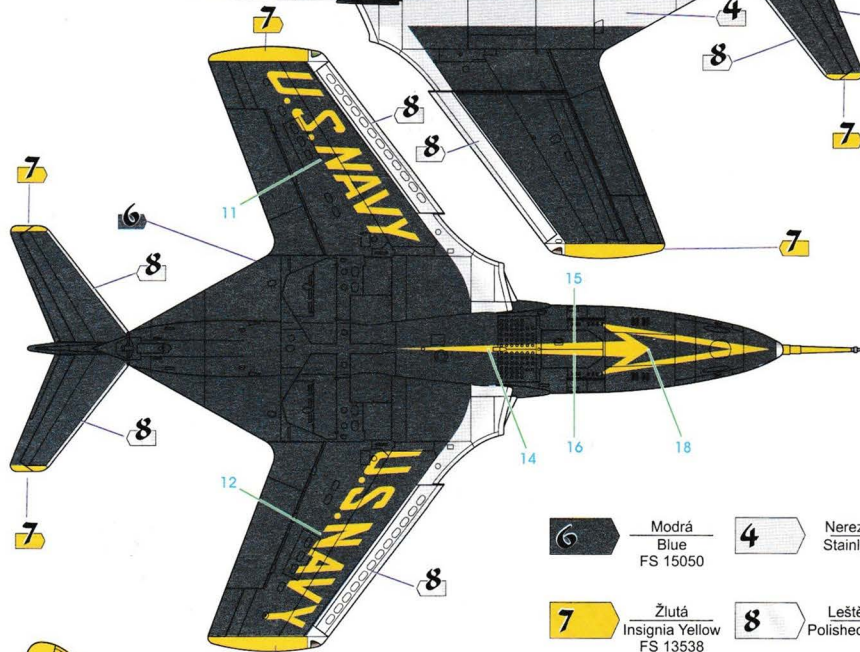
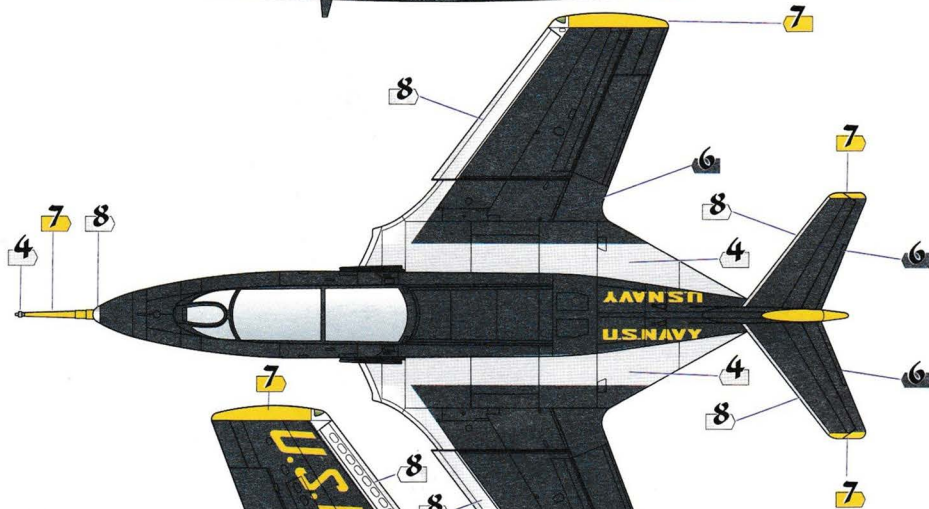
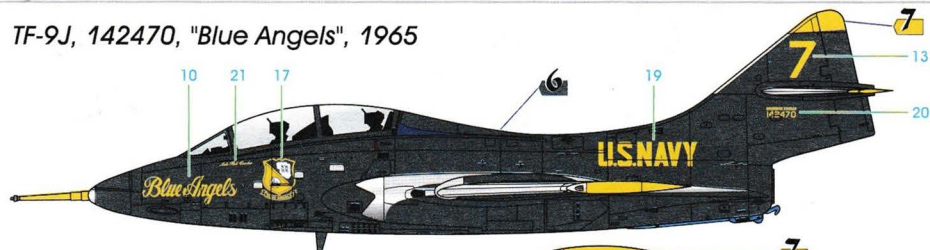

Modrá
Blue
FS 15050



Nerezová ocel
Stainless Steel



Žlutá
Insignia Yellow
FS 13538



Leštěný dural
Polished Aluminium

