

**G.W.H.**<sup>®</sup>  
LIMITED EDITION



**F-15E**

**SPECIAL PAINT SCHEMES OF  
EXPEDITIONARY EAGLES**  
鏖战中东! F-15E 远征作战特别涂装限量版



**1/48**  
SCALE **S4816**



# 1

## 弾射座椅组装 Ejection Seat Assembly 射出シートの組み立て

弾射座椅尼龙材质安全带为浅灰色 (C307)  
Paint safesbelt into light grey (C307)

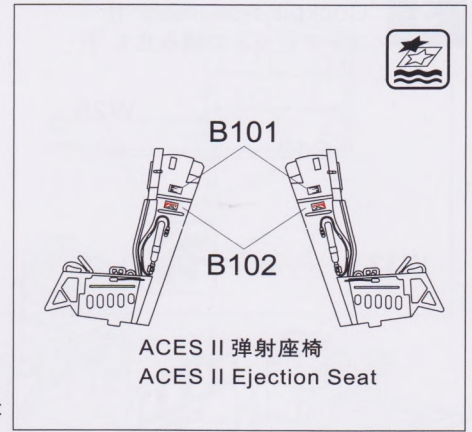
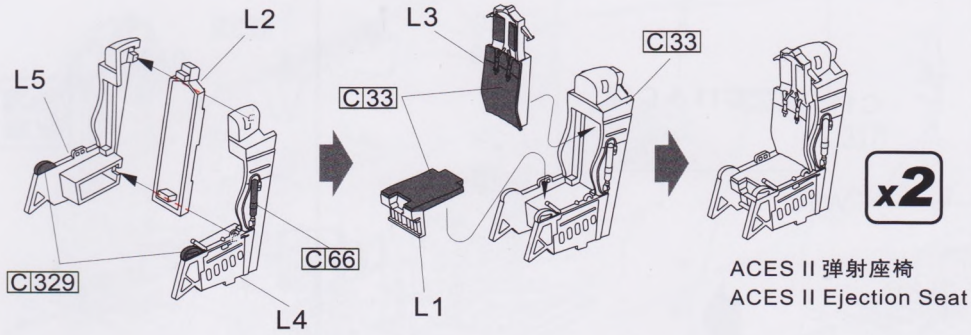

# 2

## 座舱组装 I Cockpit Assembly I コックピットの組み立て I

ACES II 弹射座椅  
ACES II Ejection Seat

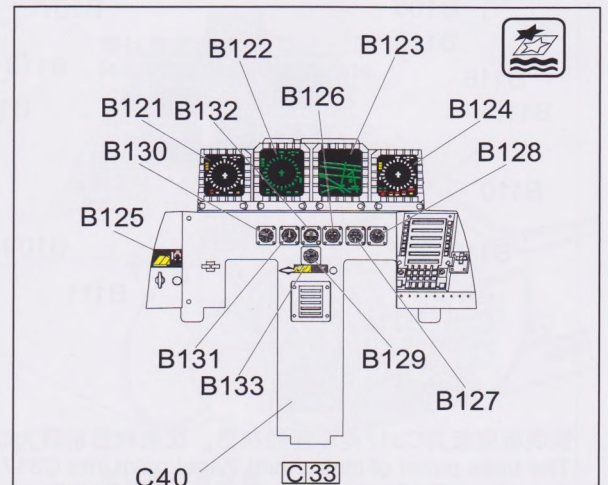
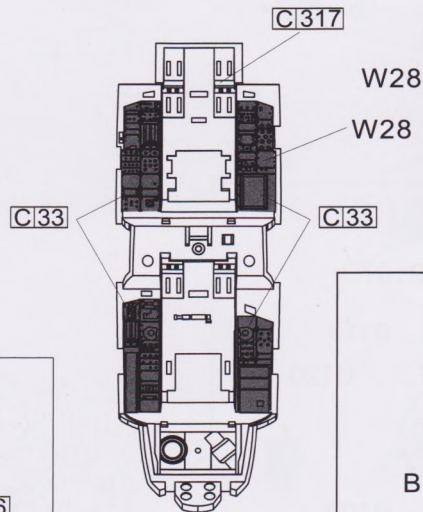
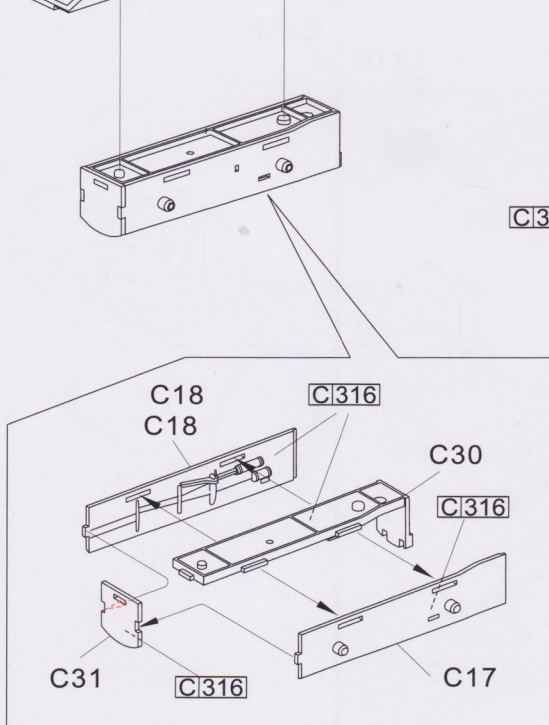
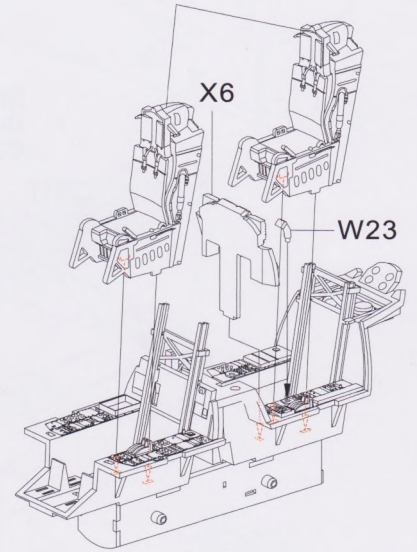
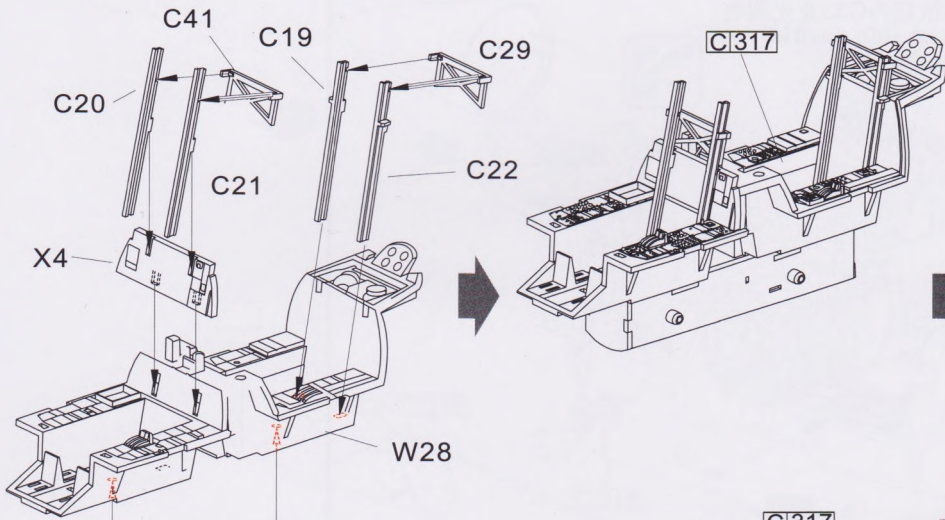

仪表板板底为C317灰色, 多功能显示器和仪表为C33亚光黑色  
The base panel of Instrument Panel paint C317, MFDs and Gauges paint in C33 FALAT BLACK



# 3

## 座舱组装 II Cockpit Assembly II コックピットの組み立て II

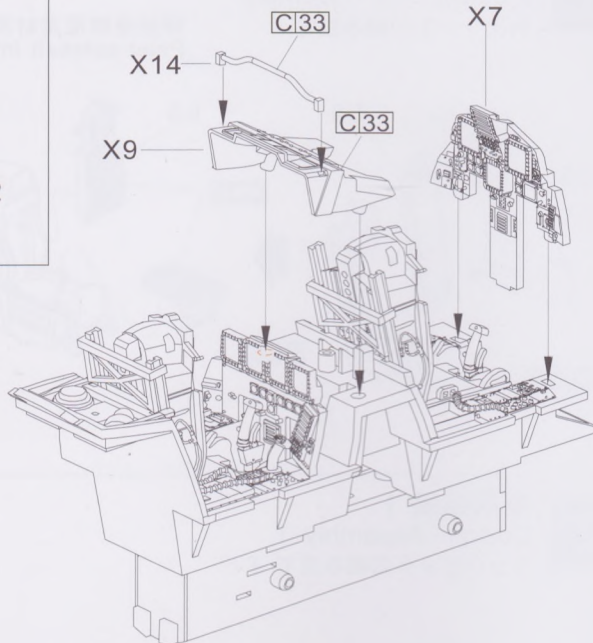
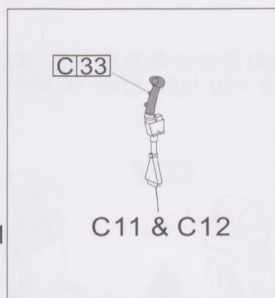
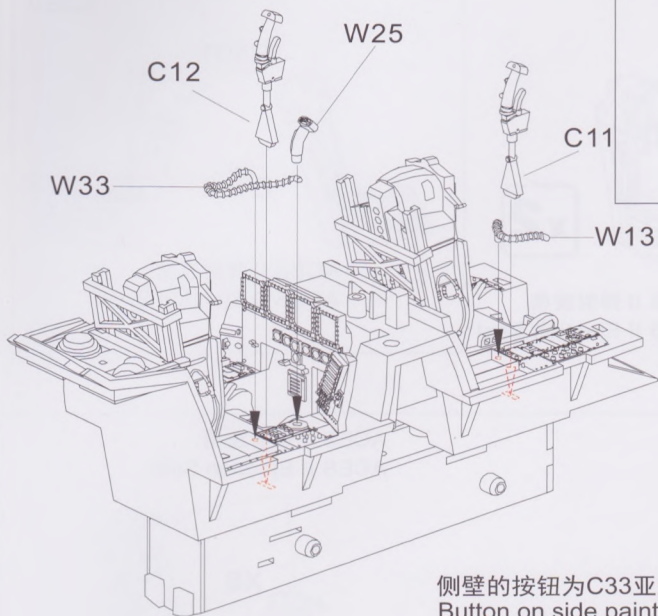

侧壁的按钮为C33亚光黑色  
Button on side paint in  
C33 Flat Black

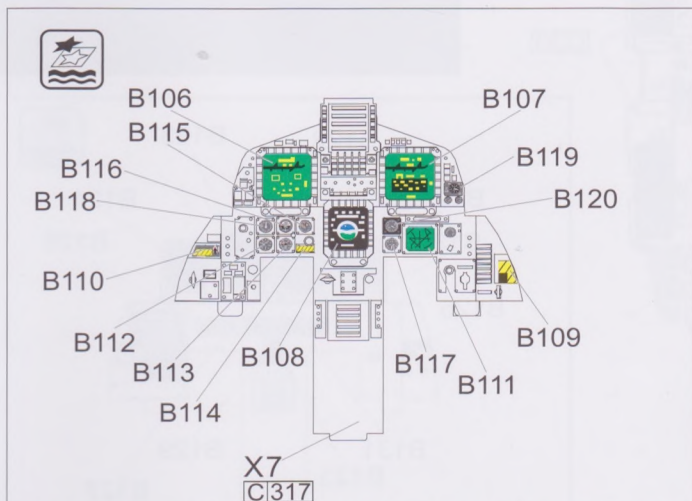
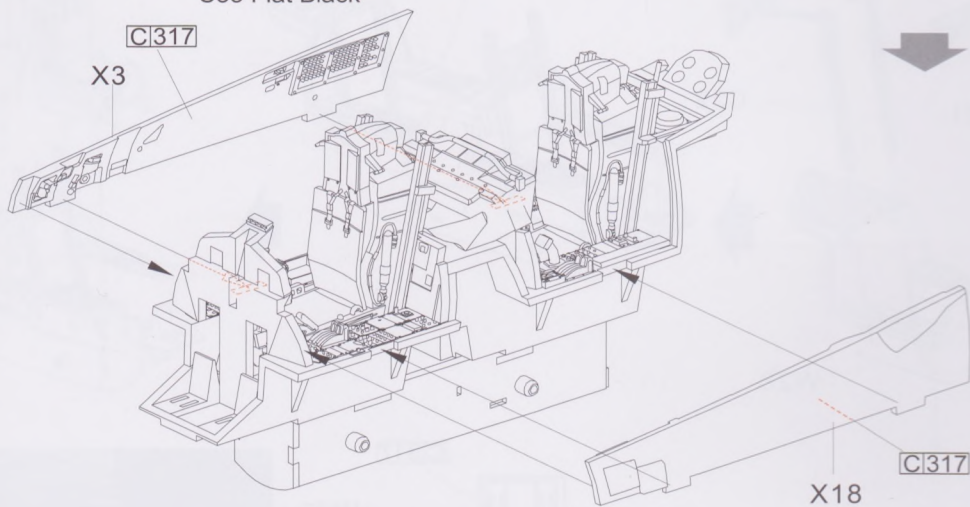

仪表板底板为C317美军座舱灰色，仪表和显示器为C33亚光黑  
The base panel of instrument Panel paint into C317 Cockpit  
Grey, the MFDS and Gauges paint into C33 Flat Black

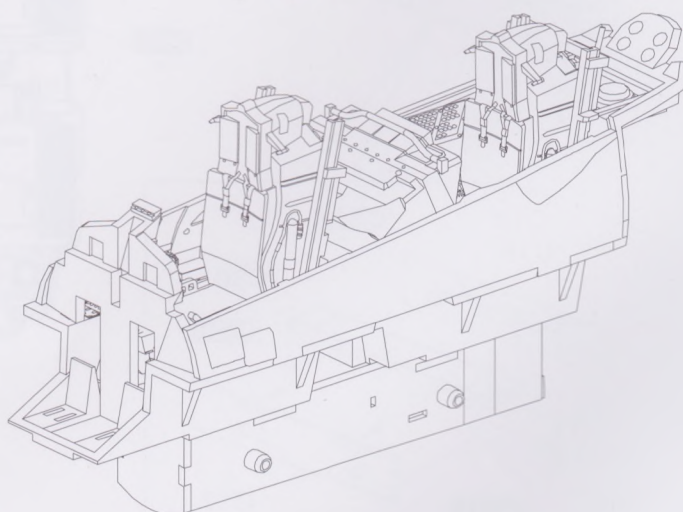



4

前机身组装  
Forebody Assembly  
機首の組み立て

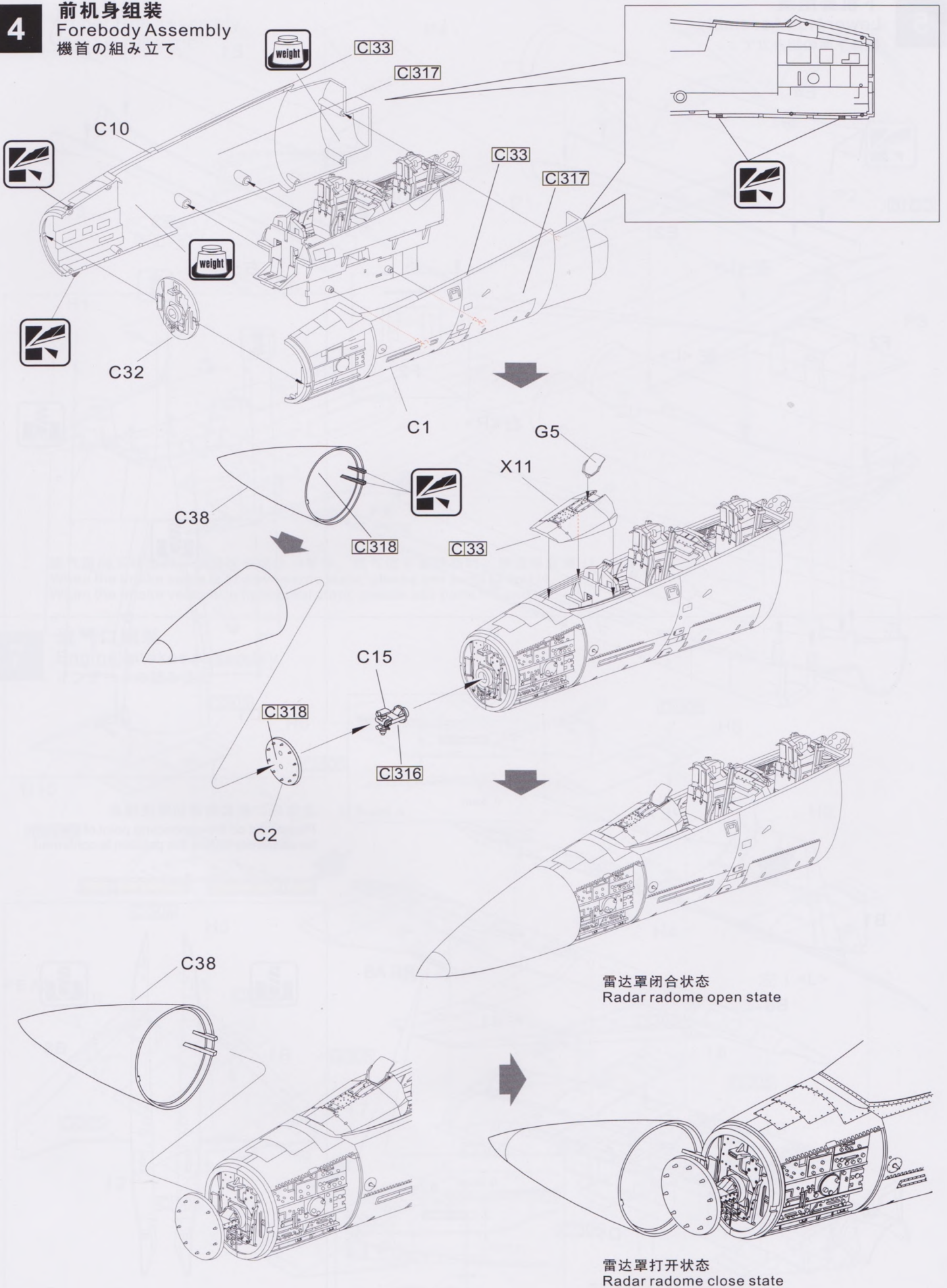

雷达罩闭合状态  
Radar radome open state

雷达罩打开状态  
Radar radome close state



# 5

## 下机身组装 Lower Hull Assembly 機体下面の組み立て

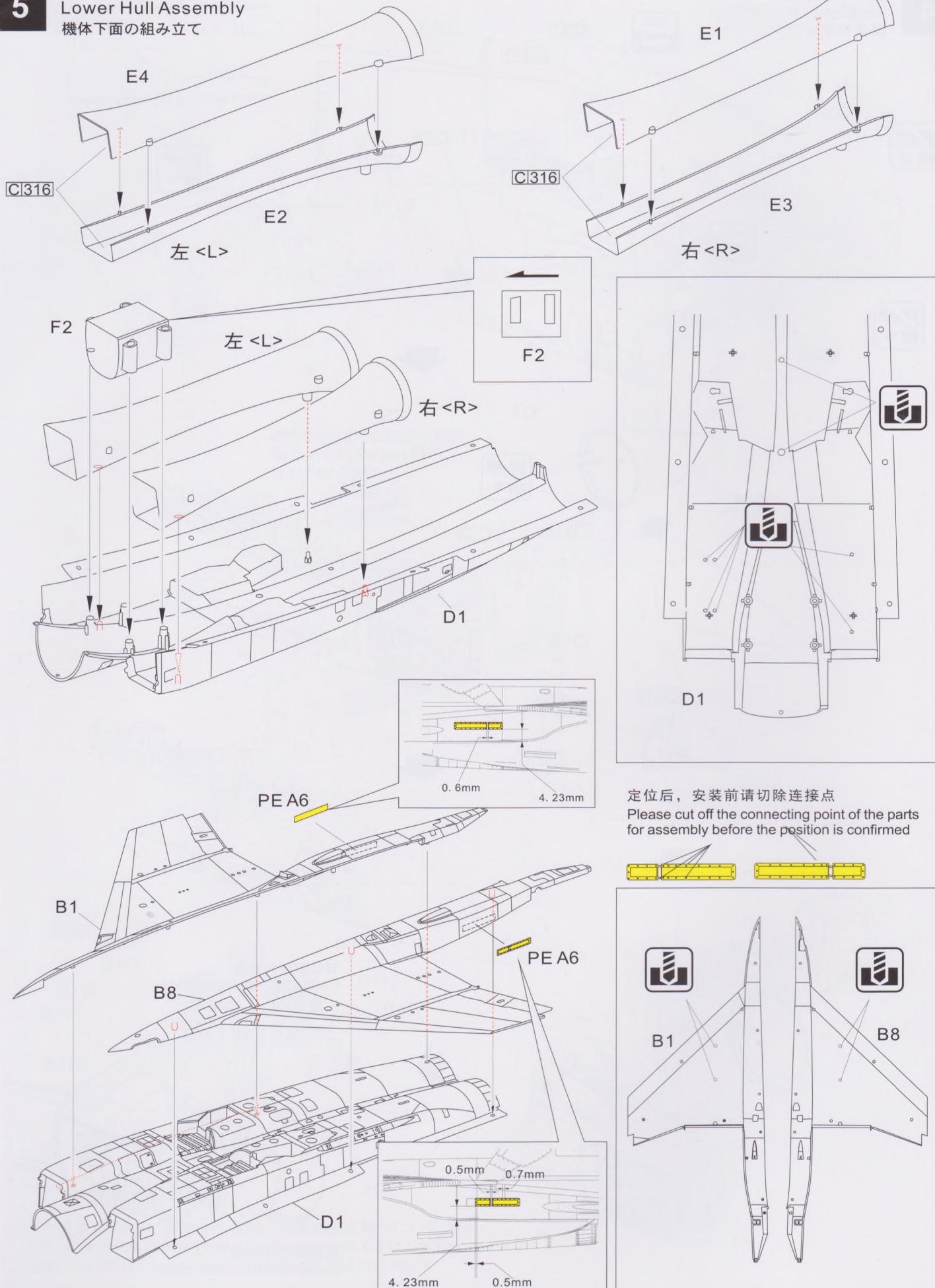



# 6

## 上机身组装 Upper Hull Assembly 機体上面の組み立て

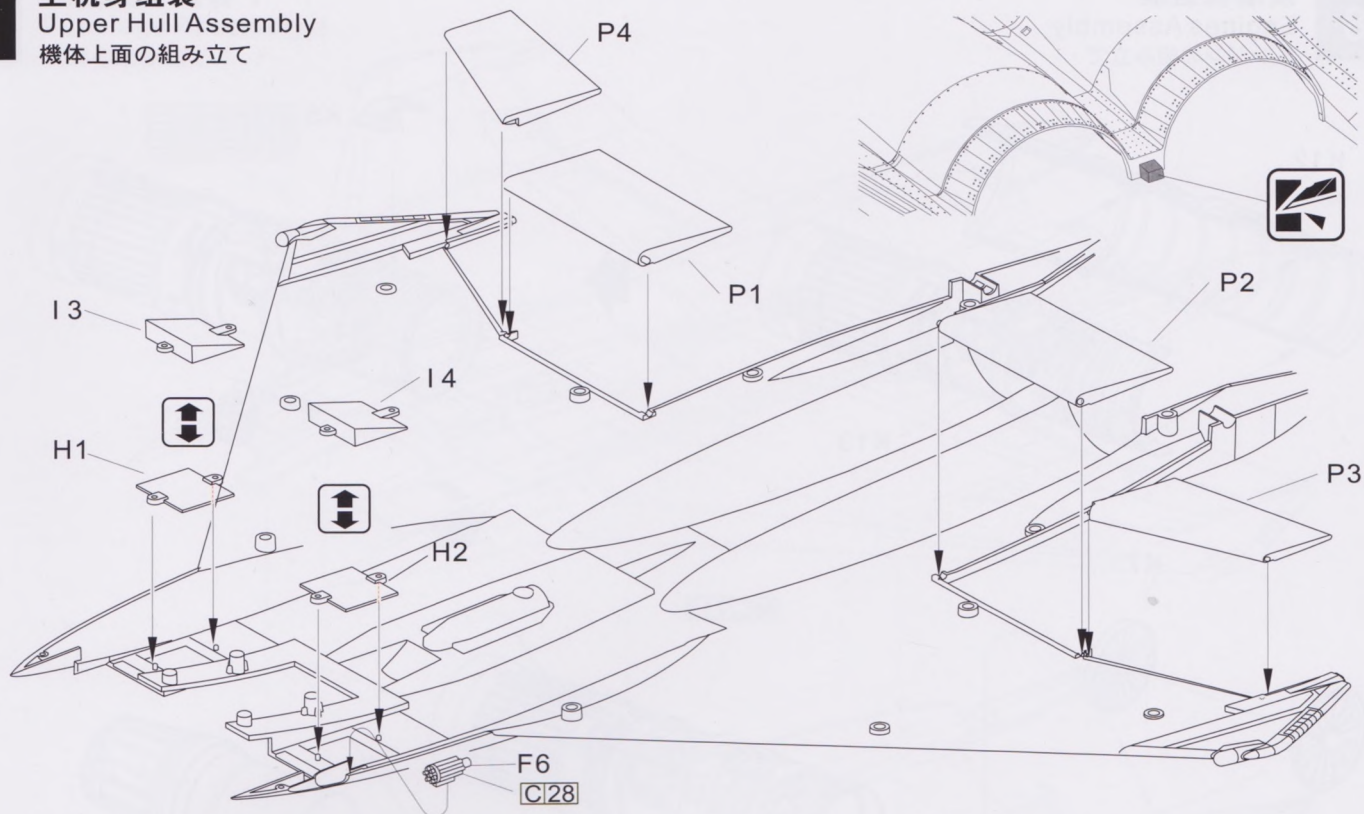

进气道向下状态时, 请选择安装I3、I4零件, 进气道平直状态时, 请选择安装H1、H2零件  
When the intake vents is in downwards state, please use parts I3 and I4.  
When the intake vents is in horizontal state, please use parts H1 and H2.

# 7

## 进气口组装 Engine Intakes Assembly インテークの組み立て

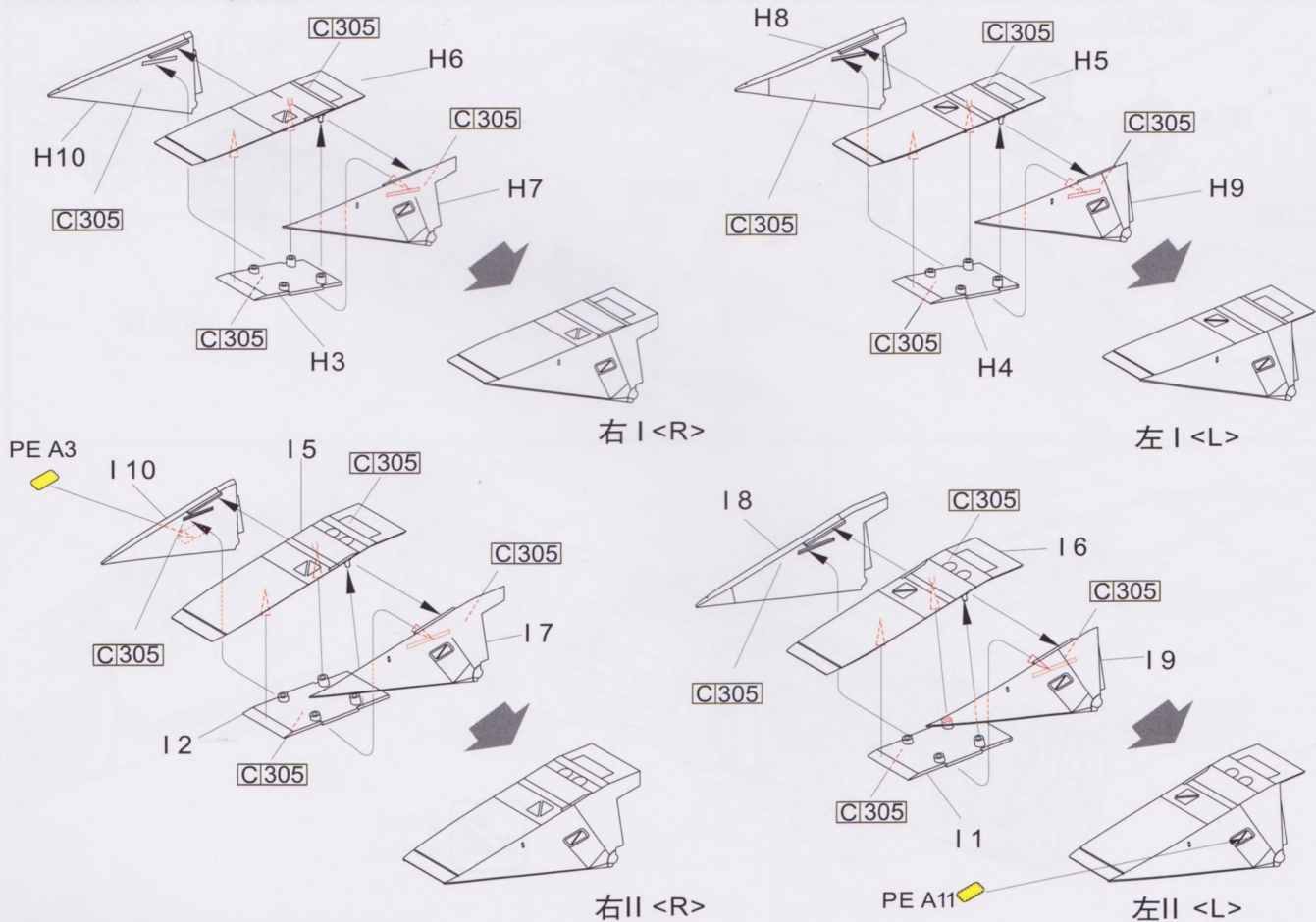



# 8

## 发动机组 Engines Assembly エンジンの組み立て

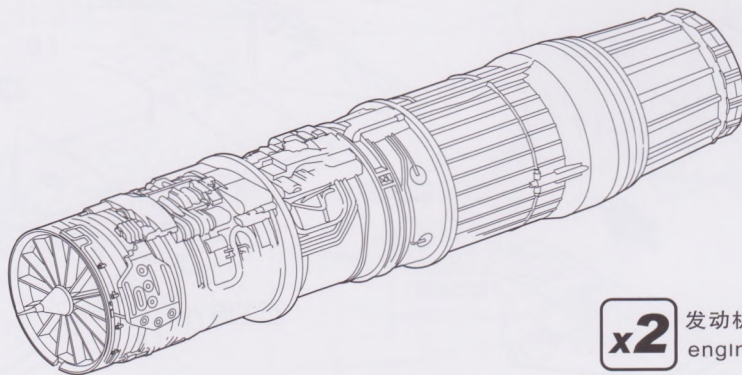
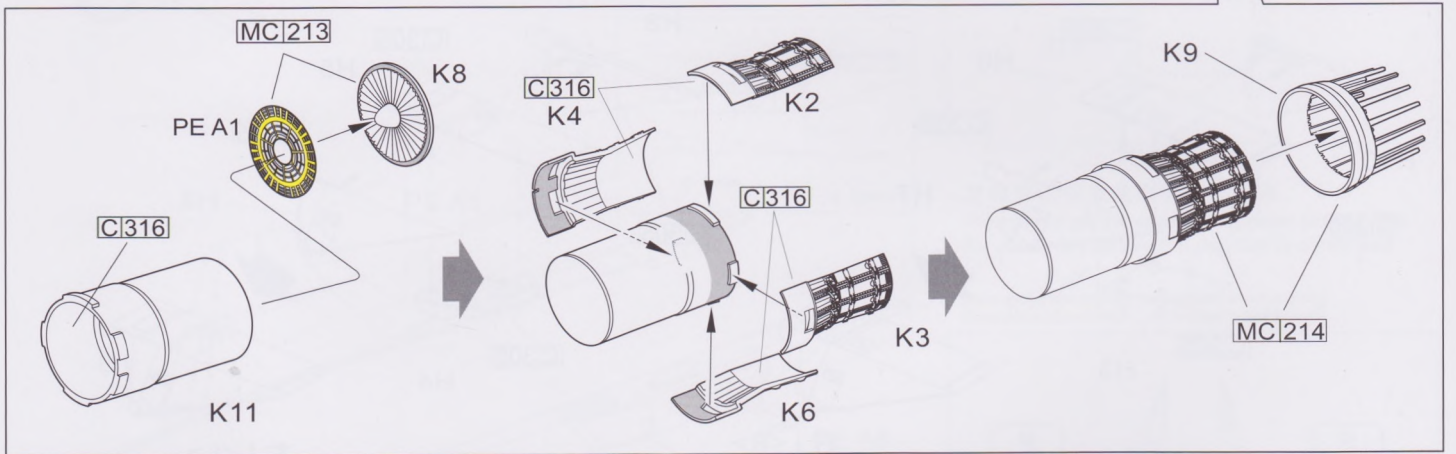
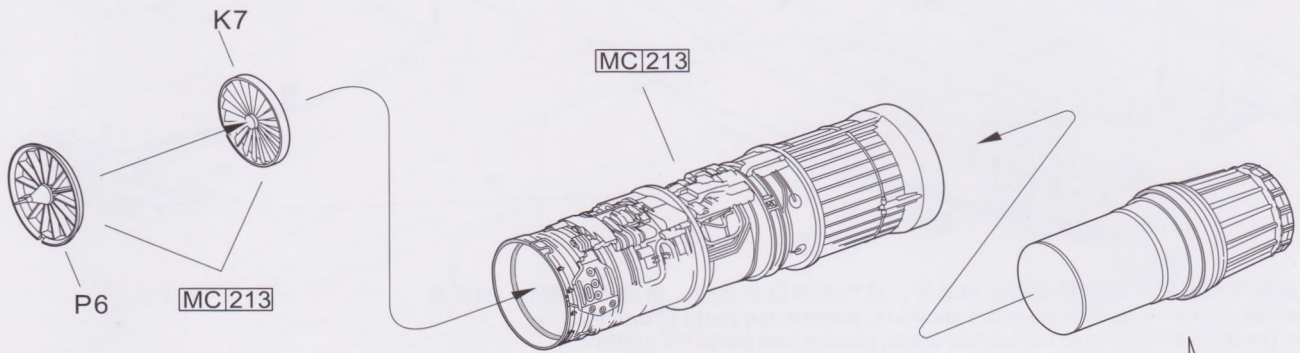
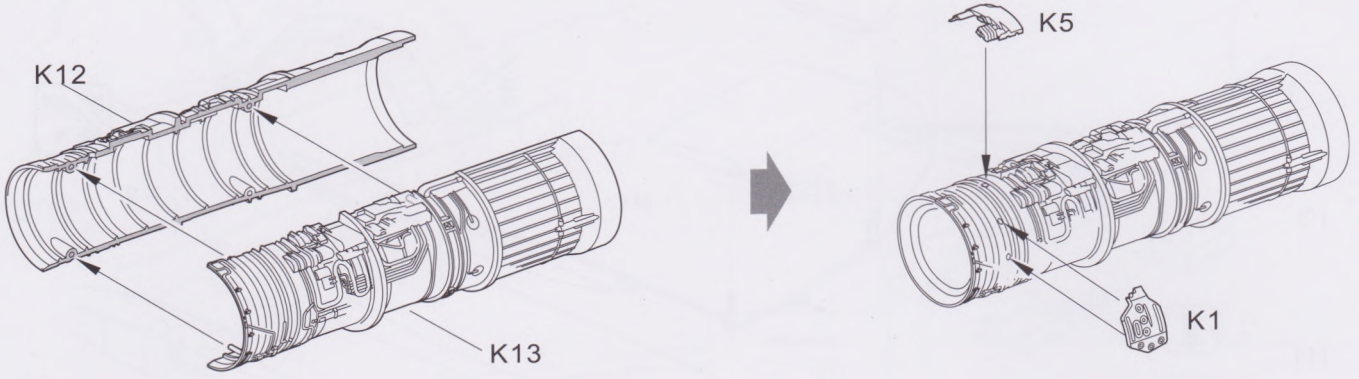

**x2** 发动机  
engine.



飞机机身组装 I  
Fuselage Assembly I  
胴体の組み立て I

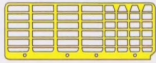

PE A7

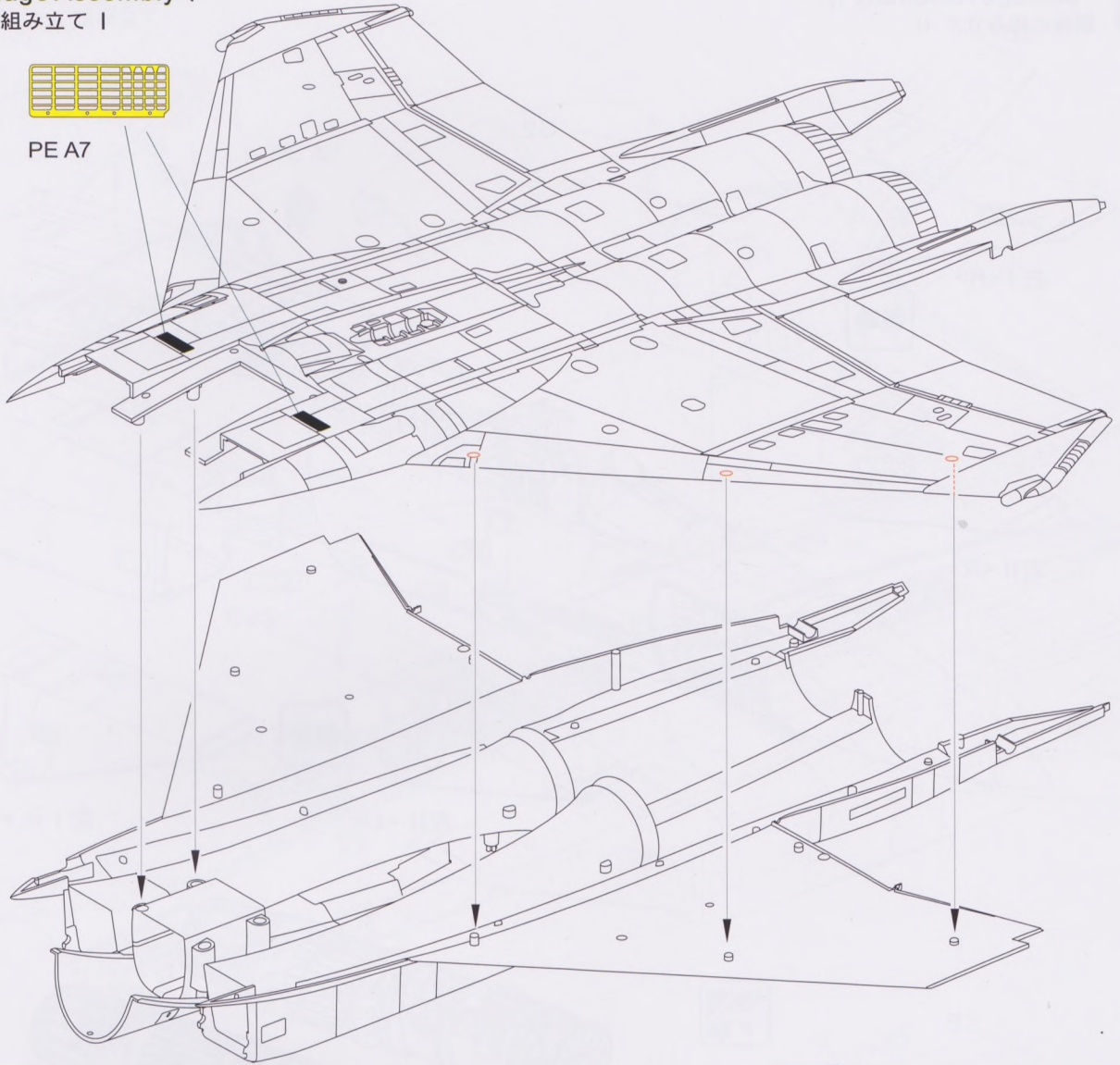

B7

PE B7

PE A10

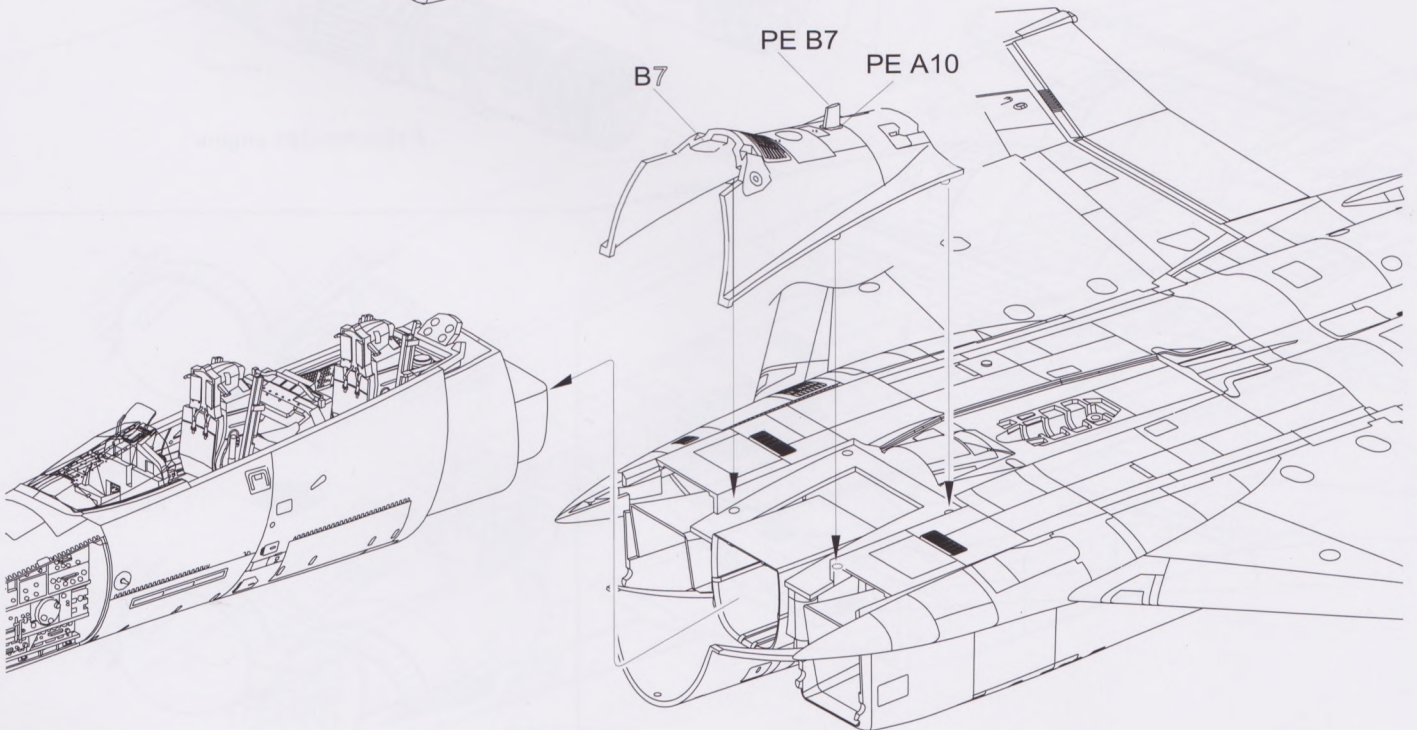



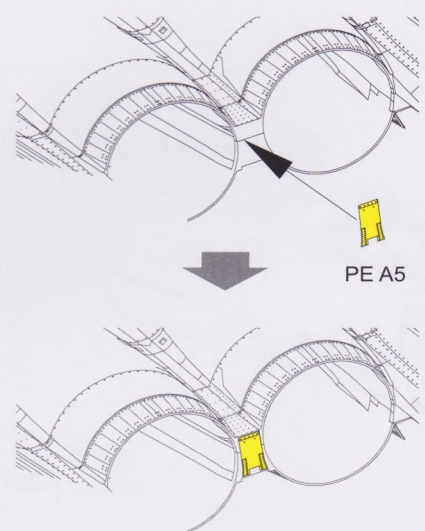
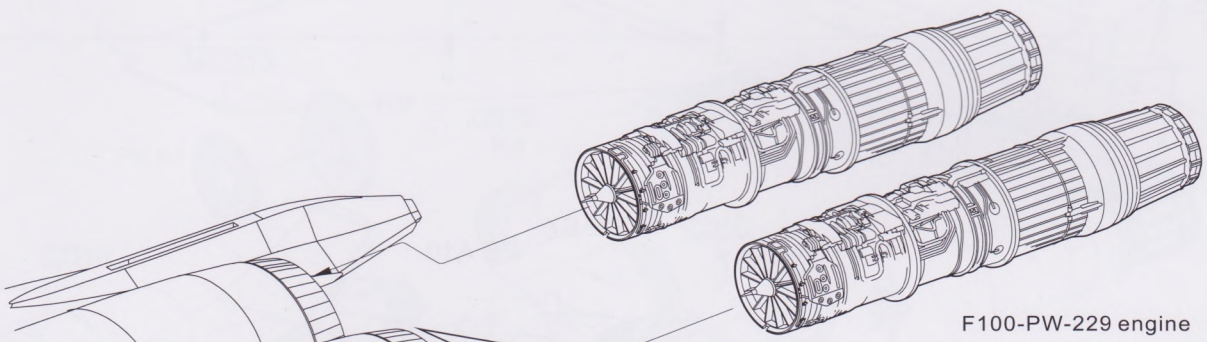
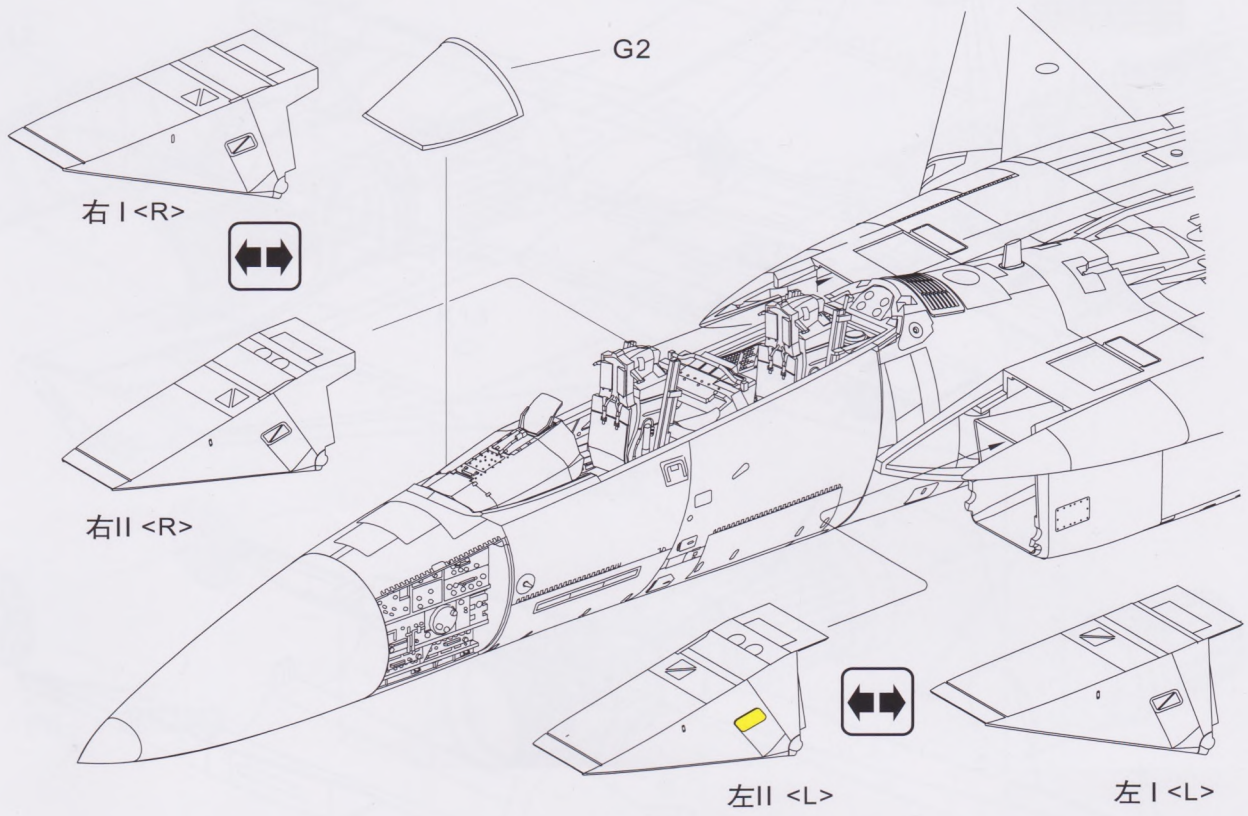



# 11

## 座舱舱盖组装 Canopy Assembly キャノピーの組み立て

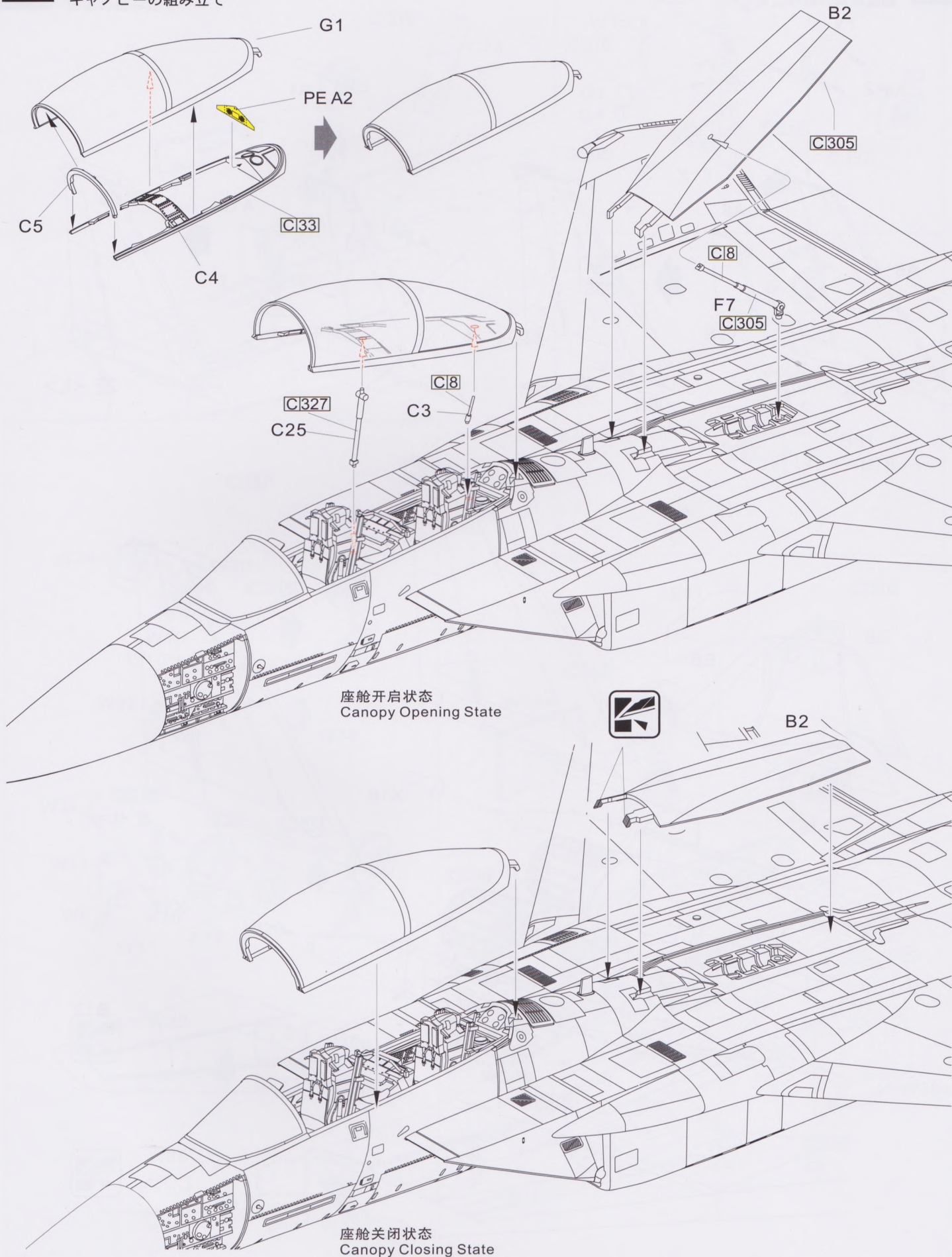



# 12

## 垂直尾翼组装 Vertical Tail Assembly 垂直尾翼の組み立て

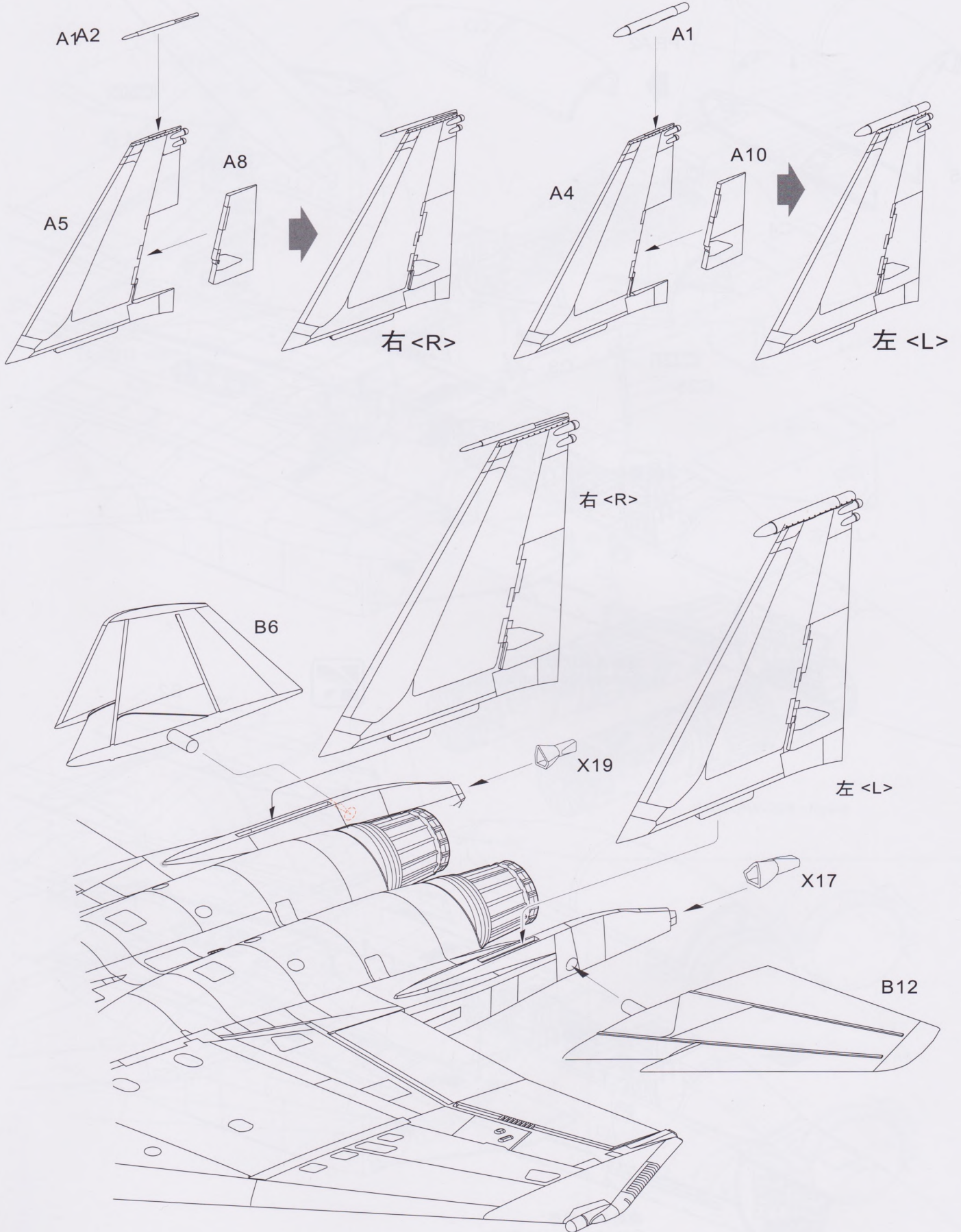



# 13

## 起落架组装

### Landing Gear Assembly

脚部の組み立て

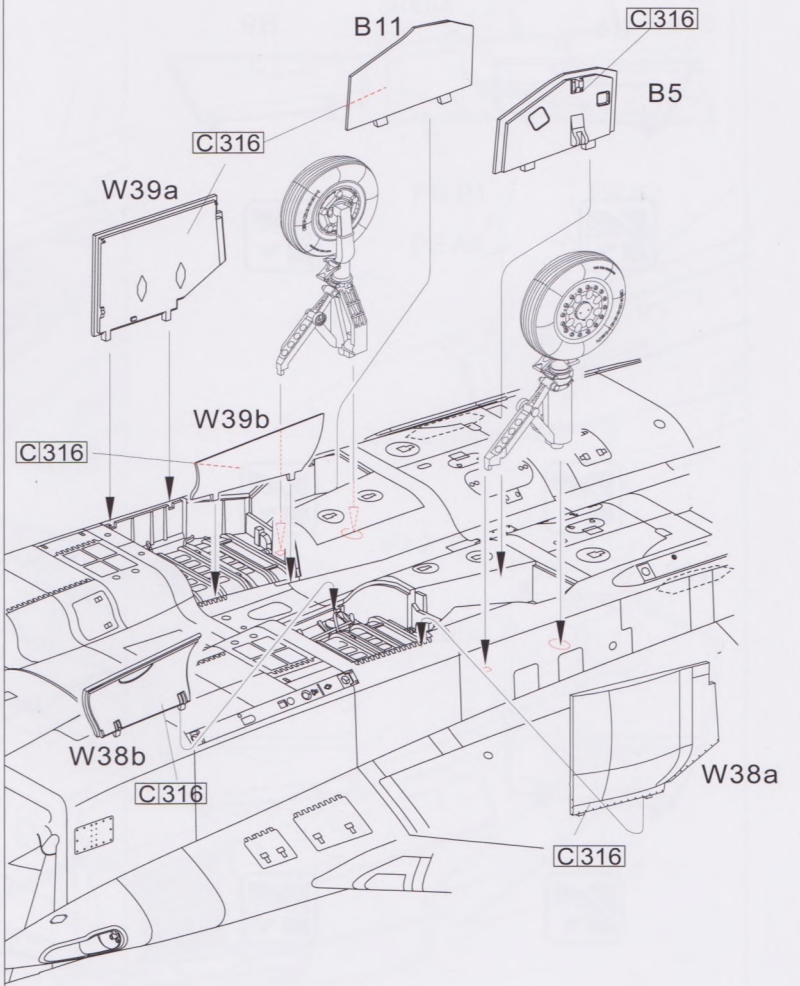
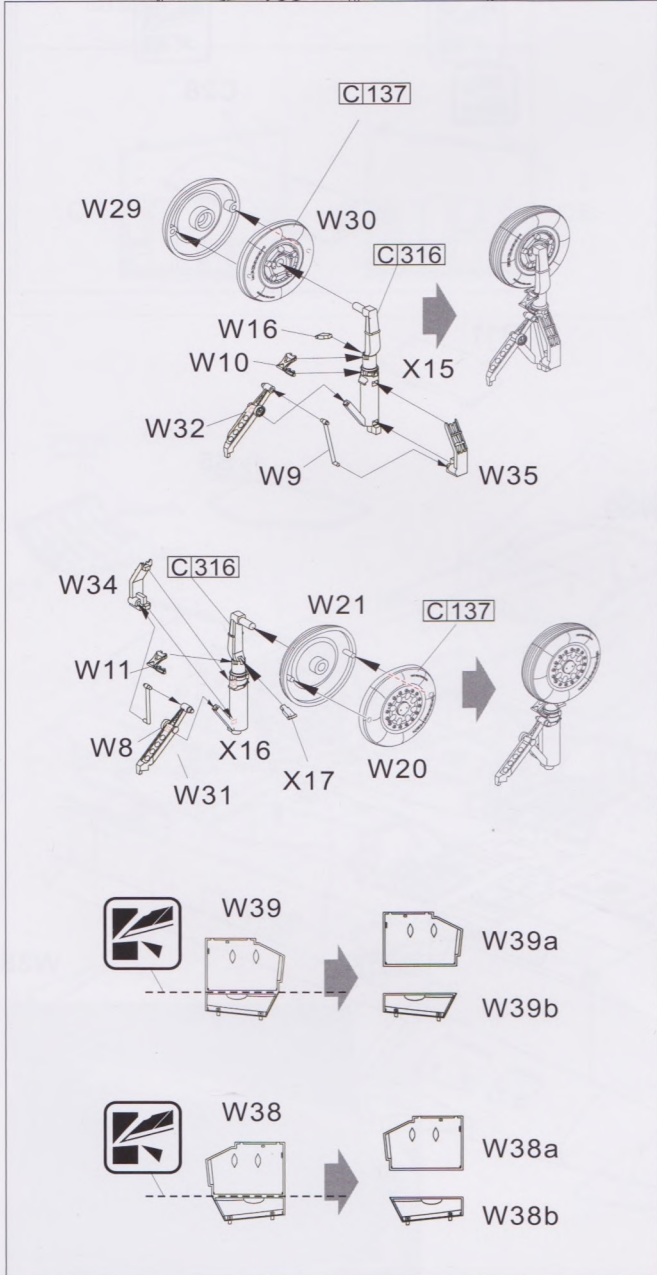
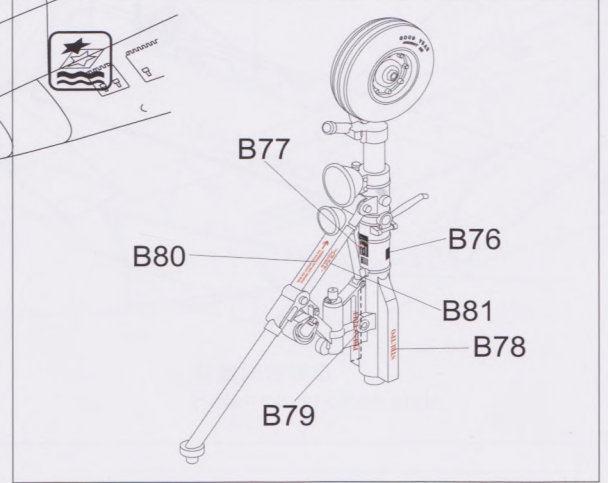
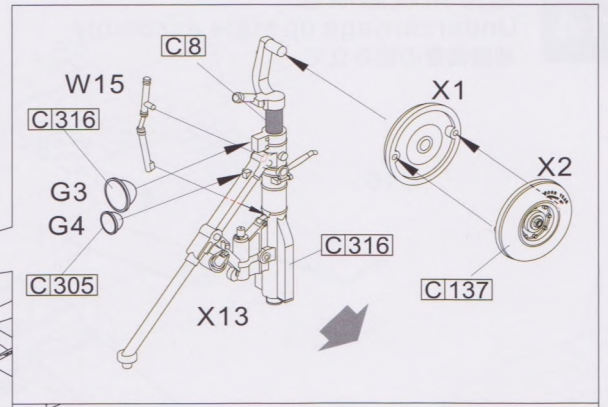
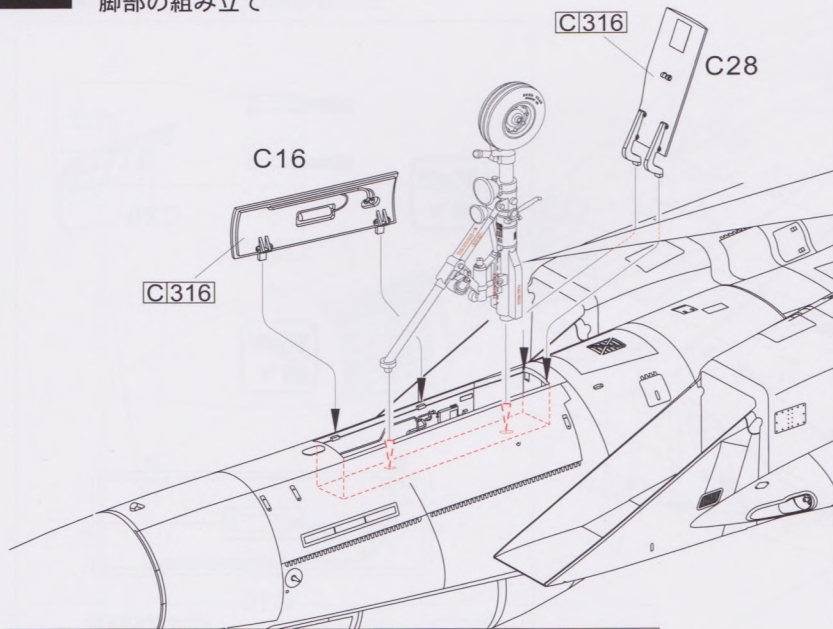



# 14

## 起落架收起状态 Undercarriage up state assembly 着陸装置の組み立て

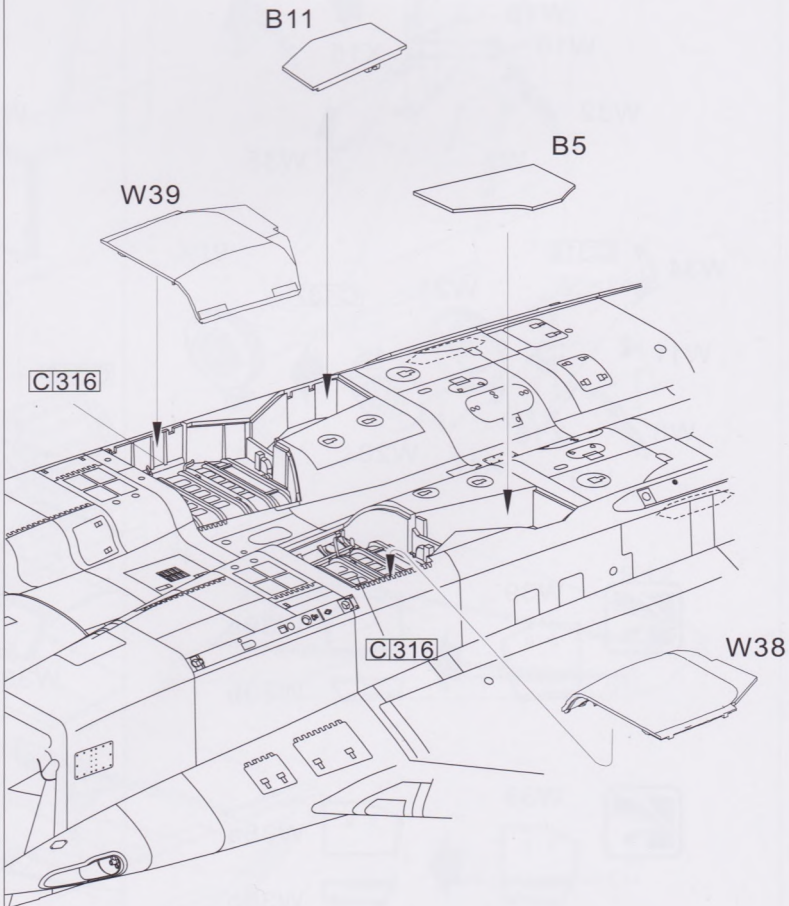
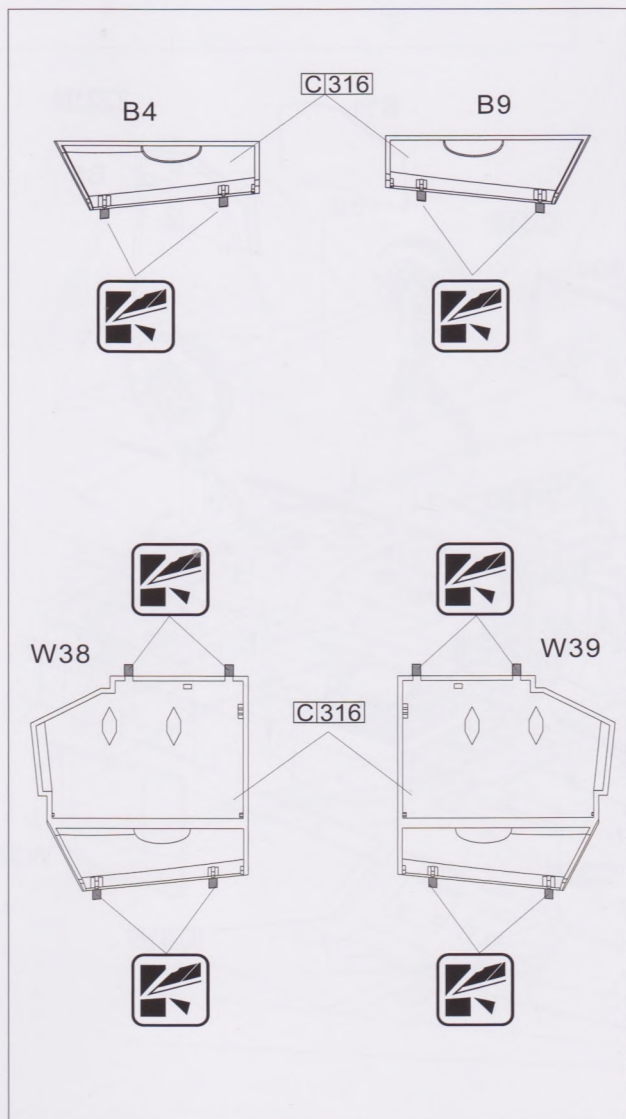
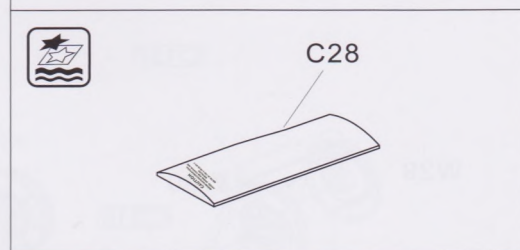
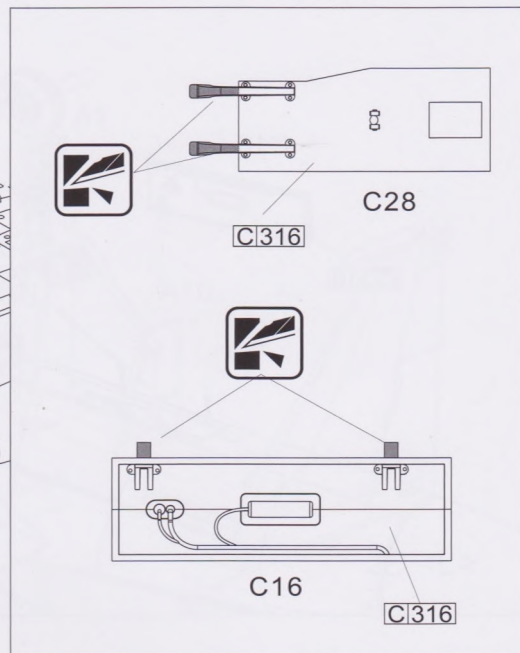
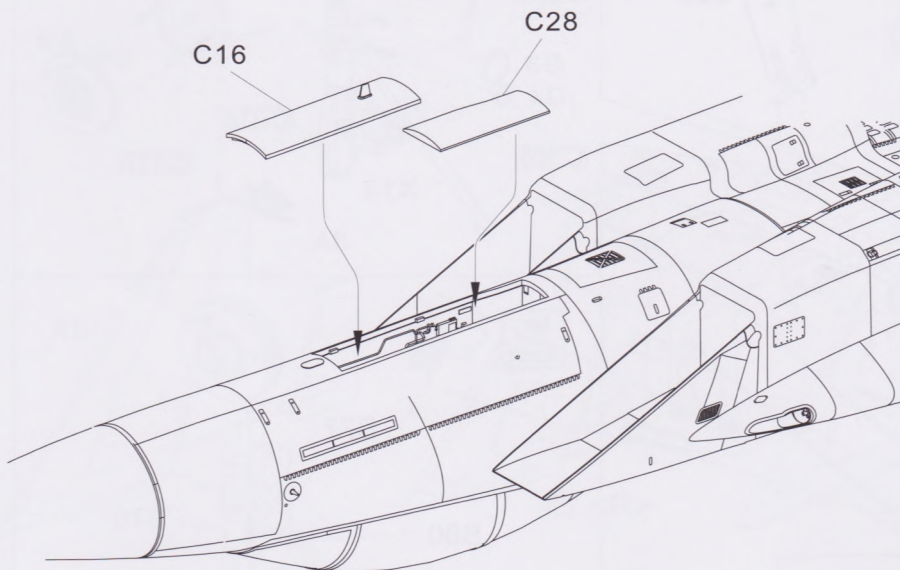



# 15

## 雷达检修仓盖组装 Radar Maintenance Cabin Assembly 点检パネルの組み合わせ

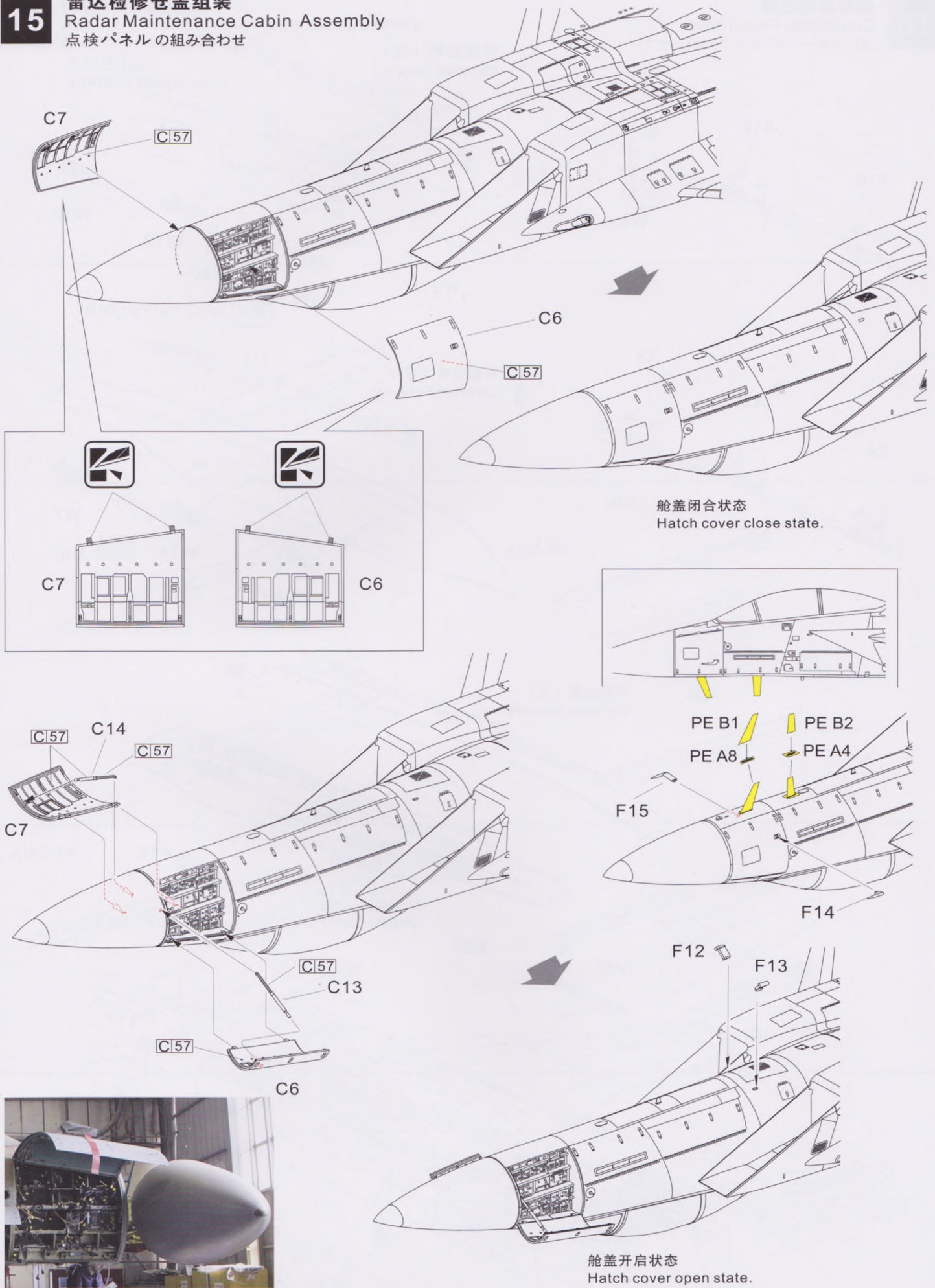



# 16

## 保形油箱组装

### Conformal Fuel Tanks

コンフォーマル・タンクの組み立て

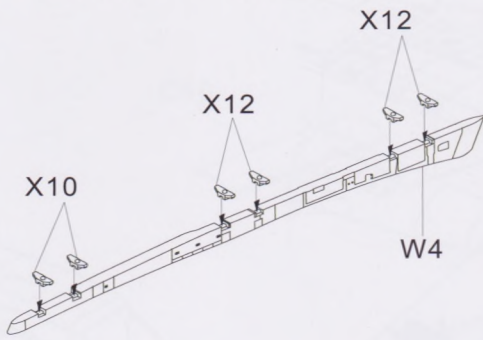

保形油箱 (左)  
Conformal Tanks <L>

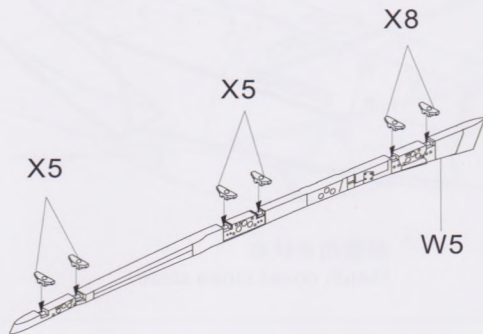
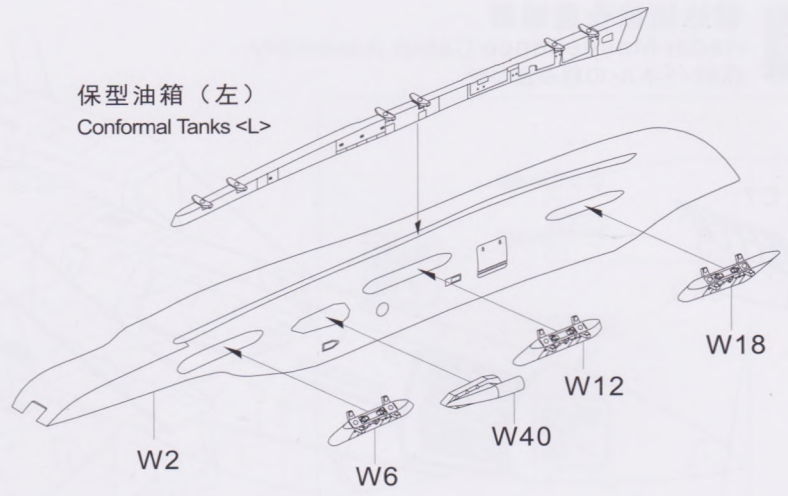

保形油箱 (右)  
Conformal Tanks <R>

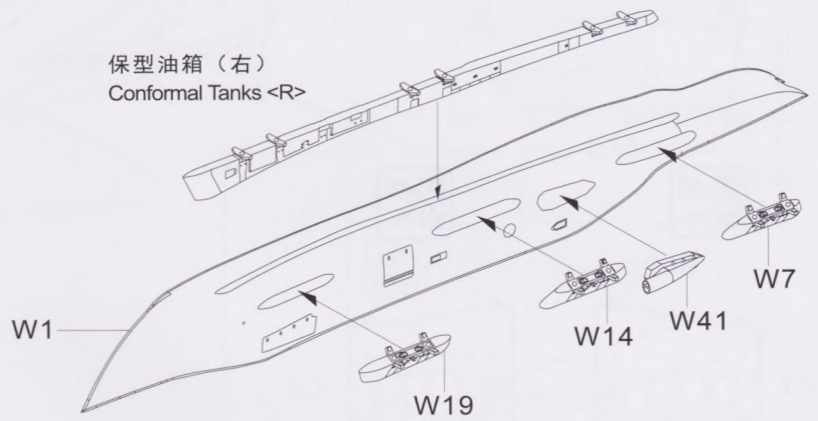

保形油箱 (右)  
Conformal Tanks <R>

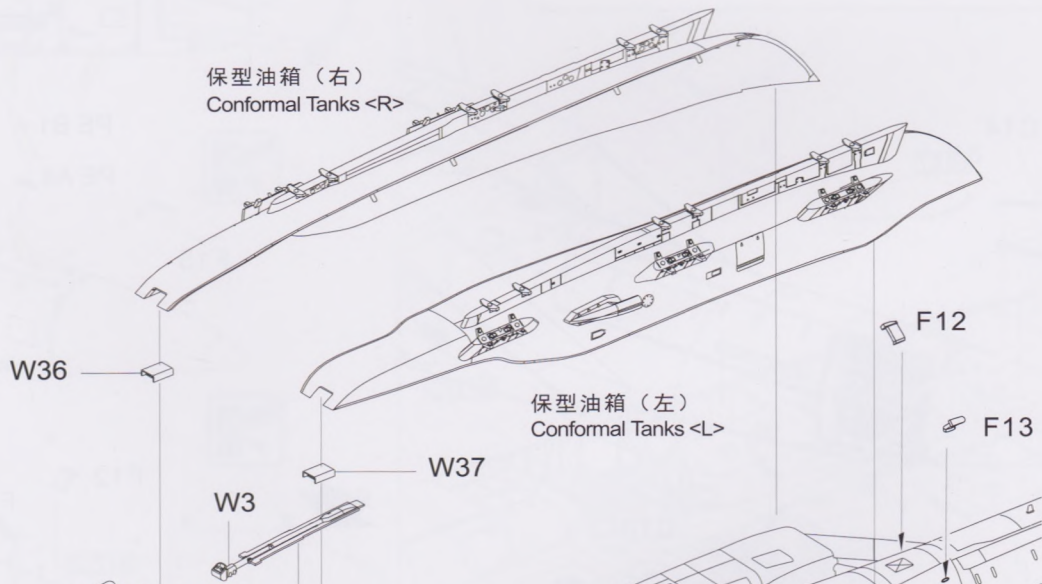

保形油箱 (左)  
Conformal Tanks <L>

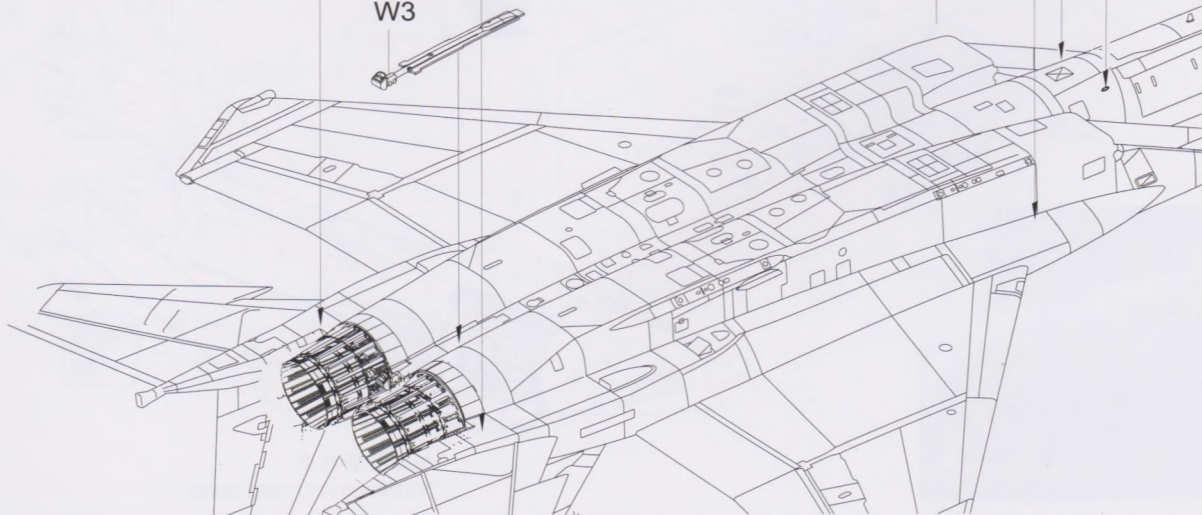



# 17

## 油箱和武器组装

Auxiliary Fuel Tanks / Weapons Assembly

増槽タンク/兵装の組み立て

主翼主挂架

Inboard wing pylon

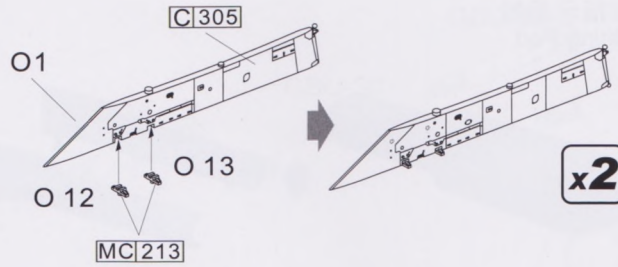

610gal Fuel Tank **x2**



AIM-120C

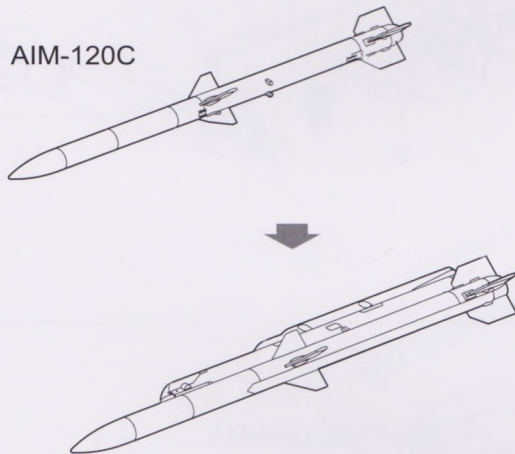

AIM-9X

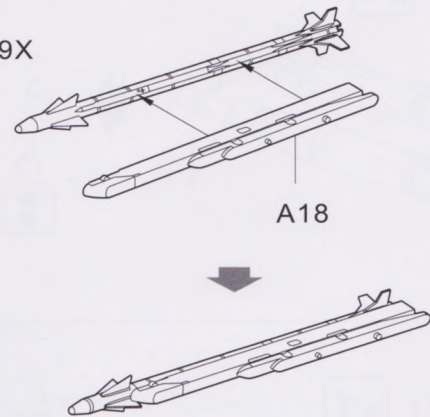

AIM-9X

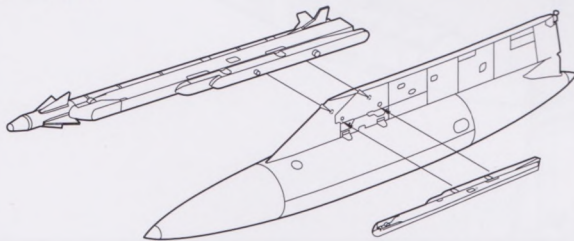

右 <R>

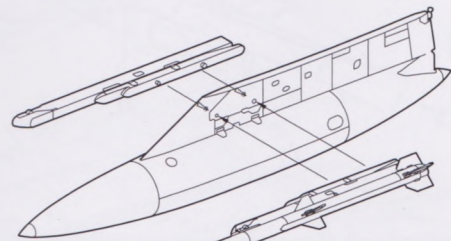

左 <L>

AIM-120C

AAQ-13 **x1**

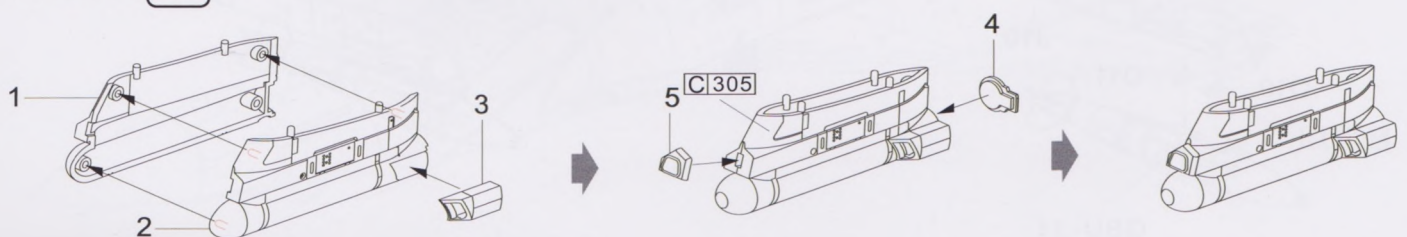



**17** 油箱和武器组装  
 Auxiliary Fuel Tanks / Weapons Assembly  
 増槽タンク/兵装の組み立て

吊舱为C305炮舰灰色 (FS36118)  
 Targeting Pod paint in C305  
 Gunship Grey (FS36118)

AN/AAQ-33 “狙击手” XR先进目标指示吊舱  
 AN/AAQ-33 Sniper XR Advanced Targeting Pod

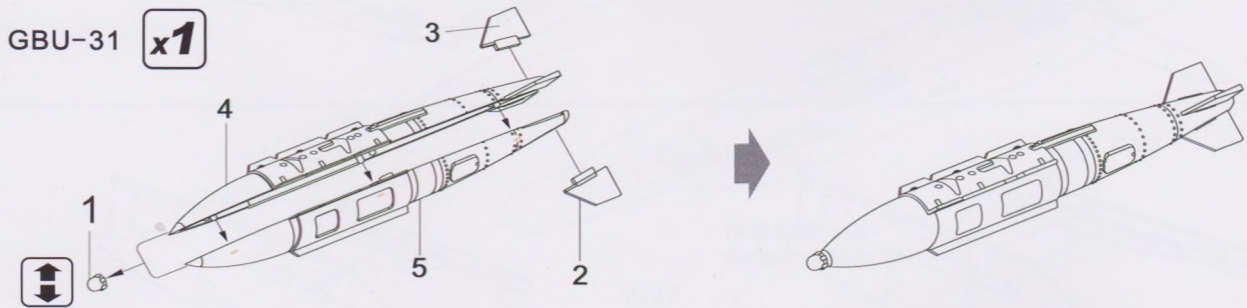
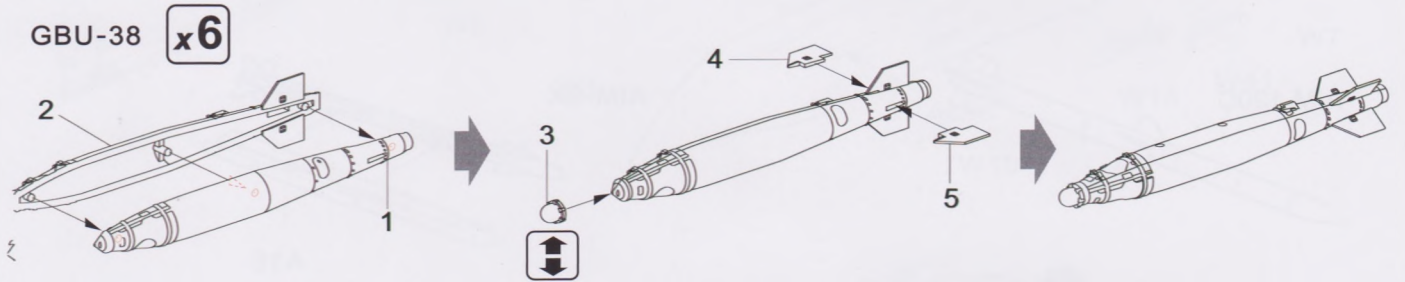
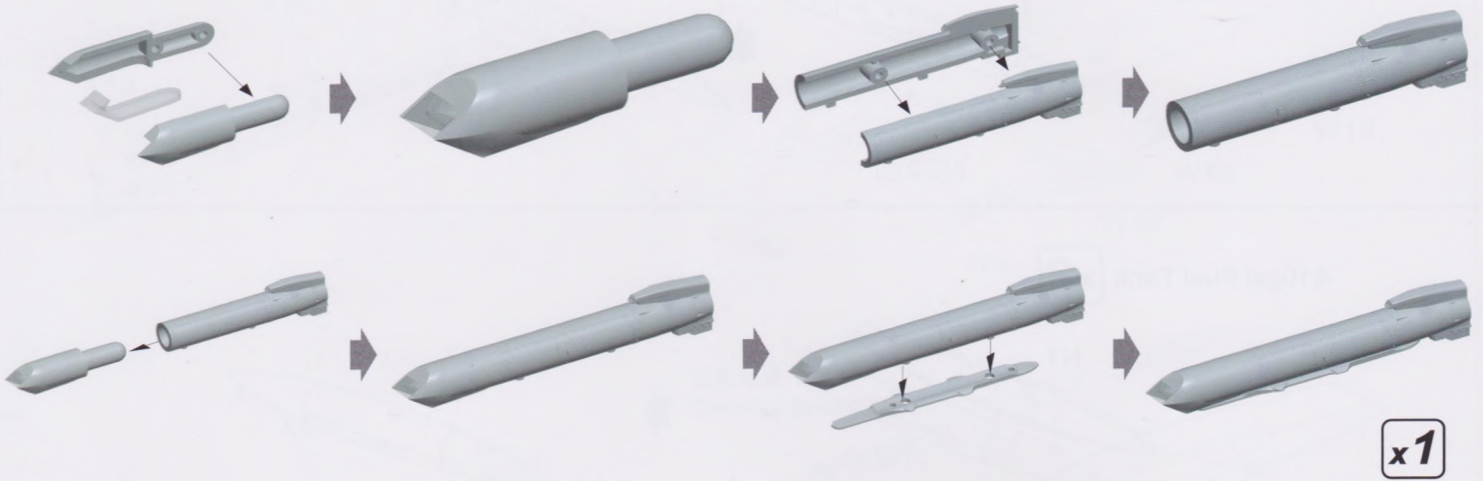

机腹中线挂架  
 Centerline pylon





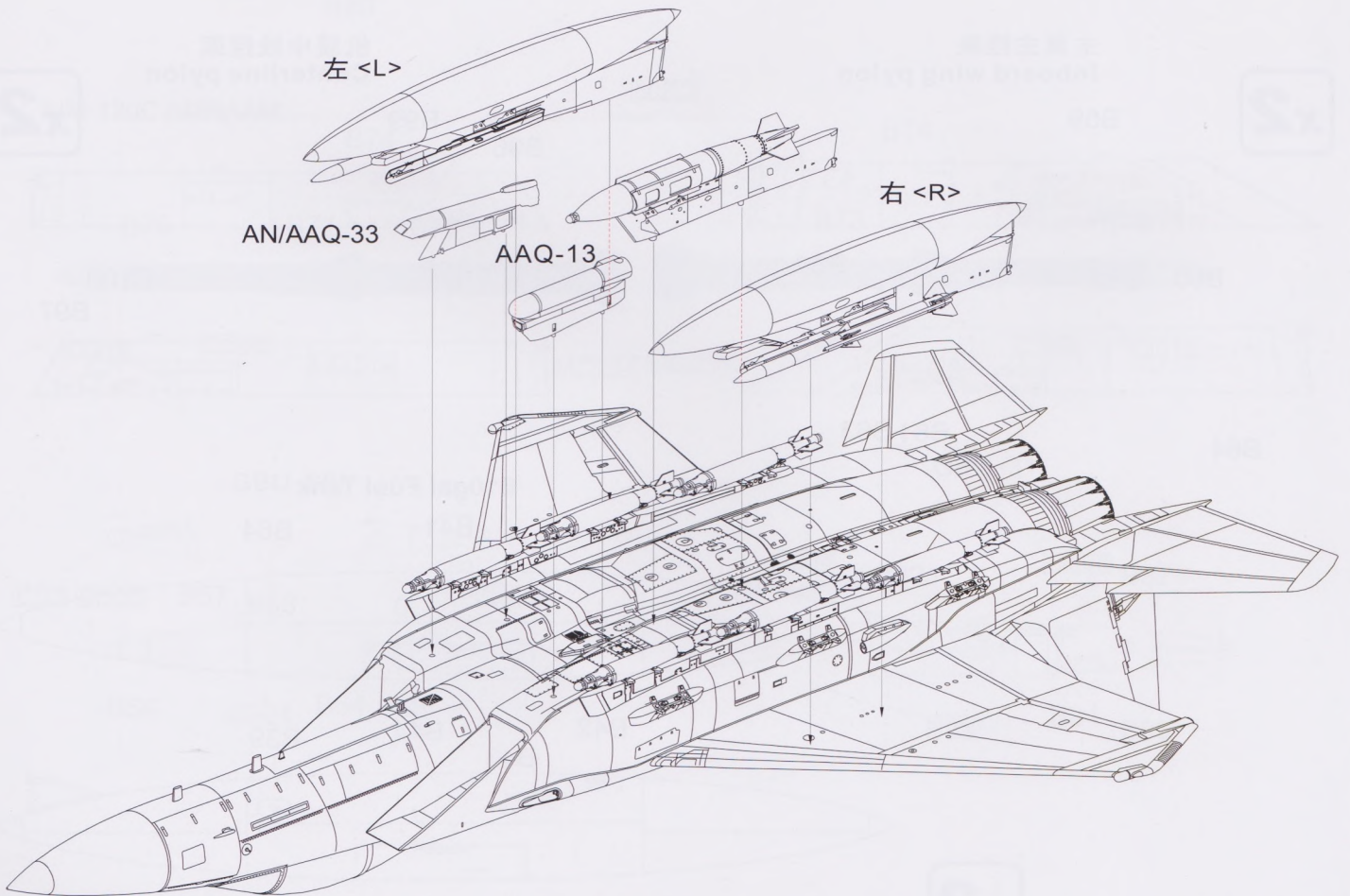
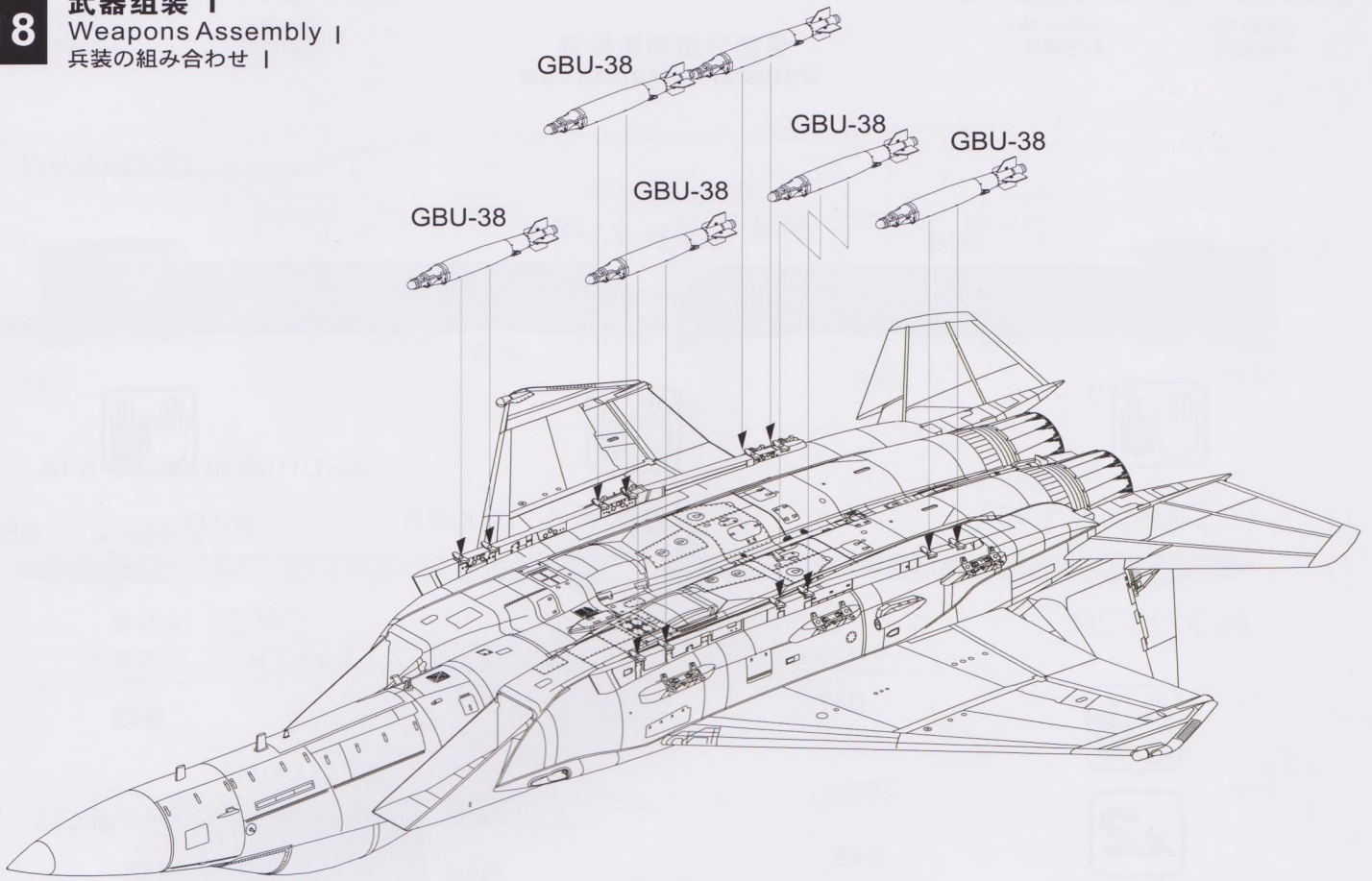



**Paint & Marking 通用水贴涂装指示**

Decal No. 水贴编号  
Colour No. 颜色编号

**保型油箱附属挂架  
Outboard weapon row**

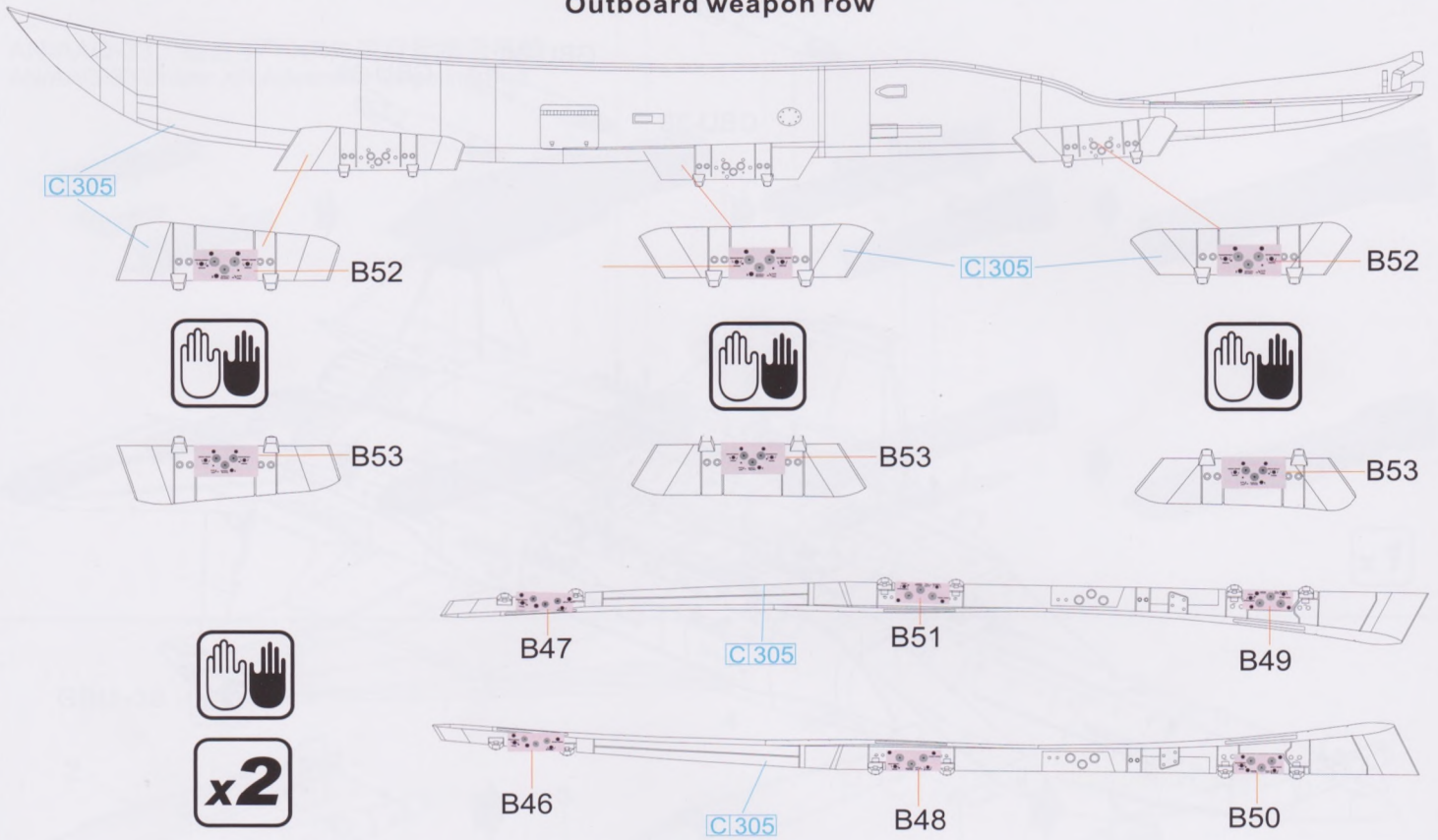

**主翼主挂架  
Inboard wing pylon**

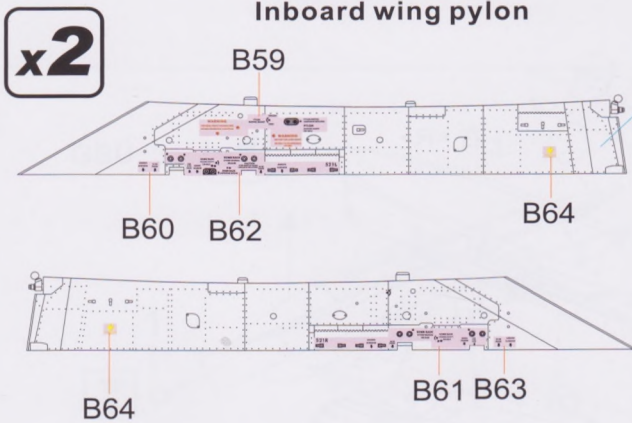

**机腹中线挂架  
Centerline pylon**

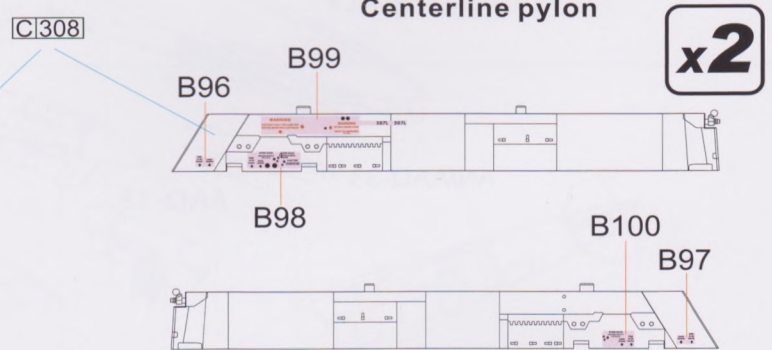

**610gal Fuel Tank**

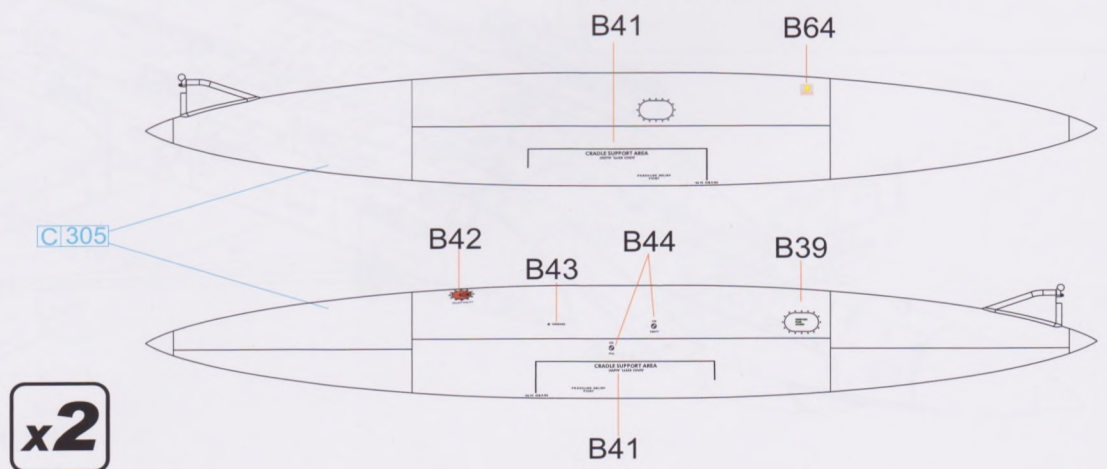



**Paint & Marking 通用水贴涂装指示**

Decal No.      Colour No  
水贴编号      颜色编号

**AN/AAQ-33**

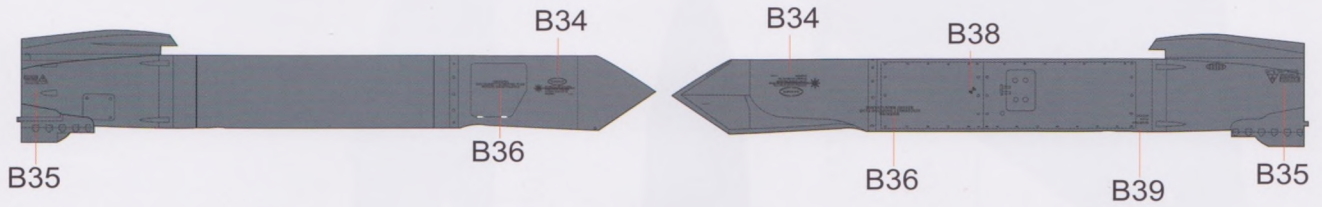

**AIM-9X SIDEWINDER**

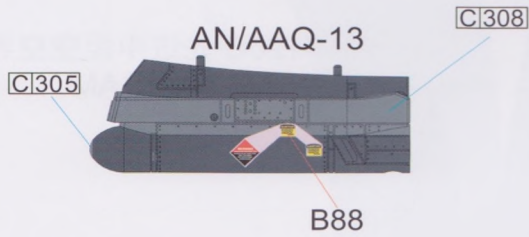

**AIM-120C AMRAAM**

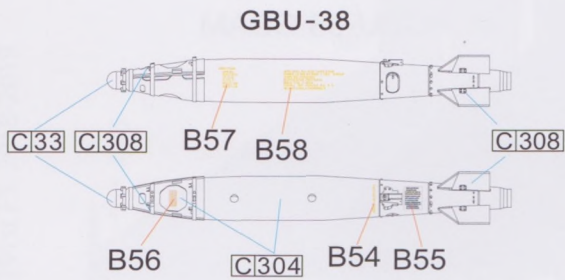
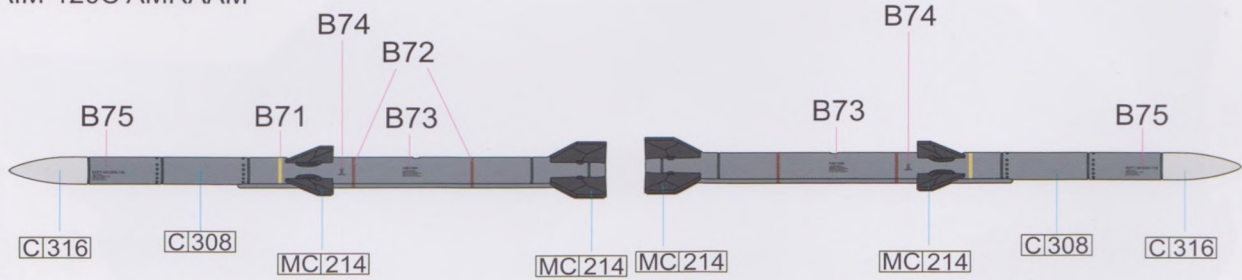

**GBU-31**

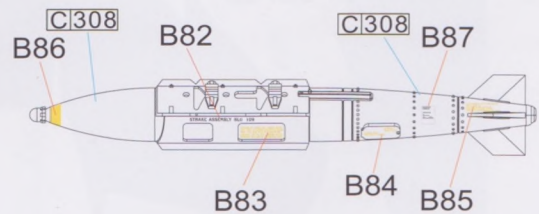



## 武器配置图

## Armaments Installation

AN/AAQ-13 红外前视/低空导航吊舱  
AN/AAQ-13 FLIR/Low Altitude  
Navigation Pod

GBU-38 JDAM

AIM-9X

GBU-31 JDAM

AN/AAQ-33 “狙击手” XR 先  
进目标指示吊舱  
AN/AAQ-33 Sniper XR Advanced  
Targeting Pod

AIM-120C 先进中距空空导弹  
AIM-120C AMRAAM

GBU-38 GDAM

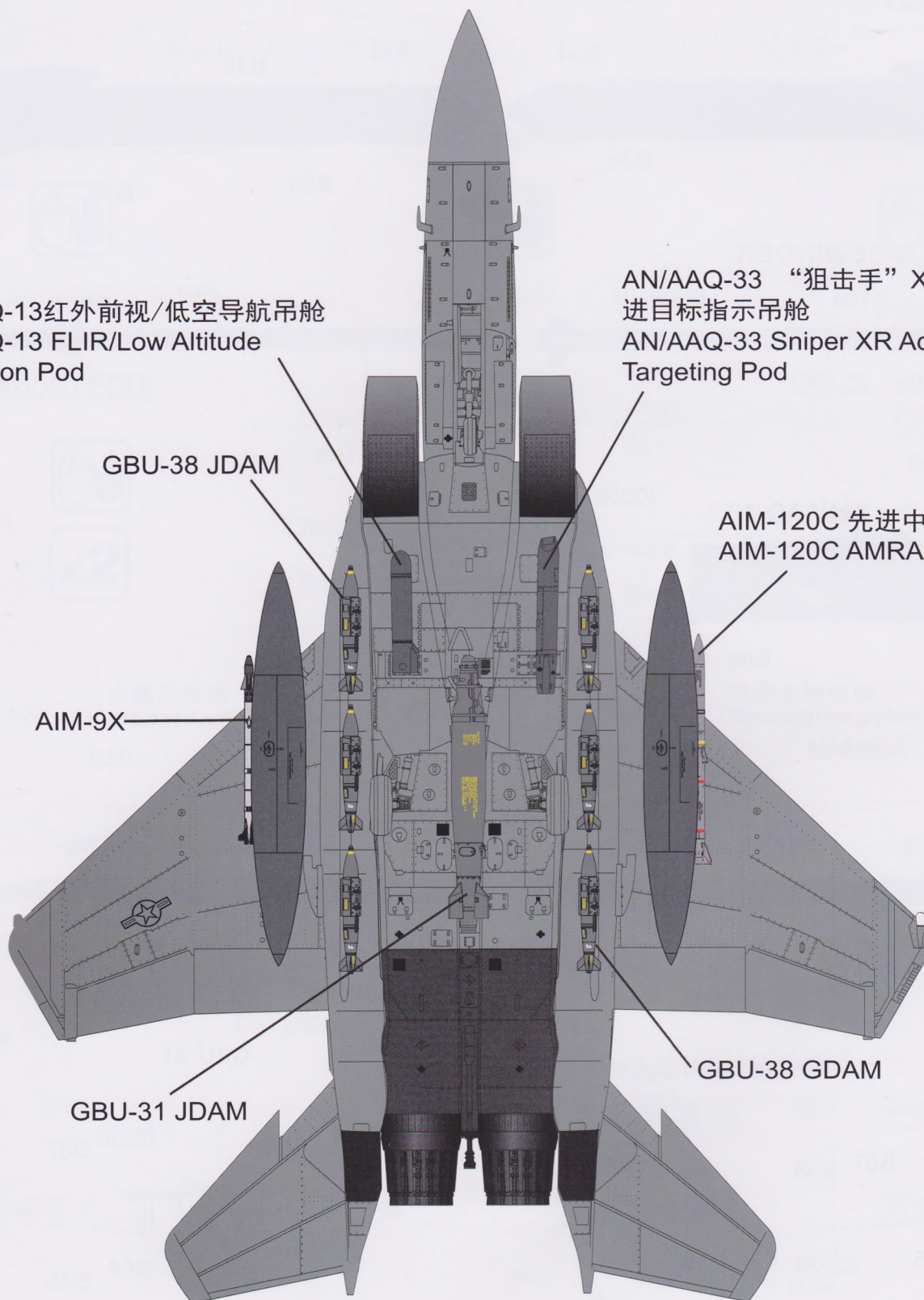



**D** 90-0237“战神阿瑞斯”，391战斗机中队，2018-2019  
 90-0237“Ares”，391st FS，2018-2019

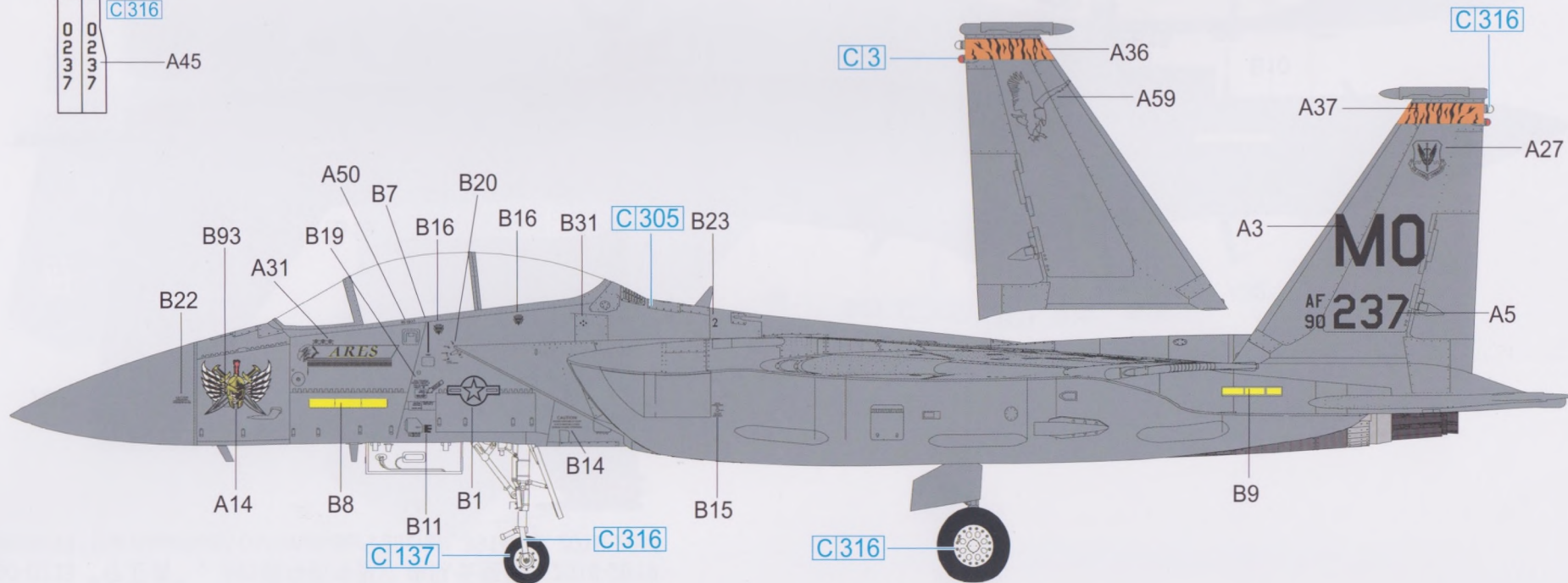
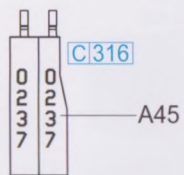
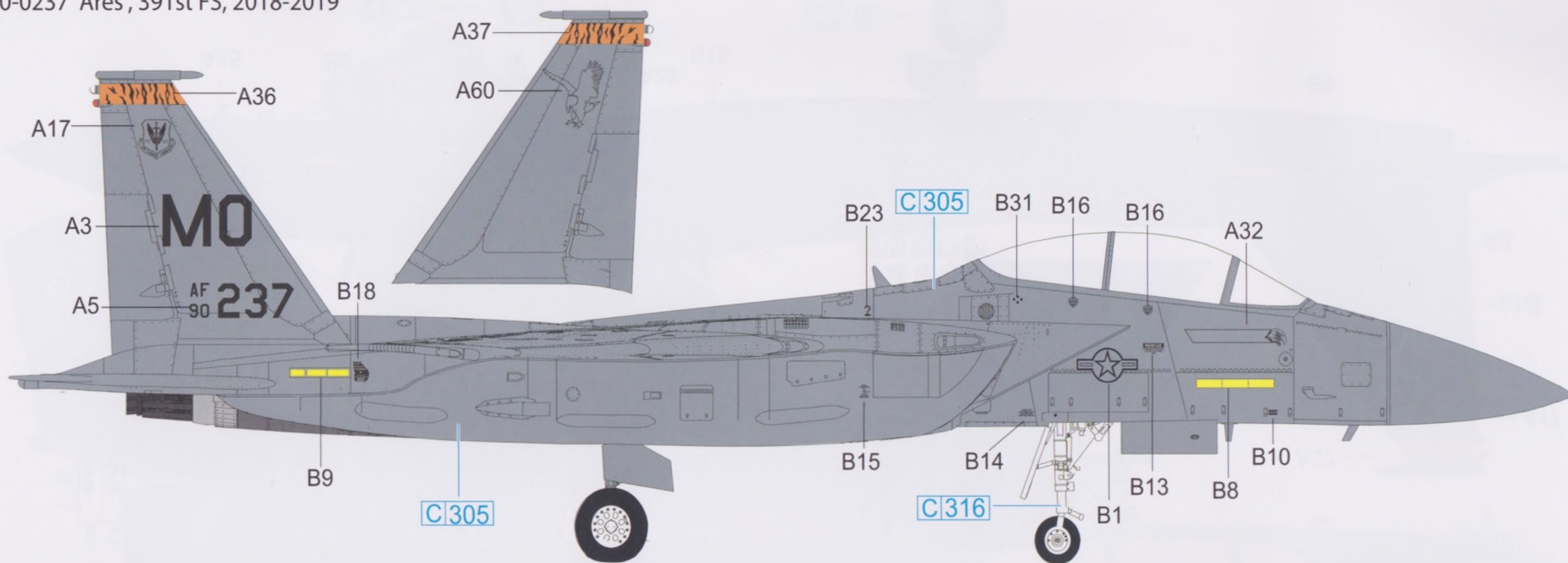



**E** 90-0233 “守护者”，391战斗机中队，中队长座机，2018-2019  
 90-0233 “The Guardian”, commander's aircraft, 391st FS, 2018-2019

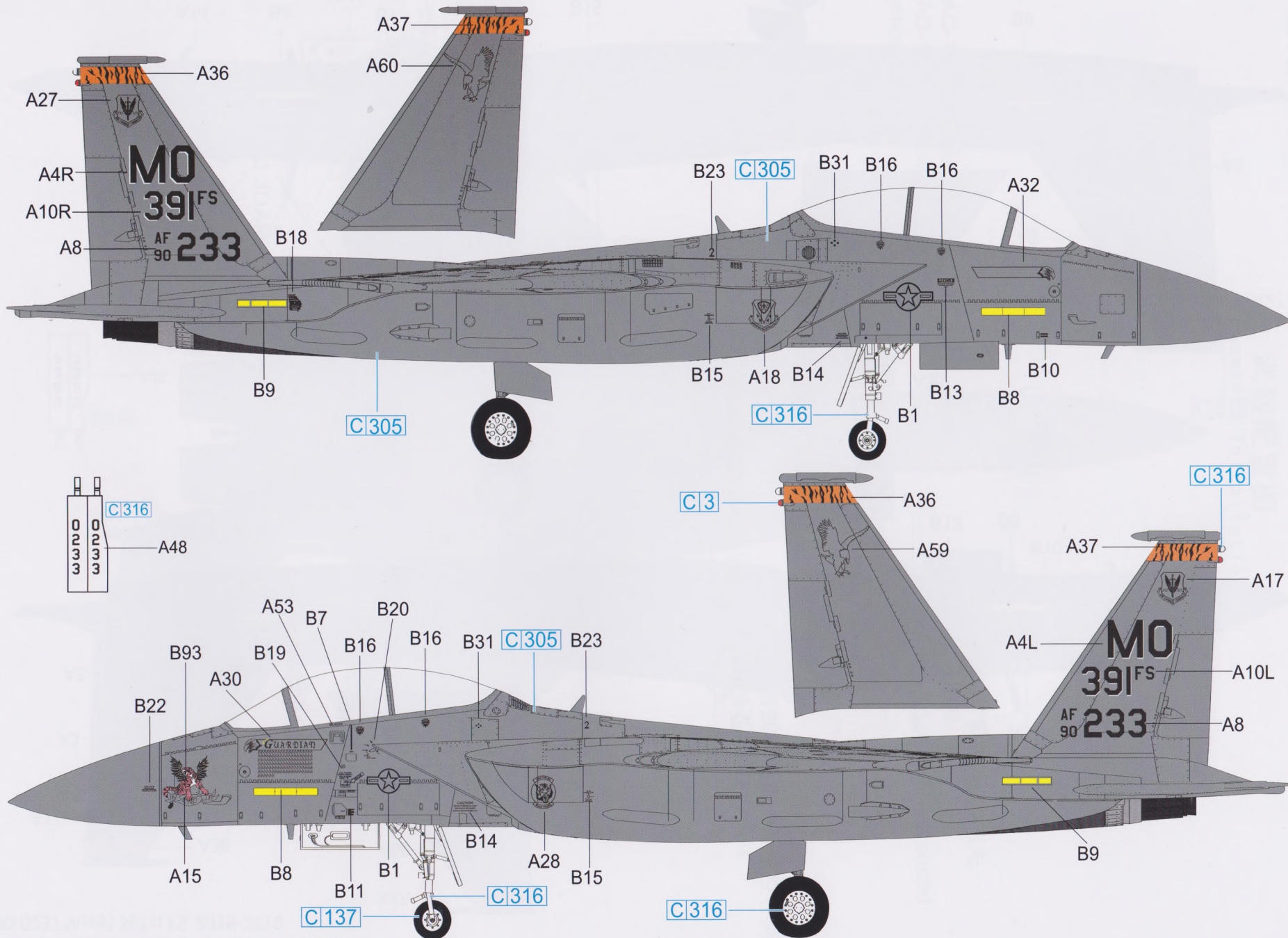



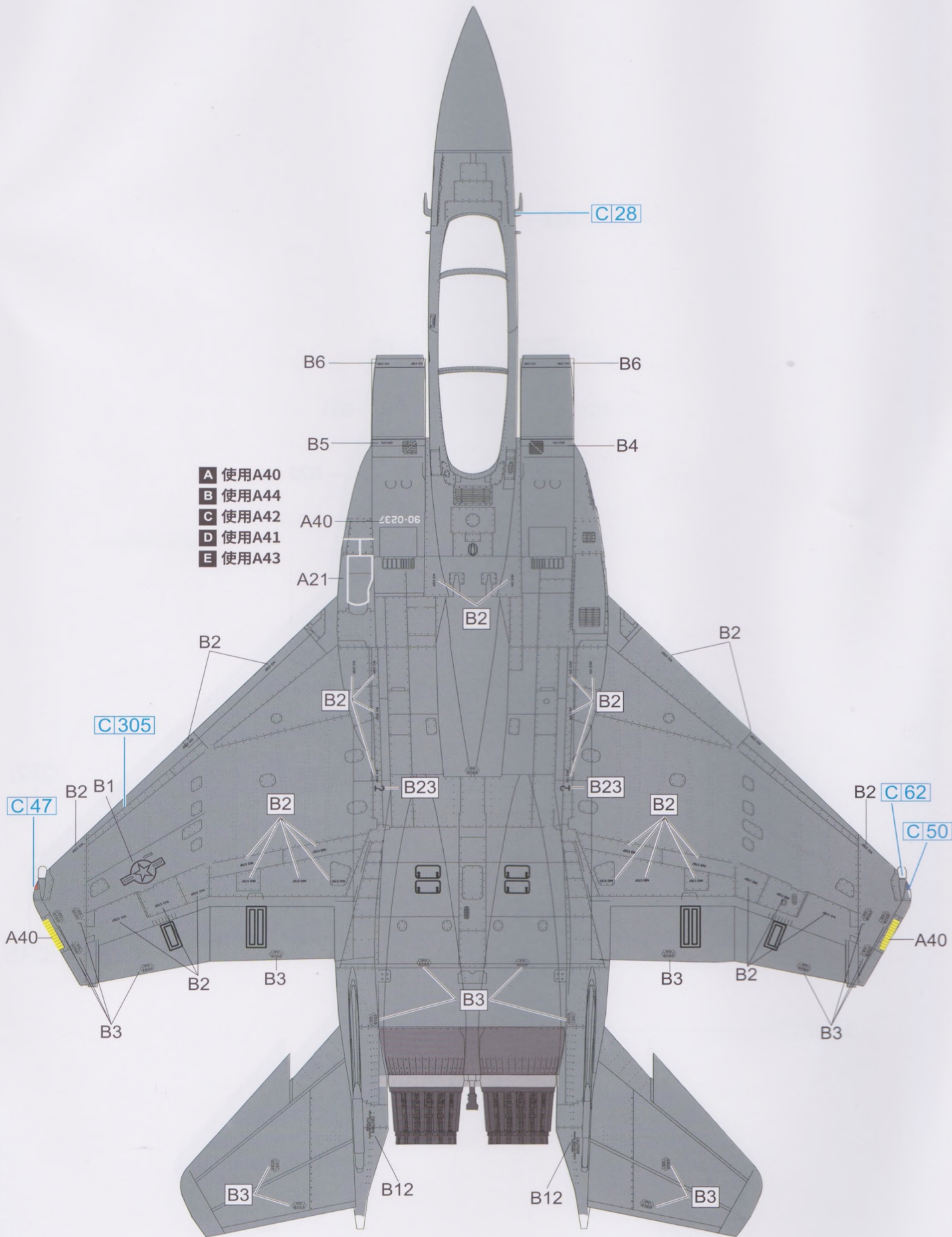



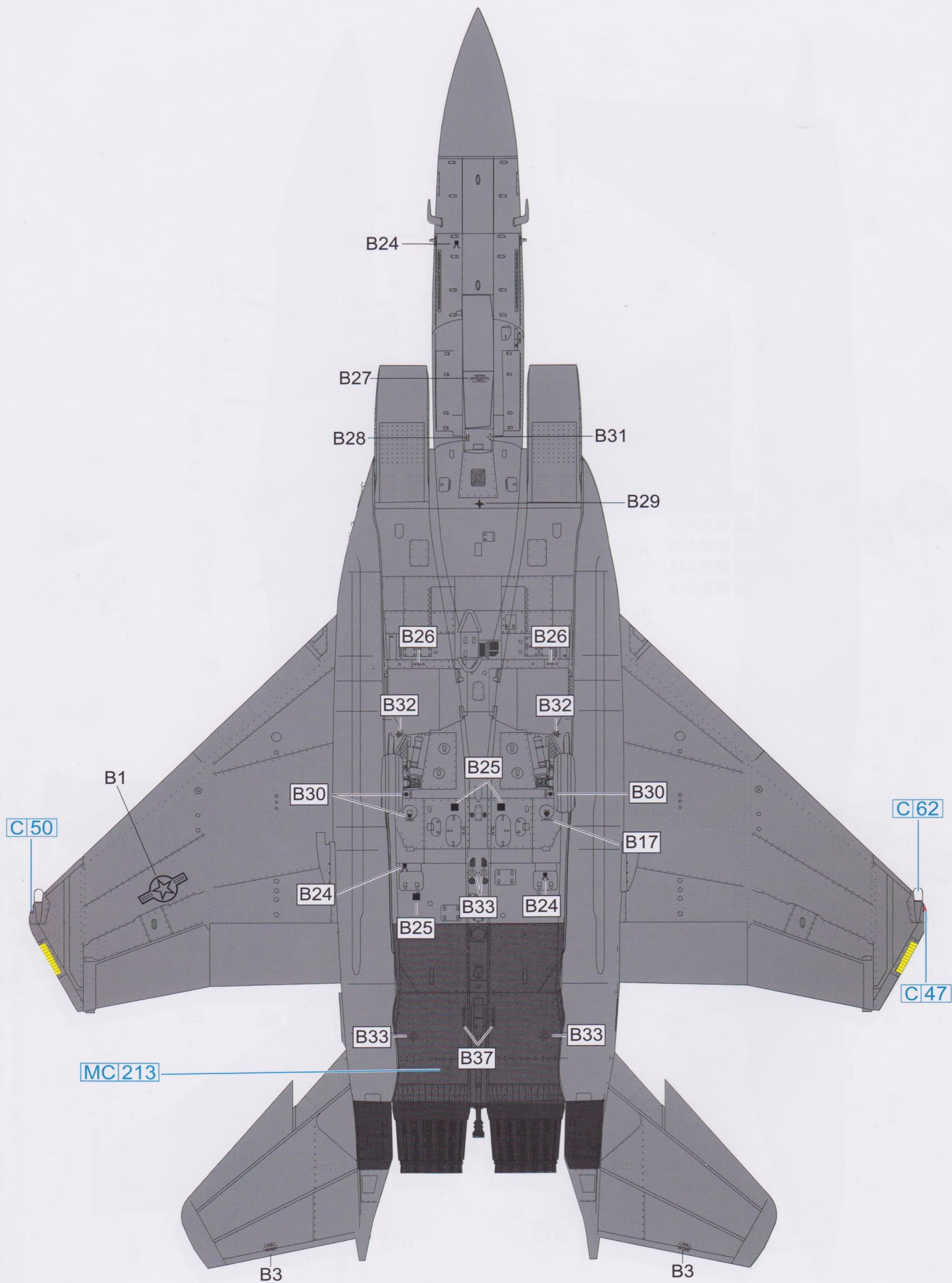





**A** 91-1326 “破坏”，48战斗机联队，494中队，2018年10月  
91-1326 “Ravage”, 494th FS, 48th FW, Oct 2018

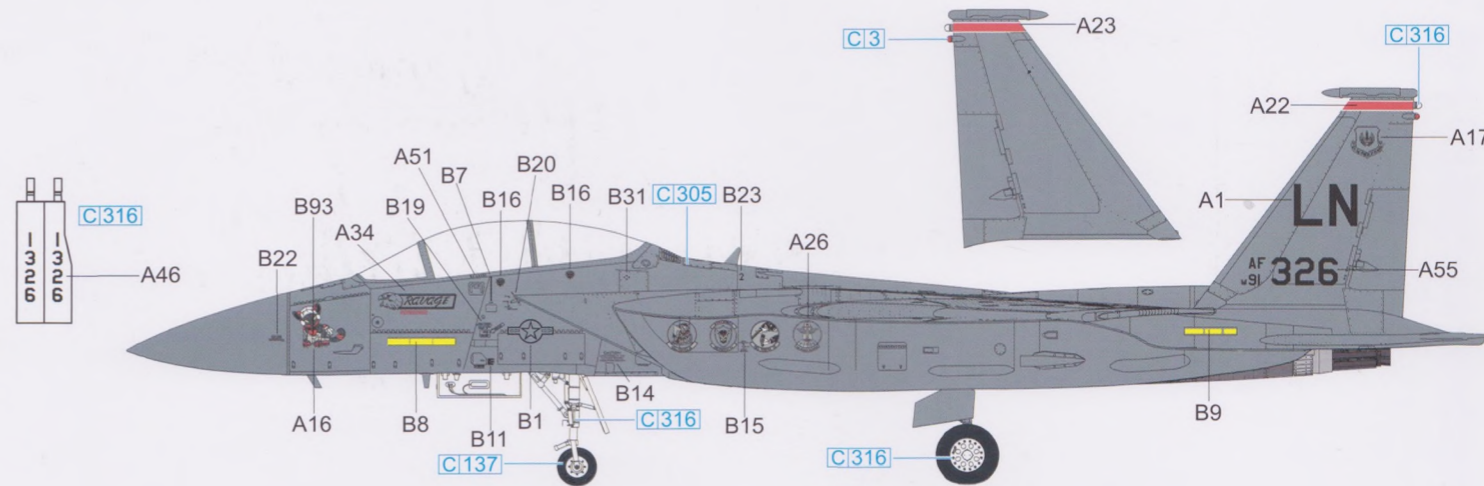
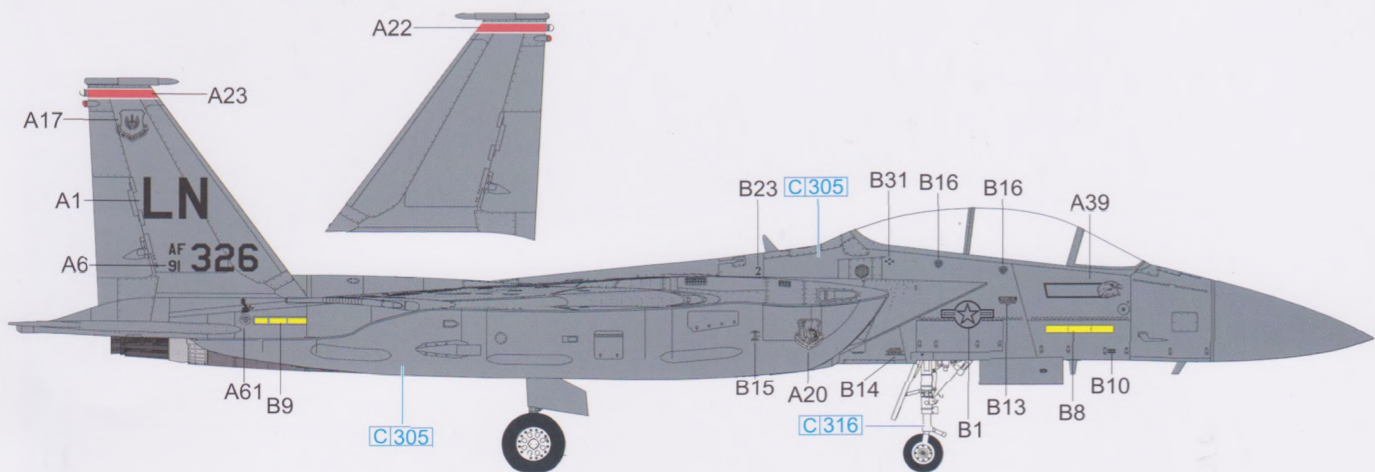

**B** 91-0311 “自由女神”，48战斗机联队，48战斗机联队，494中队，联队长座机，2018年10月  
91-0311 “Lady Liberty”, Commander's aircraft, 494th FS, 48th FW, Oct 2018

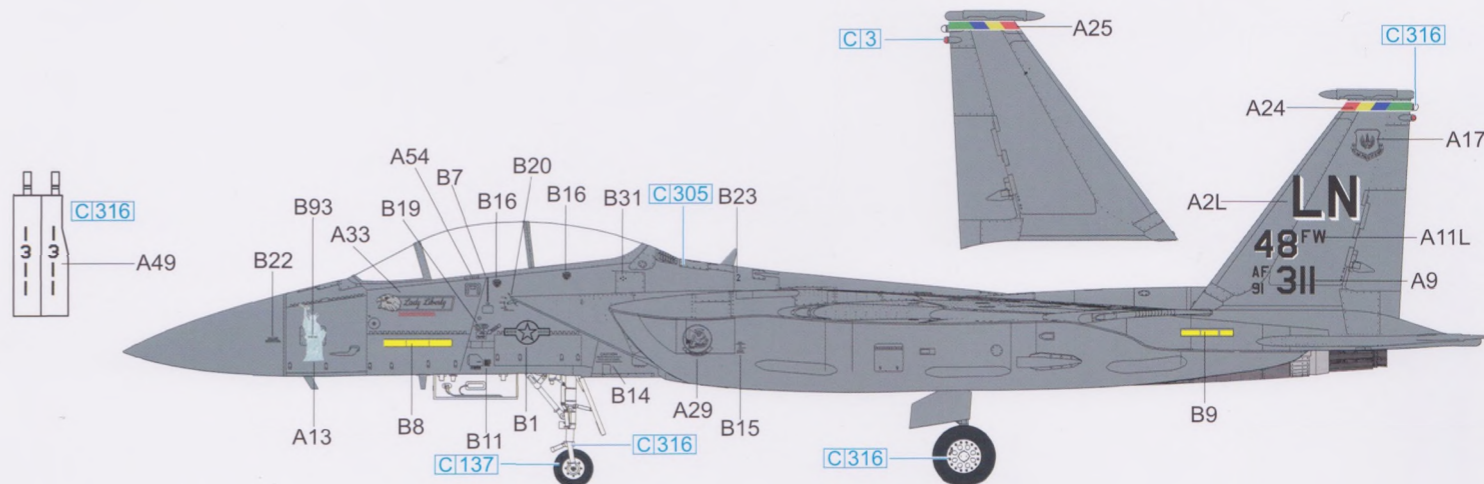
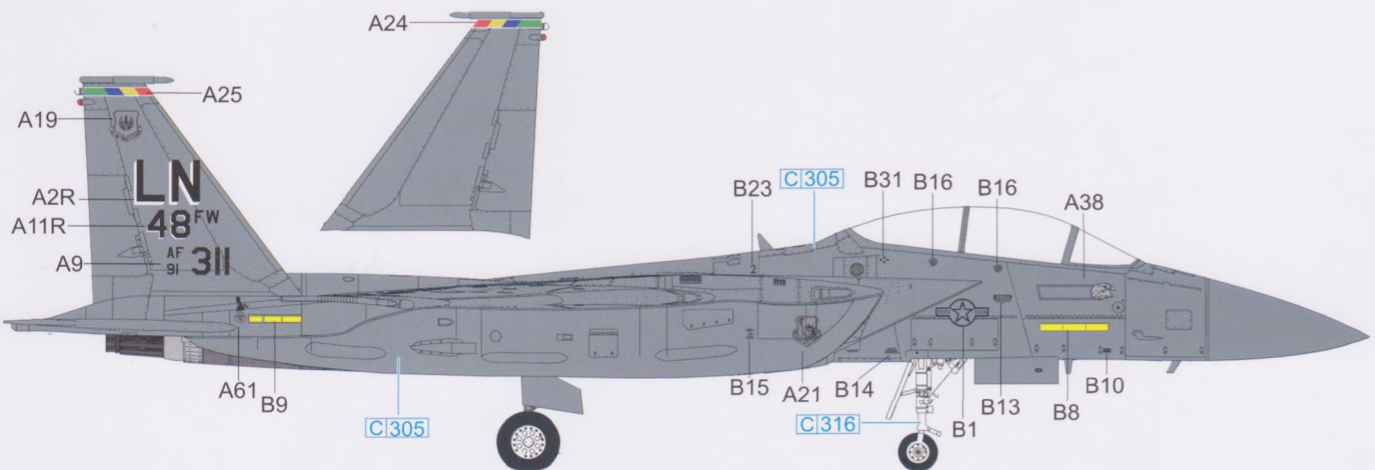

**C** 96-0204 “2-Oh-40-oz”，48战斗机联队，494中队，2018年10月  
96-0204 “2-Oh-40-oz” 494th FS, 48th FW, Oct 2018

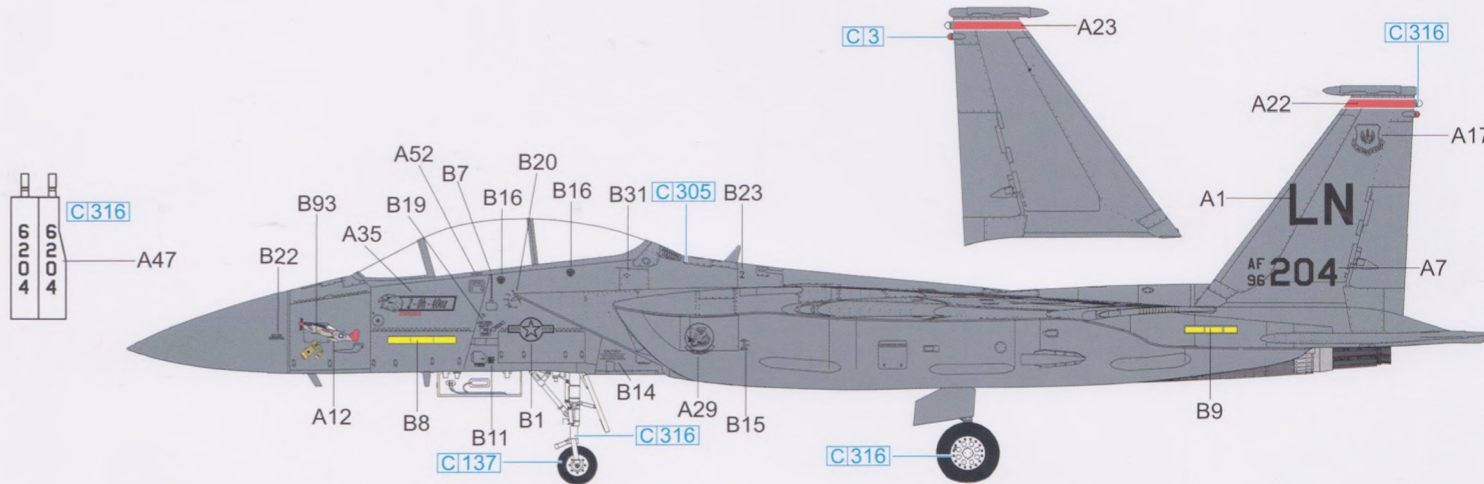
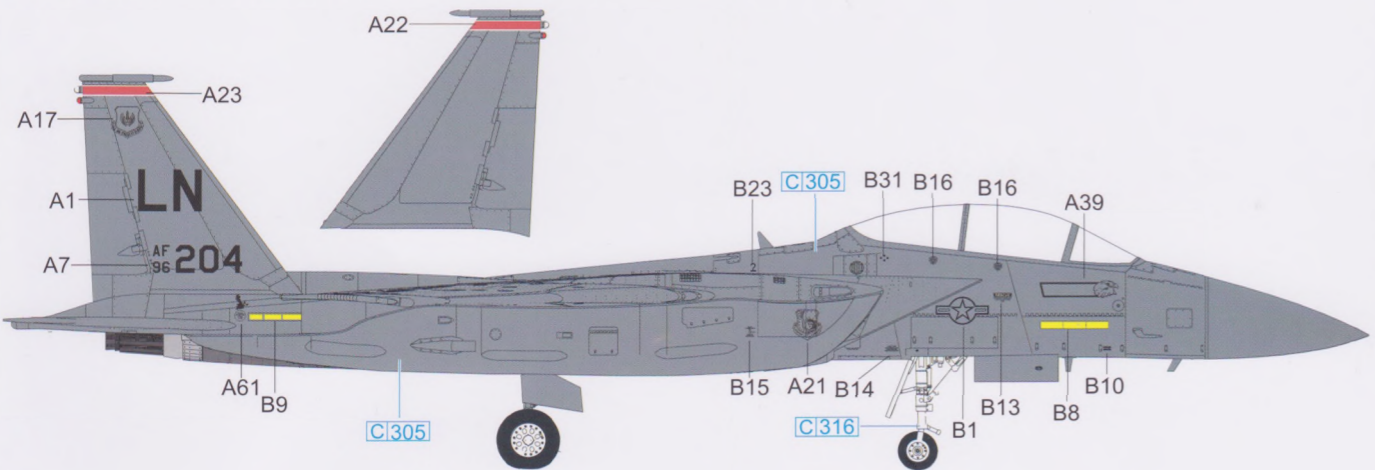



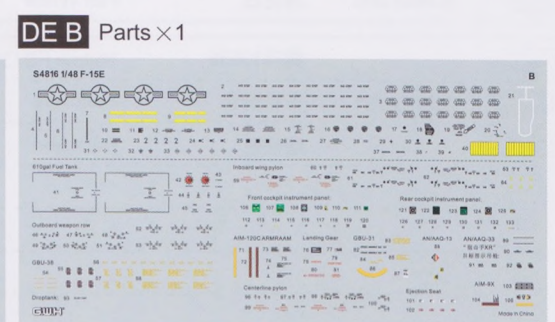
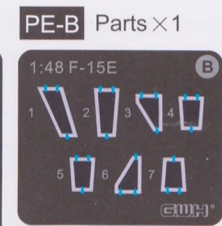
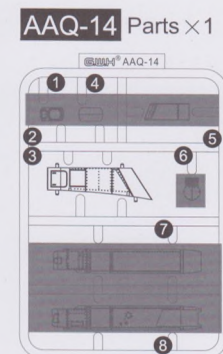
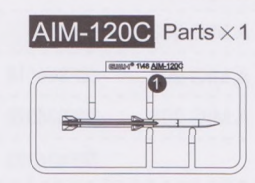
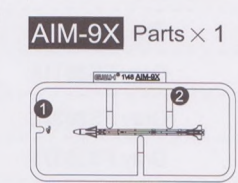
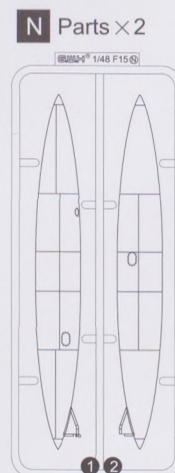
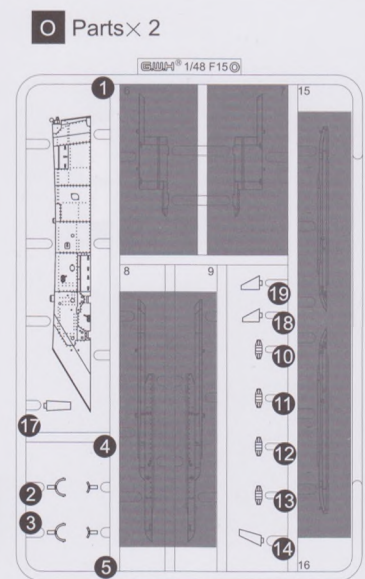
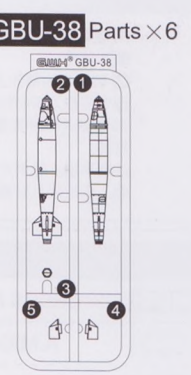
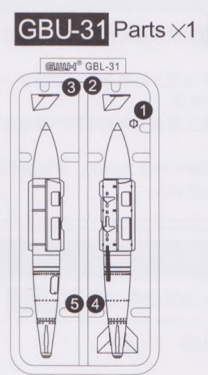
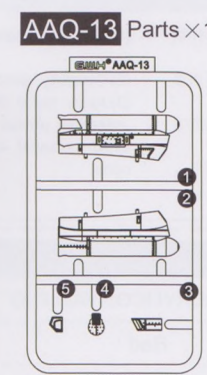
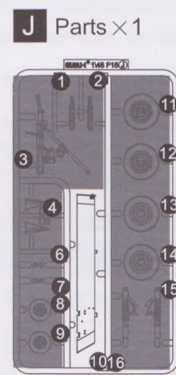
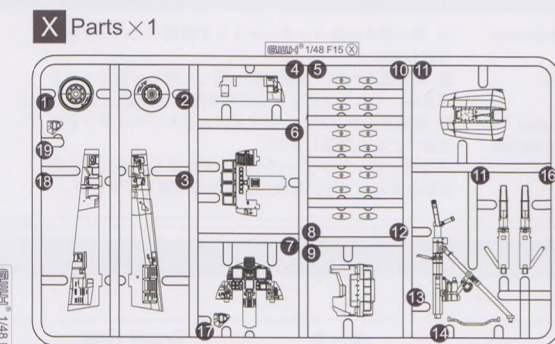
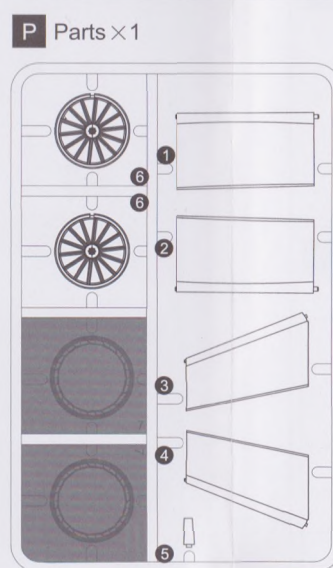
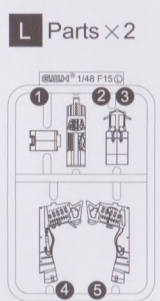
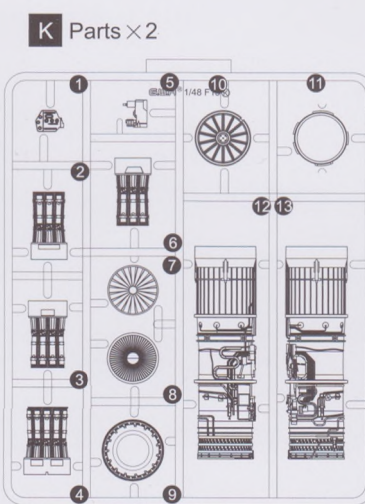
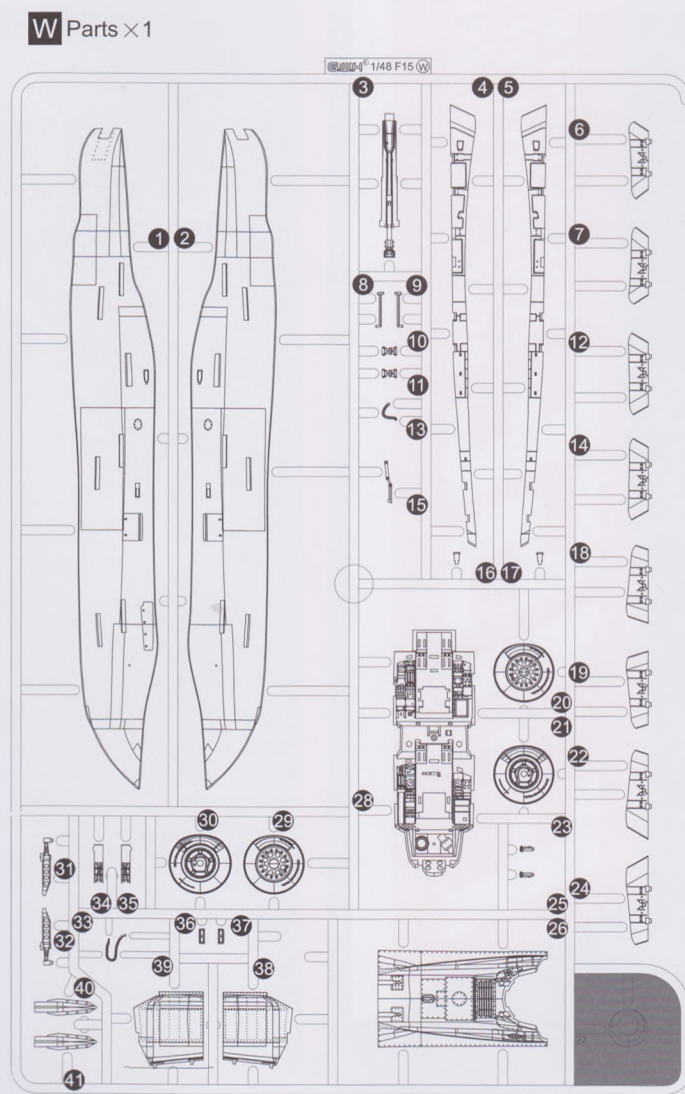
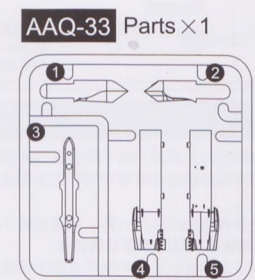
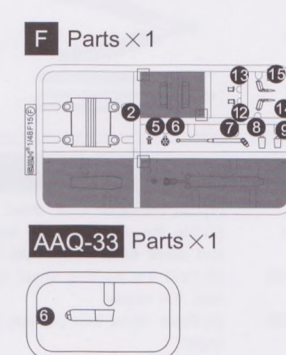
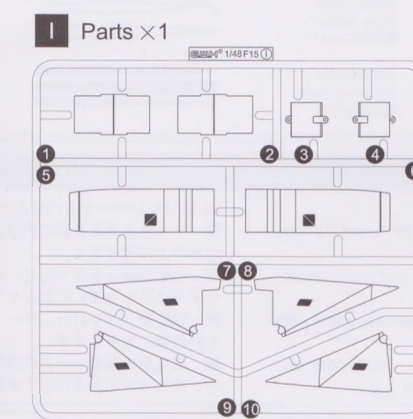
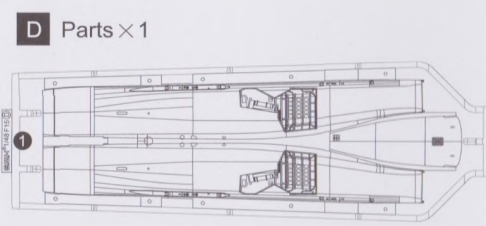
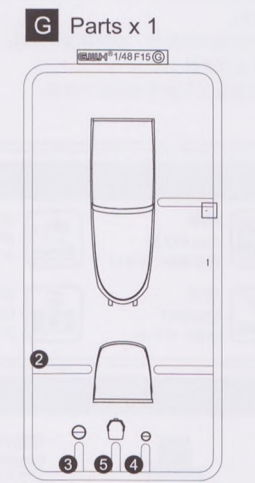
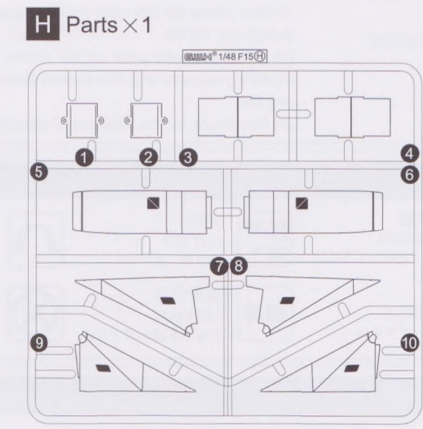
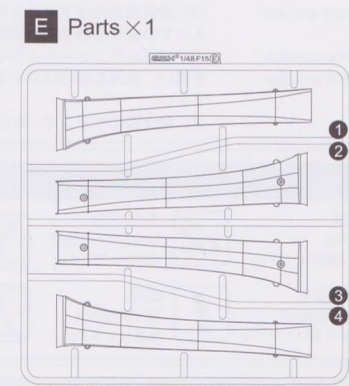
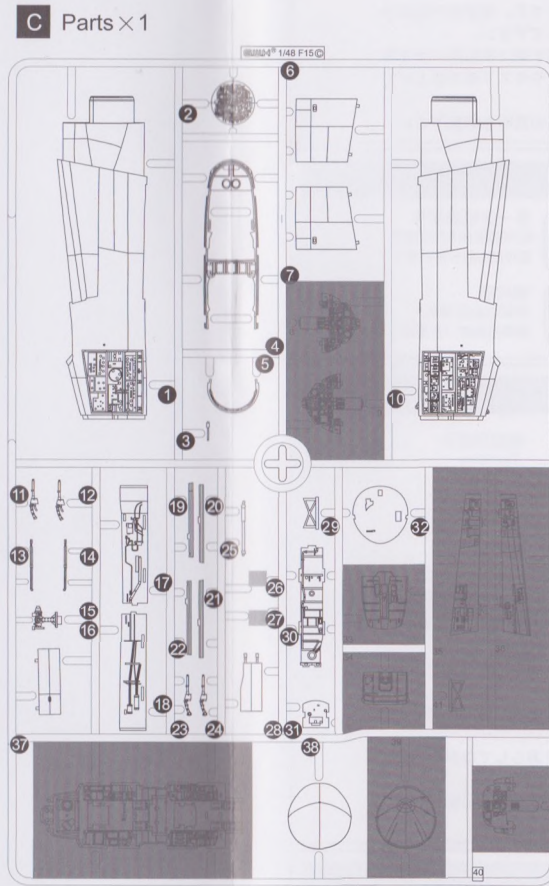
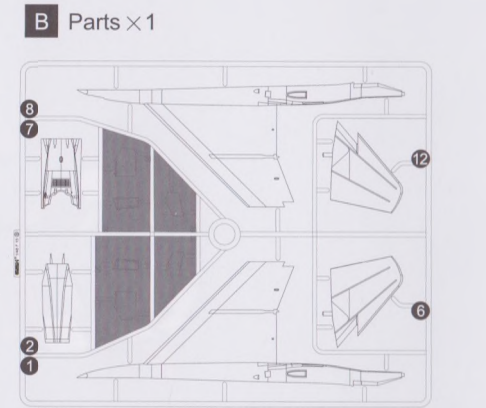
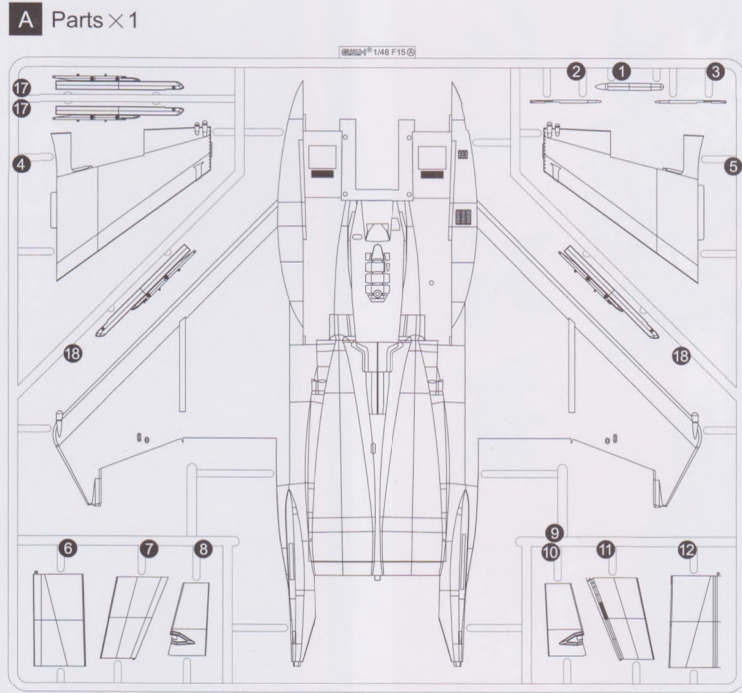



注意事項 CAUTION 組み立てのご注意

- (1) 勿于近火处使用胶水或油漆, 并打开窗户保持空气流通。
- (2) 涂料的号码请参考本栏以下的说明。本品本身不包括胶水和涂料。
- (3) 自板件中取出部件时, 应用模型专用剪, 并用介刀或小锉除去多余胶料。
- (4) 各图形的含义可参考本栏以下说明。

- (1) When you use glue or paint, do not use near a open flame, and use in a well-ventilated room.
- (2) See below for the color list. Glue and paint are not included in the kit.
- (3) When you take parts off the runner frame, use the modeling scissors and trim excess plastic with a cutter or a file.
- (4) See below for the meaning of symbols.

- (1) 接着剂や塗料は火の近くで使わないで下さい、使用の際は換気をよくして下さい。
- (2) 塗料指定のは下記のとおりです、接着剂や塗料は入っていませんので別に求めて下さい。
- (3) 部品のランナーから切り離す時は模型用ハサミ等を使い、余分な部分はカッターやヤスリ等で仕上げして下さい。
- (4) 組立図のサインマークは下の説明を御覧下さい。

图形含义 CAUTION マーク

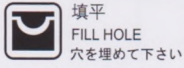

填平  
FILL HOLE  
穴を埋めて下さい



水印粘纸  
APPLY DECAL  
デカールを貼って下さい



切除  
CUT OFF  
切り取って下さい



弯折  
BEND  
折り曲げて下さい



制作两组  
MAKE TWO SET  
2個作って下さい



另一側相同制作  
DO THE SAME ON THE OPPOSITE  
反対側も取り付けます



胶水  
CEMENT  
接着して下さい



钻孔  
OPEN HOLE  
穴を開けて下さい



选择使用  
OPTIONAL  
どちらを選んで下さい



不用胶水  
NO CEMENT  
接着しないで下さい



注意  
BE CAREFUL  
注意して下さい



瞬间胶  
INSTANT GLUE FOR METAL  
瞬間接着剂(金属用)

所使用工具 RECOMMENDED TOOLS 専用工具

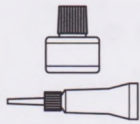

塑胶件用模型胶水  
Cement  
プラスチック用接着剂

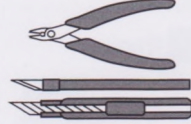

模型用剪钳  
Side cutters  
模型用ニッパー

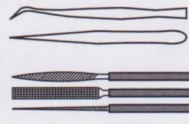

模型用镊子  
Tweezers  
ピンセット



模型用瞬间胶水  
Instant Cement  
瞬間接着剂



模型用刻刀  
Modeling knife  
模型用ナイフ



模型用锉刀  
Diamond file  
模型用ヤスリ

水贴纸使用说明 DECAL APPLICATION スライドマークの貼り方

- (1) 用模型剪刀或刻刀切下所需的图案部分。
- (2) 将水贴纸浸泡在温水中10秒左右取出放置于戏水的干布上。
- (3) 手拿着水贴纸基的一角, 用模型镊子小心夹住浮起的水贴图案移至模型表面准确位置。
- (4) 用手指适当沾水均匀涂于水贴图案表面, 使其延展移动至精确位置。
- (5) 用柔软吸水的干布将水贴图案中的气泡向一边挤出, 使水贴在模型表面保持平整。

- (1) Cut off decal from sheet.
- (2) Dip the decal in tepid water for about 10 sec. and place on a clean cloth.
- (3) Hold the backing sheet edge and slide decal onto the model.
- (4) Move decal into position by wetting decal with finger.
- (5) Press decal down gently with a soft cloth until excess water and air bubbles are gone.

- (1) 貼りたいマークをハサミで切り抜きます。
- (2) マークをぬるま湯に10秒ほど浸してからタオル等の布の上に置きます。
- (3) 台紙のはしを手で持ち、貼るところにマークをスライドさせてモデルに移して下さい。
- (4) 指に少し水を付けてマークを濡らしてながら、正しい位置にずらします。
- (5) 柔らかい布でマークの内側の気泡を押し出しながら、押しつけるようにして水分をとります。

蚀刻片使用说明 PHOTO-ETCHED PARTS エッチングパーツ

- (1) 使用蚀刻片专用剪刀或模型专用刻刀将蚀刻片零件切割下待用。
  - (2) 切割下的零件上有蚀刻片的残留连接点部分, 使用模型专用锉刀细心打模干净。
  - (3) 蚀刻片部分在涂装之前必须使用专用的模型金属底漆打底。
- 注意事项: 蚀刻片很薄外延较为尖锐, 有刮伤手的可能, 在使用之时请务必小心。

- (1) Cut off photo-etched parts using a modeling knife.
  - (2) Carefully remove any excess using a file.
  - (3) Apply metal primer prior to painting.
- Attention, please: Extra care should be taken to avoid personal injury when handling photo-etched parts.

- (1) 切り離す時はカッターナイフを使用してパーツを切り離します。
  - (2) 切り出した時、部品に出張った部品が残っている場合は、ヤスリなどで丁寧に削り落とします。
  - (3) 塗装が必要なパーツは下地にメタルプライマーを吹き着けてから塗装します。
- ご注意: エッチングパーツは大変薄く、手などを切り恐れがあります。取扱いには十分注意して下さい。

涂装色表 PAINT REQUIRED カラー番号リスト

■ C000 GSI CREOS Mr.COLOR ■ 00-000 ACRYLICOS VALLEJO ■ FS00000 联邦色号

C3	A.MIG 049	红	Red
C8		亮光银	Bright Silver
C28	A.MIG 191	黑铁色	Steel
C33		消光黑	Flat Black
C47	A.MIG 093	透明红	Clear Red
C50	A.MIG 098	透明蓝	Clear Blue
C57		青竹色	Metallic Blue Green
C62	A.MIG 050	消光白	Flat White

C66		青竹色	Bright Green
C137	A.MIG 033	轮胎黑	Tire Black
C305	A.MIG 204	灰FS36118	Gray FS36118
C307	A.MIG 208	灰FS36320	Gray FS36320
C308		灰FS36375	Gray FS36375
C316	A.MIG 047	白FS17875	White FS17875
C317		灰FS36231	Gray FS36231
C318		雷达罩色	Radome

C329		黄FS13538	Yellow FS13538
MC213	A.MIG 191	不锈钢色	Stainless
MC214		暗铁色	Dark Iron