

eduard
Express Mask

XS 195

V. Wellington

The die-cut mask for accurate canopy frame painting of the
MPM 1/72 KIT

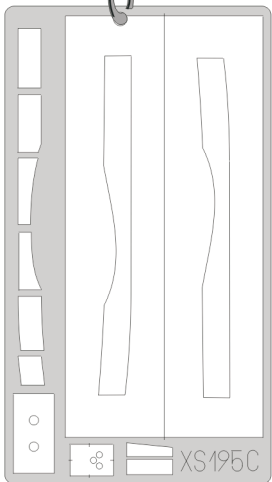
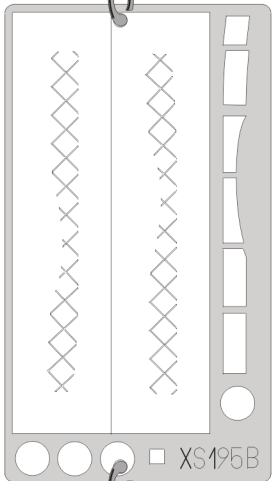
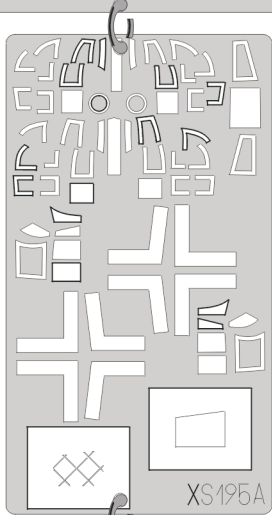

C15



2pcs



LIQUID MASK

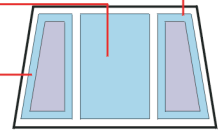
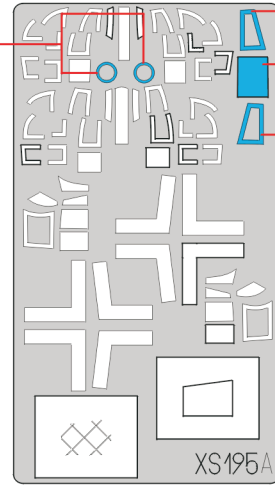

E5

C12

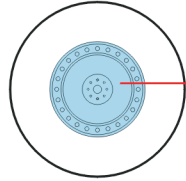

2pcs

C13

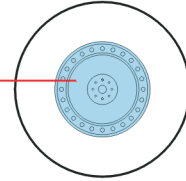

2pcs

E15



E10

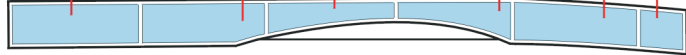

E6



E14

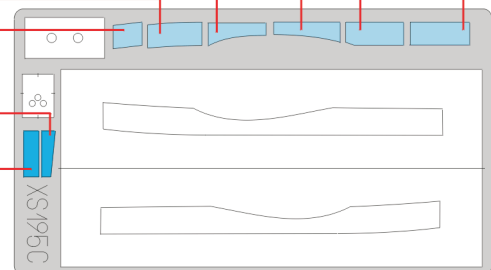
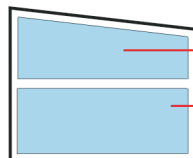

REFERENCES:

- Replika #19
- Replic #79/1998
- Flypast #12/1996

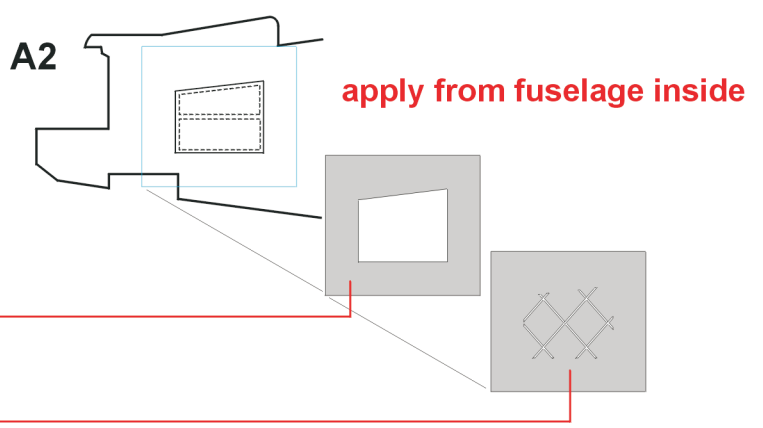
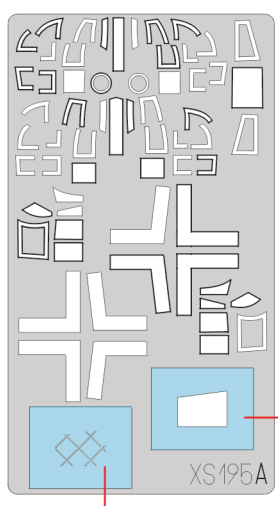
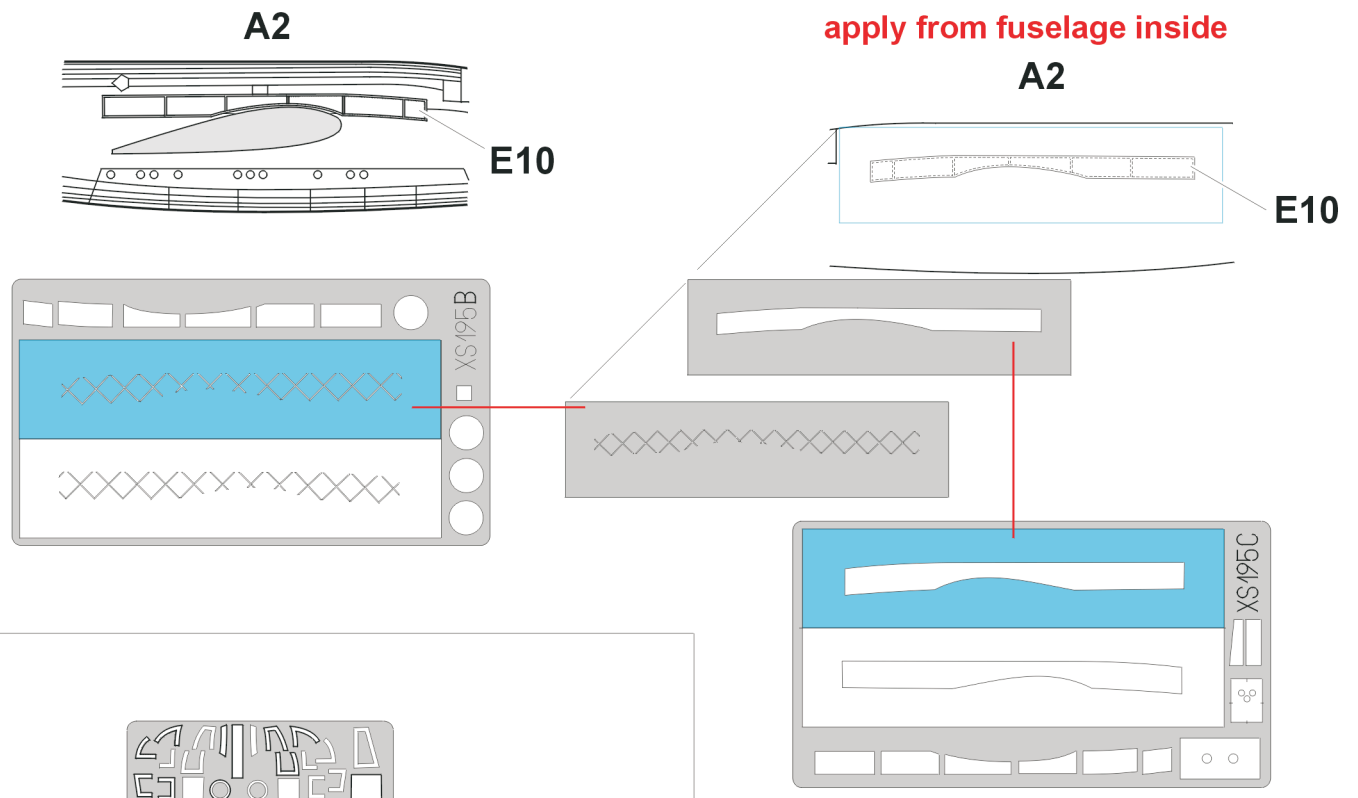
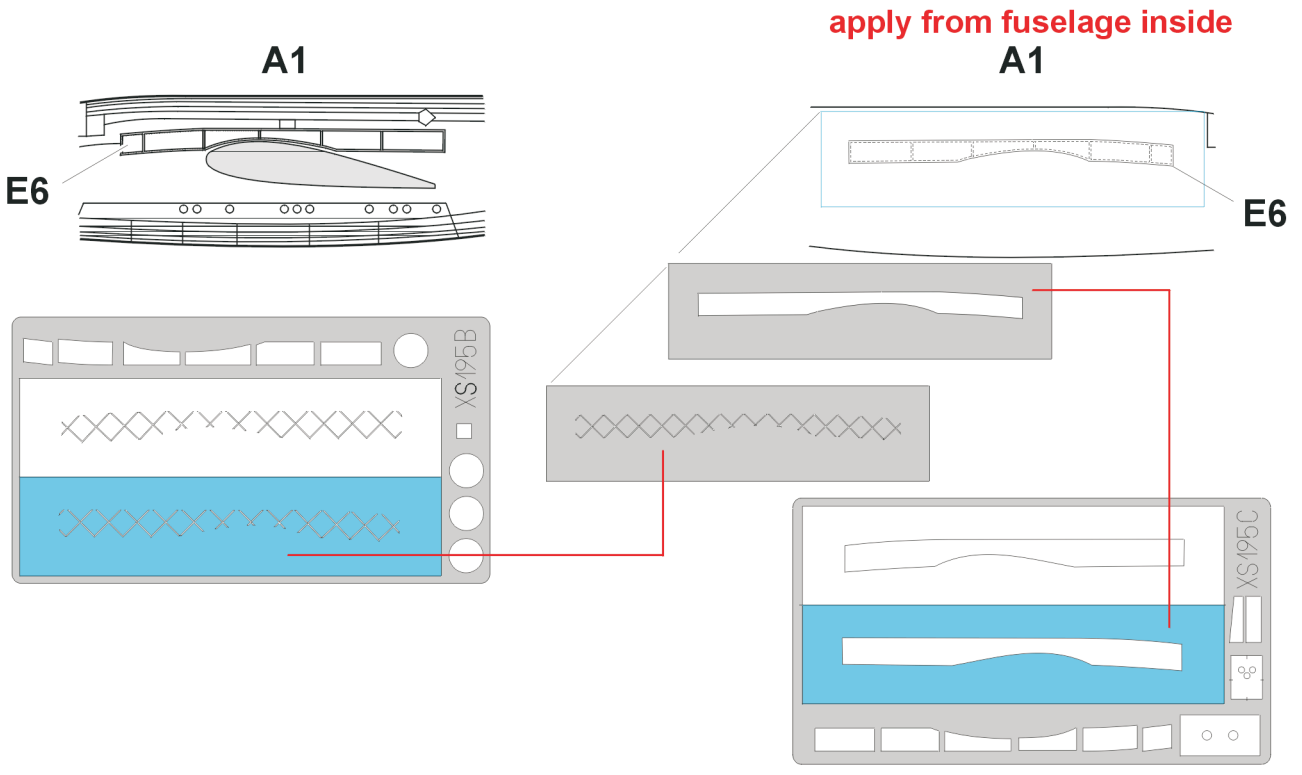

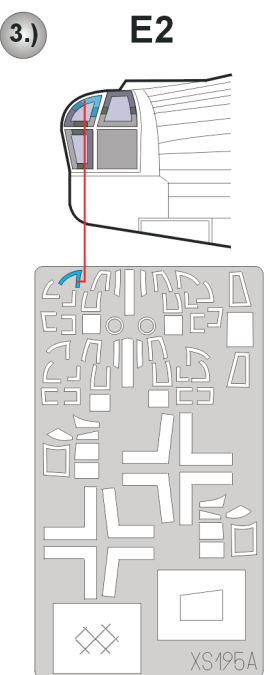
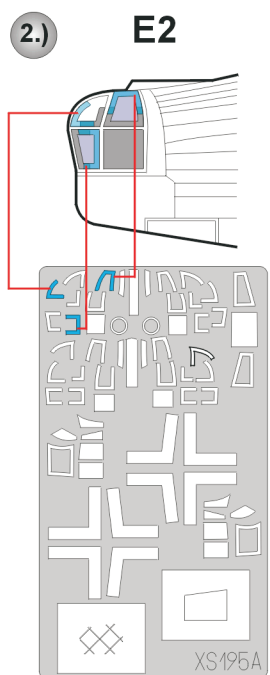
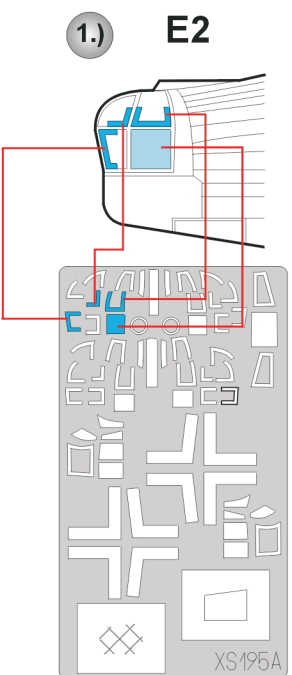
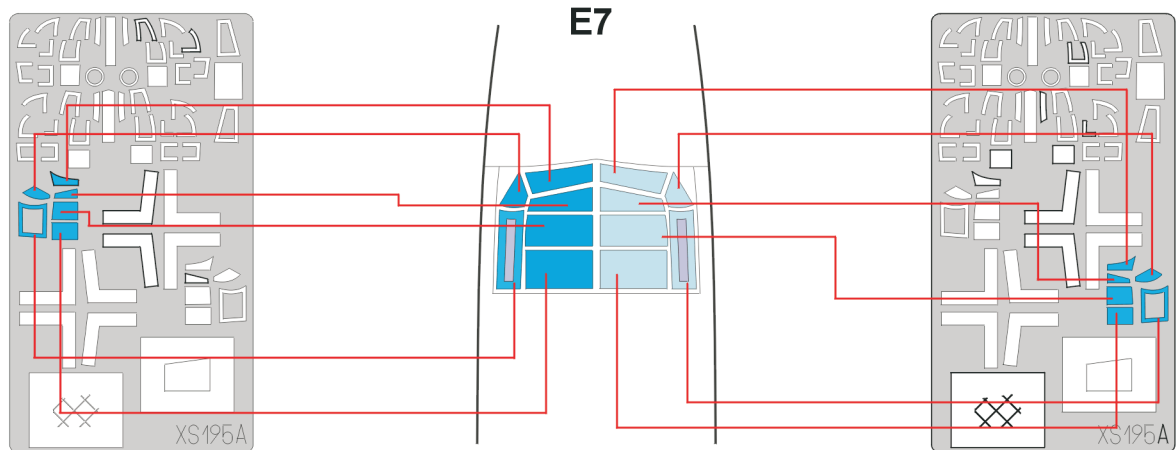
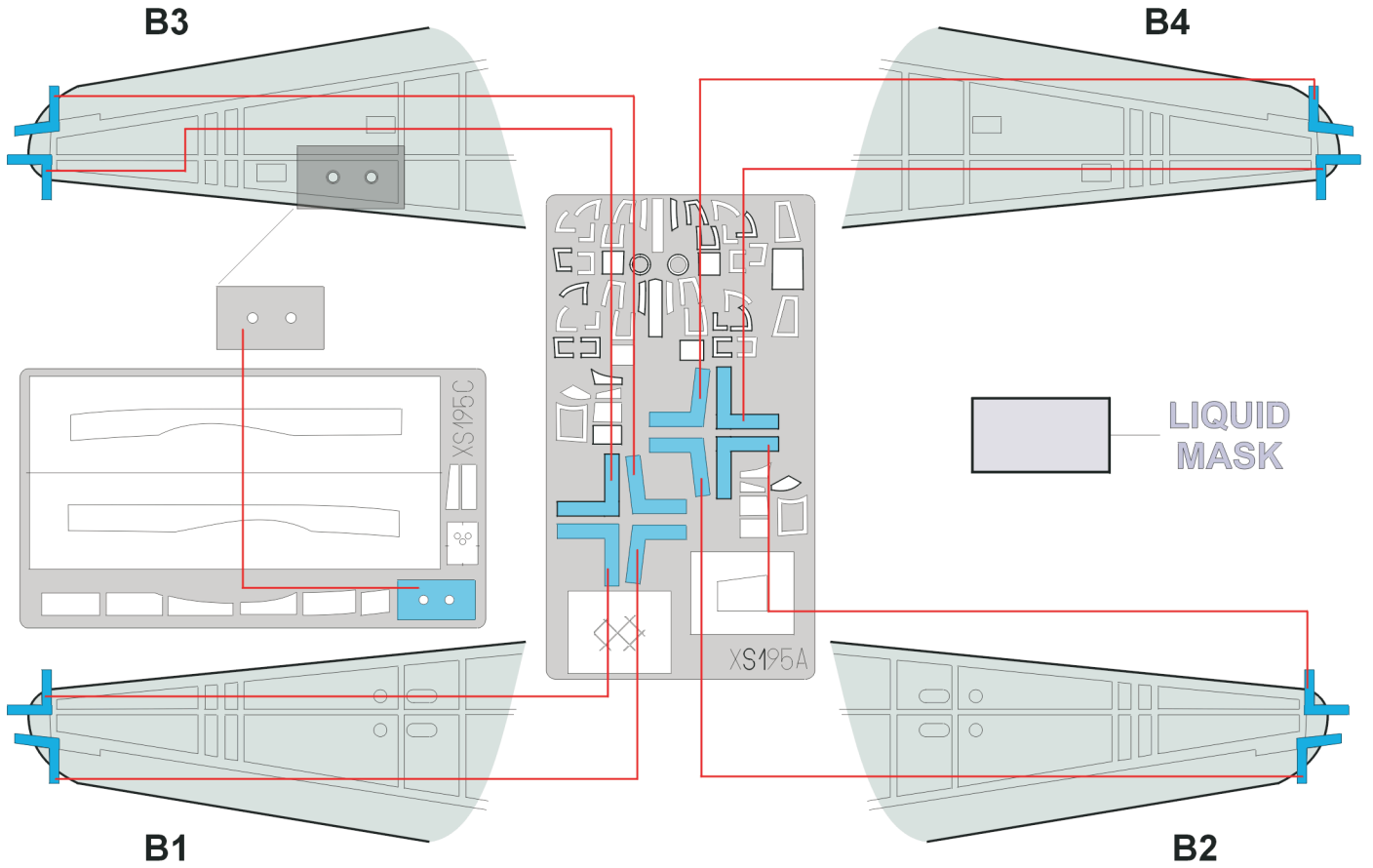

4.) E2

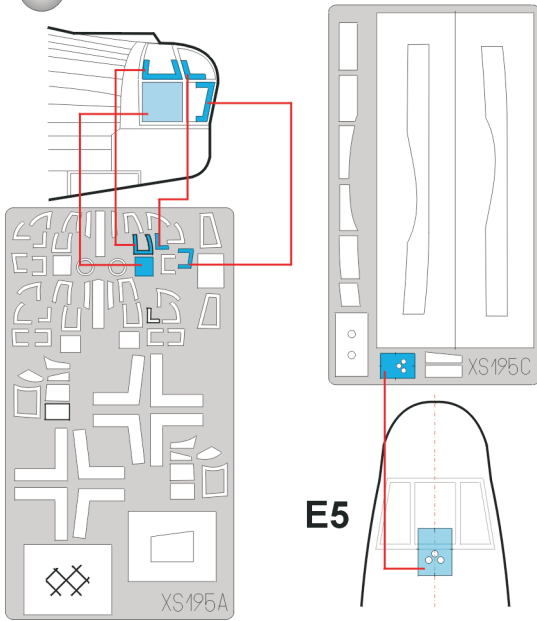

5.) E2

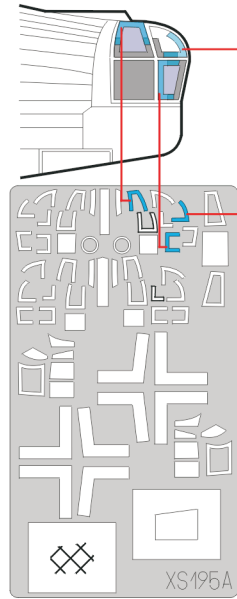

6.) E2

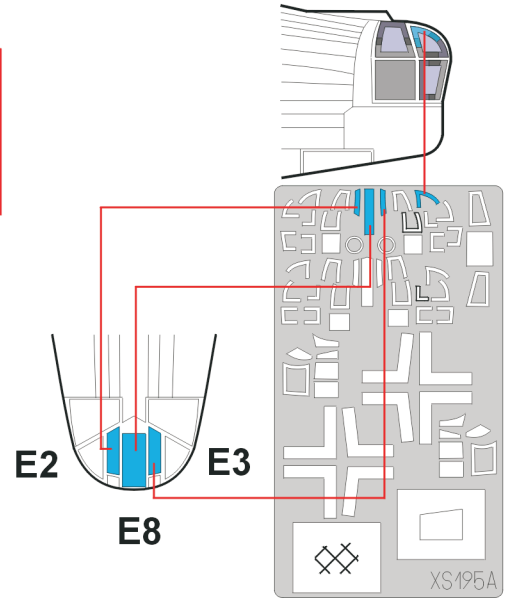

1.) E11

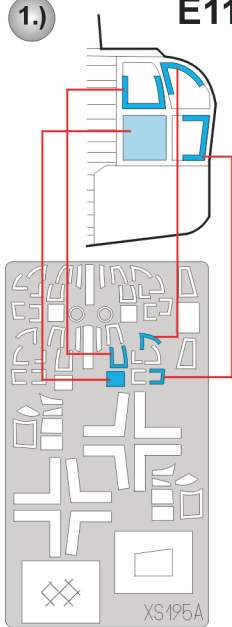

2.) E11

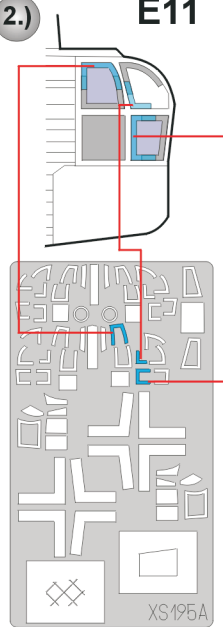

3.) E11

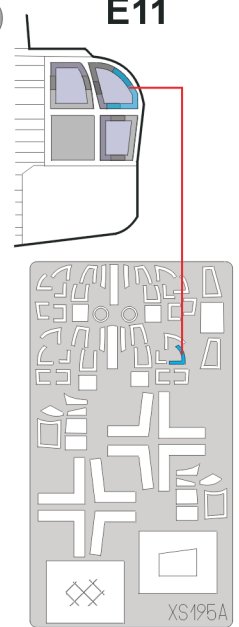

LIQUID MASK

4.) E12

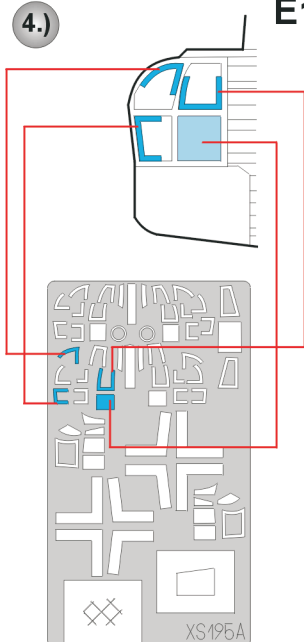

5.) E12

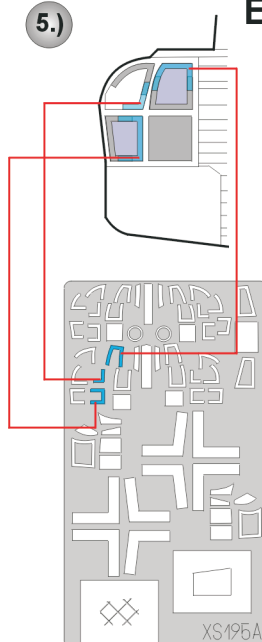

6.) E12

