

## 1/72 Scale

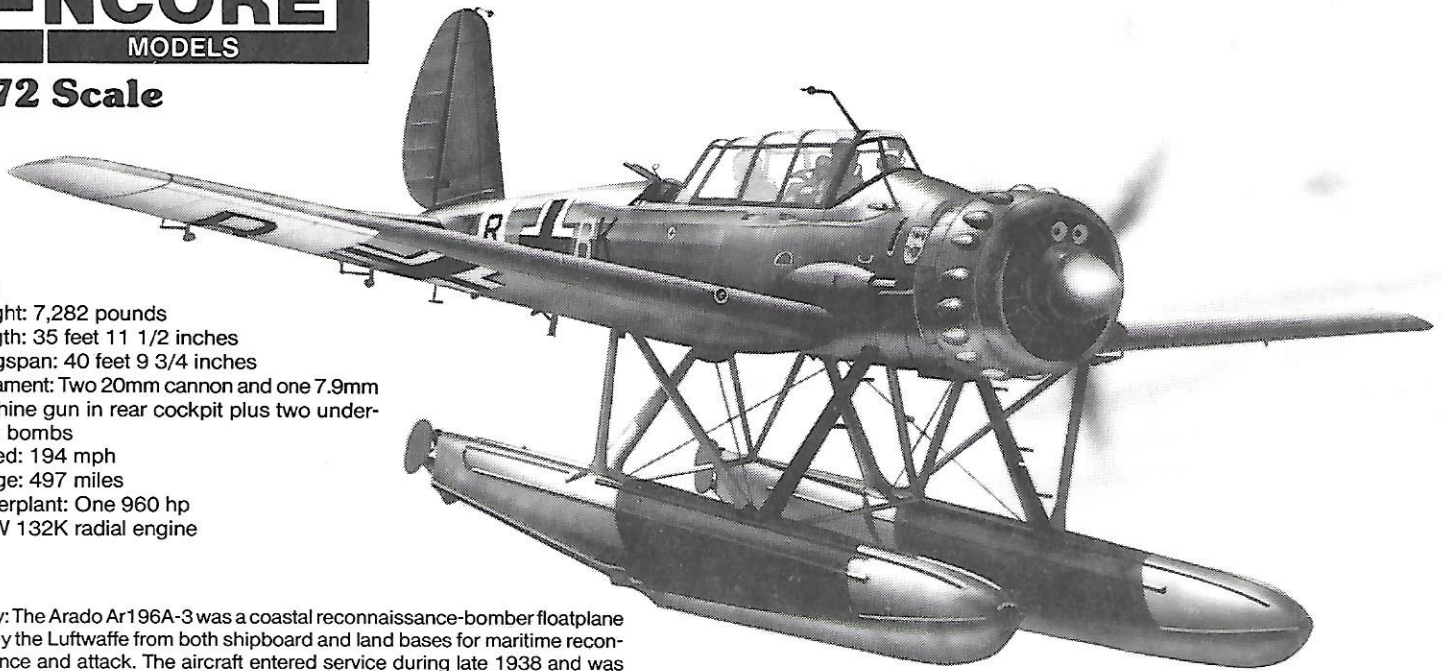

**DATA:**

- Weight: 7,282 pounds
- Length: 35 feet 11 1/2 inches
- Wingspan: 40 feet 9 3/4 inches
- Armament: Two 20mm cannon and one 7.9mm machine gun in rear cockpit plus two underwing bombs
- Speed: 194 mph
- Range: 497 miles
- Powerplant: One 960 hp BMW 132K radial engine

History: The Arado Ar196A-3 was a coastal reconnaissance-bomber floatplane used by the Luftwaffe from both shipboard and land bases for maritime reconnaissance and attack. The aircraft entered service during late 1938 and was used throughout the war. The Ar196A-3 was used by the Luftwaffe, Bulgarian and Romanian Air Forces.

### Step 1 Engine

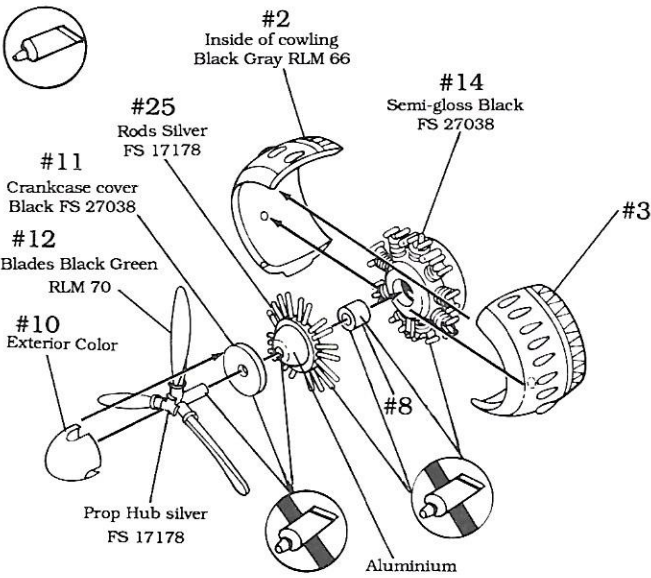

### Step 2 Fuselage

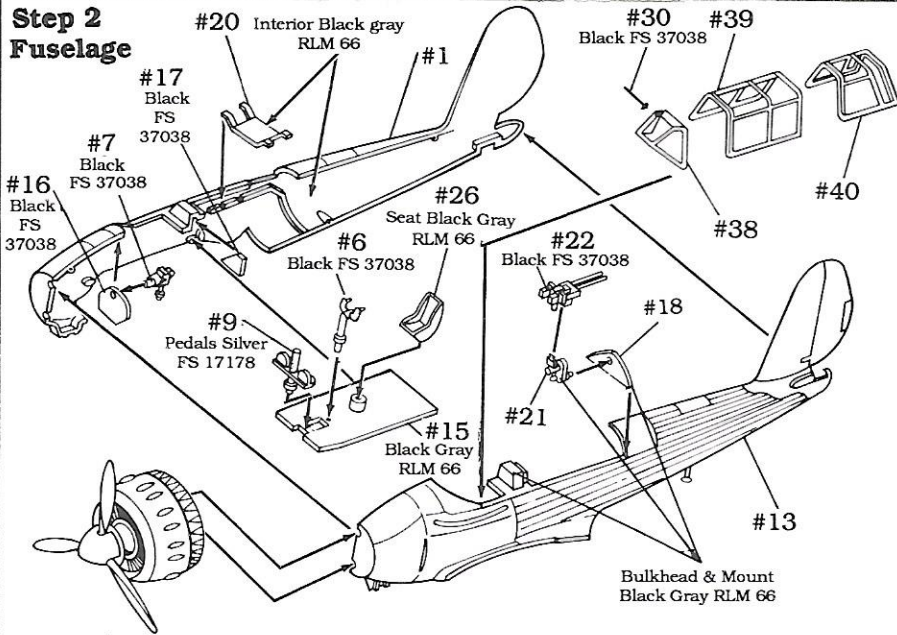

### ASSEMBLY LEGEND

- |                        |                  |                                |                    |                   |
|------------------------|------------------|--------------------------------|--------------------|-------------------|
| <b>Cement Together</b> | <b>Remove</b>    | <b>Fill Hole</b>               | <b>Apply Decal</b> | <b>Be Careful</b> |
| <b>Do Not Cement</b>   | <b>Open Hole</b> | <b>Repeat Right &amp; Left</b> | <b>Optional</b>    | <b>Omit</b>       |

# Step 3 Final Assembly



Use thread or fine wire for aerial antenna

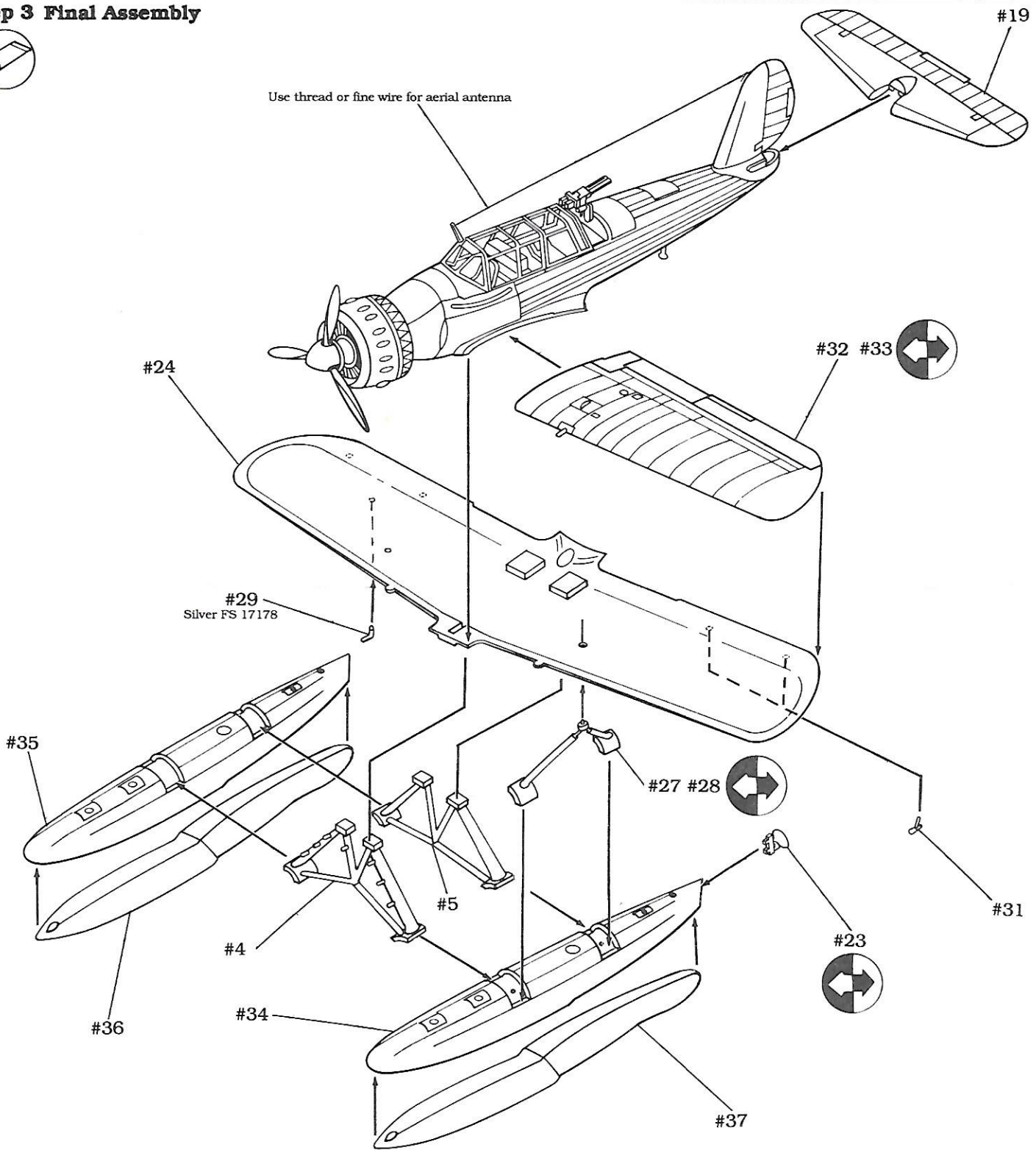

Luftwaffe  
DECAL LOCATIONS 1-21

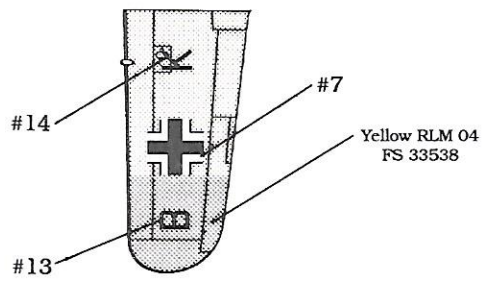
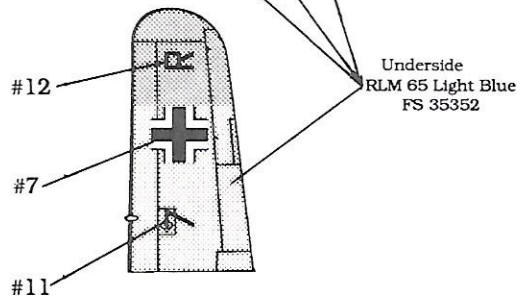
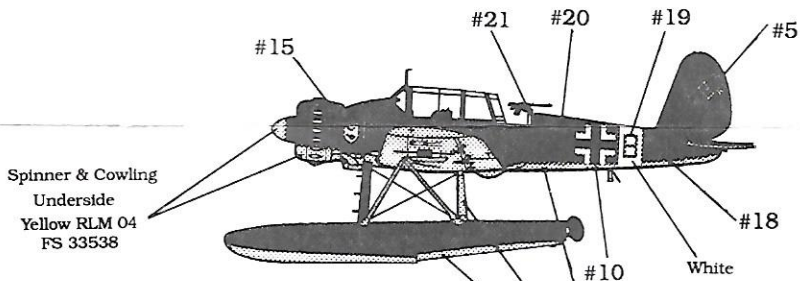
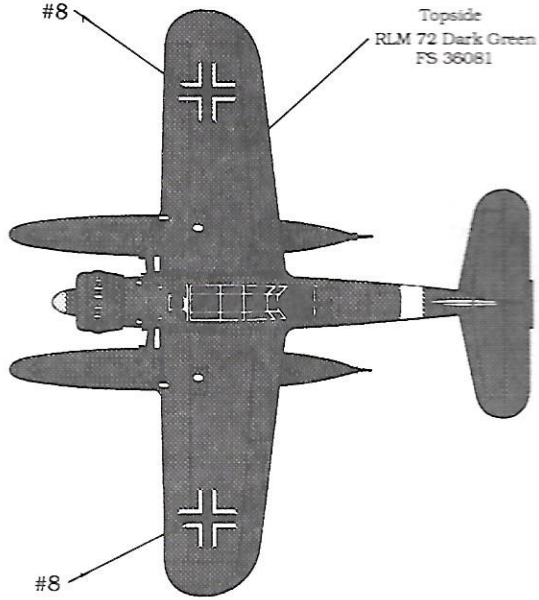

Romanian Air Force

DECAL LOCATIONS 1-21

