



VERLINDEN PRODUCTIONS

811 Lone Star Drive
O'Fallon MO 63366

N°1387

ME 262 A/B Detail Set (for DML kit)

1:48 Scale

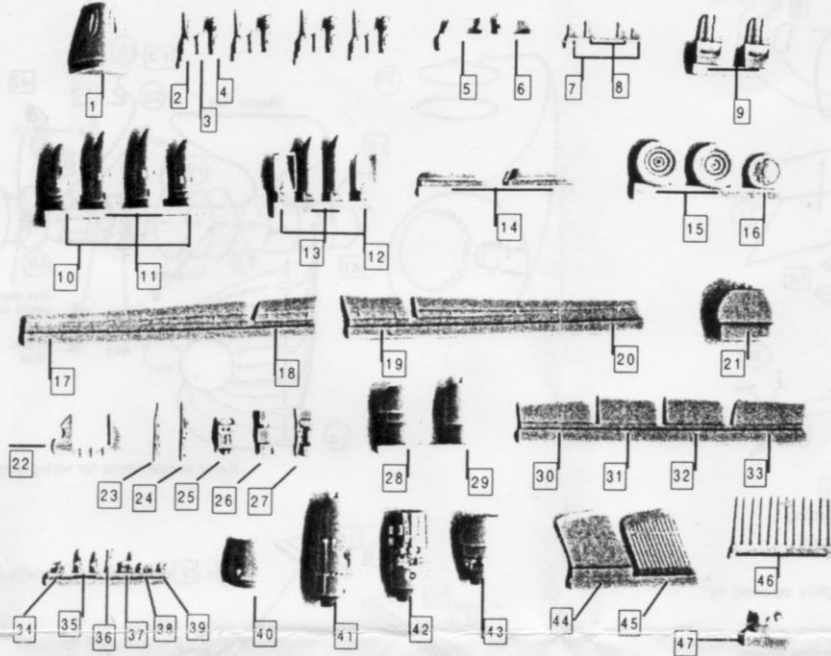

○ Indicates Photo-etched part
□ Indicates Resin part

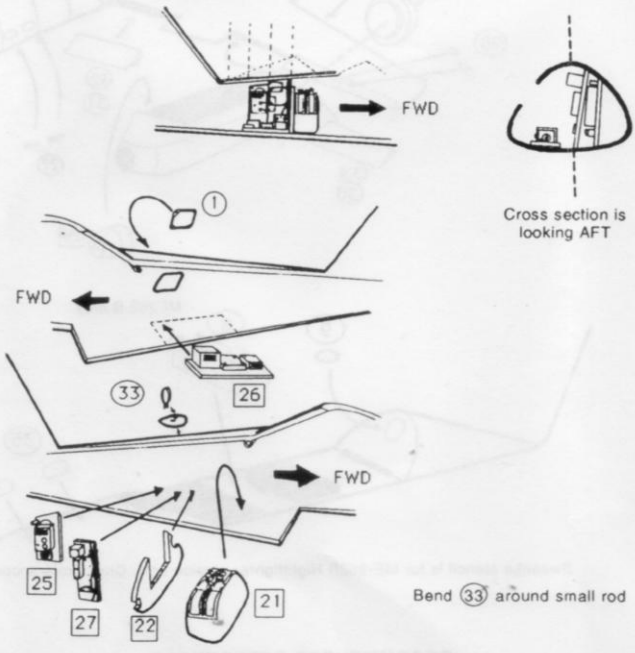

Many of the parts in this set are optional replacements for kit part. **15** **16** replace the Vinyl Tires of the kit. **25** are added to the kit parts N3 + N4. **5** + **6** are optional replacements for kit part H15. Check references when using this set!

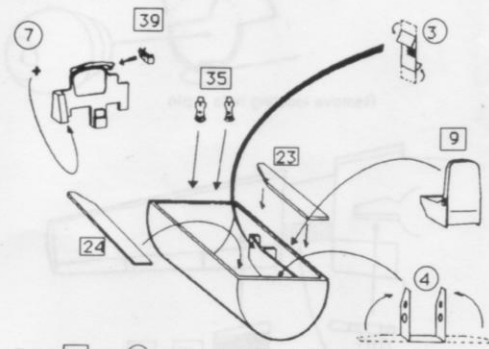

Extra **9** and **4** are included for ME262 B

For **4**, bend + test-fit carefully before cementing

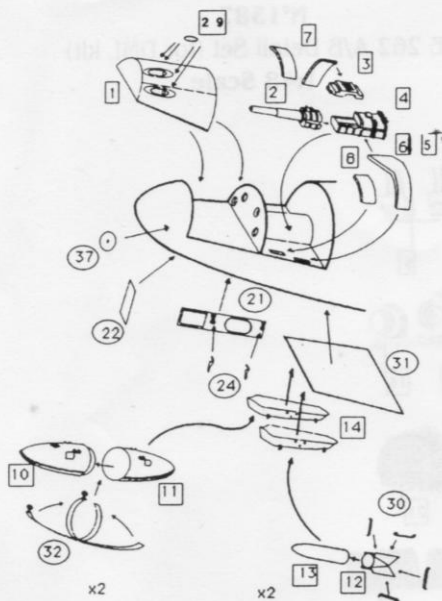

File down front of kit part H14 to receive 1
 Add weight to the nose area to avoid Tail-sitting
 Cut mounting tabs on kit before installing guns
 Slice end of 2 if 1s to be used.
 Holes in kit part H14 may need to be slightly opened to install guns properly.

ATTENTION !
 Some of the DML/DRAGON ME-262 kits do not provide complete engine assemblies. Our engine requires the use of the kit mounting lugs in order to attach it to the kit. These need to be scratchbuilt from plastic rod if they are not available

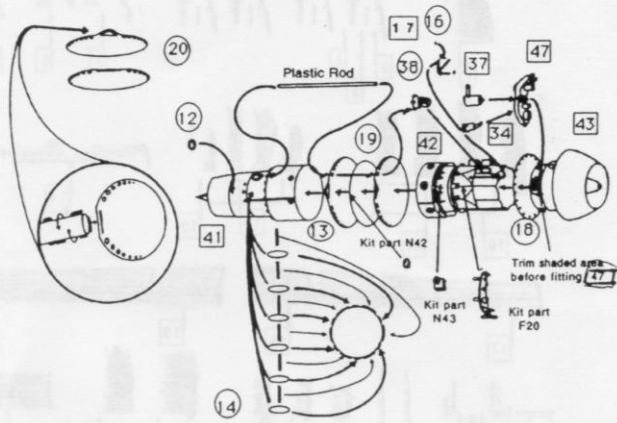

Refer to references for wiring engine.

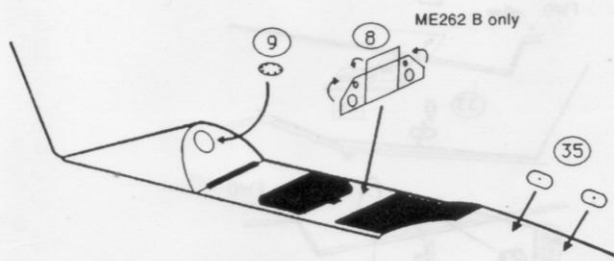
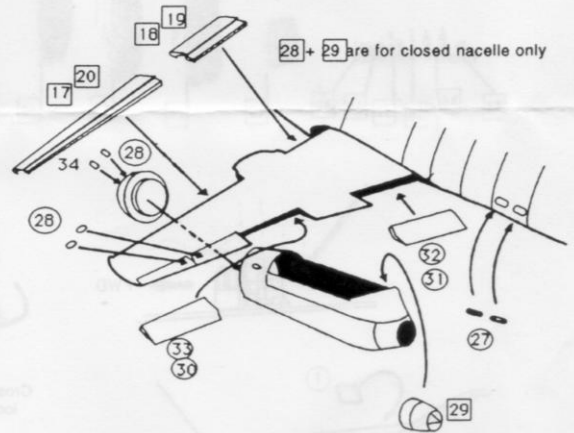
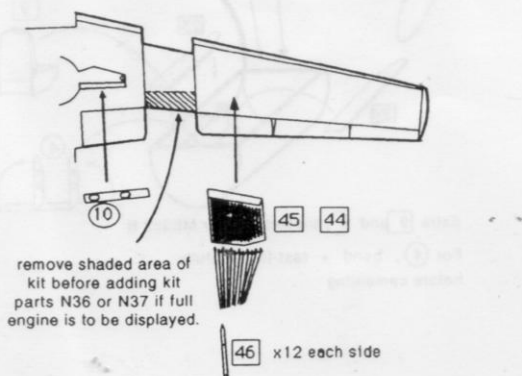
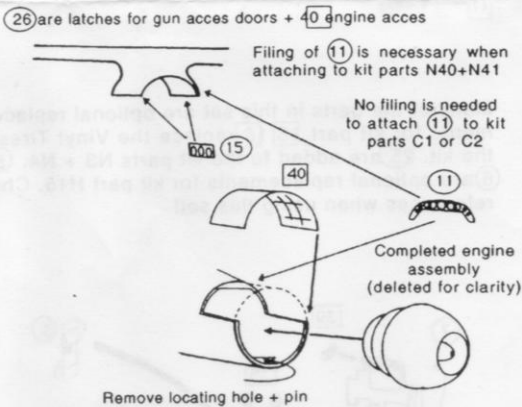

Swastika stencil is for ME-262B Nightfighter version only. Check references.

RECOMMENDED REFERENCES :
 Aero Detail #9 : ME262 A
 Famous Airplanes of the world #2 ME262
 German Aircraft Interiors 1935-1945 Vol.1
 Tankmagazine'- Model Art Special #367