

Diamond T 969 Wrecker



Cat. no. 72020

Scale 1/72



3D Design: Przemysław Głogowski
Supervision & Artwork: Jarosław Leoniec
Research: IBG crew

		Vallejo Model Air	Vallejo Model Color
black	A	71057	70950
rust	B	71080	70846
gunmetal	C	71072	70863
olive drab	D	71043	70889

1 Element złożony we wcześniejszym etapie
Element assembled in previous step

1 Element po złożeniu w aktualnym etapie
Element after assembly in actual step

? Wersja do wyboru
Version to choose

1 Kalkomania
Decal

A Kolor farby
Paint colour

■ Część nie do użycia
Part not for use

Przed montażem przeczytać instrukcję. Przestrzegać kolejności montażu podanego w instrukcji! Klej i farby nie wchodzą w skład zestawu.

Please read instruction before assembly. Obey sequence of assembly like in instruction. Glue and paints not included.

Ramka D / Frame D

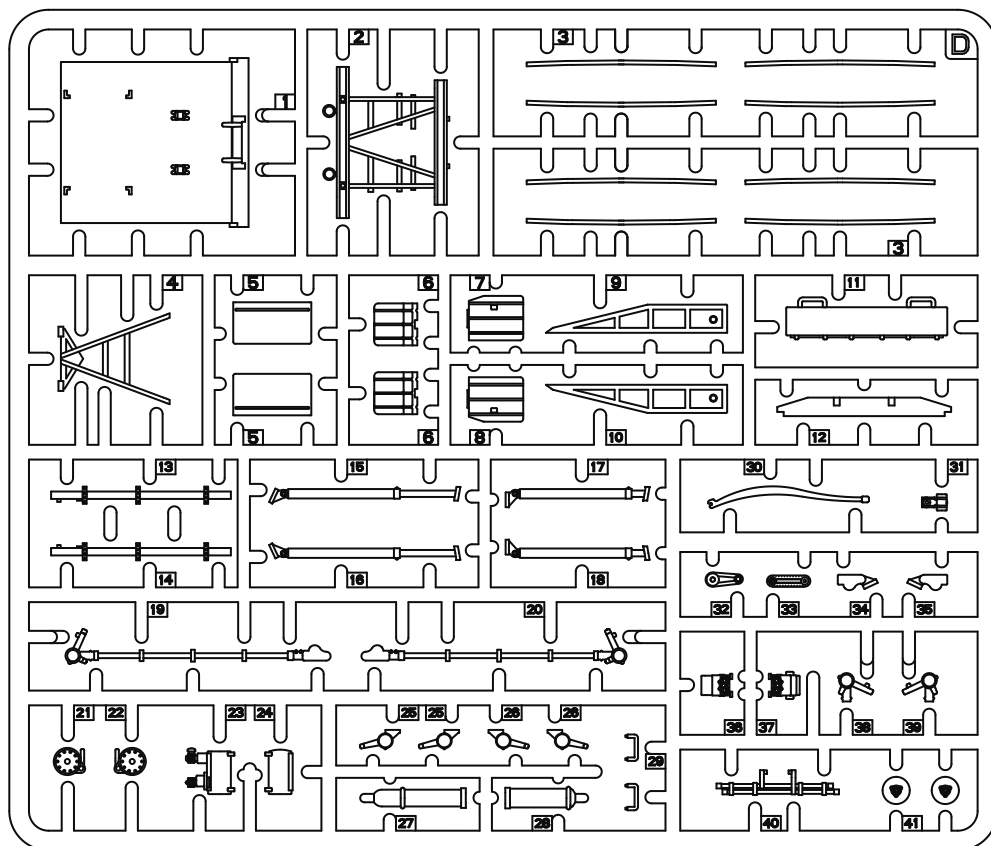

International Business Group
ul. Benedykta Hertza 2
04-603 Warszawa
Poland

tel +48 22 8159150
fax +48 22 8159151
ibgsc@ibg.com.pl
www.ibg.com.pl

Pierwsza ramka A / First frame A

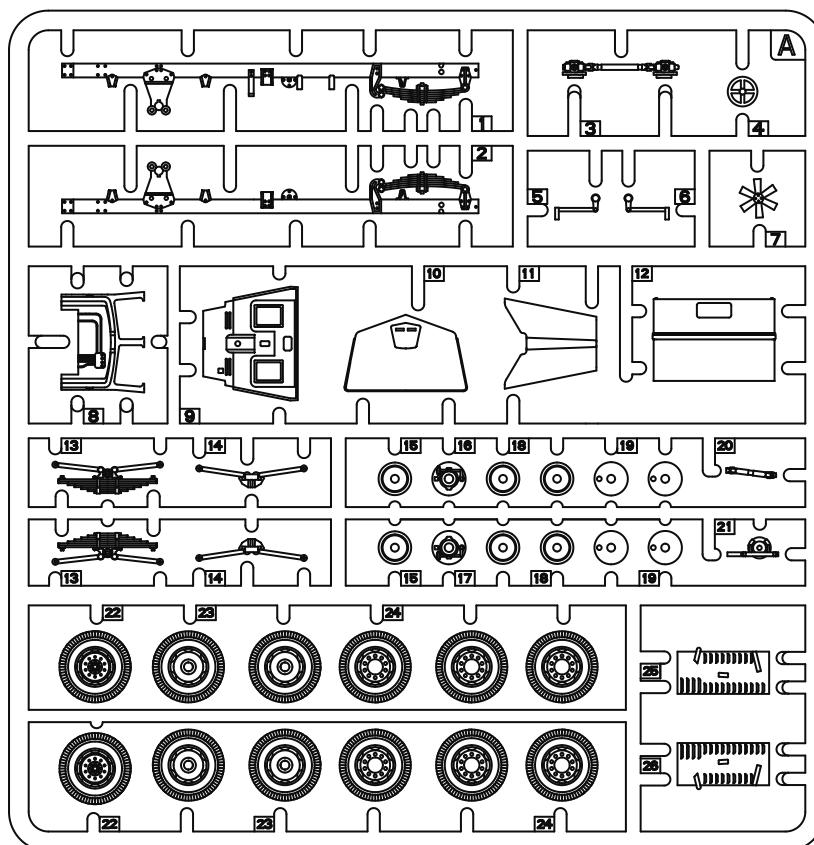

Druga ramka A / Second frame A

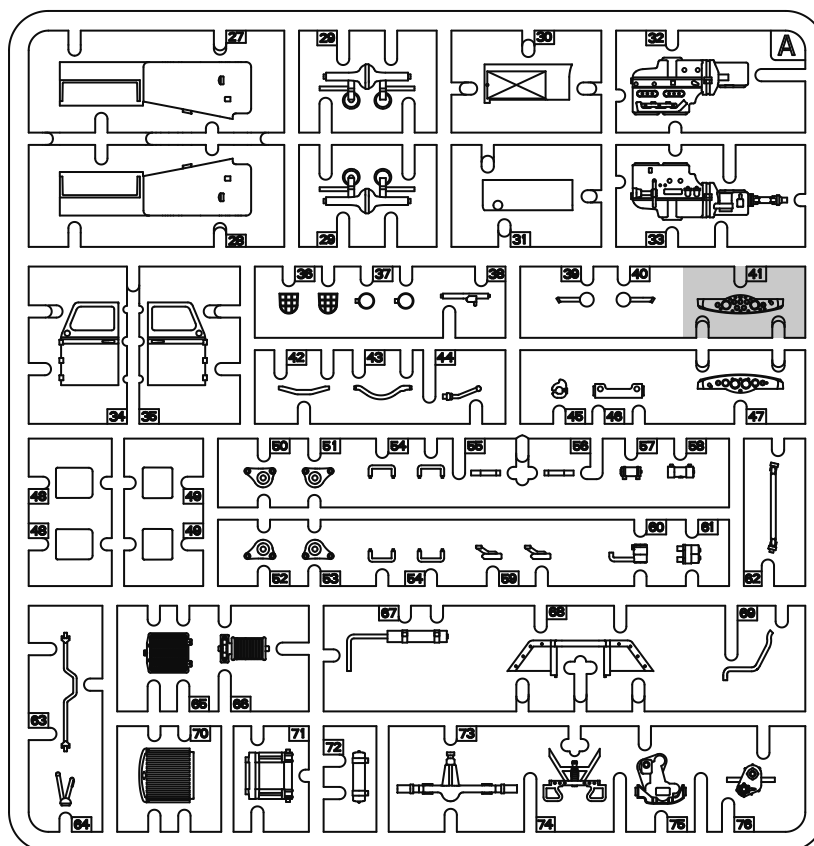

**ETAP 1
STEP 1**

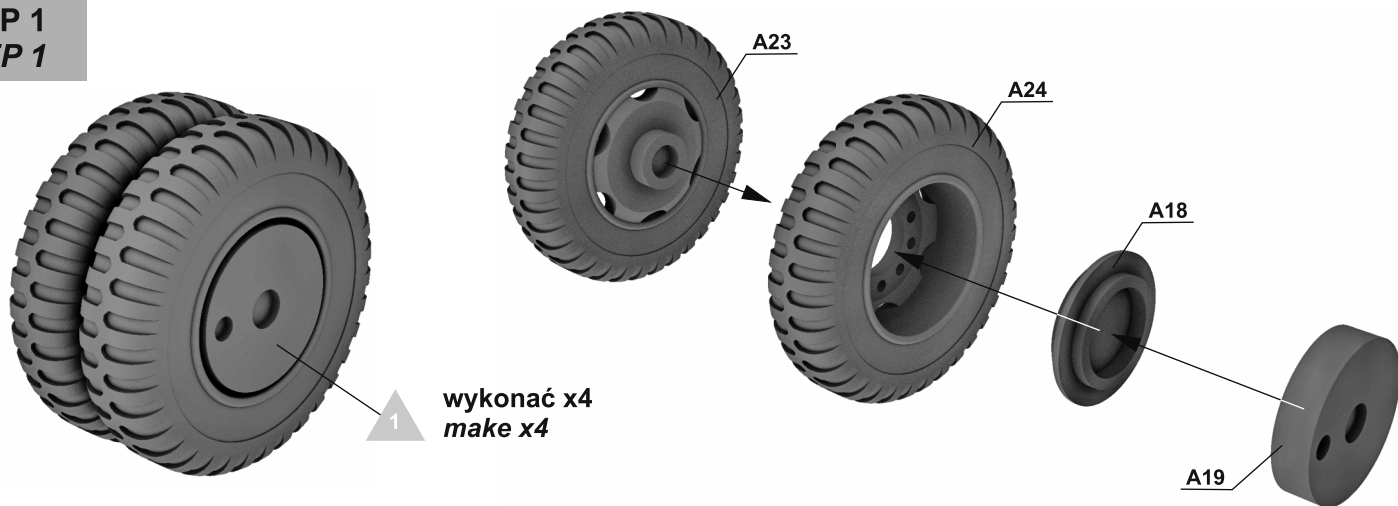

**ETAP 2
STEP 2**

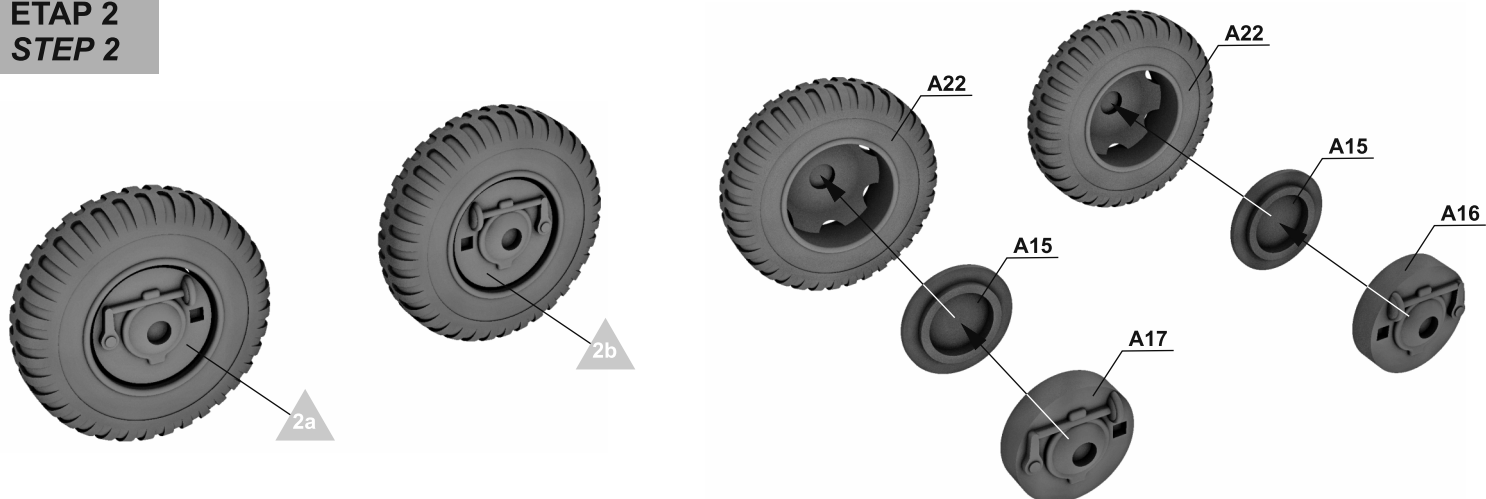

**ETAP 3
STEP 3**

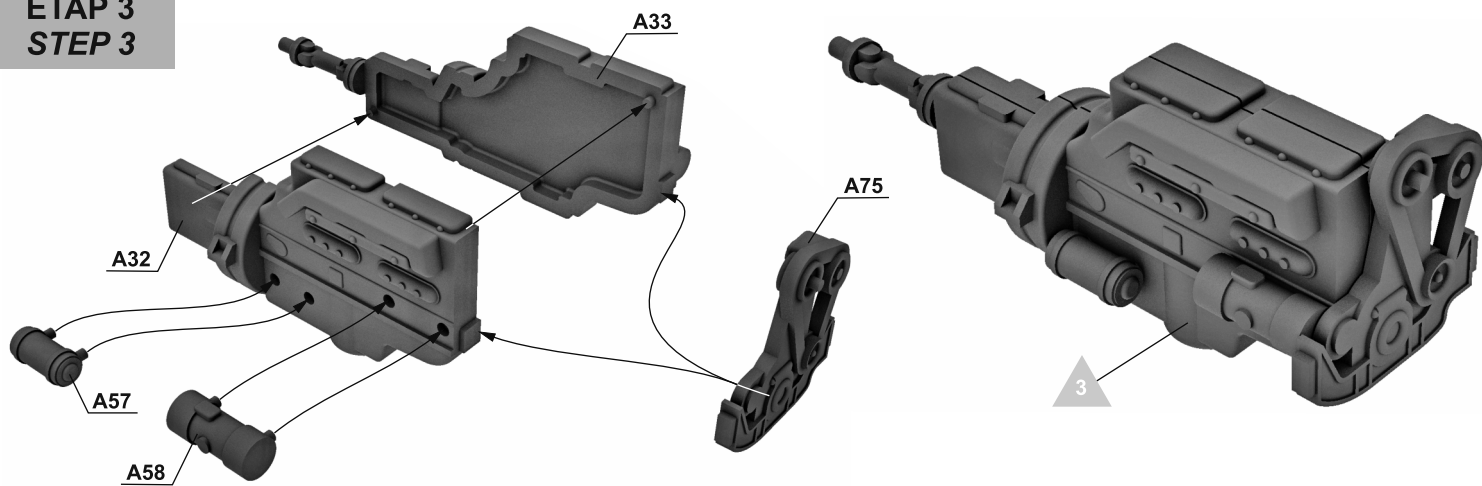

**ETAP 4
STEP 4**

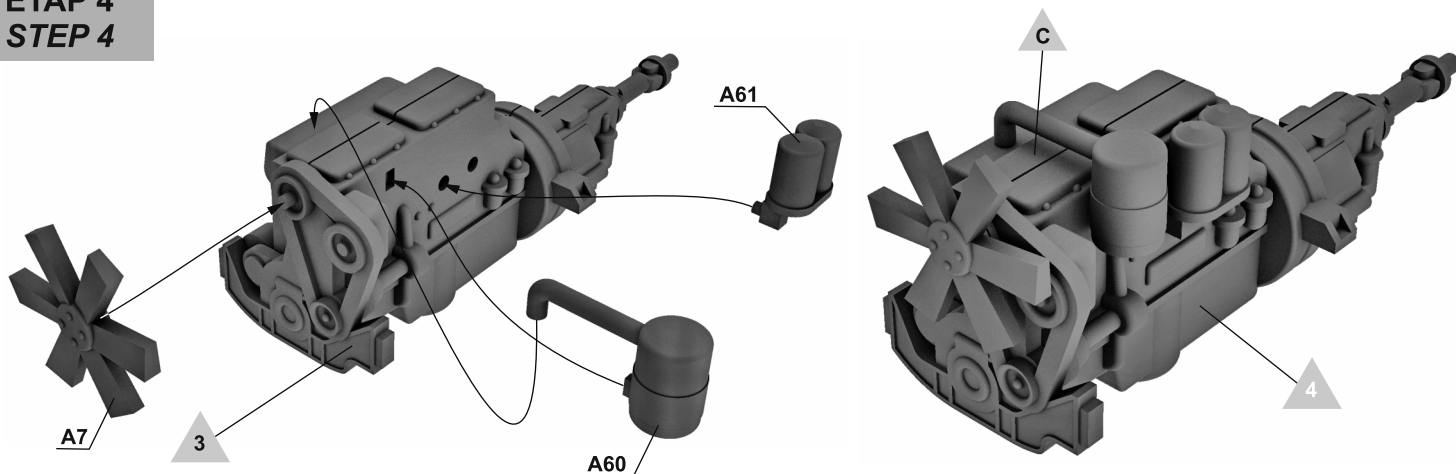

**ETAP 5
STEP 5**

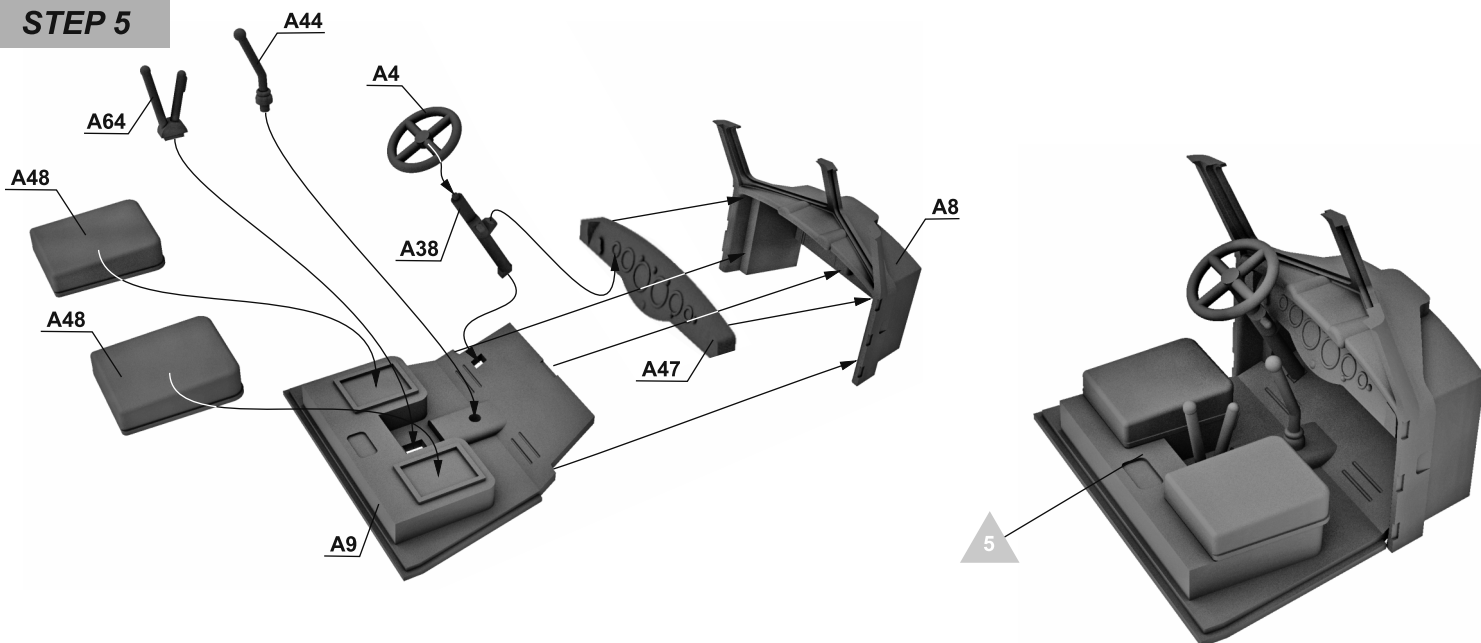

**ETAP 6
STEP 6**

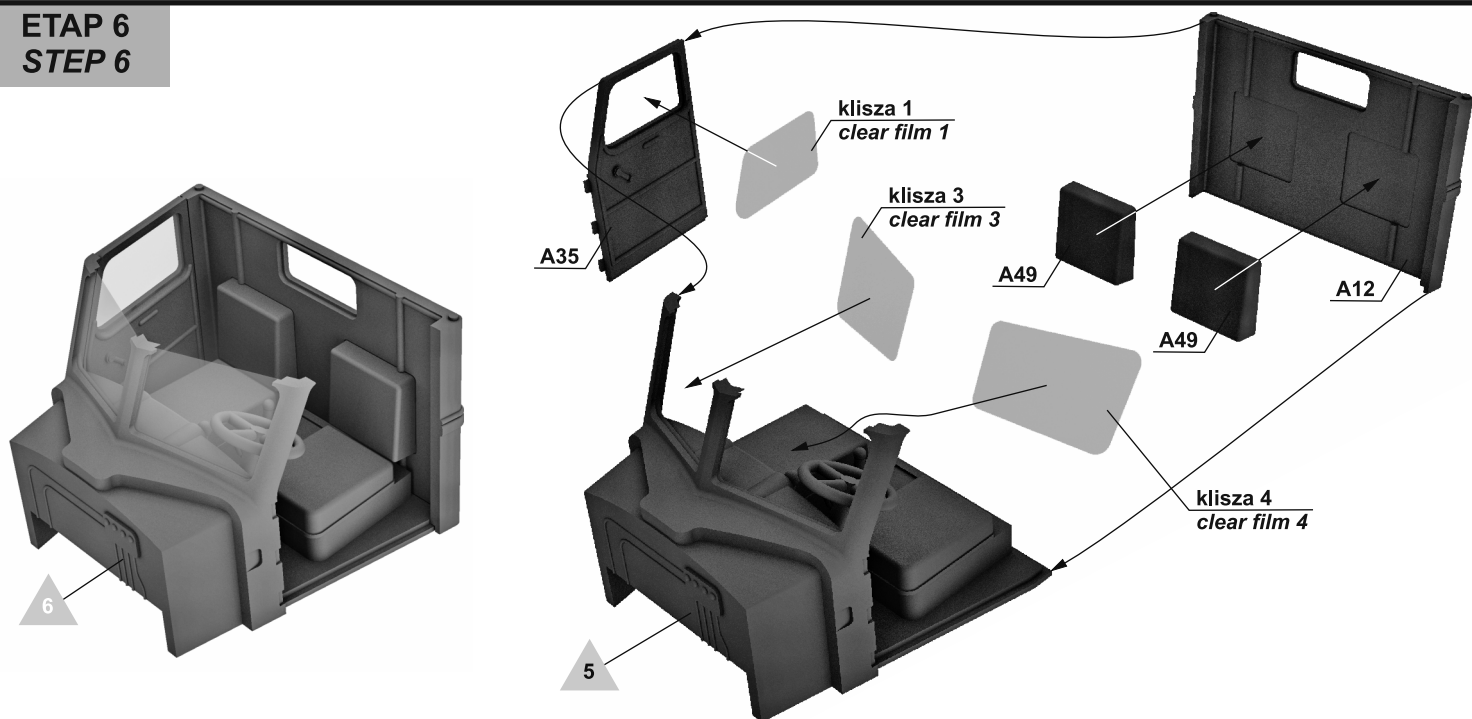

**ETAP 7
STEP 7**

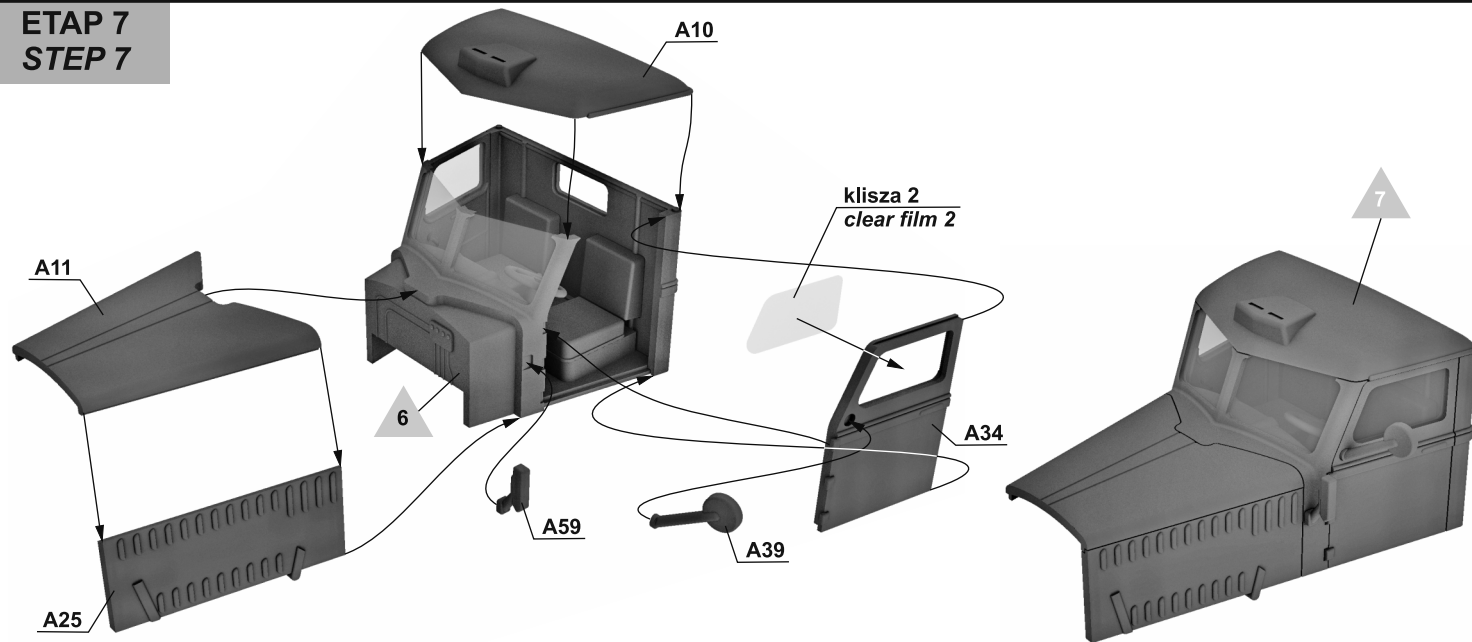

**ETAP 8
STEP 8**

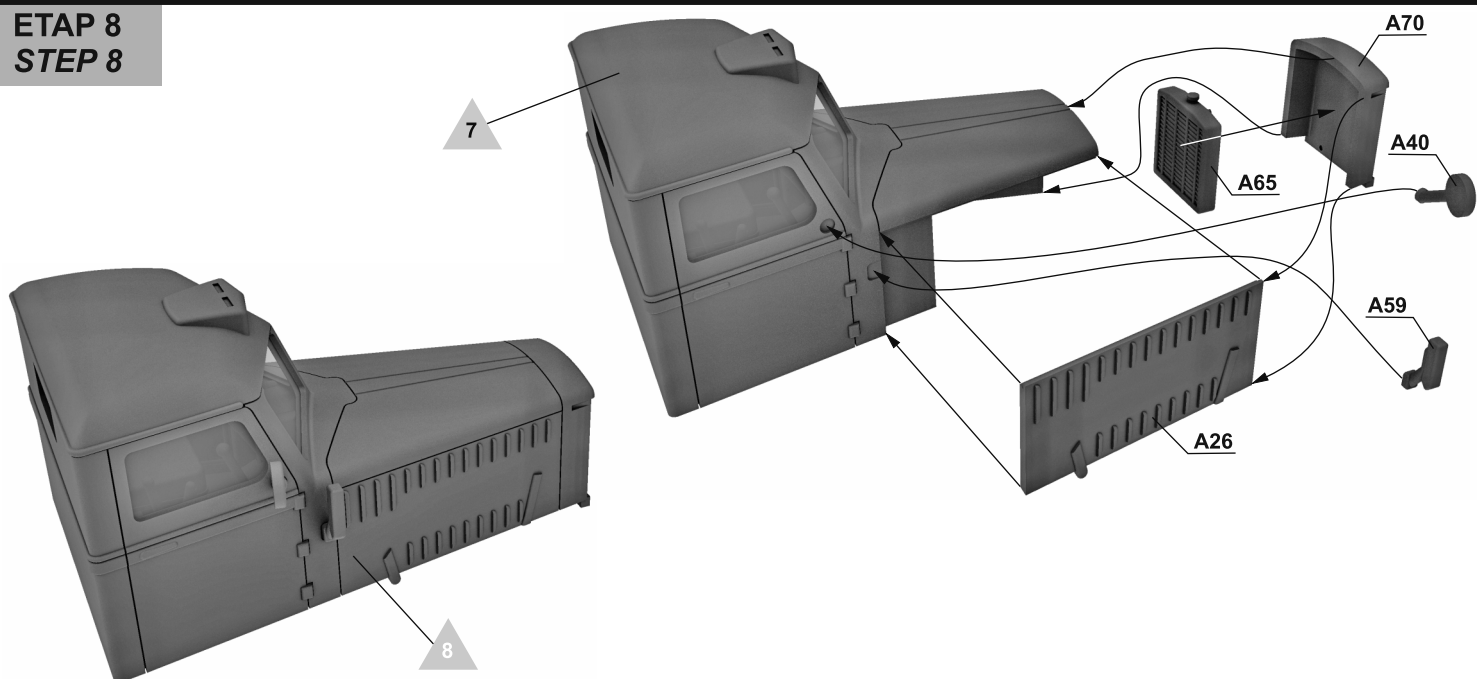

**ETAP 9
STEP 9**

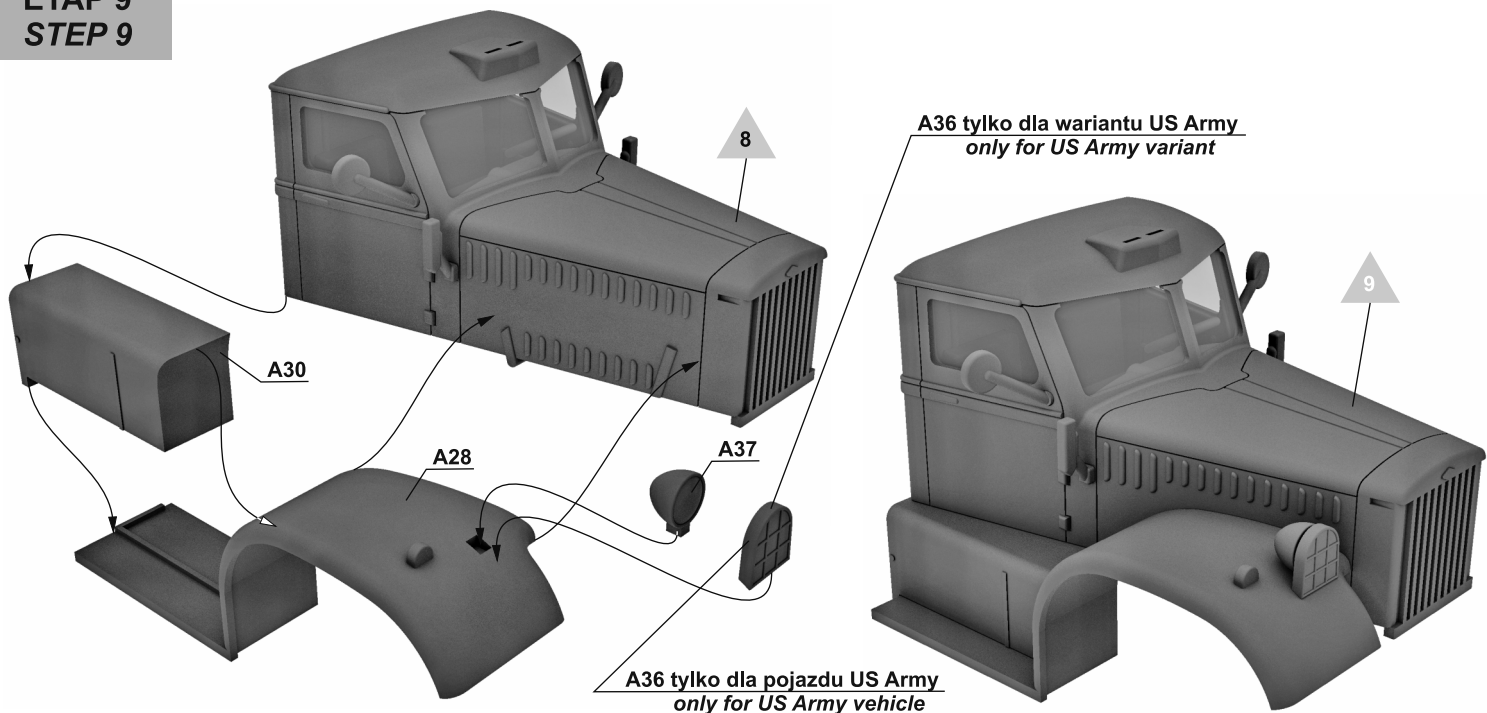

**ETAP 10
STEP 10**

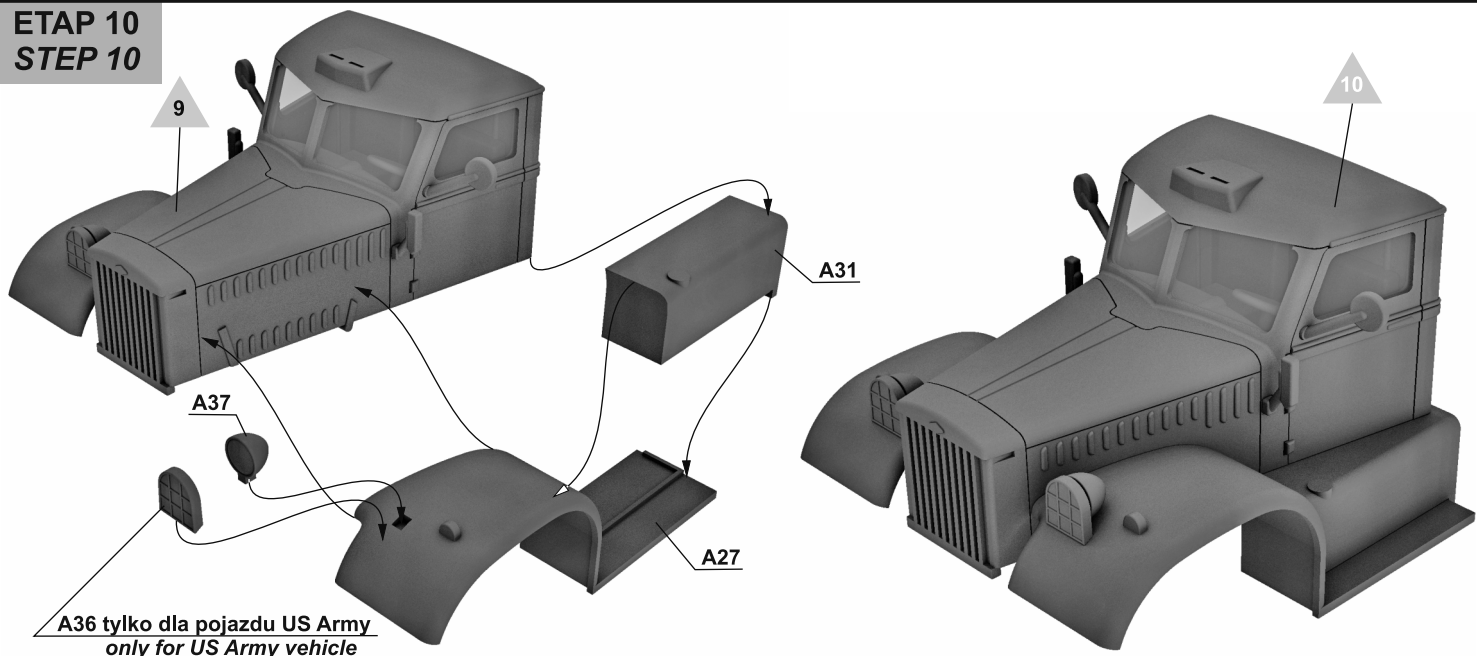

ETAP 11
STEP 11

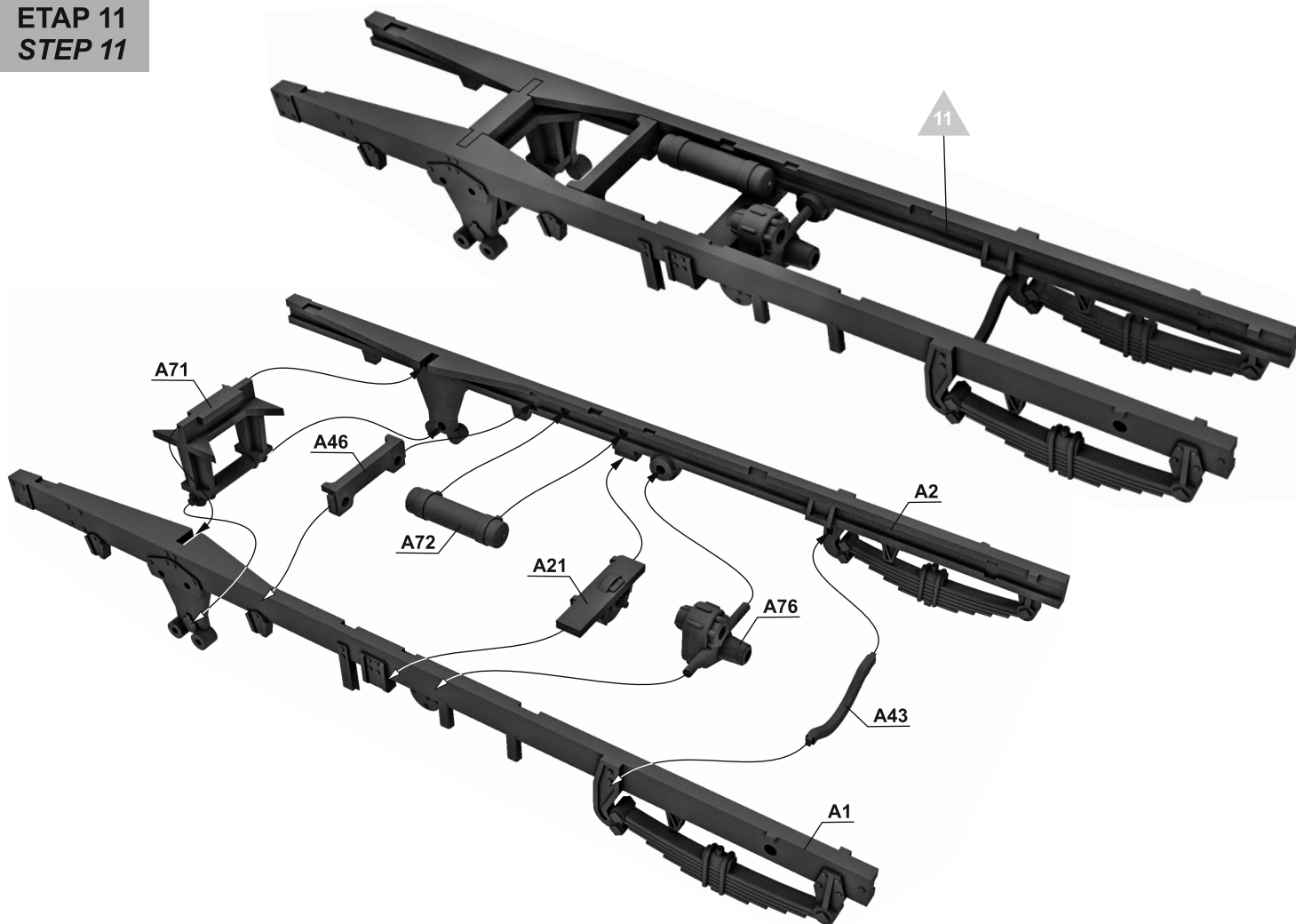

ETAP 12
STEP 12

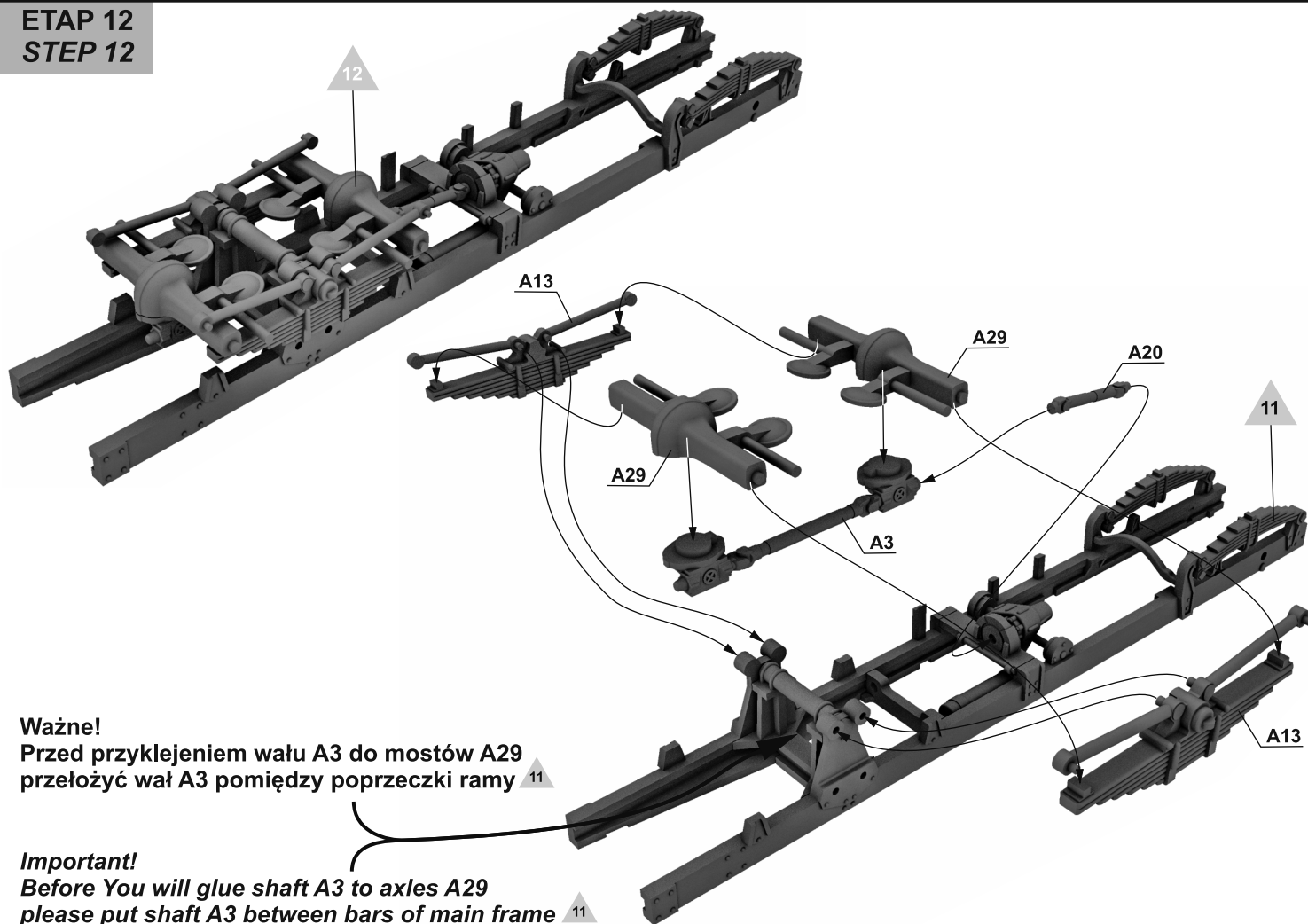

Ważne!
Przed przyklejeniem wału A3 do mostów A29
przełożyć wał A3 pomiędzy poprzeczkami ramy 11

Important!
Before You will glue shaft A3 to axles A29
please put shaft A3 between bars of main frame 11

ETAP 13
STEP 13

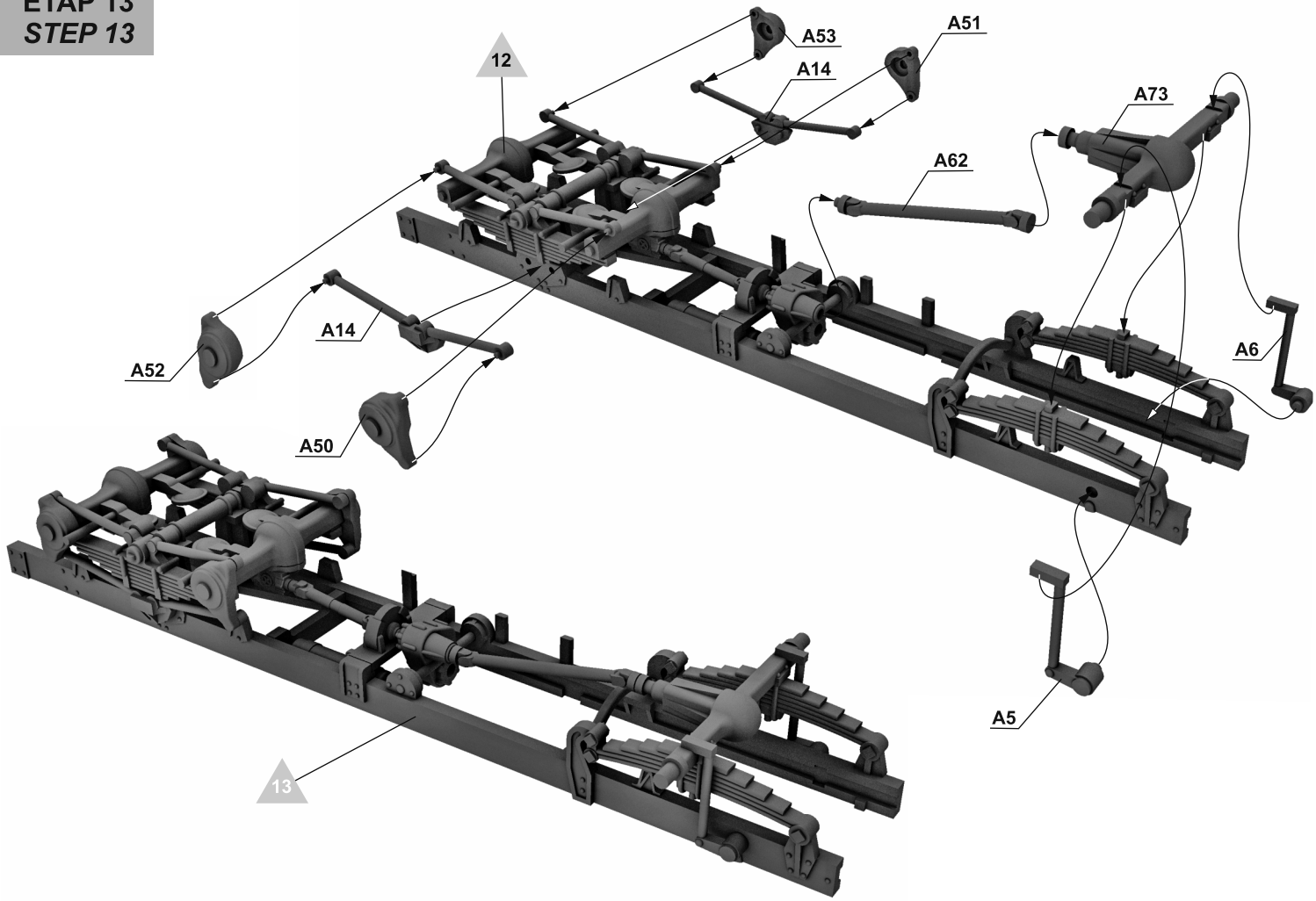

ETAP 14
STEP 14

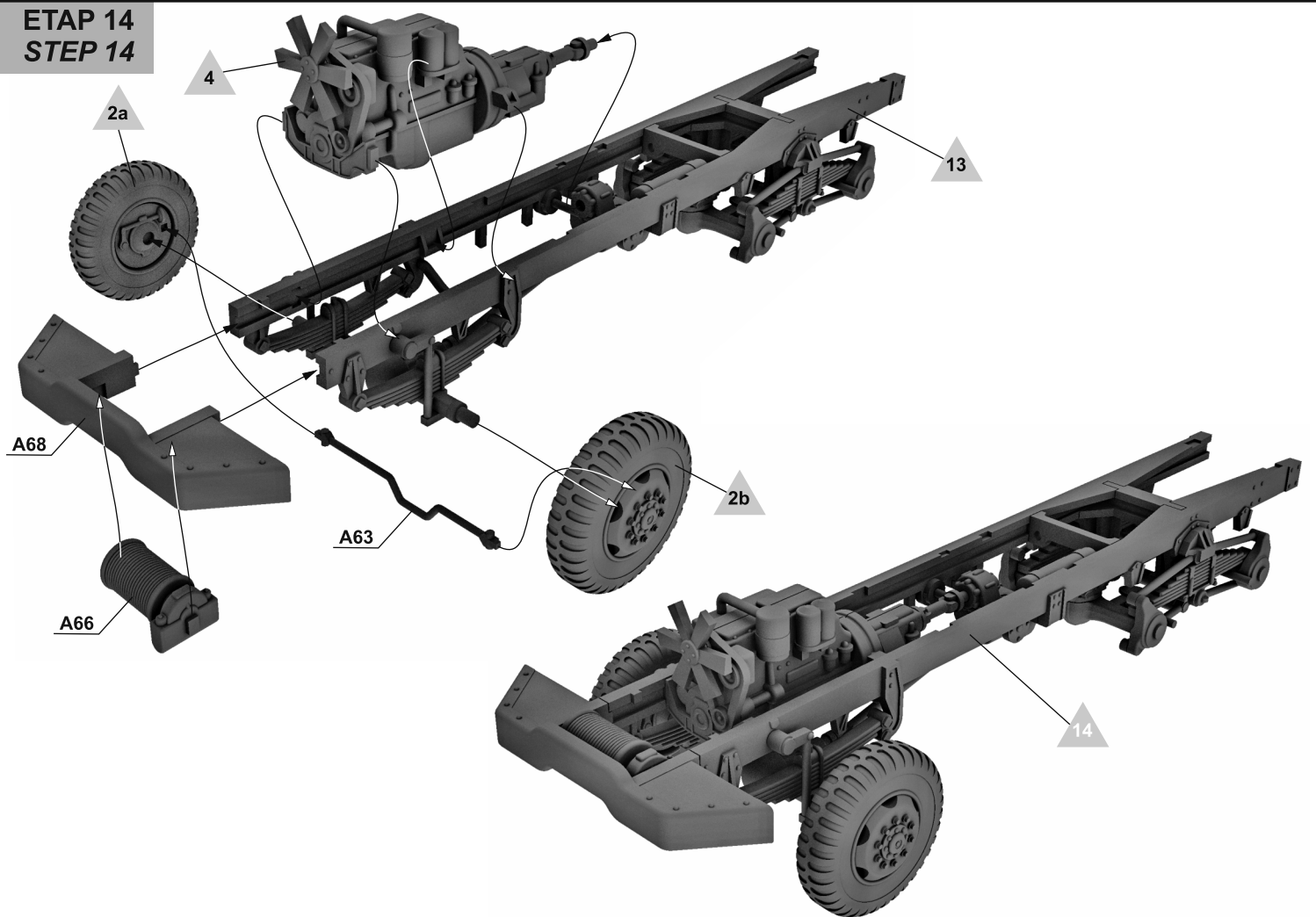

**ETAP 15
STEP 15**

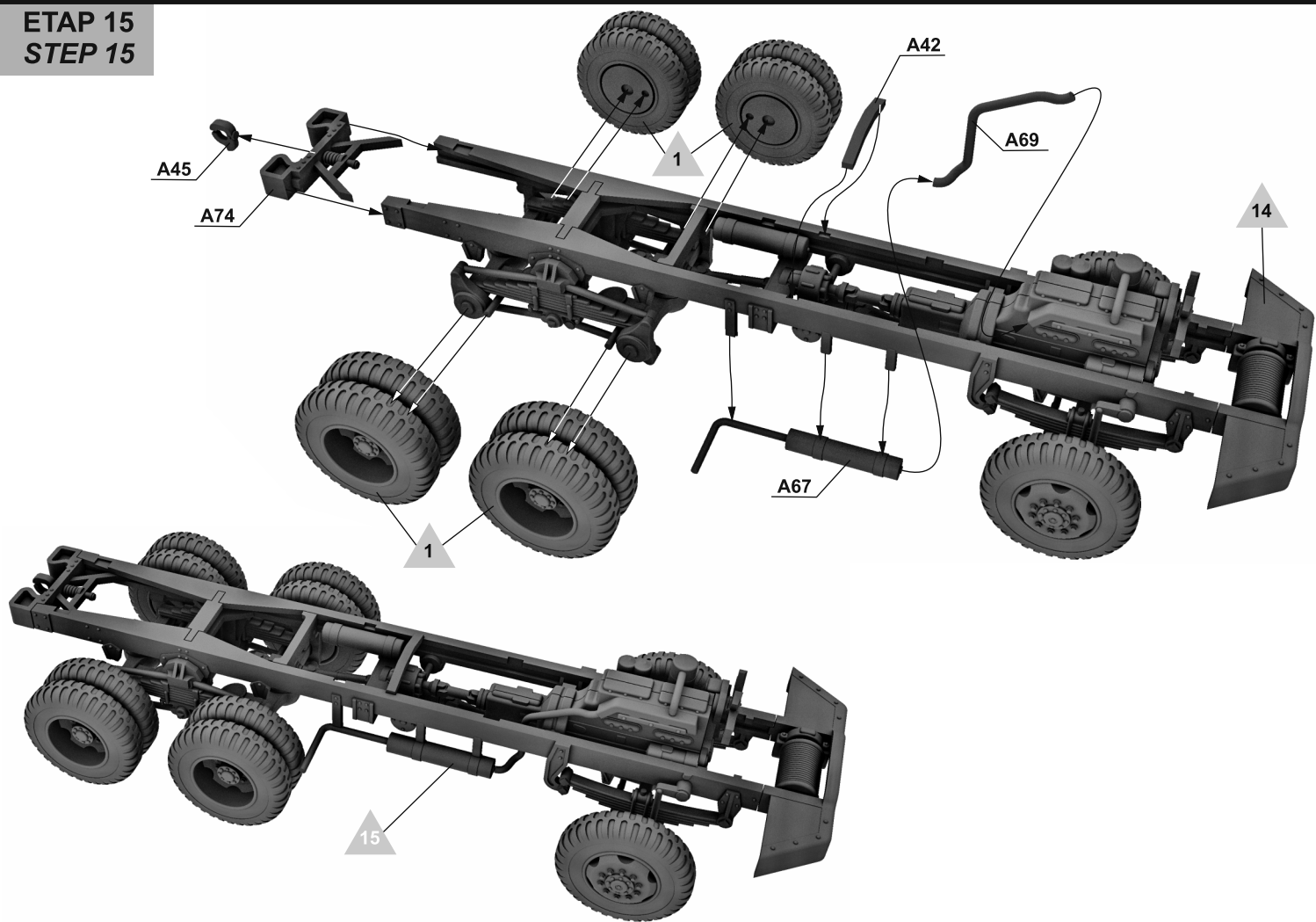

**ETAP 16
STEP 16**

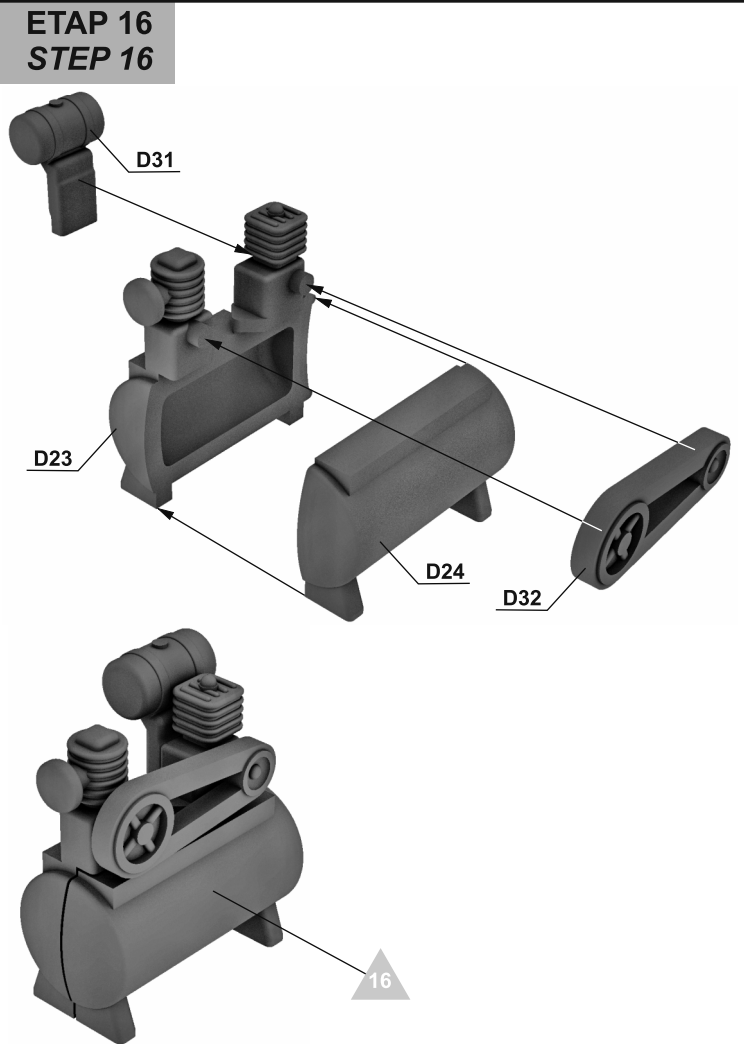

**ETAP 17
STEP 17**

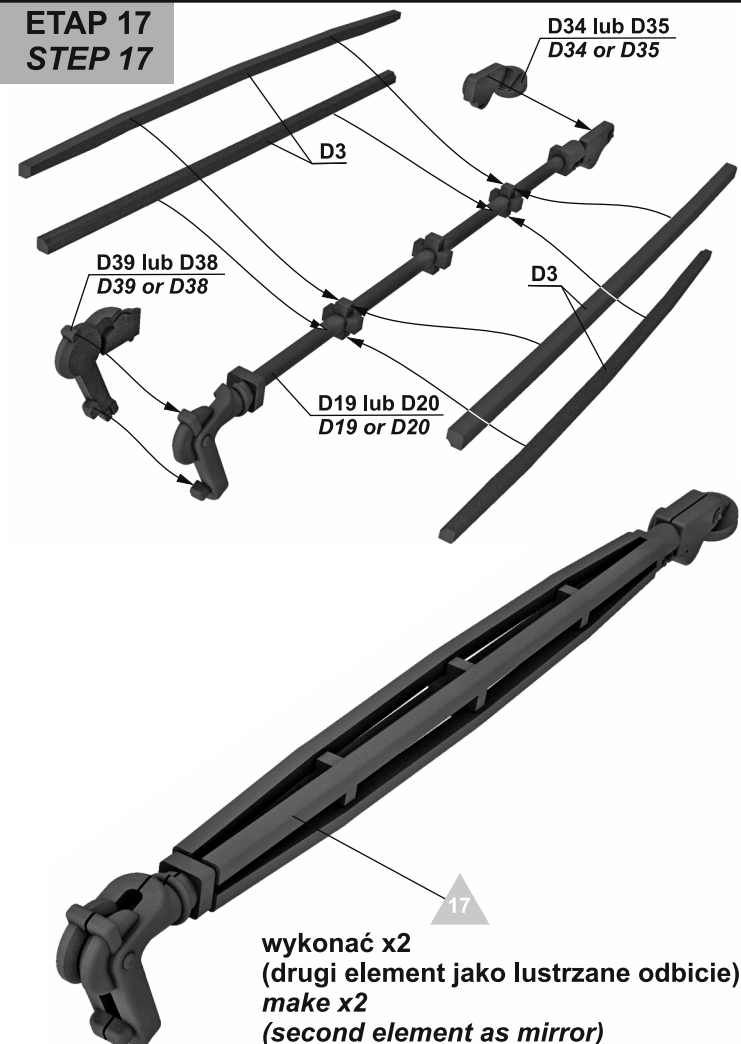

ETAP 18
STEP 18

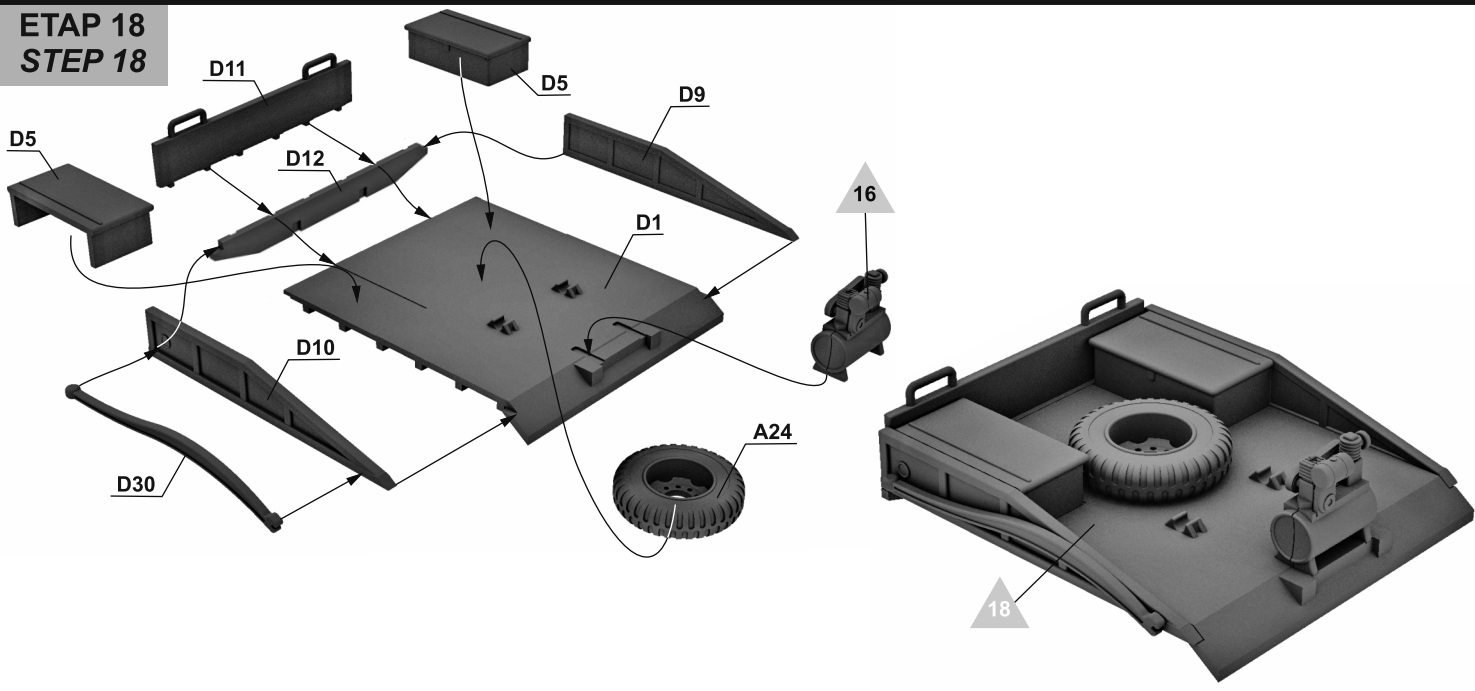

ETAP 19
STEP 19

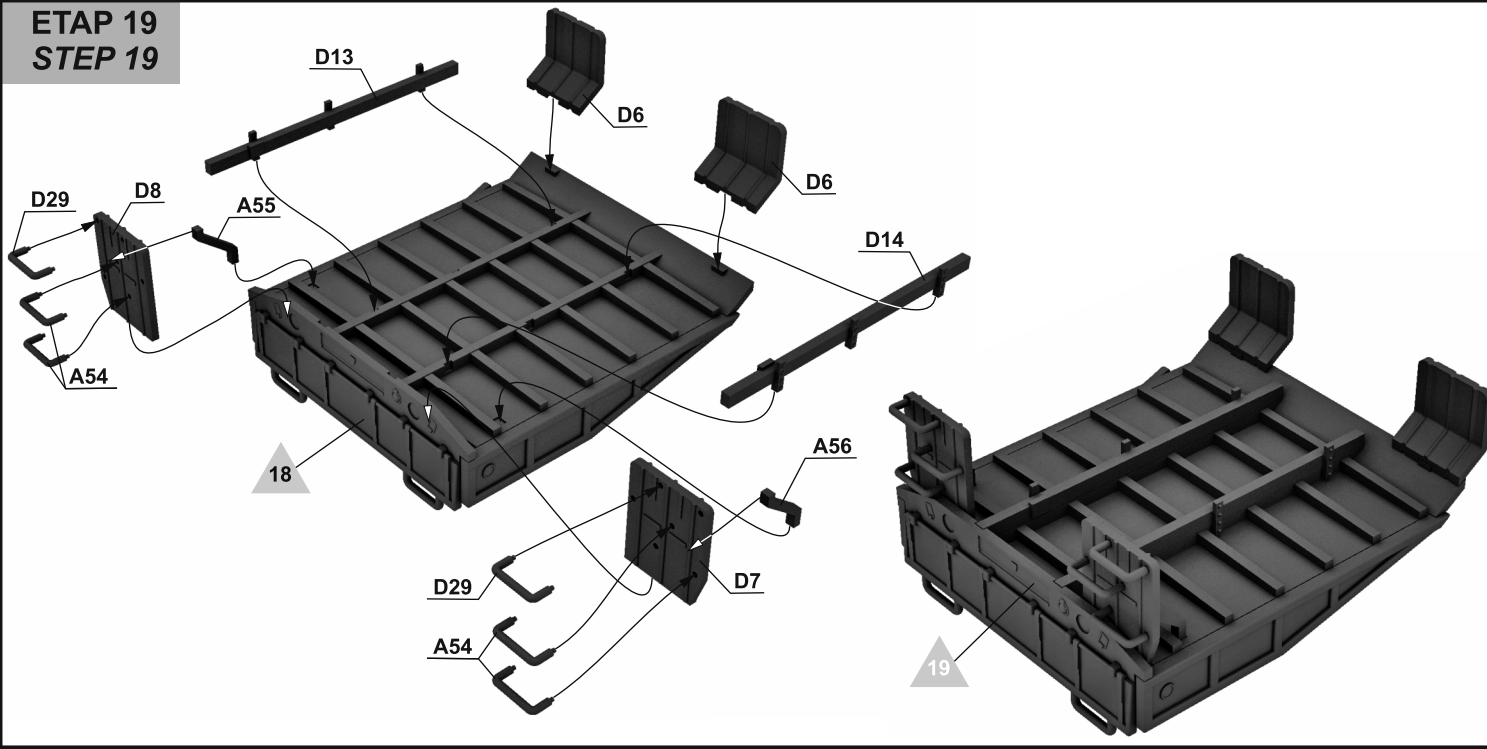

ETAP 20
STEP 20

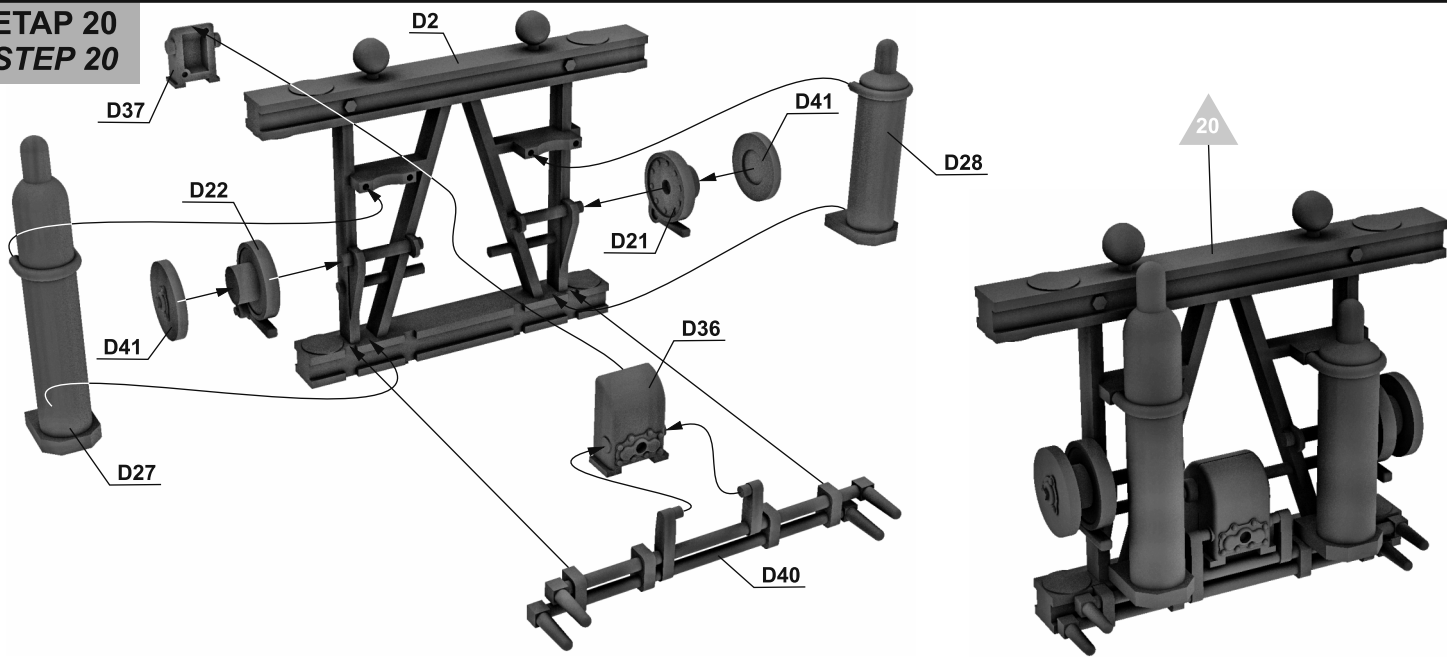

**ETAP 21
STEP 21**

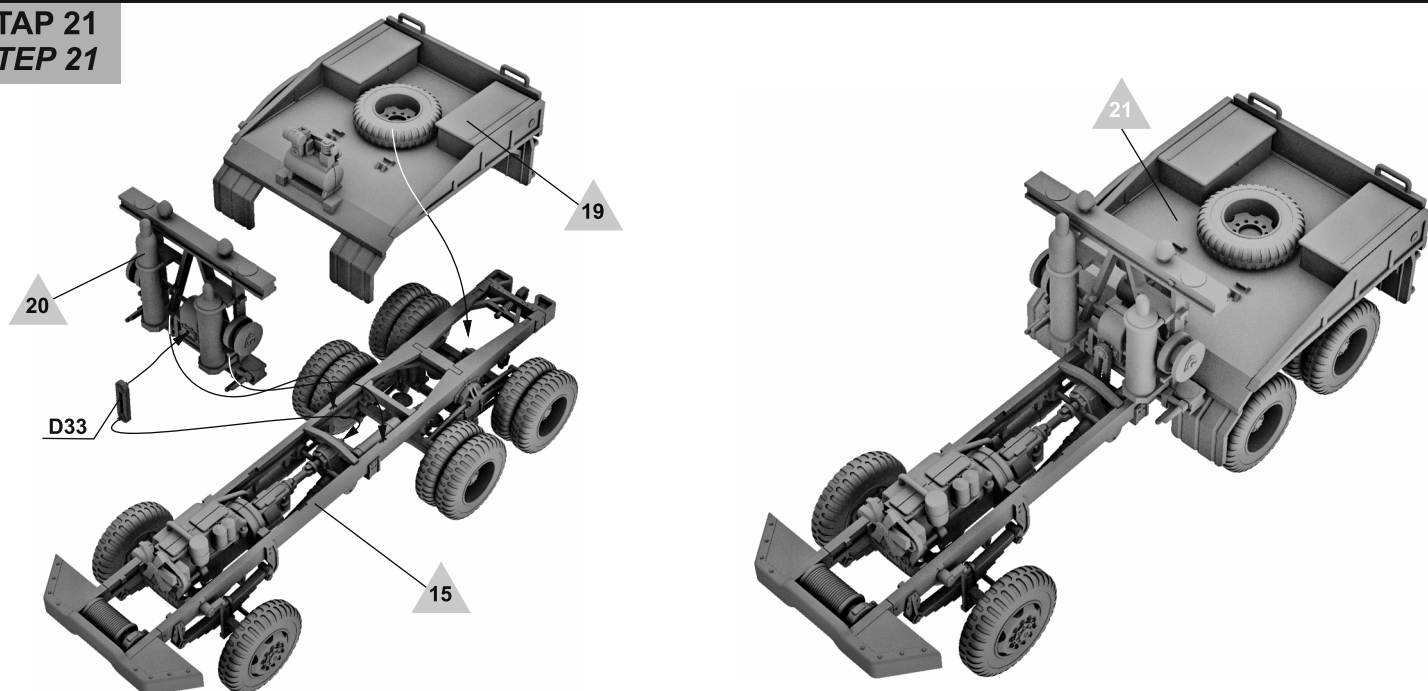

**ETAP 22
STEP 22**

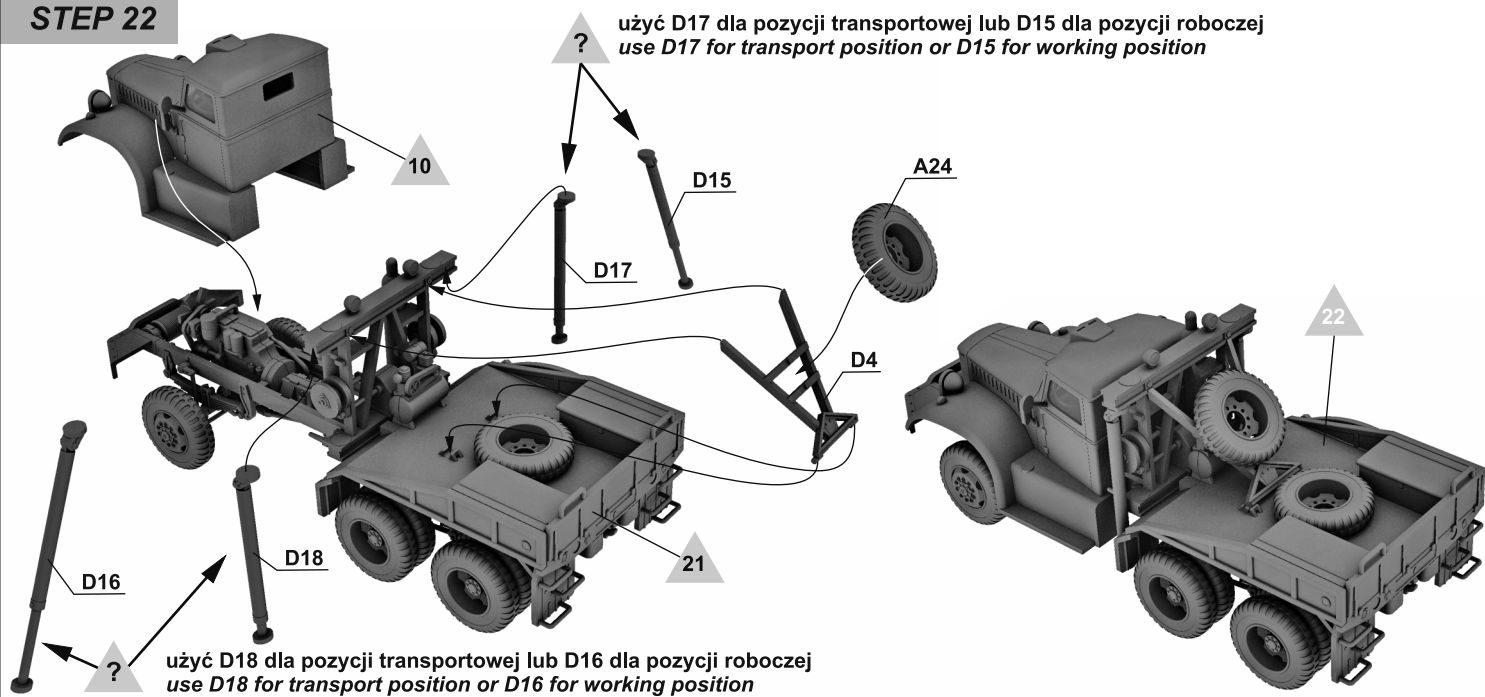

**ETAP 23
STEP 23**

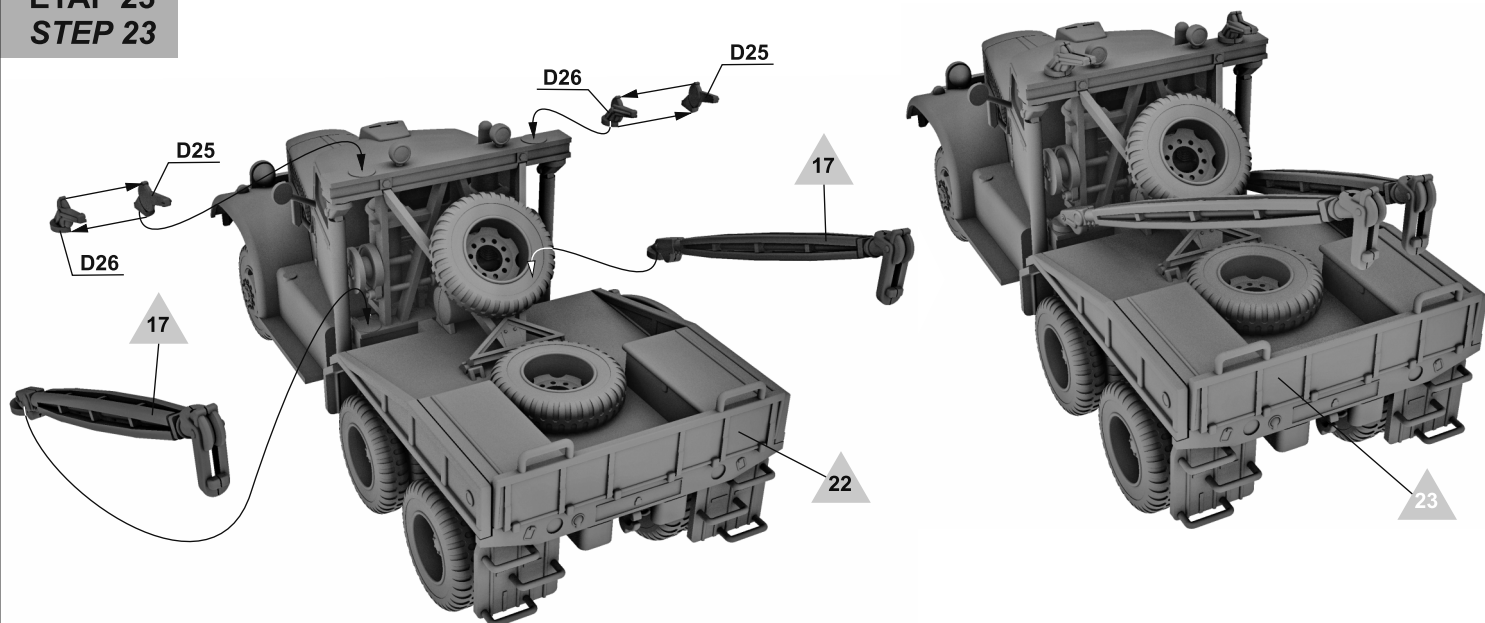

ETAP 24 - Liny dźwigu
STEP 24 - Ropes of crane

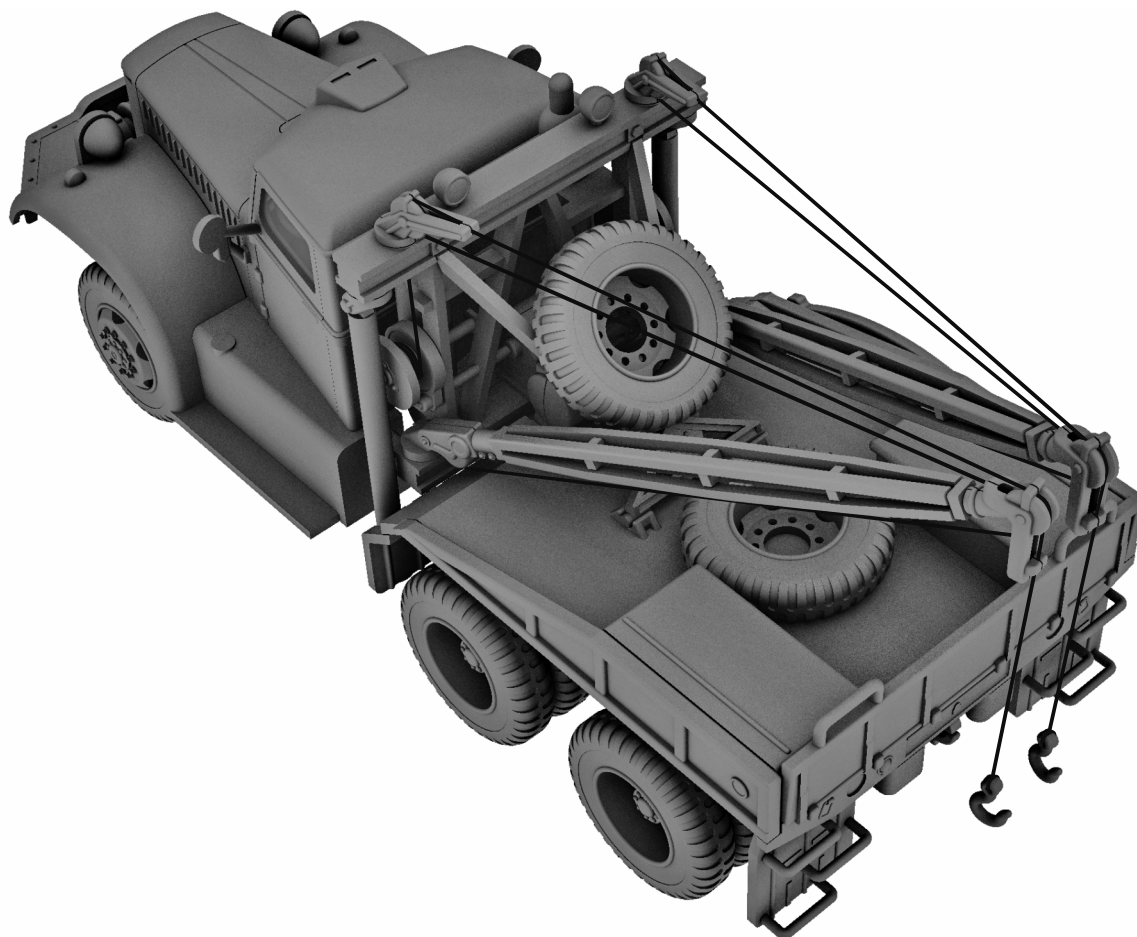

WYKONANY MODEL
FINISHED MODEL



MALOWANIE I KALKOMANIE
COLOURS AND DECALS

**Diamond T 969 wrecker z plutonu warsztatowego
kompanii Royal Canadian Army Service Corps RCASC
4 Brygady Piechoty
Beveland Causeway, Holandia, październik 1944
*Diamond T 969 wrecker from workshop platoon of 4th
Infantry Brigade Company Royal Canadian Army
Service Corps RCASC
Beveland Causeway, Holland, October 1944***

