

Kit No. CB-35019

# FRENCH HOTCHKISS LIGHT TANK H38/39 1/35 SCALE

## 法製‘霍爾吉斯’輕型坦克H38/39

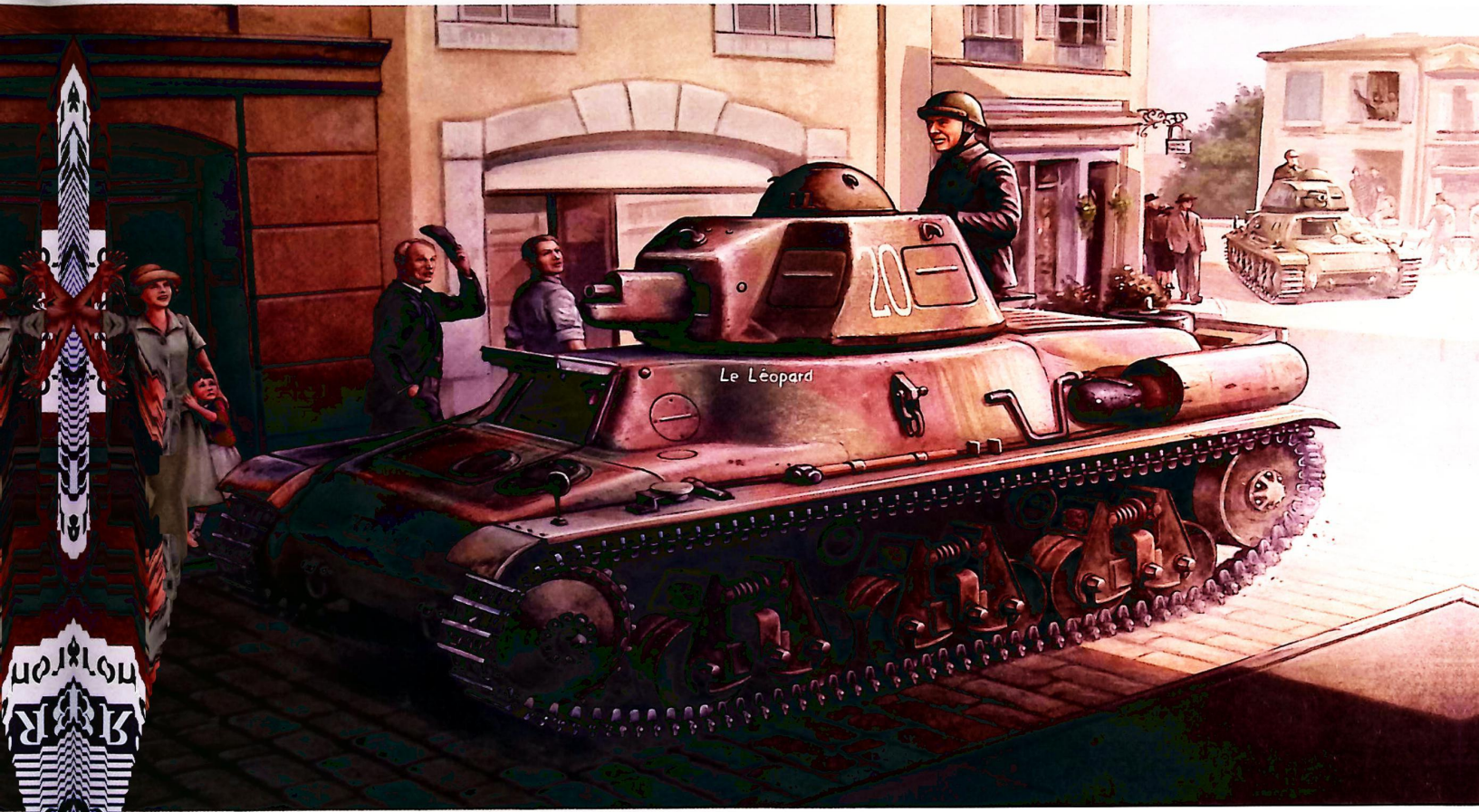

Hotchkiss began the production of Light Tanks in 1935, when the H-35 was built to the same specification as the Renault R-35. The H-35 was faster than its rival and was considered all-around a better tank. In 1938 the design was improved by thicker armour and a more powerful 120hp engine, which necessitated changes to the rear hull and engine compartment. This model being designated the H-38 by Hotchkiss, but was often known in service as the H-39. Armour on the H-38/39 was up to 40mm thick and the tank was initially armed with a 37mm short barrel gun. A longer barreled SA38 gun was mounted to later production tanks. Like all French tanks of the period, the H-39 was hampered by a lack of communications, and also by having only a 2-man crew. The German Army salvaged 821 Hotchkiss tanks in 1940 after France capitulated. Some tanks were sent out to Russia in 1941, but the majority were modified into gun tractors, ammunition or weapons carriers.

Information by Phil Greenwood

Die französische Firma Hotchkiss begann 1935 mit der Herstellung des leichten Panzers H-35. Dieser hatte die gleichen Spezifikationen wie der Renault R-35. Trotzdem hielt man den schnelleren H-35 für das bessere Modell. 1938 erfolgten Verbesserungen der Panzerung sowie der Motorleistung auf 120 PS. Dazu veränderte man die hintere Wanne und den Motorraum. Diese Ausführung, von Hotchkiss als H-38 bezeichnet, wurde im Einsatz aber als H-39 bekannt. Die Panzerung des H-38/39 war bis zu 40mm dick und das Fahrzeug war anfänglich mit einer kurzläufigen 37mm Kanone bewaffnet. Spätere Produktionslose erhielten den längeren Typ SA38. Wie andere französischen Panzer dieser Ära wurde der H-39 durch seine fehlende Funkanlage sowie die nur zweiköpfige Besatzung behindert. Die Wehrmacht erbeutete 821 Hotchkiss Panzer nach der Kapitulation Frankreichs 1940. Einige wurden an der Ostfront aufgebraucht, der Hauptteil jedoch zu Artillerie- Munitions- und Waffenträgern umgebaut.

© Translation Michael Knoblich Academy Europe

法國霍爾吉斯廠於1935年開始生產H35輕型騎兵坦克，後來改良出的H38/39比H35略大，是由於改為使用更大馬力之120hp發動機，重量也增至12噸。H38火炮仍使用原先H35的37mm SA18(21倍徑)短身炮，但其後所生產的H38則換裝成長管身的SA38(33倍徑)砲，名稱命為H39。H38/39在二次大戰爆發初期約有800多輛在一線部隊中服役。德軍在攻佔法國後，由於急劇擴張極需大量裝備以供部隊使用，不得不從佔領國中就地取材，因此不少H系列坦克被編入德國部隊使用，但德軍對原本H系之法式設計有所意見，對其他作出修改以適己用，如加裝無線電及新式的指揮塔等。



## ILLUSTRATION 圖示說明:

### CORRECT METHOD FOR APPLYING DECALS : HINWEISE ZUM ANBRINGEN DER DEKAL 正確使用水貼紙的方法:

1. Clean model parts surface with wet cloth. Entsprechende Stellen am Modell feucht reinigen.  
將需要貼上水貼之部位表面擦乾淨。
2. Cut out the decal parts and dip them in cold water for 15 ~20 seconds. Decal ausschneiden und für 15-20 Sek. ins Wasser legen.  
將所需之貼紙剪下泡在清水裏約15至20秒。
3. Place it on correct position of the model kit. Decal an der richtigen Stelle auflegen.  
將濕透之貼紙取出置放於正確之位置旁。
4. Slide off the decal from the base paper on to the model kit surface with a cotton stick. Decal mit Wattestäbchen festhalten und Papier darunter wegziehen.  
用棉花棒輕推貼紙表面使其從底紙滑出至模型表面之正確位置。
5. When decal get dry then complete. Decal mit Papiertuch andrücken und trocknen.  
待其自然乾透後即完成。

### ICON INSTRUCTION: 圖標說明:



Open Hole  
Loch bohren  
鑽孔



Remove  
Abtrennen  
切除



2 Sets needed  
Vorgang wiederholen  
同樣的製作二組



Bend  
Biegen  
曲折



Optional  
Auswahl  
可以選擇採用



Apply Decal  
Decal anbringen  
貼上水貼紙



Instant Glue For Metal  
Sekundenkleber verwenden  
瞬間接著擠，金屬用



Fill Hole  
Verspachteln  
把孔填平



Do not cement  
Nicht kleben  
不用粘合

### COLOR SUGGESTION: FARBTABELLE: 塗裝指引:

Color 塗料表	Gunze Sangyo	Hobby Color	Humbrol	Tamiya
Red Brown Rot Braun 紅褐色	H-47	C-41	160	XF-64
German Gray Deutsch Grau 德國灰	H-32	C-40	92	XF-63
Silver Silber 銀色	H-8	J-8	11	X-11
Flat White Matt Weiss 消光白	H-11	C-62	34	XF-2
Olive Drab Olive Drab 橄欖褐	H-78	C-38	66	XF-62
Dark Green Dunkel Grün 深綠	H-36	C-17	30	XF-61
Tire Black Reifen Schwarz 輪胎黑	H-77	C-137	85	XF-1
Steel Metall Stahl 黑鐵	H-18	C-28	53	/
Semi -Gloss Black Schwarz Seidenmatt 半光黑色	/	C-82	/	/
Burnt Iron Metall Bruniert 燒鐵色	H-76	C-61	/	/
Wood Brown Holz Braun 木啡色	H-37	C-43	/	/
Olive Green Olivgrün 橄欖綠	/	/	70%1325+30%86	XF58

### READ BEFORE ASSEMBLING: VOR ZUSAMMENBAU LESEN: 組裝必讀:

Carefully Study instruction before assembling. Anleitung studieren und verständlich machen. 組裝前請閱讀清楚製作指引。

Keep plastic model glue and tools away from children. Kleber, Farben, Werkzeuge und Plastiktüten von Kindern fernhalten. 膠水、油漆及工具勿讓小孩接觸。

Do not use cement or paint near open flame or sparks. Kleber/Farbe nicht in Nähe von offenen Flammen. 膠水及油漆勿接觸火種。

Do not work in closed room. Nur in ausreichend belüfteten Räumen arbeiten. 勿在密封地方製作模型。



**BRONCO**  
Bronco models

Copyright©2008

Made in China

中國製造



NO use parts  
不要部件

Ⓑ x1

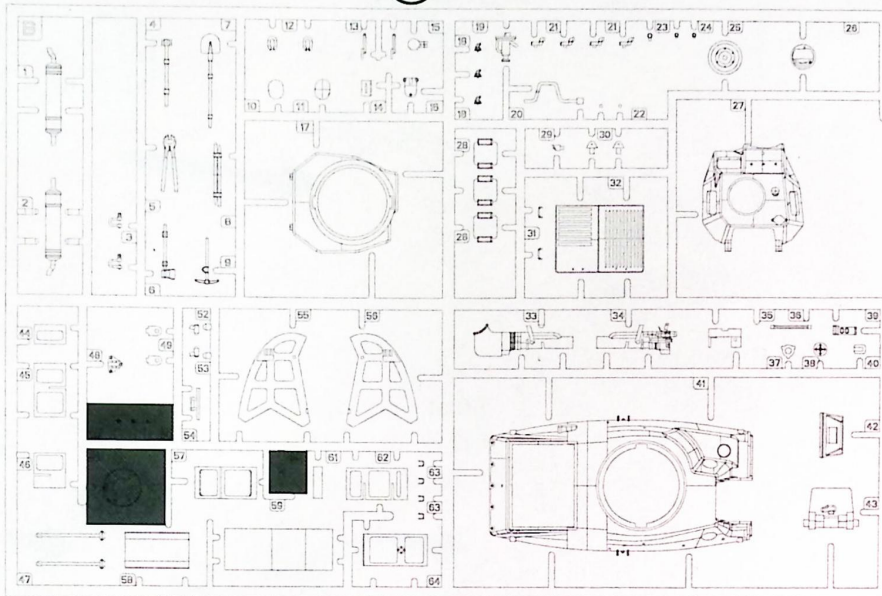

Ⓐ1 x1

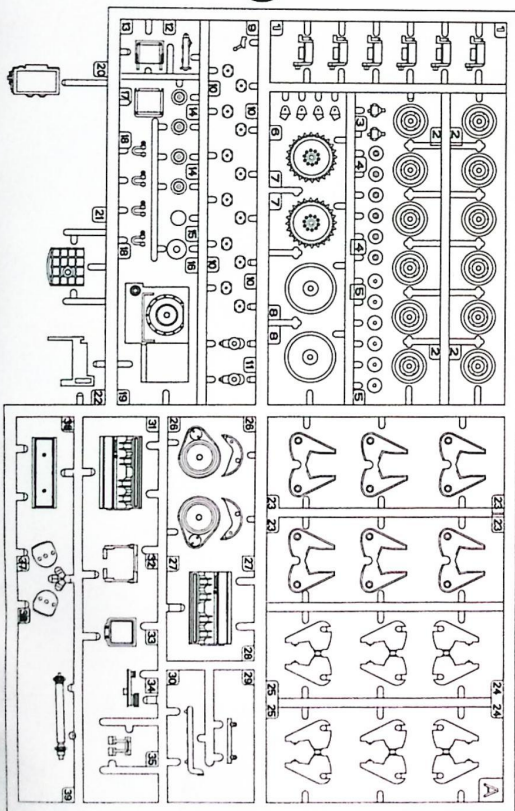

Ⓒ x1

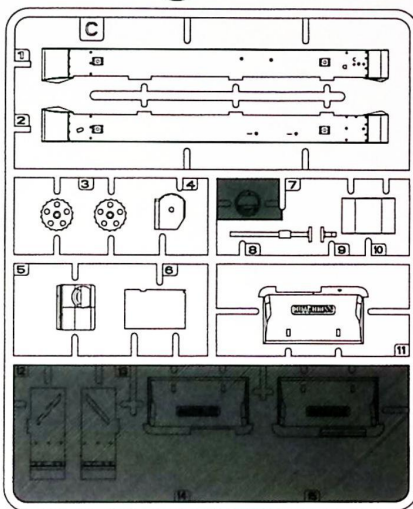

Ⓗ x1

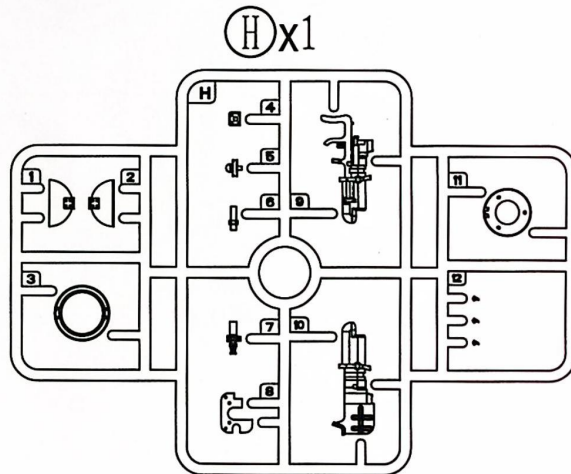

⒫ x1

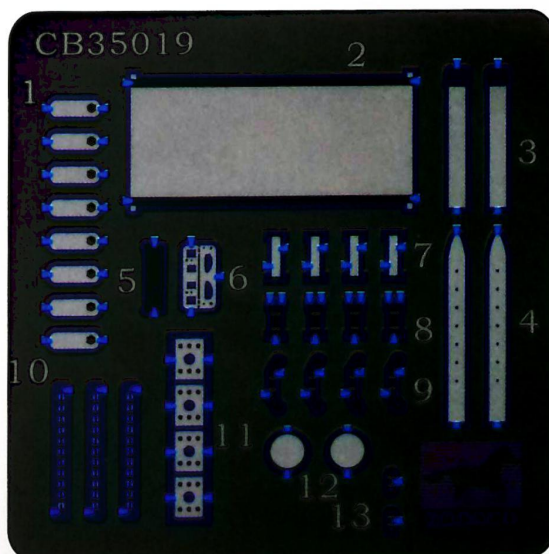

Ⓒ x2

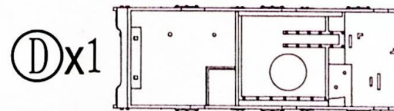
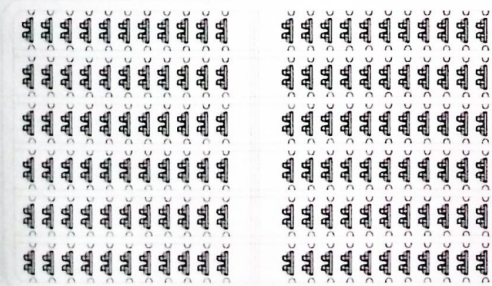

Ⓓ x1

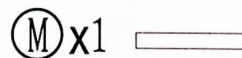

Ⓜ x1

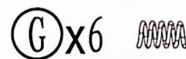

Ⓖ x6



Ⓝ x1



# ILLUSTRATION 圖示說明:

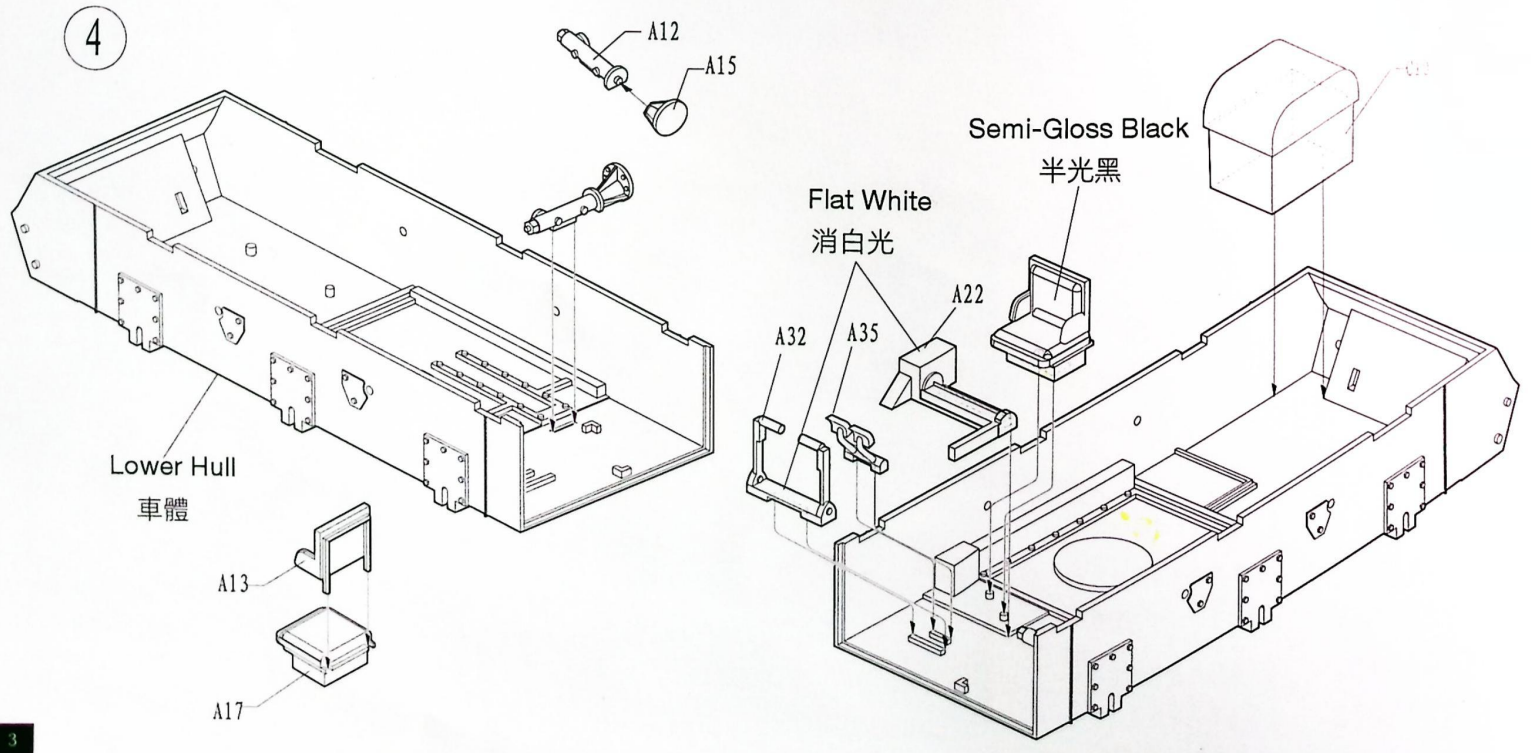
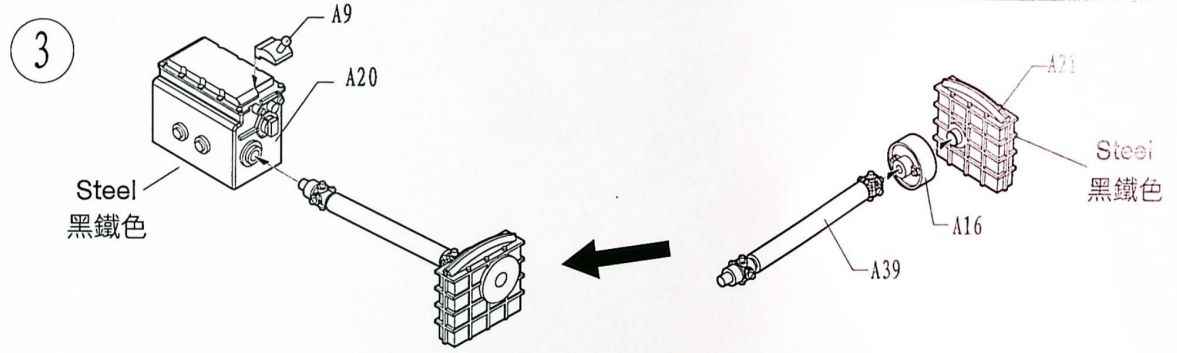
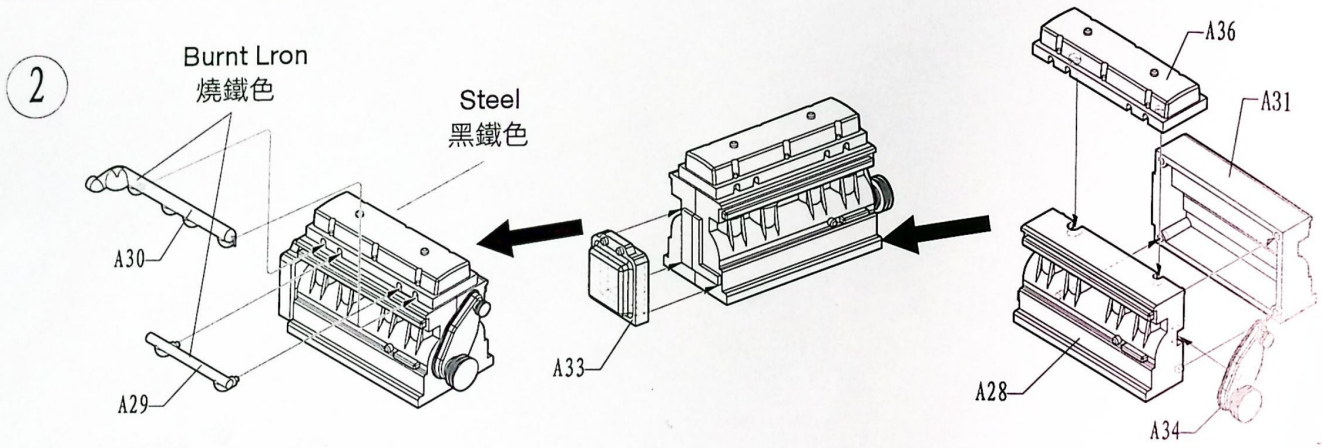
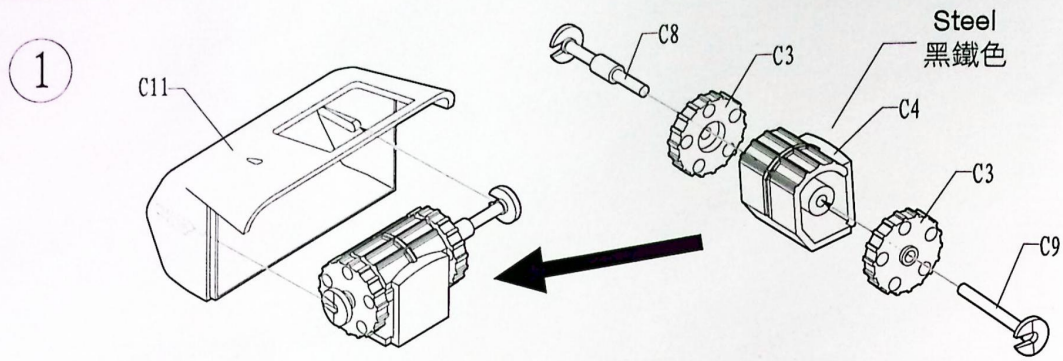



ILLUSTRATION 圖示說明:

5 Interior assembly  
車內組合

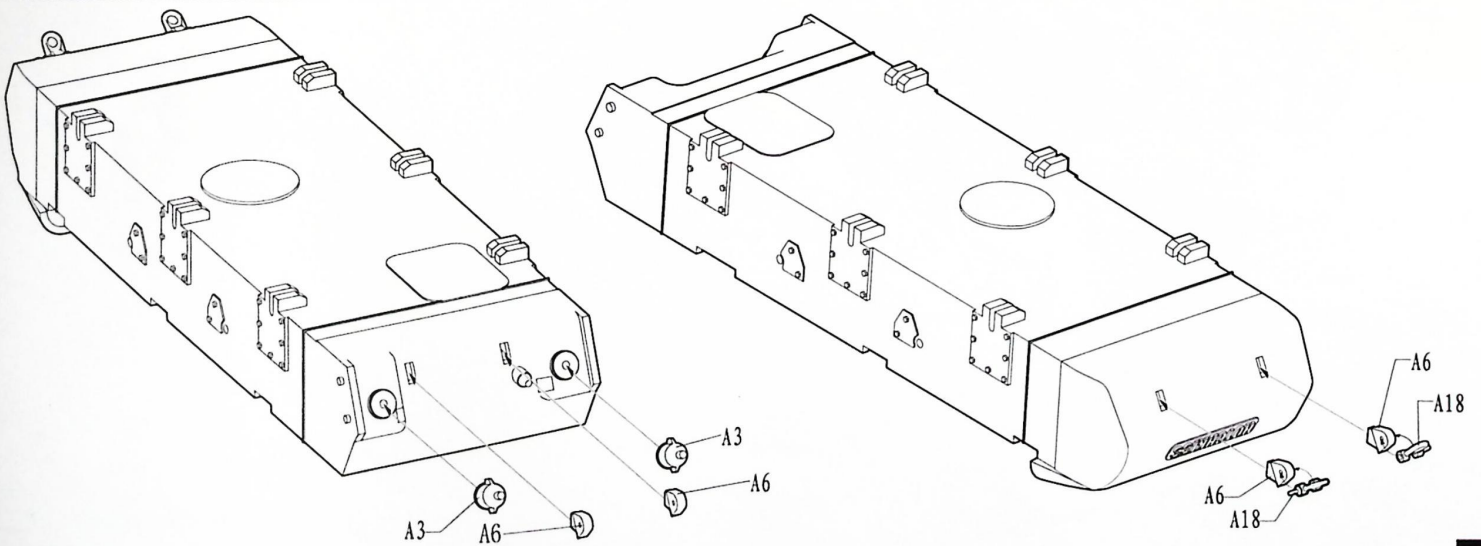
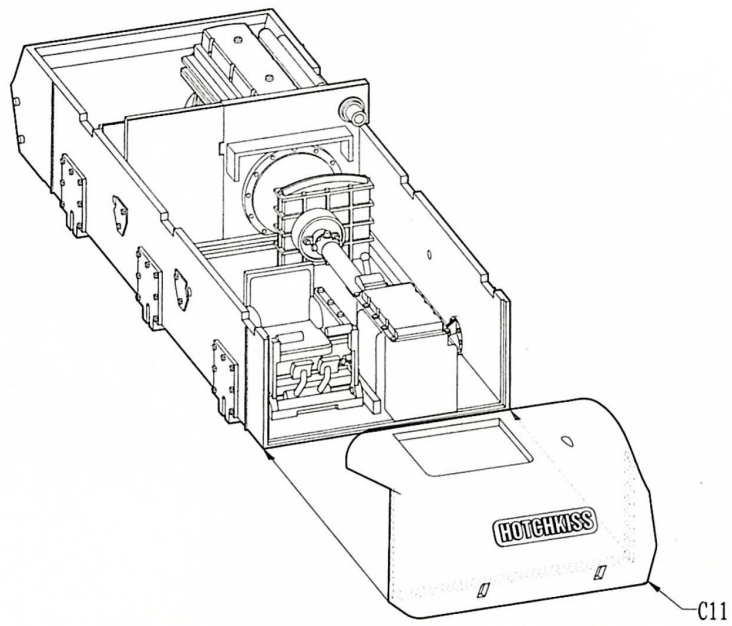
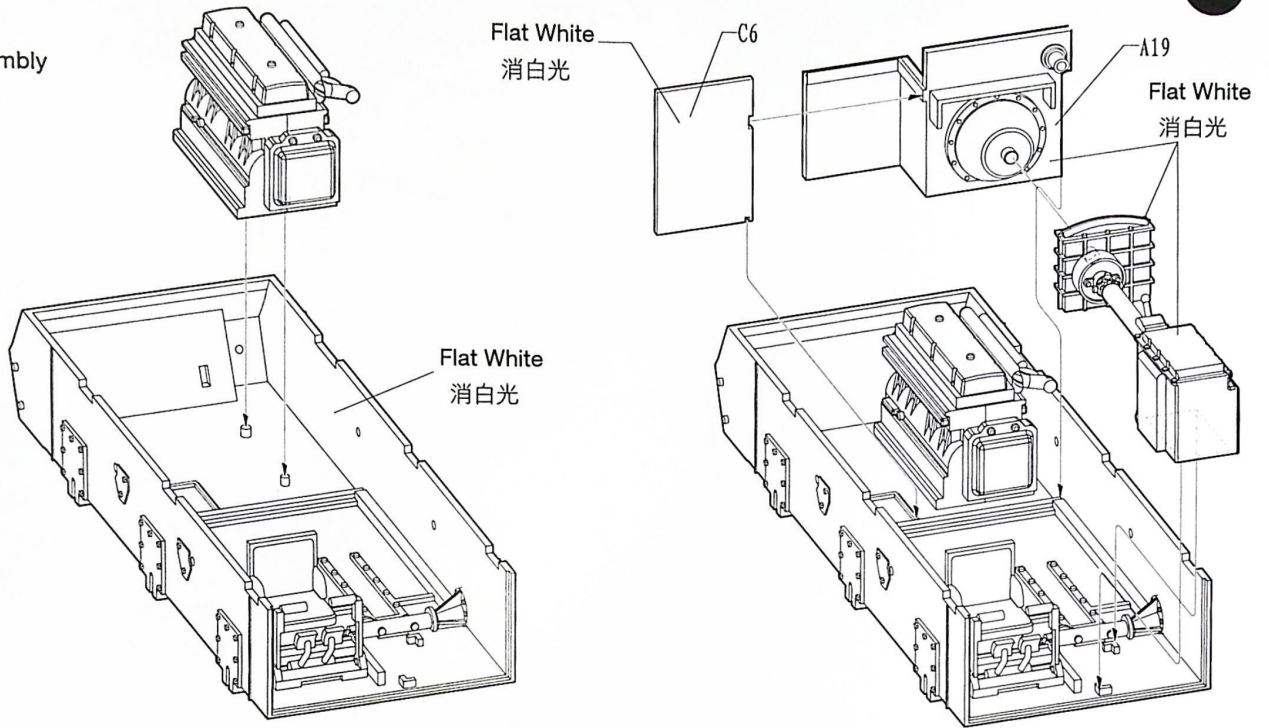
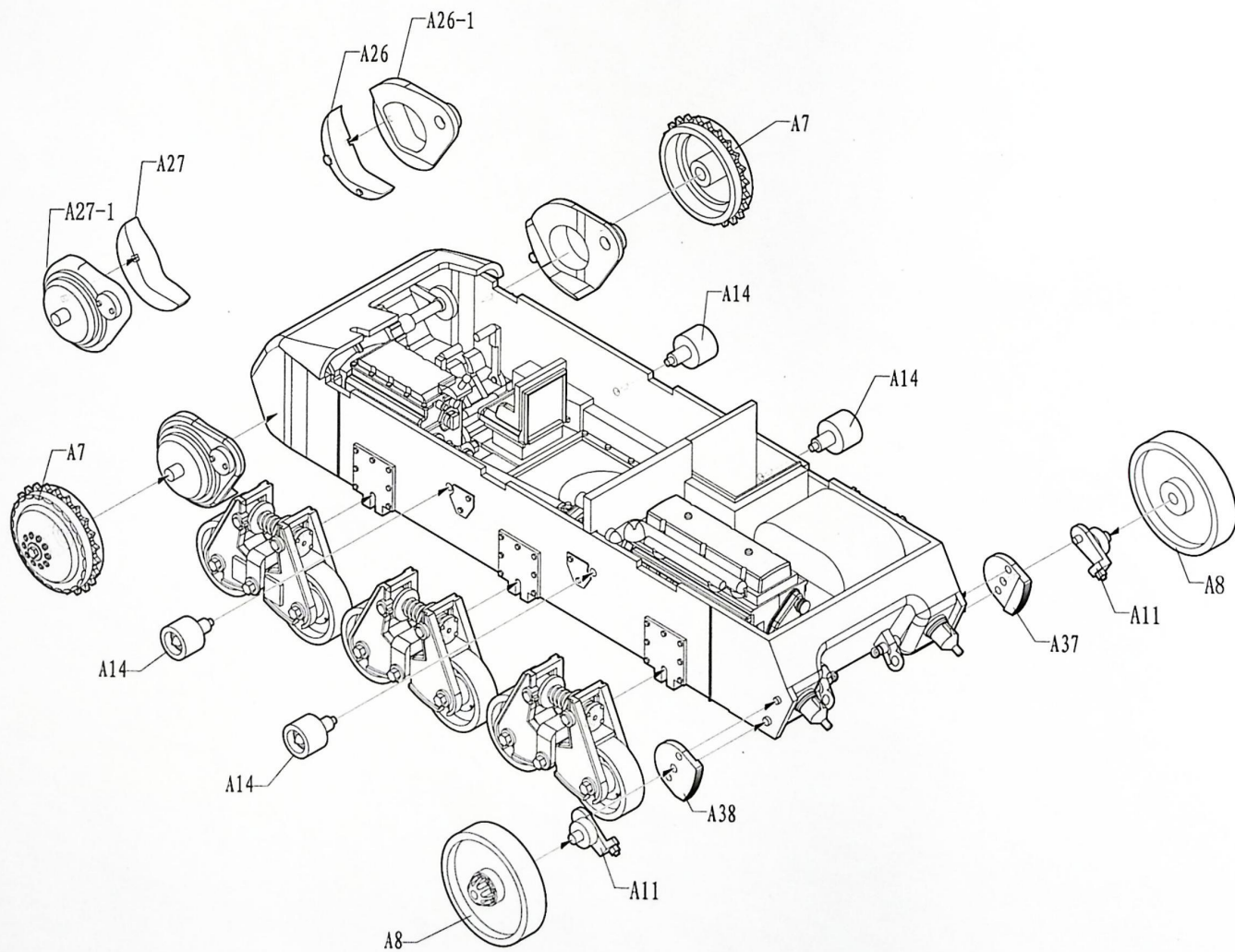
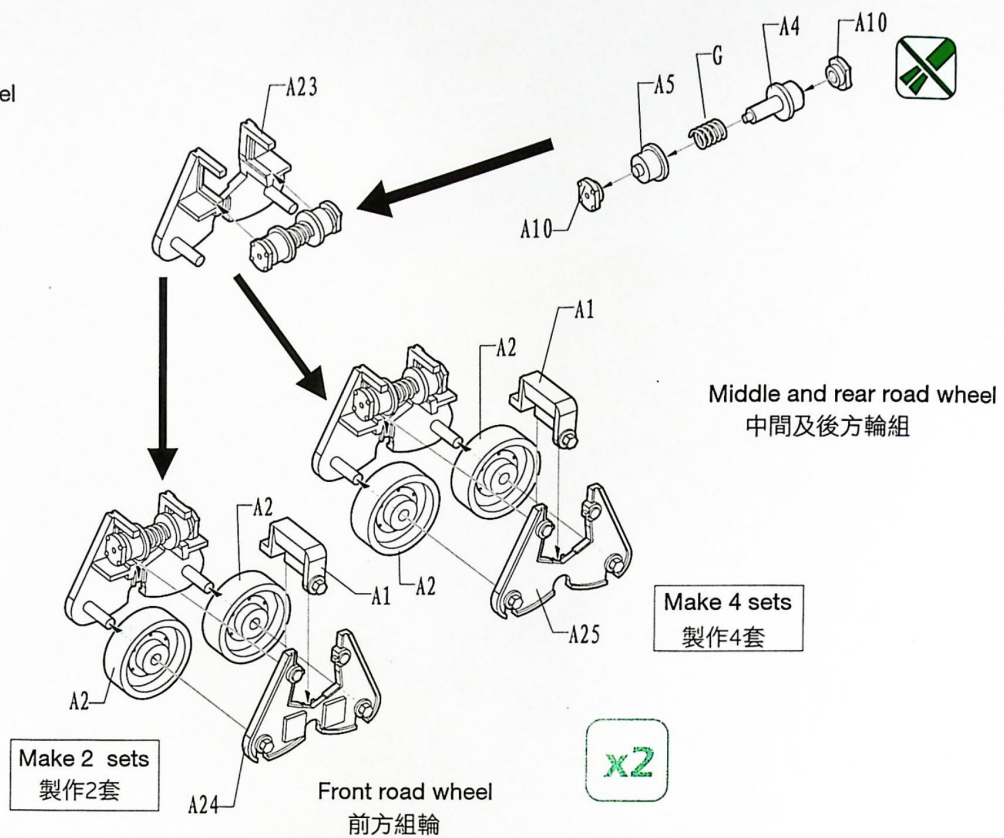



ILLUSTRATION 圖示說明:

6 Assembly for road wheel  
車輪組裝:





7 Assembly for track link  
履帶安裝:

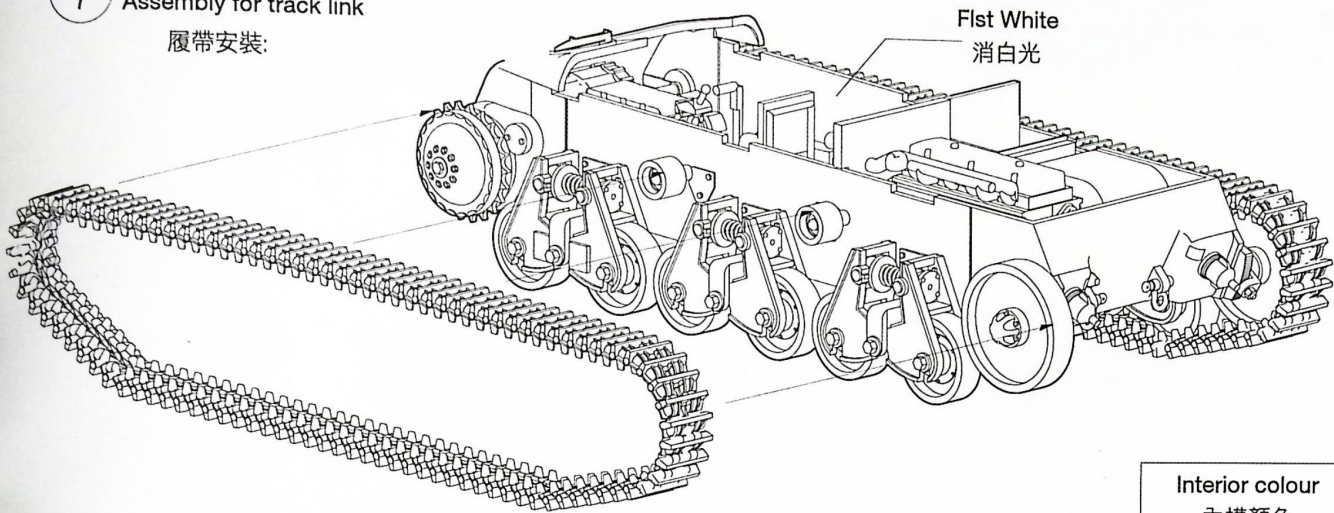

Interior colour  
內構顏色

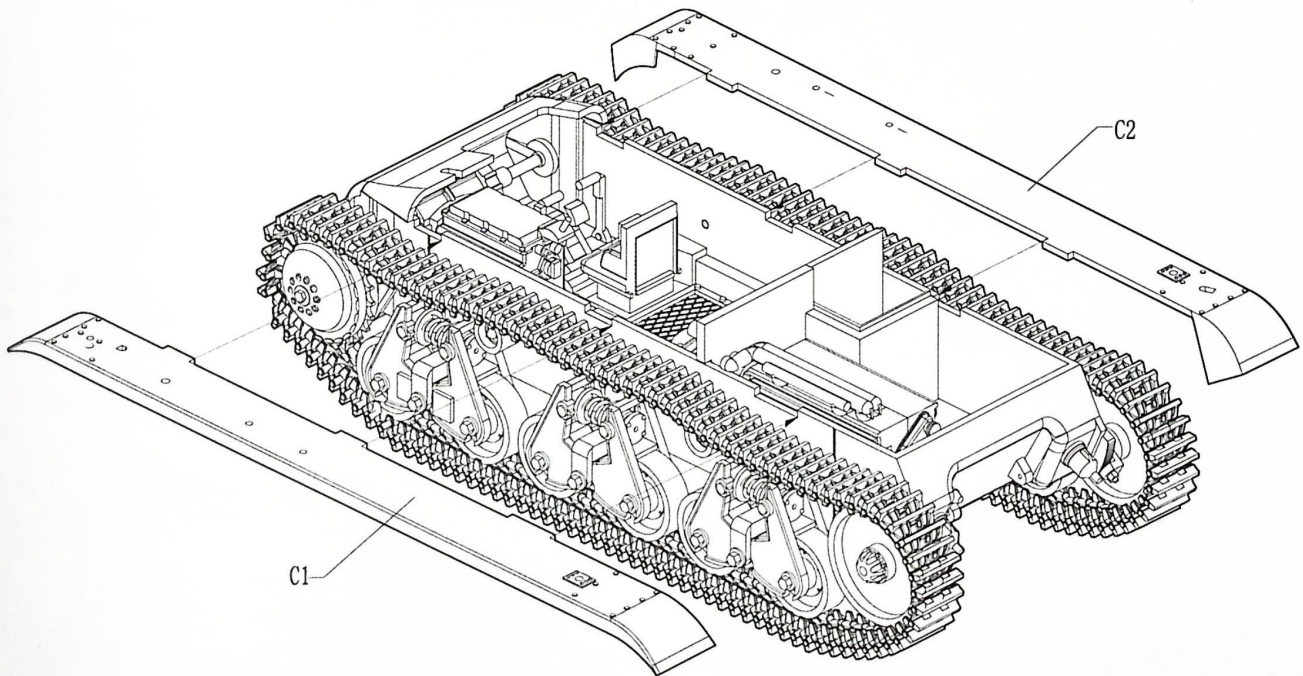
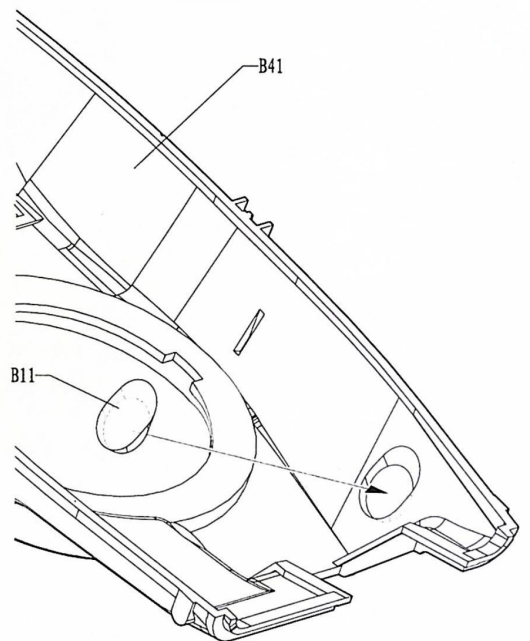
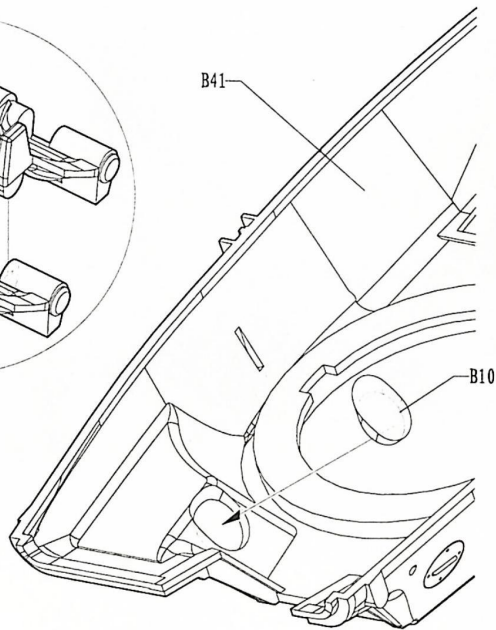
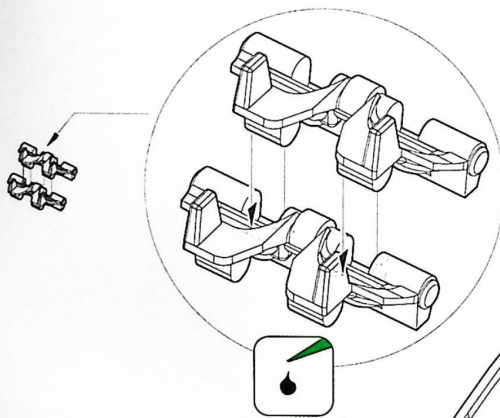



# ILLUSTRATION 圖示說明:

## 9 Assembly for upper and lower hull 主體安裝:

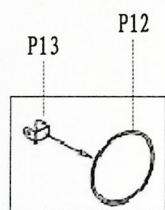
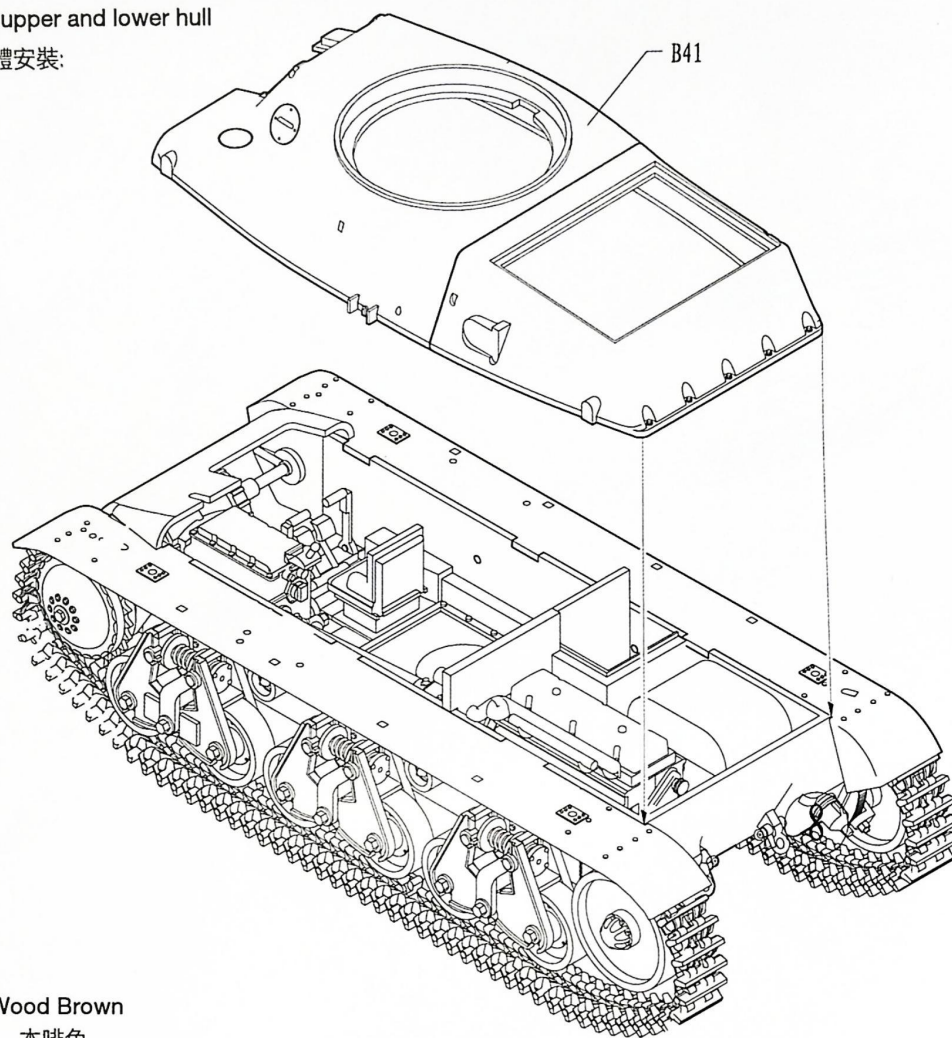

Wood Brown  
木啡色

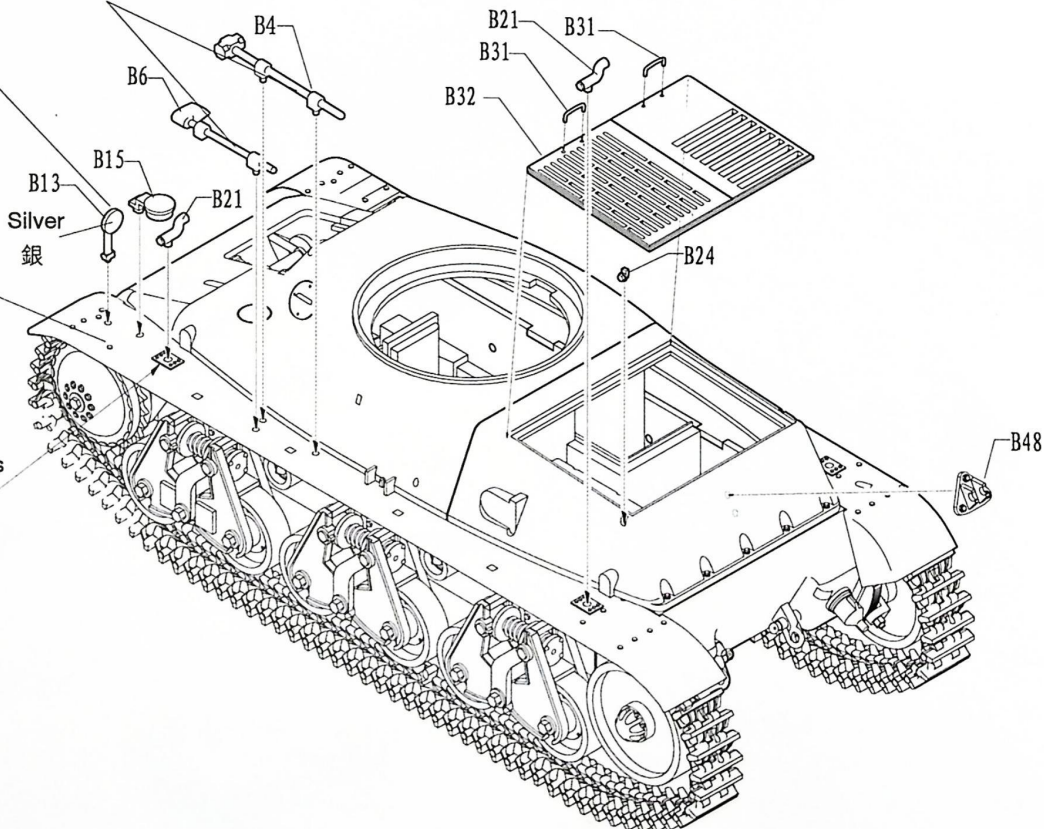

Please remove  
the stand before  
assembly the parts  
PE NO.11

如果裝上蝕刻零件  
#NO.11請將膠  
件上細節移除



10

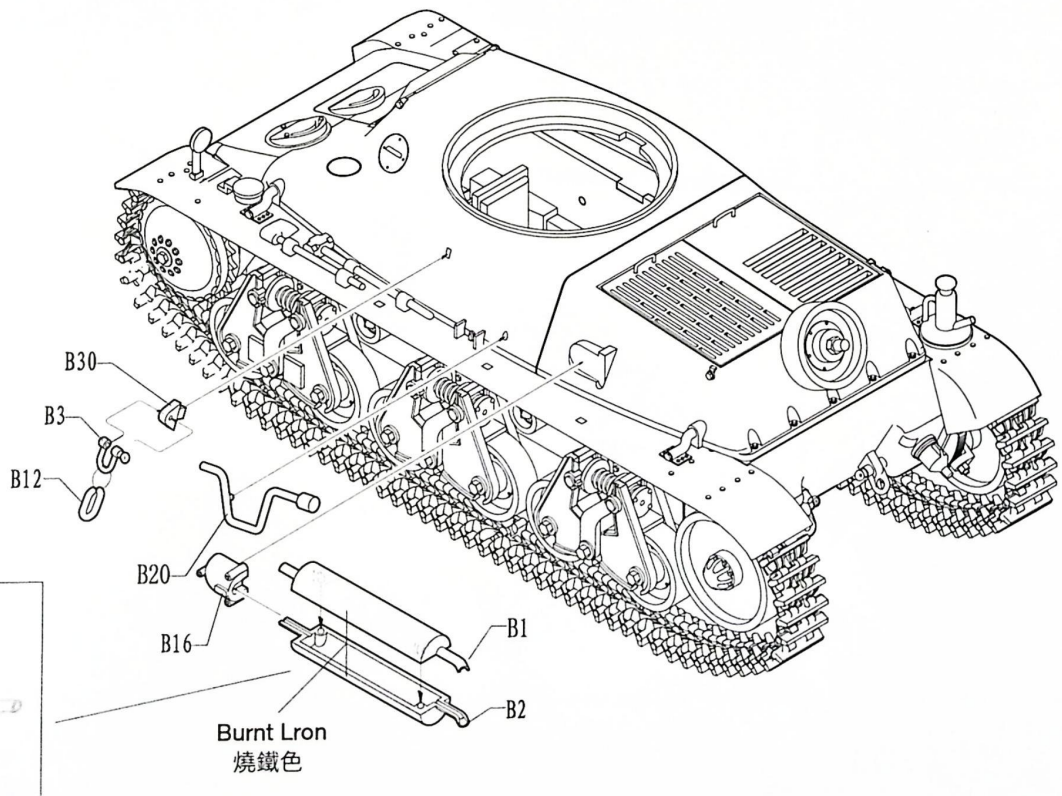
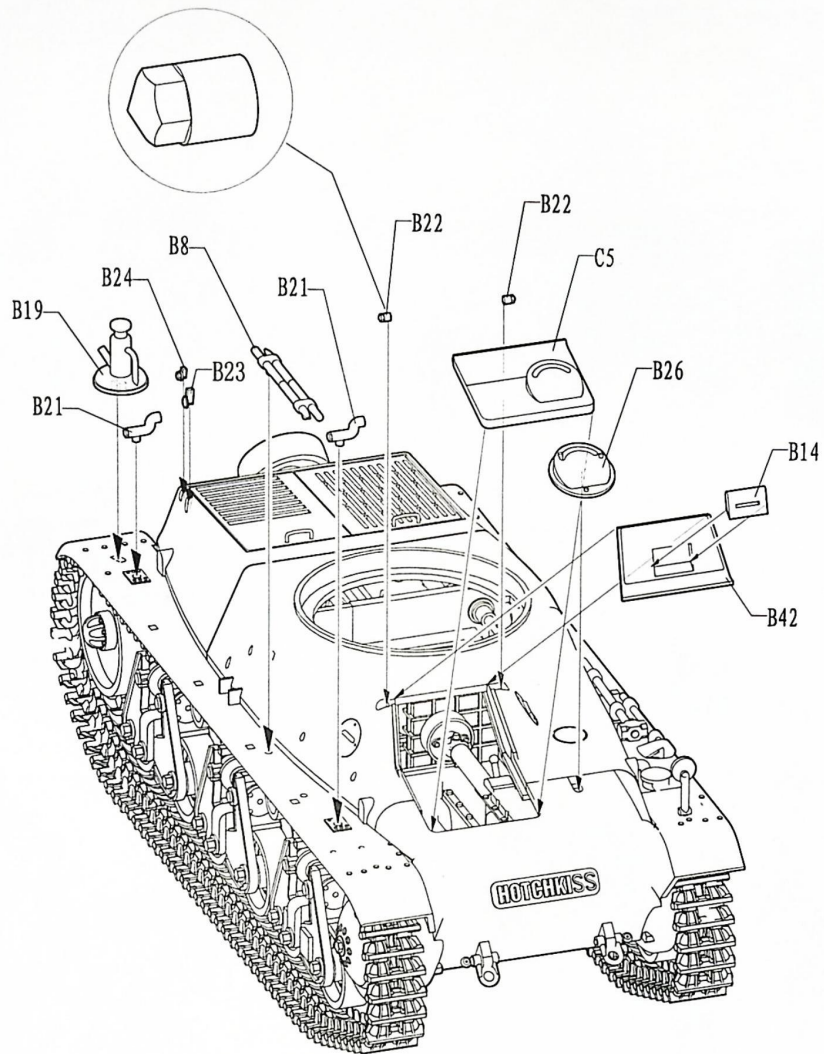



# ILLUSTRATION 圖示說明:

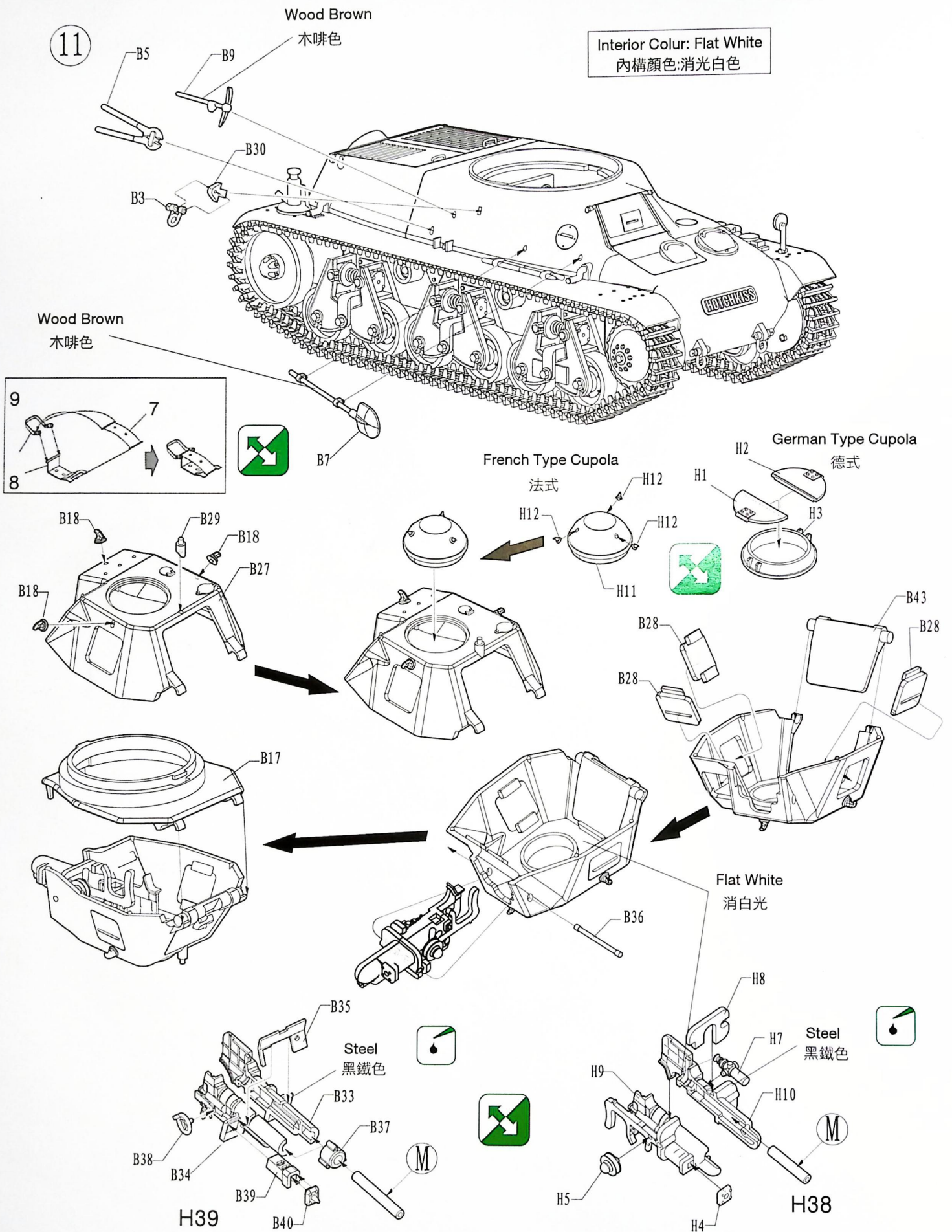



12

H38

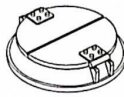
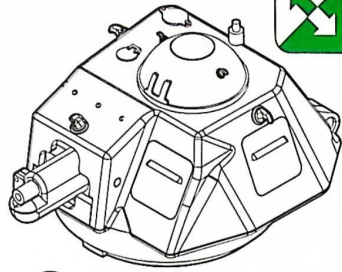

H39

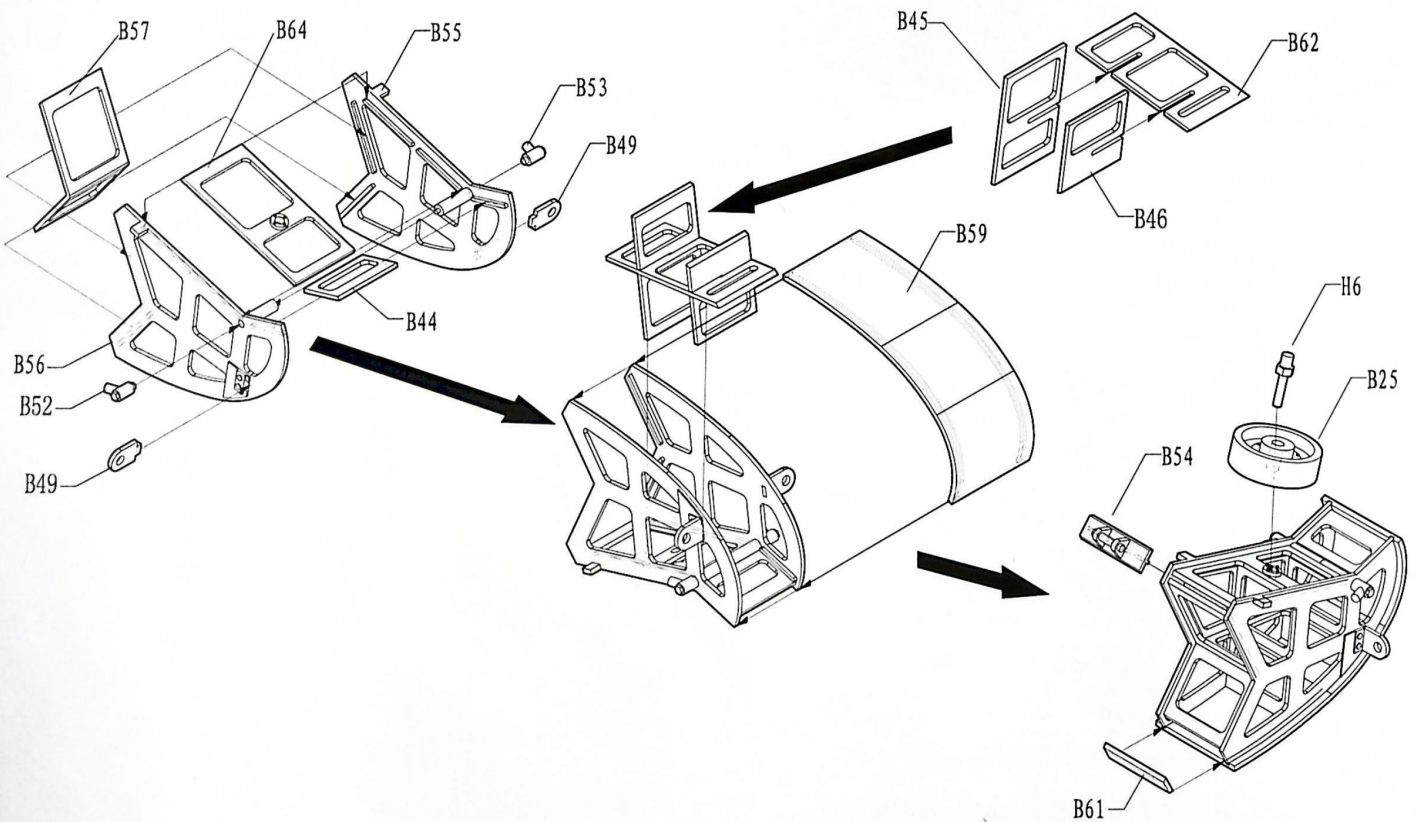
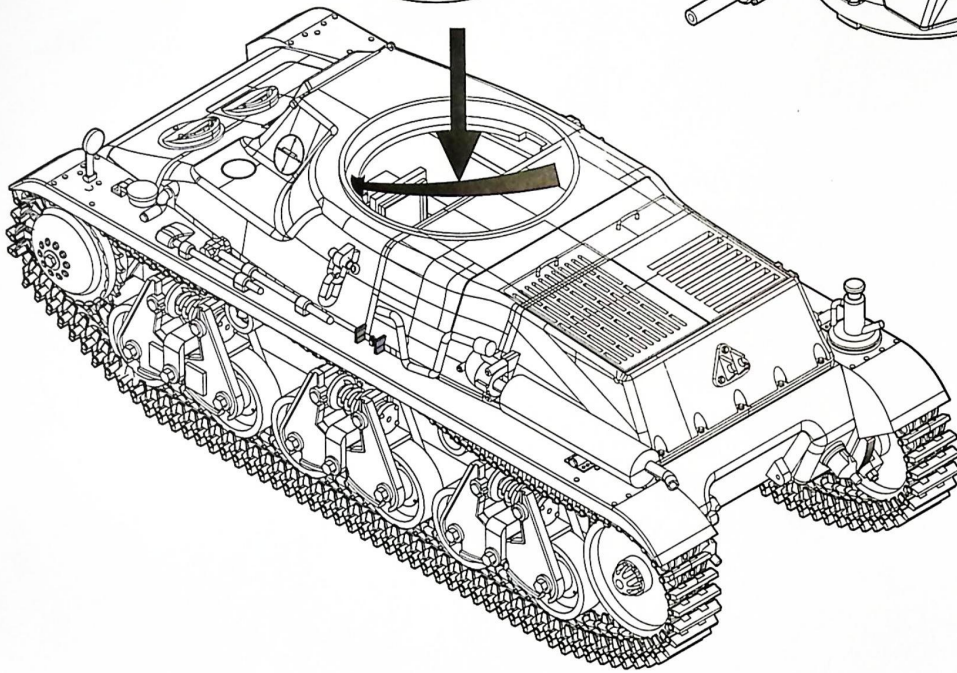
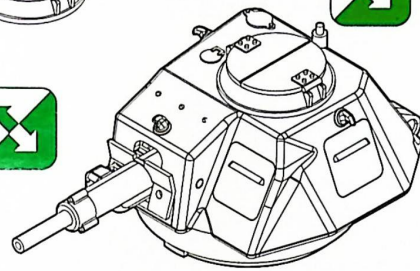

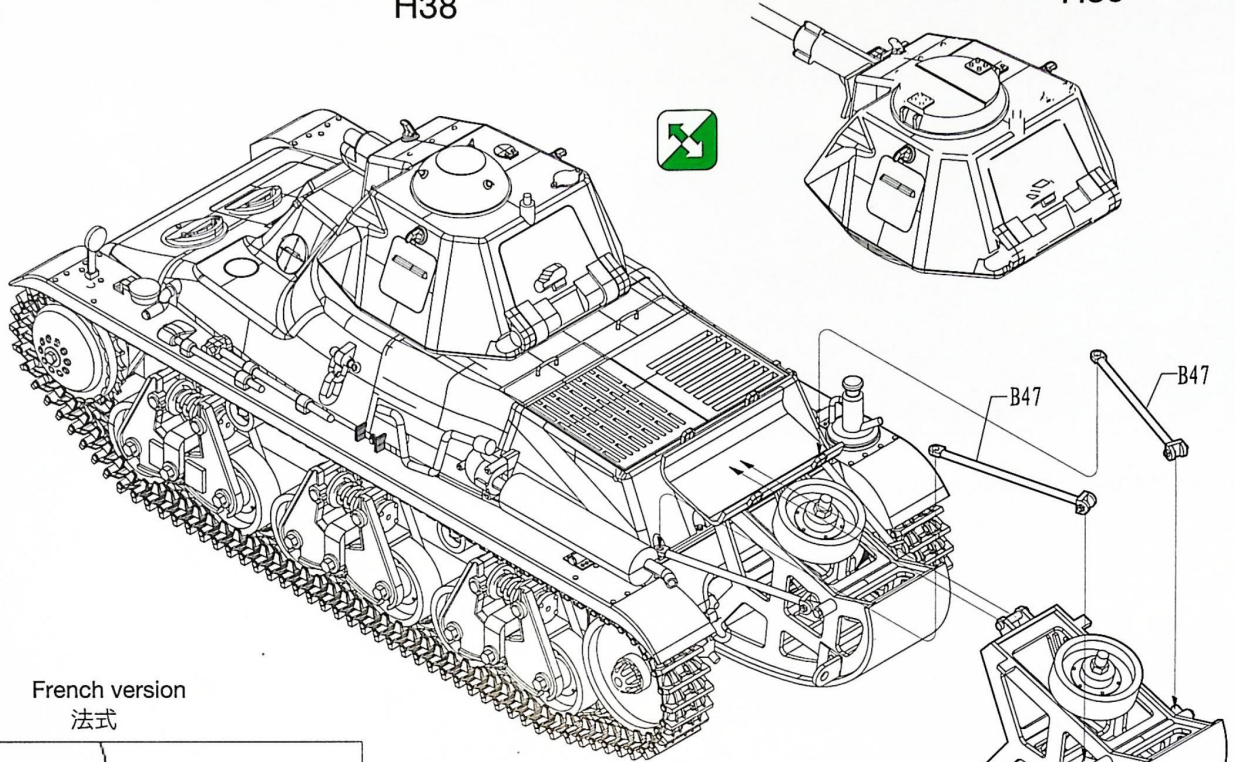

ILLUSTRATION 圖示說明:

13

H38

H39



French version  
法式

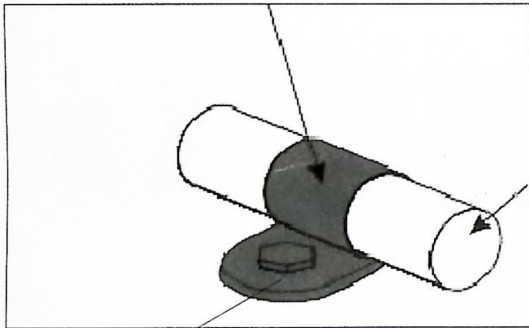

(Kit not included)  
Rob tooling  
PE用圓棒不包含  
在此膠件內

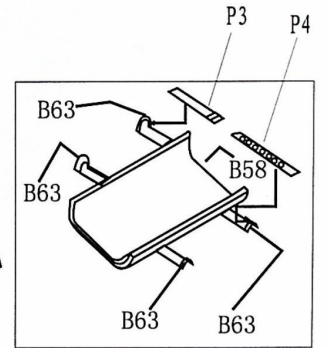
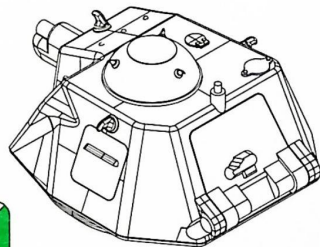

P1

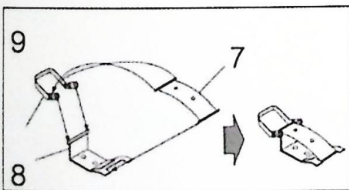
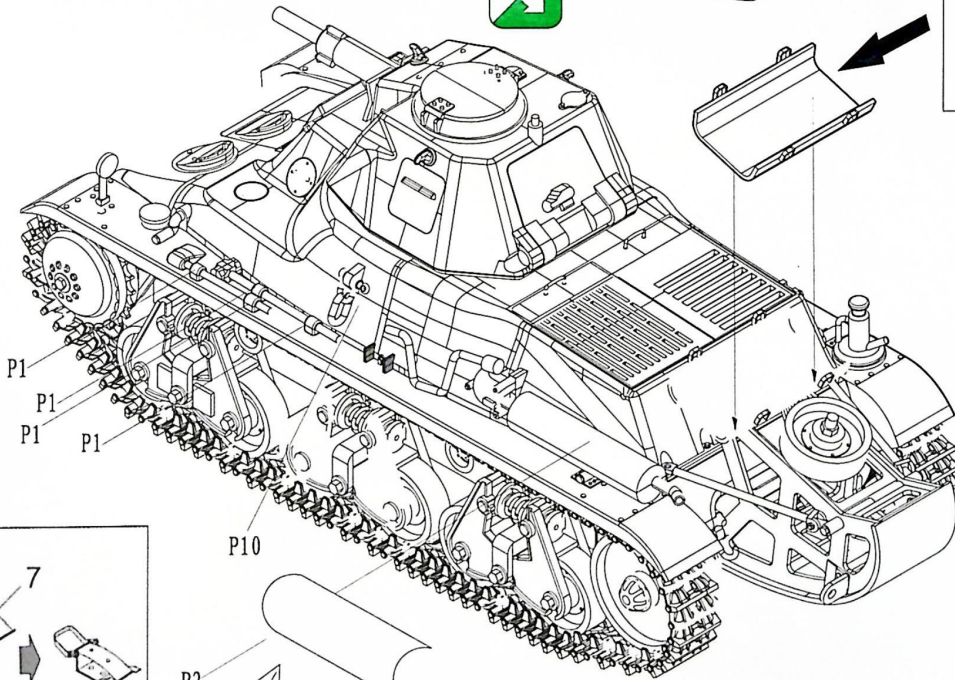

P10

P2



H38, France May, 1940

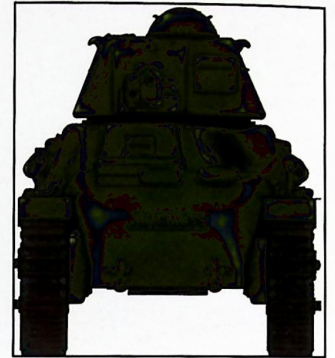
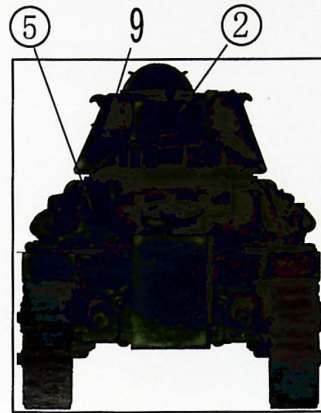
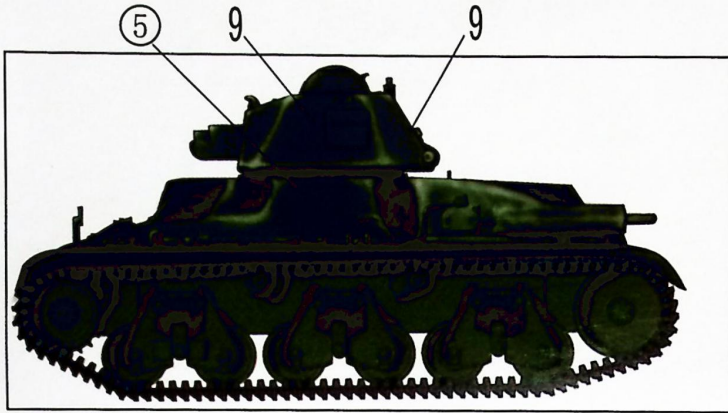

Camouflage Scheme: Olive Green  
全車塗橄欖綠色

H39 Service in German Army, Unit Unknown

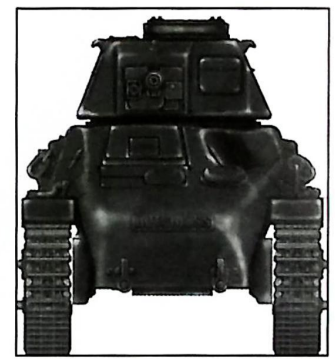
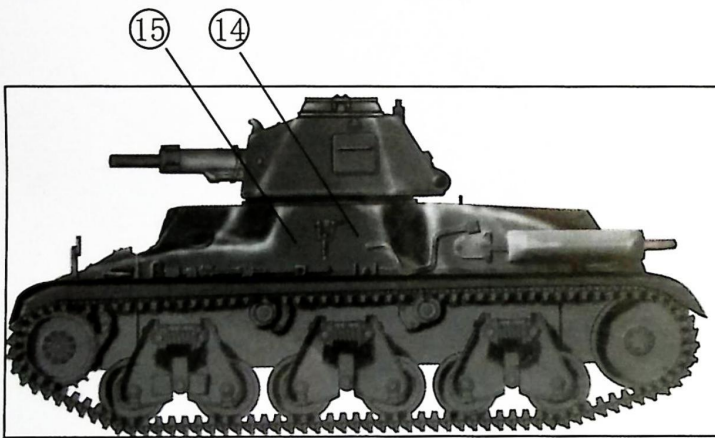

Camouflage Scheme: German Gray  
全車塗德國灰色

2e Cuirassiers, France May 1940

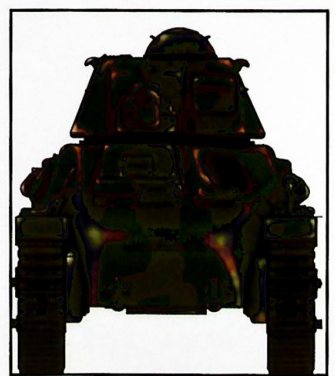
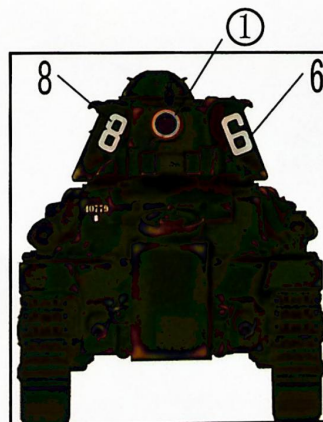
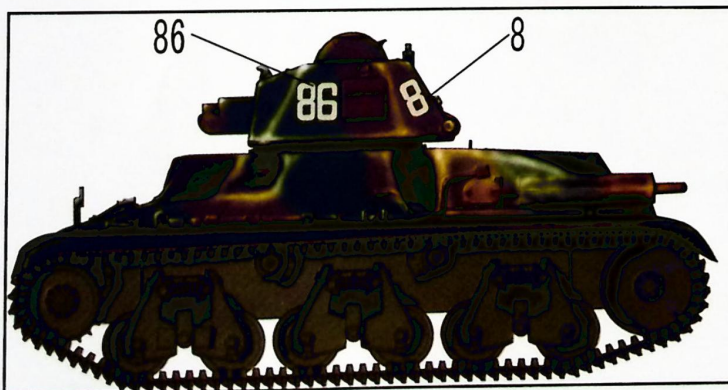

Camouflage Scheme: Olive Green with red Brown  
迷彩顏色:橄欖綠/紅啡色



DECAL & COLOUR GUIDE 水貼及塗色指示:

H38 1er Cuirassiers France April, 1940

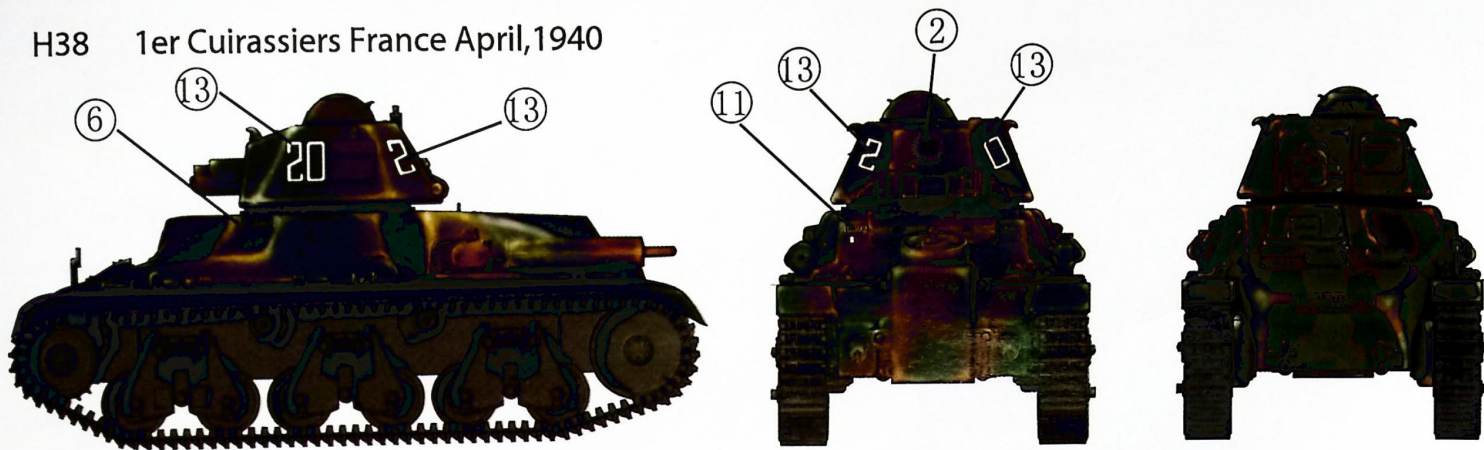

Camouflage Scheme: Olive Green with red Brown

迷彩顏色: 橄欖綠/紅啡色

1re ou 2e DLM ni des BCC France, 1940

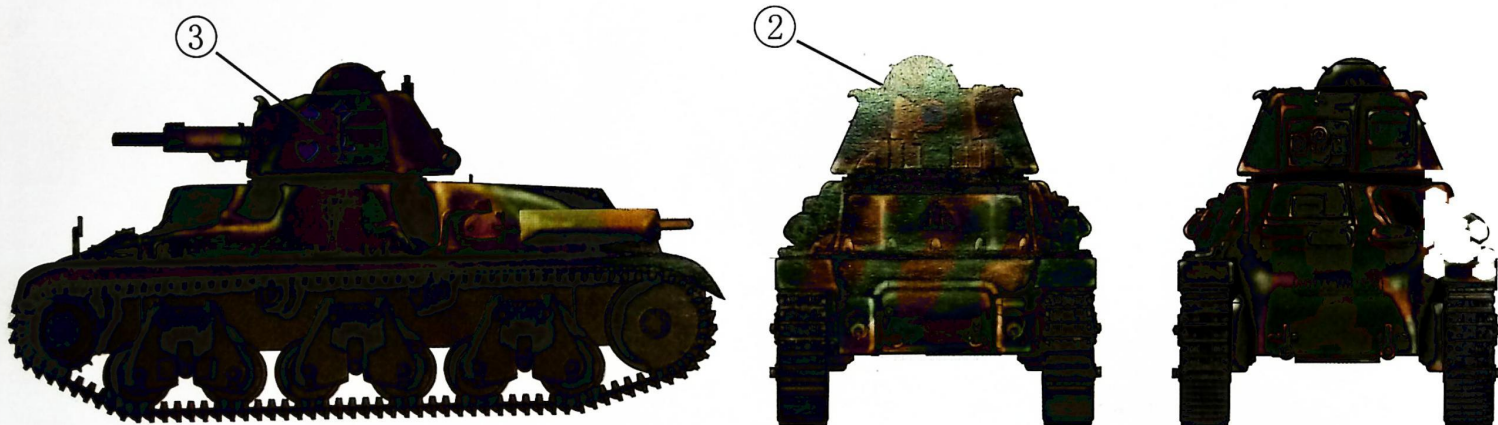

Camouflage Scheme: Olive Green with red Brown

迷彩顏色: 橄欖綠/紅啡色

H 39 Service in German Army.in Norway, 1941

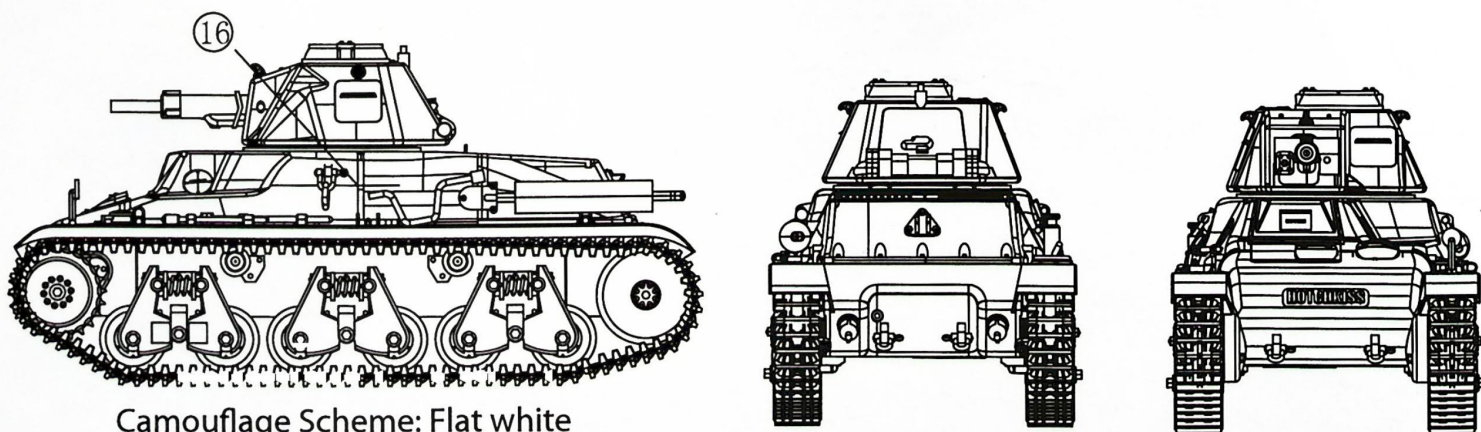

Camouflage Scheme: Flat white

全車塗消光白色