

PAINTING

We recommend the use of Humbrol Britfix Polystyrene Cement or Humbrol Britfix Liquid Poly to assemble your model, and the following Modelling Paints for a perfect finish. Humbrol Colour Reference Numbers

24 Trainer Yellow
30 Dark Green
33 Matt Black
34 Matt White
56 Aluminium

60 Scarlet
65 Aircraft Blue
75 Bronze Green
92 Iron Grey

IN CASE OF COMPLAINT

Your Humbrol Plastic Model kit has been carefully moulded and packed. Should you be in any way dissatisfied with the kit please write to the address below stating the nature of your complaint or the part number(s) required, the kit number, your name, address and post code.

The Sales Department,
Model and Hobby Division,
Humbrol Limited,
Marfleet, Hull HU9 5NE.

HUMBROL

HUMBROL CONSUMER PRODUCTS
DIVISION OF BORDEN (U.K.) LTD. MARFLEET, HULL

Model Product Group



HUMBROL

ARADO AR 196 A

KIT No. HK72012

1/72 SCALE

HISTORY

The Arado Ar196 was a German Naval reconnaissance aircraft and an artillery spotting aircraft. It was used extensively against British submarines and British Coastal Command aircraft in the North Sea Theatre during World War II. Arado Ar196's were carried on German Battleships, e.g. the 'Prinz Eugen', the 'Scharnhorst', etc. The prototype made its first flight in 1937. During the years 1939 to 1943 some 435 Arado Ar196's were produced.

SPECIFICATION

Wingspan	12.44m
Length	10.96m
Height	4.44m
Top speed	300 k.p.h.
Climbing speed	414 m/min
Max. height	7000m
Range	1070km
Engine	1 - BMW radial, 900 h.p.
Crew	1 pilot, 1 gunner/observer
Weaponry.....	2 - 20mm wing guns, 1 - 7.9mm machine gun 2 - 110lb bombs

GENERAL MODELLING

You have a Humbrol Model Kit, each piece of which has been carefully researched and produced to allow you to construct a model kit of which you can be justly proud.

Before commencing the assembly

Study these notes and the assembly instructions before starting the model. Identify the numbered pieces on each of the mouldings with the help of the plans. Make certain you know where pieces fit. Where there is a choice of versions, make certain you know which pieces are required for your intended model. Identify the pieces you have to paint before assembling and those that can be painted after assembling. Follow the step-by-step instructions carefully.

Assembling and gluing

Carefully cut the pieces from the sprue using a craft knife with a sharp blade. If necessary, trim the pieces with a file or a sandpaper board to ensure a perfect fit.

Before applying cement, assemble the pieces "dry", in order to satisfy yourself that you know where each is located and that they fit perfectly together.

Use the minimum amount of Polystyrene Cement or Liquid Poly, following the instructions for these products. Make certain that pieces are located together to give perfect symmetry in the model.

Certain pieces may need "clamping" together after cementing, until set.

Use one or more spring-type clothes pegs or adhesive tape to assist you to get a perfect join.

Use a pair of tweezers to assist you in assembling the smaller components.

Polystyrene Cement or Liquid Poly will not adhere to plated or painted plastic, so carefully scrape away the plating from the points of assembly before applying cement. Any small gaps in the model can be filled using Humbrol Model Filler.

Painting

Use Humbrol Enamels for painting your model.

Follow the instructions as to which pieces to paint before or after assembly. To matt down a gloss paint use Matt Varnish No. 49.

When intermixing paints to obtain a particular shade, make certain that you mix sufficient for the job in hand.

Positioning of decals

Identify the position for each decal on the model according to the version chosen by following the plans.

Carefully cut round the decal, soak for a few seconds in lukewarm water, carefully slide from the backing paper into the correct position.

Absorb excess water with a small piece of blotting paper or soft clean rag.

Tools and materials usually recommended and used for modelling (files, pins, craft knife, cements, solvents, paints, etc.) can represent a danger if entrusted to children without the control of a parent. All modellers should exercise care in the use of heat or naked flames and the use of these should not be attempted by a young person under any circumstances.

The above advice is not given lightly and we kindly ask you not to ignore it.

Thank You...Happy Modelling

PARTS LIST

Cluster 1

- 1 R/H 1/2 Fuselage
- 2 R/H 1/2 Hood
- 3 L/H 1/2 Hood
- 4 Front float support
- 5 Rear float support
- 6 Joystick
- 7 Visor
- 8 Propeller fastener
- 9 Rudder bar
- 10 Nosepiece
- 11 Nosepiece section
- 12 Propeller

Cluster 2

- 13 L/H 1/2 Fuselage
- 14 Cylinder
- 15 Floor
- 16 Front dashboard
- 17 Rear dashboard
- 18 Rear bulkhead
- 19 Rudders
- 20 Rear seat
- 21 Machine gun support
- 22 Machine gun
- 23 Float rudder

Cluster 3

- 24 Lower wing
- 25 Rocker arms
- 26 Front seat
- 27 Right support arm
- 28 Left support arm
- 29 Pitot tube
- 30 Antenna
- 31 Wing section(4)

Cluster 4

- 32 1/2 R/H Upper wing
- 33 1/2 L/H Upper wing
- 34 Upper R/H float section
- 35 Upper L/H float section
- 36 Lower R/H float section
- 37 Lower L/H float section

Cluster 5

- 38 Windshield
- 39 Glass hood
- 40 Rear hood

ASSEMBLY

A - Assembly of the Fuselage

- Glue 6, 9 and 26 on 15 (centring)
Glue 16, 17 and 1 into 1 (rest)
Glue 15 into 1 (rest)
Glue 13 against 1 (centring)
Glue 7 on 16 (centring)
Glue 21 on 18 (centring)
Glue 20 into the fuselage (centring)
Glue 10 on 11,
trapping and gluing 12
Glue 8 on the axle of 12
trapping 25 without gluing it
(the propeller should turn freely)
Glue 25 against 14 (centring)
Glue 14 against the fuselage
(centring)

B - Assembly of the Wings

- Glue 24 under the fuselage
Glue 32 and 33 on 24 and against
the fuselage
Glue 19 to the end of the fuselage
Glue 34 on 36 and 35 on 37
Glue 4 and 5 on the floats
(centring)
Glue 27 and 28 on the floats
Glue 4 and 5 under 24 (centring)

C - Finishing

- Glue 38, 39 and 40 on the fuselage
Glue 30 on 38 (centring)
Glue 22 on 21 (centring)
Glue 29 and 31 (4) under 24
(centring)
Glue 23 (2) to the end of the floats

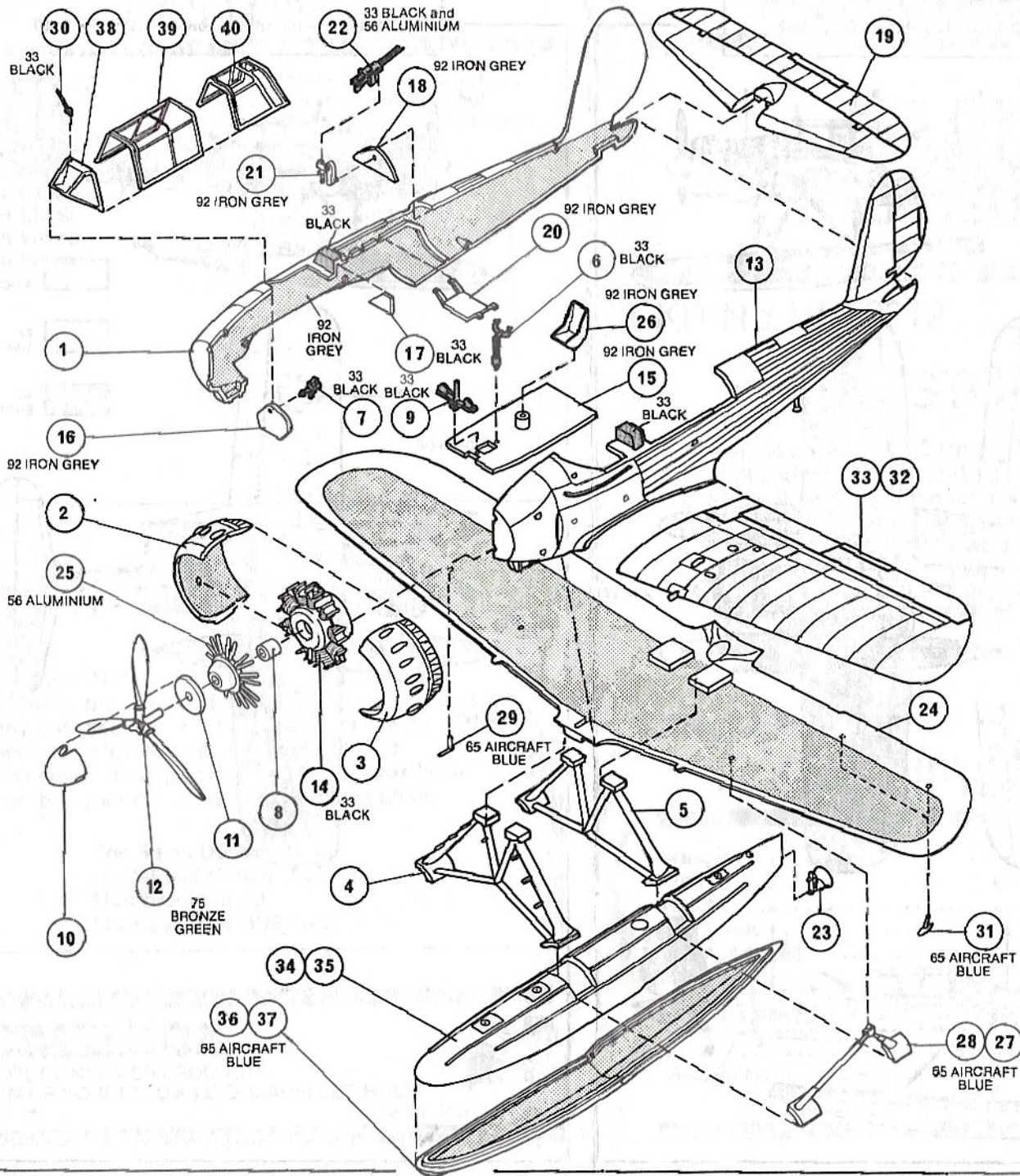

GERMANY – 2/5 AGr 125 Mer – EGEE 1942

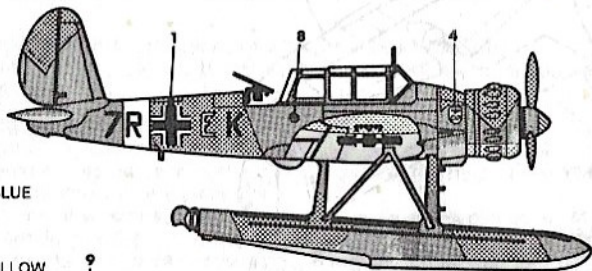

65 AIRCRAFT BLUE

24 TRAINER YELLOW

75 BRONZE GREEN

30 DARK GREEN

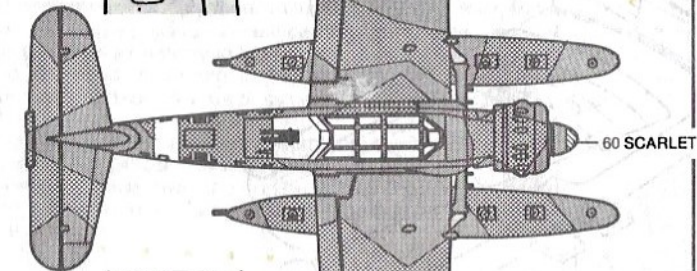
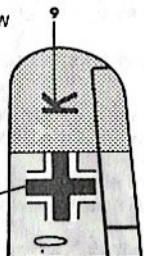

UNDERSIDE

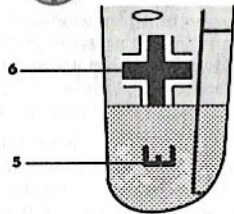

UPPER SURFACE

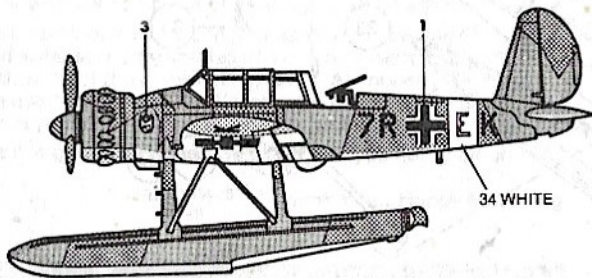

34 WHITE

ROMANIA – 102nd Squadron – ODESSA 1943

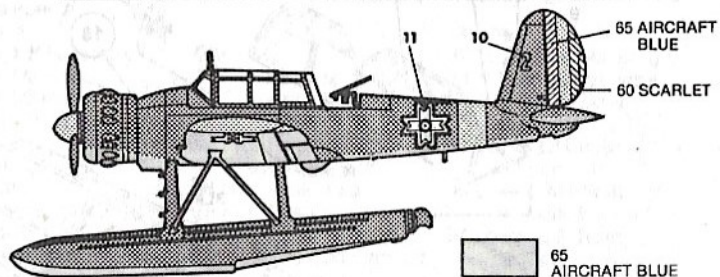

65 AIRCRAFT BLUE

24 TRAINER YELLOW

75 BRONZE GREEN

UNDERSIDE

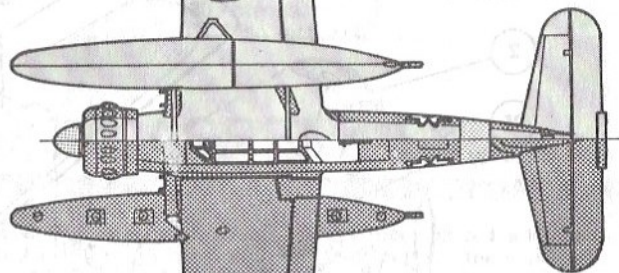

UPPER SURFACE

11

Arado Ar 196 A

1:72 SCALE MODEL KIT



HUMBROL