

eduard



Shachhak 1/48

No. 11128

Limited Edition

ATTENTION



UPOZORNĚNÍ



ACHTUNG



ATTENTION



注意



Carefully read instruction sheet before assembling. When you use glue or paint, do not use near open flame and use in well ventilated room. Keep out of reach of small children. Children must not be allowed to suck any part, or pull vinyl bag over the head.



Před započítím stavby si pečlivě prostudujte stavební návod. Při používání barev a lepidel pracujte v dobře větrané místnosti. Lepidla ani barvy nepoužívejte v blízkosti otevřeného ohně. Model není určen malým dětem, mohlo by dojít k požití drobných dílů.

INSTRUCTION SIGNS

* INSTR. SYMBOLY

* INSTRUKTION SINNBILDEN

* SYMBOLES

* 記号の説明

OPTIONAL
VOLBABEND
OHNOUTSAND
BROUSITOPEN HOLE
VYVRTAT OTVORSYMETRICAL ASSEMBLY
SYMETRICKÁ MONTÁŽREMOVE
ODŘÍZNOUTREVERSE SIDE
OTOČITAPPLY EDUARD MASK
AND PAINT
POUŽIT EDUARD MASK
NABARVIT

PARTS



DÍLY



TEILE



PIÈCES



部品

PLASTIC PARTS

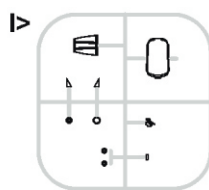
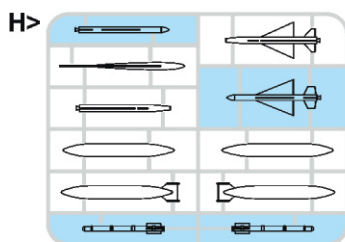
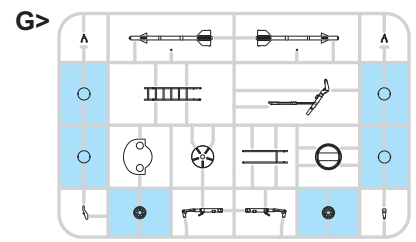
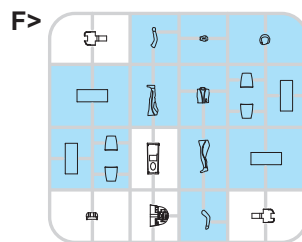
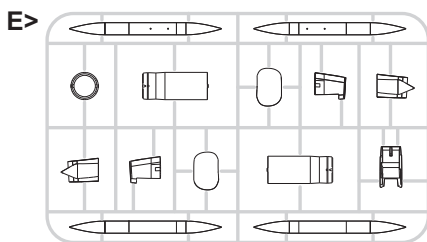
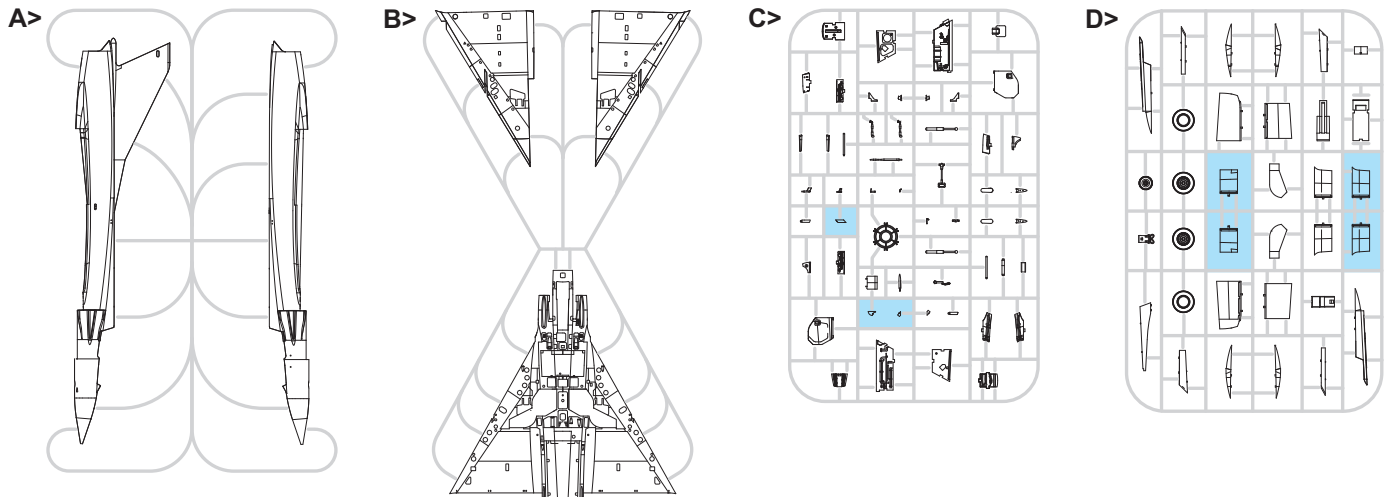
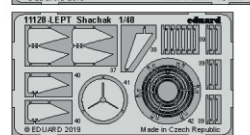
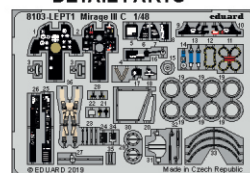
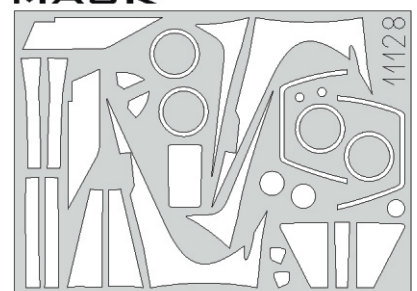
PE - PHOTO ETCHED
DETAIL PARTSeduard
MASK

RP - RESIN PARTS



RP28



RP29



RP30



RP31

-Parts not for use. -Teile werden nicht verwendet. -Pièces à ne pas utiliser. -Tyto díly nepoužívejte při stavbě. - 使用しない部品

COLOURS



BARVY



FARBEN



PEINTURE



色

| GSI Creos (GUNZE) | | MISSION MODELS | |
|-------------------|----------|----------------|-------------|
| AQUEOUS | Mr.COLOR | PAINTS | |
| [H1] | [C1] | [MMP-001] | WHITE |
| [H2] | [C2] | [MMP-047] | BLACK |
| [H3] | [C3] | [MMP-003] | RED |
| [H4] | [C4] | [MMP-007] | YELLOW |
| [H8] | [C8] | | SILVER |
| [H11] | [C62] | [MMP-001] | FLAT WHITE |
| [H12] | [C33] | [MMP-047] | FLAT BLACK |
| [H52] | [C12] | [MMP-091] | OLIVE DRAB |
| [H77] | [C137] | [MMP-040] | TIRE BLACK |
| [H90] | [C47] | | CLEAR RED |
| [H93] | [C50] | | CLEAR BLUE |
| [H94] | [C138] | | CLEAR GREEN |
| [H305] | [C305] | [MMP-084] | GRAY |

| GSI Creos (GUNZE) | | MISSION MODELS | |
|-------------------------|----------|----------------|--------------|
| AQUEOUS | Mr.COLOR | PAINTS | |
| [H307] | [C307] | [MMP-074] | GRAY |
| [H308] | [C308] | [MMP-073] | GRAY |
| [H310] | [C310] | [MMP-060] | BROWN |
| [H312] | [C312] | | GREEN |
| [H313] | [C313] | | YELLOW |
| [H314] | [C314] | | BLUE |
| Mr.METAL COLOR | | METALLICS | |
| [MC213] | | [MMM-006] | STEEL |
| [MC214] | | [MMM-001] | DARK IRON |
| [MC218] | | [MMM-003] | ALUMINIUM |
| Mr.COLOR SUPER METALLIC | | METALLICS | |
| [SM01] | | [MMC-001] | SUPER CHROME |
| [SM03] | | [MMM-002] | SUPER IRON |

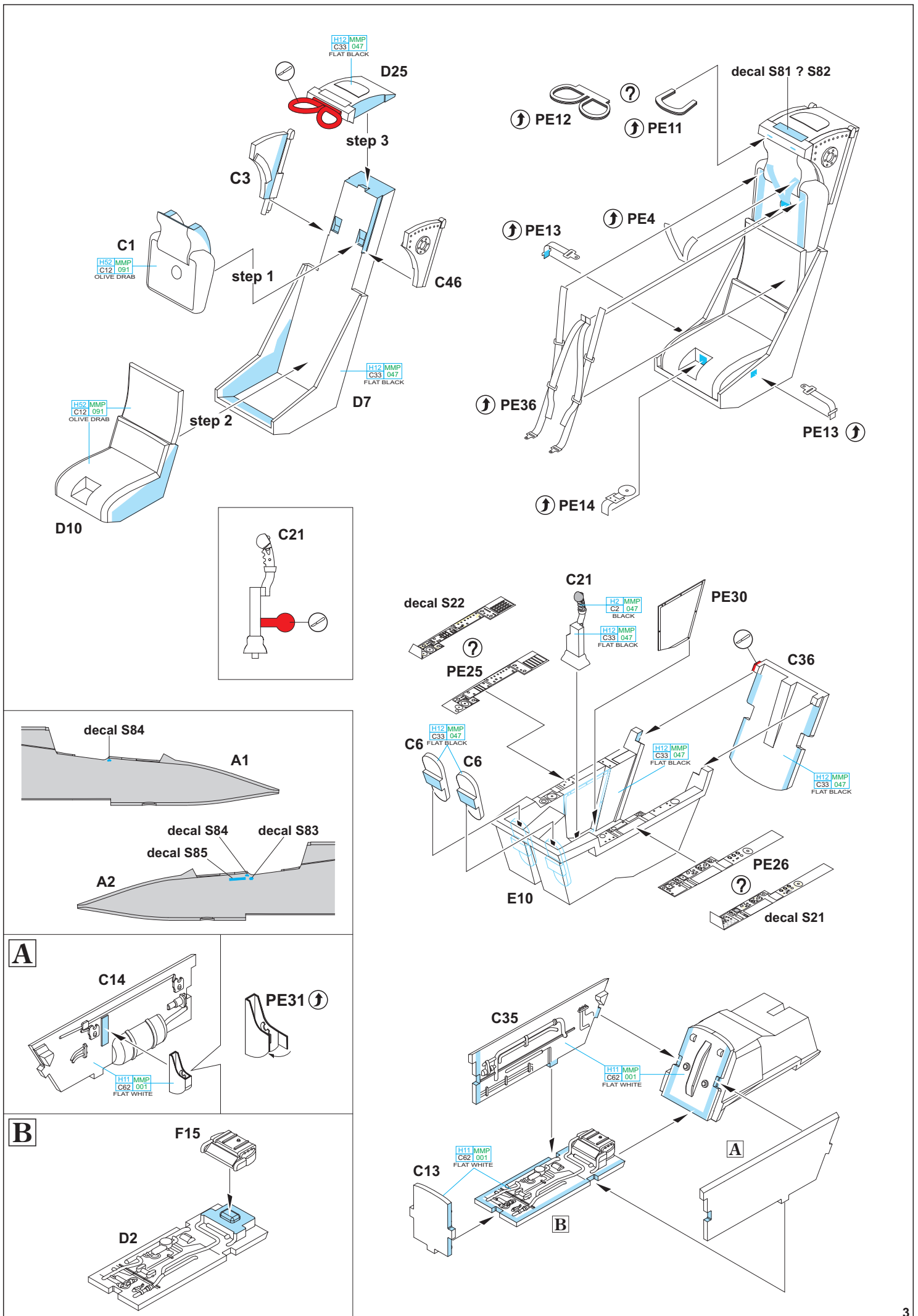

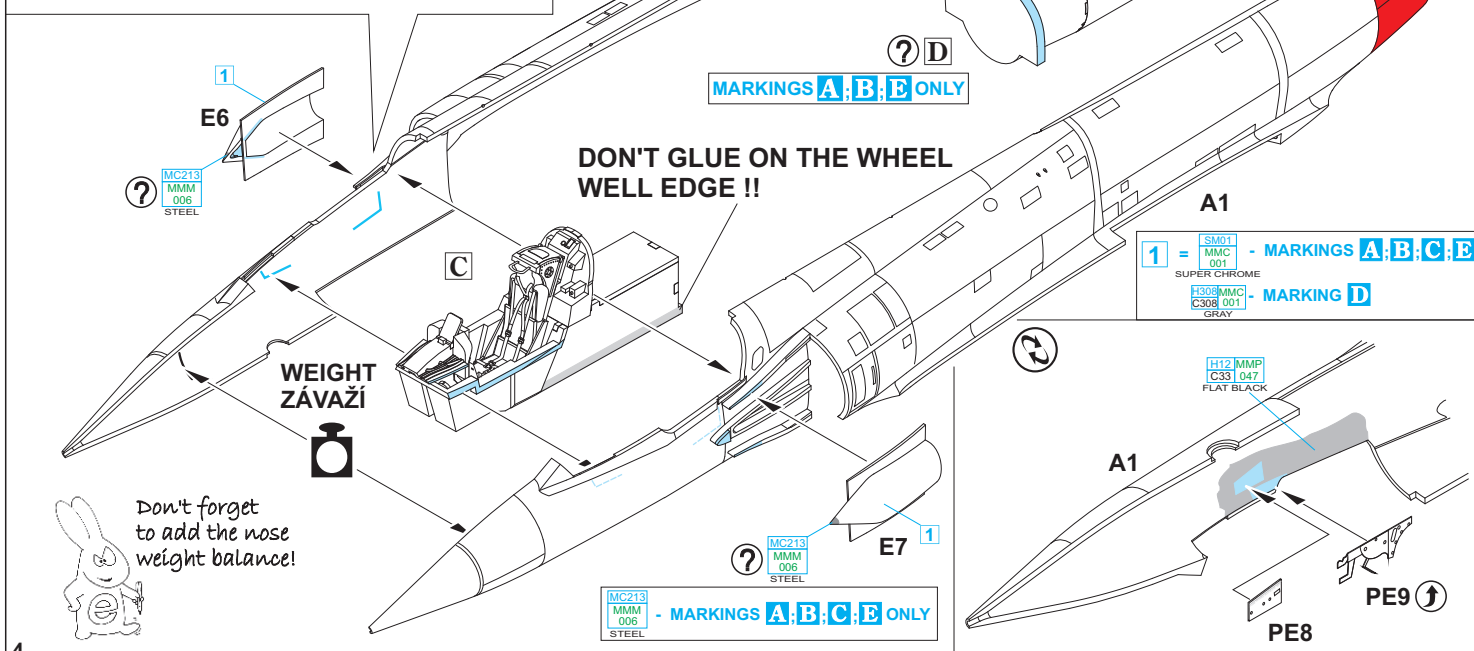
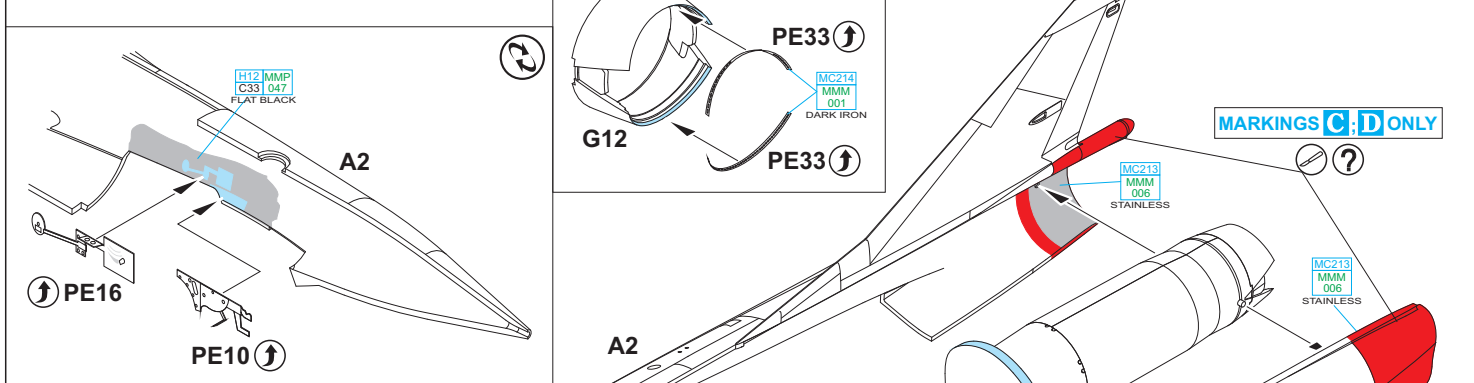
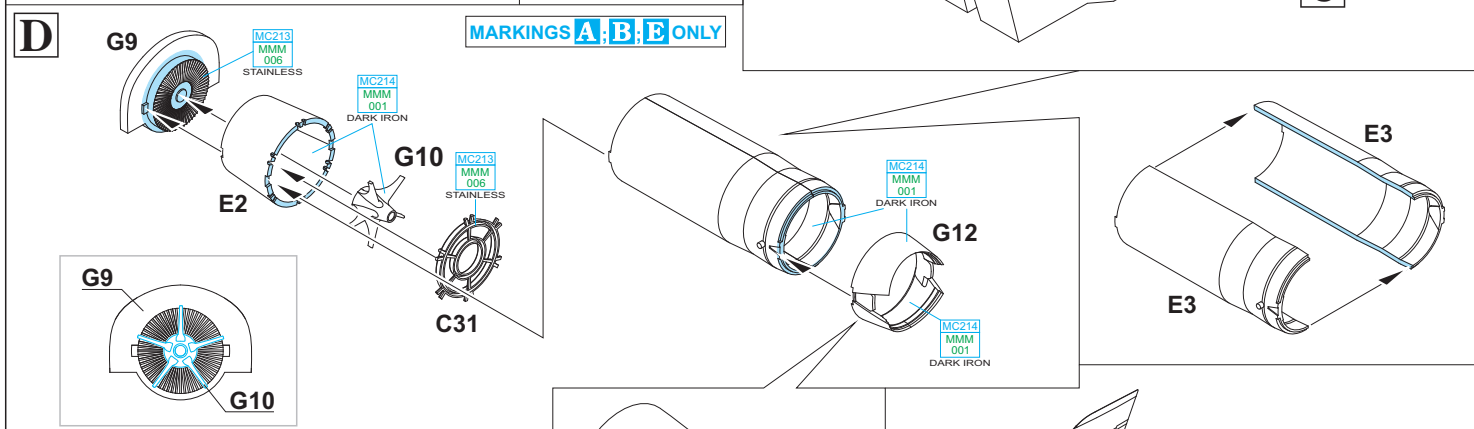
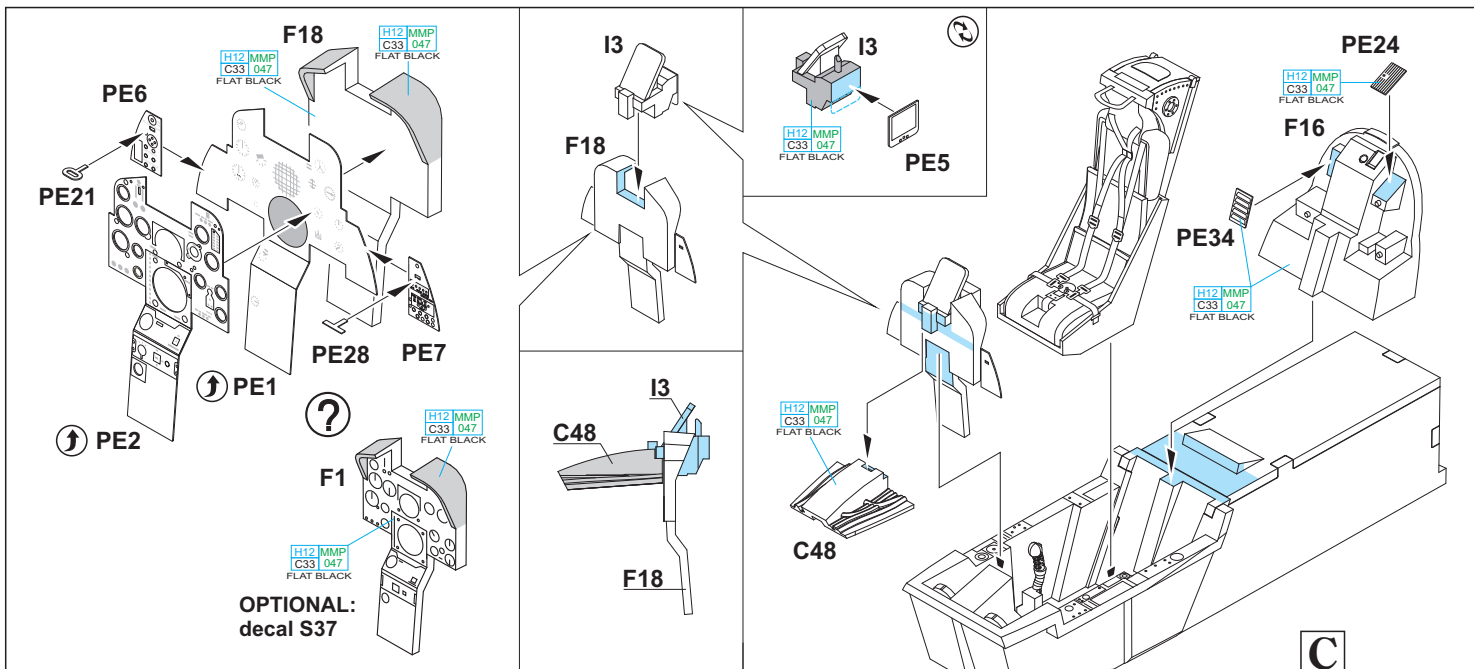

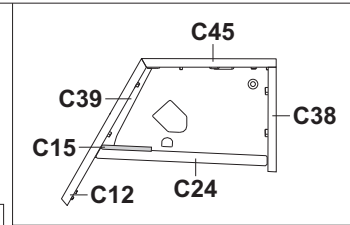
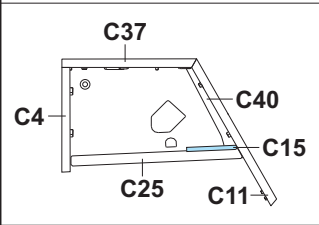
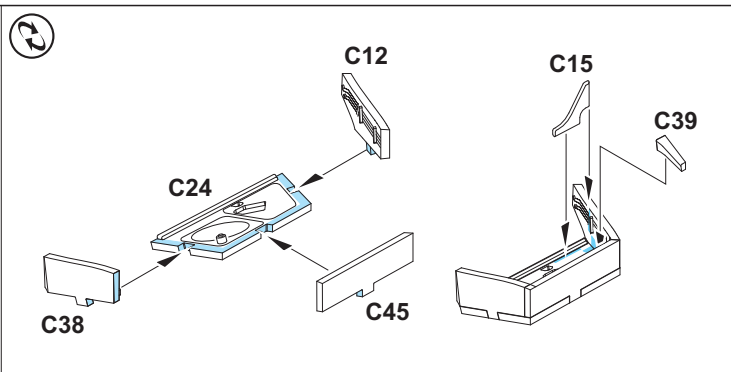
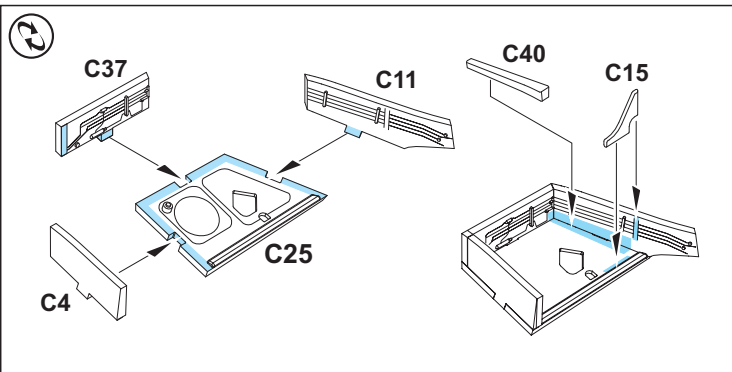

FOR EXTERNAL FUEL TANKS
RACKS D6 OR D11
SEE PAGE 13

MARKINGS B, E ONLY
FOR MATRA 530
RACK D26
SEE PAGE 13

FOR EXTERNAL FUEL TANKS
RACKS D6 OR D11
SEE PAGE 13

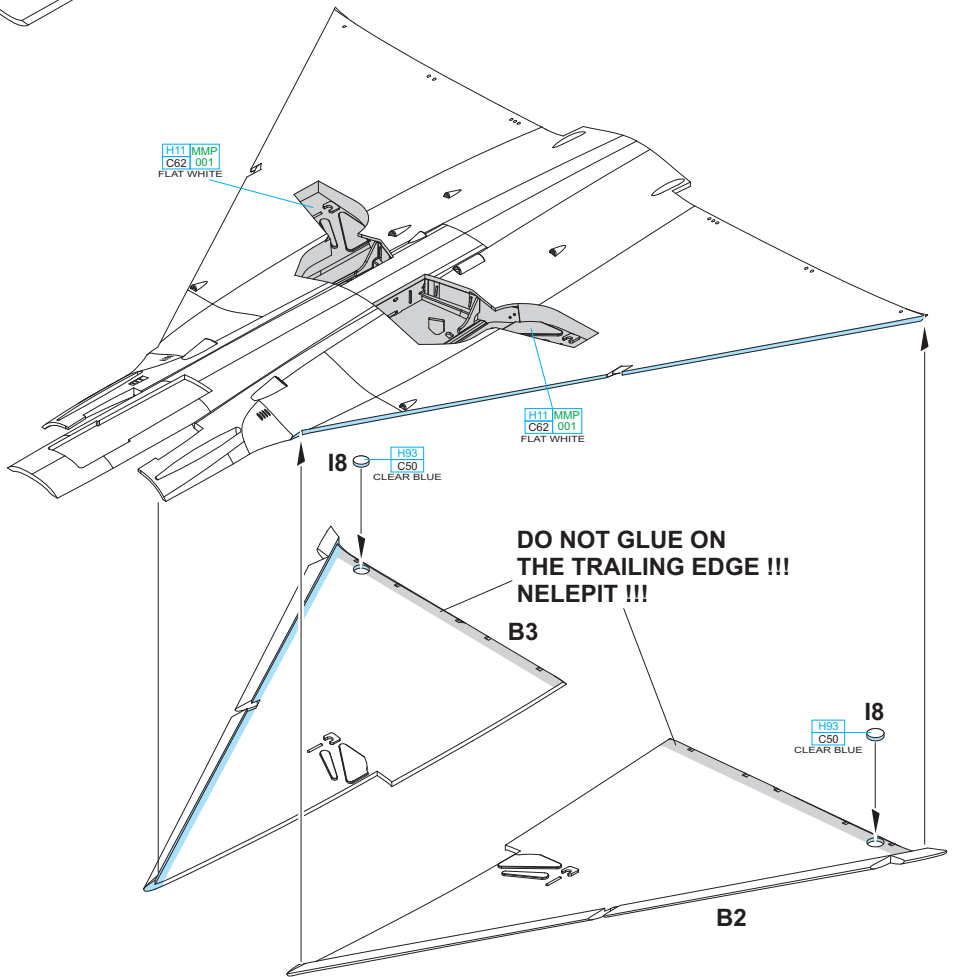
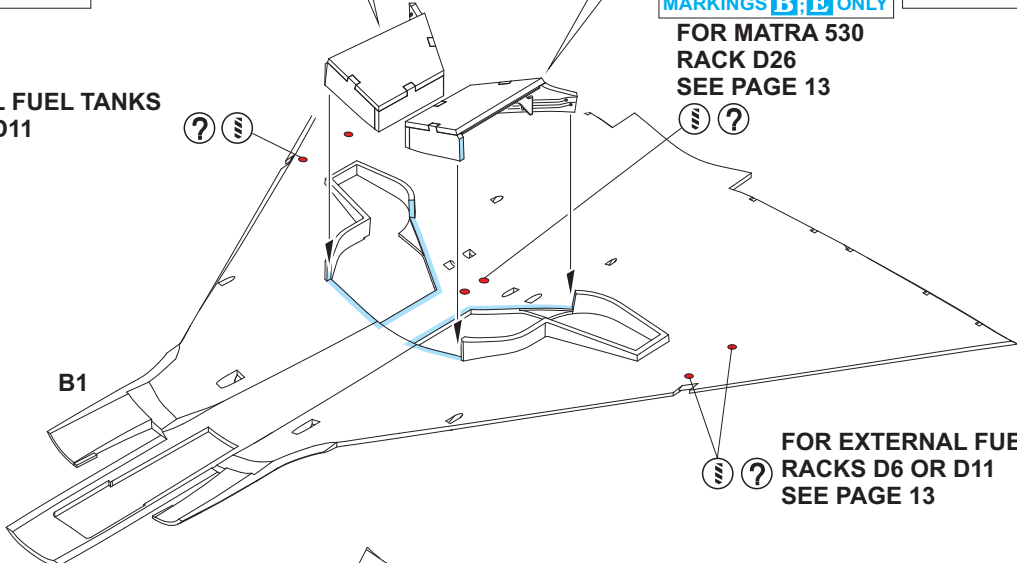

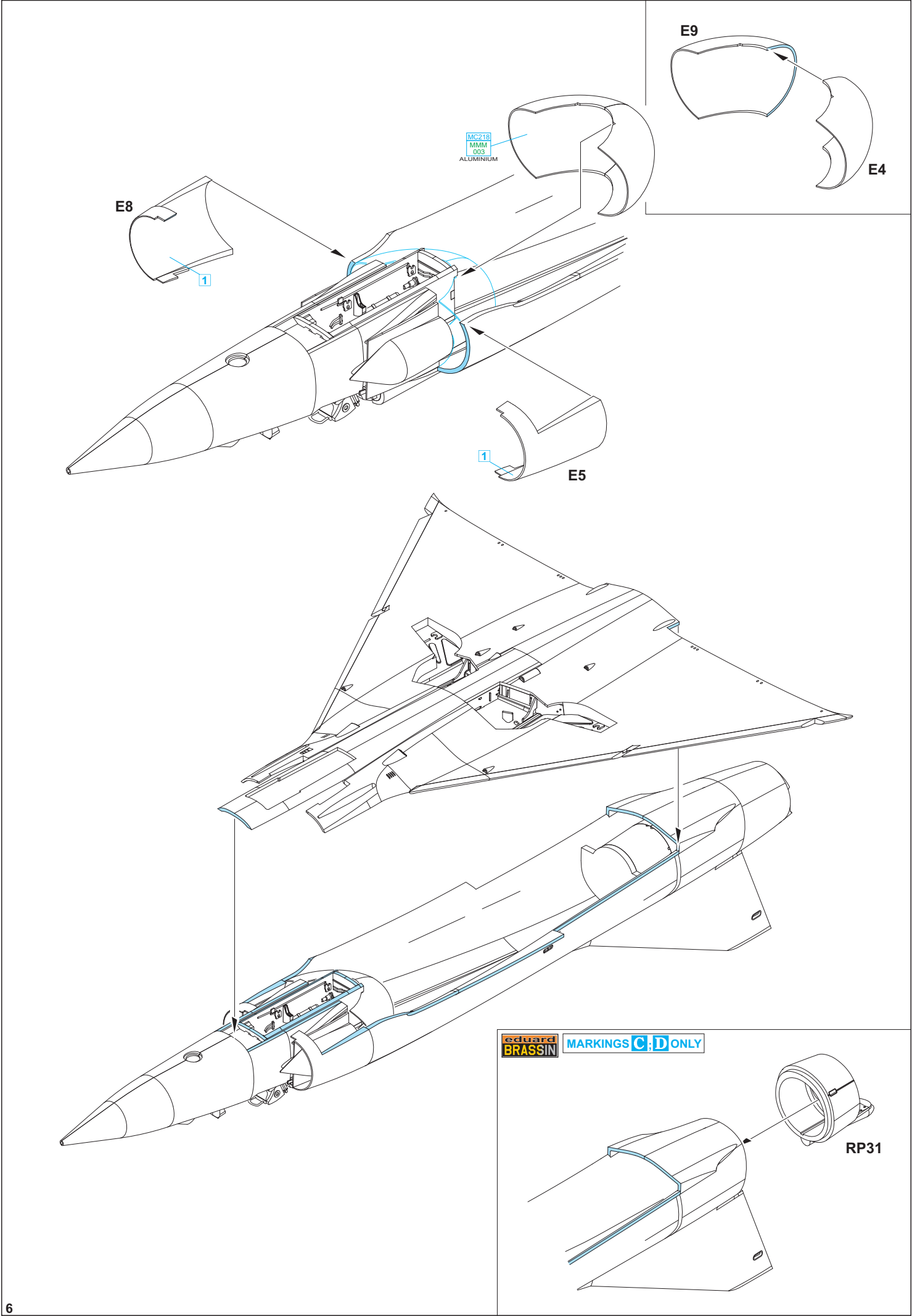

USE D5 FOR AIM-9D SIDEWINDER (PART G2)
SEE PAGE 13

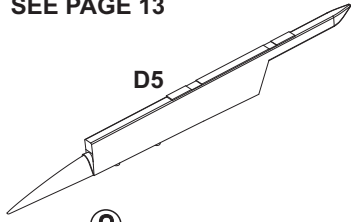

?

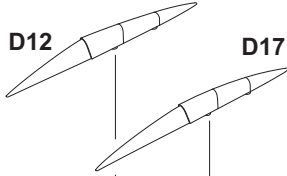

USE D5 FOR AIM-9D SIDEWINDER (PART G2)
SEE PAGE 13

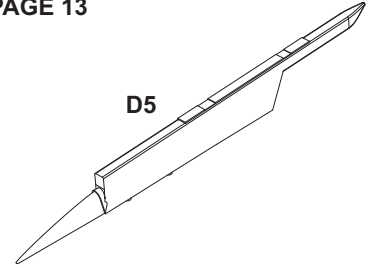

?

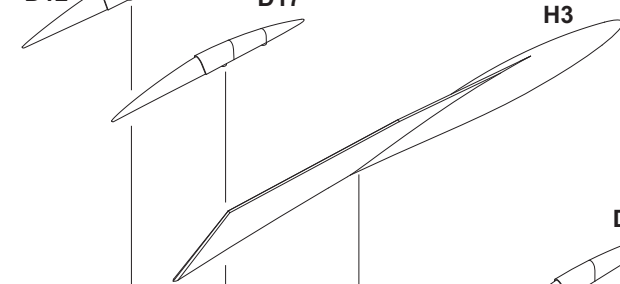

D17

D12

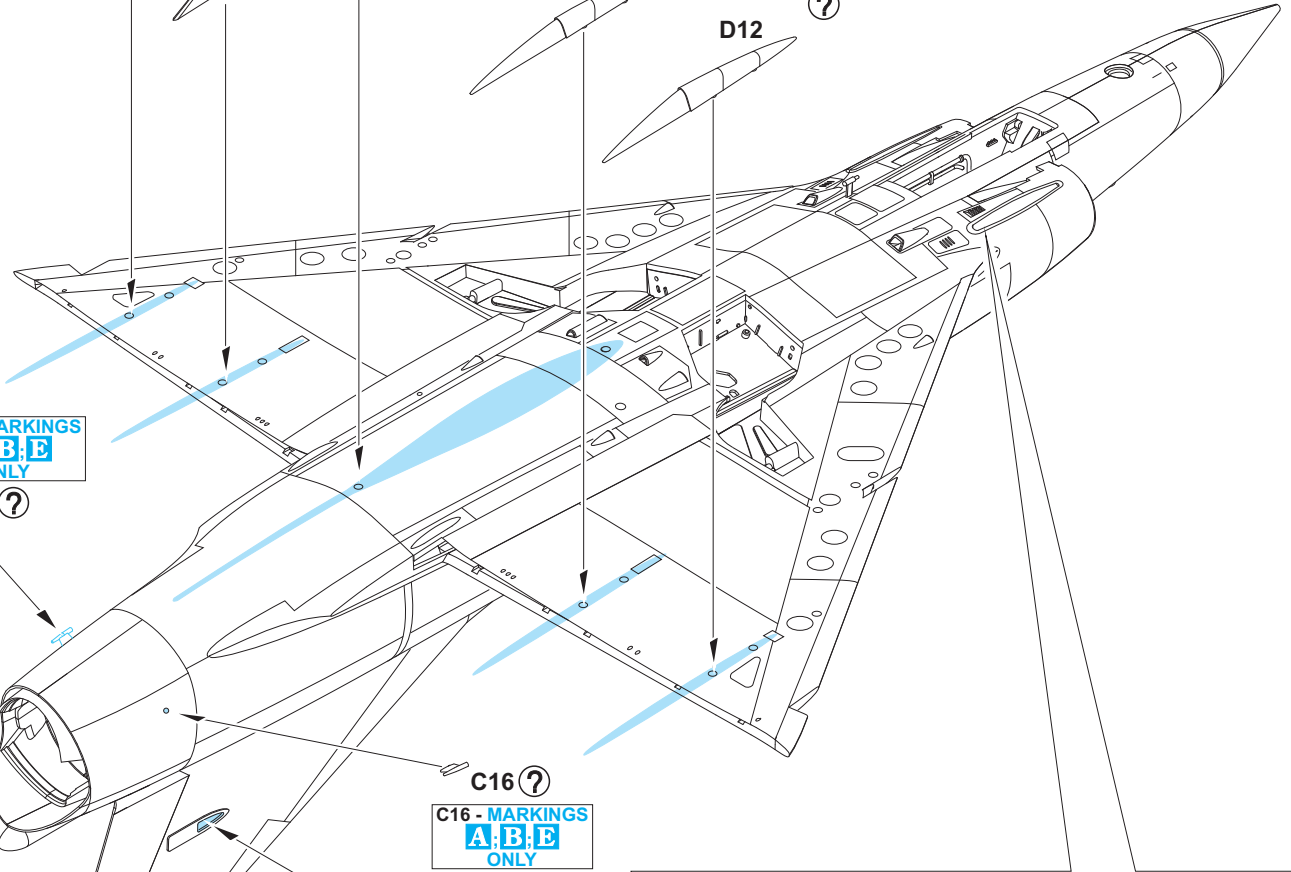

C16 - MARKINGS
A, B, E
ONLY

C16 ?

C16 ?

C16 - MARKINGS
A, B, E
ONLY

C32

CLEAR FIX ? I9

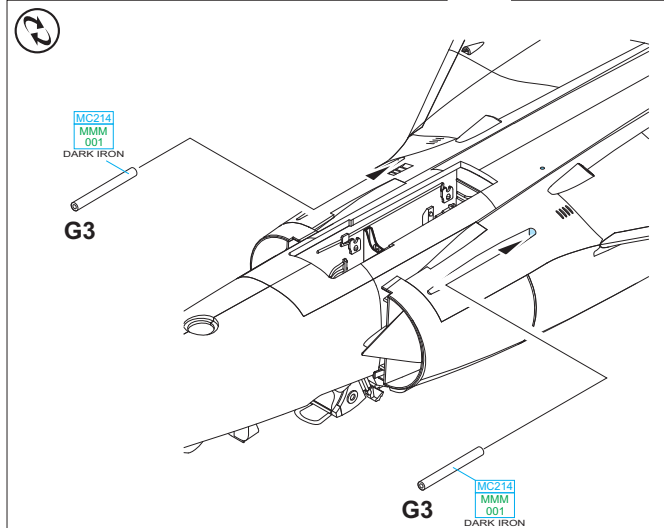
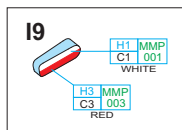

MC214
MMM
001
DARK IRON

G3

MC214
MMM
001
DARK IRON

G3

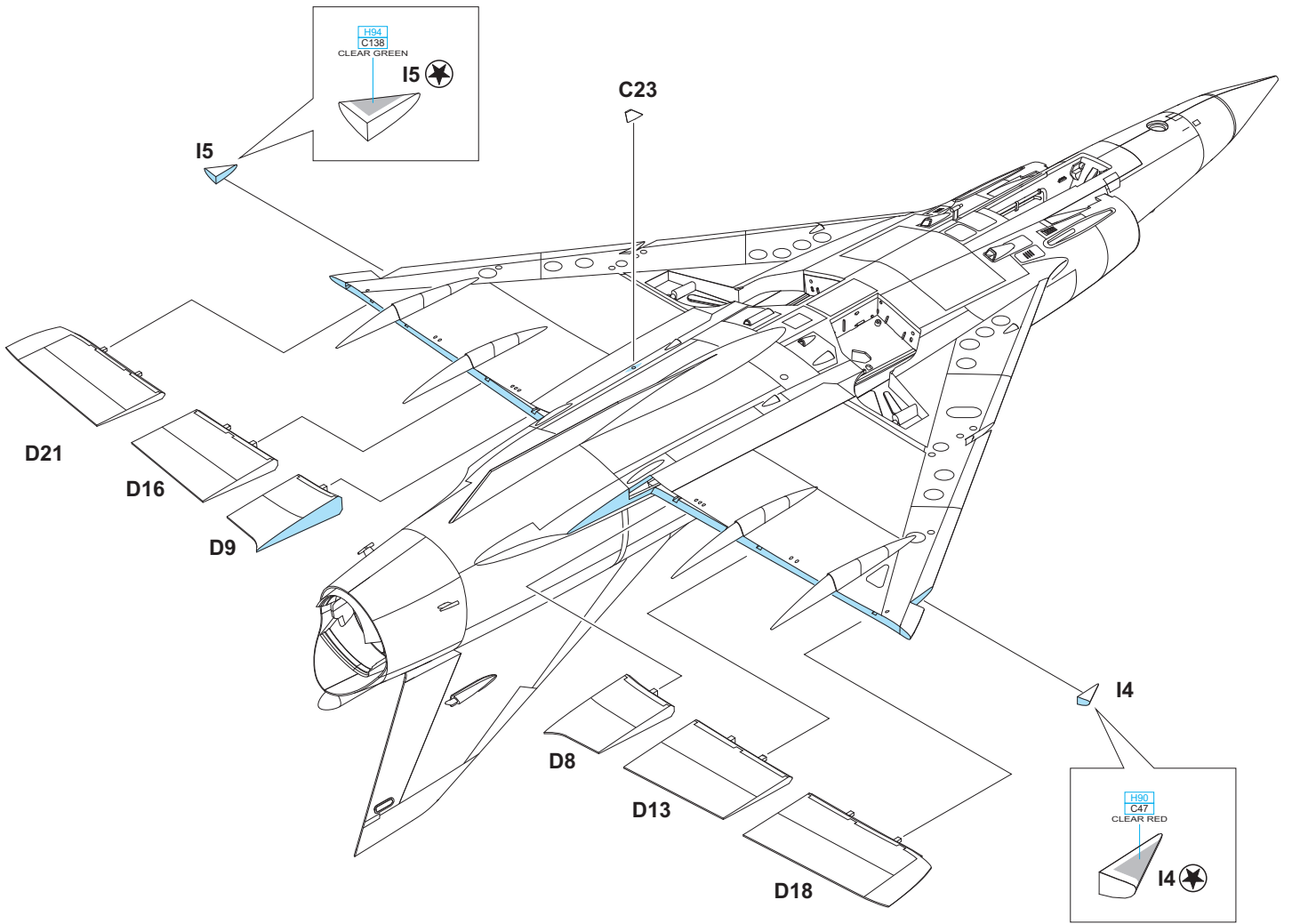

eduard
BRASSIN MARKINGS C; D ONLY

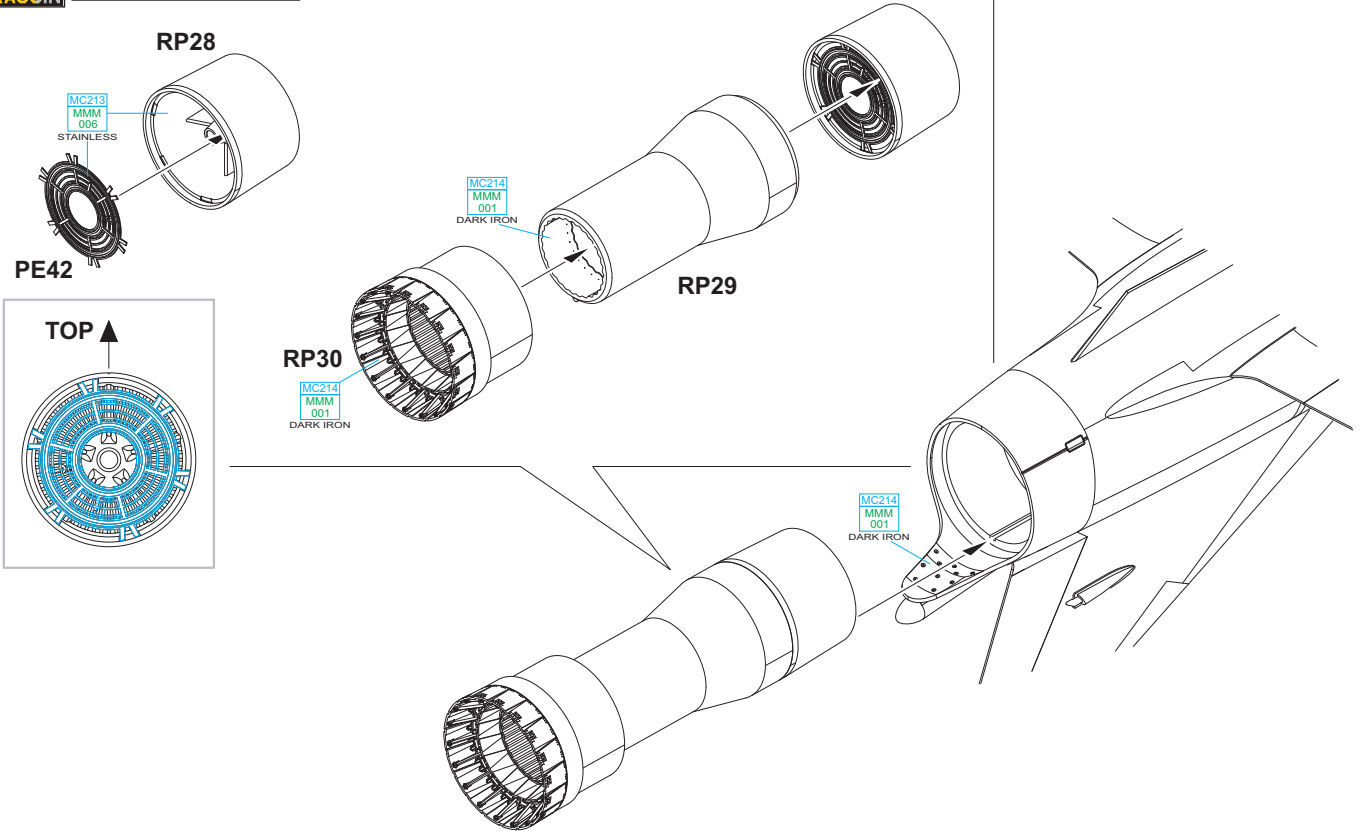

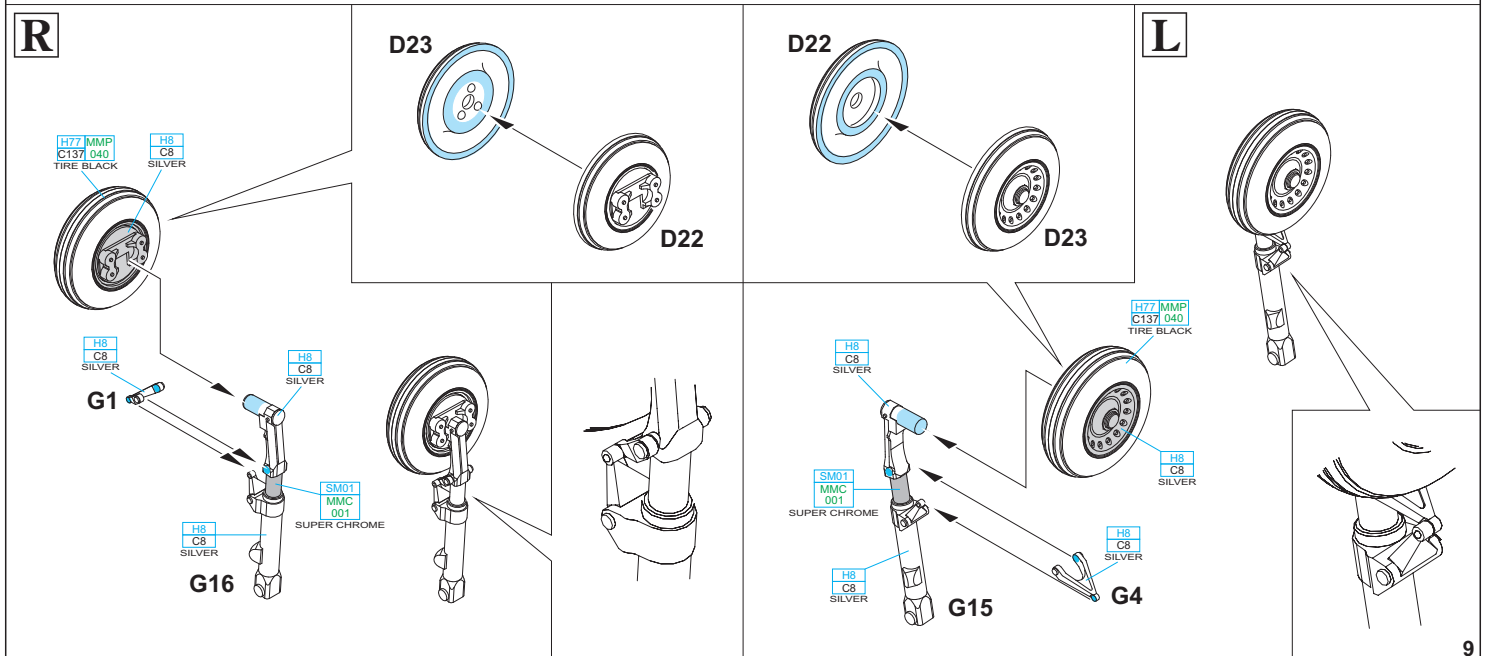
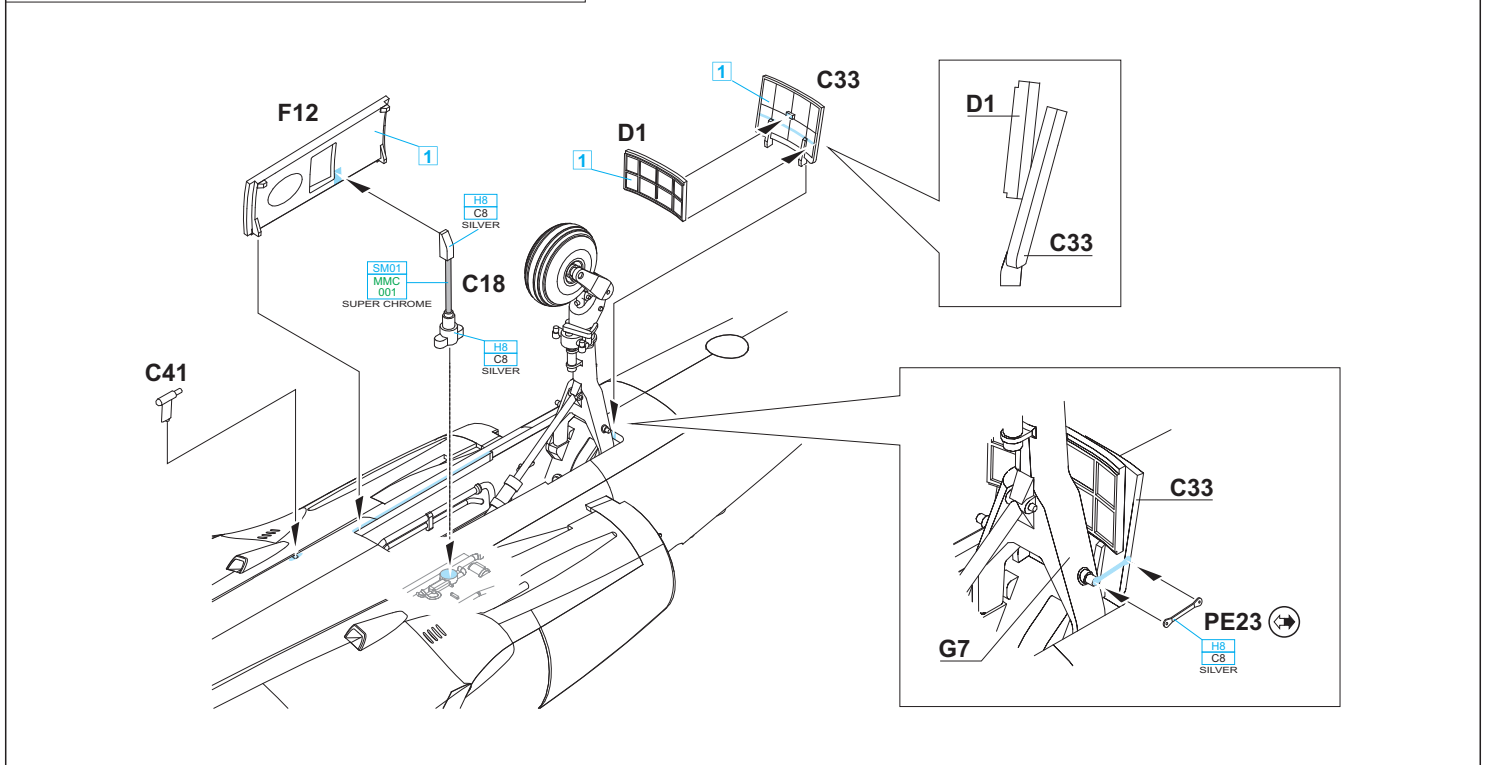
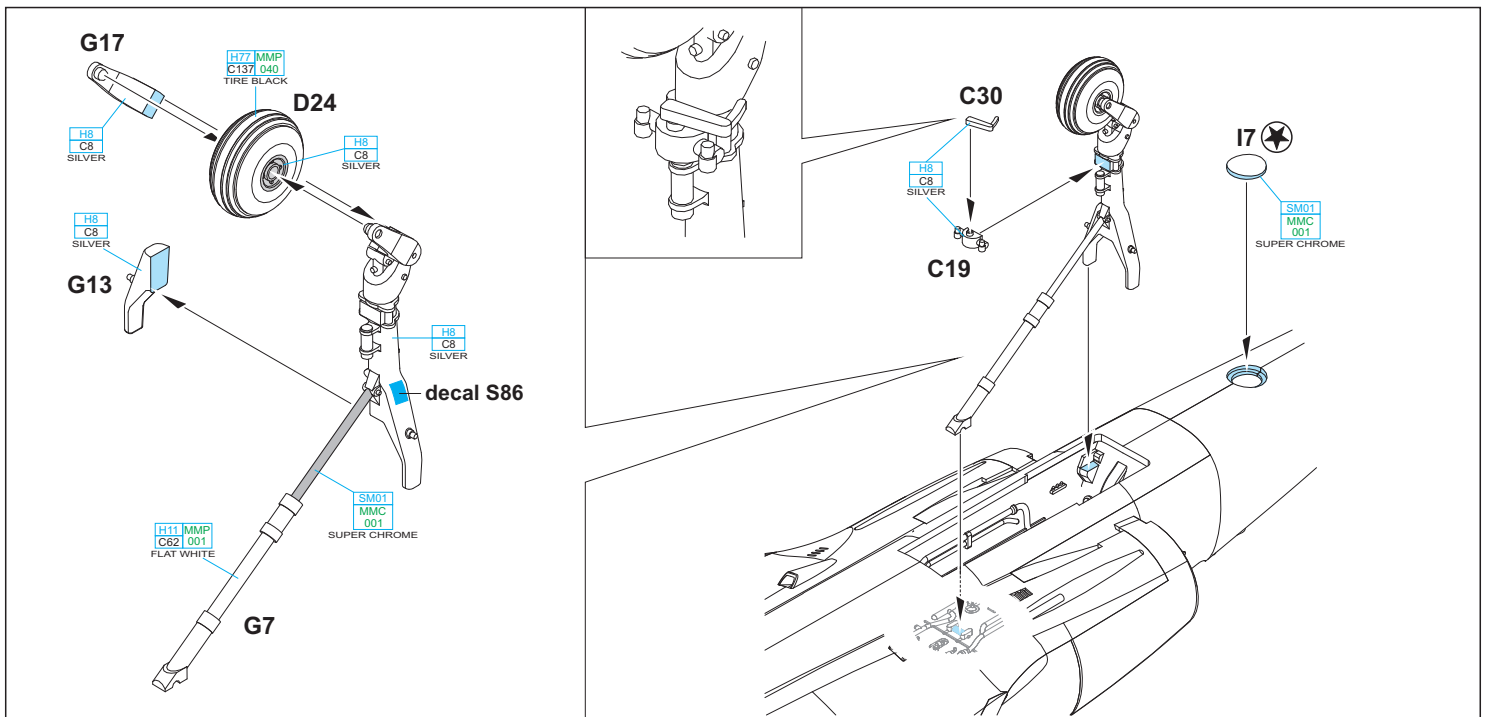

PE38 ? PE38 - MARKING C ONLY

CLOSED E

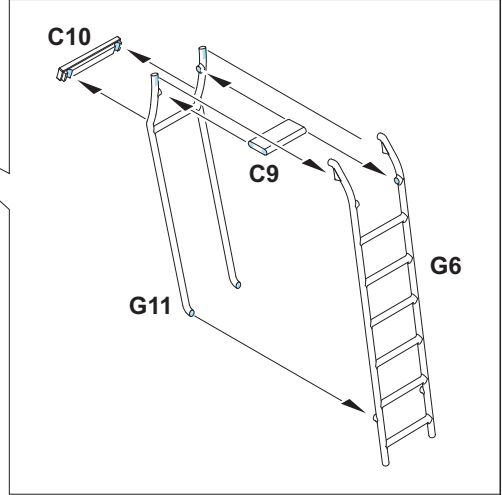
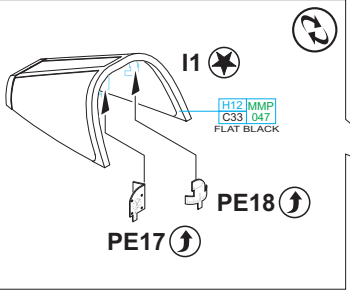
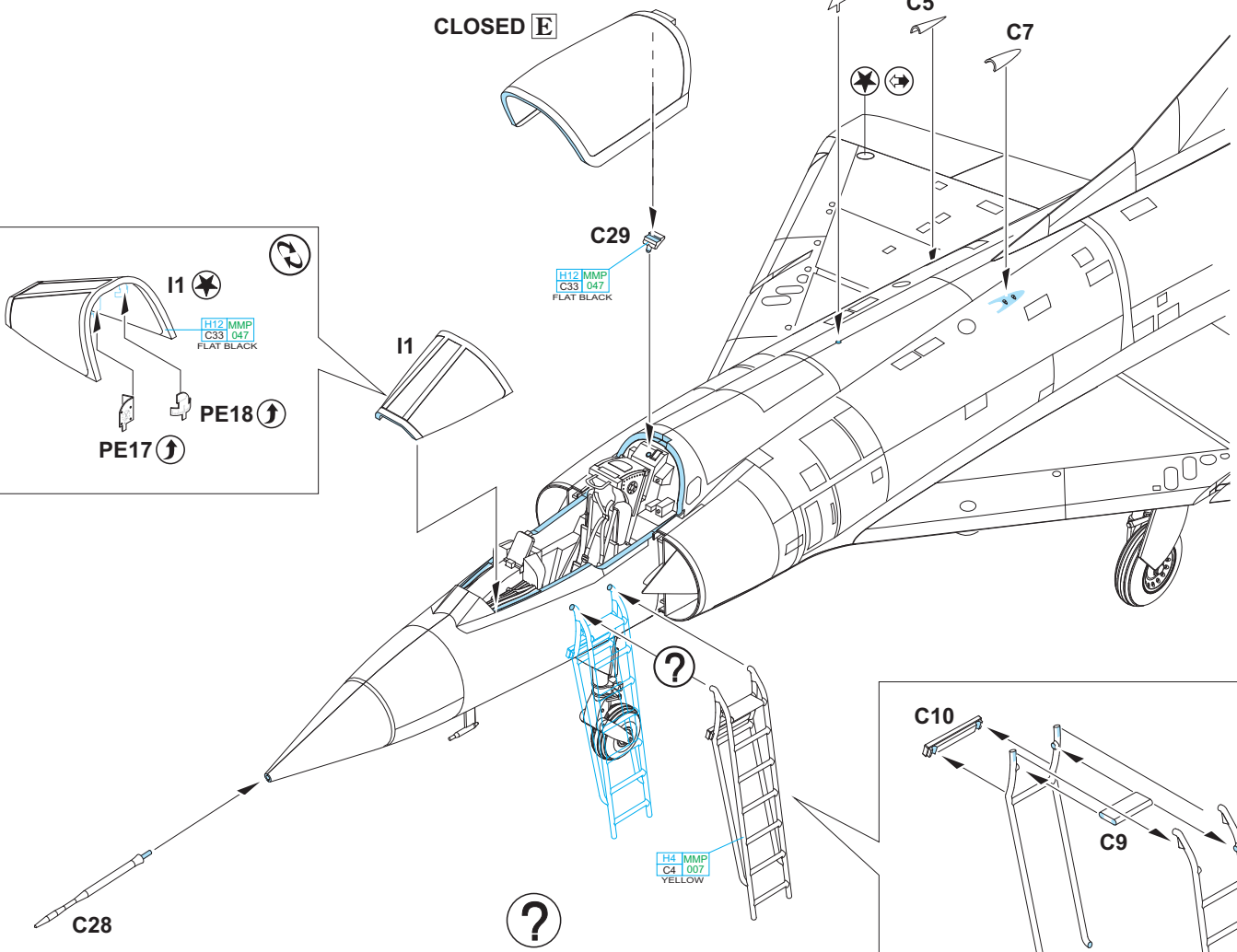

?

OPEN E

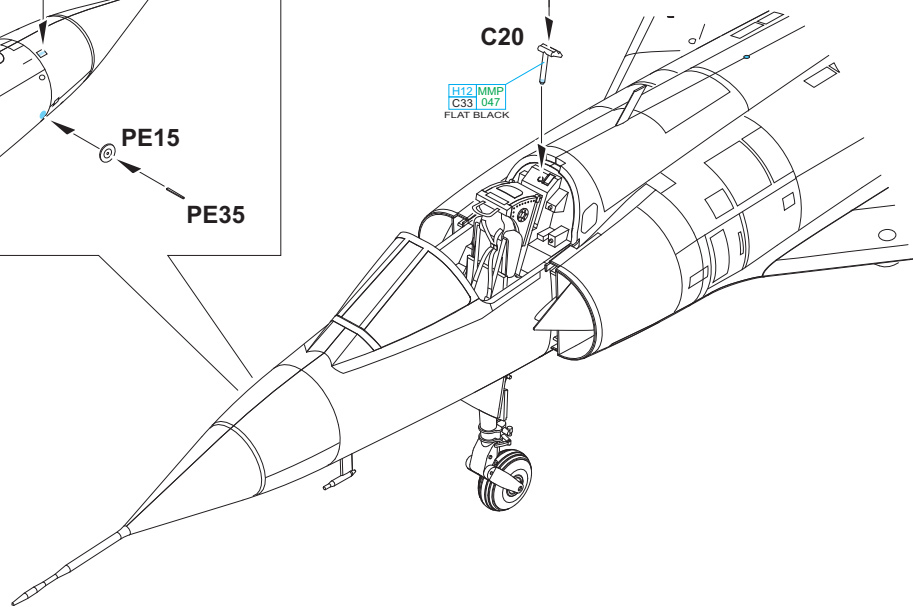
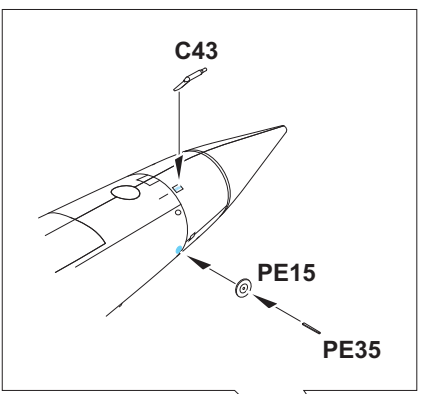

F EXTERNAL FUEL TANK- 625I
2 pcs.

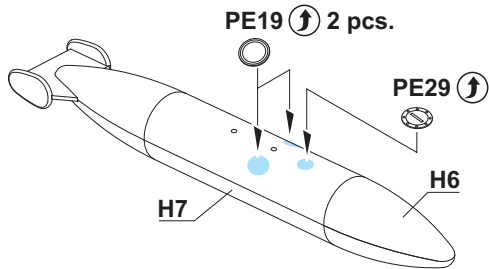
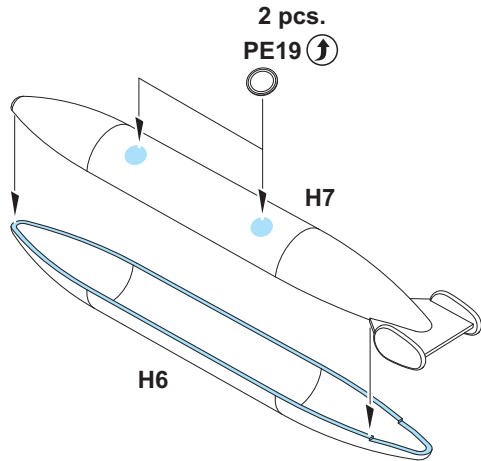

G EXTERNAL FUEL TANK- 500I
2 pcs.

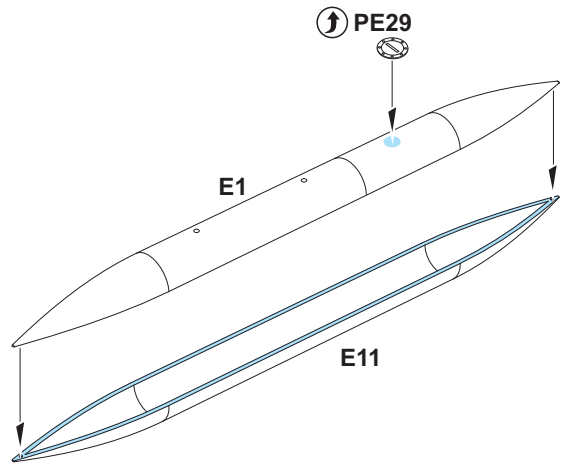

DO NOT GLUE!

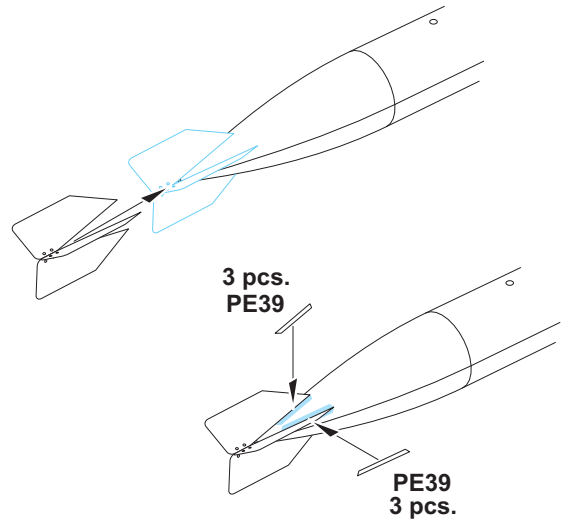
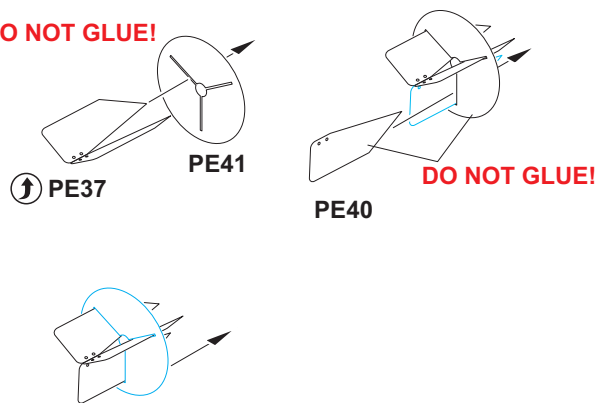

H MATRA 530C,K

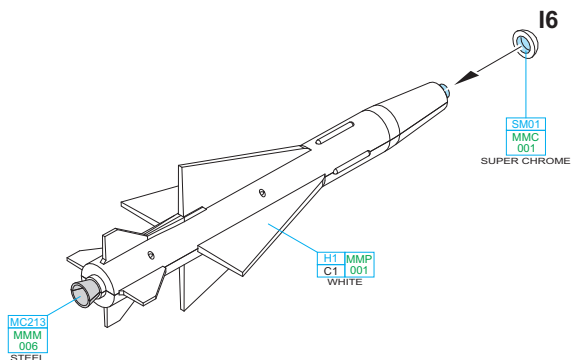
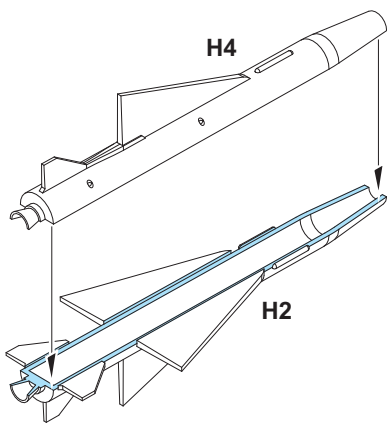

I AIM- 9D SIDEWINDER
2 pcs.

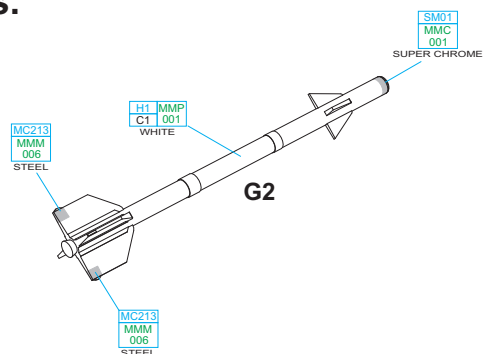

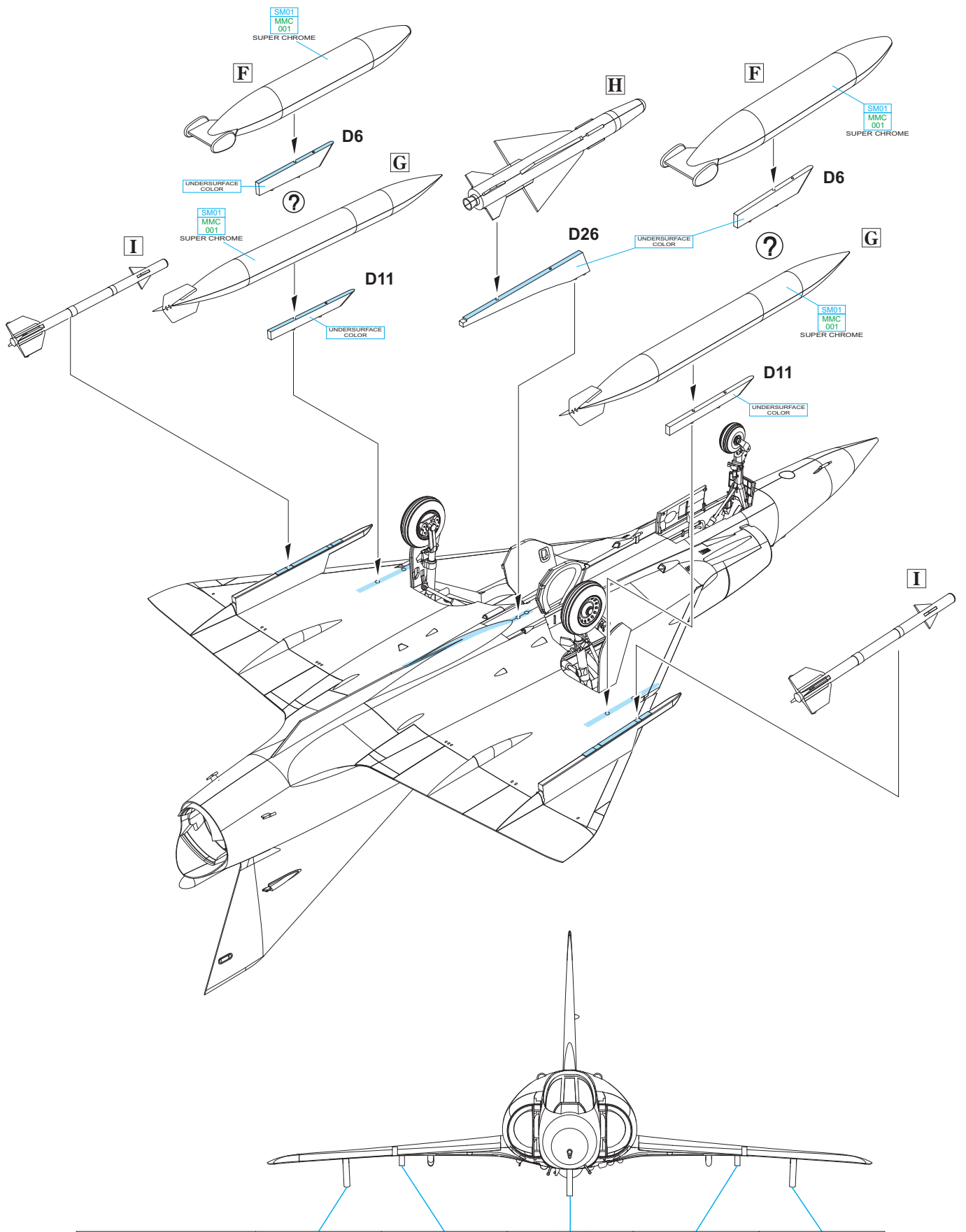

| | | | | | |
|--------------------------|---|---|---|---|---|
| MATRA 530C, K | | | ⊗ | | |
| FUEL TANK 5001 | | ○ | | ○ | |
| FUEL TANK 625I | | ⊖ | | ⊖ | |
| AIM-9D SIDEWINDER | ⊗ | | | | ⊗ |

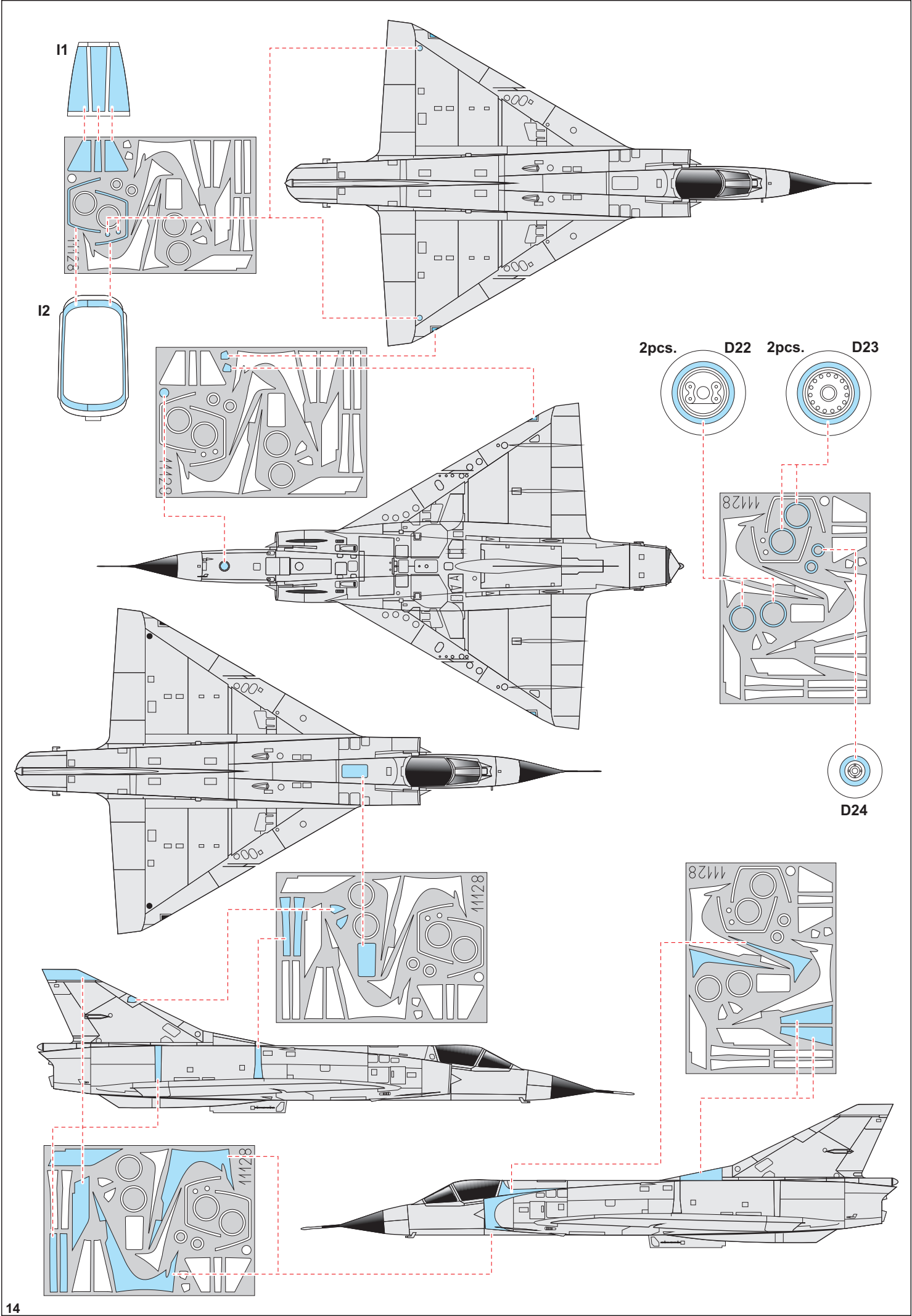

A No. 177, 117 Tayeset, Ramat David Air Base, Israel, 1977

Camouflaged Shachak nr. 177 from 117 Tayeset based at Ramat David as it appeared in 1977. Gaudy black-yellow triangles were introduced during the Yom Kippur War. Of interest are five kill markings of the Syrian aircraft painted under the canopy (three stars in the white ring). Actually, the Israeli pilots at the controls of this airplane shot down 5 Egyptian aircraft and one Syrian aircraft. Egyptian aircraft kill was marked with two stars in the white ring. Reason for swapping the symbols remains unknown.

ČESKOU VERZI TEXTU NALEZNETE NA
www.eduard.cz
 POD KATALOGOVÝM ČÍSLEM 11128

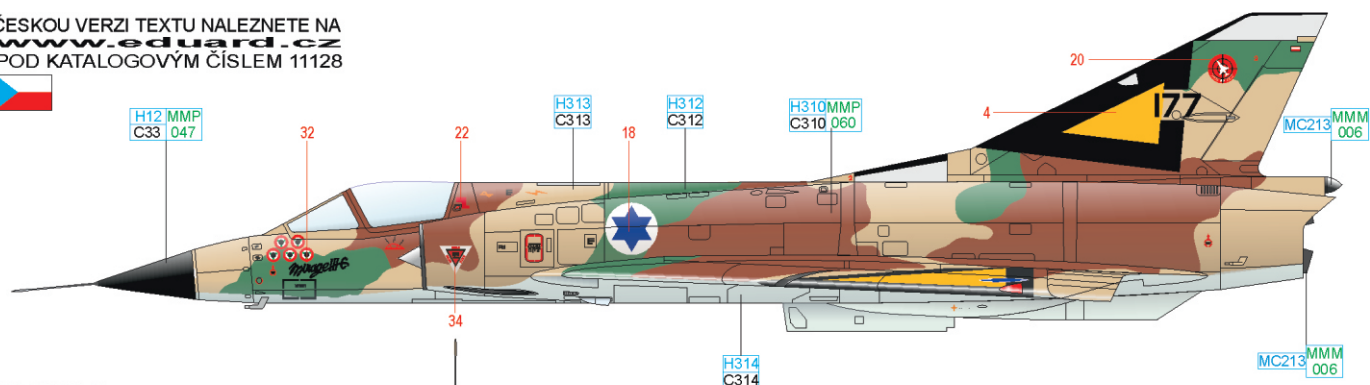

STENCILS:

- S1, S2, S3, S4, S5, S8, S9, S15, S18,
- S19, S20, S23, S24, S29, S30, S31, S33,
- S34, S35, S36, S38, S39, S40, S41, S42,
- S43, S46, S47, S48, S49, S50, S51, S52,
- S53, S54, S55, S56, S61, S62, S63, S64,
- S65, S66, S67, S68, S69, S71, S72, S77

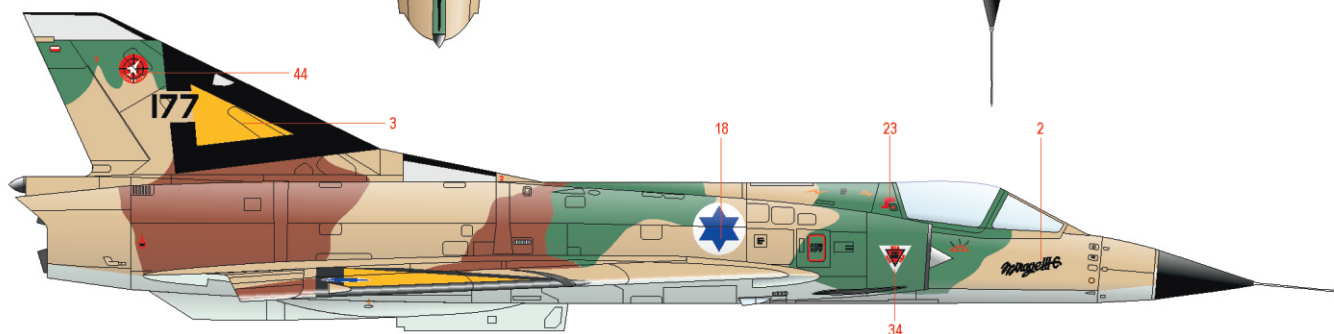
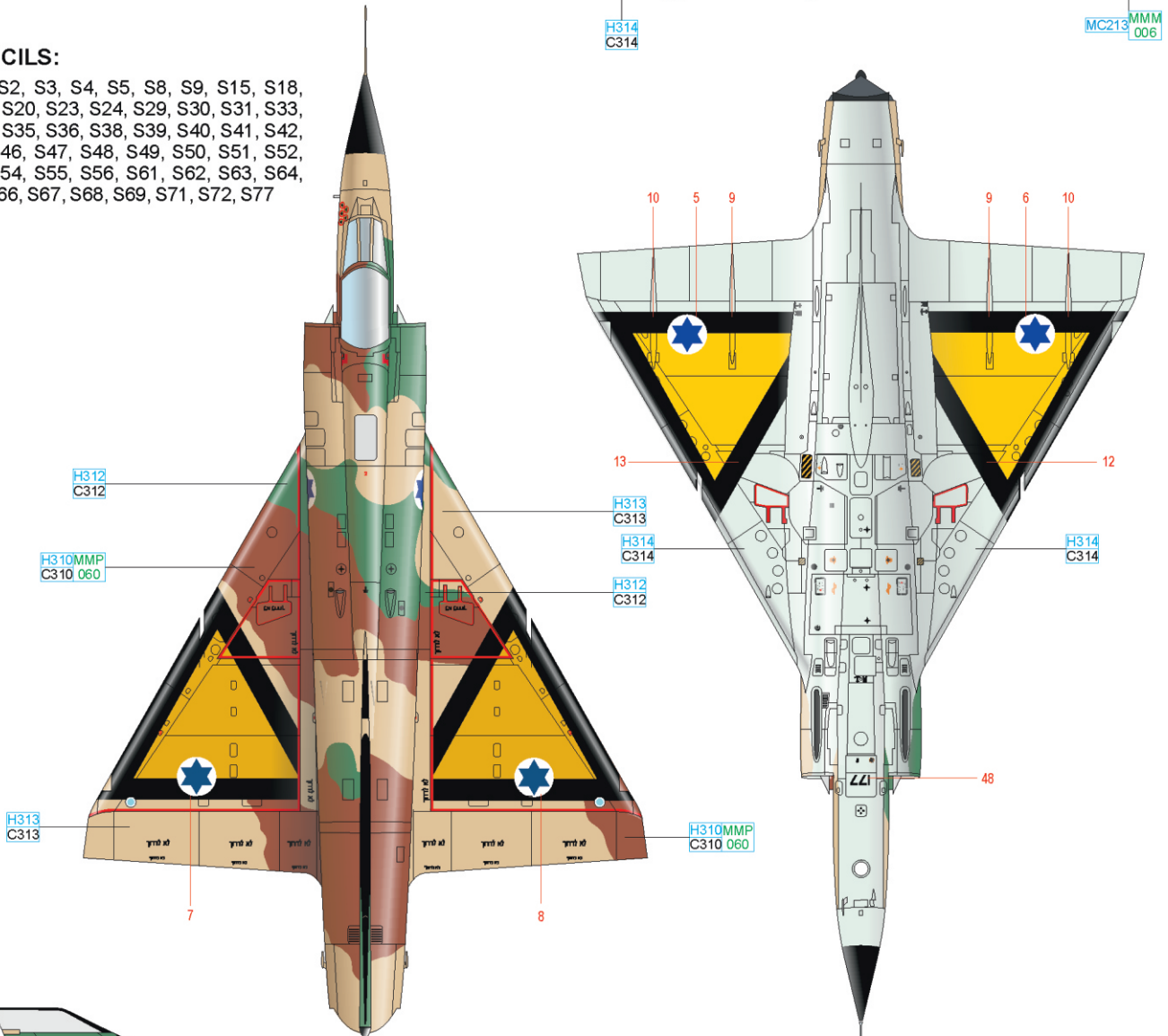

| | | | |
|-------|---------------------|--------------|-------------------------------|
| BLACK | H12 MMP C33 047 | STEEL | MC213 MMM 006 |
| BROWN | H310MMP C310 060 | GREEN | H312 C312 |
| | YELLOW | H313 C313 | LIGHT BLUE H314 C314 |

B No. 70, 117 Tayeset, Ramat David Air Base, Israel, June 1967

Shachak nr. 70 from 117 Tayeset from Ramat David airbase as it flew right after the Six Days War. At its controls the Israeli pilots claimed four aerial kills in total. Two Syrian MiG-21s during the Six Days War followed by the couple of Egyptian MiG-21s during the War of Attrition. The aircraft was shot down on March 2nd, 1970, and its pilot Ithamar Neuner ejected. Israeli sources state the ground fire as the cause of the aircraft loss, according to Egyptian sources the aircraft was shot down by Lt. Ali Wagedy in MiG-21.

ČESKOU VERZI TEXTU NALEZNETE NA
www.eduard.cz
 POD KATALOGOVÝM ČÍSLEM 11128



H12 MMP
C33 047

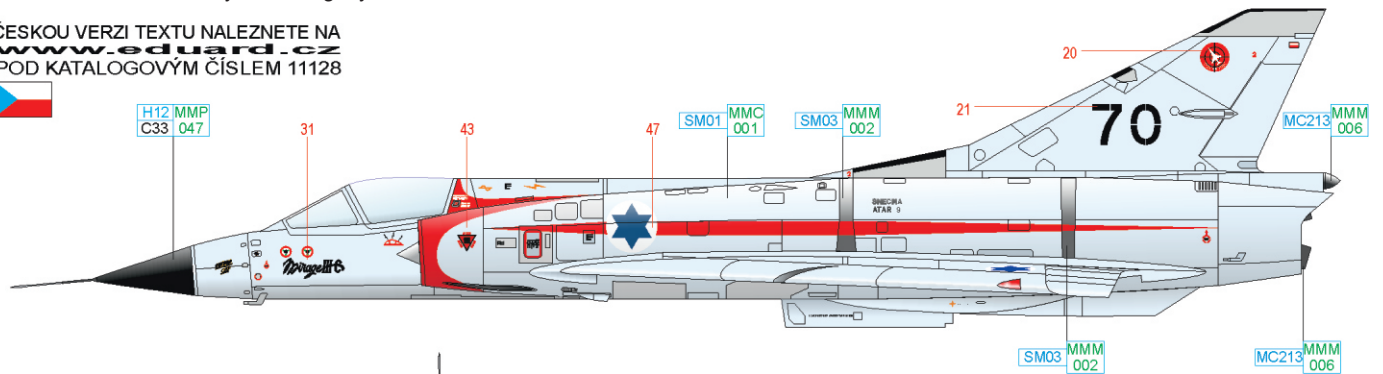

STENCILS:

S1, S2, S4, S5, S6, S7, S10, S11, S12,
 S13, S14, S15, S16, S17, S18, S23, S24,
 S25, S26, S27, S28, S29, S30, S31, S32,
 S33, S34, S35, S36, S38, S39, S42, S43,
 S46, S47, S49, S50, S51, S52, S53, S54,
 S55, S56, S57, S58, S59, S61, S62, S63,
 S64, S65, S66, S67, S68, S70, S71, S72,
 S73, S75, S76, S78

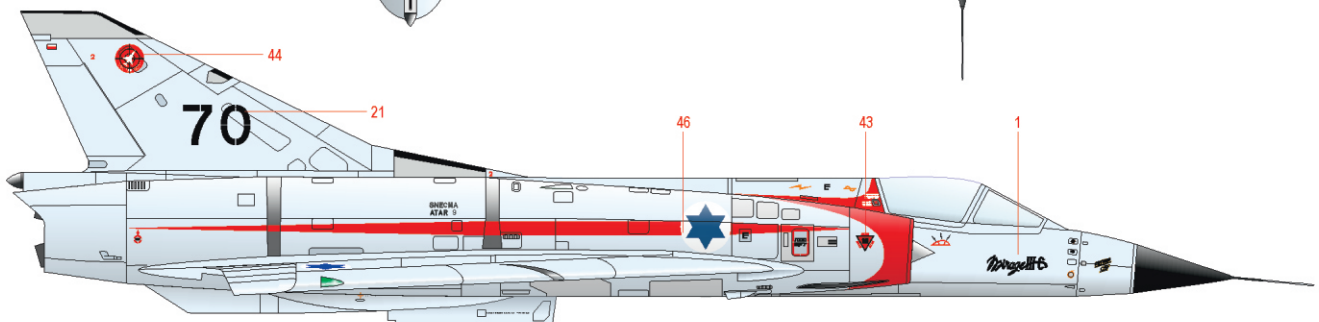
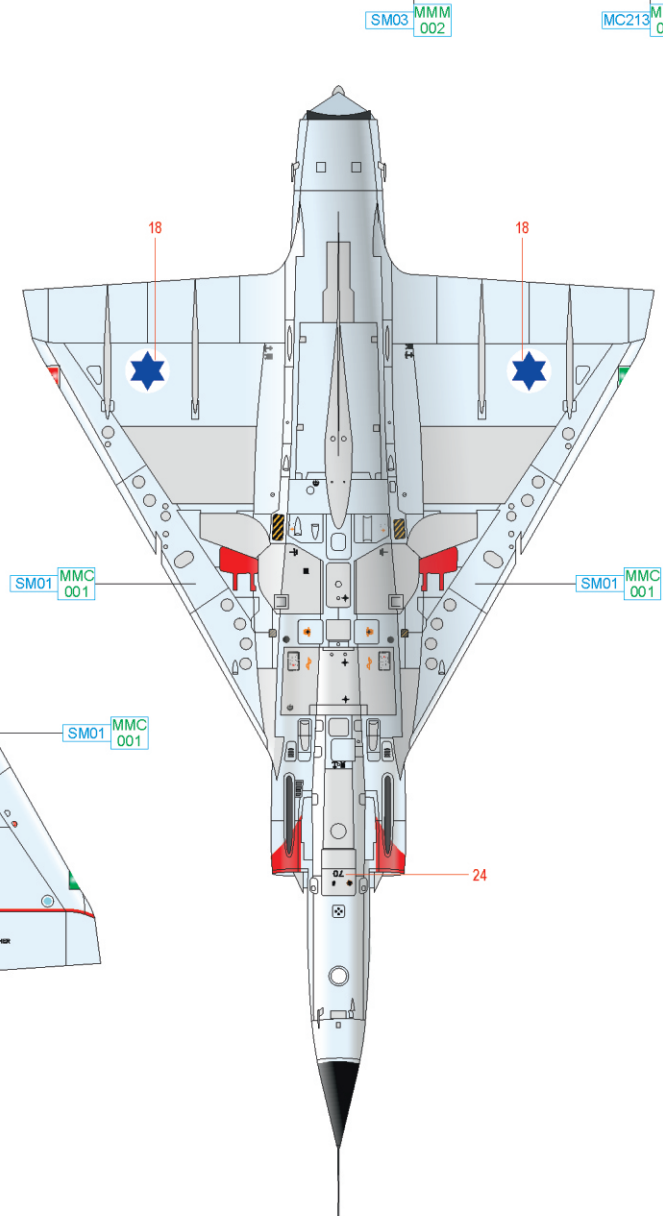
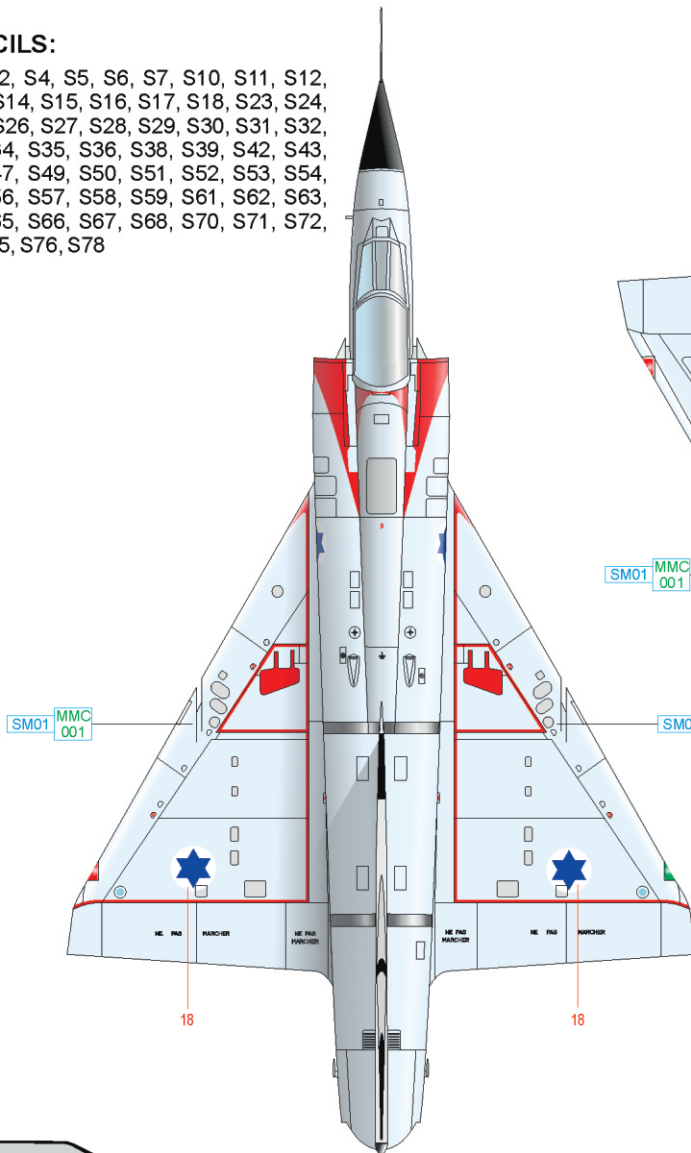

SUPER CHROME SM01 MMC 001 SUPER IRON SM03 MMM 002 STEEL MC213 MMM 006 BLACK H12 MMP C33 047

C No. 778, 101 Tayeset, Hatzor Air Base, Israel, 1972

Shachak nr. 778 in the colors of 101 Tayeset as it appeared at the end of 1972 when it was already credited with 8.5 kills instead of 8 painted under the canopy. It's the first airframe converted to the Atar 9C engine. The total kill score of this aircraft is 10.5 (it's also the highest scoring aircraft in the Six Days War). It was lost on October 10th, 1973 during the Yom Kippur War during the combat with the Syrian MiG-17s, its pilot Eitan Carmi ejected. The camouflaged aircraft were sprayed on the upper surfaces with sand FS 33531, brown FS 30219 and green FS 34227, the lower surfaces were light blue FS 35622.

ČESKOU VERZI TEXTU NALEZNETE NA
www.eduard.cz
 POD KATALOGOVÝM ČÍSLEM 11128

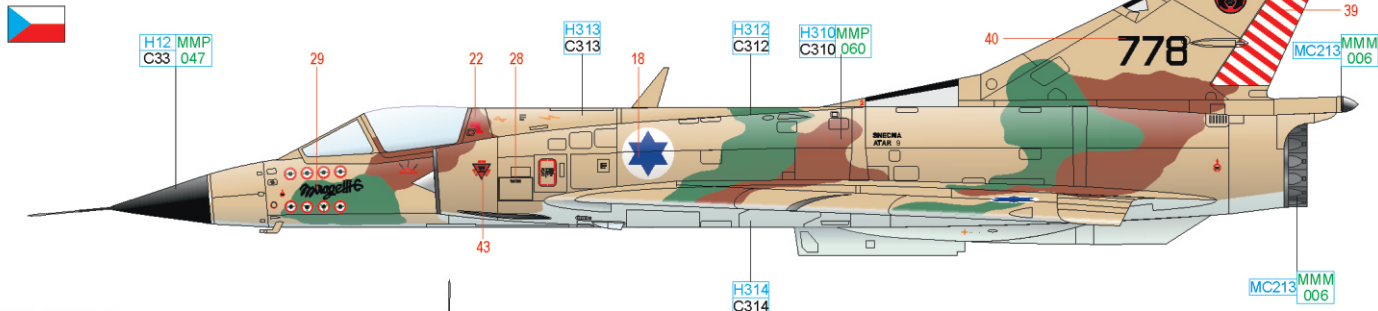

STENCILS:

S1, S2, S3, S4, S5, S8, S9, S10, S15,
 S18, S19, S20, S23, S24, S29, S30, S31,
 S33, S34, S35, S36, S38, S39, S40, S41,
 S42, S43, S46, S47, S48, S49, S50, S51,
 S52, S53, S54, S55, S56, S61, S62, S63,
 S64, S65, S66, S67, S68, S69, S71, S72,
 S77

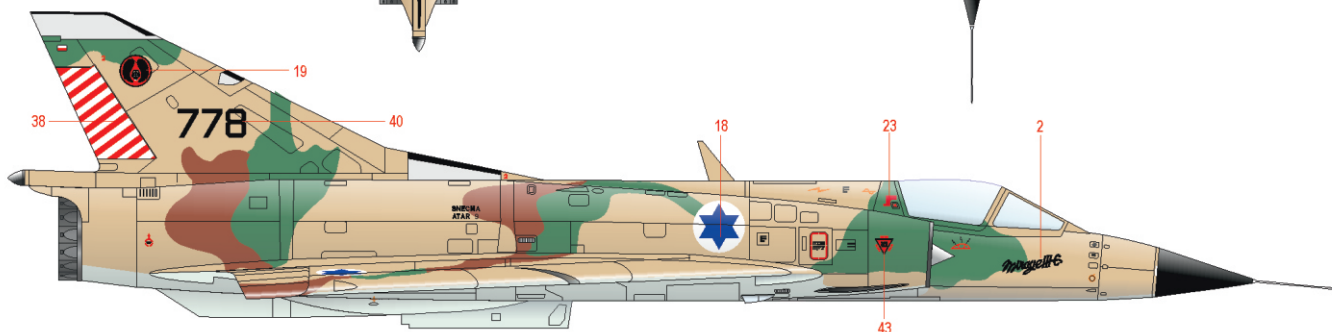
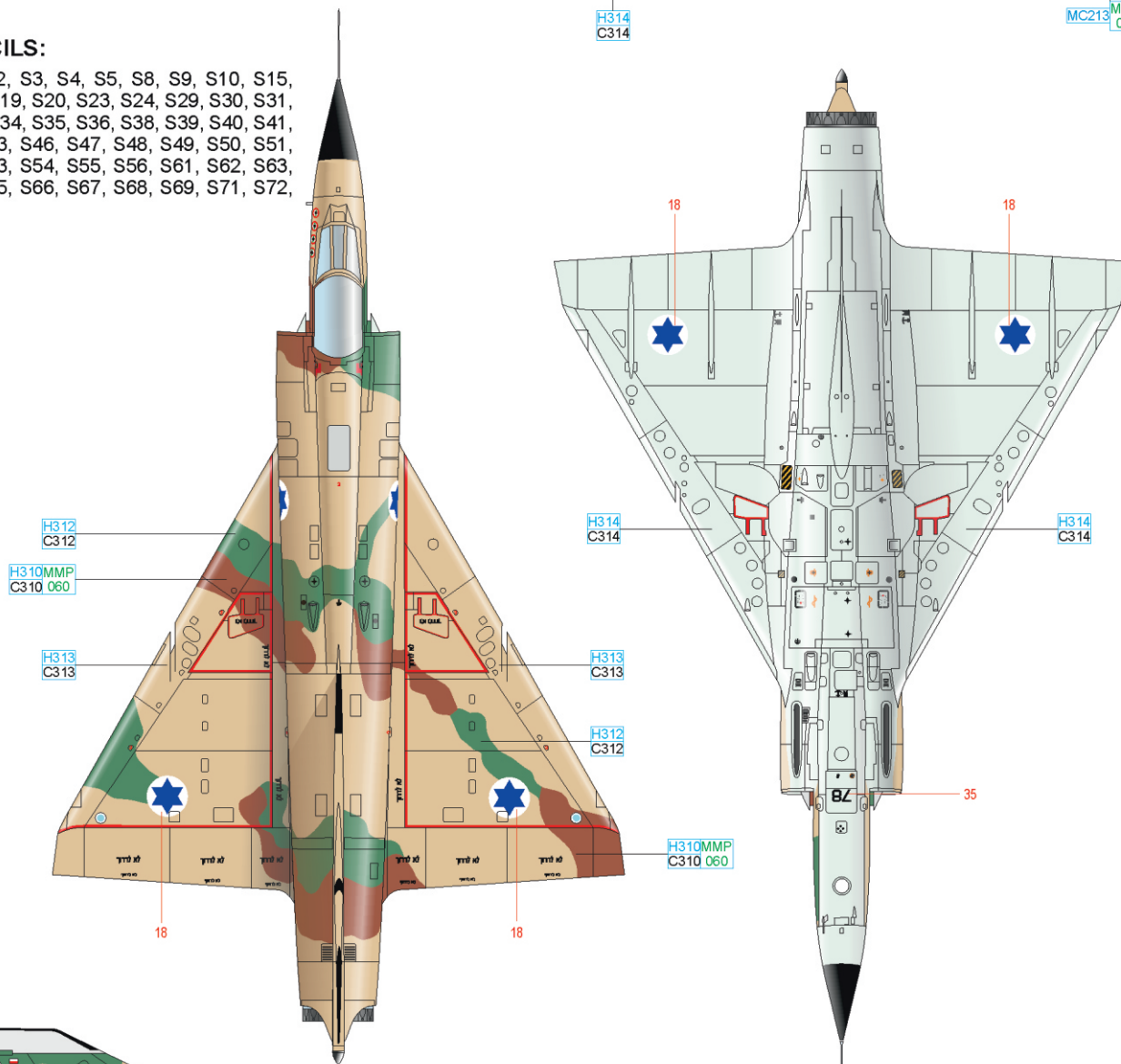

| | | | |
|-------|---------------------|---------------|---------------------|
| BLACK | H12 MMP C33 047 | STEEL | MC213 MMM 006 |
| BROWN | H310MMP C310 060 | GREEN | H312 C312 |
| | | YELLOW | H313 C313 |
| | | LIGHT BLUE | H314 C314 |

D No. 153, 253 Tayeset, Eitam Air Base, Israel, 1980

One of three Shachaks which at the end of their service in Israel were painted in so-called Air-superiority coating consisting of grey colors FS 36375 and FS 36320, was the airframe nr. 153 with the Atar 9C engine (the other two were numbers 103 and 144). The aircraft originally served with 119 Tayeset where it was rebuilt to the photo-reconnaissance version in 1963 and Ran Ronen crashed it in the same year. It was returned to service after five years long repair as the original fighter version. It was included into 117 Tayeset inventory and unit's pilots achieved three kills at its controls. In 1979 it was handed over to 253 Tayeset and then 254 Tayeset where it served until 1982. Then it was sold to Argentina where it flew as C-710 until September 1985 when it was struck off charge.

ČESKOU VERZI TEXTU NALEZNETE NA
www.eduard.cz
POD KATALOGOVÝM ČÍSLEM 11128

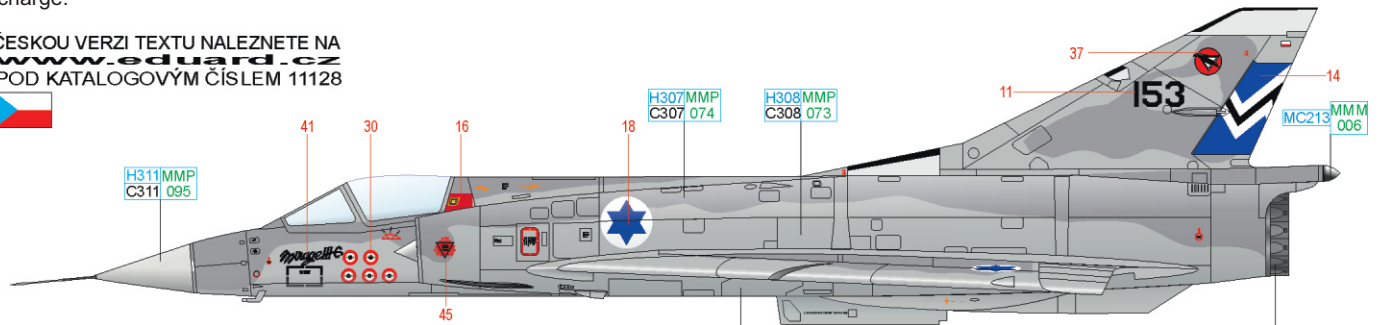

STENCILS:

S1, S2, S3, S4, S5, S8, S9, S15, S18, S19, S20, S29, S30, S31, S33, S34, S35, S36, S38, S39, S40, S41, S42, S43, S47, S48, S49, S50, S51, S52, S53, S54, S55, S56, S61, S62, S63, S64, S65, S66, S67, S68, S69, S71, S72

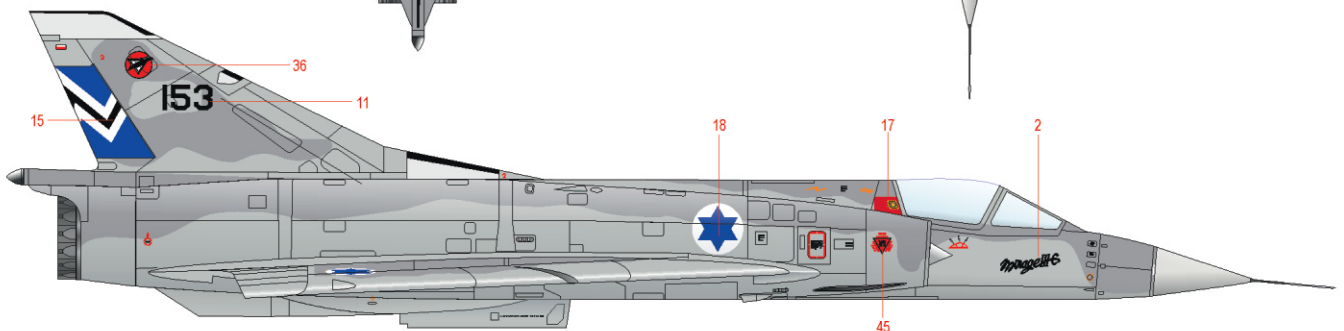
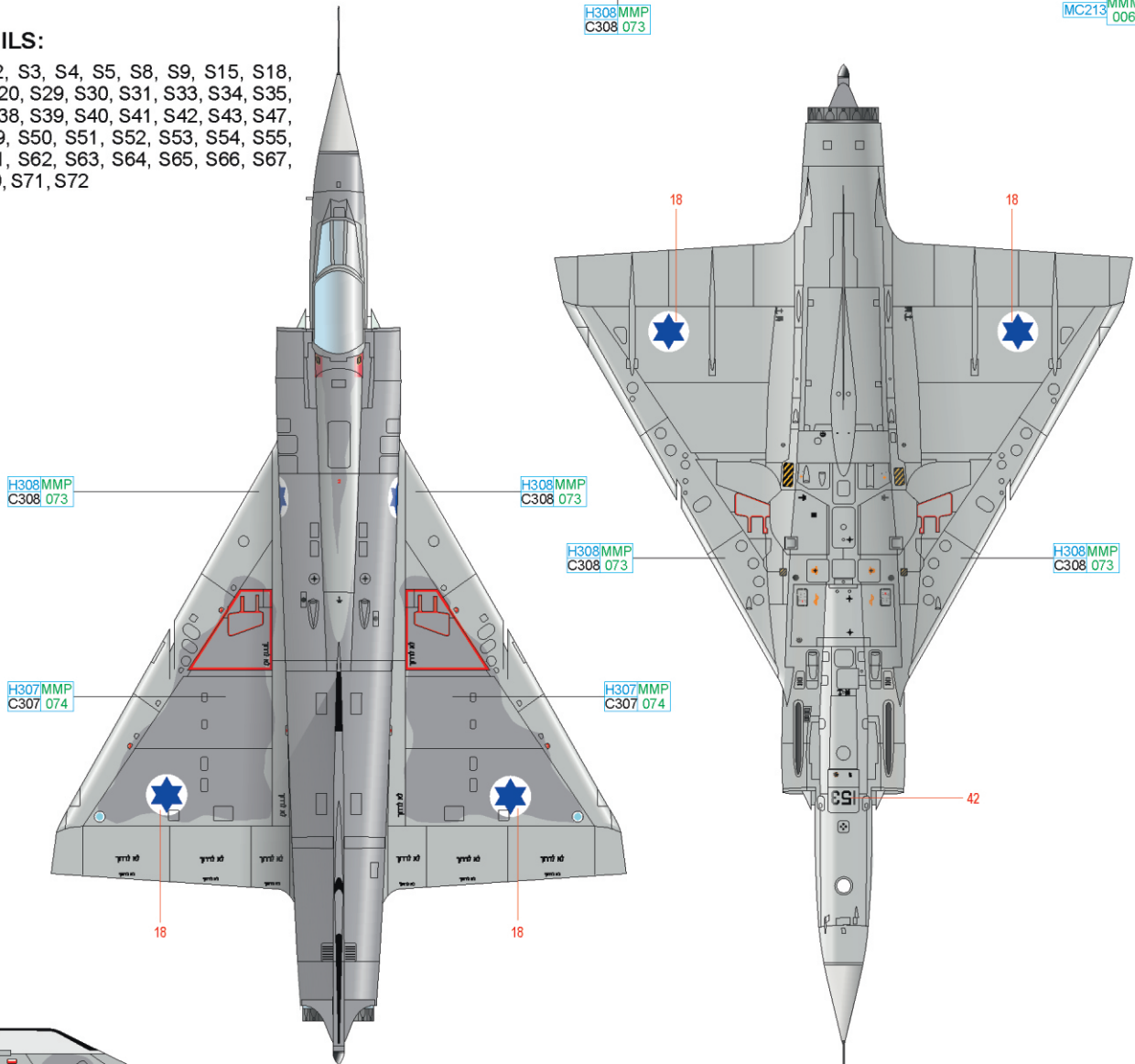

STEEL MC213 MMM 006

GRAY H307MMP C307 074 GRAY H308MMP C308 073 GRAY H311MMP C311 095

E No. 758, 119 Tayeset, Tel Nof Air Base, Israel, 1969

Shachak sporting thirteen kill markings to its credit is the aircraft nr. 58 (also known as 758, 458 or 158). It's shown here in its original natural metal finish from 1969 carrying the colors of 119 Tayeset from Tel Nof airbase. Of interest is the number of kill markings painted under the canopy. According to the available documents either two or four markings should have been painted on. These kills were as follows: June 8th, 1967, pilot Reuven Rozen (Egyptian MiG-21), May 21st, 1969, pilot Reuven Rozen (Egyptian MiG-21) and July 2nd, 1969, pilot Eitan Carmi (two Egyptian MiG-21s). In the following years the aircraft served with 101, 253 and 254 Tayeset and Israeli pilots achieved another 9 kills with it. In 1982 it was sold to Argentina where, carrying C-174 markings, served until 1990 when it was struck off charge.

ČESKOU VERZI TEXTU NALEZNETE NA
www.eduard.cz
 POD KATALOGOVÝM ČÍSLEM 11128

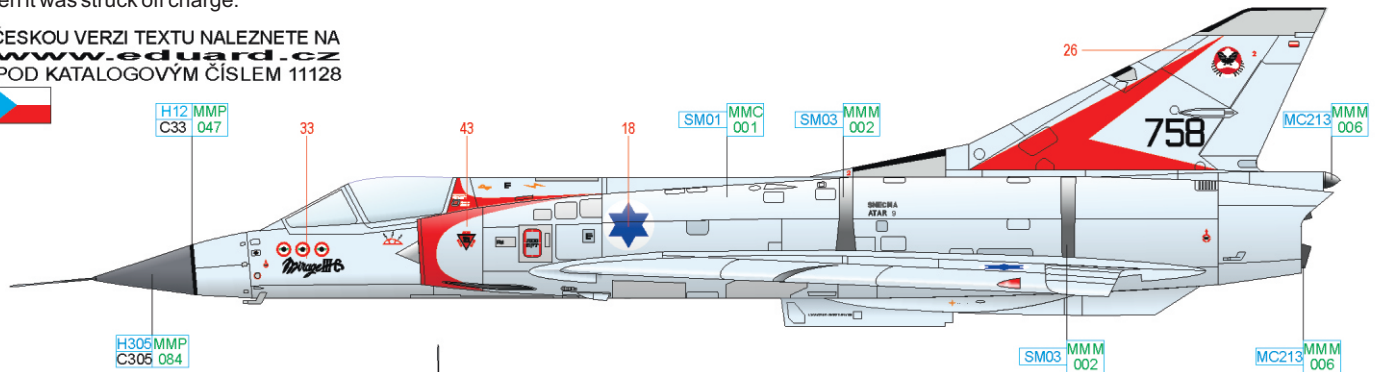

STENCILS:

- S1, S2, S4, S5, S6, S7, S10, S11, S12, S13, S14, S15, S16, S17, S18, S23, S24, S25, S26, S27, S28, S29, S30, S31, S32, S33, S34, S35, S36, S38, S39, S42, S43, S46, S47, S49, S50, S51, S52, S53, S54, S55, S56, S57, S58, S59, S61, S62, S63, S64, S65, S66, S67, S68, S70, S71, S72, S73, S75, S76, S78

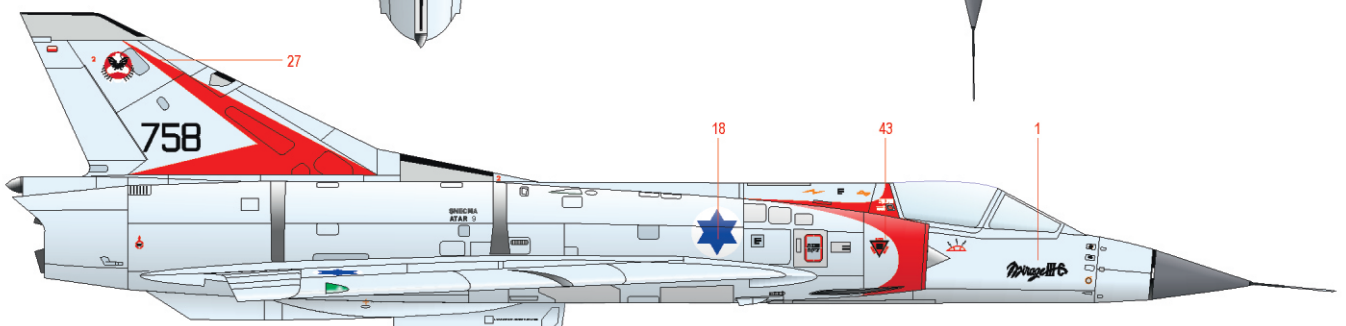
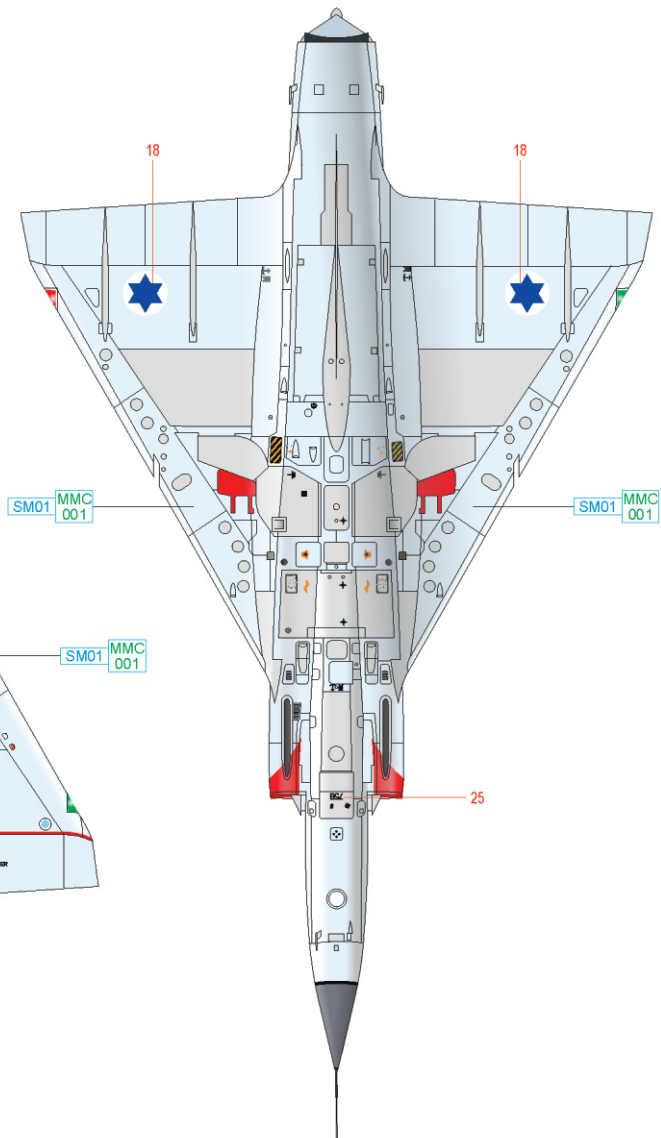
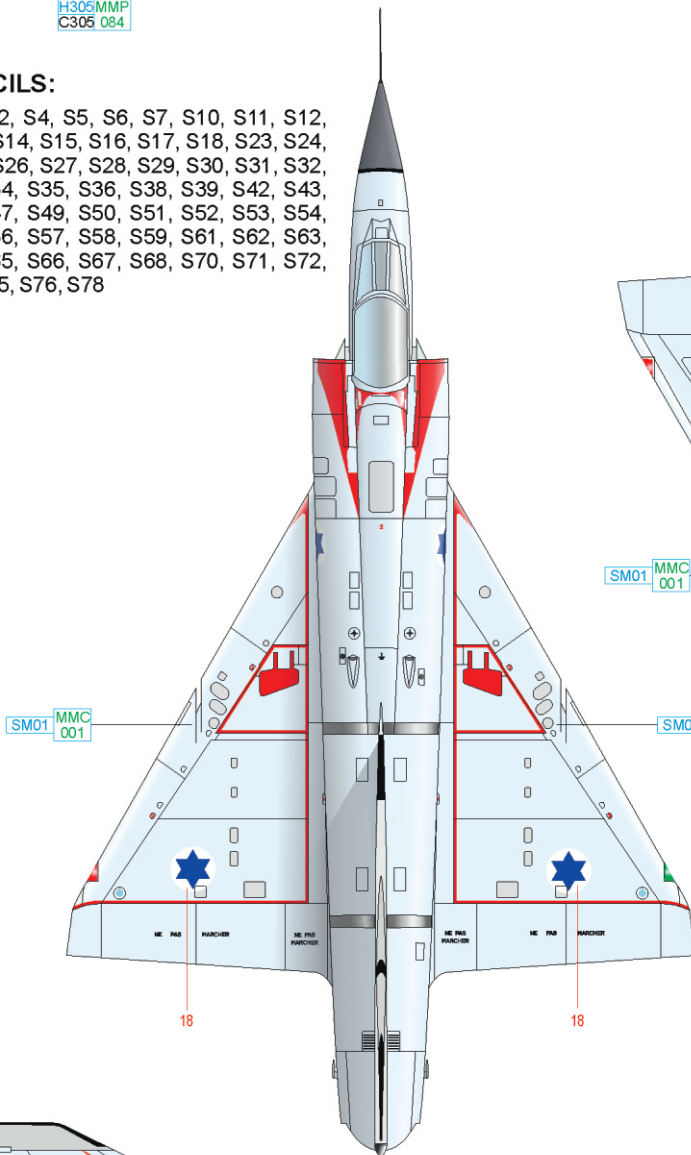

SUPER CHROME SM01 MMC 001 SUPER IRON SM03 MMM 002 STEEL MC213 MMM 006 BLACK H12 MMP C33 047 GRAY H305 MMP C305 084

