

4117-3800

The P-26 was the first monoplane ever used by the Army Air Corps. In the 1930's, when it first appeared, it was the fastest, most advanced fighter that became the basis for the following fighter series.

The "Peashooter", as it was fondly nicknamed by pilots, surpassed the fastest biplane by some 80 mph. Wing flaps had to be added to slow down the landing speed. The P-26 went on to establish not only speed records but altitude records as well.

By the time World War II began, the P-26 was already outmoded and was shipped to China and the Philippines. On December 10, 1941, three Philippine Army Air Corps P-26's

surprised a superior force of Japanese bombers and completely disrupted the enemy attack. One of their nine bombers was destroyed while the P-26's were undamaged.

BOEING P-26 "PEASHOOTER" SPECIFICATIONS:

WINGSPAN 27' 11"
 LENGTH 23' 7"
 POWERPLANT PRATT & WHITNEY
 WASP: 500 HP
 MAXIMUM SPEED 234 MPH
 RANGE 635 MILES
 SERVICE CEILING 27,400'
 ARMAMENT (2) .30 IN. MACHINE GUNS

A	BLACK	SCHWARZ	NOIR	ZWART	SVART	NEGRO	NERO
B	BROWN	BRAUN	MARRON	BRUIN	BRUN	MARRON	MARRONE
C	SILVER	SILBER	ARGENT	ZILVER	SILVER	PLATA	ARGENTO
D	GRAY	GRAU	GRIS	GRUIS	GRA	GRIS	GRIGIO
E	BLUE	BLAU	BLEU	BLAUW	BLA	AZUL	BLU
F	YELLOW	GELB	JAUME	GEEL	GUL	AMARILLO	GIALLO

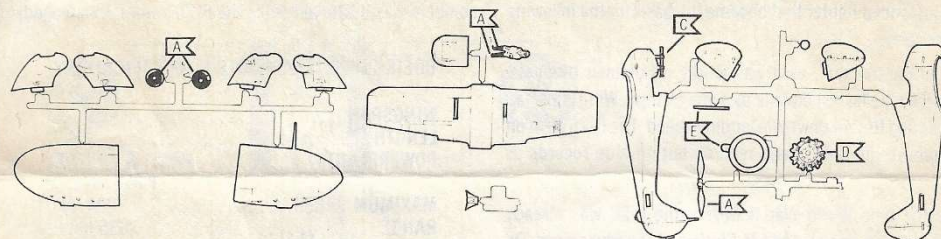

ENGLISH: ASSEMBLY DRAWINGS SHOULD BE REVIEWED BEFORE PROCEEDING WITH CONSTRUCTION. A NUMBER IDENTIFIES EACH PLASTIC PART FOR YOUR CONVENIENCE. PAINT SMALL PARTS ON RUNNER BEFORE REMOVING. ALLOW PAINT TO DRY THOROUGHLY BEFORE CONTINUING ASSEMBLY OF KIT. SCRAPE CHROME OR PAINT AT AREA TO BE GLUED. WASH PLASTIC IN MILD DETERGENT SOLUTION. RINSE AND LET AIR DRY FOR BETTER PAINT AND DECAL ADHESION.

DEUTSCH: VOR DEM ZUSAMMENBAU DIE BAUANLEITUNG GUT DURCHLESEN. JEDES TEIL IST NUMMERIERT. KLEINE TEILE ANSTREICHEN BEVOR SIE VOM RAHMEN ENTFERNT WERDEN. FARBEN GUT TROCKNEN. ERST DANN MIT DER ZUSAMMENSTELLUNG FORTSETZEN. CHROM UND FARBE AN DEN KLEBEFLÄCHEN ENTFERNEN. PLASTIKTEILE IN EINER MILDEN WASCHMITTELLOSUNG REINIGEN UND AN DER LUFT TROCKNEN. DAMIT FARBE UND UND ABZIEHBILDER BESSER HAFTEN.

FRANCAIS: EXAMINER LES SCHEMAS D'ASSEMBLAGE AVANT DE COMMENCER LA CONSTRUCTION. UN NUMERO IDENTIFIE CHAQUE PIECE DE PLASTIQUE POUR PLUS DE FACILITE. PEINDRE LES PETITES PEICES SUR LE SUPPORT AVANT DE LES ENLEVER. LAISSER LA PEINTURE SECHER COMPLETEMENT AVANT DE CONTINUER L'ASSEMBLAGE DU KIT. GRATTER LE CHROME OU LA PEINTURE SUR LES SURFACES A COLLER. LAVER LE PLASTIQUE DANS UNE SOLUTION DE DETERGENT LEGERE, RINCER ET LAISSER SECHER A L'AIR POUR UNE MEILLEURE ADHERENCE DE LA PEINTURE ET DES DECALS.

NEDERLANDS: BESTUDDER DE MONTAGE TEKENINGEN, VOORDAT U MET BOUWEN BEGINT. VOOR UW GEMAK, IDENTIFICEERT EEN NUMMER ELK PLASTIC DEEL. VERF KLEINE DEELTJES OP KIBOOM VOORDAT U ZE VERWYDERT. LAAT VERF GRONDIG DROGEN VOORDAT U DE MONTAGE VAN HET MODEL VOORTZET. SCHRAP CHROOM OF VERF VAN HET GEDEELTE DAT GELYMD WORDT. WAS PLASTIC MET EEN ZACHTE ZELF, SPOEL AF, EN LAAT IN LUCHT DROGEN, ZODAT VERF EN DECAL BETER PLAKKEN.

SVENSKA: IHOPSÄTTNINGSSKISSEN BÖR GRANSKAS INNAN IGÅNGSÄTTANDE AV BYGGANDET. ETT NUMMER IDENTIFIKERAS VARJE PLASTDEL FÖR DIN EGEN BEKVÄMLIGHET. MALA DE SMA BITARNA DIREKT PÅ FARAN INNAN DE TAS BORT. LÅT FÄRGEN TORRKA GRUNDLIGT INNAN FORTSÄTT BYGGANDE. SKRAPA AV KROMEN ELLER MALA PÅ DELARNA SOM SKALL KLISTERAS. TVÄTTA PLASTEN I MILD TVÄTTMEDELLOSNING. SKOJL OCH LUFTTORKA FÖR BÄTTRE FÄSTANDE AV FÄRG OCH DEKALER.

ESPAÑOL: DIBUJOS DE ENSAMBLAJE DEBEN SER REPASADOS ANTES DE SEGUIR CON LA CONSTRUCCION. UN NUMERO IDENTIFICA CADA PARTE DEL PLASTICO PARA SU CONVENIENCIA. PINTA PARTES PEQUEÑAS DEL KIT ANTES DE QUITARLAS. DEJE SECAR BIEN LA PINTURA ANTES DE SEGUIR EL ENSAMBLAJE. RASPE EL CROMO O LA PINTURA DEL SITIO ANTES DE SER PEGADO. LAVE EL PLASTICO EN UNA SOLUCION SUAVE DETERGENTE, ENJUAGUE, Y DEJE SECAR EN EL AIRE PARA MEJOR ADHESION DE LA PINTURA Y CALCOMANIA.

ITALIANO: I DISEGNI DELL'ASSEMBLAGGIO DOVREBBERO ESSERE RICONTROLLATI PRIMA DI INIZIARE IL MONTAGGIO. OGNI PEZZO E IDENTIFICATO DA UN NUMERO PER VOSTRA MAGGIORE COMODITA'. VERNICIARE LE PARTI PICCOLE SULLA GUIDA DI SCORRIMENTO PRIMA DE TOGLIERLE. LASCIAR ASCIUGARE LA VERNICE PRIMA DI CONTINUARE IL MONTAGGIO. RASCHIAR LA PITTURA O IL CROMO DALLE PARTI CHE DEVONO ESSERE INCOLLATE. LAVARE I PEZZI DI PLASTICA CON UN DETERGENTE NON TROPPO FORTE. SCIACQUARE E LASCIAR ASCIUGARE AFFINCHÉ VERNICE E DECALCOMANIE ADERISCANO MEGLIO.

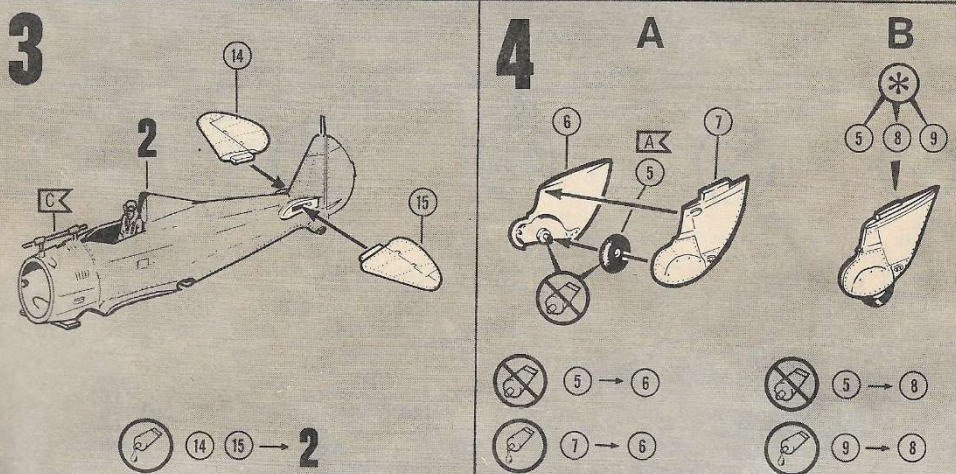
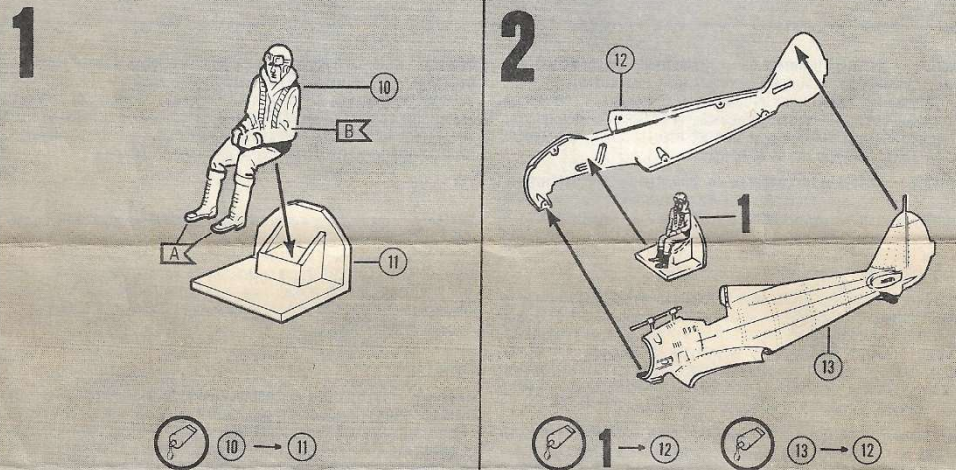

GLUE
KLEBER
COLLE
LIJM
KLISTER
PEGA
COLLA

NO GLUE REQUIRED
KEIN KLEBER NOTWENDIG
LA COLLE N'EST PAS NECESSAIRE
GEEN LIJM NODIG
INGET KLISTER BEHOVS
NO NECESITA PEGA
NON C'E BISOGNO DI COLLA

DO IT THIS MANY TIMES
ANZAHL DER ARBEITSGRENZE
LE FAIRE CE NOMBRE DE FOIS
DOE HET ZOVEEL KEER
GJOR DET SA MANGA GANGER
FATELO TUTTE QUESTA VOLTE
HAGALO ESTA CANTIDAD DE VECES

OPTIONAL
WAHLWEISE
FACULTATIF
NAAR KEUZE
VALFERI
FACOLTATIVO
OPCIONAL

APPLY DECALS
ABZIEHBILDER ANBRINGEN
COLLER LES DECALCOMANIES
BRENG PLAKPLAATJES AAN
SATT PA DEKALERNA
APPLICARE LE DECALOMANIE (ADESIVI)
APLICAR CALCAS

CLEAR
KLAR
TRANSPARENT
DOORZICHTIG
KLART
VIA LEBERA
TRANSPARENTE

YELLOW
GELB
JAUME
GEEL
GUL
AMARILLO
GIALLO

5

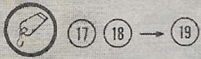
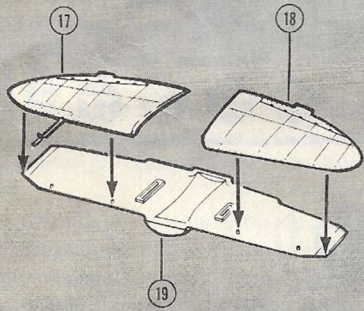

6

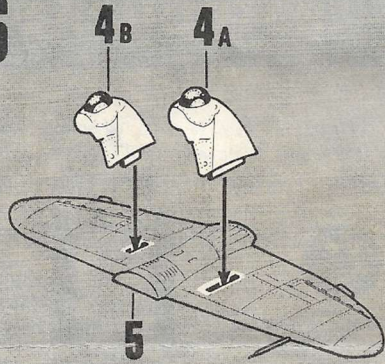

7

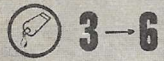
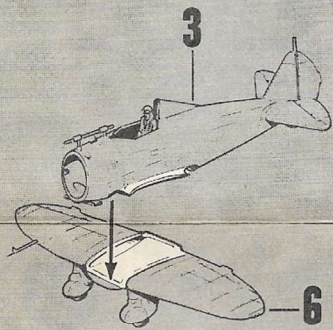

8

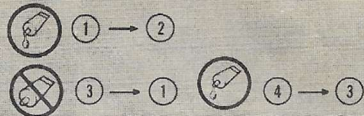
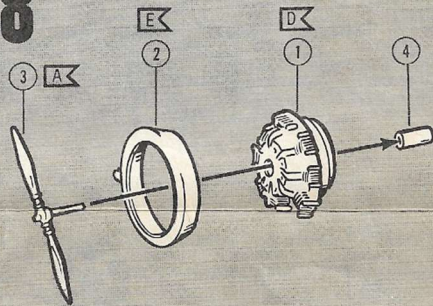

9

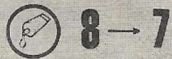
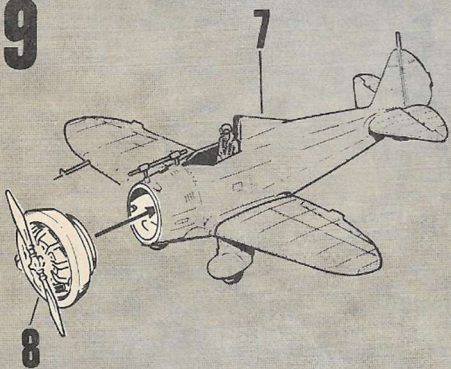

10

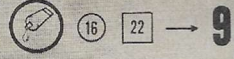
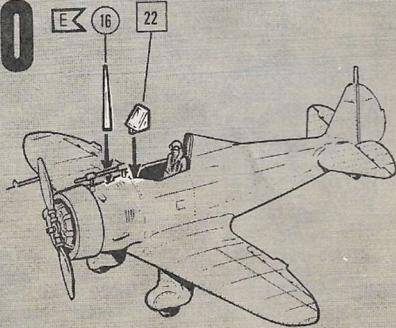

11

