

Junkers Ju-88C

HC1605 • 1:48 • German WWII Night Fighter

Derived from the fast, maneuverable and powerful Ju-88A-4 bomber, Ju-88C "Destroyers" eventually became one of the most important night fighters in service with Germany's Luftwaffe during the Second World War.

Als eine Weiterentwicklung des Ju 88A-4 Bombers wurde die Ju 88C "Zerstörer" eines der bedeutendsten Nachtjäger im Dienste der Deutschen Luftwaffe während des II. Weltkrieges.

Dérivé du puissant, rapide et agile bombardier Ju -88A-4, le Ju -88C "Destroyers" devint l'un des principaux chasseurs de nuit, de l'armée de l'air allemande durant la seconde guerre mondiale.

Derivado del rápido, maniobrable y, poderoso bombardero Ju -88A-4, el Ju -88C "Destructor" se convirtió en uno de los más importantes combatientes nocturnos en servicio con Luftwaffe alemana durante la Segunda Guerra Mundial.

Derivato del veloce, manovrabile e potente bombardiere Ju -88A-4, lo Ju -88C "DESTROYER" oivenne alla fine uno dei più importanti caccia notturni in servizio nelle Luftwaffe tedesca durante la 2° Guerra Mondiale.

cyanoacrylate glue coller cyanoacrylate Cyanoacrylate kleben incollare cyanoacrylate pegar cyanoacrylate	cut couper schneiden tagliare cortar	bend plier sich biegen piegare doblar	file / sand poner verspachteln levigare lijar	weight a lester Gewicht zavorra lastre	drill or pierce percer bohren forare agujerear	two deux zwei due dos
painting instructions mode d'emploi Anleitungen der Farben istruzioni per la verniciatura instrucciones sobre la pintura	caution! attention! vorsichten! attenzione! atención	alternative en option Alternativ alternativo alternativa	cement coller kleben incollare pegar	paint peindre bemalen verniciare pintar	decal decalcomania Abziehbild decalcomania calcomantas	no! no! nein! no! ¡no!



Read This Before You Begin!

- study the assembly drawings
- each plastic part is identified by number
- check the fit of each piece before cementing
- do not use too much cement to join parts
- model may be painted to match box illustration

Lisez Ce Qui Suit Avant De Commencer Le Montage!

- étudier les schémas d'assemblage
- chaque pièce plastique porte un numéro d'identification
- contrôler que chaque pièce soit bien conforme avant de la coller à sa place
- utilisez uniquement une colle spéciale pour polystyrène
- le modèle peut être peint conformément aux illustrations de la boîte

Vor Zusammenbau lesen sie bitte!

- studiere die Bauanleitung
- die Plastikteile sind gekennzeichnet durch ihre Nummern
- vor dem Kleben prüfe ob die Teile zusammenpassen können
- benutze nicht zuviel Klebstoff
- die Bemalung des Modells kann auf dem Becketbild zeigen

1 Cockpit Assembly / Assemblage de L' Interieur

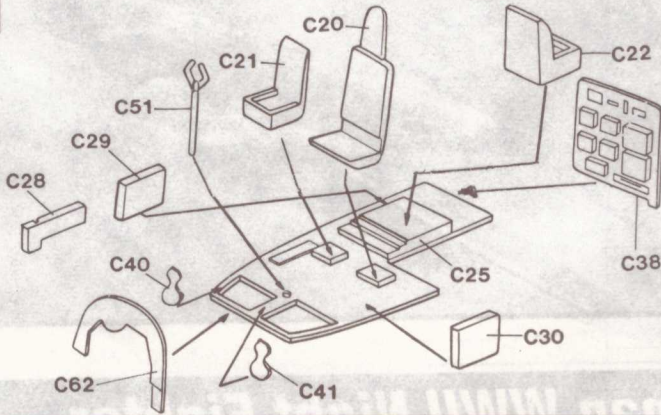

2 Propeller Assembly / Assemblage de Helice

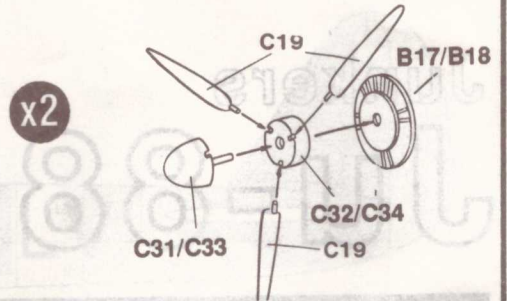

3 Fuselage Assembly / Assemblage du Fuselage

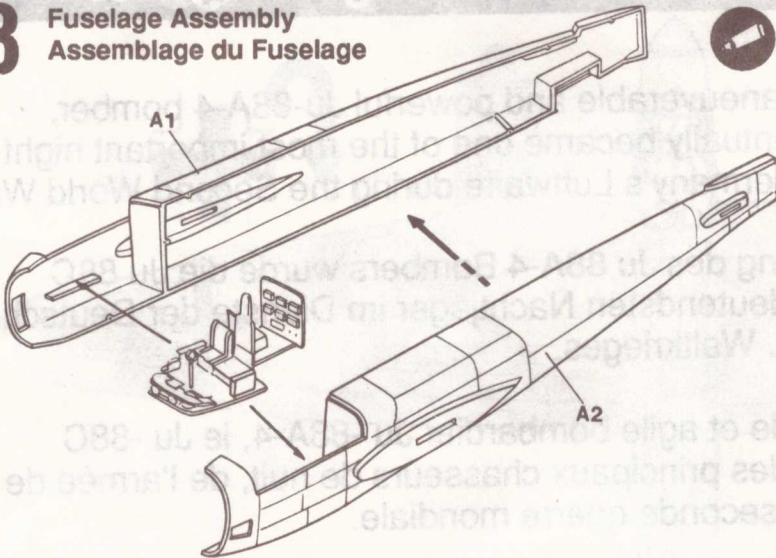

4 Landing Gear Assembly / Train D'Atterrissage

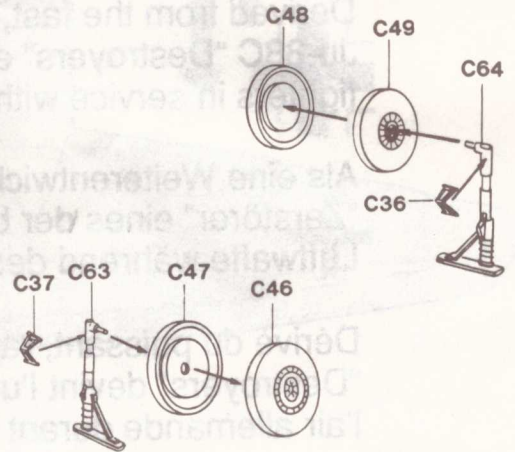

5 Wing Assembly / Assemblage Ailes

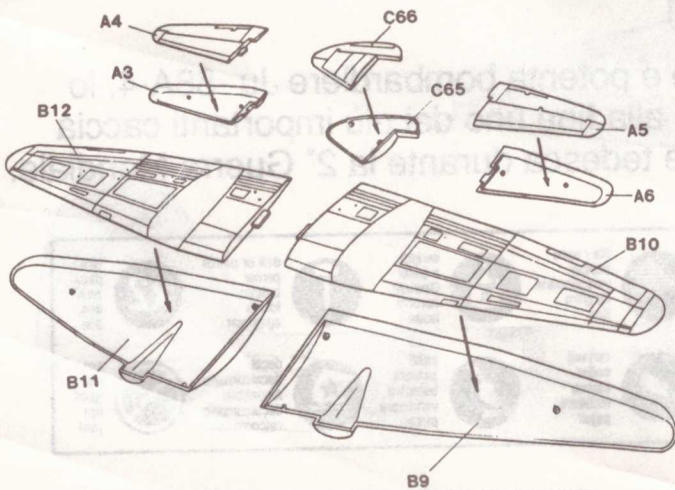

6 Wing & Fuselage Assembly / Assemblage de Ailes & Fuselage

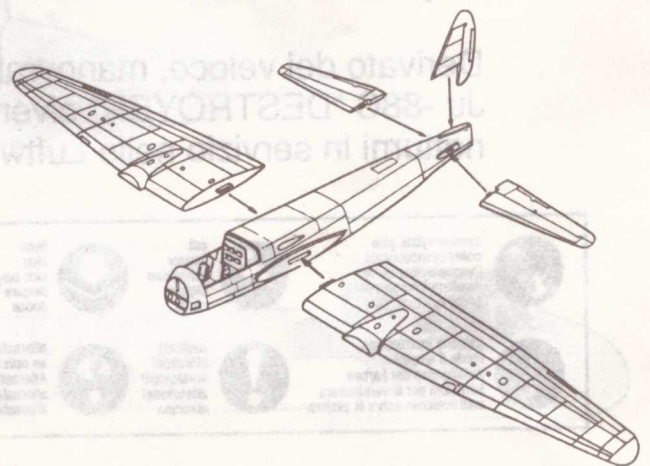

7 Propeller & Engine Assembly / Assemblage de Helice & Moteur

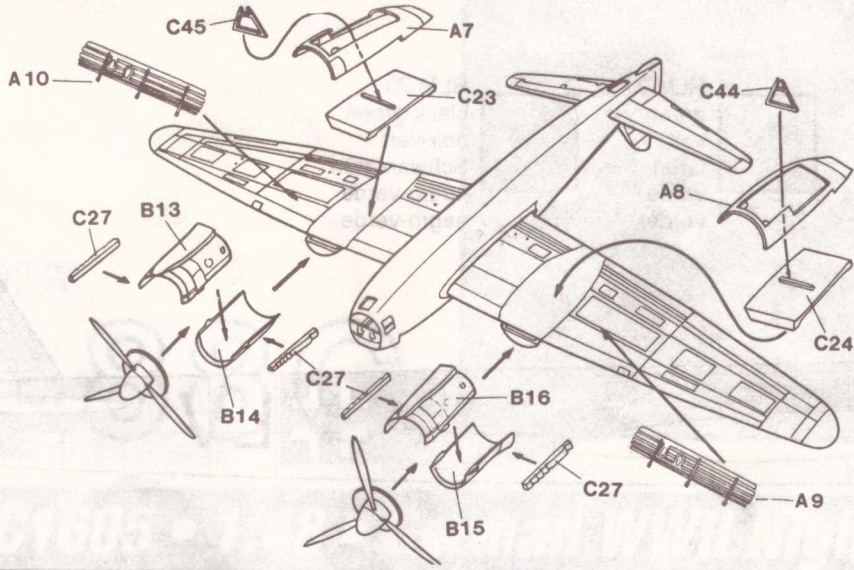

8 Landing Gear & Cover Assembly / Train D'Atterrissage & Couvercle

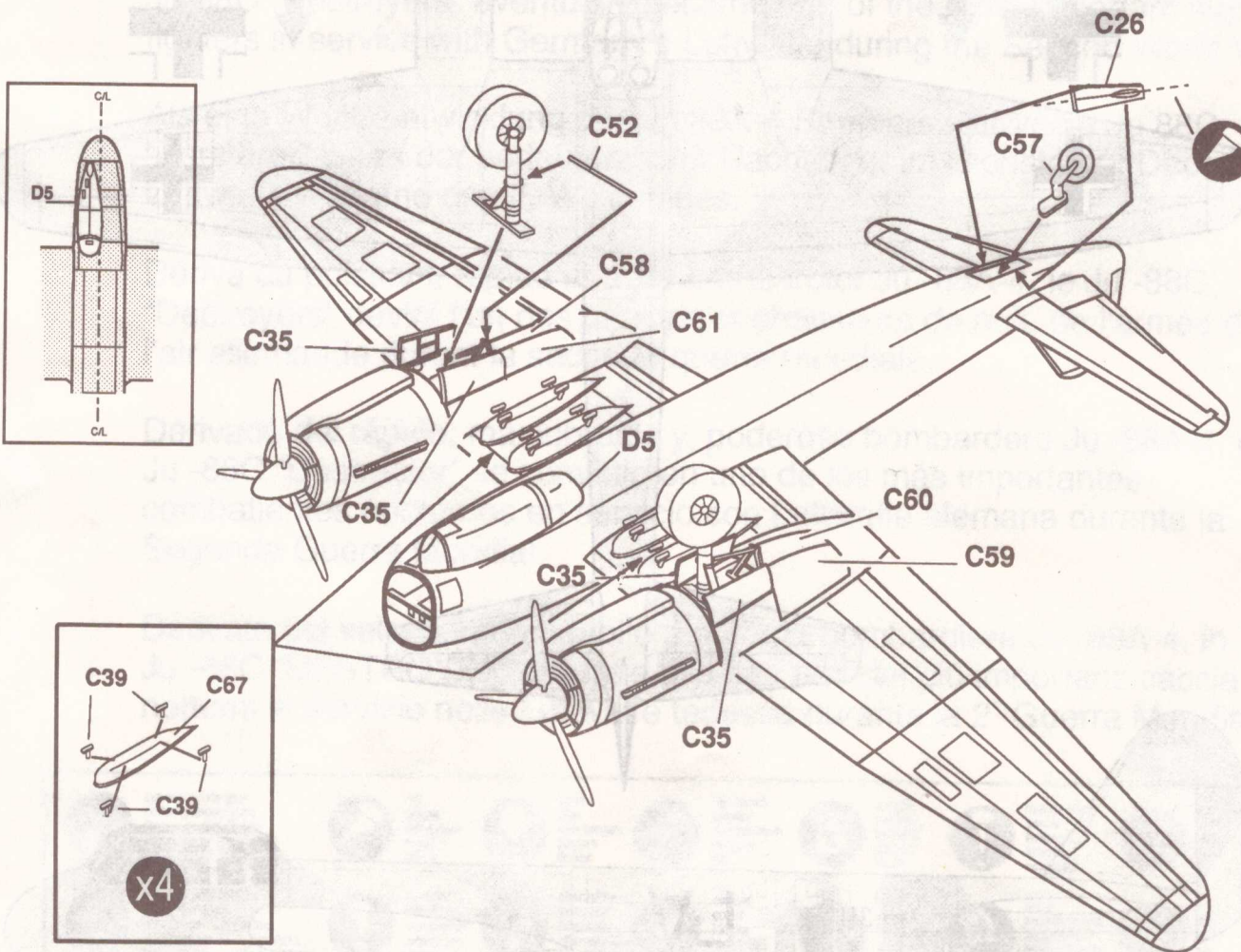

9

Canopy Assembly / Assemblage Partie & Verriere et Ailes

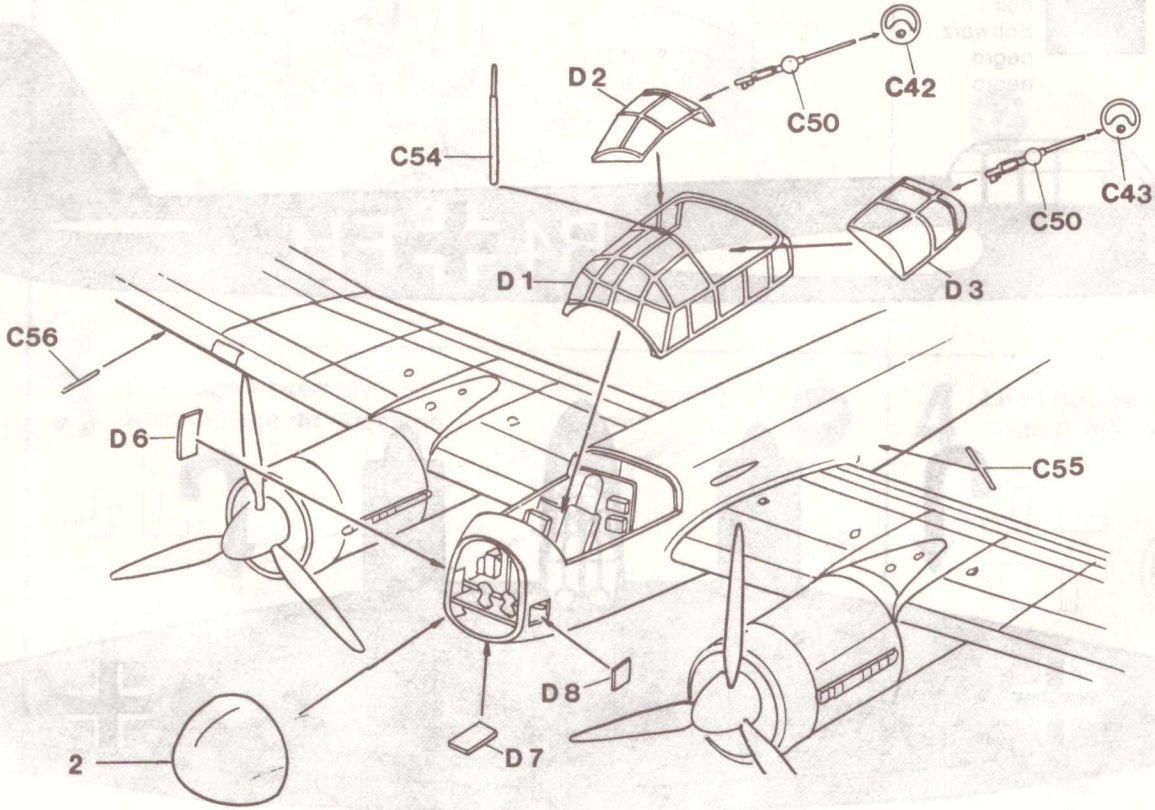

10

Bomb Assembly / Assemblage Bombe

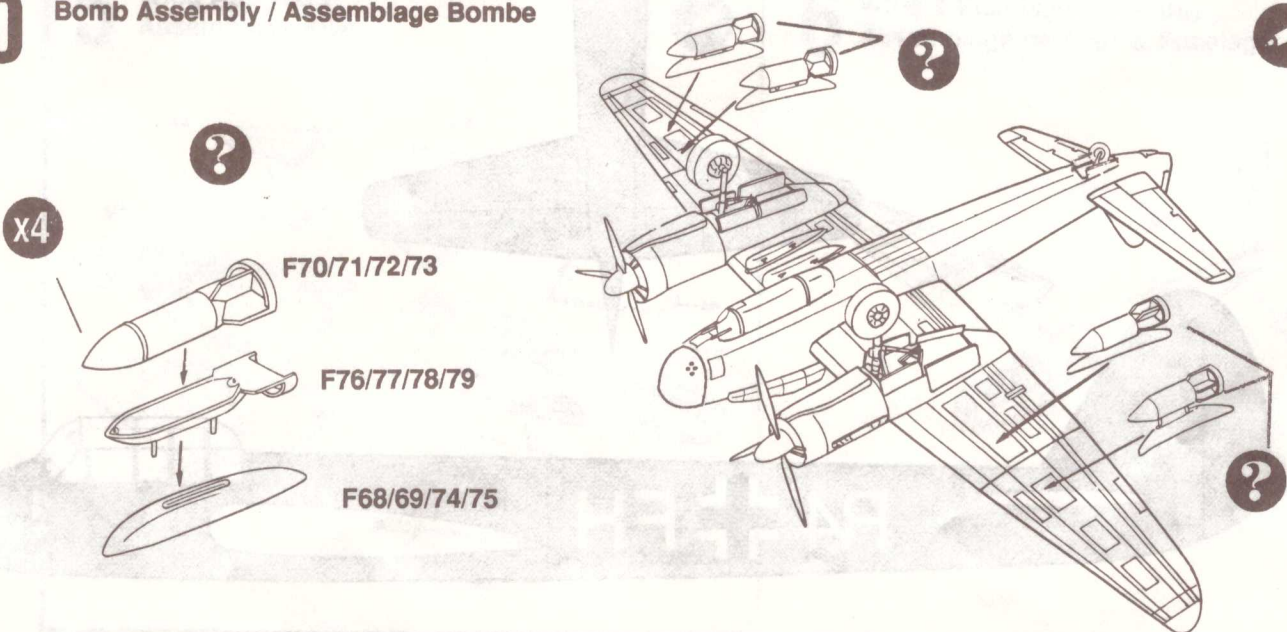

Camouflage & Markings • Appliques et Couleurs

I Ju-88C, 1./NJG 2, Holland, 1941

RLM 22
black
noir
Schwarz
negro
negro

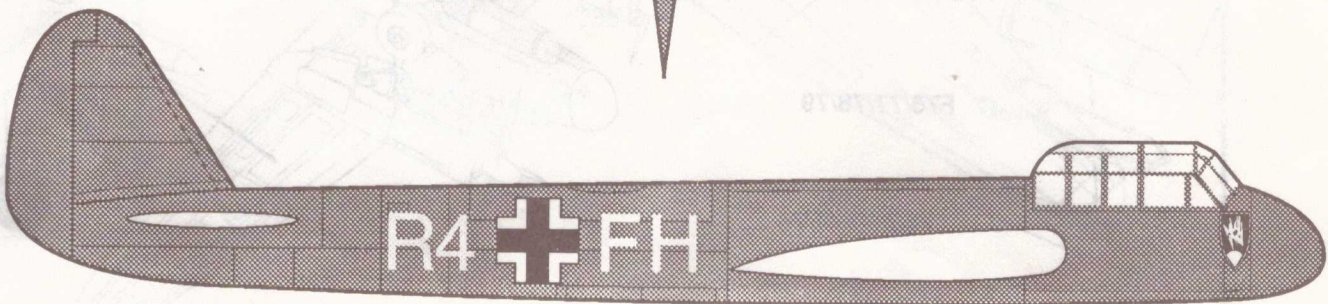
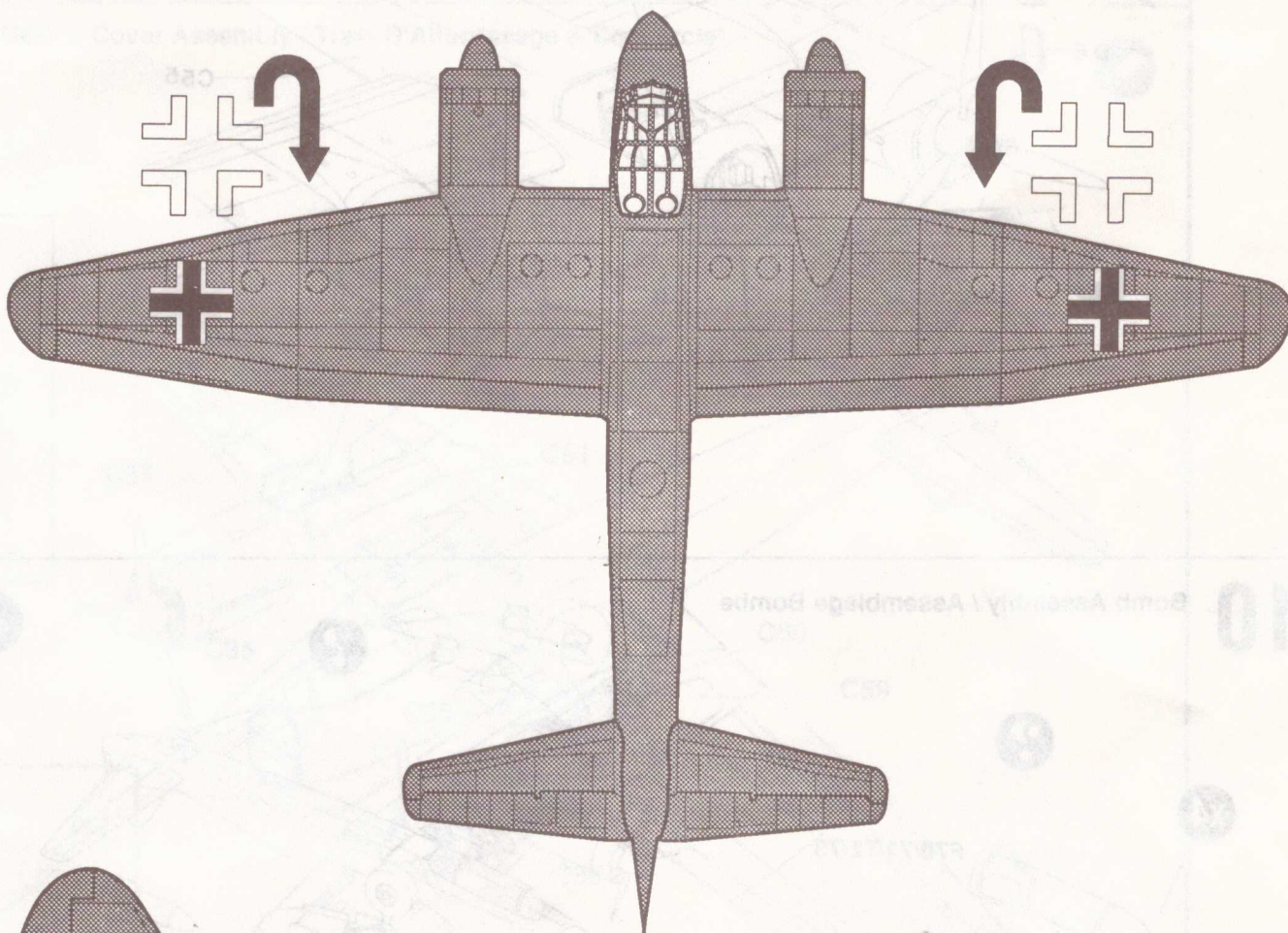
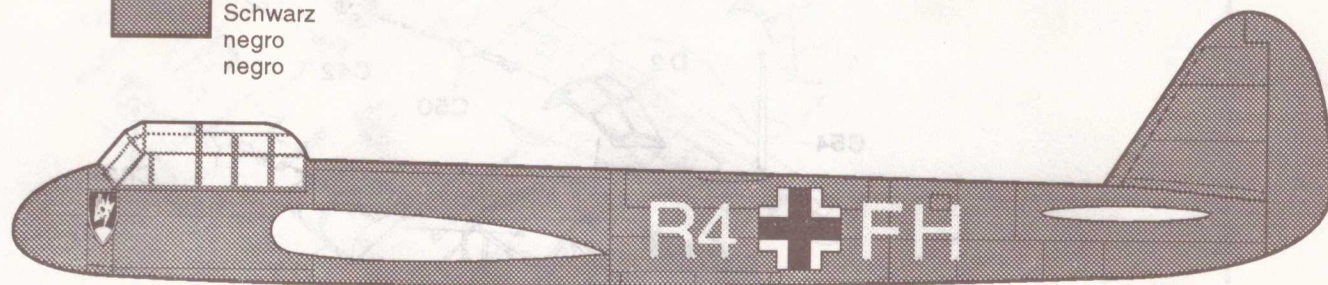

II Ju-88C, 8./NJG 2, Mediterranean, 1943

RLM 65
blue
bleu
Blau
azzurro
azul

RLM 71
green
vert
Grün
verde
verde

RLM 70
black-green
noir-vert
Schwarzgrün
negro-verde
negro-verde

