

# Revell

# SpaePz LUCHS (8x8)

03036 - 0389

©1998 BY REVELL AG.

PRINTED IN GERMANY



## SpaePz Luchs

Der Spähpanzer 2 (8 x 8) "Luchs" wurde ab 1975 mit insgesamt 408 Exemplaren bei der Bundeswehr eingeführt und in den Panzeraufklärungsataillonen eingesetzt. Der von Thyssen-Henschel gefertigte allradgetriebene "Luchs" ist gut gepanzert, hat eine NBC-Schutzanlage und zeichnet sich durch äußerst leise Fahrgeräusche aus. Die acht großvolumigen Niederdruckreifen weisen Notlaufeigenschaften auf, für Geschwindigkeiten bis ca. 50 km/h können vier Achsen gelenkt werden. Als Besonderheit ist das Fahrzeug mit einem speziellen Rückwärtsfahrer mit eigenem Fahrstand versehen. Bis zur ersten Kampfwertsteigerung ab 1986 war der "Luchs" voll schwimmfähig und konnte mit den am Fahrzeugheck angebrachten Ruderpropellern sowie dem umklappbaren Schwallbrett am Bug Wasserhindernisse rasch und eigenständig überwinden. Die 1986 anlaufende Kampfwertsteigerung zum "Luchs" A1 umfaßte u.a. den Einbau eines Wärmebild-Ziel- und Beobachtungsgerätes. Der ursprünglich links am Turm angebrachte IR/Weißlicht-Scheinwerfer entfiel. Als Bewaffnung dienen eine Bordmaschinenkanone Rh 202 Mk 20 mm mit Munitionswechseleinrichtung und ein 7,62 mm FlaMG, die im Turm untergebracht sind. Der Einbau der neuen Funkgeräte SEM 80/90 führte zur Bezeichnung SpPz 2 "Luchs" A2. Das Gefechtsgewicht beträgt 19.380 kg. Als Antrieb dient ein DB 10-Zylinder Vielstoffmotor mit 389 PS, der eine Höchstgeschwindigkeit von bis zu 90 km/h auf der Straße ermöglicht. Die Besatzung besteht aus Vorwärtsfahrer, Richtschütze, Rückwärtsfahrer/Tastfunker und Kommandant.

## SpaePz Luchs

The Spähpanzer 2 Luchs" (8x8) reconnaissance vehicle was introduced into the West German army in 1975 who used a total of 408 in their armoured reconnaissance battalions. The all-wheel drive "Luchs" made by Thyssen-Henschel is well armoured, has an NBC protection system and is characterized by its low-noise running. The eight large low-pressure tyres have run-flat properties. At speeds up to about 50 km/h all four axles can be steered. As a special feature the vehicle is equipped with a special rear-facing driver with his own driving position. Up to the first combat effectiveness upgrade (1986) the "Luchs" was fully amphibious and could surmount water obstacles quickly and independently using the propellers at the rear and the fold back trim vane at the front. The upgrade to the "Luchs" A1 that started in 1986 included the incorporation of a thermal observation and gunnery system, which replaced the original IR/white light night vision system mounted to the left of the turret. The armament consists of one Rh 2092 MK 20 mm cannon with automatic loader and one 7.62 mm AA MG located in the turret. The incorporation of the new SEM 80/90 radio system gave it the designation SpPz 2 "Luchs" A2. The combat weight is 19,380 kg. It is driven by a DB 10-cylinder 389 hp multi-fuel engine that develops a maximum speed of 90 km/h on the road. It is crewed by a forward-facing driver, gunner, rear-facing driver/radio operator and commander.

Form hergestellt und im Eigentum von Revell AG/Revell Monogram Inc. Wiedrige Rechte Nachahmungen werden gendertlich verfolgt.  
 Original ist Eigentum der Revell AG/Revell Monogram Inc. Jede Vervielfältigung oder Duplizierung ist ohne Erlaubnis der Revell AG/Revell Monogram Inc. ist strafbar.  
 Modèles y en propiedad de Revell AG/Revell Monogram Inc. Imitaciones lícitas serán perseguidas por la ley.  
 Forma prodotta dalla Revell AG/Revell Monogram Inc. e di proprietà della Revell AG/Revell Monogram Inc. Le copie non autorizzate sono perseguite secondo la legge.  
 Modell er tillverkad av och tillhör Revell AG/Revell Monogram Inc. All kopiering beivras enligt lagen om upphovsrätt.  
 Formen er fremstillet af Revell AG/Revell Monogram Inc. som også har ejendomsret. Læstidende af forfatteren søgtes.  
 Modeli su proizvedeni i su u vlasništvu Revell AG/Revell Monogram Inc. Neovlašćeni kopije budo pravno kažnjene.  
 Modeli su proizvedeni i su u vlasništvu Revell AG/Revell Monogram Inc. Neovlašćeni kopije budo pravno kažnjene.

Forma hergestellt und im Eigentum von Revell AG/Revell Monogram Inc. Wiedrige Rechte Nachahmungen werden gendertlich verfolgt.  
 Original ist Eigentum der Revell AG/Revell Monogram Inc. Jede Vervielfältigung oder Duplizierung ist ohne Erlaubnis der Revell AG/Revell Monogram Inc. ist strafbar.  
 Modèles y en propiedad de Revell AG/Revell Monogram Inc. Imitaciones lícitas serán perseguidas por la ley.  
 Forma prodotta dalla Revell AG/Revell Monogram Inc. e di proprietà della Revell AG/Revell Monogram Inc. Le copie non autorizzate sono perseguite secondo la legge.  
 Modell er tillverkad av och tillhör Revell AG/Revell Monogram Inc. All kopiering beivras enligt lagen om upphovsrätt.  
 Formen er fremstillet af Revell AG/Revell Monogram Inc. som også har ejendomsret. Læstidende af forfatteren søgtes.  
 Modeli su proizvedeni i su u vlasništvu Revell AG/Revell Monogram Inc. Neovlašćeni kopije budo pravno kažnjene.  
 Modeli su proizvedeni i su u vlasništvu Revell AG/Revell Monogram Inc. Neovlašćeni kopije budo pravno kažnjene.





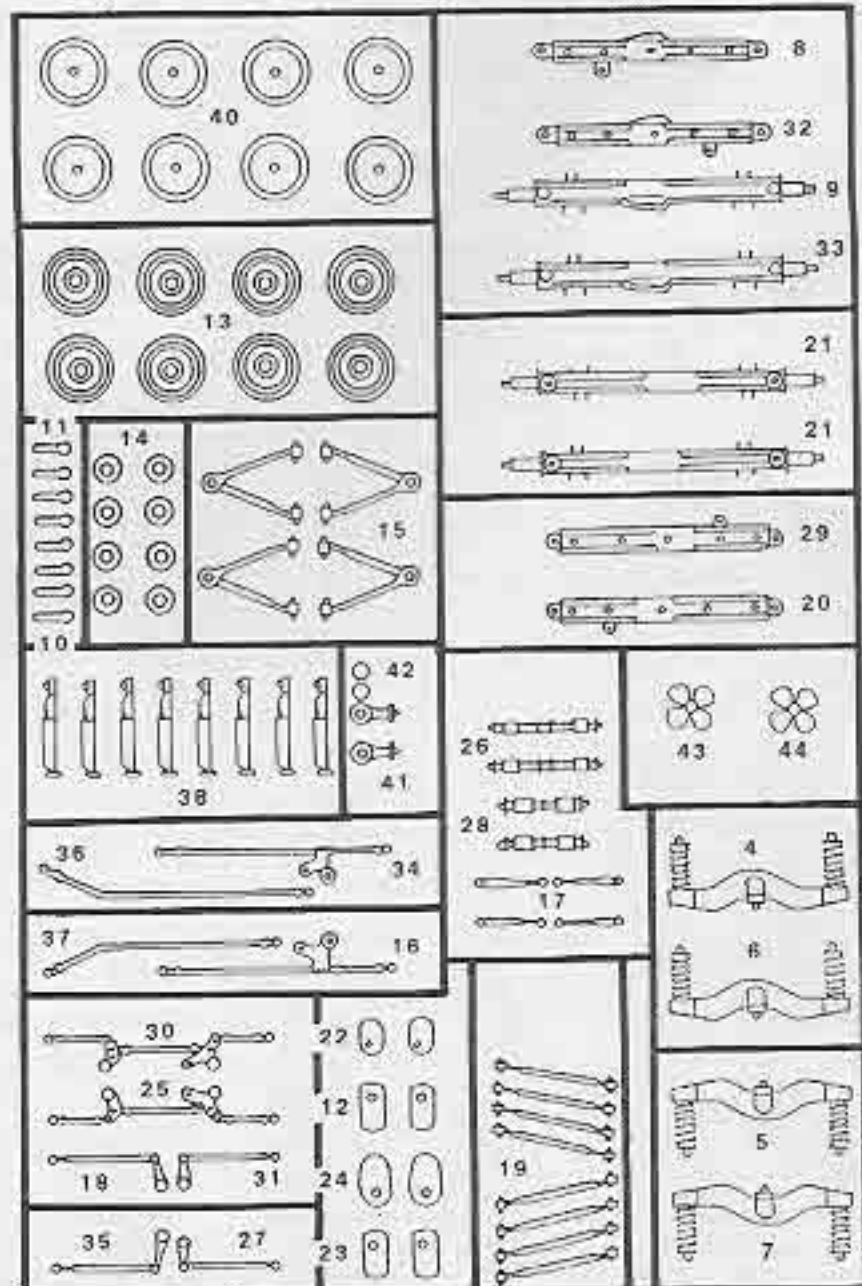
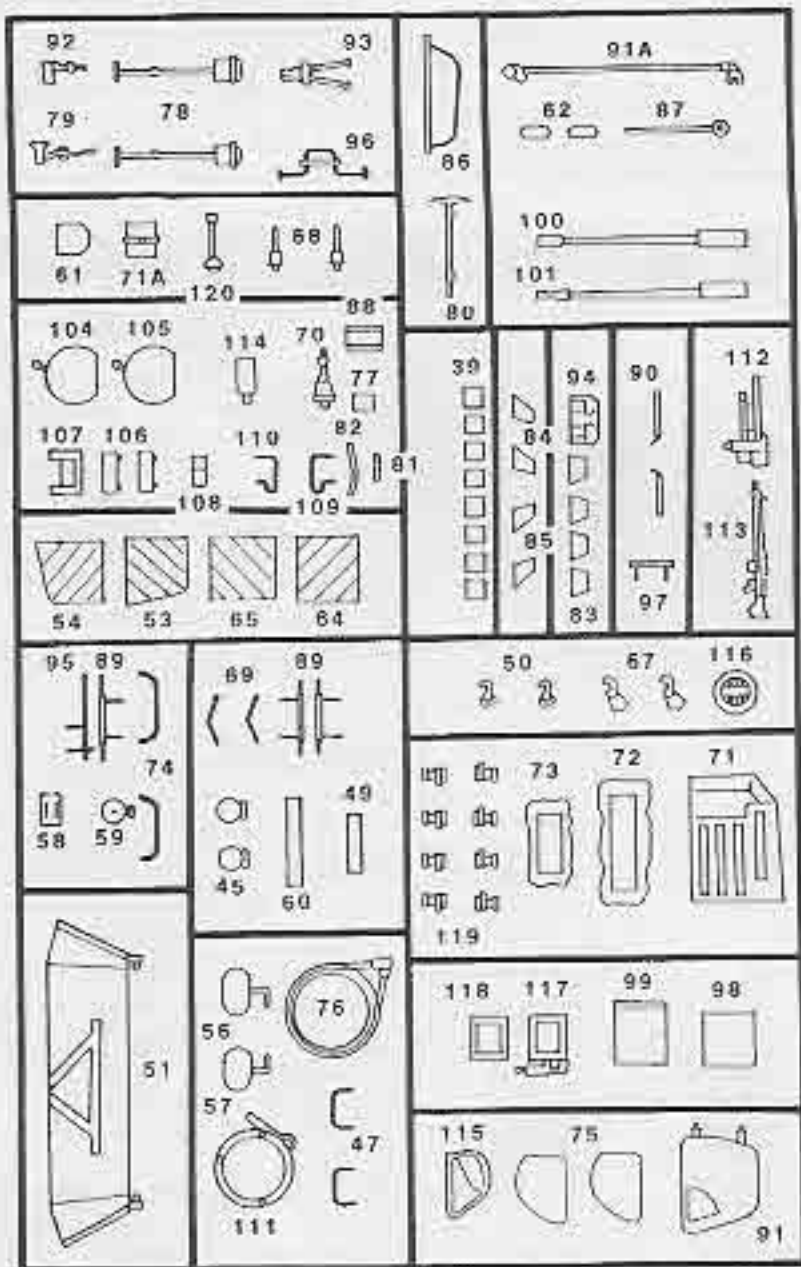
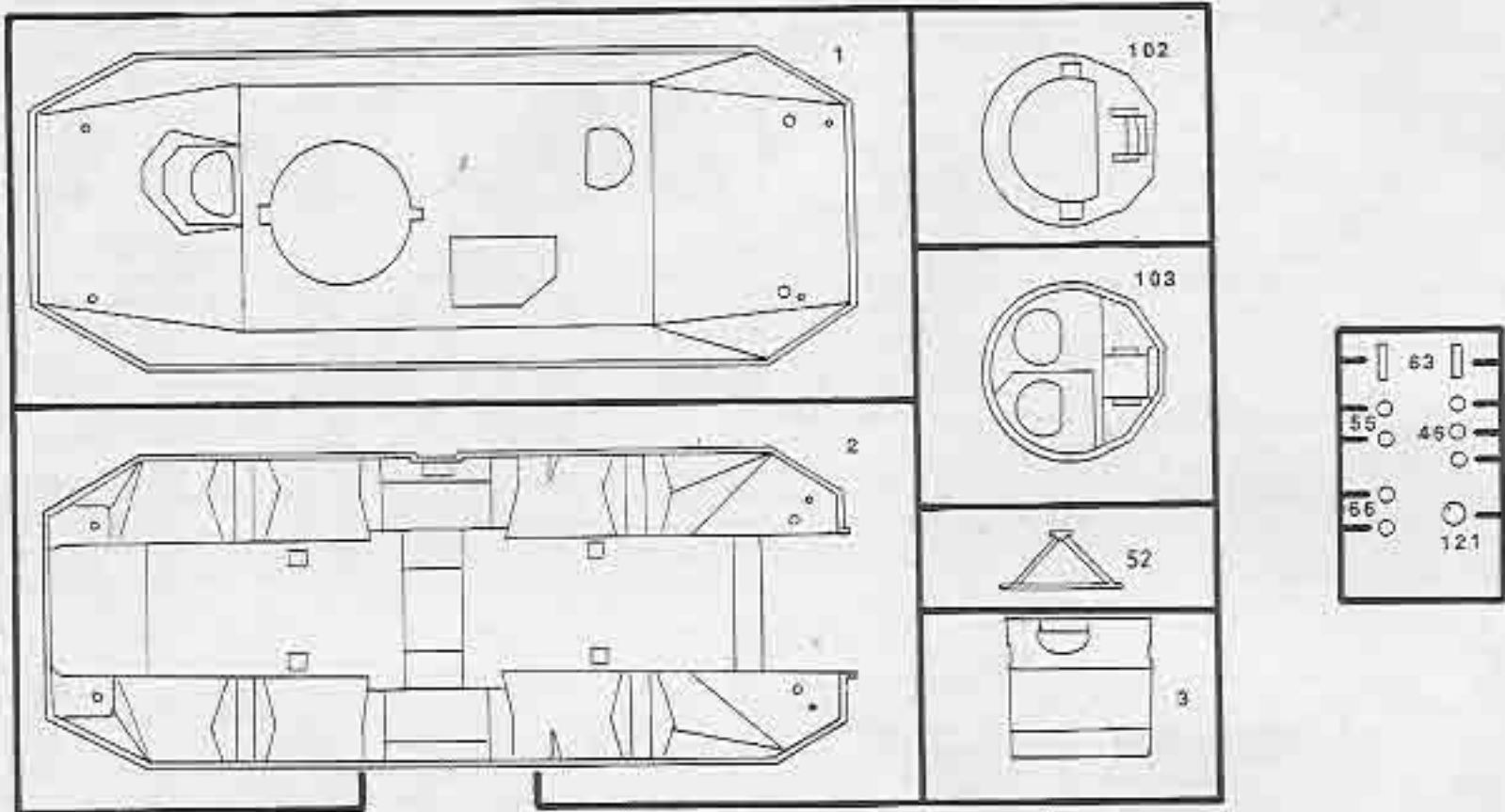

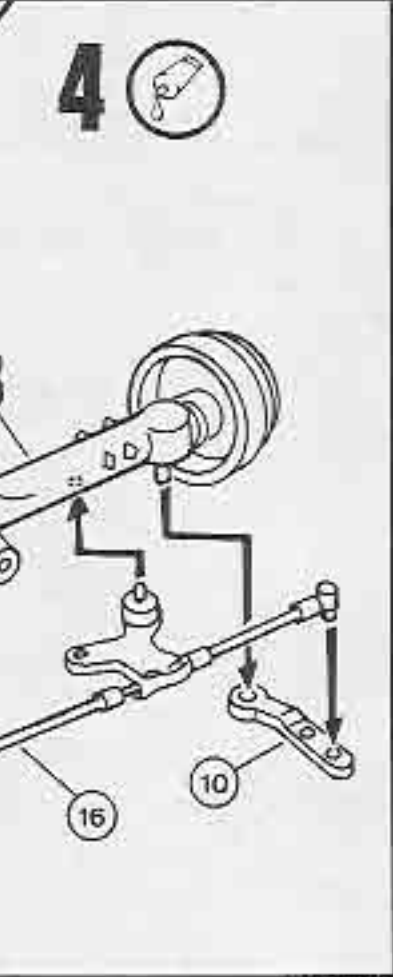
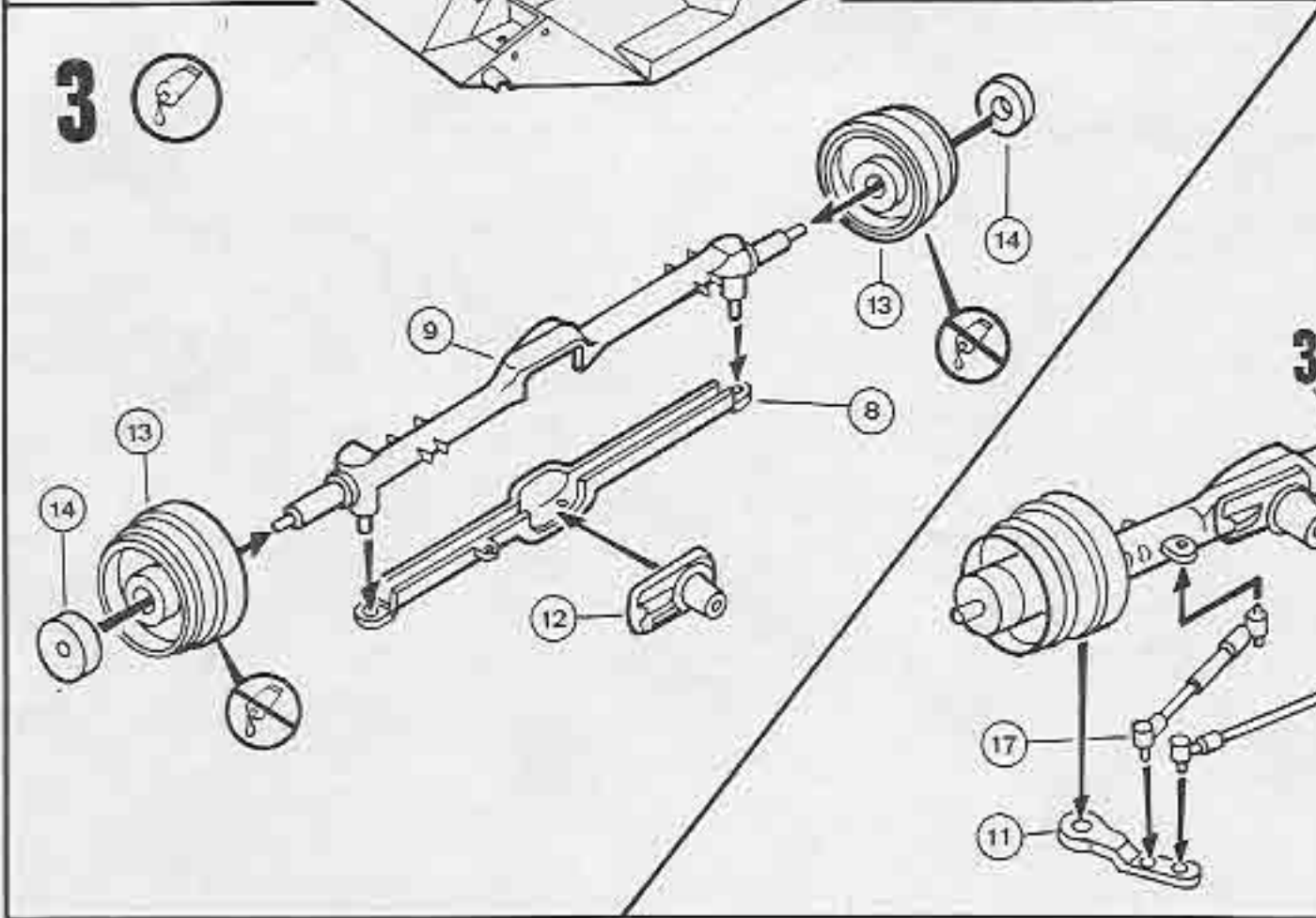
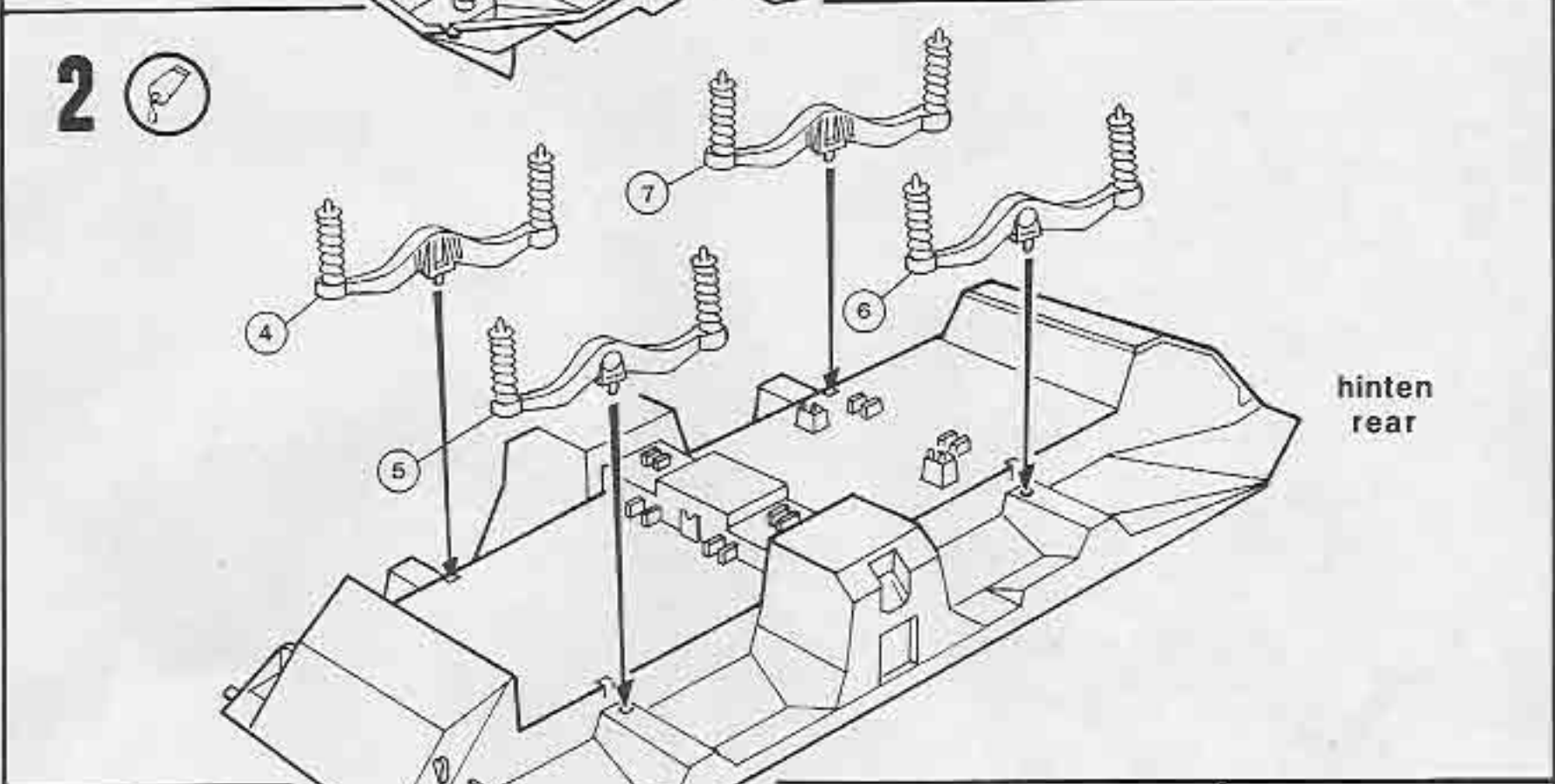
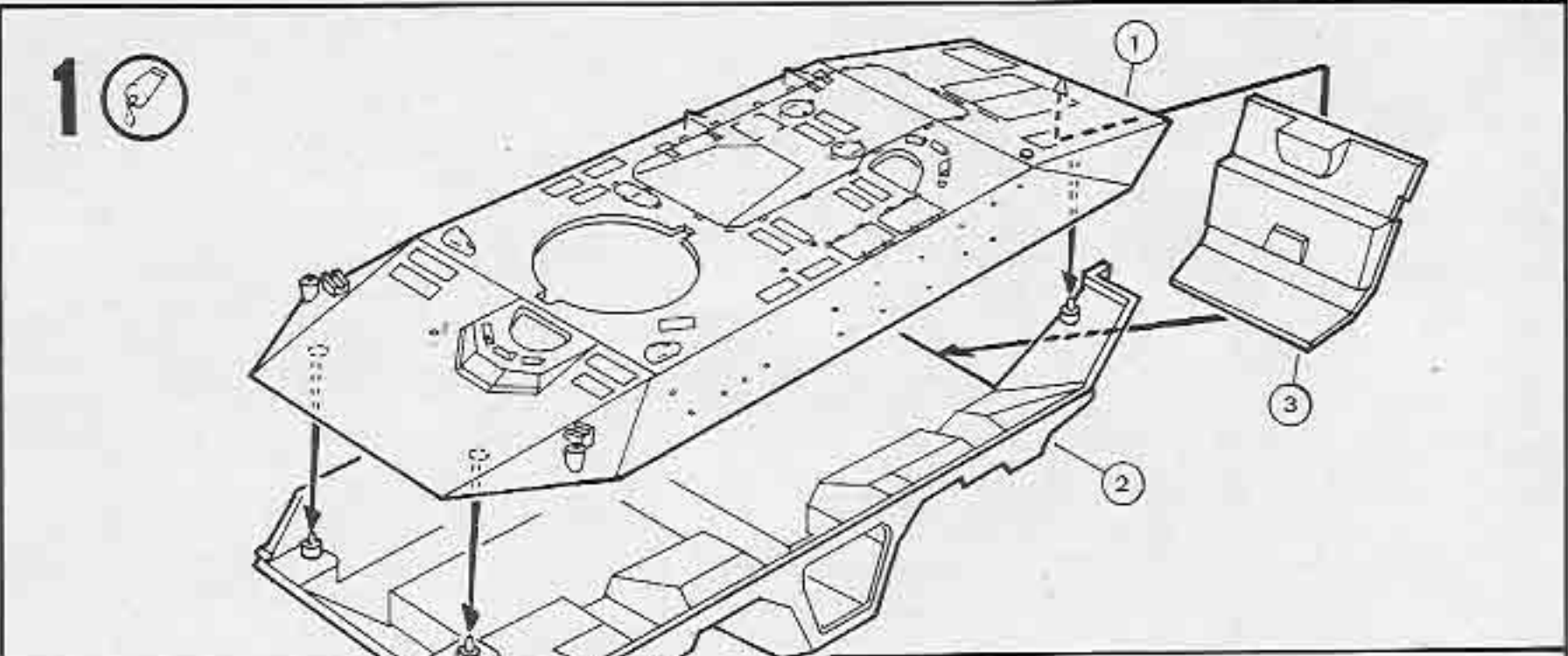

5 

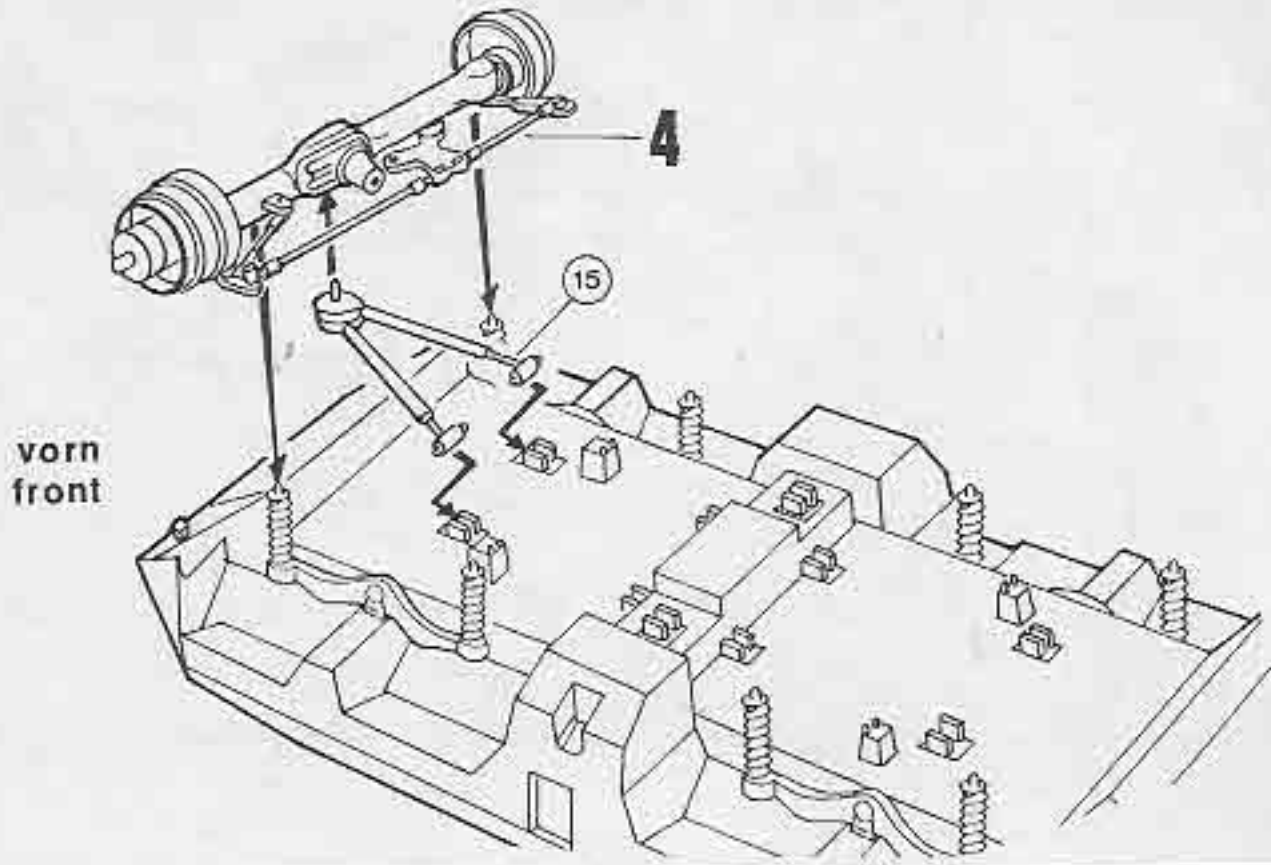

6 

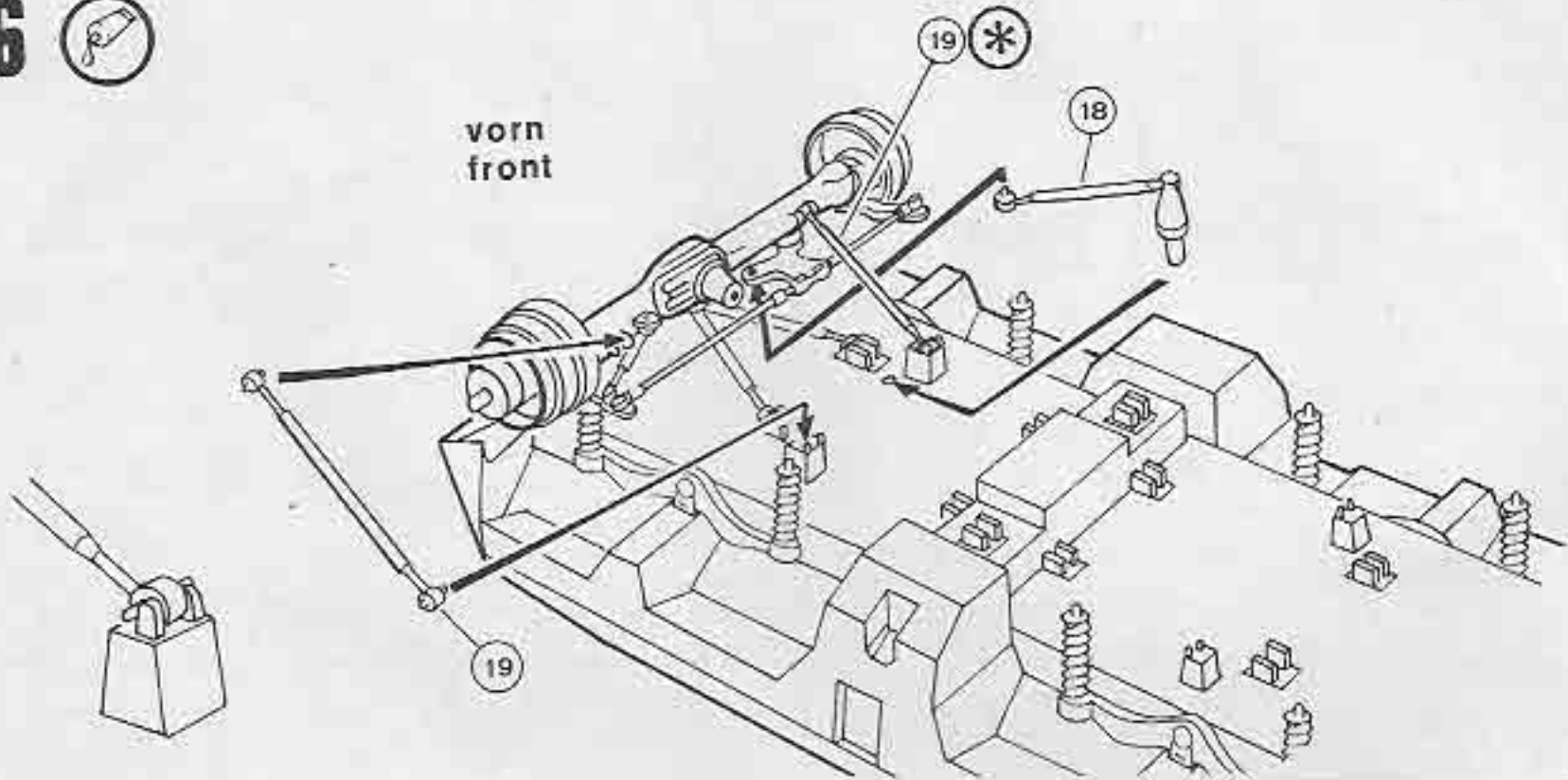

7 

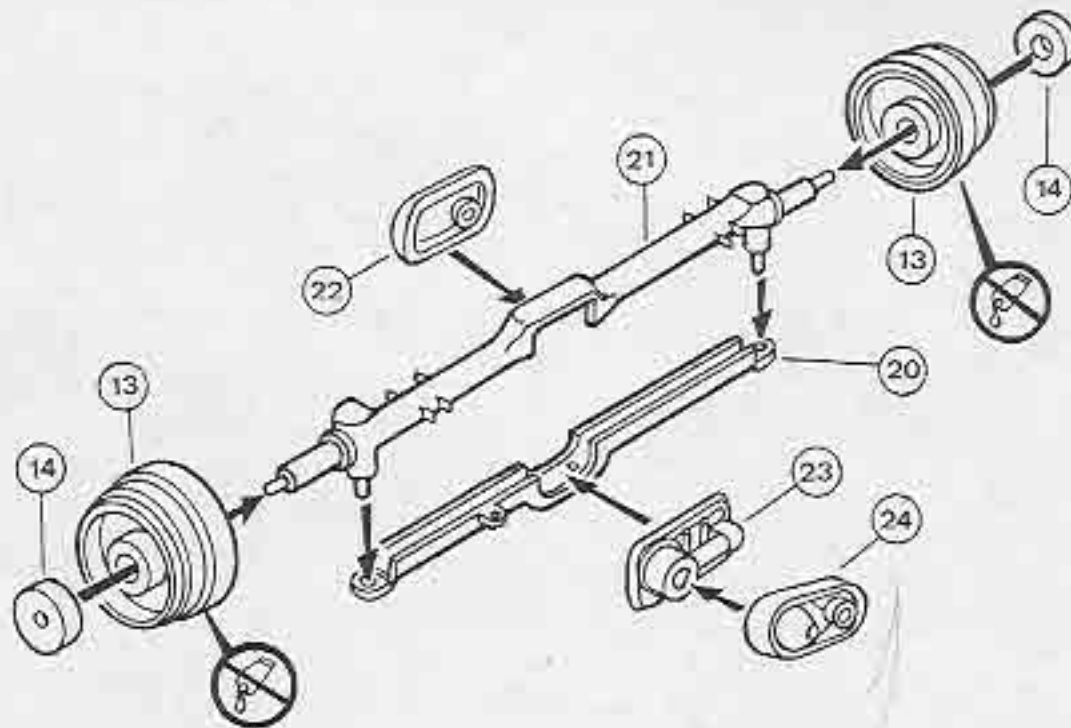

8 

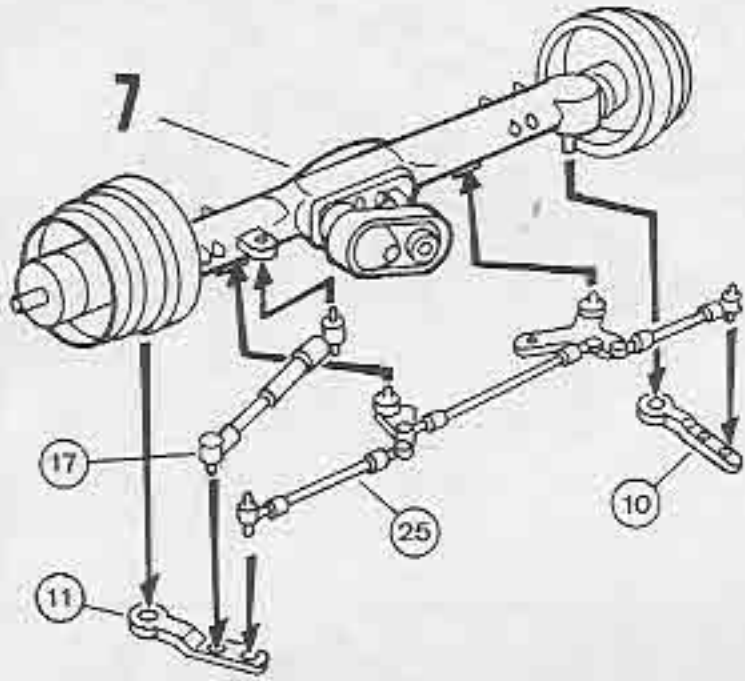

9 

vorn front

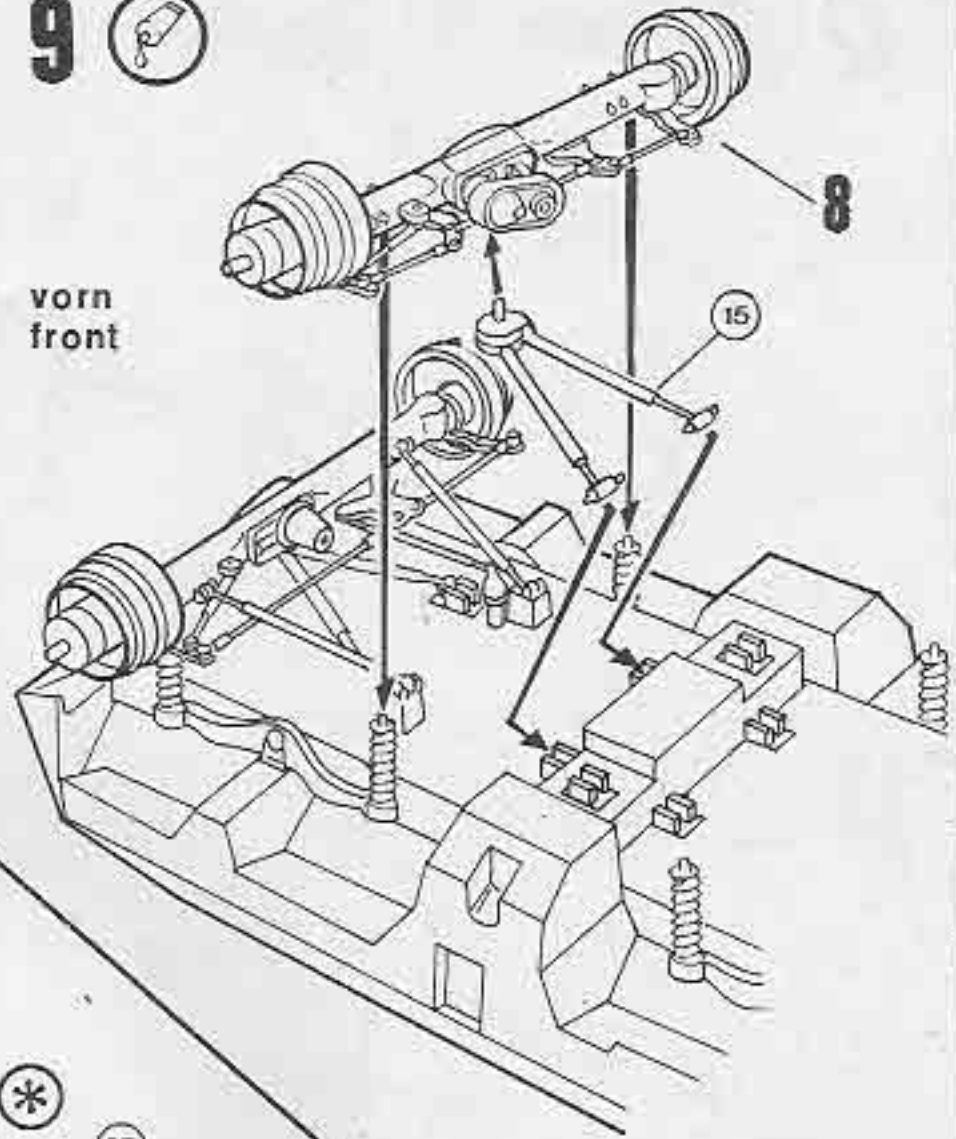

10 

vorn front

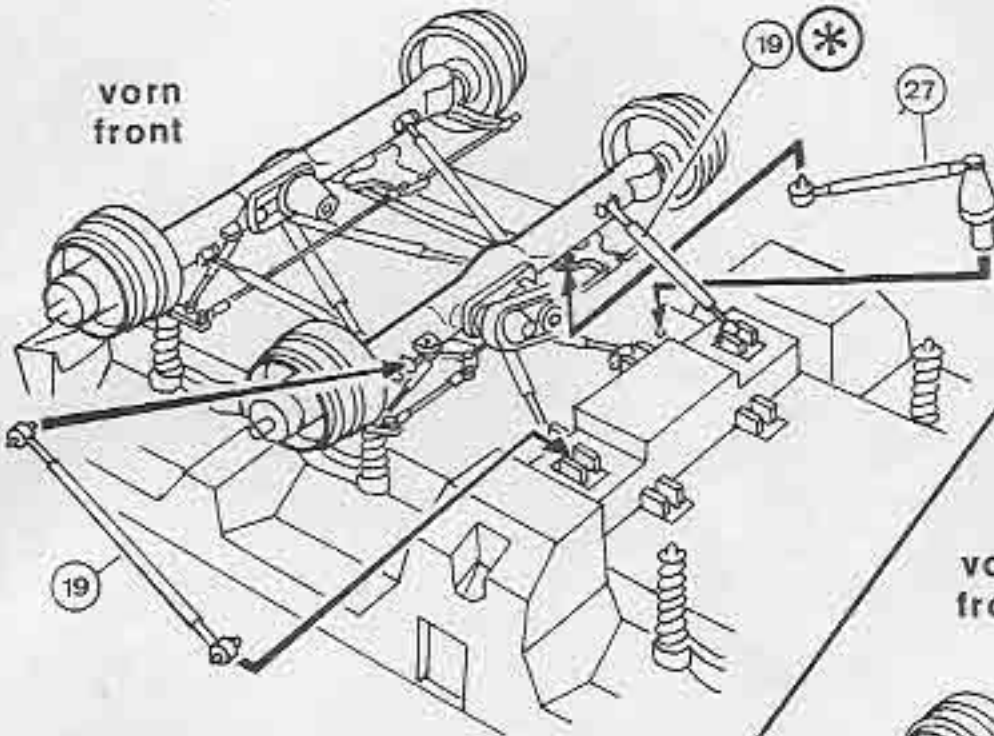

11 

vorn front

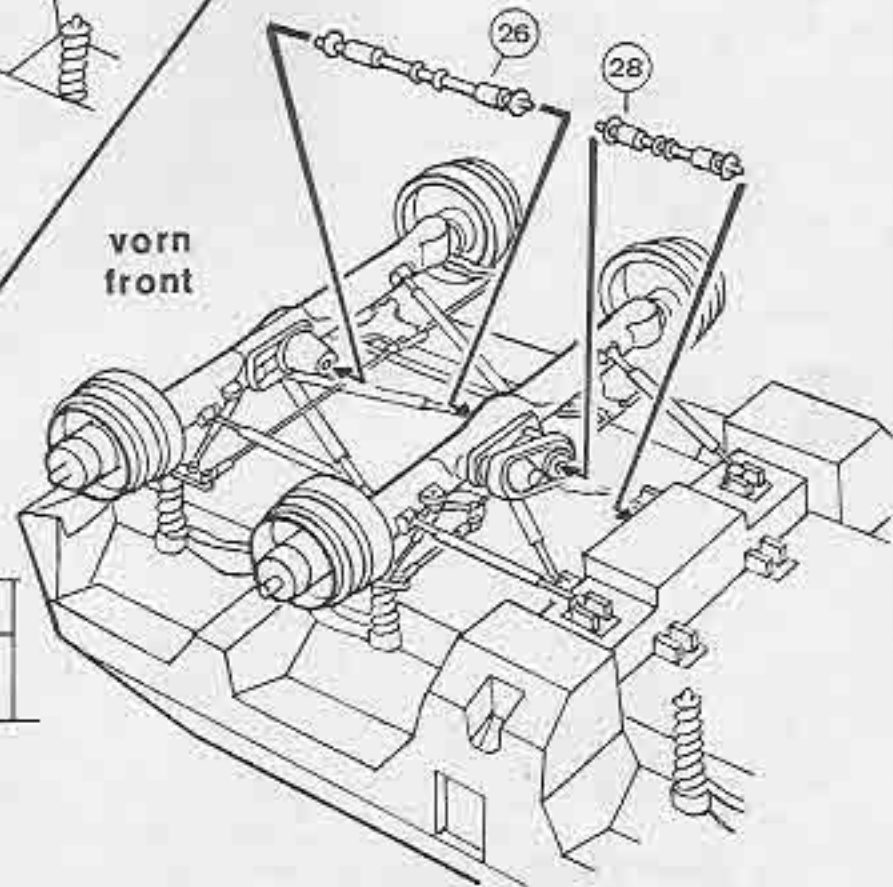

vorn front

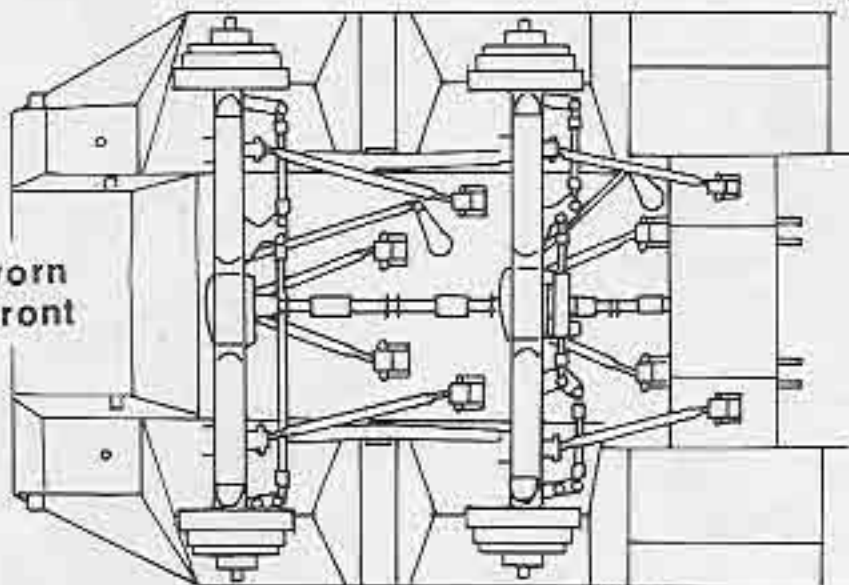

# 12

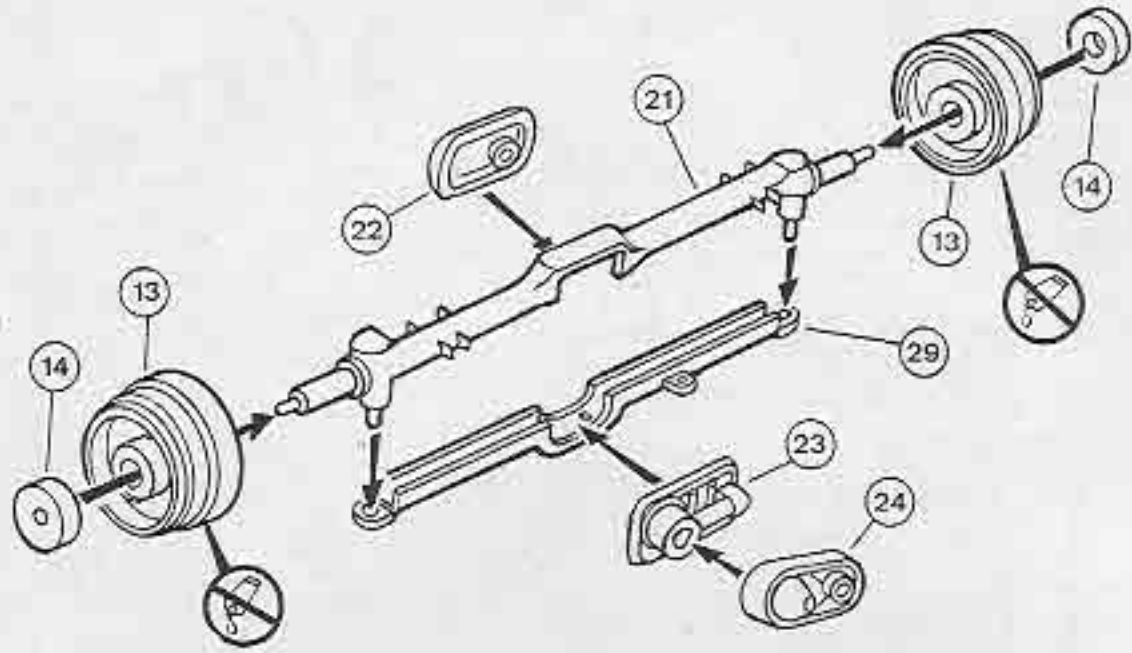

# 13

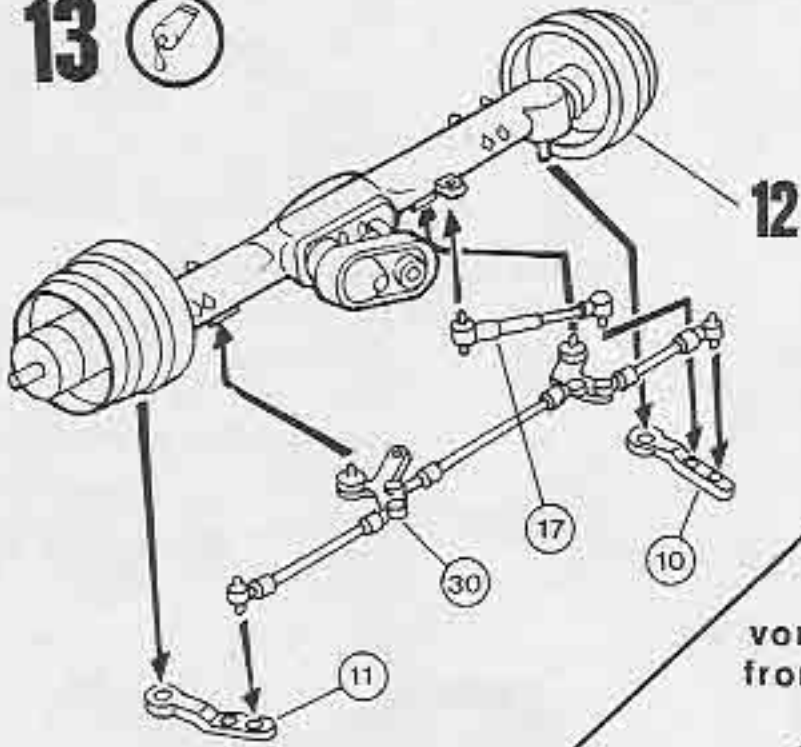

# 14

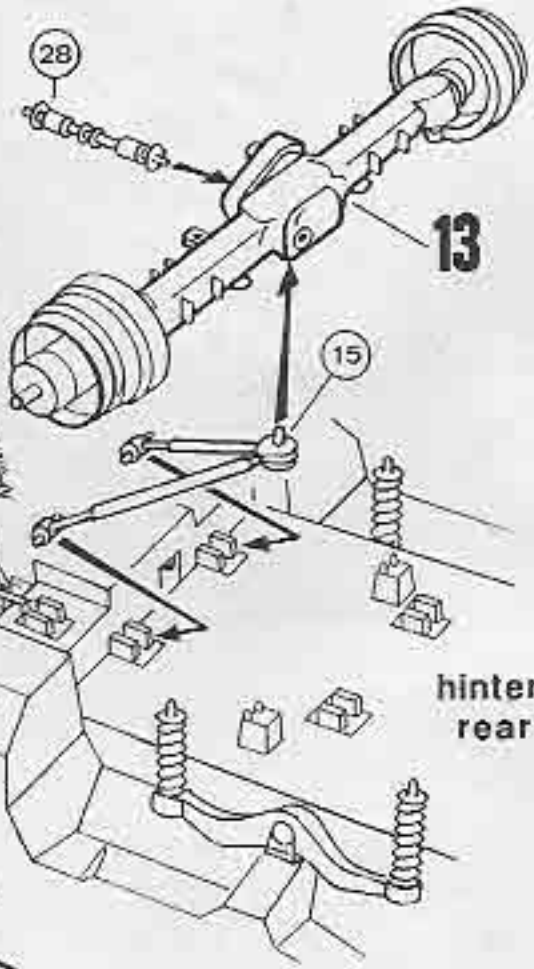

# 15

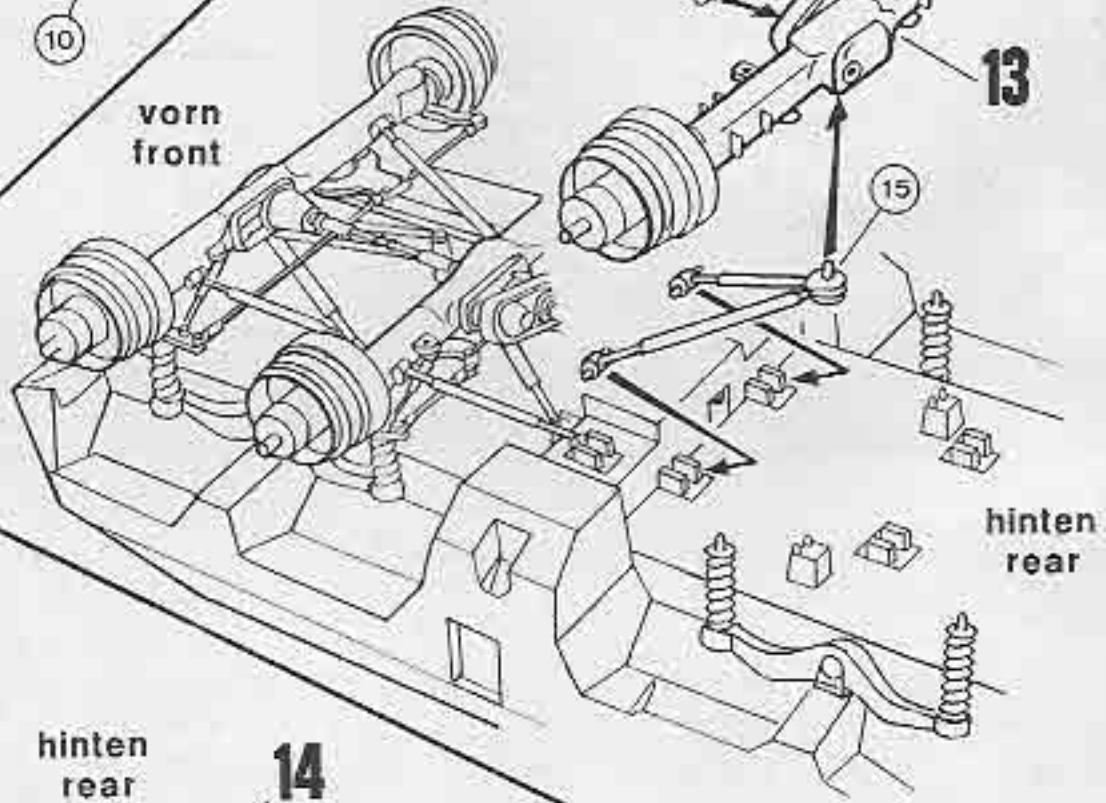
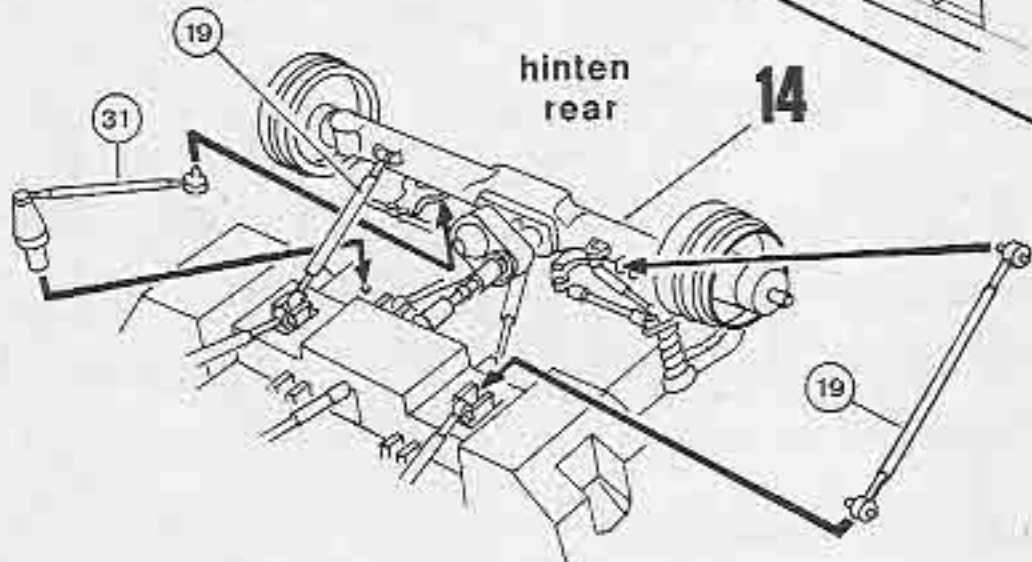



16 

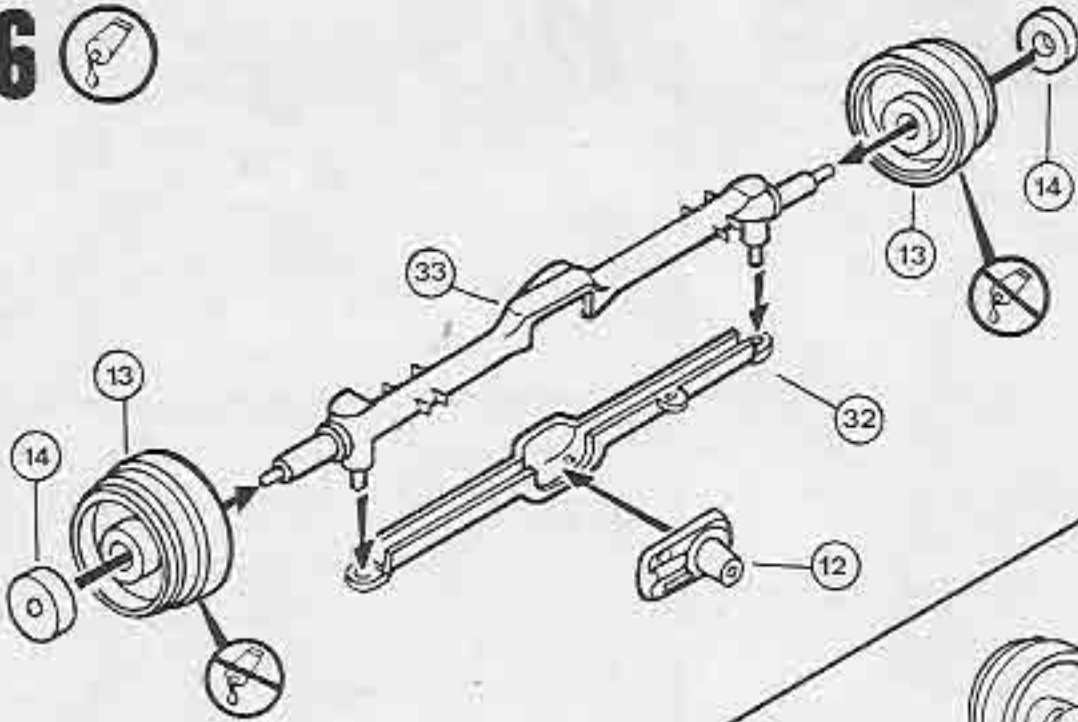

17 

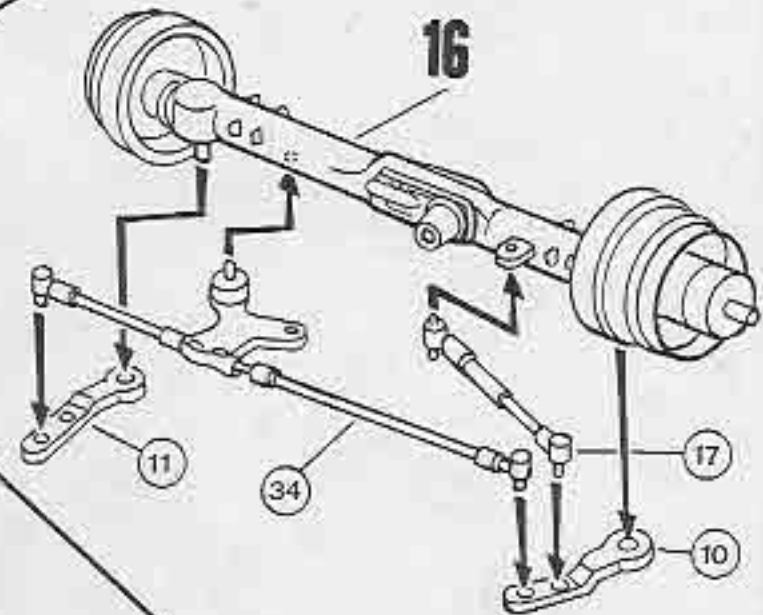

18 

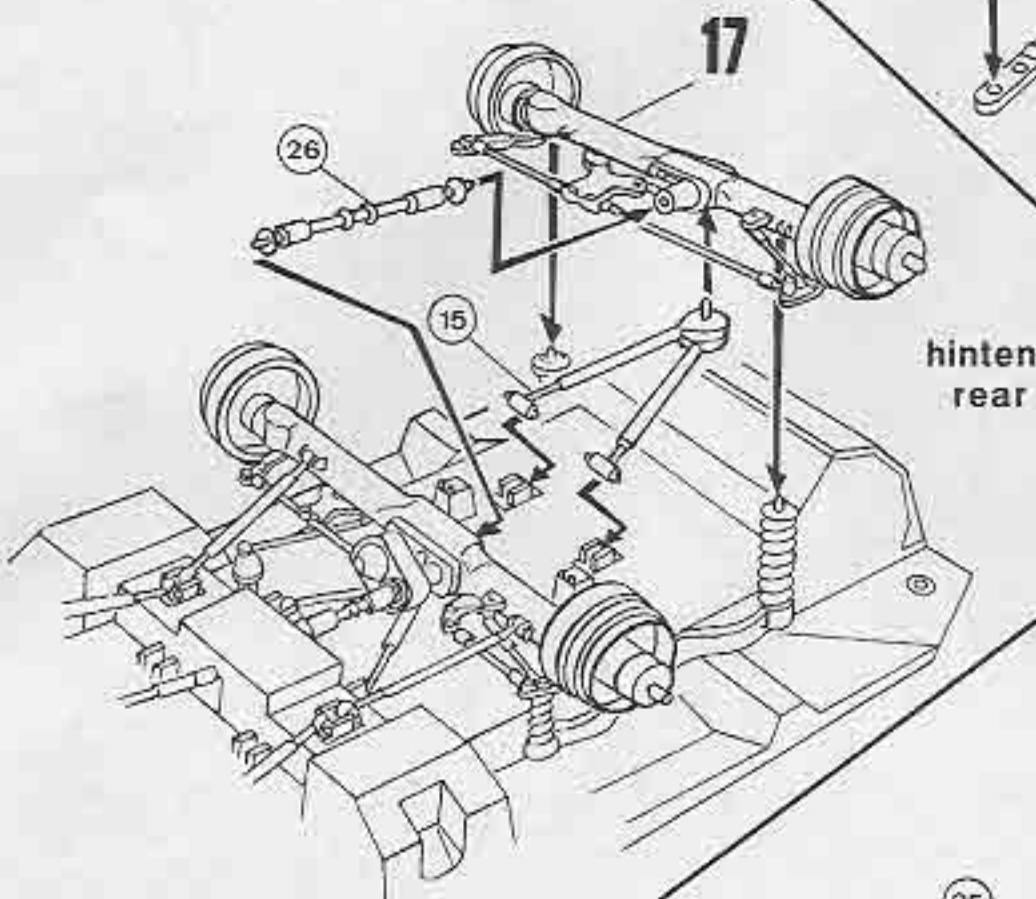

19 

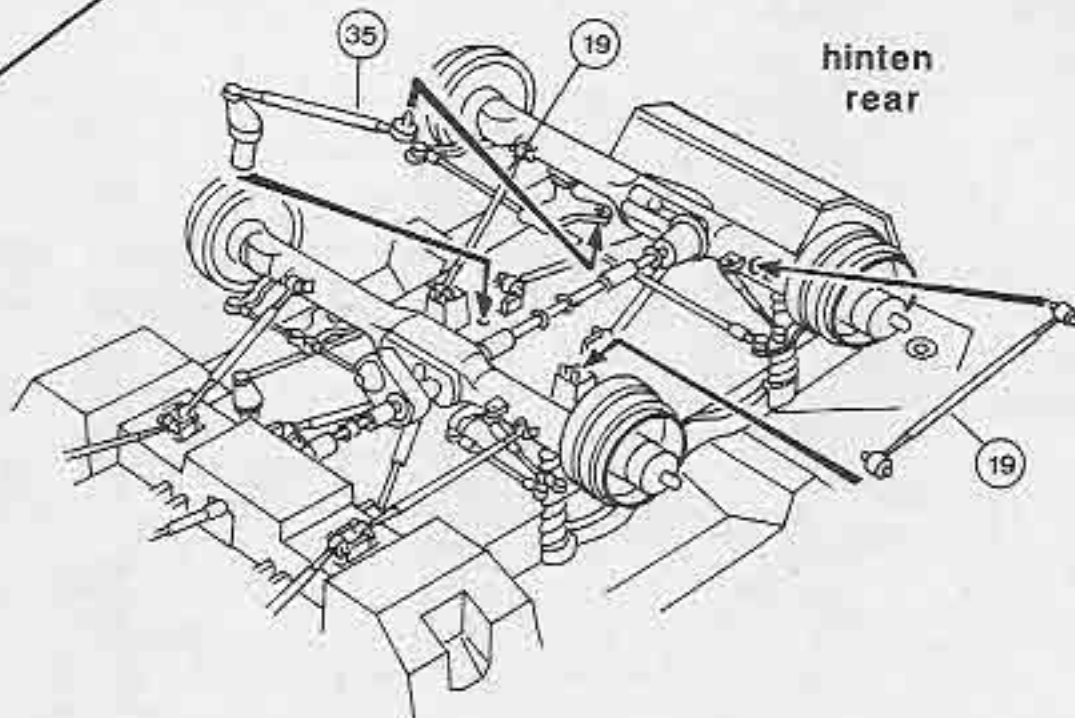

**20**  **4x**

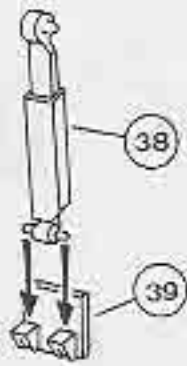

**21**  **4x**

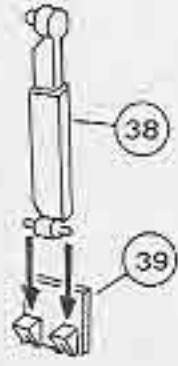

**22** 

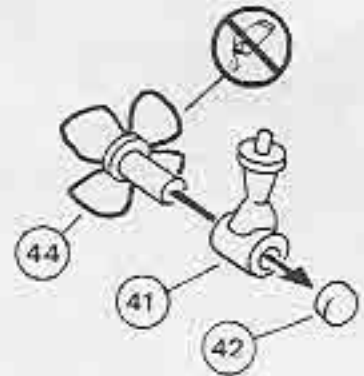

**23** 

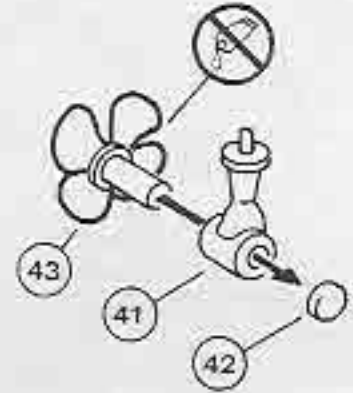

**24** 

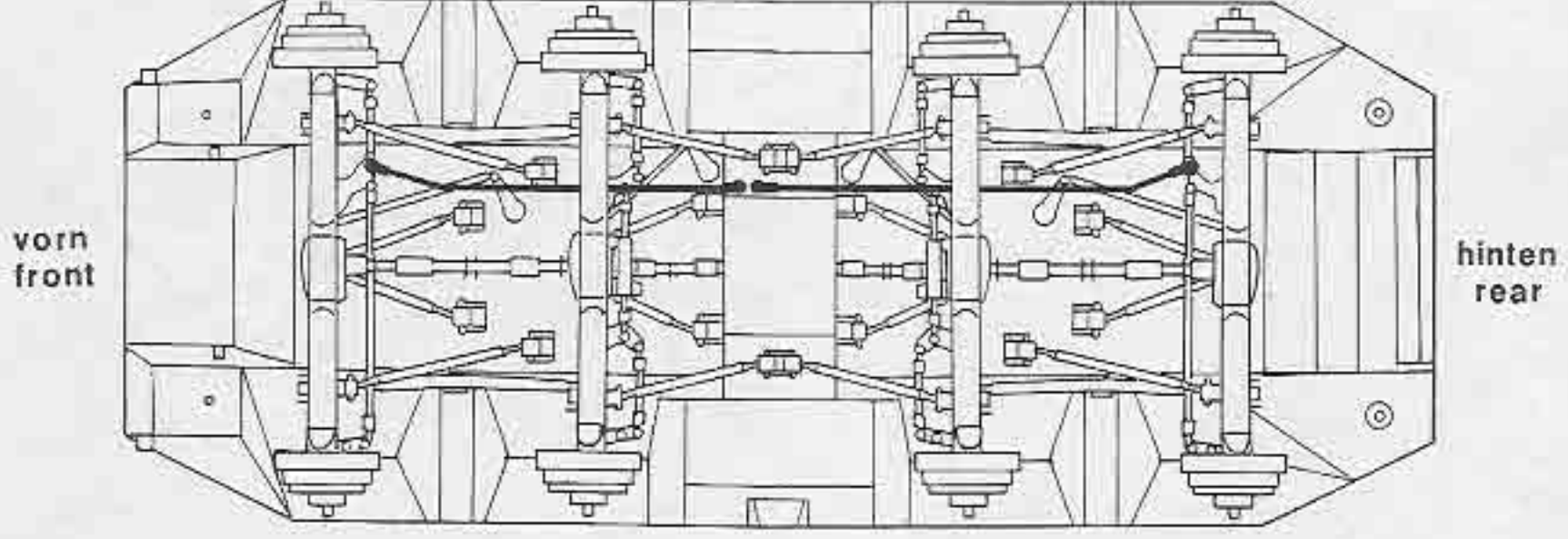
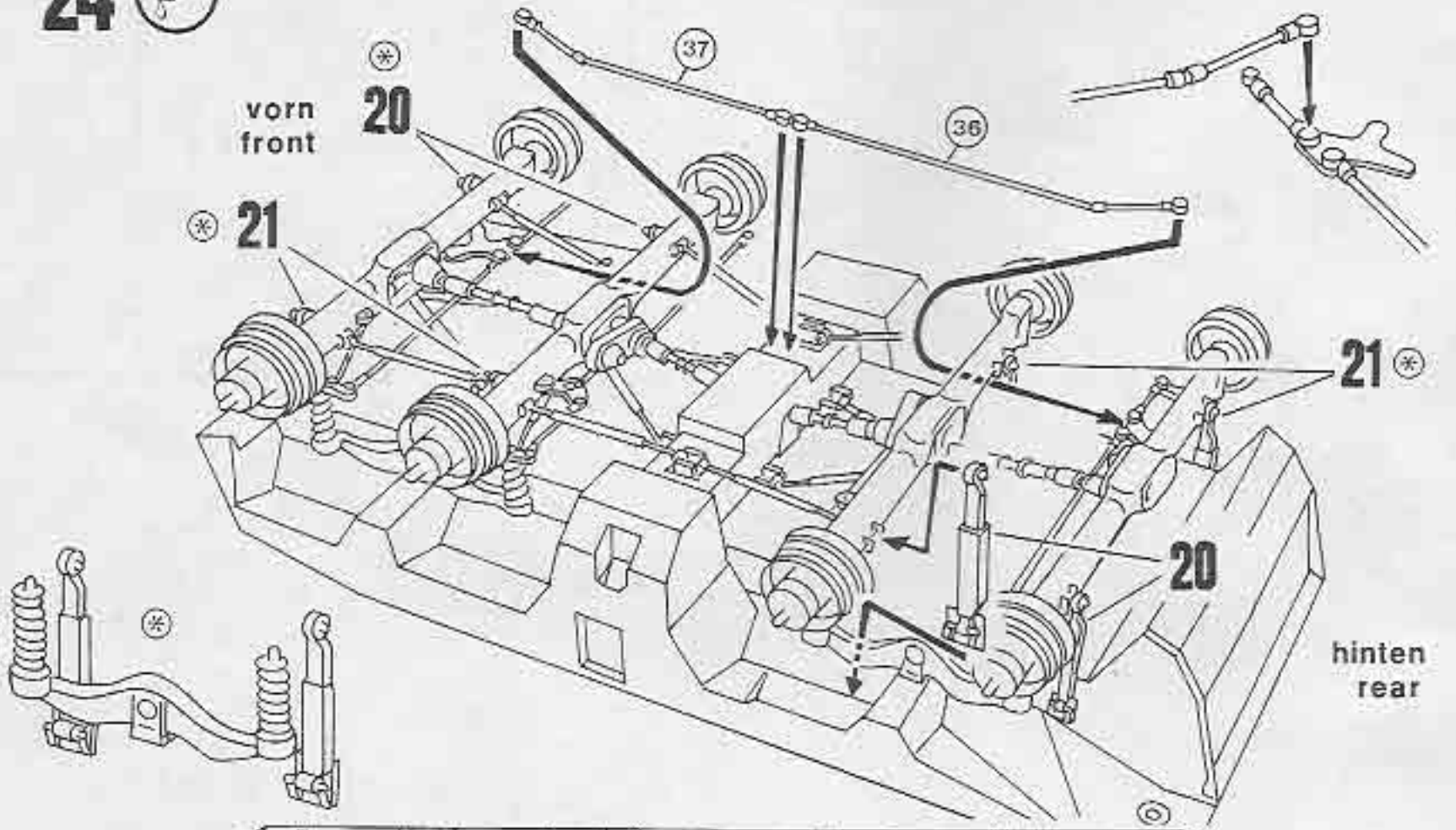

25  **8x**

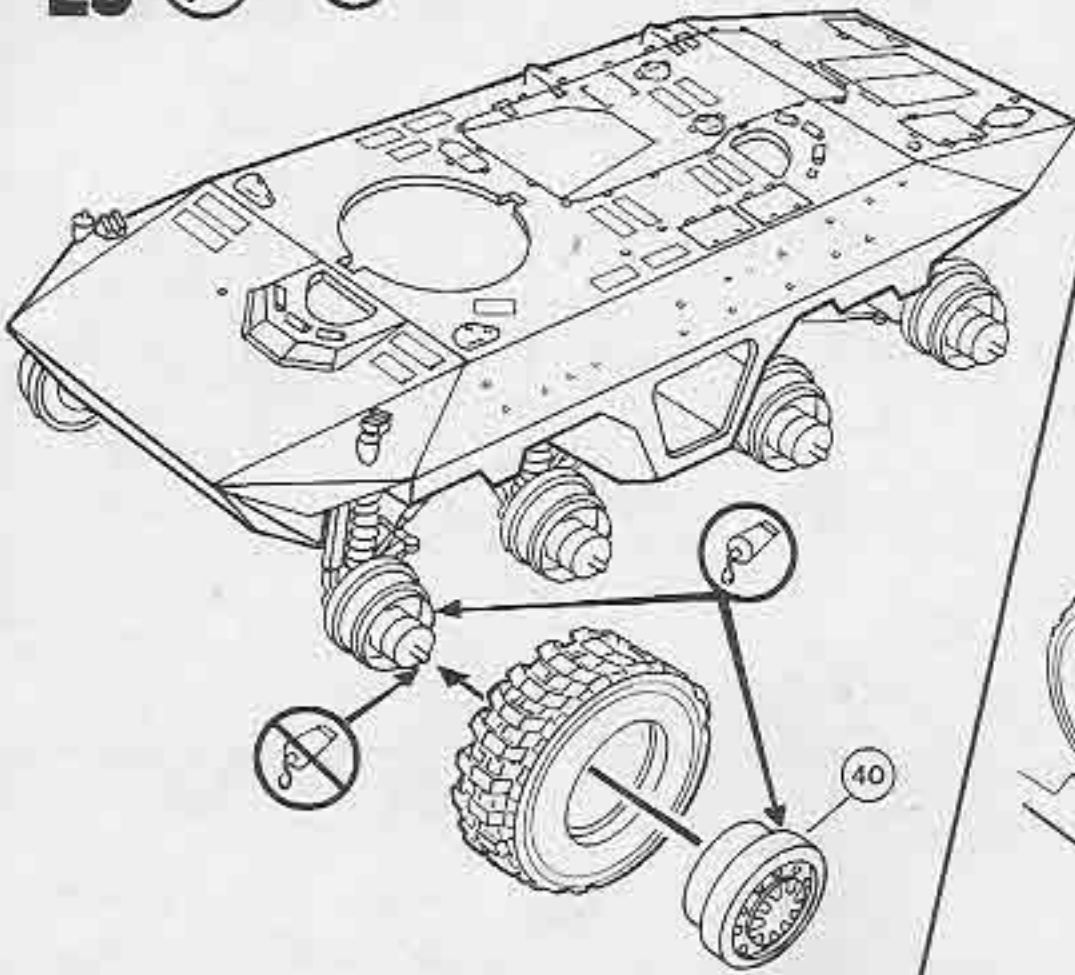

26 

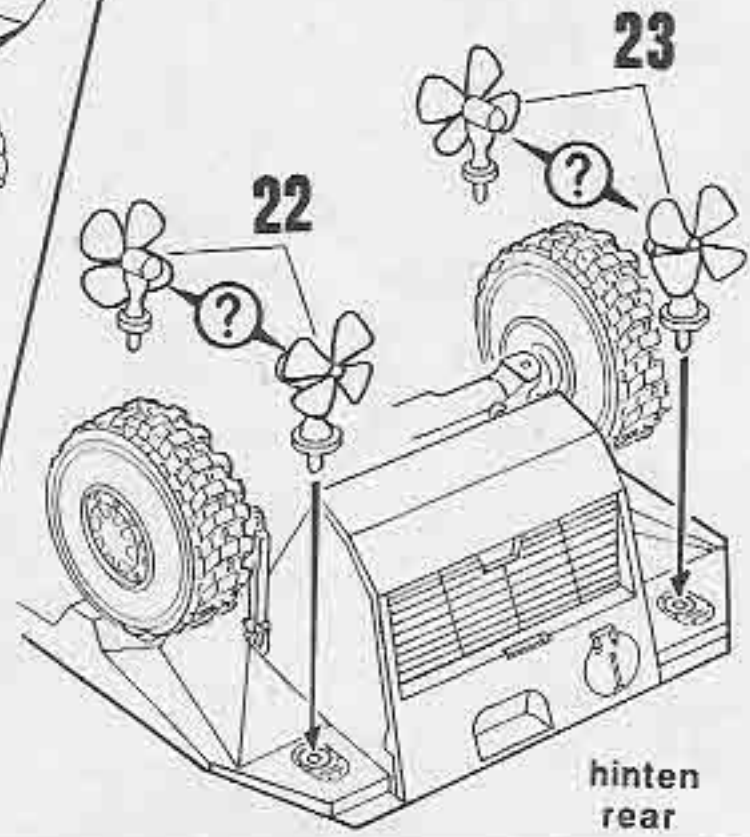

27 

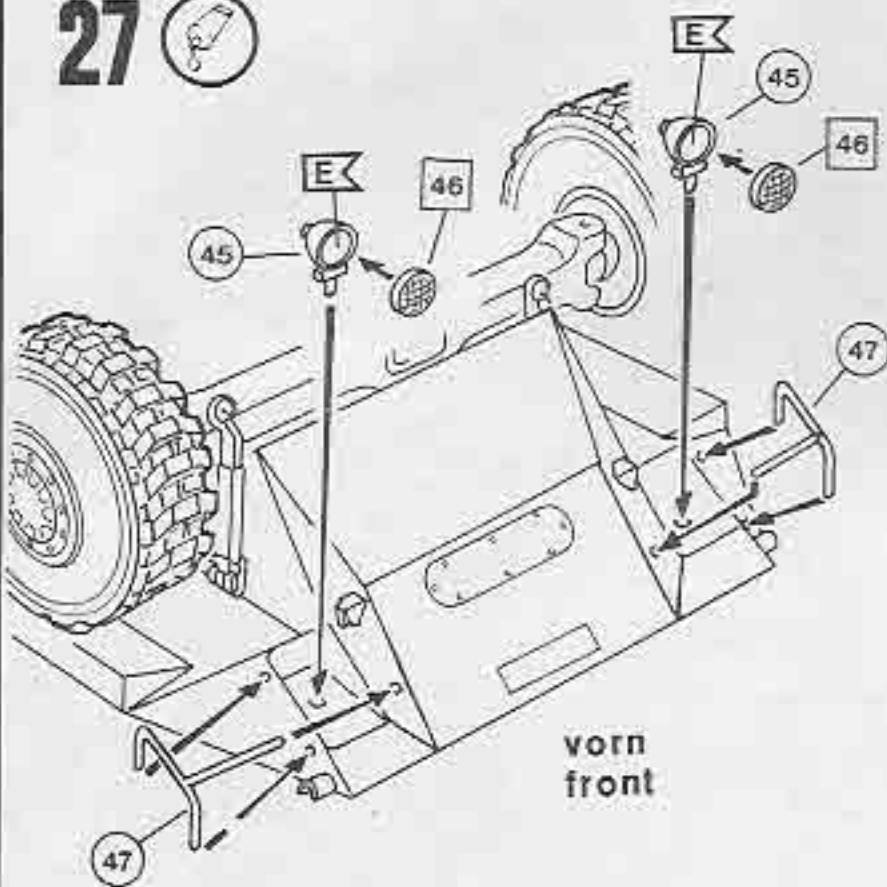

28 

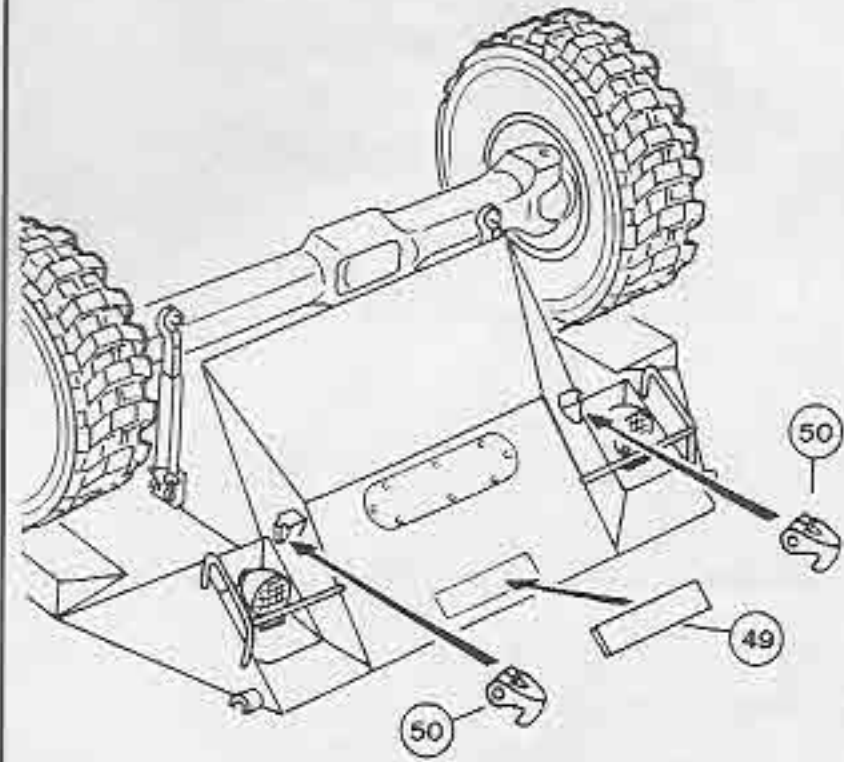

29 

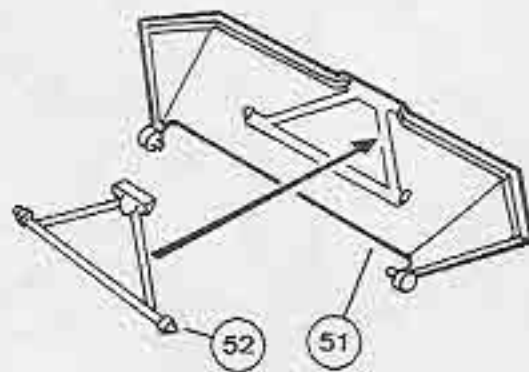

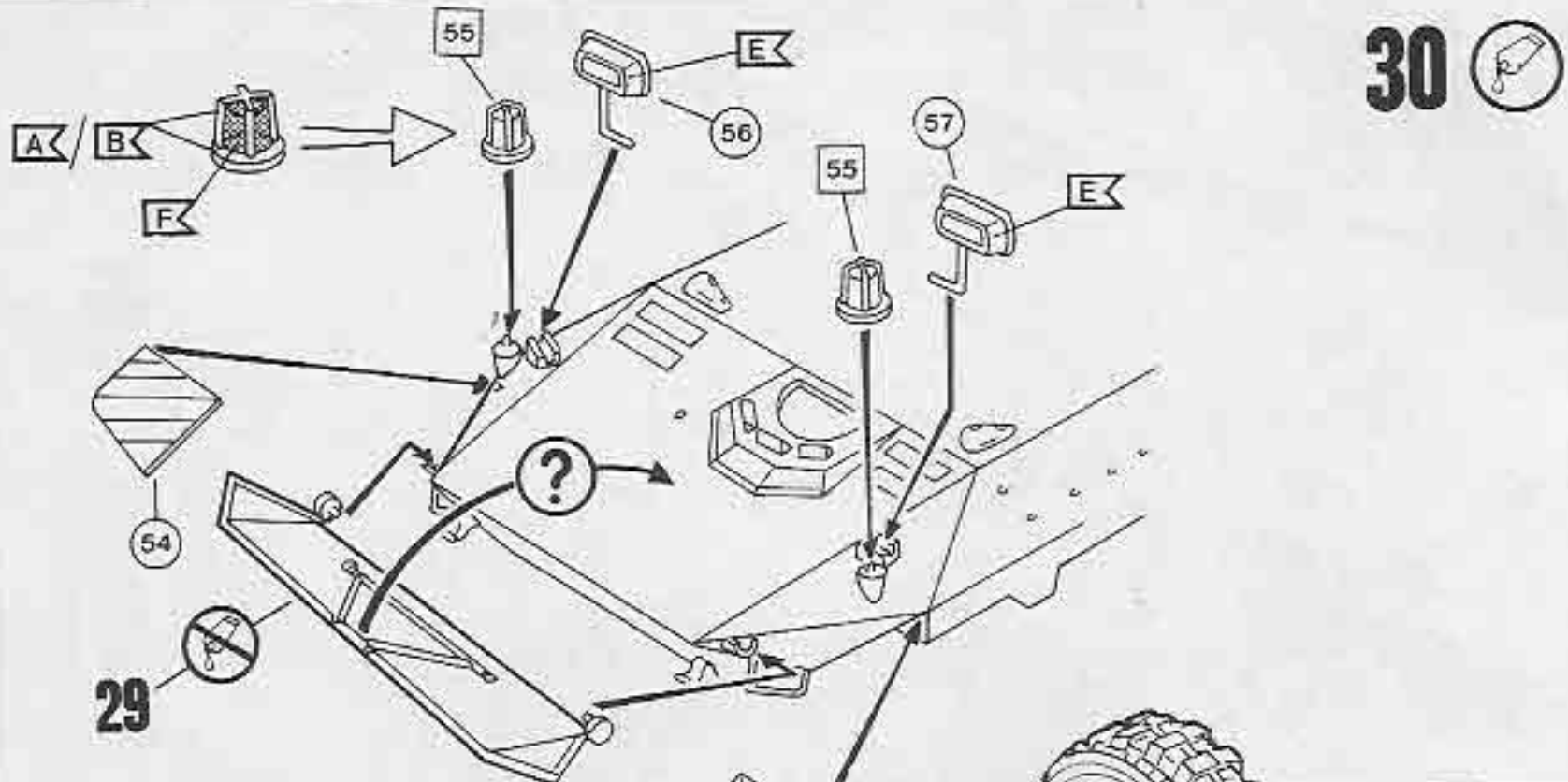

### 31

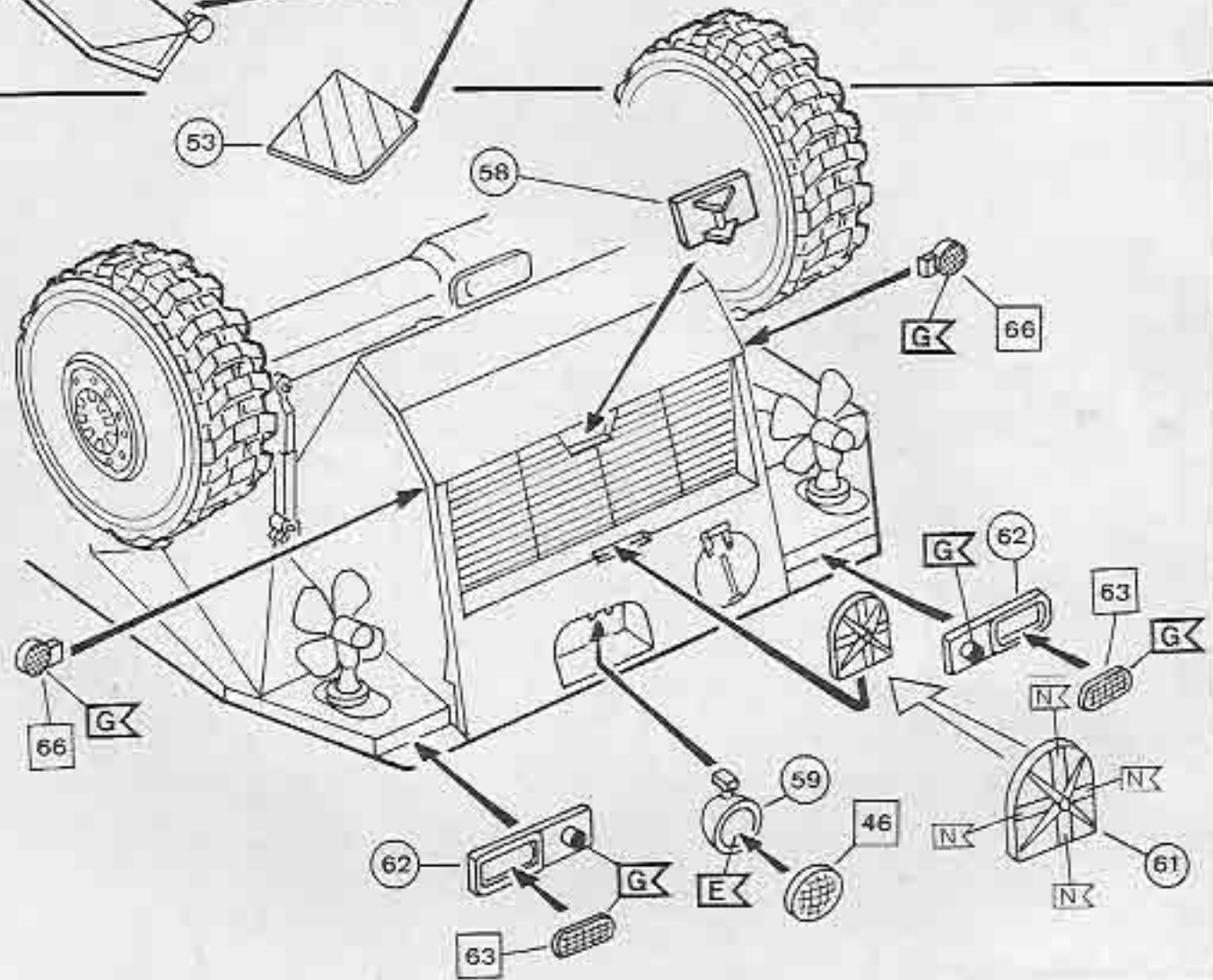

### 32

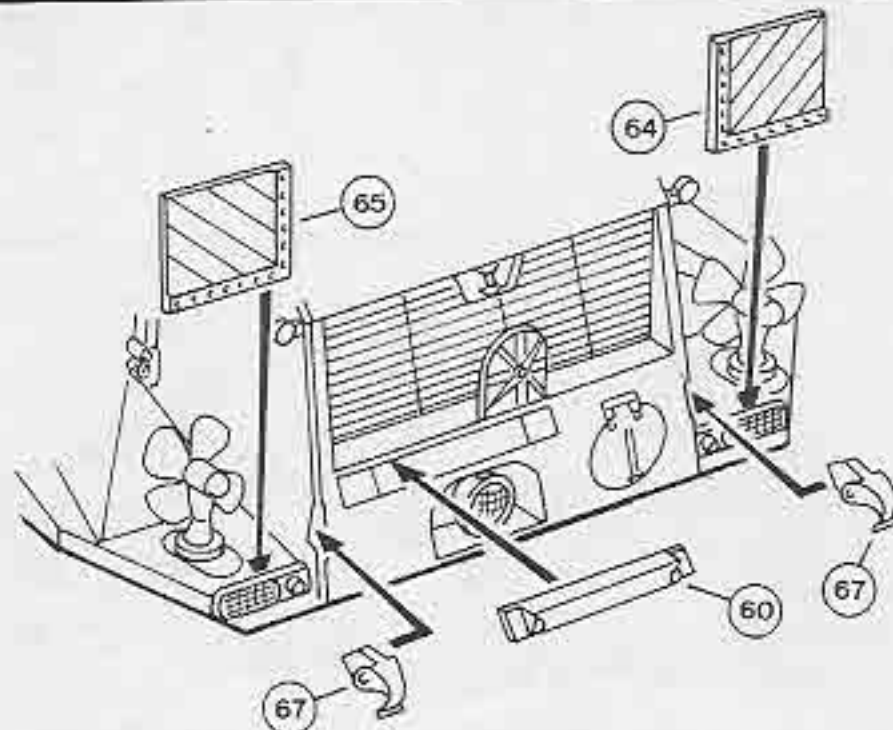

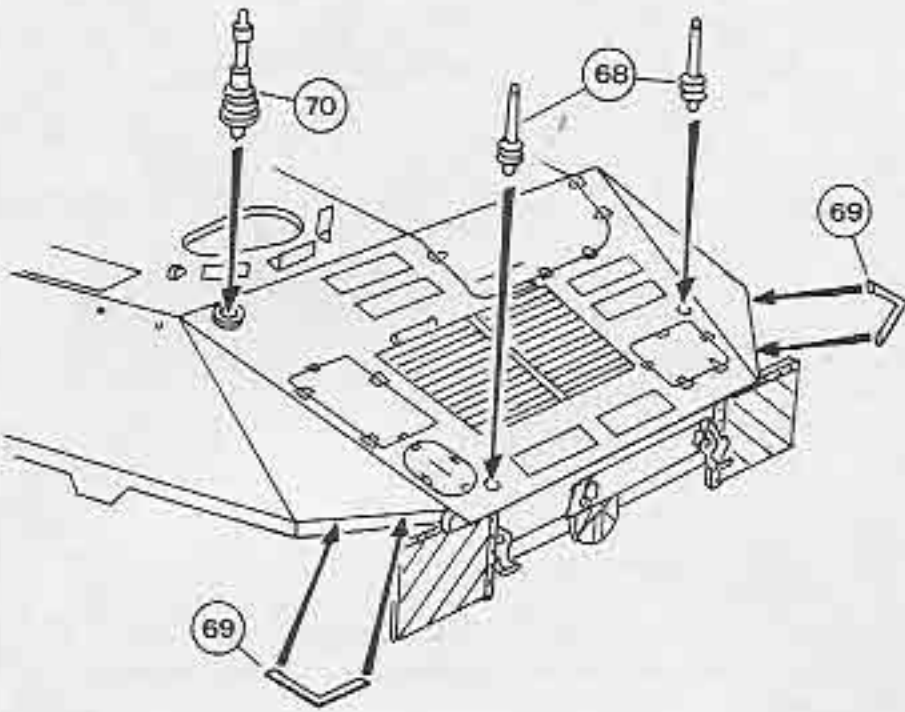
33 

34



2X

1

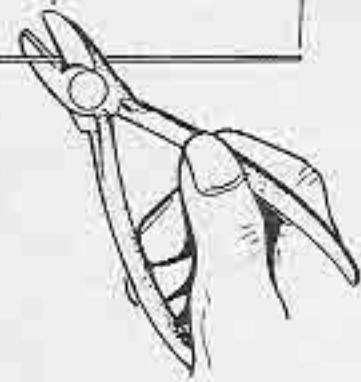

2

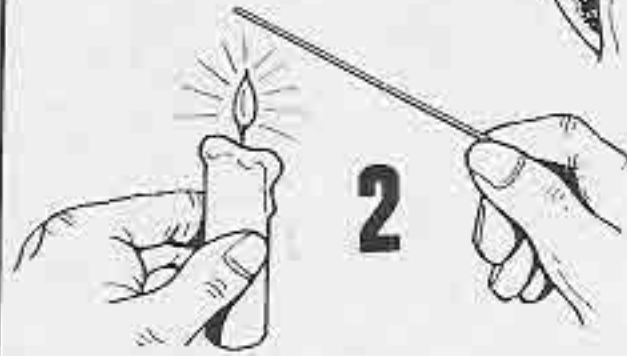

3

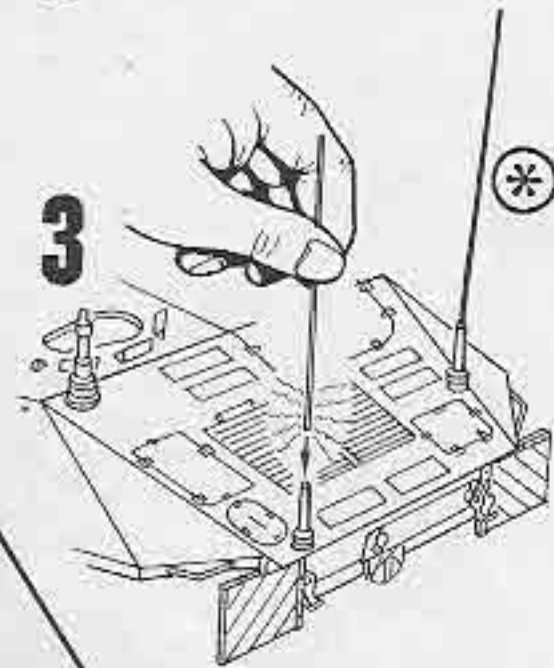
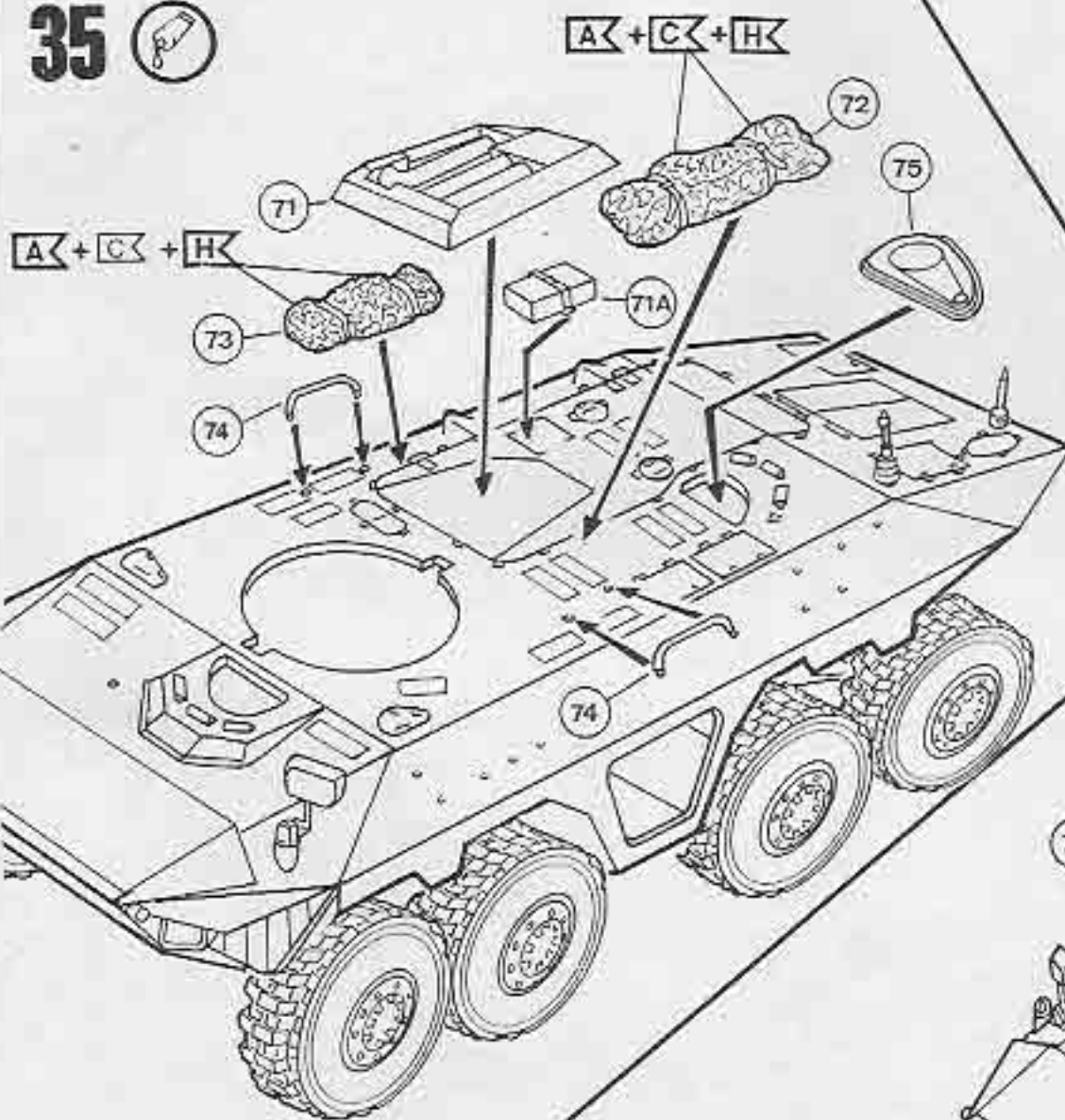
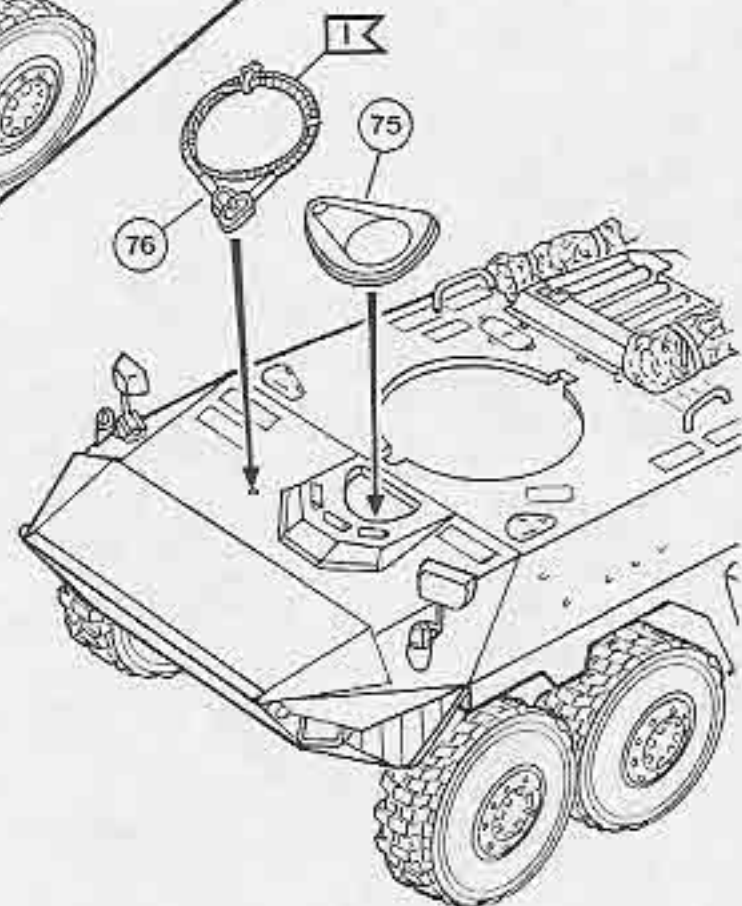
35 36 

# 37

rechte Seite  
right side

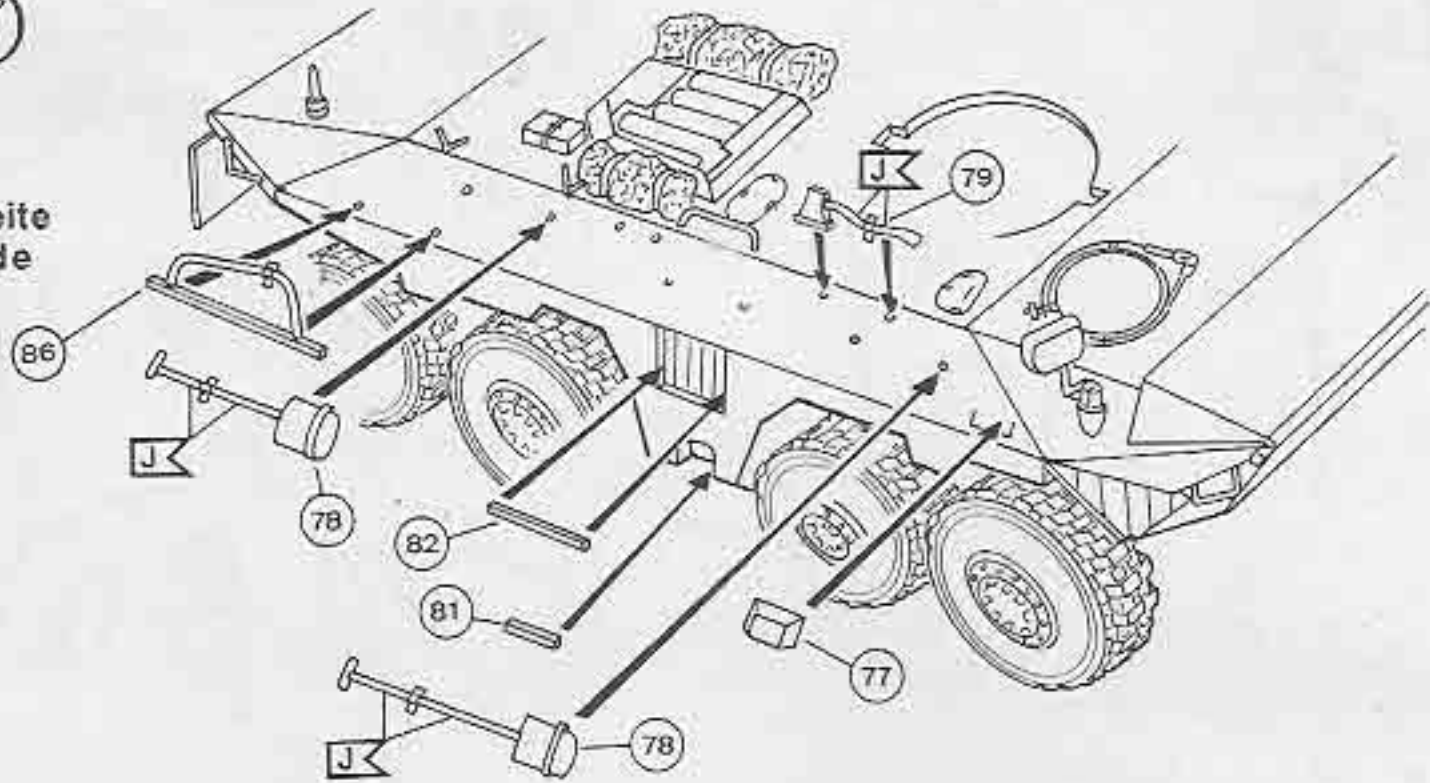

# 38

rechte Seite  
right side

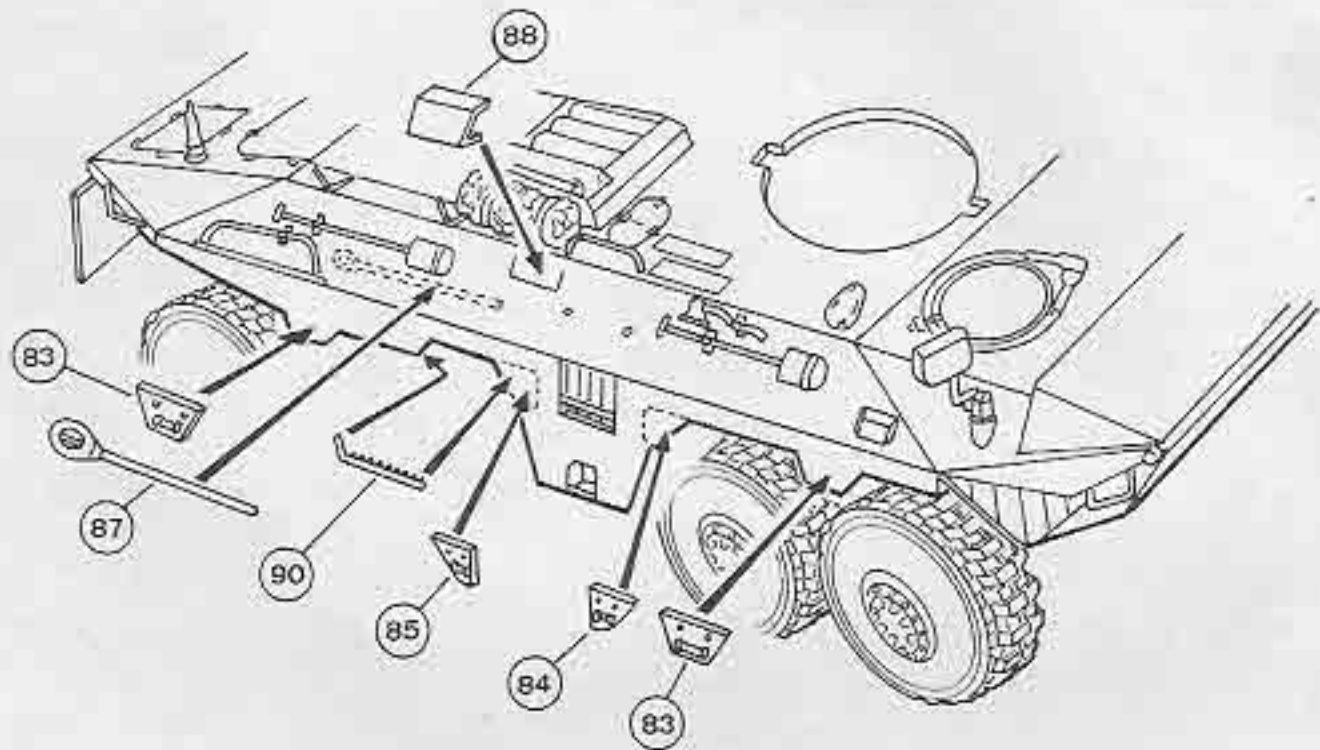

# 39

rechte Seite  
right side

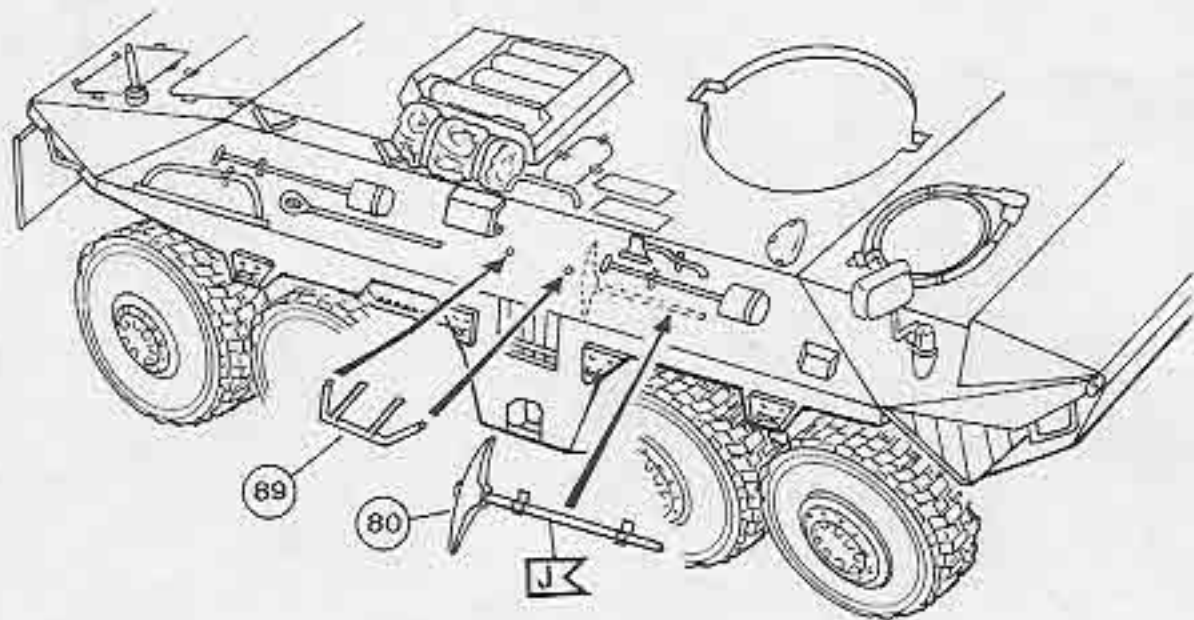

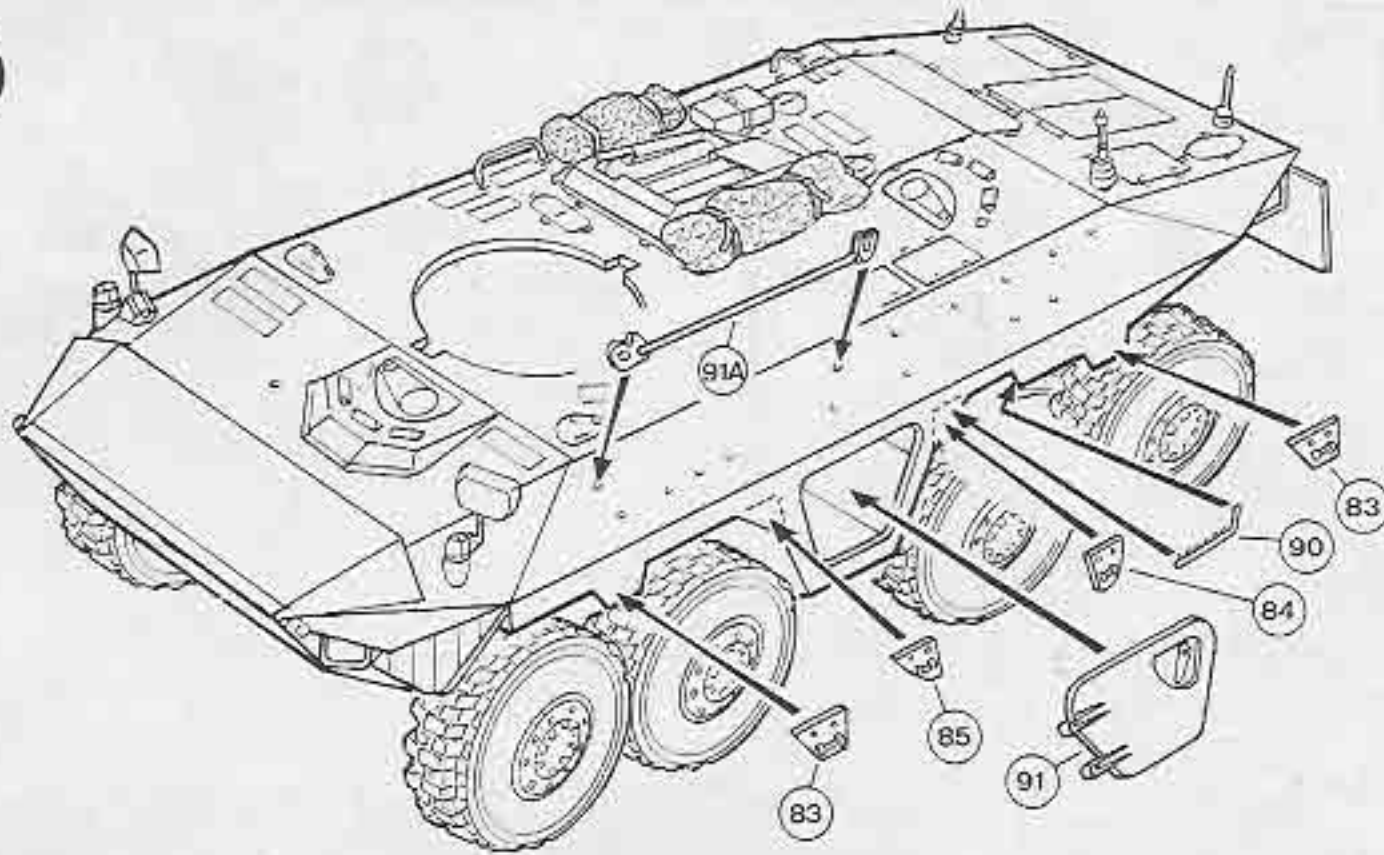
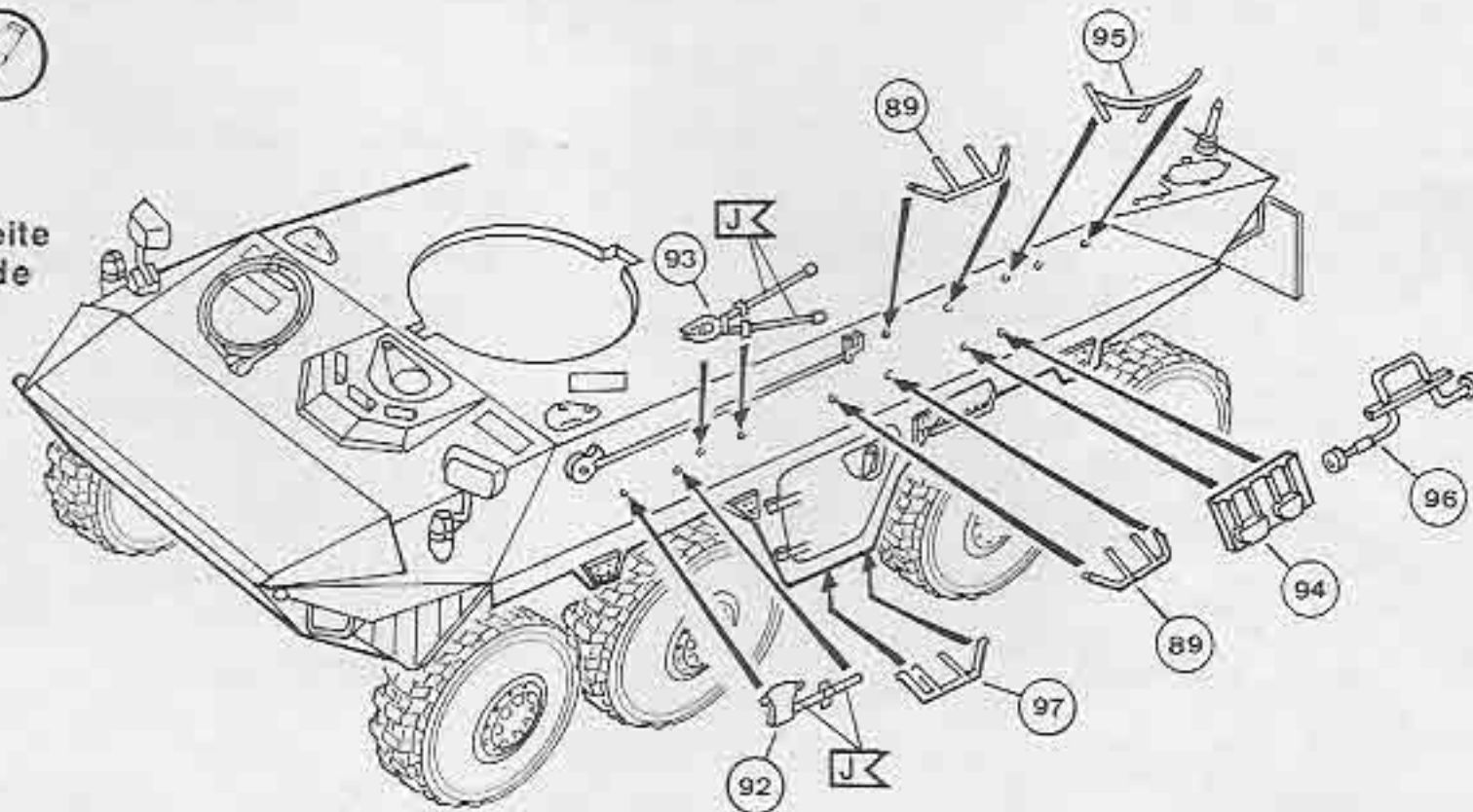
40 linke Seite  
left side41 linke Seite  
left side42 

49/50

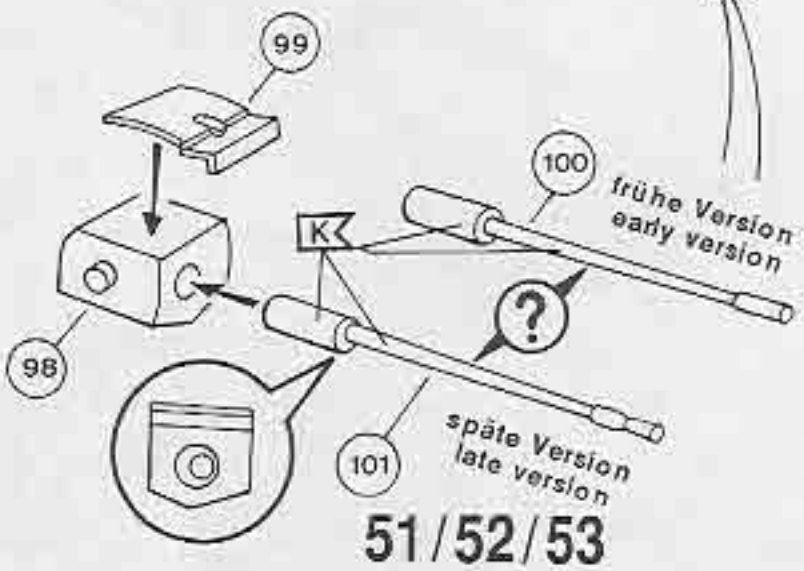
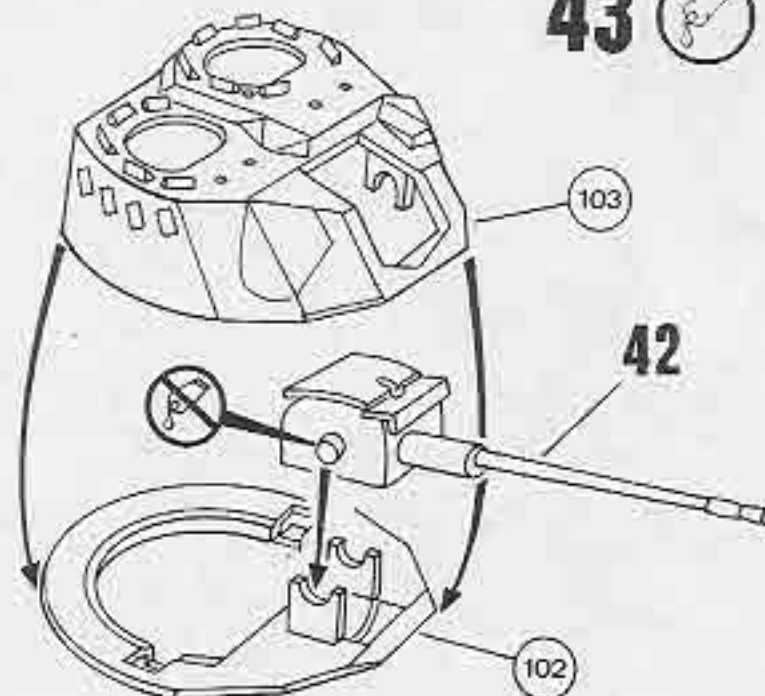
43 

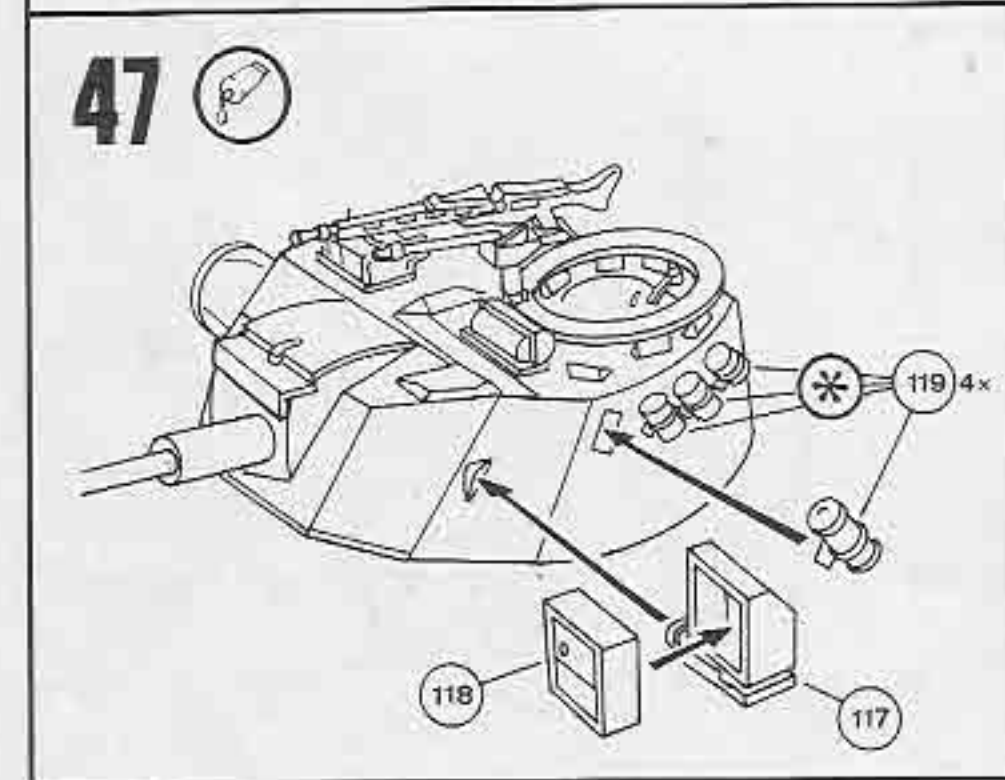
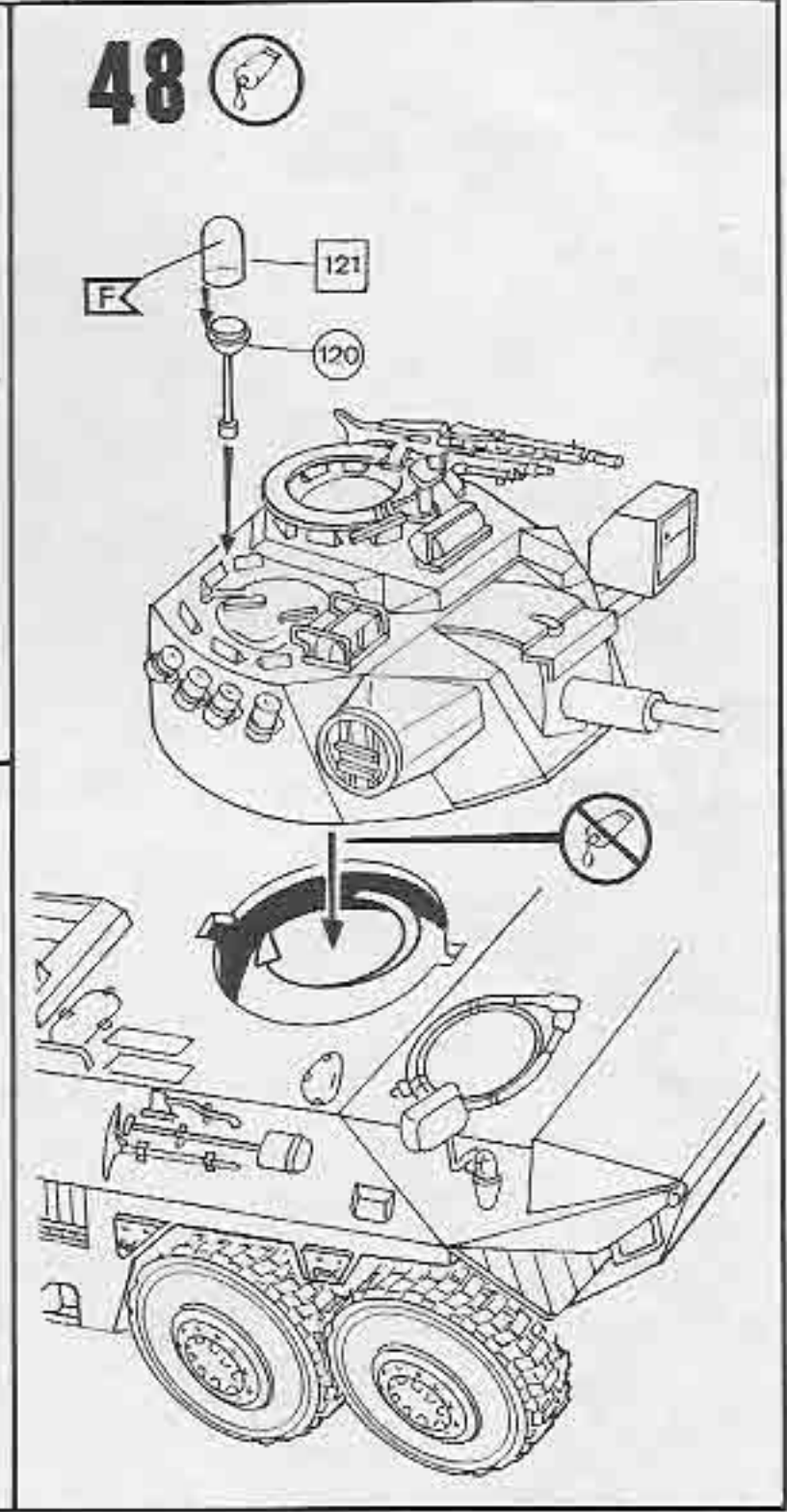
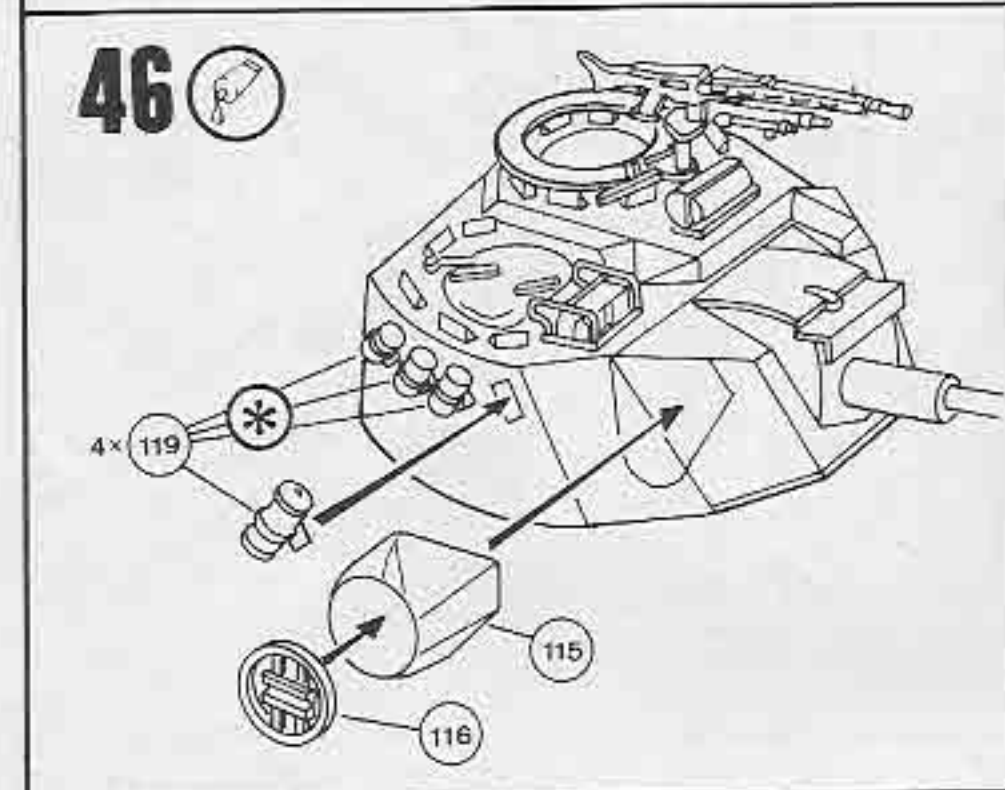
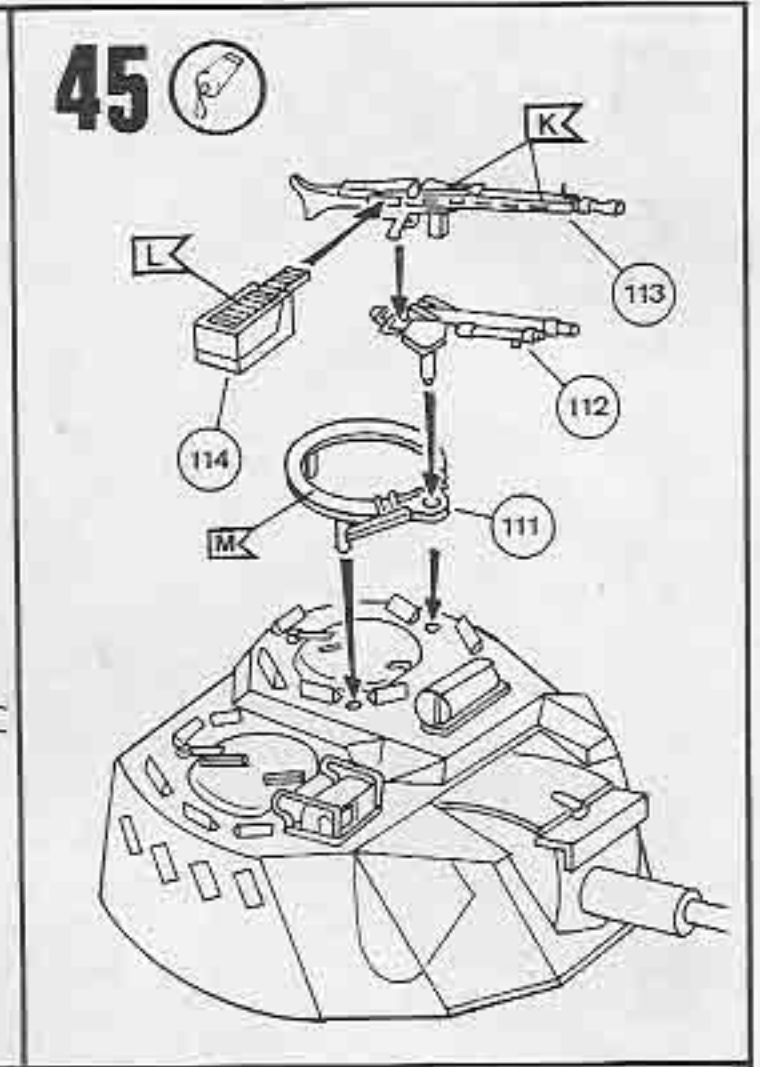
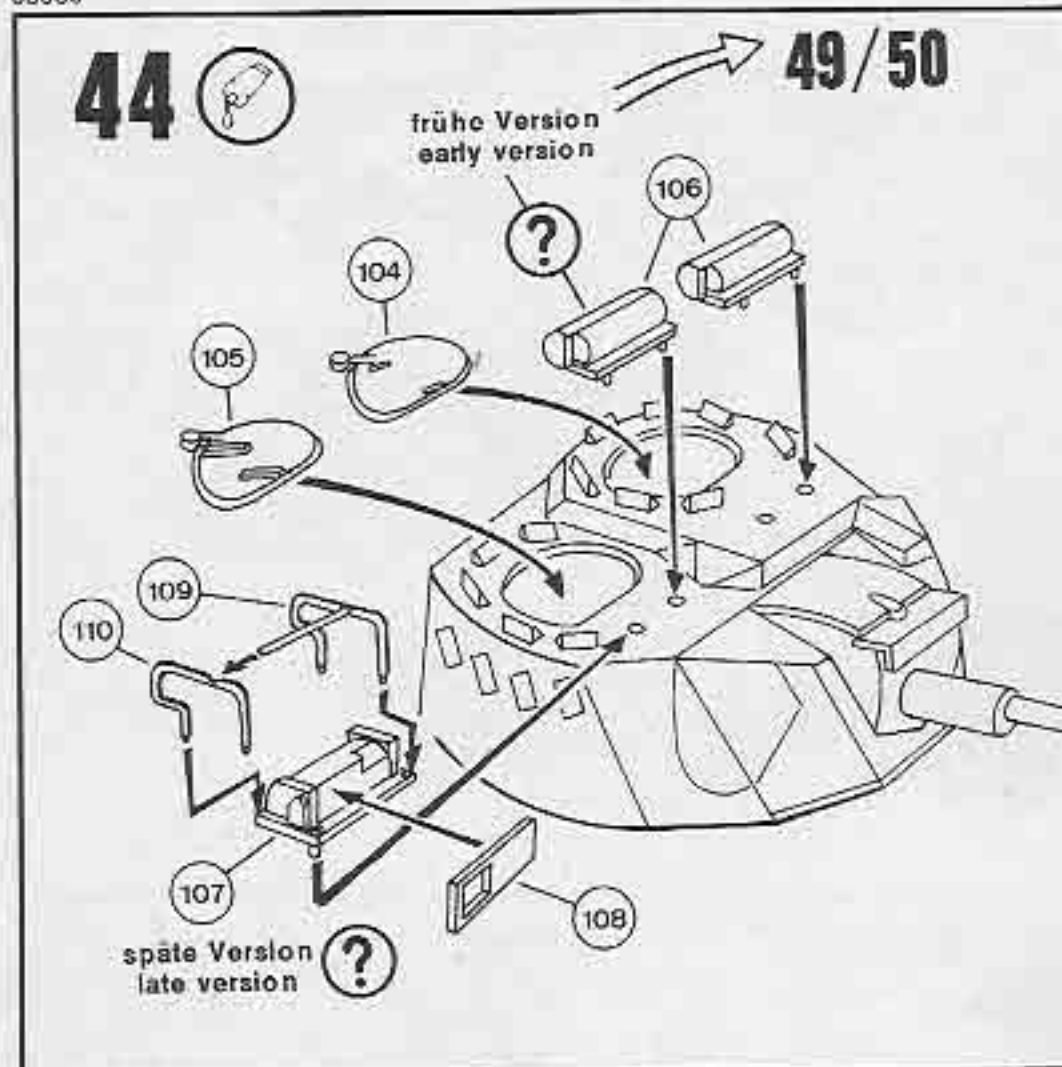



**49 ?**

frühe Version  
early Version



Kampftruppenschule 2  
Munster, 1986

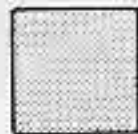

AK

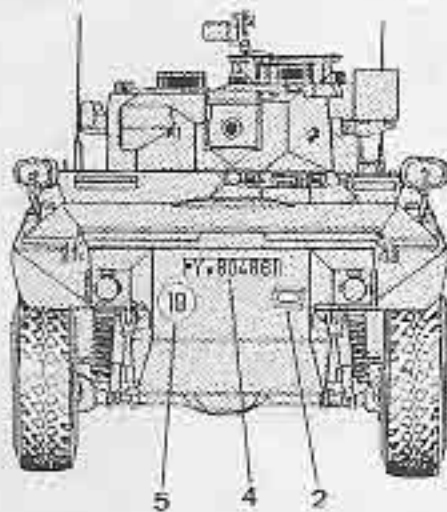
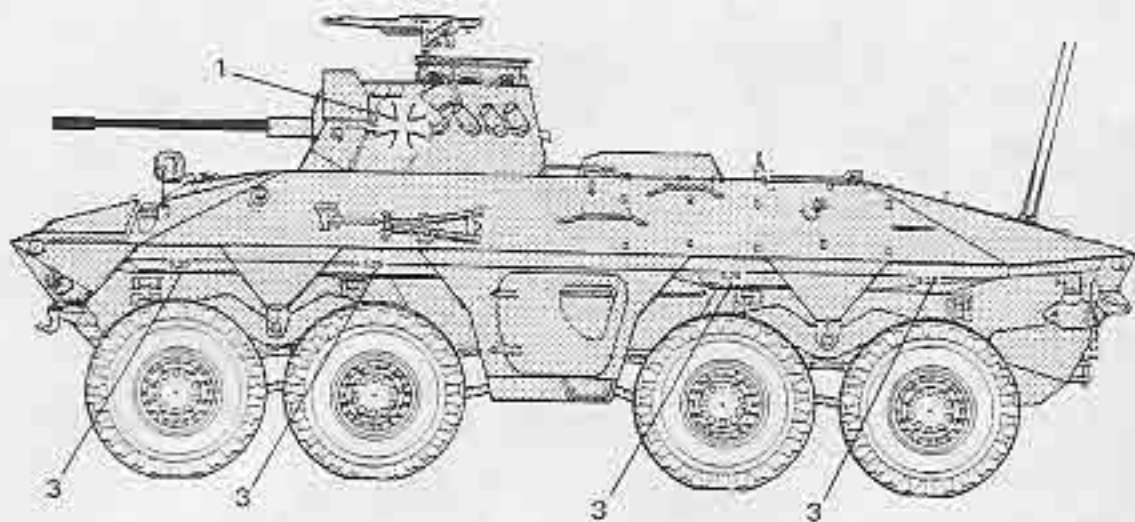
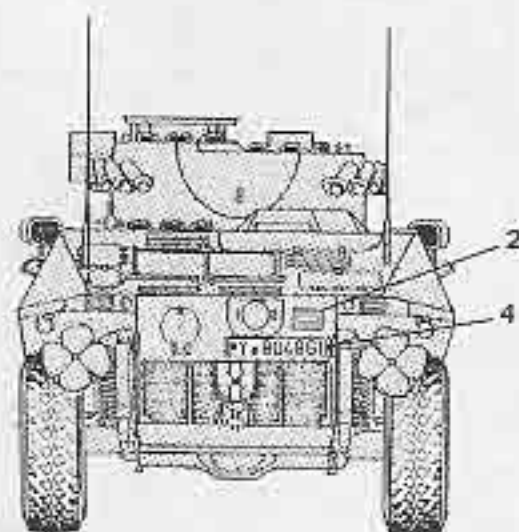
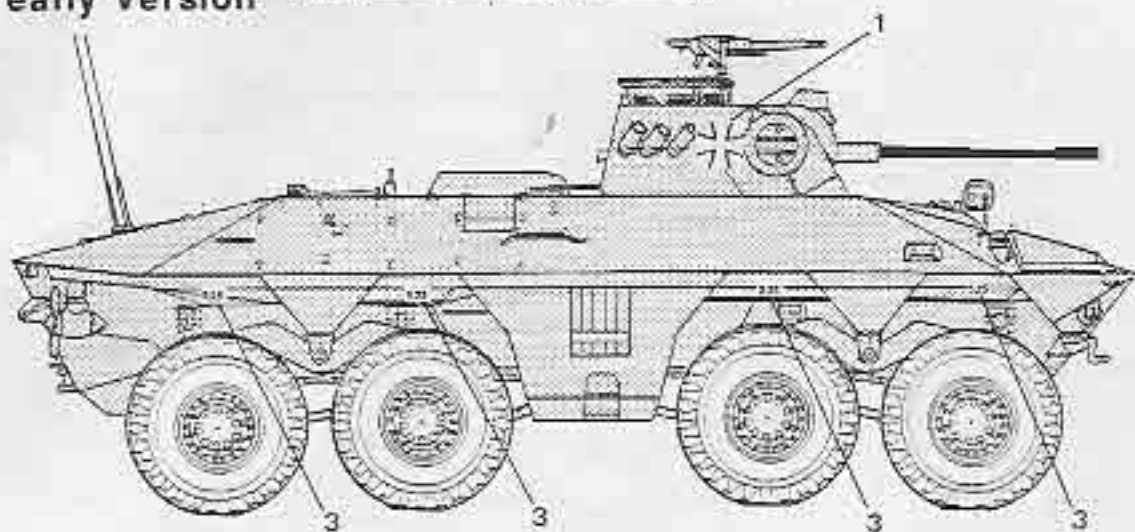

**50 ?**

frühe Version  
early version



Spähzug der Panzerbrigade 3  
Nienburg, 1987

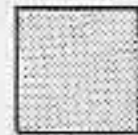

AK

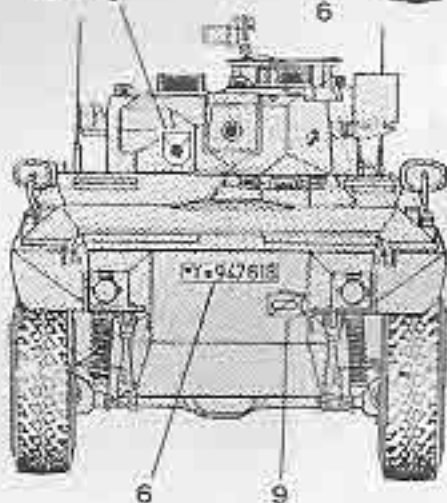
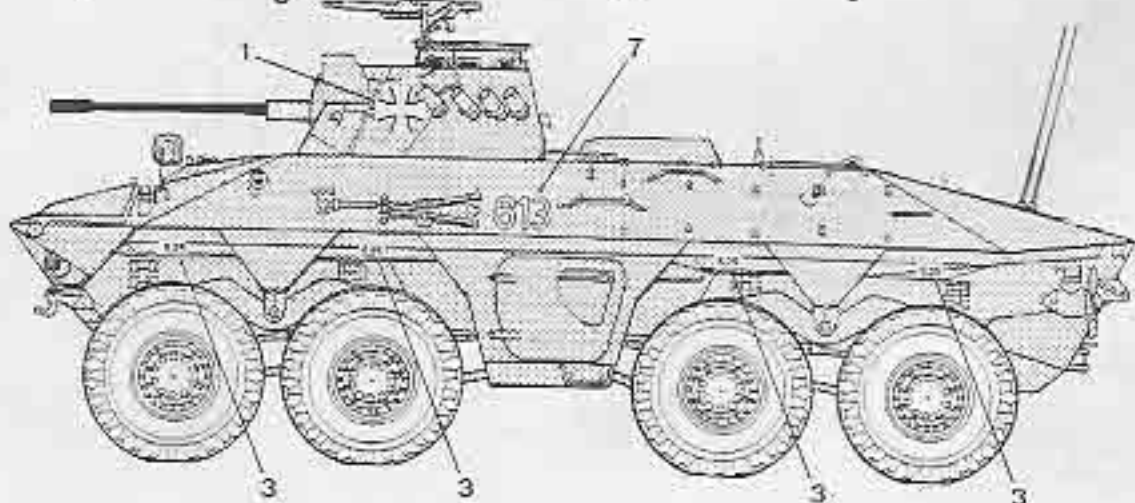
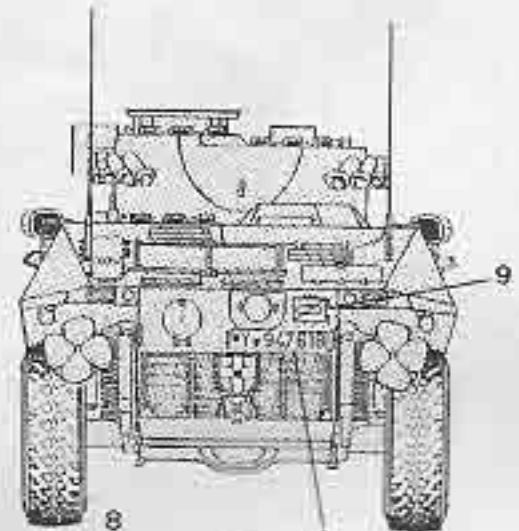
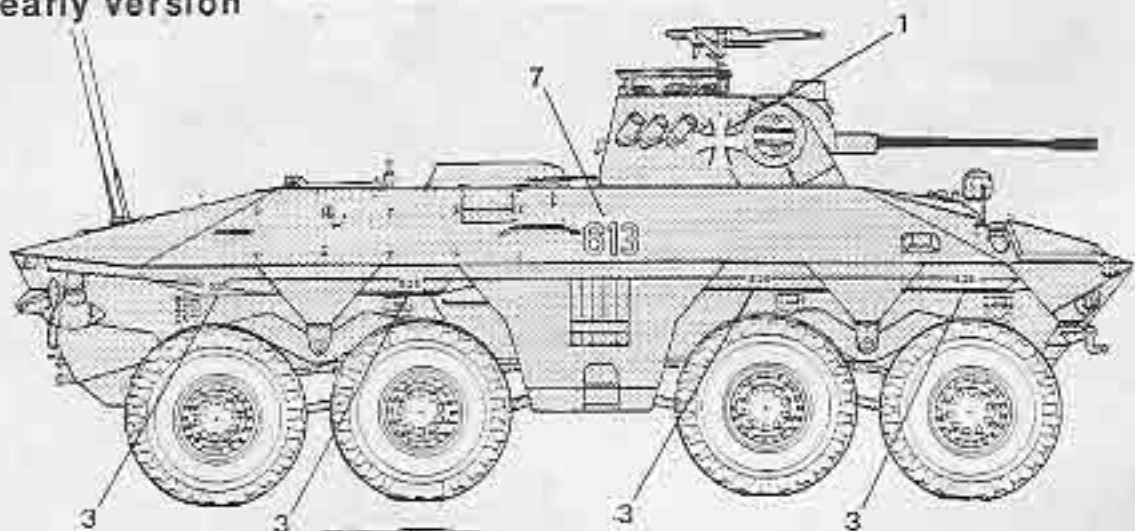

# 51?

## 3. Kompanie, PanzeraufklärungsBtl.7 Augustdorf 1989

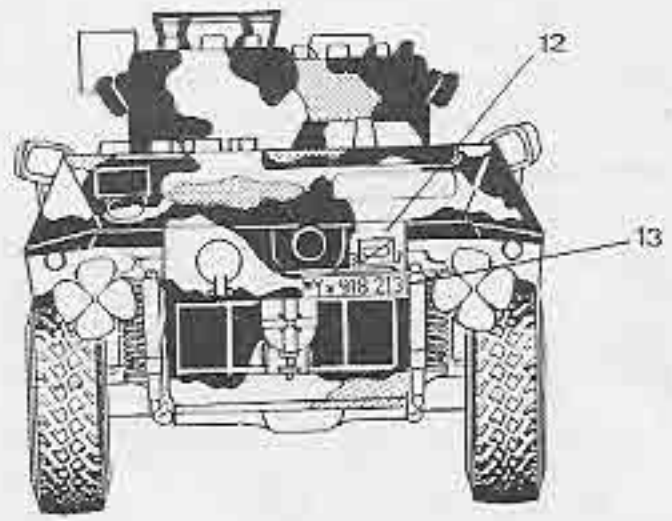
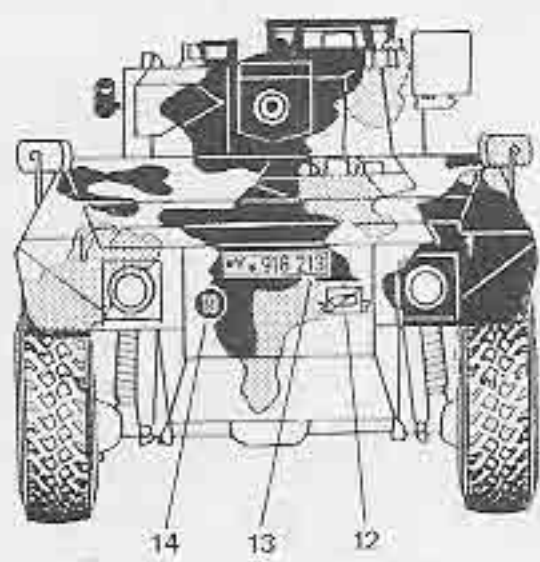
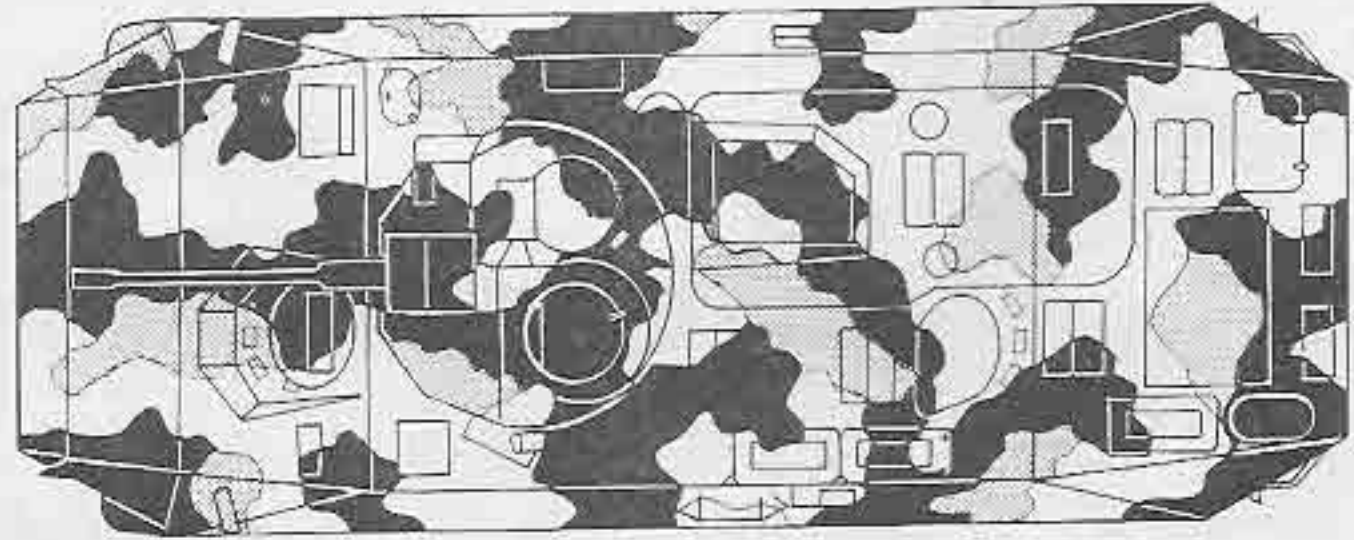
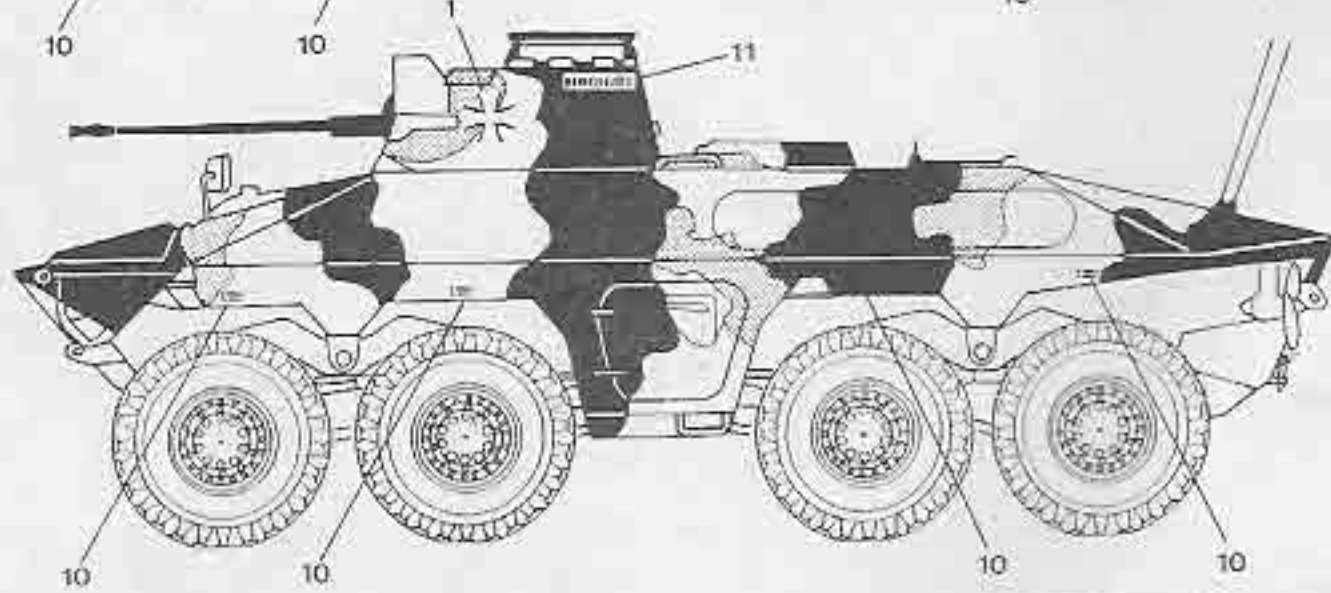
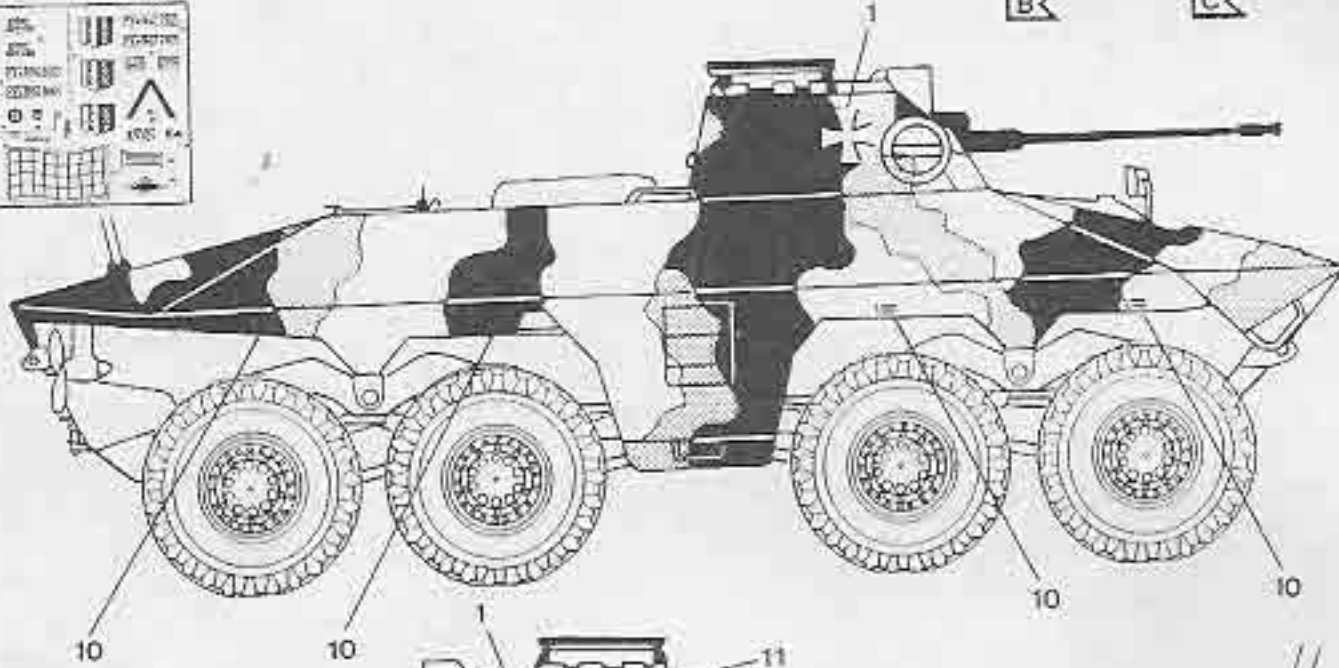
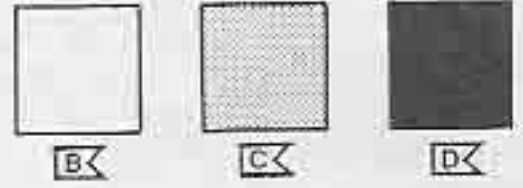

52 (?)

4. Kompanie, PanzeraufklärungsBtl. L11  
Munster 1992

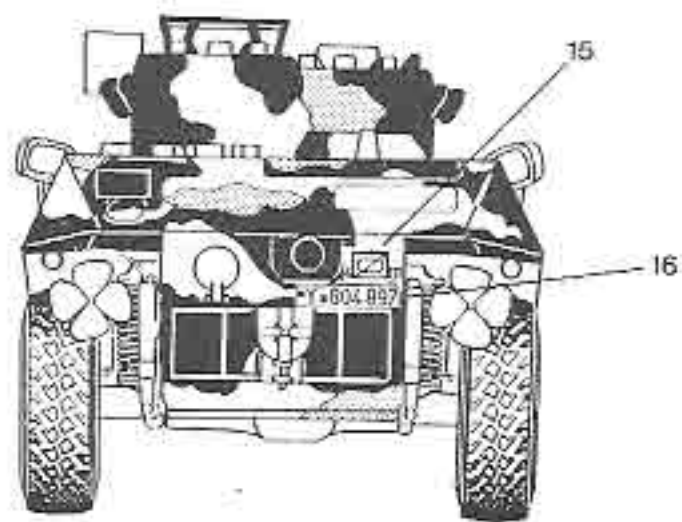
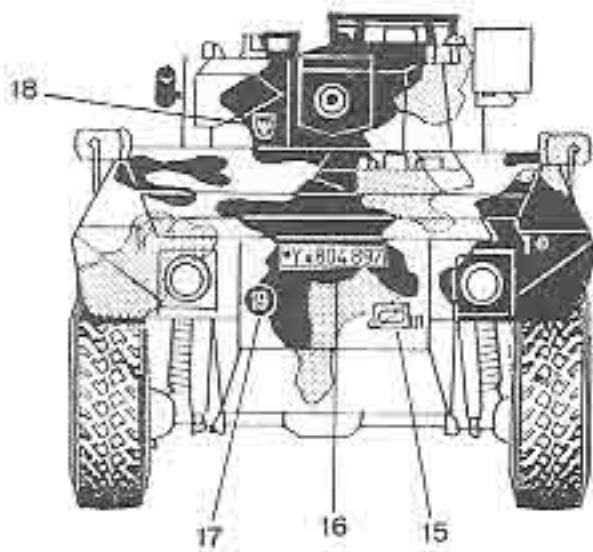
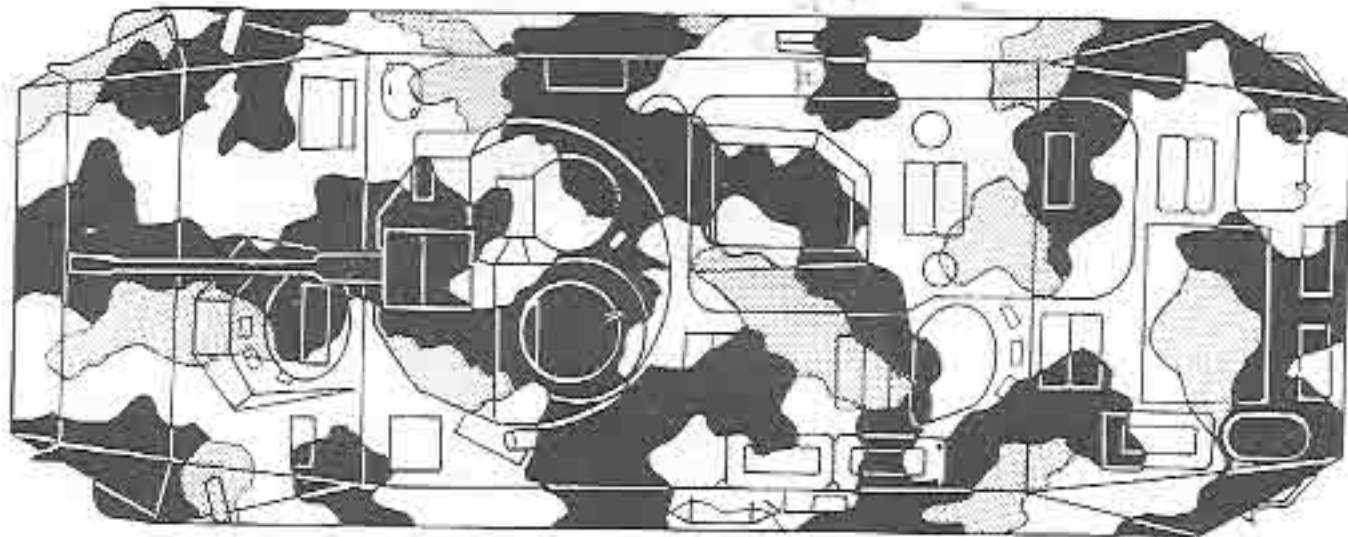
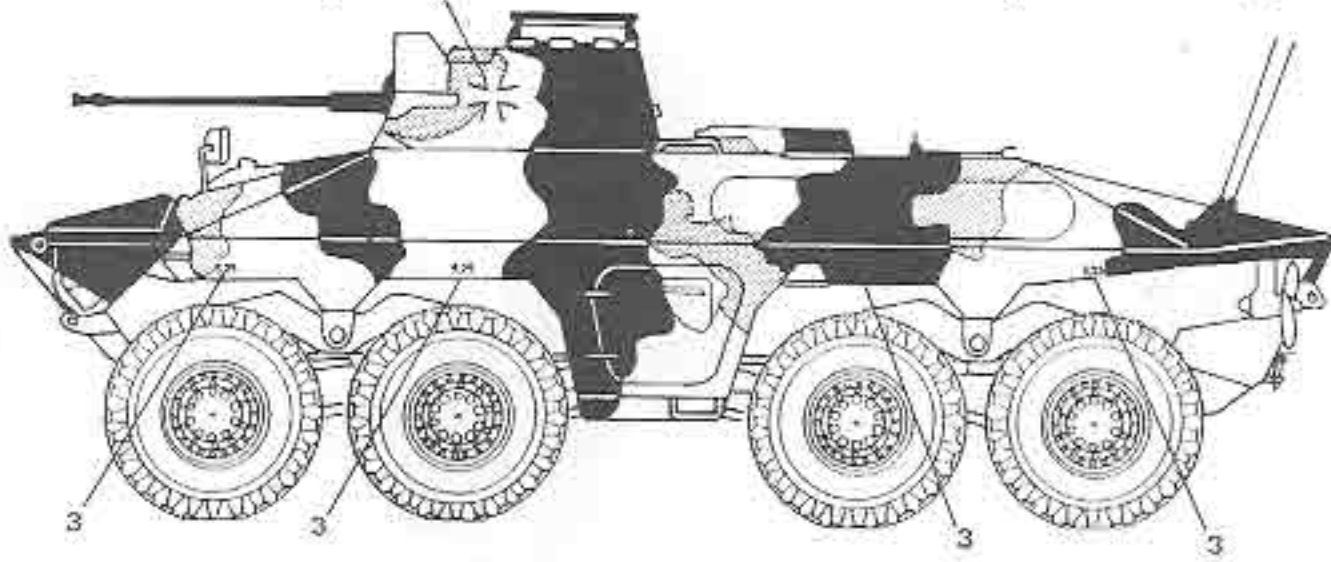
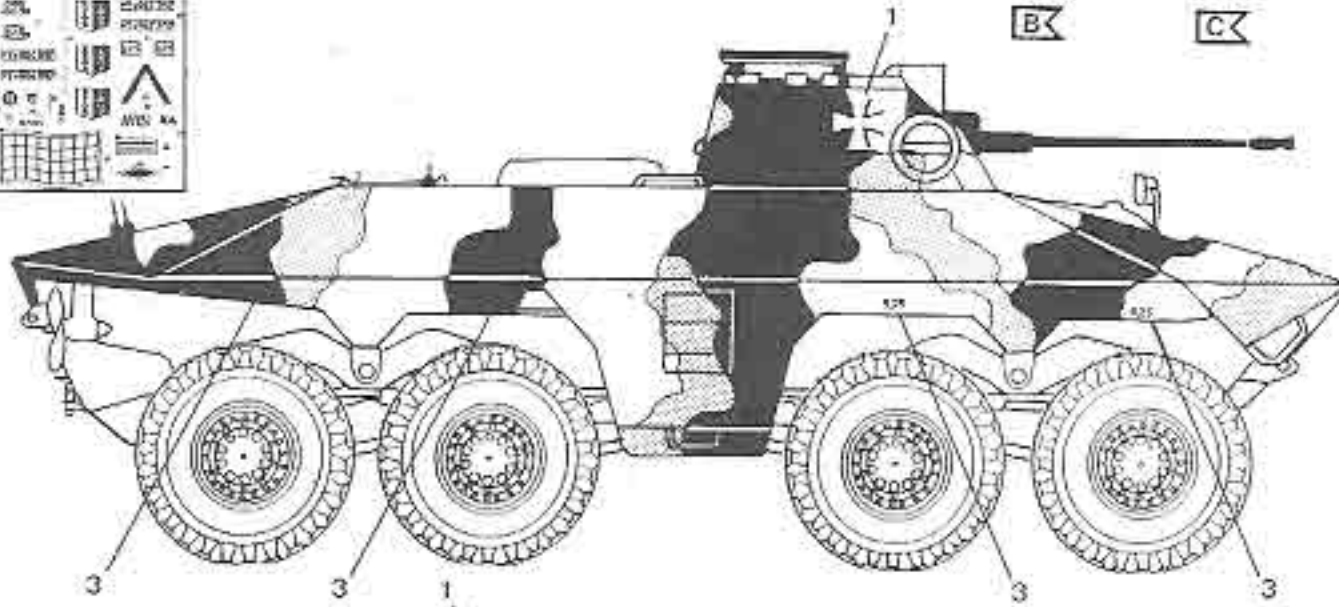
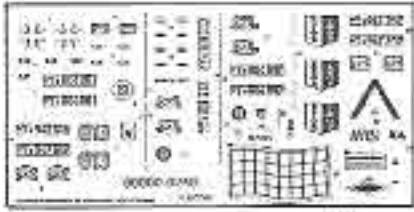
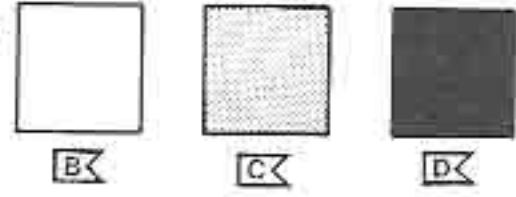

# 53 ?

## Gepanzerter Gefechtsverband GCONSFOR, Rajlovac 1997

