

A-32 18000

KANGNAM
HOBBY MODEL KIT

GENERAL DYNAMICS F-16XL FIGHTER

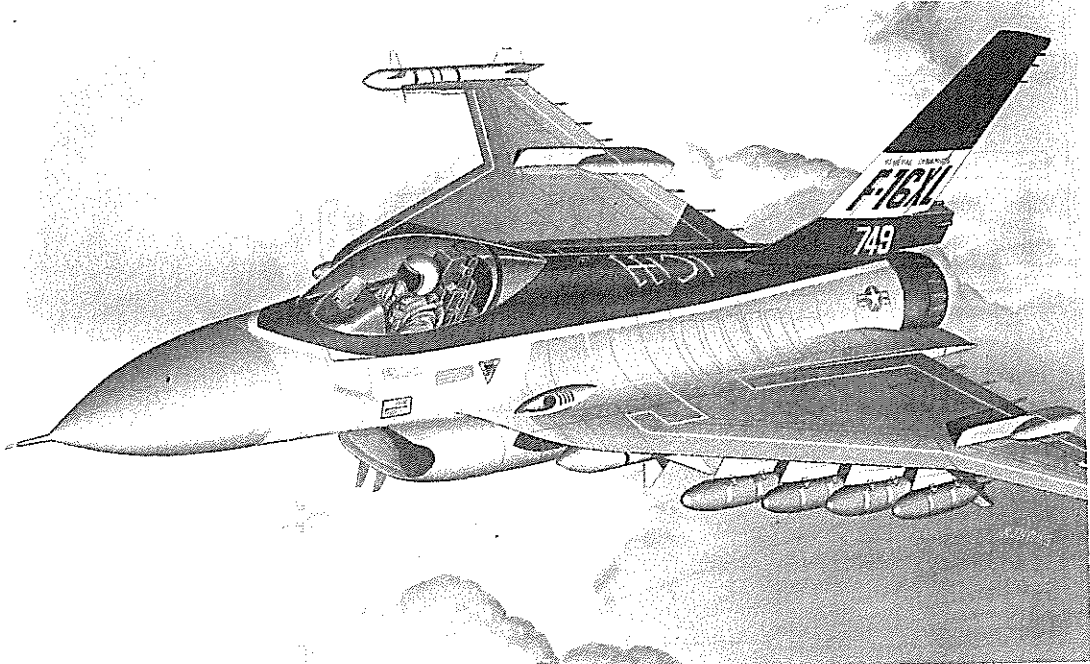

F-16XL FIGHTER

The F-16XL represents an revolutionary advancement over the design of the supersonic F-16 "Fighting Falcon." Visually, the new aircraft is distinguished by a revolutionary wing design that was developed by General Dynamics engineers with the assistance of NASA aerodynamicists. This unique 'Cranked Arrow' design provides handling characteristics throughout the flight envelope, while the increased surface area of the wing increases combat range and payload capability. Due to the results of preliminary design work, General Dynamics decided to proceed with the

development of a full-size prototype during November of 1980, and this aircraft first rolled out in July of 1982, less than two years after work began. Although this new design was not developed specifically for an Air Force program, the military is obviously quite interested in the F-16XL.

Your model portrays the prototype F-16XL. It is armed with two "Sidewinder" air-to-air missiles and six AMRAAM missiles. The actual aircraft is powered by a Pratt and Whitney F100 engine, and a 20 millimeter gun is fitted internally.

F-16XL은 초음속 F-16 "파이팅 팔콘"의 설계를 넘어서는 혁명적인 발전이라 말할수 있다. 외관상으로 이 새로운 항공기는 "미국 항공 우주국"의 공기 역학자와 "제너럴 다이내믹 엔지니어스"에 의해 설계된 혁신적인 날개에 의해 구별된다. 이 독특한 "크랭크 애로우" (꾸불꾸불한 화살형태)설계는 비행기 전체의 조종 특성을 결정지어 준다. 아울러 날개의 증가된 표면적은 전투 반경과 무기 적재 능력을 증가시킨다. 예비 설계작업의 결과로 "제너럴 다이내믹"사는 1980년 11월에 실제 크기의 기본형태 개발을 진행하기로 결정을 했으며 이 항공기는 1982년 7월에 처음으로 선을 보았다. 비록 이 새로운 설계가 미공군 프로그램을 위해 특별히 개발된 것은 아니지만 군부대에서는 확실하게 이 F-16XL에 흥미를 보였다. 이 모델은 F-16XL 원형을 묘사하고 있다. 이 항공기는 2기의 "사이드와인더" 공대공 미사일과 6기의 신형 중거리 공대공 미사일로 무장되어 있다. 실제 항공기는 "프래트 휘트니 F100" 엔진이 장착되어 있으며 20마리 포를 내재하고 있다.

★Before assembling

- Follow the instructions carefully.
- Cut off the parts from the stem with a nipper or cutter.
- When using adhesive, apply it to both parts to be cemented. Please take care not to apply too much adhesive.
- Pay attention to proper fitting of each parts using cello-tape before cementing the parts.

★조립하기전

- 설명서를 잘 읽으십시오.
- 칼이나 커터로 각 부분을 잘 자르십시오.
- 접착제 사용시는 너무 많이 바르지 말고 각 부분에 골고루 바르세요.
- 접착제 사용전에 스킨 테이프를 미리 붙일부분을 부차 제대로 되었는지를 확인하십시오.

부 품 도

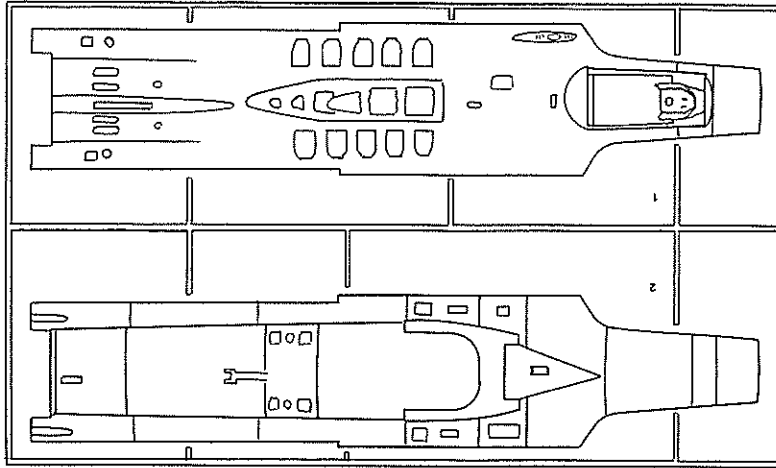

P PARTS NO. & NAME

A·PARTS

1. Fuselage top
2. Fuselage bottom

B·PARTS

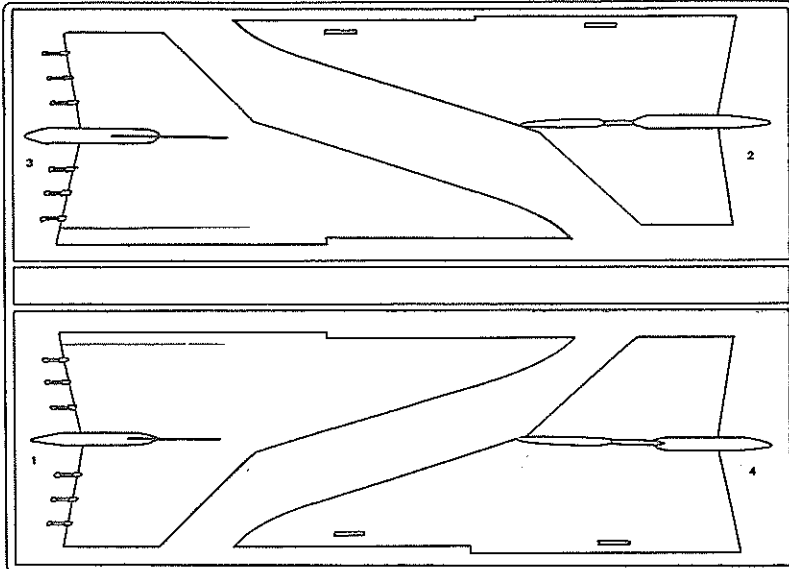

B·PARTS

1. Main wing top (left)
2. Main wing top(right)
3. Main wing bottom(right)
4. Main wing bottom(left)

C·PARTS

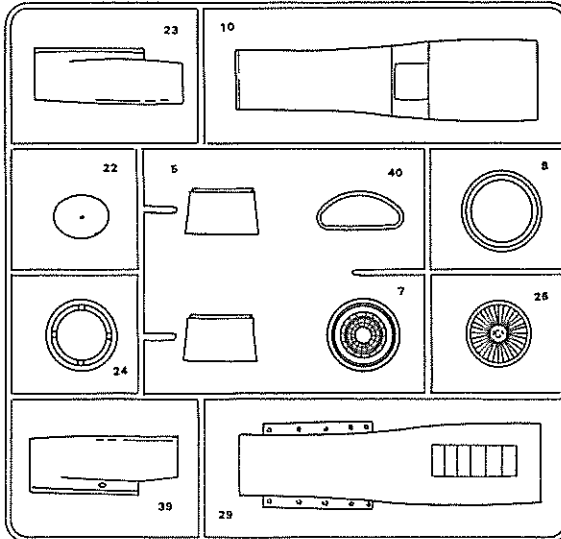

C·PARTS

1. Sidewinder(top)
2. Sidewinder(top)
3. Sidewinder(bottom)
4. Sidewinder(bottom)
5. Sparow(bottom)
6. Sparow(top)
7. Sparow(bottom)
8. Sparow(top)
9. Sparow(bottom)
10. Sparow(top)
11. Sparow(bottom)
12. Sparow(top)
13. Sidewinder pylon(left)
14. Sidewinder pylon(right)
15. Sidewinder wing
16. Sidewinder wing
17. Horizontal tail(right)
18. Horizontal tail(left)
19. Cockpit
20. After burner igniter

D - PARTS

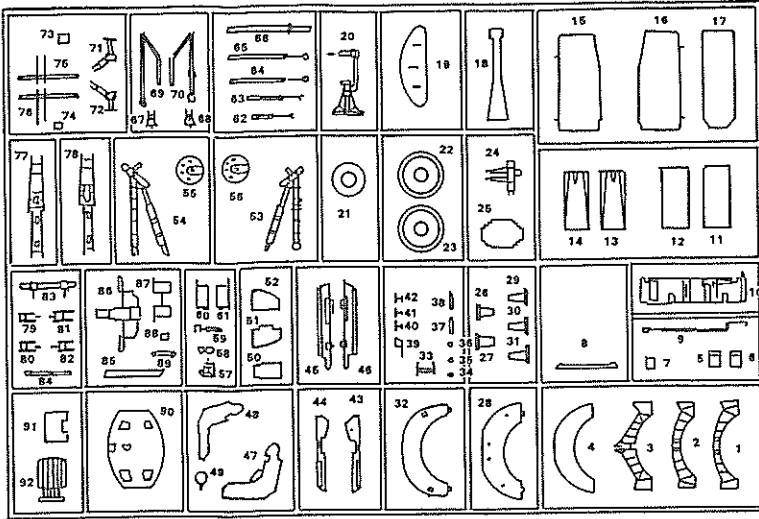

D - PARTS

1. Main landing gear rear bulk head
2. Main landing gear front frame
3. Main landing gear center frame
4. Main landing gear rear frame
5. Main landing gear front bulk head
6. Arresting hook
7. UHF antenna(A)
8. Temperature sensor
9. UHF antenna(left)
10. UHF antenna(right)
11. VHF antenna
12. Air brake part
13. Air brake part
14. Nose cone hinge
15. Nose cone arm
16. ECM antenna
17. ECM antenna
18. Pilot tube(B)
19. AGFA transmitter
20. Radar arm
21. Bomb rack part(B)
22. Vulcan cannon ammo supplier(left)
23. Vulcan cannon ammo supplier(right)
24. Vulcan cannon ammo supplier bottom
25. Vulcan cannon ammo supplier top(B)
26. Radar strut
27. Nose wheel
28. Air brake strut(top)
29. Air brake strut(bottom)
30. Vulcan cannon motor(bottom)
31. Vulcan cannon motor(top)
32. Vulcan cannon part(A)
33. Vulcan cannon ammo belt(R) (right)
34. Vulcan cannon ammo belt(left)
35. Vulcan cannon part(A)
36. Vulcan cannon part(B)
37. Vulcan cannon barrel
38. Vulcan cannon barrel
39. Vulcan cannon barrel
40. Seat guide rail(left)
41. Seat guide rail(right)
42. Seat part(right)
43. Seat part(left)
44. Ejection ring
45. Bomb rack part(C)
46. Seat back rest
47. seat
48. Head rest(left)
49. Head rest(right)
50. Central radar scope
51. Instrument panel(right)
52. Instrument panel(left)
53. Meter
54. Arm rest
55. Foot pedal part(left)
56. Foot pedal part(right)
57. Throttle stick
58. Control stick
59. Foot pedal
60. Instrument panel
61. Current adjuster
62. Canopy actuator
63. Pilot tube
64. Main wheel
65. Main wheel
66. Main gear strut(right)
67. Main wheel brake
68. Main gear strut(left)
69. Main wheel brake
70. Main gear arm
71. Main gear arm
72. Nose gear strut
73. Nose gear part
74. Nose gear cover actuator
75. Nose gear actuator
76. Main gear actuator(left)
77. Main gear actuator(right)
78. Nose gear arm
79. Shock absorber part
80. Shock absorber part
81. Main gear cover actuator(left)
82. Main gear cover actuator(right)
83. Main gear part(right)
84. Main gear part(left)
85. Main gear well part(B)
86. Main gear well part A(right)
87. Main gear well part A(left)
88. Main gear well part B

E - PARTS

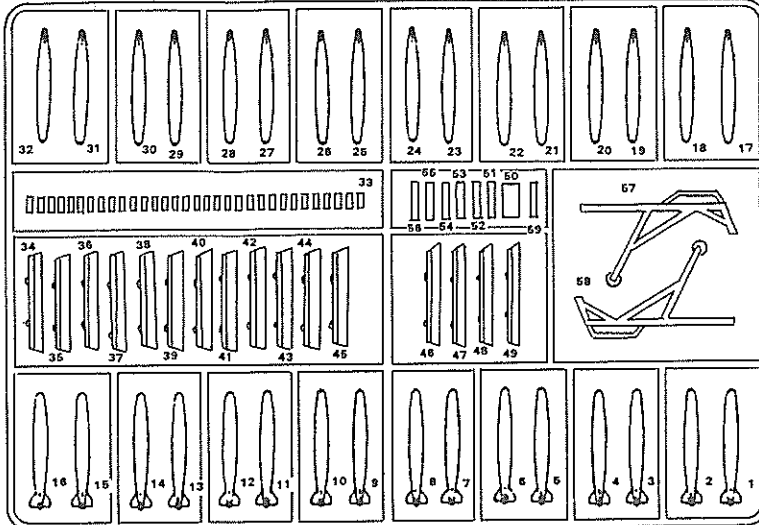

F - PARTS

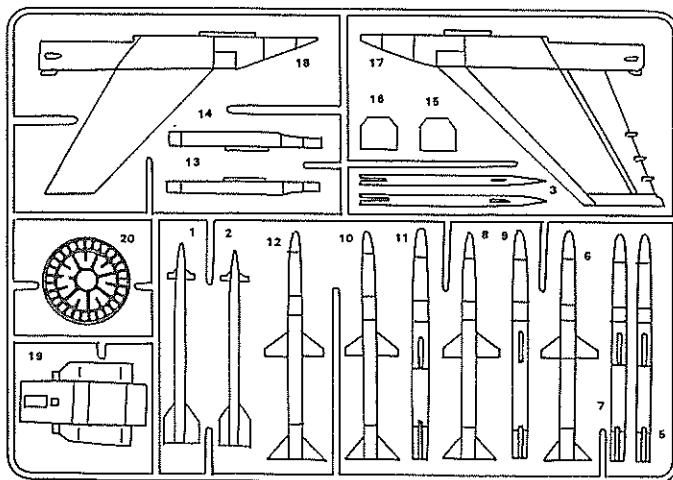

E - PARTS

- 1-16. MK-82LDGP bomb(bottom)
- 17-32. MK-82LDGP bomb(top)
33. MK-82LDGP bomb pylon Lock
- 34-49. MK-82LDGP bomb pylon
50. Ladder part(B)
- 51-56. Ladder part (B) dder
57. Ladder frame(left)
58. Ladder frame(right)
59. Ladder part(A)

F - PARTS

5. After burner
6. After burner
7. After burner part(B)
8. Exhaust pipe
10. Air duct
22. Nose Cone
23. Air intake side(right)
24. After burner cover
26. Engine turbine fan
27. Air duct bottom
39. Air intake side(left)
40. Air Intake

G - PARTS

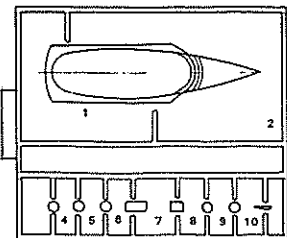

1 COCKPIT ASSEMBLY 조종석 조립

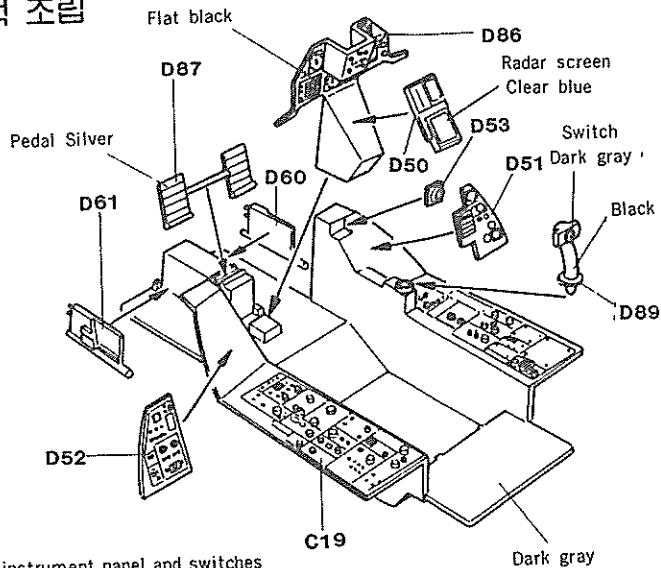

■ Paint instrument panel and switches to look realistic using White Black Red Flat black paint

환색, 검정, 빨강 페인트를 사용하여 조종석과 스위치들이 실제처럼 보이도록 합하시오.

의자설치 SEAT INSTALLATION

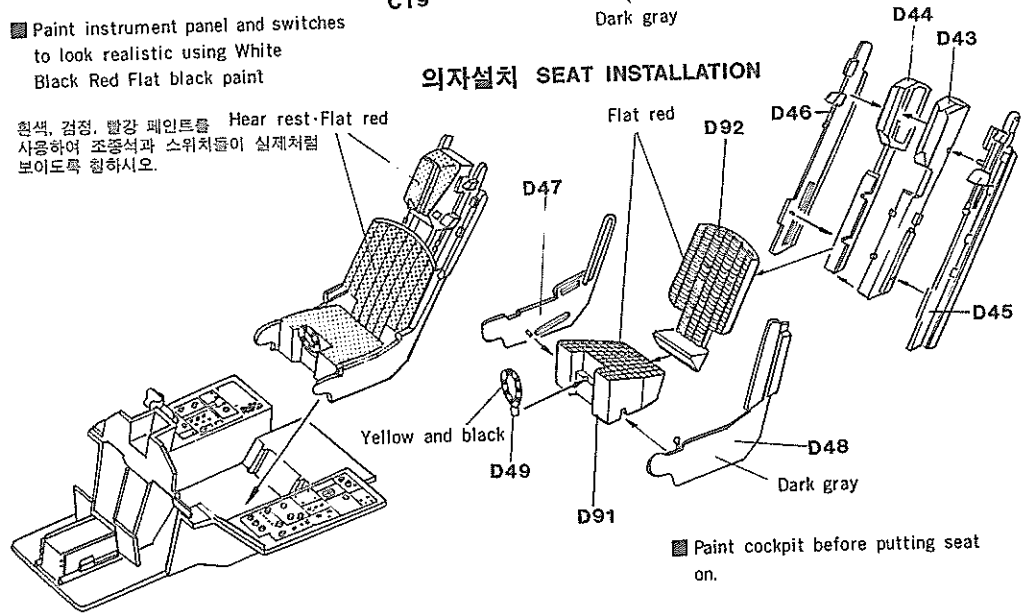

■ Paint cockpit before putting seat on.

2 FUSELAGE 동체조립 INSIDE ASSEMBLY

많은 벌크헤드 부품들에 유의하여 조립하시오.

■ Pay attention to numbered part of each bulk head and then assemble.

BULK HEAD ASSEMBLY

벌크헤드 조립 White

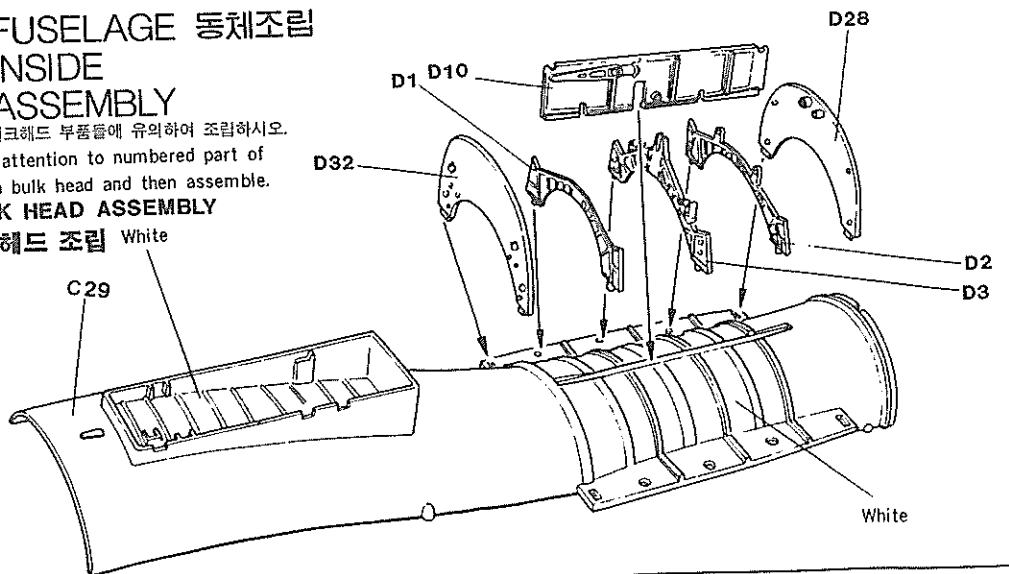

3 FUSELAGE ASSEMBLY

동체안쪽 조립

AIR INTAKE ASSEMBLY 공기흡입구 조립

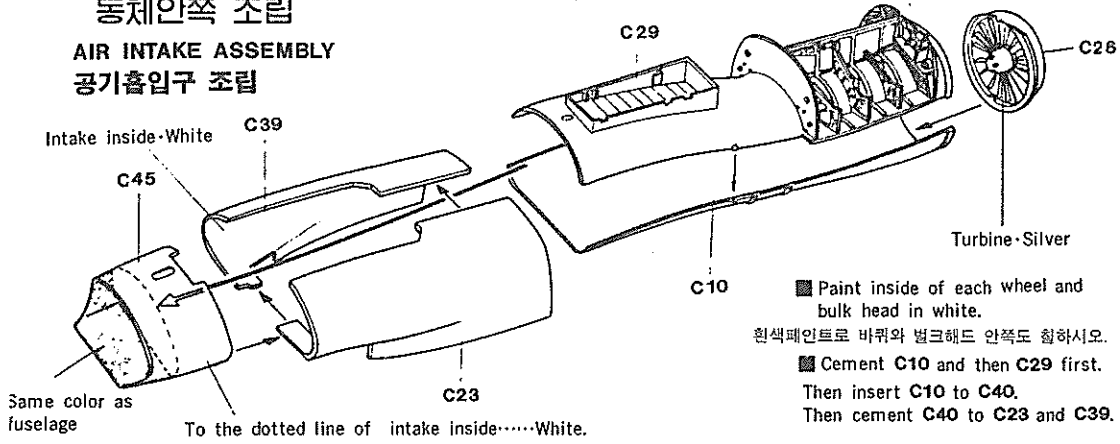

- Paint inside of each wheel and bulk head in white.
흰색페인트로 바퀴와 벌크헤드 안쪽도 칠하시오.
- Cement C10 and then C29 first.
Then insert C10 to C40.
Then cement C40 to C23 and C39.

AIR INTAKE INSTALLATION 공기흡입구 설치

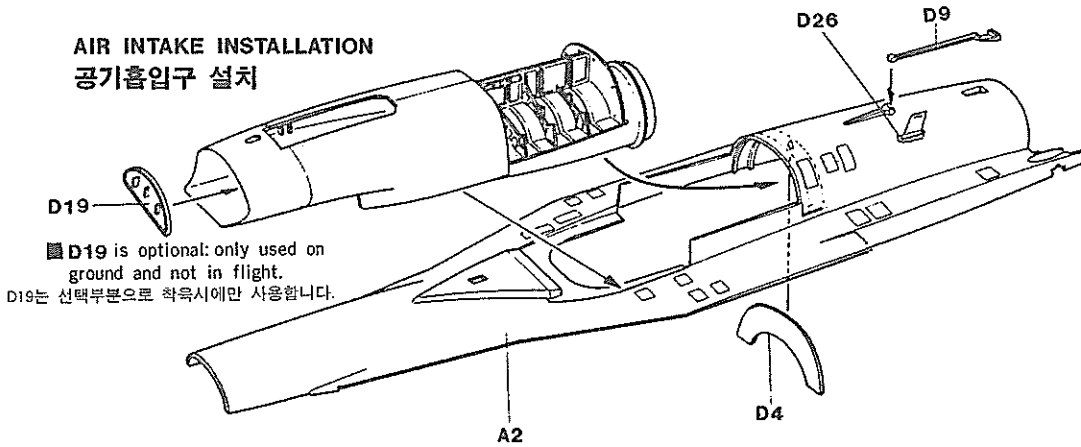

- Install first, then joint air intake to fuselage.
먼저 접착한후 공기흡입구를 동체에 조립하시오.

동체조립

FUSELAGE ASSEMBLY

- After cementing fuselage top and bottom, fix them with stick, tape until dry.

동체위와 밑을 접착시킨후 마를때까지 테이프로 고정시키시오.

COCKPIT INSTALLATION 조종석 설치

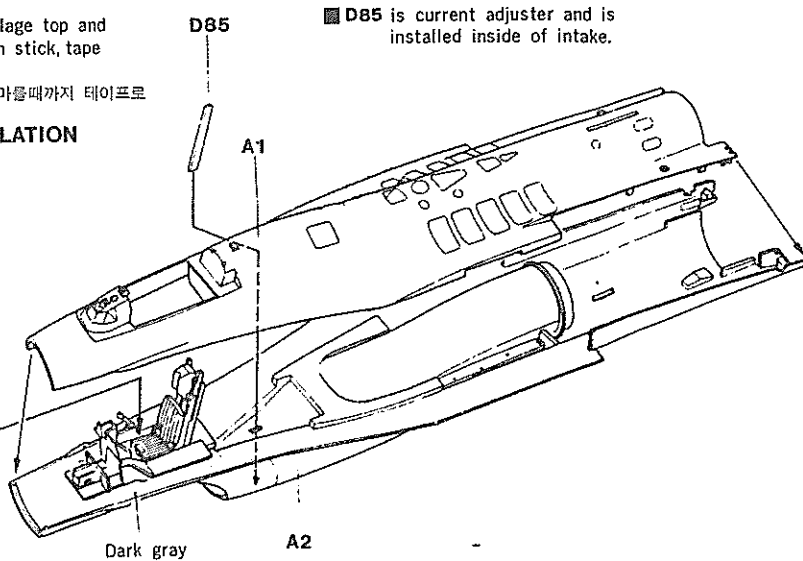
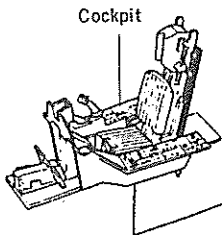

- D85 is current adjuster and is installed inside of intake.

4 WING AND NOSE ASSEMBLY

날개와 노즈 조립

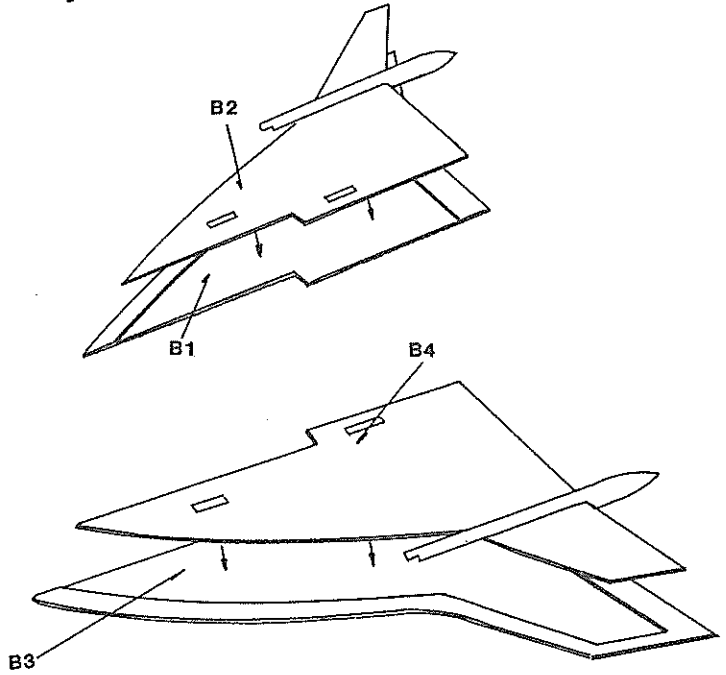

NOSE RADAR ASSEMBLY

노즈레이이다 조립

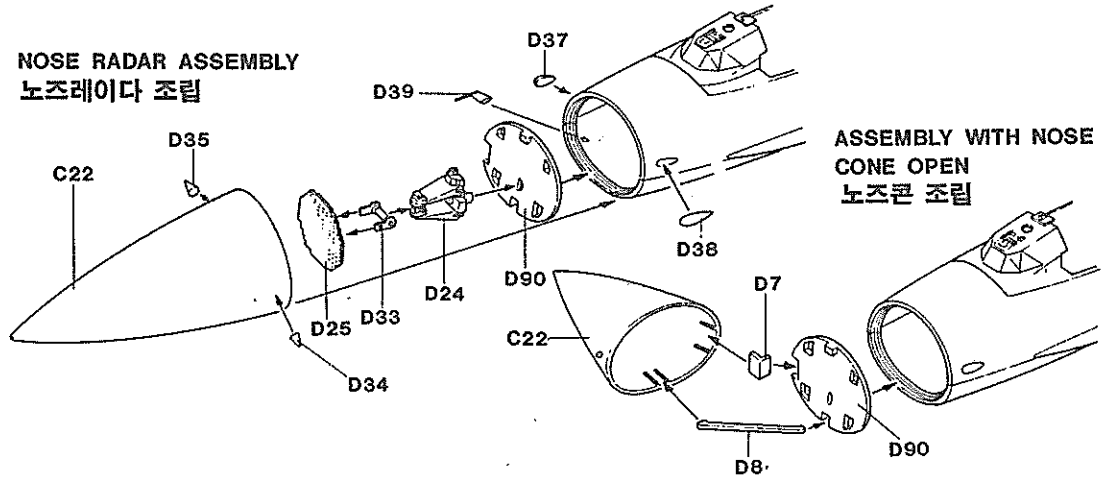

CANOPY INSTALLATION

캐노피 설치

■ Rader part is not shown on this picture but assemble as shown above.
레이더 부분은 이 그림에는 나타나있지 않으나 위의 그림같이 조립하시오.

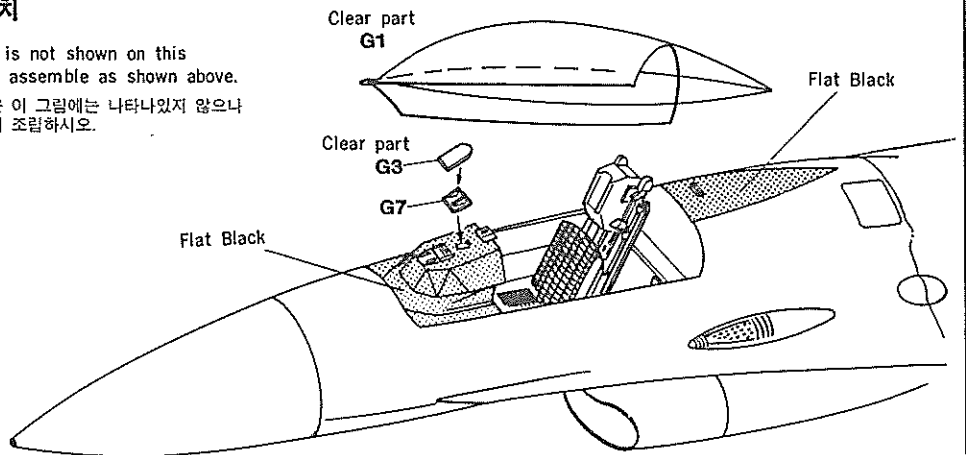

5 LANDING GEAR ASSEMBLY

랜딩기어 조립

NOSE LANDING GEAR ASSEMBLY 노즈 랜딩기어 조립

■ Paint nose gear strut white except indicated parts.

표시된 부분을 빼고 흰색으로 노즈기어 받침대를 칠하십시오.

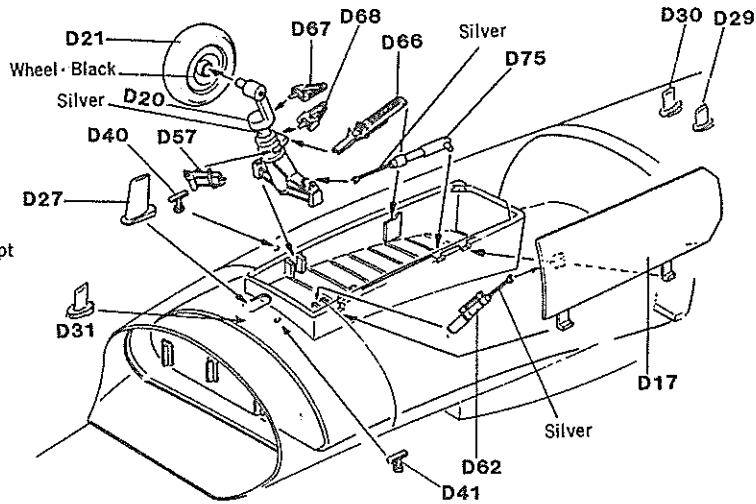

랜딩기어 조립 MAIN LANDING GEAR ASSEMBLY

■ Paint main gear strut white except indicated parts.

표시된 기어를 빼고 흰색으로 주기어 받침대를 칠하십시오.

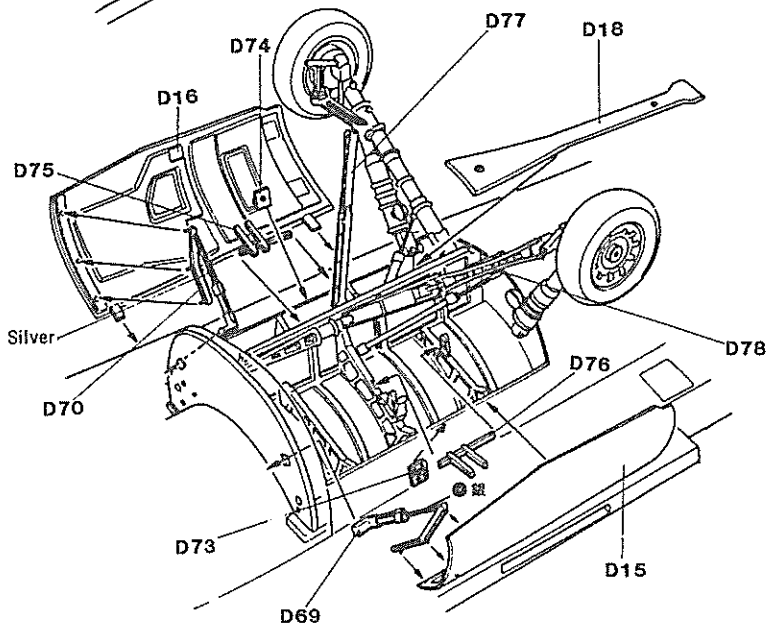
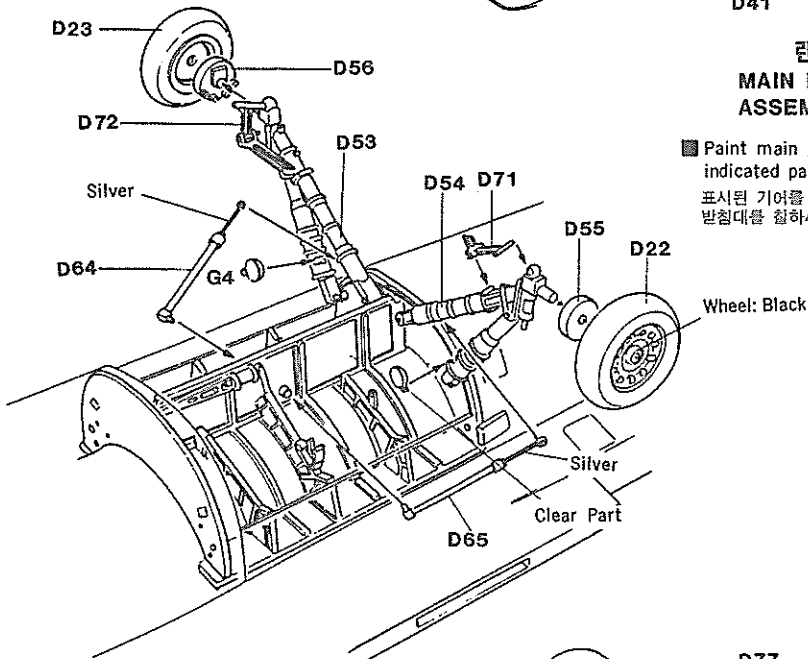

6 FUSELAGE 후미동체 조립

REAR ASSEMBLY

에어 브레이크 조립

ASSEMBLY WITH AIR BRAKE OPENED

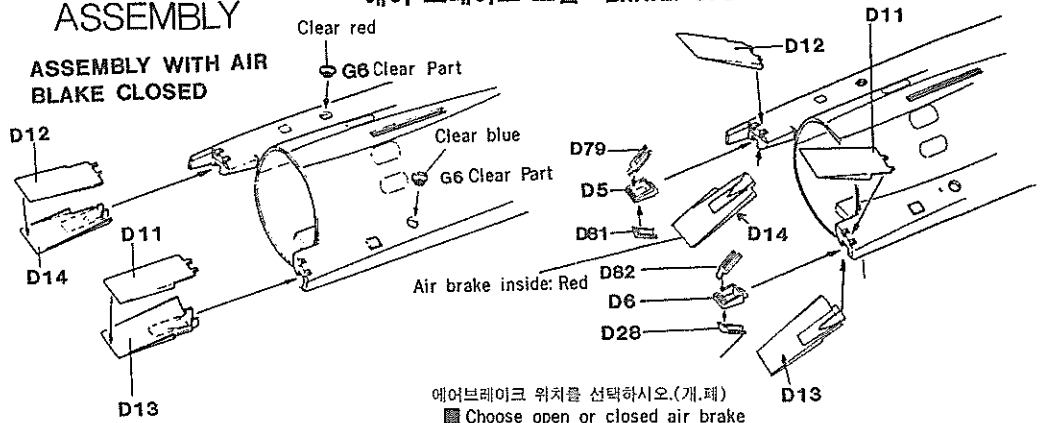

에어브레이크 위치를 선택하십시오.(개,폐)
 ■ Choose open or closed air brake position
 ■ Part D5, 6, 81, 82 and are not used when air brake is closed.
 부품 D5, 6, 81, 82는 에어브레이크가 닫혀있을 때는 사용하지 않습니다.

AFTER BURNER ASSEMBLY 후미분사구 조립

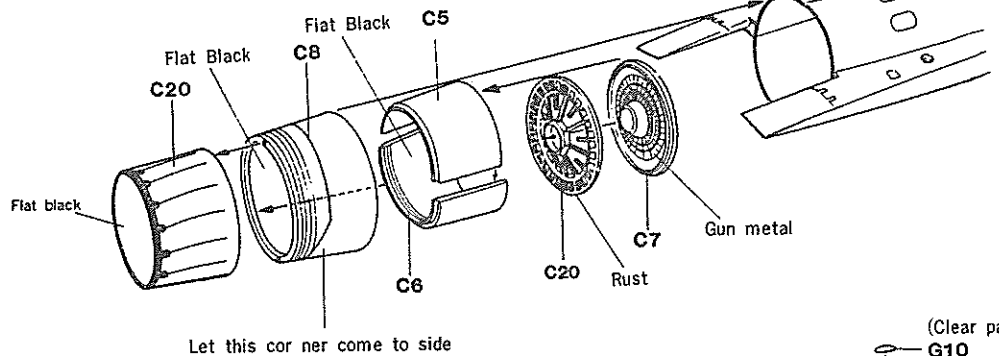

WING AND VERTICAL TAIL ASSEMBLY

주날개와 수직날개 조립

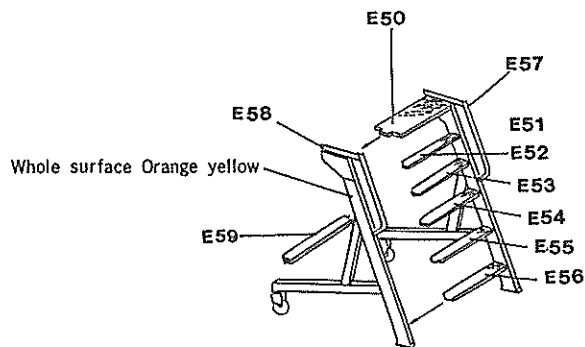
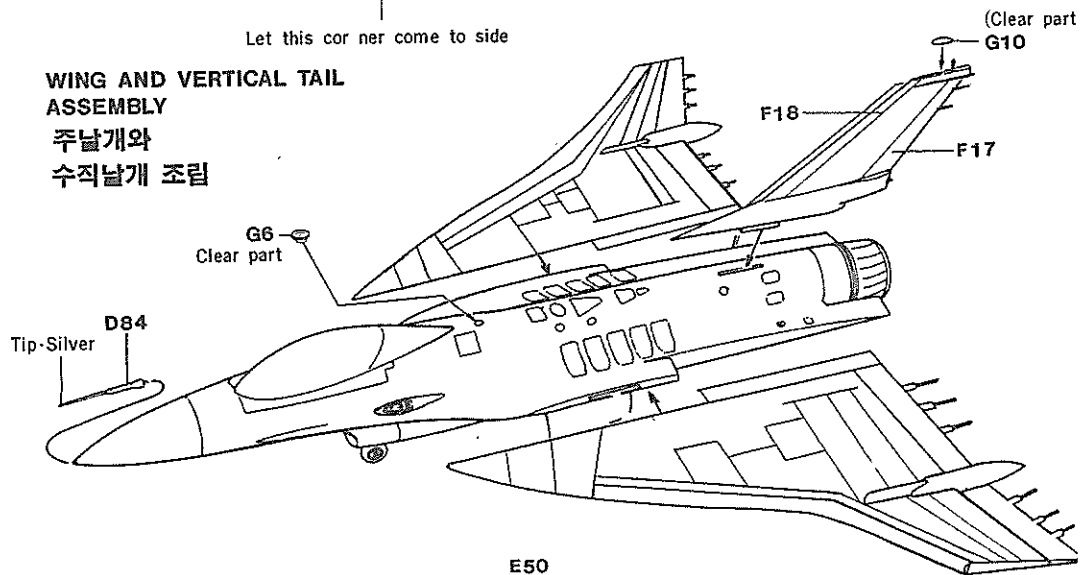

7 ARMAMENT 무장조립

ARMAMENT ASSEMBLY 무장조립

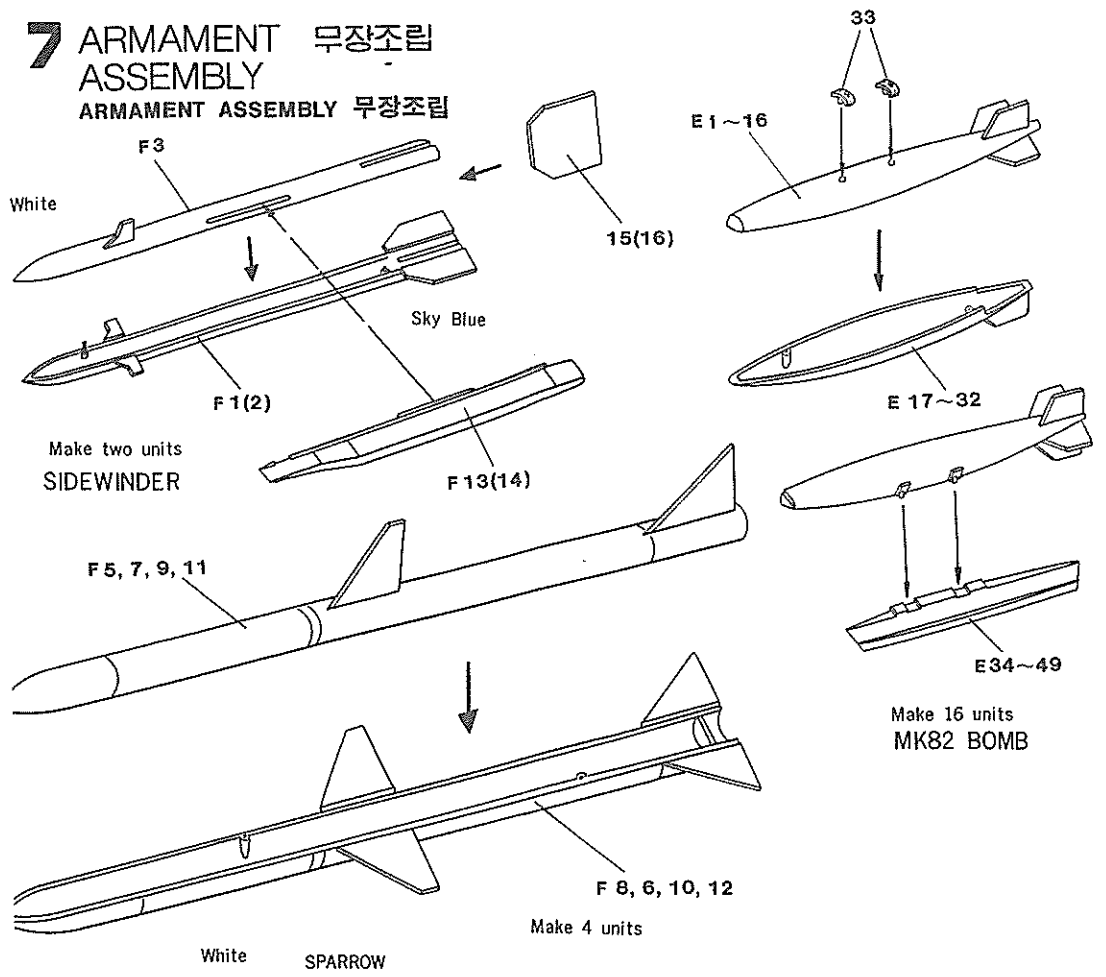

무장의 위치

ARMAMENT PLACEMENT

▣ Select either ordinary bomb.
The same as sparrow and sidewinder.
The position of other armament.
패로우나 사이드와인더 미사일 처럼 다른 쪽의
탄을 고르시오.

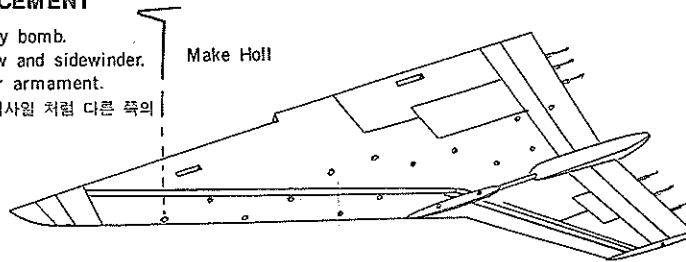

별표시가된 F5~12.E8 무기의 얇은쪽은 비행기
등체를 향하게 하시오.

▣ Thinner side of arms of F5~12
E8 (indicated by ★) faces fuselage.

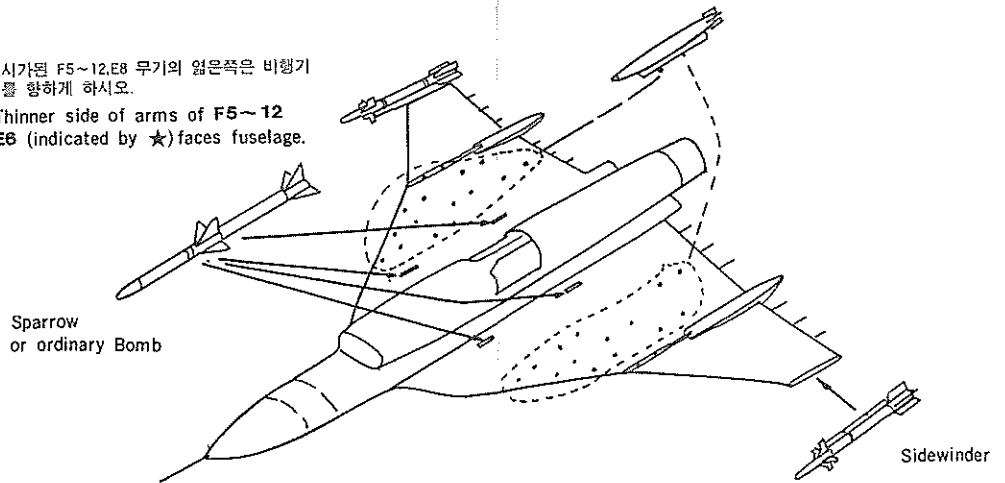

MARKING AND COLOR PAINTING GUIDE
전사마크와 색칠하기

