

## BRITISH MAIN BATTLE TANK

# CHIEFTAIN MK.11

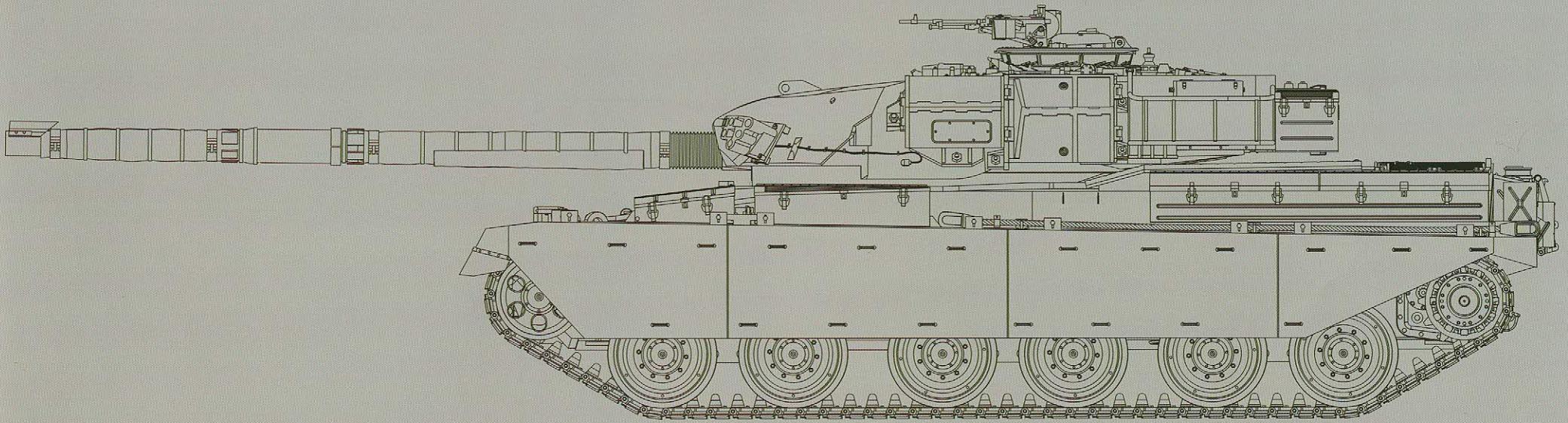

The Mk.11 was the final Mark of Chieftain used by the British Army and in many ways it was the Ultimate Chieftain, had the cold war continued there were plans to upgrade the entire Chieftain fleet to Mk.11 status but the collapse of the Soviet Union meant that only 324 were ever upgraded. During the 1980's it was realised that Chieftain was becoming outdated and that the latest generation of soviet weapons had been designed specifically to defeat the Chieftains Armour this led to the development of the Stillbrew up armouring package designed by RARDE which radically reshaped the turret front and gave protection against the new soviet weapons but did not degrade the performance of the Tank to any noticeable degree. 23 Base workshops in Witter West Germany began fitting Stillbrew upgrade packs in 1986 as vehicle came in for base overhaul.

A new and greatly improved NBC system was also fitted. Alongside these improved protection upgrades major changes were also made to Chieftains Gunner equipment, The Tank laser sight (TLS) Improved Fire Control System (IFCS) and Muzzle Reference System (MRS) were all tied into the new Thermal Observation and Gunner System (TOGS) which replaced the outdated Infra Red searchlight with a state of the art passive thermal imaging system which is still in use today on Challenger 2. TOGS Proved itself in the Gulf war when fitted to Challenger 1 and is considered the best TI system in the world and a battle winner. Fitting this system to the Chieftain Mk.11 gave the tank a full night fighting capability and vastly increased the effective range of the improved L11 A5 120mm main gun which achieved first round kills at ranges beyond 3500 meters. The only negatives of the TOGS installation the loss of the contra rotating ability of the commander's cupola and storage space for 4 projectiles.

A well trained Chieftain Mk.11 crew would consistently outperform those of the then new Challenger 1 on annual gunner training and it is a widely held belief amongst ex Chieftain MK.11 Crewmen that if they had been chosen for the 1987 CAT trophy it would not have been the disaster it turned out to be for the British Army. Continued development of the infamous L60 Engine meant that by the time of the Mk.11 the engine was somewhat more reliable and if used regularly as at BATUS gave little trouble although nothing it seemed to could stop the engine producing clouds of dense black smoke.

The Chieftain Mk.11 continued in front line service until 1995. It is fitting that the Final regiment issued with the Chieftain was the 1st Royal Tank Regiment which had conducted the user trails for the Chieftain in 1962

# READ BEFORE ASSEMBLY

## CAUTION

- Read carefully and fully understand the instructions before commencing assembly. A supervising adult should also read the instructions if a child assembles the model.
- When assembling this kit, tools including knives used. Extra care should be taken to avoid personal injury.
- Keep out of reach of small children. Children must not be allowed to suck any part, or pull vinyl bag over their heads.



Optional



Instant Glue  
for Metal



Apply Decal



Do Not Cement



Drill



Be Careful

## PAINTS REQUIRED

Color info and profiles by Mig Jimenez

## APPLYING DECALS

1. Clean the model surface with a wet cloth.
2. Cut out each decal design from sheet, and dip it in tepid water for 15~20 sec.
3. Hold the backing sheet edge and slide decal onto the model.
4. Move decal into position by wetting decal with finger.
5. Press decal gently down with a soft cloth until excess water and air bubbles are gone.

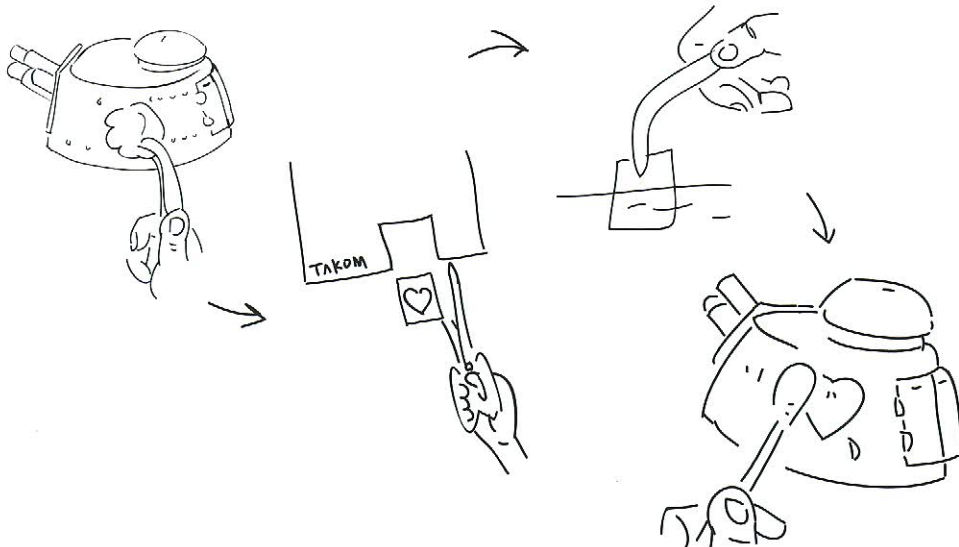

## REMOVING PE

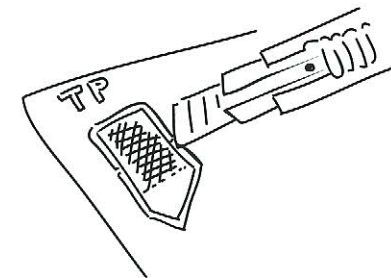

Be careful not to hurt when removing PE parts.

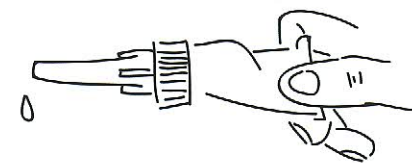

Secure using instant glue (not included).

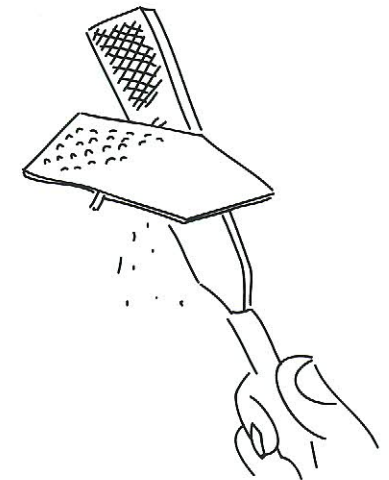

Finish using file.

# PARTS

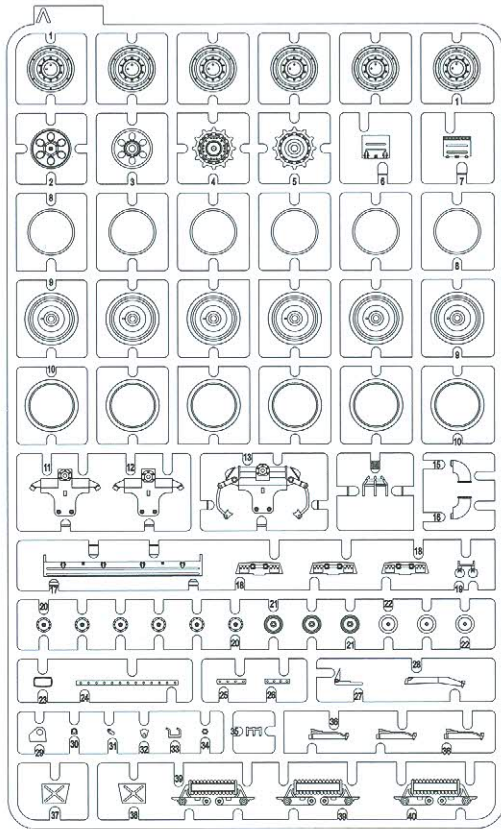

X2

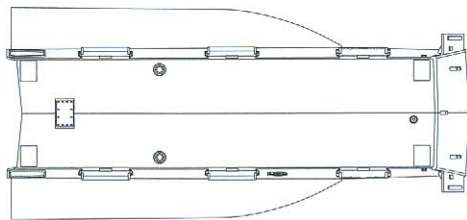

Poly cap  
X2

Gun Mask

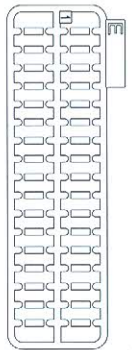
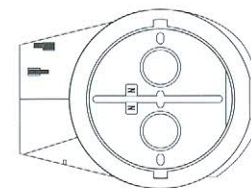
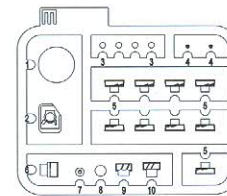
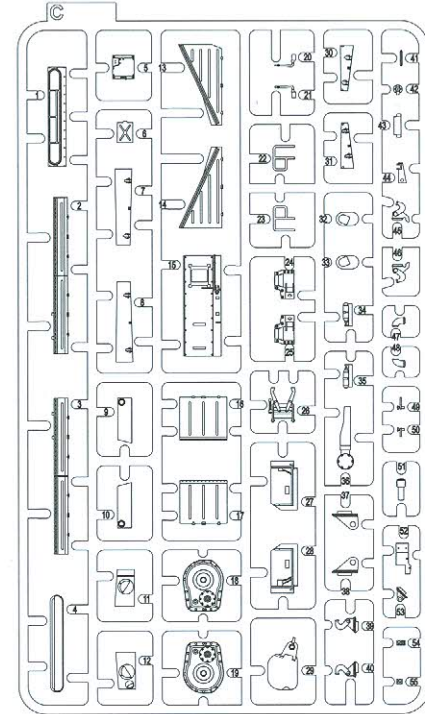
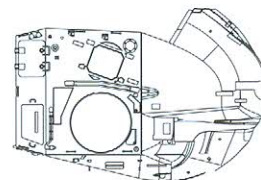
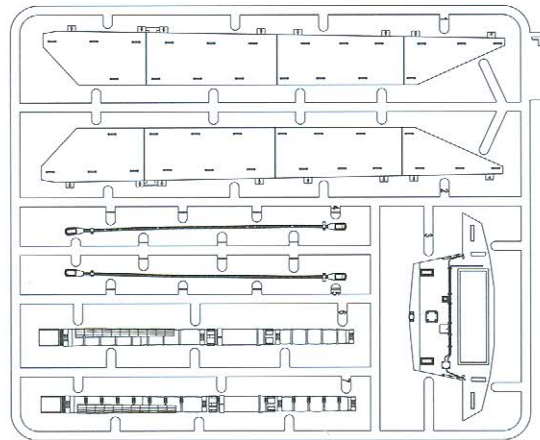
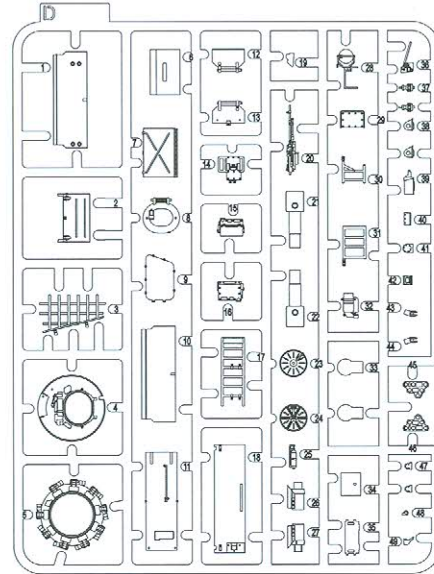
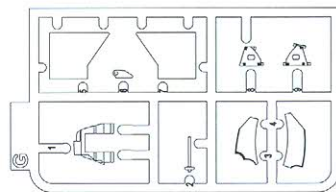
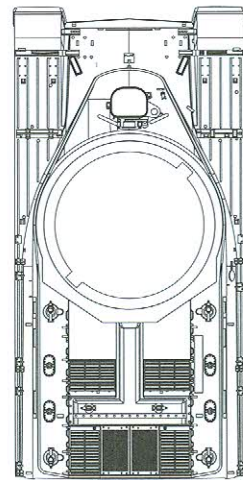
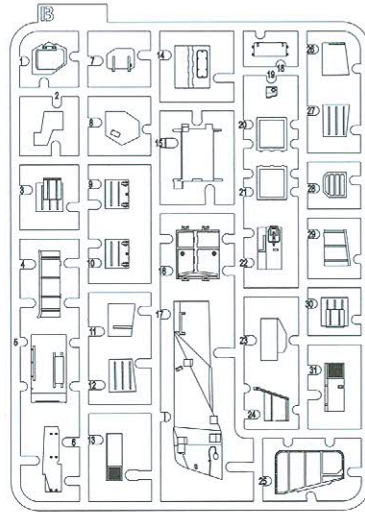

X6



X200

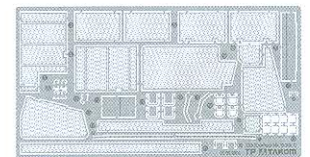

PE



Decal

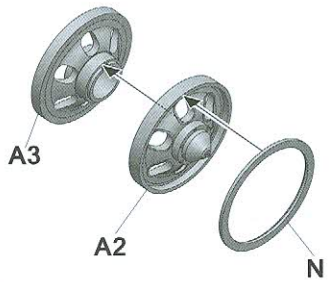

**Make 2**

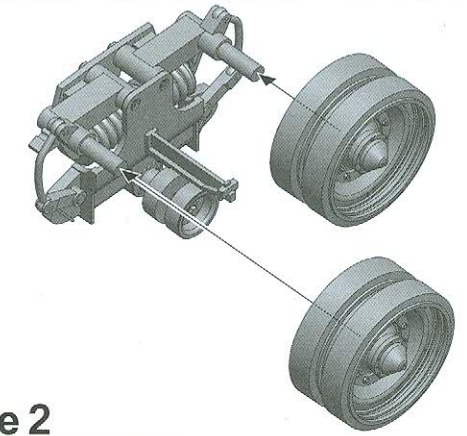
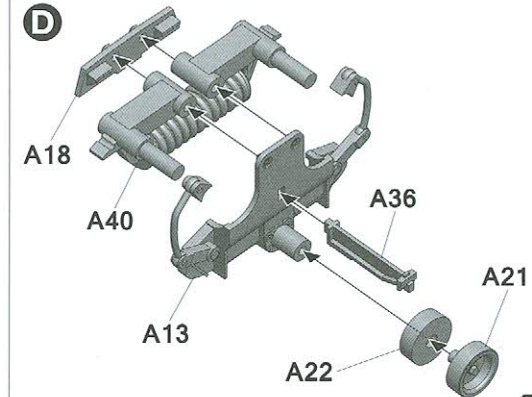
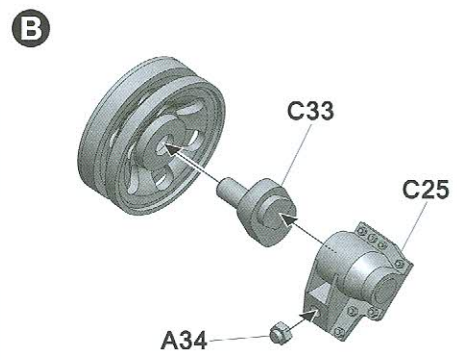
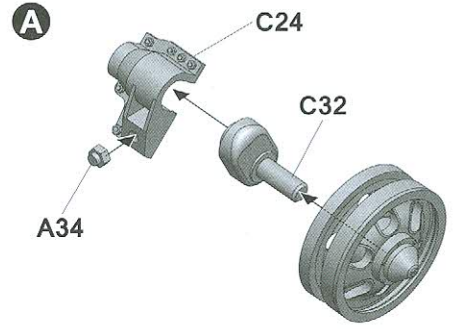

**Make 2**

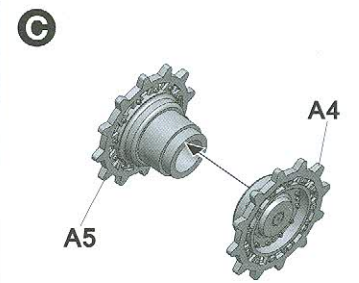

**Make 2**

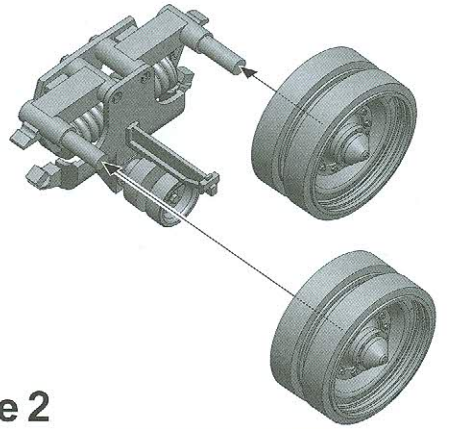
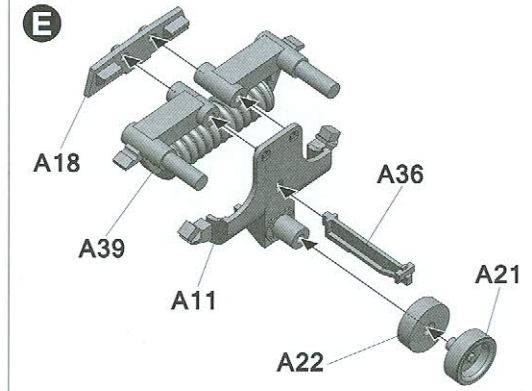

**Make 2**

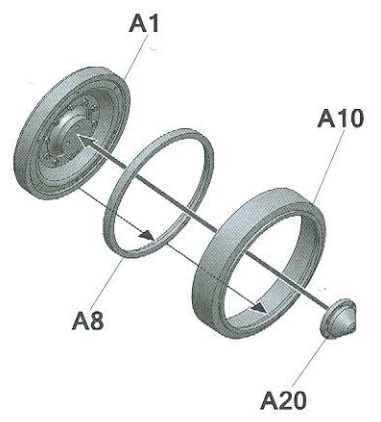

**Make 12**

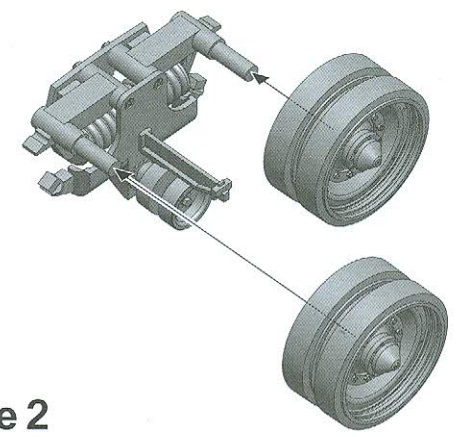
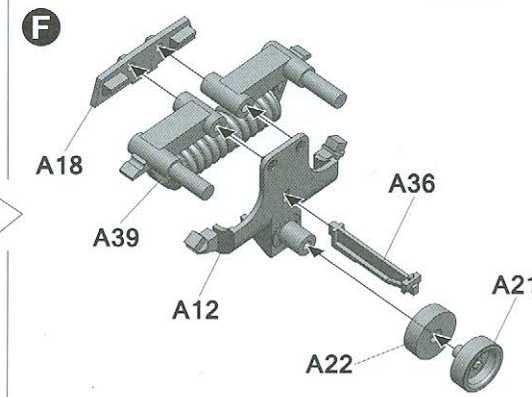
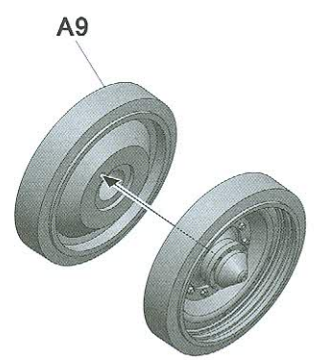

**Make 2**

2

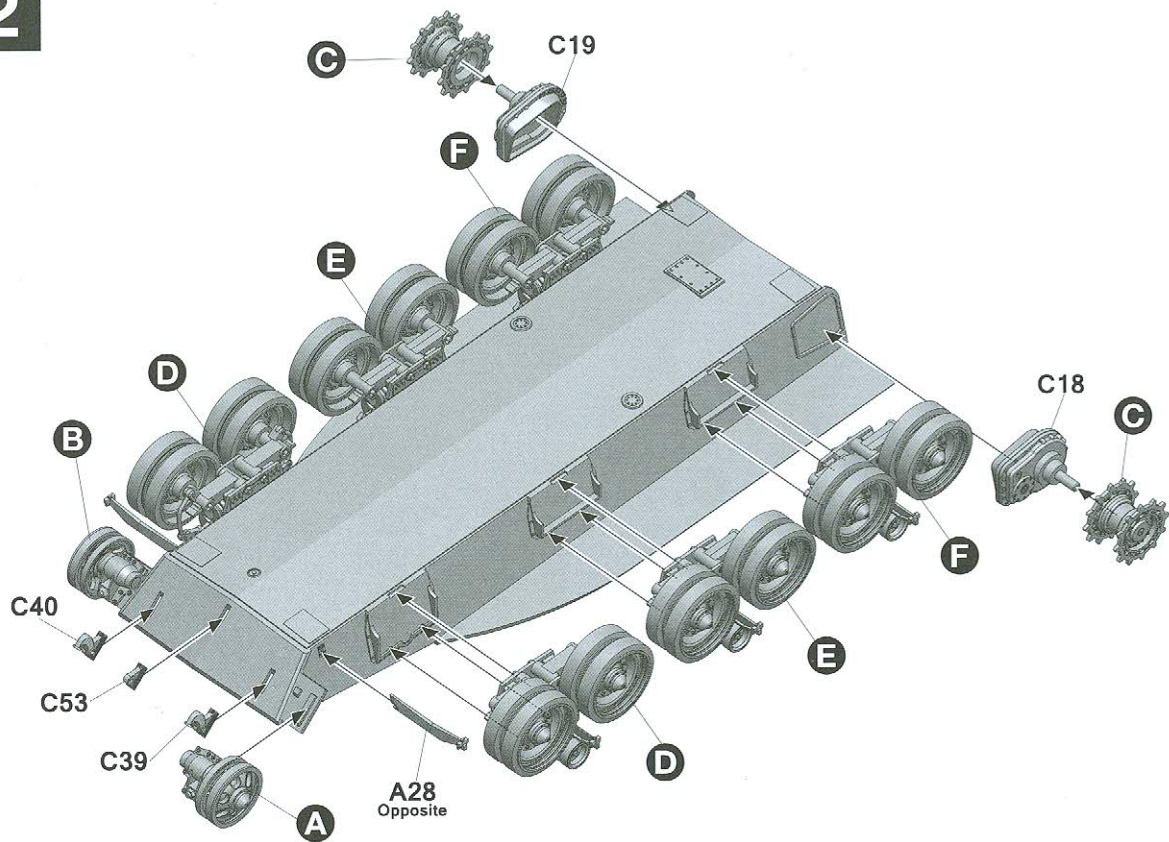

3

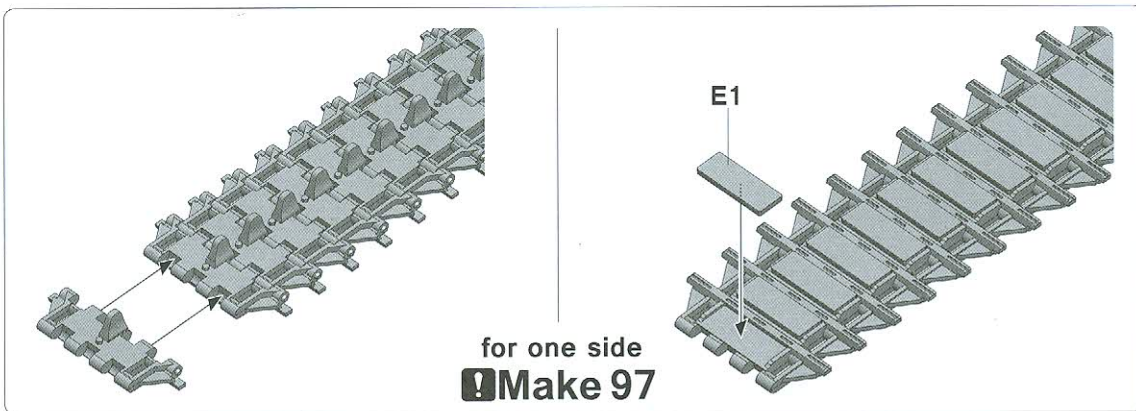
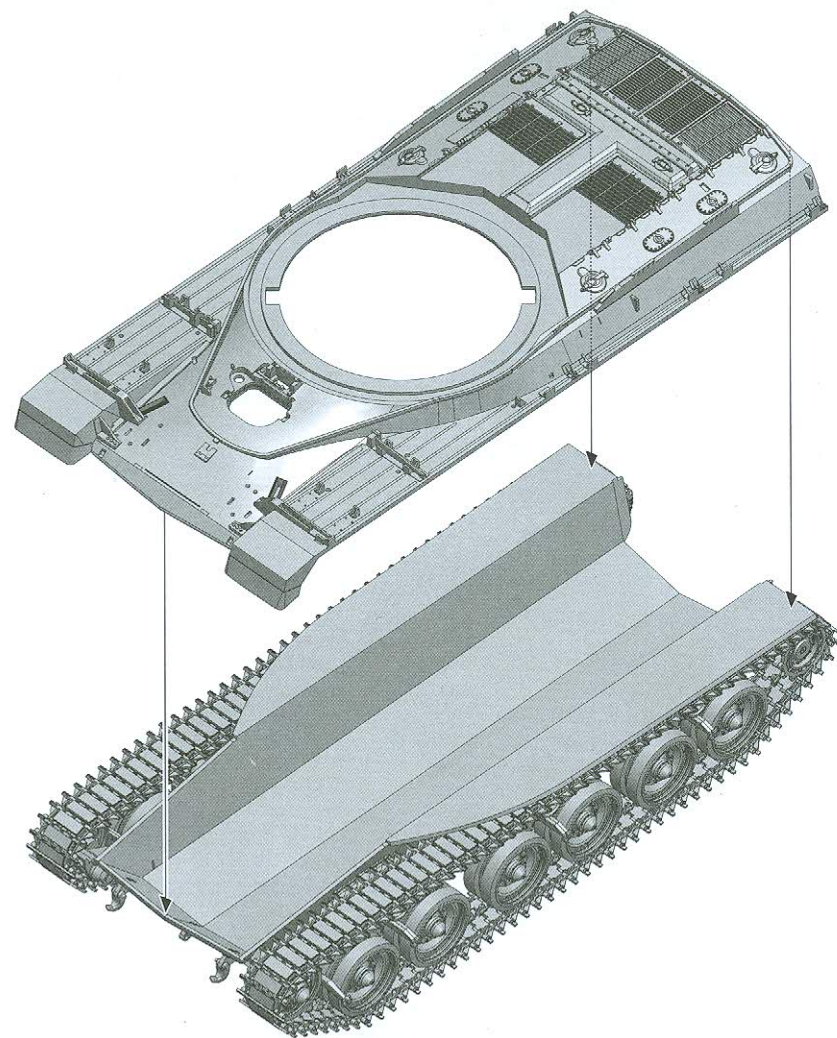
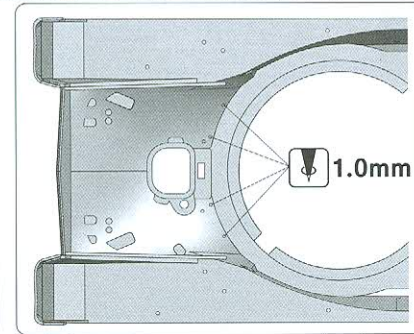
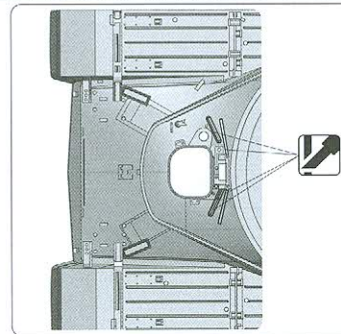

4

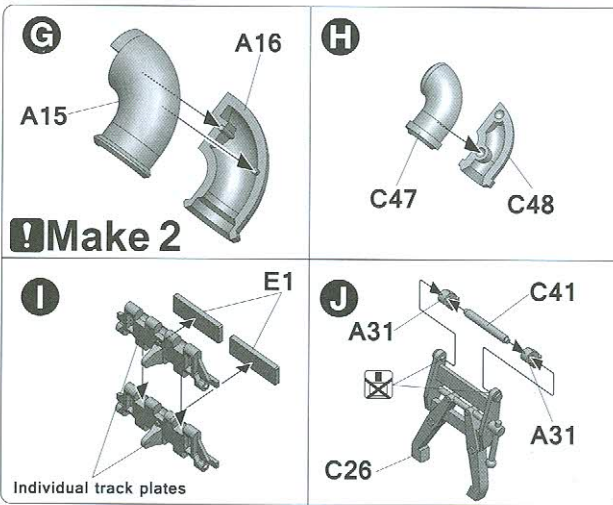
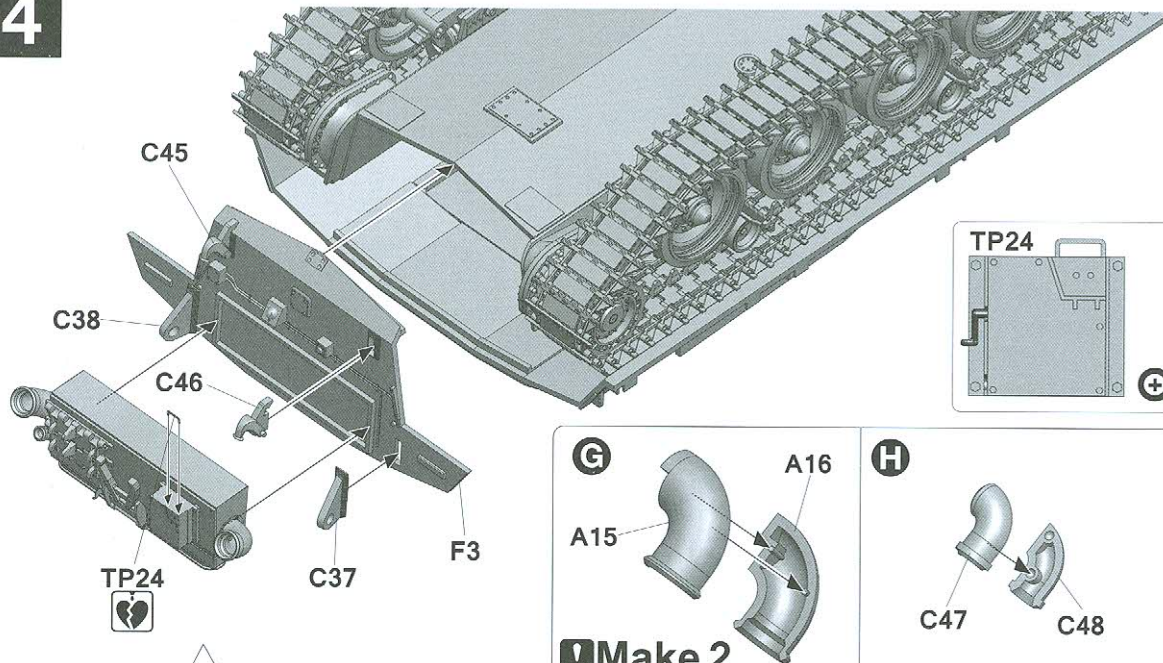

Make 2

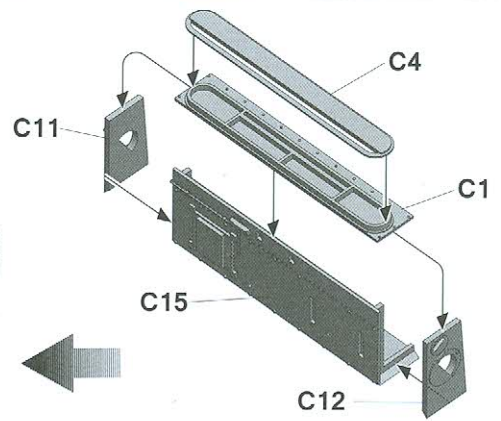
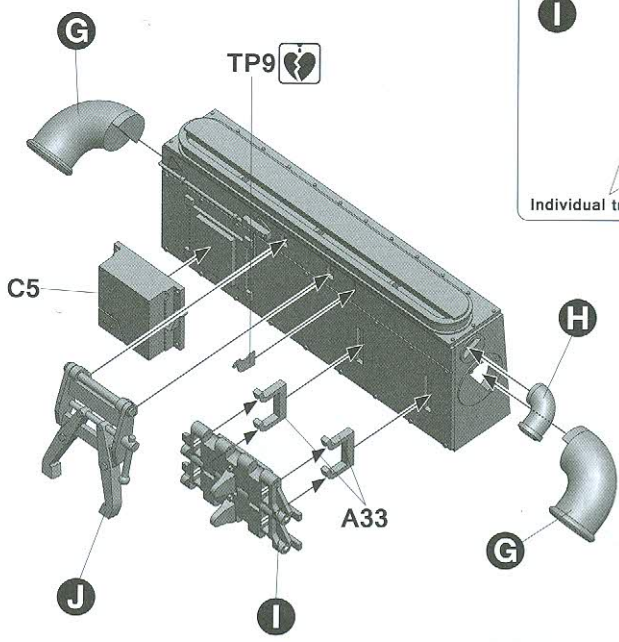

6

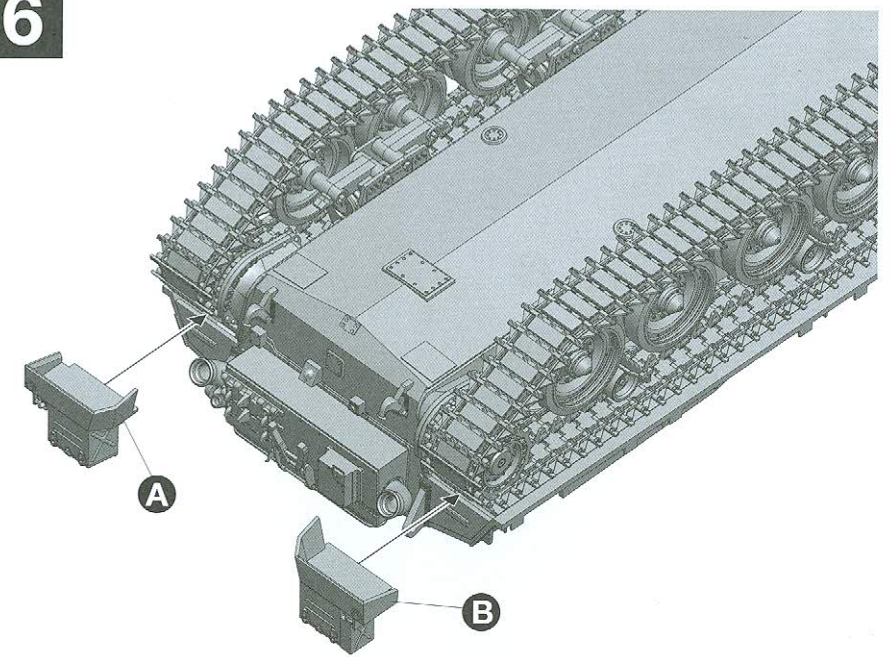

5

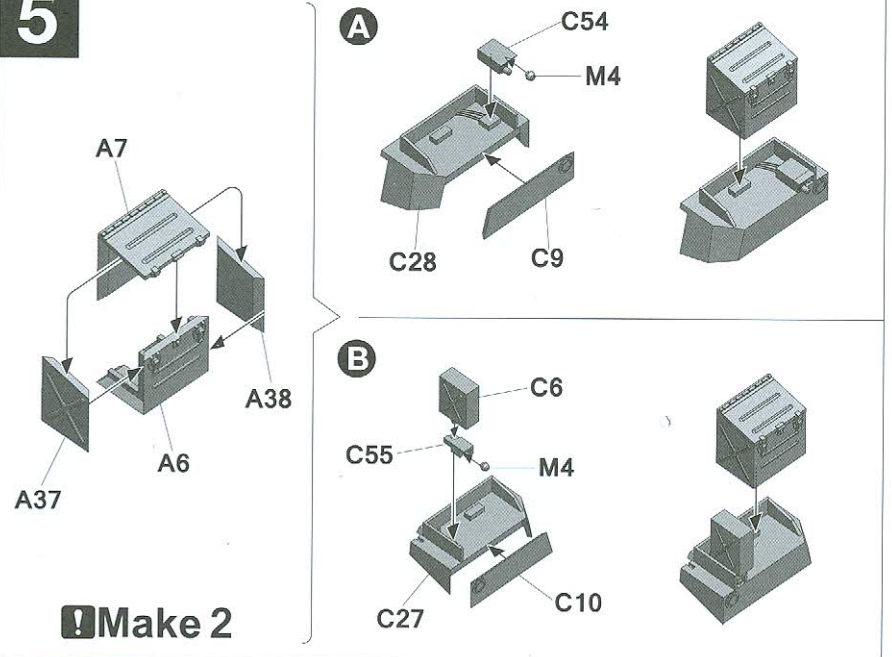

5

7

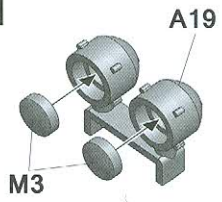

Make 2

A

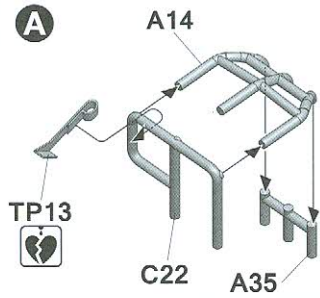

B

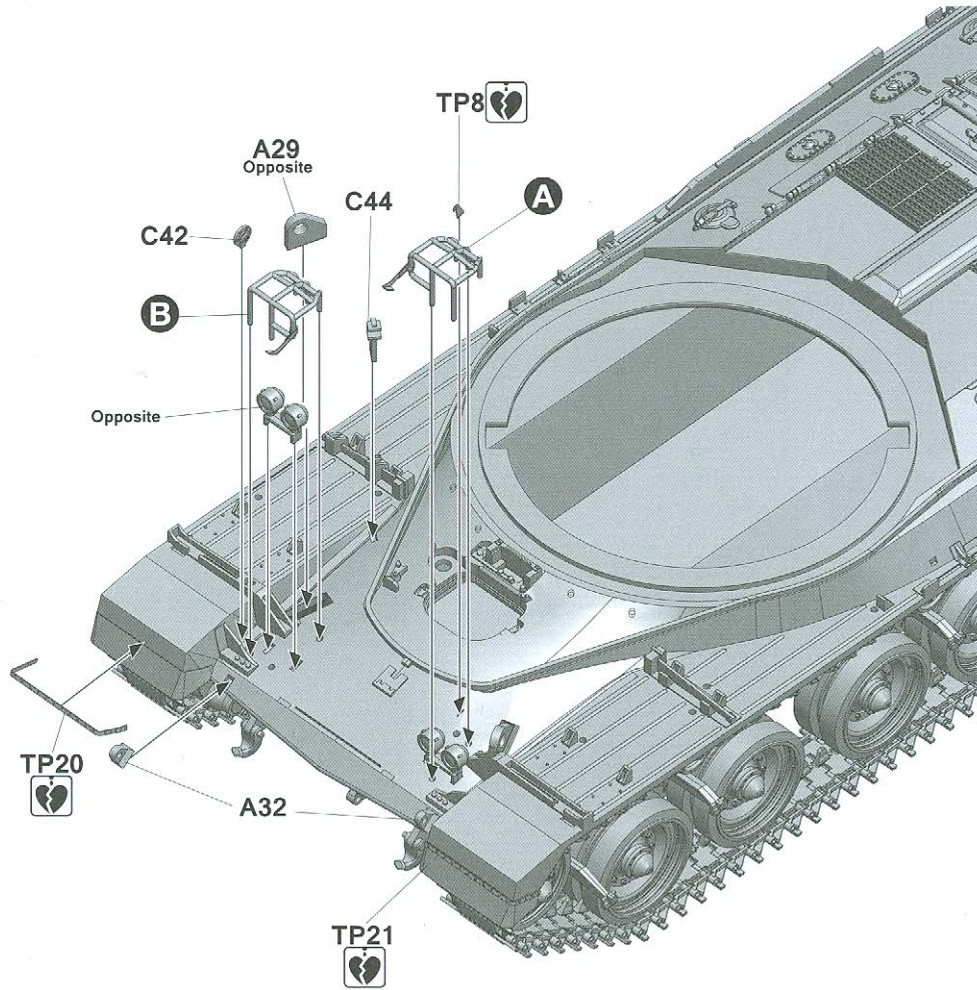
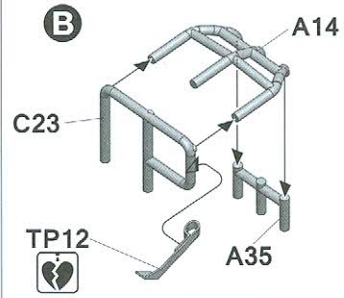

8

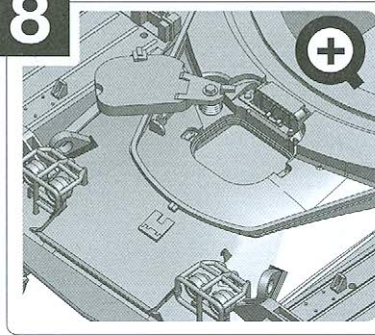

Open

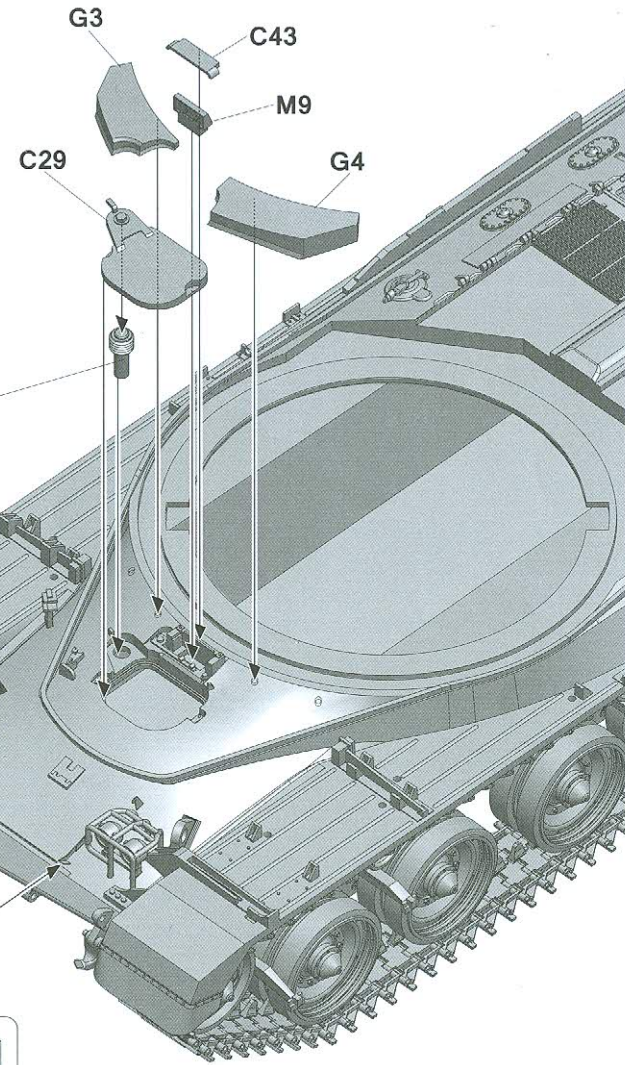

C51  
Open/closed

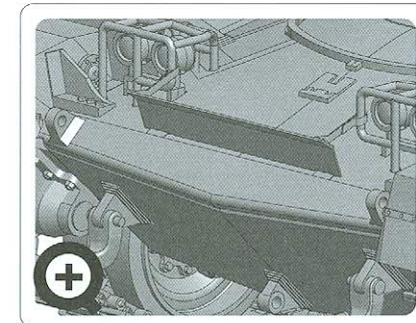

9

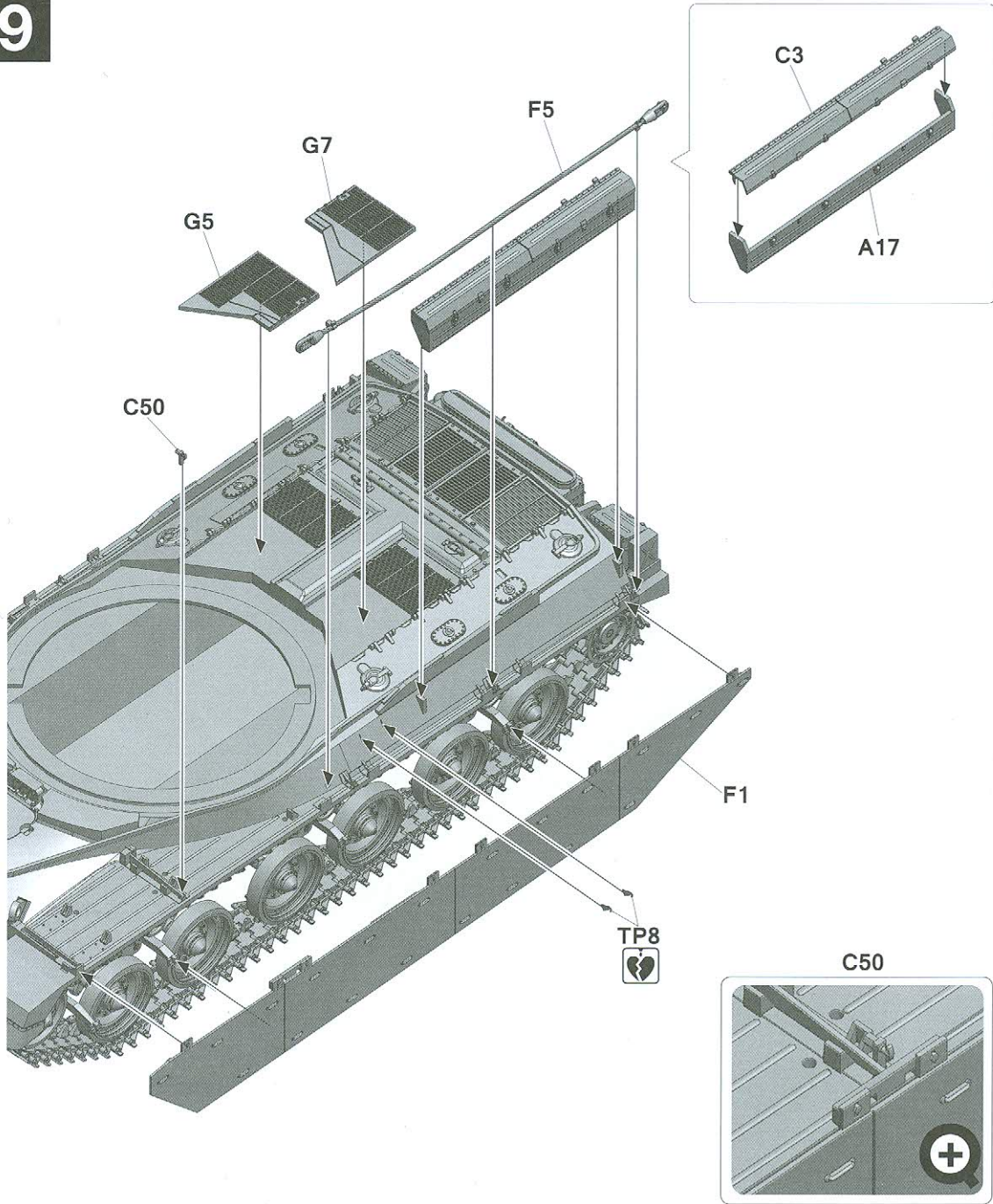

10

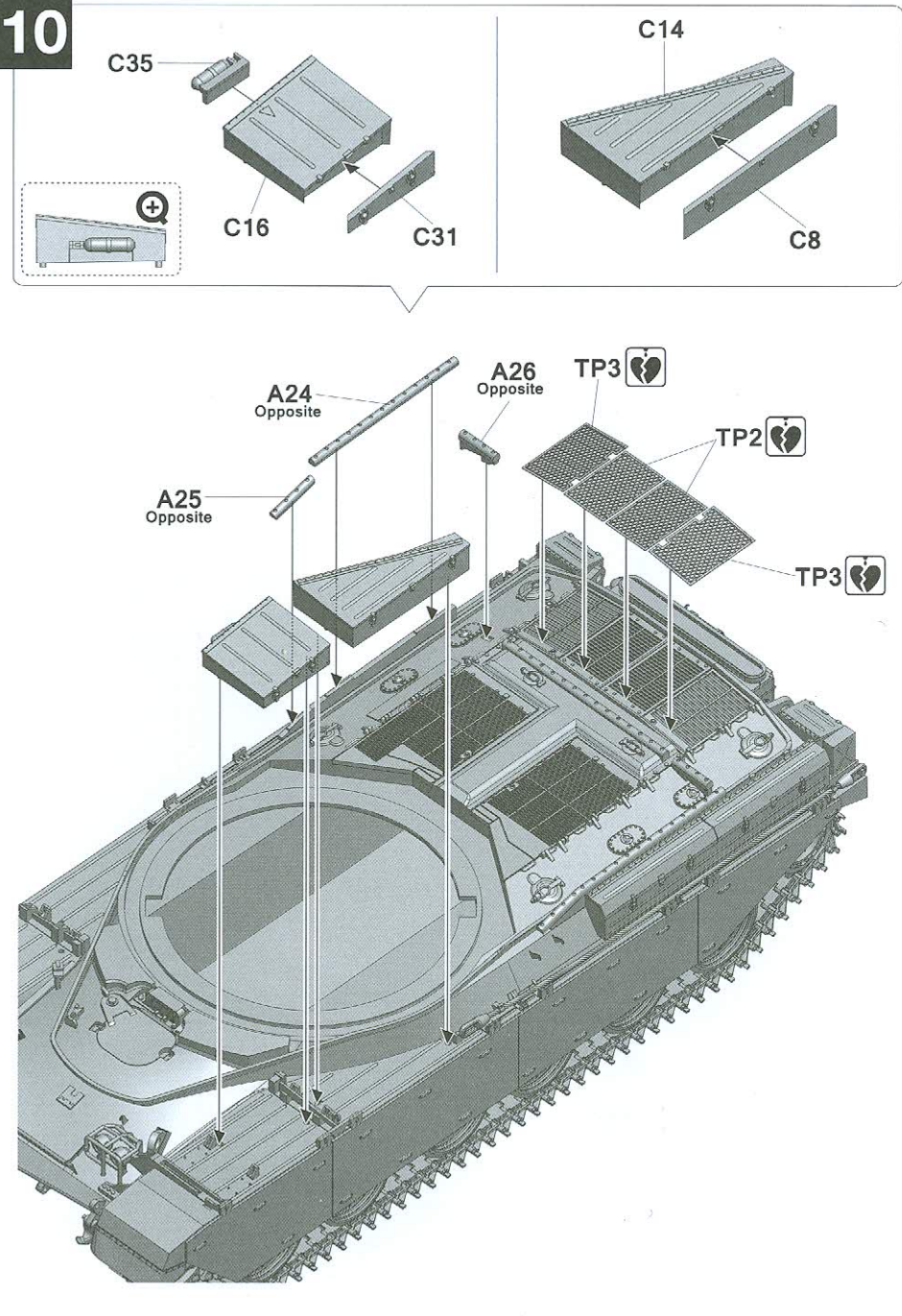



# 11

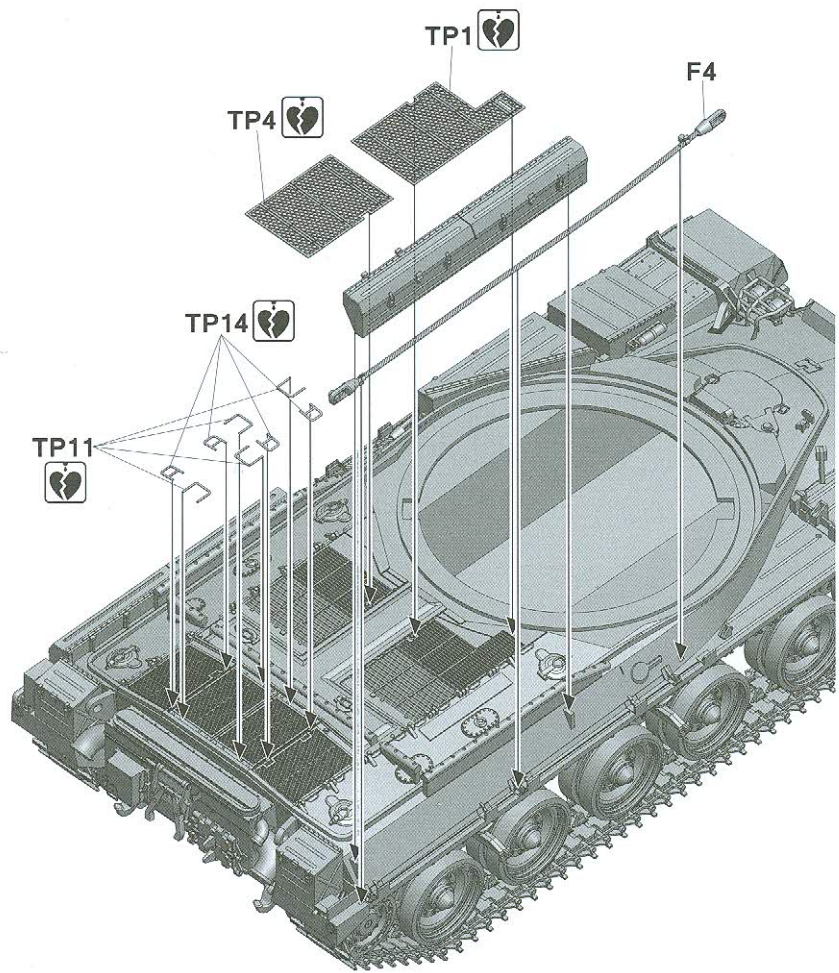
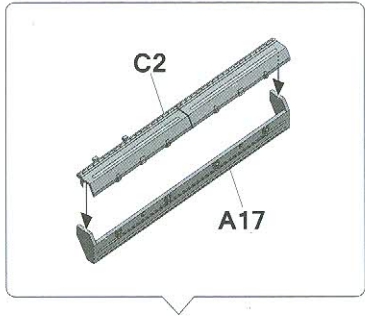

# 12

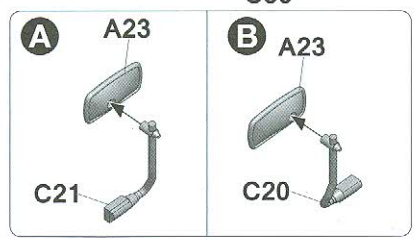
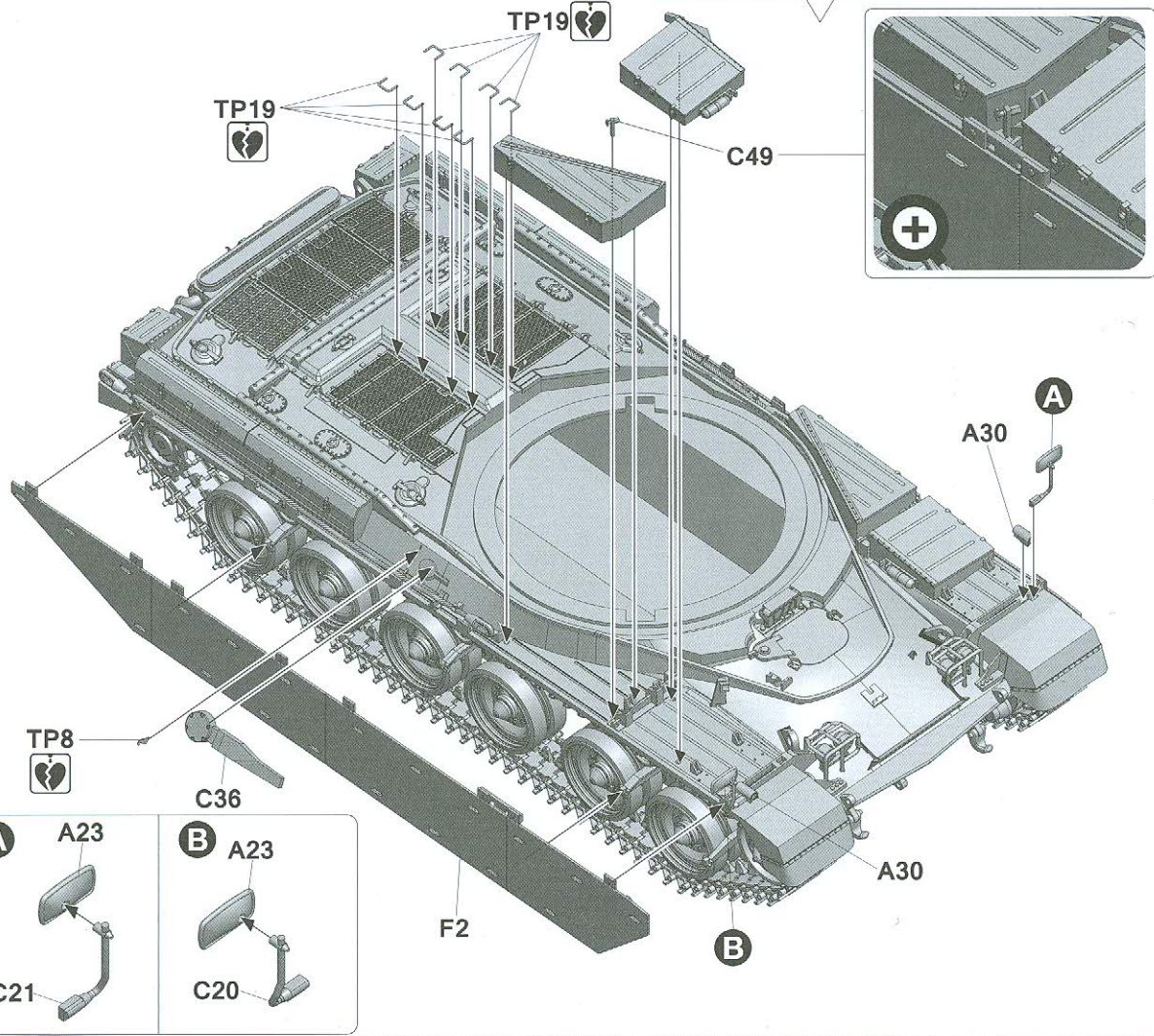
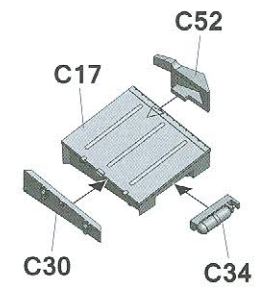
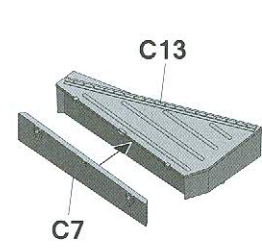
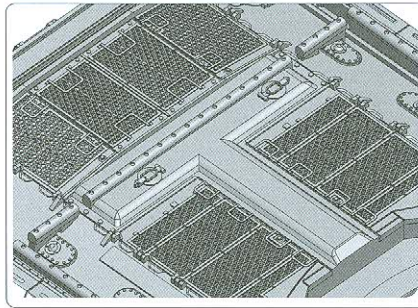

13

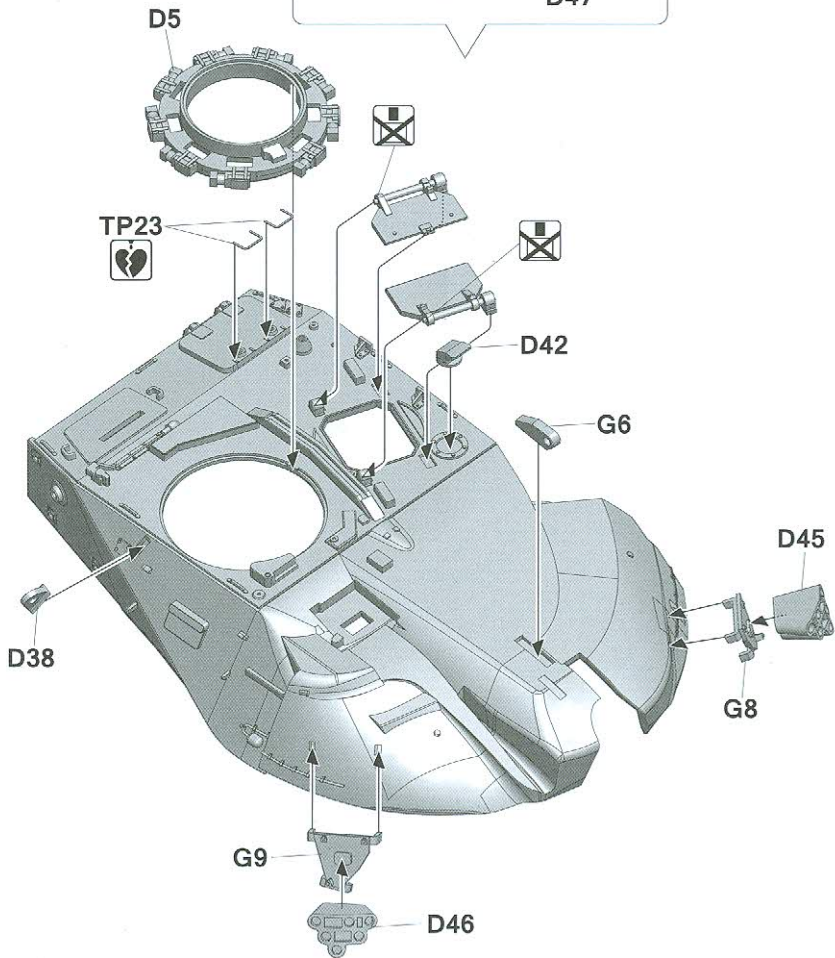
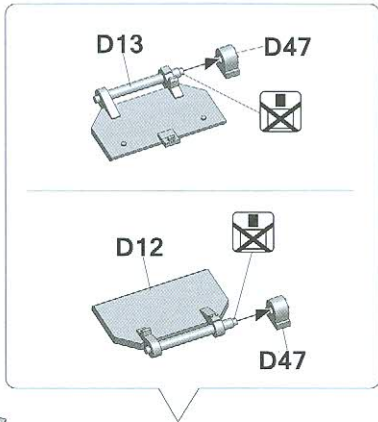

14

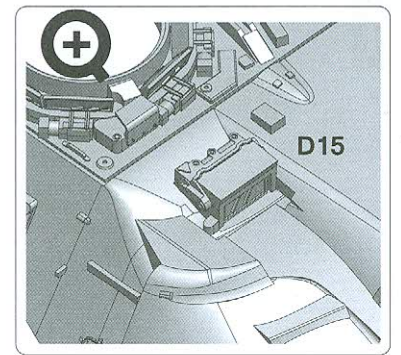
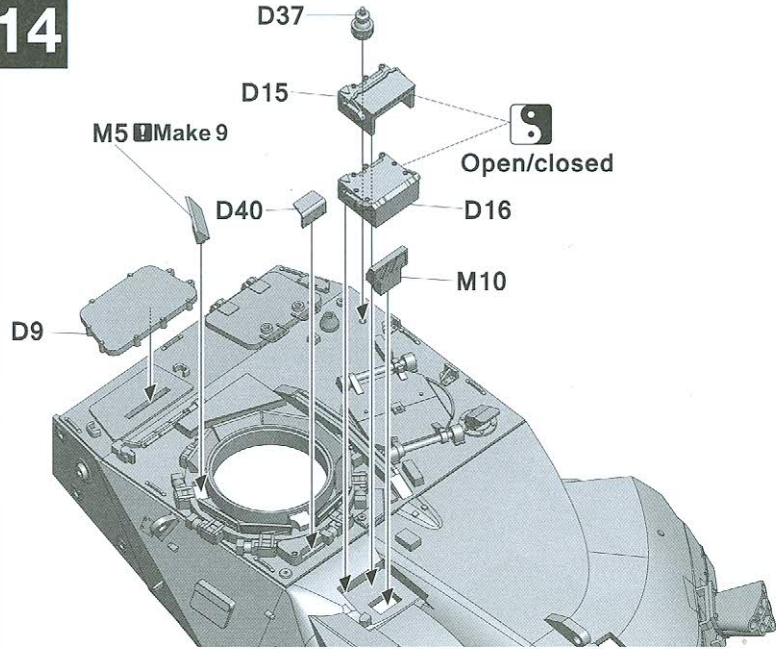

Open

15

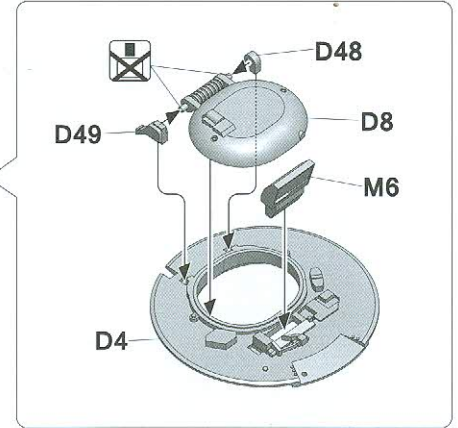
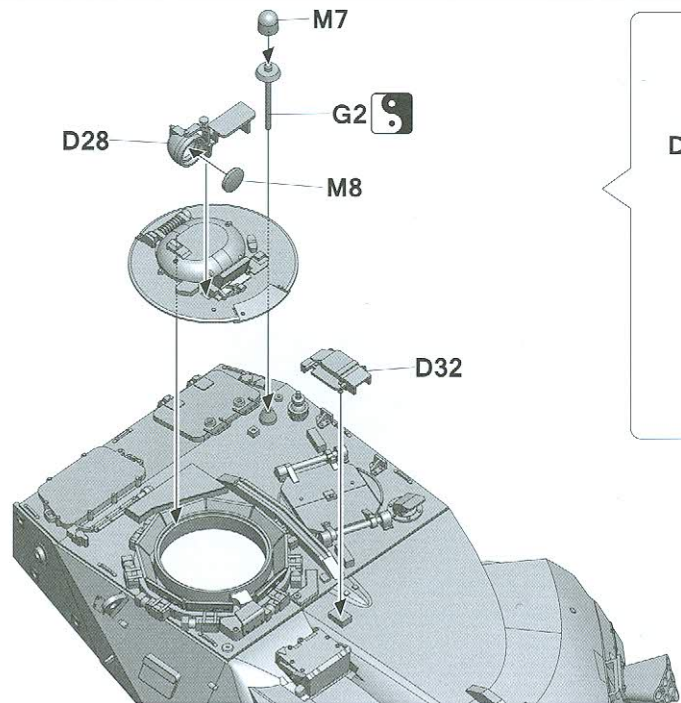

16

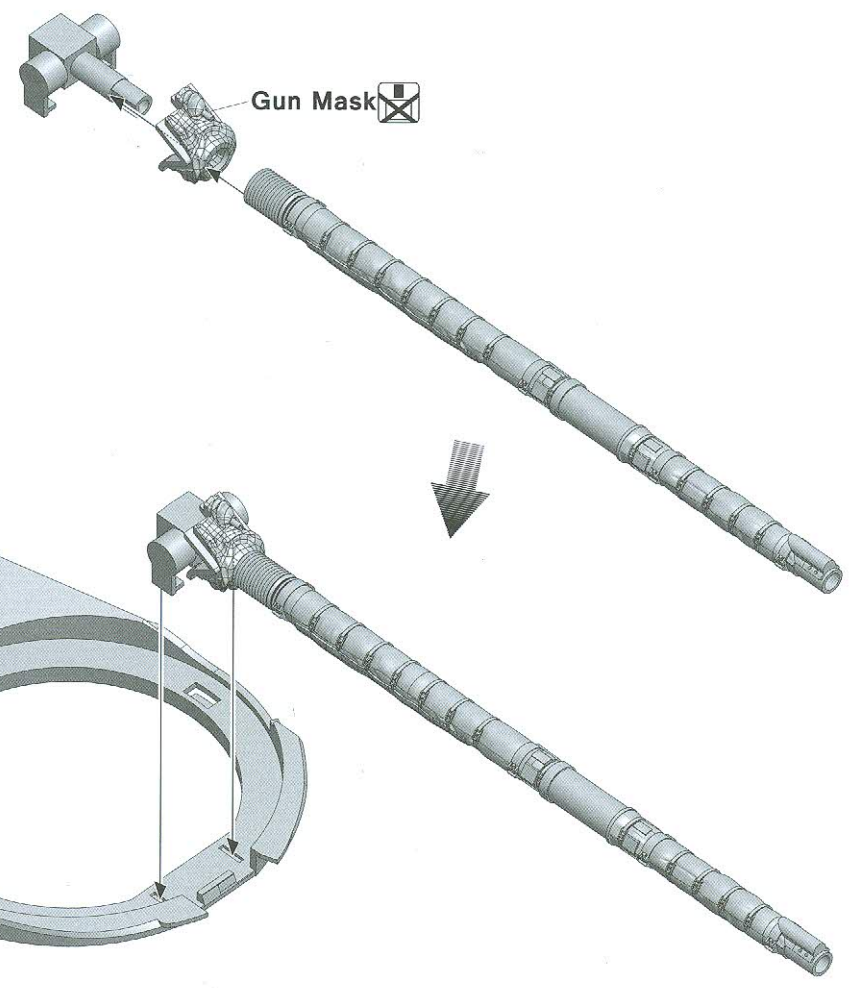
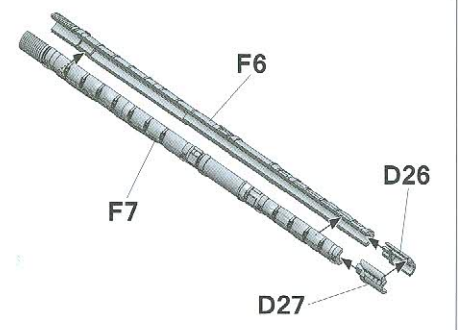
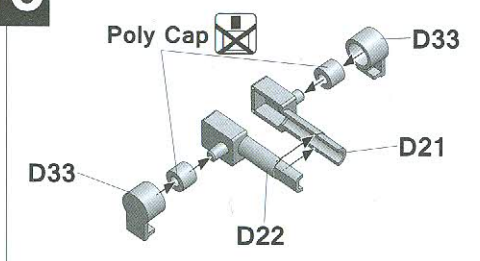

17

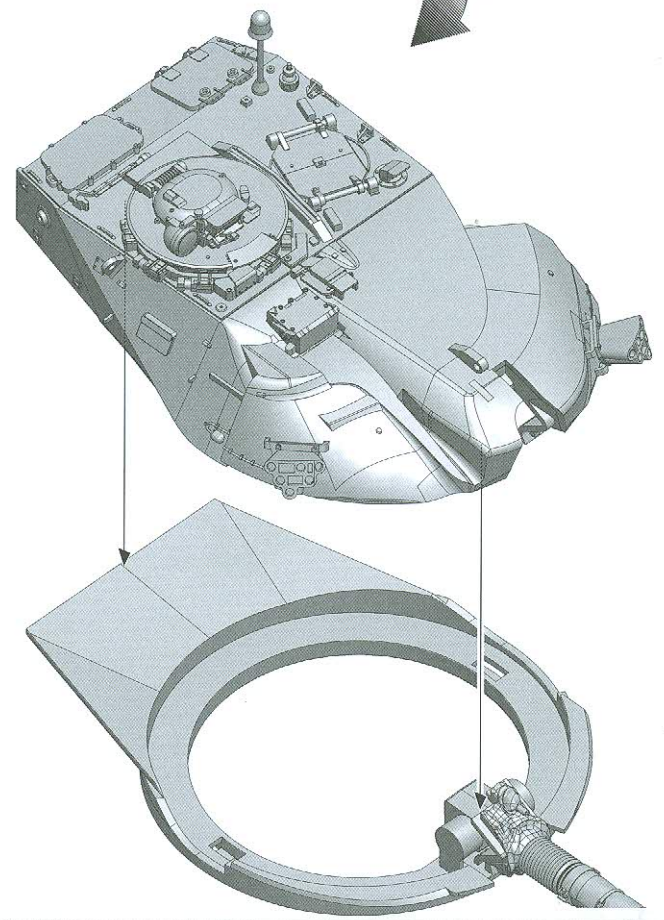
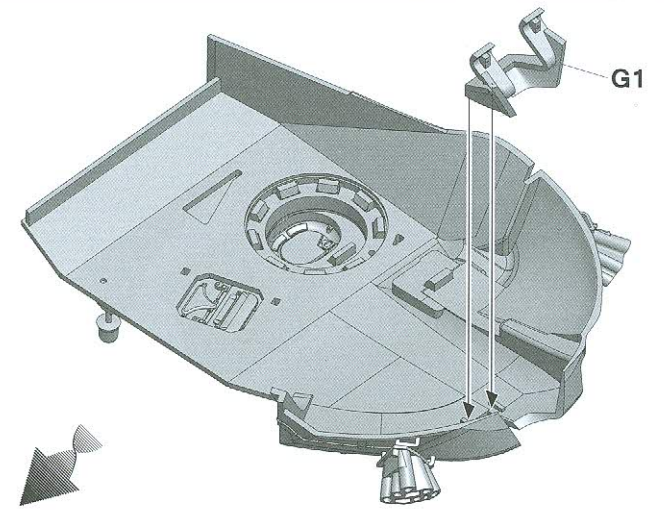
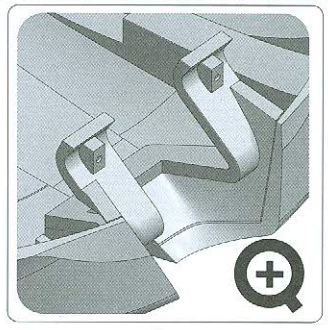

18

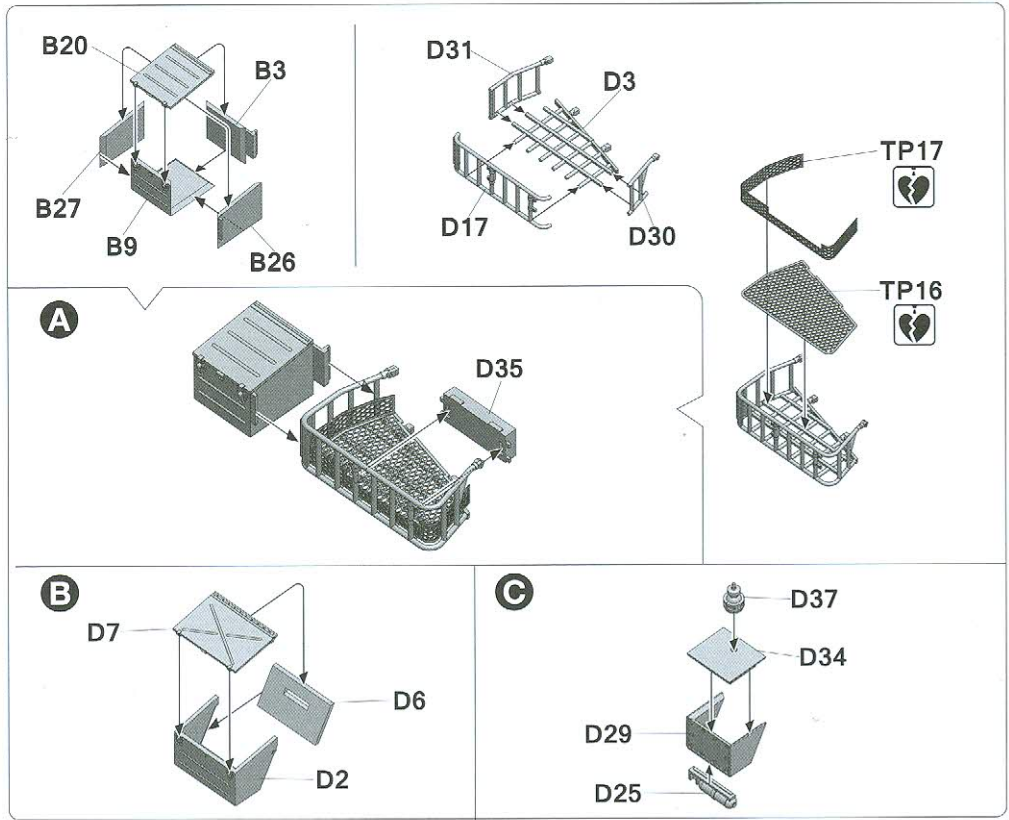
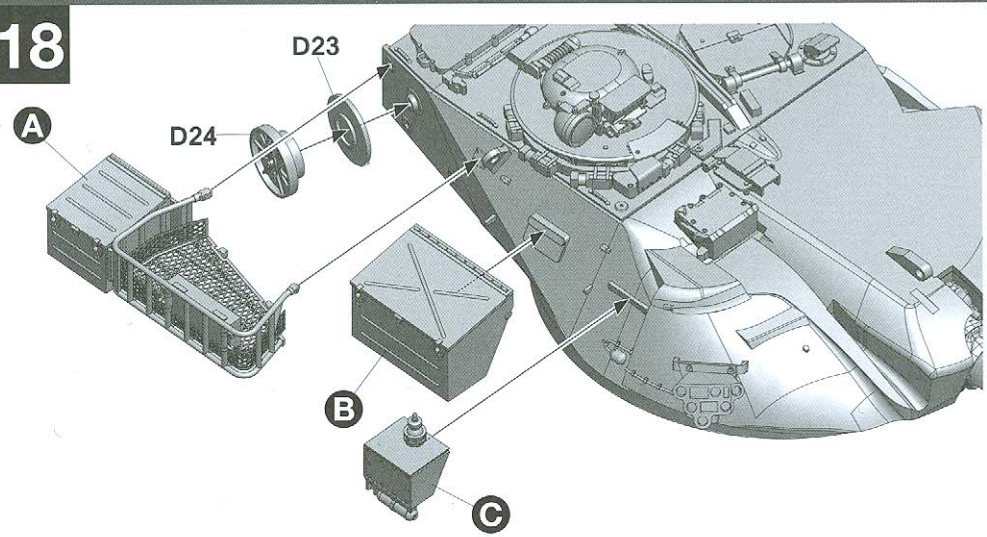

19

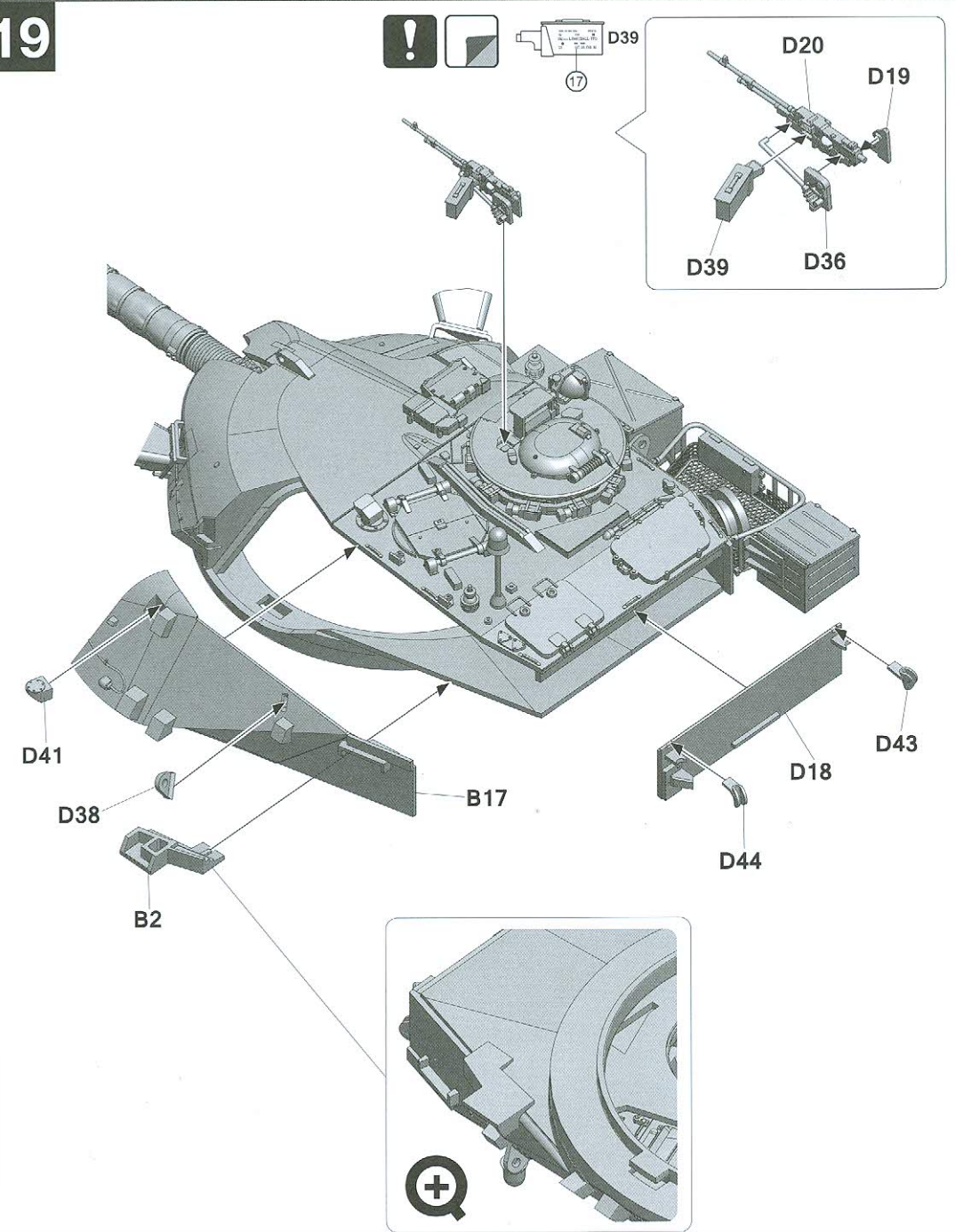

20

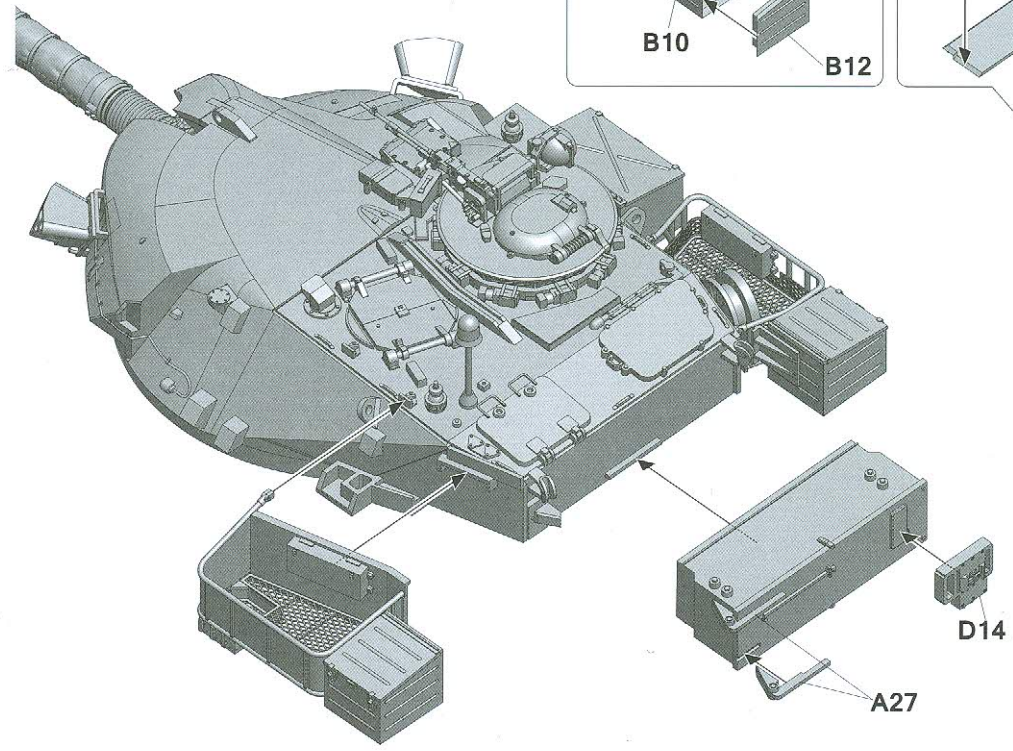
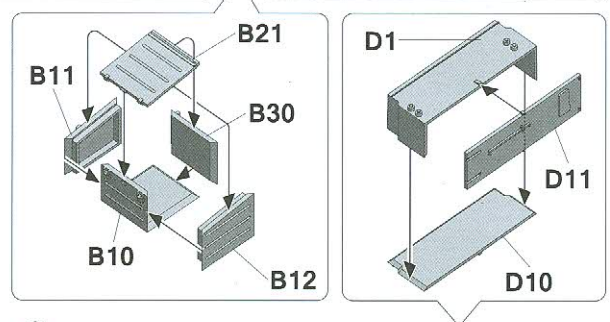
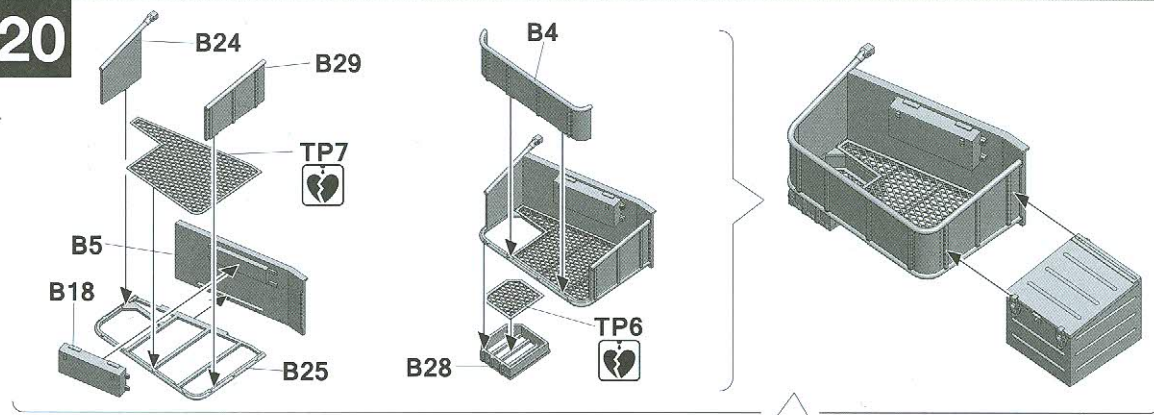

21

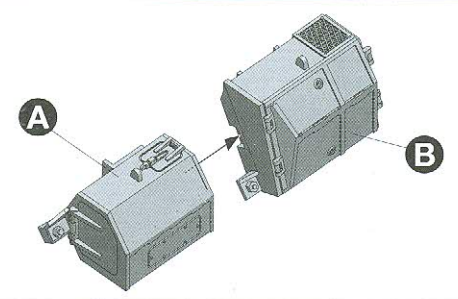
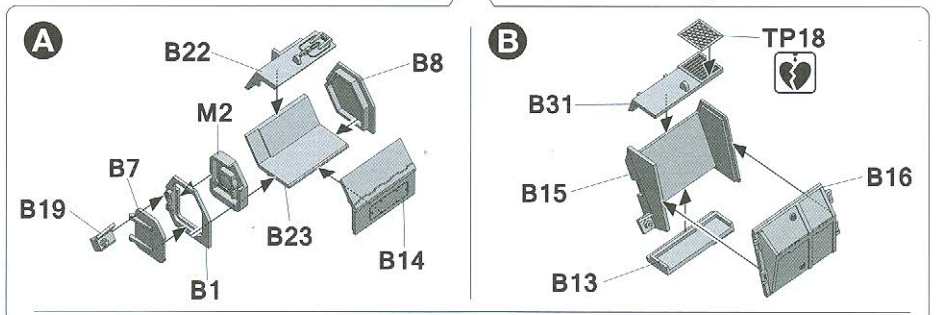
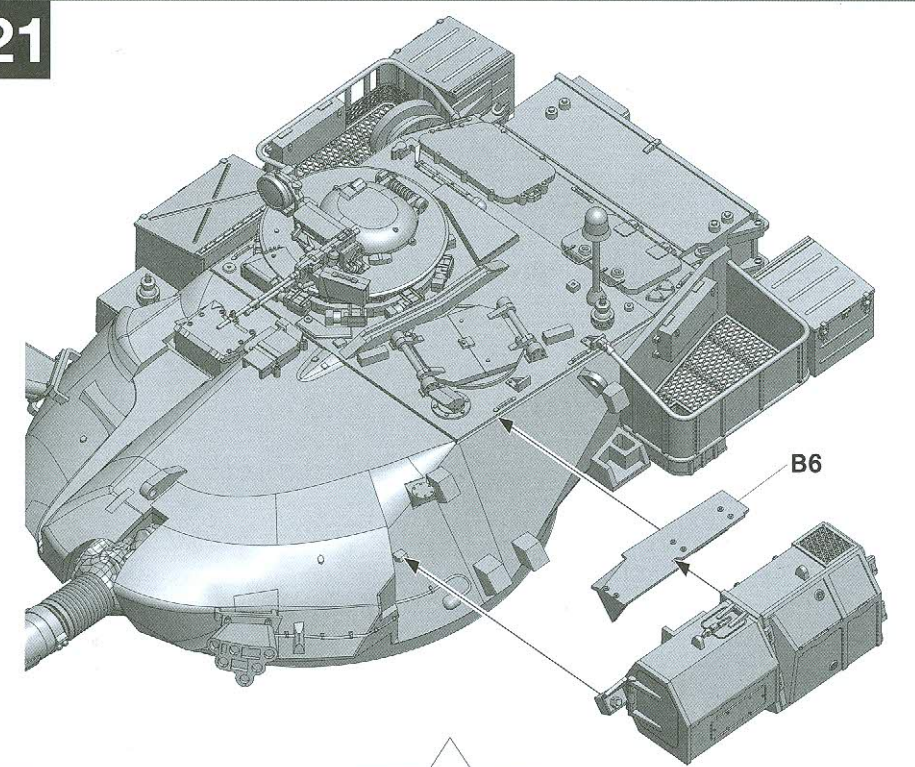

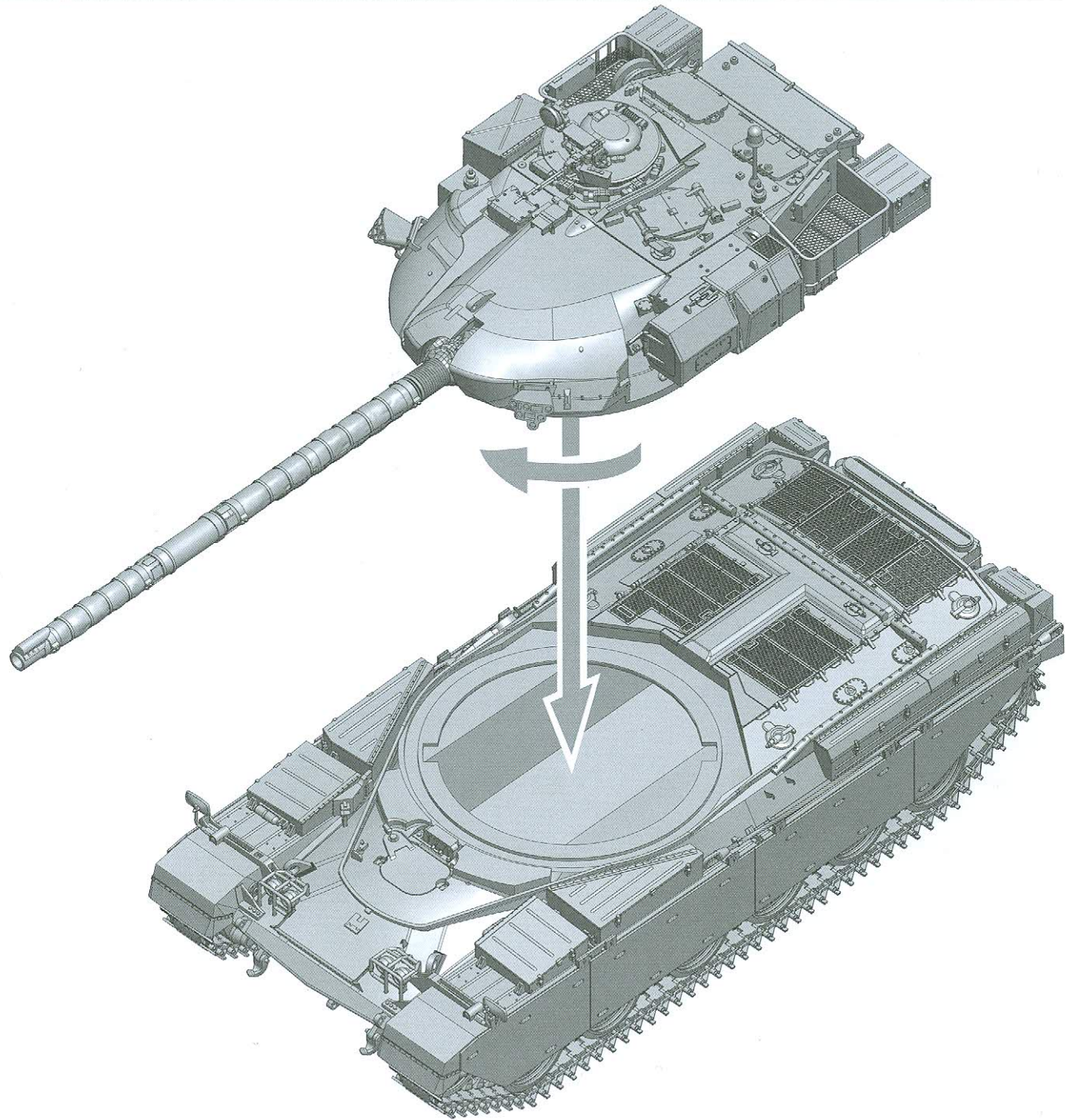

**1/35**  
No. 2034

**LATE TYPE**

**TAKOM**

**FRENCH HEAVY TANK**

**ST. CHAMOND**

ALL THE WHEELS & TRACK LINKS ARE MOVABLE. A DETAILED STATIC DISPLAY PLASTIC MODEL. A  
 4 TYPES OF MARKINGS. A REPRODUCE THE CHASSIS STRUCTURE EXACTLY. A  
 1 TRACK LINK INCLUDES A READY TO ASSEMBLE PRECISION MODEL KIT. A  
 1 TRACK LINK INCLUDES A READY TO ASSEMBLE PRECISION MODEL KIT. A  
 1 TRACK LINK INCLUDES A READY TO ASSEMBLE PRECISION MODEL KIT. A

**1/35**  
No. 2034

**MK.V**

**Female**

**Hermaphrodite**

**TAKOM**

DETAILED STATIC DISPLAY PLASTIC MODEL. A  
 ALL WHEELS ARE MOVABLE. A  
 2 PARTS INCLUDED. A  
 8 TYPES OF MARKINGS. A  
 EASY ASSEMBLY WORKABLE TRACKS. A  
 ALL DOORS CAN BE OPENED. A  
 3 PARTS INCLUDED. A  
 1 TRACK LINK INCLUDES A  
 1 TRACK LINK INCLUDES A  
 1 TRACK LINK INCLUDES A

**3** **1n** **1**

**B 56** **9703**

**Male**

A READY TO ASSEMBLE PRECISION MODEL KIT. A INTENDED FOR COLLECTORS OF AGE 14 YEARS AND ABOVE. A MODEL MAY VARY FROM IMAGE ON BOX. A CEMENT AND PAINT NOT INCLUDED.

WWI / WWII GERMAN

**Krupp 21 cm Mörser 10/16**

A DETAILED STATIC DISPLAY PLASTIC MODEL. A THE MAIN GUN FROM ANOTHER. A 4 TYPES OF MARKINGS. A 4 TYPES OF WHEELS.

**TAKOM**

**1/35**  
No. 2032

**2** **1n** **1**

WWII GERMAN

**12.8 CM FLAK 40 ZWILLING**

A READY TO ASSEMBLE PRECISION MODEL KIT. A INTENDED FOR COLLECTORS OF AGE 14 YEARS AND ABOVE. A MODEL MAY VARY FROM IMAGE ON BOX. A CEMENT AND PAINT NOT INCLUDED.

**TAKOM**

**1/35**  
No. 2023

**MKA "WHIPPET"**

**WWI MEDIUM TANK**

**TAKOM**

DETAILED STATIC DISPLAY PLASTIC MODEL. A  
 ALL WHEELS ARE MOVABLE. A  
 EASY ASSEMBLY WORKABLE TRACKS. A  
 ALL DOORS CAN BE OPENED. A  
 3 PARTS INCLUDED. A  
 8 TYPES OF MARKINGS. A

**1/35**  
NO. 2025

2015/2026

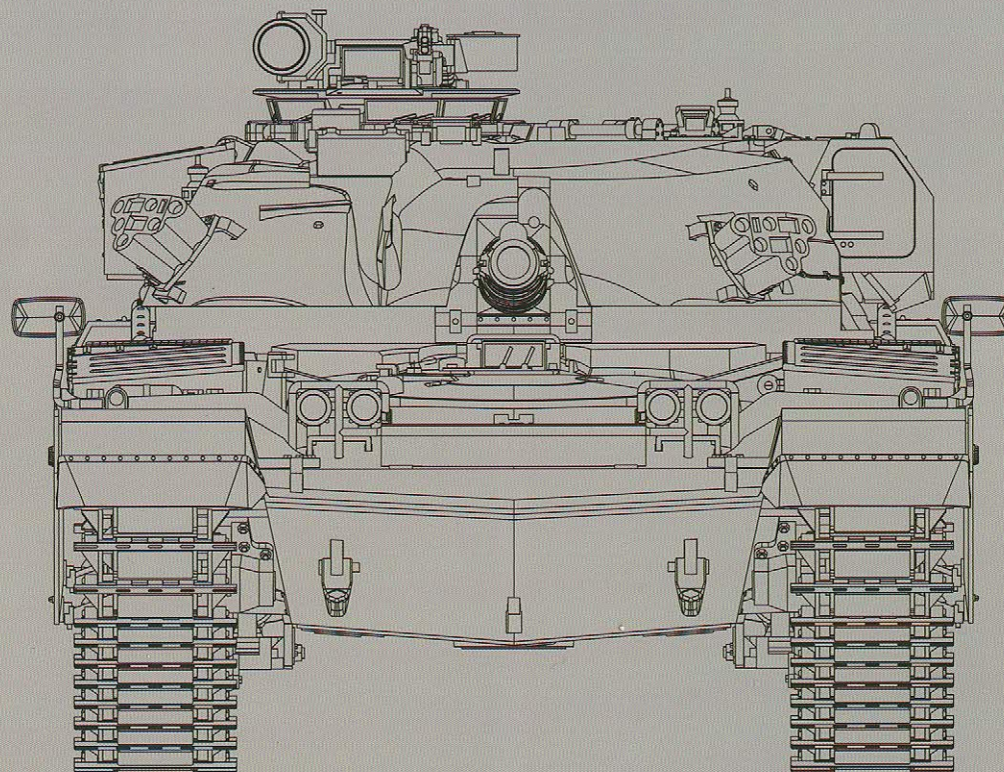

 You can find TAKOM on Facebook.com



# Upper Turret

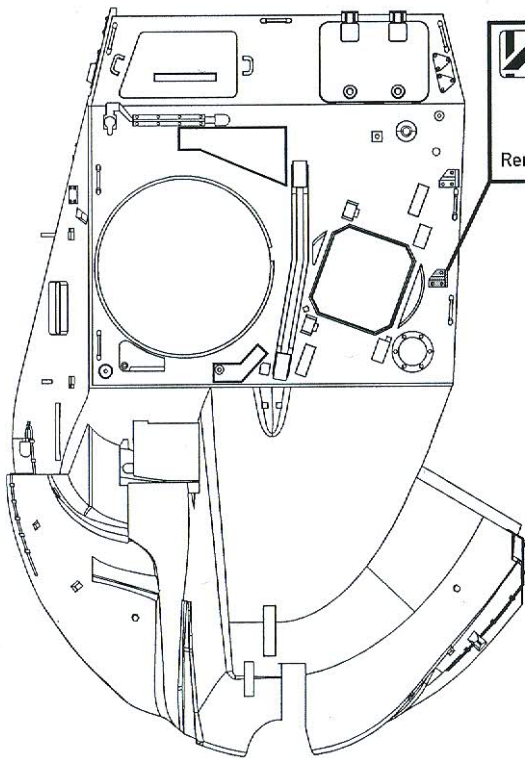

#2026

BRITISH MAIN BATTLE TANK

# CHIEFTAIN Mk.11



△ READY TO ASSEMBLE PRECISION MODEL KIT   △ INTENDED FOR COLLECTORS OF AGE 14 YEARS AND ABOVE   △ MODEL MAY VARY FROM IMAGE ON BOX   △ CEMENT AND PAINT NOT INCLUDED



1/35  
No.2026

- △ DETAILED STATIC DISPLAY PLASTIC MODEL
- △ PE & CLEAR PARTS INCLUDED
- △ INDIVIDUAL TRACKS
- △ 5 TYPES OF MARKINGS
- △ THE GUN CAN PITCH
- △ ALL HATCHES CAN BE BUILT IN OPEN OR CLOSED POSITION

## Painting and Marking Guide

A.MIG 033

Rubber &amp; Tires

A.MIG 041

Dark Rust

A.MIG 045

Gun Metal

A.MIG 094

Crystal Glass

A.MIG 095

Crystal Smoke

A.MIG 096

Crystal  
Pantopice Green

A.MIG 061

Warm Sand  
Yellow

A.MIG 084

NAIO Green

Unknown unit, BATUS

A.MIG 050

Mott White

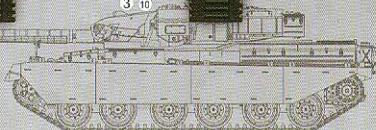
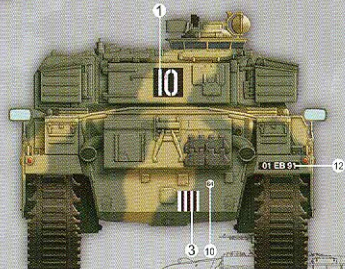
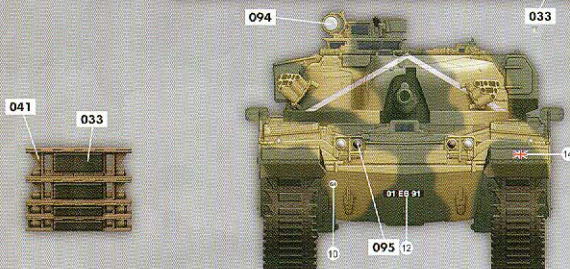
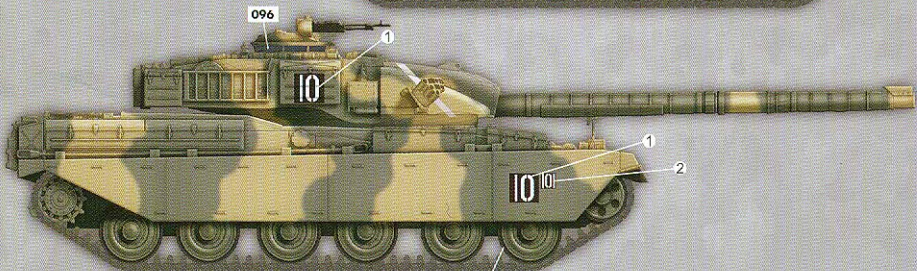
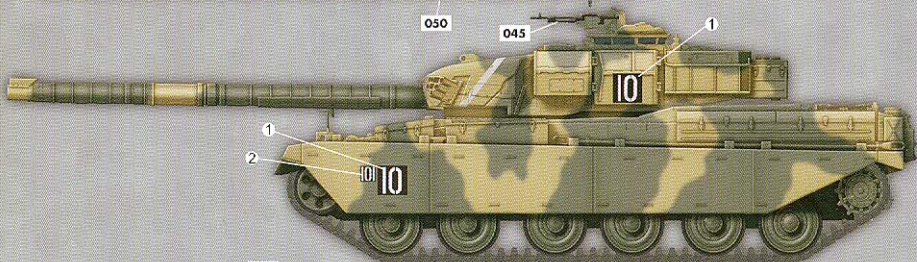
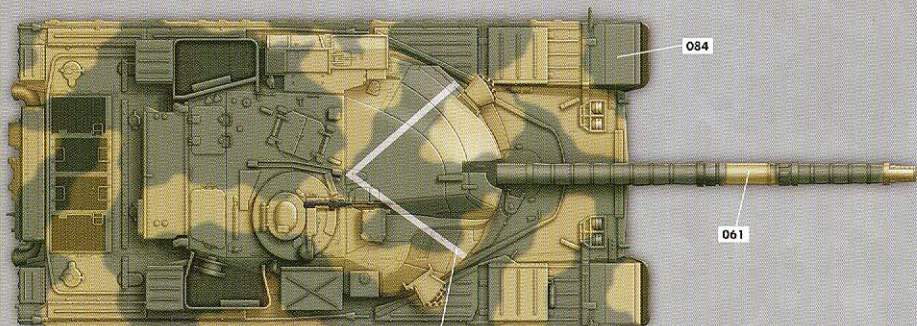

## Painting and Marking Guide

A.MIG 033

Rubber &amp; Tires

A.MIG 041

Dark Rust

A.MIG 045

Gun Metal

A.MIG 094

Crystal Glass

A.MIG 095

Crystal Smoke

A.MIG 096

Crystal  
Pansyope Green

A.MIG 046

Matt Black

A.MIG 084

NATO Green

A Squadron, 1 RTR Tofrek Barracks, Hildesheim,  
Germany 1992

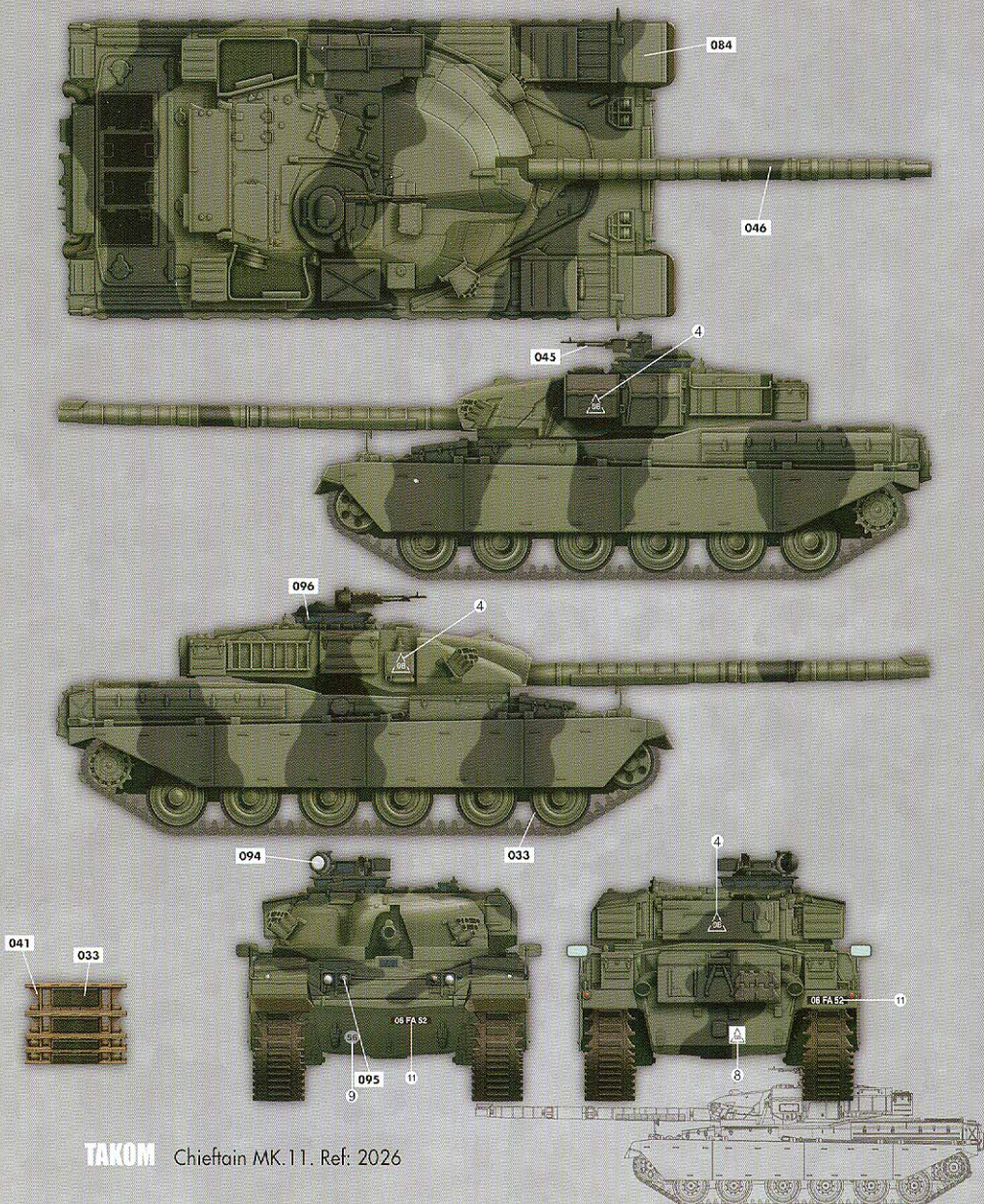

## Painting and Marking Guide

<b>A.MIG 033</b> Rubber & Tires	<b>A.MIG 041</b> Dark Rust	<b>A.MIG 045</b> Gun Metal	<b>A.MIG 094</b> Crystal Glass
<b>A.MIG 095</b> Crystal Smoke	<b>A.MIG 096</b> Crystal Parrotree Green	<b>A.MIG 061</b> Warm Sand Yellow	<b>A.MIG 206</b> FS 34075 (BS 641)
<b>A.MIG 084</b> NATO Green	<b>A.MIG 194</b> Aluminium	<b>A.MIG 050</b> Melt White	

5th Inniskilling Dragoon Guards, British Army training unit Suffied, Canada

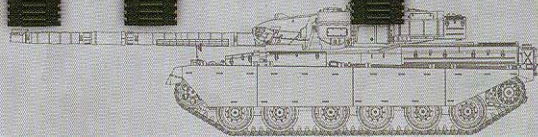
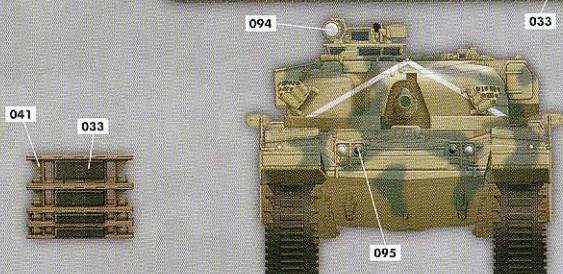
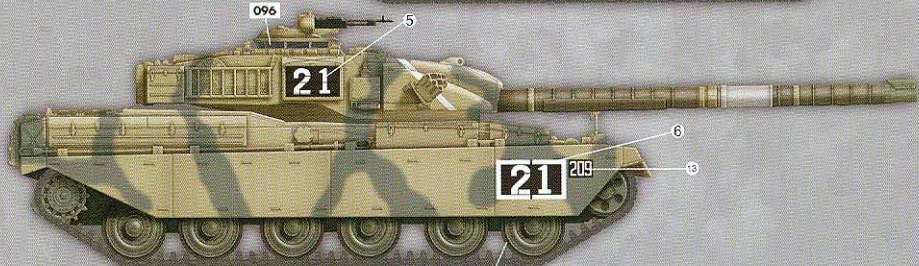
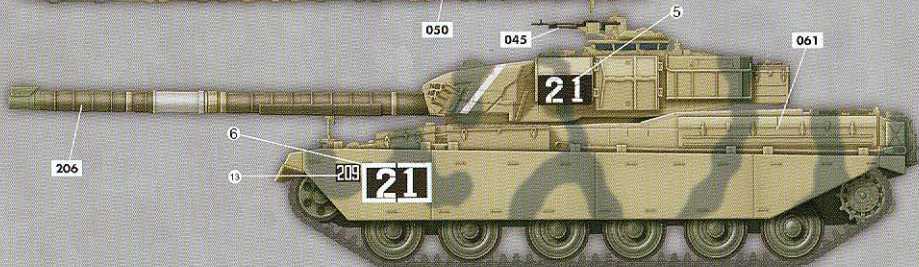
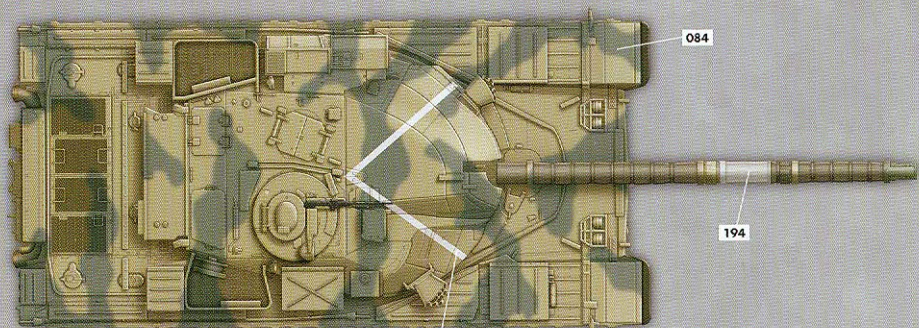

## Painting and Marking Guide

A.MIG 033	Rubber & Tires	A.MIG 041	Dark Rust	A.MIG 045	Gun Metal	A.MIG 094	Crystal Glass
A.MIG 095	Crystal Smoke	A.MIG 096	Crystal Partiscope Green	A.MIG 061	Warm Sand Yellow	A.MIG 206	FS 34075 (BS 641)
A.MIG 084	NATO Green	A.MIG 194	Aluminium	A.MIG 050	Matt White		

5th Inniskilling Dragoon Guards, British Army  
training unit Suffield, Canada

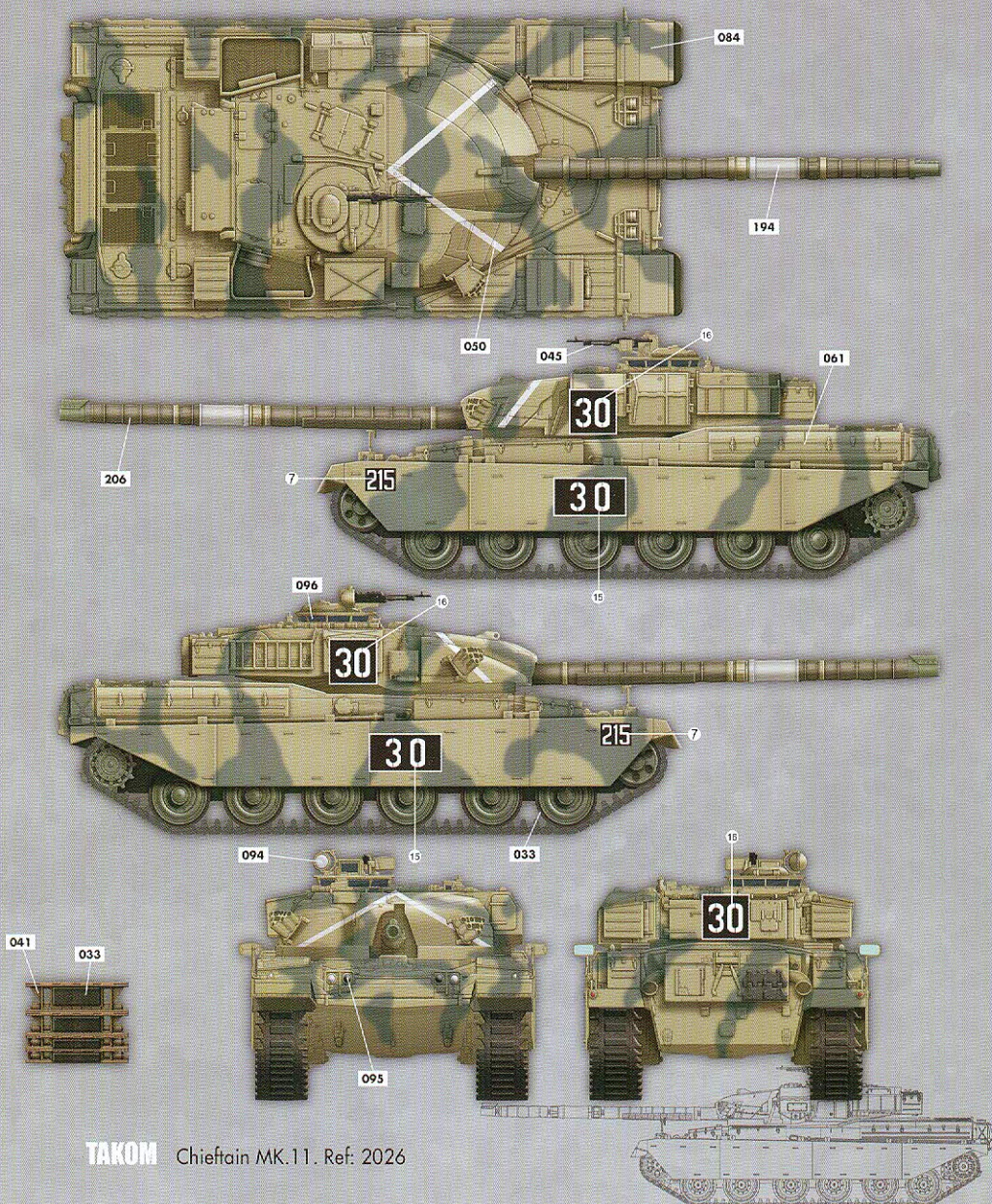

## Painting and Marking Guide

A.MIG 033

Fubber &amp; Tires

A.MIG 041

Dark Rust

A.MIG 045

Gun Metal

A.MIG 094

Crystal Glass

A.MIG 095

Crystal Smoke

A.MIG 096

Crystal  
Periscope Green

A.MIG 084

NATO Green

Royal Scots Dragoon Guards

