

**NORTH AMERICAN  
-ROCKWELL**

# RA-5C VIGILANTE

MINICRAFT MODELS, INC  
1510 W. 228th STREET  
TORRANCE, CA 90501



1/72 SCALE

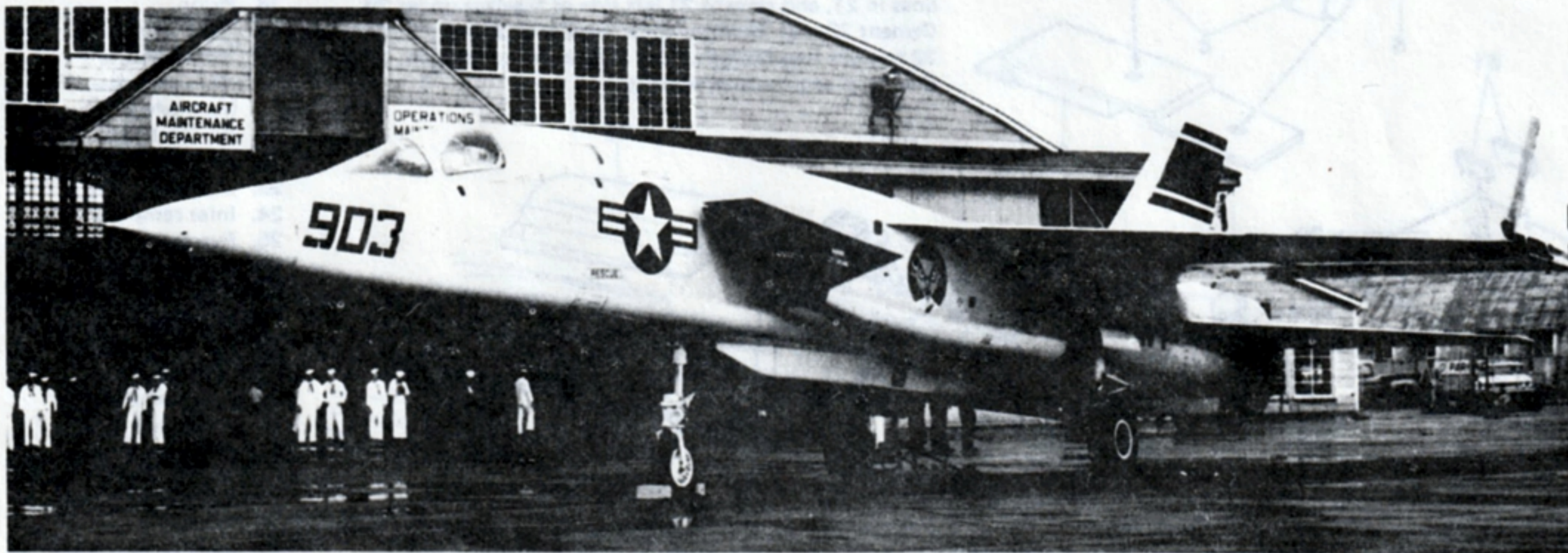

"The eyes of the fleet" could well be used to describe the role of the North American Rockwell RA-5C Vigilante. This supersonic two-seat carrier-based reconnaissance plane was originally designed as an attack bomber, and that version became operational on the nuclear carrier Enterprise in February, 1962.

The first reconnaissance Vigilante, the RA-5C, flew on June 30, 1962. This model features a large fuel tank faired into the fuselage top and a ventral pod attached to the belly. This pod contains a battery of high-resolution cameras, side-looking radar and related surveillance gear for its observation missions. Since the design was originally planned as a bomber, the weapon-carrying and delivery capabilities for that role are retained in the RA-5C, with four underwing hardpoints capable of carrying several thousand pounds of offensive ordnance.

More than 100 Vigilantes were constructed as RA-5C's and many A-5A attack bombers were converted to the reconnaissance version.

## CHARACTERISTICS

Dimensions — wingspan 53 feet, length 76 feet 7 inches.

Powerplant — two General Electric J79-GE-10 turbojet engines of 17,859 lbs. thrust with afterburner.

Performance — maximum speed 1,385 mph at 40,000 feet.

Range — 3,000 miles.

Armament (in addition to reconnaissance gear) — nuclear or high explosive bombs, air-to-air or air-to-ground missiles as required.



**1** STEP 1: Cement 5 to one 4 then cement 4 to 3. Cement 6 to remaining 4 and cement this to 3. Cement 28 to 29 as shown, then cement two 51's to 29.

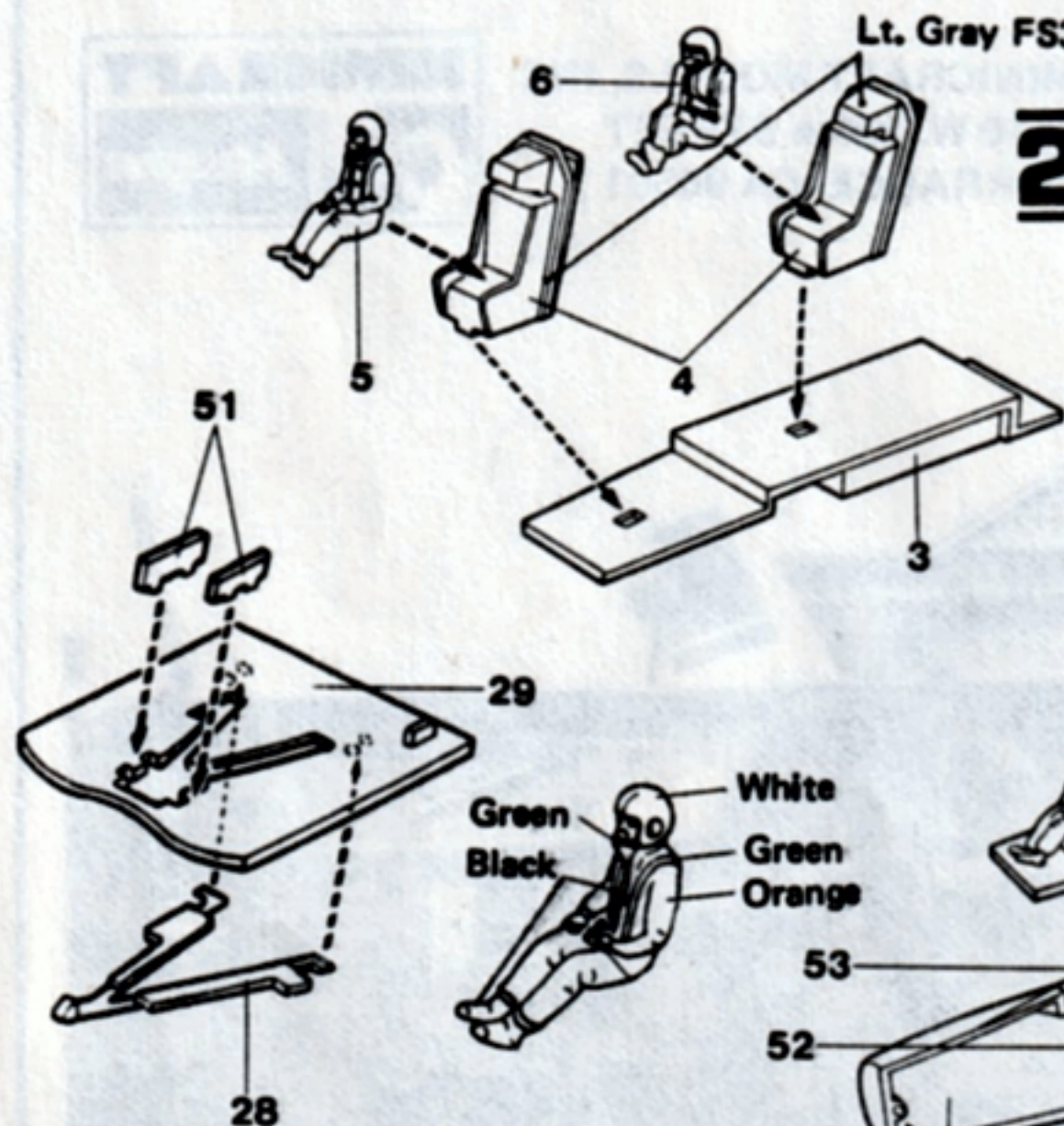

Lt. Gray FS36173

**2**

STEP 2: Cement clear window 52 to 1 and 53 to 2. Cement cockpit assembly into 2 making certain wheel well is over opening in 2. Cement 1 and 2 together. Cement 25 to fuselage assembly, then cement 24 into 21, as shown by dotted lines in 21, and cement 21 left side of fuselage under 25. Cement 23 into 22 in the same manner as above, then cement 22 to right fuselage side. Cut instrument panel from decal sheet and cement into cockpit.

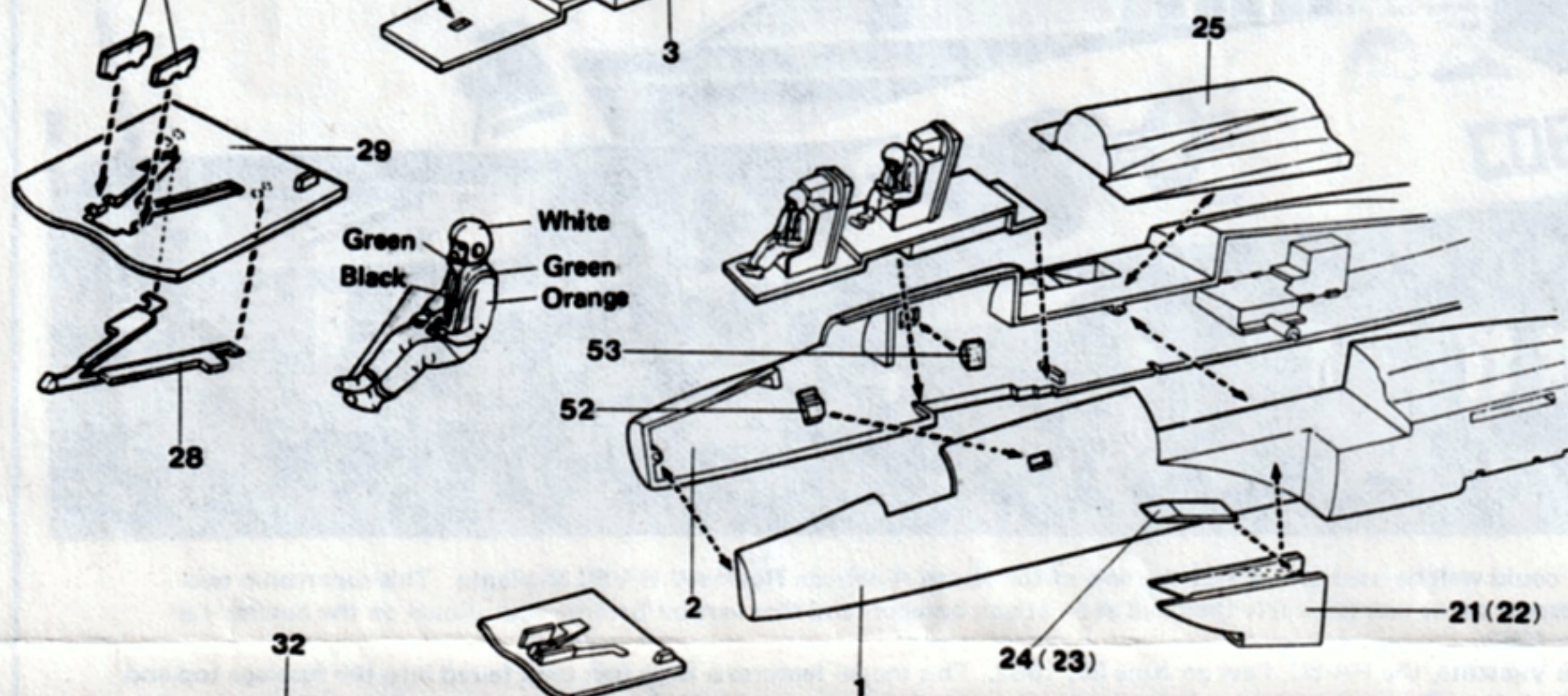

**3**

STEP 3: Cement tail hook assembly into empennage making certain panel is flush with fuselage bottom. Place bar on 32 in notches in empennage as shown and cement 33 to fuselage assembly trapping 32. Cement two 34's in place in 33. Cement 35 and 36 to 33.

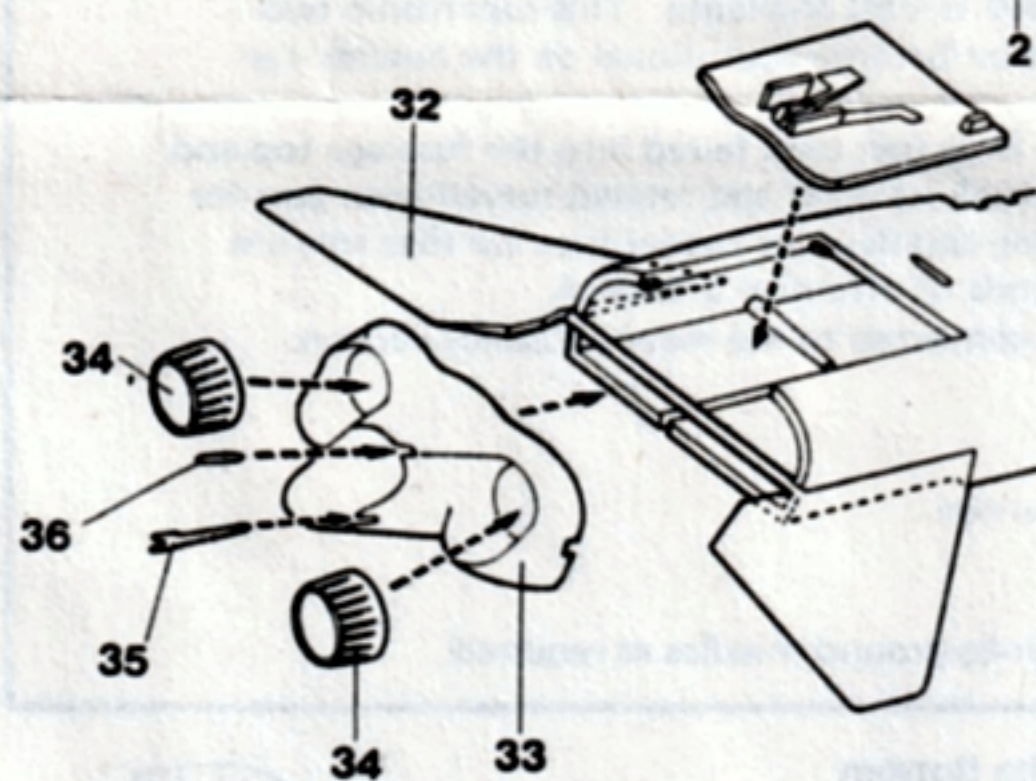

**4**

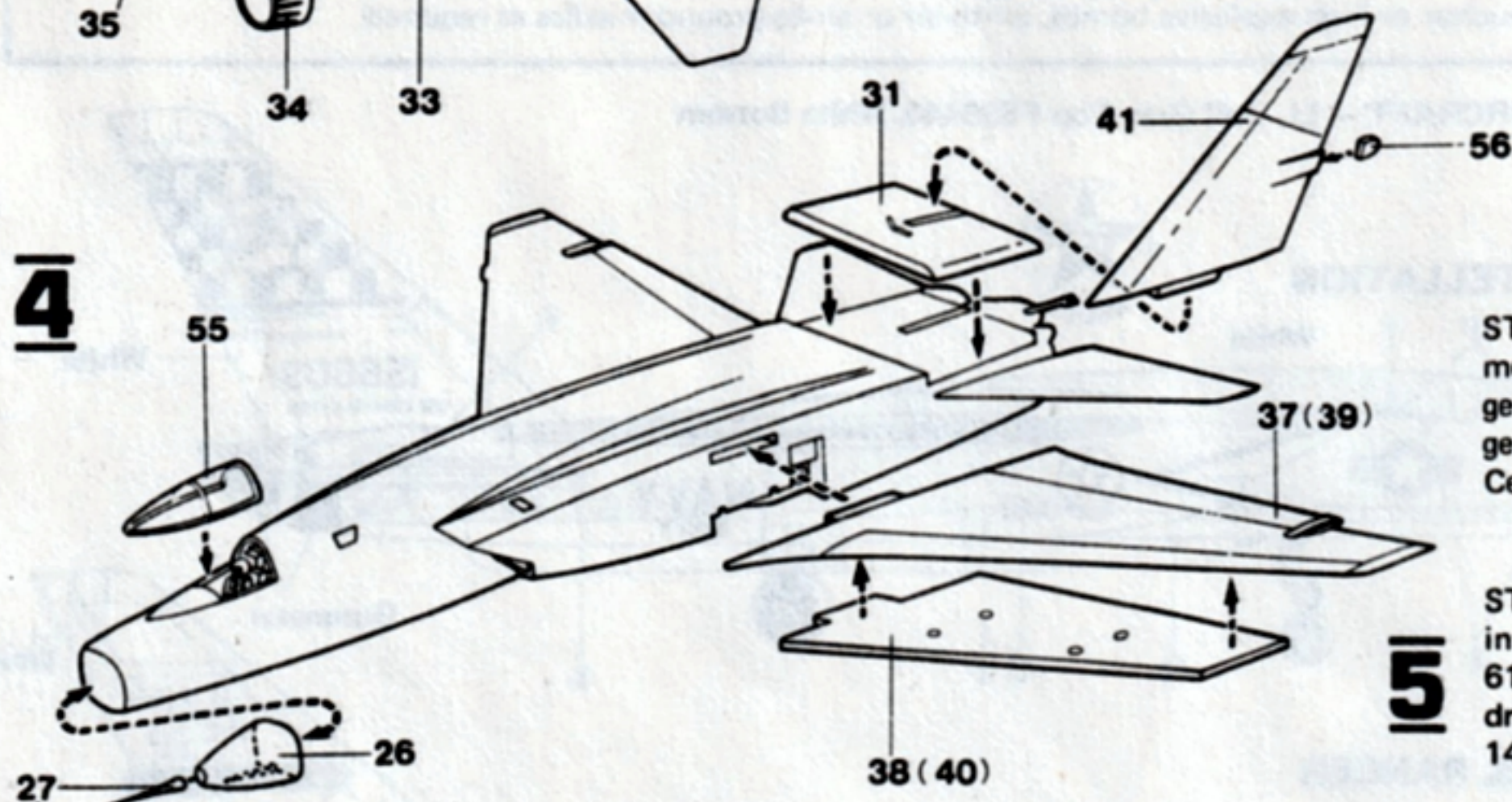

STEP 4: Cement 31 to fuselage above stabilizers then cement 41 into 31. Cement 56 to 41. Cement 37 and 38 together and attach to left fuselage. Cement 39 and 40 together and cement to right fuselage. Cement 55 over cockpit. Cement 26 to nose then cement 27 to 26.

**5**

STEP 5: Cement 54 to 18 then cement 18 to 17. Cement 17 into nose well. Cement 43 and 44 to well as shown. Cement 61 to nose where indicated by dotted outline. Make four drop tanks by cementing 7 to 8, 9 to 10, 11 to 12 and 13 to 14.

1. Fuselage (L)
2. Fuselage (R)
3. Cockpit floor
4. Seat (2)
5. Pilot
6. Radar operator
- 7-14. Drop tank half (8 pcs)
15. Pylon
16. Pylon
17. Nose gear
18. Landing light
19. Main gear strut (R)
20. Main wheel (2)
21. Air intake (L)
22. Air intake (R)
23. Inlet ramp (R)
24. Inlet ramp (L)
25. Fuselage top panel
26. Radome
27. Pitot tube
28. Arresting gear
29. Arresting gear panel
30. (Deleted)
31. Empennage top
32. Stabilator
33. Tailcone
34. Tailpipe (2)
35. Fuel dump
36. Fuel vent
37. Wing top (L)
38. Wing bottom (L)
39. Wing top (R)
40. Wing bottom (R)
41. Rudder
42. Recon pod
43. Nose gear door
44. Nose strut door
45. Main wheel door (R)
46. Upper main strut door (R)
47. Lower main strut door (R)
48. Main wheel door (L)
49. Upper main strut door (L)
50. Lower main strut door (L)
51. Arresting gear door (2)
52. Cockpit window (L)
53. Cockpit window (R)
54. Landing light lens
55. Canopy
56. Taillight
- 57-60. Camera window (4 pcs)
61. Nose beacon



**STEP 6:** Cement 19 to 20 then cement 19 into locator in right fuselage well. Repeat for left gear. Gear door 45 may be cemented open or closed. Cement 46 and 47 above and below right main gear well as shown. Repeat with 48, 49 and 50 on left side. Cement a 15 and 16 to the bottom of each wing in the position shown.

**6**

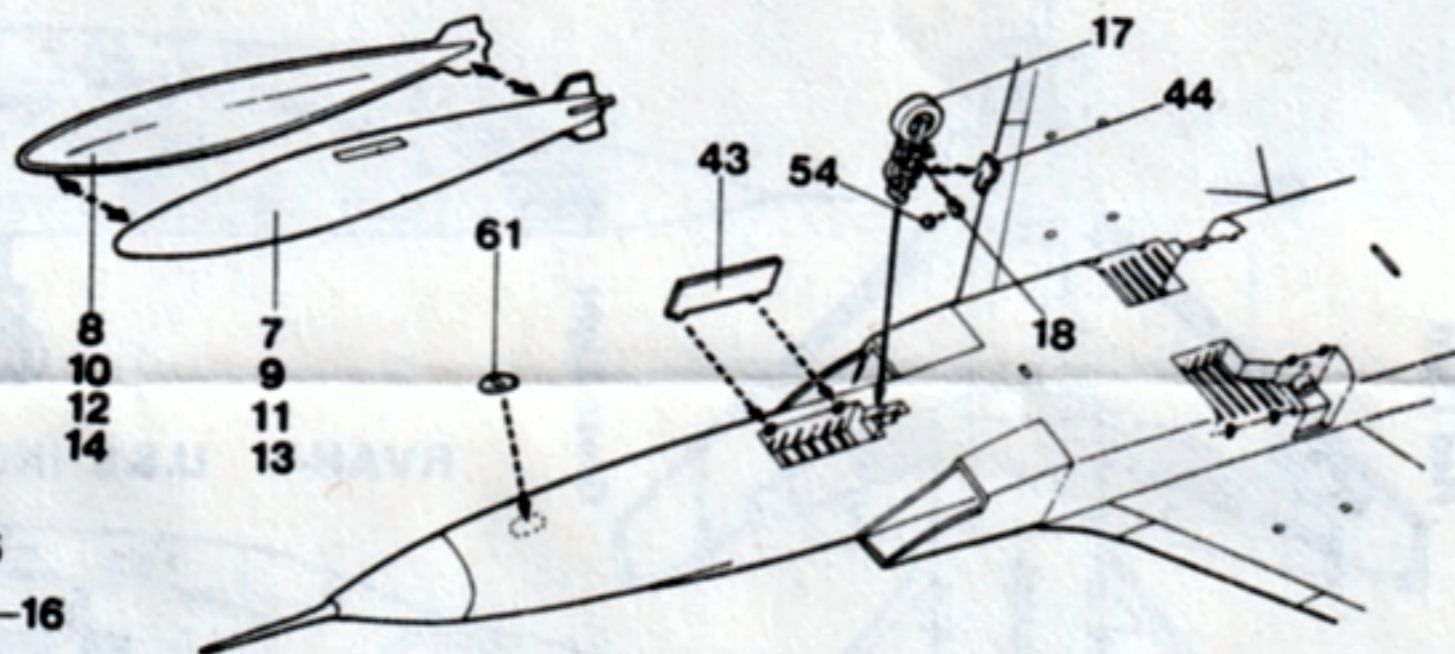
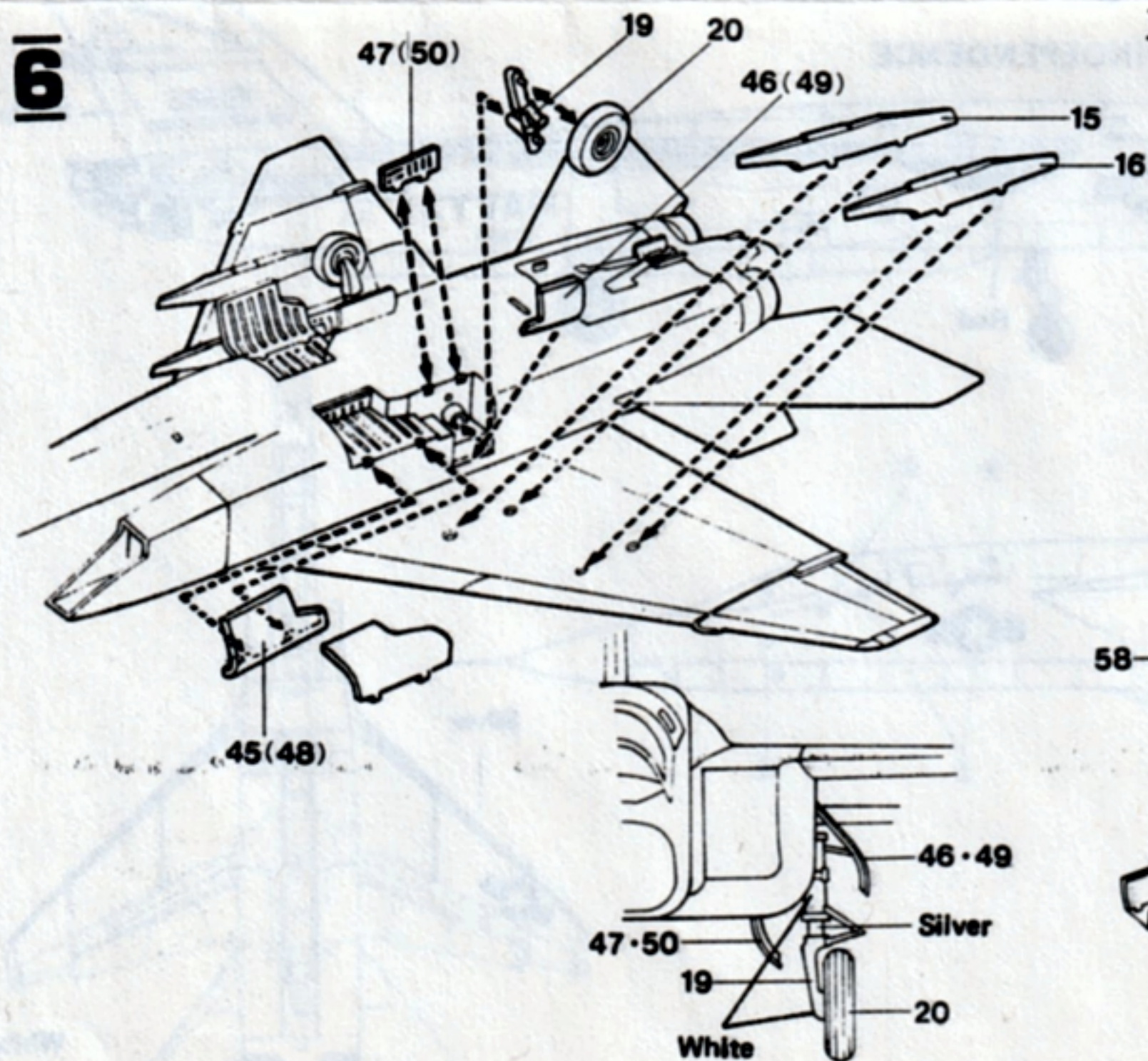

**7**

**STEP 7:** Cement 58 to 42 from the inside, then cement 57, 59 and 60 to 42. Cement 42 to fuselage bottom. Cement four drop tanks to wing pylons.

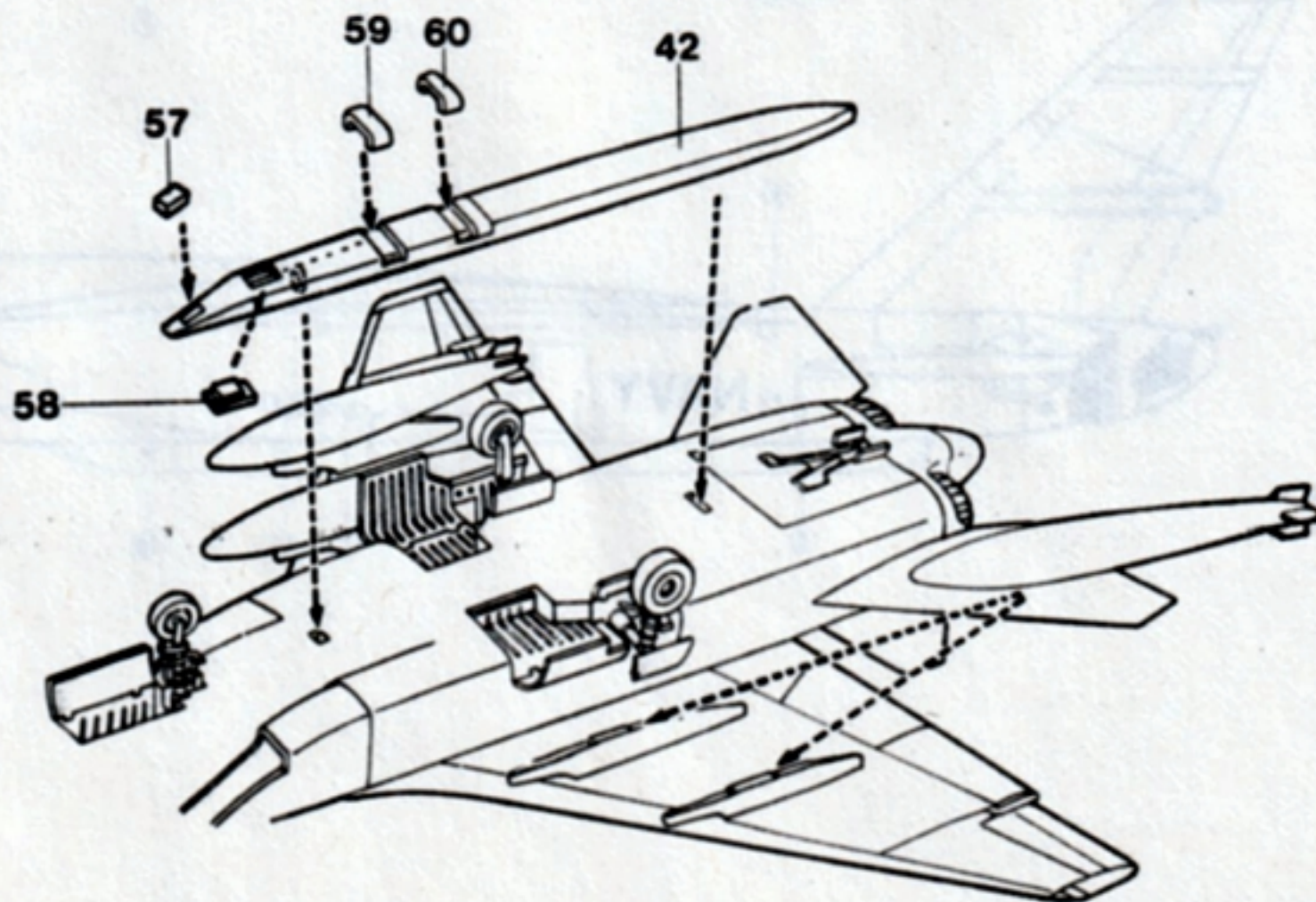



PAINTING SUGGESTIONS

ALL AIRCRAFT — Lt. Gull Gray Top FS36440, White Bottom

RVAH-11 U.S.S. CONSTELLATION

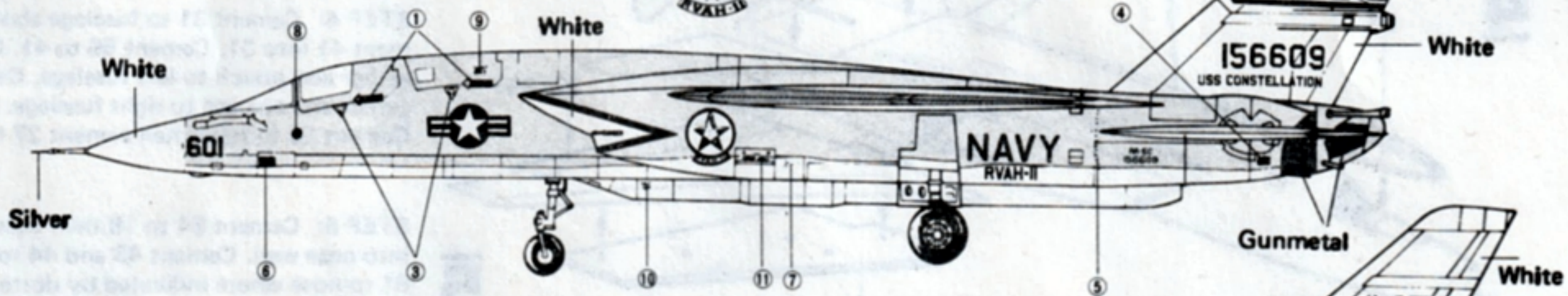

RVAH-5 U.S.S. RANGER

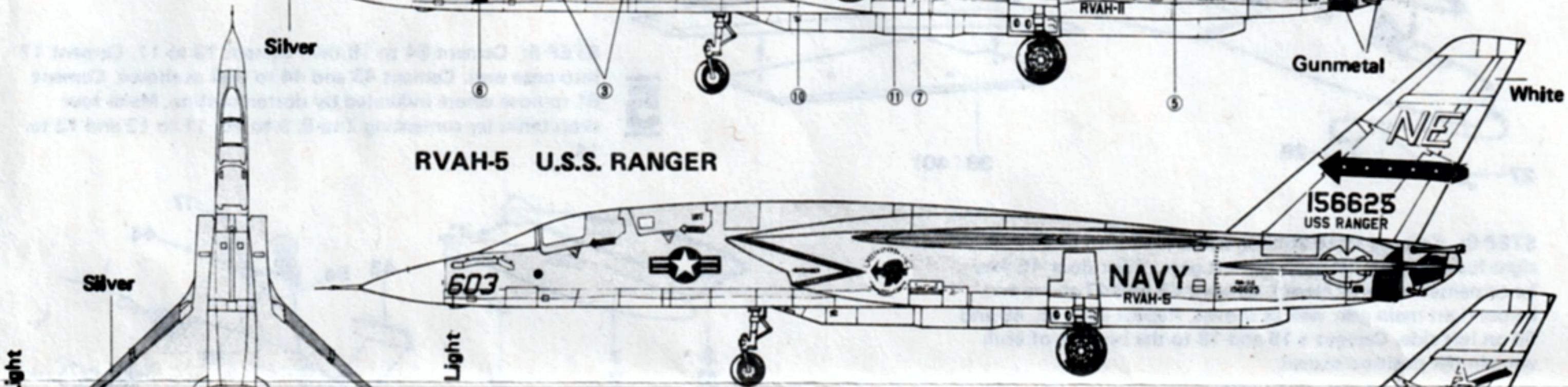

RVAH-1 U.S.S. INDEPENDENCE

