

# F-16N "Fighting Falcon"



KIT 4767

1/32 SCALE 1/32 ECHELLE ESCALA 1/32

REVELL, INC. Des Plaines, IL Copyright © 1987 All rights reserved. Made in U.S.A.

4767-4200

The U.S. Navy's version of the efficient F-16 Fighting Falcon is based on the Air Force F-16C, but has been modified specifically for the role of an adversary for the Navy's Top Gun training program. The first of these planes was delivered to the Navy on April 29, 1987, at NAS Miramar, near San Diego, Calif. The planes will be flown by the instructor pilots from Top Gun and from the adversary squadrons, VF-45 in Key West, Florida, and VF-126, based at Miramar.

The new F-16N's have performance characteristics much like the new generation of Soviet aircraft, such as the MiG-29 and Su-27, now in operation with the Russian air forces and their satellite countries. The aggressor planes are generally painted in Soviet-type camouflage and carry Russian-style numbers to complete the impression of doing combat with an actual enemy aircraft.

The excellent service record of the F-16 in world-wide usage was a major factor

in the selection of the Fighting Falcon. The F-16N has been modified to carry a different radar, more suited to its training role, and the 20mm cannon has been removed from the fairing on the wing extension. In most operations it will carry a simulated Sidewinder missile on one wingtip and an electronics pod on the other.

The markings on this model represent the first F-16N as it appeared during the presentation ceremony at Miramar.

## READ THIS BEFORE YOU BEGIN

- Study the assembly drawings.
- Each plastic part is identified by a number.
- Check the fit of each piece before cementing in place.
- Do not use too much cement to join parts.
- Use only cement for polystyrene plastic.
- Model may be painted to match photos on box.
- Allow paint to dry thoroughly before handling parts.
- Scrape paint from areas to be cemented.
- For better paint and decal adhesion, wash the plastic parts in a mild detergent solution. Rinse and let air dry.

## LISEZ CE QUI SUIT AVANT DE COMMENCER LE MONTAGE

- Etudier les schémas d'assemblage.
- Chaque pièce plastique porte un numéro d'identification.
- Contrôler que chaque pièce soit bien conforme avant de la coller à sa place.
- N'utilisez pas trop de colle pour réunir les pièces.
- Utilisez uniquement une colle spéciale pour polystyrène.
- Le modèle peut être peint conformément aux photos sur la boîte.

- Laissez sécher la peinture complètement, avant de manipuler les pièces.
- Grattez la peinture sur les surfaces devant être collées.
- Pour assurer la meilleure adhésion possible de la peinture et des décalcomanies, laver les pièces de plastique avec une légère solution savonneuse. Rincer et laisser sécher à l'air.

## LEA ESTO ANTES DE EMPEZAR

- Estudie los dibujos de ensamblaje.
- Cada pieza de plástico se identifica por un número.
- Verifique que cada pieza encaje bien antes de pegar en posición.
- No use demasiado pegamento para unir las piezas.
- Use únicamente pegamento para plástico de poliestireno.
- El modelo puede pintarse de acuerdo con las fotografías de la caja.
- Permita que se seque la pintura completamente antes de tocar las piezas.
- Raspe la pintura de las superficies que serán pegadas.
- Para una mejor fijación de la pintura y de las calcomanías, lávense las piezas plásticas en una solución de detergente suave. Enjuáguese y déjense secar al aire.



CEMENT TOGETHER  
À COLLER  
UNIR CON PEGAMENTO



DO NOT CEMENT  
NE PAS COLLER  
NO USE PEGAMENTO



REPEAT SEVERAL TIMES  
À REPETER PLUSIEURS FOIS  
REPITA VARIAS VECES



DECAL (DIP IN WATER)  
DECALCOMANIE (À PLONGER DANS L'EAU)  
DECALCOMANIA (MOJE CON AGUA)

A	FLAT BLACK	NOIR TERNE	NEGRO APAGADO
B	LIGHT GRAY	GRIS CLAIR	GRIS CLARO
C	METALLIC	METALLIC	METALICO
D	DARK GRAY	GRIS FONCE	GRIS OSCURO
E	DARK BLUE	BLEU FONCE	AZUL OSCURO
F	OLIVE GREEN	VERT OLIVE	VERDE OLIVA
G	GREEN	VERT	VERDE
H	RED	ROUGE	ROJO
J	MEDIUM GRAY	GRIS	GRIS
K	SILVER	ARGENT	PLATA
L	WHITE	BLANC	BLANCO
M	FLAT GULL GRAY	GRIS CLAIR	GRIS CLARO
N	NEUTRAL GRAY	GRIS	GRIS

1

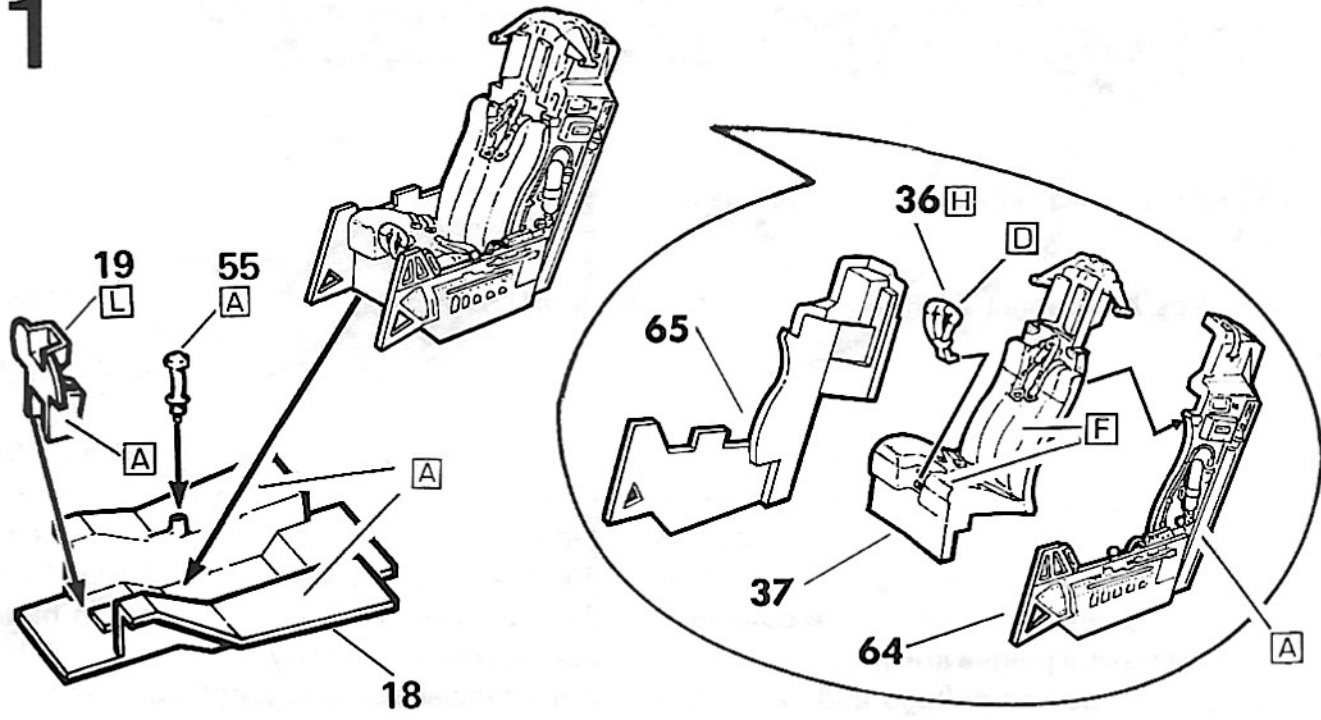

2

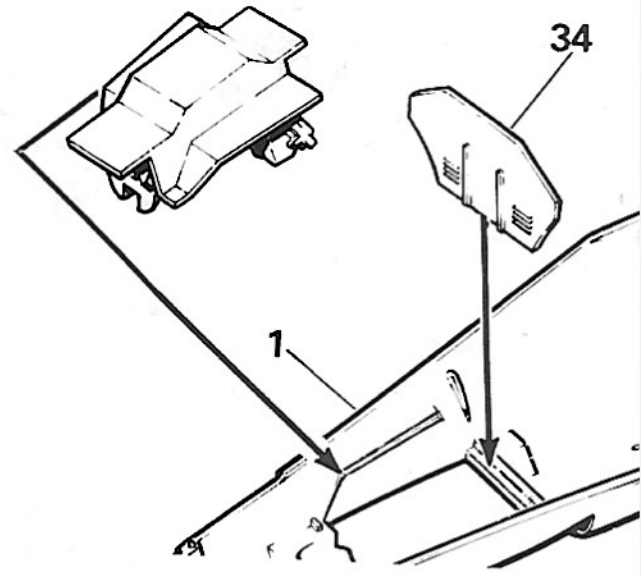

7

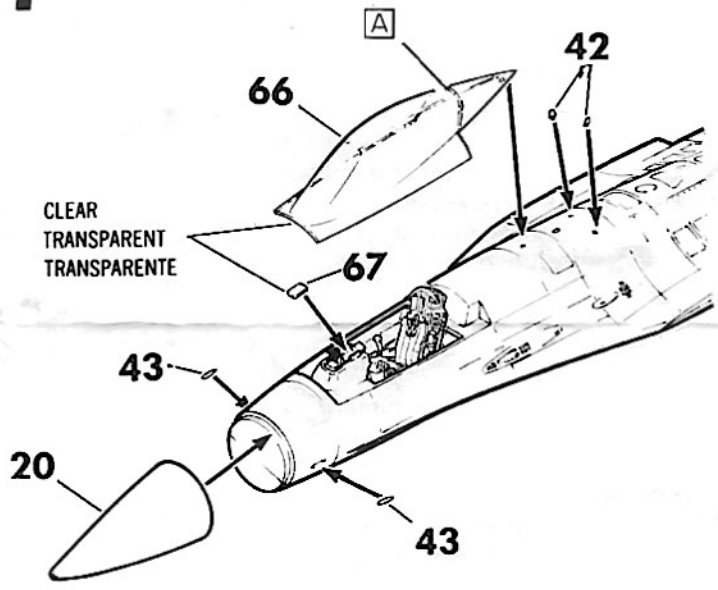

8

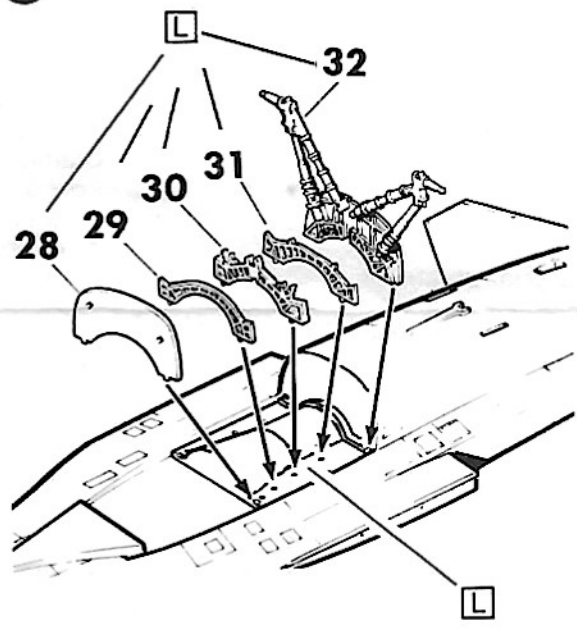

9

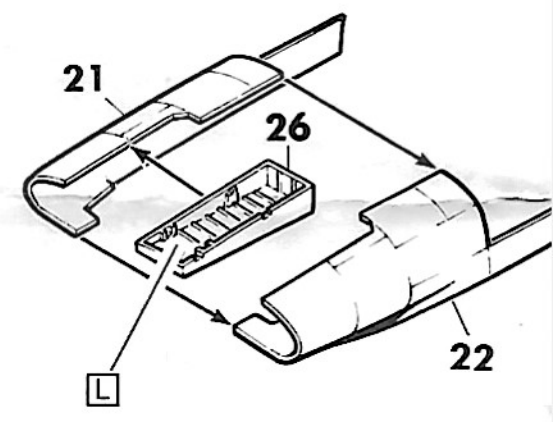

14

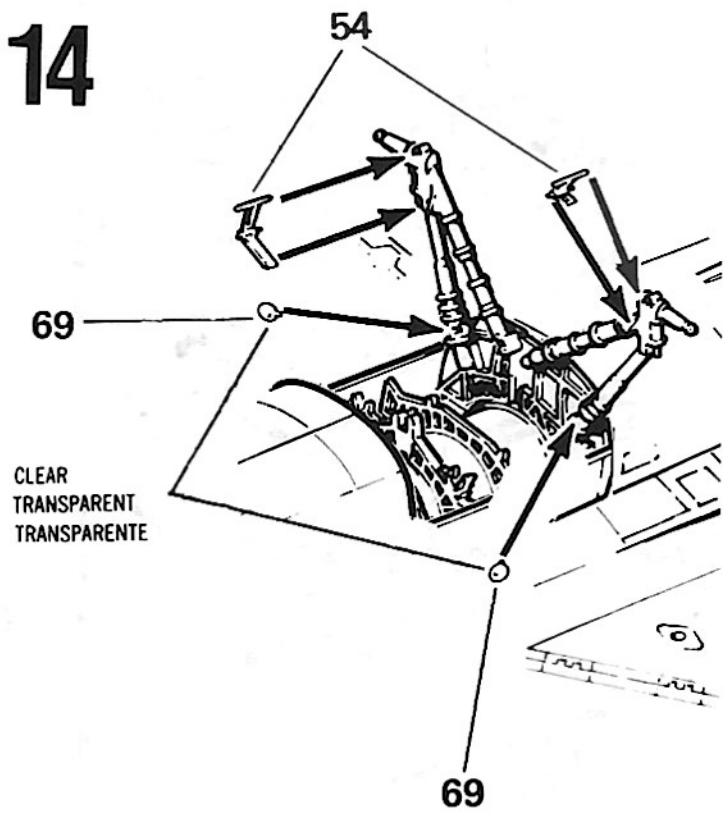

15

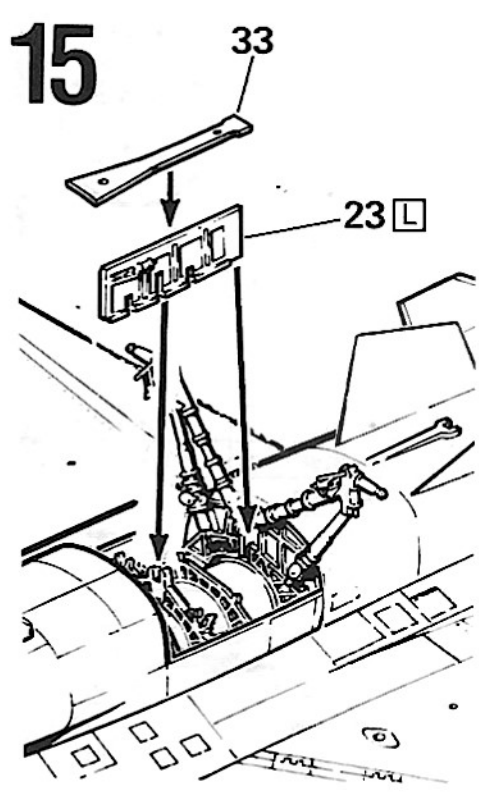

16

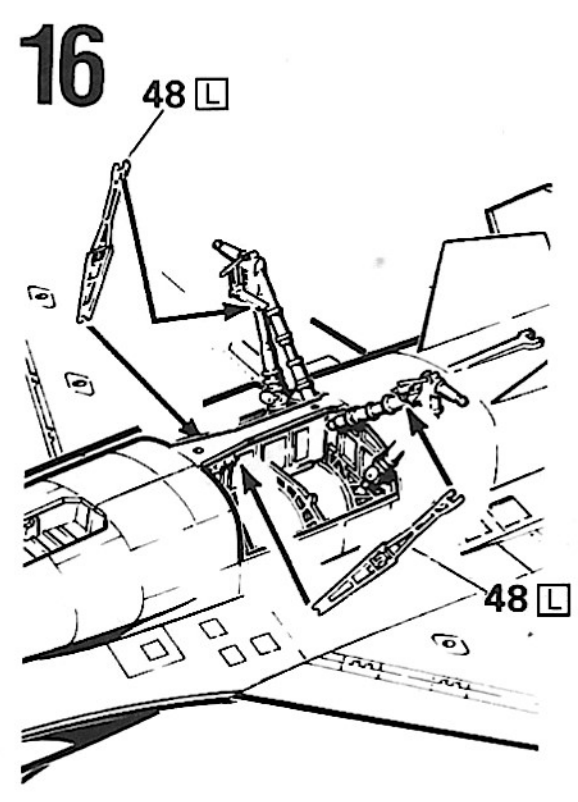

3

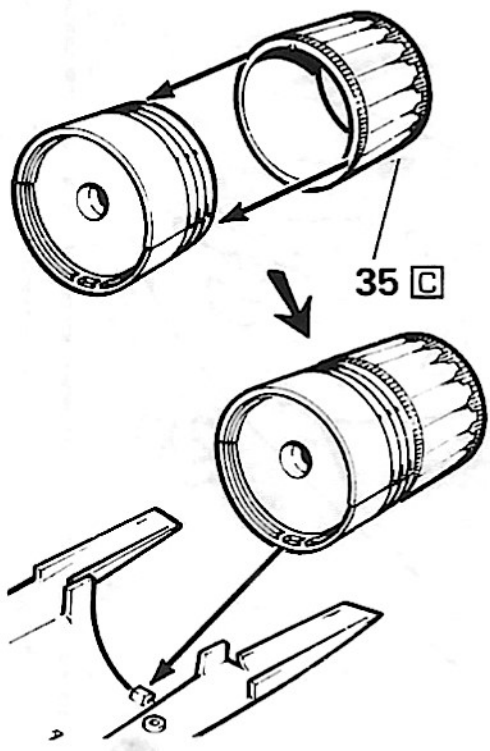
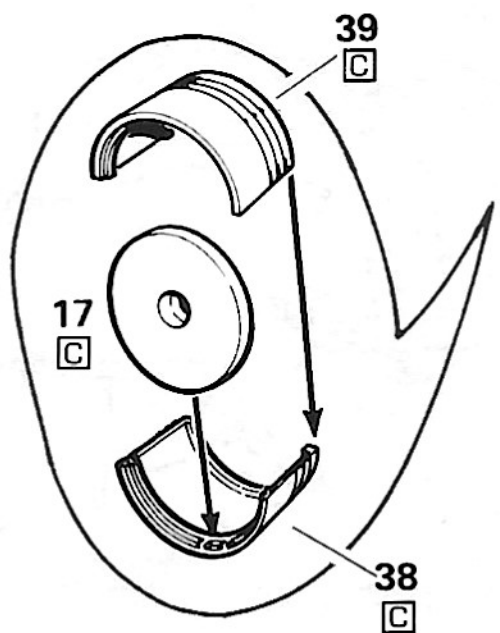

4

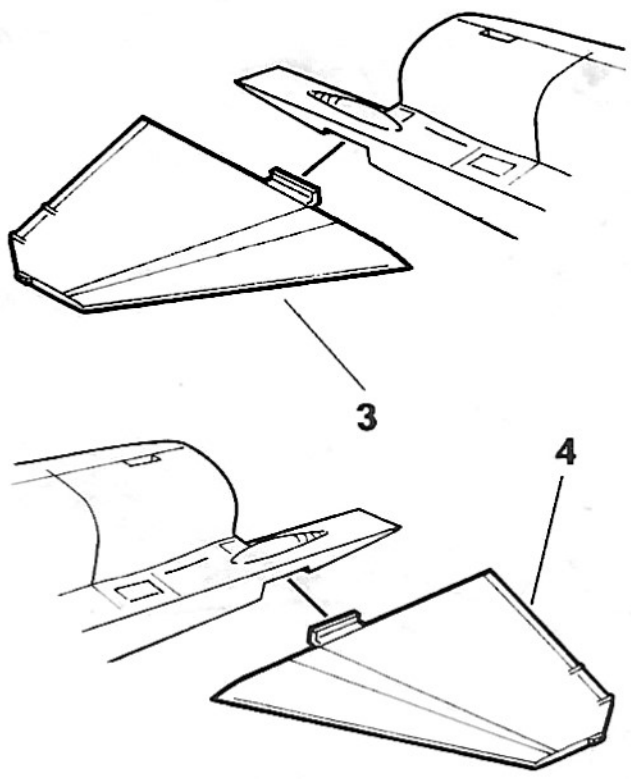

10

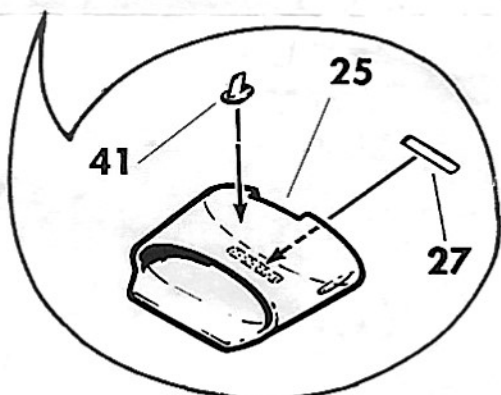
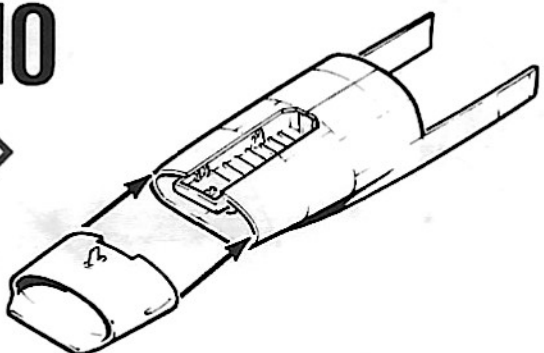

11

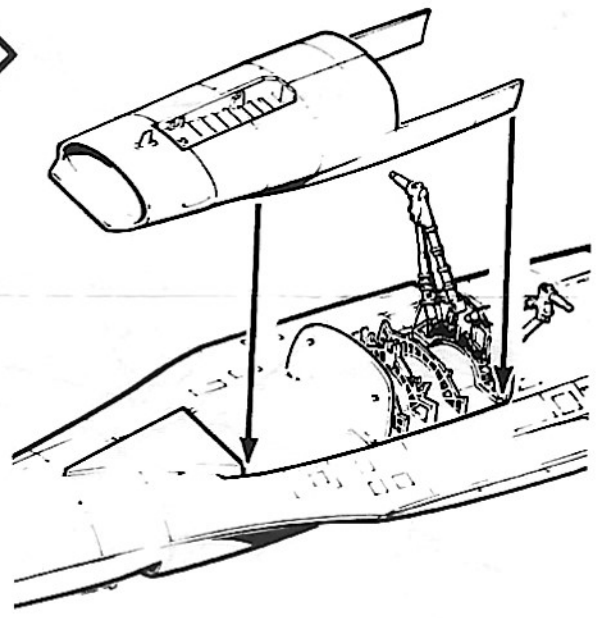

12

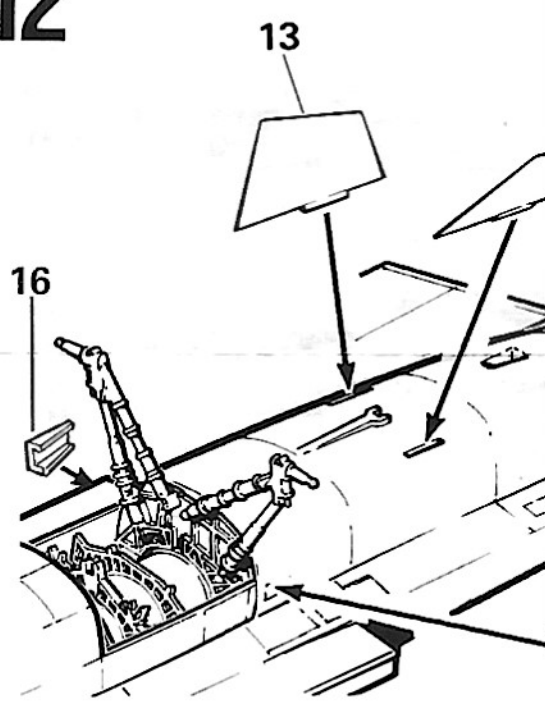

17

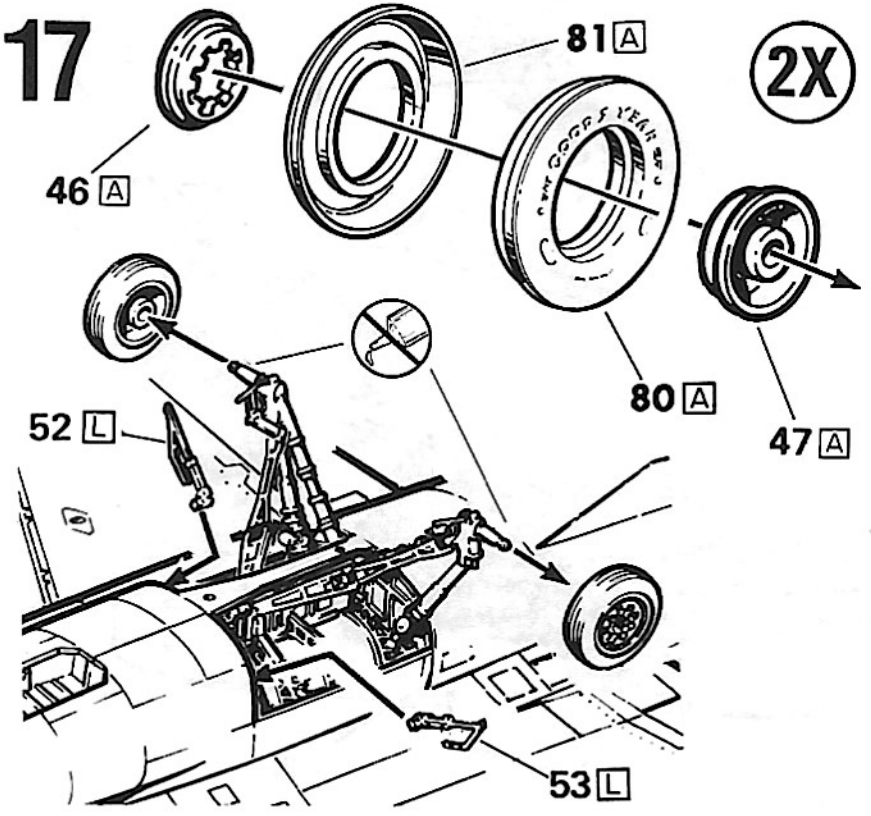

18

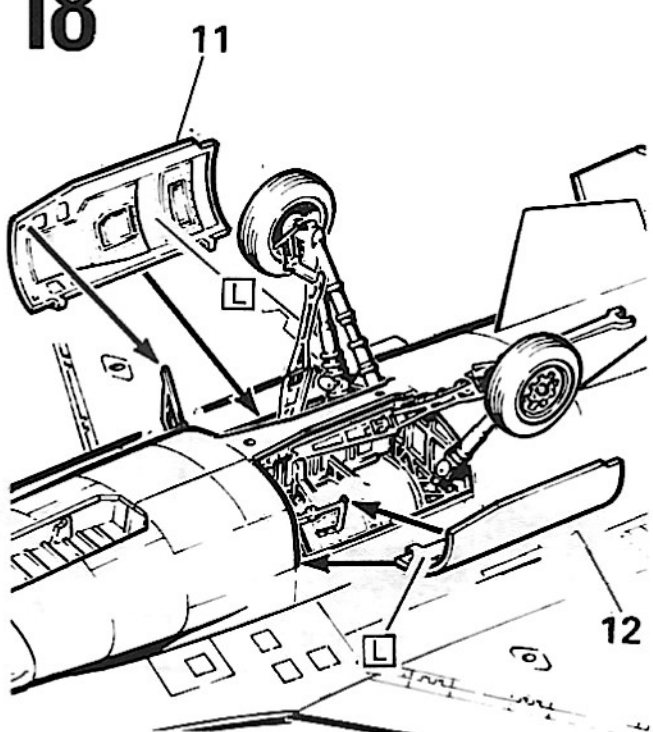

19

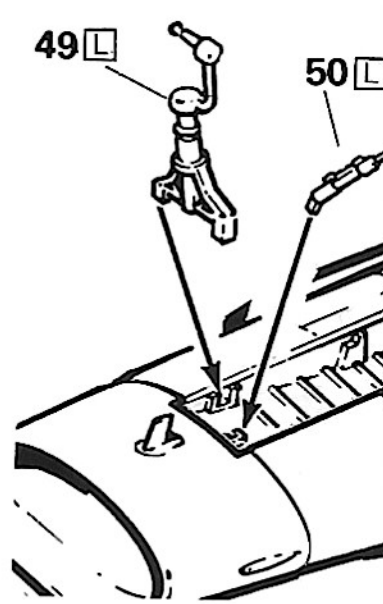

5

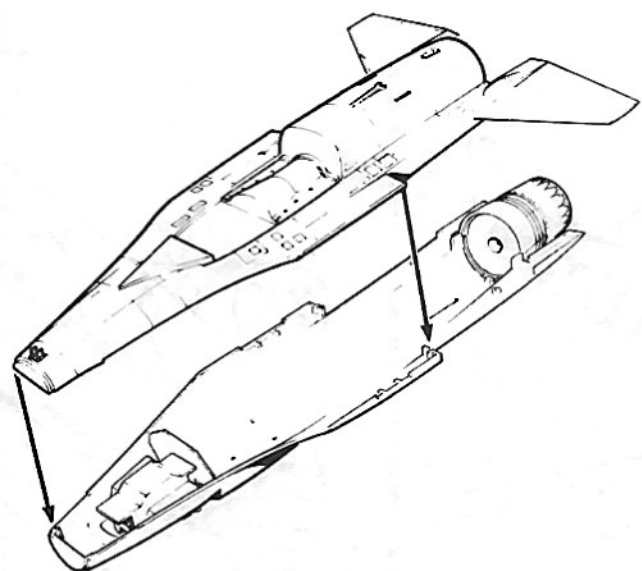

6

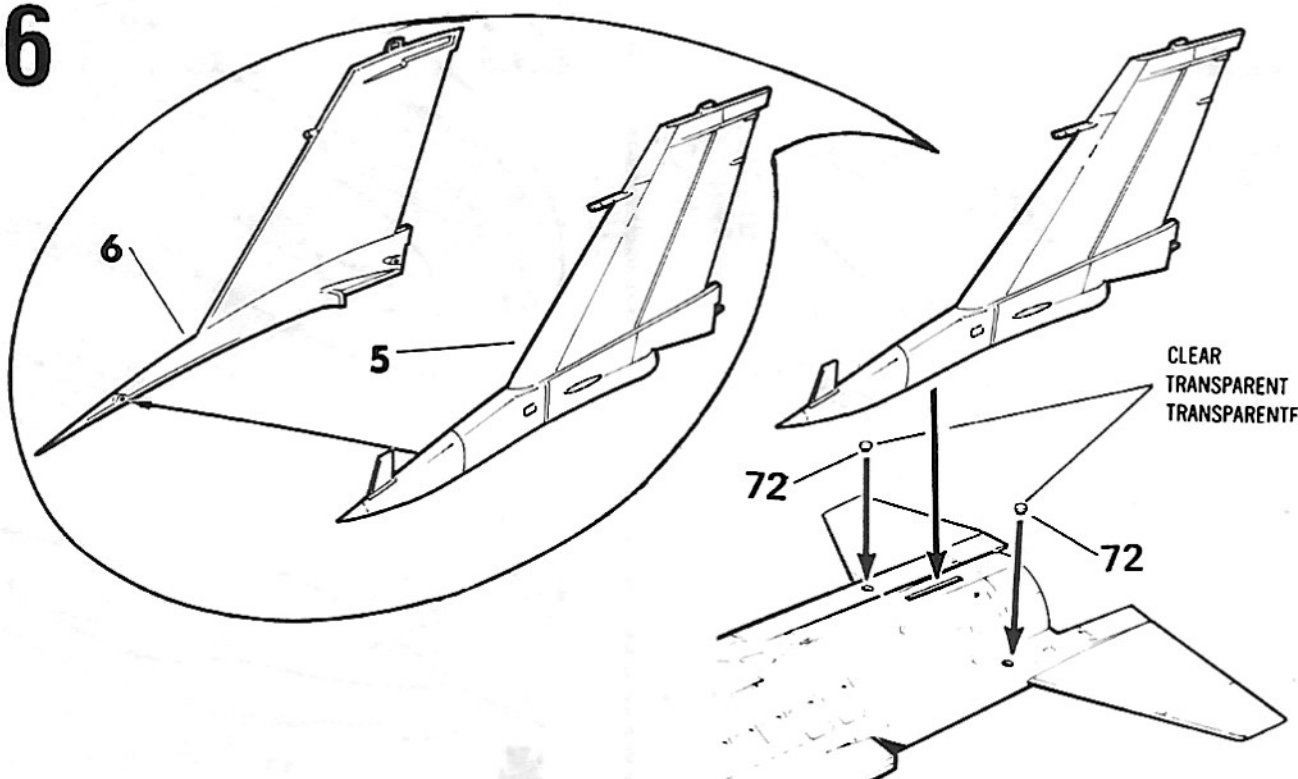

4

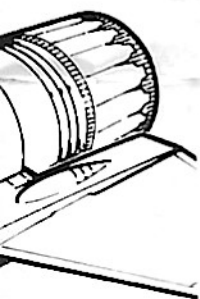

16

13

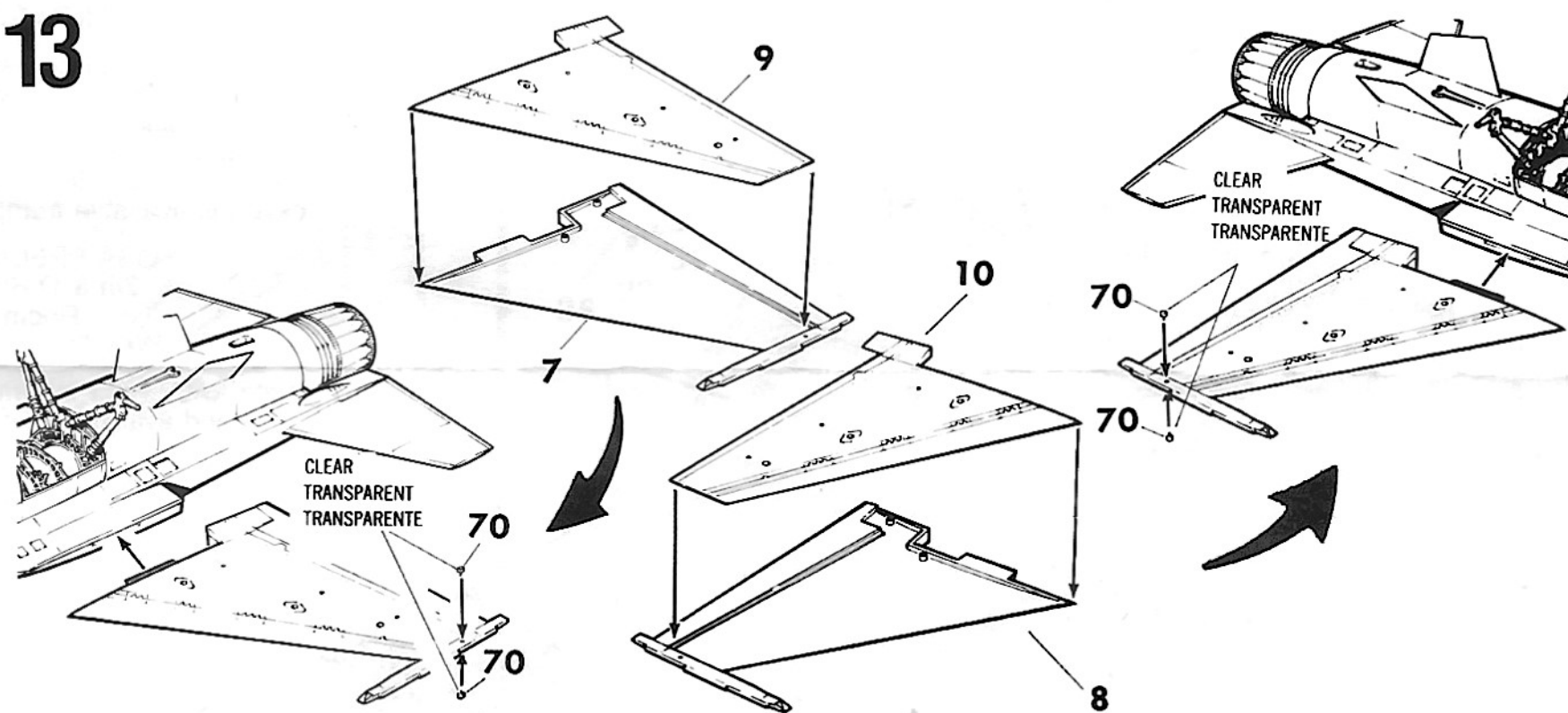

20

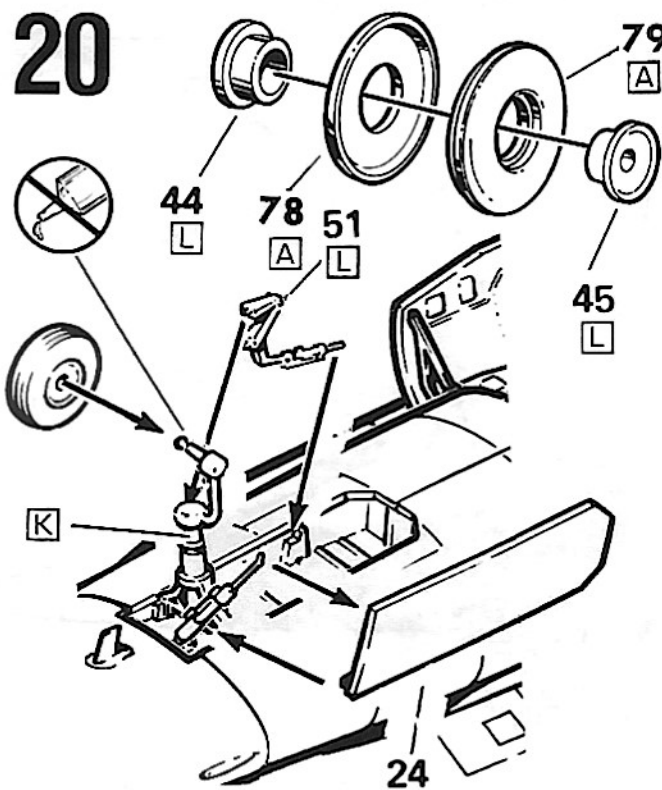

21

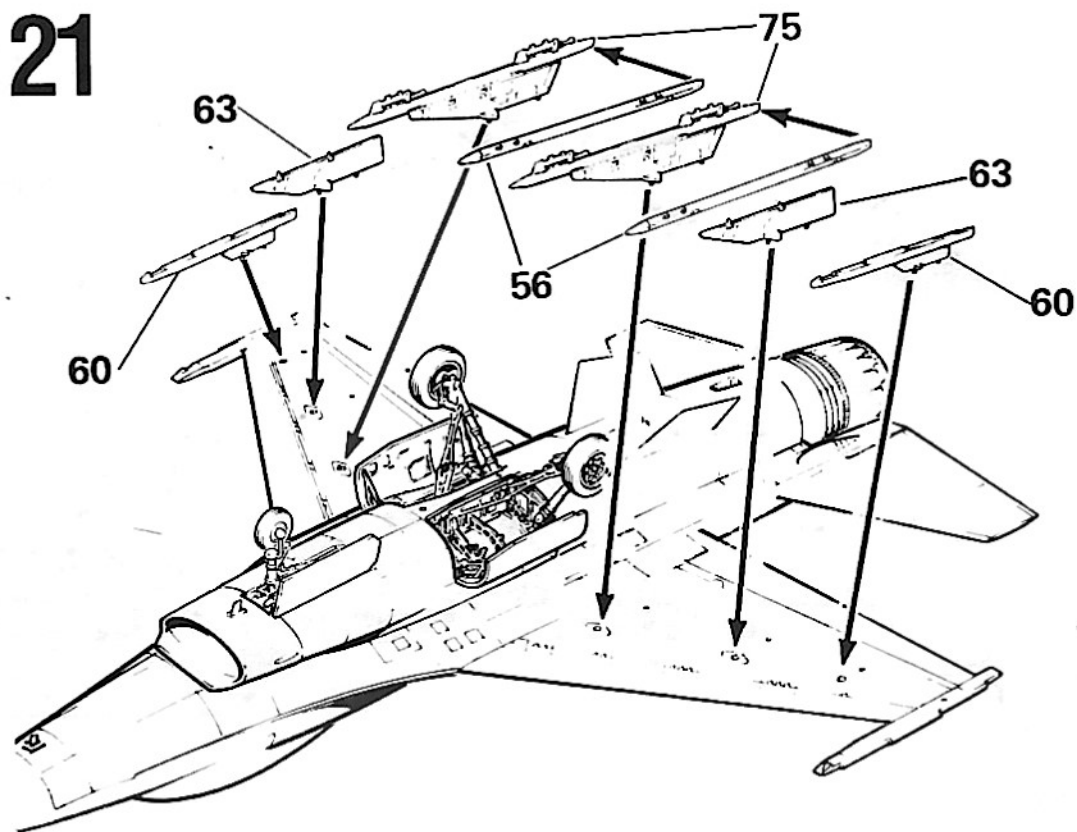

22

? OPTIONAL PARTS  
PIECES EN OPTION  
PIEZAS OPCIONALES

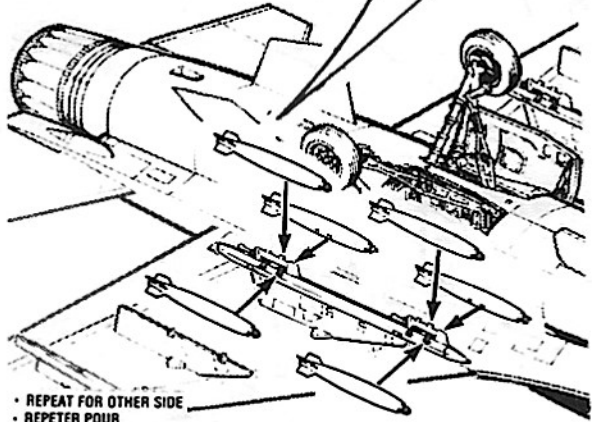
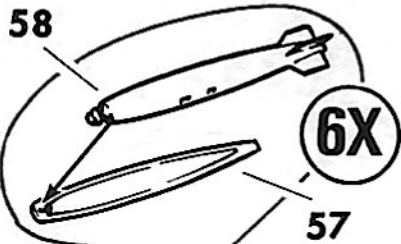

• REPEAT FOR OTHER SIDE  
• REPETER POUR  
L'AUTRE COTE  
• REPITASE PARA EL  
OTRO LADO

23

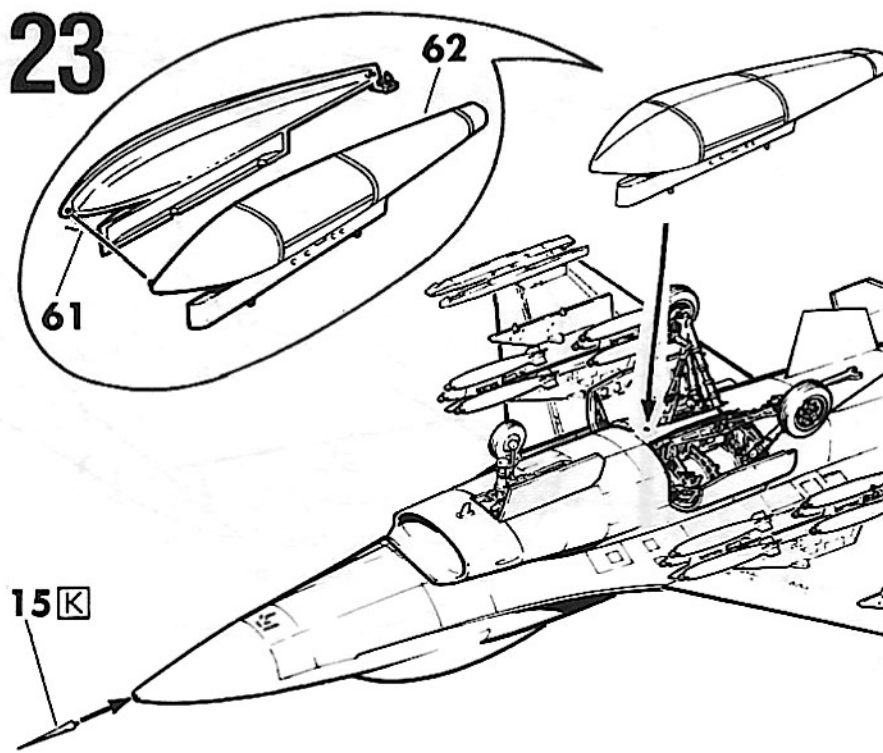

24

2X

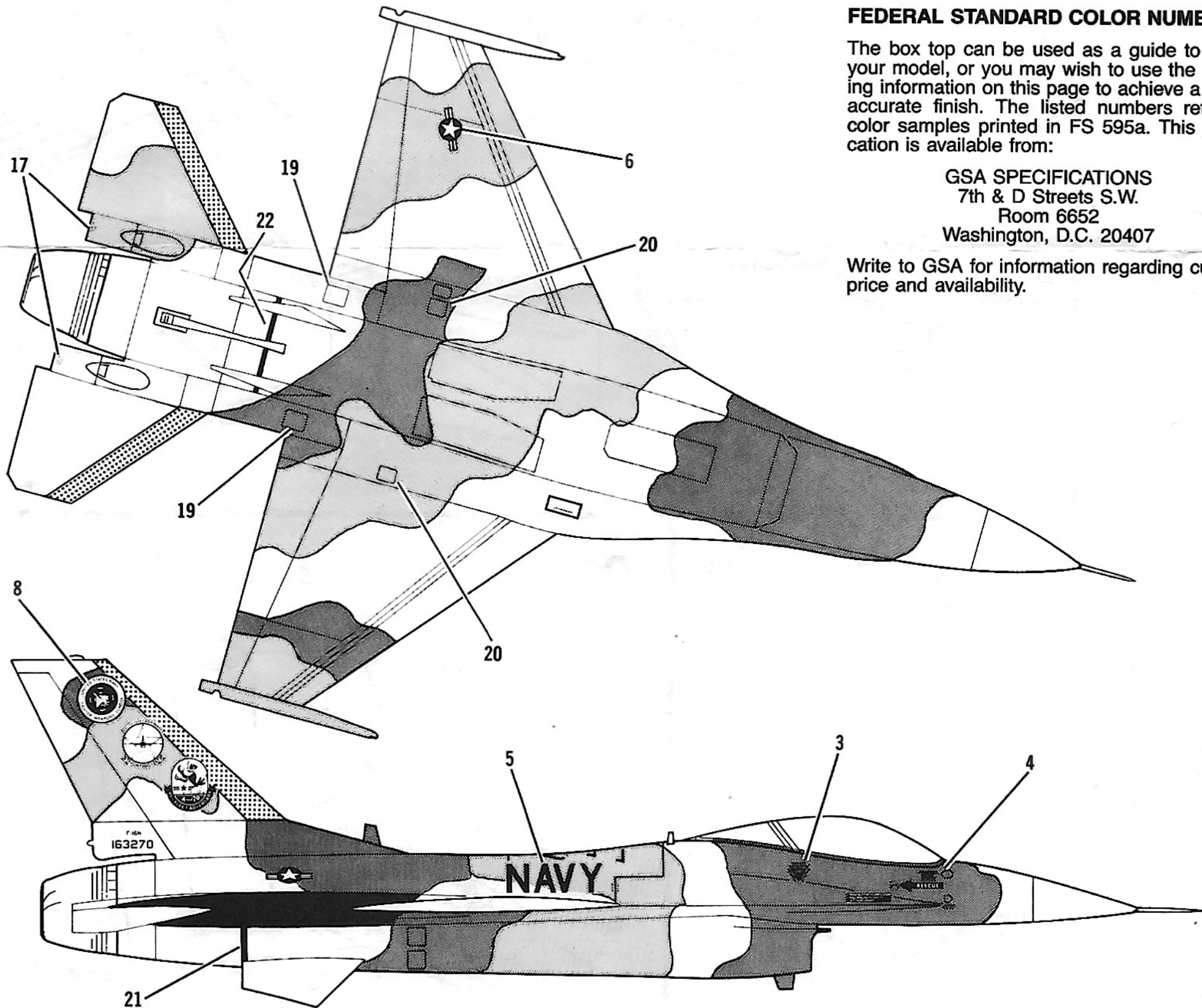
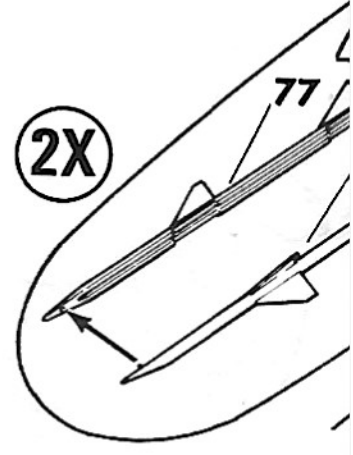

### FEDERAL STANDARD COLOR NUMBERS

The box top can be used as a guide to paint your model, or you may wish to use the painting information on this page to achieve a more accurate finish. The listed numbers refer to color samples printed in FS 595a. This publication is available from:

GSA SPECIFICATIONS  
7th & D Streets S.W.  
Room 6652  
Washington, D.C. 20407

Write to GSA for information regarding current price and availability.

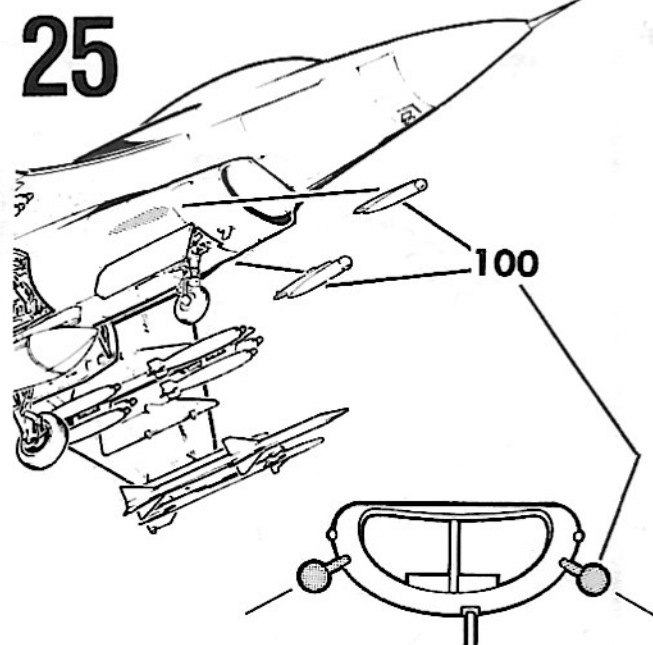
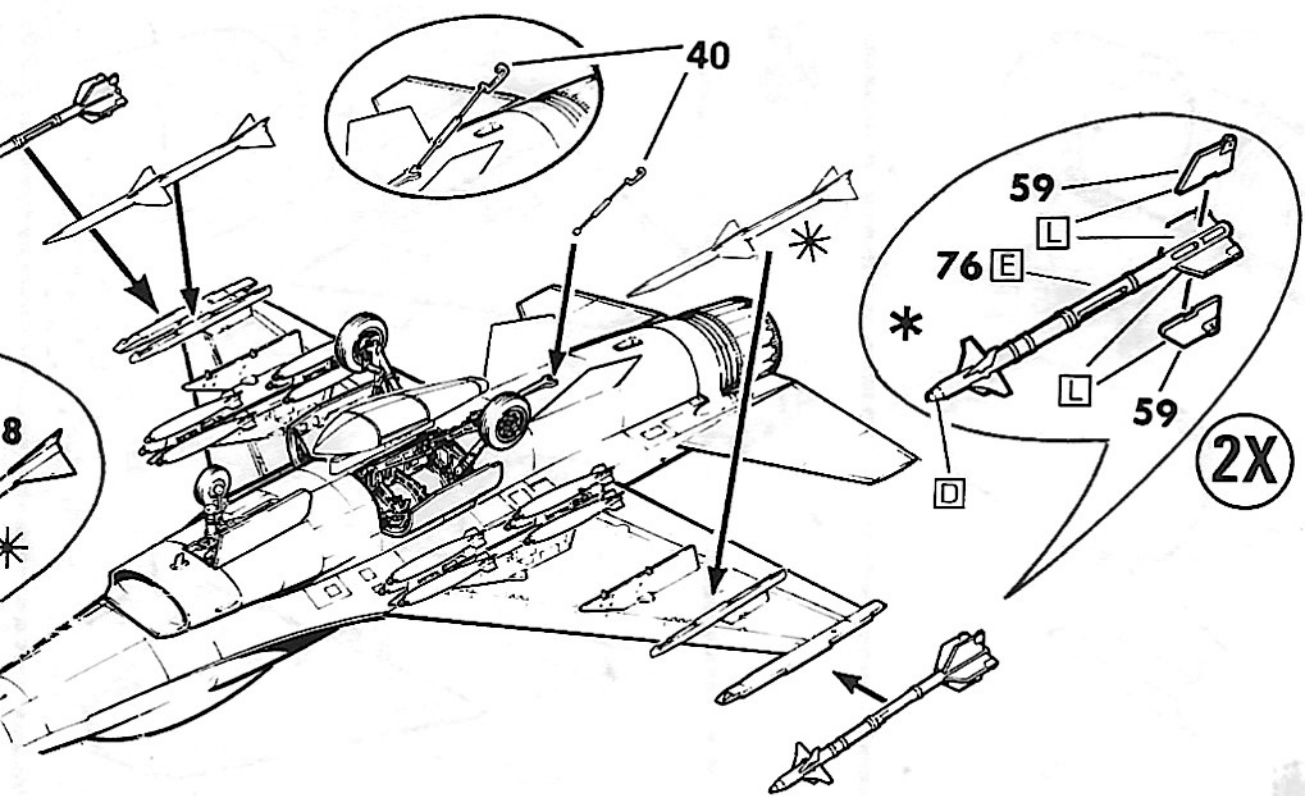

• DISCARD ALL REMAINING PIECES  
 • SE DEBARASSER DE TOUTES LES PIÈCES RESTANTES  
 • DESECHENSE TODAS LAS PIEZAS RESTANTES

**FEDERAL STANDARD COLOR NUMBERS**

B		FS 36307
J		FS 36251
D		FS 36270
M		FS 35237
N		FS 36152

