

ACADEMY

HOBBY MODEL KITS

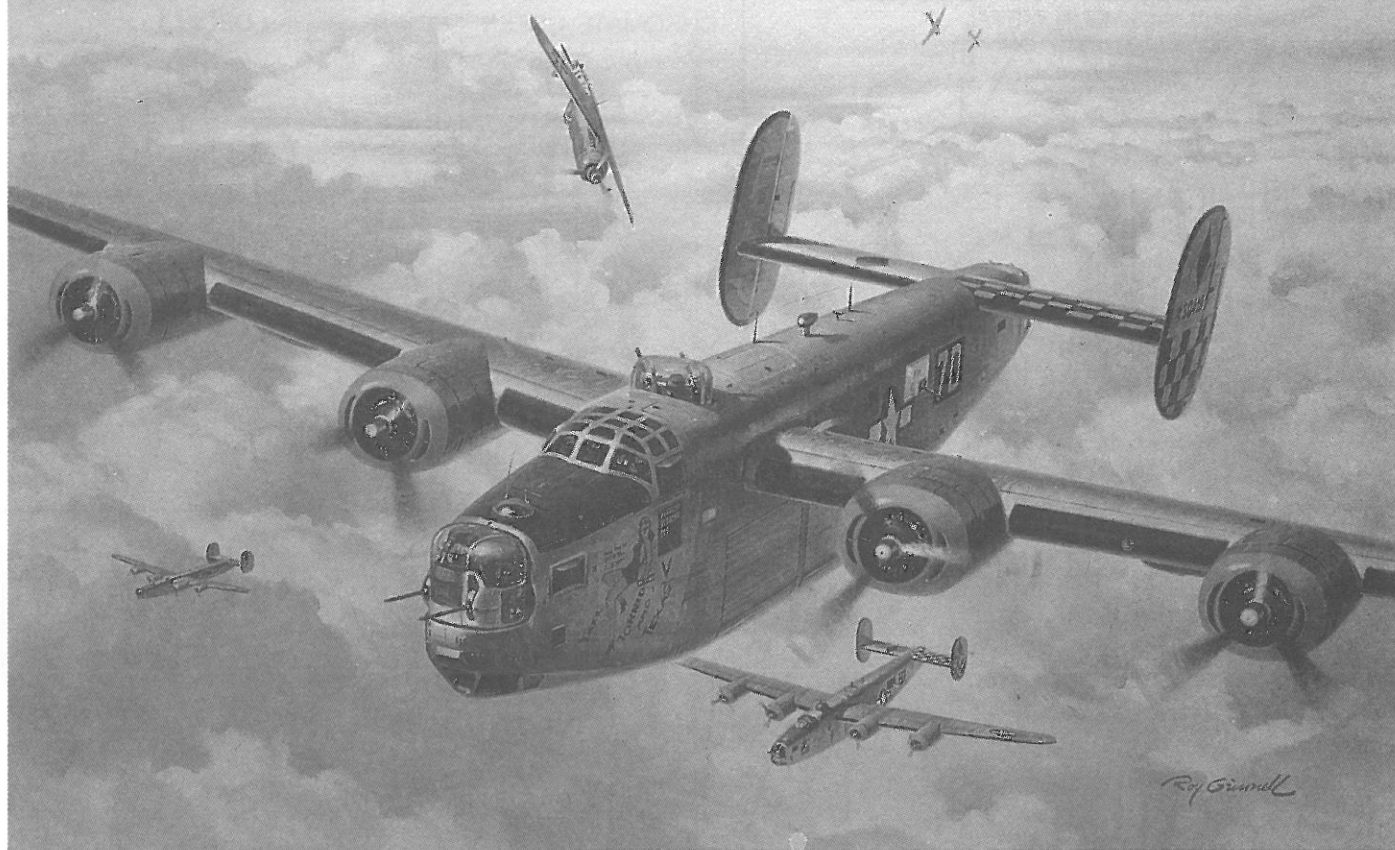

1/72nd scale

CONSOLIDATED **B-24M LIBERATOR**

The last of the mass-produced Liberator bombers was the "M" version of which Ford built 1,677 aircraft and Consolidated assembled 916 for a total of 2,593 planes. This version differed from earlier types by its more severely slanted bomb aimer's panel, bulged navigators's side windows and a lighter weight tail turret.

Armed with 10 fifty caliber machine guns and 5,200 rounds of ammunition in the nose, tail, top, belly and side positions, the B-24M still had the ability to carry its 4,000 pound bomb load deep into Germany.

Four Pratt & Whitney supercharged R-1830-65 engines rated at 1,200 horsepower each gave the B-24M a cruising speed of 215 miles per hour and a service ceiling of 28,000 feet. Its rather slow rate of climb, 1,025 feet per minute was often criticized by its crews. Its maximum range was an outstanding 3,700 miles using its full fuel capacity of 3,614 gallons. Empty the B-24M weighed 36,500 pounds, but fully loaded it had a gross weight of 56,000 pounds. The wingspan was 110 feet; the length 67.3 inches and the height 18 feet.

The purpose of the B-24 was to deliver a massive tonnage of bombs on the Nazi war machine. It may have been difficult to fly, uncomfortable and noisy, but the B-24M did accomplish its mission flying countless missions deep into the Ruhr and beyond.

1 GUN ASSEMBLY

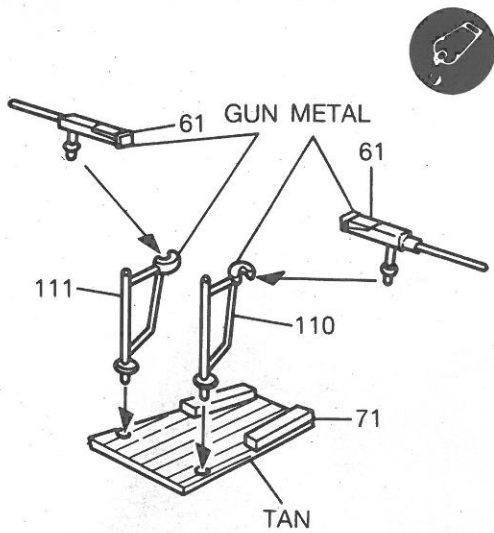

2 COCKPIT

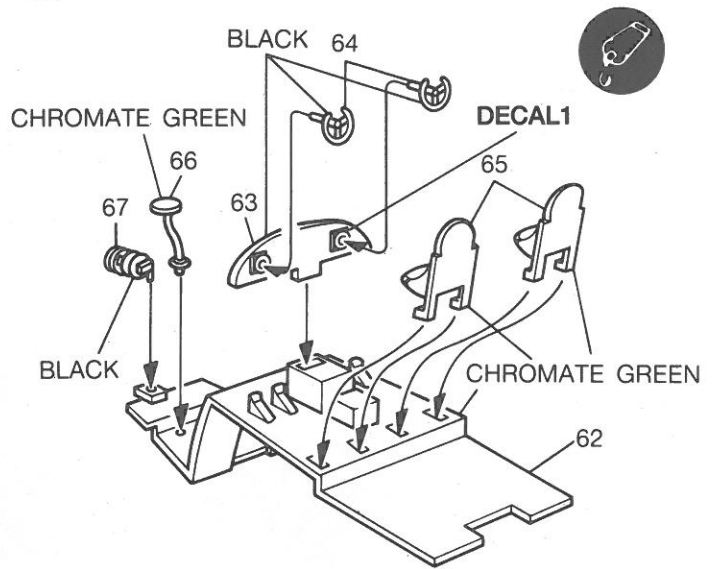

3 FUSELAGE INTERIOR

(Repeat for Left side)

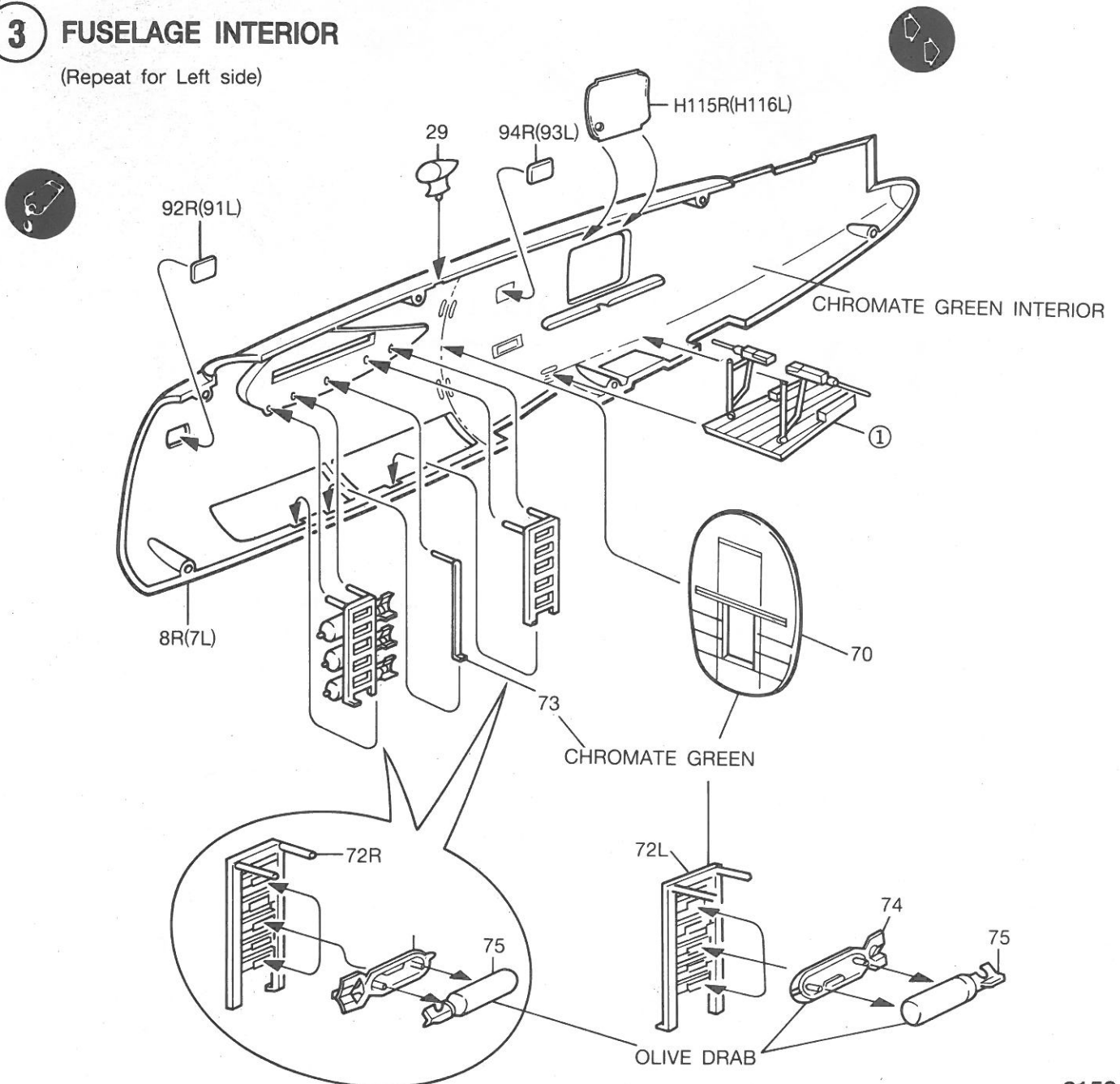

4 NOSE WHEEL

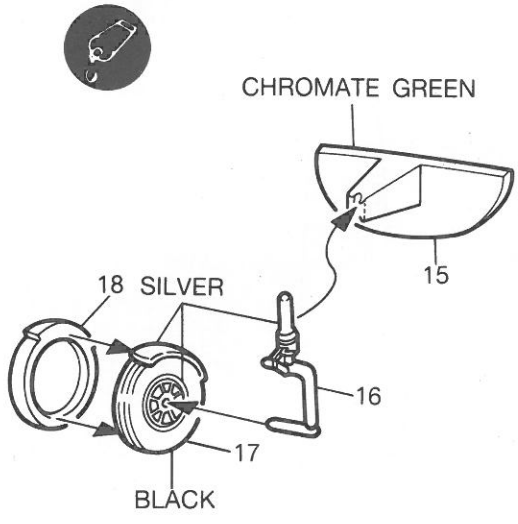

5 NOSE AND TAIL TURRETS

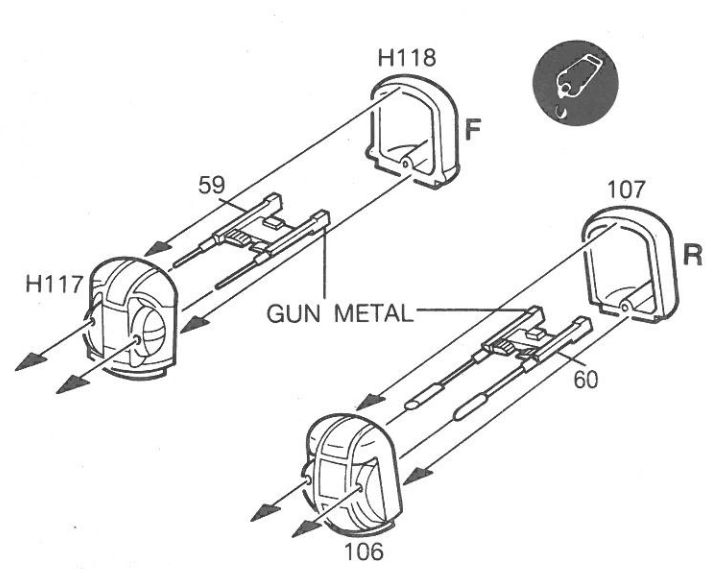

6 COCKPIT INSTALLATION

(Repeat for Left side)

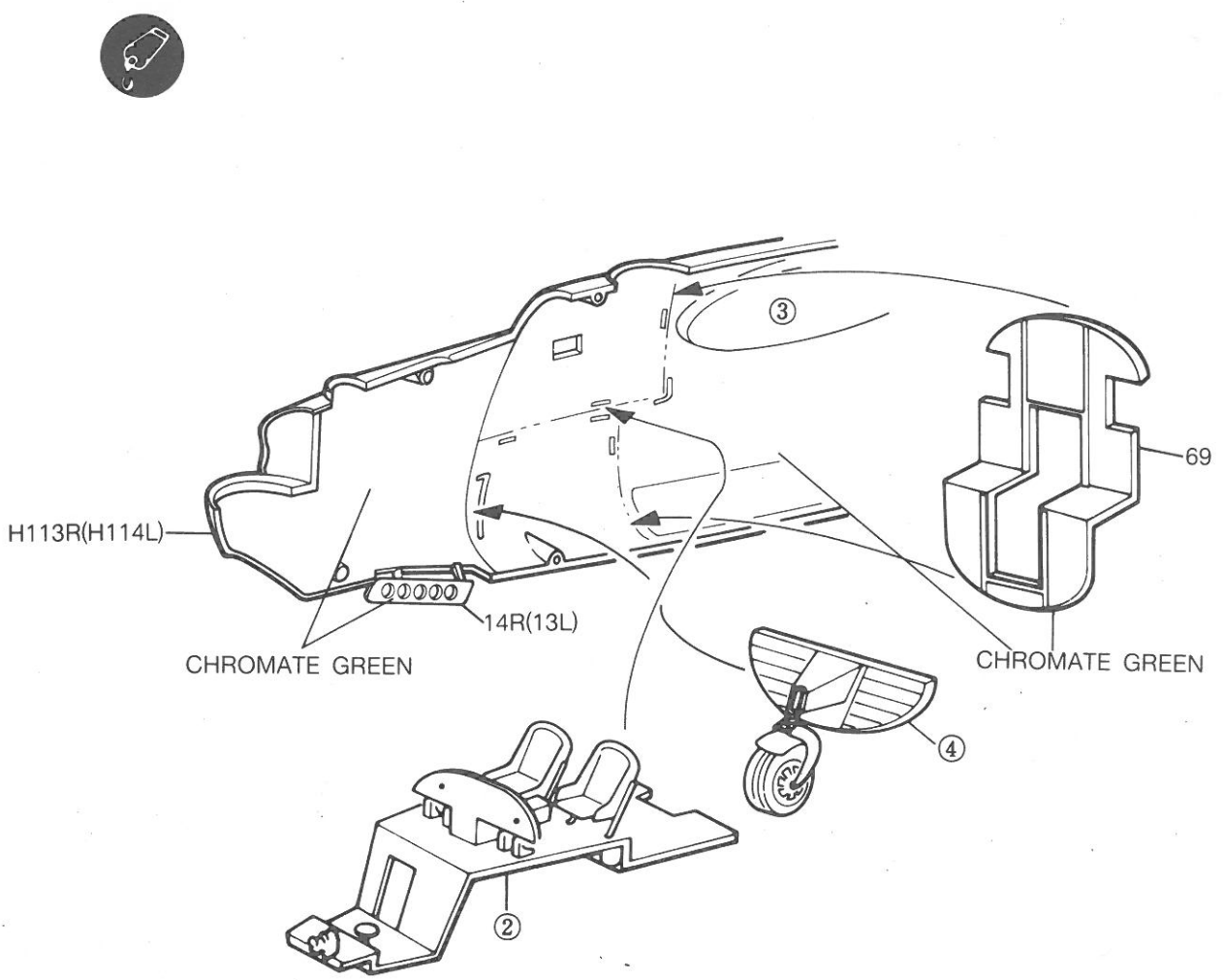

7 MAIN FUSELAGE ASSEMBLY

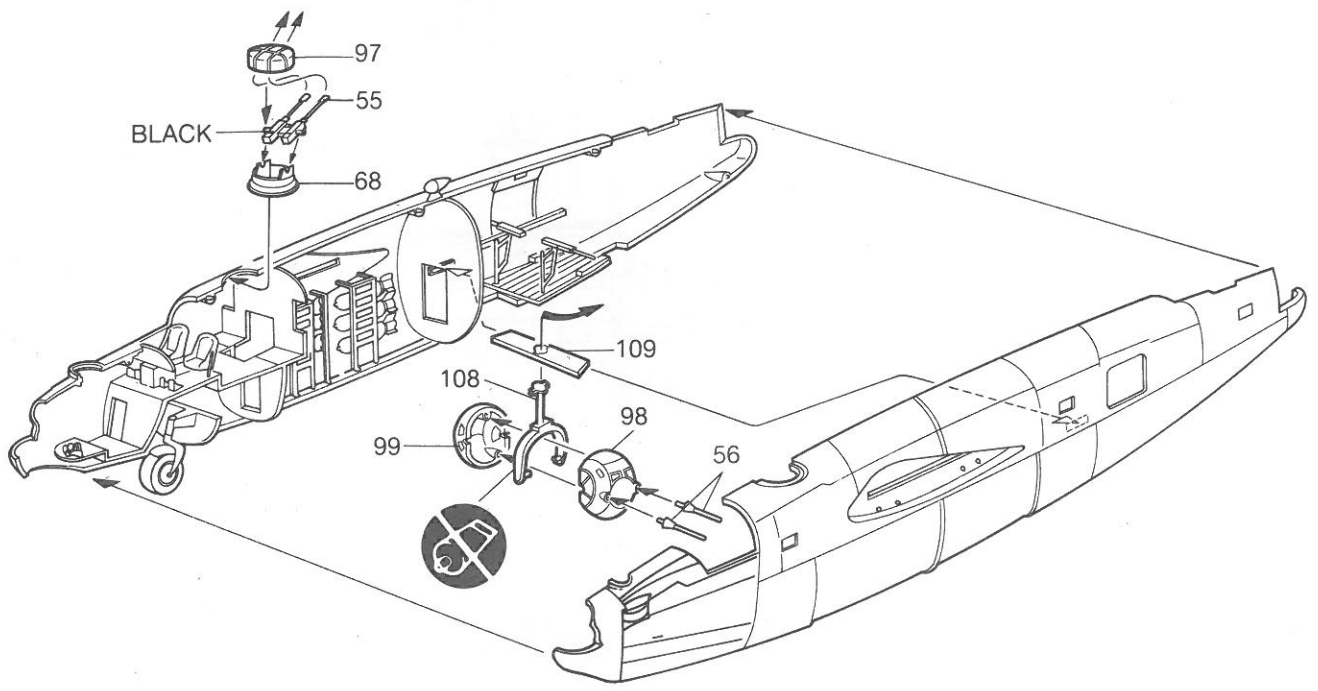

8 FORWARD FUSELAGE ASSEMBLY

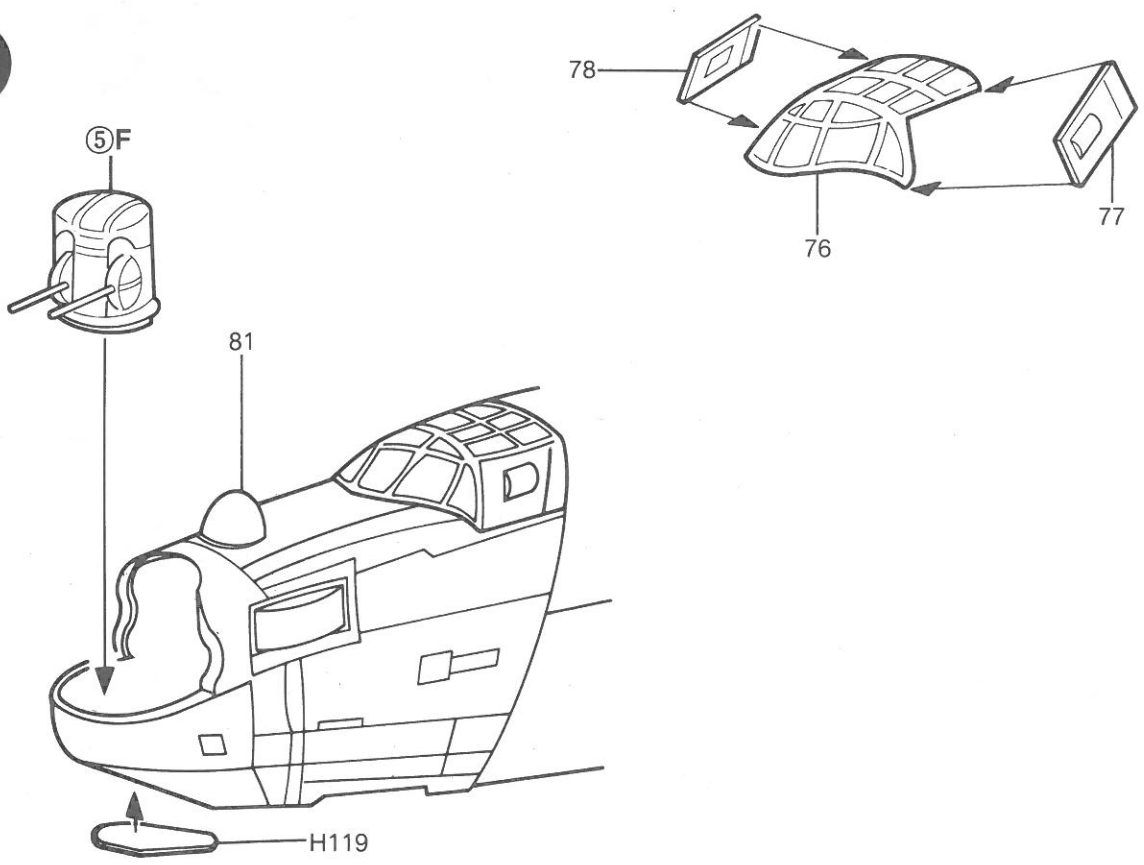

9 BOMB BAY DOORS(CLOSED)

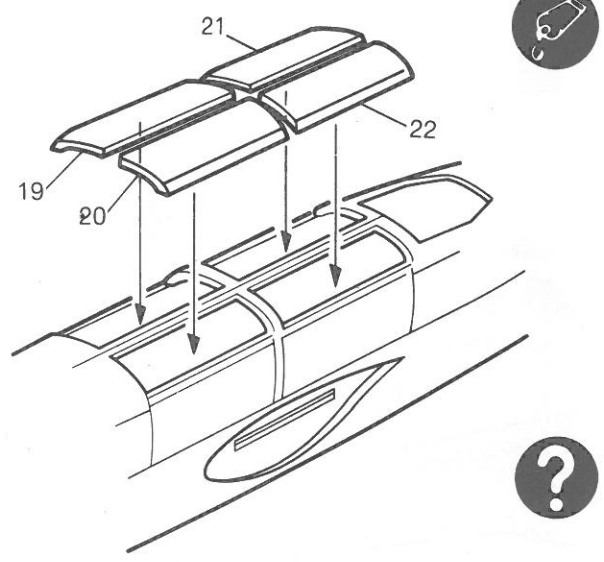

10 BOMB BAY DOORS(OPEN)

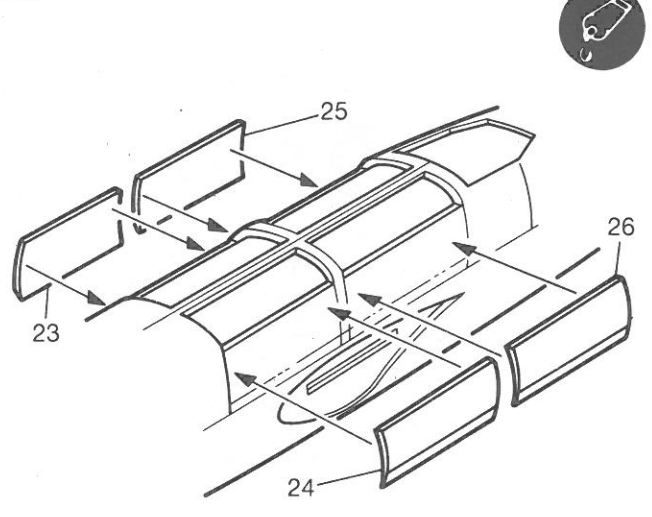

11 LOWER PANEL

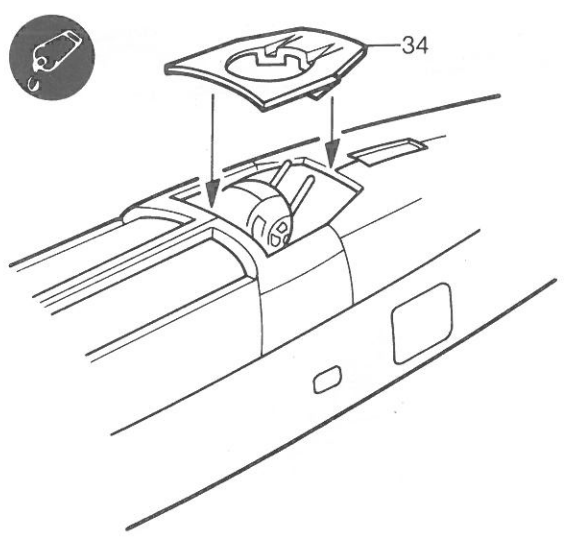

12 LOWER REAR FUSELAGE

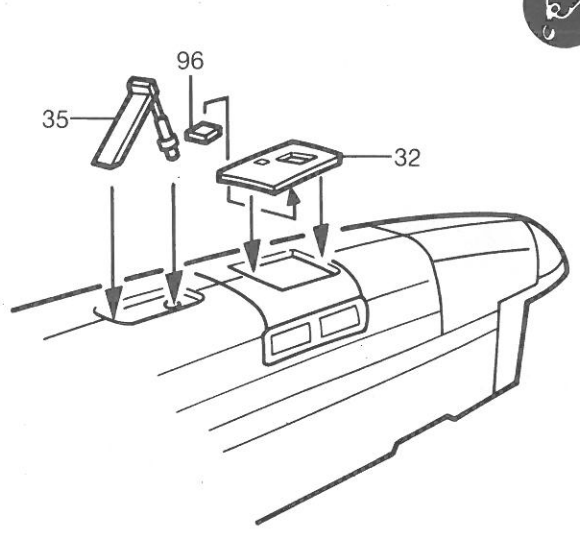

13 REAR TURRET INSTALLATION

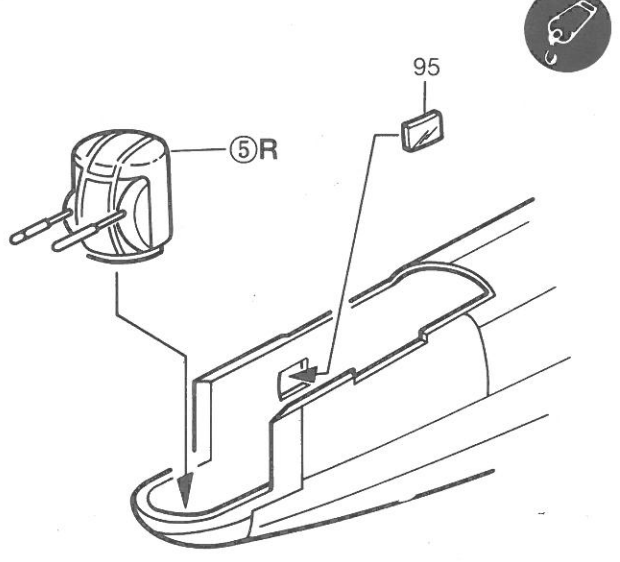

14 ENGINE ASSEMBLY

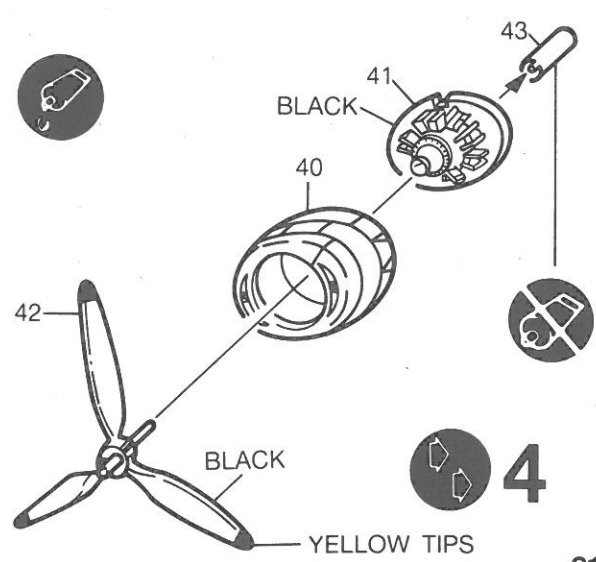

15 WING ASSEMBLY

2

(Repeat for Left side)

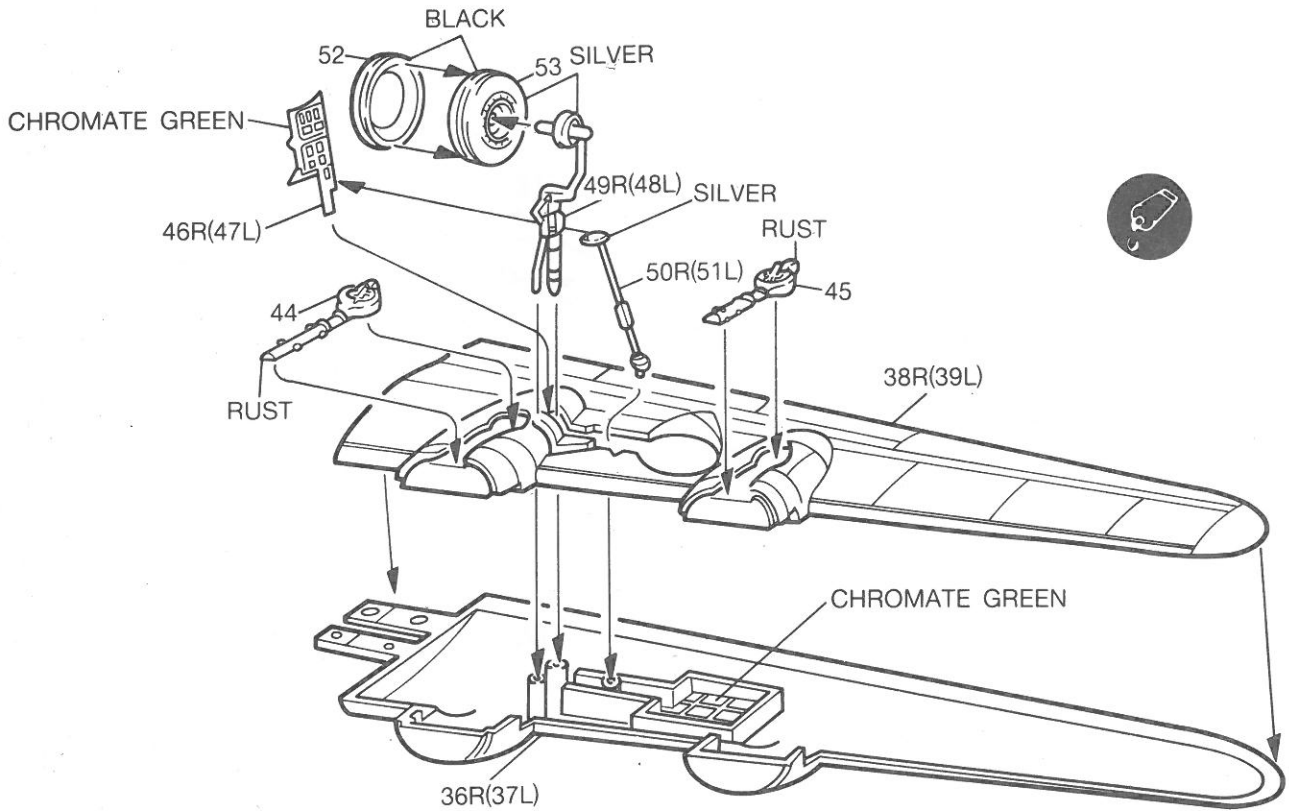

16 TAIL AND FINAL ASSEMBLY

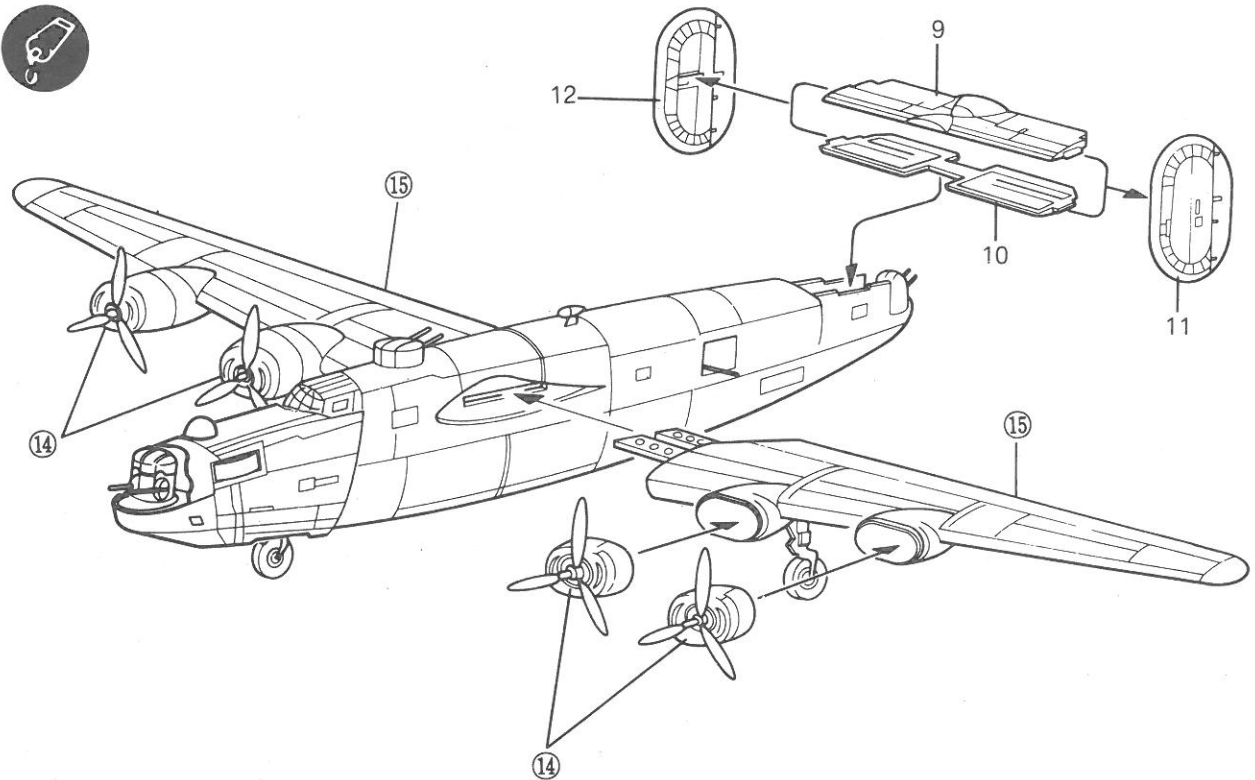

Painting and Decal Placement Diagram

Paint Overall **SILVER** Natural Metal
 Paint leading edges of cowl **YELLOW**

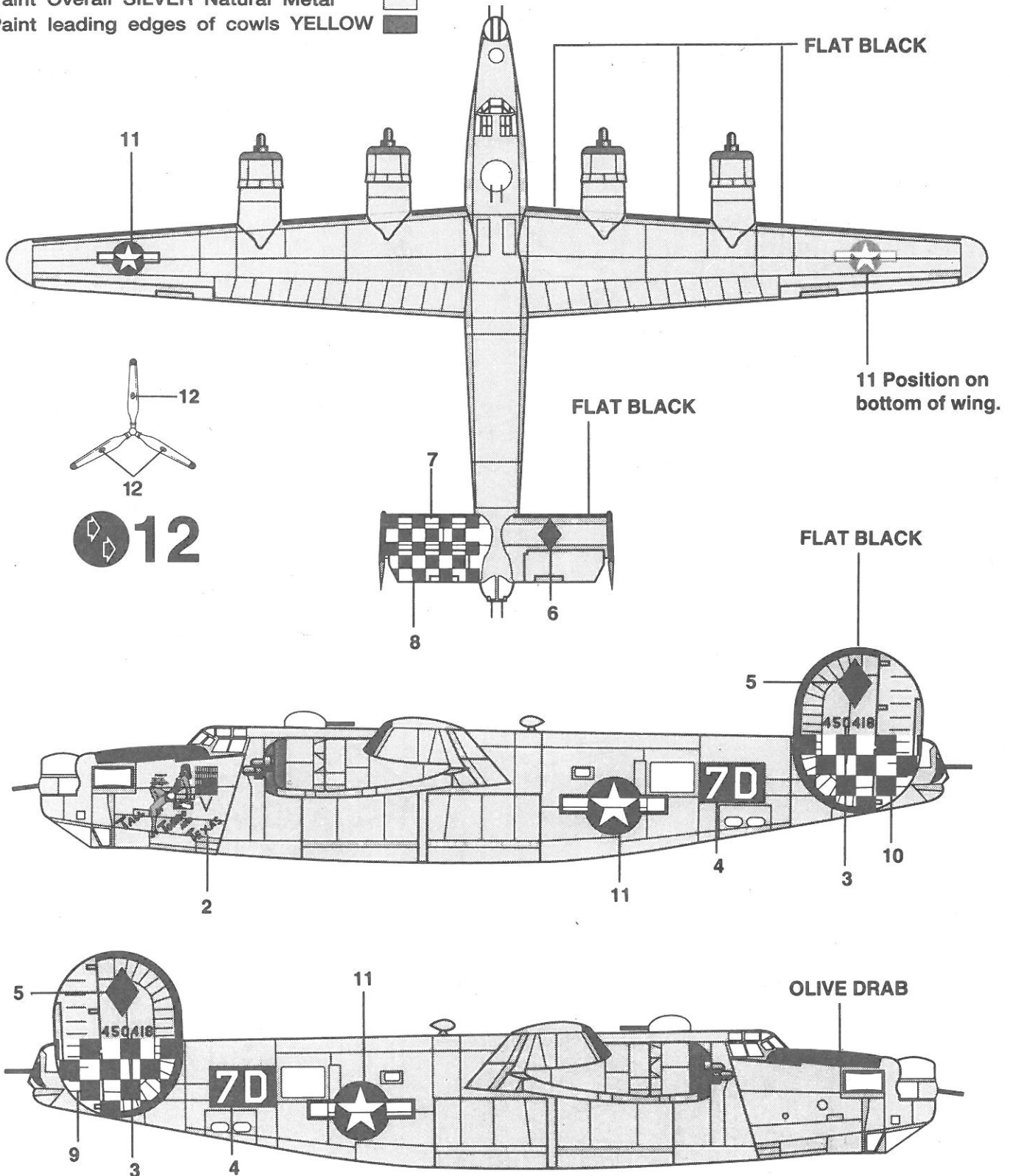

ENGLISH	FRENCH	GERMAN	SPANISH	ITALIAN
BLACK	NOIR	SCHWARZ	NEGRO	NERO
SILVER	ARGENT	SILBERN	PLATA	ARGENTO
GRAY	GRIS	GRAU	GRIS	GRIGIO
RED	ROUGE	ROT	ROJO	ROSSO
YELLOW	JAUNE	GELB	AMARILLO	GIALLO
GREEN	VERT	GRÜN	VERDE	VERDE



Cement Parts
 Coller
 Kleben
 Pagar
 Incollare
 Colar
 Kleven



Do Not Cement Parts
 Ne Pas Coller
 Nicht Kleben
 No Pagar
 Non Incollare
 Não Colar
 Niet Kleven



Cut Away
 Couper
 Schneiden
 Cortar
 Tagliare
 Cortar
 Snijden



Optional Parts
 Choix
 Auswahlmöglichkeit
 Eleccion
 Scelta
 Opcao
 Keuze



Repeat Operation
 Répéter l'opération
 Vorgang Wiederholen
 Repetir la operación
 Repetere
 Repetir a Operação
 Herhalen

ACADEMY
 HOBBY MODEL KITS

Parts locating Diagram

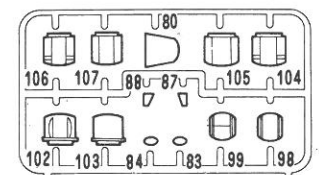
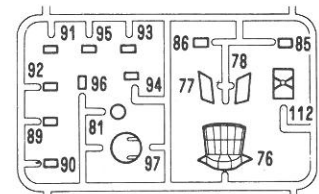
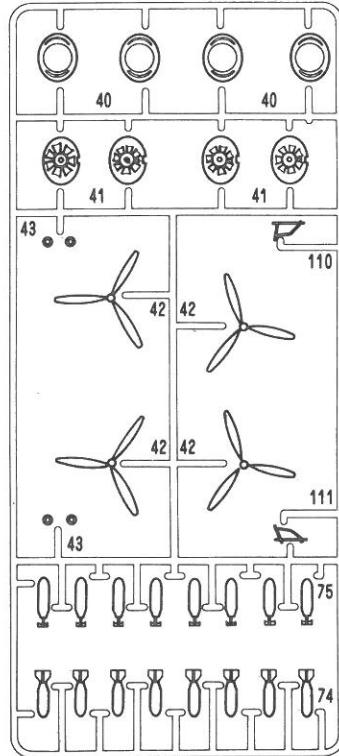
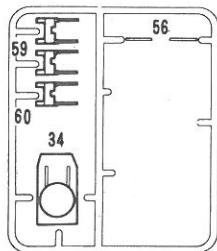
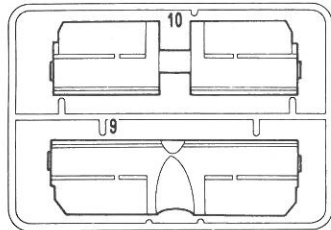
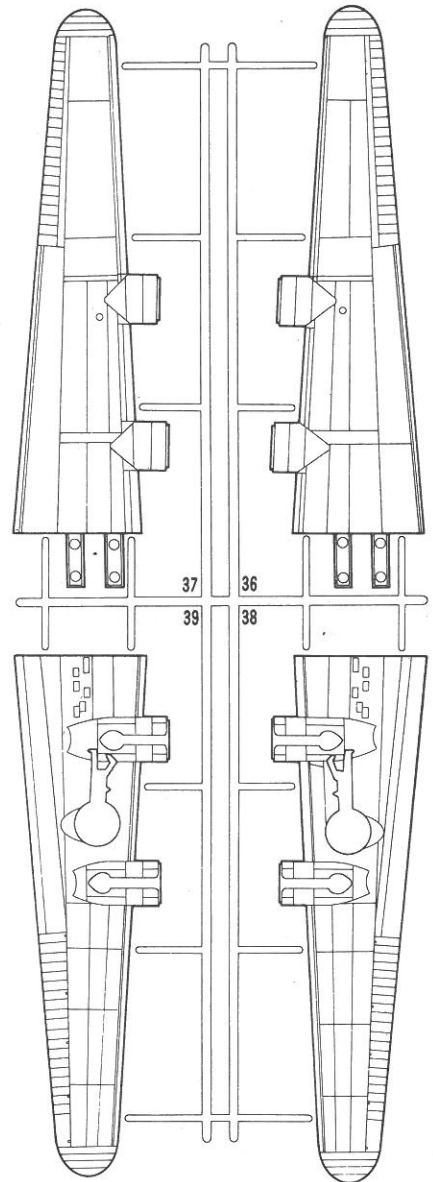
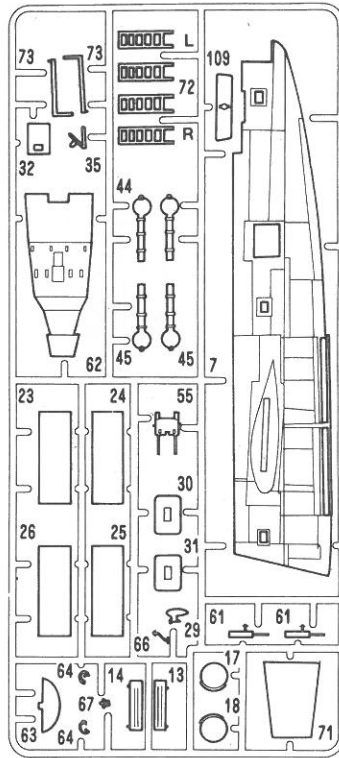
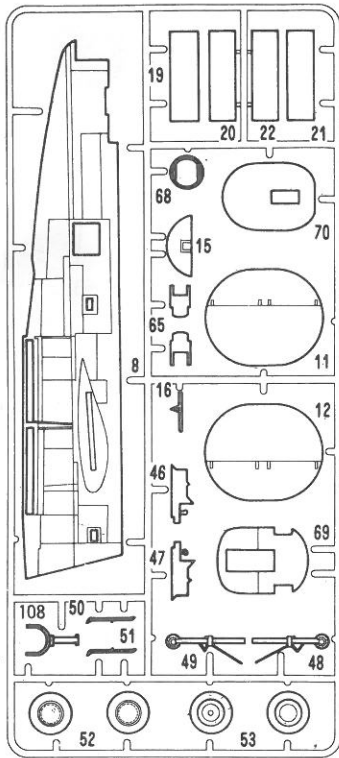

H

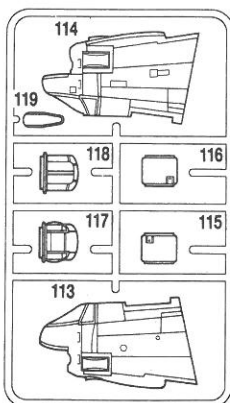

*UNUSED PARTS: 30, 31, 80, 83, 84, 85, 86, 87, 88, 89, 90, 102, 103, 104, 105, 112

ACADEMY
HOBBY MODEL KITS

Copyright 1995 Academy Plastic Model Co., Ltd.
273-64, Suyu-dong, Kangbuk-ku, Seoul, Korea FAX: 82-2-997-3003