

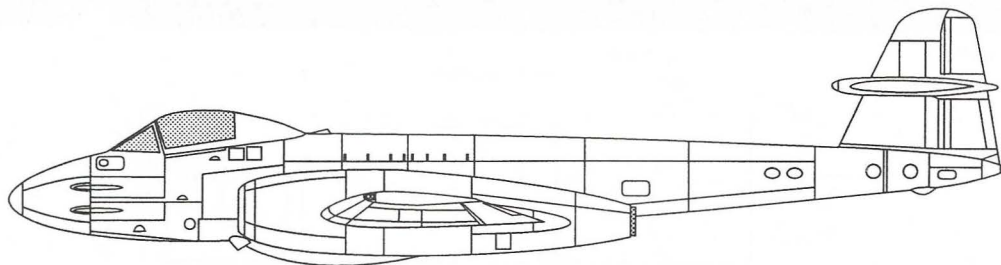

Classic Airframes



Gloster Meteor F.8

The Gloster Meteor holds the distinction of being the first British jet fighter to see active service under combat conditions. It entered service in the summer of 1944 to counter the menace of the V-1 rocket attacks over southern England. Numerous modifications to enhance power and serve in different roles, assured that the Meteor served for many years with the RAF and a host of other nations.

Some note must be given to the distinguished role it played while serving with the RAAF over the skies of Korea when the first jet vs. jet combat took place versus Mig 15's. Later it also played a role in the Middle East conflict, serving not only the RAF, but also the air forces of Israel, Egypt, Syria and Iraq.

Many people contributed to this kit becoming a reality: from the UK, David Hannant and Les Piper; from the US, Ron Dobrzelecki, Steven Eisenman, John Valo and Jim Maas; and last but certainly not least from Australia, Brett Green and Max Shore. My thanks go to them for making it all possible.

Meteor F.8 Specifications

Powerplant:	2x 3500lb. Rolls-Royce Derwent jet engines	Armament:	4x 20mm cannon
Wing Span:	372"		
Length:	44'7"		
Maximum Speed:	592 mph		

This model kit is intended for experienced modelers. The nature of limited-run kits such as this require additional time and effort to clean up and fit the parts, as well as experience with the various media utilized to provide the most accurate effect on the finished model. Use CyA ('super') glue to assemble Resin (PU) parts.

Assembly Instruction Symbols



MULTIPLE ASSEMBLIES



BEND



OPTIONAL



DRILL



CUT



SYMMETRICAL ASSEMBLIES

Paint Reference Guide

A

Light Grey



C

Aluminum



E

Dark Brown



B

Flat Black-grey



D

Burnt Metal



F

Gunmetal



Parts

PLASTIC PARTS

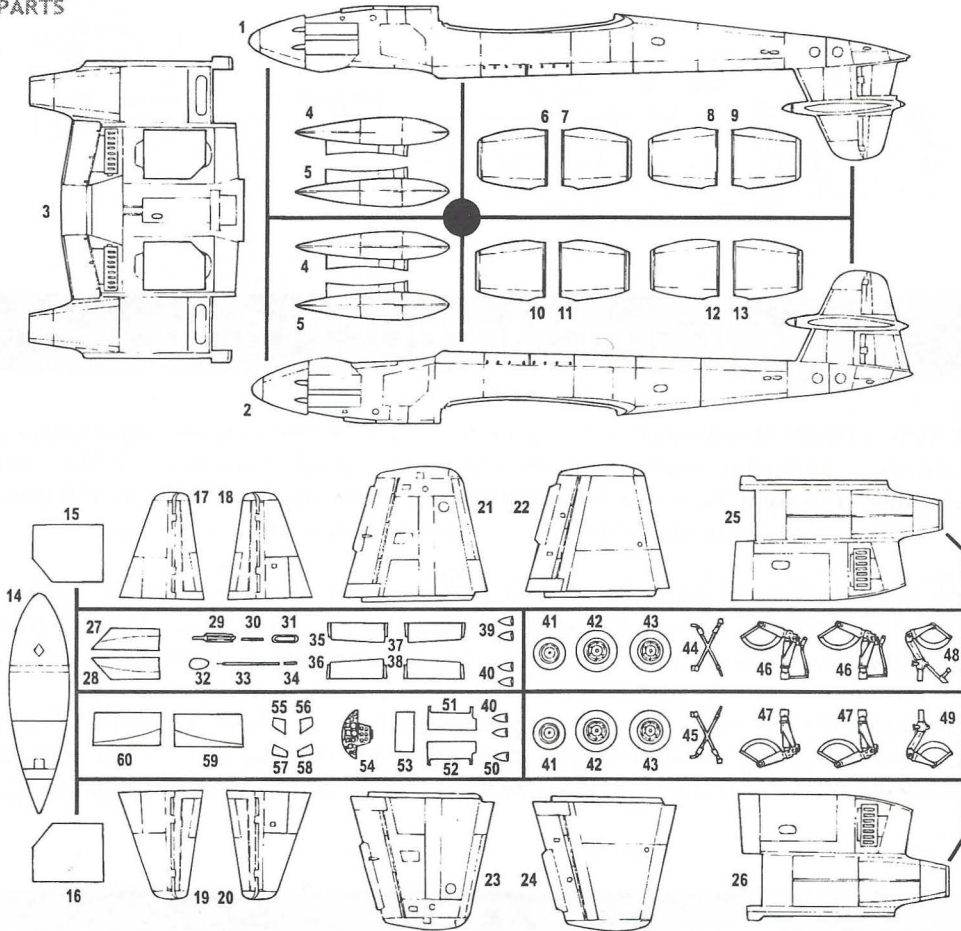

RESIN PARTS

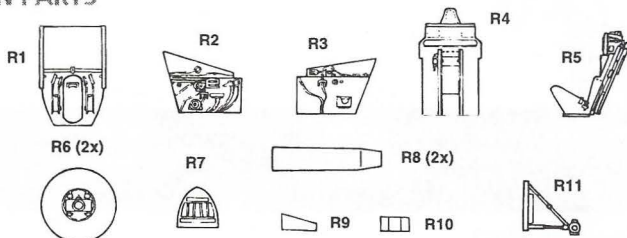

CLEAR PARTS

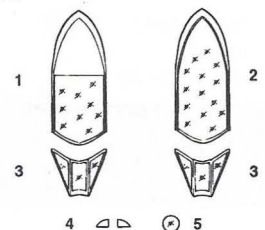

1 All cockpit parts are Flat Black/Grey with Silver, Black & White details

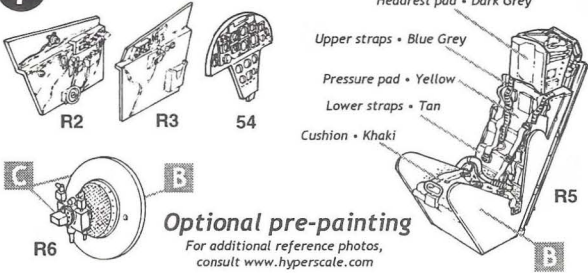

2 Be sure to dry-fit all parts before assembly!

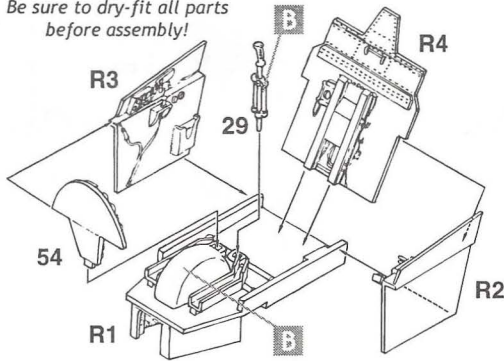

3

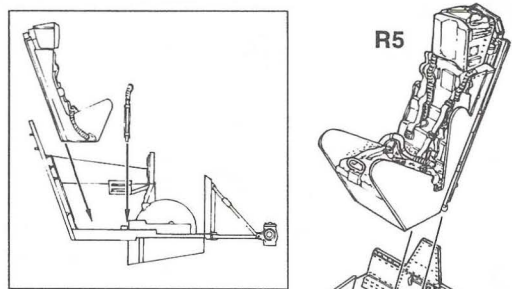

Be sure to dry-fit all parts before assembly!

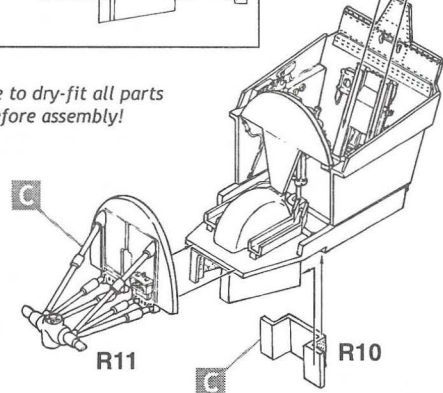

4 Be sure to add 60 grams (~2 Oz.) to nose area so model sits on nose wheel

Be sure to dry-fit all parts before assembly!

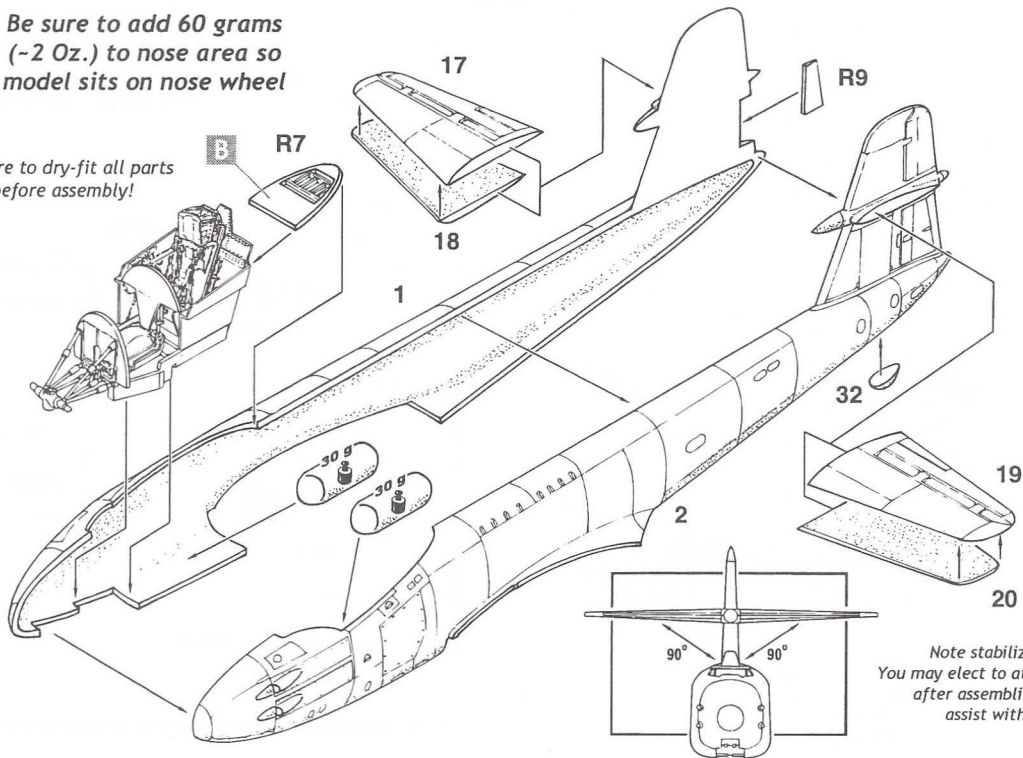

Note stabilizer alignment
You may elect to attach the stabilizers after assembling the wings to assist with alignment

5 Intake interiors

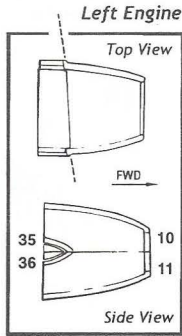
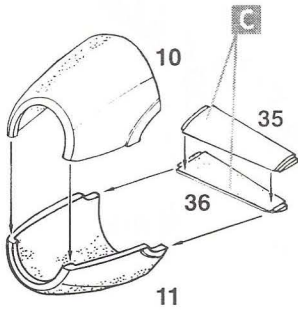
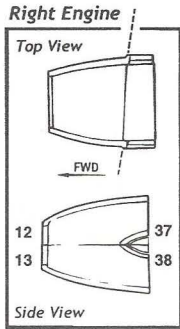
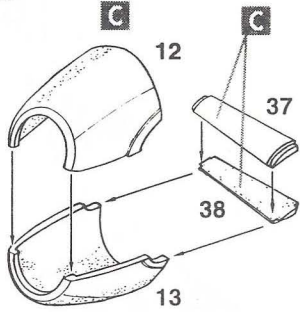

6 Be sure to dry-fit all parts before assembly!

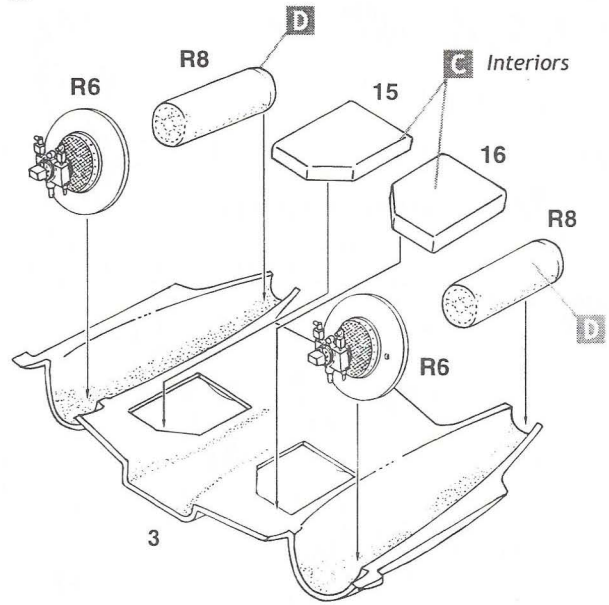

7

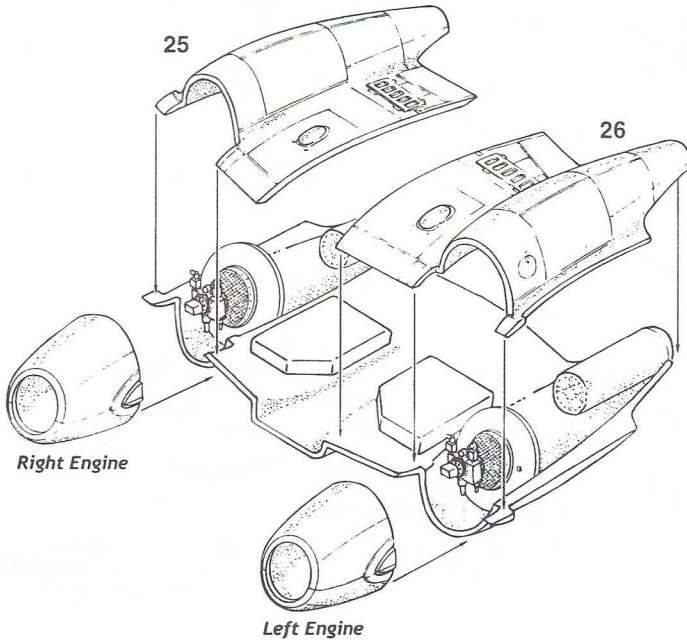

Note relative positions of all parts.
Be sure to dry-fit all parts before assembly!

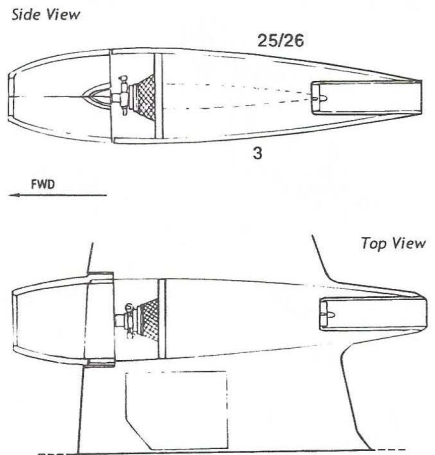

8

Be sure to dry-fit and check alignment of all parts during assembly.

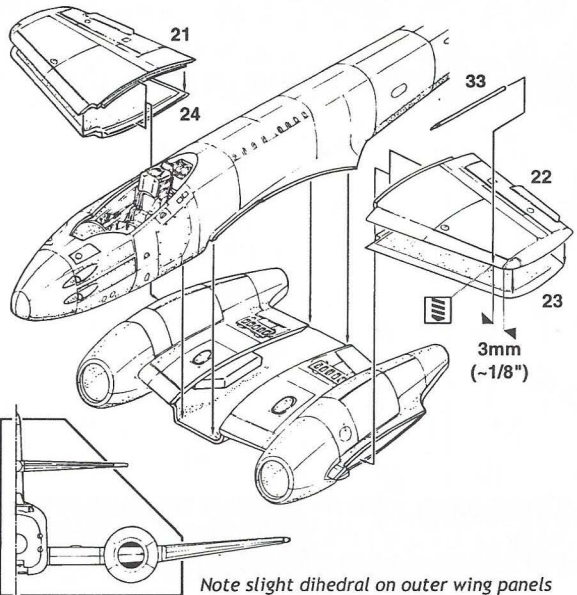

9

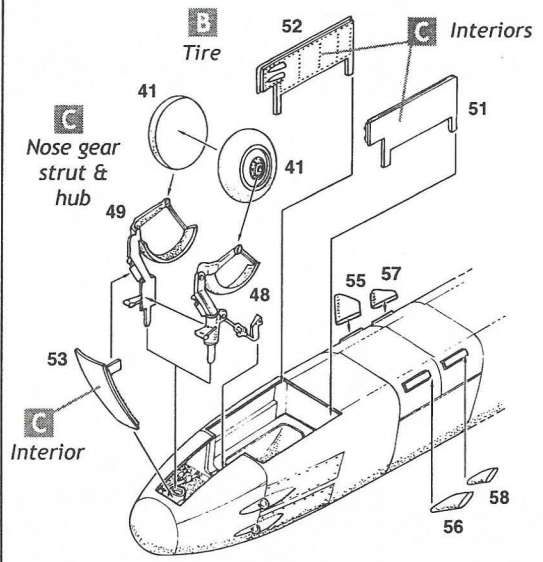

10

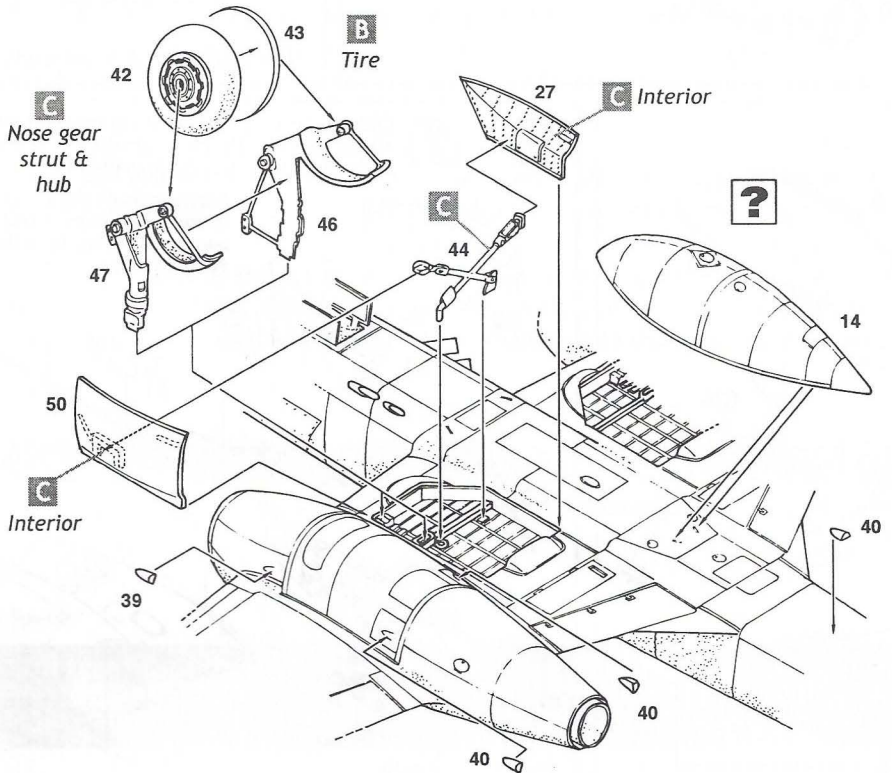

11

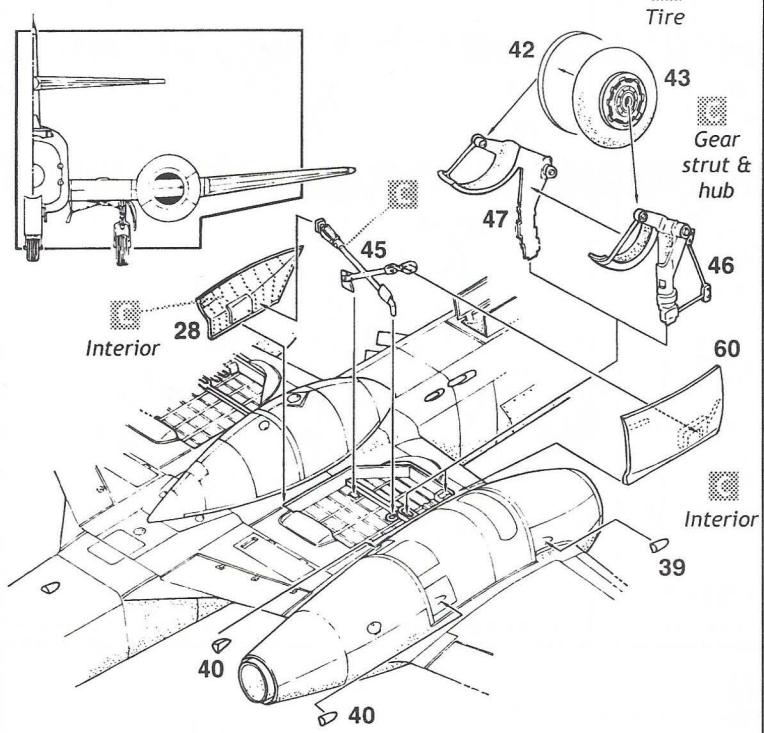

12

?

Wing tank & Navigation Light

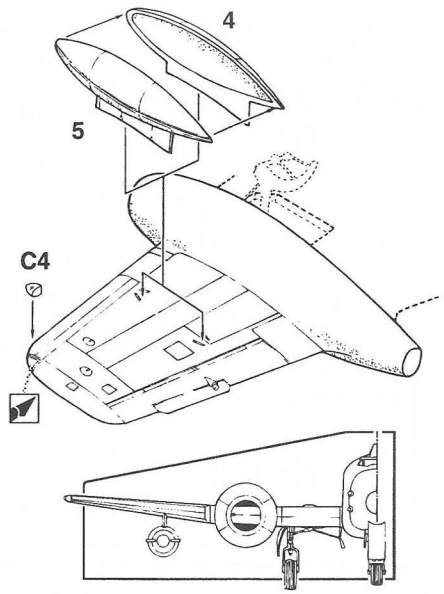

Note hanging tank is perpendicular to ground.

13

?

Wing, Navigation & Landing Lights

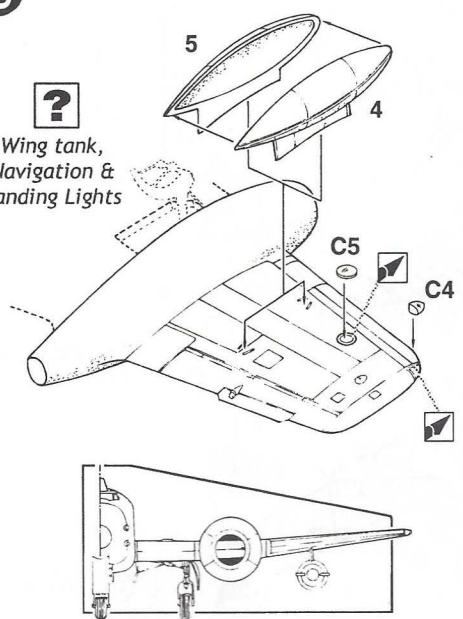

Note hanging tank is perpendicular to ground.

14

?

Check your references for canopy and antenna styles appropriate for your model. Note that only one style of canopy may be provided in your kit.

Photos indicate the use of a clear fairing on some Australian aircraft in place of part 31. This may be easily scratchbuilt. Be sure to consult references.

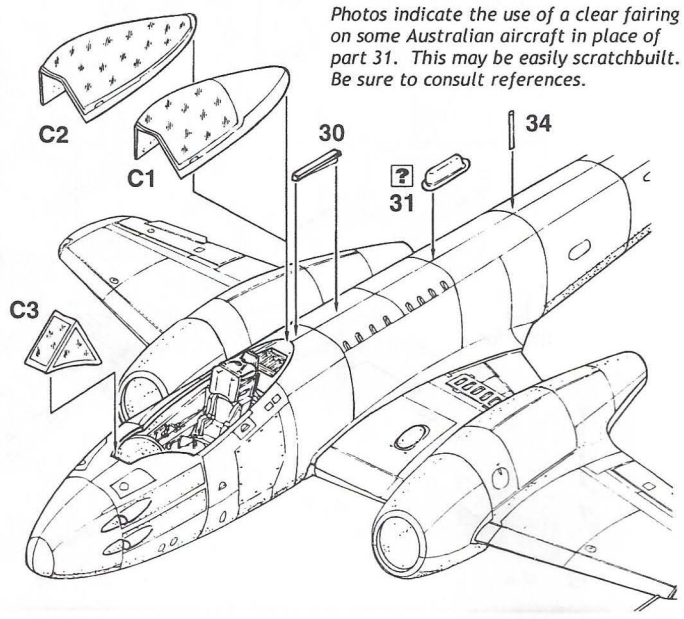

Gloster Meteor F.8 PAINTING & MARKING GUIDE

Sgt. George Hale, 77 Squadron, RAAF, Korea, March 1953

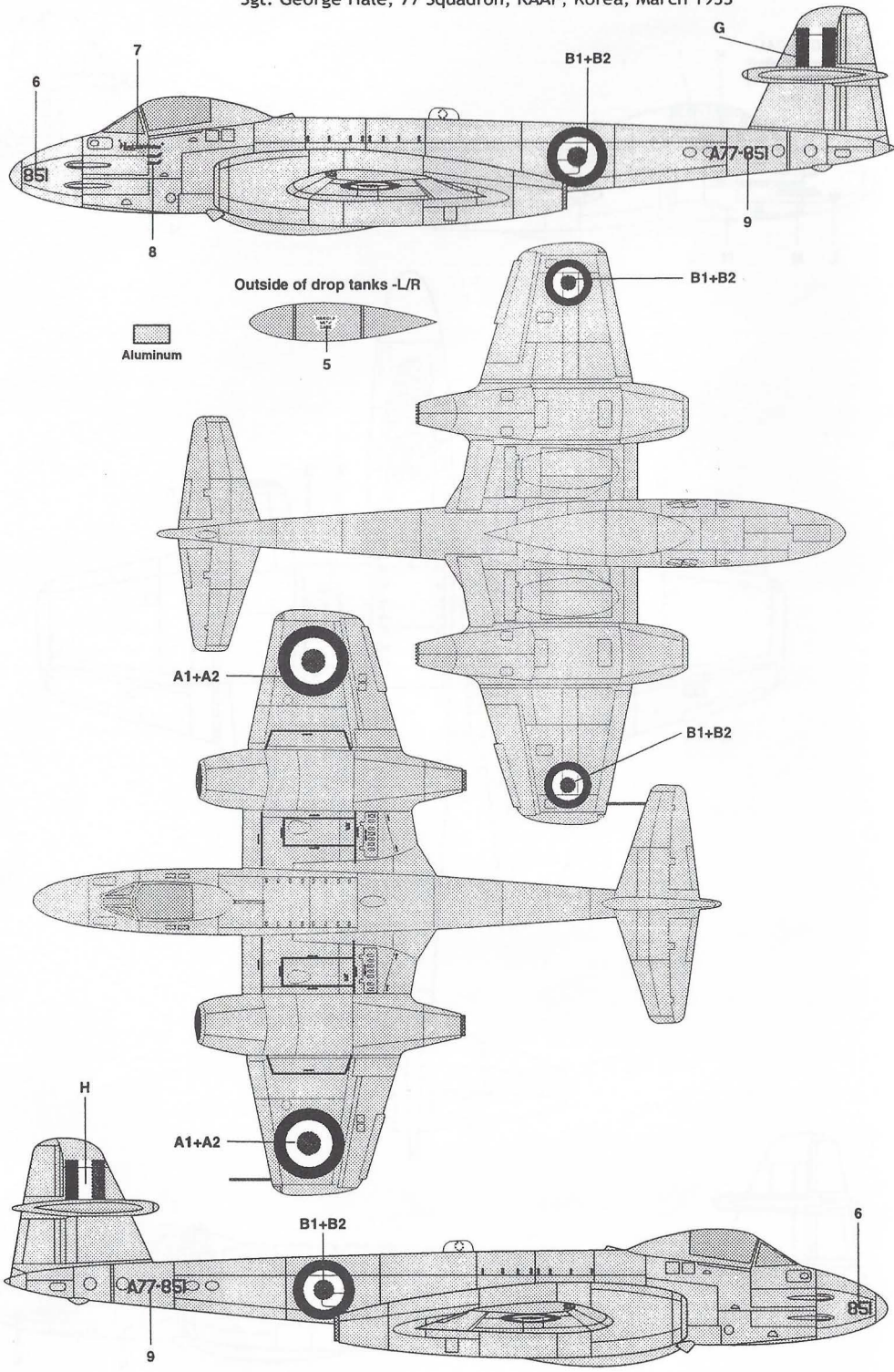

Gloster Meteor F.8 PAINTING & MARKING GUIDE

56 Squadron, RAF Waterbeach, 1953

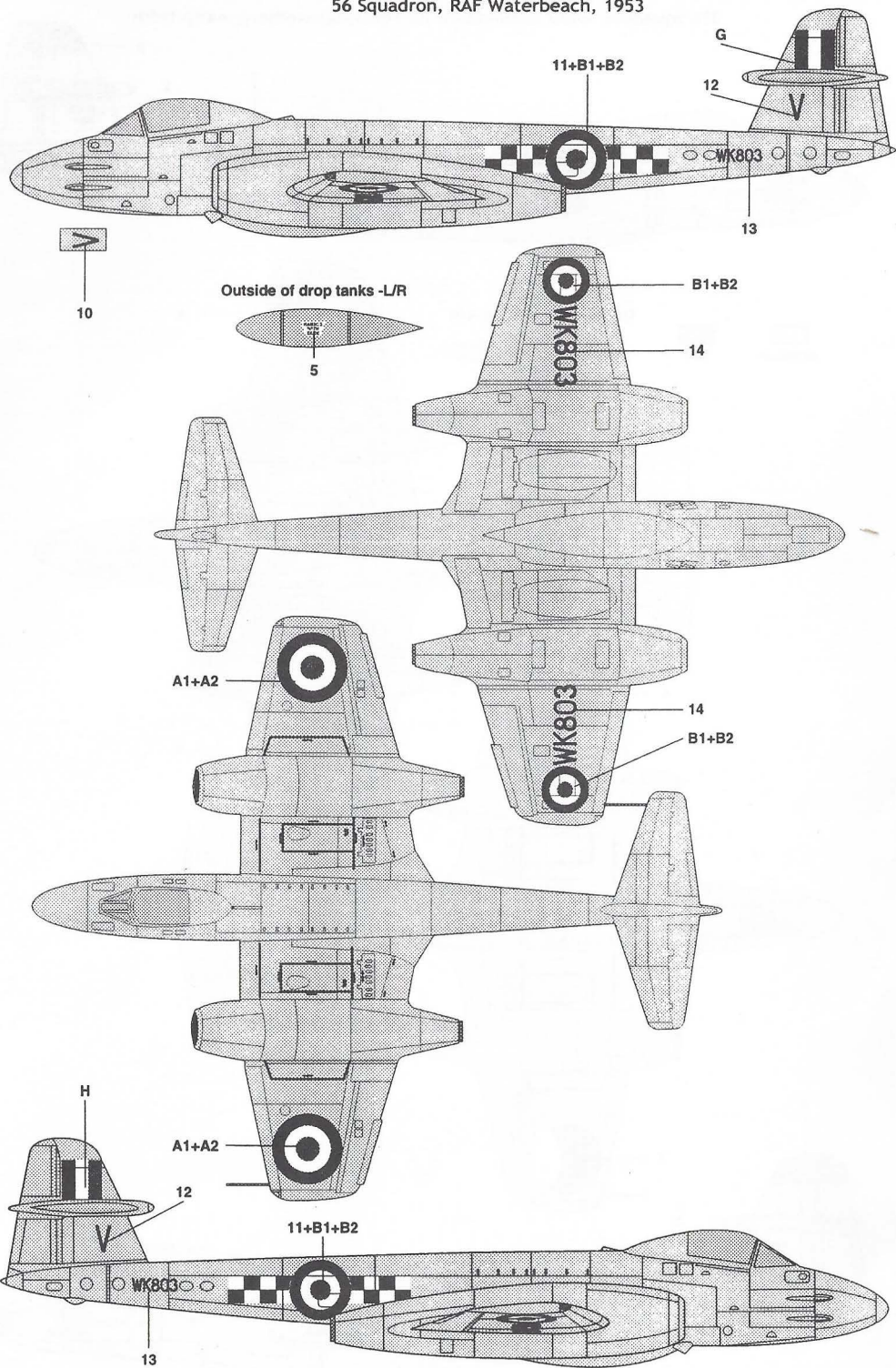

Gloster Meteor F.8 *PAINING & MARKING GUIDE*

326 Squadron, Royal Netherlands Air Force, Soesterberg, early 1950s.

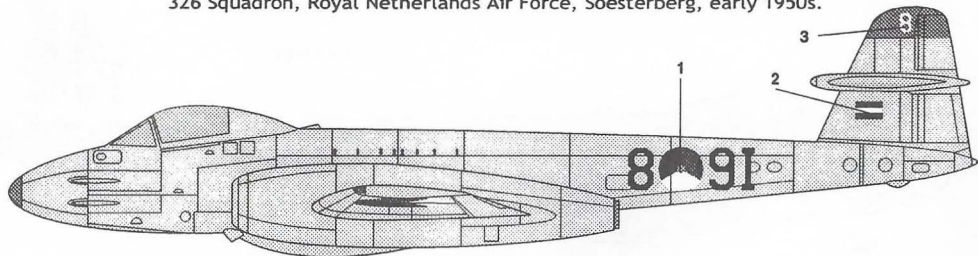

Aluminum

Red

Outside of drop tanks -L/R

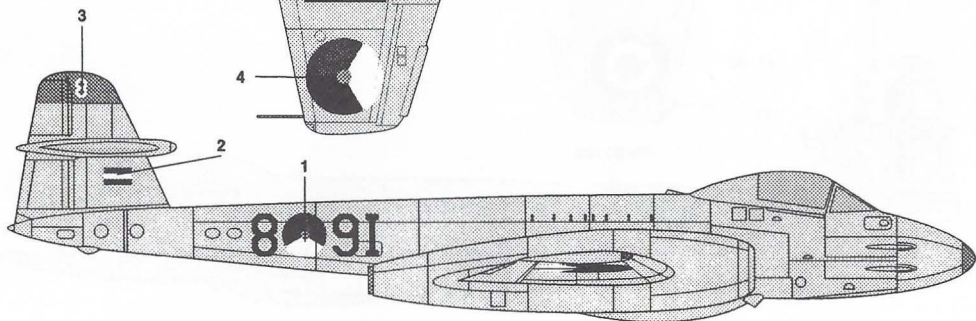
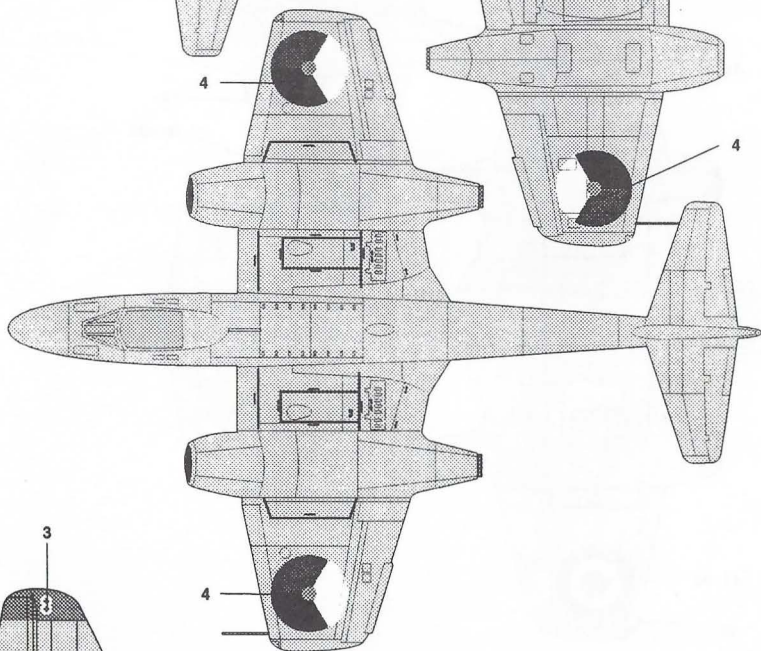
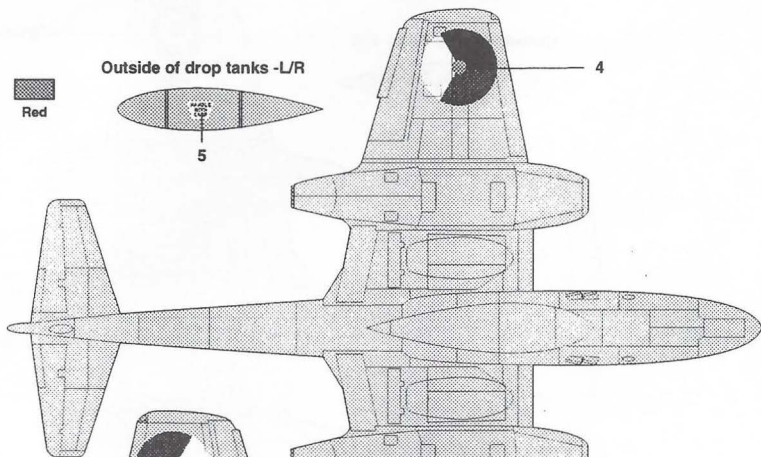
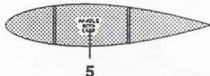

Gloster Meteor F.8 STENCIL PLACEMENT GUIDE

J
Note 'ELECTRICAL'
stencils were applied
to most access doors
in nose area

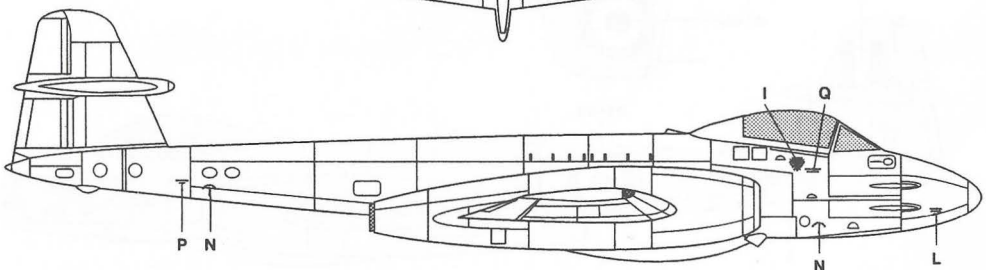
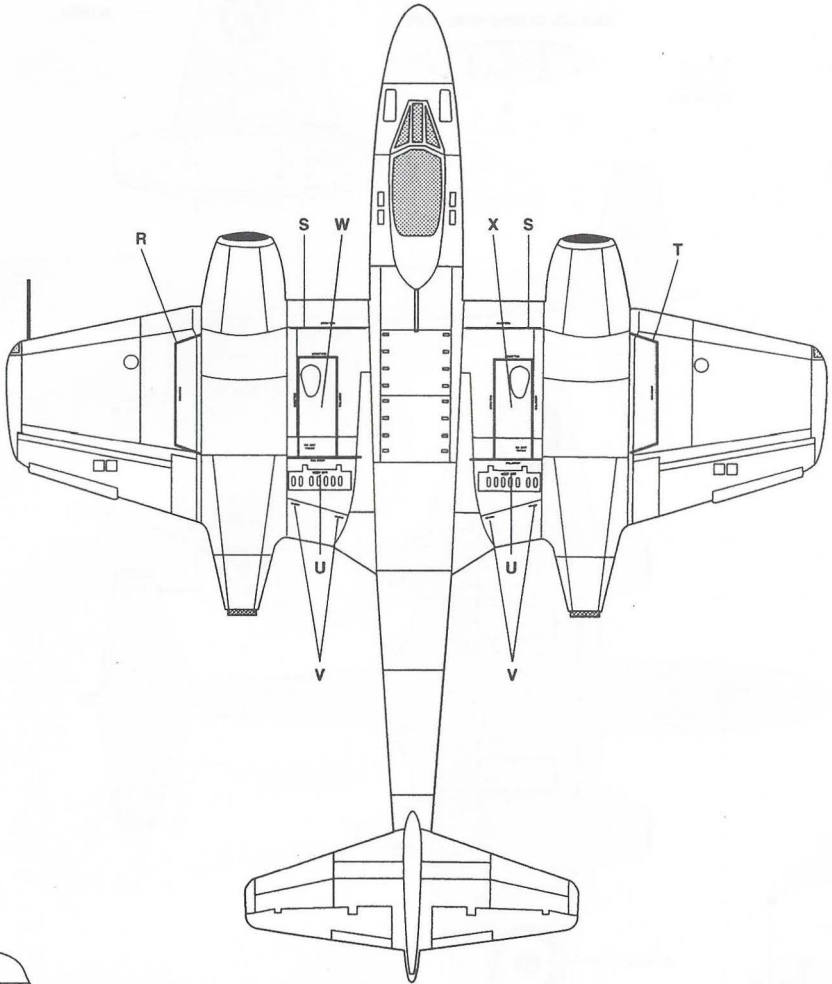
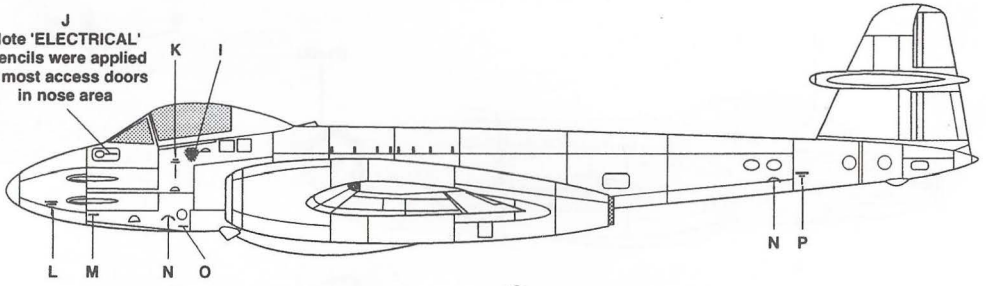

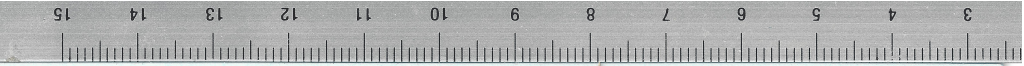

891 A77-851 891

A77-851

HALESTORM

851 851

WK803 WK803

V V

V WK803

HANDLE WITH CARE

Classic Airframes
custom printed by
MICROSCALE
Kit #466

HANDLE WITH CARE

A1 C E F D A1

B2 B1 B1 B2 A2

G H I

Classic Airframes

custom printed by
MICROSCALE

X O Q M N R T L S W

K P J U V J

Classic Airframes

custom printed by
MICROSCALE