



1/32



Arado Ar 234B-2/B-2N

INJECTION PARTS

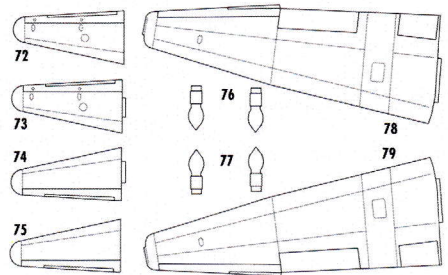
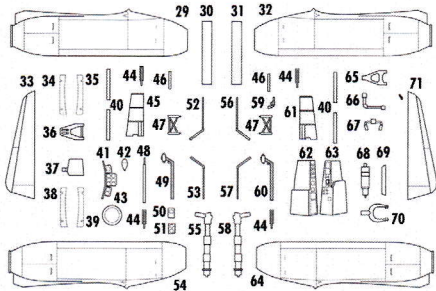
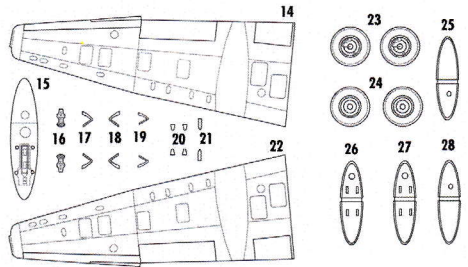
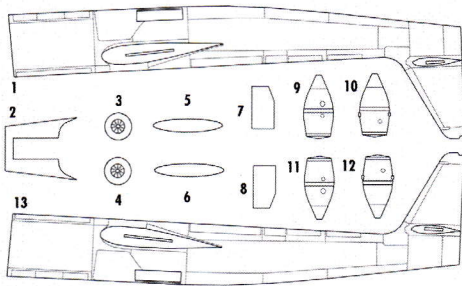

TWINE - B



WIRE



ARADO Ar 234 B-2N

1/32 scale

CLEAR PARTS (CP)

POLYURETHAN PARTS (U)

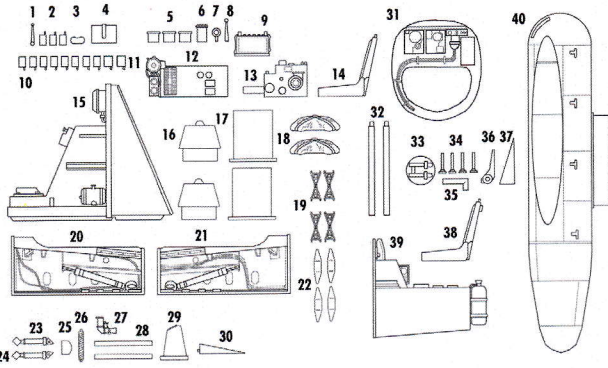
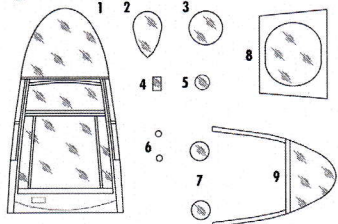
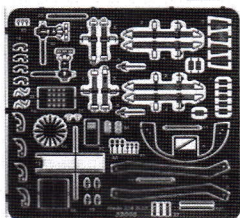
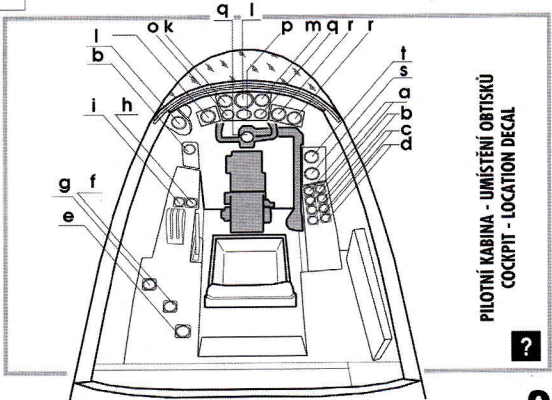
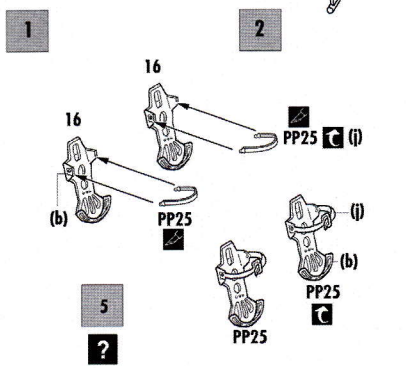
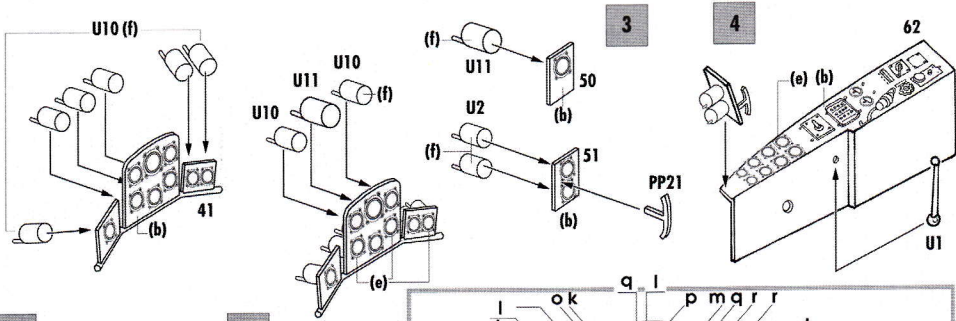

PHOTO-ETCHED PARTS (PP)



- COLORS**
- | | | | |
|-----------------|---------------|------------------|--------------|
| (a) - RLM02 | (b) - RLM66 | (c) - LINEN | (d) - CHROME |
| (e) - SILVER | (f) - BLACK | (g) - TYRE BLACK | (h) - RED |
| (i) - BURN IRON | (j) - LEATHER | (k) - DARK METAL | (l) - WHITE |



PILÓTNÍ KABÍNA - UMÍSTĚNÍ ORBITSKŮ
COCKPIT - LOCATION DECAL



ARADO Ar 234 B-2N

1/32 scale

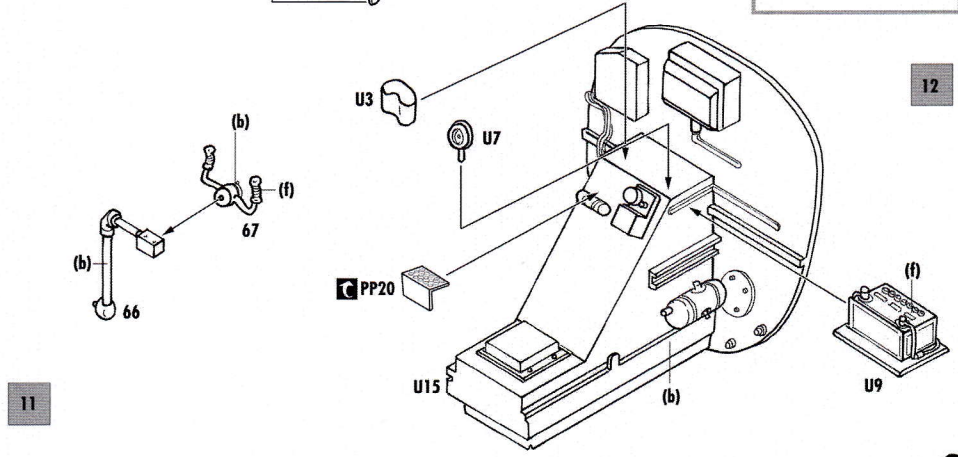
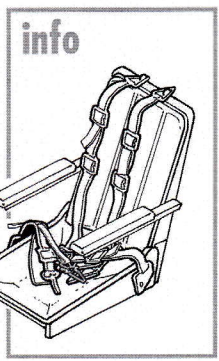
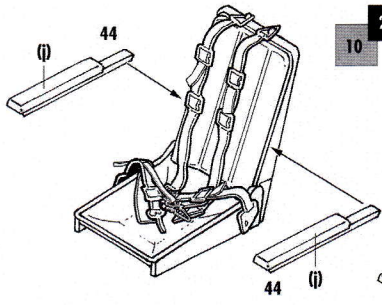
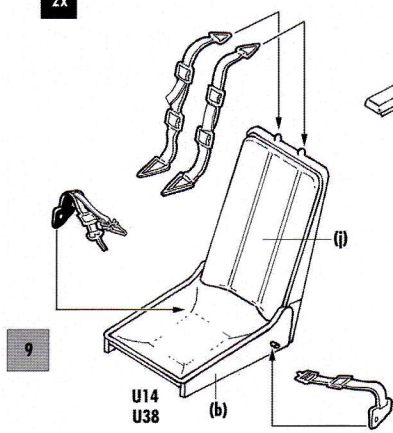
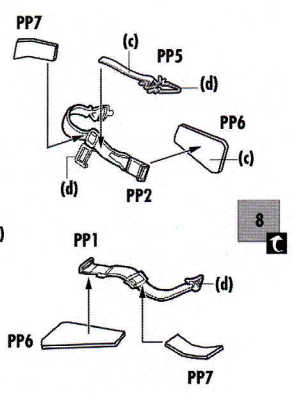
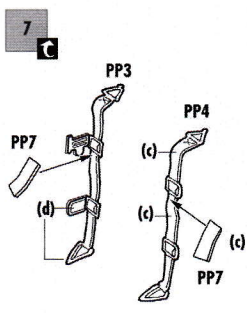
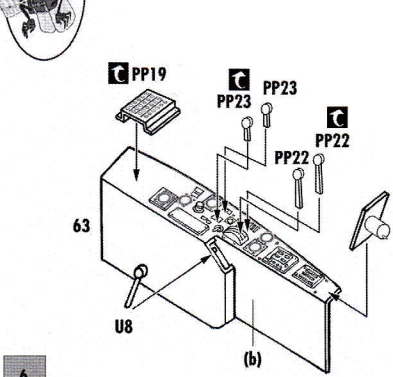

12



ARADO Ar 234 B-2N

1/32 scale

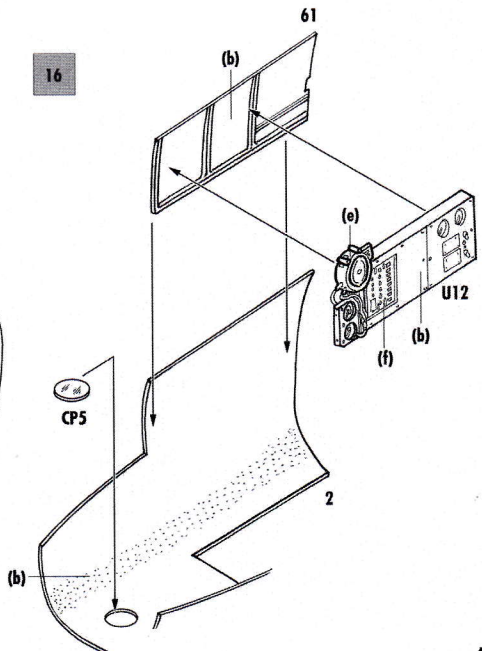
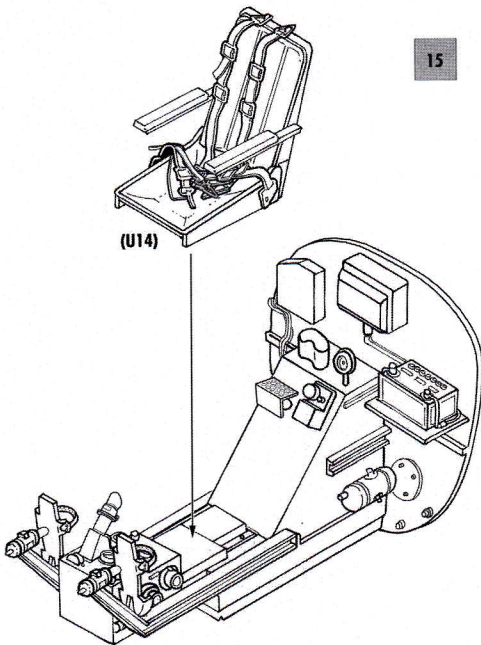
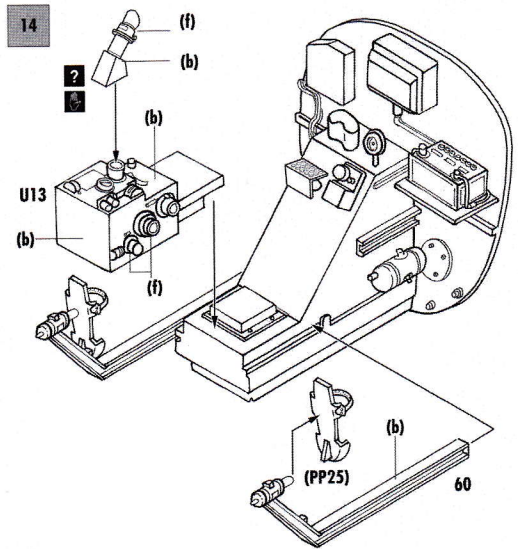
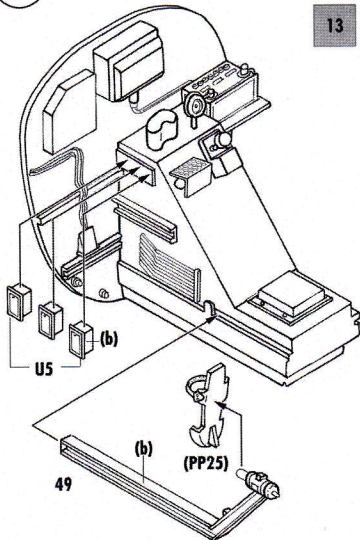



ARADO Ar 234 B-2N

1/32 scale

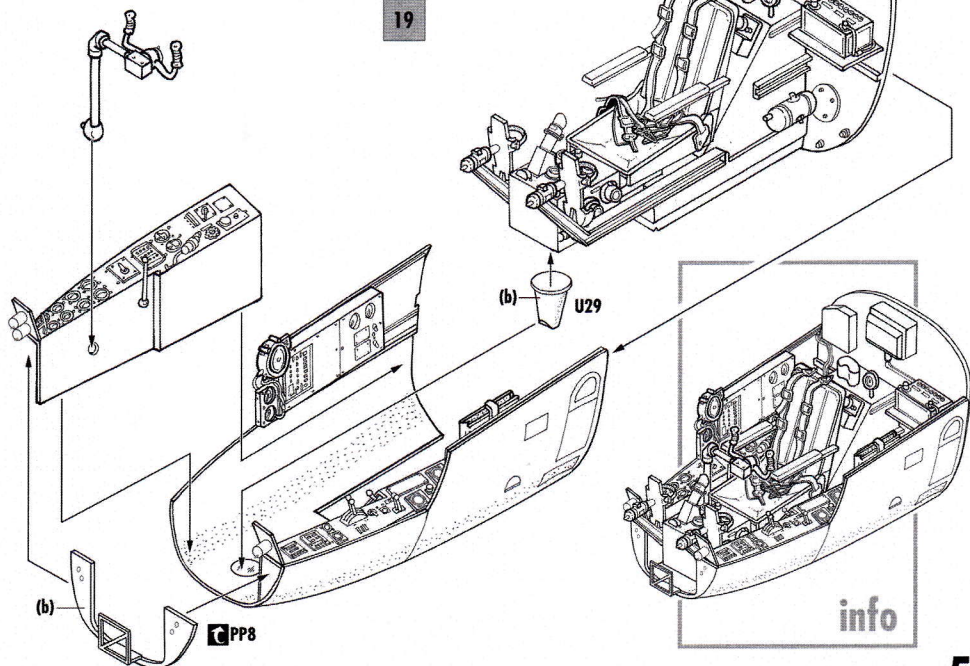
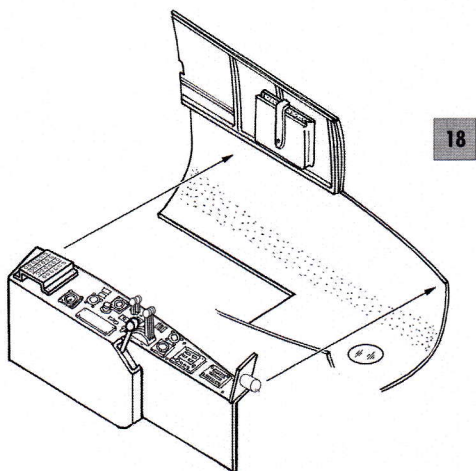
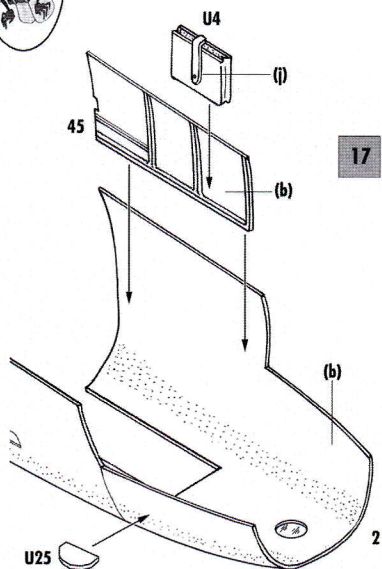



ARADO Ar 234 B-2N

1/32 scale

20

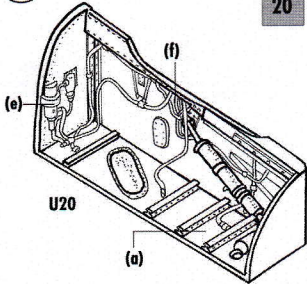

21

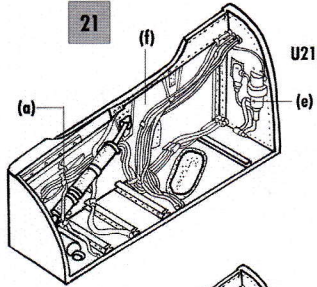

22

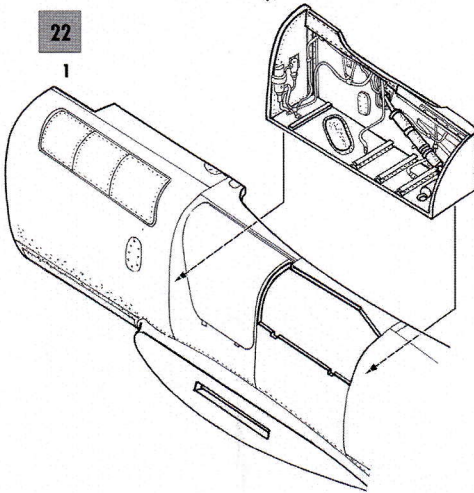

23

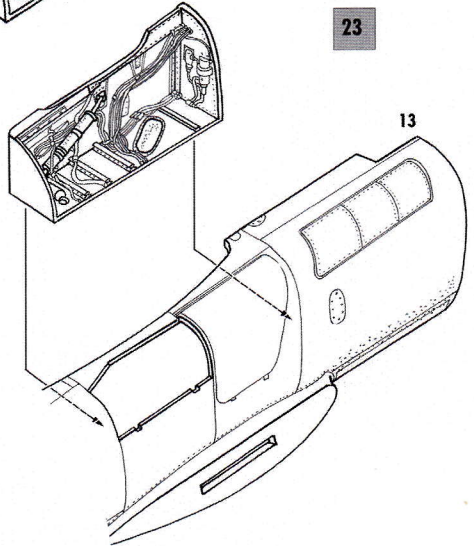

24

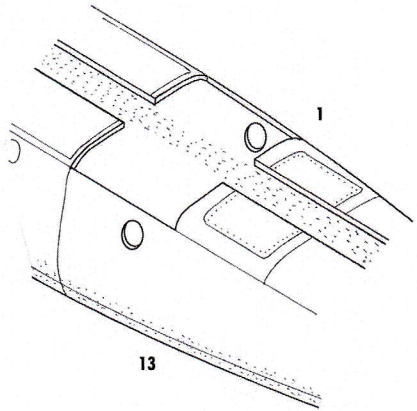
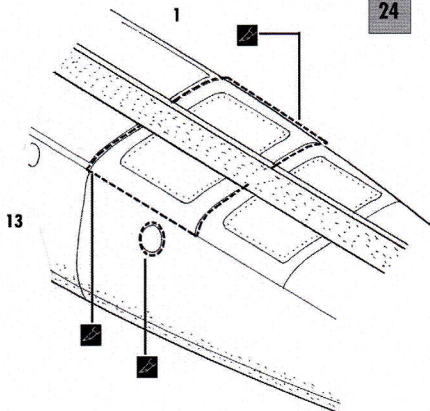



ARADO Ar 234 B-2N

1/32 scale

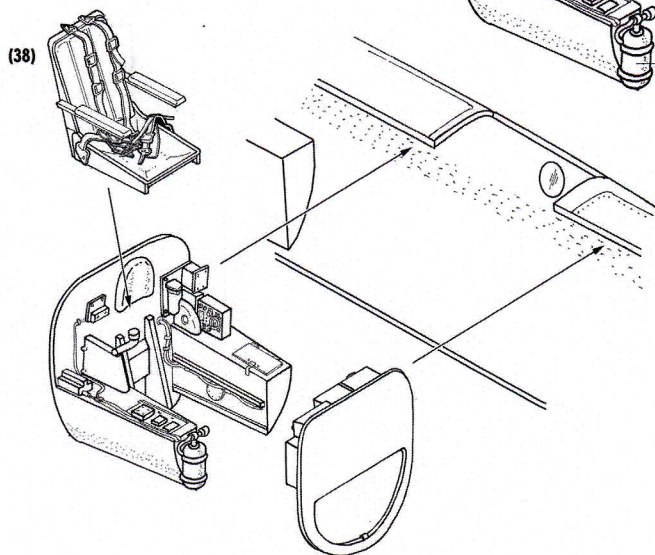
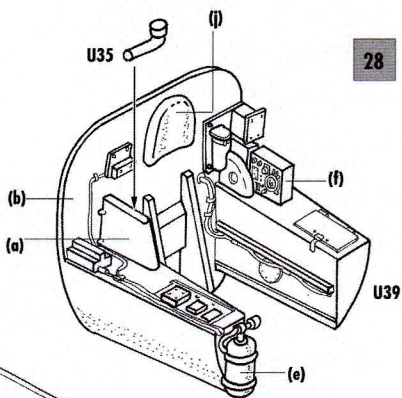
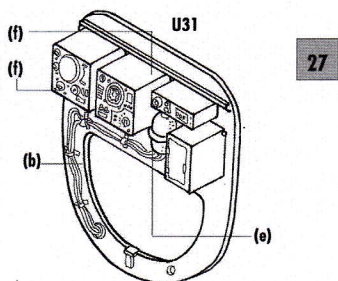
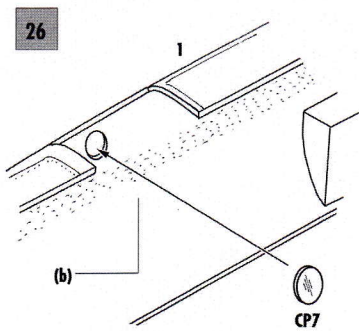
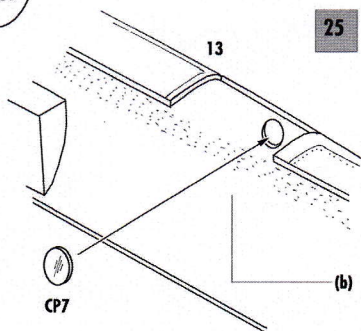



ARADO Ar 234 B-2N

1/32 scale

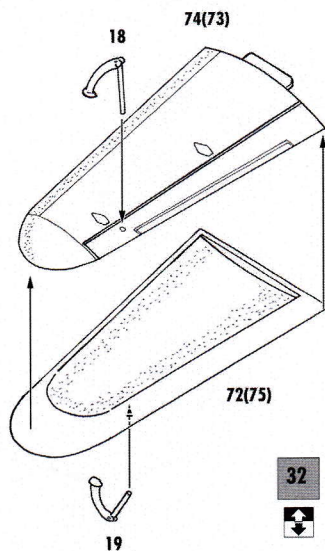
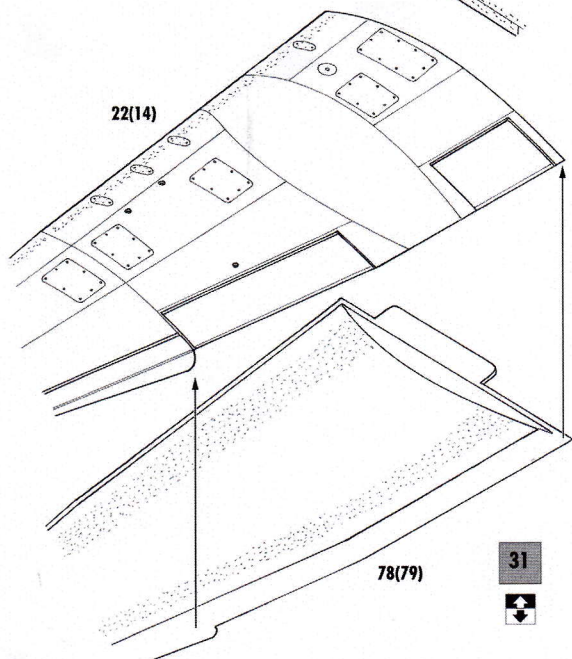
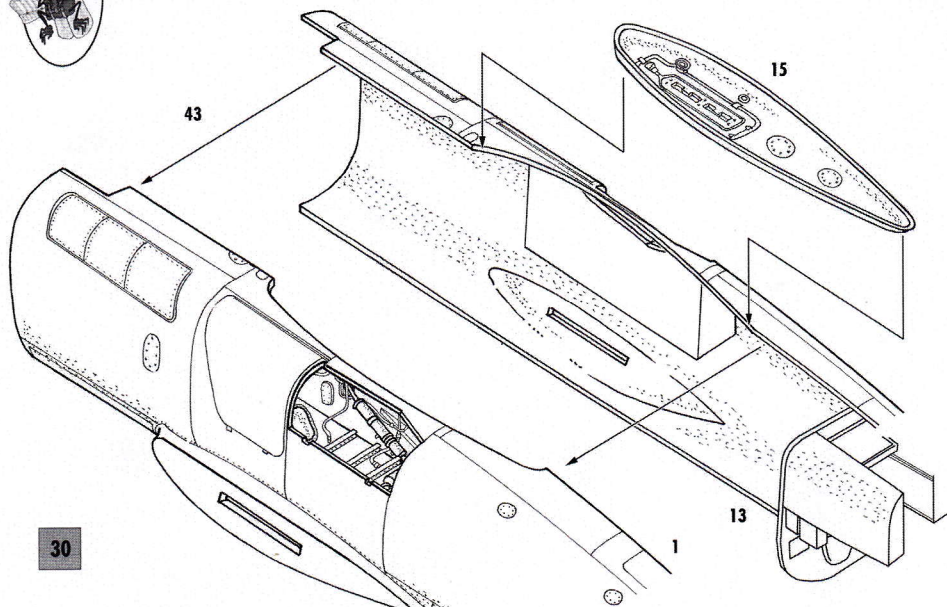



ARADO Ar 234 B-2N

1/32 scale

33

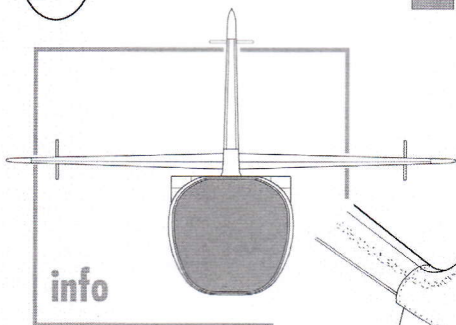

(72+75)

CP4

17

17

33

71

PP29

(74+73)

34

PP27

PP14

PP27

PP27

TWINE - A

U30

info



35

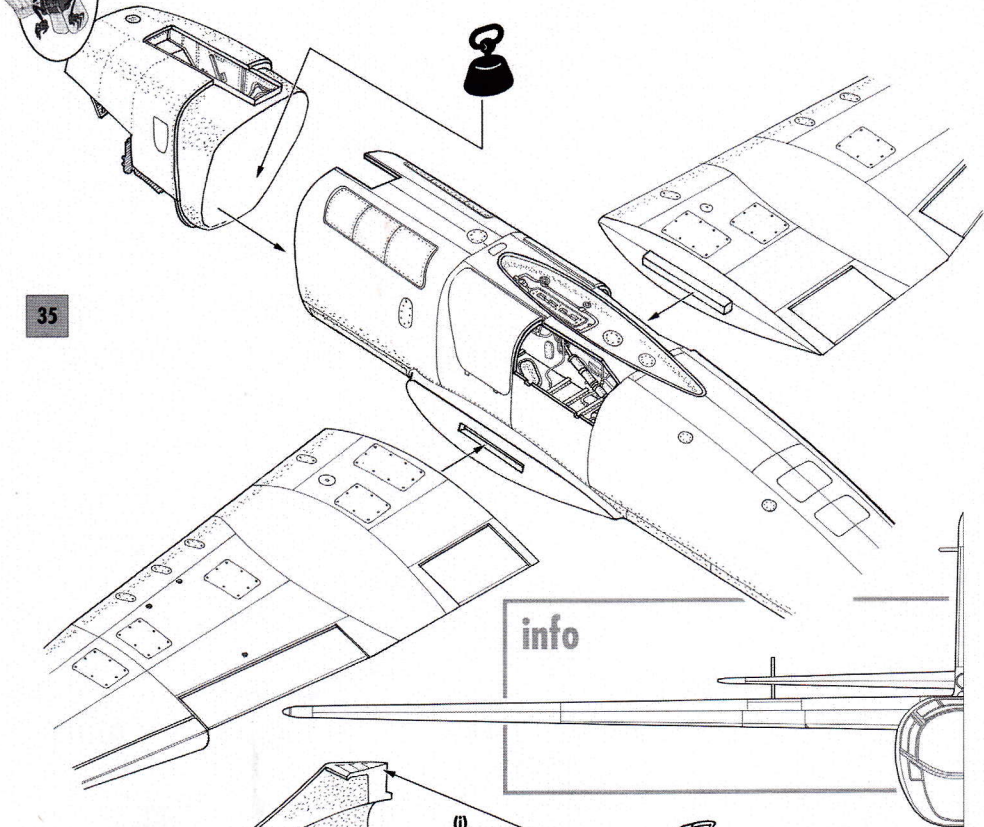

info

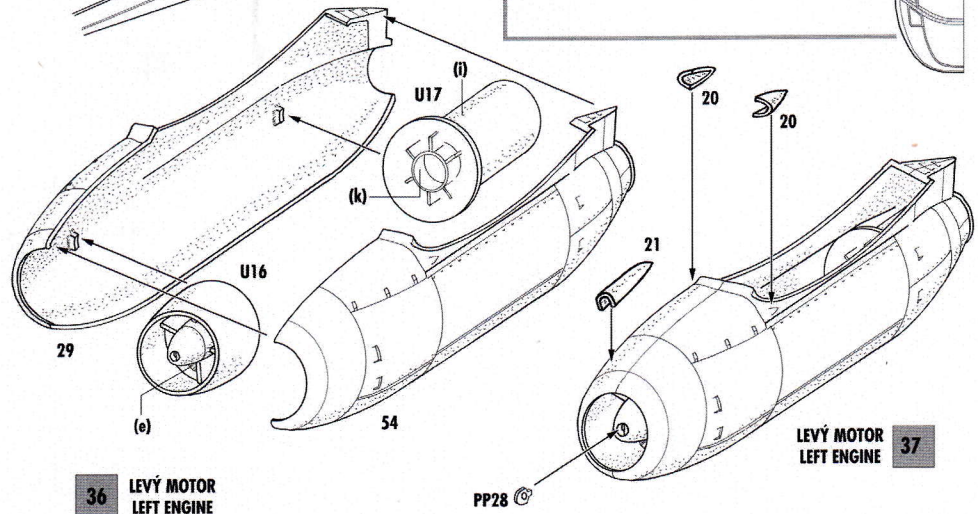

36 LEVÝ MOTOR
LEFT ENGINE

LEVÝ MOTOR
LEFT ENGINE 37

PP28 ©



ARADO Ar 234 B-2N

1/32 scale

38 PRAVÝ MOTOR
RIGHT ENGINE

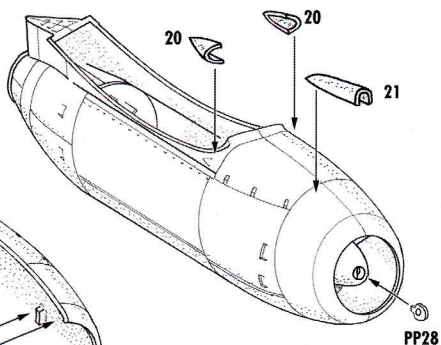
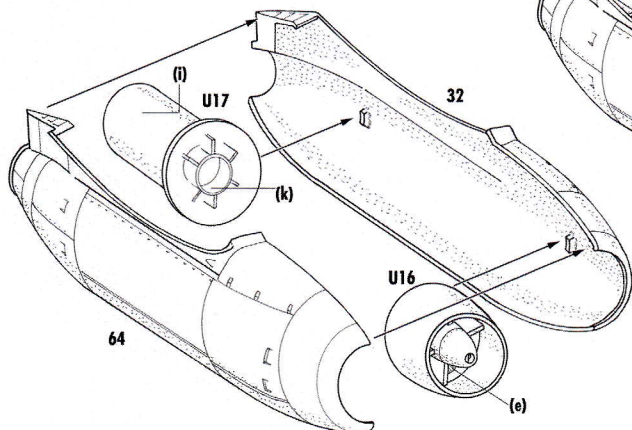

39 PRAVÝ MOTOR
RIGHT ENGINE

40

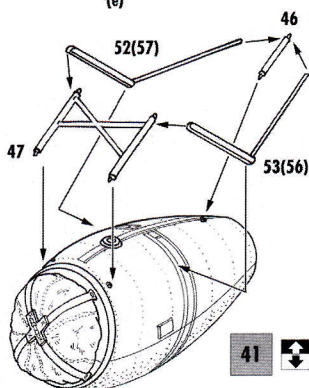
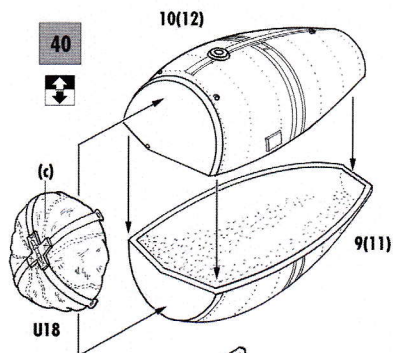

41

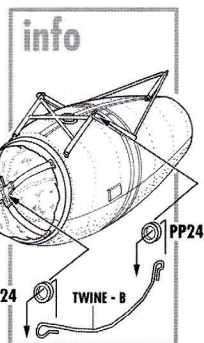

42

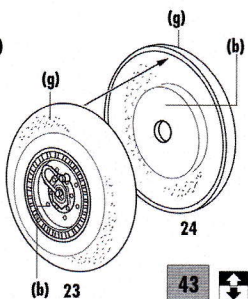
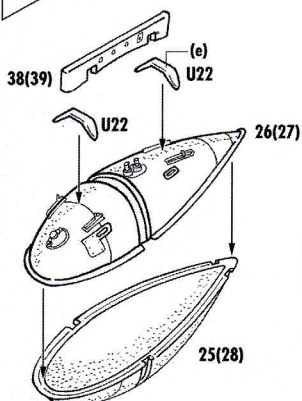

43

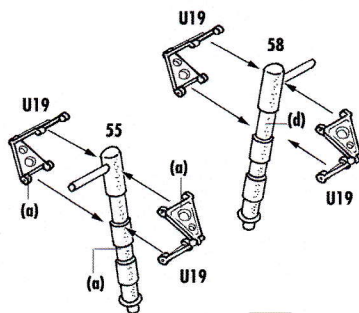

44



ARADO Ar 234 B-2N

1/32 scale

45

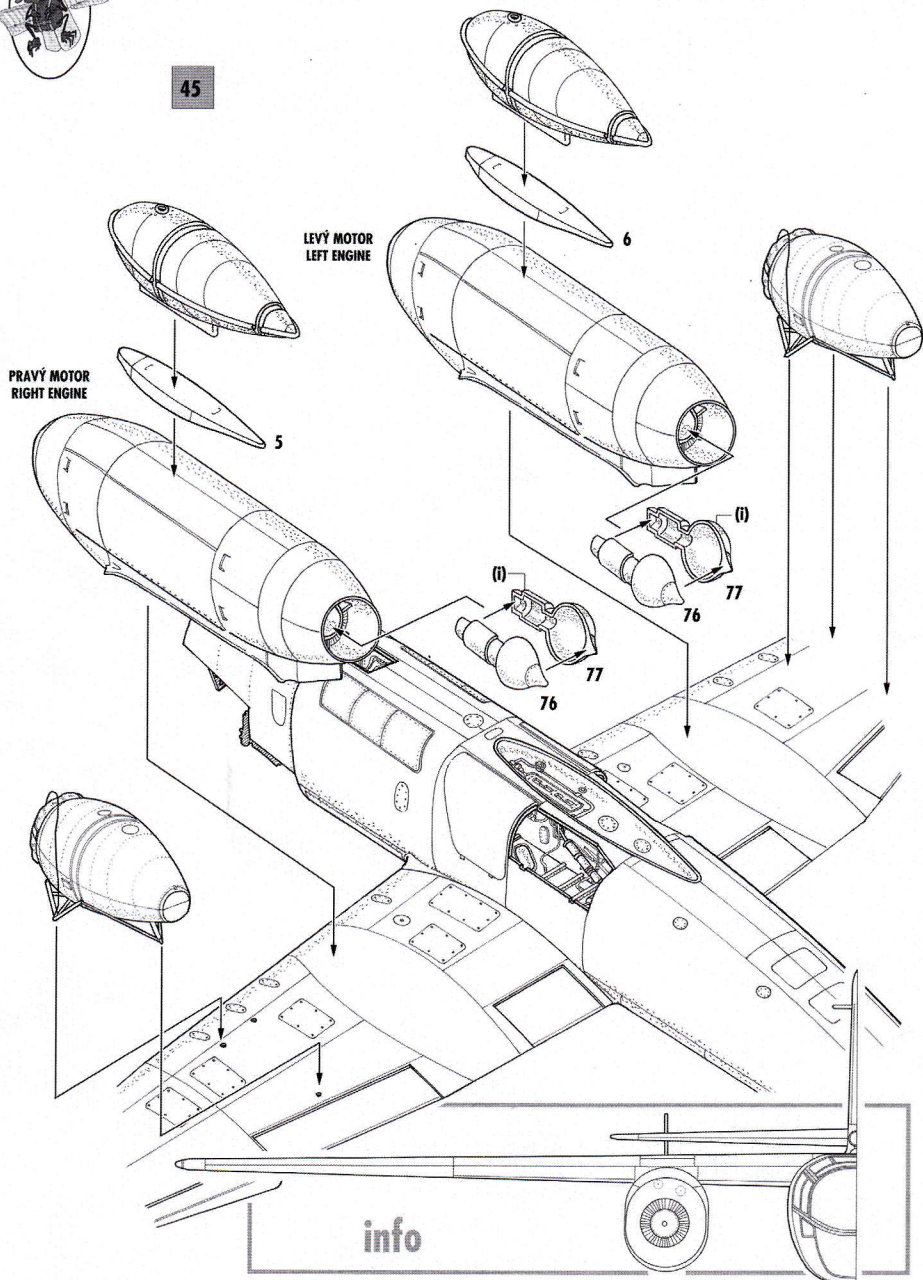



ARADO Ar 234 B-2N

1/32 scale

46

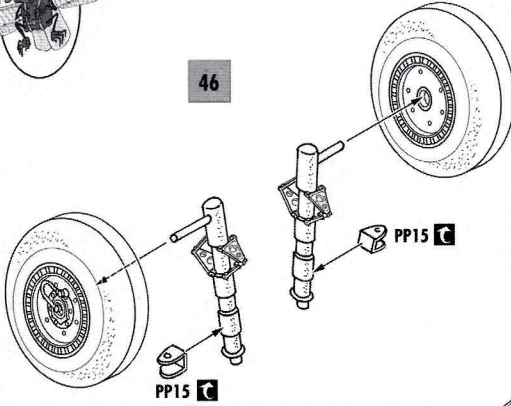

47

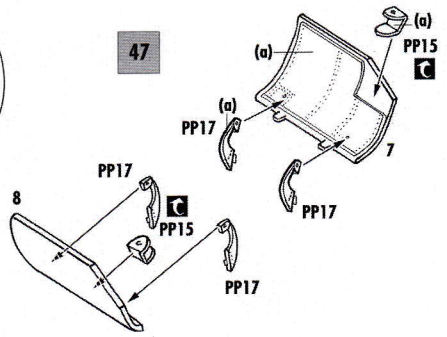

48

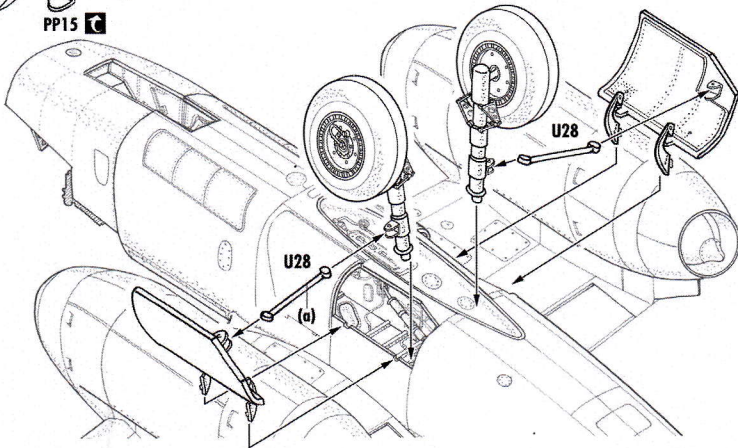

info

49

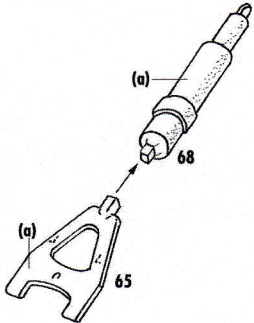

50

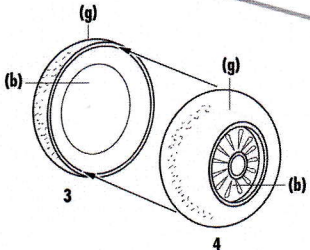



51

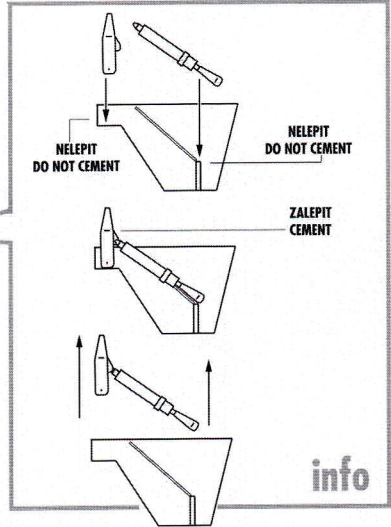
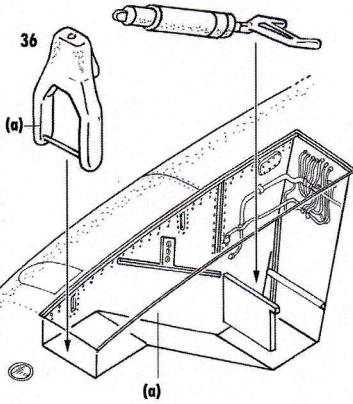

info

52

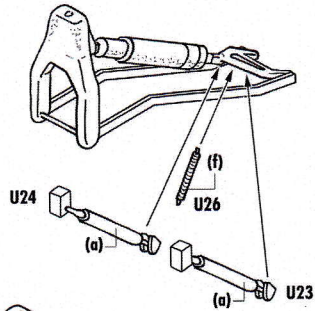
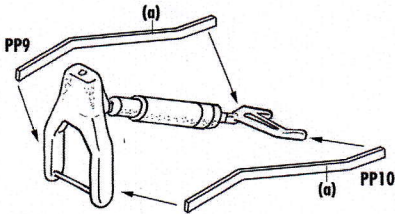

53

info

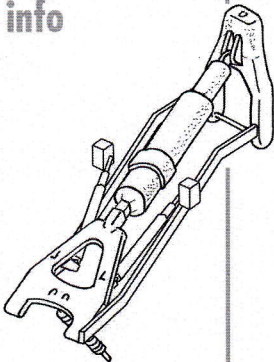

54

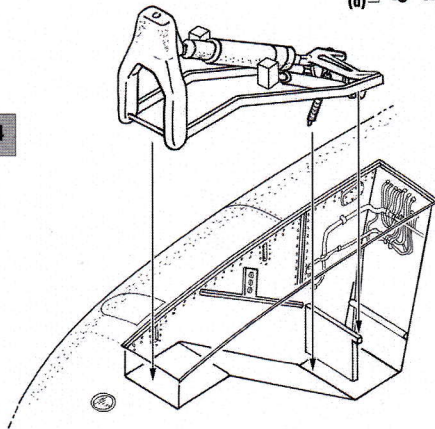



ARADO Ar 234 B-2N

1/32 scale

55

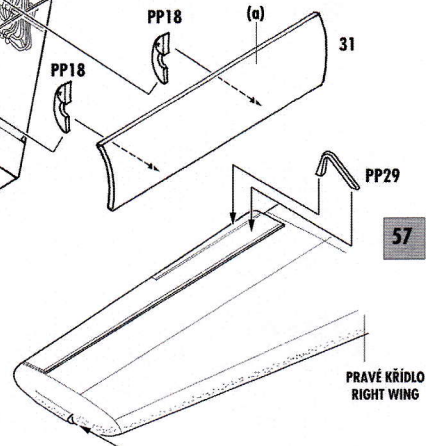
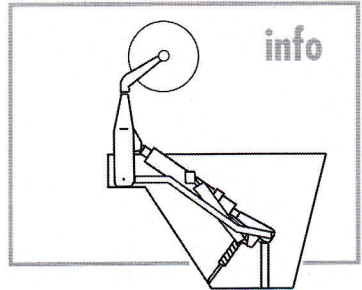
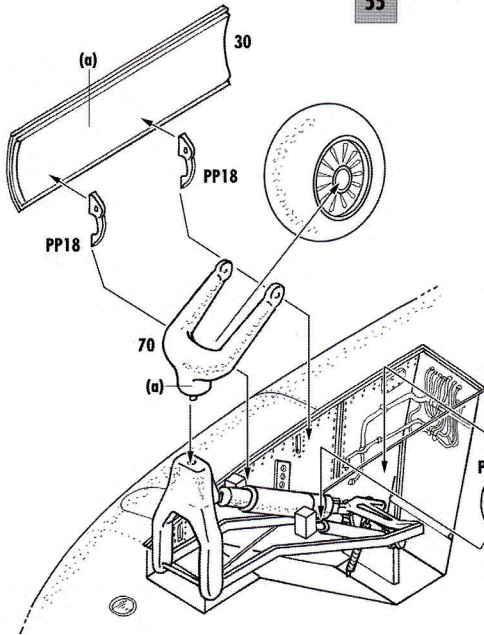

56

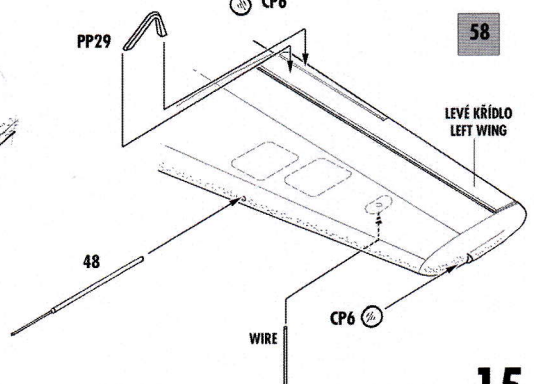
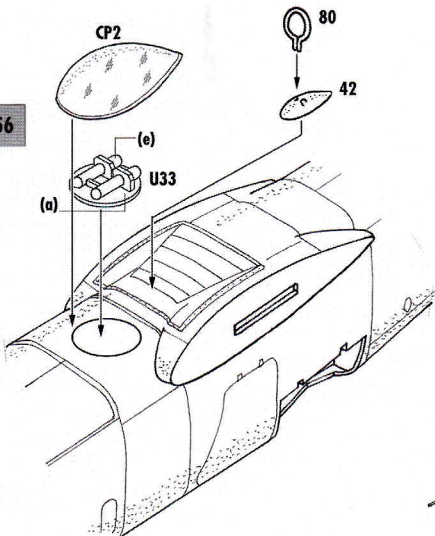

ARADO Ar 234 B-2N

1/32 scale



59

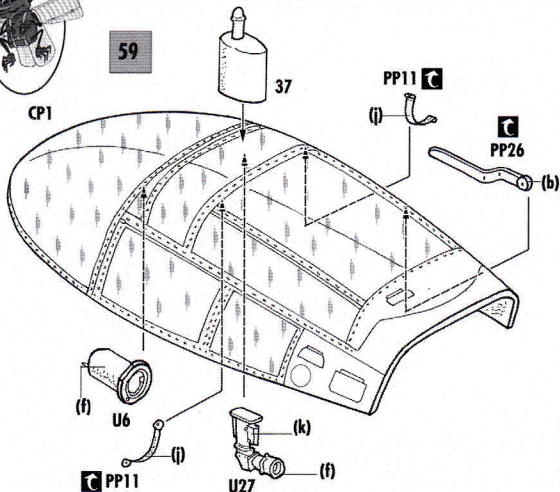

60

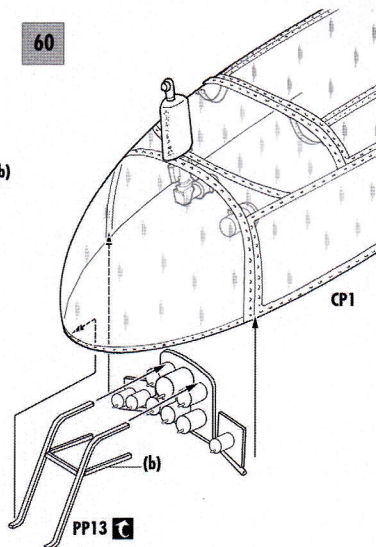

61

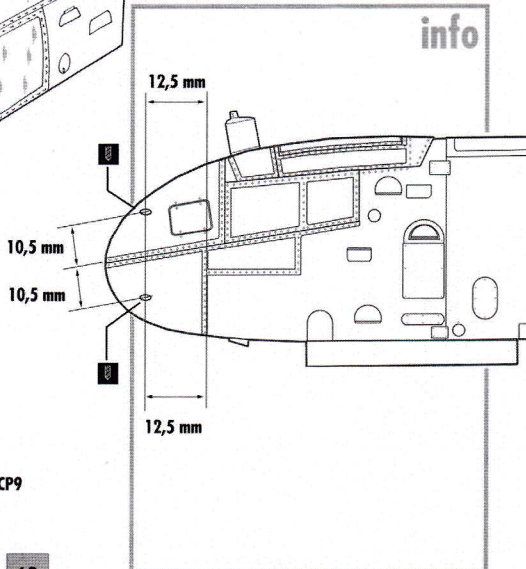
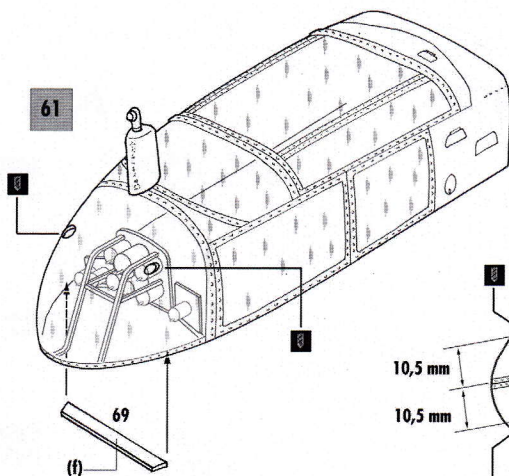

62

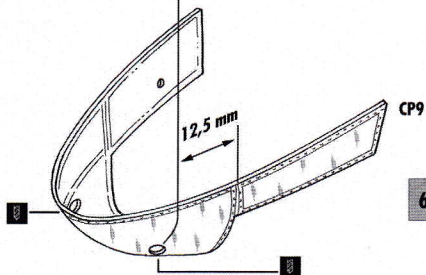

ARADO Ar 234 B-2N

1/32 scale

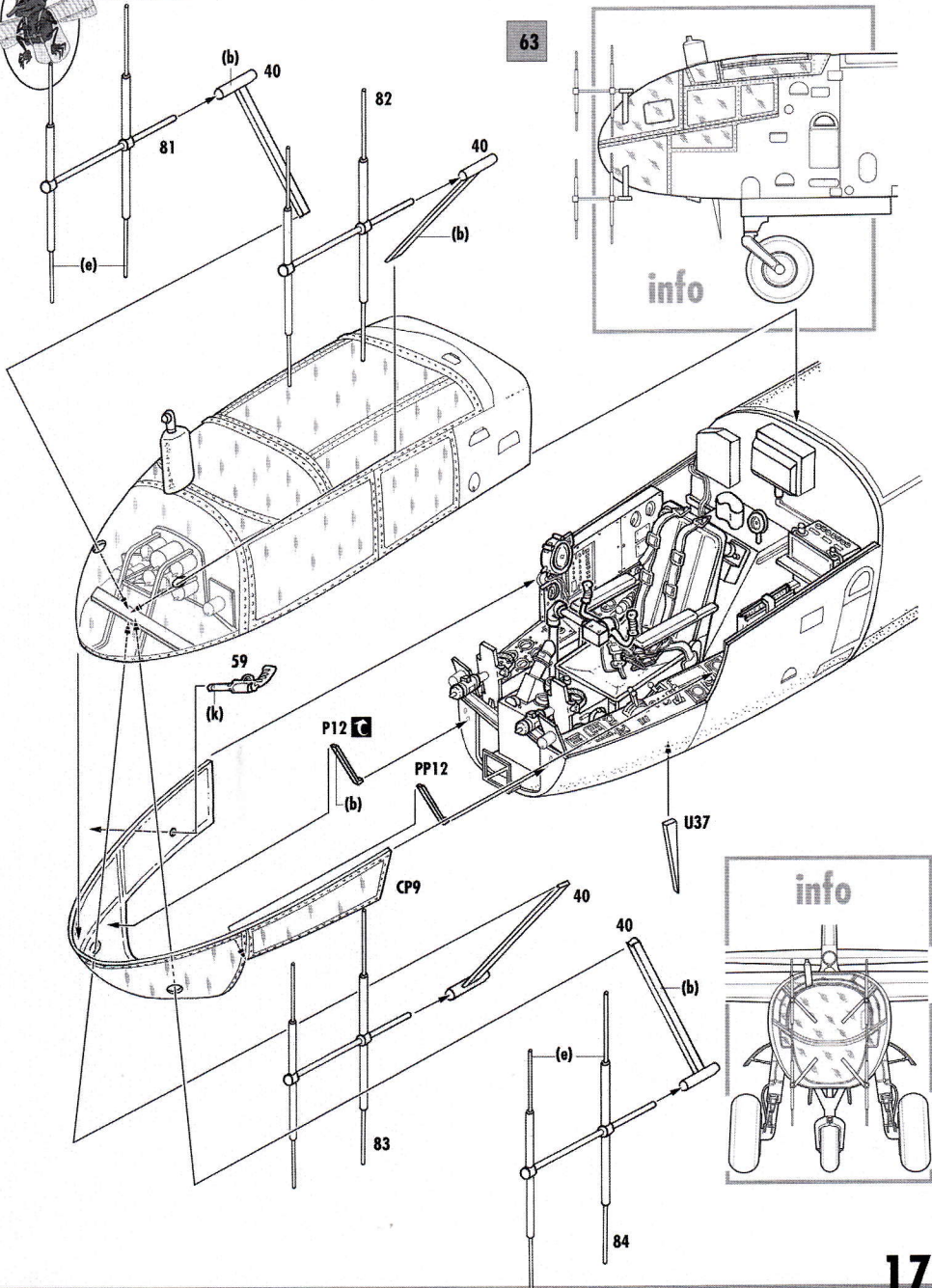



ARADO Ar 234 B-2N

1/32 scale

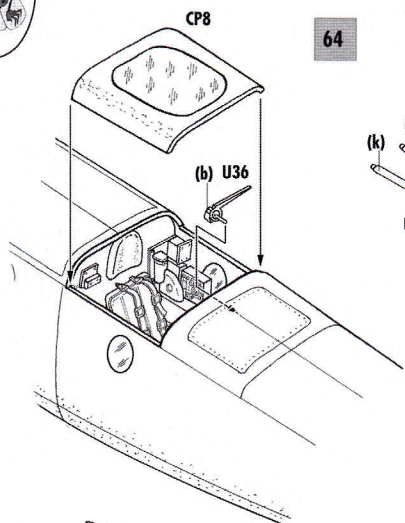

64

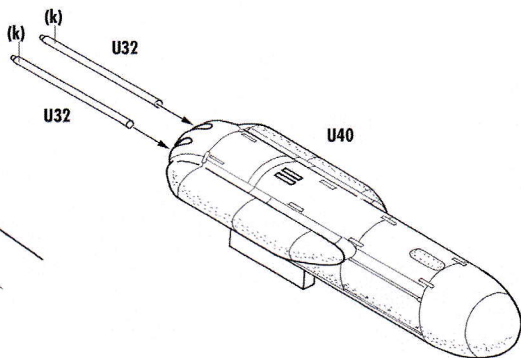

65

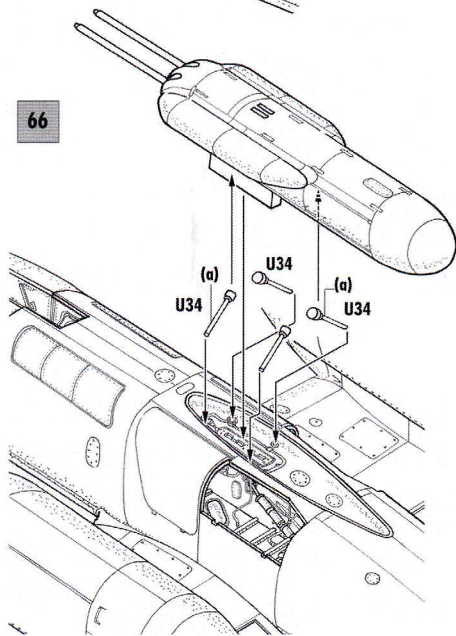

66









SAAB J-29F 1/32

COMING SOON



Arado Ar 234C 1/32

Humbrol	33	32	247	252	251	56
						
	735	2008	2009	2027	2026	3035

Arado Ar 234B-2N/2b

Fly

1 Arado Ar-234 B-2N, Wr. 140 146, Leutnant Kurt Bonow, „Erprobungskommando“ Bonow Oranienburg, March 1945. A/C was equipped with FUG 218 - Neptun Radar for night fighting and weapon container with two 20 mm MG 151. Camouflage colors RLM 75/76/22

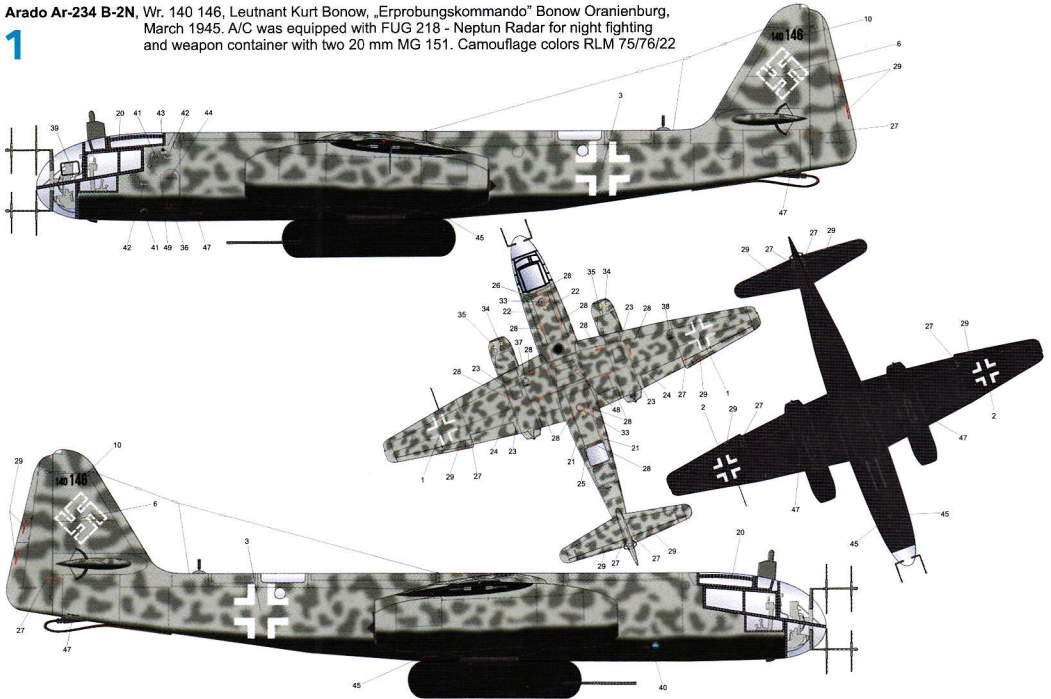

2 Arado Ar-234 B-2b, Wr. 140 344, Oblt. Erich K. Sommer, Udine airfield, Italy, April 1945. Weapon container with two 20 mm MG 151. Camouflage colors RLM 81/82/76

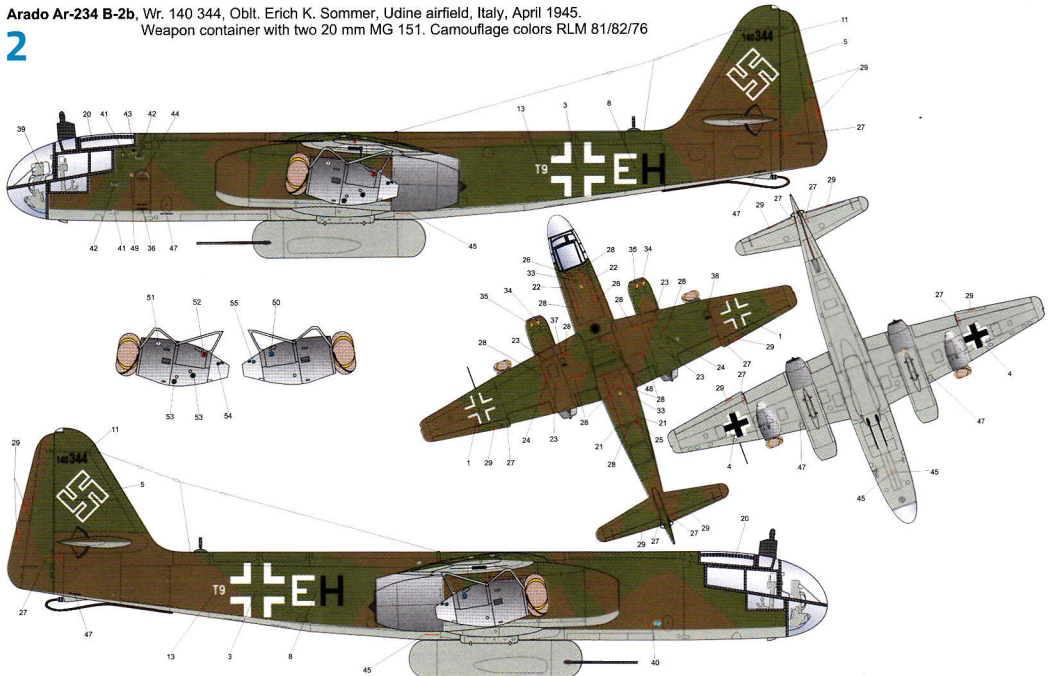

	252	251	247	34
	2027	2026	2009	751

Arado Ar 234B-2

PH

3 Arado Ar 234B-2, WR 140 149, of 1.(F)/123, flown by Hptm. Hans Felde. Originally in RLM 81/82176, with green areas temporarily repainted with white washable paint. Aircraft shot down 11 February 1945.

