

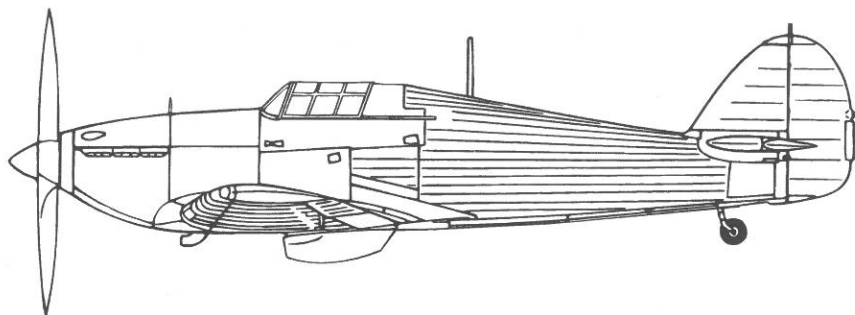

Classic Airframes



Hawker Hurricane Mk. I

First flown in November 1935, the Hawker Hurricane requires no introduction. Together with the Supermarine Spitfire, the two aircraft spearheaded the British aircraft industry into the forefront of "Modern Fighter" development. This kit presents for the first time in 1/48th scale the earliest operational version of this aircraft, distinctive because of its fabric covered wings.

As well as serving with the RAF, the aircraft immediately caught the eye of foreign governments looking for modern fighters and it was exported to Belgium, Finland, Yugoslavia, Turkey, Rumania, South Africa. It was also ordered by Poland, but they never arrived.

The Hurricane's original fabric wings were gradually replaced by metal although some aircraft used their original wings well into the Battle of Britain.

Classic Airframes is pleased to offer this variant of this distinguished aircraft. We would like to thank Steven Eisenman and Jim Maas for their cooperation in this project.

Hurricane Mk. I Specifications

Powerplant:	1,030hp Rolls-Royce Merlin II/III inline	Armament:	8x .303 Machine Guns
Wing Span:	40'		
Length:	31'4"		
Maximum Speed:	317 mph		

This model kit is intended for experienced modelers. The nature of limited-run kits such as this require additional time and effort to clean up and fit the parts, as well as experience with the various media utilized to provide the most accurate effect on the finished model. Use CyA ('super') glue to assemble Resin (PU) parts.

1

Instrument panel is Satin Black
with Black gauges and Silver details

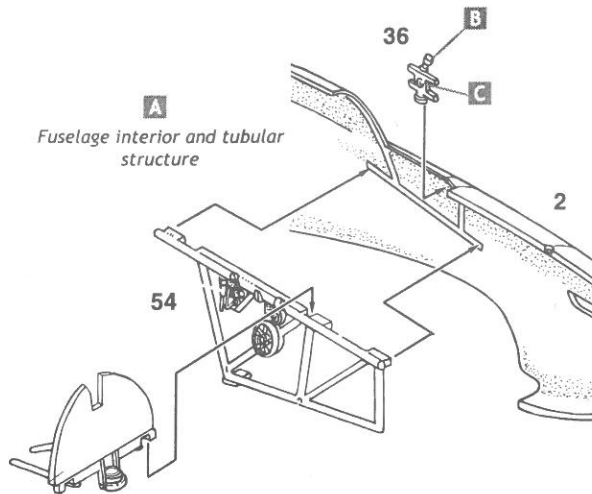
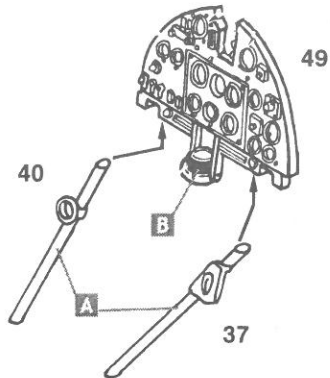

2

All cockpit parts

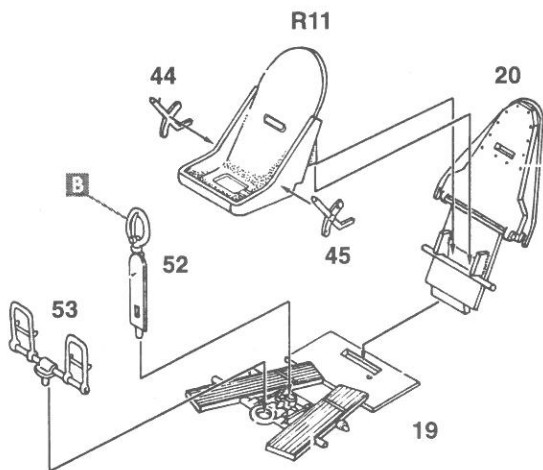

3

Fuselage interior and tubular structure

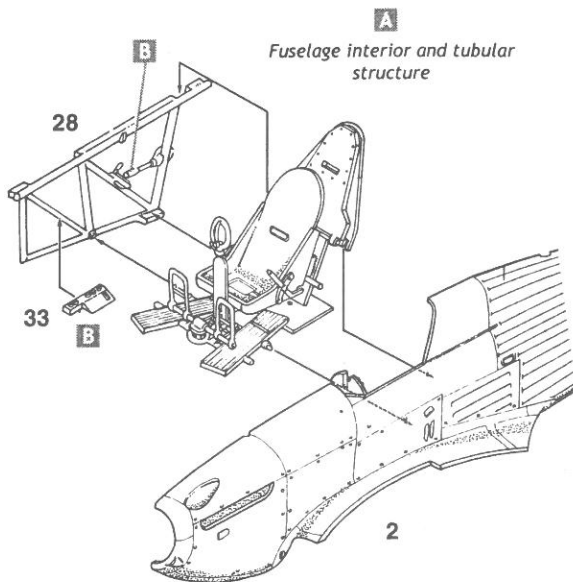

4

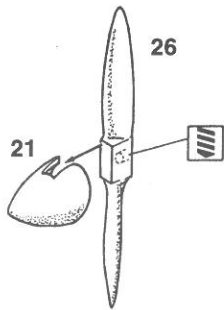

**Watts Z-38
Propeller**

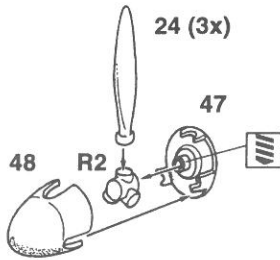

**DeHavilland 5/31
Propeller**

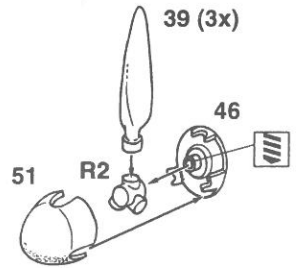

**Rotol RMS-7
Propeller**

Consult your references for propeller blade and spinner colors. Propeller may be installed after all other assembly steps are complete.

5

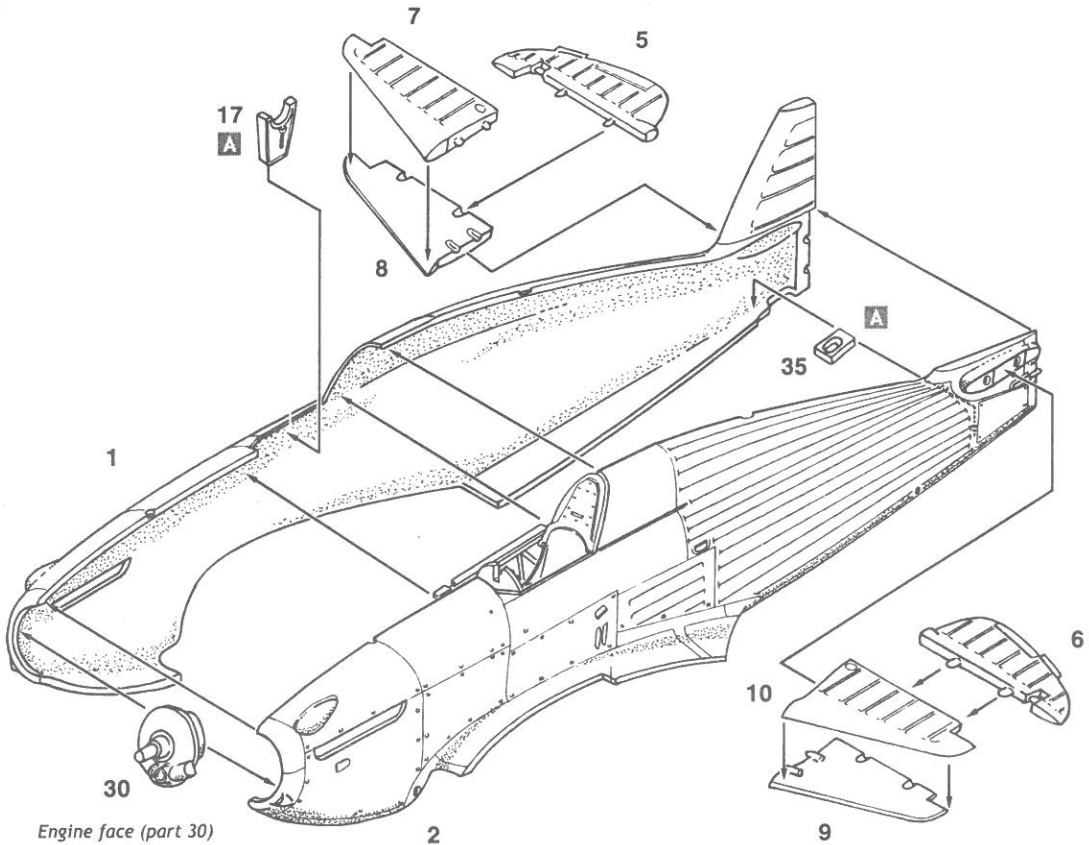

Engine face (part 30)
is Dark Grey

8

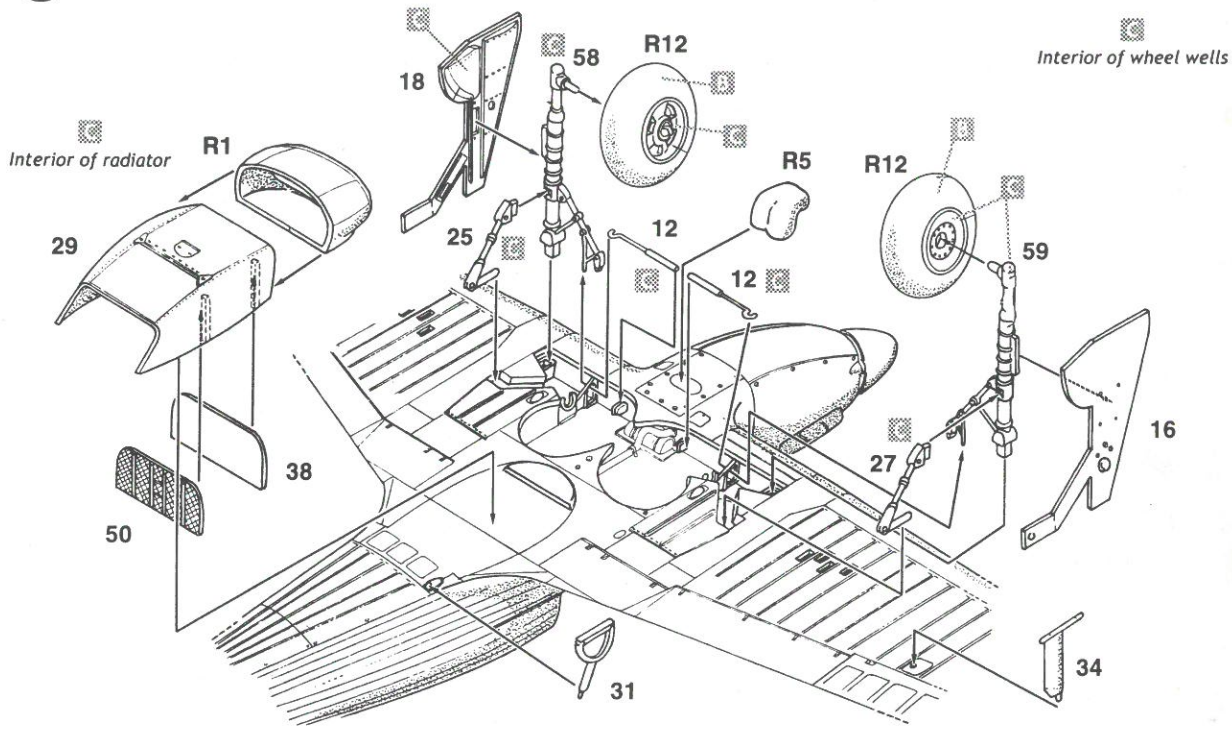

9



Early production machines lacked the ventral strake (part 41) and had a shorter rudder (part 15). Check references for the aircraft you are modeling.

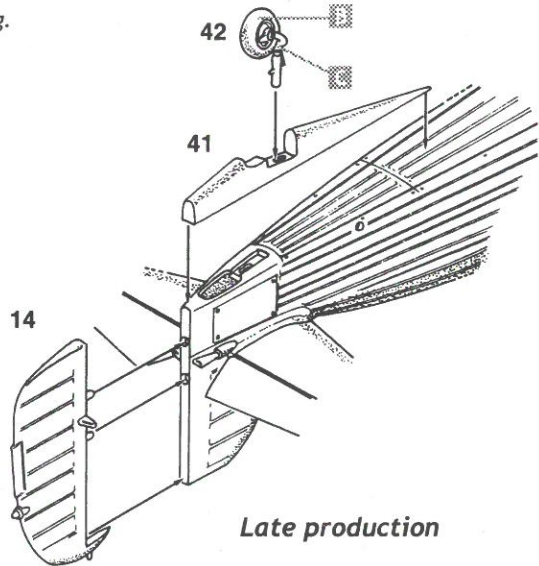
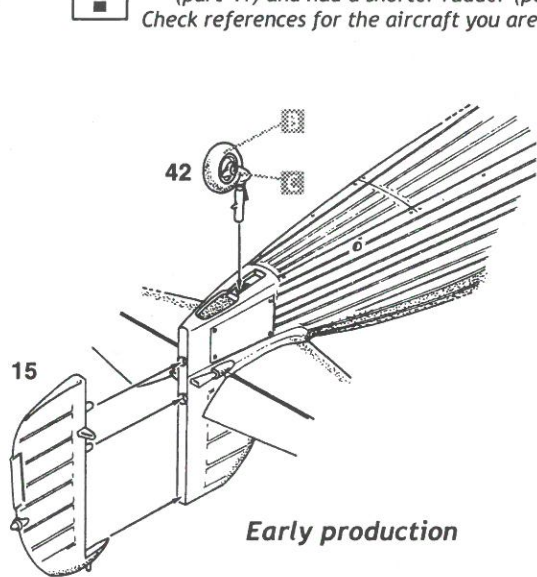

Assembly Instruction Symbols



Paint Reference Guide

A Interior Green FS 34558
B Flat Black-grey _____

C Aluminum _____
D Rusty Brown _____

E Dark Brown _____
F Gunmetal _____

Parts

PLASTIC PARTS

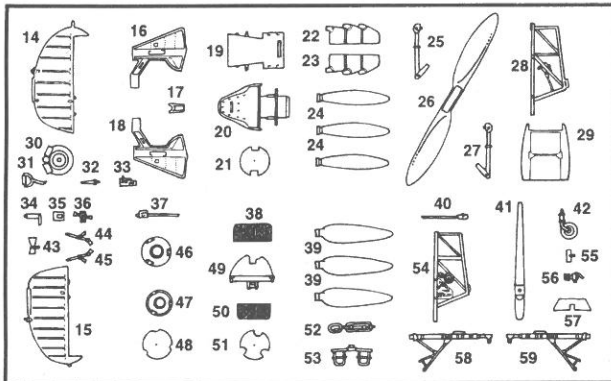
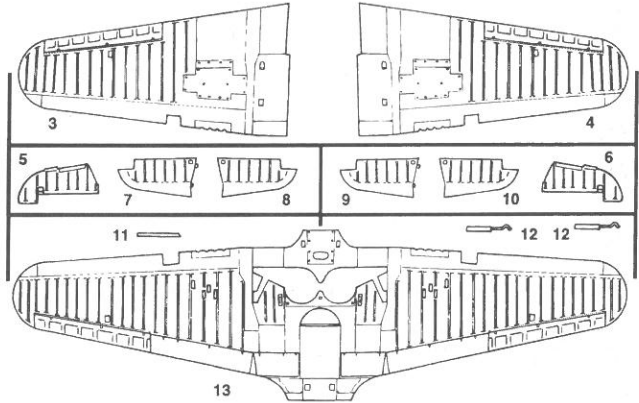
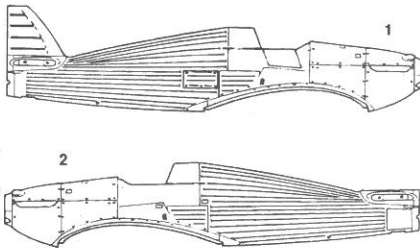

PLEASE NOTE

Parts are included in this kit to build one of three variants of the Hurricane Mk.I. Variations include propeller, exhausts, ventral strake, canopy and venturi. Check your references for the aircraft you are modeling to create an accurate model.

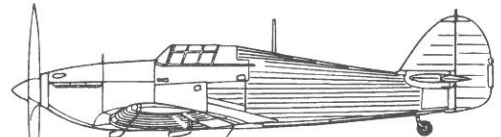

Watts Z-38 Two-Blade Propeller, Merlin II

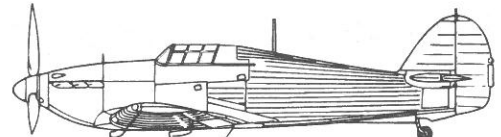

Rotol RMS-7 Three-Blade Propeller, Merlin III

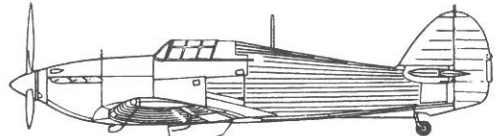

DeHavilland 5/31 Three-Blade Propeller, Merlin III

CLEAR PARTS

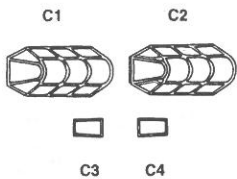

RESIN PARTS

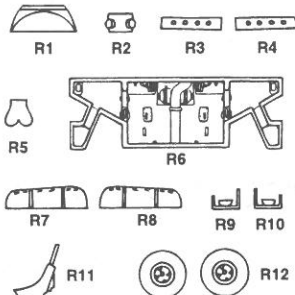

Hawker Hurricane Mk.I *PAINTING & MARKING GUIDE*

No. 151 Squadron, August 1939

Two-bladed Watts Propeller

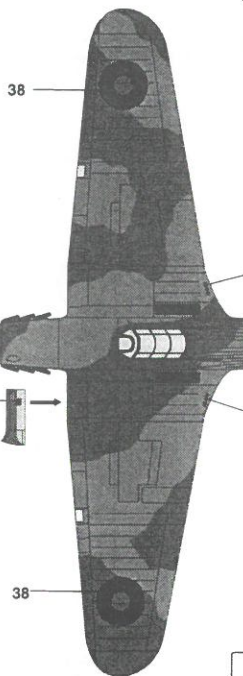
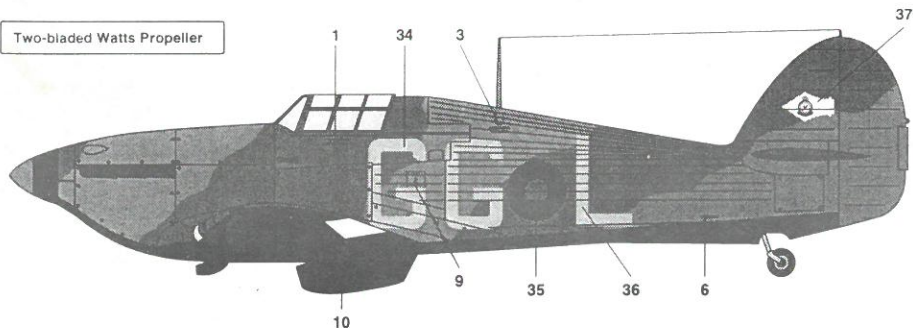

NOTE
Decals 40 are provided to represent the doped linen patches covering the gun ports on wing leading edges

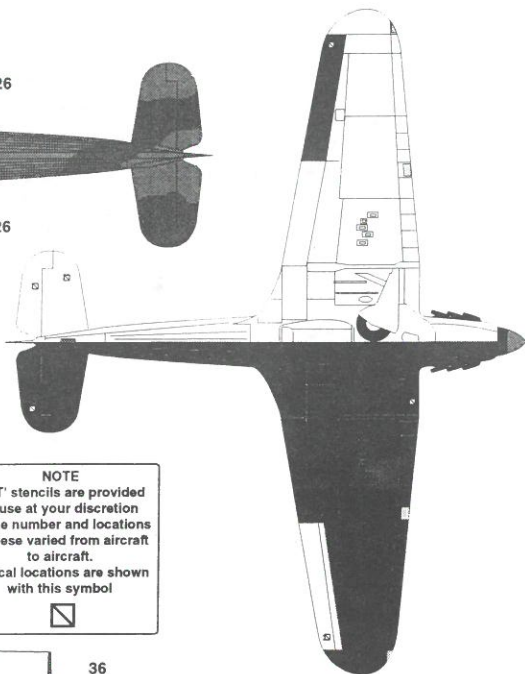

NOTE
"WT" stencils are provided to use at your discretion as the number and locations of these varied from aircraft to aircraft. Typical locations are shown with this symbol 

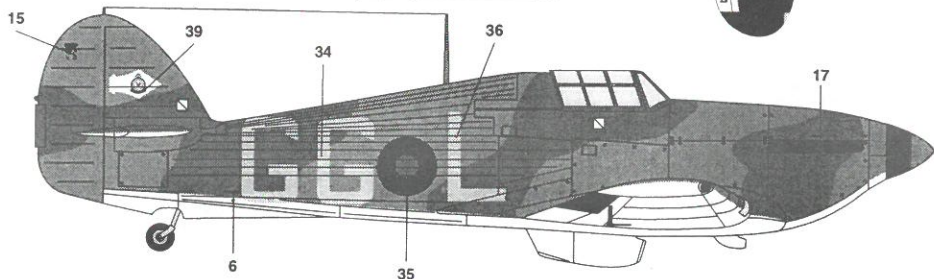

Hawker Hurricane Mk.I PAINTING & MARKING GUIDE

Squadron Leader John Gillan, 111 Squadron, circa 1938

Two-bladed Watts Propeller

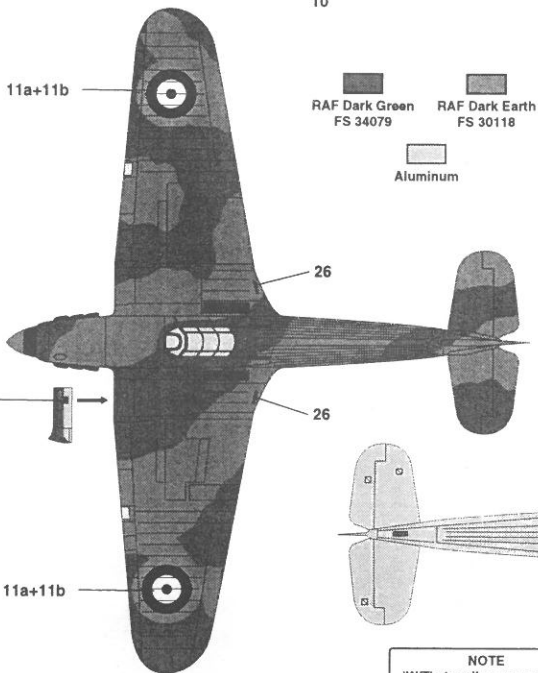
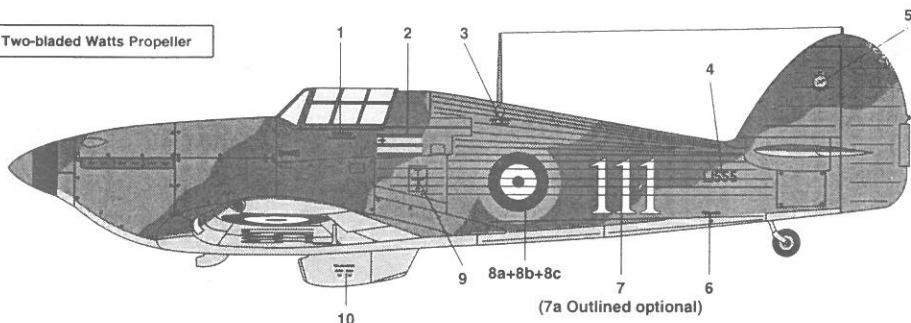

L1555 was the aircraft used by Sqn. Ldr. Gillan on his record-setting flight from Edinburgh to Northolt on February 10, 1938, with an average ground speed of 408.75 mph. At the time, the aircraft did not carry the '111' (Decal 777a) on the fuselage sides.

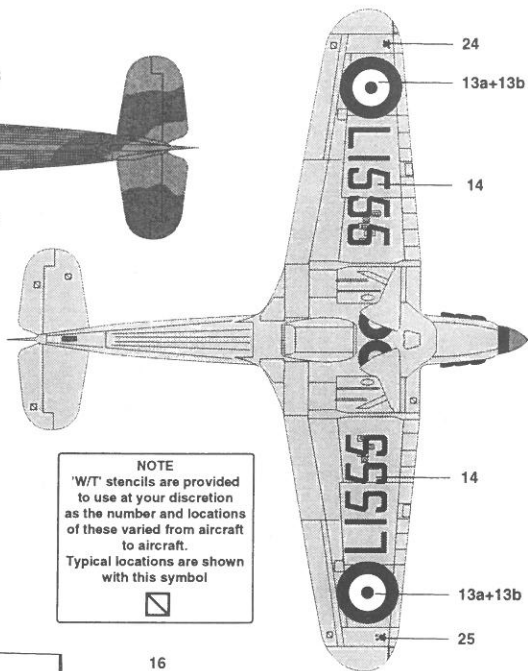

NOTE
Decals 40 are provided to represent the doped linen patches covering the gun ports on wing leading edges

NOTE
'W/T' stencils are provided to use at your discretion as the number and locations of these varied from aircraft to aircraft. Typical locations are shown with this symbol

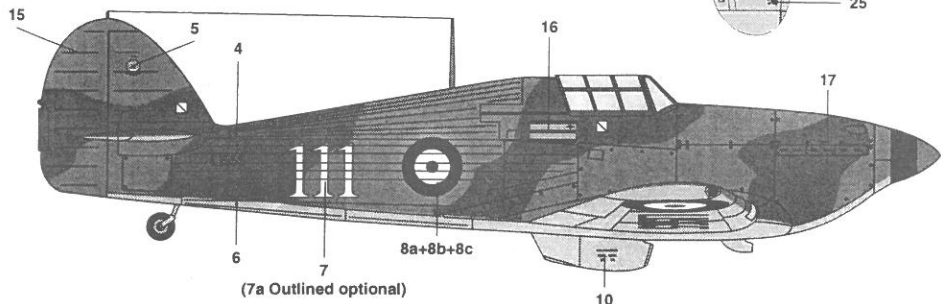

(7a Outlined optional)

10



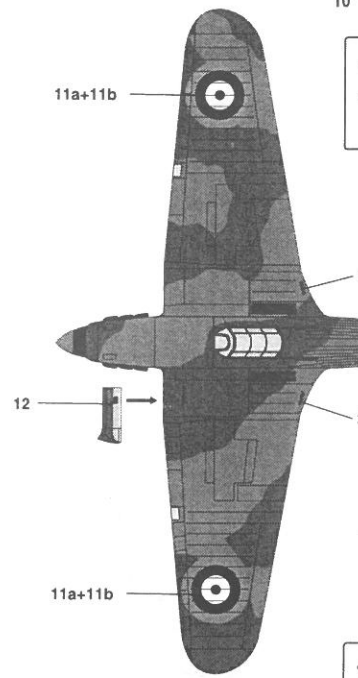
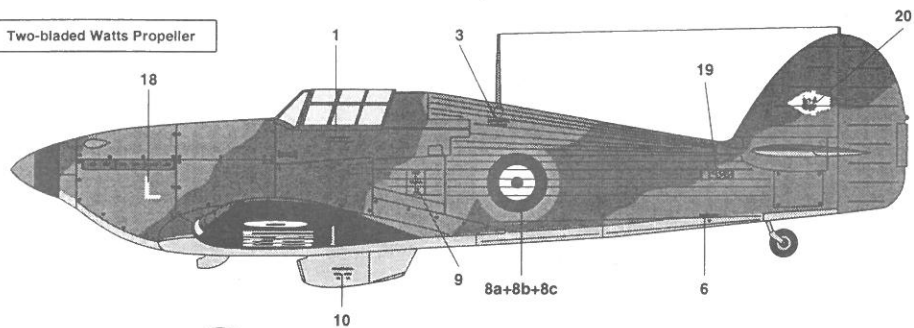

Hawker Hurricane Mk.I *PAINING & MARKING GUIDE*

No. 56 Squadron, 1939

Two-bladed Watts Propeller

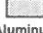

NOTE
Decals 40 are provided to represent the doped linen patches covering the gun ports on wing leading edges

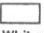
 RAF Dark Green FS 34079	 RAF Dark Earth FS 30118	 Aluminum
 Black	 White	

NOTE
'W/T' stencils are provided to use at your discretion as the number and locations of these varied from aircraft to aircraft. Typical locations are shown with this symbol 

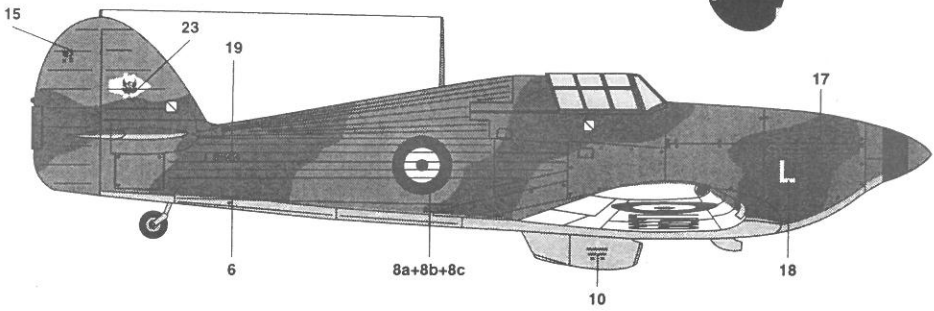
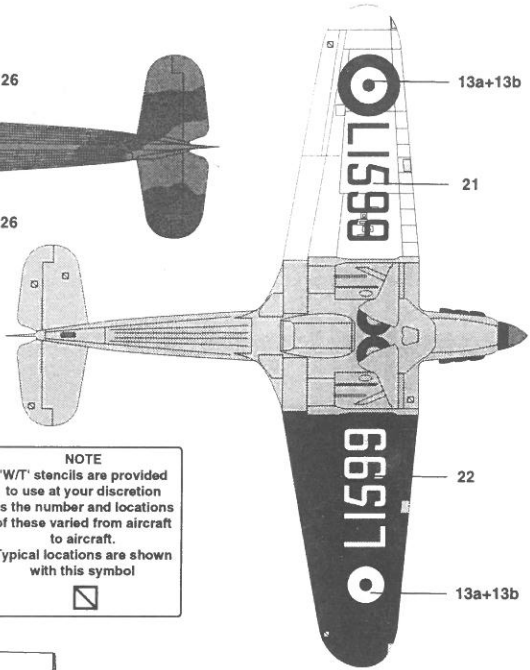

Hawker Hurricane Mk.I *PAINING & MARKING GUIDE*

Pilot Officer P.W.O. Mould, No.1 Squadron, France, 1939

Two-bladed Watts Propeller

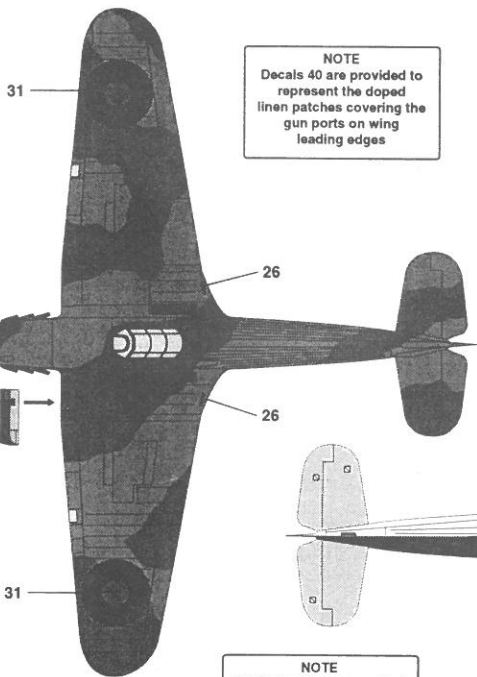
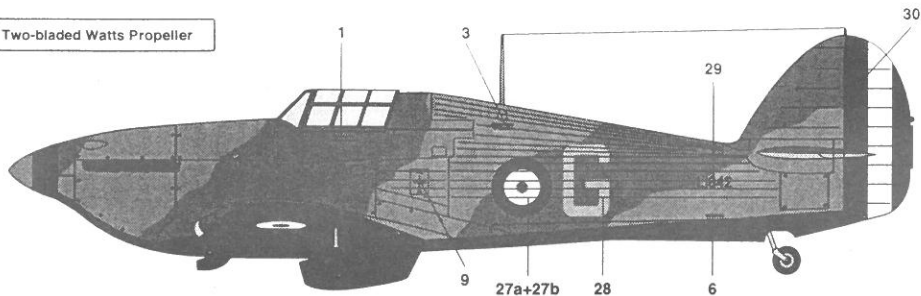

NOTE
Decals 40 are provided to represent the doped linen patches covering the gun ports on wing leading edges

-  RAF Dark Green FS 34079
-  RAF Dark Earth FS 30118
-  Aluminum
-  Black
-  White

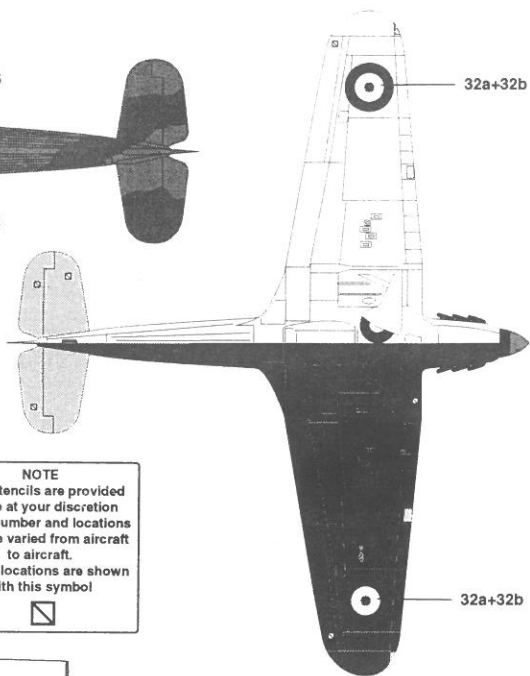

NOTE
"W/T" stencils are provided to use at your discretion as the number and locations of these varied from aircraft to aircraft. Typical locations are shown with this symbol 

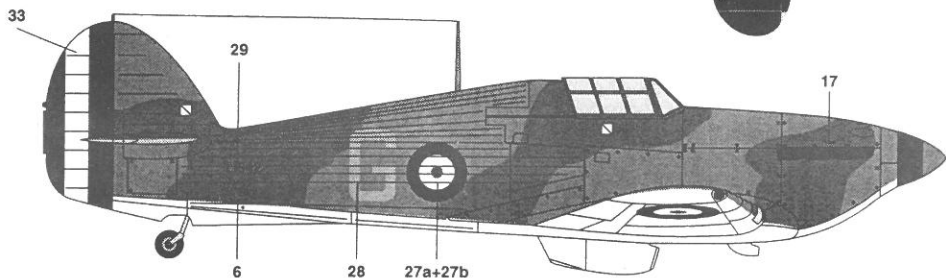

LI555

LI555

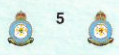

14

14

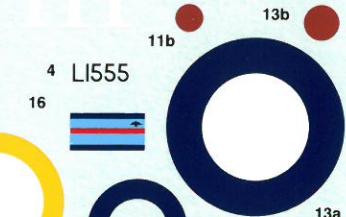
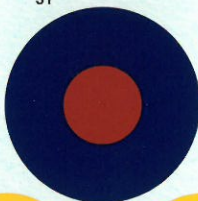
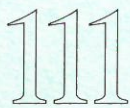
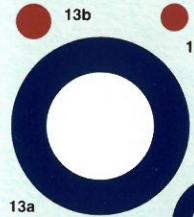
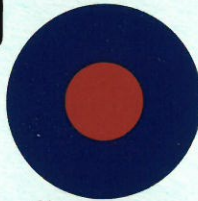
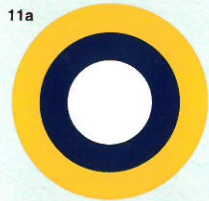

LI599

19



LI599

LI599

21



22

23



18

LI599

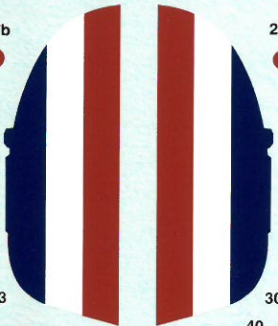

G

LI842

29

37

35

36

33

30

39

35

34

34

34

34

34

34

LI842

G

G

G

G

G

G

G

G

G

G

G

G

G

G



NO STEP
26
NO STEP

10

12

25

15

3

6

9

1

24



38

38

Classic Airframes
Kit#460
custom printed by
MICROSCALE

