

# SUPER WING OPTIONS



ZOUKEI-MURA INC. PRESENTS SUPER WING SERIES<sup>®</sup> No.02  
**1/32 FOCKE-WULF Ta152H-1**

## Photo-Etched Exterior Set

### ◆◆Important Points for Assembly◆◆

- For use of this part, please refer to the Instruction Manual of the 1/32 "Ta 152 H-1" and prepare the required tools.
  - Please use nippers for etching parts when cutting off the etching parts. Tweezers may also be very useful when handling the parts you cut and attaching them to the kit. Also, to reproduce small details, please prepare a metal wire (e.g. brass wire) of 0.5mm diameter.
  - To affix the parts of the kit, please use instant glue. Please do not use glue dedicated to plastic models. Before painting, make a primer coat using the Metal Primer. (Without primer coat, paint may peel.)
  - The recommended brand for painting your kit is the latest line of acrylic paint from Vallejo Color. Please refer to the Zoukei-mura 1/32 "Ta 152 H-1" Instruction Manual and Luftwaffe historical manuals to paint the model with the coloring of your choice.
- ※Please carefully use the tools and solvents for assembly and painting by referring to their instruction manuals.

We take the utmost of care when overseeing manufacturing, but if your kit is among the very small percentage that contains a defective part, please contact customer service within two weeks of your purchase with your full name and order number.

Purchasers from VOLKS Japan International Web Site: Please contact [imos@volks.co.jp](mailto:imos@volks.co.jp)  
 Purchasers from VOLKS USA: Please contact [service@volksusa.com](mailto:service@volksusa.com)

©ZOUKEI-MURA INC. All Rights reserved. Made in Czech Republic

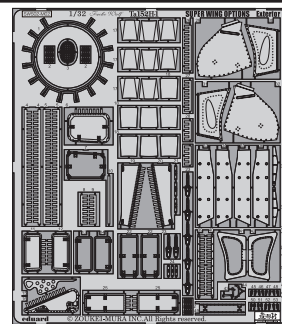

ZOUKEI-MURA INC. PRESENTS  
**SUPER WING SERIES**  
**1/32 Ta 152 H-1**  
 These are extra parts to be used with the "Ta 152 H-1" kit.

These are photo-etched parts. Please be careful during assembly. Plastic model cement won't work on these parts. Please use a suitable instant glue.

SWS02-M02

- Attention!**
- This item is meant for hobbyists 15 years of age or older. Please do not give this item to children under 15.
  - This item is intended for use with the Zoukei-mura 1/32 "Ta 152 H-1".
  - The polyethylene bags that contain the parts and assembly manual present a suffocation risk. Please do not drop the parts or bend them in unintended ways, as they may be damaged.
  - In order to properly express the shape of the items, it was unavoidable for some parts to have sharp edges. Please be careful. Also, please make sure not to leave them in the reach of small children.

■ Plan & Design : Zoukei-Mura, Inc.      ■ Manufacturer : Eduard  
 ■ Distributor : VOLKS, Inc. <http://www.volks.co.jp/en/>  
 60 Goshonouchi Nakamachi Shichi-jo, Shimogyo-ku, Kyoto Japan 600-8862

### Marks Used in the Instructions

- Do the same for right and left.
- Cut off.
- Bend.
- Make a hole.
- Process the hinges and assemble.
- Scrape away.
- Choose one.
- Replace the default part.

### Colors Used in the Instructions

- Parts of the Kit.
- Parts of this Photo-Etched Set.
- Cut off this area.
- Fill this opening with a putty, or similar.

## Fuselage Lateral Hatch Assembly

1/32 Ta 152 H-1  
 Instruction Manual **P14**

### Hinges Process / Assembly

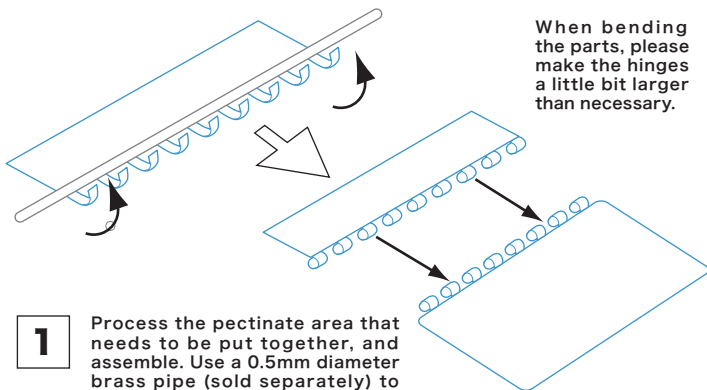

**1** Process the pectinate area that needs to be put together, and assemble. Use a 0.5mm diameter brass pipe (sold separately) to recreate the circular shape of the hinges. Assemble after processing the parts on both sides.

When bending the parts, please make the hinges a little bit larger than necessary.

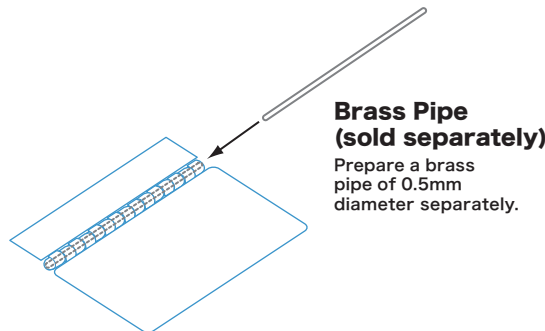

**2** After assembly, insert a brass pipe (sold separately) to fix the parts. (Cut the brass pipe in order its size fits the parts.) Since the parts can be broken easily, we recommend fixing the parts as soon as after adjusting the angle of the hinges. (Like the real hinges, these parts are not movable.)

Scrape away the details of the panel, shape the cross-section and make the panel open.

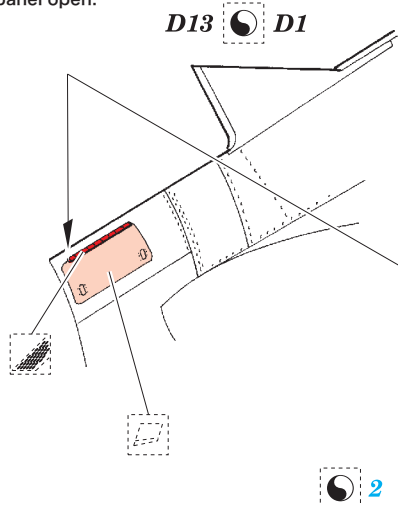

When seeing this mark, please proceed as explained above.

**Brass Pipe (sold separately)**  
 Prepare a brass pipe of 0.5mm diameter separately.

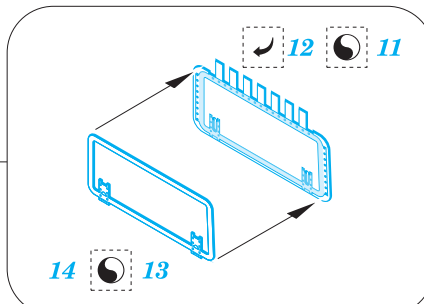

## Equipment Access Panel Assembly

1/32 Ta 152 H-1  
Instruction Manual **P14**

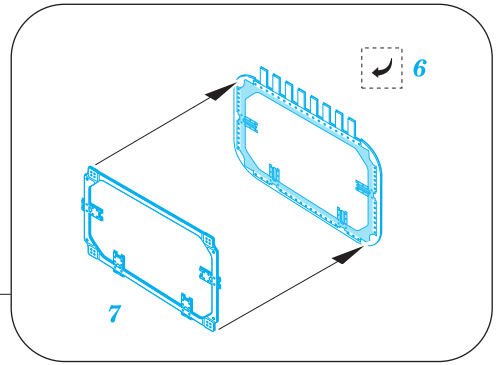
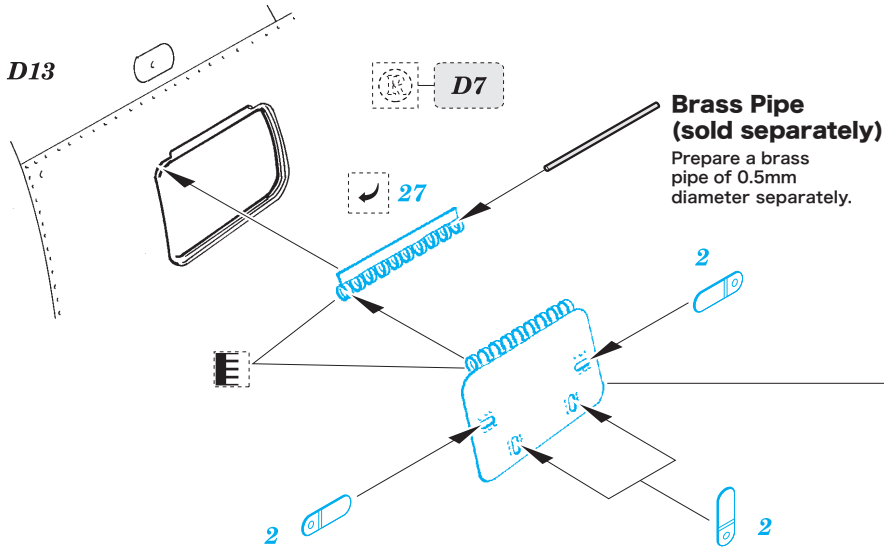

## Rear Wheel Strut Access Panel Assembly

1/32 Ta 152 H-1  
Instruction Manual **P15**

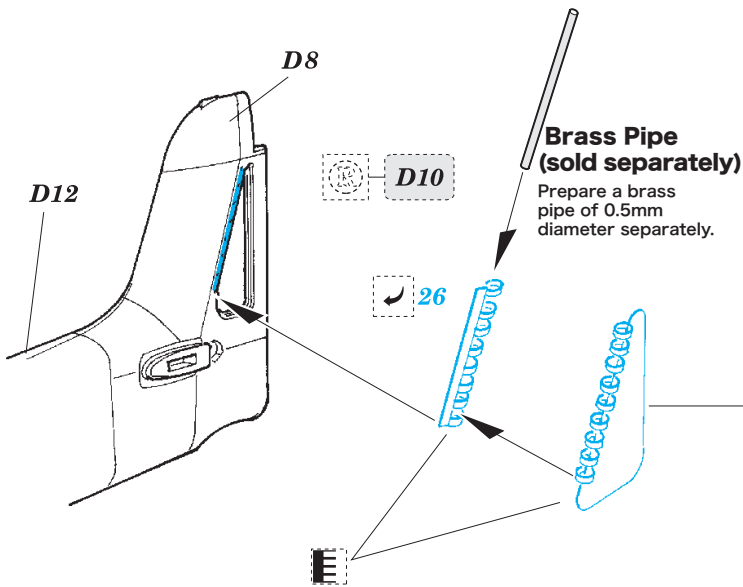

### Panel Process and Assembly

Press the photo-etched part 15 from the opposite side of the molds with a varnish for in letter or a spatula, and recreate the concave molds. Using a sharp tool like a pen may damage the part, so please be careful.

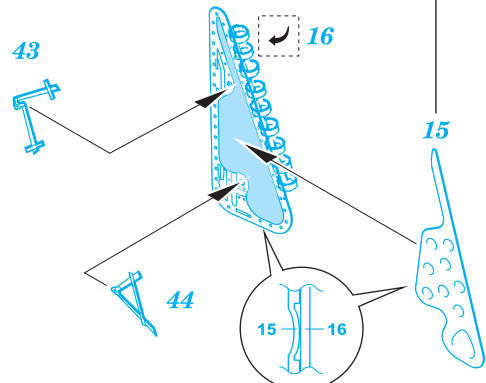
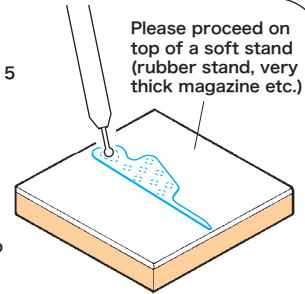

Fitting cross-section view

## Wheel Cover Assembly

1/32 Ta 152 H-1  
Instruction Manual **P25**

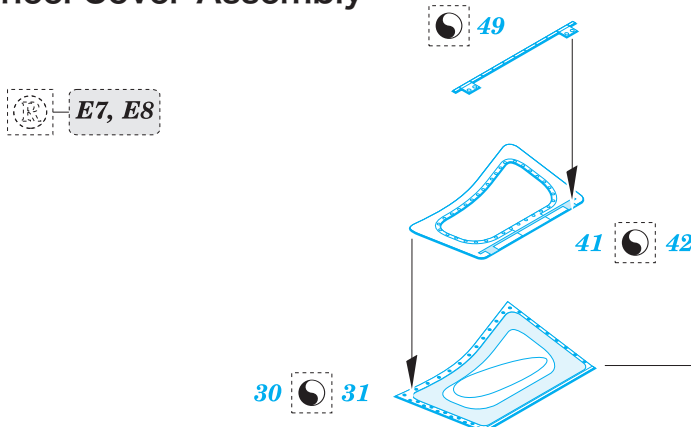

Press the photo-etched parts 30 and 31 from the side with the molds to recreate the convex molds. Proceed carefully while referring to the instruction manual.

Please proceed on top of a soft stand (rubber stand, very thick magazine etc.)

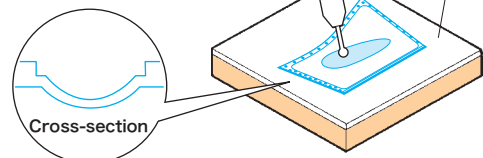

### Gun Panel Assembly

1/32 Ta 152 H-1  
Instruction Manual **P28**

**Brass Pipe (sold separately)**  
Prepare a brass pipe of 0.5mm diameter separately.

39 0  
4  
20 19  
E  
G8 F7

### Main Wing Base Assembly

**Brass Pipe (sold separately)**  
Prepare a brass pipe of 0.5mm diameter separately.

1/32 Ta 152 H-1  
Instruction Manual **P18**

28  
2  
2  
2  
22  
25  
G6 F6

### Aileron Linkage Assembly

1/32 Ta 152 H-1  
Instruction Manual **P19**

**Plastic Rod (sold separately)**  
Prepare a rod of 1.5mm diameter separately.

Assemble by adjusting to the shapes of the kit's parts.

21  
24  
E11  
22  
25

### Main Strut Cover Assembly

1/32 Ta 152 H-1  
Instruction Manual **P25**

Please proceed on top of a soft stand (rubber stand, very thick magazine etc.)

Press following the guide of the adhesive side of the part to recreate the convex molds on the surface.

To press the part, we recommend using a spatula or an in letter varnish. Using a sharp tool like a pen may damage the part, so please be careful.

E5 E6  
33 36  
32 29  
34 35  
46 53 52 45  
38 37  
48 47  
51 50

# Engine Cowling Assembly

1/32 Ta 152 H-1  
Instruction Manual **P21**

After being processed, part E15 attaches as the kit's part.

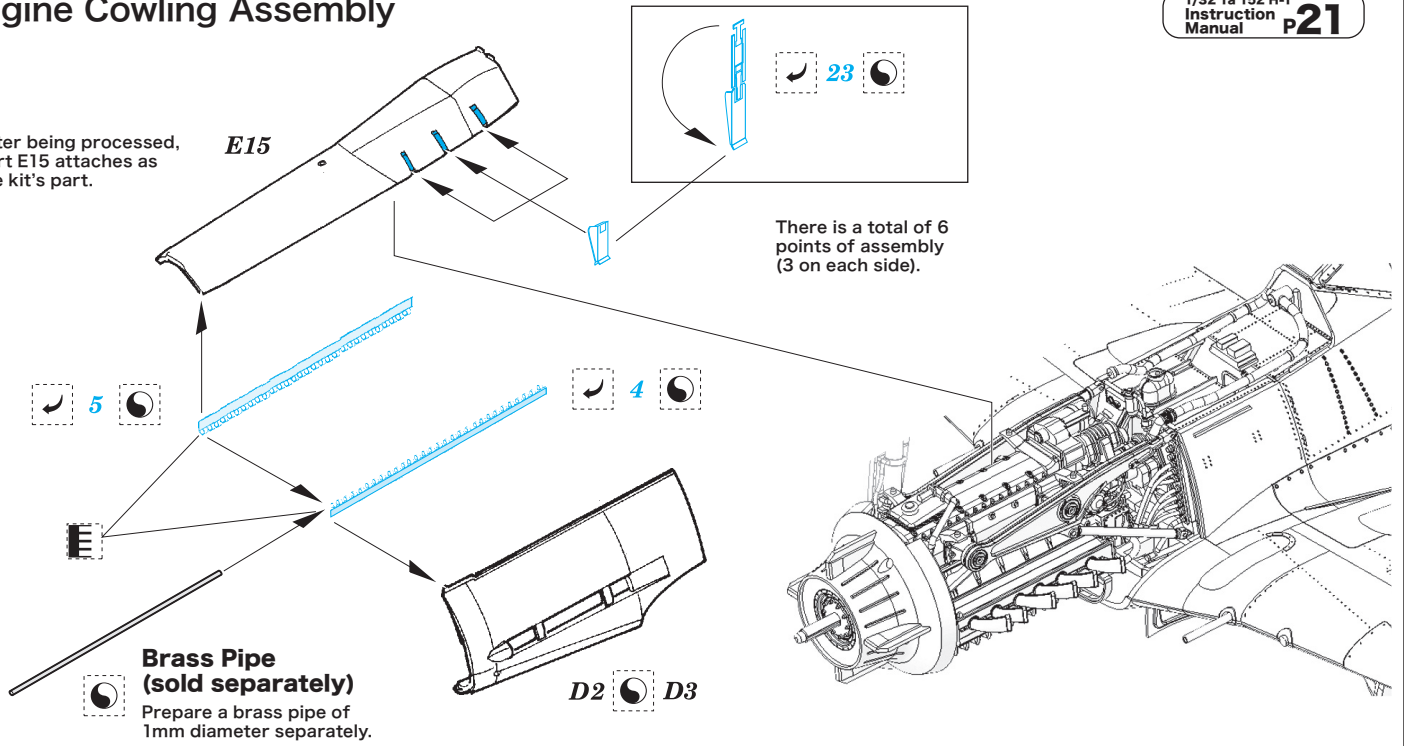

# Cowl Flap Assembly

1/32 Ta 152 H-1  
Instruction Manual **P22**

Before attaching parts A28 and A29 to the kit, insert the photo-etched part 1 and attach parts E2 and E17. Then, assemble the cowl flap with photo-etched parts 17 and 18. When doing this, make the photo-etched parts 17 and 18 curved like part E3.

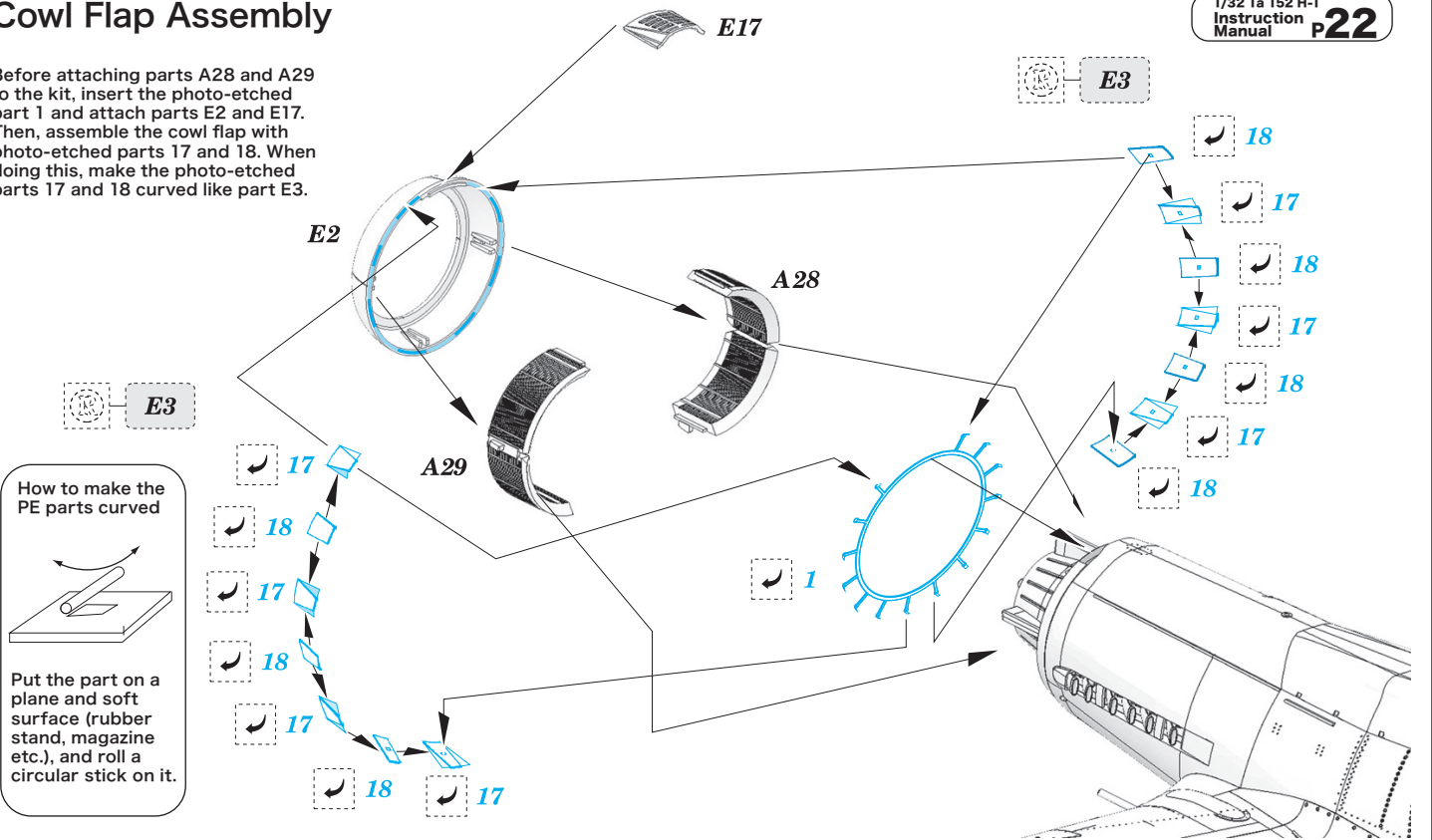

# Air Inlet Assembly

1/32 Ta 152 H-1  
Instruction Manual **P22**

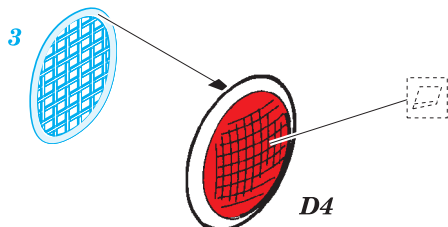

# Loop Antenna Assembly

1/32 Ta 152 H-1  
Instruction Manual **P28**

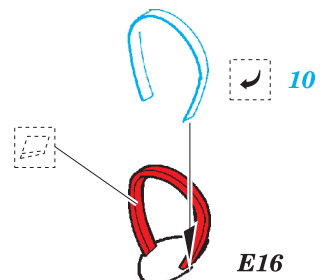



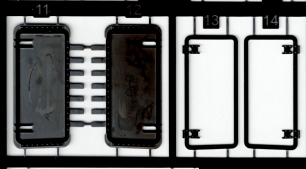
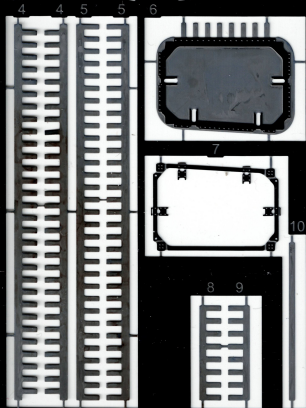
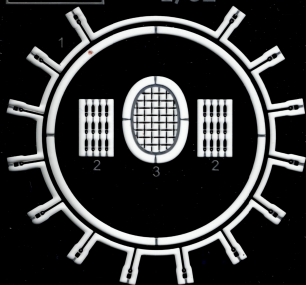

eduard



© ZOUKEI-MURA INC. All Rights reserved.



2 49

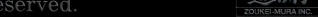
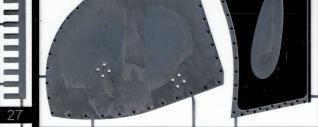

39 40 41 42 43 44 45 46 47 48 50 51 52 53

Made in Czech Republic

