

L7202
1/72 SCALE

G.W.H.[®]



F-15I IAF Ra'am

以色列空军F-15I攻击鹰战斗机

Israeli Air Force (IAF) was the first foreign buyer of the F-15 fighter series. In '80s, IAF discovered its lack of capability in long range anti-ground attack missions. This gap was covered by acquiring the F-15 Fighters with its large weapon load and long range. The F-15s were modified to load precision-guided weapon such as GBU-15 and external fuel tanks (CFT) were added which were still under testing at the time. On October 1, 1985, in response to a terrorist attack, the Israeli air force carried out Operation "Wooden Leg". The strike involved the bombing of PLO Headquarters in Tunis by 24 F-15 Eagles. This was the longest combat mission ever undertaken by the IAF, a stretch of 300 kilometres, involving in-flight refuelling. As a result PLO headquarters and barracks were either destroyed or damaged. The action promoted USAF's project of the F-15E. In the next year it beat the General Dynamics' competitor F-16XL and in 1988 the F-15E came into service.

As a dual-role long range fighter for attack and interception was urgently needed, IAF purchased the F-15E in 1994. The F-15I – arguably the best of its type in the Middle

Eastern arena – entered service in January of 1998, and became the IAF's leading fighter aeroplane. It is a special version of the F-15E Strike Eagle that was designed specifically for Israel by McDonnell Douglas (now Boeing). It utilizes lots of special instruments designed by IAF themselves. Its tremendous payload capacity, combined with its advanced systems, enable it to carry out attacks with a large weapons load at long ranges and low altitude, 24 hours a day and in any weather conditions. Due to its high price (more than 1 billion USD each), only 25 aircraft were purchased. 24 planes entered the 69 "Hammers" Squadron, which is the combat unit with the longest history in IAF. The remaining one (No.201) was provided to 601 Squadron (Flight Test Center) in Tel Nof Airbase (Air Force Base 8) for weapon loading tests. The painting scheme of No.201 in the kit is for the aforementioned testbed F-15I. On Jan 1, 1999, F-15Is in 69 "Hammers" Squadron completed training and the first combat missions were flown in Lebanon on 11 January 1999. They attacked the terrorist in Lebanon with laser-guided bombs under target designation by AN/AAQ-13 LANTIRN navigation pods.

以色列空军是F-15系列战斗机的第一个海外用户，进入1980年代，以色列空军现有的对地攻击机在远程奔袭任务方面显得鞭长莫及，于是将目光转向具备强大挂载能力且航程较远的F-15战斗机身上，他们对F-15战斗机进行改装，使其能挂载GBU-15等精确制导炸弹，并加装尚在试验阶段的保形油箱（CFT）。在1985年10月1日，这些改进过的F-15进行了对地打击实战，长途奔袭远在突尼斯海岸的巴解总部（木腿行动），取得重大成功。这举动对美国空军的F-15E“攻击鹰”计划起到了巨大的推动作用。次年，F-15E击败了F-16XL，1988进入美国空军服役。

F-15E服役后，出于远程打击作战的需要，以色列空军对其产生了巨大的兴趣。在1994年向美国订购了F-15E的以色列定制款，该型号配备了大量以色列自己研发的系统，就是今天的F-15I。F-15I成为以色列空军最先进的打击平台。由于采购成本高昂（每架飞机售价接近1亿美元！），最终只采购了25架，装备给历史悠久的轰炸机中队——第69“锤子”中队。这25架飞机中，除了24架装备给“锤子”中队，剩余的一架飞机（201号）配属给特尔诺夫基地的空军试飞评估中队，用于武器挂载测试。本套件中的201号机涂装方案就是测试中队装备的那架飞机。69中队的F-15I在1999年1月1日形成战斗力，并在当月进行了首次实战，用“兰盾”吊舱引导激光制导炸弹对黎巴嫩境内的恐怖分子目标实施了精确打击。

注意事項 CAUTION 組み立てのご注意

- | | | |
|--|---|---|
| <p>(1) 勿于近火处使用胶水或油漆,并打开窗户保持空气流通。</p> <p>(2) 涂料的号码请参考本栏以下的说明。本品本身不包括胶水和涂料。</p> <p>(3) 自板件中取出部件时,应用模型专用剪,并用介刀或小锉刀除去多余胶料。</p> <p>(4) 各图形的含义可参考本栏以下说明。</p> | <p>(1) When you use glue or paint,do not use near a open flame,and use in a well-ventilated room.</p> <p>(2) See below for the color list.Glue and paint are not included in the kit.</p> <p>(3) When you take parts off the runner frame,use the modeling scissors and trim excess plastic with a cutter or a file.</p> <p>(4) See below for the meaning of symbols.</p> | <p>(1) 接着剂や塗料は火の近くで使わないで下さい、使用の際は換気をよくして下さい。</p> <p>(2) 塗料指定のは下記のとおりです、接着剂や塗料は入っていませんので別に求めて下さい。</p> <p>(3) 部品のランナーから切り離す時は模型用ハサミ等を使い、余分な部分はカッターやヤスリ等で仕上げして下さい。</p> <p>(4) 組立図のサインマークは下の説明を御覧下さい。</p> |
|--|---|---|

图形含义 CAUTION マーク

填平 FILL HOLE 穴を埋めて下さい	水印粘纸 APPLY DECAL デカールを貼って下さい	切除 CUT OFF 切り取って下さい	配重块 COUNTER WEIGHT 重り	制作两组 MAKE TWO SET 2個作って下さい	另一側相同制作 DO THE SAME ON THE OPPOSITE 反対側も取り付けます
胶水 CEMENT 接着して下さい	钻孔 OPEN HOLE 穴を開けて下さい	选择使用 OPTIONAL どちらを選んで下さい	不用胶水 NO CEMENT 接着しないで下さい	注意 BE CAREFUL 注意して下さい	瞬间胶 INSTANT GLUE FOR METAL 瞬間接着剂(金属用)

所使用工具 RECOMMENDED TOOLS 専用工具

塑胶件用模型胶水 Cement プラスチック用接着剂	模型用剪钳 Side cutters 模型用ニッパー	模型用镊子 Tweezers ピンセット
模型用瞬间胶水 Instant Cement 瞬間接着剂	模型用刻刀 Modeling knife 模型用ナイフ	模型用锉刀 Diamond file 模型用ヤスリ

水贴纸使用说明 DECAL APPLICATION スライドマークの貼り方

- | | | |
|--|--|---|
| <p>(1) 用模型剪刀或刻刀切下所需的图案部分。</p> <p>(2) 将水贴纸浸泡在温水中10秒左右取出放置于戏水的干布上。</p> <p>(3) 手拿着水贴纸基的一角,用模型镊子小心夹住浮起的水贴图案移至模型表面准确位置。</p> <p>(4) 用手指适当沾水均匀涂于水贴图案表面,使其延展移动至精确位置。</p> <p>(5) 用柔软吸水的干布将水贴图案中的气泡向一边挤出,使水贴在模型表面保持平整。</p> | <p>(1) Cut off decal from sheet.</p> <p>(2) Dip the decal in tepid water for about 10 sec and place on a clean cloth.</p> <p>(3) Hold the backing sheet edge and slide decal onto the model.</p> <p>(4) Move decal into position by wetting decal with finger.</p> <p>(5) Press decal down gently with a soft cloth until excess water and air bubbles are gone.</p> | <p>(1) 貼りたいマークをハサミで切り抜きます。</p> <p>(2) マークをめぐるま湯に10秒ほど浸してからタオル等の布の上に置きます。</p> <p>(3) 台紙のはしを手で持ち、貼るところにマークをスライドさせてモデルに移して下さい。</p> <p>(4) 指に少し水を付けてマークを濡らしてながら、正しい位置にずらしします。</p> <p>(5) 柔らかな布でマークの内側の気泡を押し出しながら、押しつけるようにして水分をとります。</p> |
|--|--|---|

蚀刻片使用说明 PHOTO-ETCHED PARTS エッチングパーツ

- | | | |
|---|---|---|
| <p>(1) 使用蚀刻片专用剪刀或模型专用刻刀将蚀刻片零件切割下待用。</p> <p>(2) 切割下的零件上有蚀刻片的残留连接点部分,使用模型专用锉刀细心打磨干净。</p> <p>(3) 蚀刻片部分在涂装之前必须使用专用的模型金属底漆打底。</p> <p>注意事项: 蚀刻片很薄外延较为尖锐,有刮伤手的可能,在使用之时请务必小心。</p> | <p>(1) Cut off photo-etched parts using a modeling knife.</p> <p>(2) Carefully remove any excess using a file.</p> <p>(3) Apply metal primer prior to painting.</p> <p>Attention, please: Extra care should be taken to avoid personal injury when handling photo-etched parts.</p> | <p>(1) 切り離す時はカッターナイフを使用してパーツを切り離します。</p> <p>(2) 切り出した時、部品に出っ張った部品が残っている場合は、ヤスリなどで丁寧に削り落とします。</p> <p>(3) 塗装が必要なパーツは下地にメタルプライマーを吹き付けてから塗装します。</p> <p>ご注意: エッチングパーツは大変薄く、手などを切り恐れがあります。取扱いには十分注意して下さい。</p> |
|---|---|---|

涂装色表 PAINT REQUIRED カラー番号リスト

■ C|000 GSI CREOS Mr.COLOR ■ 00-000 ACRYLICOS VALLEJO ■ A.MIG-000 米格色号 ■ FS00000 联邦色号

C 1	—	—	—	光泽白	CLOSS WHITE	C 306	—	—	FS36271	中灰色	GRAY
C 2	—	—	—	光泽黑	CLOSS BLACK	C 307	—	A.MIG-208	FS36320	中灰色	DARK COMPASS GHOST GRAY
C 3	71-084	—	—	光泽红	RED	C 308	71-050	A.MIG-203	FS36375	浅灰色	LIGHT COMPASS GHOST GRAY
C 6	—	—	—	光泽绿	GREEN	C 310	70-929	A.MIG-202	FS30219	棕色	BROWN FS30219
C 33	71-057	—	FS37038	消光黑	FLAT BLACK	C 312/C26	70-287	A.MIG-201	FS34227	浅灰绿色	LIGHT GRAY GREEN
C 47	70-934	—	—	透明红	CLEAR RED	C 313	70-847	A.MIG-200	FS33531	沙漠色	MIDDLESTONE
C 49	70-956	—	—	透明橙	CLEAR ORANGE	C 316	70-919	—	FS17875	白	WHITE FS17875
C 50	—	—	—	透明蓝	CLEAR BLUE	C 319	70-968	—	—	薄松叶色	LIGHT GREEN
C 57	70-808	—	—	青竹色	METALIC BLUE GREEN	C 329	70-915	—	FS13538	亮光橙黄色	YELLOW FS13538
C 73	71-012	—	—	飞机灰	AIRCRAFT GREY	MC 213	71-072	—	—	不锈钢色	STAINLESS
C 137	—	—	—	轮胎黑	TIRE BLACK	MC 214	71-865	A.MIG-191	—	钢铁色	STEEL

A PARTS x1

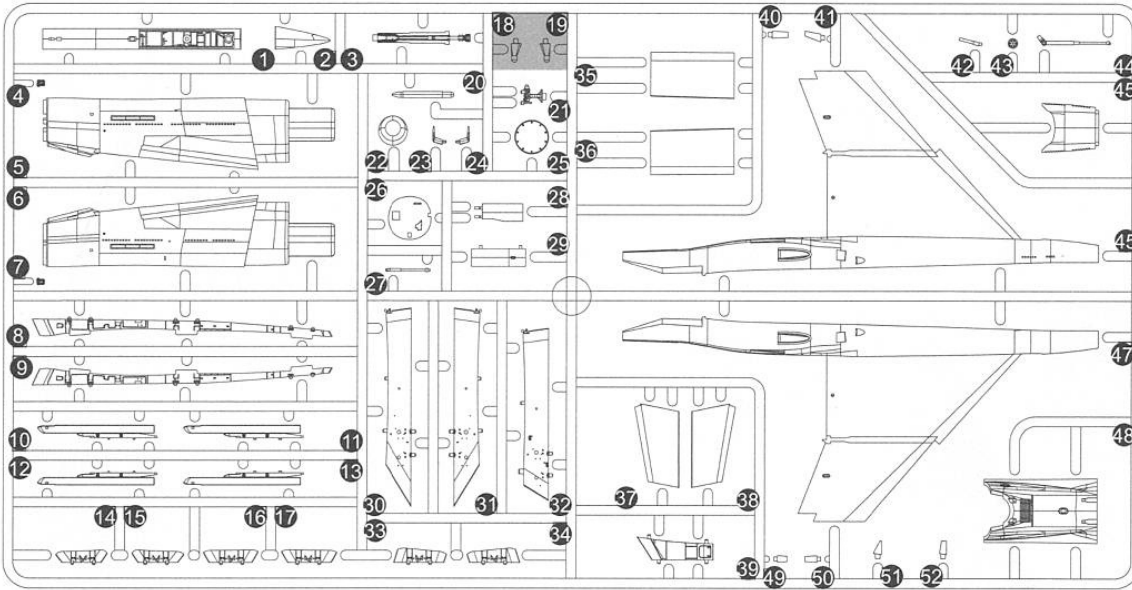

O PARTS x1

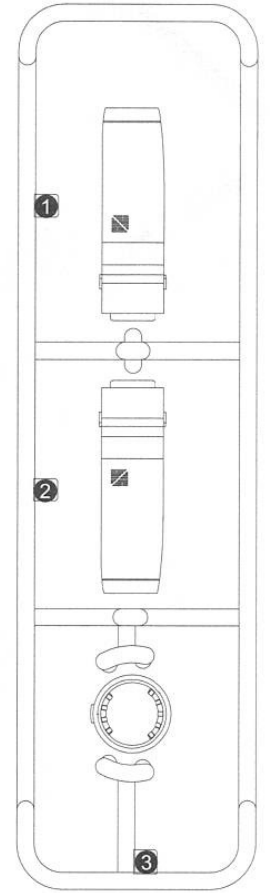

M PARTS x1

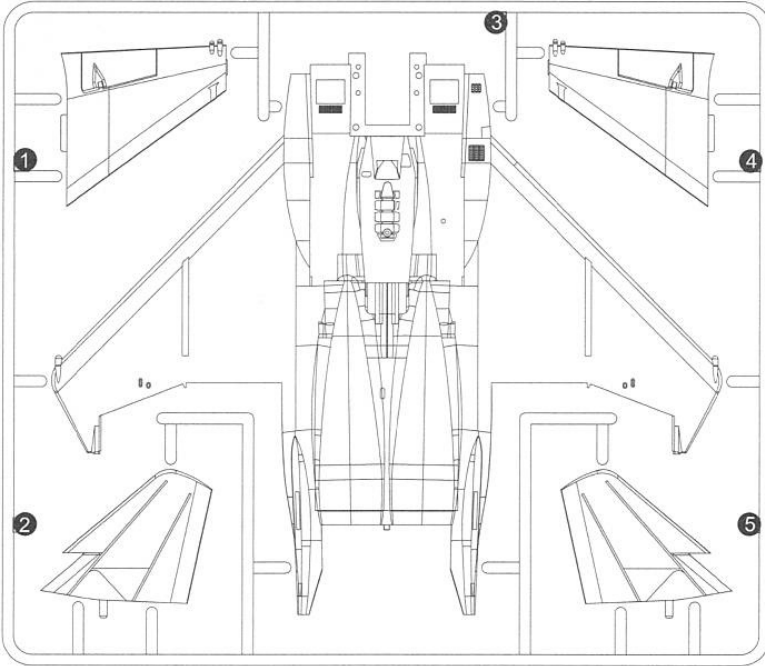

U PARTS x1

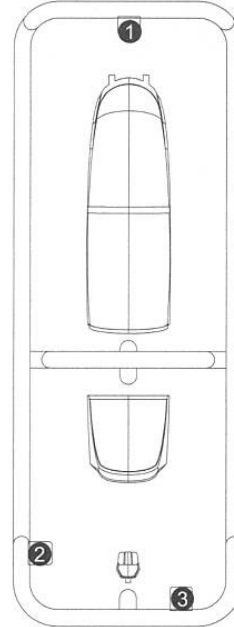

Q PARTS x1

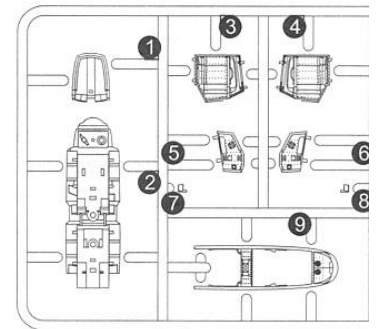

T PARTS x1

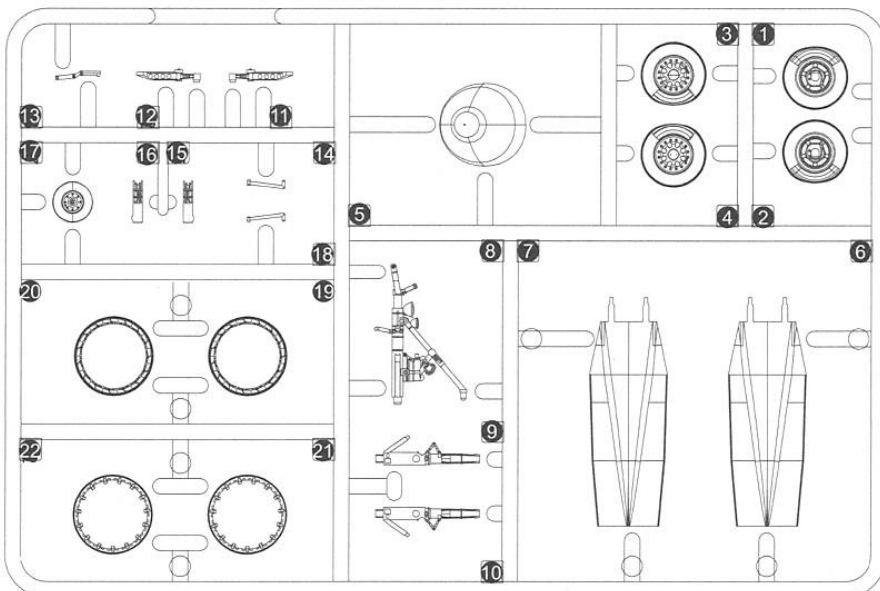

C PYHON-4/AGM-142 x2

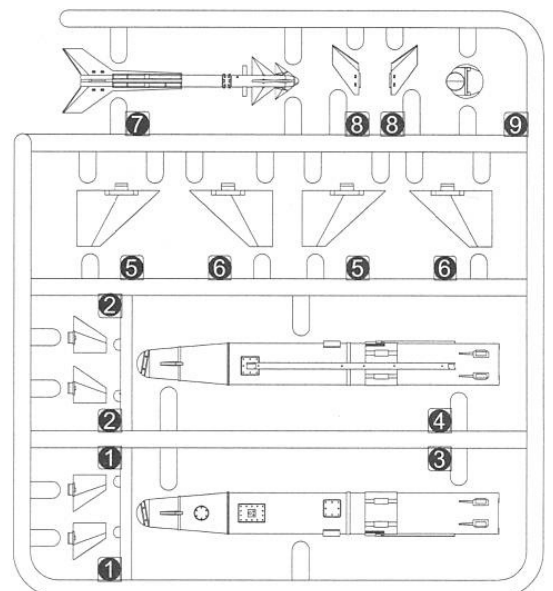

ST パーツリスト

P PARTS x1

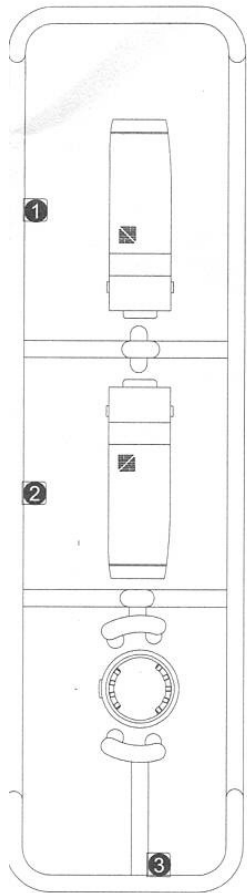

N PARTS x1

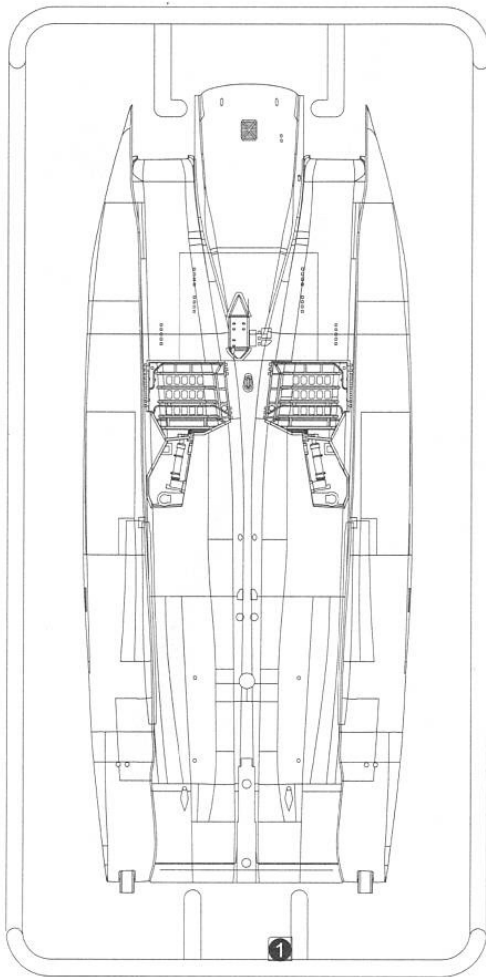

R PARTS x2

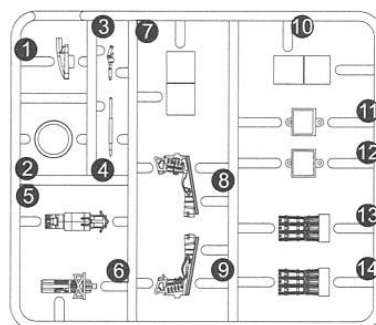

G AGM-130 x1

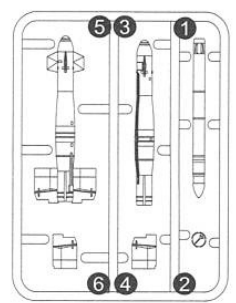

J AAQ-14 x1

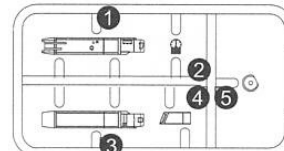

L 610GAI-FUEL x2

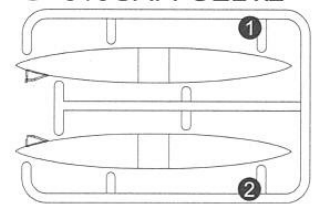

B GBU-12 x4

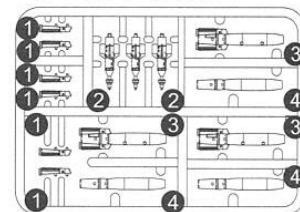

D AIM-120B x2

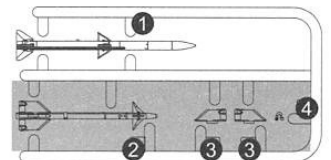

I AXQ-14 x1

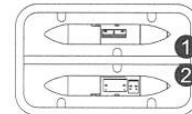

H AAQ-13 x1

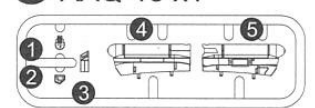

F GBU-38 x3

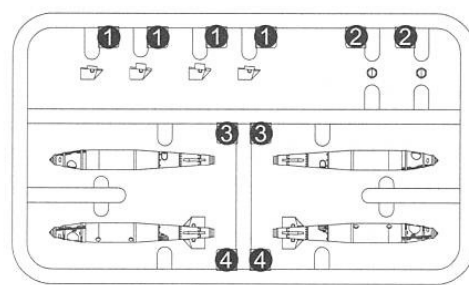

K GBU-31 x1

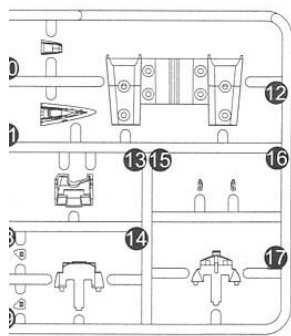
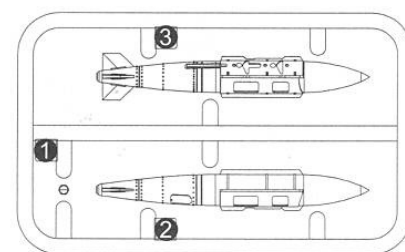

DE A

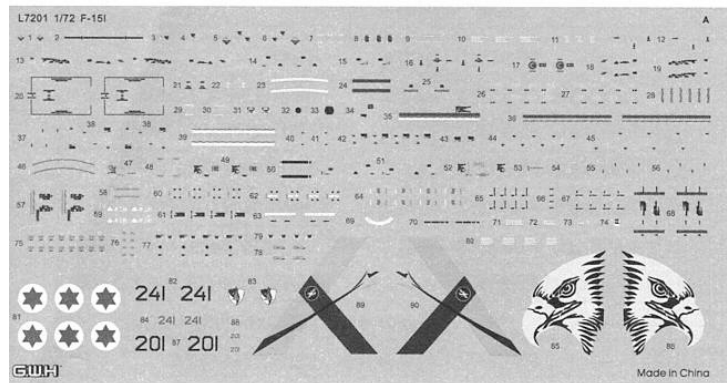

DE B

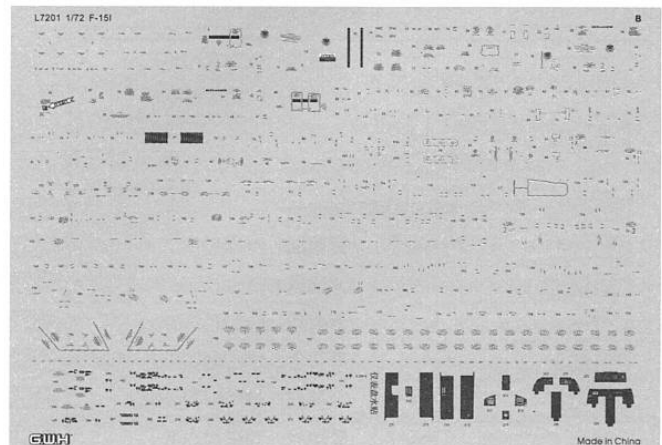

Parts not for use
不需要板件零件

G.W.H.[®]

L7202 F-15I IAF Ra'am

1

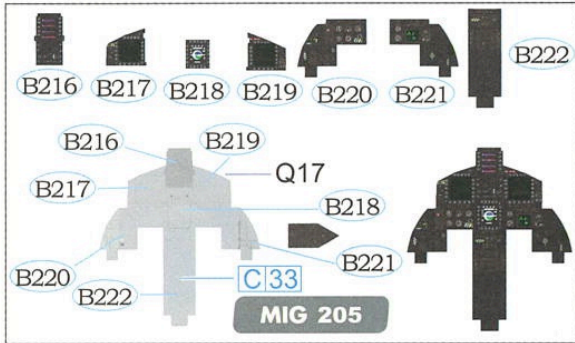
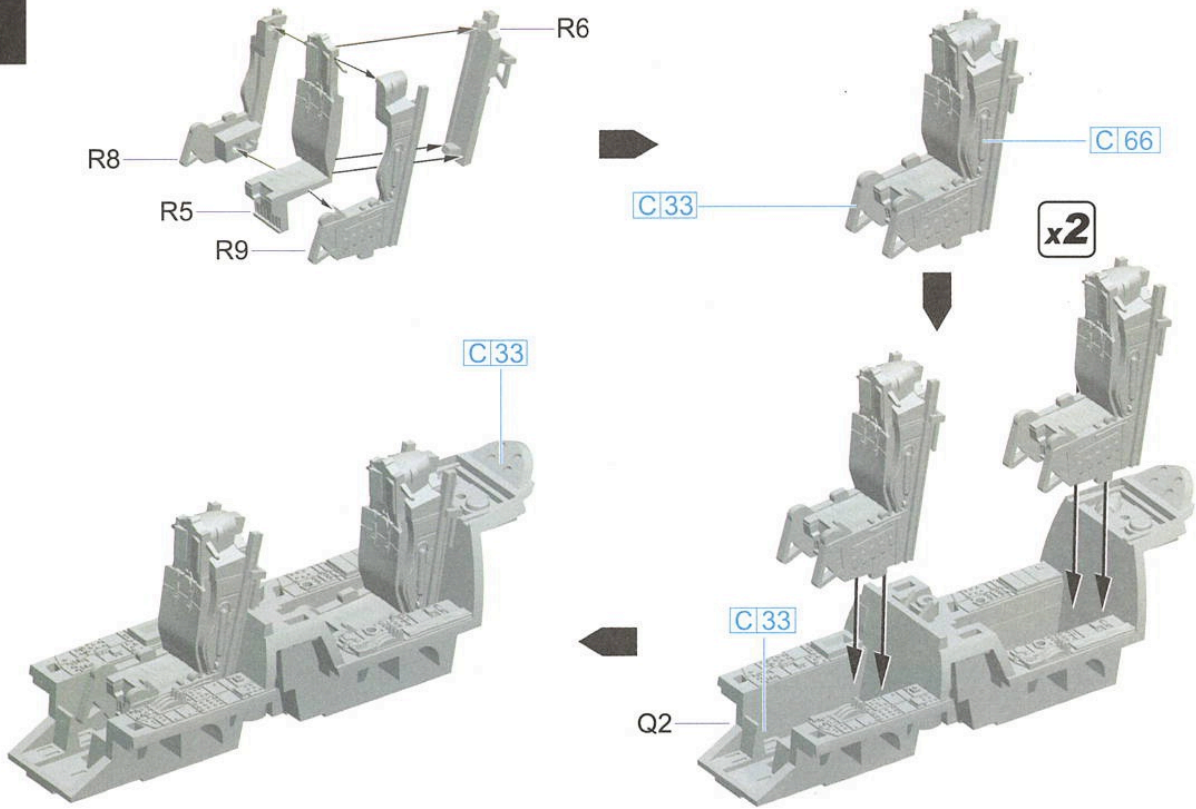

前仪表板
Front Instrument Panel
前にダッシュボード

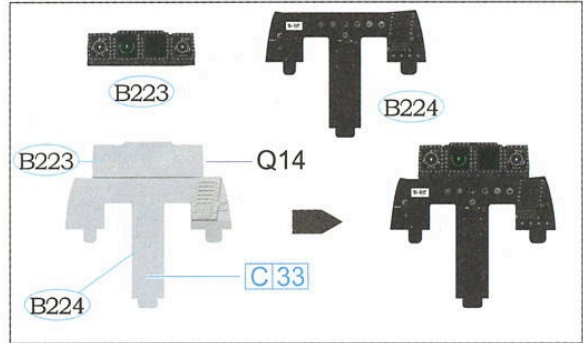

后仪表板
Rear Instrument Panel
後にダッシュボード

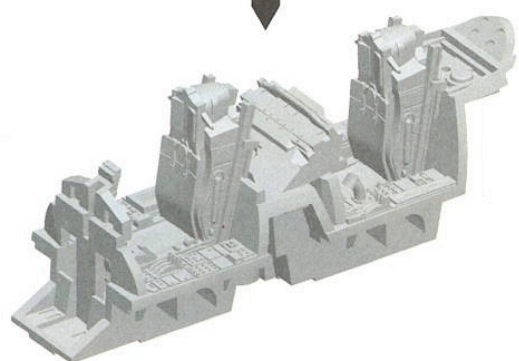
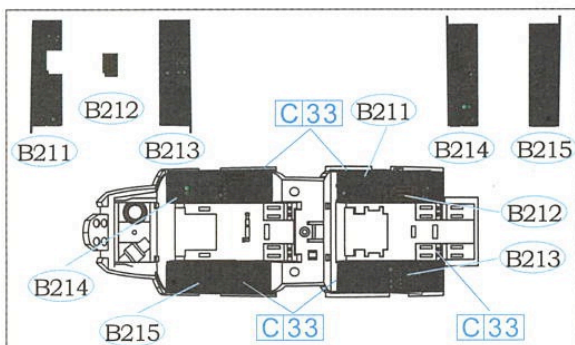
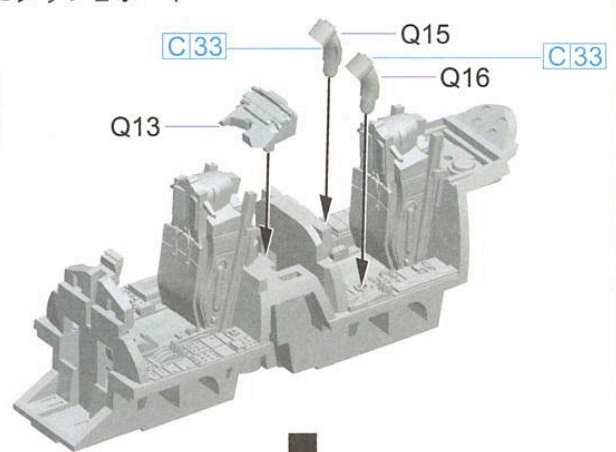
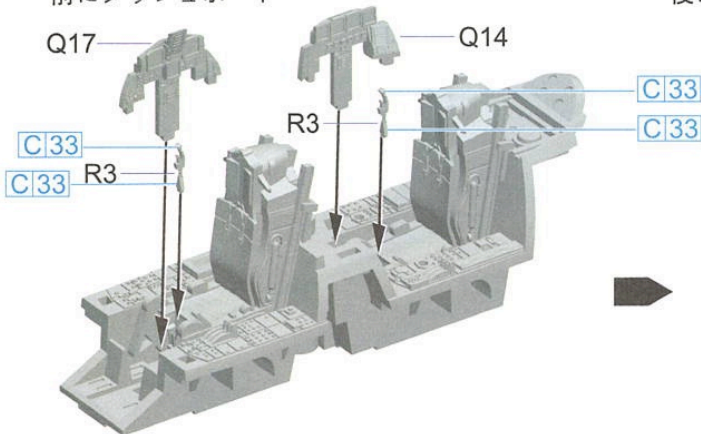

2

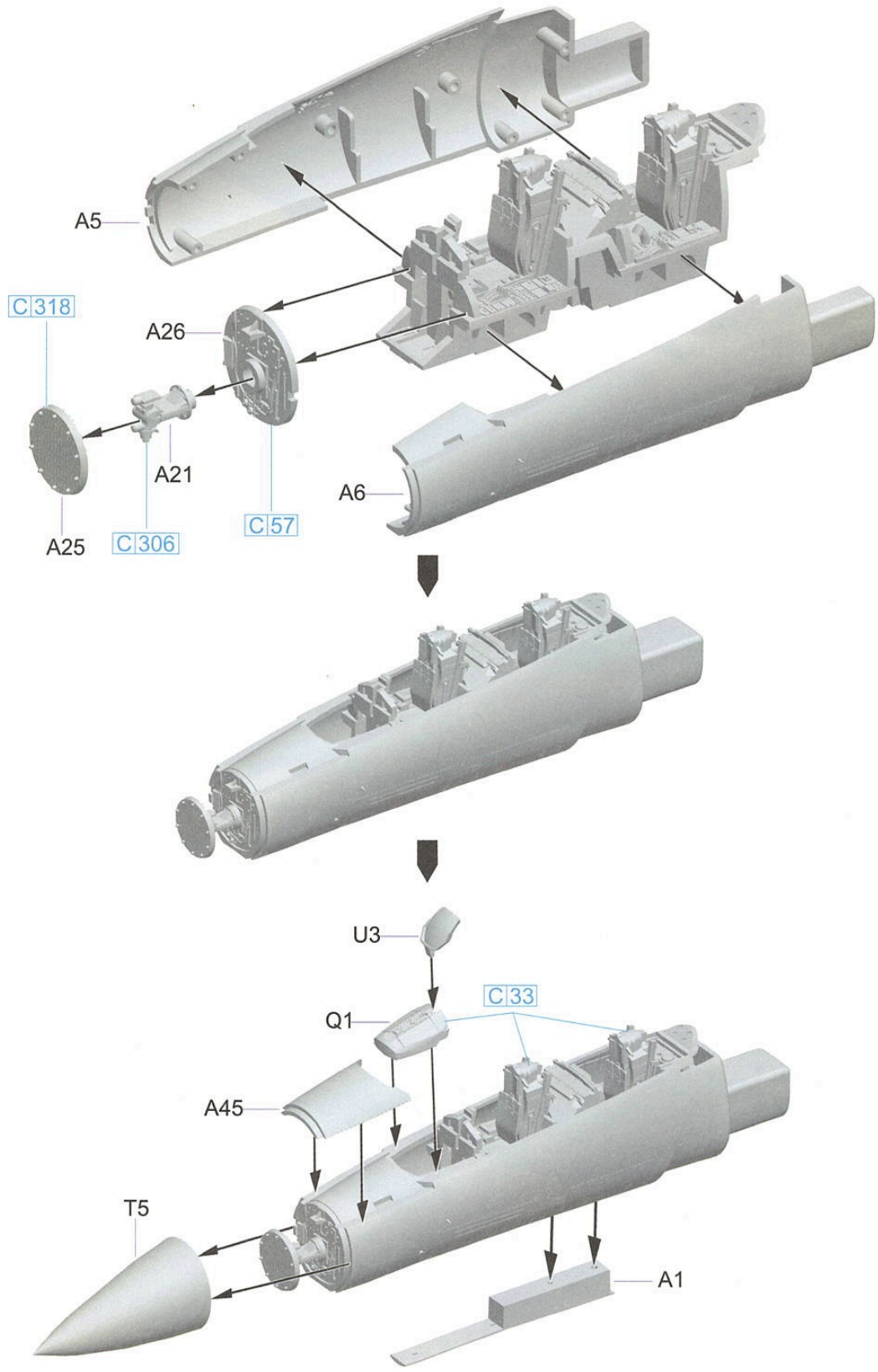

3

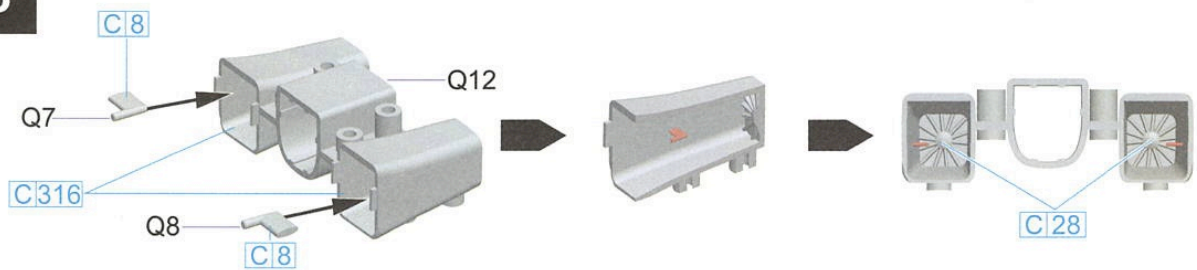

4

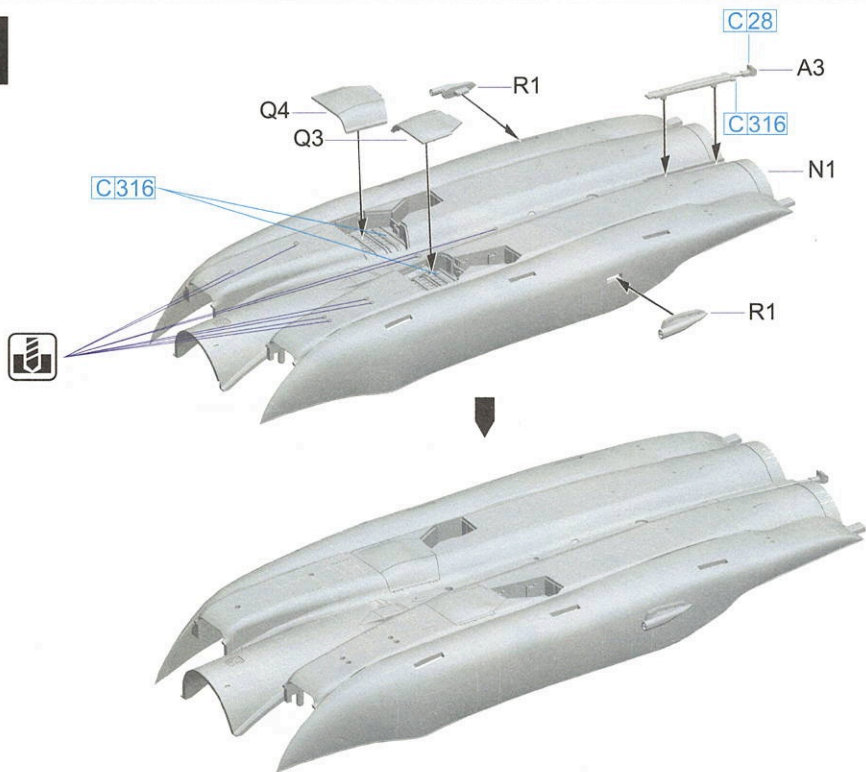

尾噴口組装
Exhaust Nozzle Assemble
ノズル組み立て

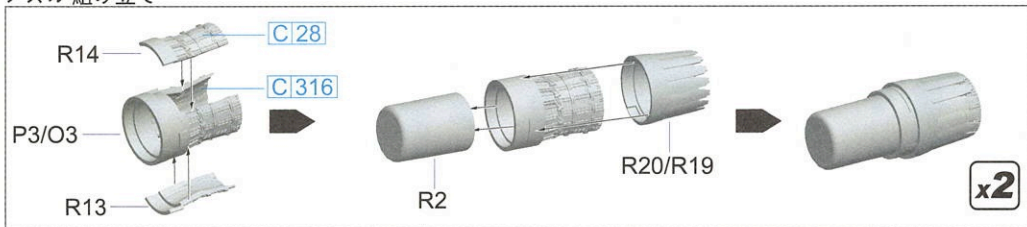

5

起飞降落状态組装
Gear Up Style Assemble
離陸状態組み立て

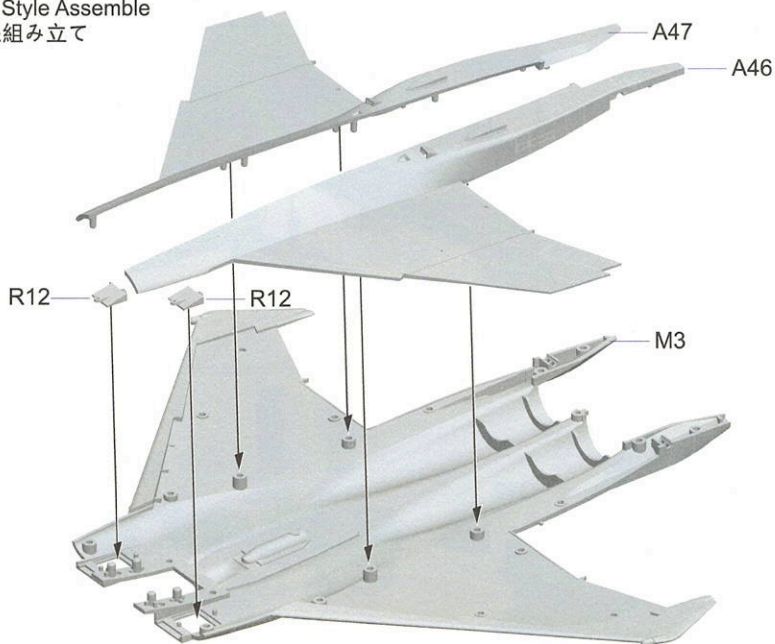

5

起飞降落状态组装
Gear Up Style Assemble
離陸状態組み立て

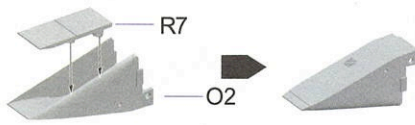

Left

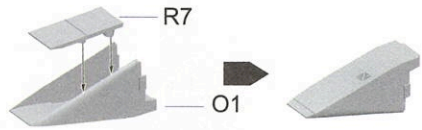

Right

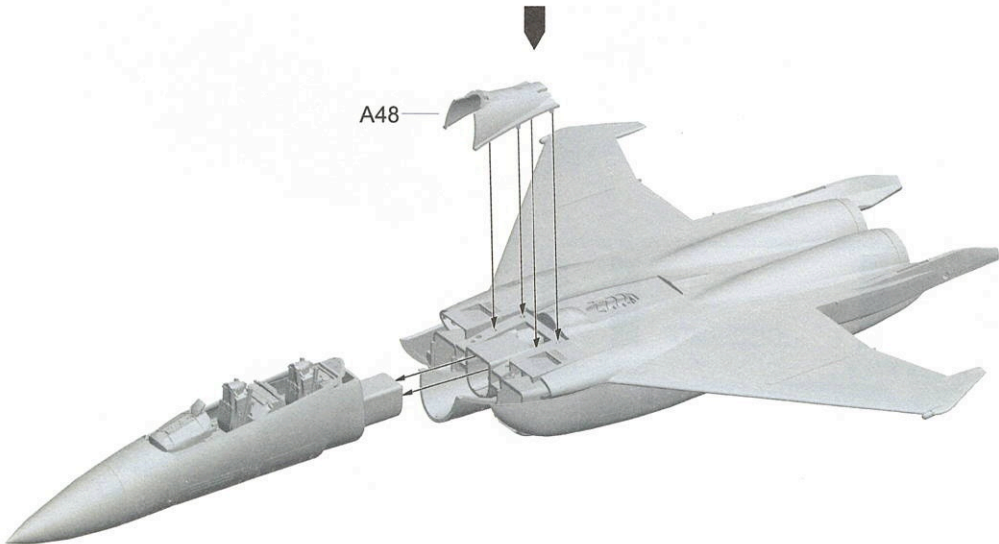
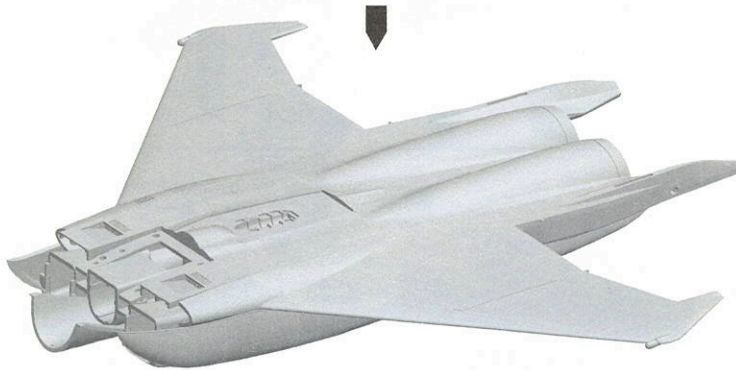
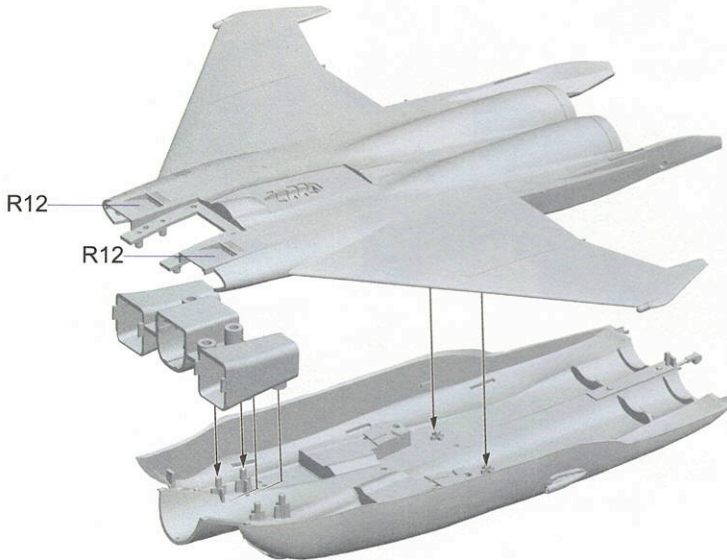

5

起飞降落状态组装
Gear Up Style Assemble
離陸状態組み立て

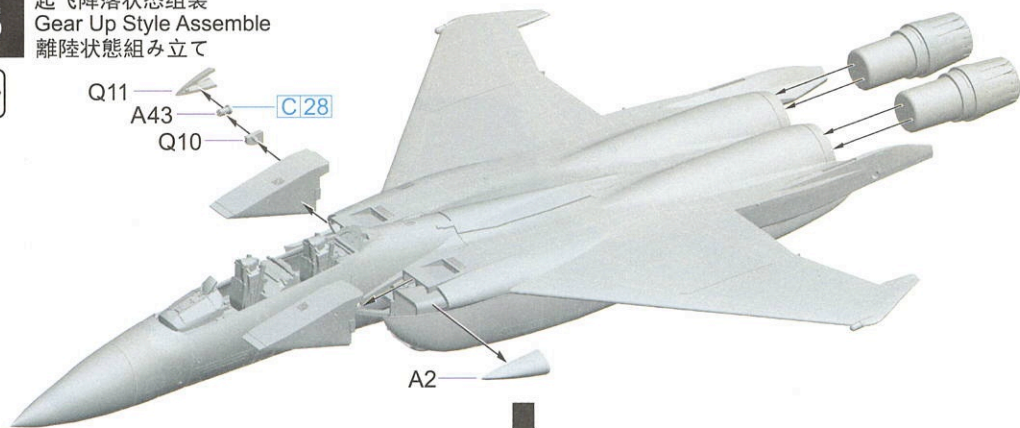

6

停机状态组装
Gear Down Style Assemble
停止状態の組み立て

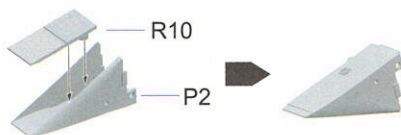
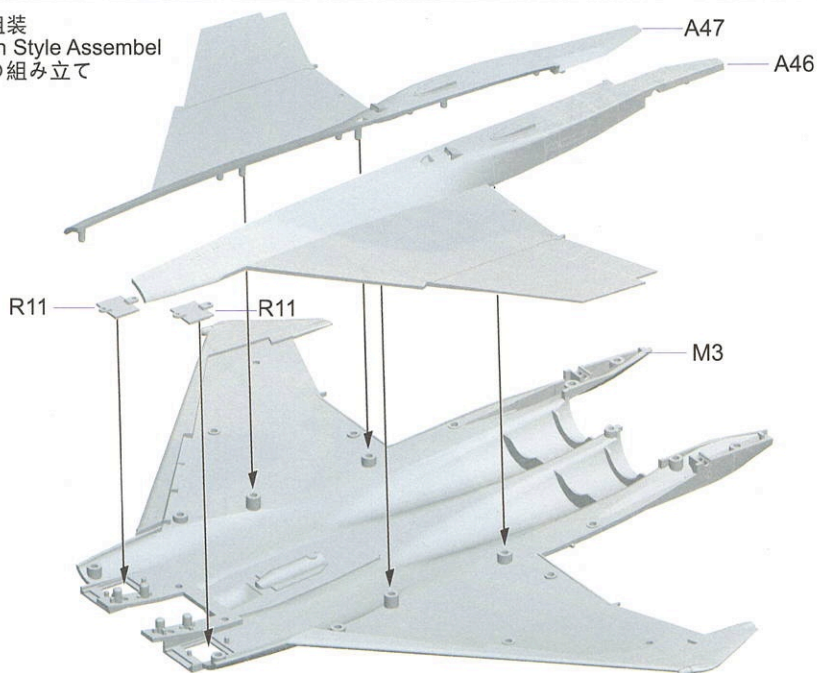

Left

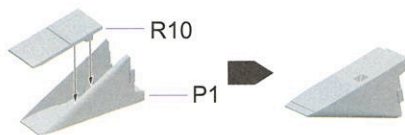

Right

6

停机状态组装
Gear Down Style Assembl
停止状態の組み立て

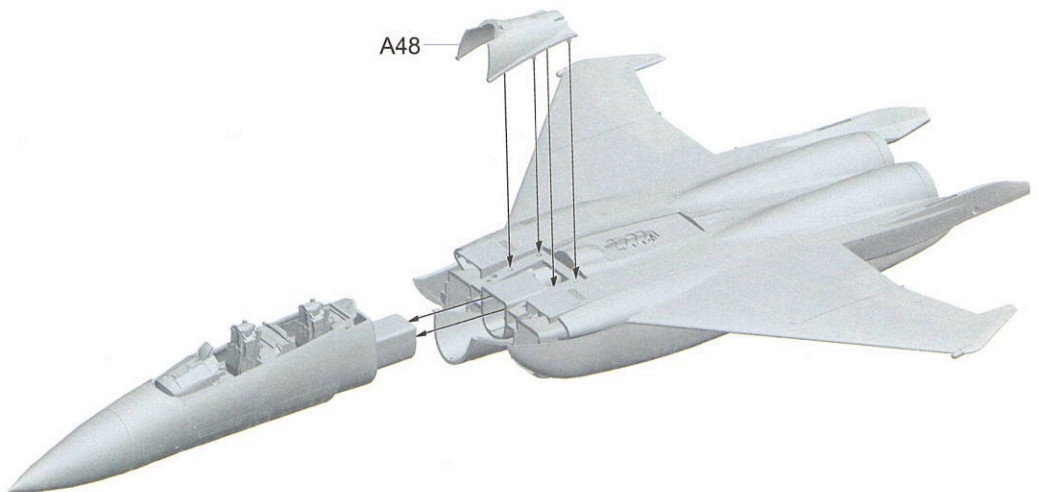
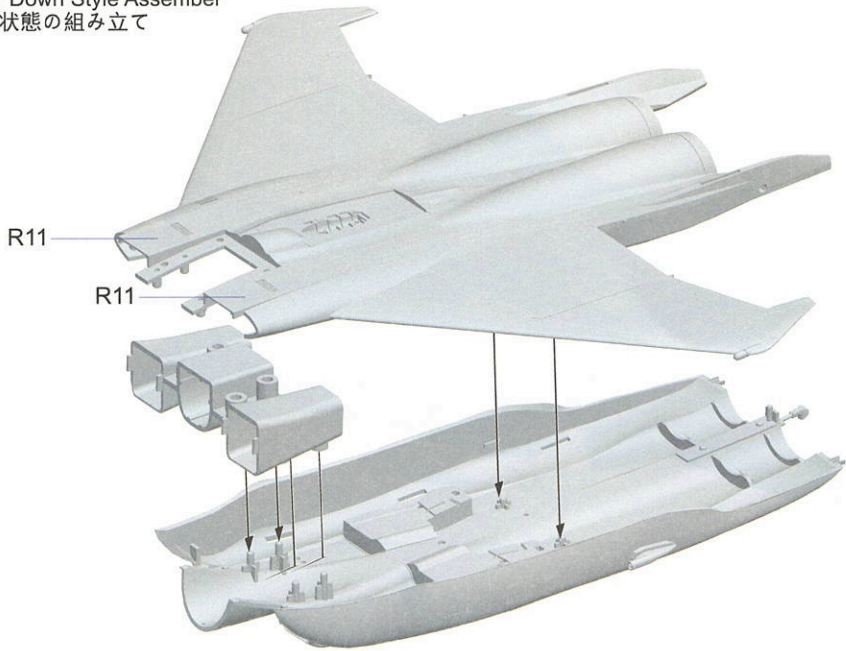

6

停机状态组装
Gear Down Style Assembl
停止状態の組み立て

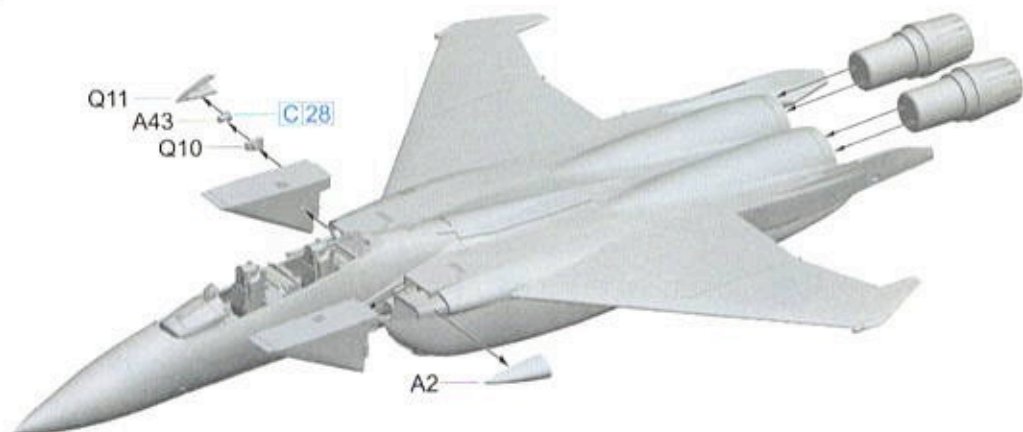

7

关闭状态
Retracted
閉じ状態

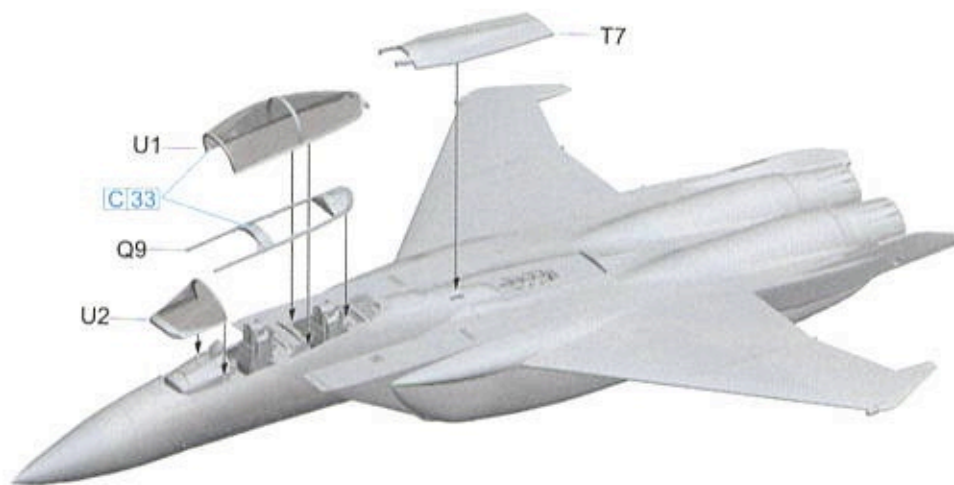

7

关闭状态
Retracted
閉け状態



8

打开状态
Extended
開け状態

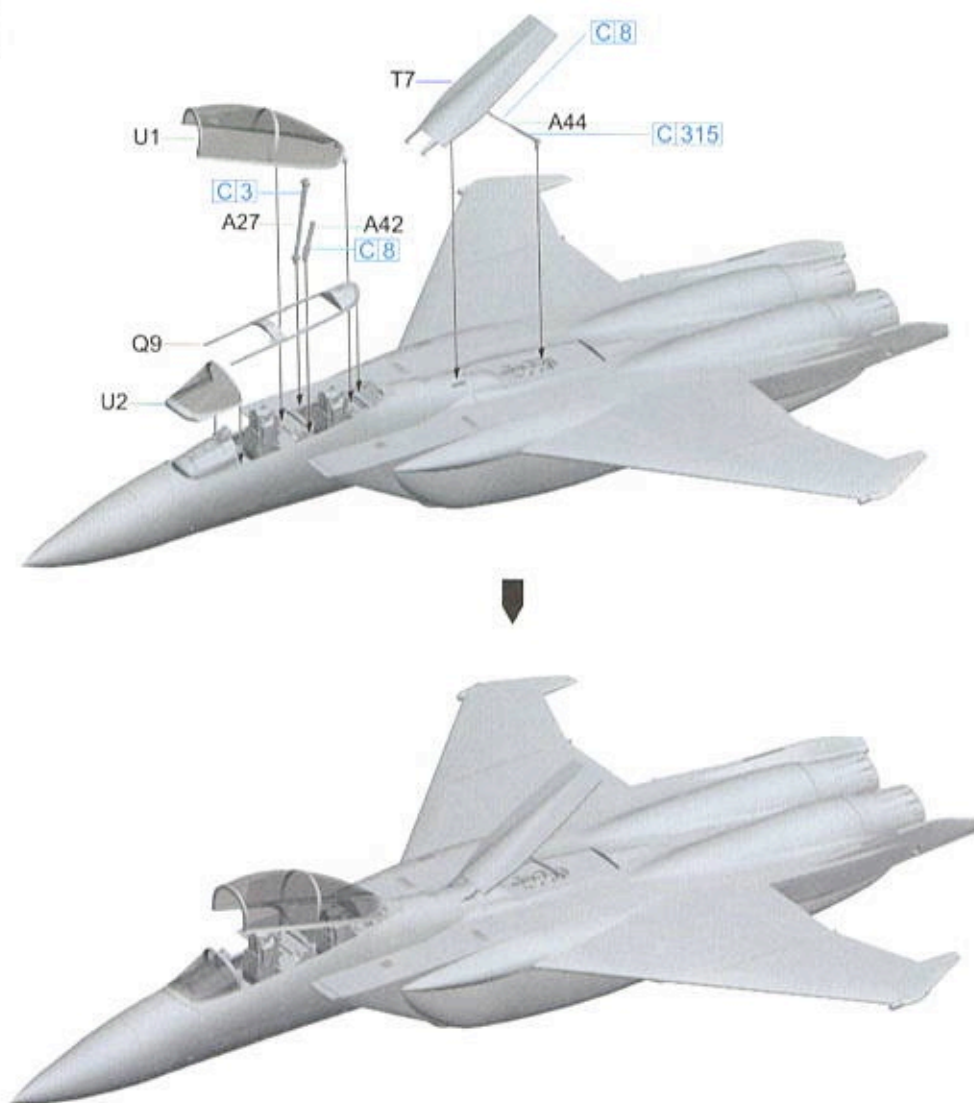

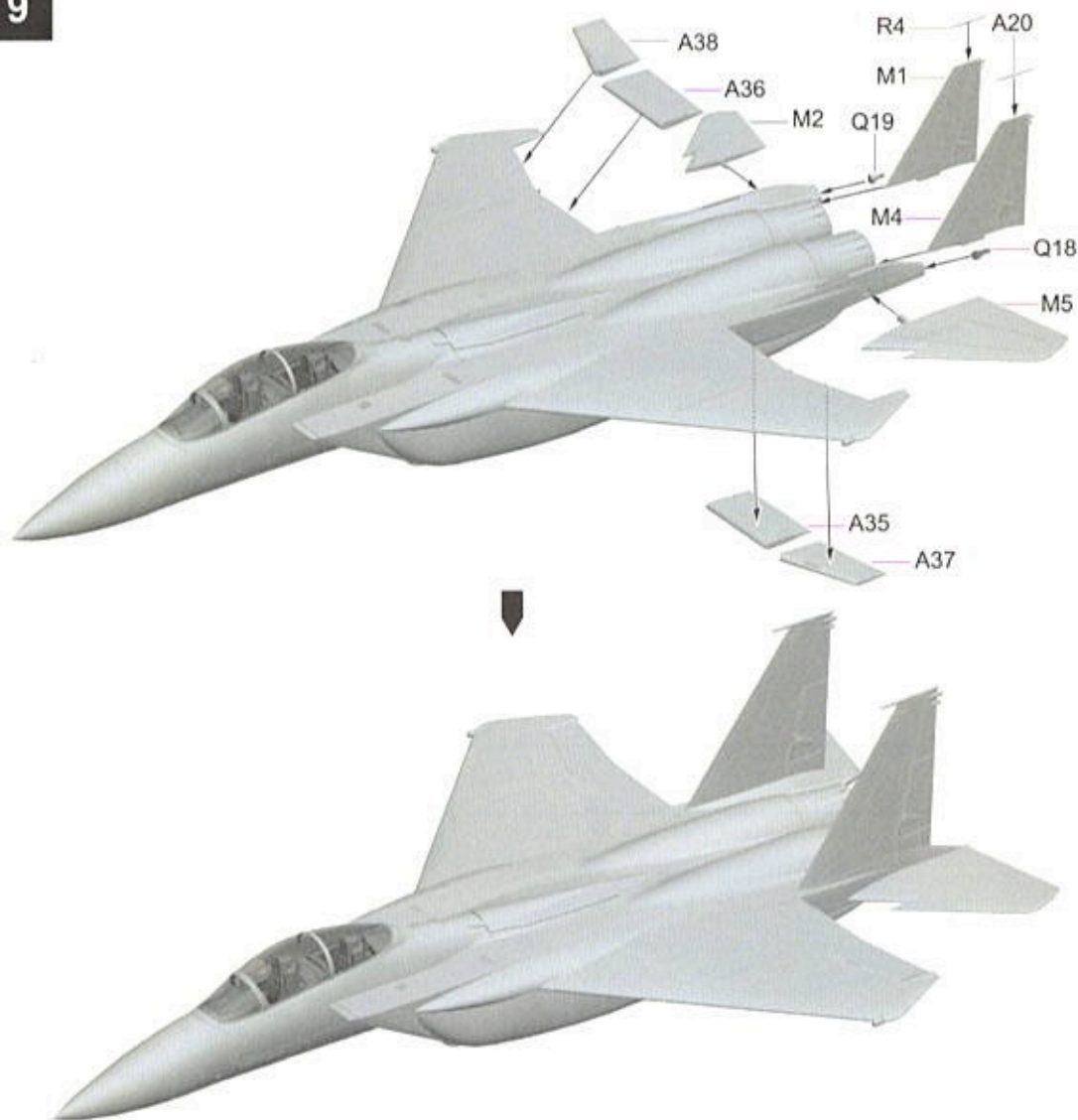

前輪
Nose Wheel
前輪

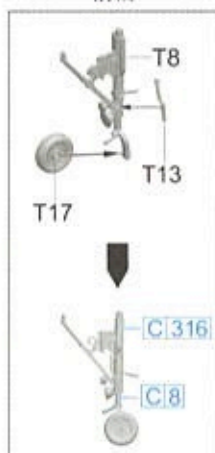

左后輪
Left Main Wheel
左の後輪

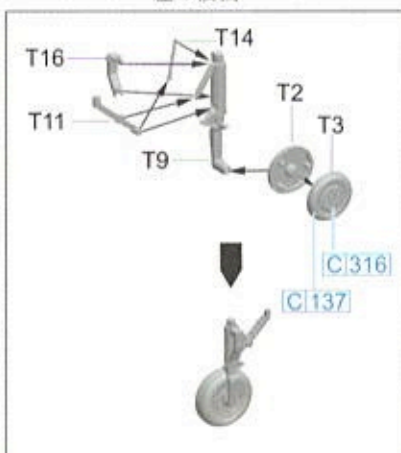

右后輪
Right Main Wheel
右の後輪

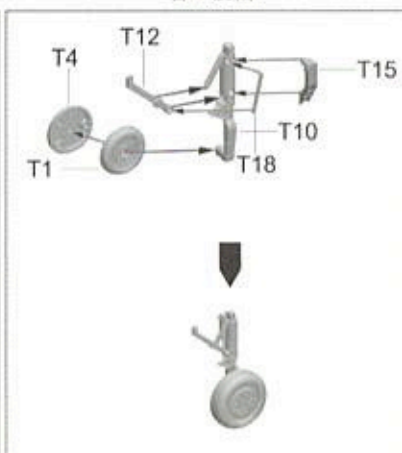

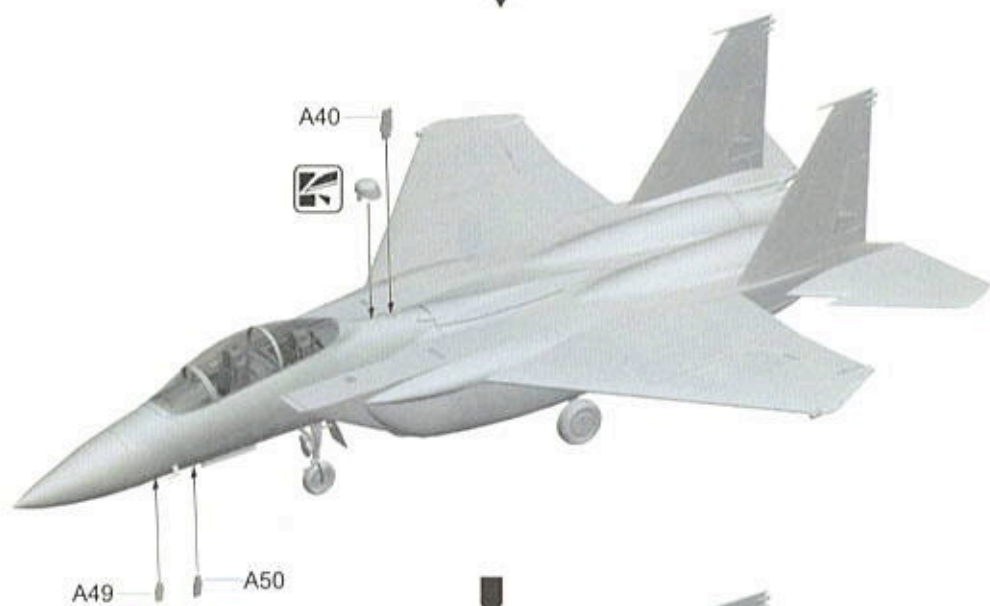
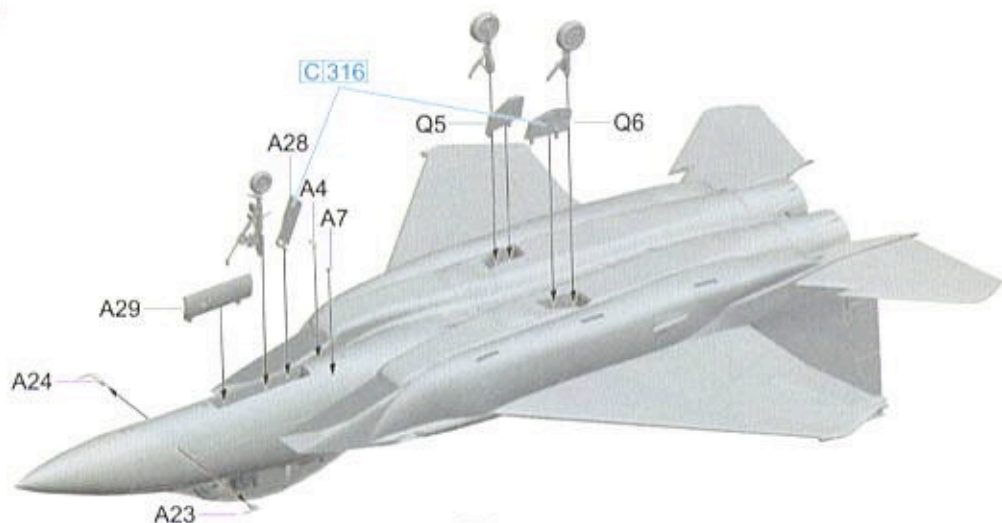

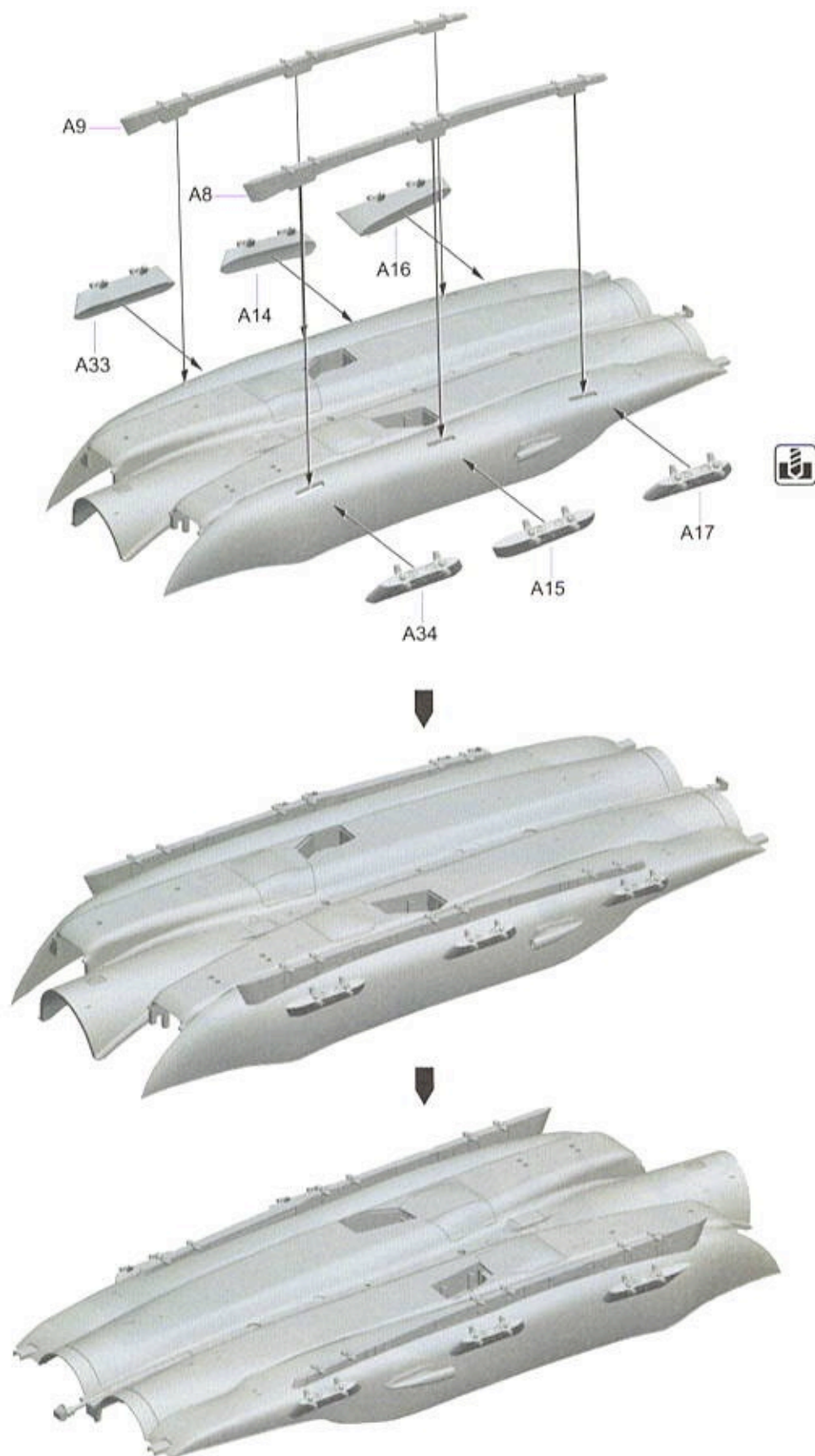



AIM-120B先进中距空导弹 · AIM-120 AMRAAM

X2

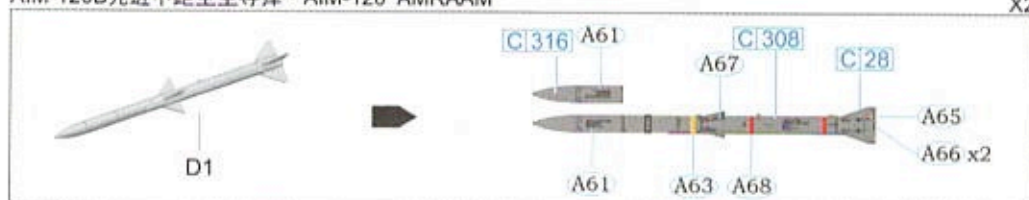

GBU-38

x3

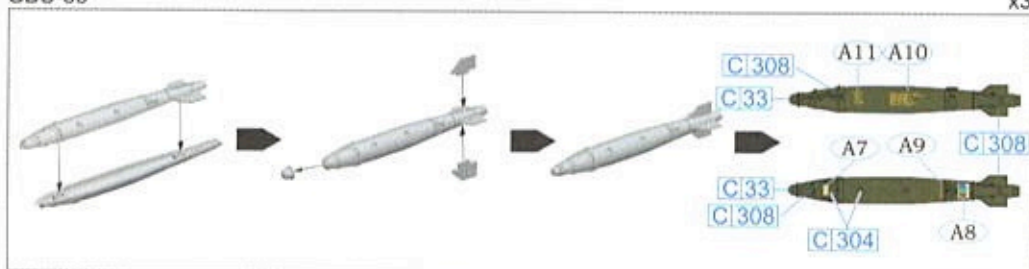

GBU-31

x1

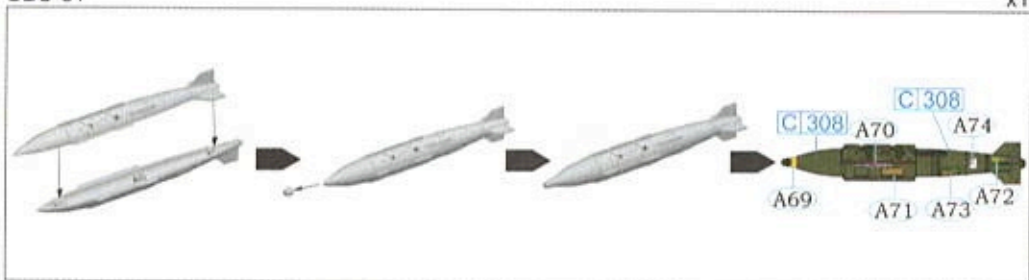

AN/AXQ-14数据指令吊舱 · AN/AXQ-14 Data-link Pod · AN/AXQ-14データリンクポッド

X1



AN/AAQ-14目标指示吊舱 · AN/AAQ-14 Targeting Pod · AN/AAQ-14照準ポッド

X1

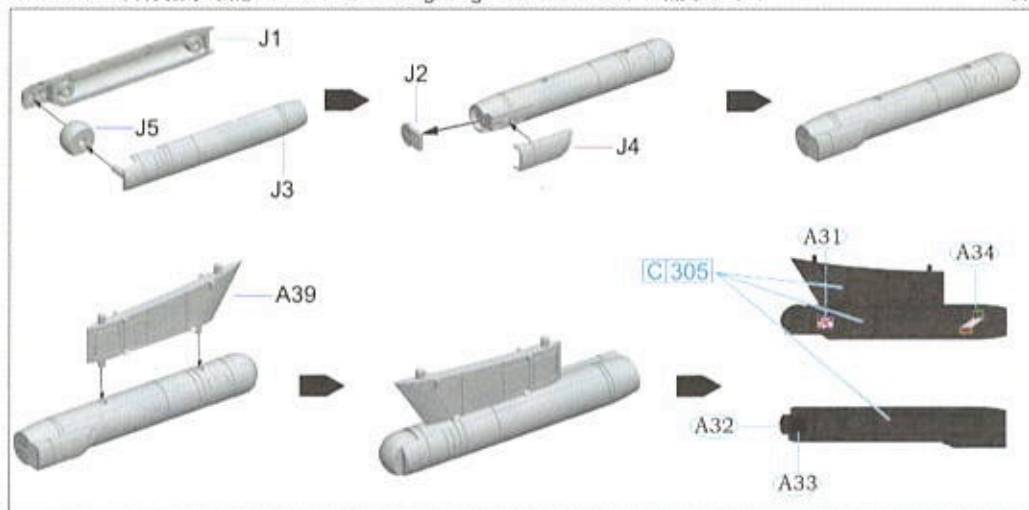

AN/AAQ-13低空导航吊舱 · AN/AAQ-13 Navigation Pod · AN/AAQ-13航法ポッド

X1

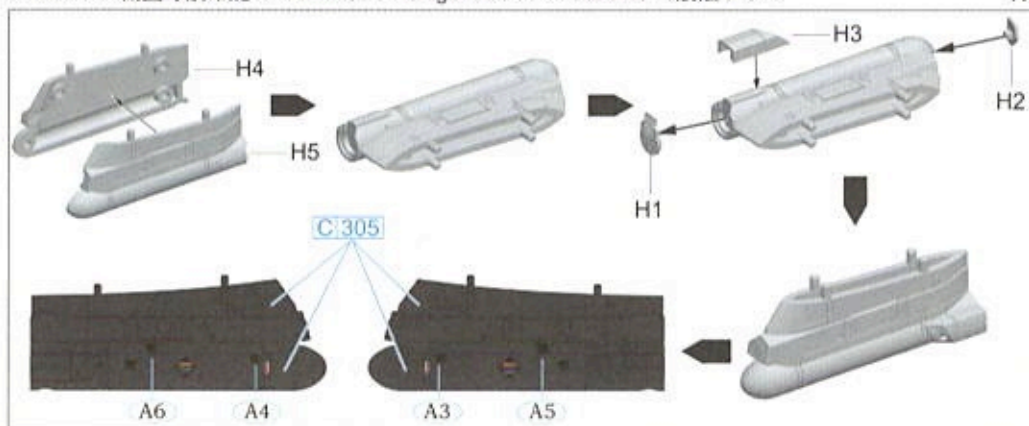

AGM-142

X1

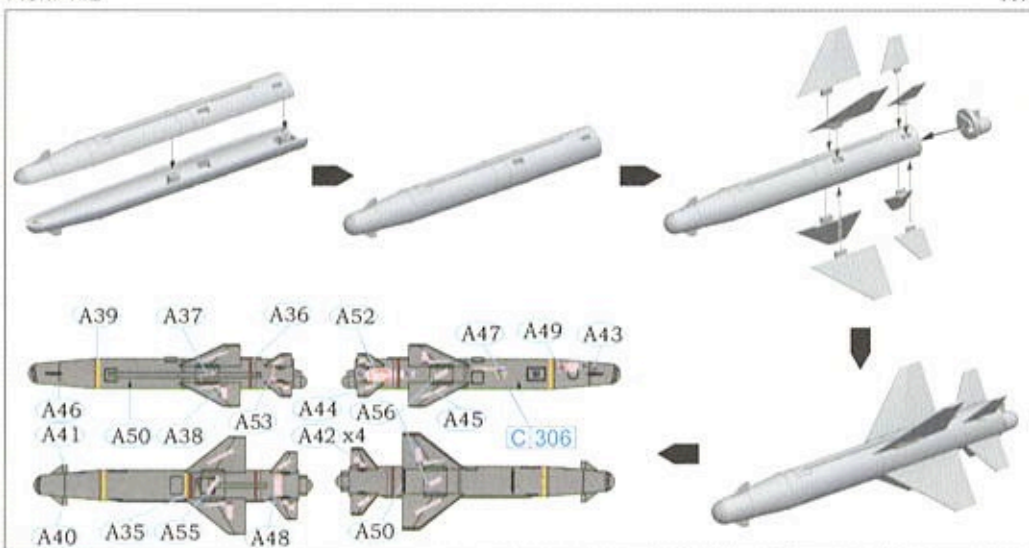

610副油箱・610Drop Tank・610ガロン増槽

X2

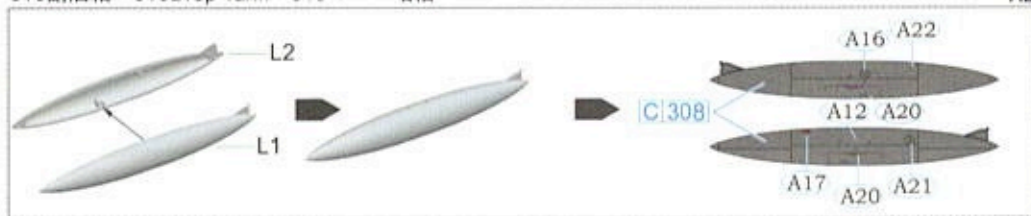

GBU-12激光制导炸弹・GBU-12 Laser Guided Bomb・GBU-12 ベイブウェイII誘導爆弾

X4

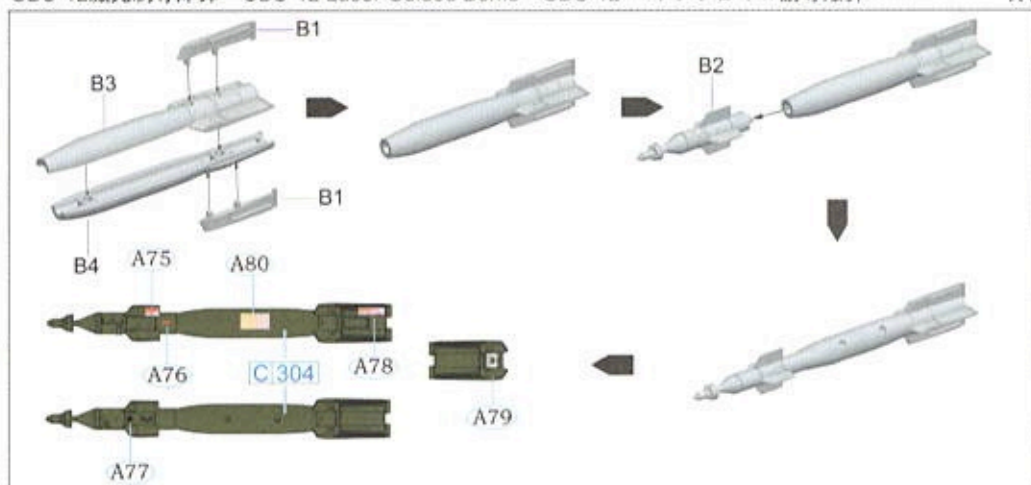

AGM-130

X1

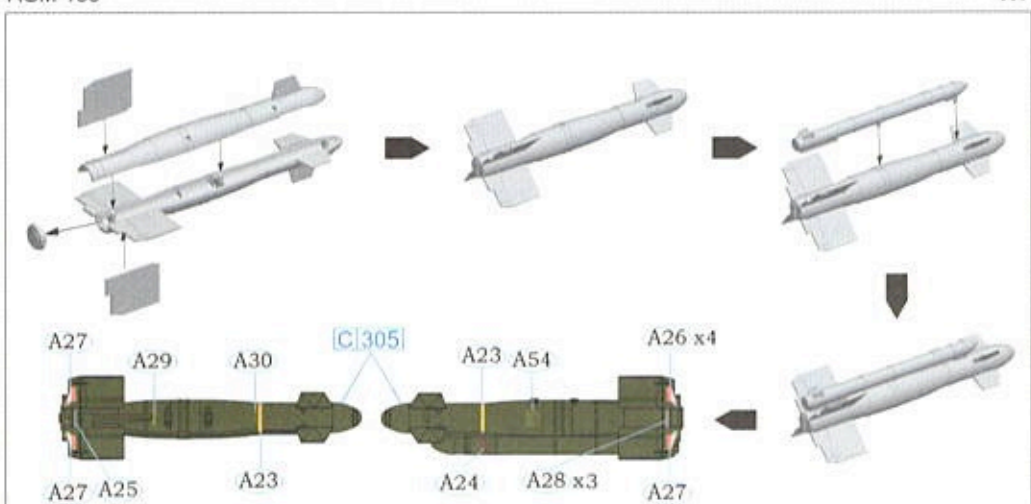

PYTHON-4

X2

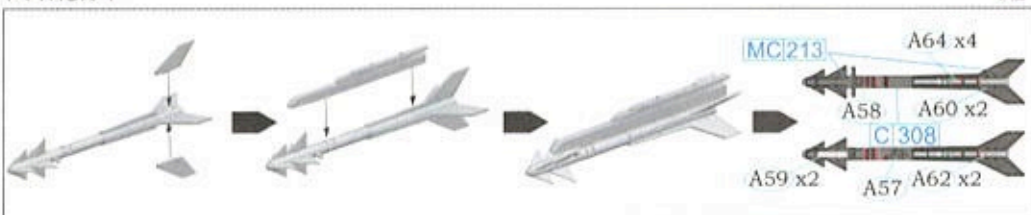

保型油箱附属挂架
Outboard weapon row

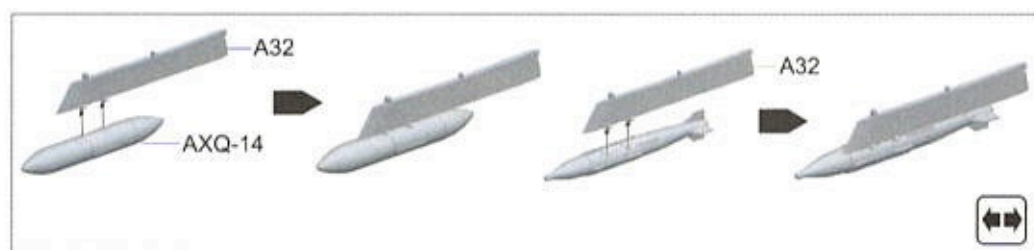
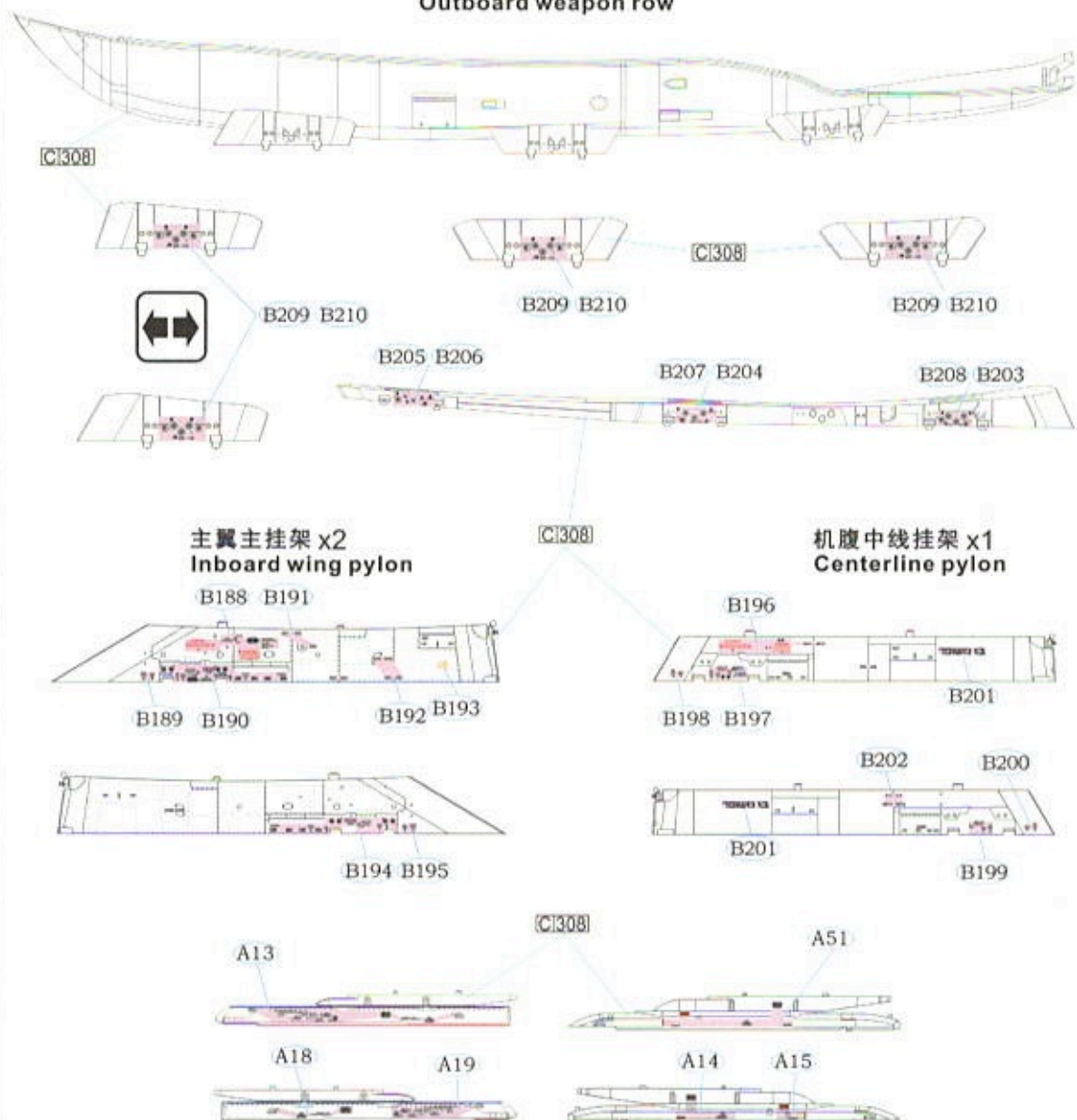

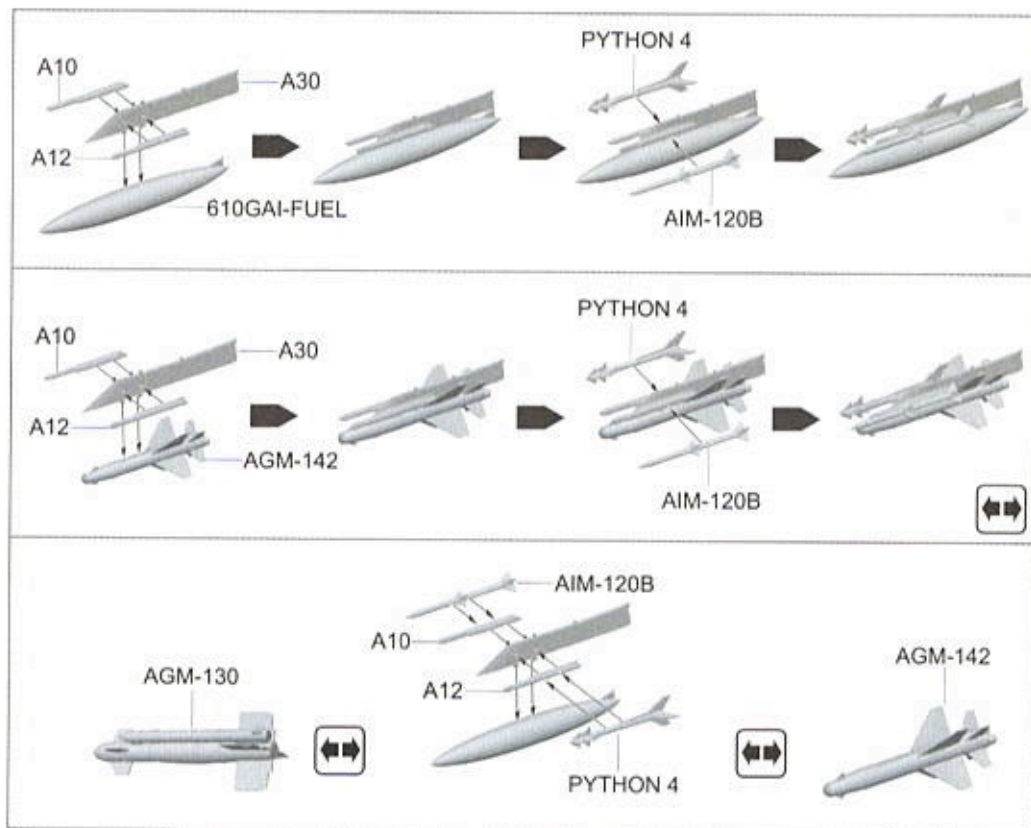

B F-15I Ra'am 以色列国防军空军第69“铁锤”中队, 241号机
 F-15I Ra'am IAF 69 "Hammers" Squadron, No.241

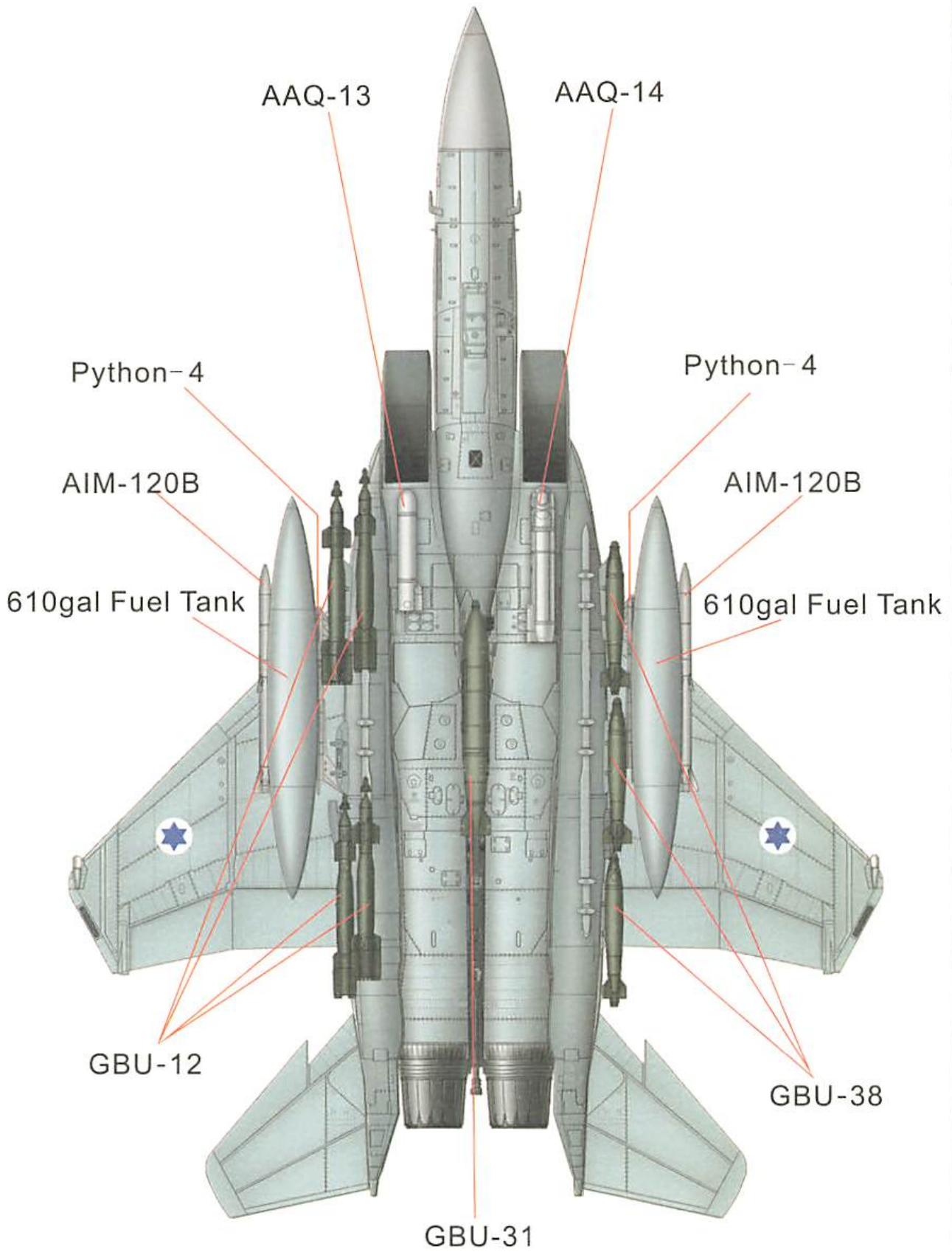

- | | | | | |
|---------------------|-----------|-------------|-------------|-----------|
| AAQ-13 x1 | AAQ-14 x1 | Python-4 x2 | AIM-120B x2 | GBU-38 x3 |
| 610gal Fuel Tank x2 | GBU-12 x4 | GBU-31 x1 | | |

A

F-15I 以色列空军飞行测试评估中队, 201号机 特尔诺夫空军基地

F-15I Israeli Air Force Test & Evaluation Squadron(Manat in Hebrew),No.201 Tel-Nof AFB

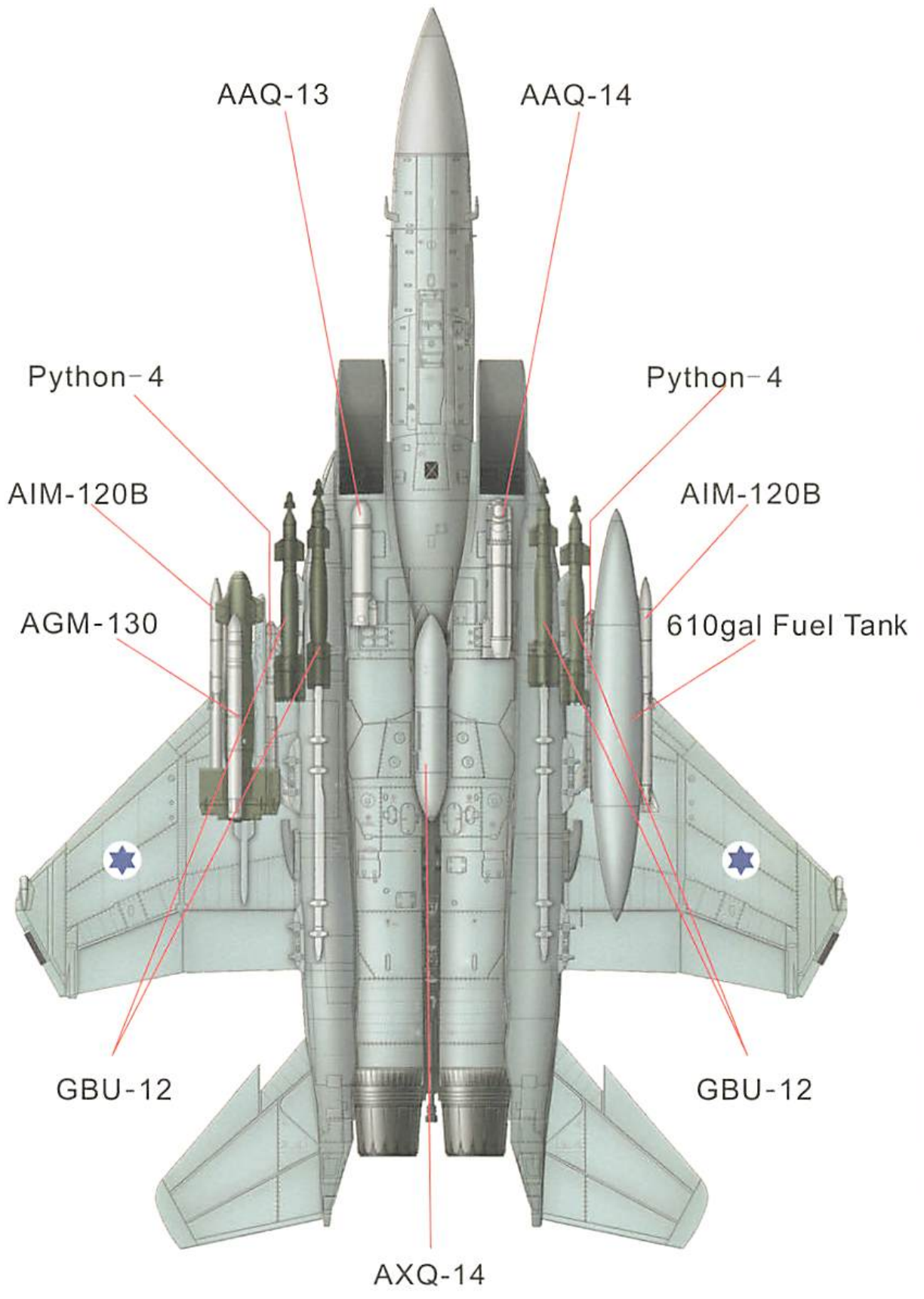

- | | | | | |
|---------------------|-----------|-------------|-------------|----------------|
| AAQ-13 x1 | AAQ-14 x1 | Python-4 x2 | AIM-120B x2 | AGM-130 |
| 610gal Fuel Tank x1 | GBU-12 x4 | AXQ-14 x1 | | |

A

F-15I 以色列空军飞行测试评估中队, 201号机 特尔诺夫空军基地

F-15I Israeli Air Force Test & Evaluation Squadron (Manat in Hebrew) , No.20 Tel-Nof AFB

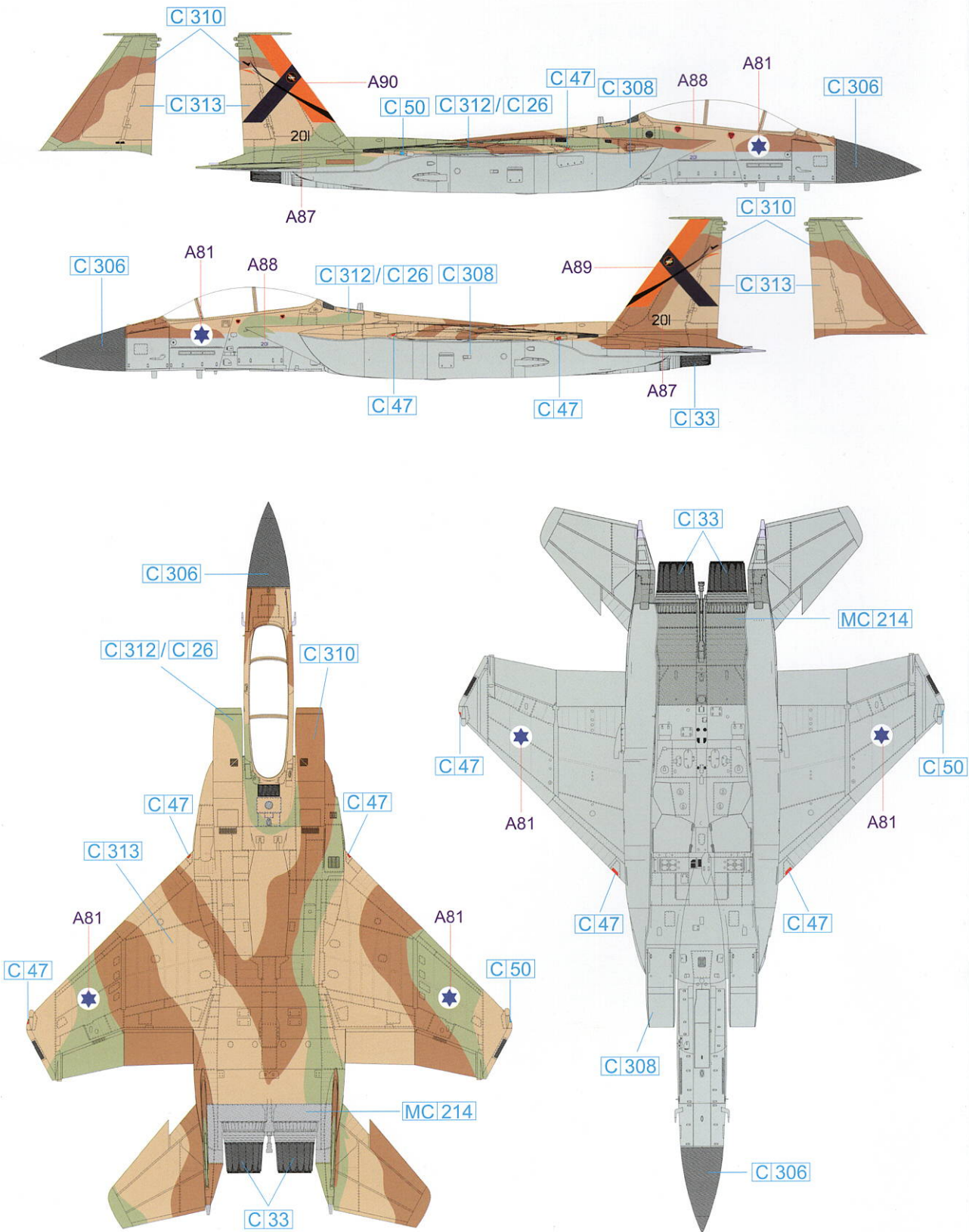

B

F-15I Ra'am 以色列国防军空军第69“铁锤”中队, 241号机
F-15I Ra'am IAF 69 "Hammers" Squadron, No.241

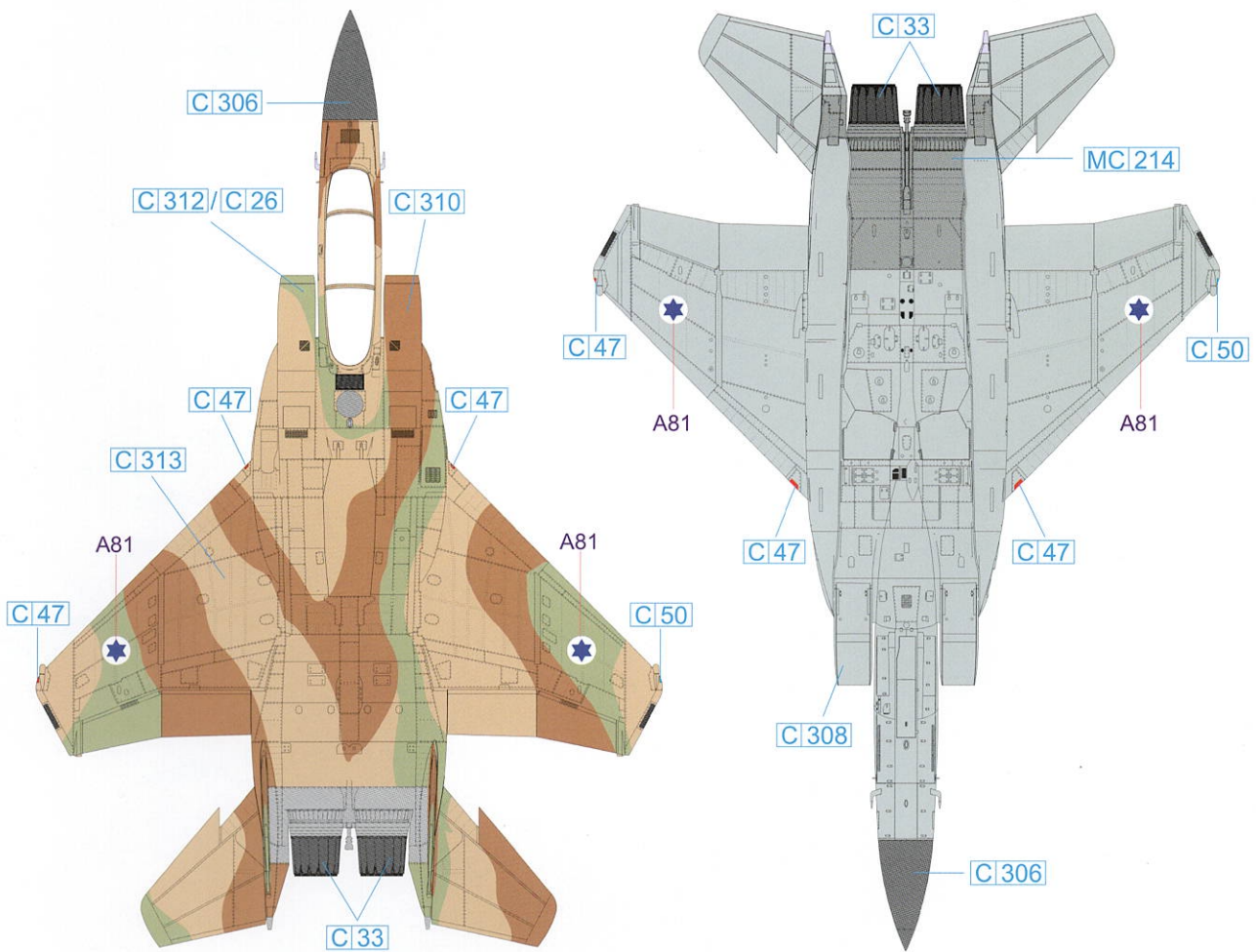
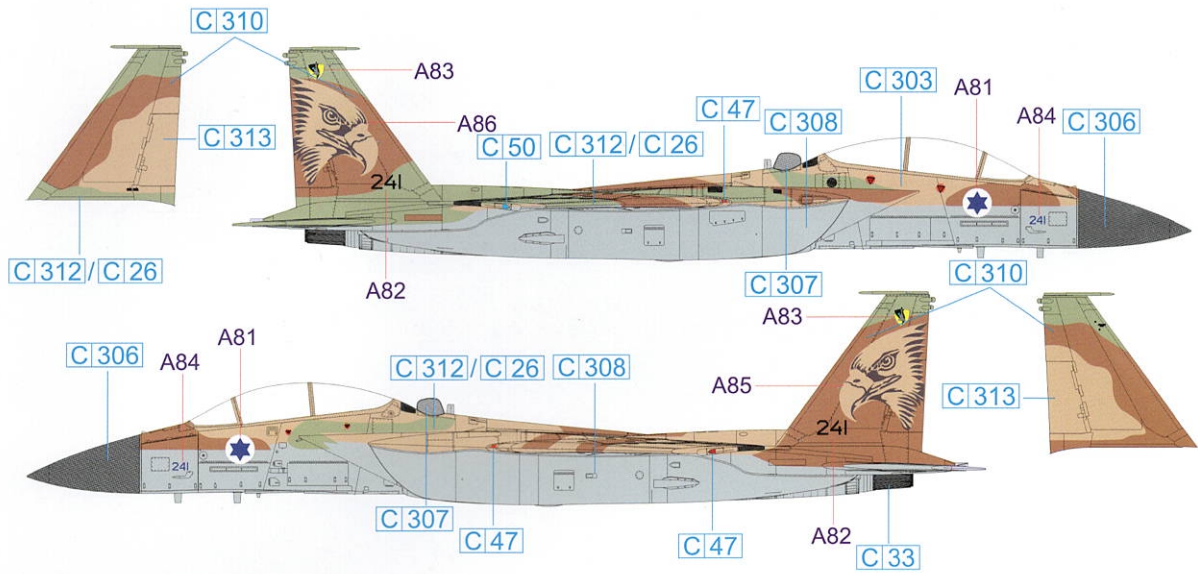

G.W.H.[®]

L7202 F-15I IAF Ra'am

由于说明书组装的零件编号有误，以及水贴编号说明不够合理，特此附上订正网页。给诸位模友带来的不便，谨此深表歉意。

8 p.8

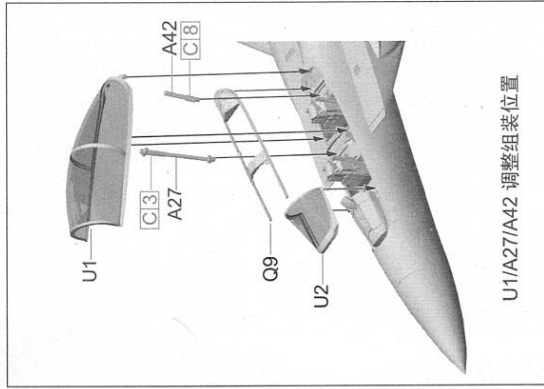

U1/A27/A42 调整组装位置

12 p.11

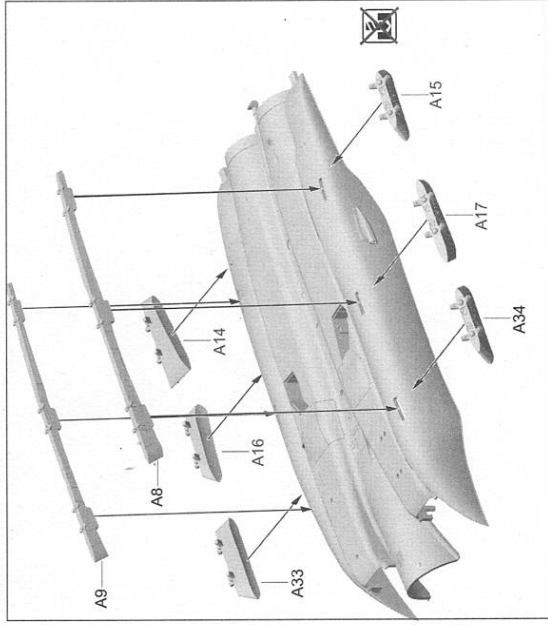

13 p.13
AGM-142

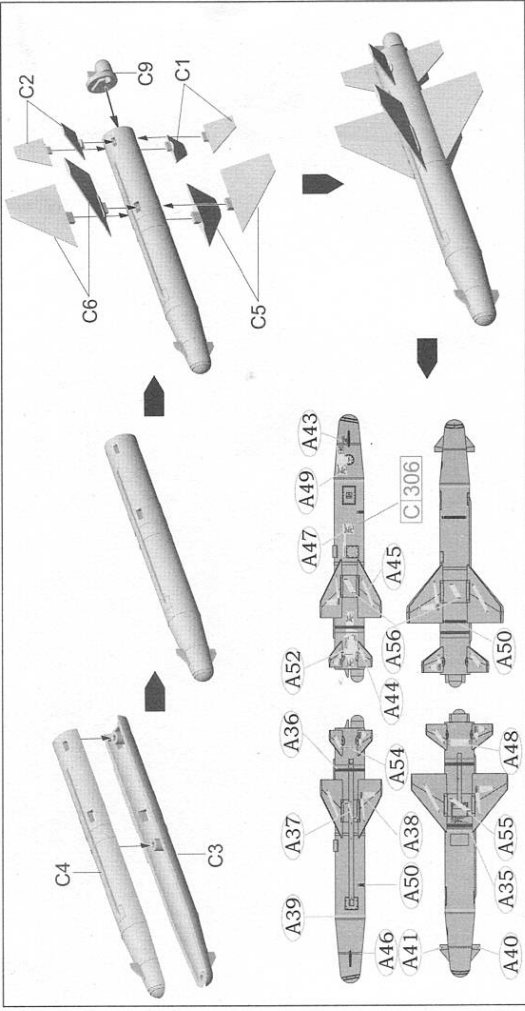

13 p.14
AGM-130

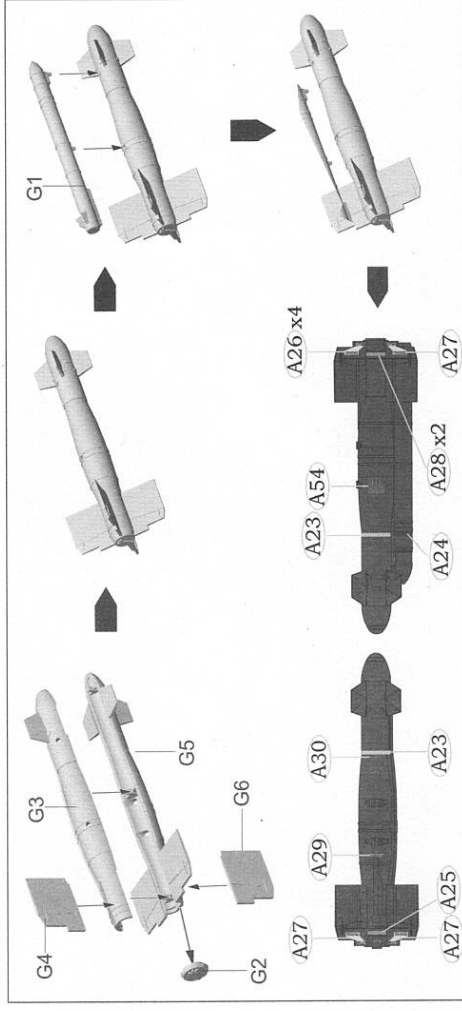

13 p.12
GBU-38

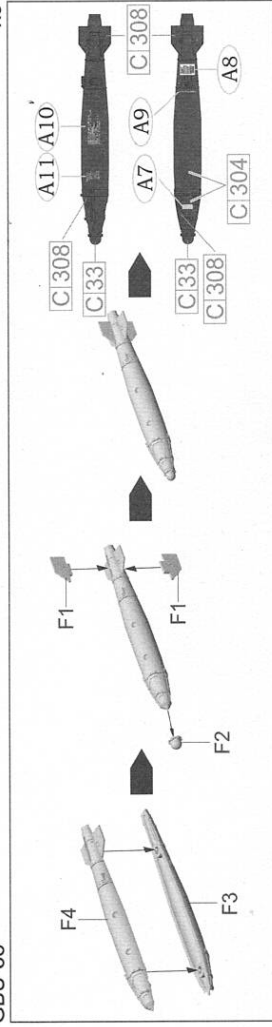

GBU-31

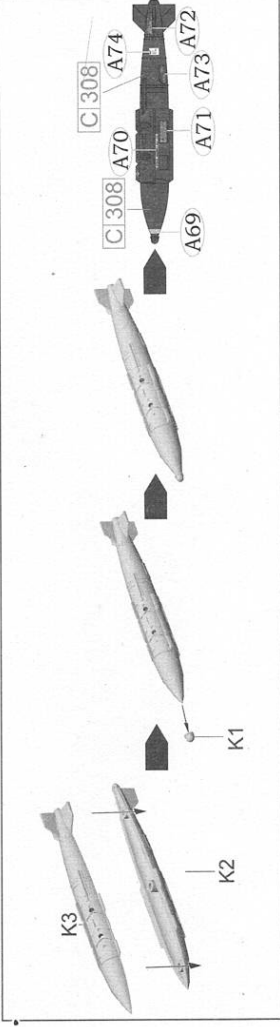

PYTHON-4

