

Bell 412 N302FD exterior set for Italeri 70391

72-AE001

This exterior detailing set is developed for Italeri 1/72 Bell 412 Los Angeles Fire Department – 70391 kit and replacing some of the plastic parts. This manual will help you to build an N302FD helicopter with all data I was able to find.

Unused and replaced exterior part list and unnecessary actions with their representation on original instructions:

STEP 5:

- 1) Do not drill a hole for the hoist mount (Hoist used from the detailing set)
- 2) 33A is modified with E1 (see the instructions below)

STEP 6:

- 1) Replace parts 47A with ST1
- 2) Parts 45A, 100B, 53B unused (not present on the N302FD)
- 3) Raised base for detail 100B should be leveled and the hole filled (not present on the N302FD)
- 4) Part 55A should be used (present on the N302FD, not on instruction)

STEP 8:

- 1) Parts 68A is unused (not present on the N302FD)
- 2) 87C, 59B, 85C, 60B are replaced with the detailing set doors

STEP 9:

- 1) parts 81B, 89B unused (not present on the N302FD)

STEP 10:

- 1) parts 26B, 82B unused (not present on the N302FD)
- 2) 61B, 85C, 87C, 62B are replaced with the detailing set doors
- 3) 90A, 91A, 92A are replaced with the detailing set doors

DECALS:

Nº15,16 are replaced with decals from the detailing set (Nº 4)

Remove castings showed with RED on scheme:

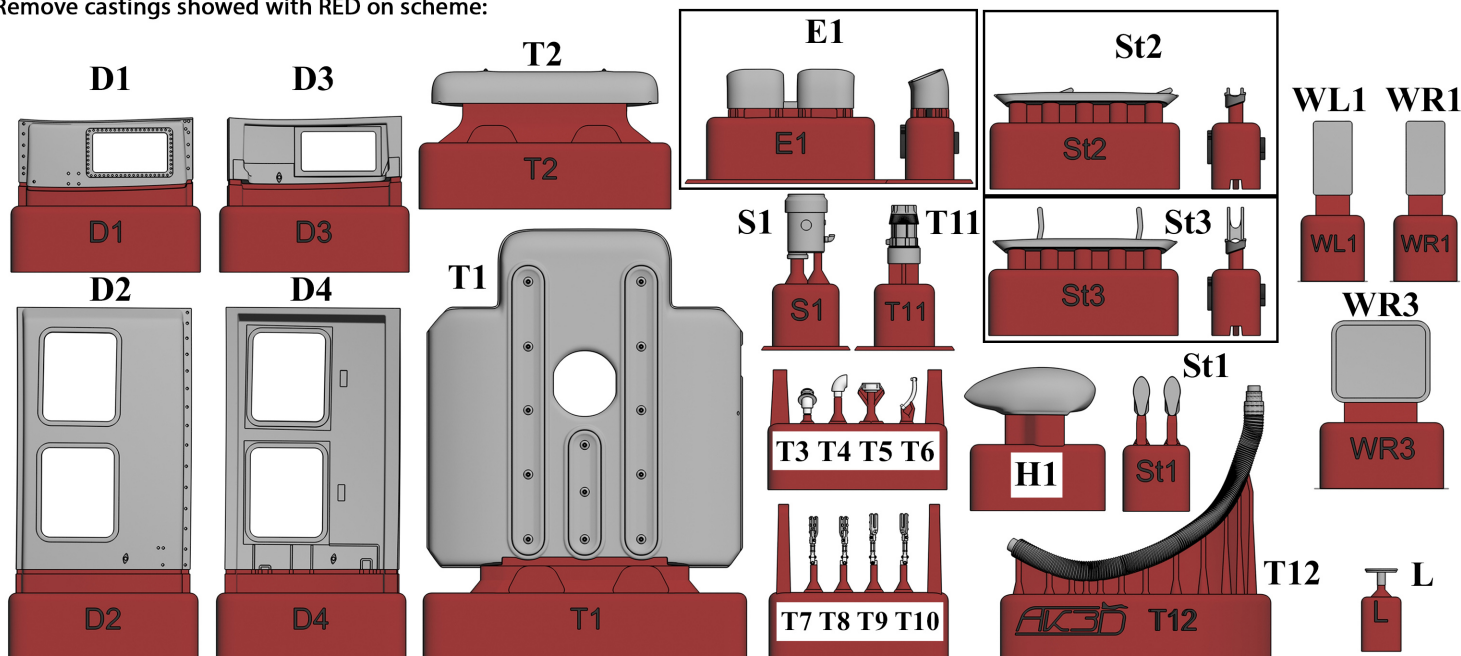

Remove supports from 3D printed parts.

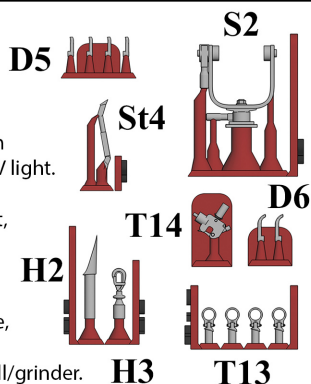

These parts of the kit are made from photopolymer resin, sensitive to UV light.

Parts should avoid of direct sunlight, until primed or painted.

Detaching parts from a supports is recommended with sharp blade, file, nippers or mill/grinder.

For thicker supports, use saw or drill/grinder.

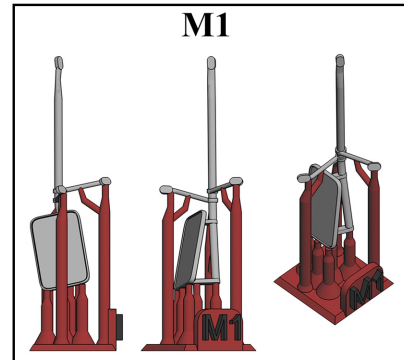
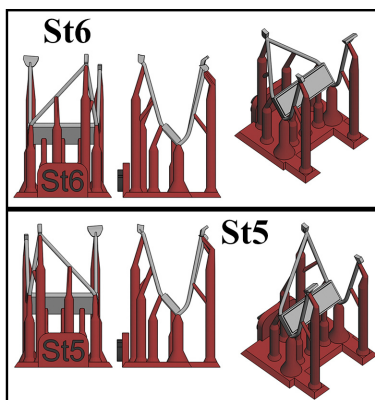

Landing gear skids assembly manual

Remove castings showed with RED on scheme:

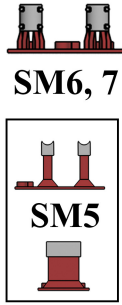
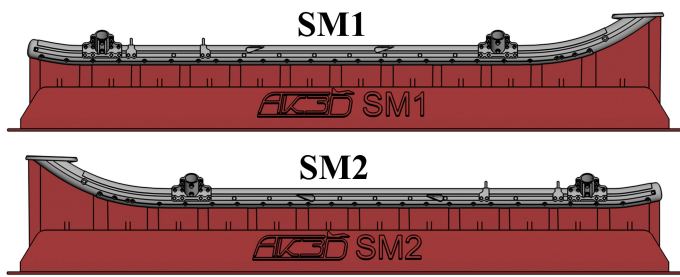

Bending jig parts:

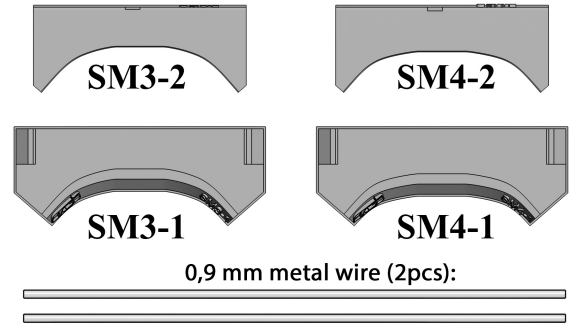

1 Slide part SM3-2 into SM3-1

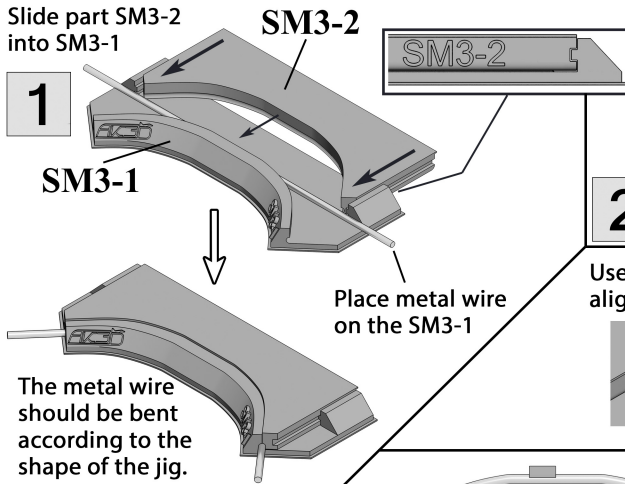

2

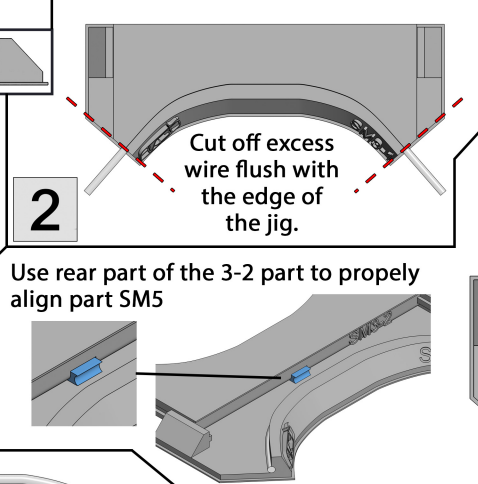

3

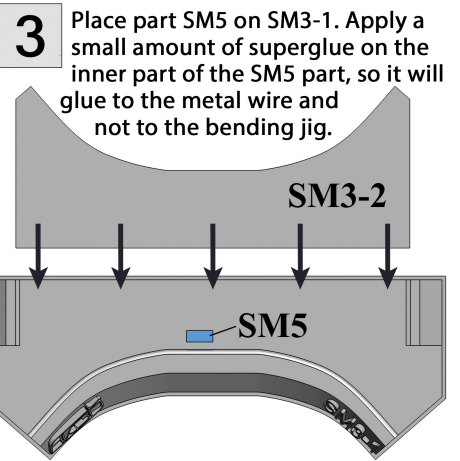

4

Use the same method to create rear cross-tube. This time use parts SM4-1 and SM4-2 instead of SM3-1 and SM3-2.

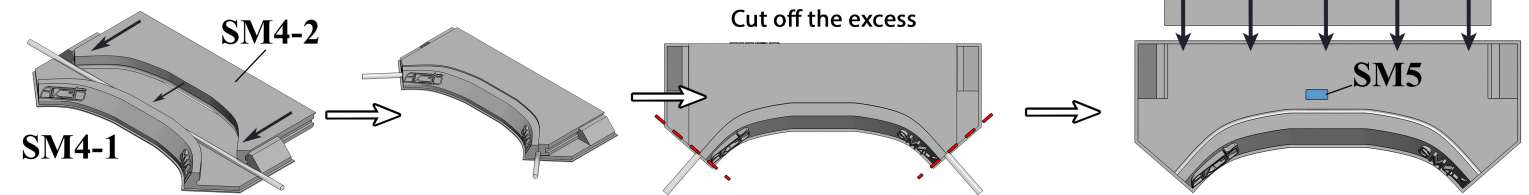

5

File the edges of the wire to facilitate insertion into the skids parts (SM1; SM2) and threading of SM6 and SM7 parts.

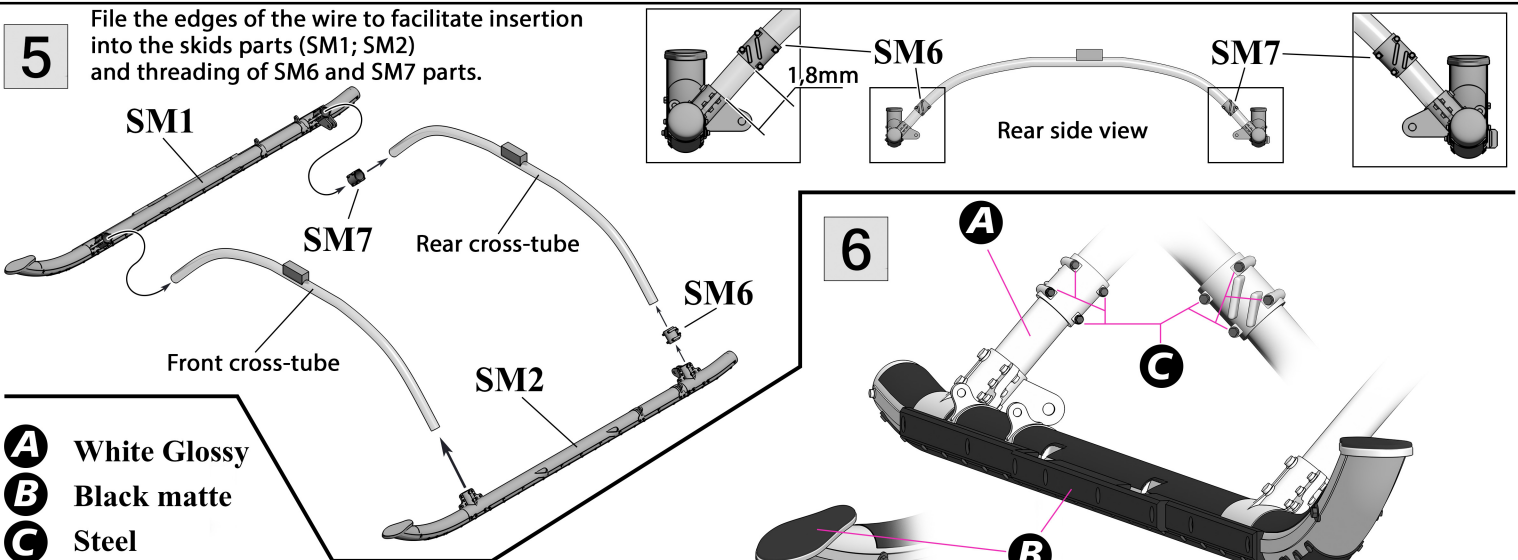

6

- A** White Glossy
- B** Black matte
- C** Steel

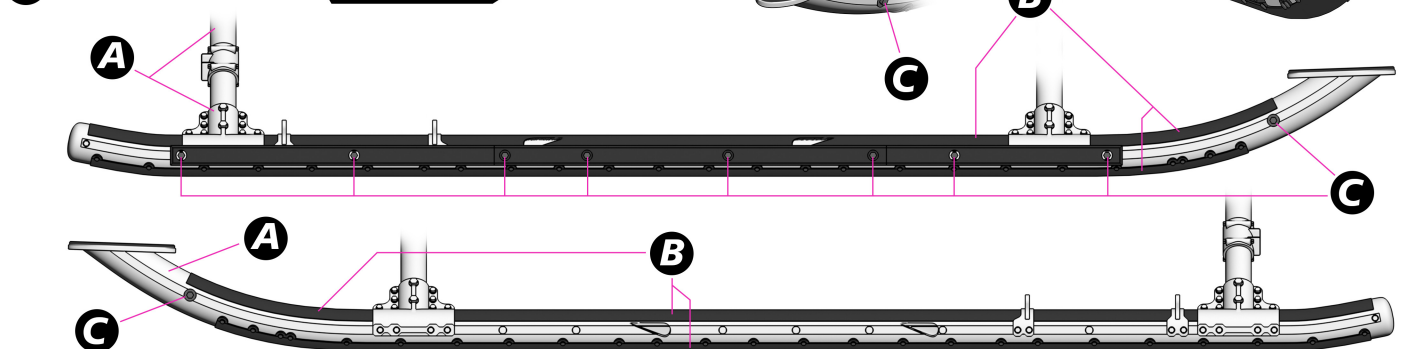

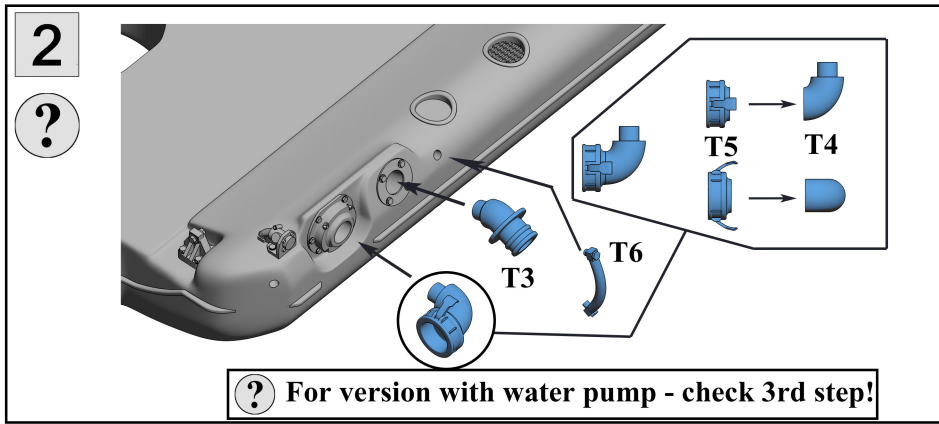
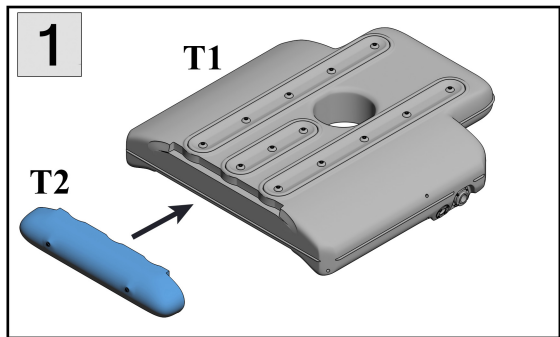

For version with water pump - check 3rd step!

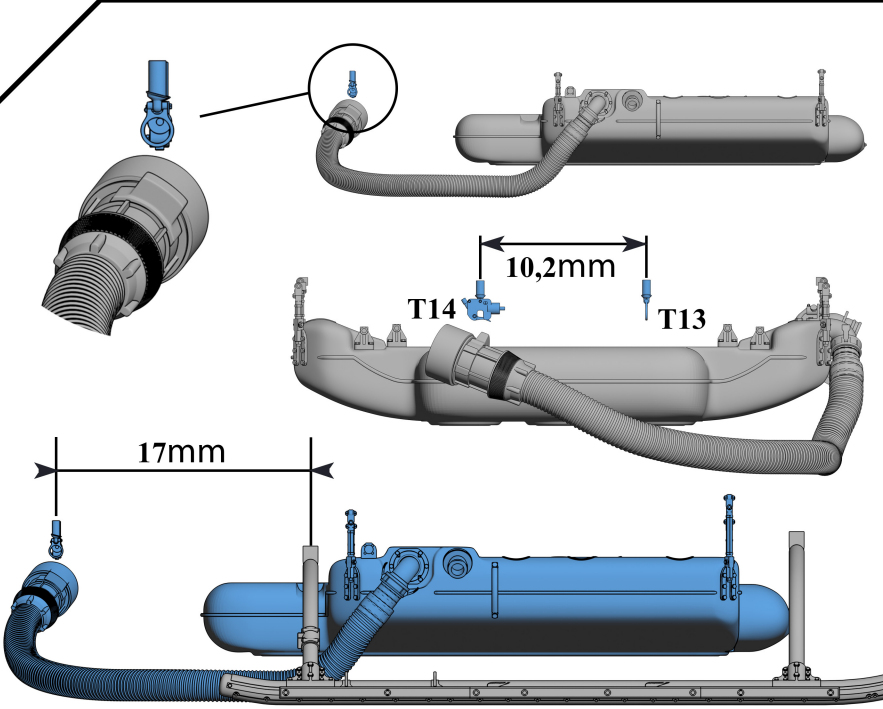
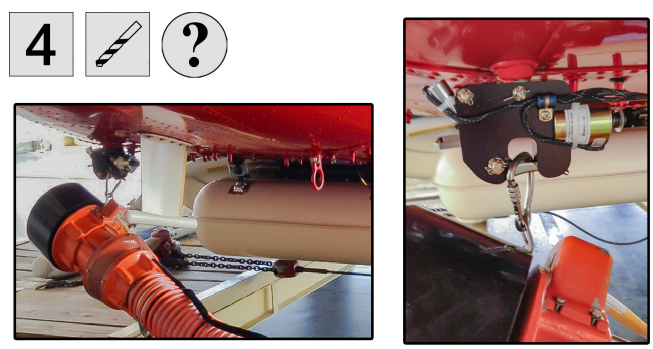
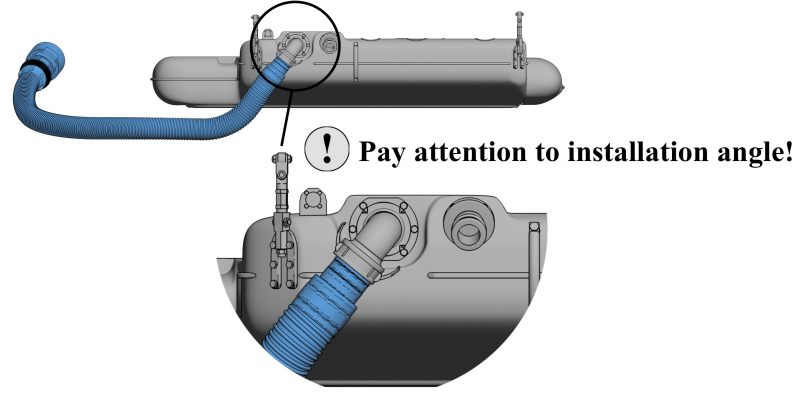
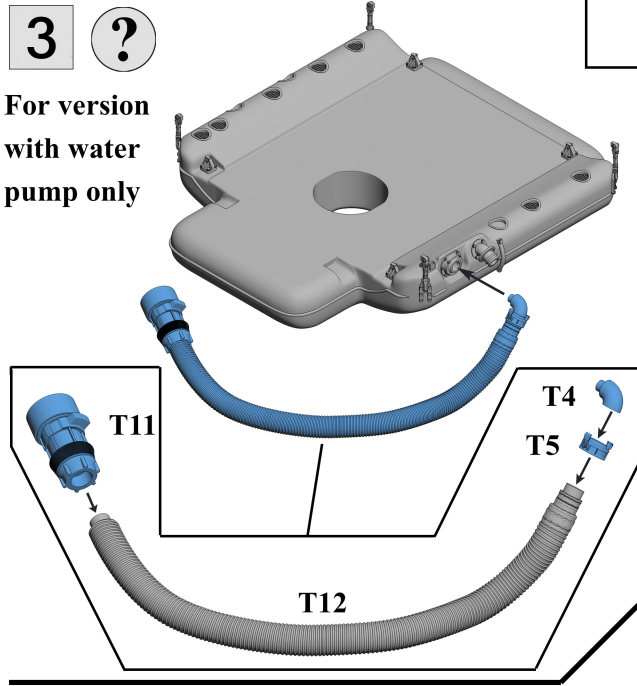

Drill the two holes for parts T13 and T14 on a kit hull with a 0,5mm drill bit.
 Placement of the holes can be found with the help of provided measurement, fixed to the rear Skid and center axis. If you don't want to use water pump - use second T13 part instead of T14.

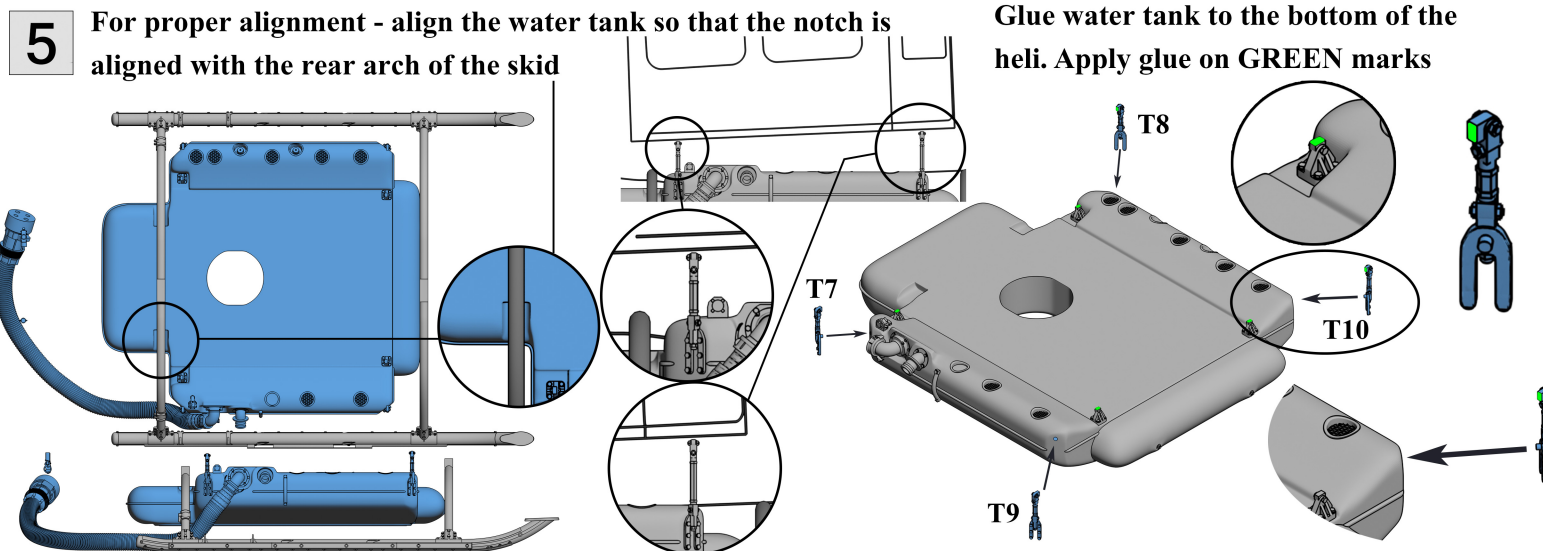

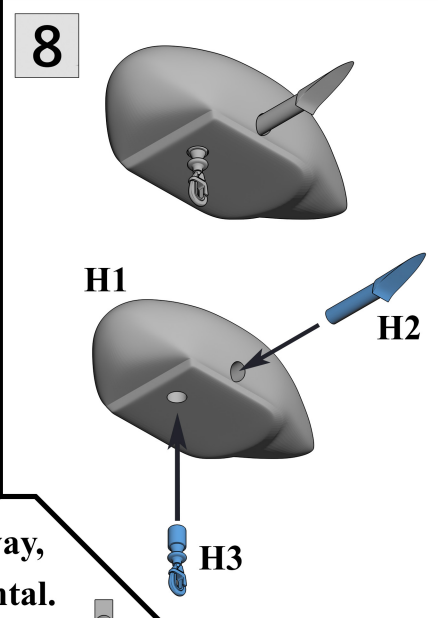
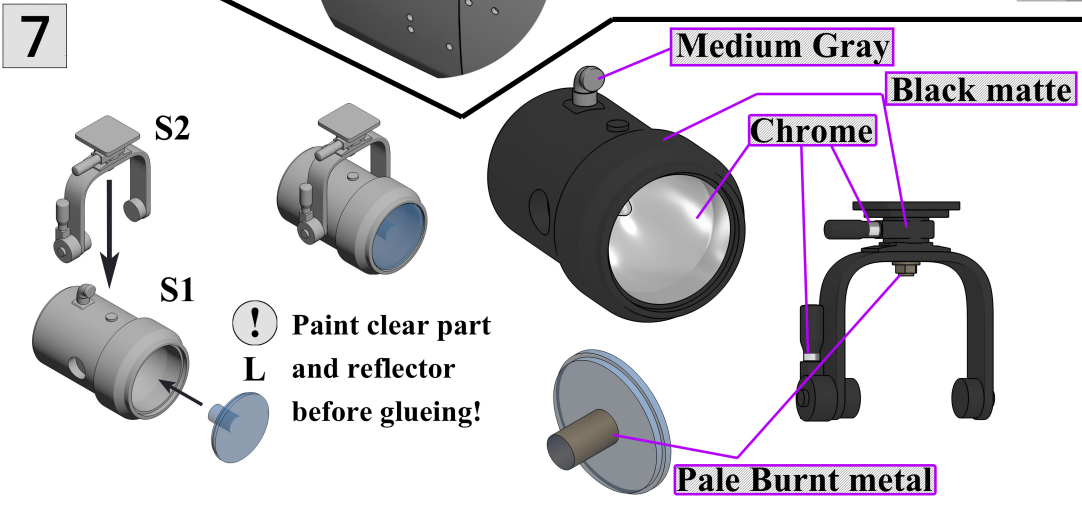
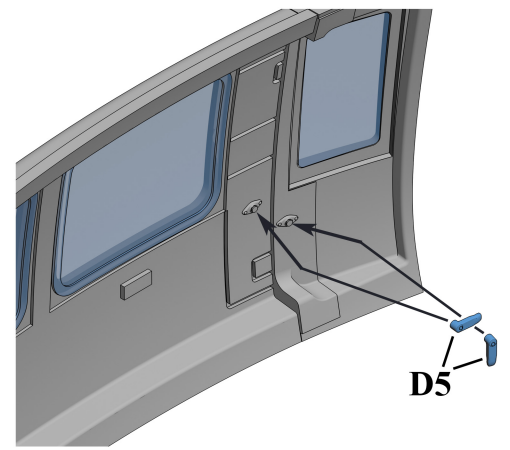
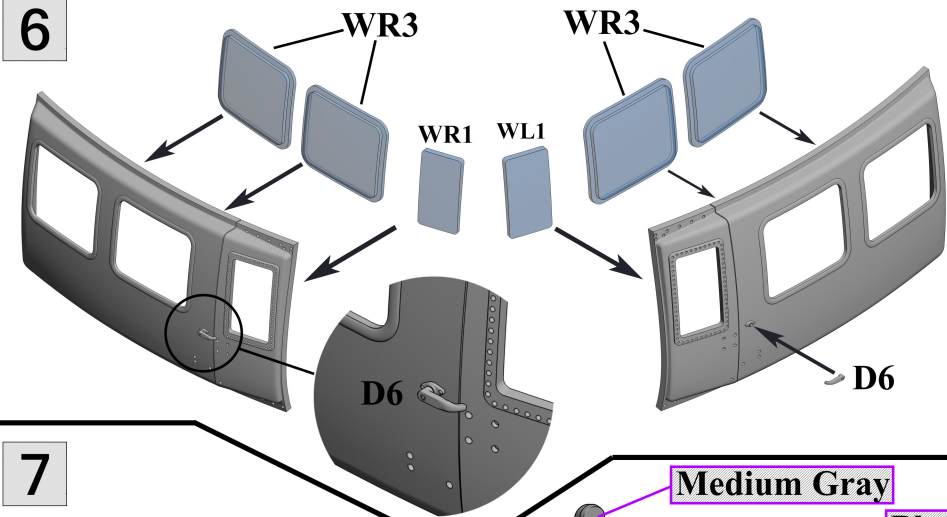

9 ? Electric steps (St2 or St3) should be aligned on a skid in a way, so their top surface should be horizontal.

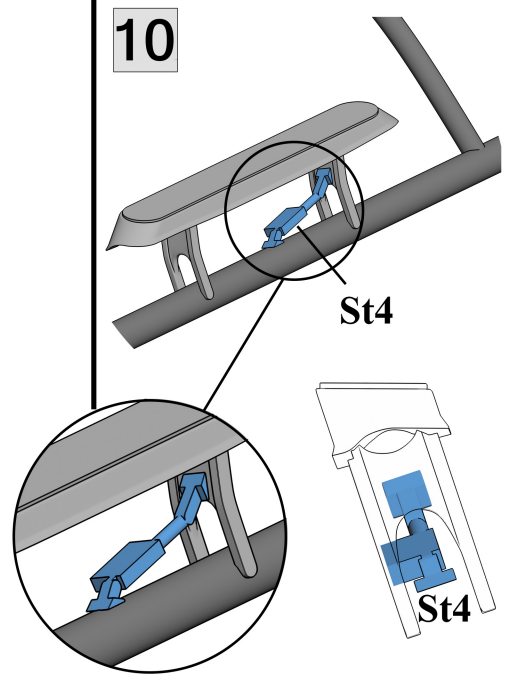
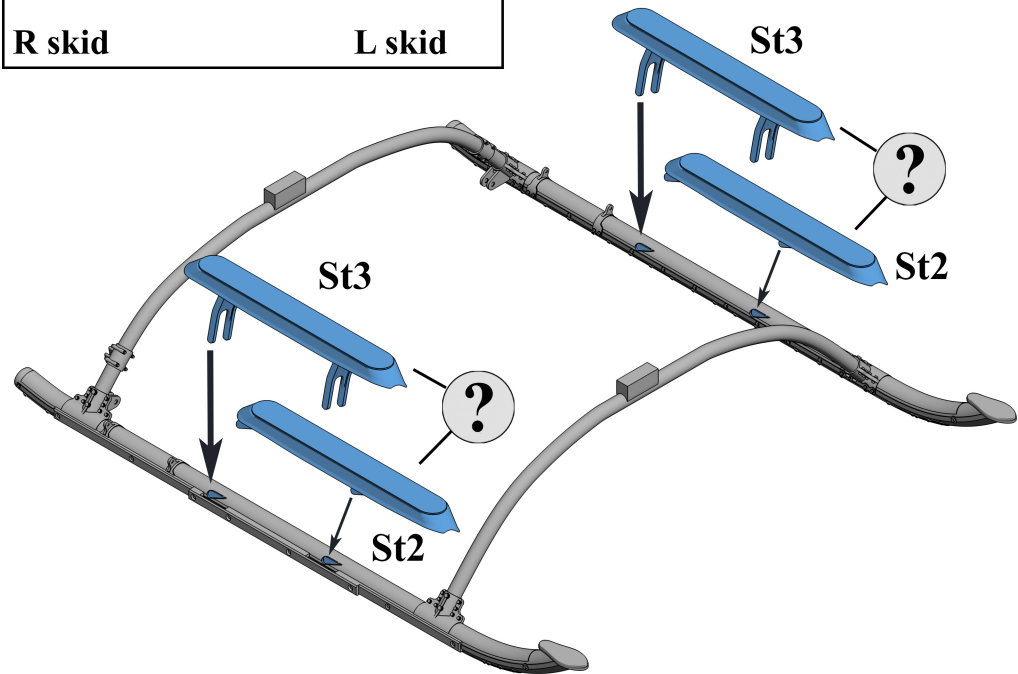
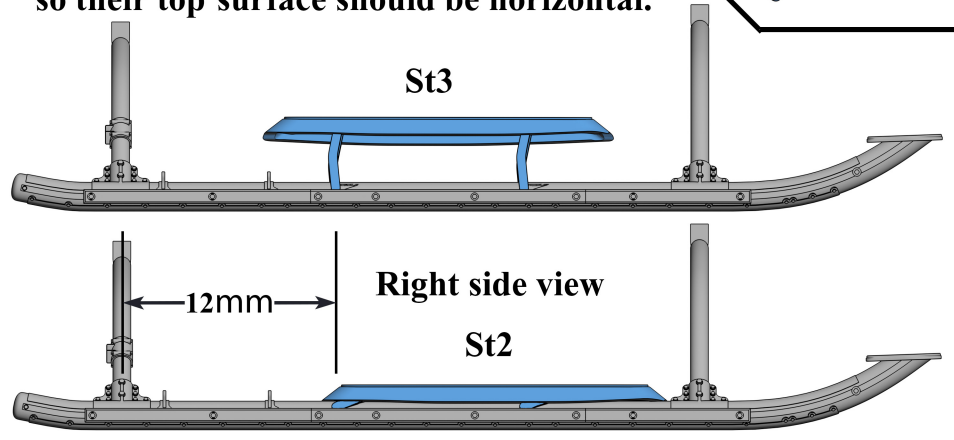
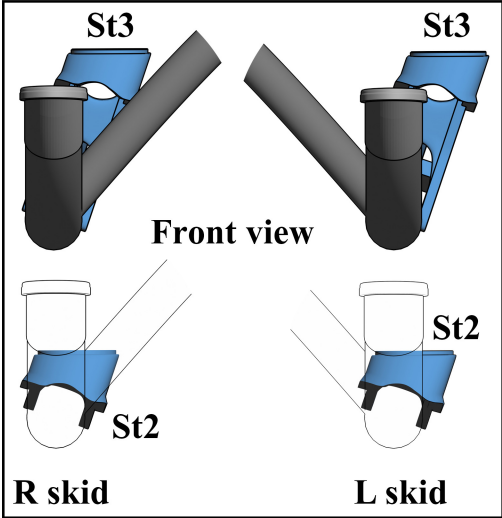

11

At STEP5 of Italeri kit, cut the wrong exhaust pipes from part N°33a (marked with RED on the scheme). After assembly of parts 30a, 31a, 36a, 37a, a38b, 29a,32a and 33a - glue part E1 from this set to back side of parts 29a and 32a.

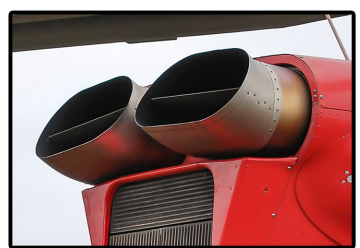
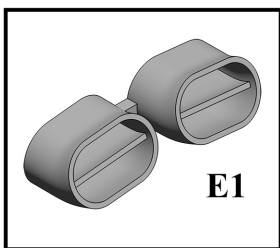
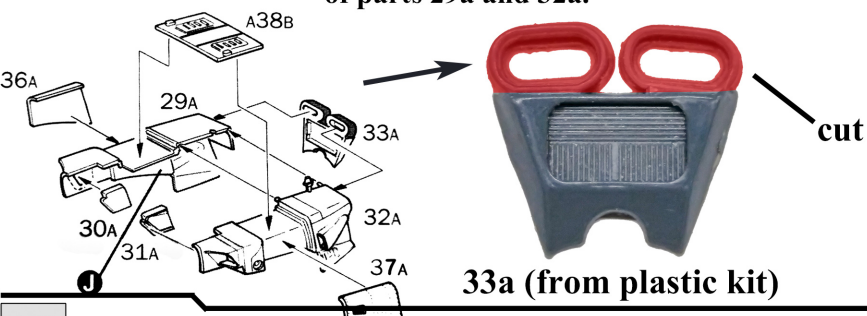

12

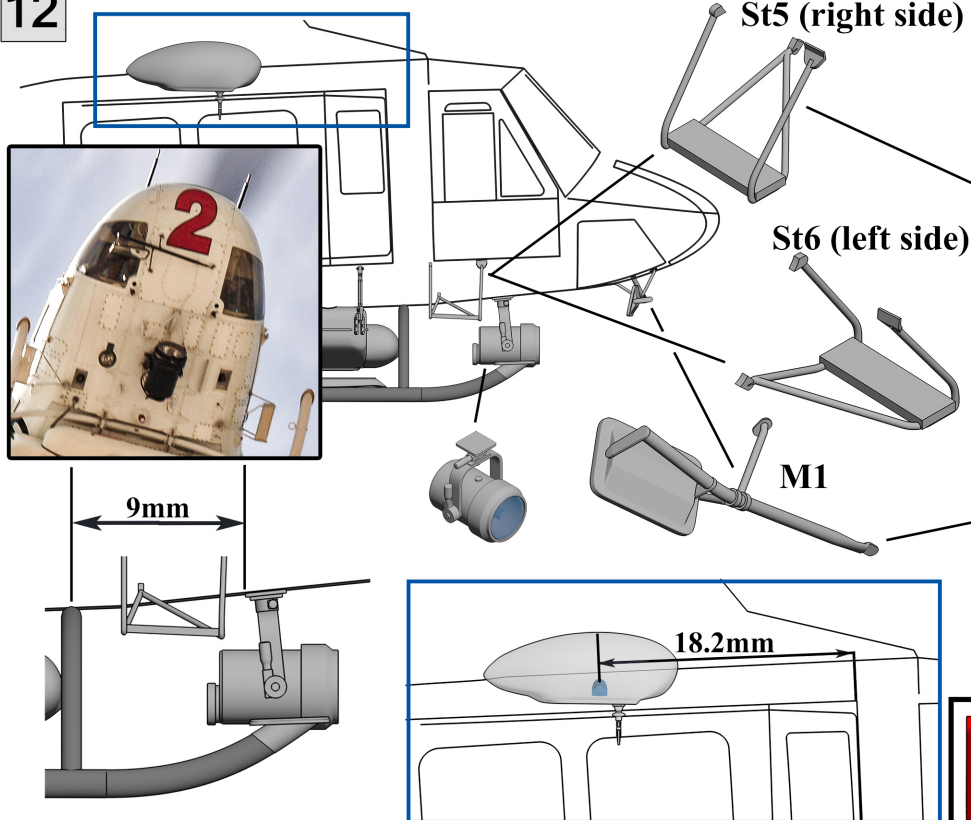

Decals

The decals in this set are completely covered with varnish. You need to cut out each decal along the outline, with a slight indentation.

Use special solutions to soften and transfer decals

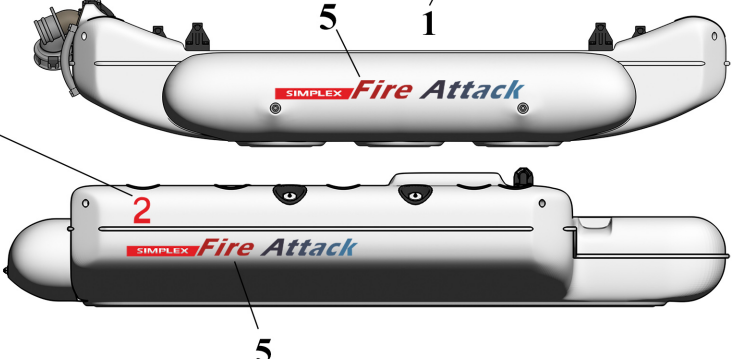
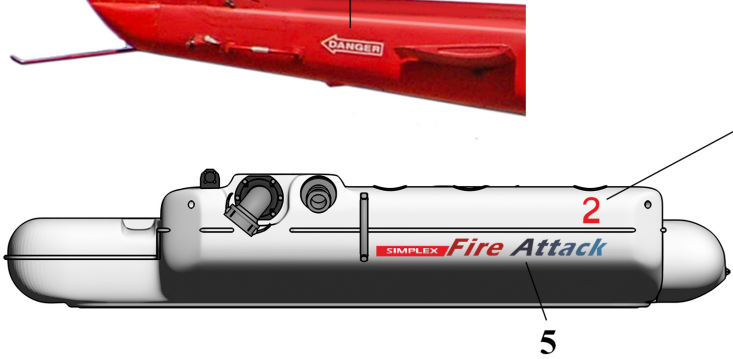
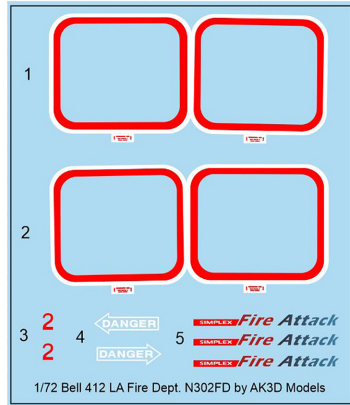

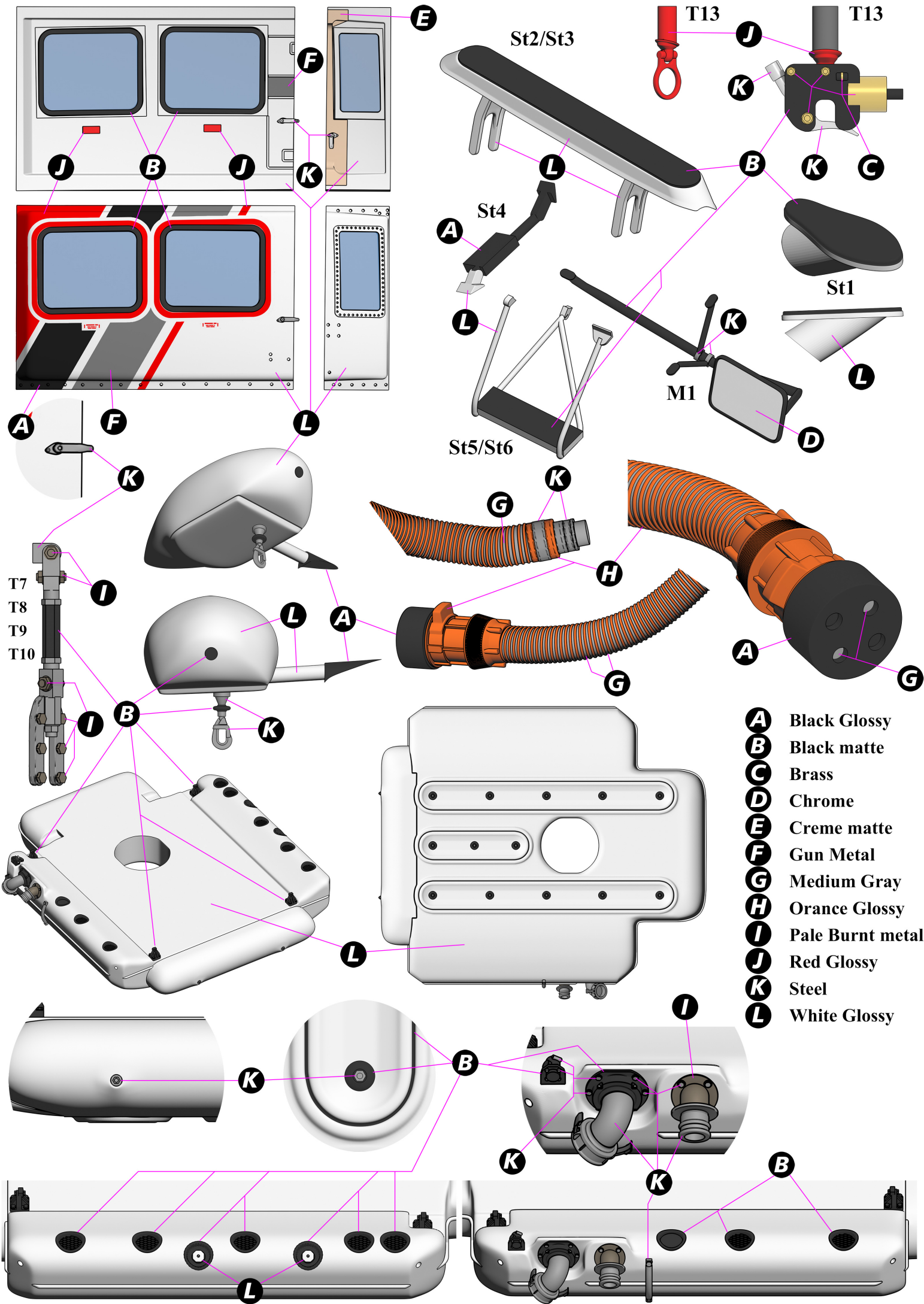

- A** Black Glossy
- B** Black matte
- C** Brass
- D** Chrome
- E** Creme matte
- F** Gun Metal
- G** Medium Gray
- H** Orange Glossy
- I** Pale Burnt metal
- J** Red Glossy
- K** Steel
- L** White Glossy

