

# 1/144 AC-130A Gunship “Azrael, Angel Of Death”



*Legends in the making™*



First deployed in the late 1960's the United States Air Force recognized the heavy weight carrying capacity and long duration flight of the C-130. These attributes made the C-130 an ideal aircraft to be adapted to serve as an airborne gun platform for accurate high volume fire directed at enemy locations. The C-130A named "Azrael" first operated in Viet Nam and proved the effectiveness of the C-130 gunship concept.

Minicraft Model Kits new #14593 represents the C-130A deployed in Vietnam and includes both 105 MM gun and 7.65 "miniguns" used so effectively to blanket enemy positions in South-east Asia in the late 1960's and early 1970's. Kit includes several armament options including proto-type armament, operational armament and markings for both the proto-type aircraft and Azrael, Angel of Death".

14593

A FUSELAGE PARTS SPRUES

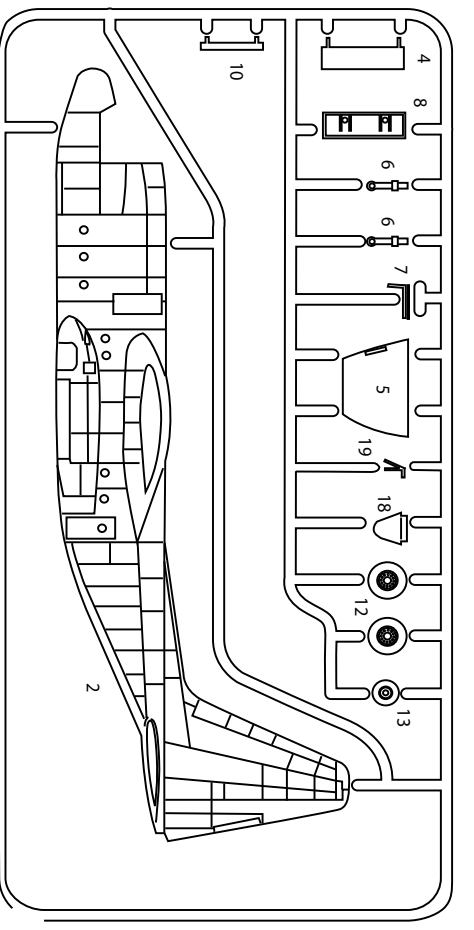
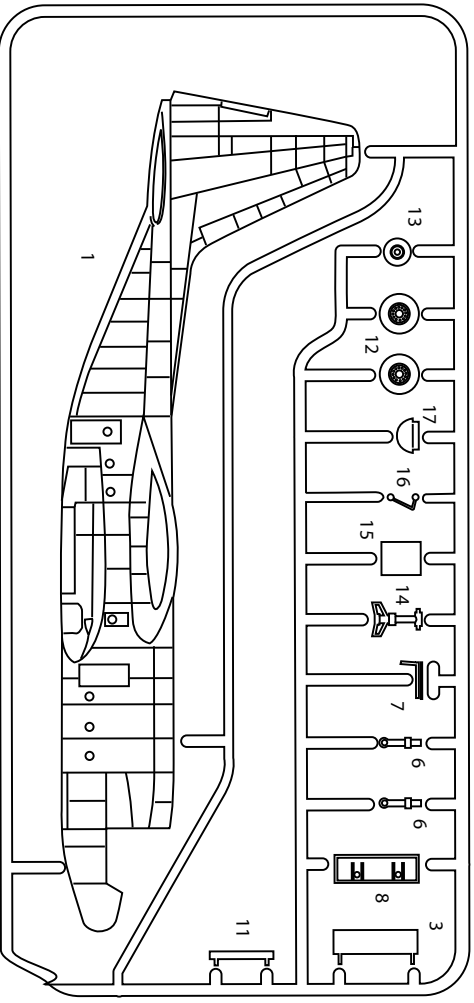

B WING / ENGINE / TANK PARTS SPRUE

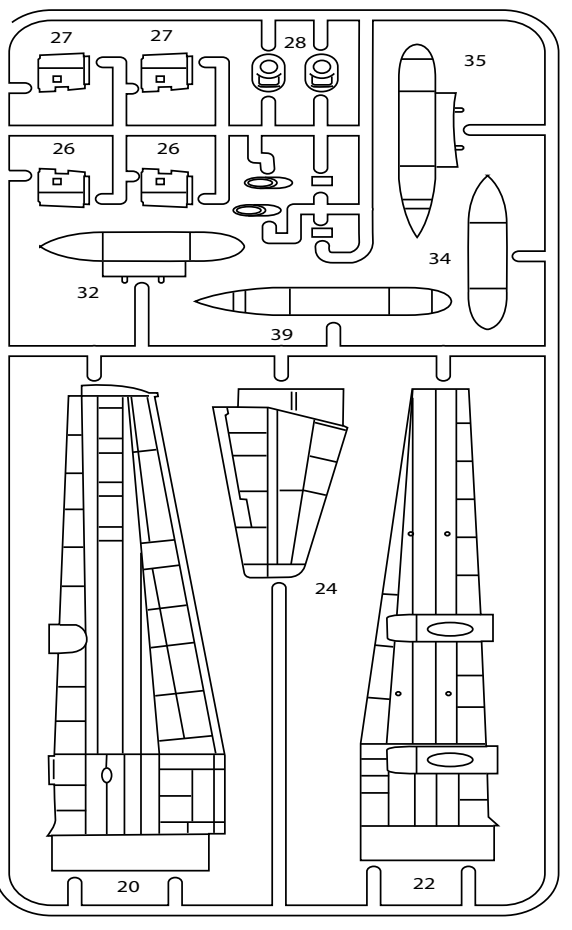
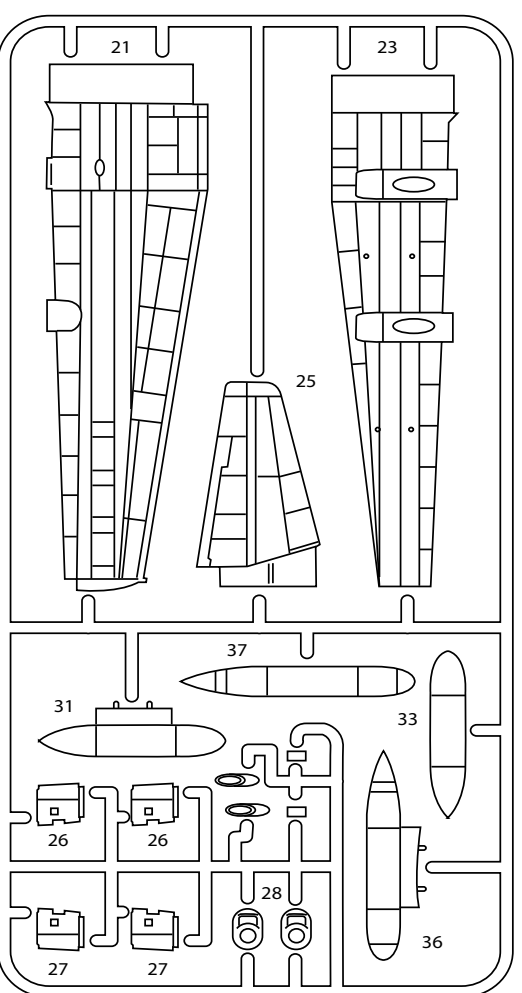

G GUNSHIP PARTS SPRUE

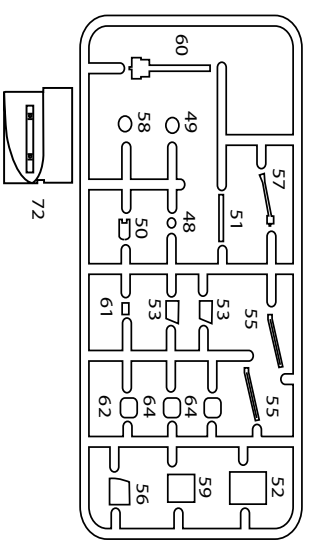

D PROPELLER / ROMAN NOSE SPRUE

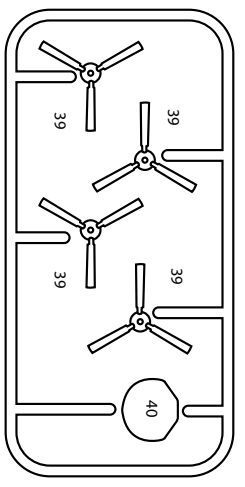

C CLEAR PARTS SPRUE

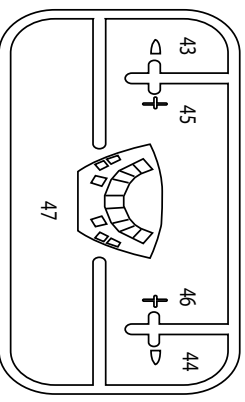

INTERIOR PARTS SPRUE

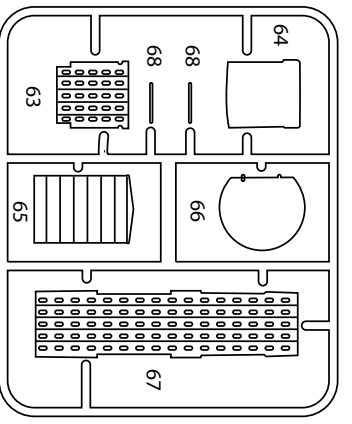



Cement  
Coller  
Kleben  
Pegar  
Incollare  
Colar  
Kleven



DO NOT Cement  
Ne pas Coller  
Nicht Kleben  
No Pegar  
Non Incollare  
Nao Colar  
Niet Kleven



Cut away  
Couper  
Scheiden  
Cortar  
Tagliere  
Cortar  
Snijden



Optional parts  
Choix  
Auswahlmöglichkeit  
Eleccion  
Scelta  
Opaco  
Keuze



3

Repeat operation  
Répétez l'opération  
Vorgang wiederholen  
Repitir la operacion  
Ripetere  
Repitir a operacao  
Herhalen



Symmetrical assembly



Drill hole

## PLEASE NOTE

Your MINICRAFT model kit has been precision engineered and designed to allow the modeler to build different variants of the AC-130. Early AC-130s carried various combinations of armament, sometimes varying from mission to mission. Refer to the decal placement guide for options available to the builder, and review the instruction sheet before beginning assembly.

# AC-130A ONLY

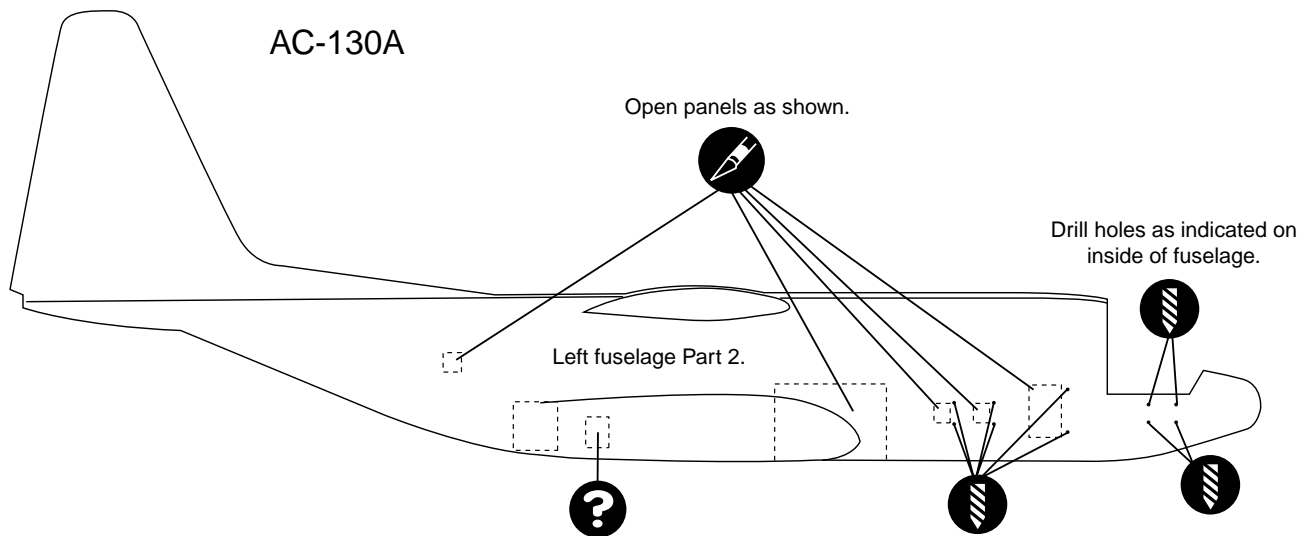

Open panel for single 40mm cannon installation only.  
A decal is provided to simulate the hatches for a dual 40mm cannon installation. Advanced modelers may choose to carefully cut the second small hatch out and add sheet styrene to the fuselage interior to mount the dual cannons. Refer to the decal guide, Step 3 and your references for information.

## 1 WHEEL WELLS



All Parts

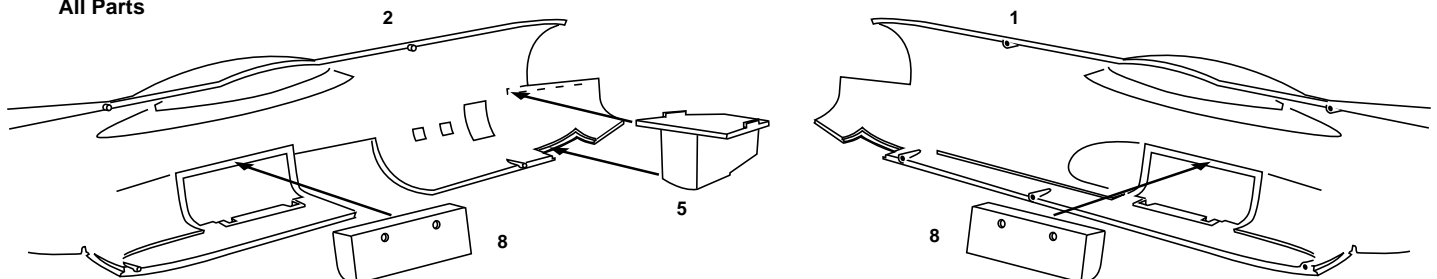

• Cockpit area **FLAT BLACK**  
or **LIGHT GRAY**

## 2 INTERIOR ASSEMBLY



All Parts

• Interior parts LIGHT GRAY or FLAT ALUMINUM

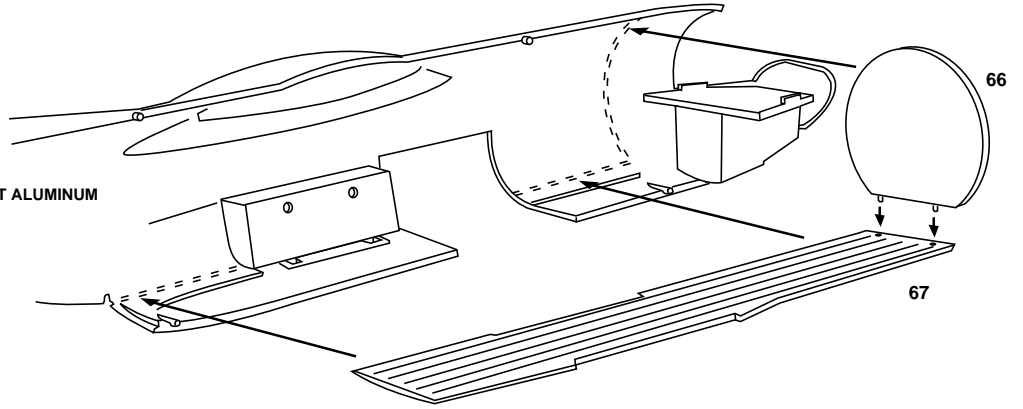

## 3 ARMAMENT INTERIOR PARTS



All Parts

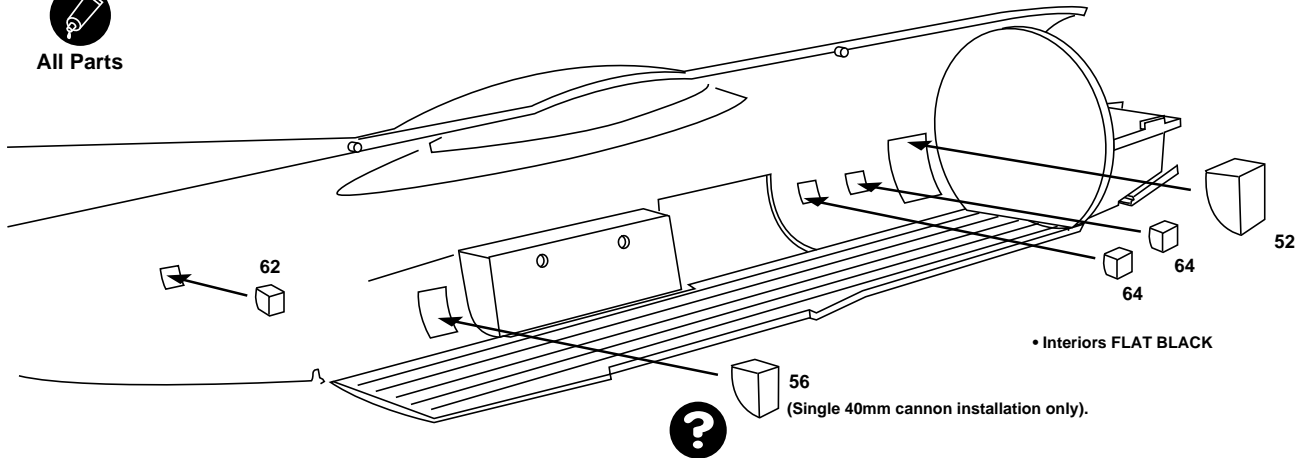

• Interiors FLAT BLACK

(Single 40mm cannon installation only).

## 4 FUSELAGE ASSEMBLY



All Parts

### PLEASE NOTE

You may choose to add 20mm cannons (parts 55) and 40mm cannon (part 57) after final assembly to avoid breakage.

Refer to decal guide for additional information to add additional armament.

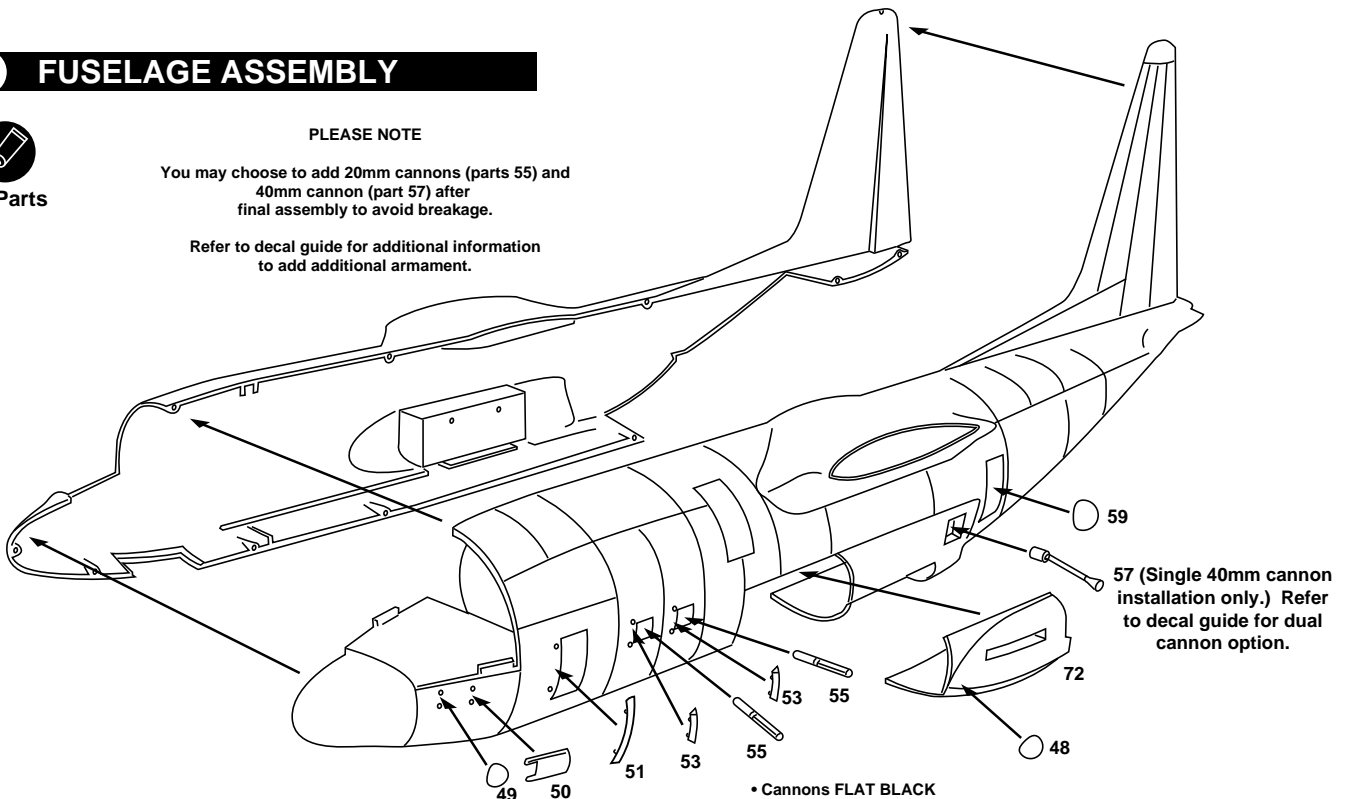

57 (Single 40mm cannon installation only.) Refer to decal guide for dual cannon option.

• Cannons FLAT BLACK

## 5 NACELLE ASSEMBLY



All Parts

4

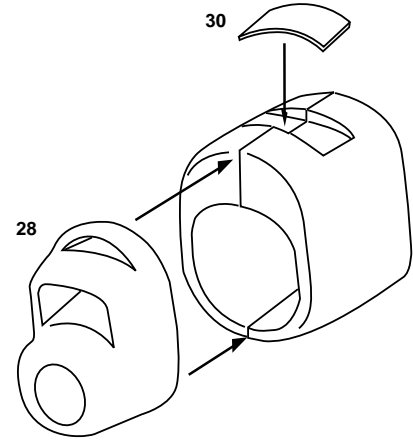
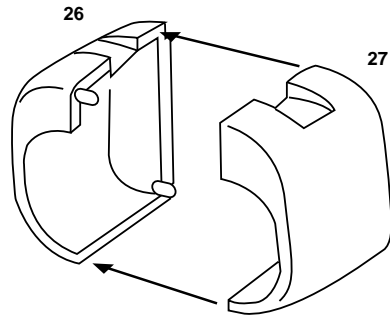

NOTE - Parts are shown upside down for clarity.

## 6 WING / EXHAUST ASSEMBLY

LEFT WING

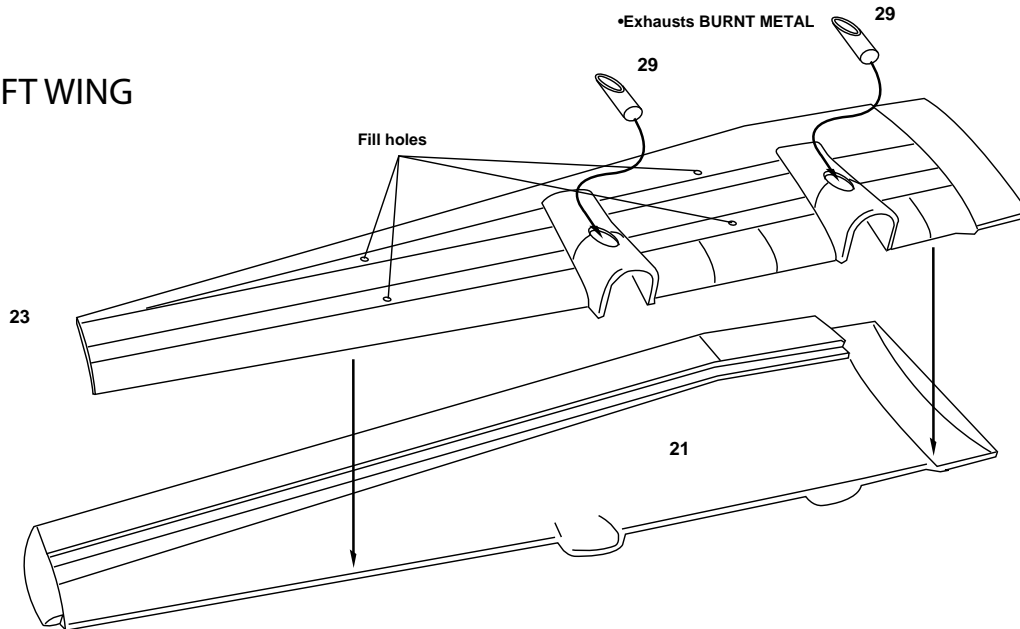

NOTE - Parts are shown upside down.

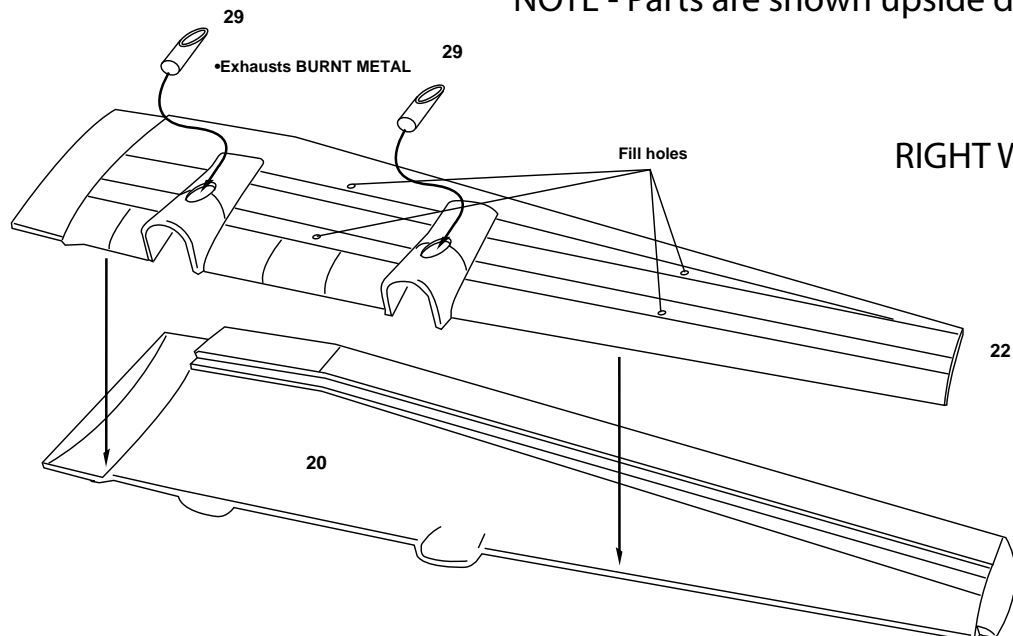

RIGHT WING

# 7 MAIN ASSEMBLY

Some parts not shown for clarity



All Parts

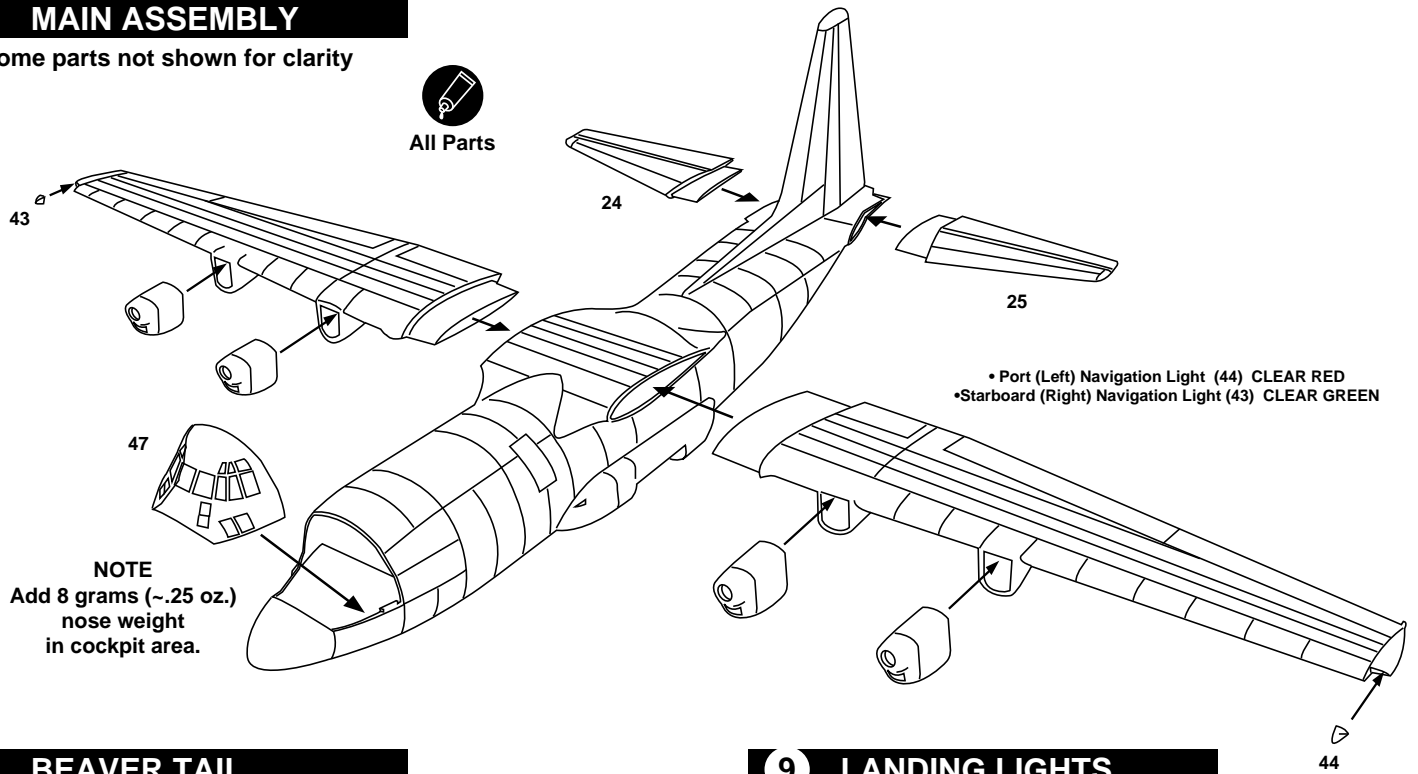

# 8 BEAVER TAIL



All Parts

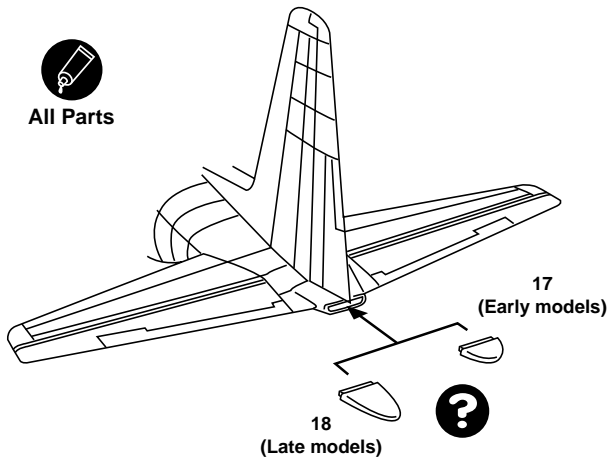

# 9 LANDING LIGHTS

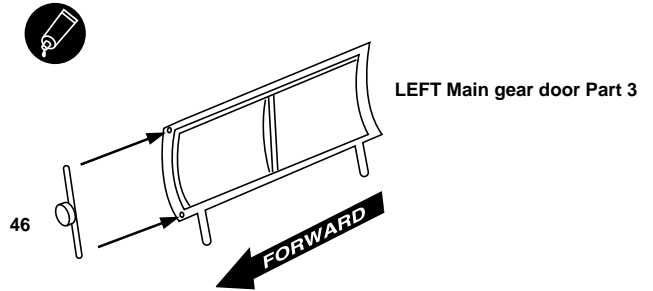
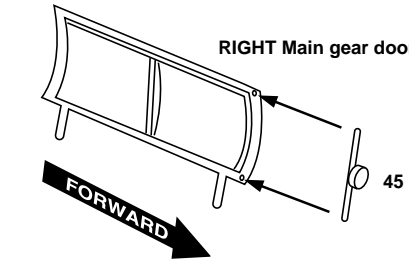

# 10 MAIN LANDING GEAR

RIGHT MAIN LANDING GEAR

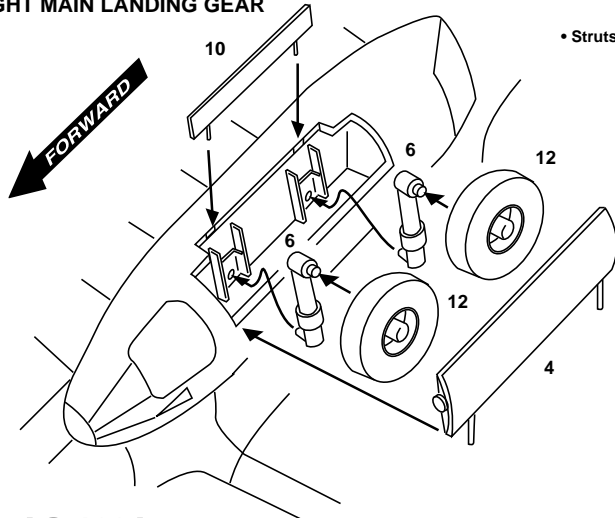

• Struts / Hubs / Interiors ALUMINUM  
• Tires FLAT BLACK

LEFT MAIN LANDING GEAR

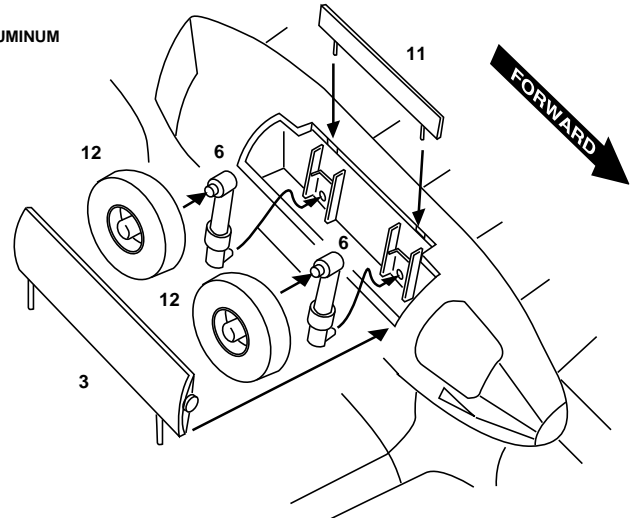

All Parts

# 11 NOSE LANDING GEAR



All Parts

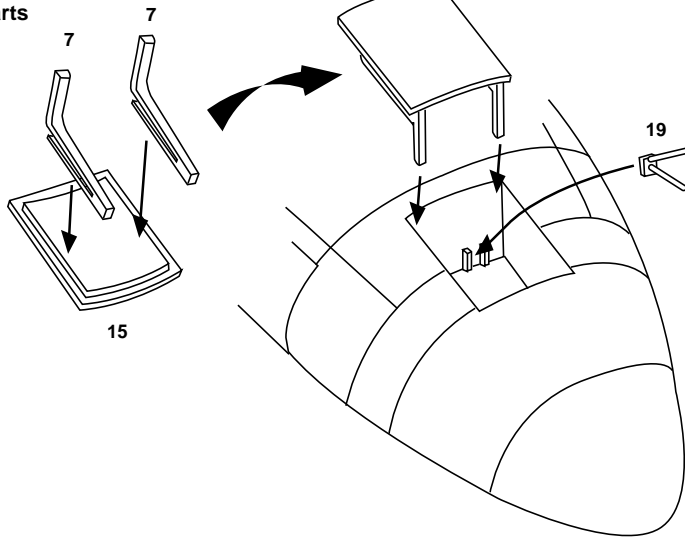

• Strut / Hubs / Interior ALUMINUM  
• Wheels FLAT BLACK

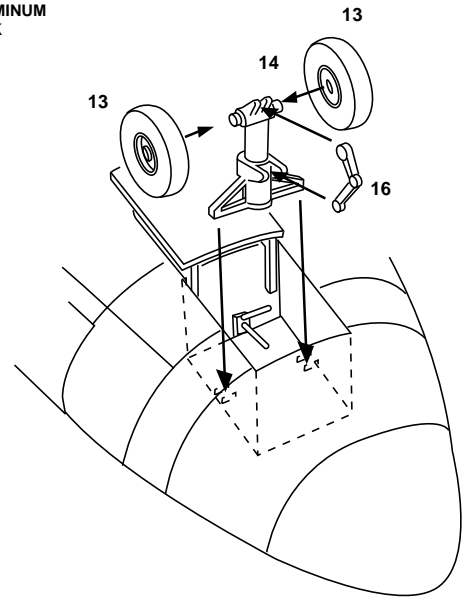

# 12 CARGO HATCH



All Parts

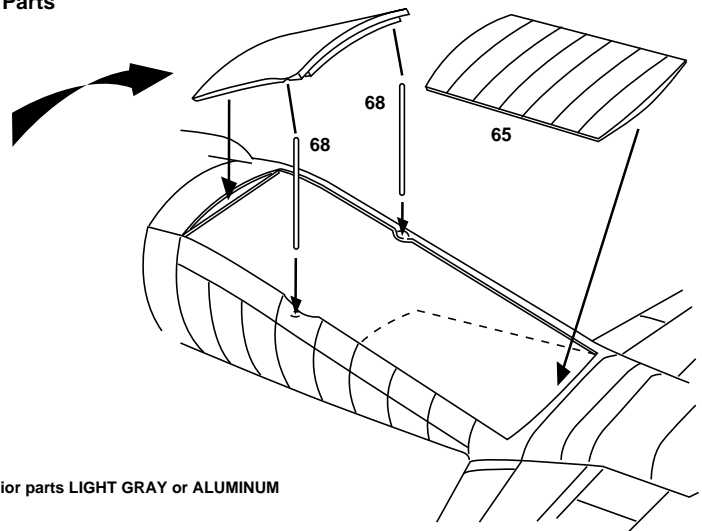
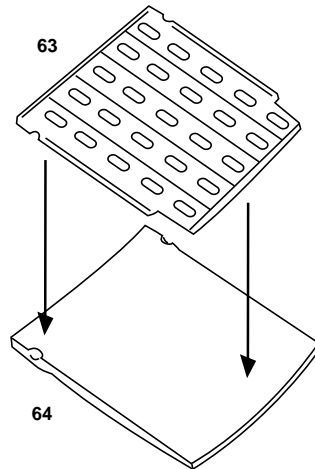

• Interior parts LIGHT GRAY or ALUMINUM

# 13 PROPELLERS



4

•Hub / Blades FLAT BLACK

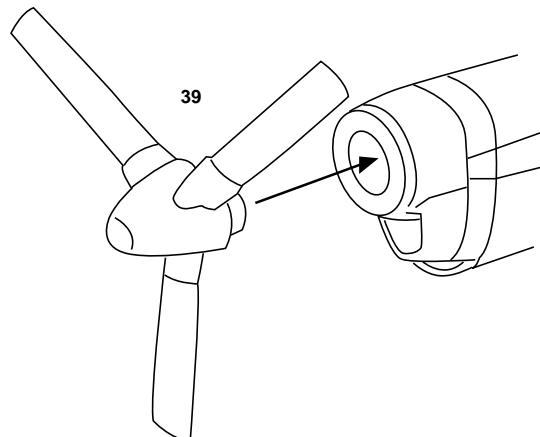



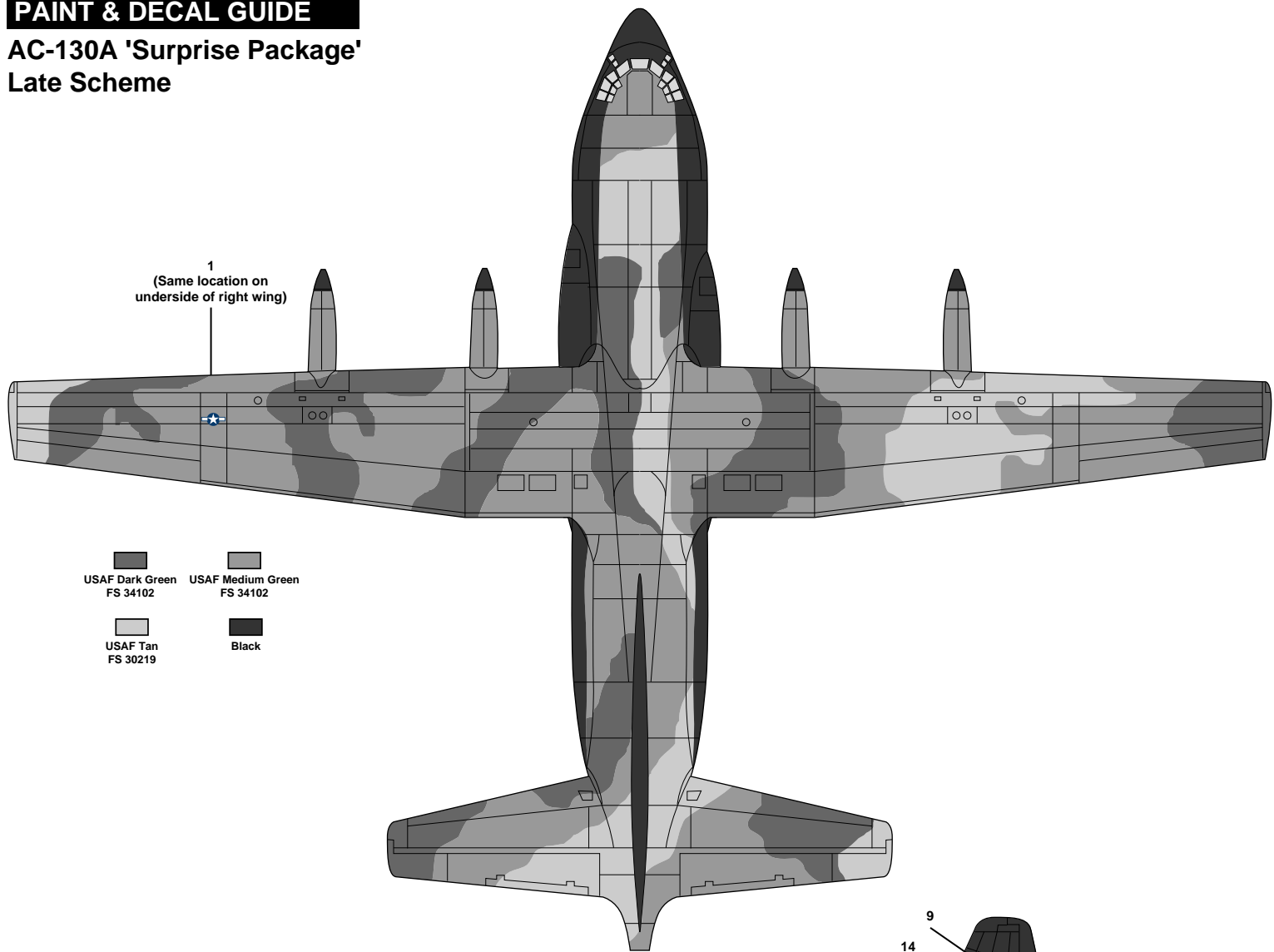

All Parts

# PAINT & DECAL GUIDE

## AC-130A 'Surprise Package' Late Scheme



-  USAF Dark Green  
FS 34102
-  USAF Medium Green  
FS 34102
-  USAF Tan  
FS 30219
-  Black

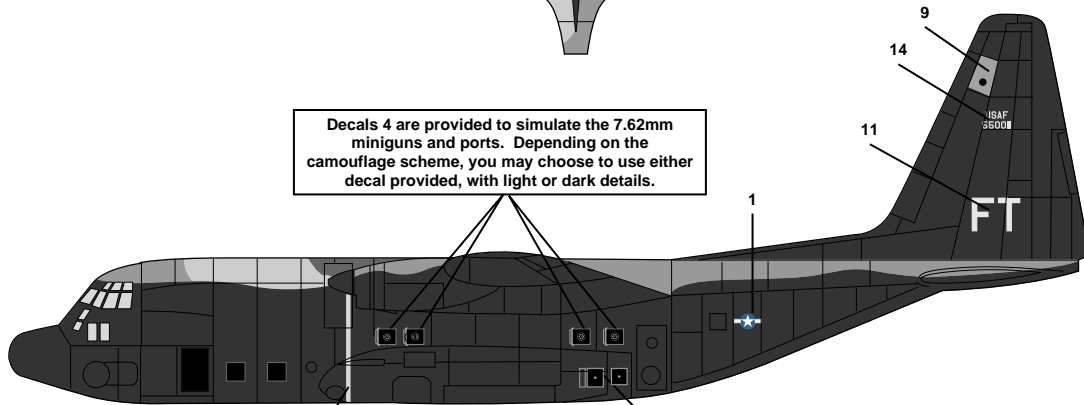

Decals 4 are provided to simulate the 7.62mm miniguns and ports. Depending on the camouflage scheme, you may choose to use either decal provided, with light or dark details.

Wrap propeller warning stripe around lower fuselage and trim as shown.

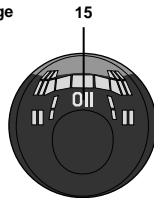
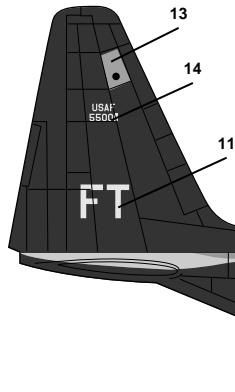





Decal 6 is provided to simulate the openings for the aft 20mm cannons (parts 55). After the decal is thoroughly dry, drill a small hole in the center of each panel and mount one part 55 in each hole. Depending on the camouflage scheme, you may choose to use either decal provided, with light or dark details.

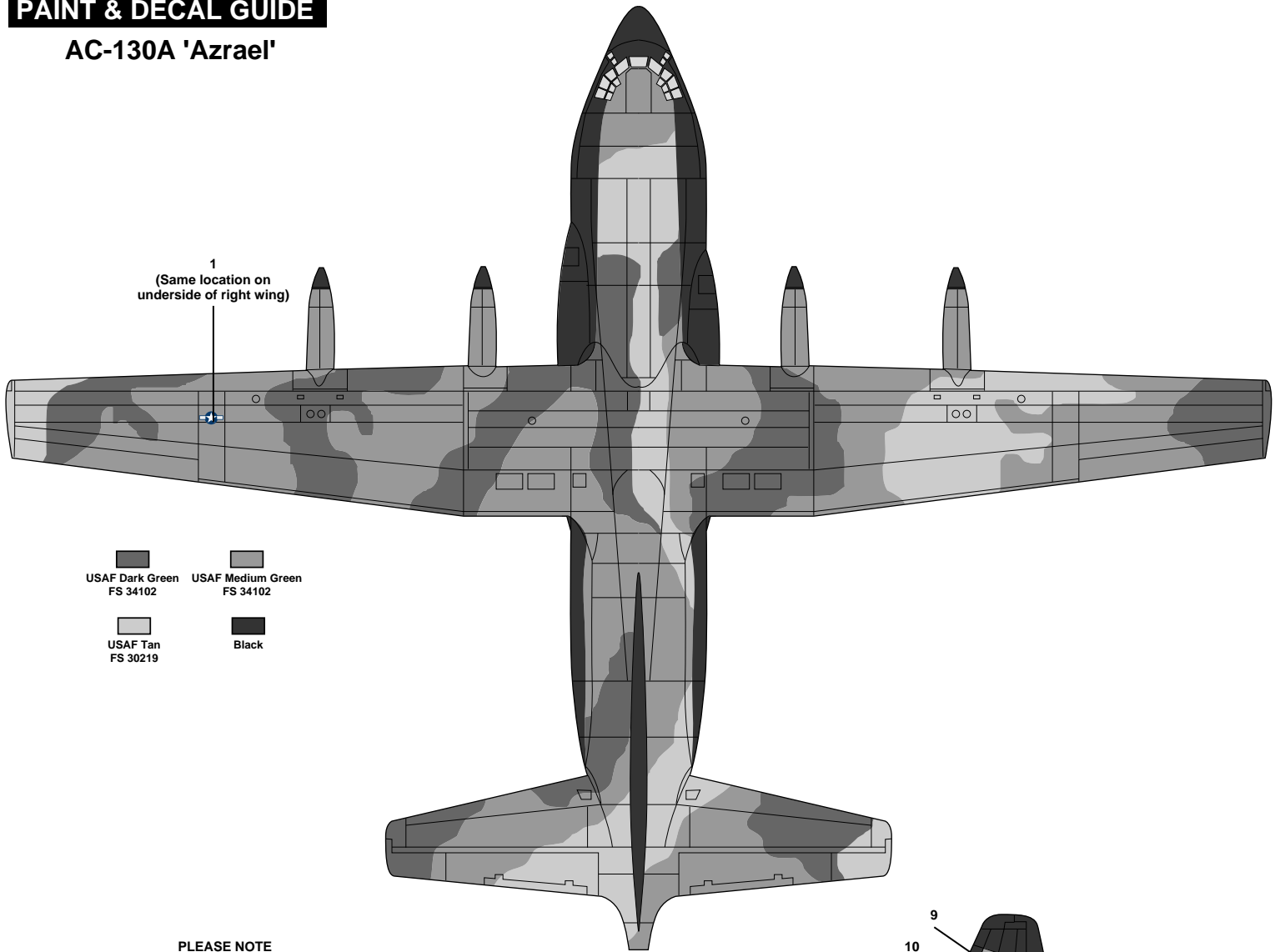

# PAINT & DECAL GUIDE

## AC-130A 'Azrael'

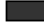

-  USAF Dark Green  
FS 34102
-  USAF Medium Green  
FS 34102
-  USAF Tan  
FS 30219
-  Black

**PLEASE NOTE**

'Azrael' wore at least two distinct designs of nose art. Decal 7 shows the early version, decal 8 the late. Refer to the box top for placement of decal 8.

Decals 4 are provided to simulate the 7.62mm miniguns and ports. Depending on the camouflage scheme, you may choose to use either decal provided, with light or dark details.

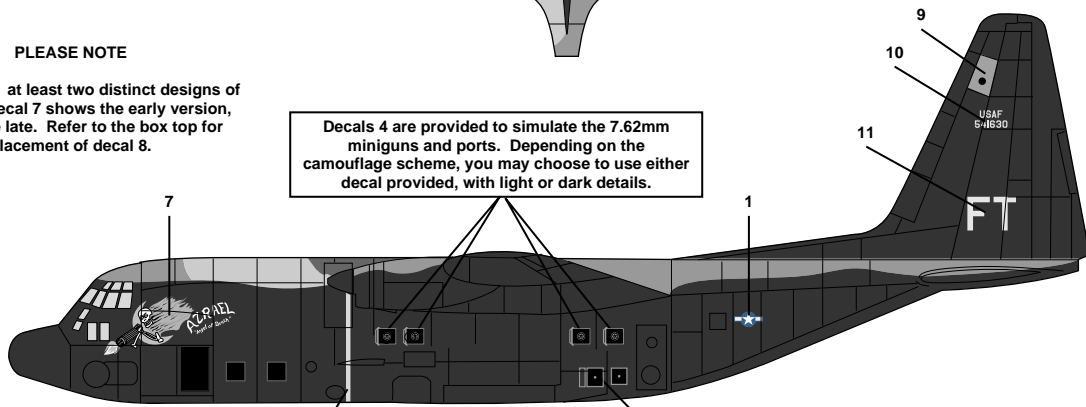

Wrap propeller warning stripe around lower fuselage and trim as shown.

Decal 6 is provided to simulate the openings for the aft 20mm cannons (parts 55). After the decal is thoroughly dry, drill a small hole in the center of each panel and mount one part 55 in each hole. Depending on the camouflage scheme, you may choose to use either decal provided, with light or dark details.

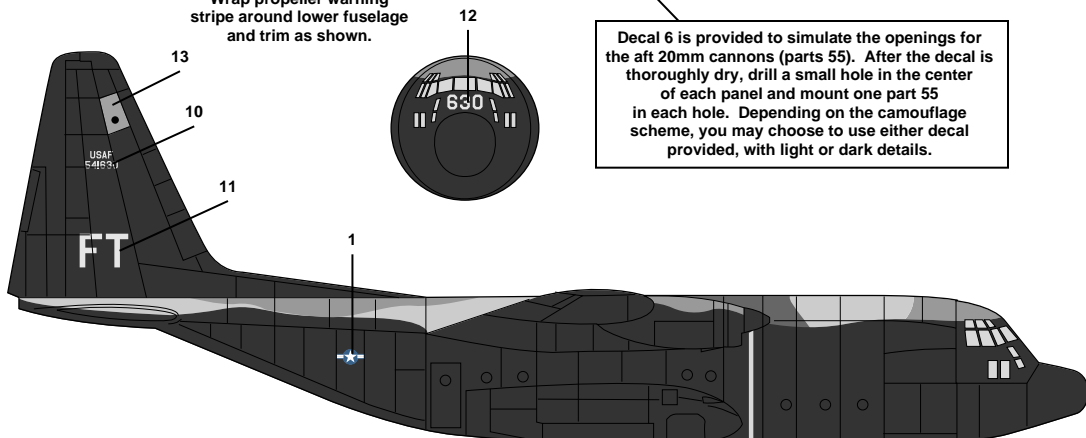

# PAINT & DECAL GUIDE

## AC-130A 'Surprise Package' Early Scheme

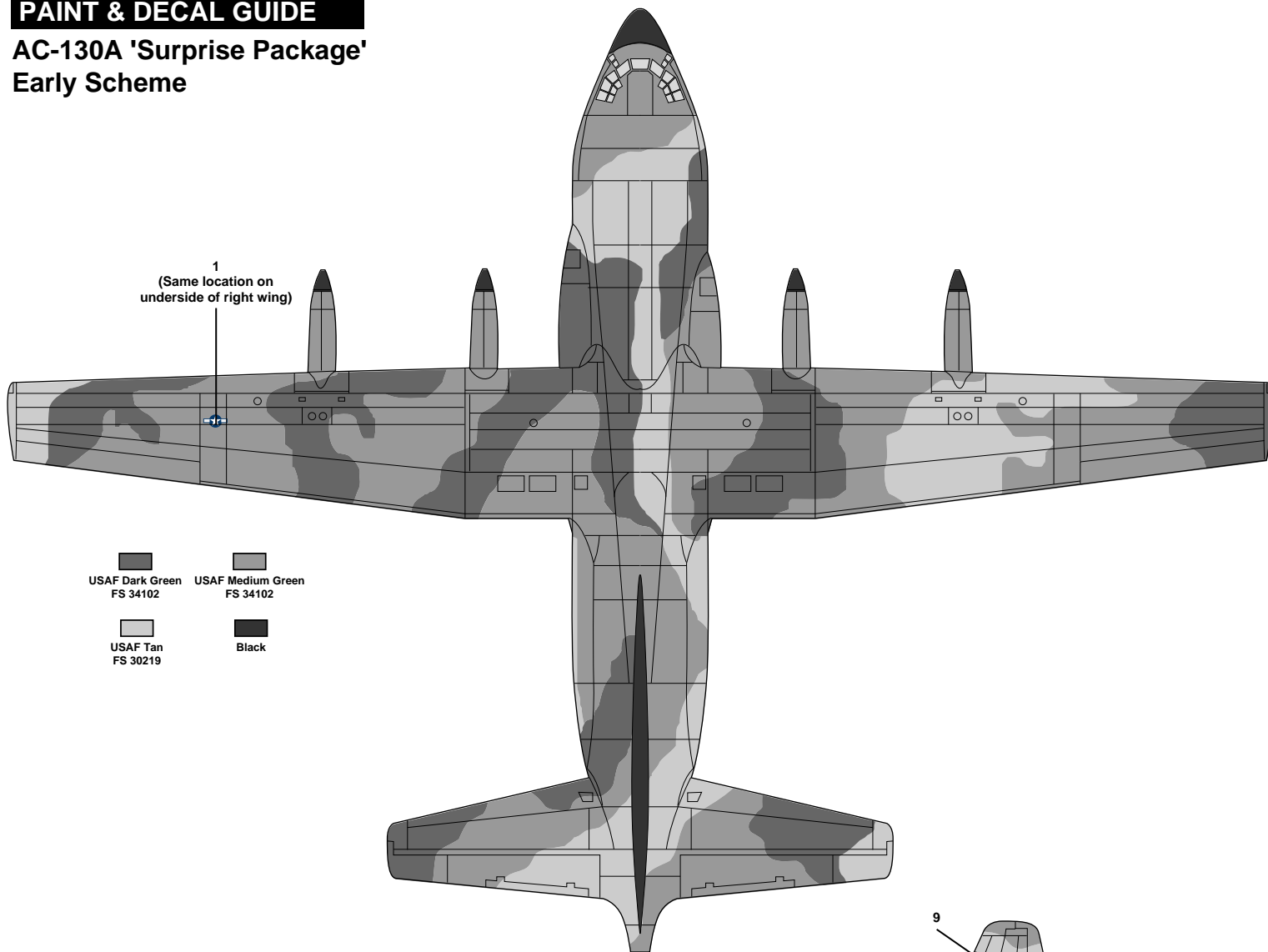

- USAF Dark Green  
FS 34102
- USAF Medium Green  
FS 34102
- USAF Tan  
FS 30219
- Black

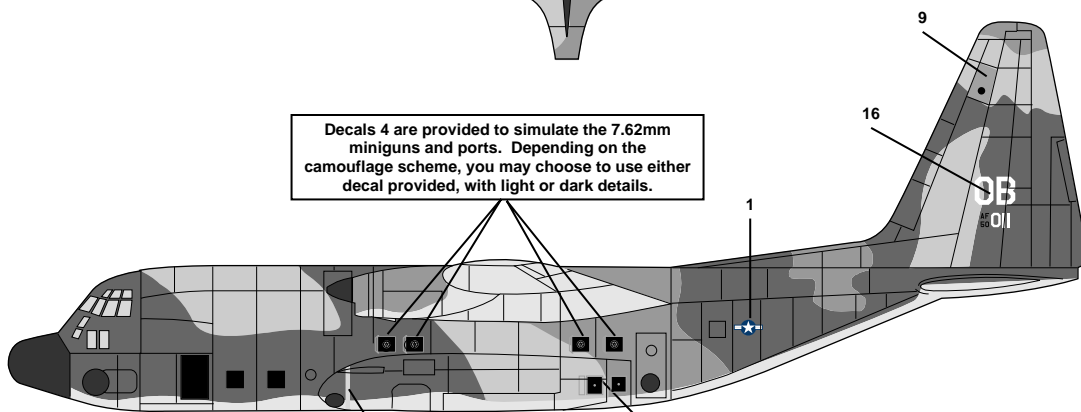

Decals 4 are provided to simulate the 7.62mm miniguns and ports. Depending on the camouflage scheme, you may choose to use either decal provided, with light or dark details.

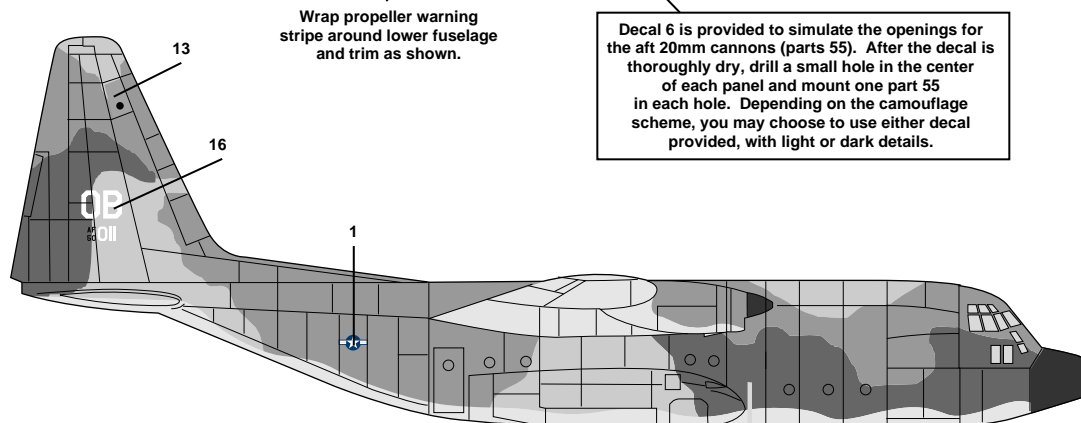

Wrap propeller warning stripe around lower fuselage and trim as shown.

Decal 6 is provided to simulate the openings for the aft 20mm cannons (parts 55). After the decal is thoroughly dry, drill a small hole in the center of each panel and mount one part 55 in each hole. Depending on the camouflage scheme, you may choose to use either decal provided, with light or dark details.

# PAINT & DECAL GUIDE

## AC-130A Prototype

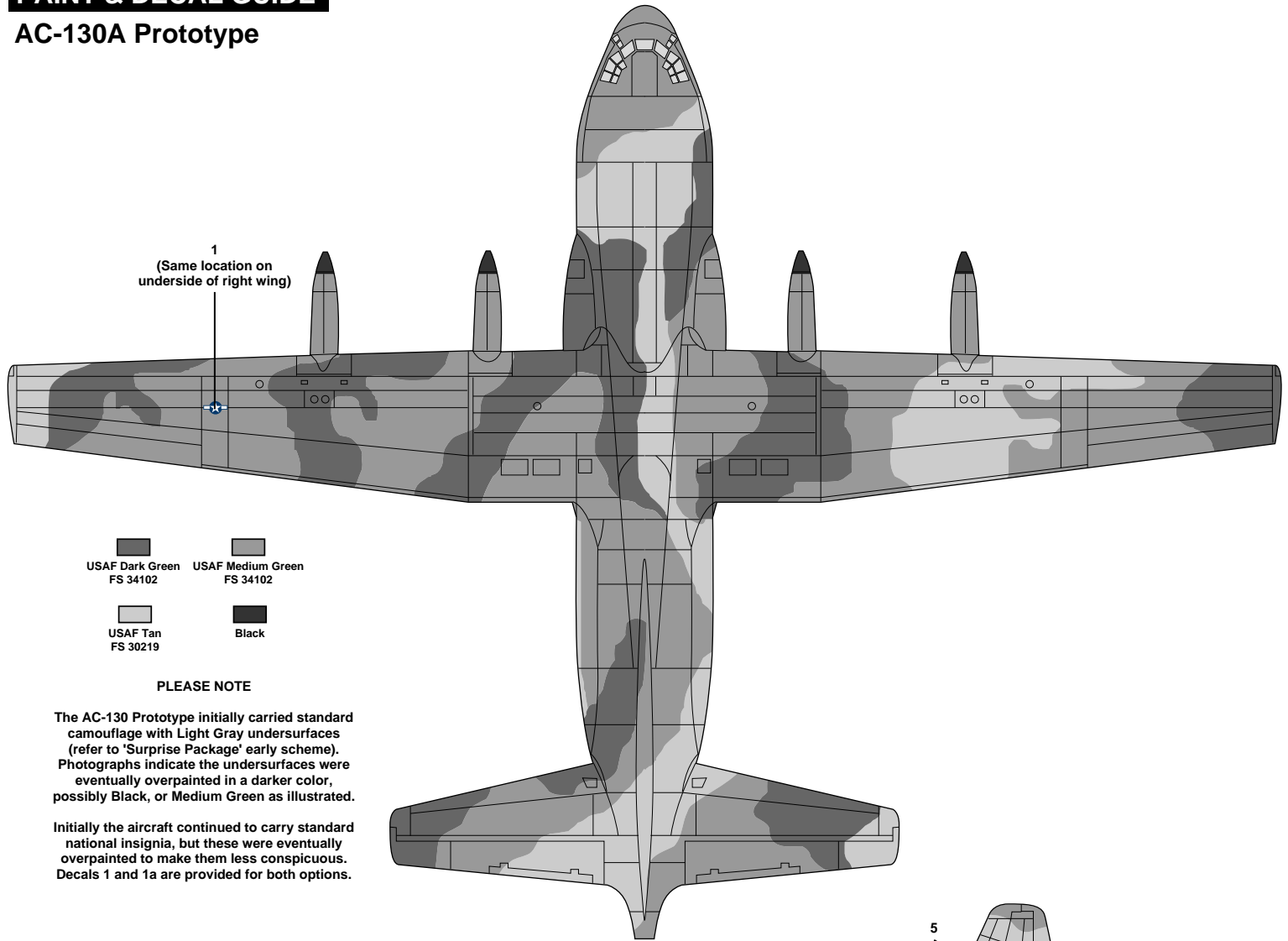

- USAF Dark Green  
FS 34102
- USAF Medium Green  
FS 34102
- USAF Tan  
FS 30219
- Black

**PLEASE NOTE**

The AC-130 Prototype initially carried standard camouflage with Light Gray undersurfaces (refer to 'Surprise Package' early scheme). Photographs indicate the undersurfaces were eventually overpainted in a darker color, possibly Black, or Medium Green as illustrated.

Initially the aircraft continued to carry standard national insignia, but these were eventually overpainted to make them less conspicuous. Decals 1 and 1a are provided for both options.

