

How to use masks

Canopy and exhaust pipes should be installed after painting the model.

To lower the mask adhesion and protect the paintwork from peeling you may want to stick it first to your hand.

- 1 It is recommended to paint the model underside first before painting camouflage pattern. When the model is ready to apply the camouflage, mask the underside edges using masks B1–B8 and paint the top with Dark Green first.
- 2 When thoroughly dry, apply masks. Please note that masks on the Hurricane should be applied without a canopy attached to the model.
- 3 Use diagrams to place masks in the correct place on the model. Each mask has a code corresponding with the code on the diagram. Start with the top (T1–T6) then left (L1–L6) and eventually right (R1–R3). When using with Italeri and Tamiya kits use additional masks marked X.
- 4 There are two symbols used on diagrams which show how to position masks: one indicating where to start placing masks: ▲, the other showing where to cross-check the alignment with panel lines and ensure correct final position: ▲.
- 5 When all masks are in place paint the model with Dark Earth colour. When dry, remove masks.

A bit of history

In 1937 the RAF adopted two camouflage colours for plane sides and upper surfaces: Dark Green and Dark Earth, for all aircraft operating over land.

There were two camouflage patterns in use on RAF Hurricanes – type A and type B. Type B was a mirror image of type A. They were usually applied alternatively to aircraft leaving the production line. Type B camouflage pattern was eventually abandoned in January 1941.

About Verben masks

Verben masks #VBM48001 are designed for an RAF Hurricane type B camouflage scheme. Although the design has been specifically tailored for the Airfix model kit #A05127 it can also be used on Italeri and Tamiya kits.

Please check your references to see which pattern you need.

RAF Hawker Hurricane Mk. I

Type B scheme

Scale 1:48

Verben
Camouflage Painting Masks

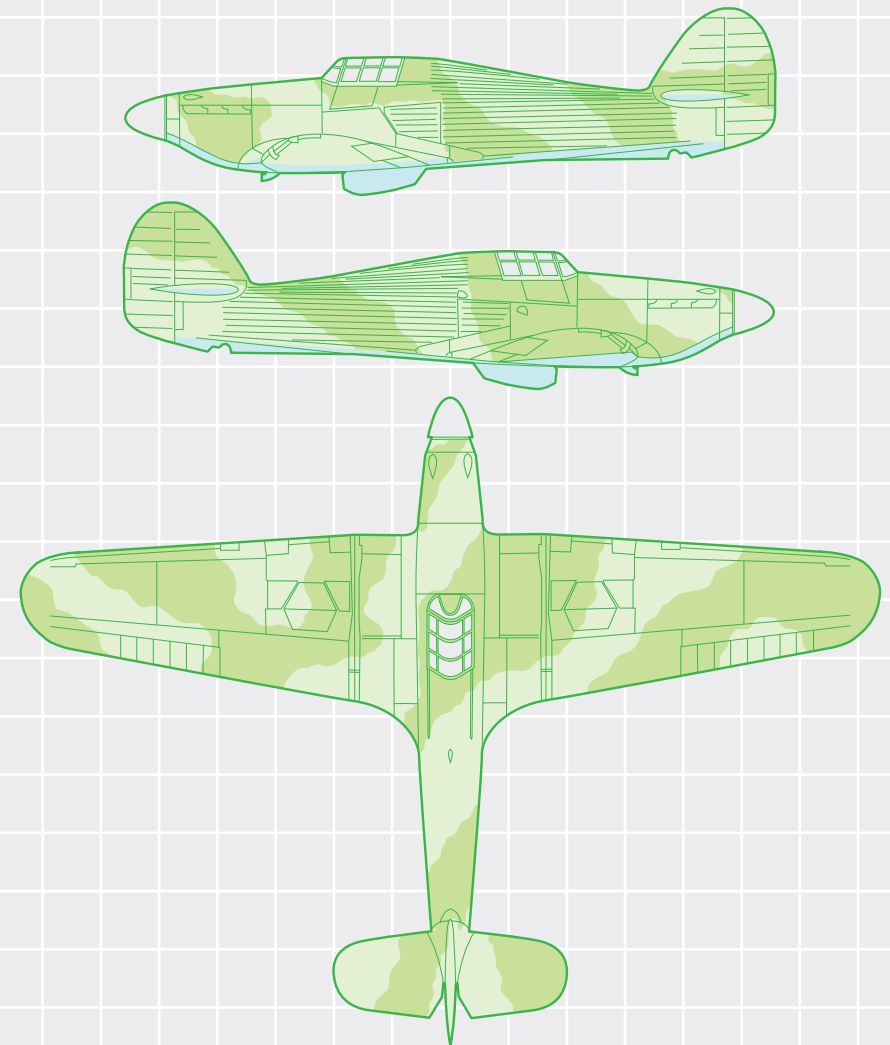

For more information please visit: www.verben.co.uk

Graphic design by Sam Harris. Made in the UK. © Coelo Ltd.

For Airfix, Italeri and Tamiya models

Product #**VBM48001**

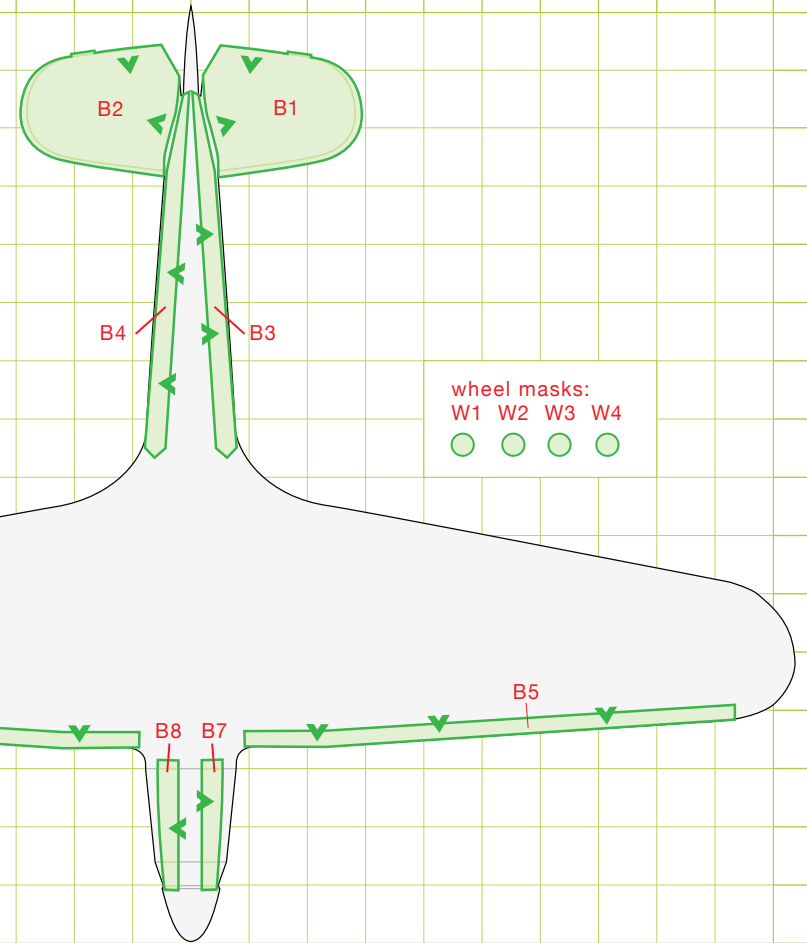
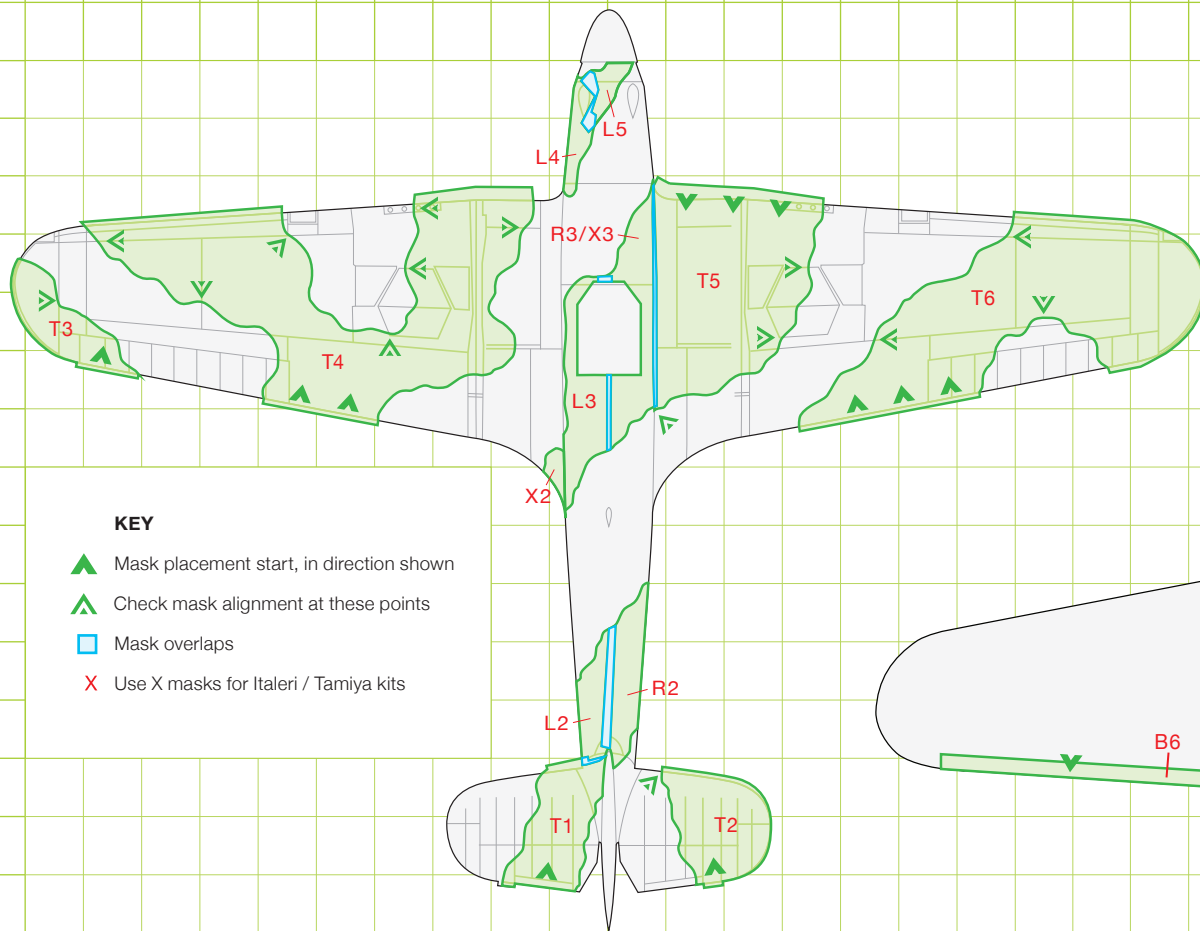

wheel masks:
 W1 W2 W3 W4
 ○ ○ ○ ○

KEY

- ▲ Mask placement start, in direction shown
- ▲ Check mask alignment at these points
- Mask overlaps
- X Use X masks for Italeri / Tamiya kits

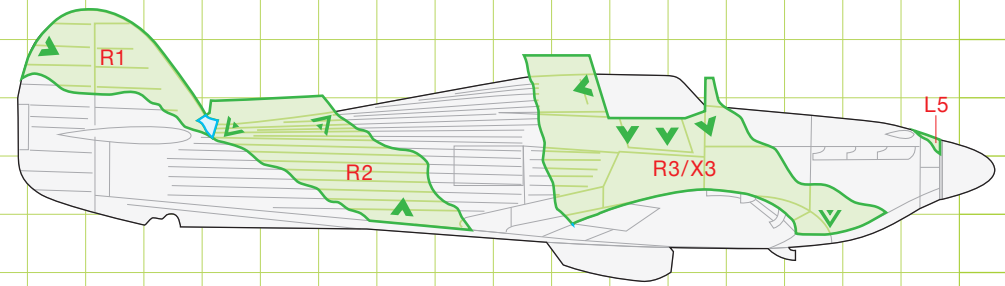
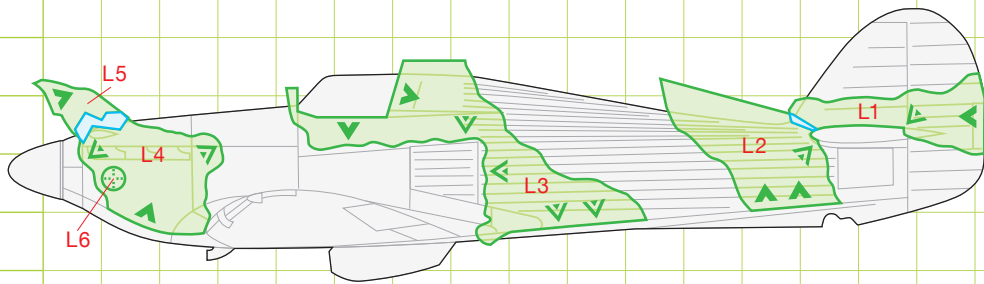

For more information please visit: www.verben.co.uk

For Airfix, Italeri and Tamiya models
 Product #VBM48001