



# U.S. AIR FORCE C-22C

*NJP*

**MINICRAFT**  
**MODEL KITS**  
*Legends in the making*

in 1/144 SCALE



On the occasion that the government needs to transport certain high ranking personnel, or highly secret equipment, it is important to keep a low profile and not attract undue attention. One of the best ways of doing this is to use innocuous, inconspicuous equipment. The sole C-22C is an example of this. It's simple markings are intended to actually hide it right out in the open.

But the most interesting thing about this plane is its history!

727-212 was first delivered to Singapore Airlines, as 9V-SGH on July 9, 1979. After flying with Singapore for four years, the plane was sold to a private firm, operating under the name "Age of Enlightenment Trust" but was still registered in Singapore. It served them until March, 1984. It then became the property of "Rolls Royce CC" and bore the US registration of N48054. By the end of the year, it was carrying the name Ryan International,

and used for a variety of operations.

In June of 1986, it was in the possession of E-Systems, a company used by the Air Force to convert civil aircraft to military specs. Following the conversion, it became a test bed for unspecified purposes, and flown as a transport.

In June, 1989, it was assigned the USAF serial number 83-4618 and was designated a C-22C International Transport. But, one year later it was carrying the civil registration N8596C and three months later carried the title "Century" on the fuselage. One month after that, it lost the title and again bore the Air Force serials.

The C-22C was then operated by the 486th FLTS with the Air National Guard as a transport and medical evacuation aircraft throughout the world. Finally, on April 23, 2001, this aerial chameleon was retired into storage, where it awaits today for...who knows what?

# PARTS LAYOUT DIAGRAM

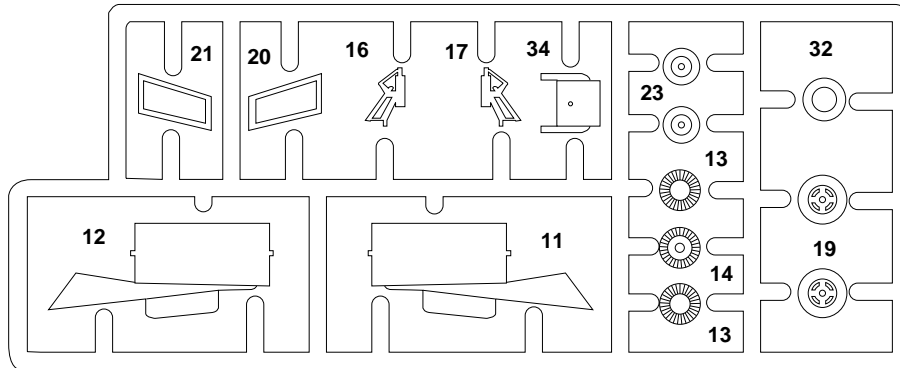
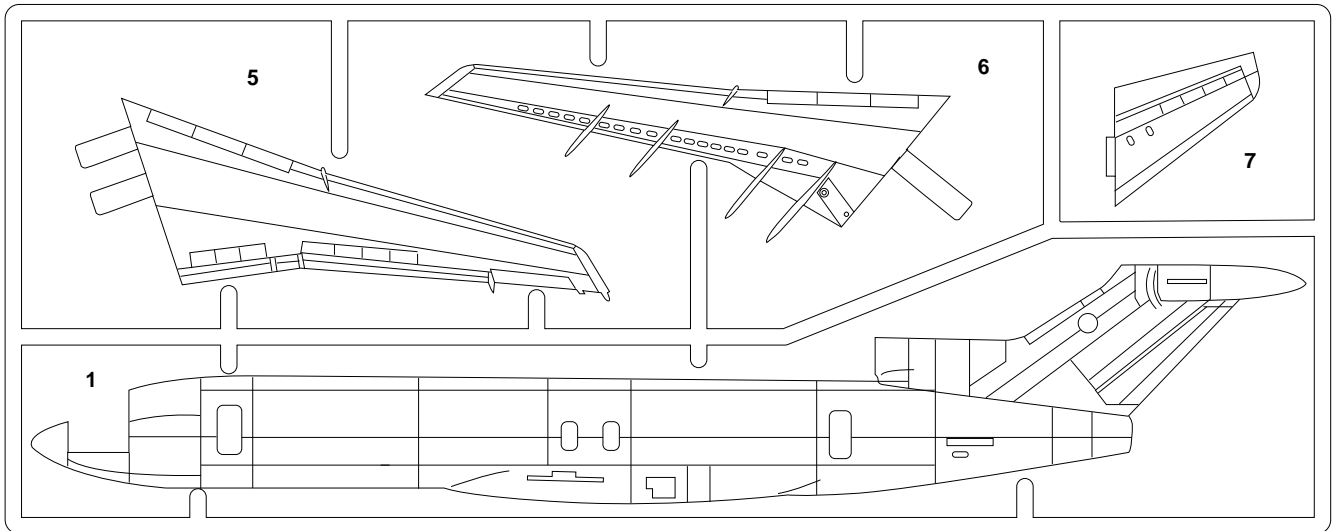
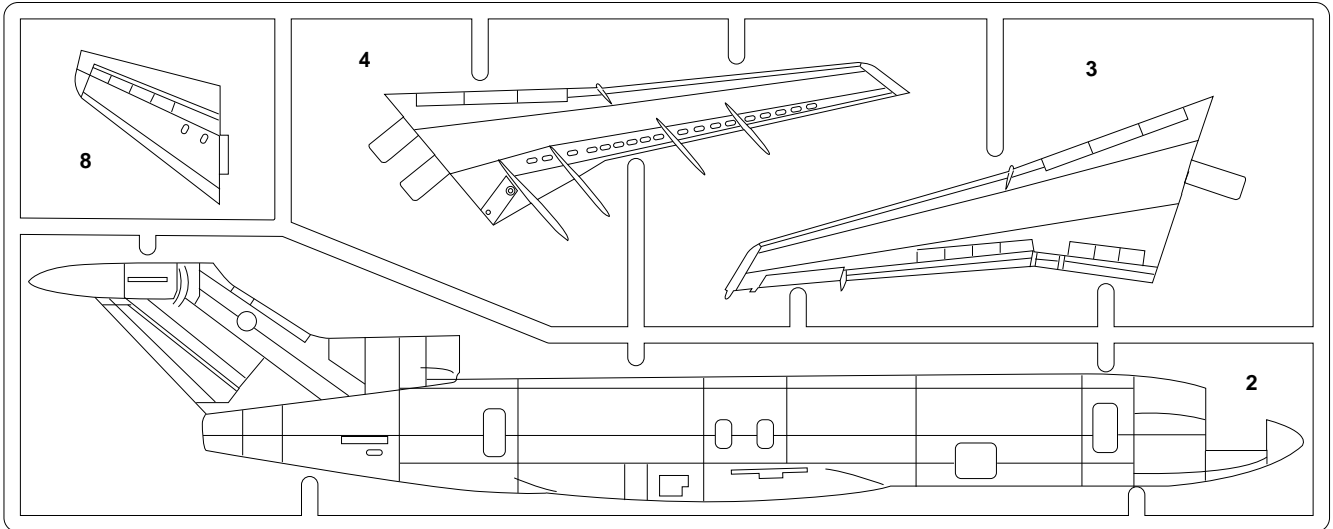

**WINDSCREEN**

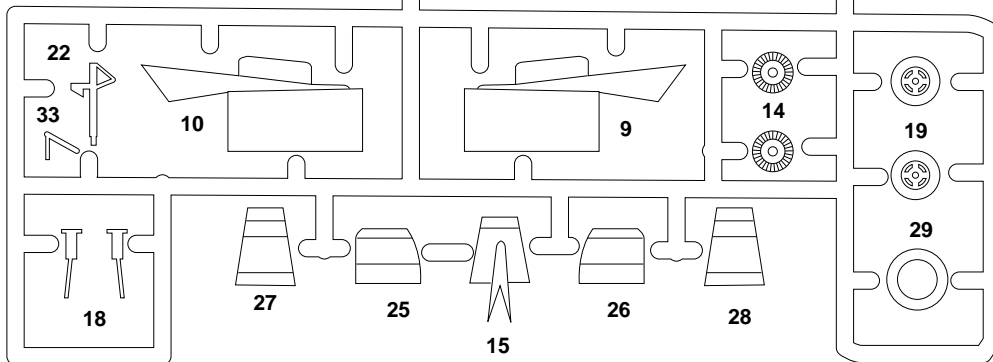
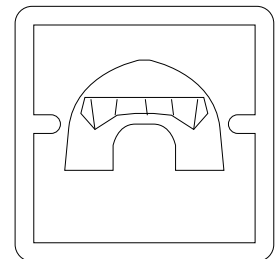



Cement  
Coller  
Kleben



DO NOT Cement  
Ne pas Coller  
Nicht Kleben



Cut away  
Couper  
Scheiden



Optional parts  
Choix  
Auswahlmöglichkeit

# 1 FUSELAGE ASSEMBLY

- 1 • Left (Port) Fuselage / fuselage gauche / linker rumpf
- 2 • Right (Starboard) Fuselage / fuselage droite / richtiger rumpf

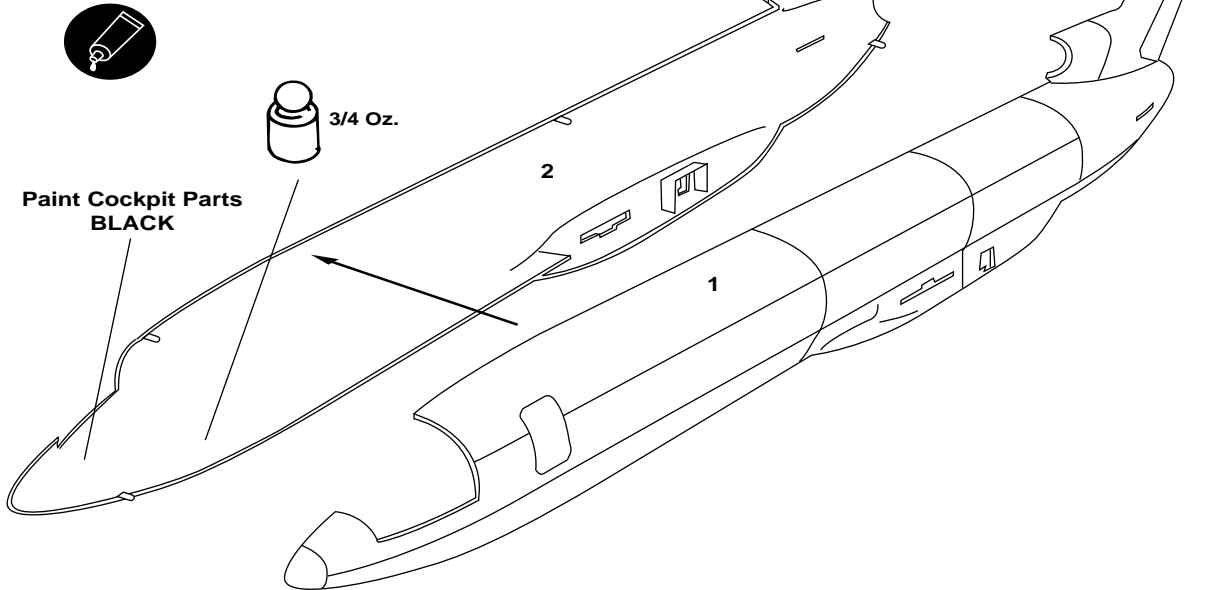

**PLEASE NOTE**  
Wing parts are very delicate; please use care  
when separating parts from the sprues to avoid damage

# 2 LEFT WING

- 3 • Left (Port) Upper Wing / superieur aile gauche / linker oberen flügel
- 4 • Left (Port) Lower Wing / bas aile gauche / linker läßt flugel

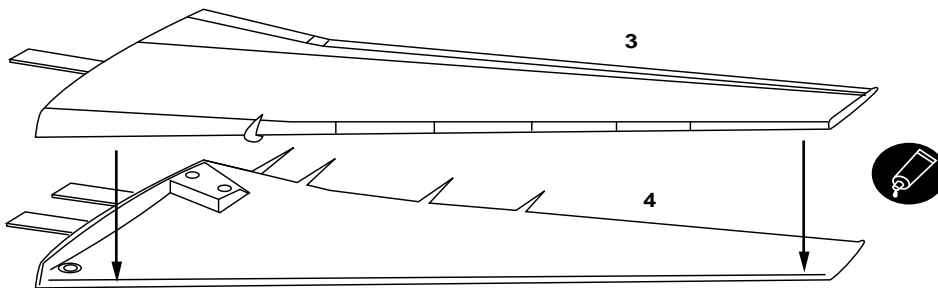

# 3 RIGHT WING

- 5 • Right (Starboard) Upper Wing / superieur aile droit / richter oberen flügel
- 6 • Right (Starboard) Lower Wing / bas aile droit / richter läßt flugel

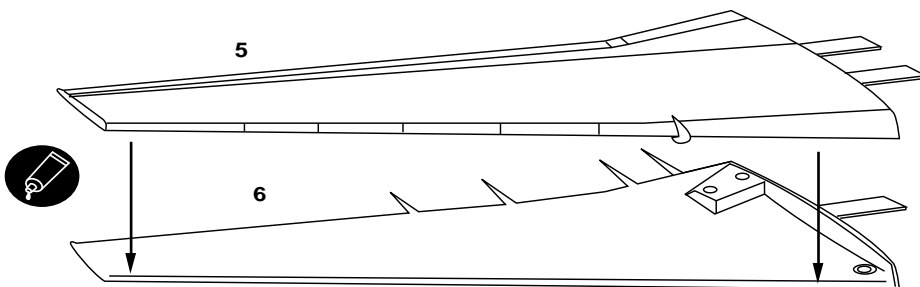

# 4 MAIN ASSEMBLY

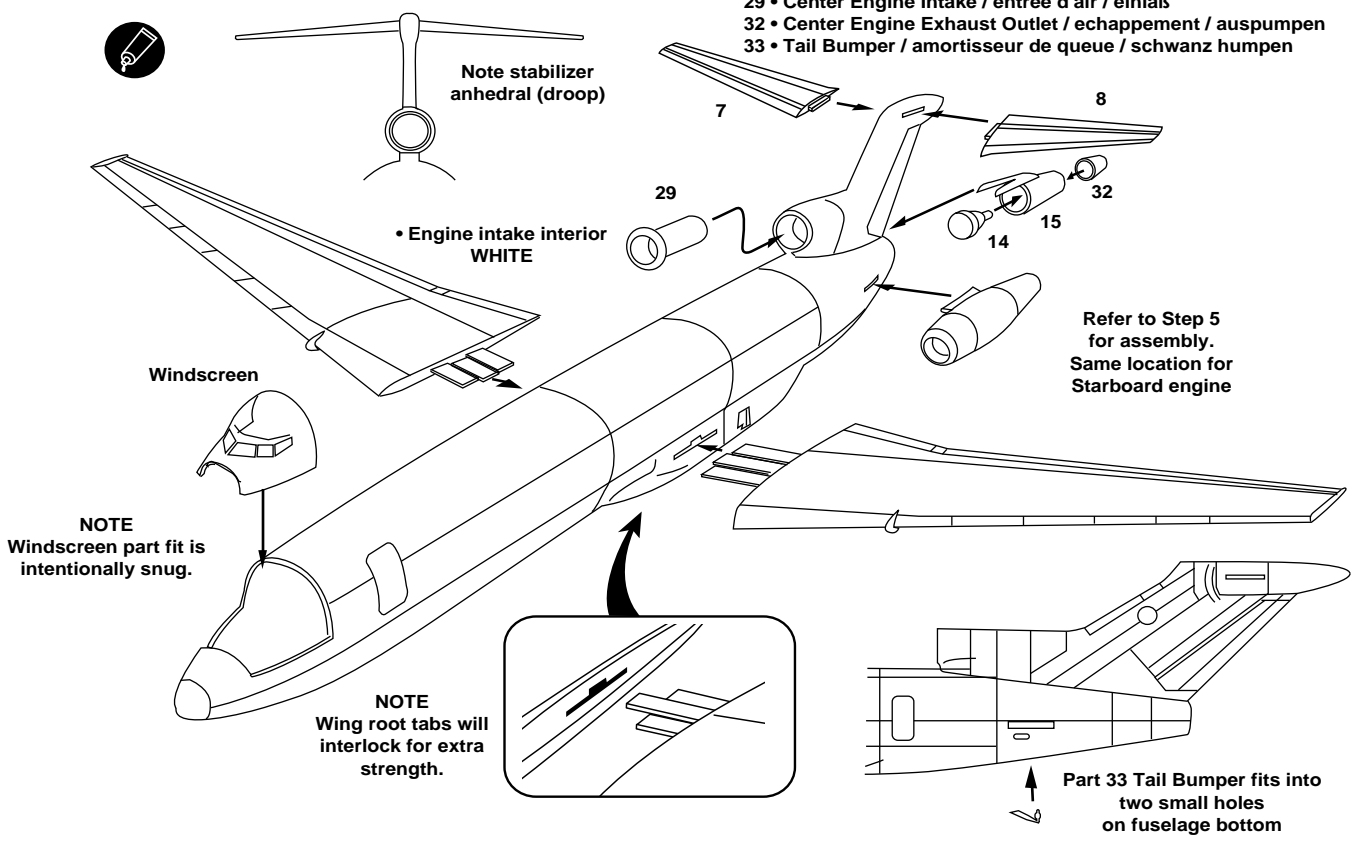

# 5 ENGINES

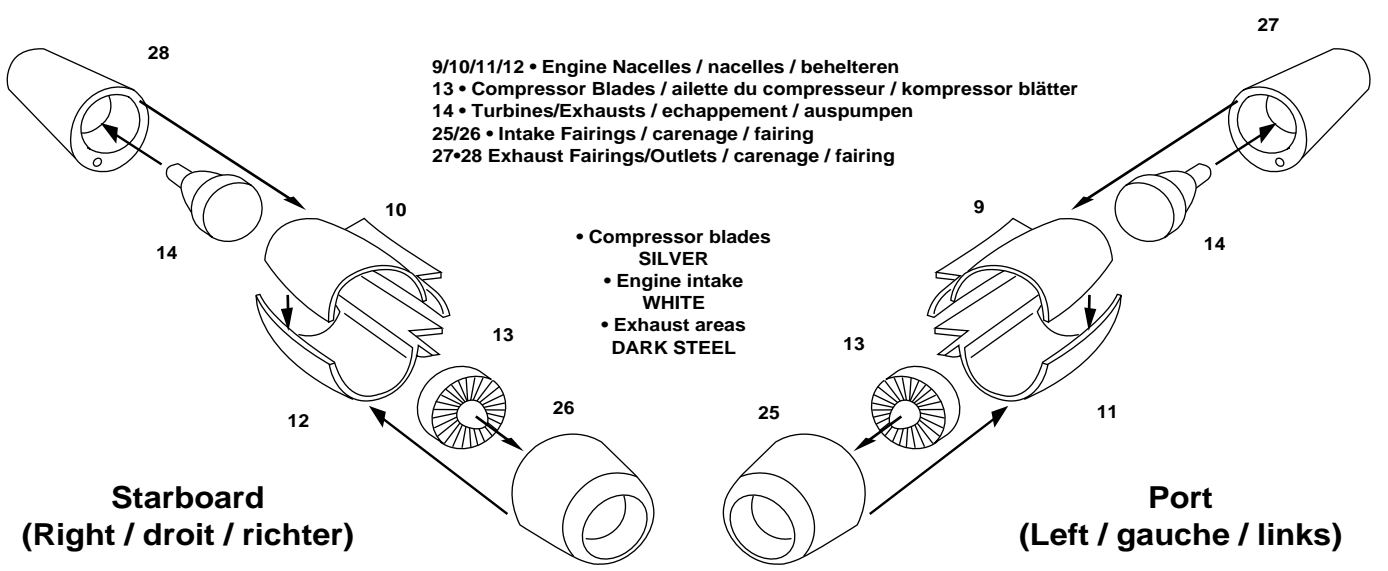

• Refer to Step 4 to locate engines to fuselage

• Note - For proper orientation of engines, Left and Right are as viewed from the rear of the aircraft.

## 6 LEFT MAIN LANDING GEAR

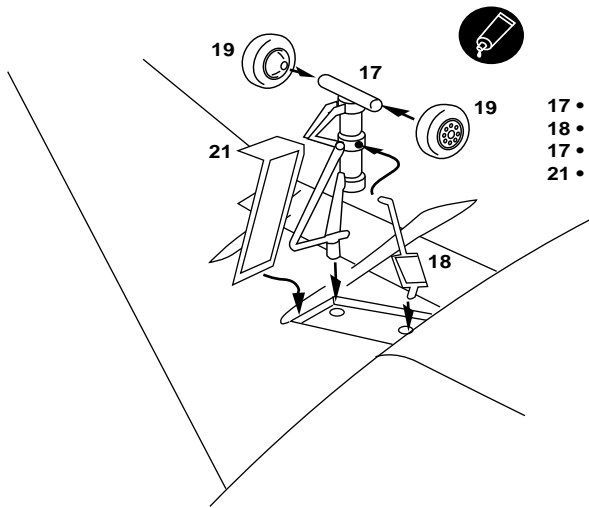

- 17 • Left (Port) Main Gear Strut / entretoise principal gauche / linker hauptlandung strut
- 18 • Retraction strut / biellette de retraction / retraction strut
- 19 • Mainwheel / roue principale / hauptrad
- 21 • Left (Port) Main Gear Door / trappe de train / linker gang türen

- Tires BLACK
- Hubs ALUMINUM
- Struts WHITE
- Gear Door Interiors and Gear Wells WHITE

## 7 RIGHT MAIN LANDING GEAR

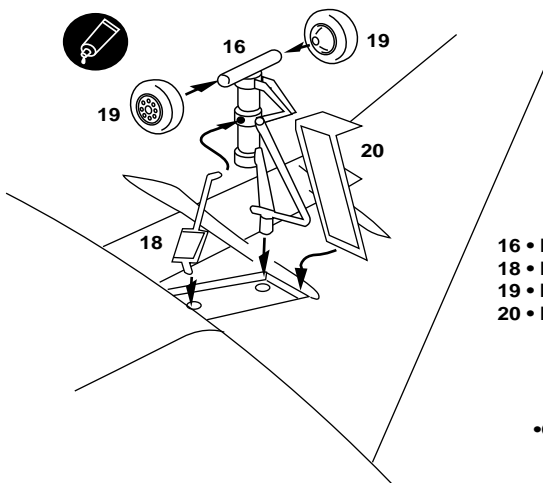

- 16 • Right (Starboard) Main Gear Strut / entretoise principal droit / richter hauptlandung strut
- 18 • Retraction strut / biellette de retraction / retraction strut
- 19 • Mainwheel / roue principale / hauptrad
- 20 • Right (Starboard) Main Gear Door / trappe de train / richter gang türen

- Tires BLACK
- Hubs ALUMINUM
- Struts WHITE
- Gear Door Interiors and Gear Wells WHITE

## 8 NOSE LANDING GEAR

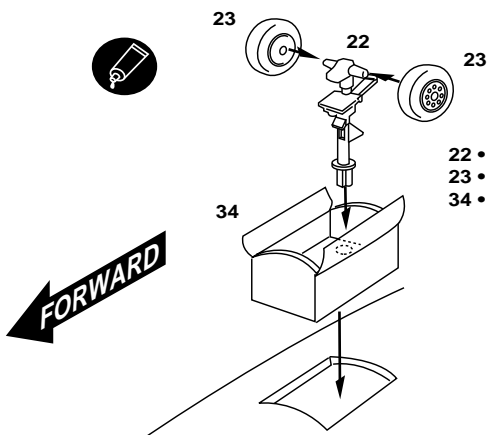

- 22 • Nose gear strut / train d'atterrissage avant / nase gang strut
- 23 • Nosewheel / roulette de nez / nase rad
- 34 • Nose gear doors / trappe de train / nase gang türen

- Tires BLACK
- Hubs ALUMINUM
- Struts WHITE
- Gear Door Interiors and Gear Wells WHITE

# U.S. AIR FORCE C-22C *TJP*

