



# GREAT DANE 40' REEFER TRAILER

A1249-200



1/25 SCALE

This 1/25 scale Great Dane Great Dane 40' refrigerator trailer, precisely patterned after the quality vans built by Great Dane Trailer Company. Highly detailed silver, black, plated and transparent red parts come together to produce an accurate, true scale model of this terrific trailer, the famous Great Dane Reefer Trailer.

## READ THIS BEFORE YOU BEGIN

**Cement all parts unless otherwise indicated.**

Look over this instruction sheet carefully before you begin building. Follow the assembly instructions and "test-fit" the parts without cementing. This will familiarize you with the location of the parts.

For the best results, the various sub-assemblies and components should be painted before any "chrome" parts are attached. For example: When attaching "non-chrome" body accessories, it is best to cement them in place and paint the body as a unit.

AMT® kits are molded from the finest High-Impact Styrene plastic. Use only paint and cement made for Styrene. Trim excess plastic from parts before joining. When attaching "chrome" parts, scrape plating away where parts are to be joined. Use just enough cement to join parts, and be careful not to smear cement on exposed surfaces.

Built according to the instructions on this sheet, you should have no trouble assembling your kit.

- 37S . . . indicates silver part
- 145CR . . . indicates chrome part
- 12BK . . . indicates black part
- 24TR . . . indicates transparent red part

You are about to work with a checklist instruction sheet. As each part is applied take a pencil and put a check mark in the box in front of each number. In this way you can see what you have done and what you have not.



GENERAL MOTORS Trademarks used under license to Round 2, LLC. Ford Motor Company Trademarks and Trade Dress used under license to Round 2, LLC. ©2021 Autocar, LLC. ©Hostess Brands, LLC. All Rights Reserved. The Hostess trademarks are used under license from Hostess Brands, LLC. Goodyear (and winged foot design) and Blimp design are trademarks of The Goodyear Tire & Rubber Company used under license by Round 2, LLC, South Bend, IN 46628. Copyright 2021 The Goodyear Tire & Rubber Company. Other names and trademarks used under license to Round 2, LLC or by permission. AMT and design is a registered trademark of Round 2, LLC. ©2021 Round 2, LLC, South Bend, IN 46628 USA. Product and packaging designed in the USA. Made in China. All rights reserved.

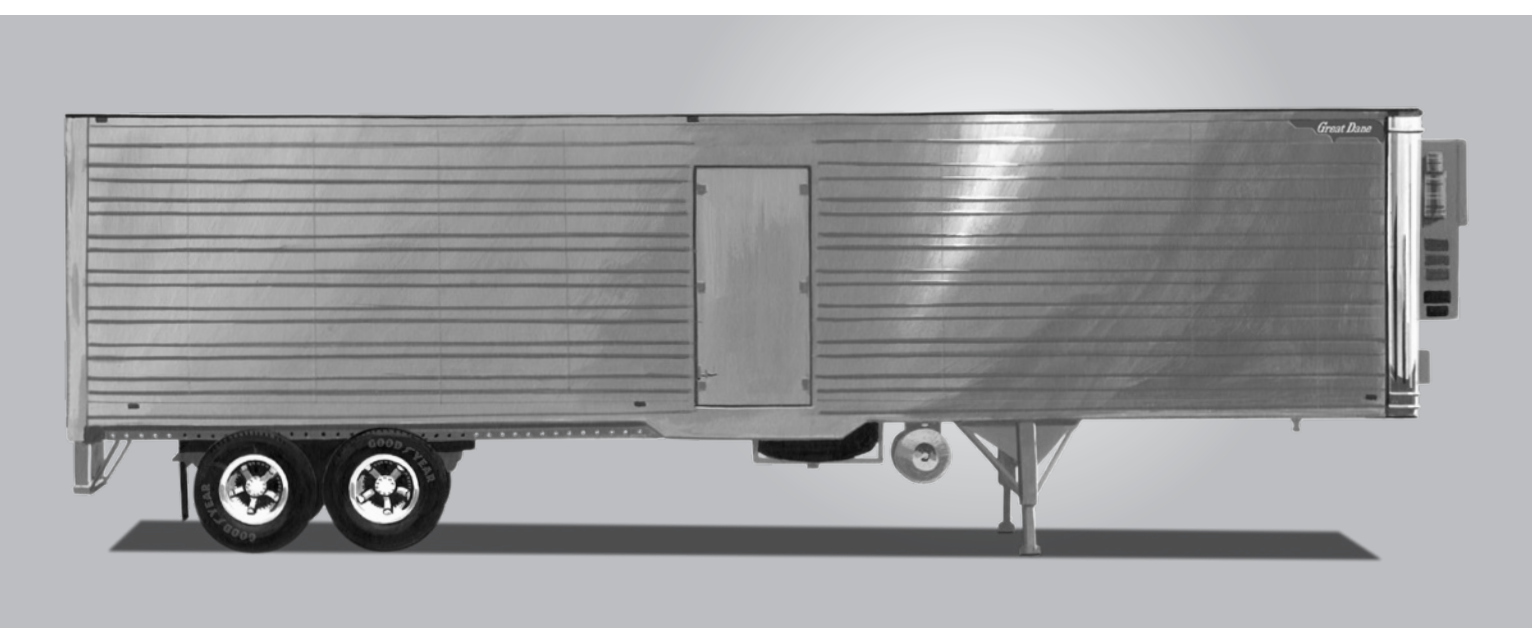

## MODELING TIPS

### HOBBY KNIFE

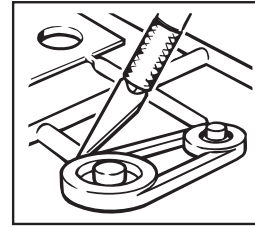

Use a sharp hobby knife to remove parts from the trees. Some parts may appear to have an extra "tab" on them, these should be removed.

### HEAT SWAGE

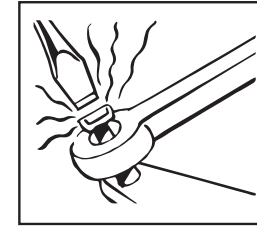

When heat swage is indicated, heat the tip of the knife in a candle or match flame. When touched to the plastic, the plastic will soften and form a "mushroom" head.

### TWEEZERS

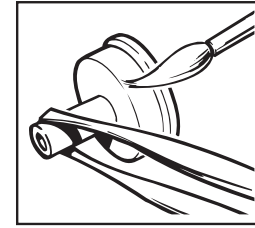

Tweezers are handy for holding very small parts during assembly or painting.

### CEMENT

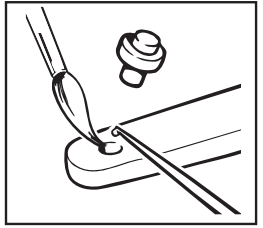

We recommend the use of liquid polystyrene cement. Apply with a fine brush or toothpick. Use cement sparingly or a sloppy job will result.

## PAINT COLORS

<b>A</b> Black	<b>I</b> Steel	<b>Q</b> Yellow	<b>MB</b> Metallic Blue
<b>B</b> Flat Black	<b>J</b> Brass	<b>R</b> Beige	<b>Z</b> Gray
<b>C</b> Semi-Gloss Black	<b>K</b> Gold	<b>S</b> Brown	<b>WB</b> Wood Brown
<b>D</b> White	<b>L</b> Amber	<b>T</b> Lt. Blue	<b>CC</b> Chassis Color
<b>E</b> Flat White	<b>M</b> Transparent Amber	<b>U</b> Med. Blue	<b>BC</b> Body Color
<b>F</b> Silver	<b>N</b> Red	<b>V</b> Dark Blue	<b>▲</b> Semi-Gloss
<b>G</b> Chrome (Bright Silver)	<b>O</b> Burgundy	<b>W</b> Transparent Blue	<b>▲</b> Gloss
<b>H</b> Aluminum	<b>P</b> Orange	<b>X</b> Lt. Green	<b>▲</b> Metallic

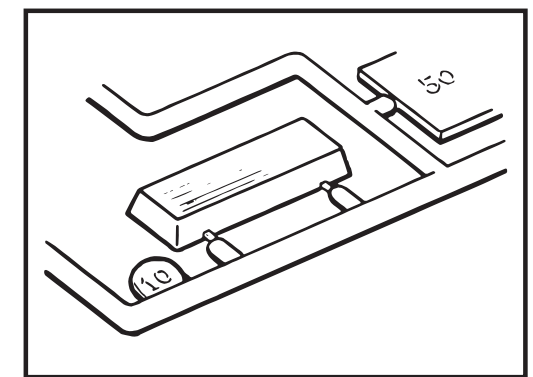

When you study your parts you will notice that each part is numbered. Remove parts from trees only as you use them — not before.

It is recommended that you search the internet for additional color references and details.

Glue the air tank—50—to the tandem frame—44. Glue the tandem spring frames—53, 54—to the tandem frame. Before the glue sets insert the crossbraces—45—into position and cement.

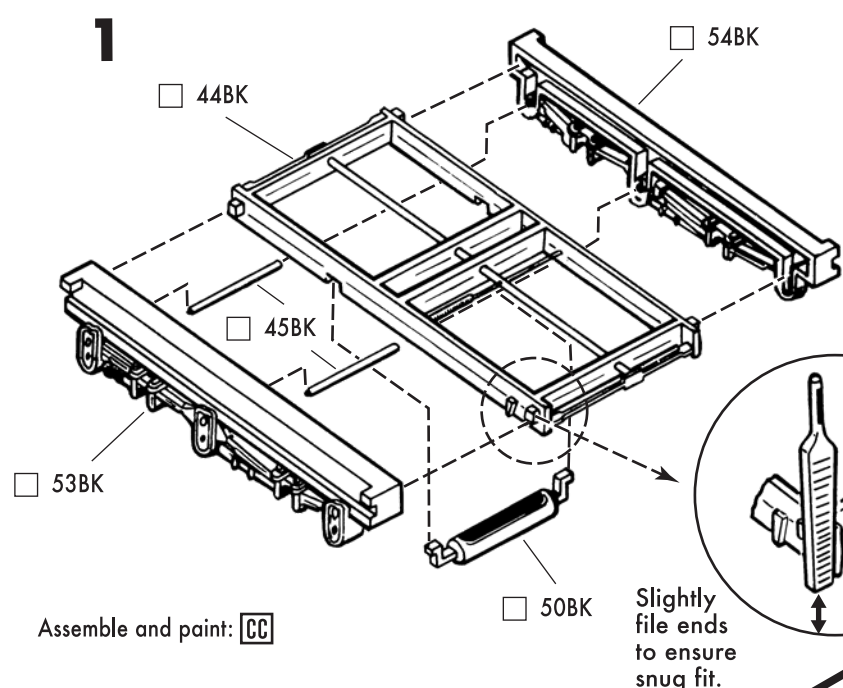

Assemble and paint: **CC**

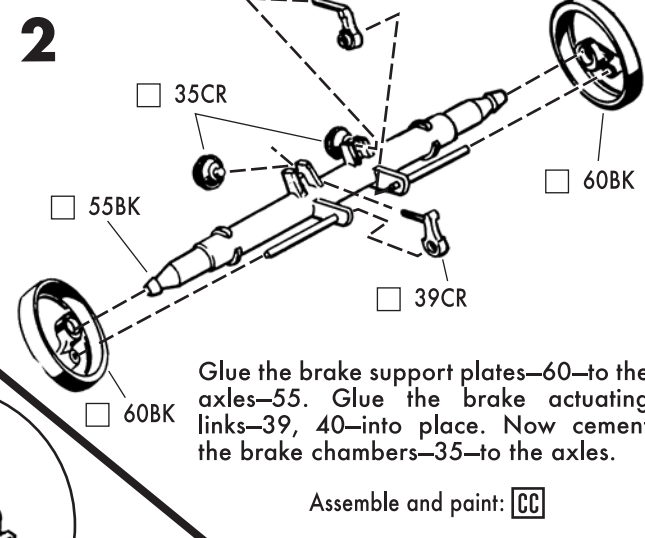

Glue the brake support plates—60—to the axles—55. Glue the brake actuating links—39, 40—into place. Now cement the brake chambers—35—to the axles.

Assemble and paint: **CC**

Scrape plating from glue joints

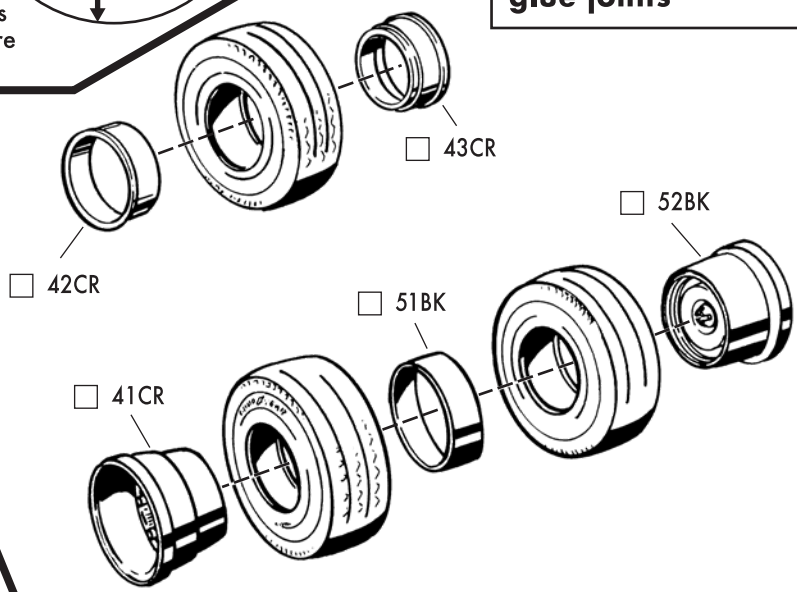

Make one spare tire and four road wheel sets as shown.

Glue the axle units to the tandem frame as shown. Glue mud flap—49—into position.

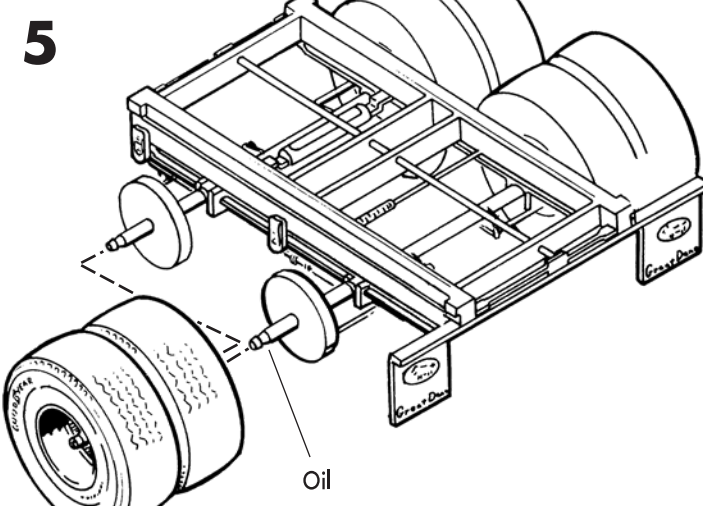
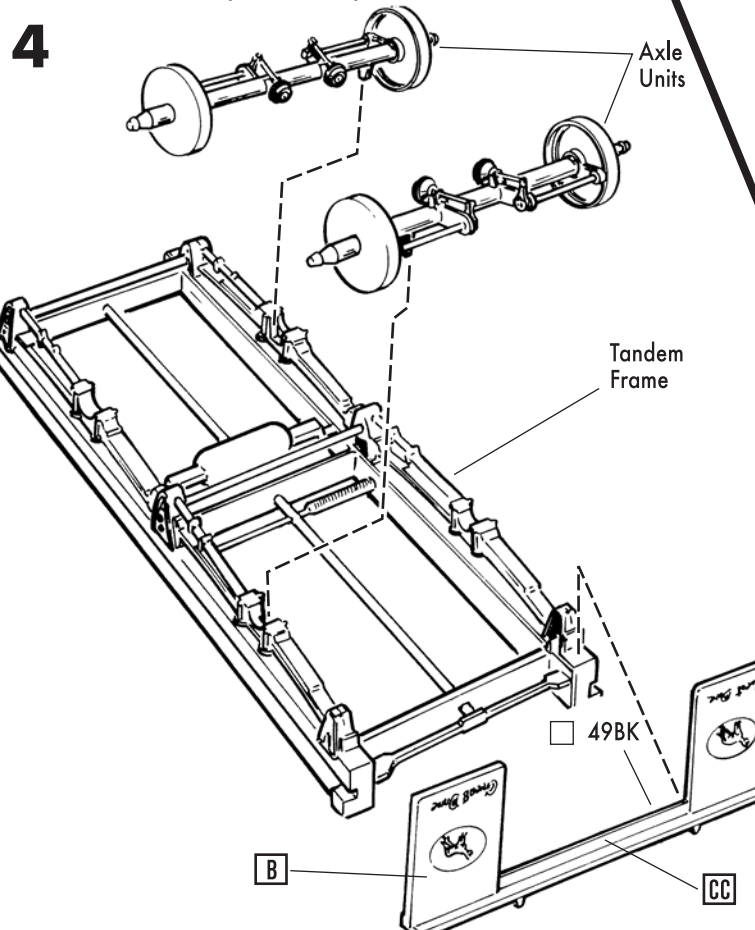

Place a drop of oil on the axle ends. Carefully snap the 4 sets of road wheels into place.

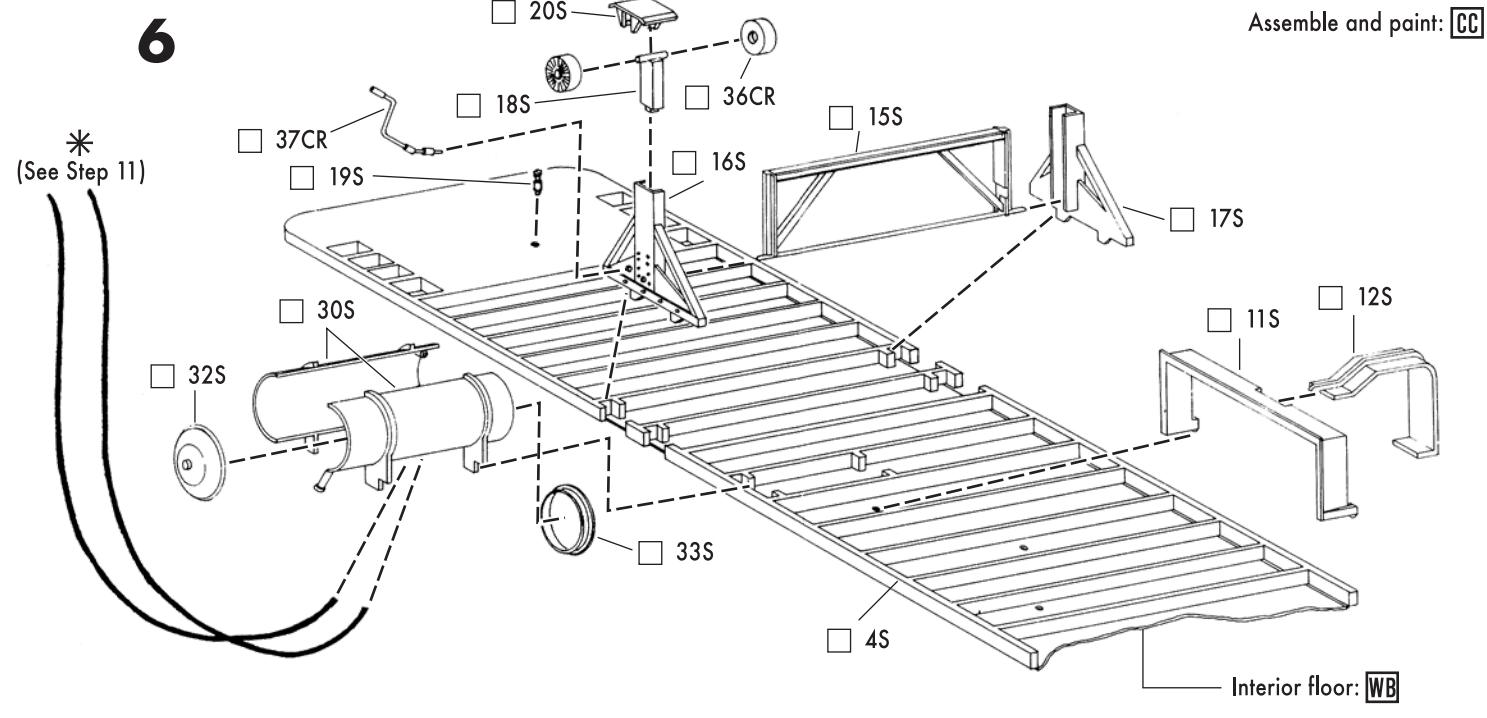

Assemble and paint: **CC**

Glue spare tire mount—11—and—12—together and glue to locator holes in floor as shown. Glue landing gear supports—17—and—16—and cross-bracing—15—to floor as shown. Glue support legs—18—to landing gear supports, glue either sand shoes—20—or wheels—36—to support legs. Glue king pin—19—to locator hole in floor as shown. Glue on crank—37—as shown. Assemble sump tank—30—32—33—and attach as shown. Glue two 9" lengths of vinyl tubing to pins on sump tank.

## 7

Glue sub-frame rails—9—10—to locator pins on floor. Place the tandem axle unit atop the frame rails, gently spread rails until axle drops into place—see END VIEW illustration. The tandem axle unit is now locked into place but can be slid forward or backward, or can be glued in place.

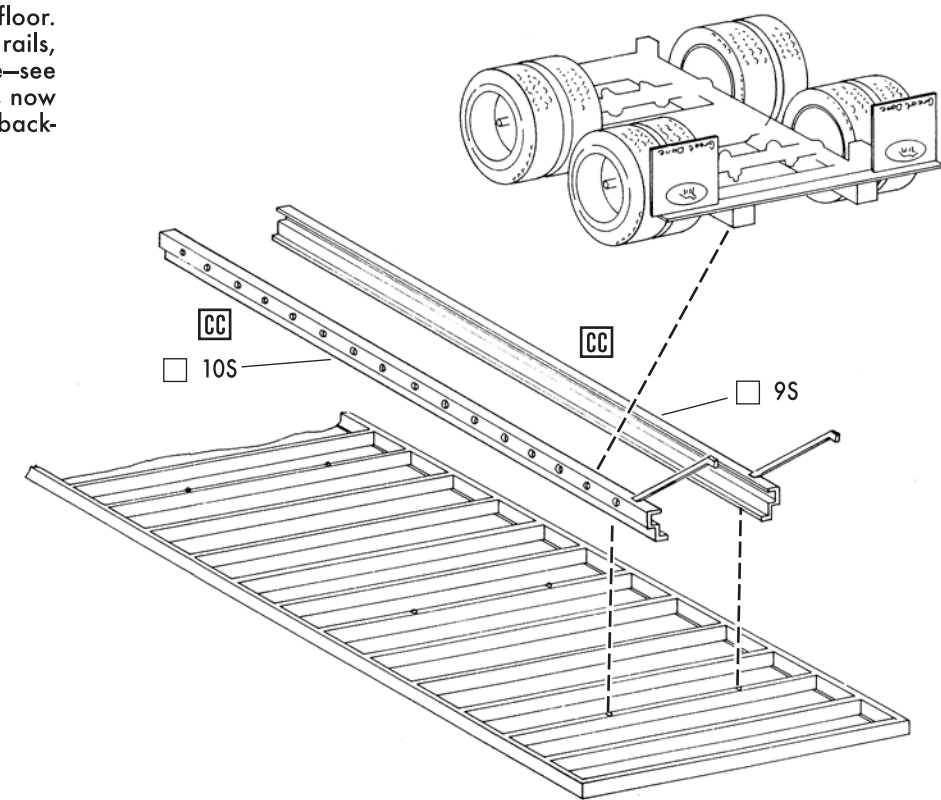
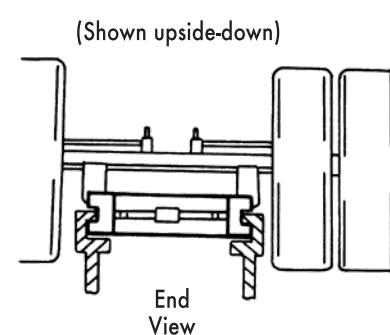

8

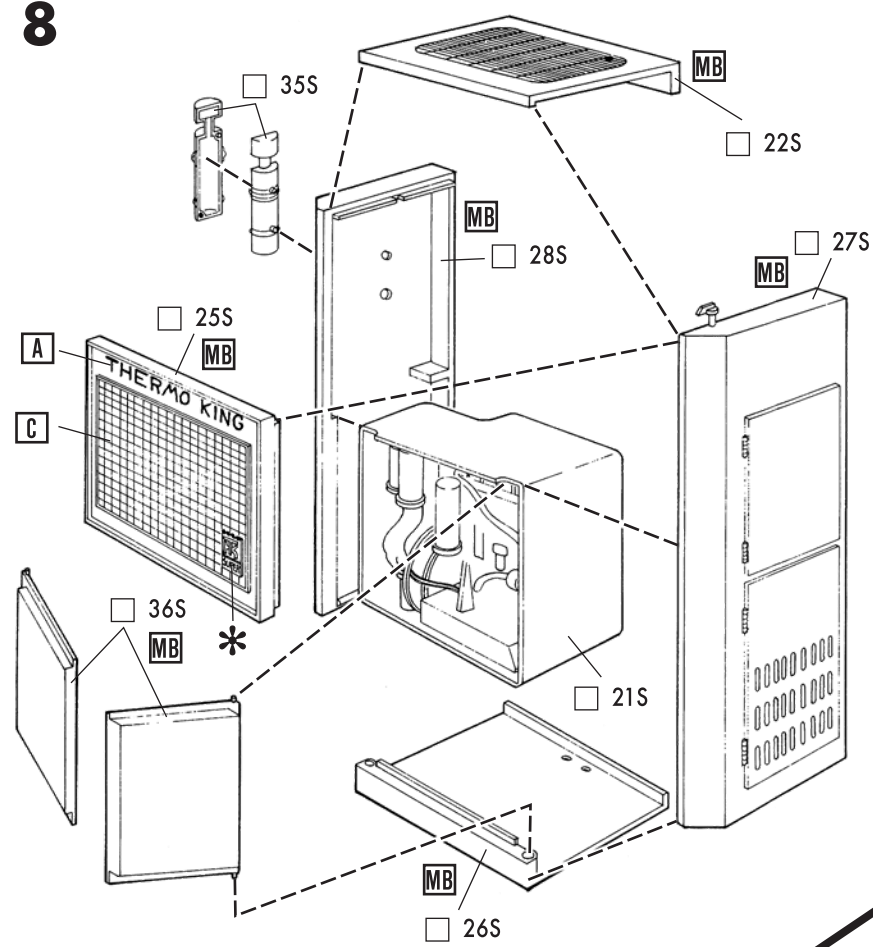

Glue reefer engine compartment—21—to inside of reefer right side—28. Glue reefer unit top—22—and bottom—26—to locators on reefer side, then attach left side—27. Position doors—36—into locator holes reefer door sill and notches on engine compartment. Glue on grille—25. Glue air cleaner halves together—35—and attach to locator holes on right side of reefer unit.

Engine compartment: **A**  
 Engine: **N**  
 Filters on engine: **P**  
 Lower left filter: **Q**  
 Upper left filters: **D**  
 \* Thermo King logo on grille:  
 Background: **A**  
 T: **F**  
 K: **T**  
 Grille: **C**  
 THERMO KING lettering: **A**

Scrape plating from glue joints

9

Glue evaporator halves—24—together and attach to opening in bulkhead—5—as shown. Hang reefer unit from evaporator tab and glue to front of bulkhead. Glue on battery boxes—31—as shown.

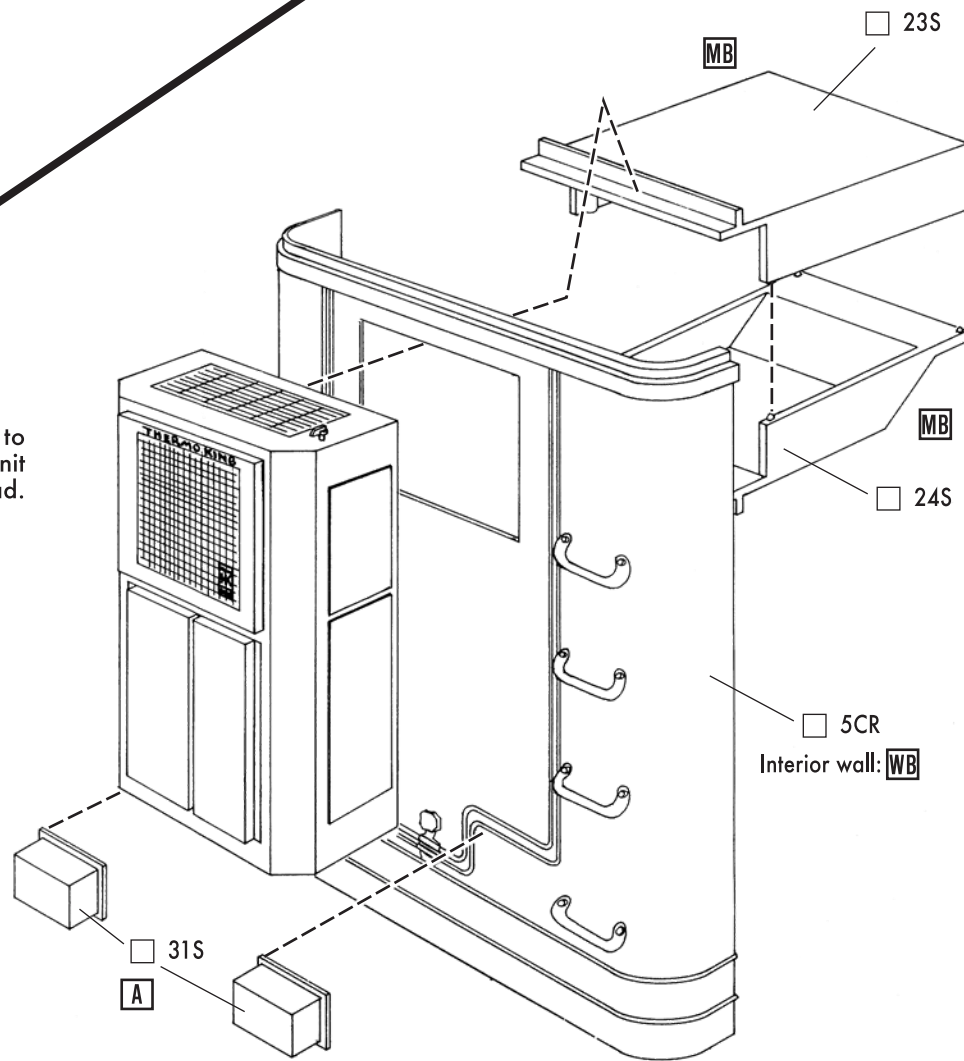
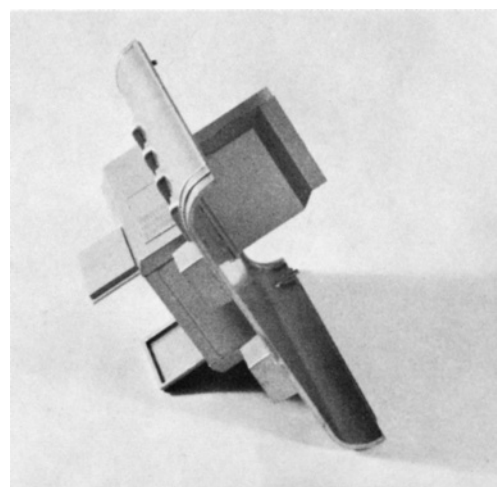

Scrape plating from glue joints

10

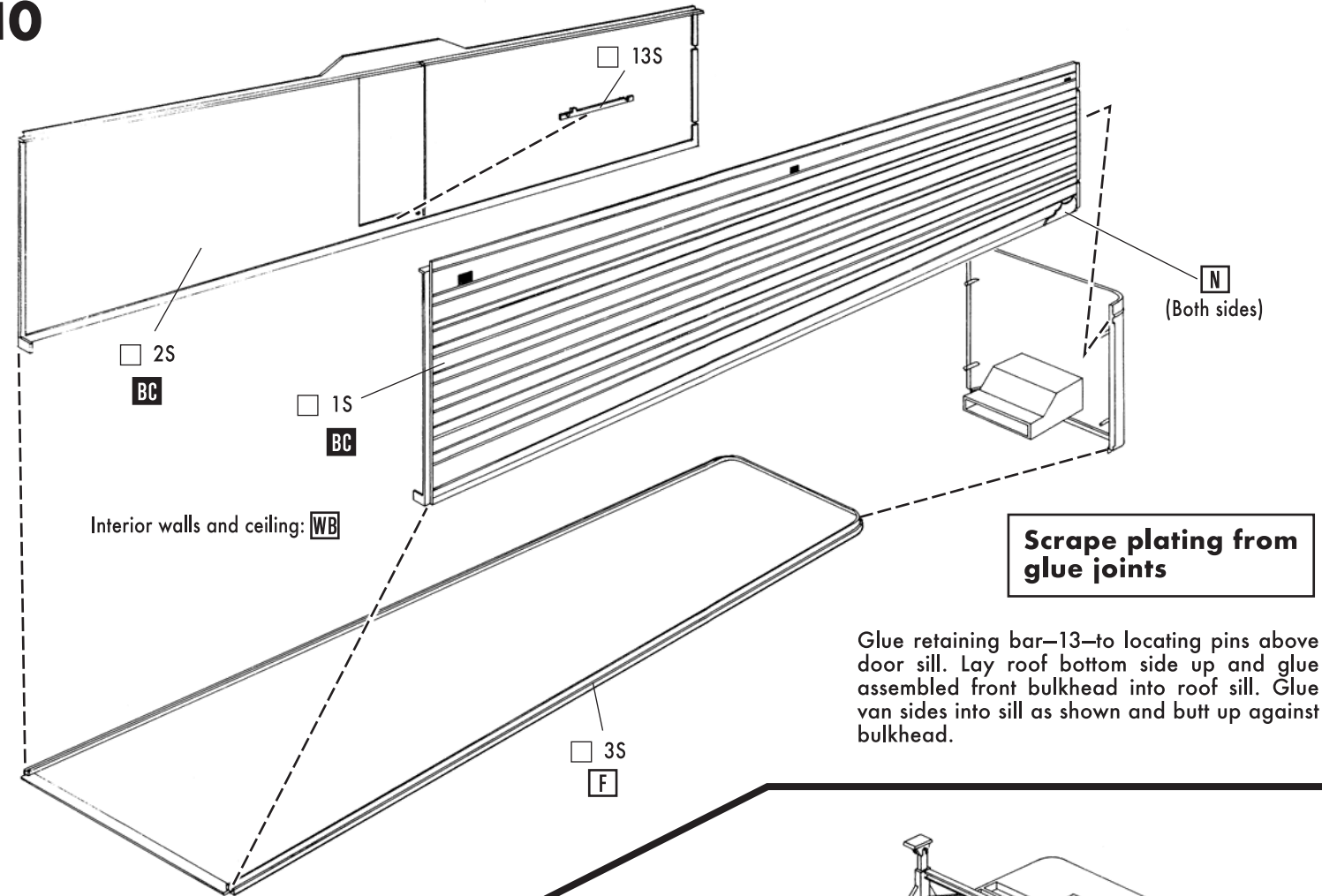

Scrape plating from glue joints

Glue retaining bar—13—to locating pins above door sill. Lay roof bottom side up and glue assembled front bulkhead into roof sill. Glue van sides into sill as shown and butt up against bulkhead.

11

Locate door—14—in open position to notches in door frame and retaining bar. Glue floor assembly to assembled van body. Glue on lights—67—to van body as shown. Glue vinyl tubing to locating holes in bottom of reefer unit.

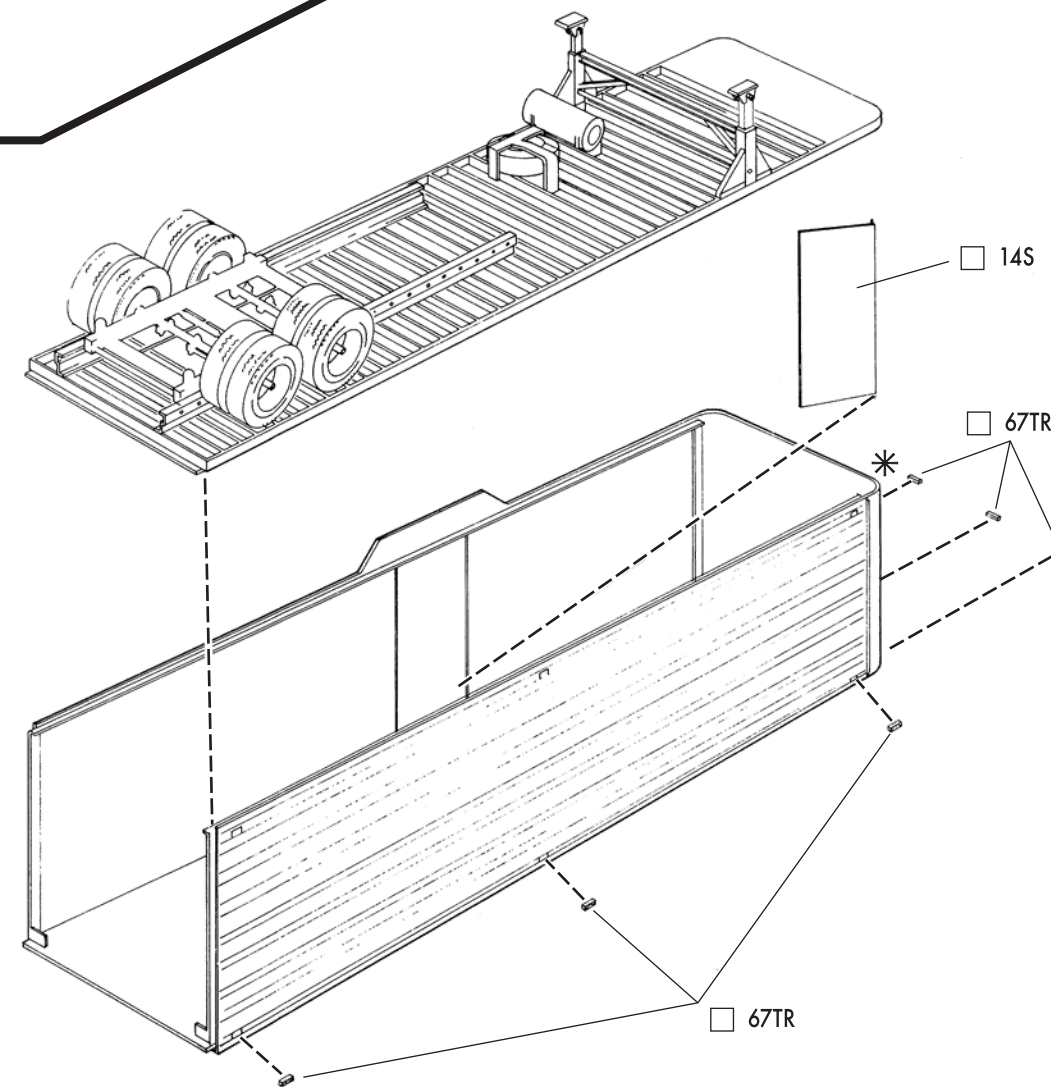
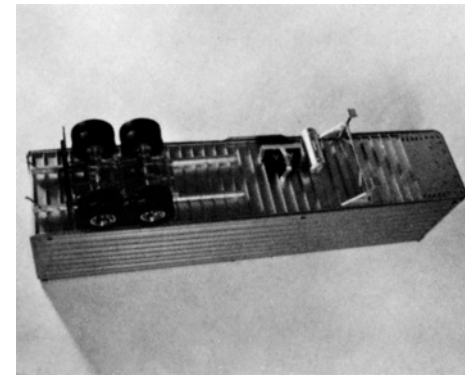

12

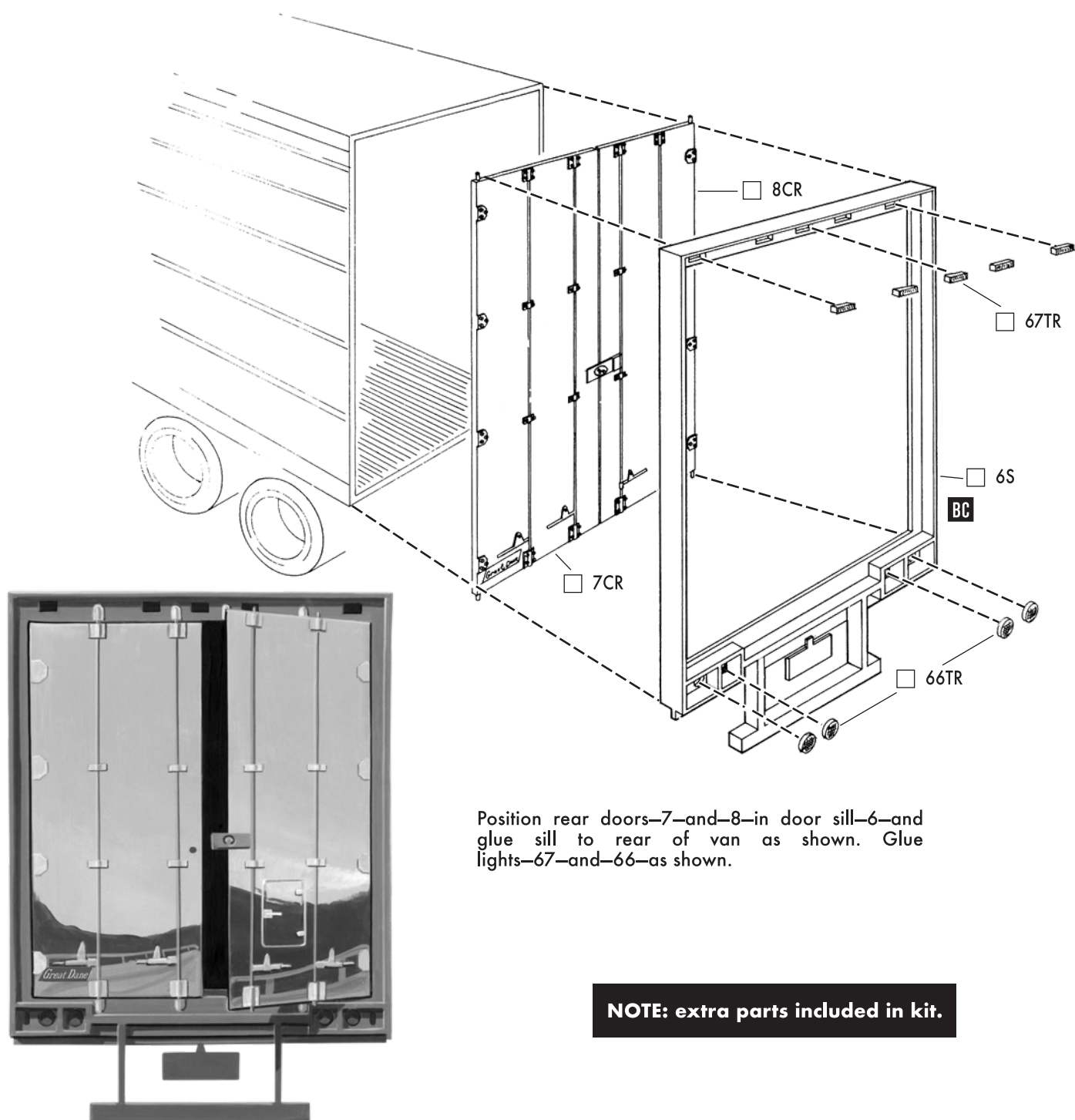

Position rear doors—7—and—8—in door sill—6—and glue sill to rear of van as shown. Glue lights—67—and—66—as shown.

NOTE: extra parts included in kit.

### Nomenclature

01S Left Wall Panel	19S King Pin	54BK Tandem Spring Frame - Left
02S Right Wall Panel	20S Sand Pads (2)	55BK Axles
03S Roof Panel	35CR Brake Chamber	60BK Brake Support Plate
04S Floor Panel	36CR Landing Gear Wheels	66TR Stop and Tail Lamps
05CR Bulkhead	37CR Landing Gear Crank	67TR Identification Lamps
06S Rear Door Frame	38CR Air Connections "Gladhands"	21S Reefer - Engine Insert
07CR Right Rear Door	39CR Brake Actuating Link	22S Reefer - Top
08CR Left Rear Door	40CR Brake Actuating Link	24S Evaporator
09S Sub-Frame Rail - Right	41CR Outer Wheel Rim	25S Reefer - Grille
10S Sub-Frame Rail - Left	42CR Spare Tire Rim - Outside	26S Reefer - Bottom
11S Spare Tire Bracket - Front	43CR Spare Tire Rim - Inside	27S Reefer - Left Side
12S Spare Tire Bracket - Rear	44BK Tandem Frame	28S Reefer - Right Side
13S Door Retaining Bar	45BK Cross Brace	30S Sump Tank
14S Side Door	49BK Mud Flaps	31S Battery Box
15S Landing Gear - Cross Brace	50BK Air Tank	32S Sump Tank - Front
16S Landing Gear - Right Side	51BK Wheel Spacer	33S Sump Tank - Back
17S Landing Gear - Left Side	52BK Inner Rim	35S Air Cleaner
18S Gear Post (2)	53BK Tandem Spring Frame - Right	36S Reefer Doors

## MORE GREAT TRUCK & TRAILER KITS FROM THE KATS AT



AMT1132/06: DOUBLE HEADER! EXTERIOR POST DOUBLES VANS



AMT1140/06: GMC® ASTRO 95

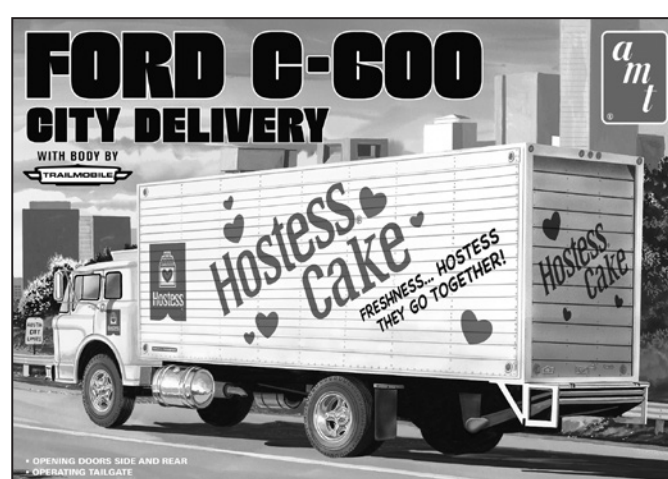

AMT1139/06: HOSTESS/FORD C-600 CITY DELIVERY



AMT1099/06: AUTOCAR A64B TRACTOR



AMT1193/06: HAULAWAY FIVE-CAR TRAILER

FIND THESE KITS AND MORE @ ROUND2CORP.COM