

PARTS LOCATING DIAGRAM

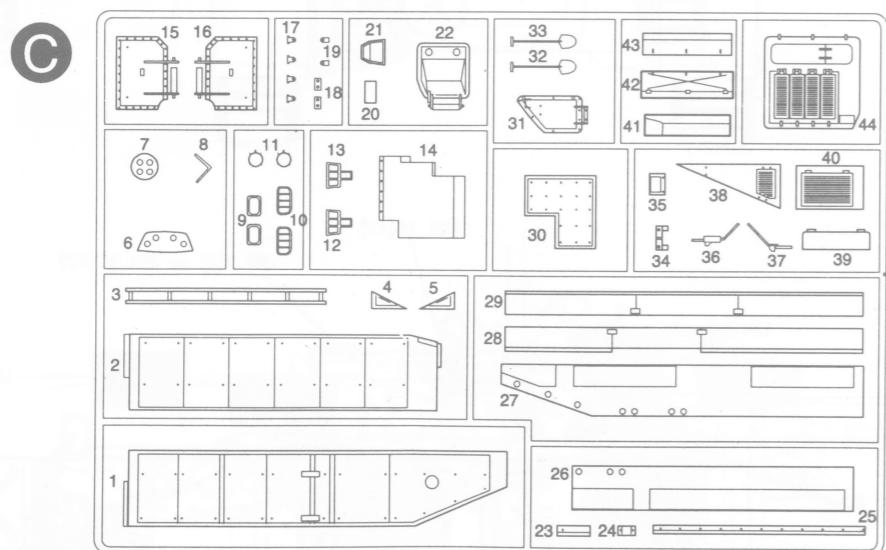
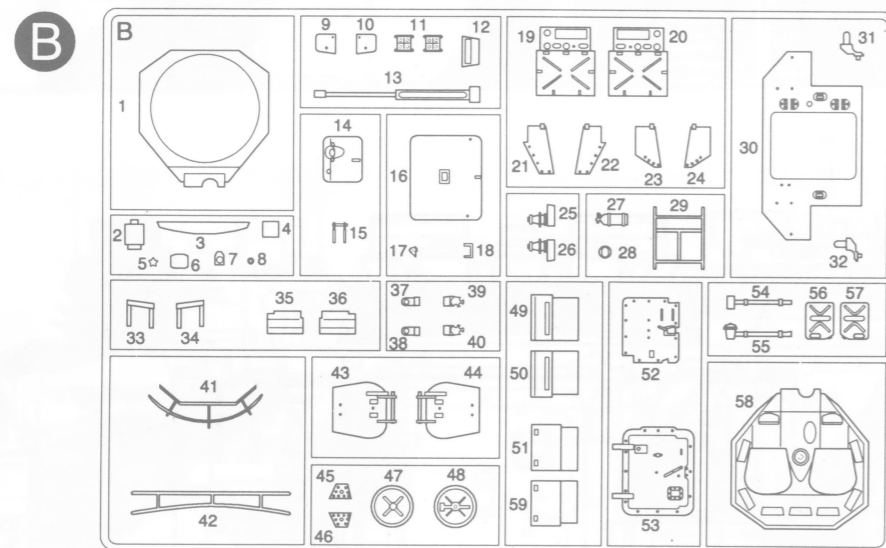
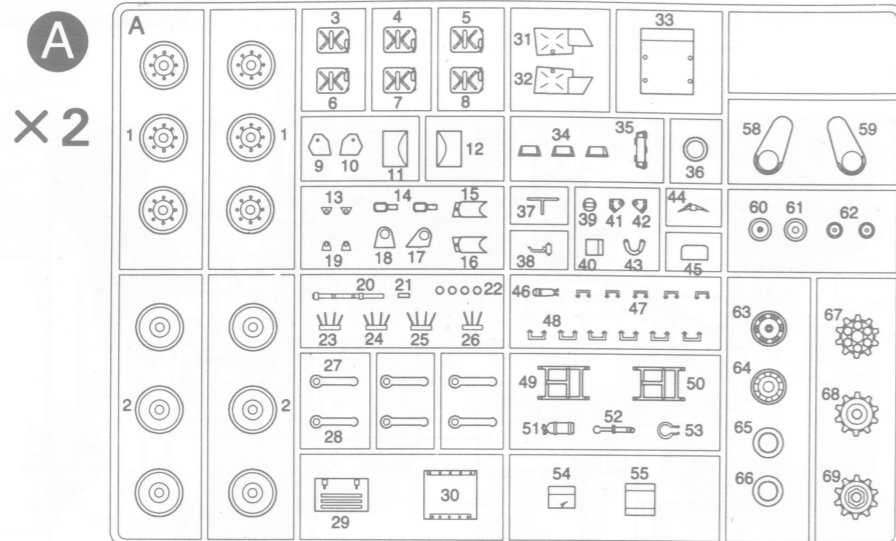

- Upper hull 1
- Lower hull 1
- Track 2
- Decal 1
- Mesh 1
- Thread 1
- Poly cap 1

■ UNUSED PARTS

- A: 15,16, 69
- C: 23
- Poly cap: Small 4
Large 4

ACADEMY
HOBBY MODEL KITS

MECHANISED COMBAT VEHICLE WARRIOR MCV

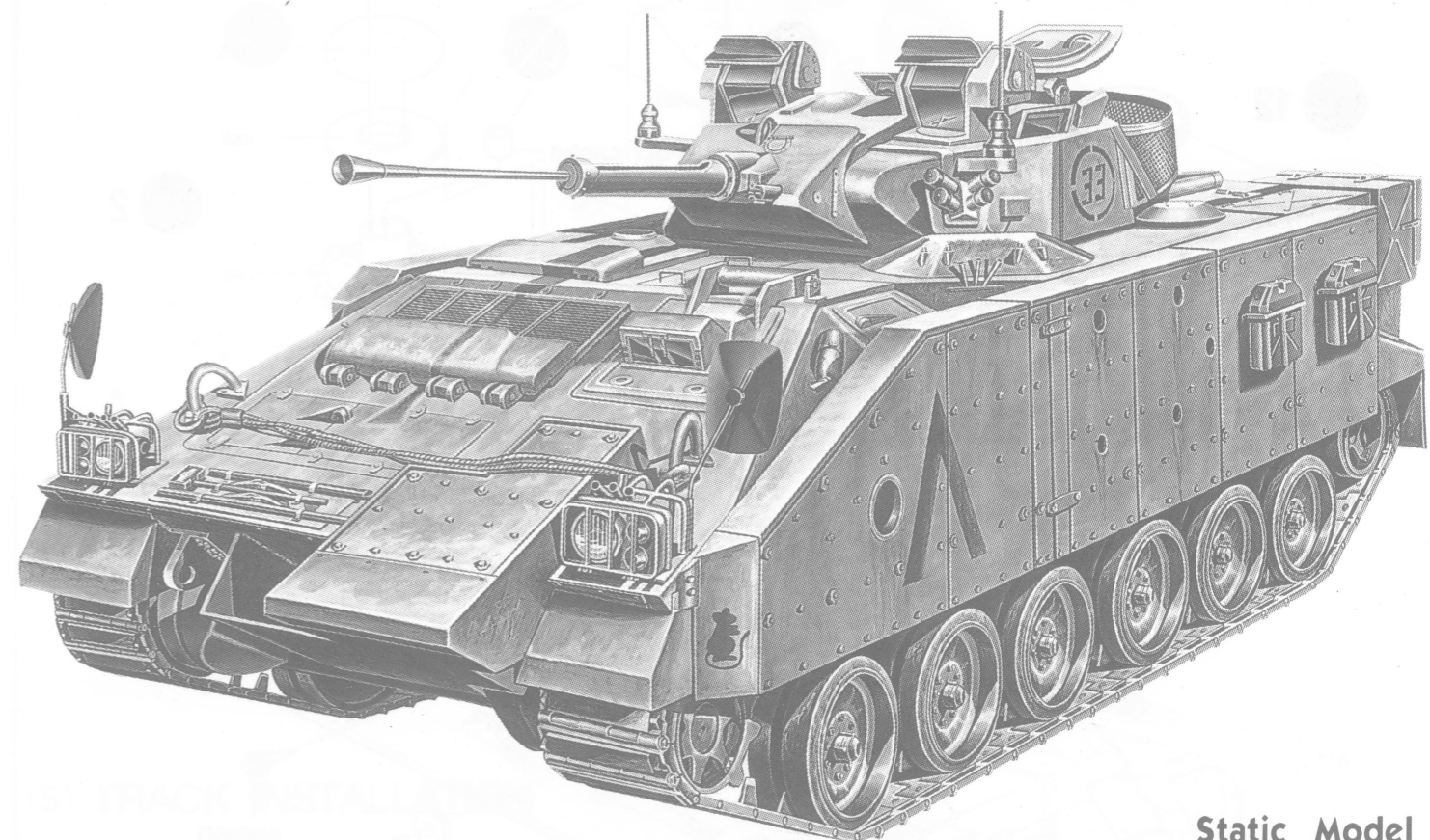

Static Model

1/35th SCALE

1365

Warrior Mechanised Combat Vehicle was developed in mid-1970s by GKN Defence for the British Army. In 1978 a parallel evaluation of the American M2 Bradley IFV took place. The following year full development of the Warrior started in parallel with continued study of the M2 Bradley. Production of Warrior began in January 1986 with first production vehicles completed in the December. It was officially handed over to the British Army in May 1987. The total requirement was for 1,053 vehicles and by late 1994 over 789 vehicles had been delivered to the British Army. Eight mechanised infantry battalions will now be equipped with the Warrior in service only with British Army, two in the UK and six in Germany.

The hull of Warrior is of all-welded aluminum construction with well sloped glacis plate. The engine is a Perkins CV8 TCA V8 diesel developing 550hp at 2,300rpm which is coupled to an American Allison X300-4B transmission, manufactured under licence in the UK by Perkins Engines. And the turret of Warrior has vertical sides with long barrel 30mm RARDEN cannon with 7.62mm L94A1 Chain Gun and mounted in external mantlet. For operations in the Middle East and Bosnia-Herzcegovina, the Warrior was fitted with additional armor protection.

©1996 ACADEMY PLASTIC MODEL CO., LTD.

Copyright 1996 Academy Plastic Model Co., Ltd.
273-64, Suyu-dong, Kangbuk-ku, Seoul, Korea FAX: 82-2-997-3003

1365

 Cement Parts Coller Kleben Pegar Incollare Colar Kleven	 DO NOT cement Ne pas coller Nicht kleben No pegar Non incollare Nao colar Niet kleven	 Cut away Couper Scheiden Cortar Tagliare Cortar Snijden	 Optional parts Choix Auswahlmöglichkeit Eleccion Scelta Opcao Keuze	 Repeat operation Répéter l'opération Vorgang wiederholen Repetir la operación Ripetere Repetir a operação Herhalen
---	---	---	---	--

① WHEEL ASSEMBLY

* This kit can be choose to standard type or Add-On Armor type.

※ () is opposite number.

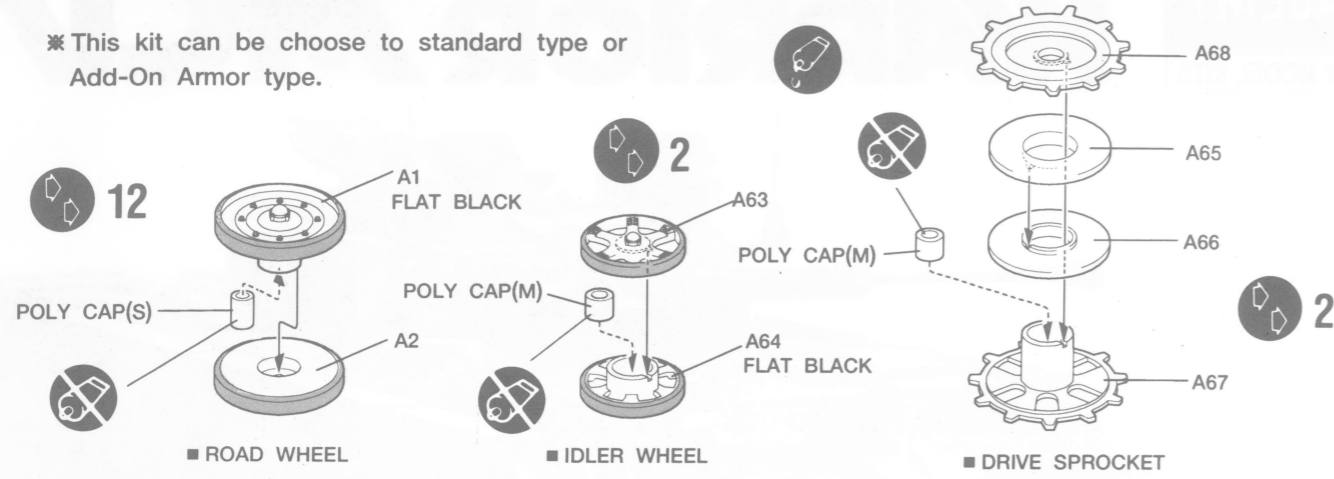

② SUSPENSION ASSEMBLY

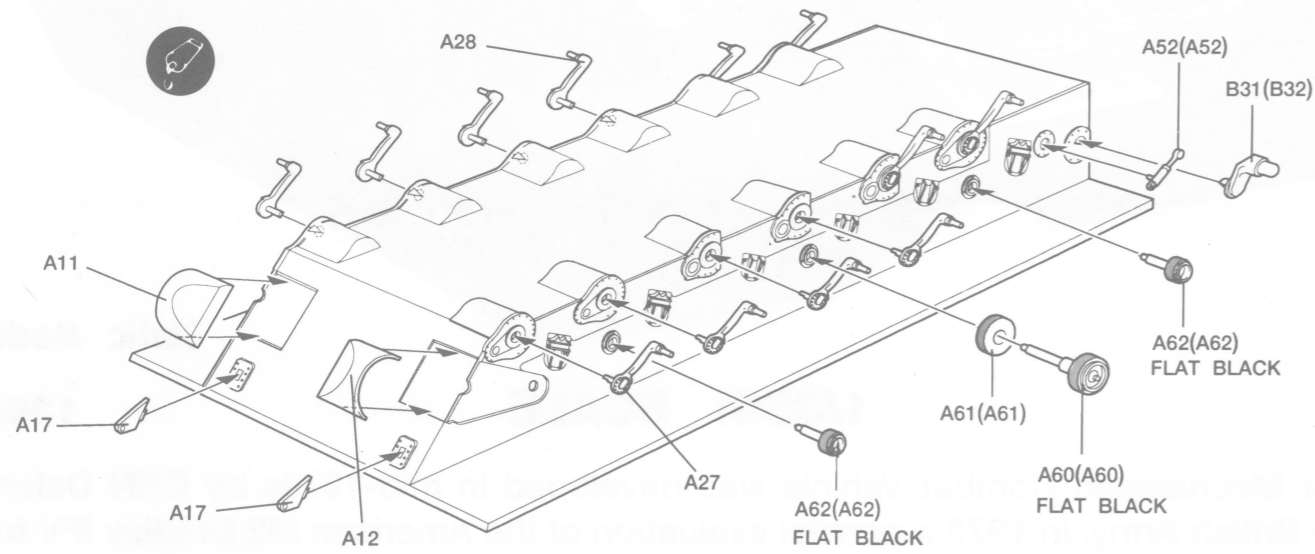

③ WHEEL INSTALLATION

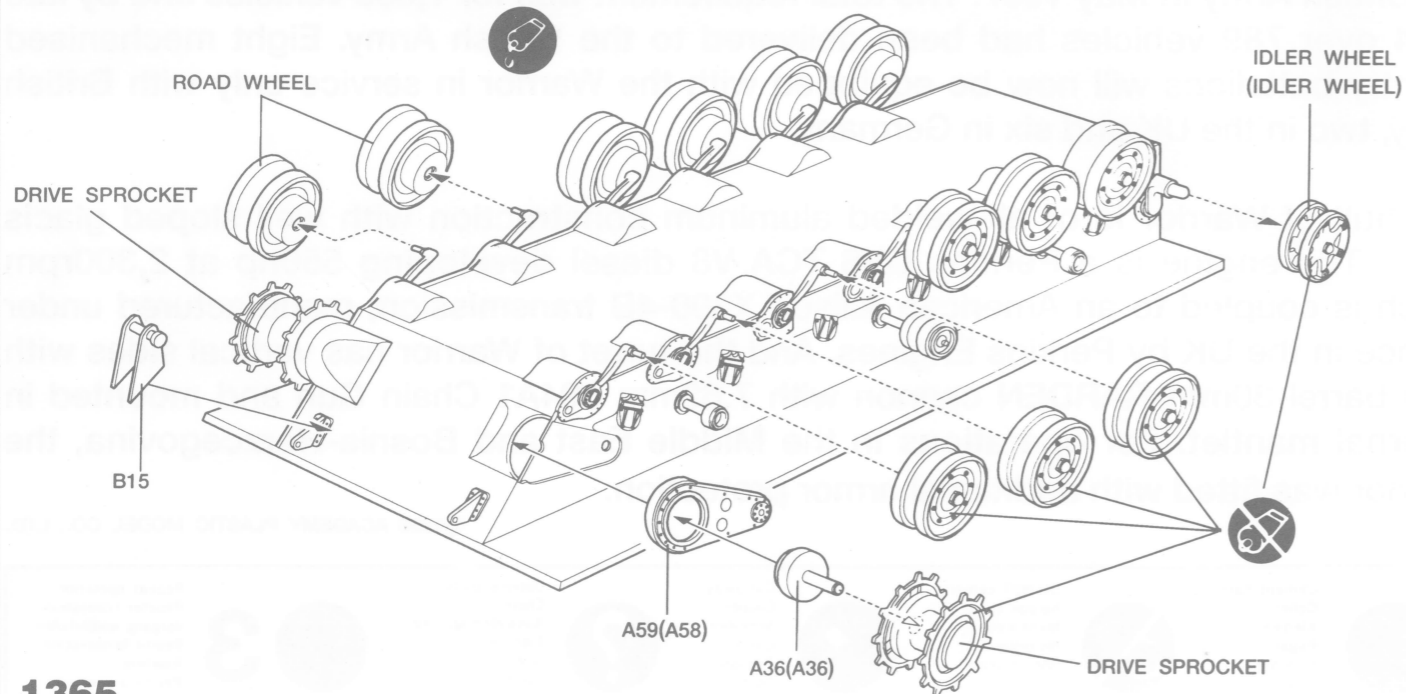

④ REAR PANEL ASSEMBLY

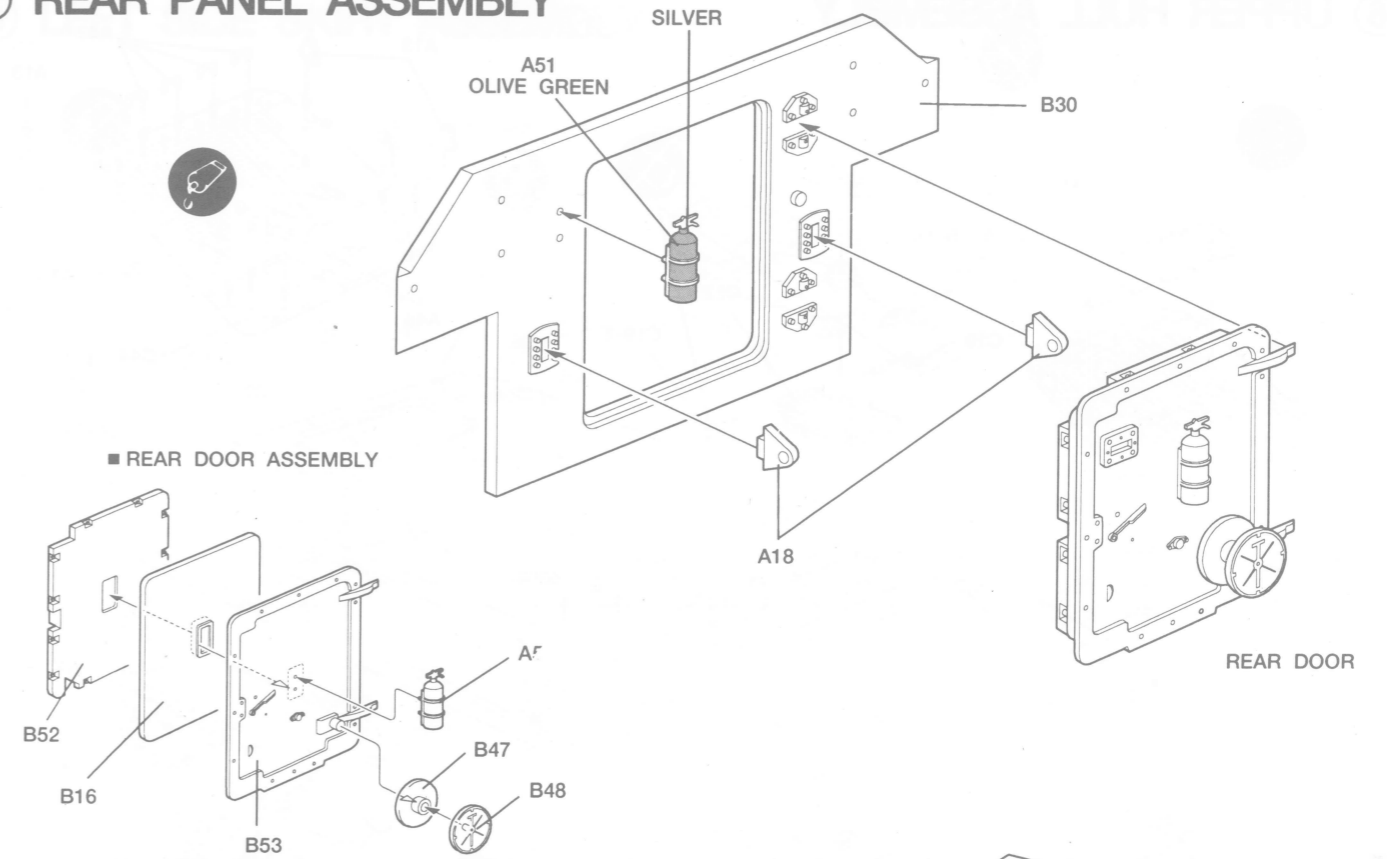

⑤ TRACK INSTALLATION

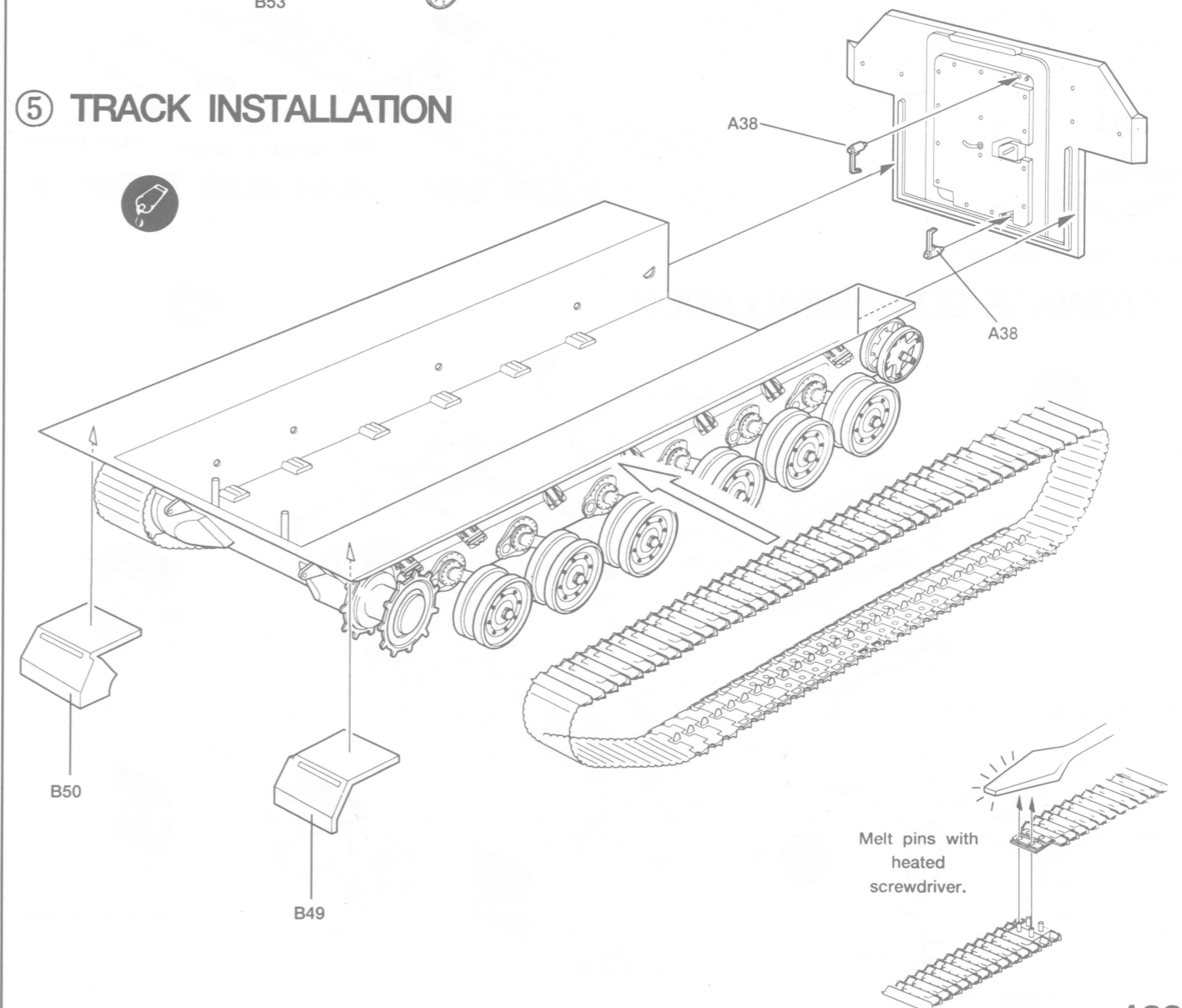

⑥ UPPER HULL ASSEMBLY

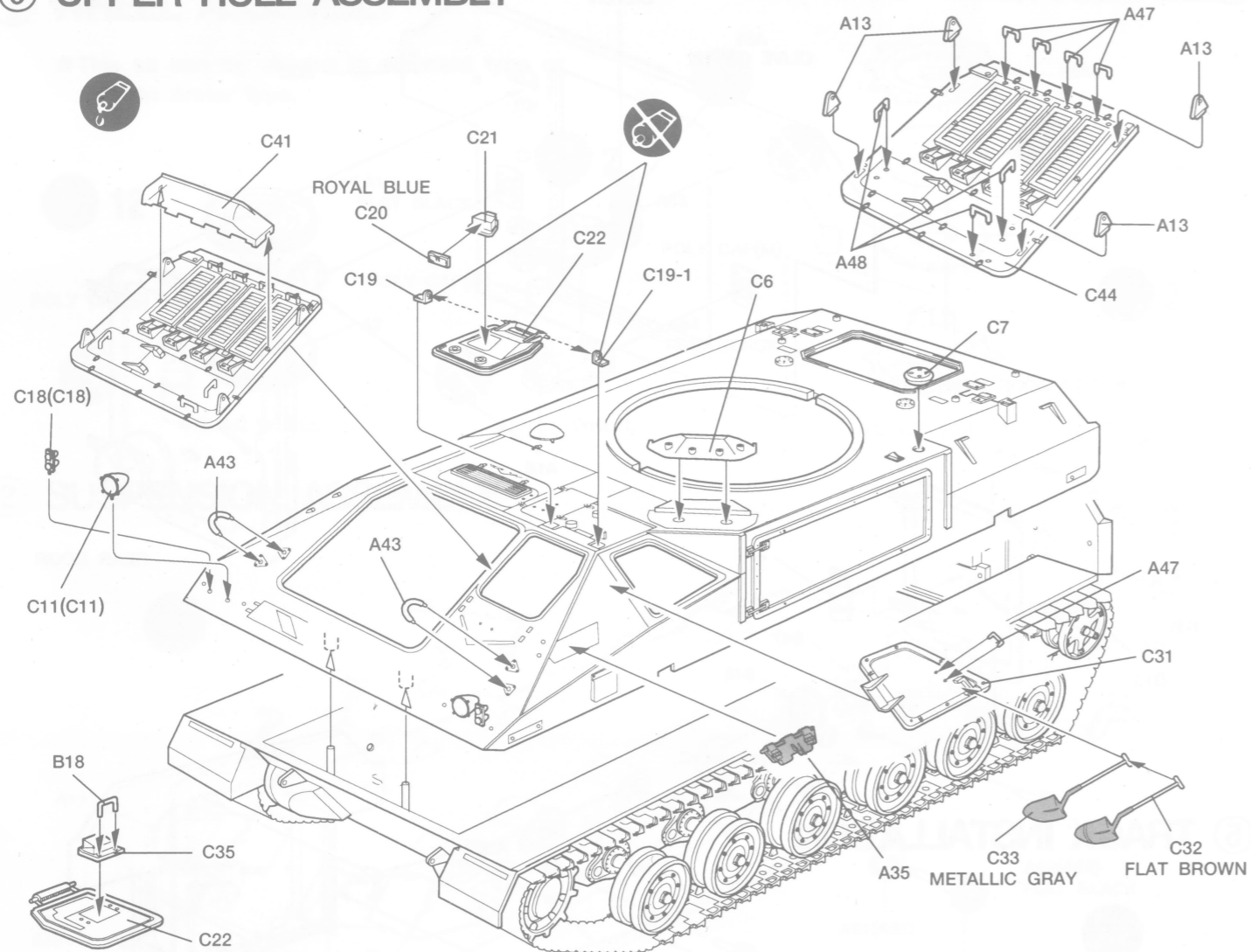

■ DRIVER'S HATCH ASSEMBLY

⑦ STOWAGE BOX INSTALLATION

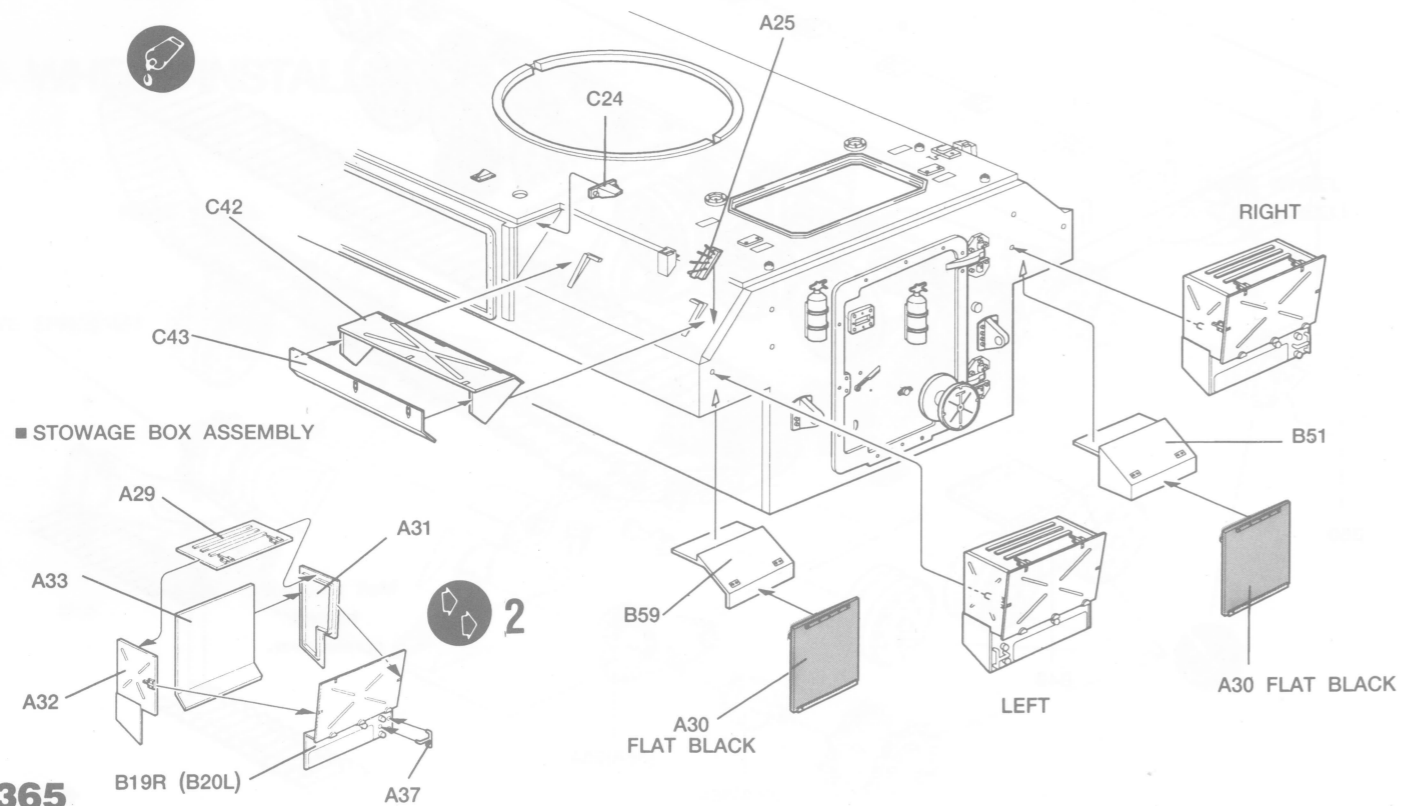

1365

⑧ LEFT SIDE SKIRT ASSEMBLY

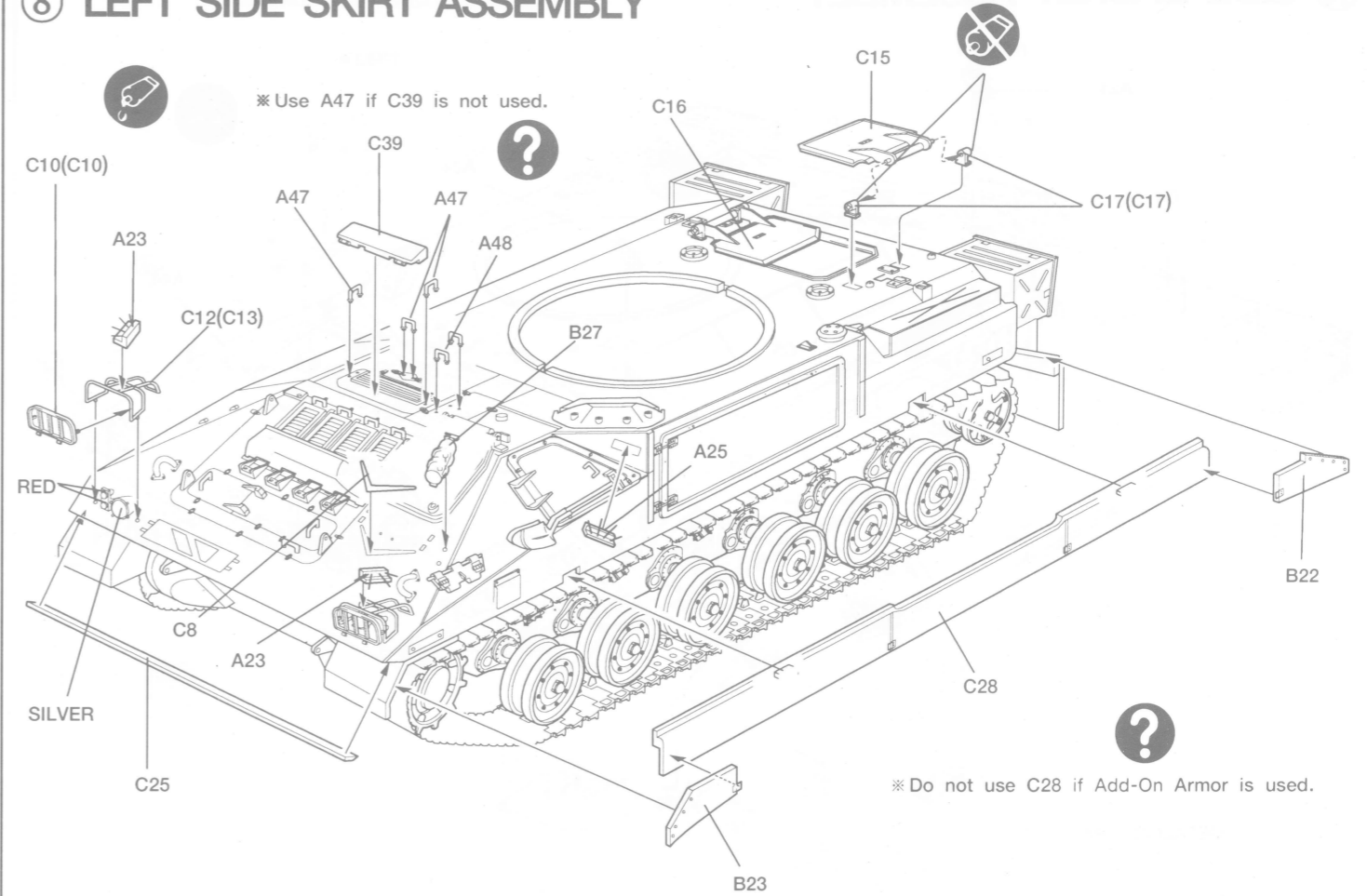

⑨ RIGHT SIDE SKIRT ASSEMBLY

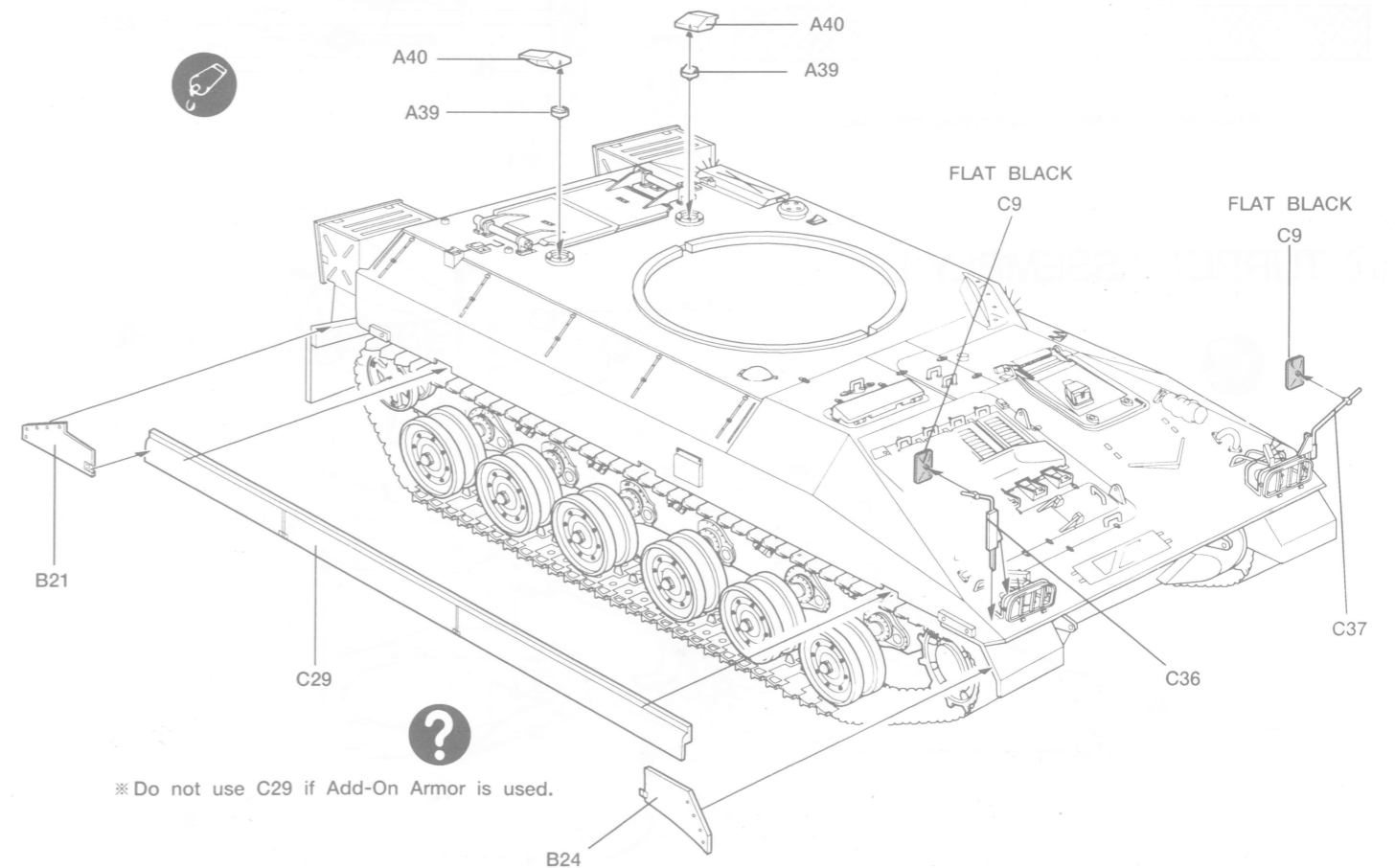

1365

10 SIDE BASKET ASSEMBLY

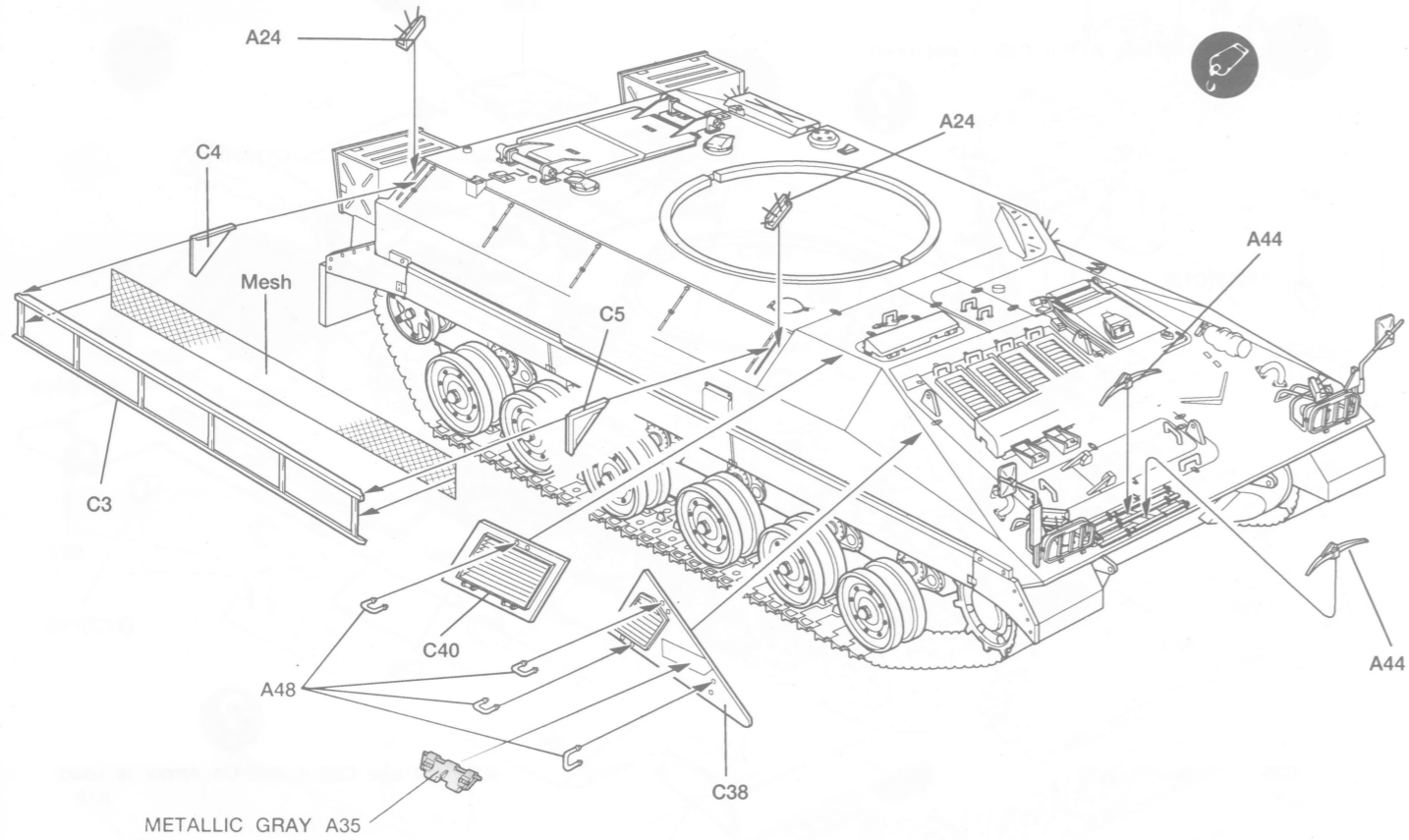

■ ACTUAL SIZE

87.5mm



*Cut Screen Mesh to size using template.

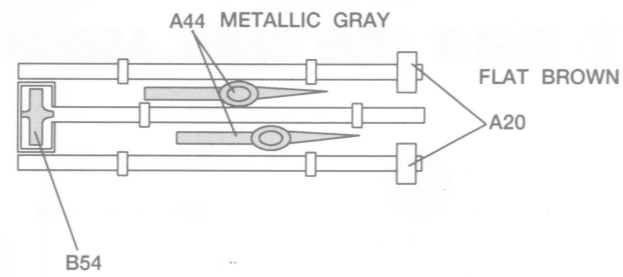

11 TURRET ASSEMBLY I

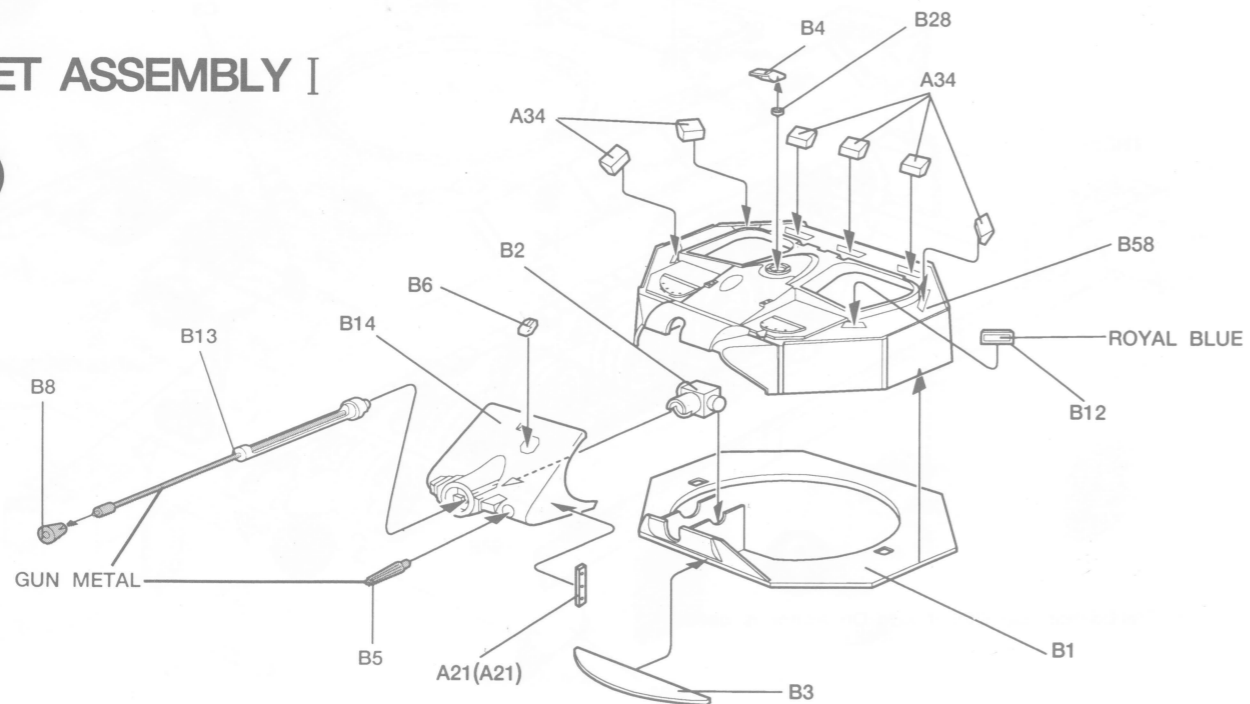

1365

■ SMOKE DISCHARGER ASSEMBLY



12 HATCH ASSEMBLY

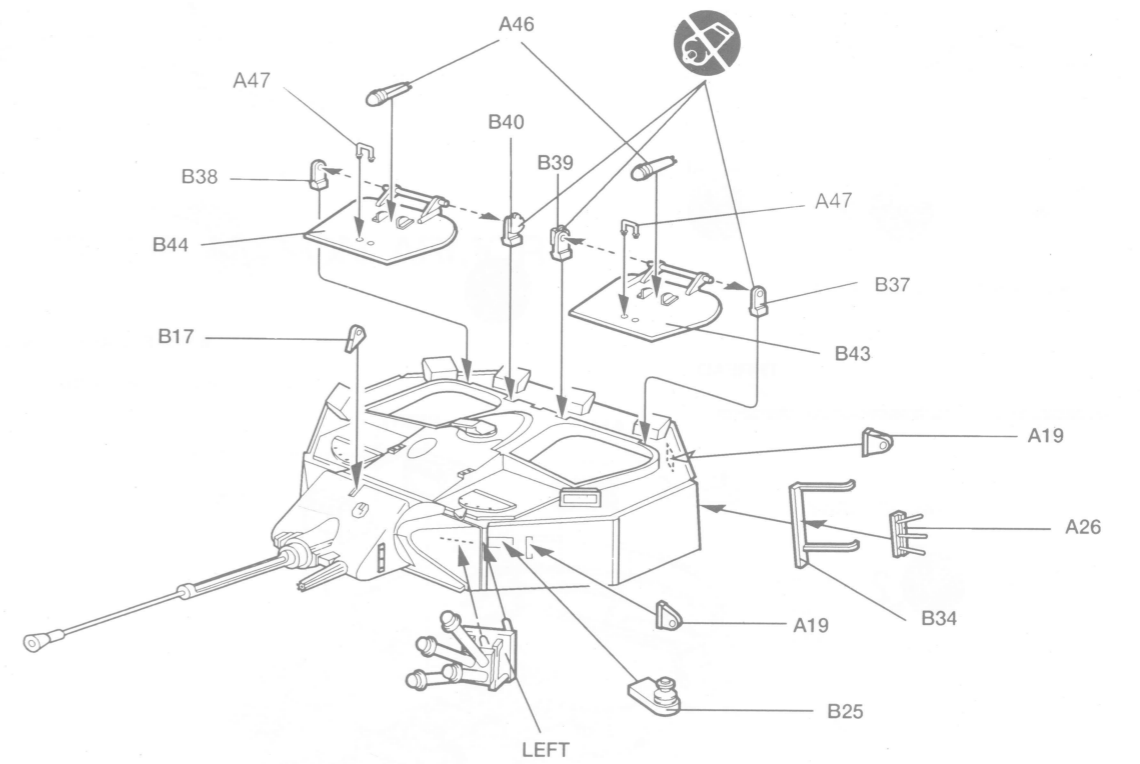

13 TURRET ASSEMBLY II

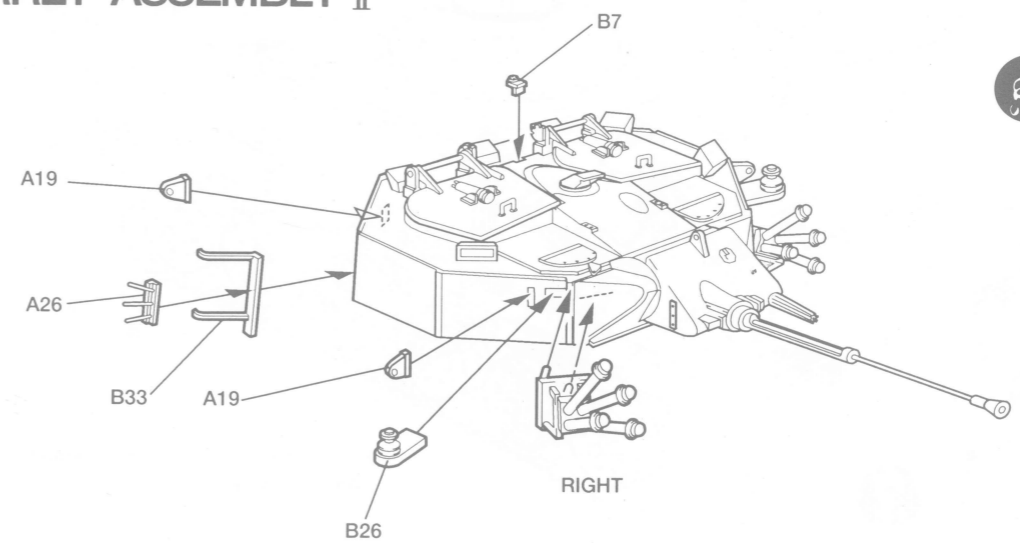

1365

14 TURRET INSTALLATION (COMPLETE OF STANDARD TYPE)

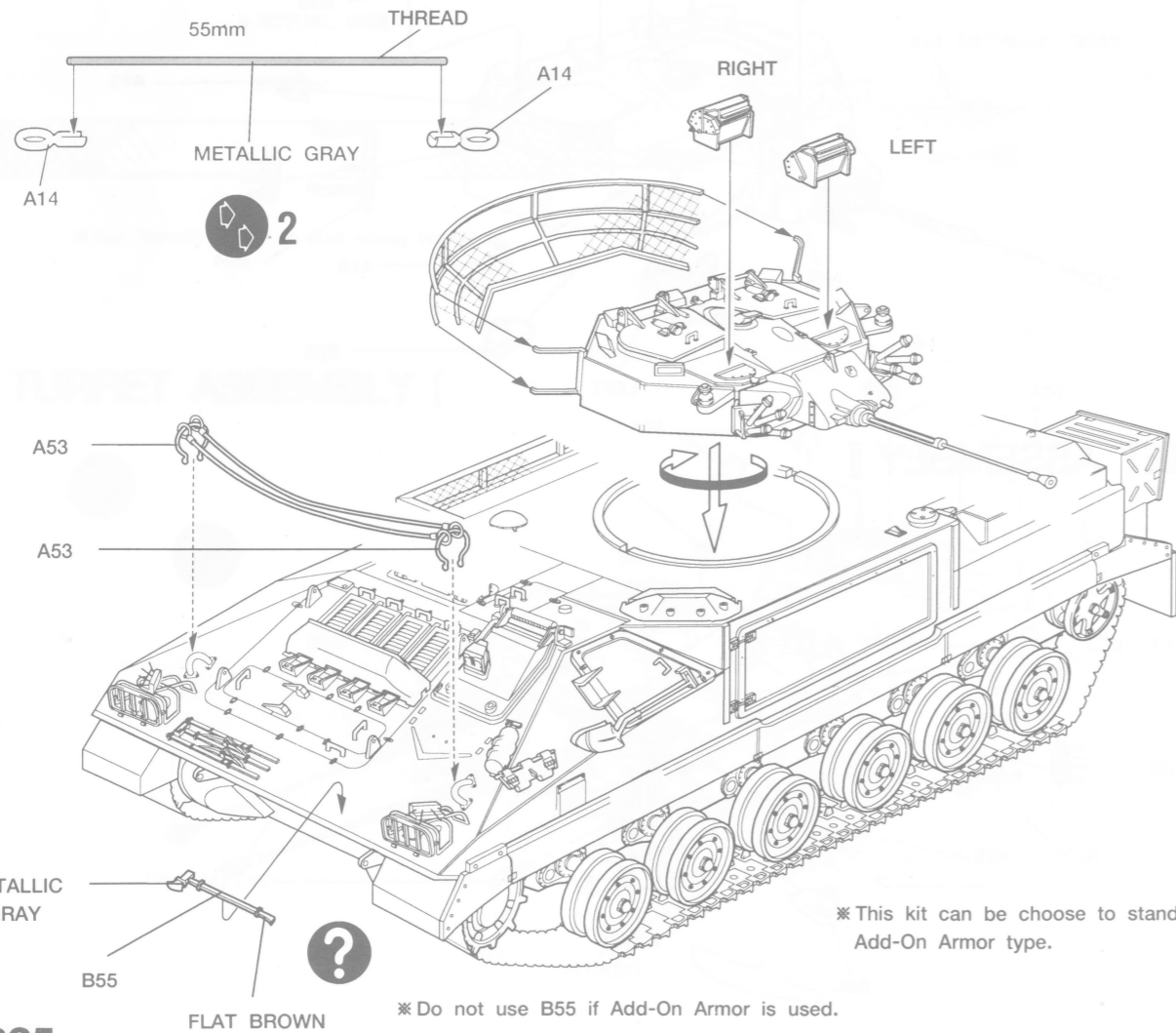
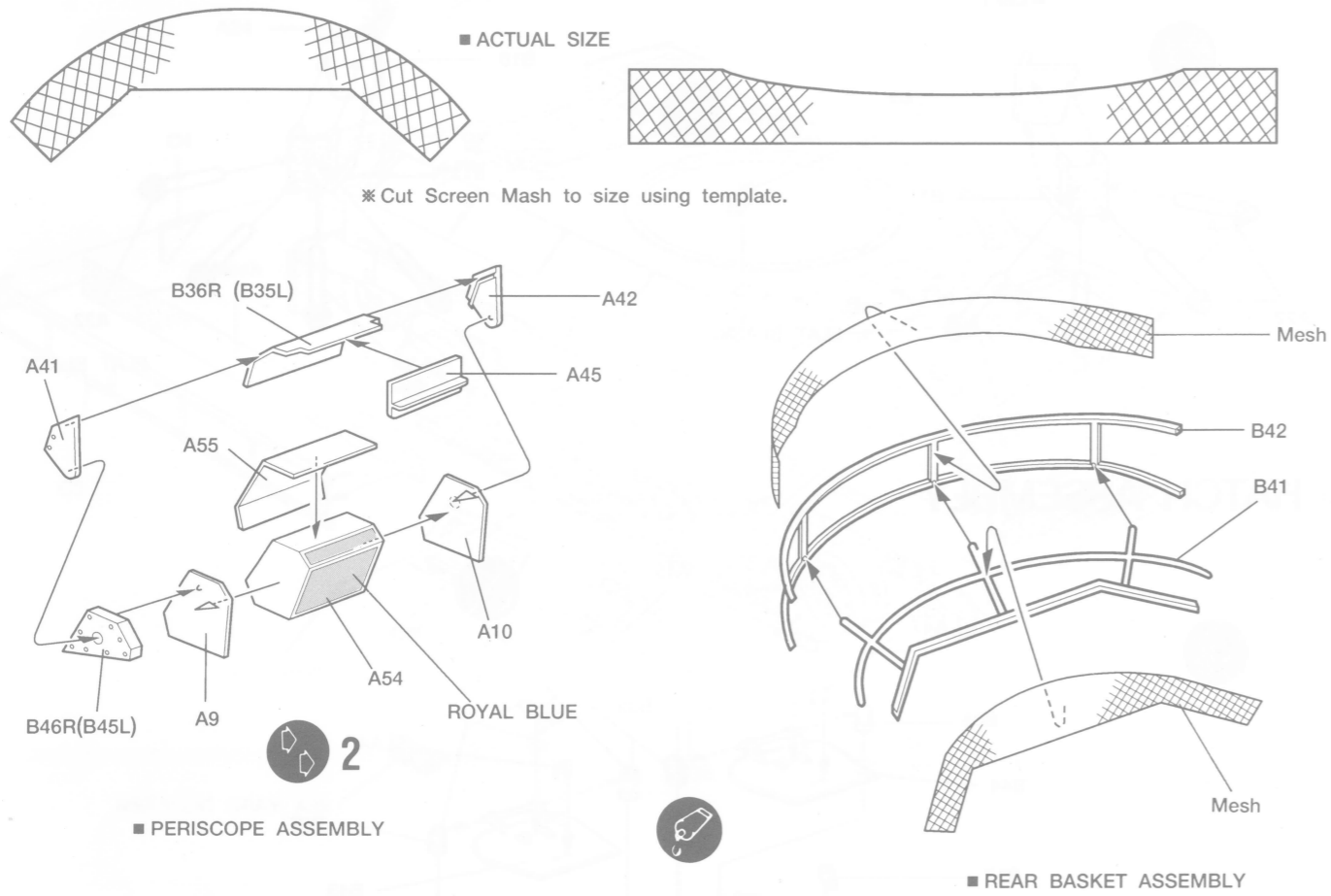

15 ADD-ON ARMOR PLATE ASSEMBLY

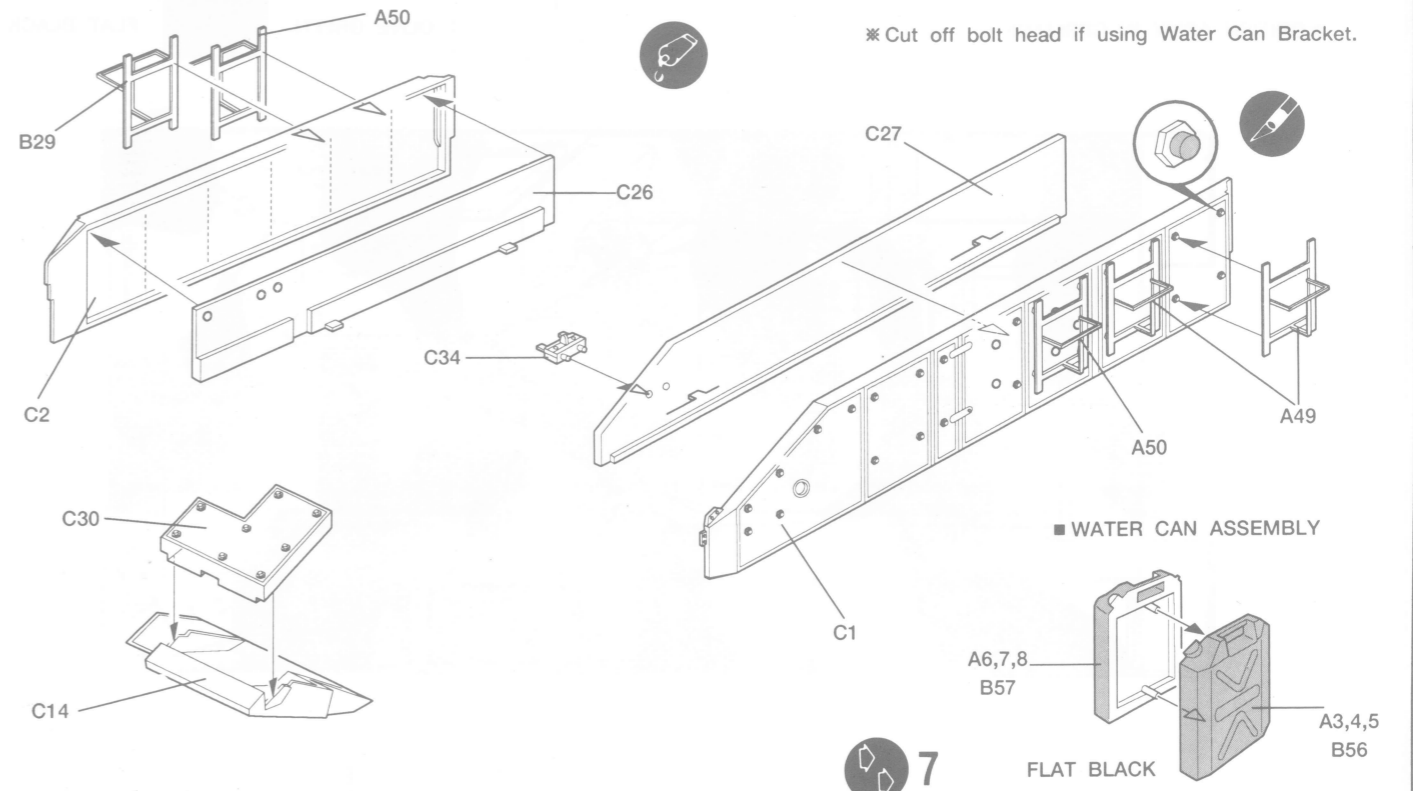

16 COMPLETE OF ADD-ON ARMOR

*Make hole B25, B26 if attached Antenna.

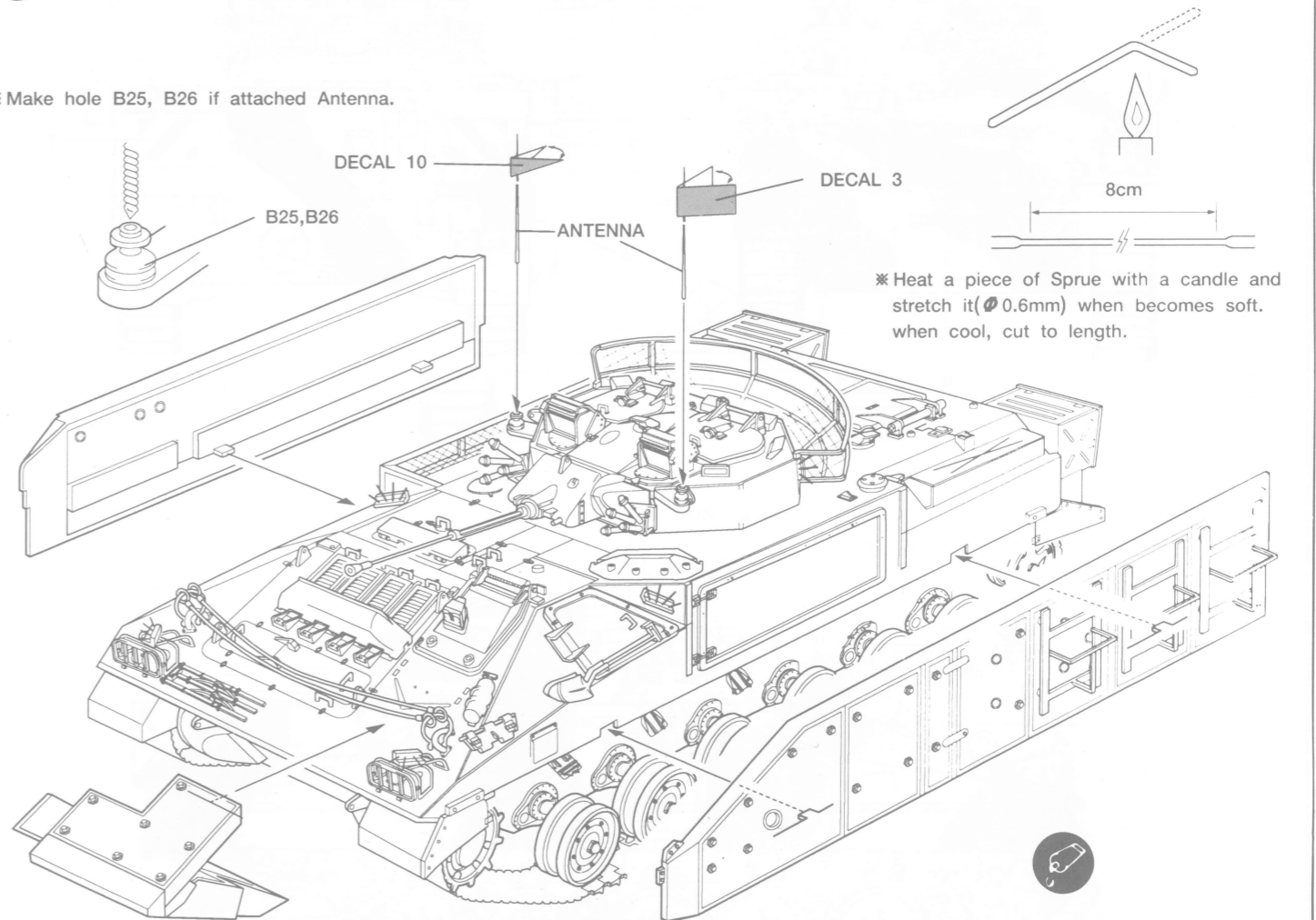

PAINING & DECAL PLACEMENT

■ BRITISH ARMY IN GERMANY

OLIVE GREEN FLAT BLACK

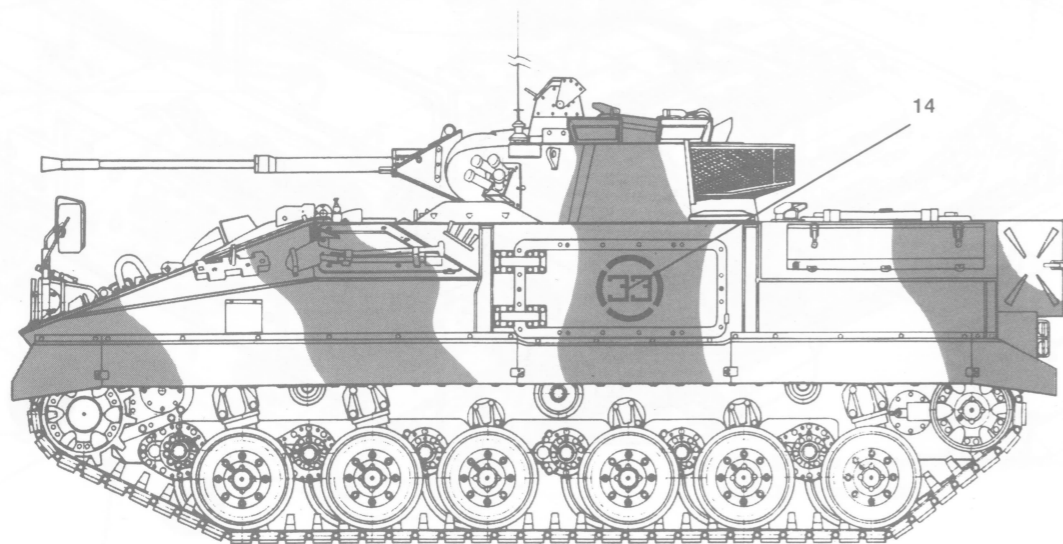
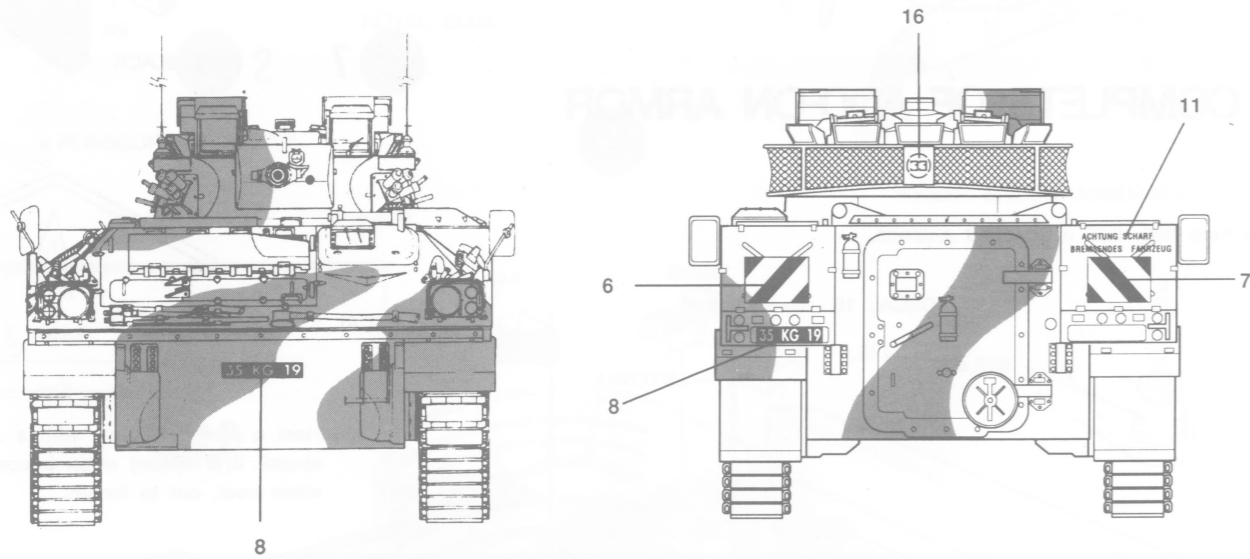
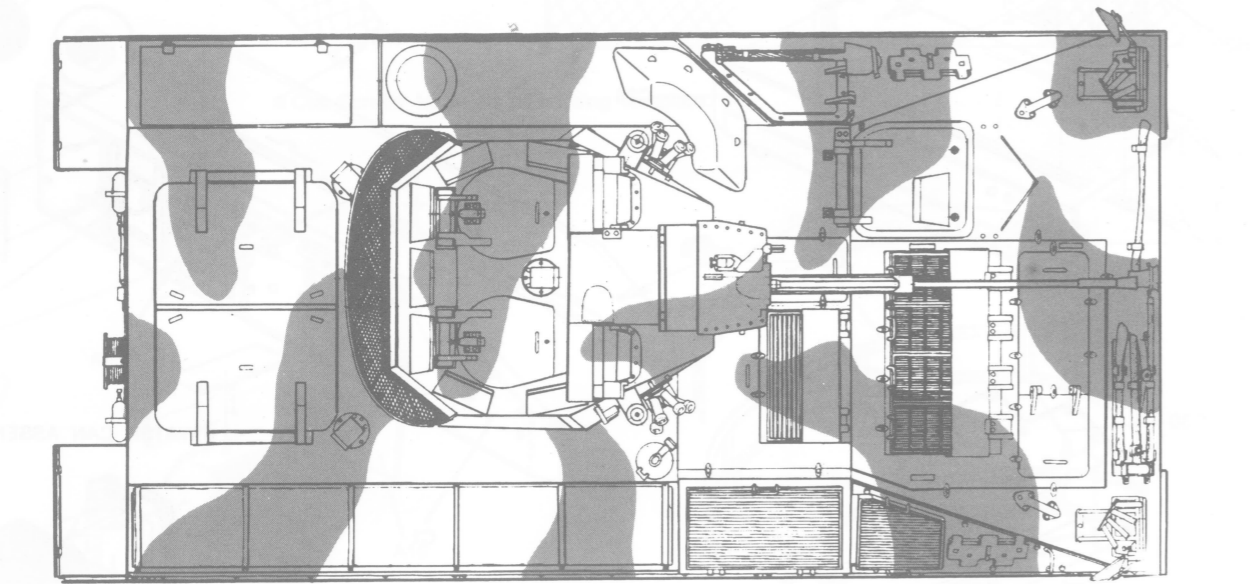

1365

■ UN: UN P.K.F : FLAT WHITE
 ■ DS: DESERT SABRE : DESERT SAND

■ () is opposite decal number.

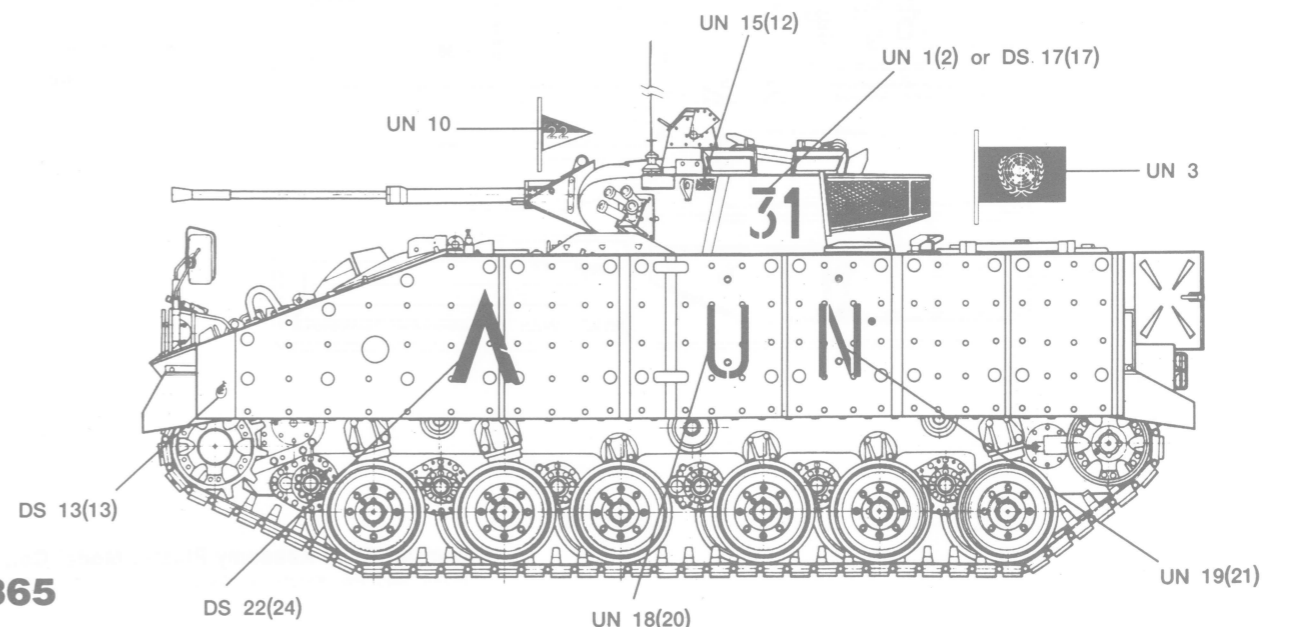
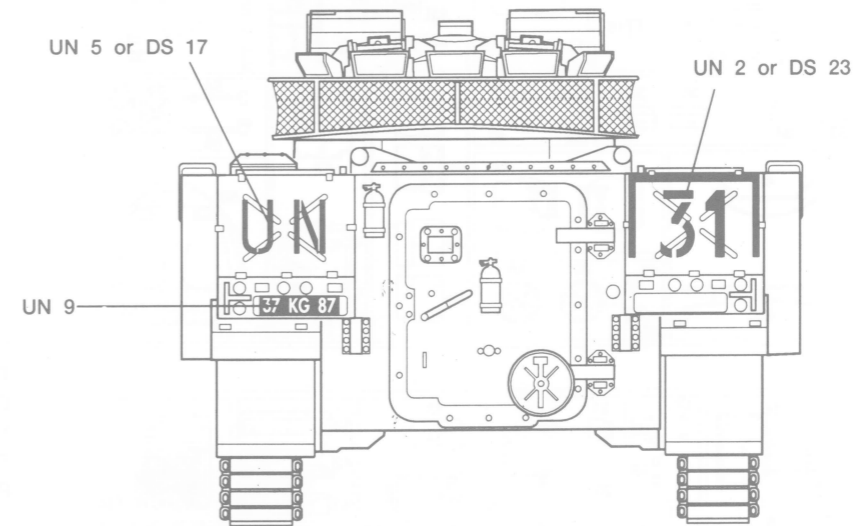
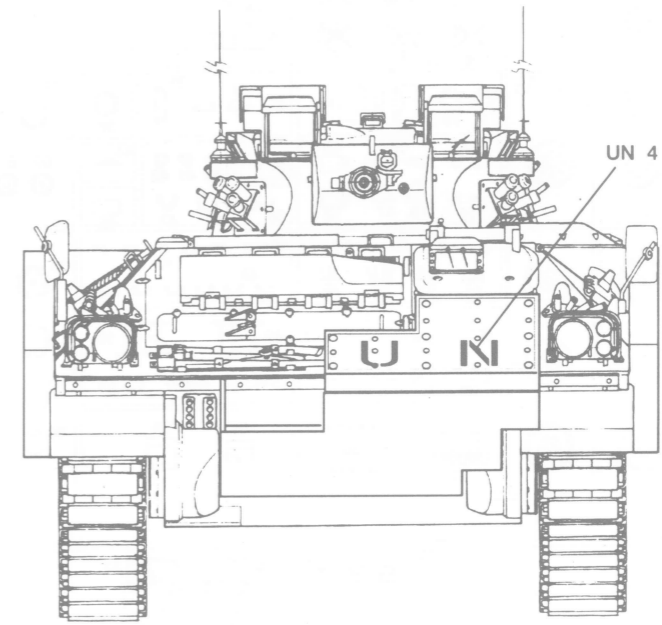

1365