

## **Seafire Mk.III** **“D-Day Fleet Eyes”**

### **Historie**

**CZ**

Na přelomu let 1939 a 1940 chtěla Admiralita objednat námořní verzi Spitfiru se sklopnými křídly. Projekt Supermarine Type 338 počítal s motorem Griffon, křídla se měla skládat podél trupu. Objednávka na 50 kusů byla zrušena, Velká Británie v té době potřebovala hlavně Spitfiry Mk.I.

Námořní piloti se dočkali Seafiru (jak byla navalizovaná verze Spitfiru nazvána) se sklopným křídlem až mnohem později. Seafiry a Hooked Spitfiry používalo Royal Navy již od začátku roku 1942, ale všechny verze měly pevné křídlo. To omezovalo jejich službu na letadlových lodích. Na jaře 1942 zahájila vývoj sklopného křídla firma GAL, ve spolupráci s firmou Supermarine. Jako prototyp byl použit Seafire Mk.II sériového čísla MA970. 9. listopadu 1943 vzlétl poprvé se sklopným křídlem. Toto křídlo bylo schváleno pro sériovou výrobu.

Letouny s novým křídlem byly vyráběny pod označením Supermarine Type 358 Seafire Mk.III u firem Westland a Cunliffe-Oven. Nejprve byla vyráběna verze Seafire F. Mk.III, další byly dokončovány jako LF. Mk.III s motory dávajícími nejvyšší výkon v nižších výškách. Malá část strojů byla postavena ve verzi FR.M.III. Tato stíhací-průzkumná verze byla vybavena dvěma kamerami F.24 za kabinou pilota.

Seafiry Mk.III se dostaly k prvoliniovým jednotkám v listopadu 1943. Bojovaly v Norsku, Středomoří i v Tichomoří. Rozsáhlá byla i jejich služba u druholiniových squadron.

Po válce je kromě Velké Británie používalo francouzské námořnictvo a letectvo Irska.

Seafire Mk.III byl nejlepší námořní stíhačkou britské konstrukce, která zasáhla do druhé světové války.

TTD Seafire LF.Mk.III

Rozpětí: 11,23 m, délka: 9,21 m,

max. rychlost u mořské hladiny: 533 km/h, v 1830 m: 560 km/h, výstup do 1525 m: 1,9 min., dolet 825 km, praktický dostup: 7 315 m

### **History**

**EN**

In the break of 1939 and 1940 the Admiralty decided to order a naval version of the Spitfire that should feature folding wings. Supermarine Type 338 Project was to be powered by the Griffon engine and the wings should fold up along the fuselage. The order for 50 aircraft was cancelled since Great Britain hardly needed every Spitfire Mk.I.

Naval pilots finally received their Seafires (code name for the naval version of the Spitfire) with folding wings much later. The Royal Navy used both Seafires and Hooked Spitfires since the beginning of 1942 but all these aircraft had fixed wing and therefore this feature limited their use aboard aircraft carriers. In spring 1942 began the development of the folding wing mechanism by the GAL Company together with Supermarine. The test bed for the latter was chosen a Seafire Mk.II of serial number MA970. It took off for the first time on November 9, 1943 with folding mechanism already installed. This wing with its folding mechanism was approved for series production. The aircraft with the latter were produced by the Westland and Cunliffe-Oven companies under designation Supermarine Type 358 Seafire Mk.III.

Initially the production started with the Seafire F. Mk.III and subsequent versions were designated as LF. Mk.III and were powered by engines tuned for high performance in lower altitudes. The FR. Mk.III was produced in small series. This fighter-reconnaissance version was equipped with two F.24 cameras located behind the cockpit. Seafire Mk.IIIs were assigned to combat units in November 1943. They fought over Norway, the Mediterranean and the Pacific theatres. Also their service with back up units was admirable.

The post war users except Great Britain were France and Ireland.

Seafire Mk.III was the best naval fighter of British design to enter WW II.

Seafire LF.Mk.III

Wingspan: 11.23 m, Length: 9.21 m,

Max. Speed at Sea level: 533 kmh, at 1830 m: 560 kmh, Climb to 1525 m: 1.9 min, Range: 825 km, Service

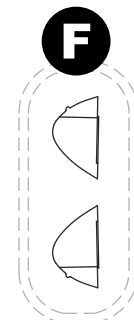
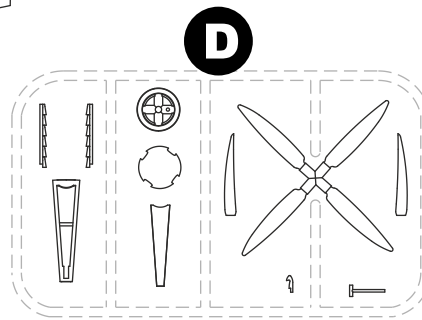
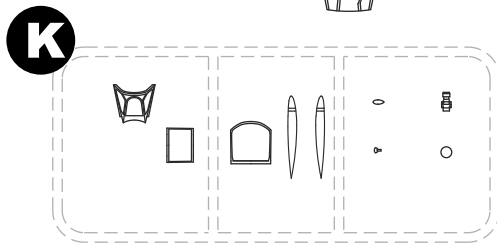
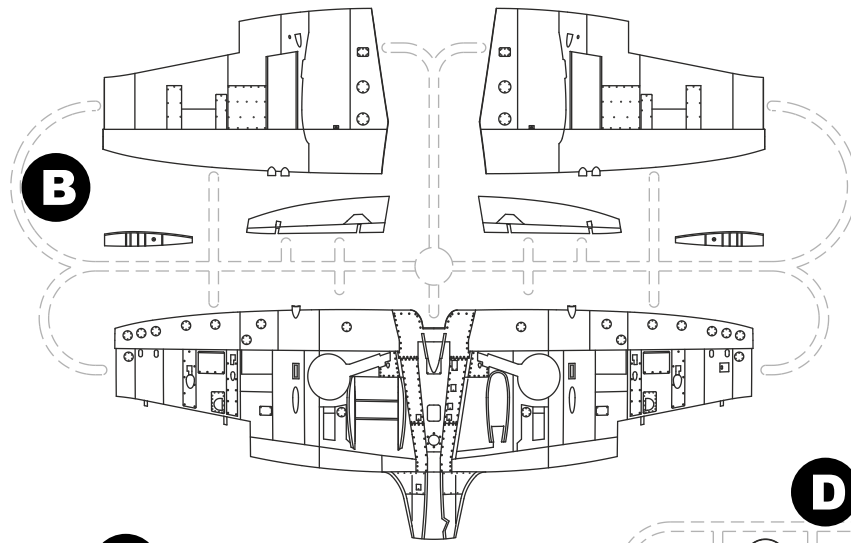
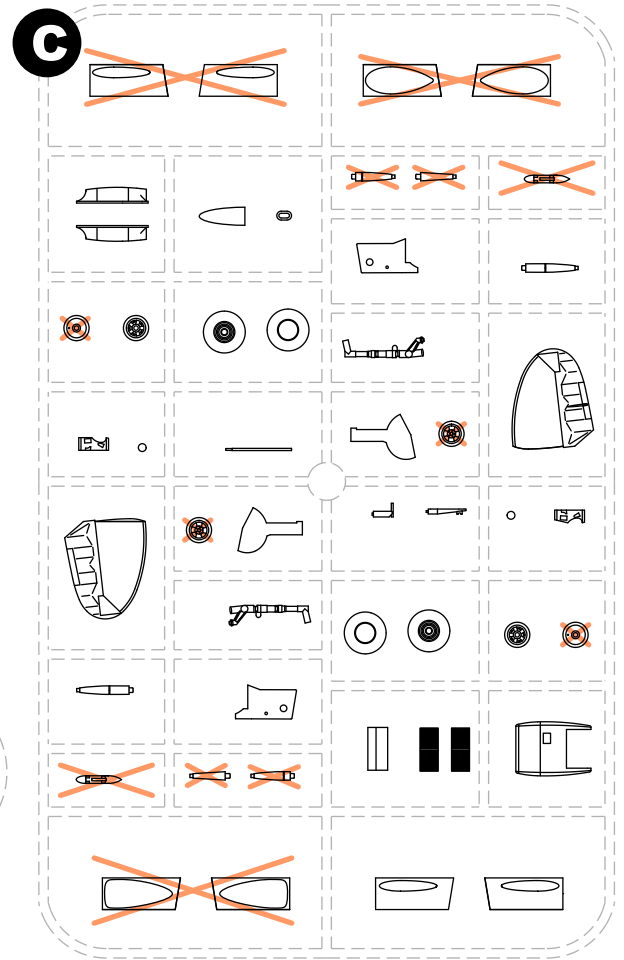
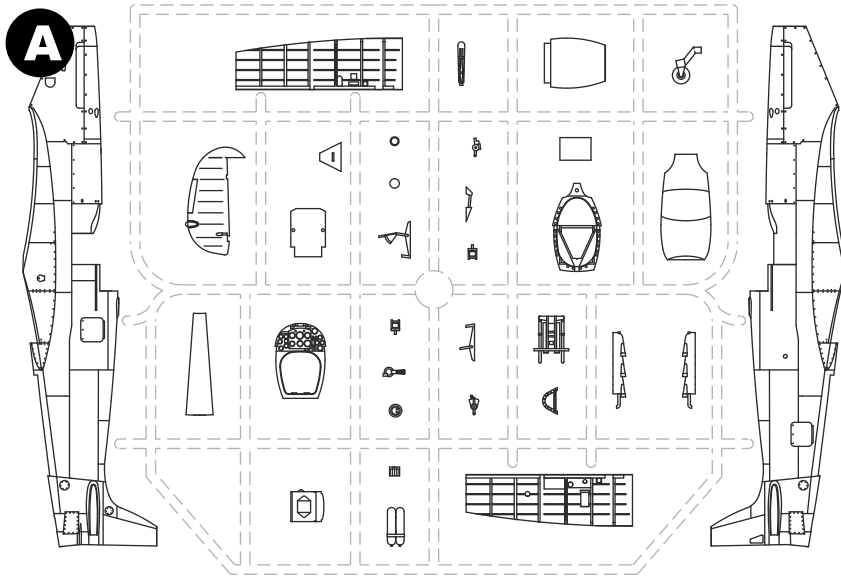

**Film Parts (FP)**

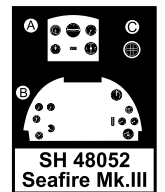

*Doporučené/ Recommended*

**Barvy GUNZE/ GUNZE Colour No.**

<b>A</b>	Černá lesklá/ Gloss Black	H2/C2
<b>B</b>	Černá matná/ Matt Black	H12/C33
<b>C</b>	Ocel/ Steel	H18/C28
<b>D</b>	Plátno/ Tan	H27/C44
<b>E</b>	Opálený kov/ Burnt Iron	H76/C61
<b>F</b>	Černá na pneu./ Tire Black	H77/C137
<b>G</b>	Šedozeleňá/ Grey Green	C364
<b>H</b>	Hnědočervená/ Red Brown	+ 80% H47/C41 + 20% H92/C49
<b>I</b>	Hliníková/ Aluminium	H8/C8
<b>J</b>	Bílá/ White	H21/C69

**Photoetched Parts (PP)**

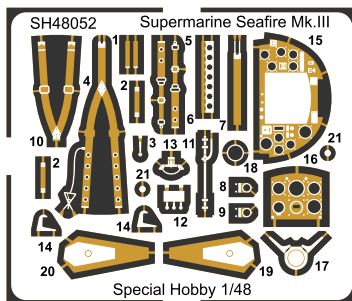

**Mask (MP)**

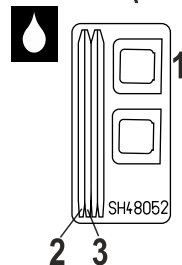

**X** - Tento díl nepoužít  
Do not use this part

**SYMBOLS**

**?** MOŽNOST VOLBY  
OPTIONAL  
NACH BELIEBEN  
OPTION

**Water Drop** POUŽÍT KYANOAKRYLÁTOVÉ LEPIDLO  
INSTANT CYANOACRYLATE GLUE  
ZYANOAKRYLÄTKLEBER  
ADHÉSIF CYANOACRYLAT

**Bend Arrow** OHNOUT  
BEND  
BIEGEN  
COURBER

**Hand** ZHOTOVIT NOVÉ  
SCRATCH BUILD  
FERTIGSTELLEN  
ACHEVER

**Scissors** ŘEZAT/VRTAT  
CUT OFF/DRILL  
ENTFERNEN  
DETACHER

**Water Drop** GSI **A** NATŘÍT  
COLOUR  
FARBEN  
PEINDRE  
colours code



# 1a

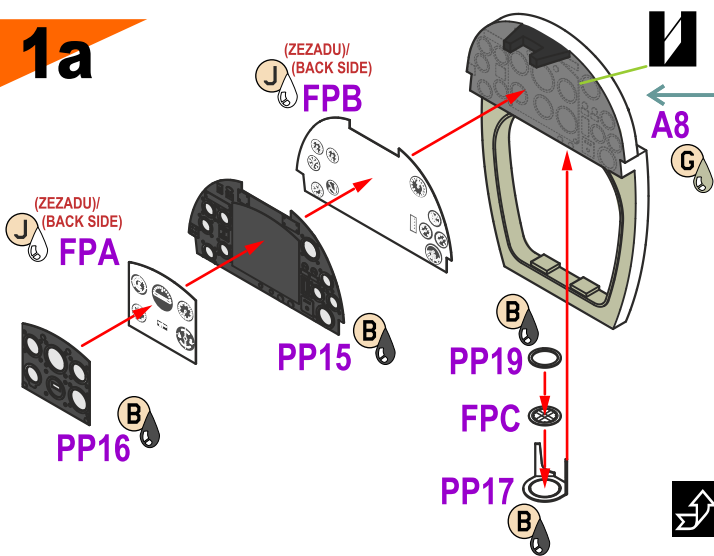

# 1b

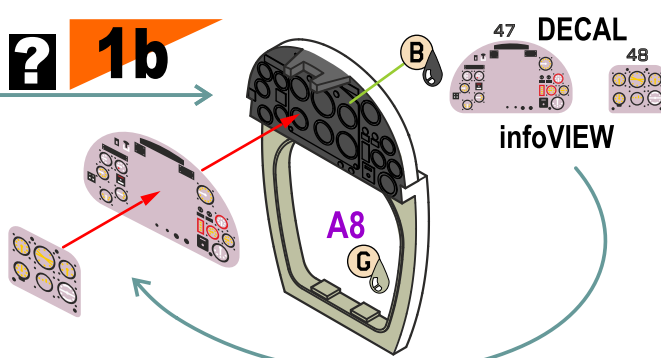

# 2

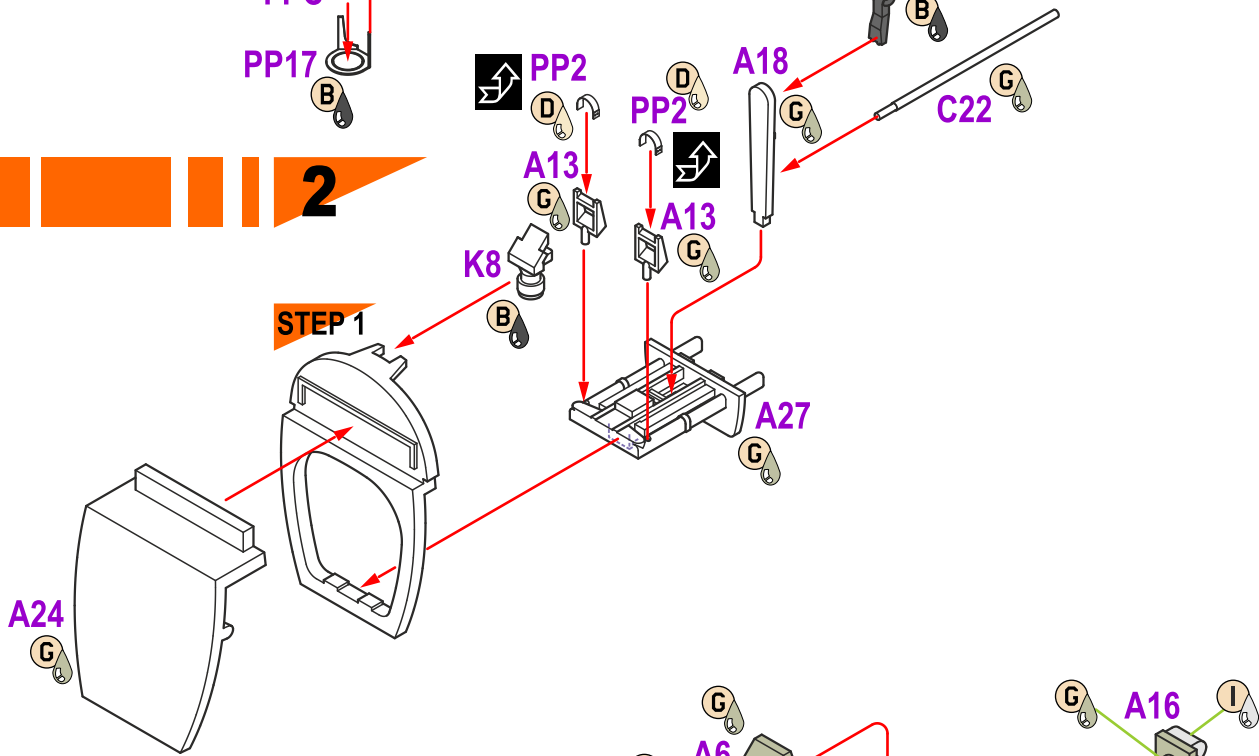

# 3

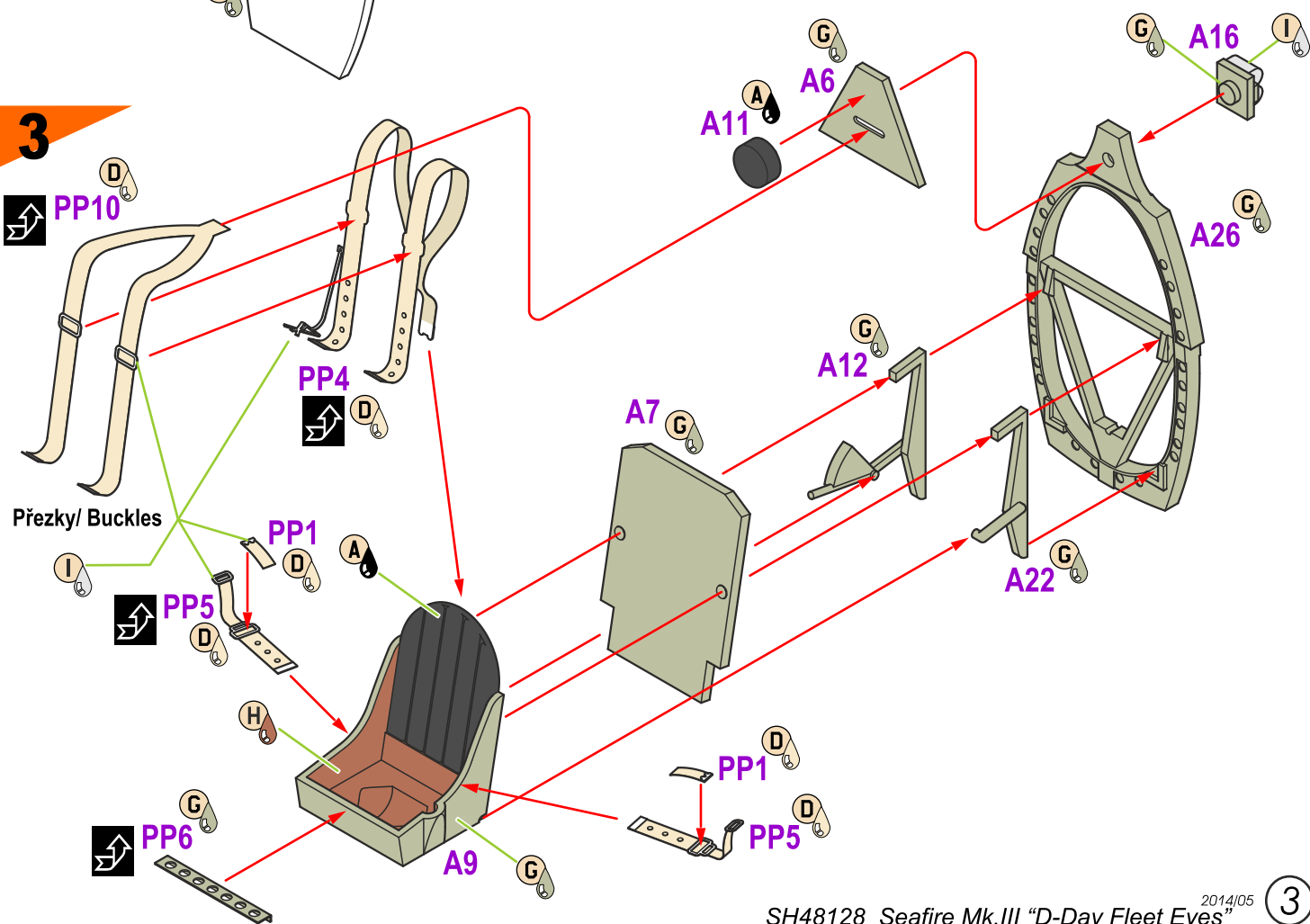

4

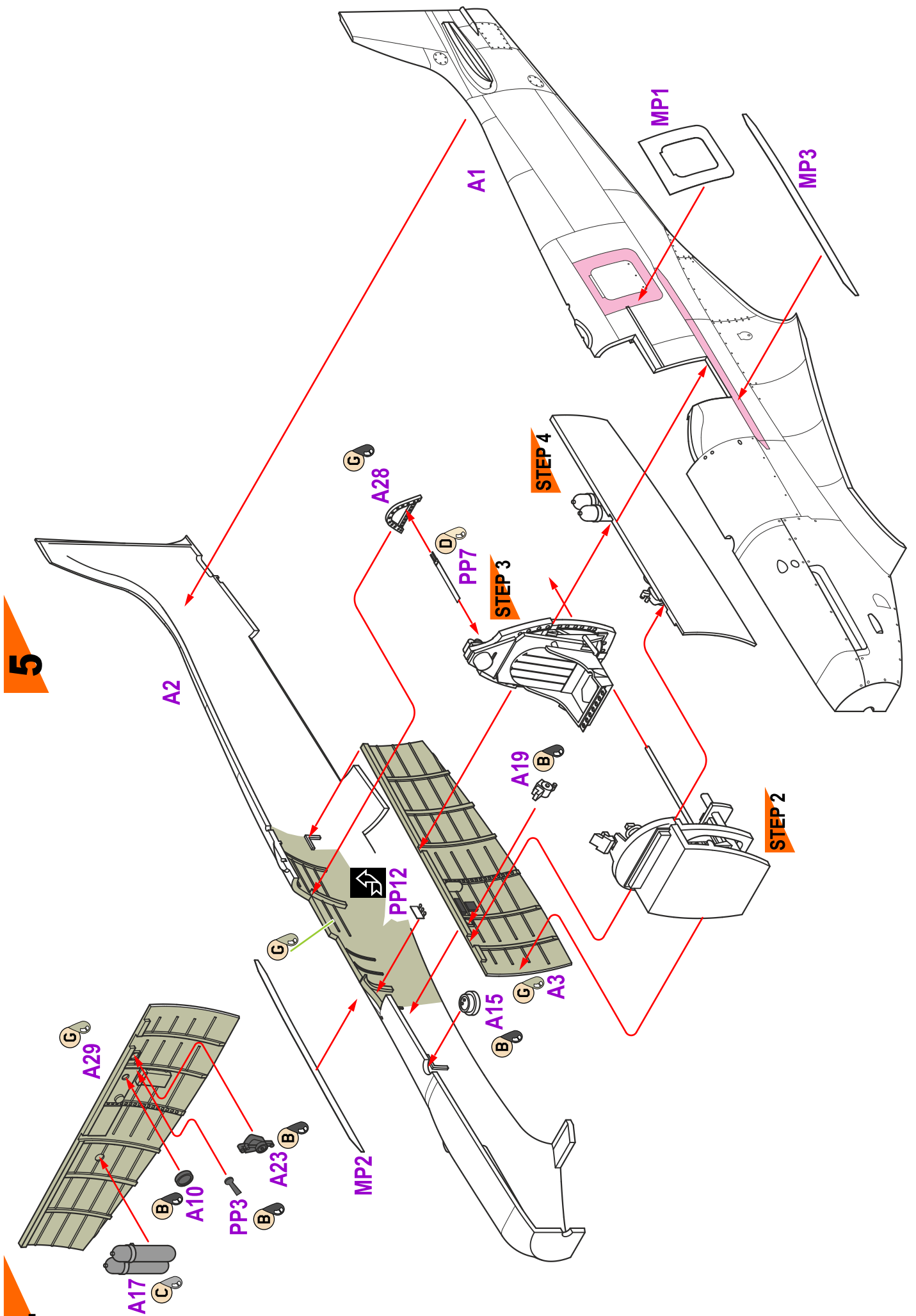

5

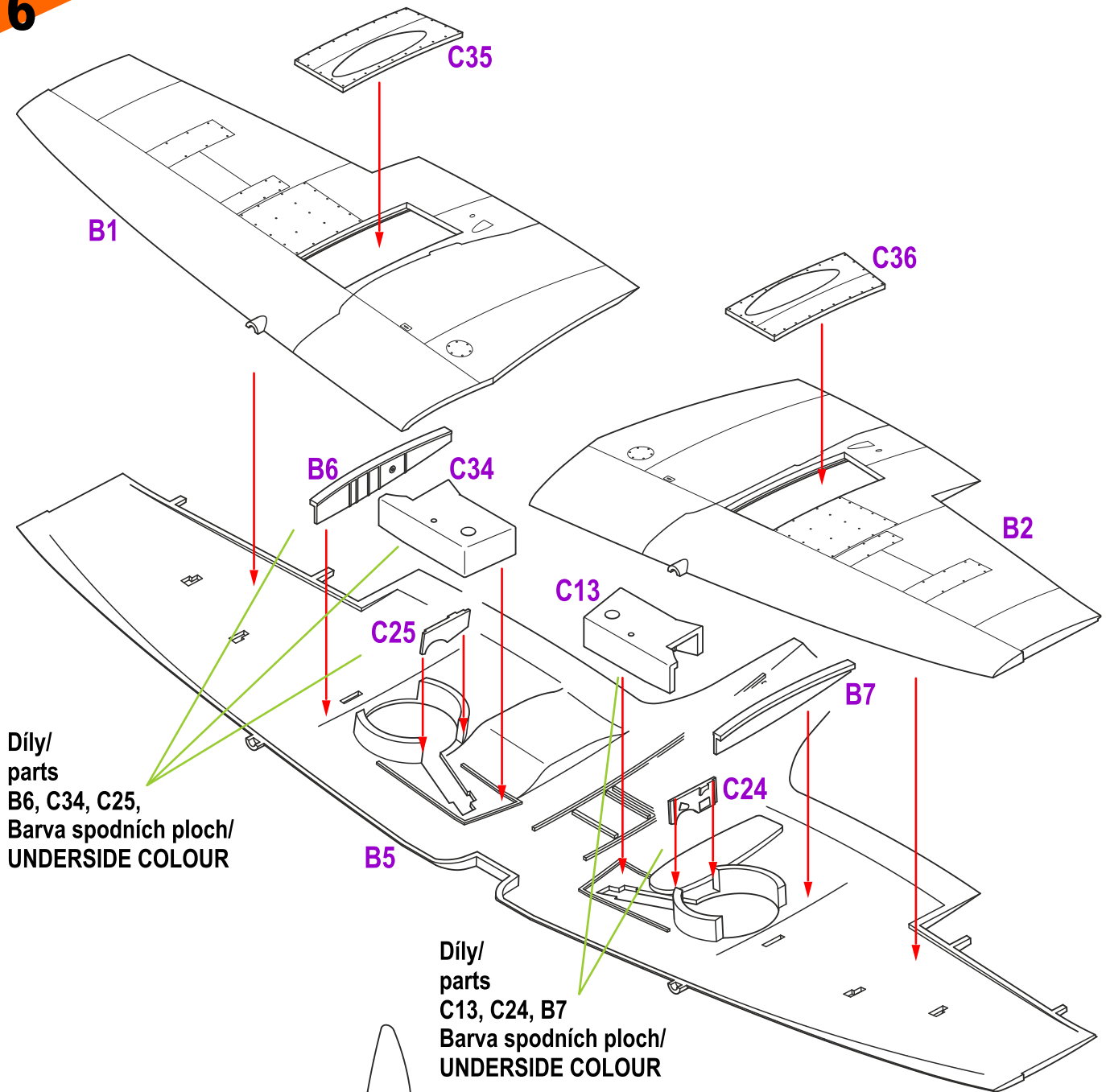
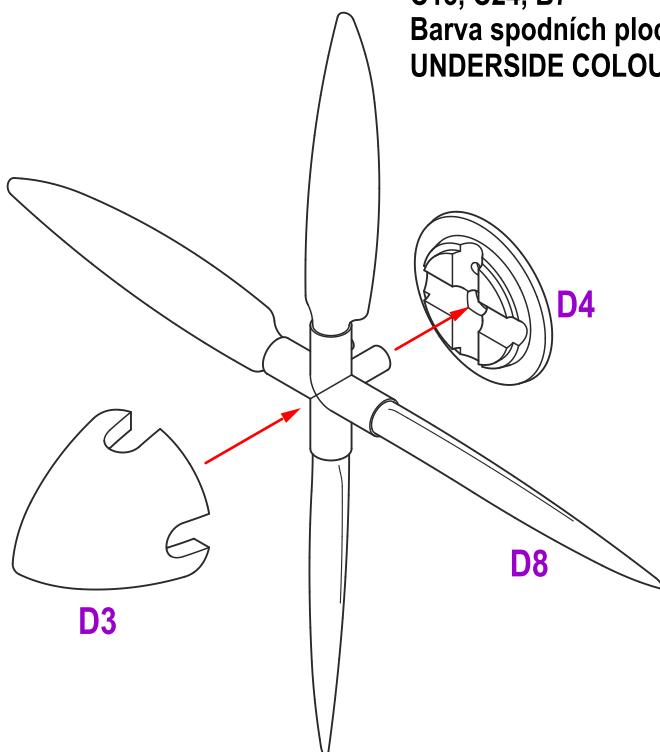
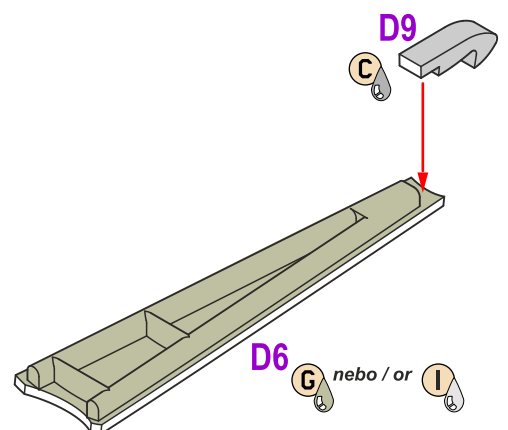
**6****7****8**



**NOTE:**

Díly K4 a K5 camo A,  
 díly F1 a F2 camo B.  
 Parts K4 a K5 camo A,  
 parts F1 and F2 camo B

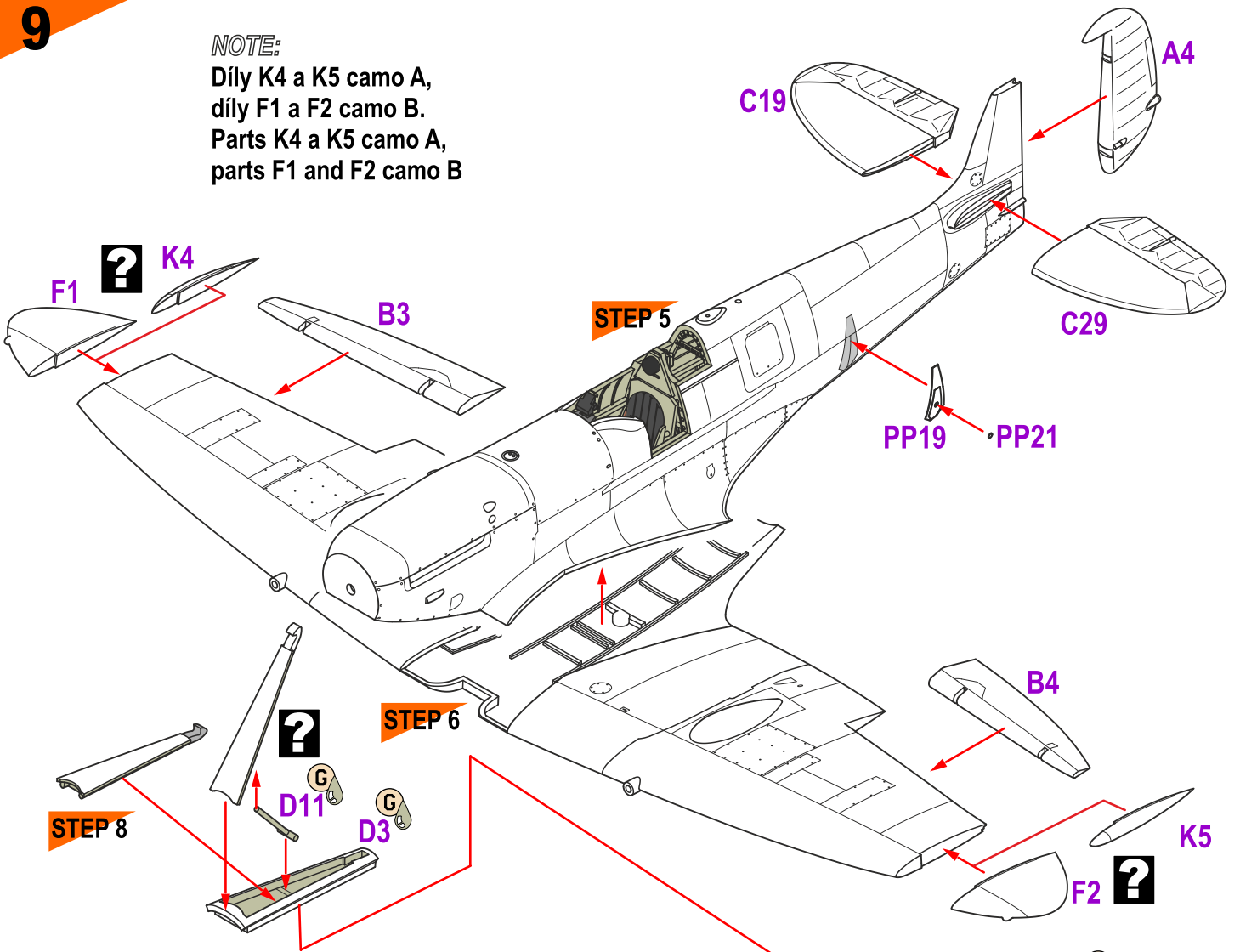

Barva spodních ploch/  
 UNDERSIDE COLOUR

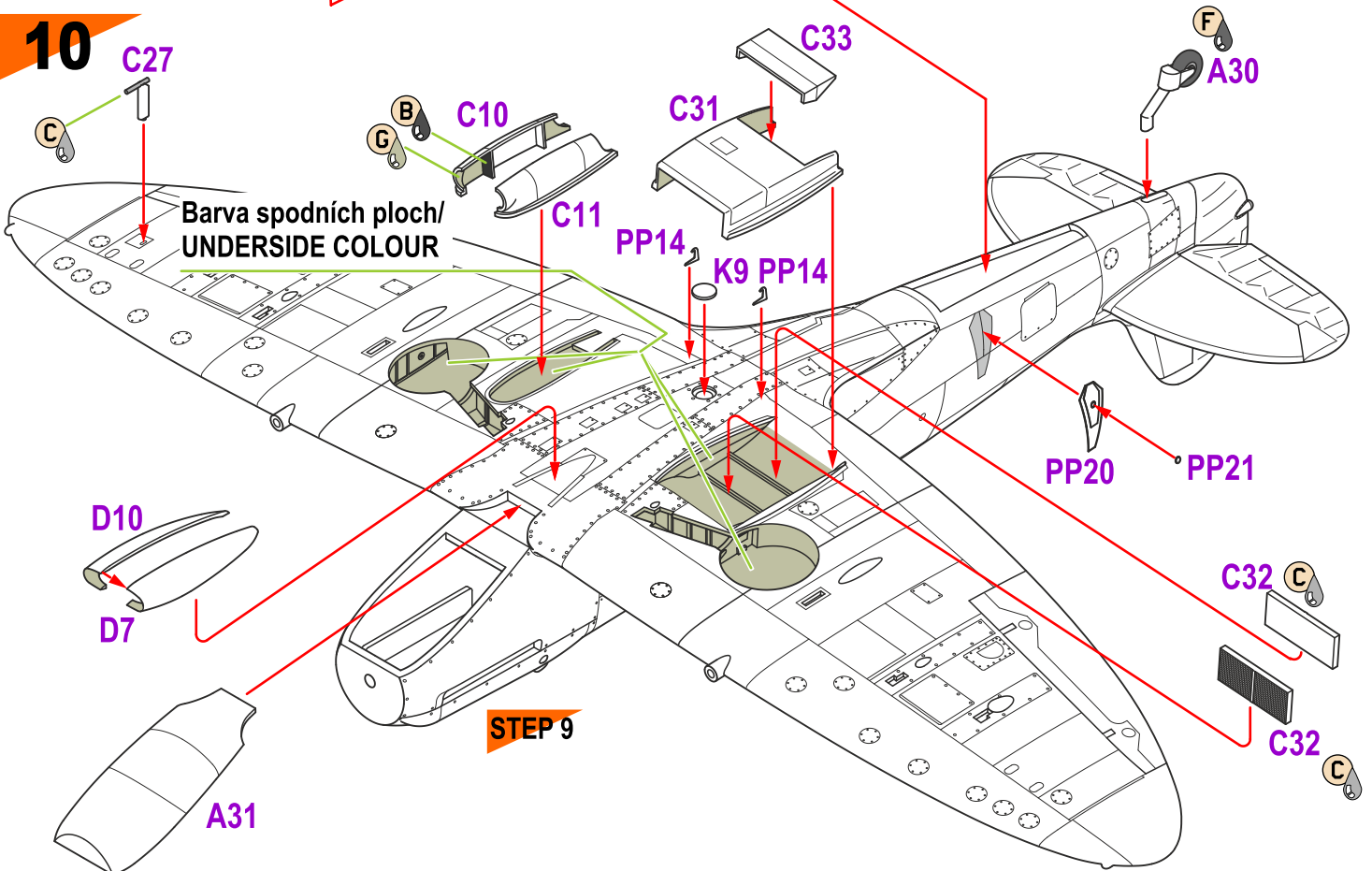

11

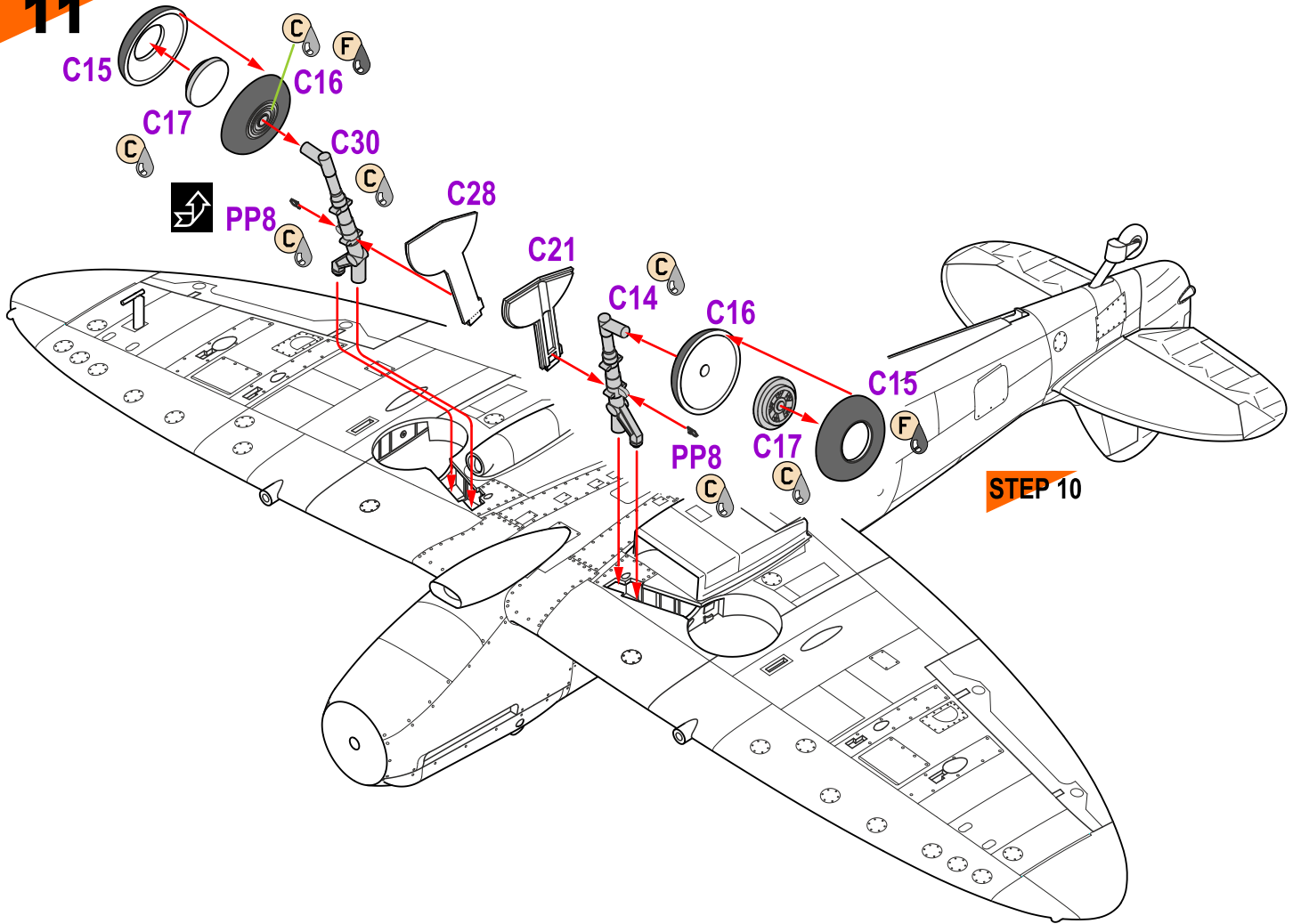

STEP 10

12

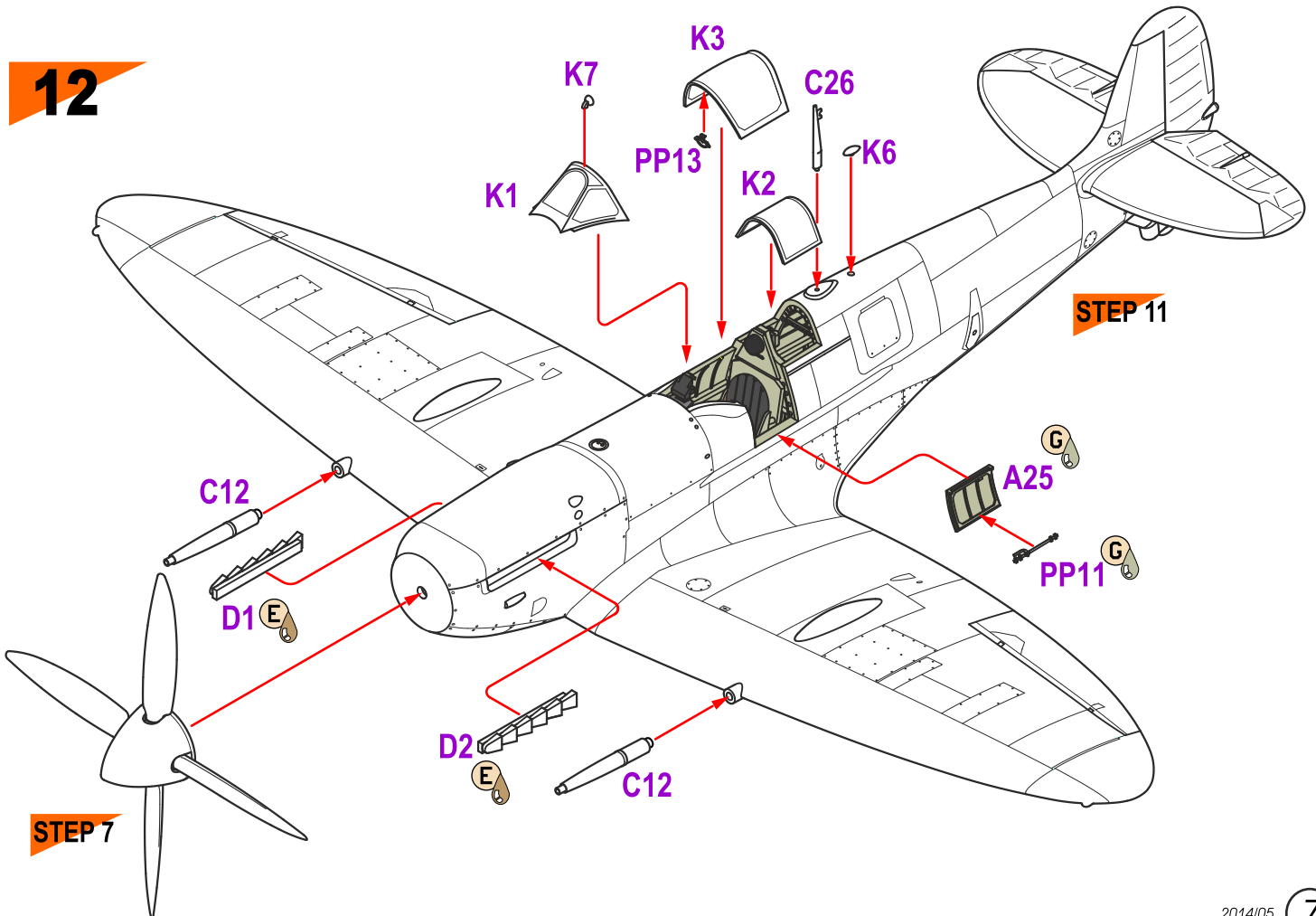

STEP 11

STEP 7

Supermarine Seafire LF Mk.III, NF547/2D, No.885 Sqn. NAS, No. 3 Naval (Air Spotting Wing), RNAS, Lee-on-Solent, červen 1944. Firmou Westland vyrobený Seafire nesl Day Fighter Scheme (kamuflážní barvy RAF). Ocasní plochy byly po výměně nastříkány základovou zelenošedou barvou. Stroj nesl plně invazní pruhy. Fotograficky je doložen s černým i bílým kuzelem vrtule. Podobně jako ostatní Seafiry No.3 NASW řídili piloti NF547 palbu bitevních lodí invazní flotily. Byla to nebezpečná práce, piloty ohrožovala palba ze země i nepřátelské stíhačky. 8.června S/L R.C.S. Chamen v kabině NF547 sestřelil jeden Bf 109 a 16.června 1944 Sub. Lt. R. Hales v kabině NF547 poškodil dva Bf 109G.

Supermarine Seafire LF Mk.III, NF547/2D, No.885 Squadron NAS, No. 3 Naval (Air Spotting Wing), RNAS, Lee-on-Solent, June 1944. This Westland produced Seafire was camouflaged in the Day Fighter Scheme (RAF camouflage colours) but the scheme template corresponded to the Sea Scheme. When the tail planes were replaced they were painted by base grey-green colour. The machine received complete invasion stripes and is documented on contemporary photographs wearing black as well as white spinner. Similarly to other No. 3 NASW Seafires, pilots of this machine also directed fire of the invasion fleet battleships. It was dangerous work since the pilots were endangered by both AA fire and enemy fighters. S/L R.C.S. Chamen flying NF547 managed to shot down one Bf 109 on June 8, 1944 and on June 16 Sub. Lt. R. Hales also in the cockpit of NF547 damaged two other Bf 109Gs.

**CAM. A**

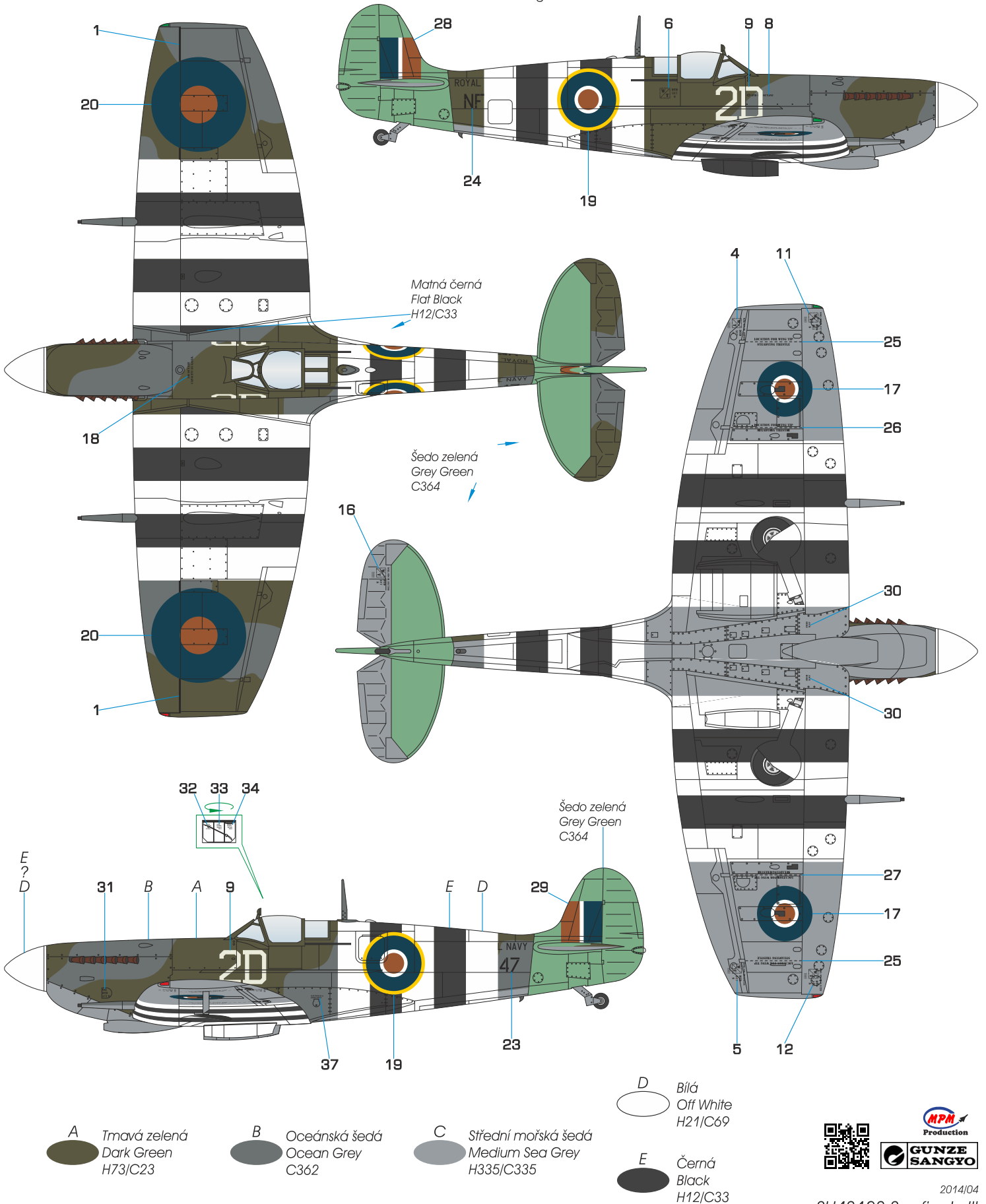



Supermarine Seafire LF Mk.III, NF541/3N, No.886 Sqn. NAS, No. 3 Naval (Air Spotting Wing), RNAS, Lee-on-Solent, červen 1944. Dne D se v kabině tohoto stroje zúčastnil několika letů Lt.(A) Hugh "Sam" Lang (RNZNVR) a naváděl palbu bitevní lodě HMS Warspite. Hned následujícího dne byl NF541 zasažen flakem a pilot Lt. D.B. Law s ním nouzově přistál ve Francii. Vymontoval utajovaná zařízení, zakopal je (včetně tehdy utajovaného anti-G obleku) a zničil zařízení IFF. Úspěšně přešel frontu a 18. června se opět hlásil u jednotky.

Supermarine Seafire LF Mk.III, NF541/3N, No.886 Squadron NAS, No. 3 Naval (Air Spotting Wing), RNAS, Lee-on-Solent, June 1944. Lt.(A) Hugh "Sam" Lang (RNZNVR) flew couple of sorties during the D-Day and directed the fire of battleship HMS Warspite. The following day was NF541 hit by flak and its pilot, Lt D.B. Law made a crash landing on the French soil. He dismantled and buried secret equipment, including the then secret G-suit and destroyed the IFF. Successfully crossed the front-line and reported again to his unit on 18 June.

CAM. B

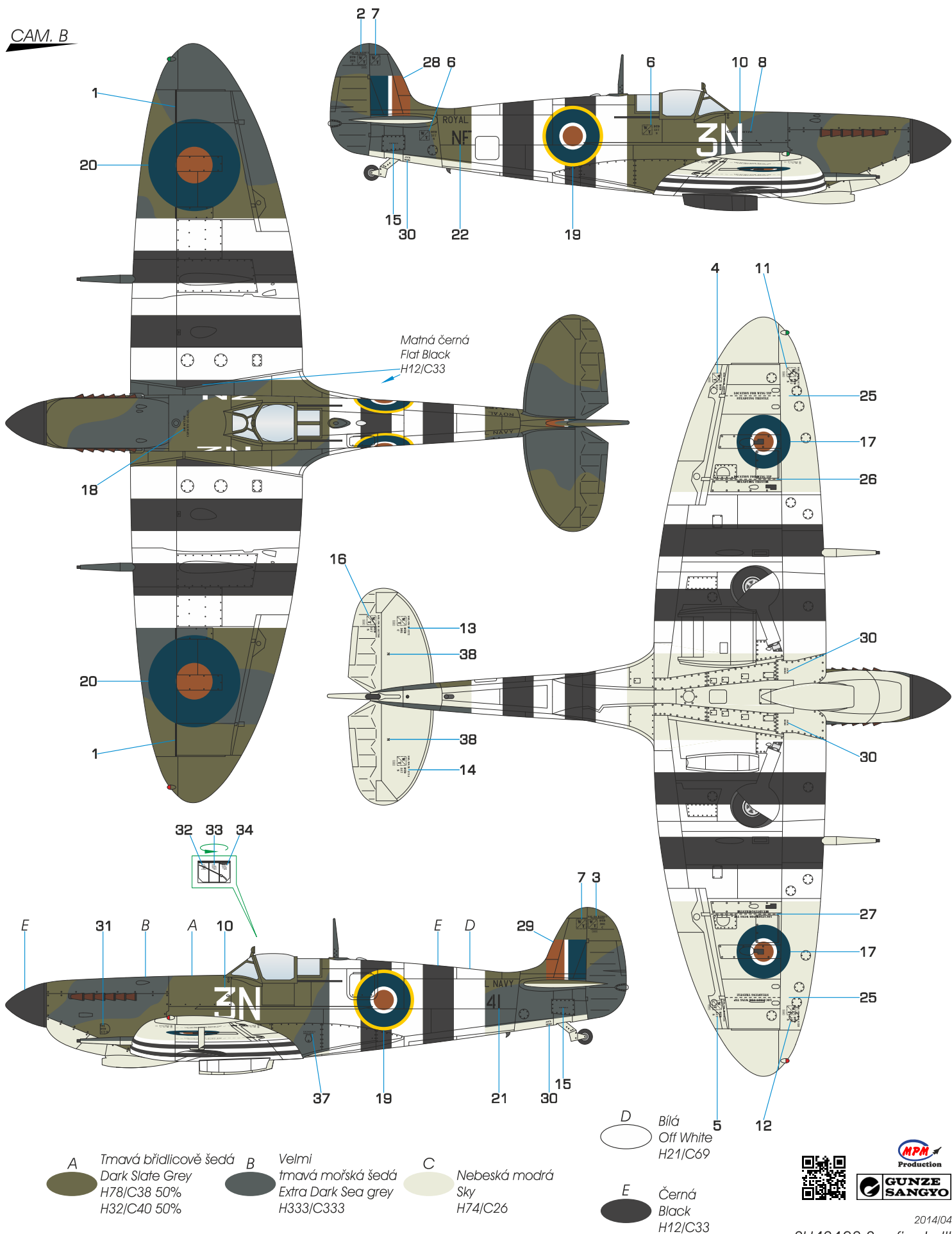

# THE BEST FOR YOUR KITS - CMK HIGHLY DETAILED RESIN SETS

**4297**

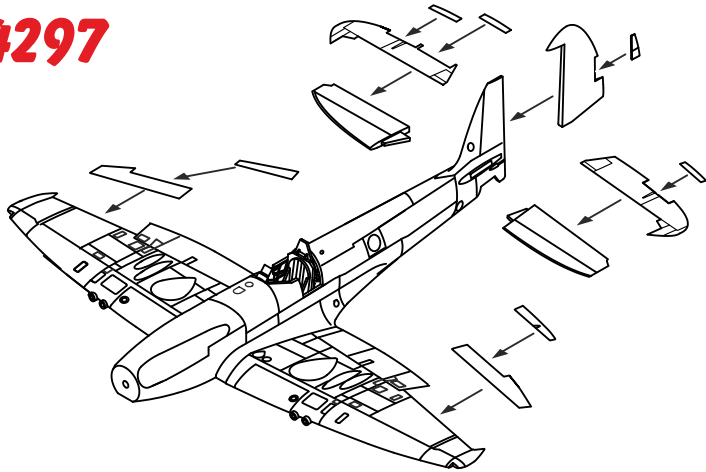

**SEAFIRE MK.46/47 CONTROL SURFACES SET**

**4298**

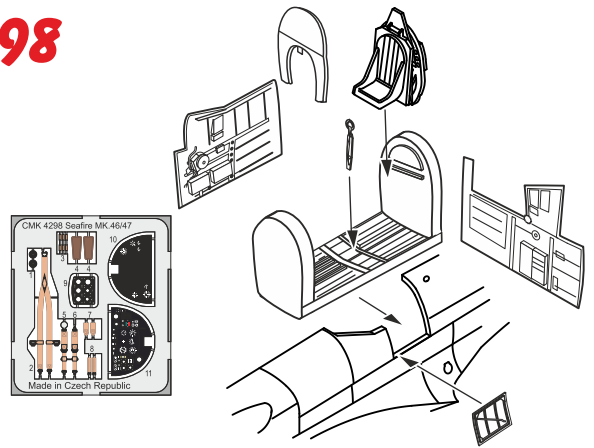

**SEAFIRE MK.46/47 INTERIOR SET**

**SETS FOR 1/48 AIRFIX  
SEAFIRE MK.46/47 KITS**

**4299**

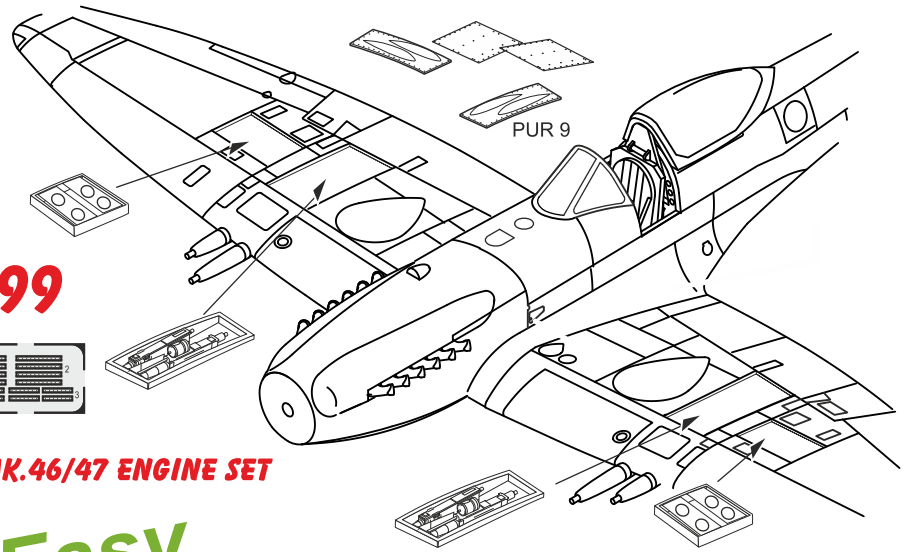
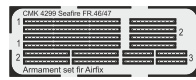

**SEAFIRE MK.46/47 ENGINE SET**

**Quick & Easy**

**HIGH QUALITY CAST PRODUCT**

**1/48 SCALE**

**Q48059**

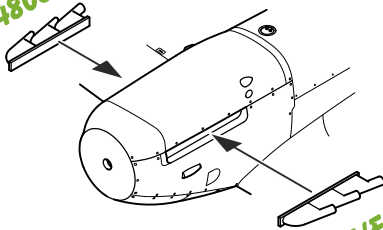

**SPITFIRE MK.I/EARLY MK.V  
EXHAUST STUBS  
- FOR TAMIYA KIT**

**Q48060**

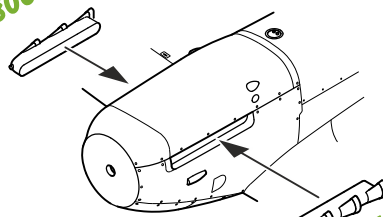

**SPITFIRE MK.V  
EXHAUST STUBS - FOR HASEGAWA/  
TAMIYA /SPECIAL HOBBY**

**Q48061**

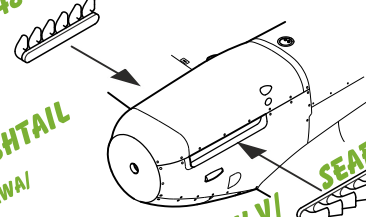

**FISHTAIL  
LATE SPITFIRE MK.VI/  
SIX EXHAUST  
- FOR HASEGAWA/TAMIYA/SPECIAL  
HOBBY KIT**

**Q48068**

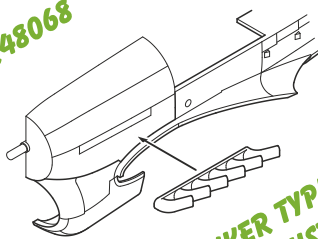

**HAWKER TYPHOON MK.I  
EXHAUST STACKS**

**Q48092**



**HAWKER HURRICANE MK.I  
WHEELS 5 SPOKED DISCS**

**Q48093**



**SPITFIRE MK.I/III/IV  
WHEELS 5 SPOKED DISCS**