

ACADEMY

HOBBY MODEL KITS

13212

M3 GRANT



1/35th Scale

M3 그랜트

The M3 Lee was the first modern American medium battle tank employed in combat in World War II. It saw action with the British in North Africa as early as 1941 & the South Pacific theater along with the M4 Sherman tank. The M3 was the result of crisis management that was prevalent immediately following the fall of France. No tank in history ever went from design to production faster than the M3. As furnished to the British under the lend-lease program, this first model of the M3 medium tank was nicknamed the General Lee by the British. This 100% new tooling, 1/35 scale M3 Lee "Rivet Hull" has certainly been worth the wait! Academy really "nailed" this magnificent war machine. It incorporates the early type Vertical Volute Spring Suspension (VVSS) and each individual rivet that's studded along the entire body is faithfully reproduced. The shape of the M3's unique polygonal body & cast turret is perfectly made, as is the exquisitely detailed interior of the turret. Modelers have a choice of assembling the long barrel 75mm gun or the short barrel. Beautifully molded flexible track and crisp, accurate decals add to the impressiveness of detail that Academy brings to this new release. On the other hand, among M3s which were given to the British Army they were called "GRANT". The characteristic features of the "GRANT" were a new lower/wider 37mm top turret, revised stowage box and sand skirts.

Der M3 Lee war der erste amerikanische mittelschwere Panzer, welcher zum Kampfeinsatz kam. Dies geschah auf dem nordafrikanischen Kriegsschauplatz bei den britischen Streitkräften (später auch unter US Flagge) sowie im Pazifikkrieg gegen die Japaner. Sein größter Verdienst war die Verstärkung der englischen Panzertruppen im Mai 1942 bei Gazala. Die damals aktiven Panzertypen (INFANTRY TANK) wie Mathilda/Valentine oder (CRUISER TANK) A9/A10/Crusader waren mit der 2-Pfünder (40mm) Kanone den deutschen 50mm (Pz.III) oder 75mm (Pz.IV) Geschützen unterlegen. Obwohl der M3 seine 1930er Jahre Einflüsse wie geteilte Bewaffnung und genietete Panzerung nicht verleugnen konnte, war die 75mm M2/M3 Kanone ein geeignetes Instrument zu Panzerbekämpfung. Außerdem war endlich eine wirksame Sprenggranate einsetzbar, denn die britische 40mm HE Munition war entweder nicht verfügbar oder wurde den Panzern nicht zugeteilt. Der M3 Lee war der erste alliierte Panzer, welcher die drei Grundparameter Panzerung - Beweglichkeit - Feuerkraft zwar nicht perfekt, aber wirkungsvoll vereinte. Insgesamt betrachtet war der M3 genau zur richtigen Zeit am richtigen Ort, um seine Wirksamkeit und Verlässlichkeit bis zum Erscheinen des M4 unter Beweis zu stellen. Während der M3 Medium Tank von den Briten als "LEE" bezeichnet wurde, bekam die eigens für sie gebaute Version den Namen "GRANT". Die Hauptmerkmale waren der vergrößerte Turm zur Aufnahme der Funkanlage, geänderte Staukästen und Sandchürzen.

M3 리어는 미국산으로서는 최초로 제2차 세계 대전에서 사용된, 근대적 중전차입니다. 1941년에는,早くも北아프리카에서 영국군과 함께 작전에 참가하고 있으며, 남태평양 전선에서도 M4 셔먼 전차와 병행하여 사용되고 있습니다. M3 중전차는, 프랑스 패배 직후에 이르렀던 위기 관리 체제의 결과로 탄생한 전차이며, 설계에서 제조까지의 기간이 이 정도로 짧았던 전차는, 역사상 유례를 찾아볼 수 없습니다. 전시 물자 배급 방식(렌드리스법) 하에서, 영국군에 공급된 덕분에, 이 M3 중전차의 최초의 모델에는, 영국군에 의해 「리어-장군」의 별칭이 붙여져 있습니다.

1/35스케일, 100% 신형 모델에 의한, M3 리어 중전차 「리벳 체결 차체」 모델의 등장입니다. 아카데미는, 이 특이한 전투용 무기를 실제로 모델링하고 있습니다. 초기의 「수직 나선 스프링 서스펜션(VVSS)」을 장착한 이 모델에서는, 차체 판의 전체에 걸쳐서 하나하나의 리벳까지도 완벽하게 재현하고 있습니다. 유니크한 각형의 차체와 주조된 포탑도 완벽하게 모델링되어, 포탑 내부도 세부까지도 사실적으로 재현하고 있습니다. 75mm 포는 조립 시에, 장포신·단포신의 선택이 가능합니다. 사실에 모사된 디칼과, 그리고 정교하고 정밀하게 인쇄된 디칼에 의해, 아카데미가 이 신형 모델에 담아낸 디테일의 인상이, 더욱더 생생한 것으로 되어 있습니다.

M3 Lee는 제2차 세계 대전 당시 최초로 실전에 투입된 미군의 근대적 중형 전차로서, 1941년 초 북아프리카 전선에서 독일군을 상대로 사용되었으며, 남태평양 전선에서는 M4 셔먼과 함께 일본군을 상대로 실전에 투입되었다. M3 Lee는 독일군의 프랑스 함락 이후, 위기 관리 차원에서 급조되어 만들어진 전차이기 때문에, 전차 개발 역사상 기획에서 생산에 이르기까지 가장 빠르게 진행된 전차로 기록되어 있다. M3 Lee는 전시 무기 공여법에 따라 영국군과 소련군에 공여 되었으며, 병사들 사이에서는 'General Lee'라는 별명으로 통하기도 했다. M3 Lee는 다각형의 리벳 차체와 특이하게도 차체에 장착된 75mm 주포를 특징으로 하고 있으며, 그 외 무장으로는 포탑의 37mm 포와 큐폴라와 차체 등에 4점의 7.62mm 기관총을 장비하고 있다. 한편 제2차 세계 대전에서 공여된 M3는 그랜트라는 이름으로 불리게 되었다. 그랜트의 특징은 폭이 넓어지고 높이가 낮아진 37mm 주포를 채용했으며 그랜트 전용 후부 공구박스 및 사이드 스킵트를 채용하였다.

<READ THIS BEFORE YOU BEGIN>

- Study the instructions before assembling.
- Do not use too much cement to join parts.
- Open a window or make area well ventilated when cement or paint is in use.
- Check the fit of each piece before cementing into place.
- Never use cement or paint near open flame.
- Tear up and throw away the empty plastic bags to avoid danger of suffocation for little children

<ALLGEMEINE HINWEISE>

- Die Anordnung der Bauteile ist aus den Zeichnungen der Anleitung ersichtlich.
- Die Teile vor dem Verkleben ungleichmässig zusammenhalten, um ihren paßsitz zu prüfen.
- Klebstoff nicht zu dick auftragen.
- Klebstoff und Farben niemals in der Nähe einer Flamme verwenden.
- Während der Bemalung mit Spritzpistole oder Pinsel für frische Luftzufuhr, z.B. öffnen des Fensters, sorgen.
- Bausatz von kleinen Kindern fernhalten. Verhüten Sie, daß Kinder irgendwelche Bauteile in den Mund nehmen oder Plastiktüten über den Kopf ziehen.



<READ THIS BEFORE YOU BEGIN>
 <ALLGEMEINE HINWEISE>
 <LISEZ CE QUI SUIT AVANT DE COMMENCER LE MONTAGE>
 <組み立てる前に>
 <조립하기 전에 먼저 읽어 주십시오>

<LISEZ CE QUI SUIT AVANT DE COMMENCER LE MONTAGE>

- Etudier les schémas d'assemblage. - Contrôler que chaque pièce soit bien conforme avant de la coller à sa place.
- N'utilisez pas trop de colle pour réunir les pièces. - Ne jamais manipuler la colle ou peinture à proximité d'une flamme.
- Aérer soigneusement la pièce où vous peignez(ouvrir la fenêtre). - Après avoir sorti les pièces du sac en plastique, déchirer le sac afin d'éviter que les enfants ne le mettent sur la tête et ne s'étouffent.

<組み立てる前に>

- 組み立てる前に説明書をお読み下さい。 - 部品をランナーから切りはなす時は模型用ニッパーとカッターを使用します。
- 接着剤を少なめに使うことがきれいに仕上げるコツです。 - 組み立て後の部品やビニール袋は小さな子供の届かない安全所に保管して下さい。
- 接着剤や塗料を使用する時はときどき窓を開けて換気に気をつけましょう。 - 接着する前に部品を合わせて確かめます。

■조립하기 전에

- 부품을 조립하기 전에 설명서를 잘 읽어본 후 조립한다.
- 점착하기 전에 부품을 맞추어 확인한 후 조립한다.
- 부품을 자를 때에는 칼이나 니퍼로 깨끗이 잘라준다.
- 에나멜 페인트나 점착제를 사용할 때는 창문을 열어 환기를 시키고 화기를 멀리한다.
- 점착제를 사용할 곳과 사용하지 않는 곳에 주의하고 너무 많이 바르지 않도록 한다.
- 사용 후 남은 부품은 어린 아이들의 손에 닿지 않도록 잘 처리한다.

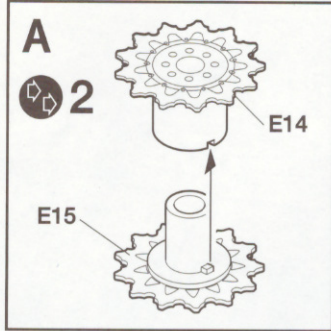

* () is opposite number. —> Cement 적착합니다.
 ()는 반대측 번호입니다. - - -> Do not cement. 적착하지 않습니다.

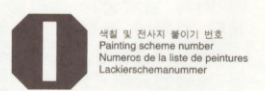
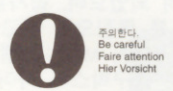
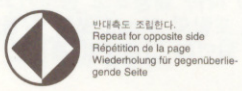
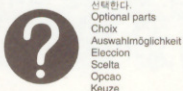
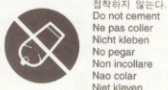
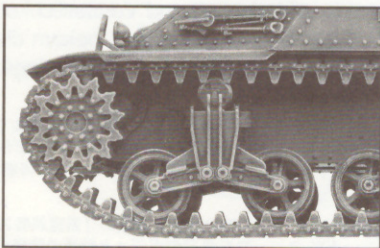
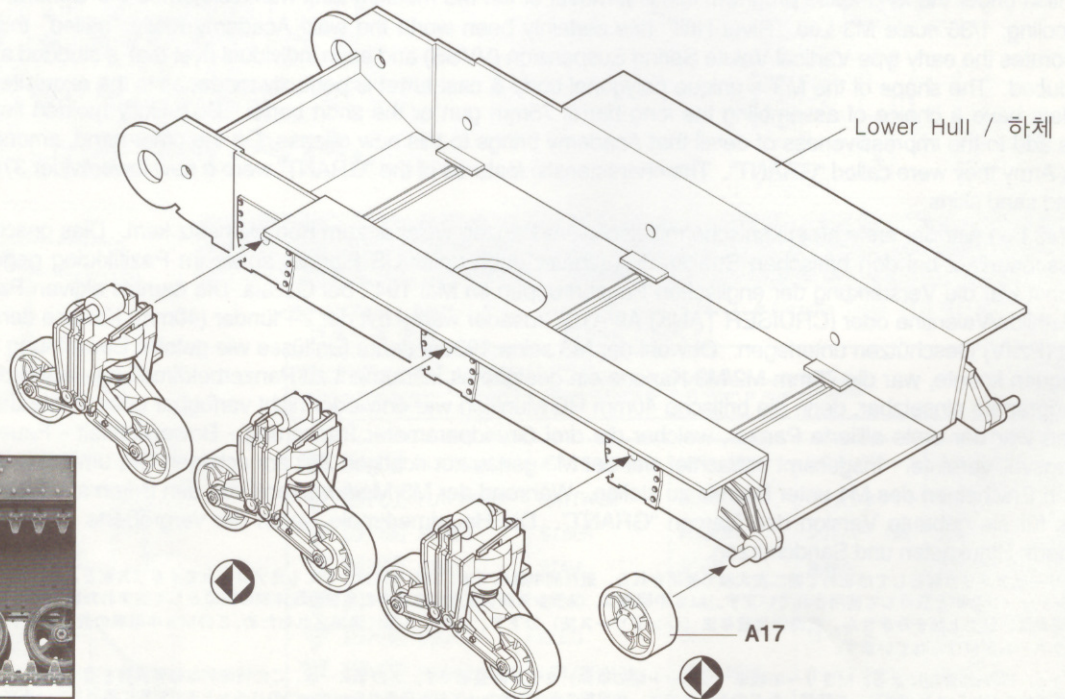
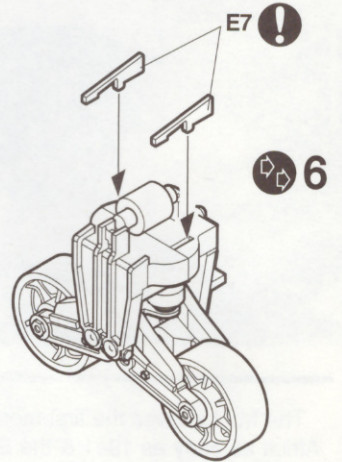
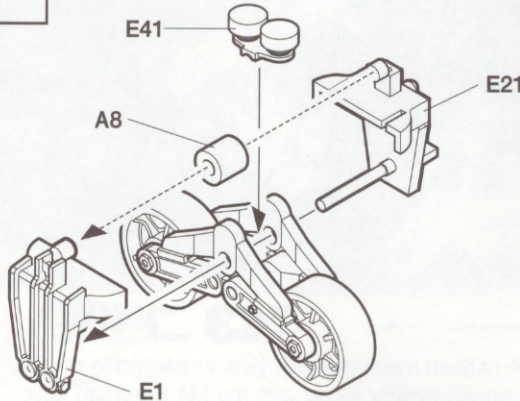
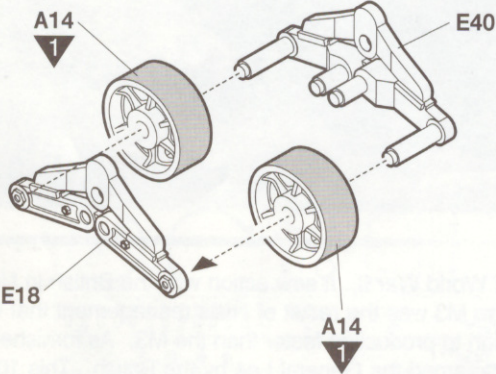

3

Interior color
내부색 : 2

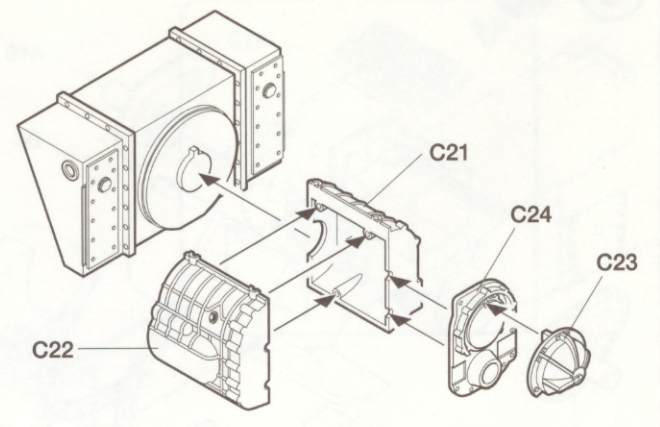
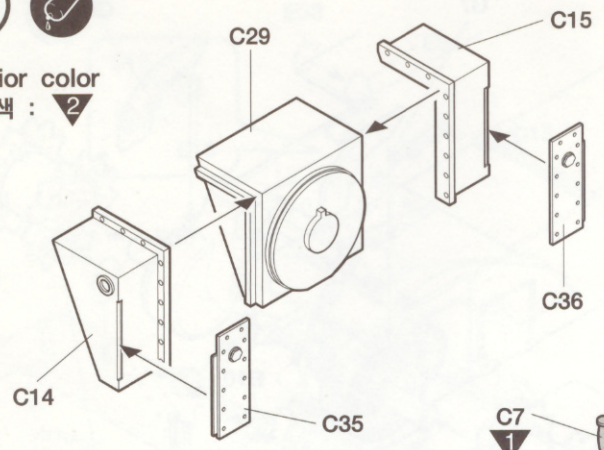

4

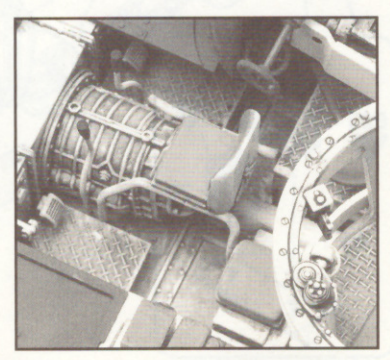
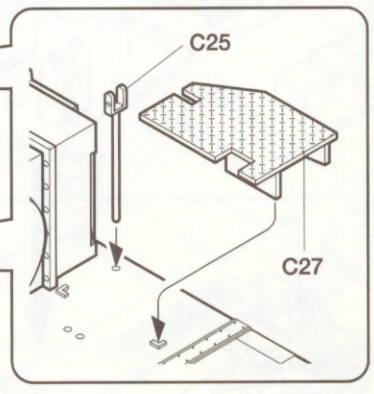
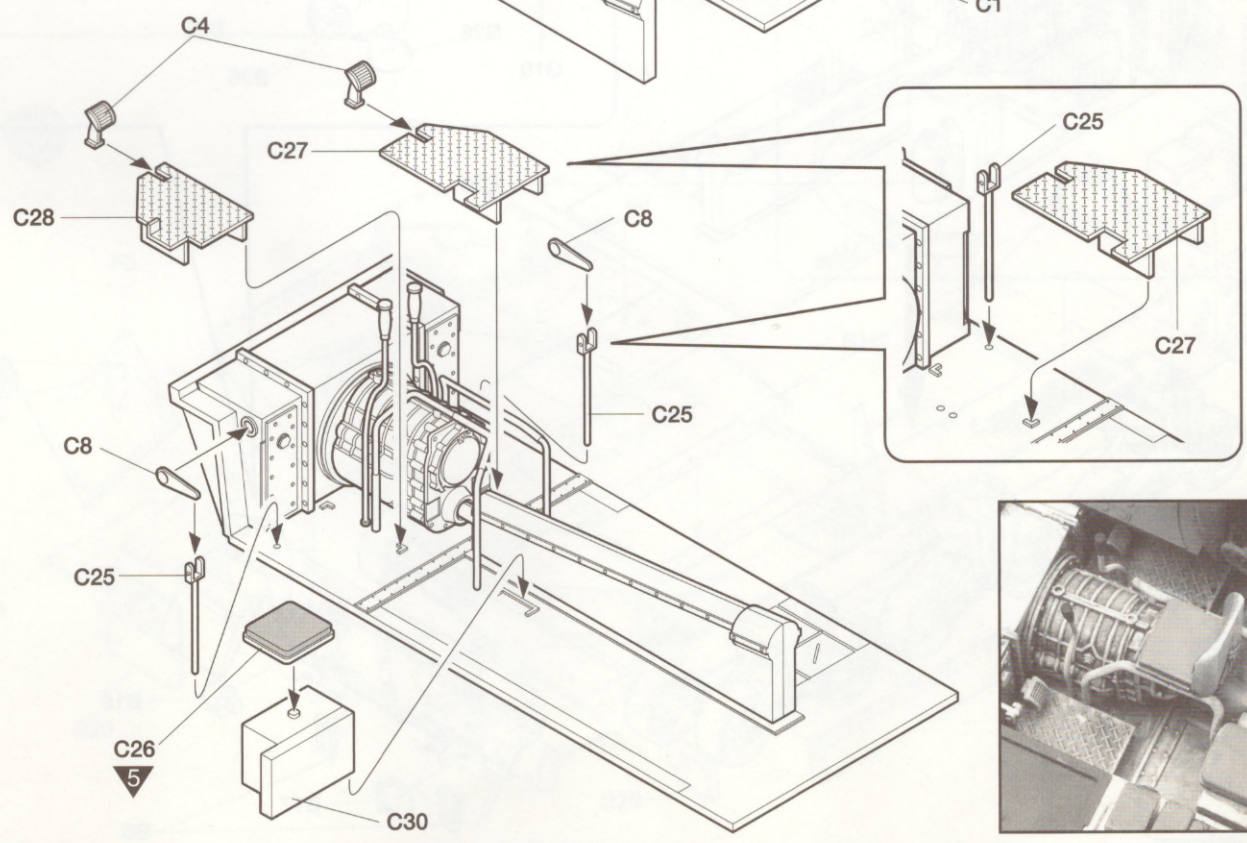
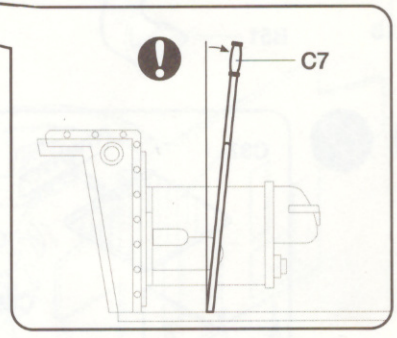
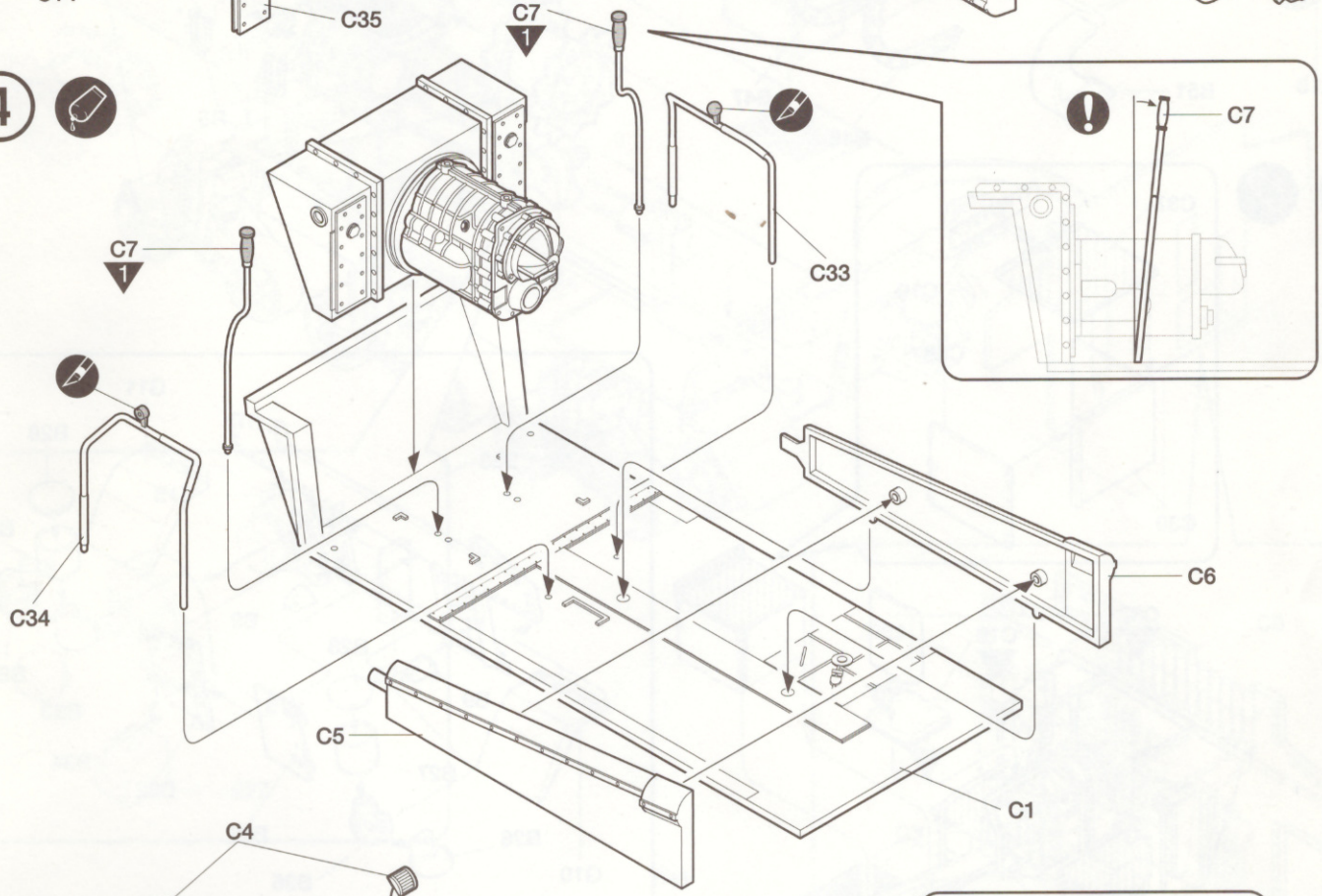

5

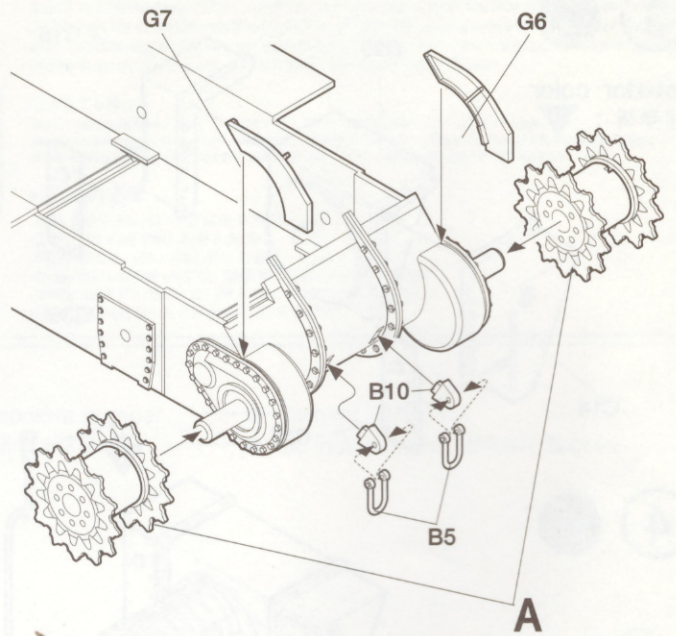
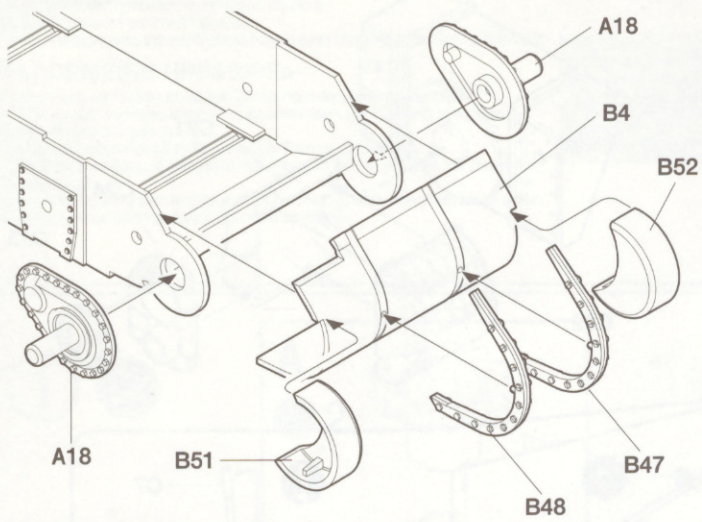

6

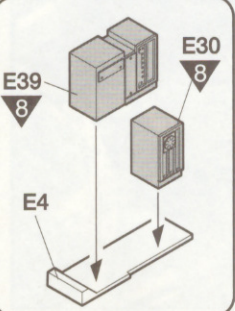
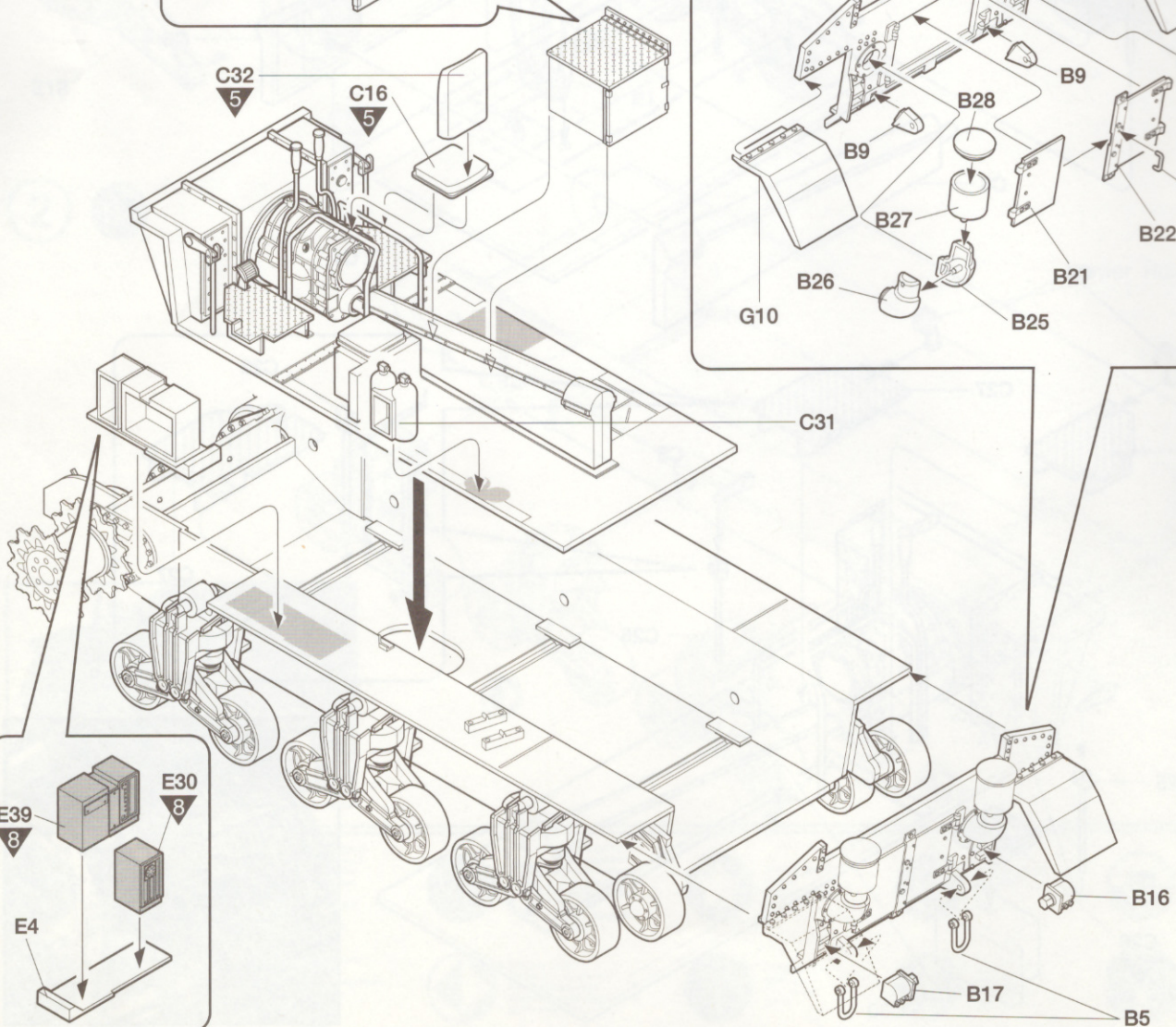
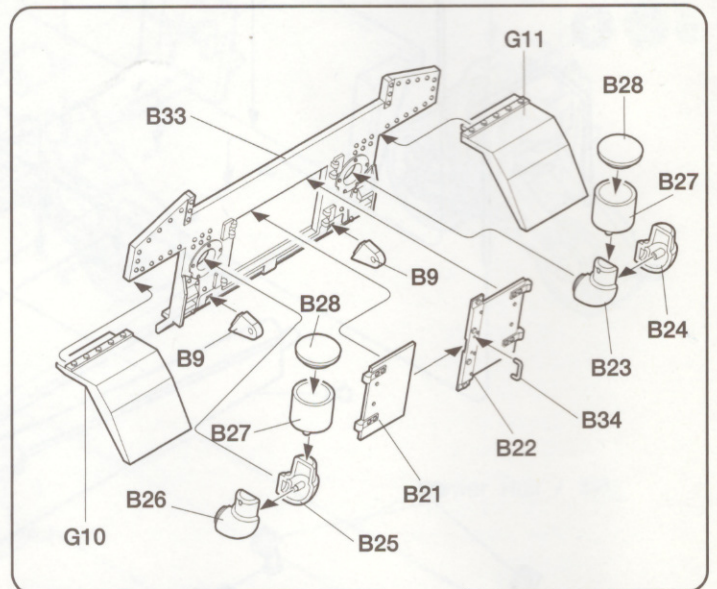
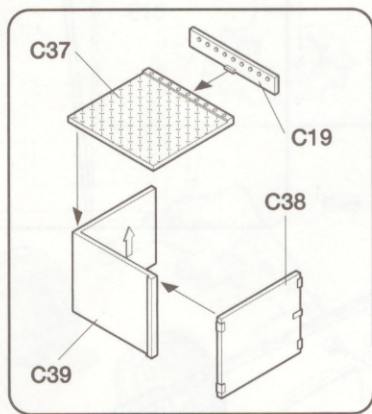

7

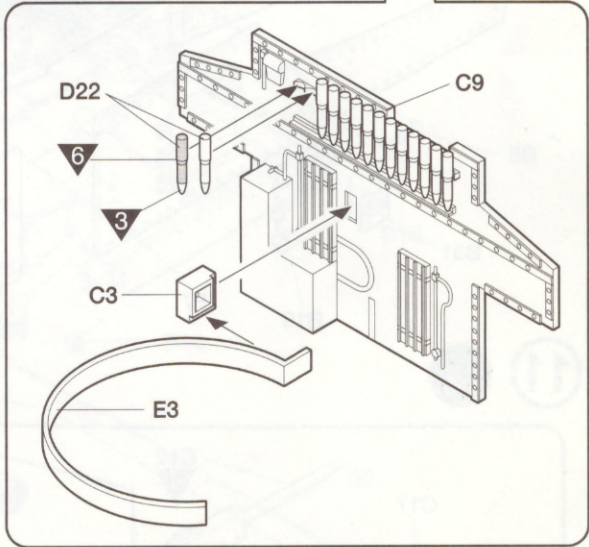
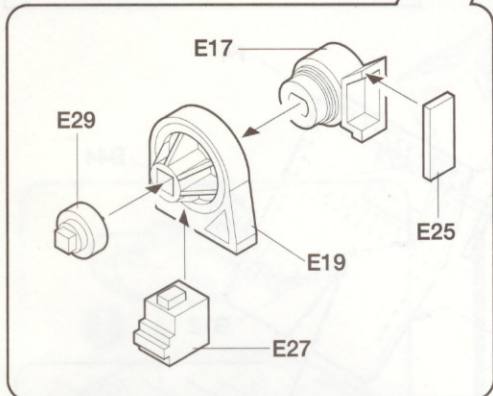
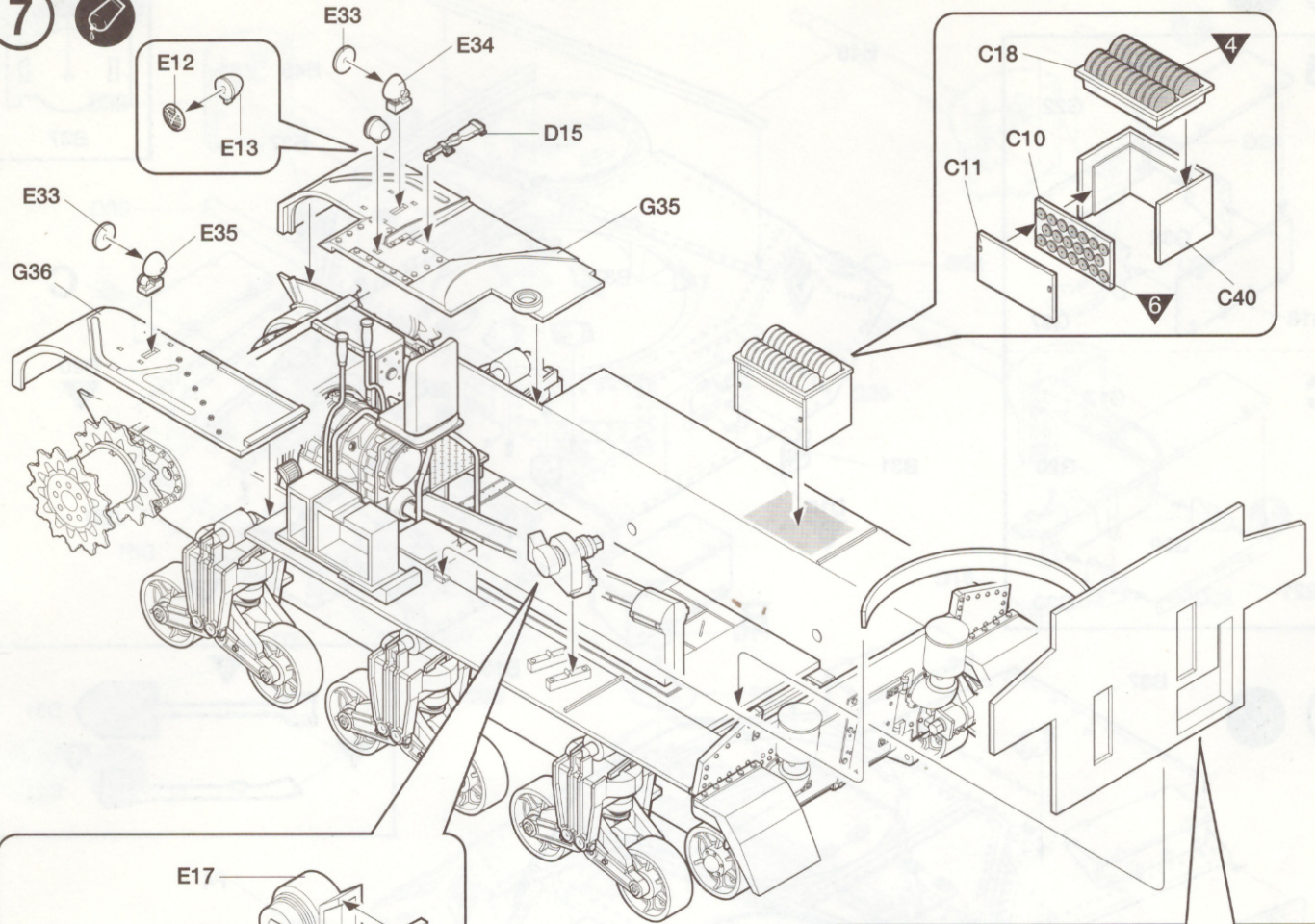

8

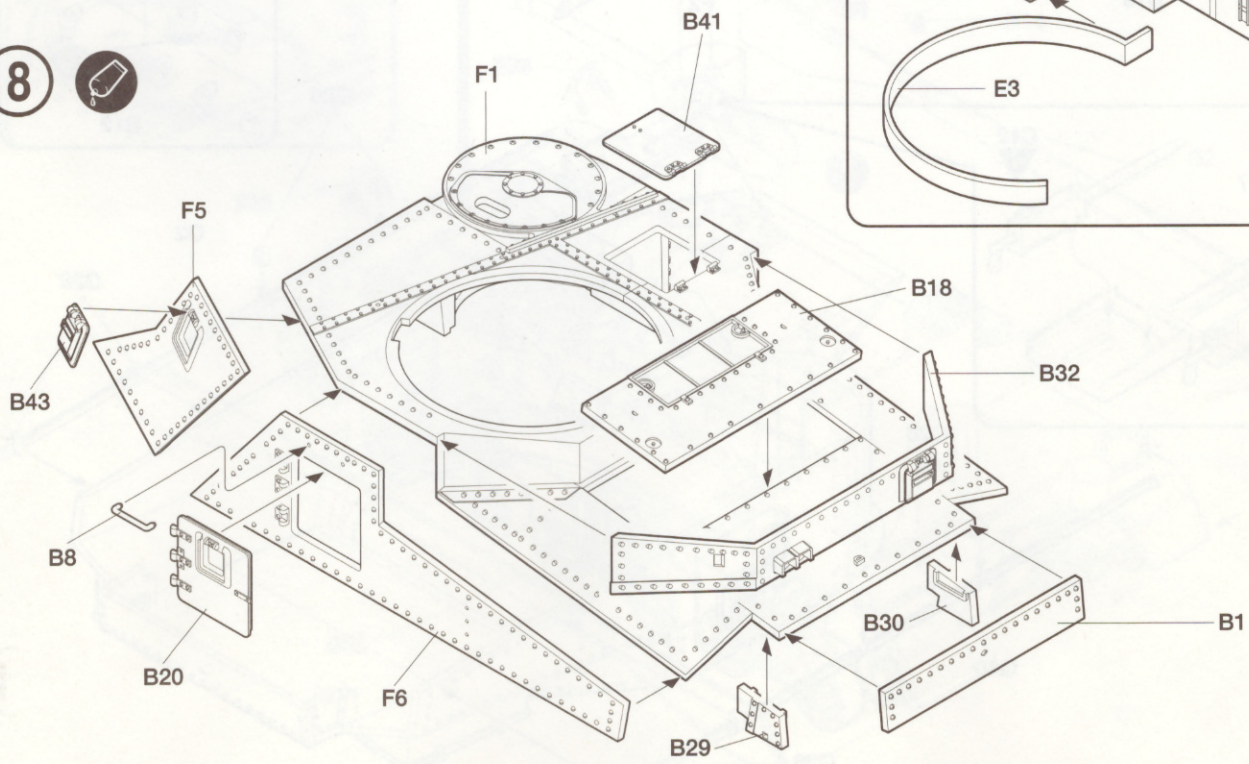

9

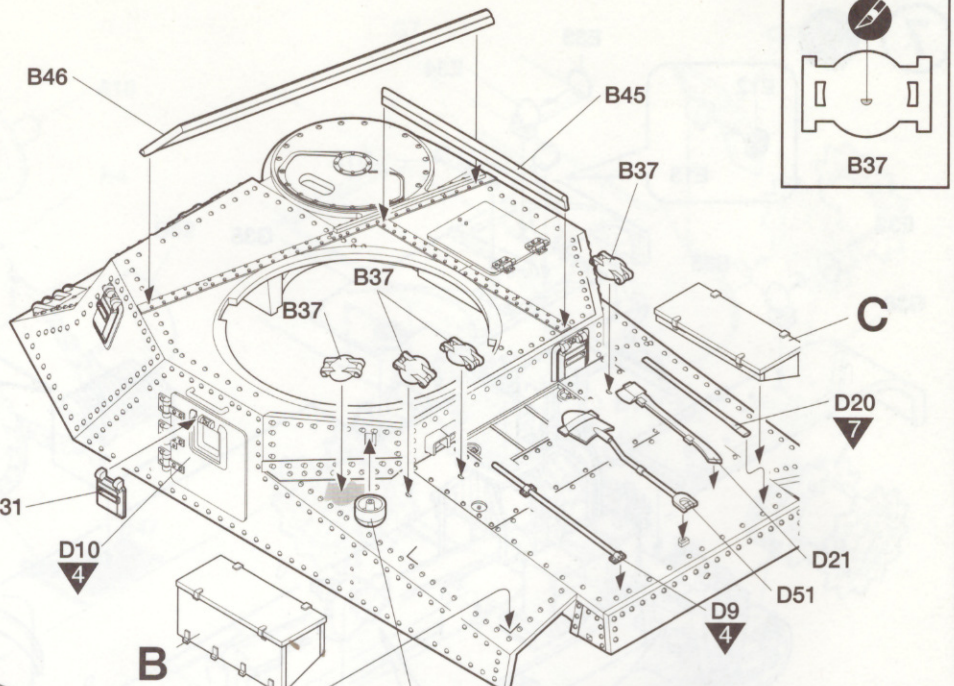
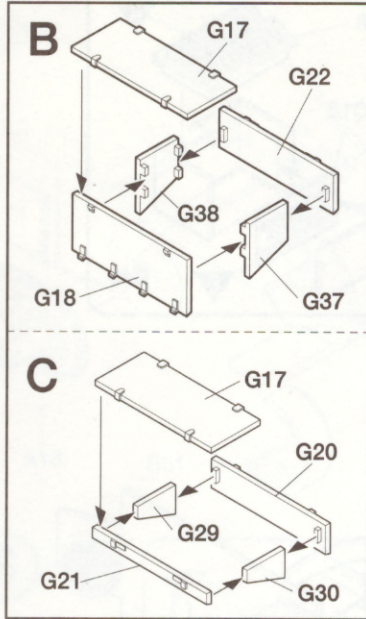

10

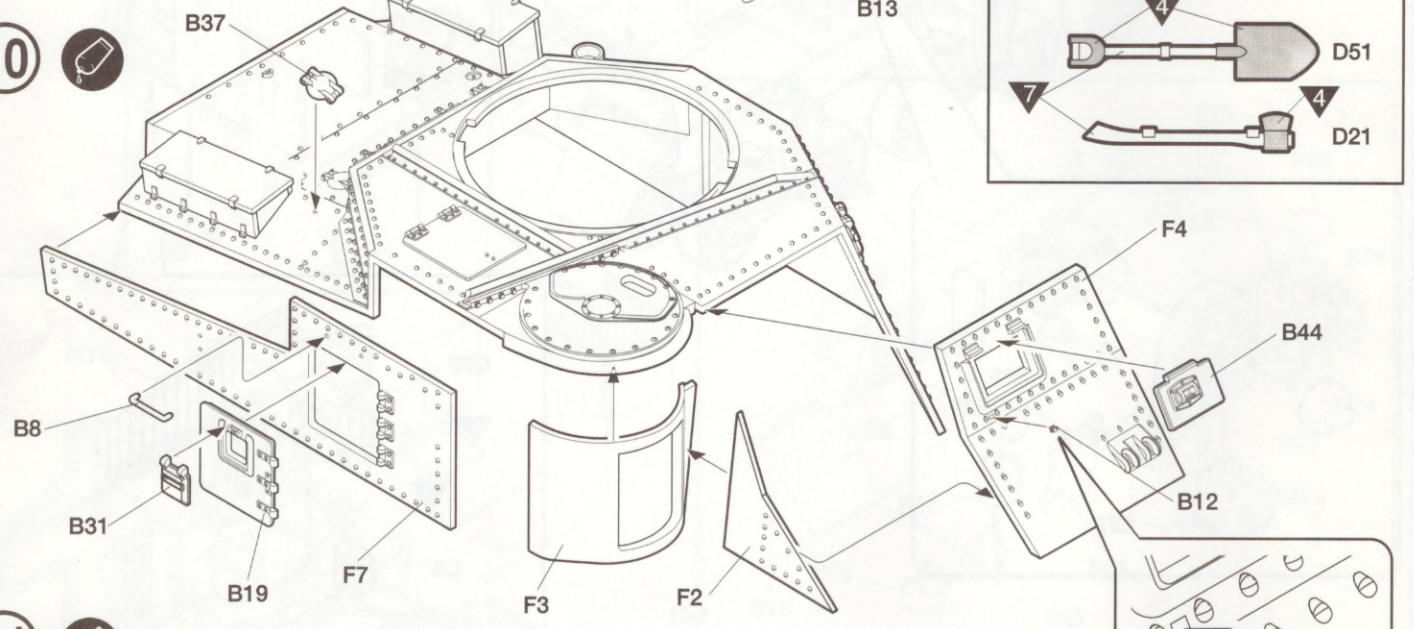

11

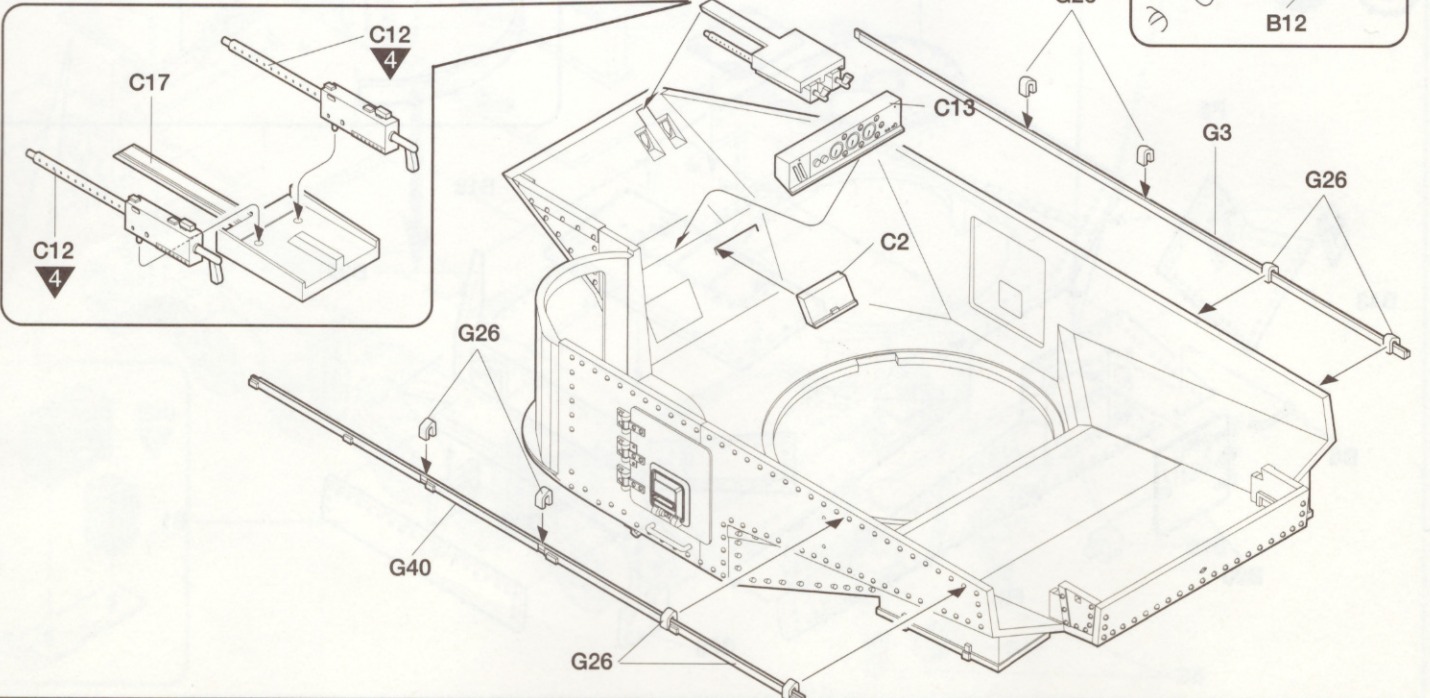

12

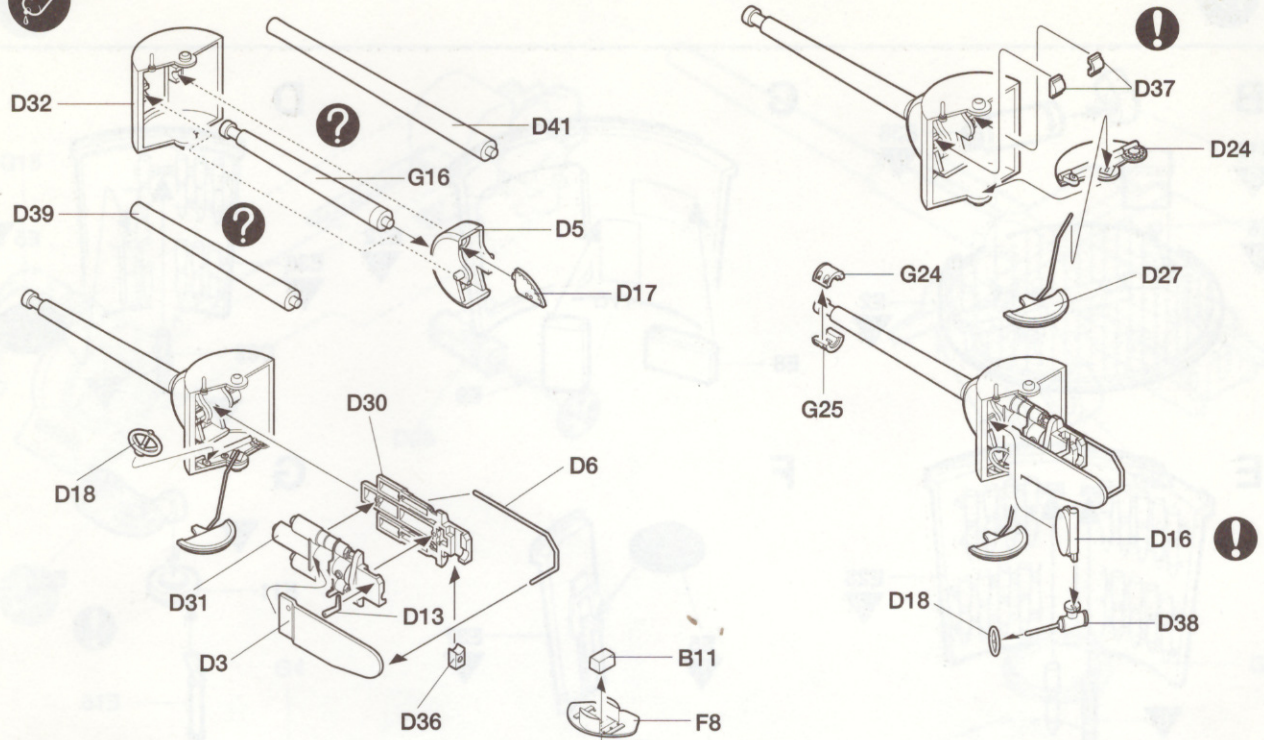

13

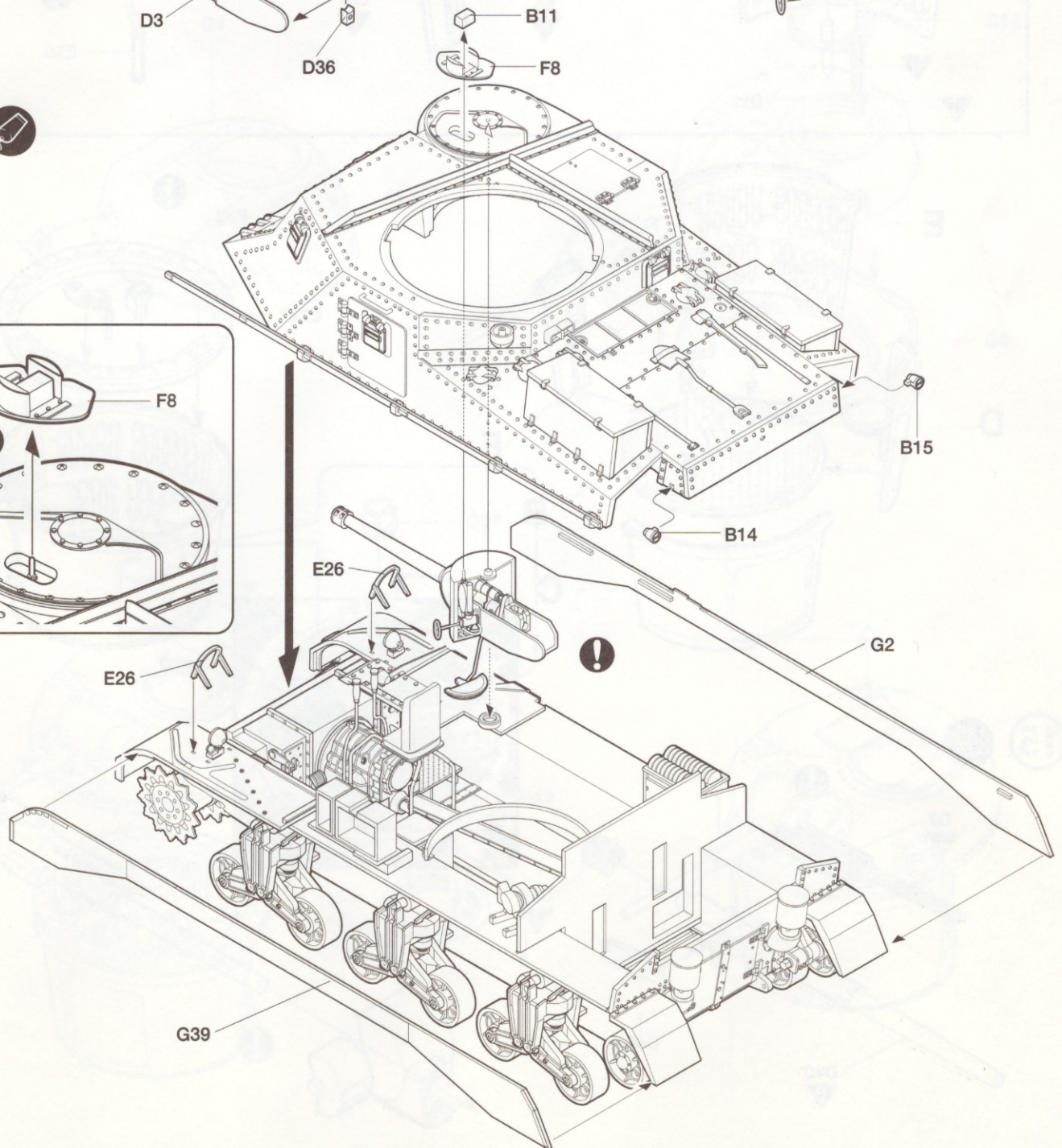
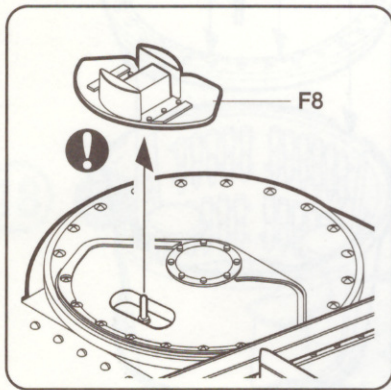

14 

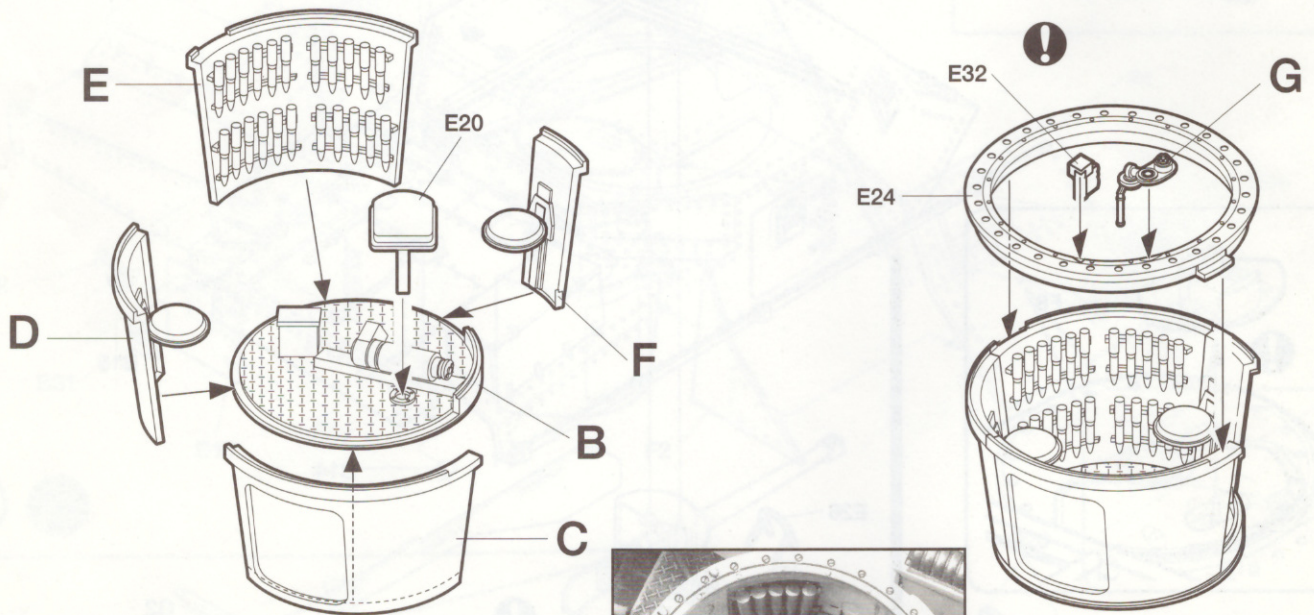
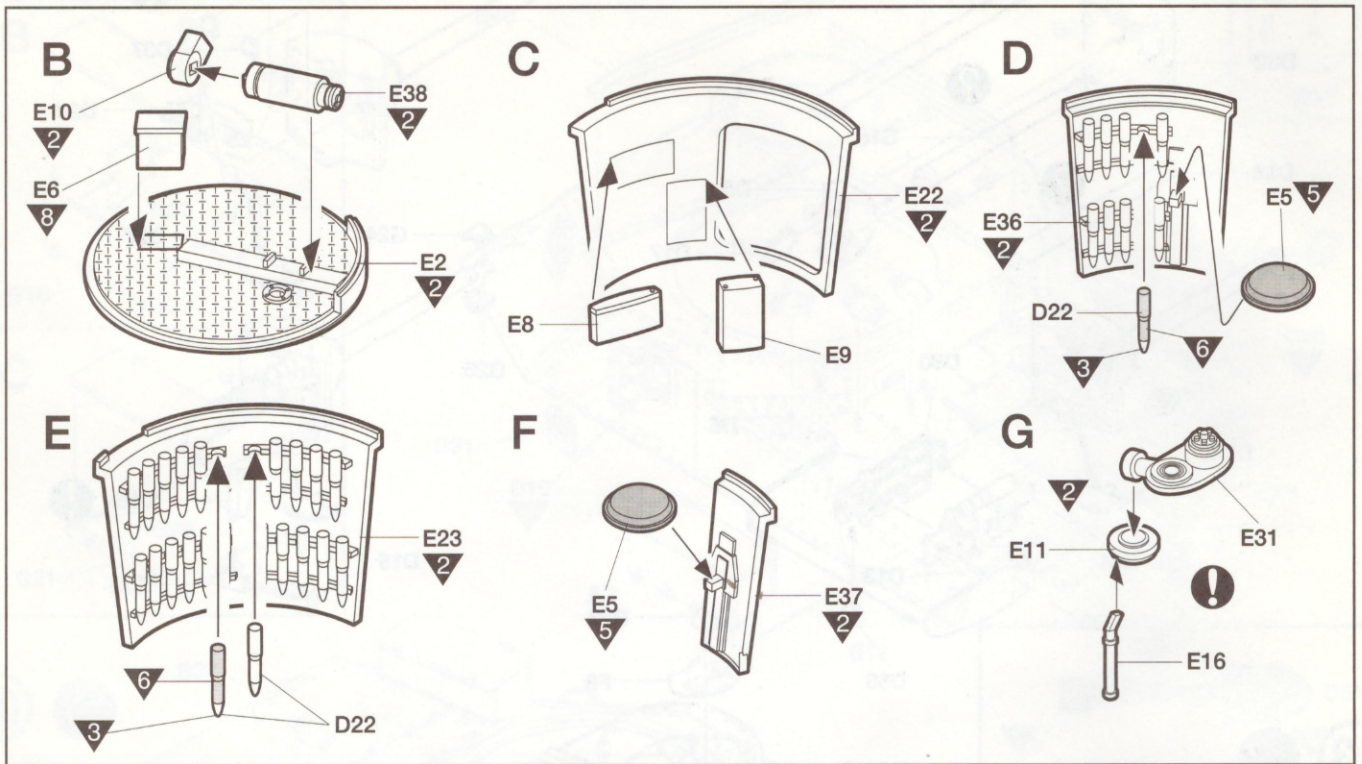

15 

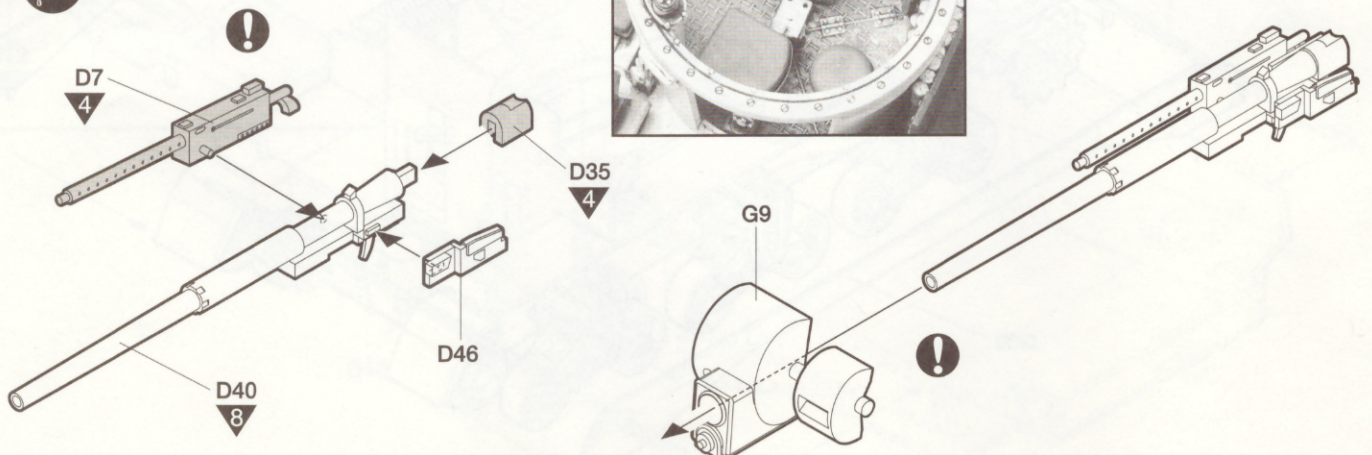

16

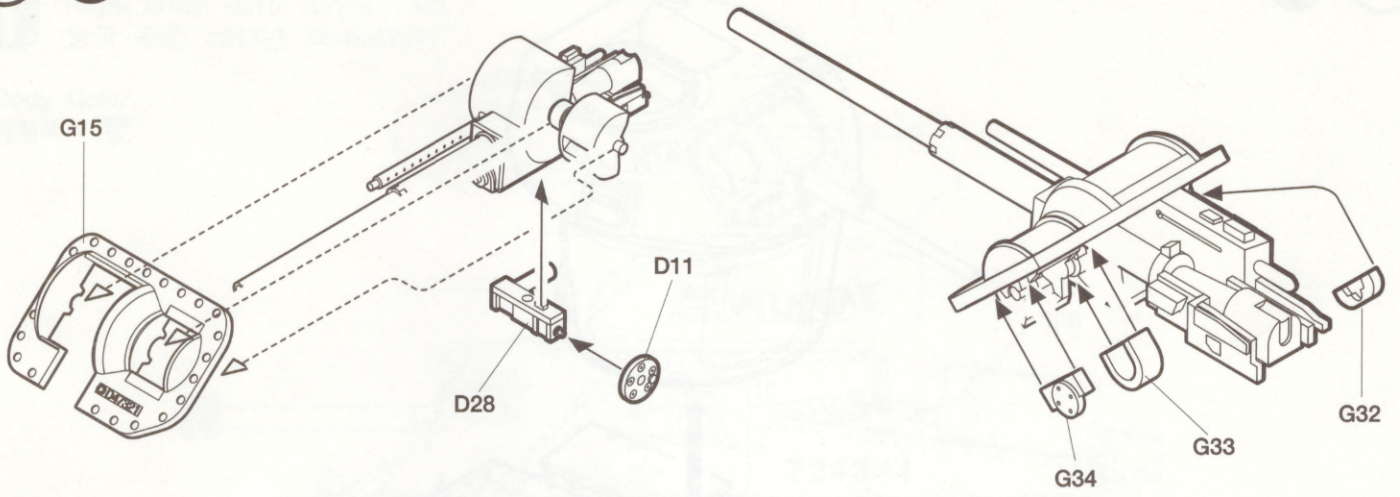

17

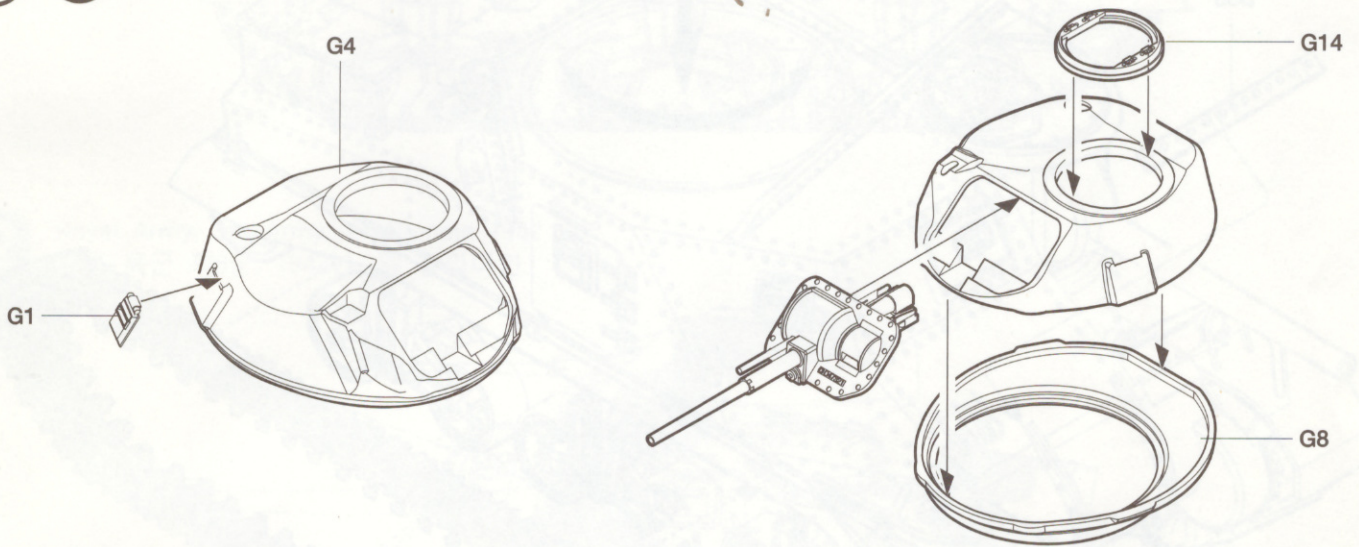

18

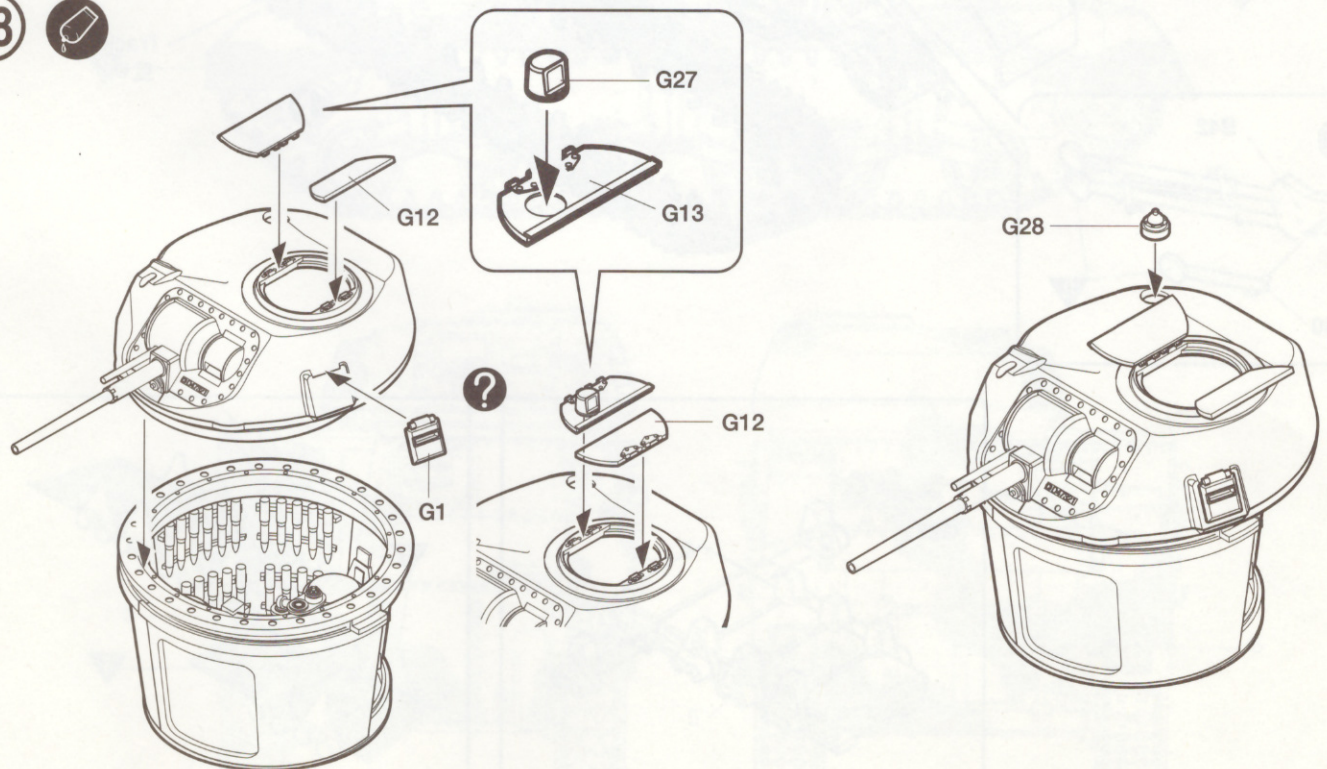

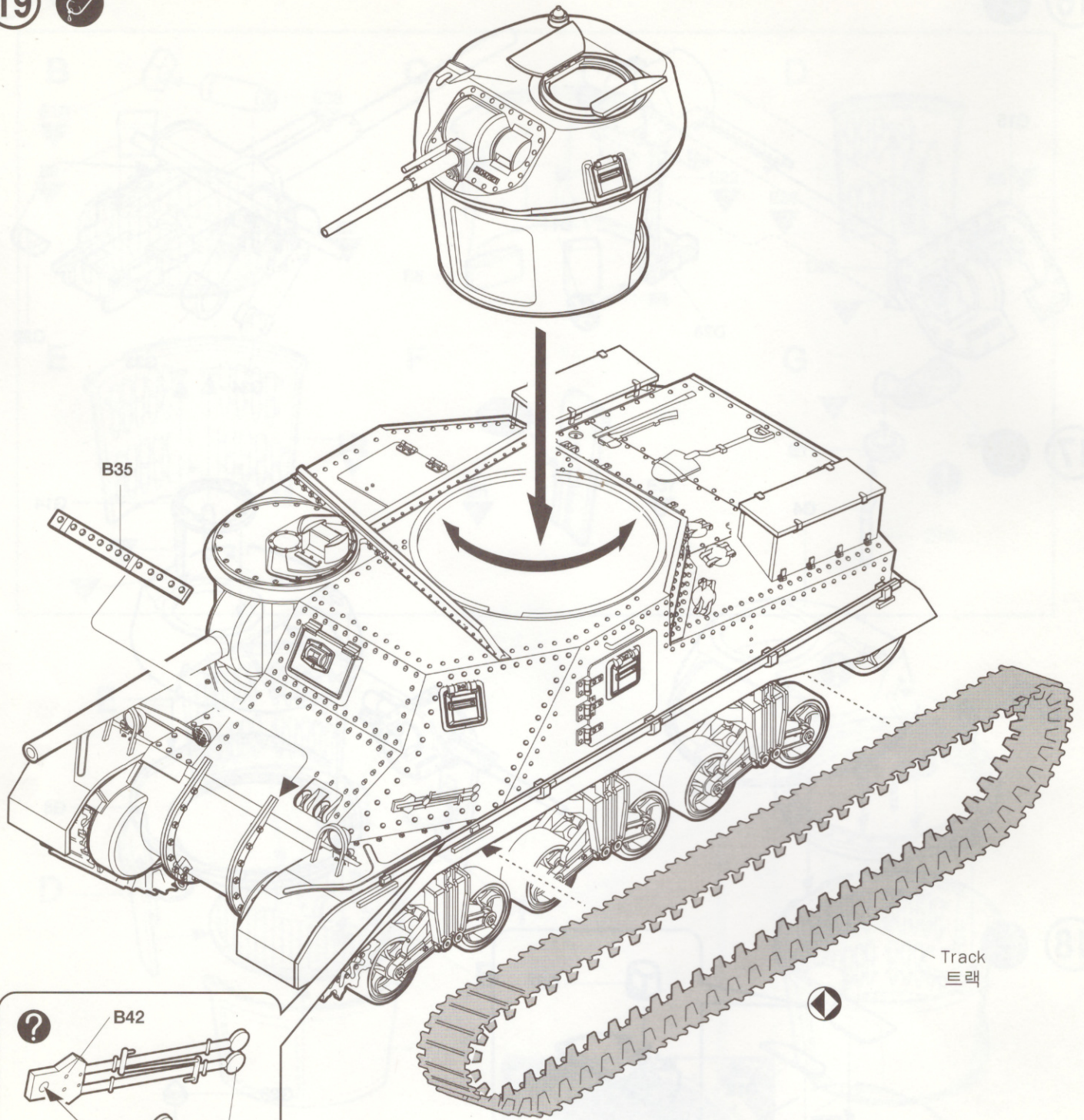

Track
트랙

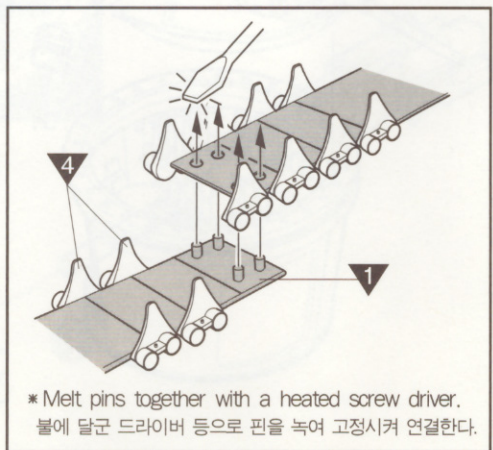
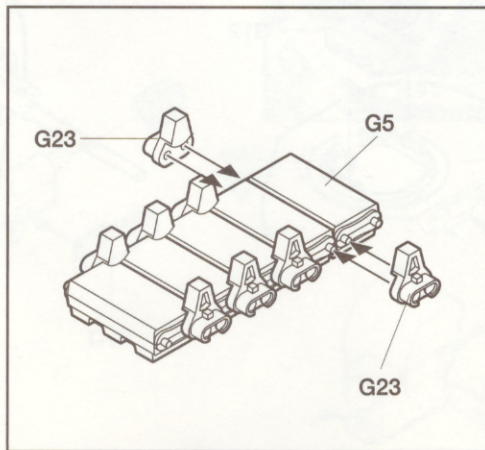
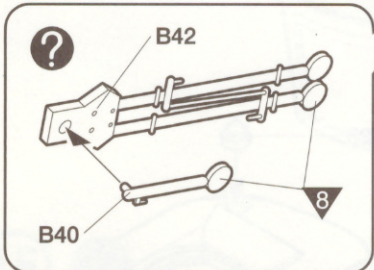

* Melt pins together with a heated screw driver.
 불에 달군 드라이버 등으로 핀을 녹여 고정시켜 연결한다.

Painting & Decal placement 색칠 및 전사지 붙이기

1 Royal Army, North Africa, 1943
 영국 육군, 1943년, 북아프리카

Body Color
 차체색 : 8

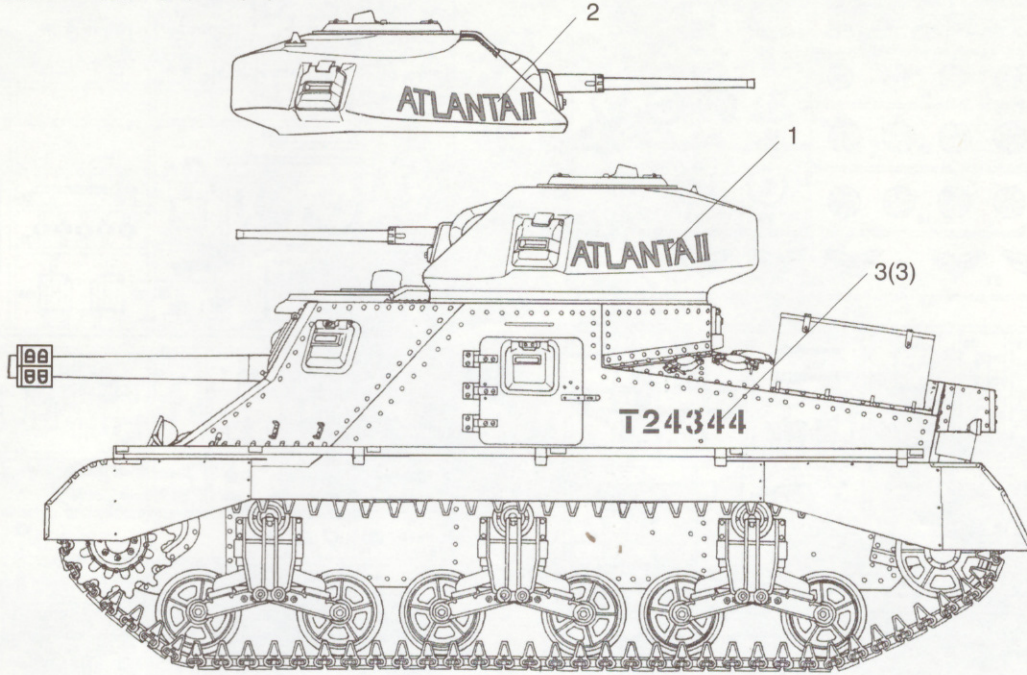

2 Royal Army, 8th Army, El Alamein 1942
 영국 육군 제8군, 1942년, 엘 알라마인

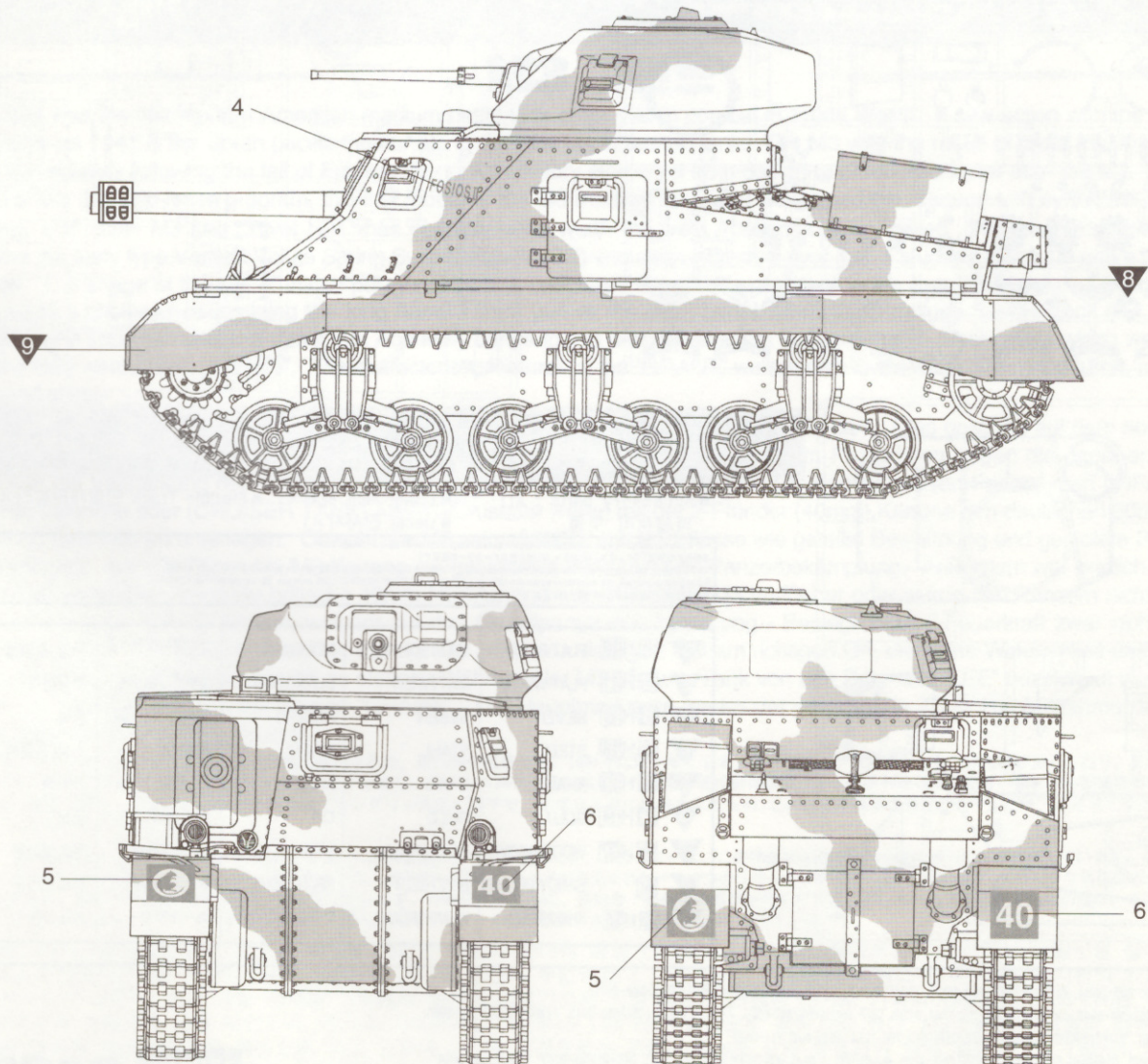

Parts Locating Diagram 부품도

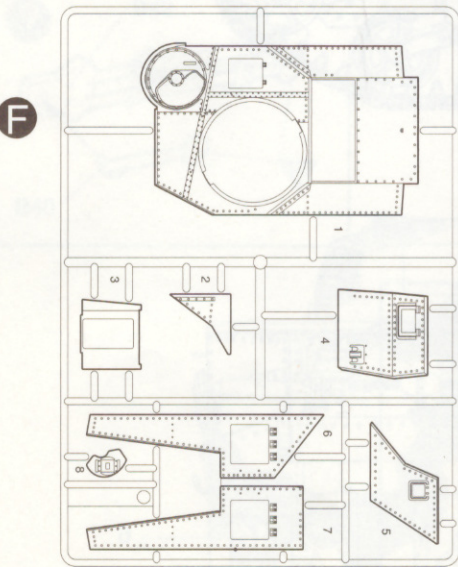
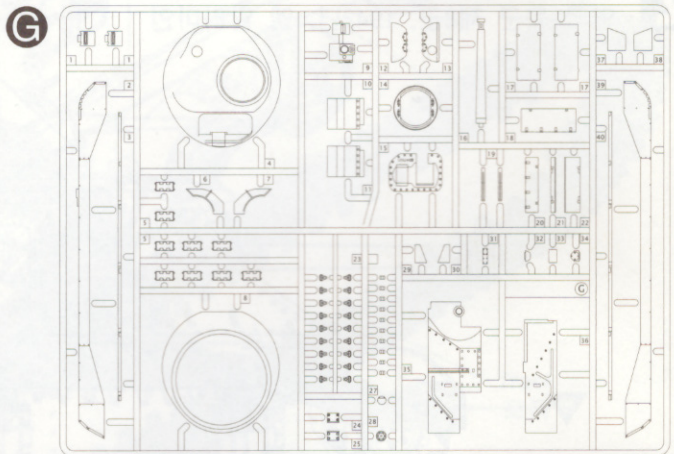
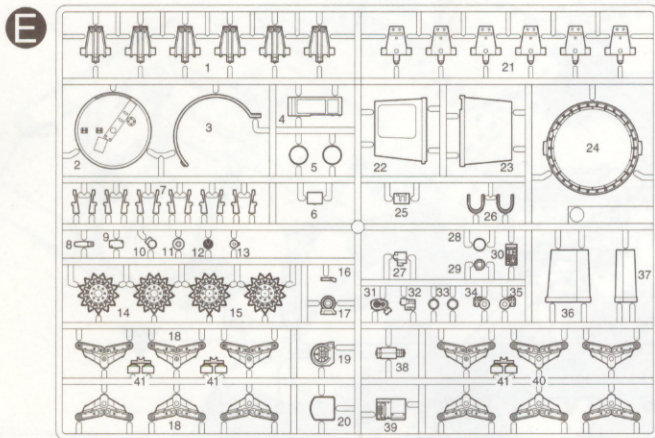
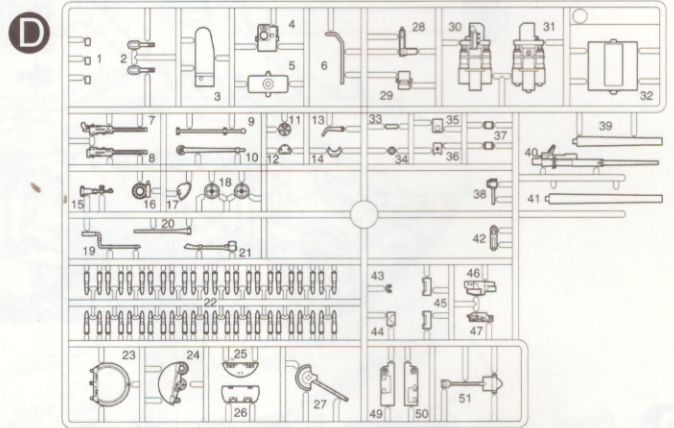
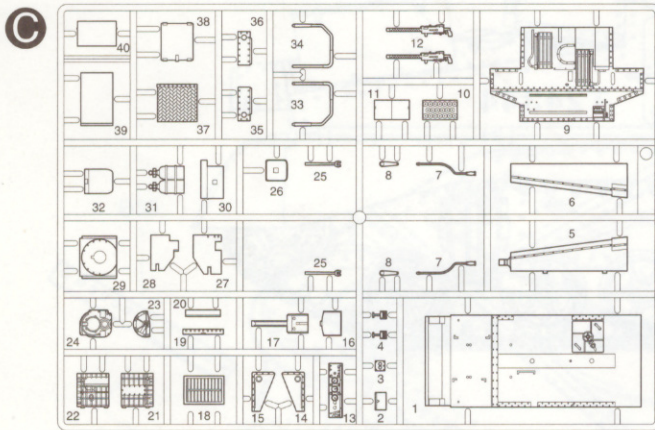
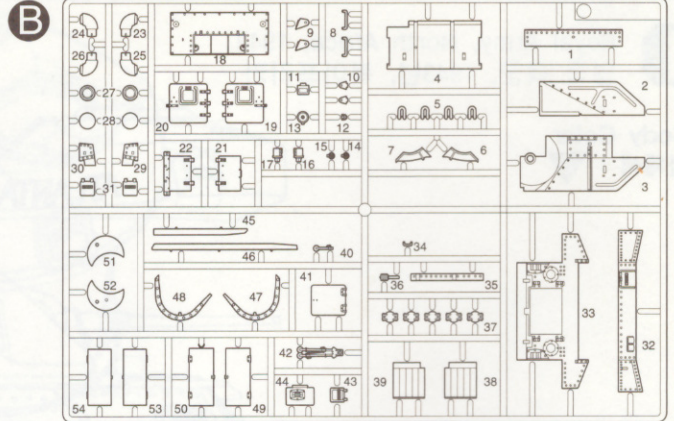
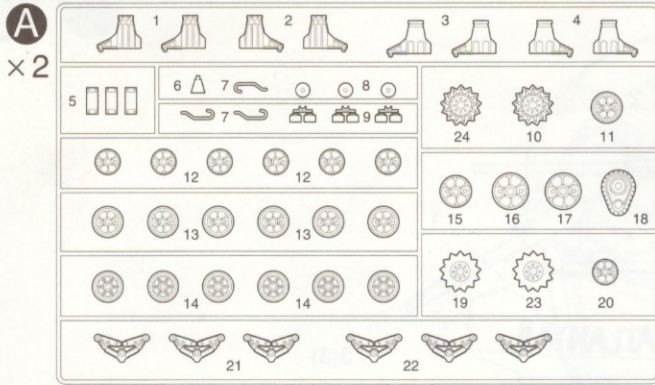

■ Unused parts : A1, A2, A3, A4, A5, A6, A7, A9, A10, A12, A13, A15, A16, A19, A20, A21, A22, A23, A24, B2, 불필요 부품 B3, B6, B7, B36, B38, B39, B49, B50, B53, B54, C20, D1, D2, D4, D10, D12, D13, D14, D19, D23, D25, D26, D29, D33, D34, D42, D43, D44, D45, D47, D49, D50, D52, D53, E28, G33

■ Accessory parts : A11 ■ Lower Hull 하체 x1 ■ Flexible Track 연결캐터필러 x2
액세서리 부품 ■ Decal 전사지 x1

H1: In painting indication is the number of GSI Creos Aqueous Hobby Color, while ■ is that of Mr. Color.
塗料指定の数字はGSIのアクエウス・ホビーカラー、■は水性ホビーカラーの番号です。
H1: Bei Bemalungshinweisen ist die Nummer der Aqueous-Hobby-Color von GSI Creos, während ■ den Ton der Farbserie Mr. Color anzeigt.
Sur le guide de peinture, H1 correspond au numéro de couleur GSI CREOS AQUEOUS HOBBY COLOR, alors que ■ correspond à Mr. COLOR.
도료지정 ■ 은 GSI 크레오스 Mr. 컬러, H1 은 수성아미블러의 번호입니다.

1	33 H12	FLAT BLACK	MATTSCHWARZ	NOIR MAT	つや消しブラック	무광 검정색
2	62 H11	FLAT WHITE	MATTWEISS	BLANC MAT	つや消しホワイト	무광흰색
3	8 H8	SILVER	SILBER	ARGENT	シルバー (銀)	은색
4	28 H18	STEEL	STAHL	ACIER	黒鉄色	스틸(흑철색)
5	55 H81	KHAKI	KHAKI	KAKI	カーキ	카키색
6	9 H9	GOLD	GOLD	OR	ゴールド	금색
7	48 H37	WOOD BROWN	HOLZBRAUN	BRUN BOIS	ウッドブラウン	우드브라운
8	19	SANDY BROWN	SAND GELB	BRUN SABLE	サンディブラウン	샌디브라운
9	54 H80	KHAKI GREEN	KHAKI GRÜN	VERT KAKI	カーキグリーン	카키 그린

●총판점 : 강남아카데미:485-6884, 강북아카데미:762-0980, 강서아카데미:2678-7988, 경기아카데미:(031)388-9815,
경남아카데미(창원):(055)298-6940, 대구아카데미:(053)744-9293, 대구 R/C:(053)741-6326, 서면아카데미:(051)816-9773, 서울아카데미:907-0940,
아티(구리):(031)527-8801, 양재아카데미:575-9997, 용산아카데미:796-1214, 용산 R/C:711-0922
●매 장 : 삼선교:742-9293, 아셈하비:6002-6293, 하비관:701-4293 ●A/S센터 : 본사:908-7000(교환 147, 148), 동대문:745-9293, 천호동:485-6884
●고객상담문의 : 080-969-7000 ●본사주소 및 전화번호 : 서울시 강북구 수유2동 273-64 ☎308-7000
●홈페이지 : <http://www.academy.co.kr>

ACADEMY HOBBY MODEL KITS **ACADEMY** ACADEMY PLASTIC MODEL CO., LTD.