

# Universal Carrier MMG Mk.II

1/35 SCALE

NO.RV 35016



The Universal Carrier was built in 1940 as a replacement for a series of Carriers introduced during the 1930's. The basic vehicle then being modified to the specific task required. The Universal Carrier MkII was modified to carry the .303 Vickers water-cooled medium machine gun. This weapon was stowed in the right side compartment and could be mounted on top of the engine cover, firing forward. It could also be dismounted from the vehicle and fired from its tripod. The .303 Vickers MMG was the British army standard support weapon and was widely used in infantry and motorized infantry units. It had a sustained fire of 450 rounds per minute. It was accurate to ranges up to 4,000 meters and was served by a gunner and loader. The Vickers MMG Carrier Mk.II was used by all British and Commonwealth armies throughout WWII and well into the 1950's. The weapon itself was not finally retired by the British army until 1962.

Short story by Phil Greenwood

通用运输车于1940年被生产出来，用以替换30年代引进的一系列步兵运输车。基本型Mk. II型因为特定任务需要被改进行生搭载维克斯.303水冷式重机枪的Mk. II型机枪装载车。维克斯机枪通常被存放在右侧隔舱，或则架在发动机盖顶部，朝前射击，同时也可以从车上卸下并从三脚架发射。维克斯.303重机枪作为英军标准的地面部队支援武备在步兵和机械化步兵单位中被广泛使用。维克斯机枪每分钟射速450发，精准距离4000米，组员由一个机枪手和一个填弹手组成。由二战直至上世纪50年代，英军和所有联邦军队都曾装备过维克斯重机枪运载车Mk. II型。直到1962年，英军才正式宣布维克斯机枪最终退出现役。

ユニバーサルキャリアは1930年代に導入された一連のキャリア(兵器運搬車)が導入、その後続車両として1940年に作られました。基本車両を特化目的に改造することが要求、303ヴィッカーズ水冷中型機関銃を搭載する車両としてこのユニバーサルキャリアMMGマークIIとして装備変更されました。機銃は車両右側戦闘室に収められ、エンジン室上面に装着前方射撃できました。また機銃は車外へ取り外して三脚を使用して射撃もできました。303ヴィッカーズ中型機関銃は英陸軍の標準支援火器であり広く歩兵や自動化部隊に使用されました。毎分450発の発揮するもので最大射程距離は4000メートル、装填手と射手の2名で操作されました。ユニバーサルキャリアMMGマークIIは第二次大戦を通じ1950年代にも英国および英連邦諸国で使用されました。機銃自身は1962年まで英陸軍より現役でした。

**CORRECT METHOD FOR APPLYING DECALS:**

正确贴水上贴纸的方法:

- |  |   |
|--|---|
| <ol style="list-style-type: none"> <li>1. Clean model surface with wet cloth.</li> <li>2. Cut out of decal sheet and dip them in cold water for 15 seconds.</li> <li>3. Place it on proper position on model.</li> <li>4. Slide off base paper leaving decals on model with wet finger tip.</li> <li>5. Move decals to exact position, push out excess water under decal with soft cotton cloth.</li> <li>6. When decals get dry then complete.</li> </ol> | <ol style="list-style-type: none"> <li>1. 将模型表面擦干净。</li> <li>2. 将贴纸剪下泡入清水中约15秒。</li> <li>3. 将泡湿之贴纸取出置于欲贴处旁。</li> <li>4. 用指尖轻推贴纸表面使其滑出底纸。</li> <li>5. 将贴纸调整至适当位置并轻擦拭水份。</li> <li>6. 待其自然干燥后即完成。</li> </ol> |
|--|---|

**READ BEFORE ASSEMBLING:**

组装前必读:

- |   |  |
|---|--|
| <ul style="list-style-type: none"> <li>★ When you use glue or paint, do not use near open flame, and use in well ventilated room.</li> <li>★ Keep plastic model glue and tools away from children.</li> <li>★ Glue, paints and tools are not included in the kit.</li> <li>★ Remove all injection pins carefull using a modeling file.</li> </ul> | <p>胶水或油漆勿接近火源, 并打开窗户保持空气流通。</p> <p>胶水、油漆及工具勿让小孩接触。</p> <p>胶水、油漆及工具不包含在模型内。</p> <p>小心用专业锉刀锉平所有多余胶料。</p> |
|---|--|

**ICON INSTUCTION 图标说明:**

 Bend 弯曲	 Optional 选择采用	 Apply Decal 贴上水贴纸	 Weight 配重	 Open Hole 钻孔	 x2 2 Sets needed 同样的制作二组
 Remove 切除	 Attention 请注意	 Do not cement 不用粘合	 File/Sand 锉平	 Fill Hole 把孔填平	 Instant Glue For Metal 瞬间接着剂金属用

售后服务卡限中国大陆 AFTER MARKET SERVICE CARD OF MAINLAND CHINA

部品名称	单价 (RMB)
A版零件	20
B版零件	10
C版零件	10
D版零件	16
L版零件	20
N版零件	20
H版零件	8
P版零件	20
J版零件	10
Wg3版零件	10
Wf版零件	10
M2版零件	1
M3版零件	1
Pa 蚀刻片	8
Pb 蚀刻片	10
Pc 蚀刻片	8
Decal 水贴	5
以下空白	



**RV 35016**  
零件补充申请表

本表价格仅作为您补件的参考  
如果原包装中零件遗失或者损坏,  
制作途中遗失或者损坏, 您可以  
登陆Riich Models官方网店, 客  
服部将尽快为您处理。



A x1

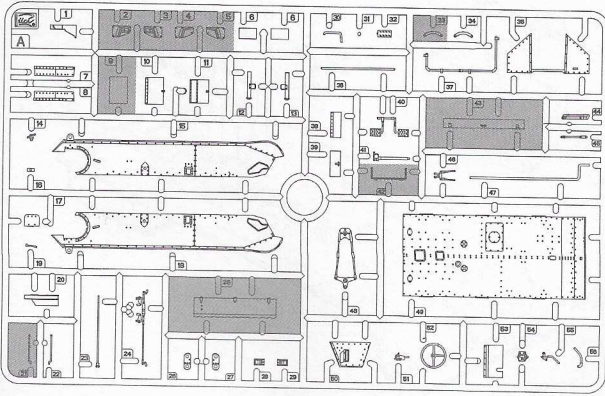

B + C x2

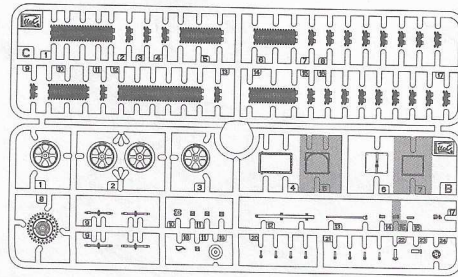

L x1

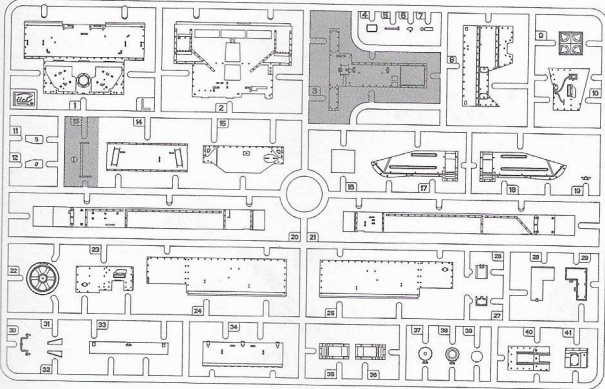

N x1

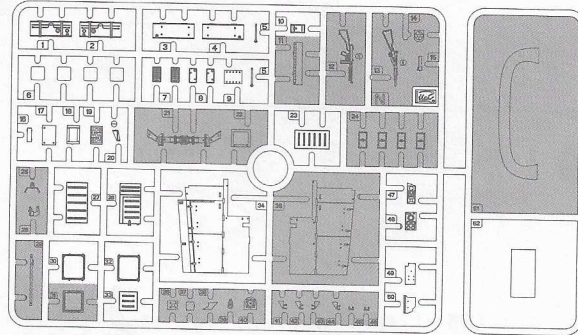

D x1

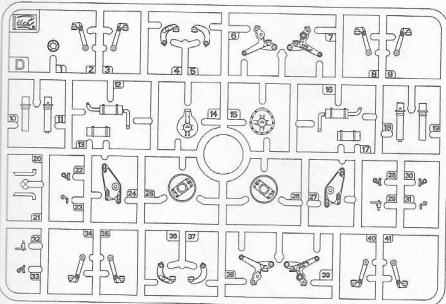

P x1

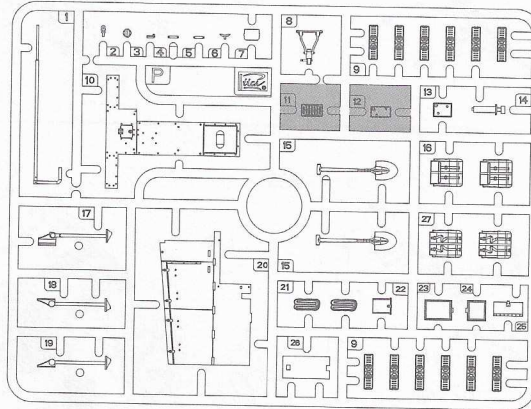

Pa x1

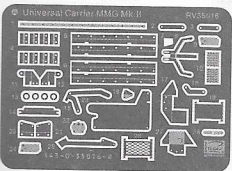

Pc x1

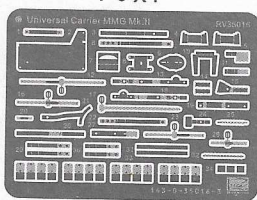

Pb x1

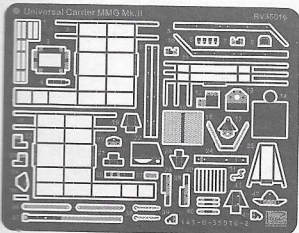

Decal x1

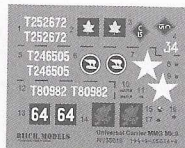

No used  
不使用的部件

J x2

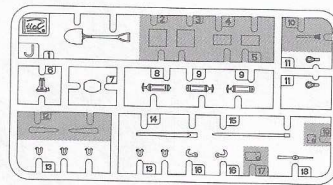

Wg3 x1

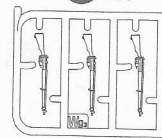

H x1

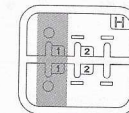

Wf x1

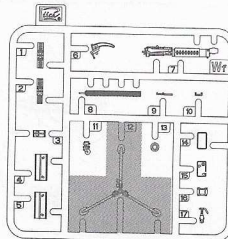

Chain  
细链 (8cm)



Thread  
细绳 (50cm)



M2 x16



M3 x16



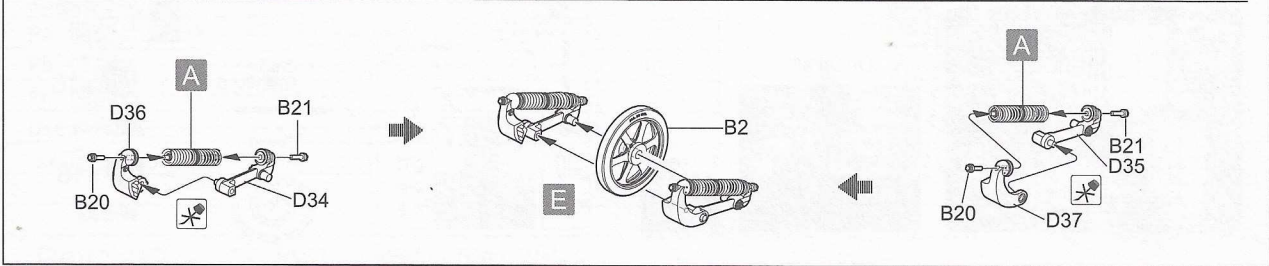
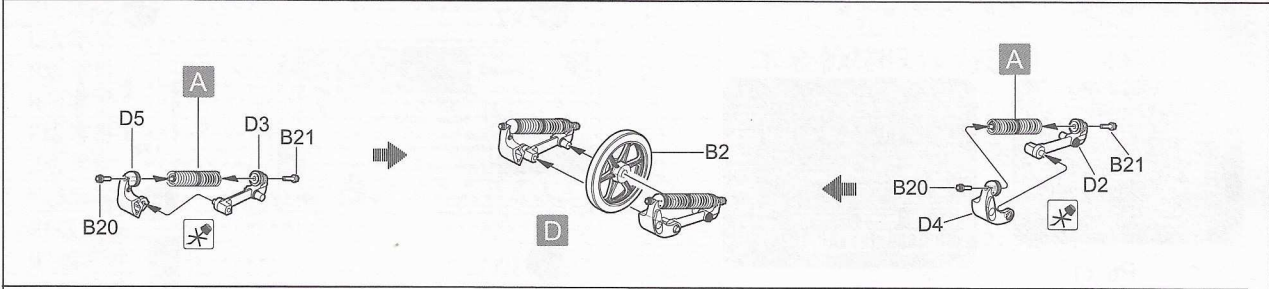
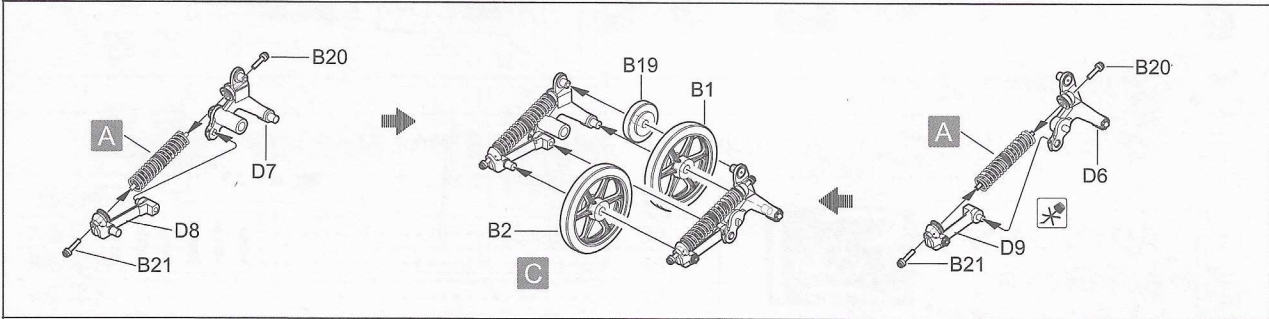
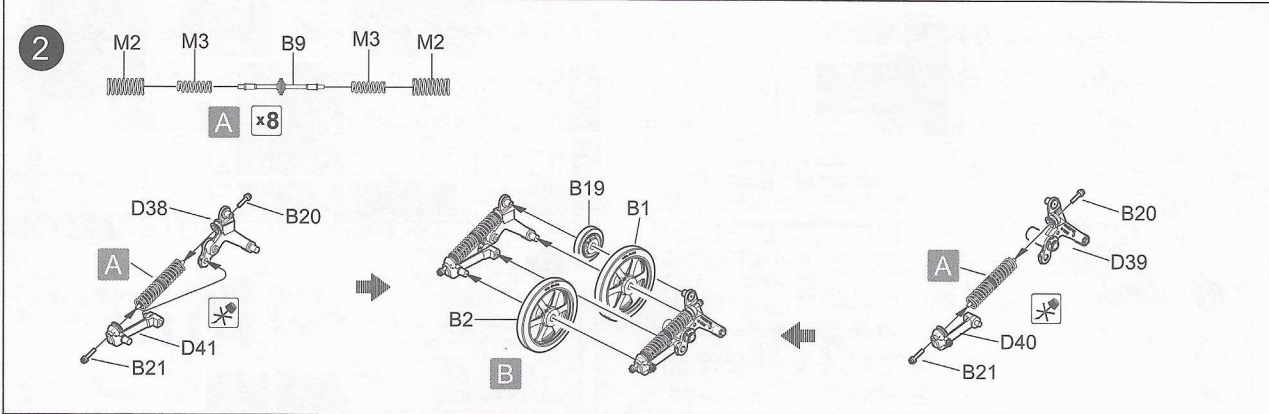
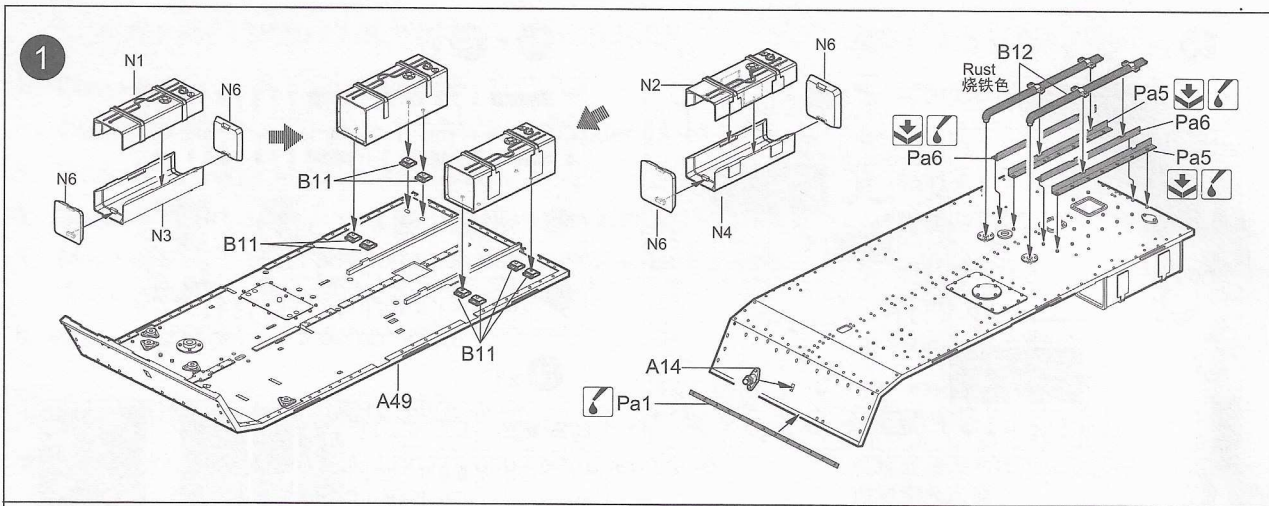

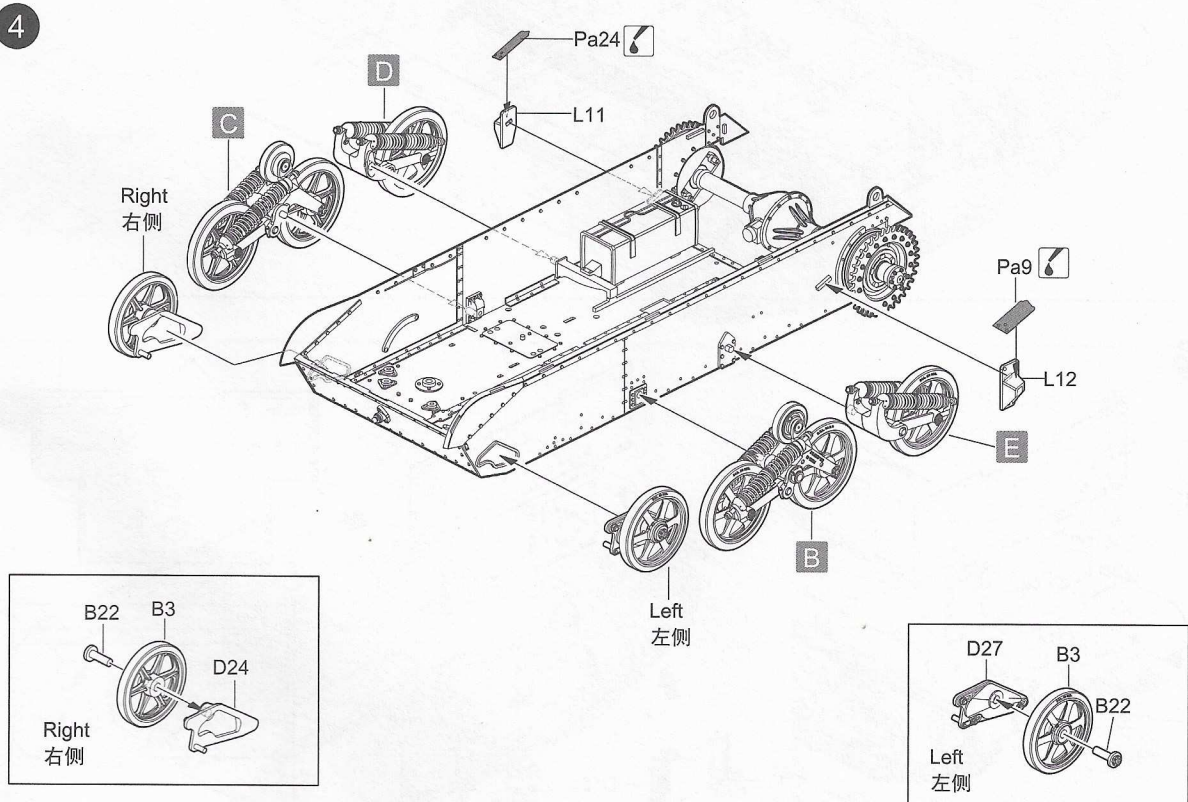
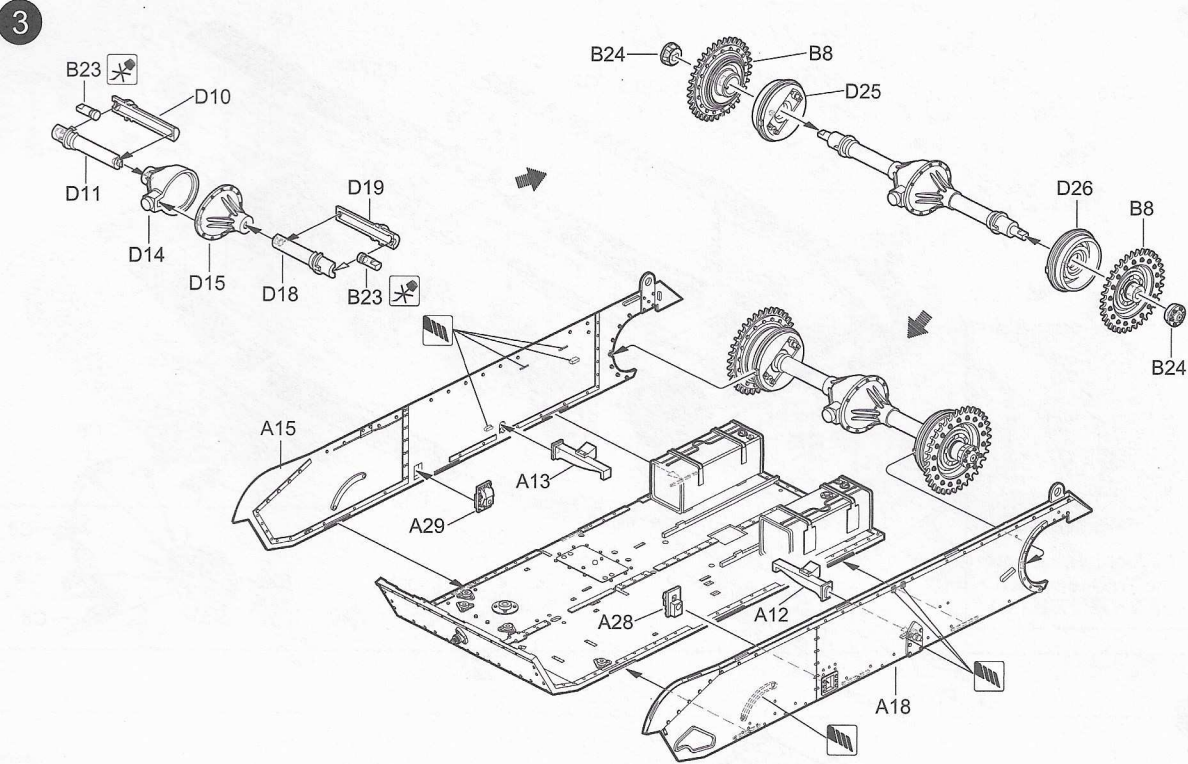

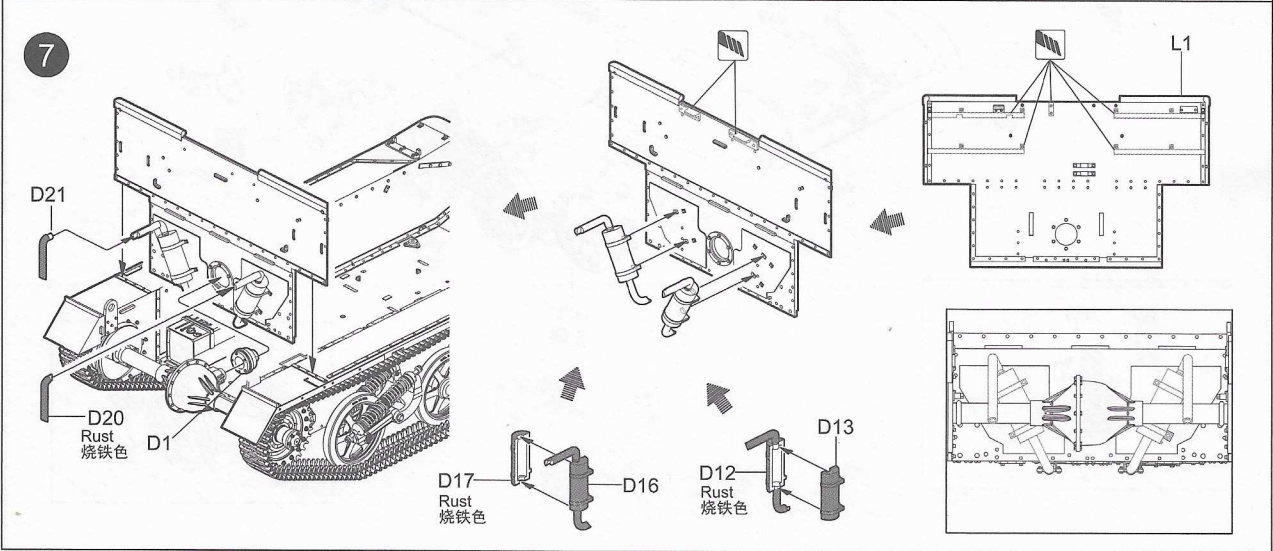
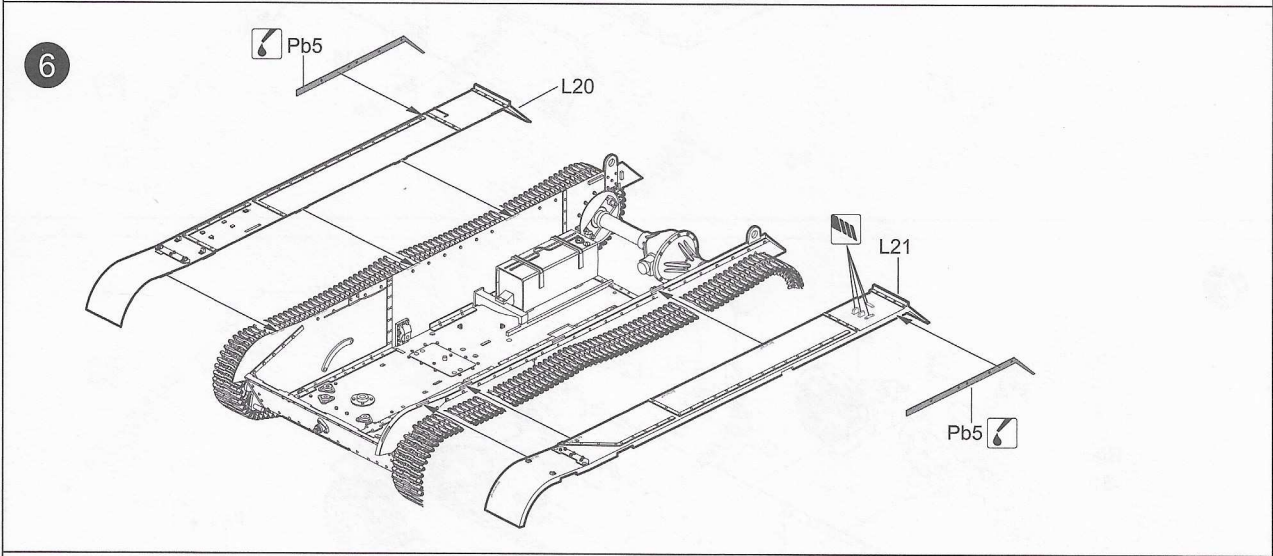
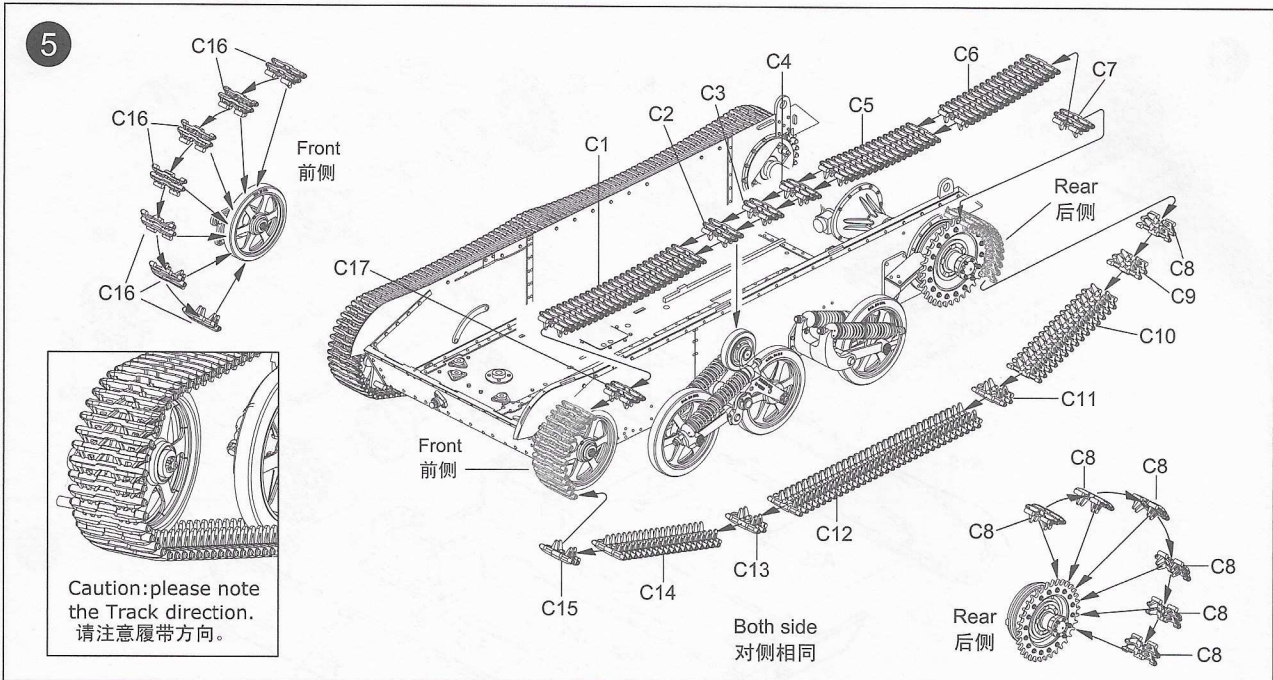

8

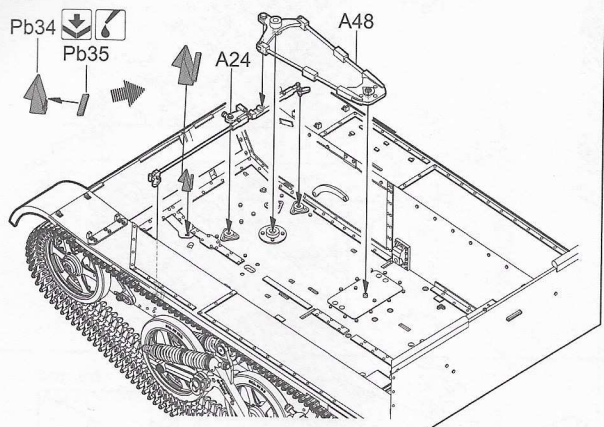

9

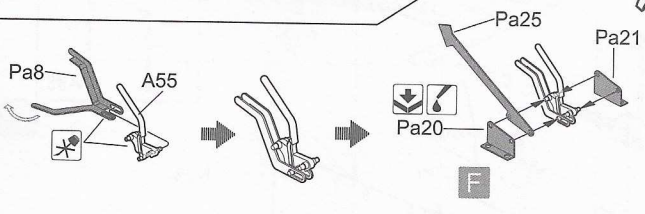
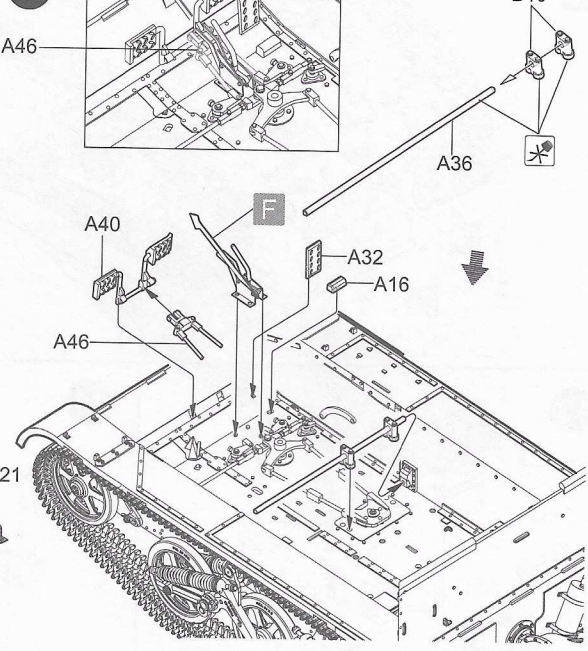

10

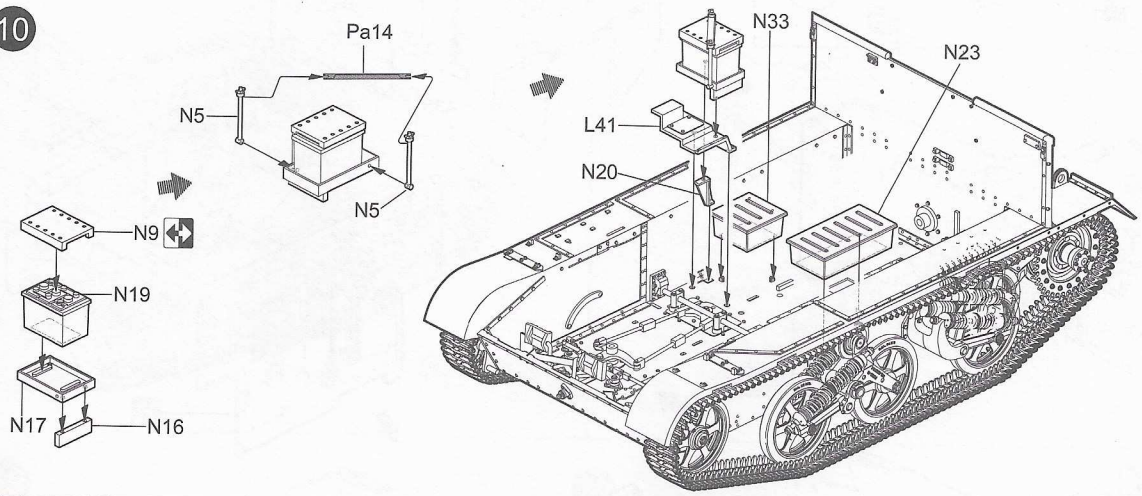

11

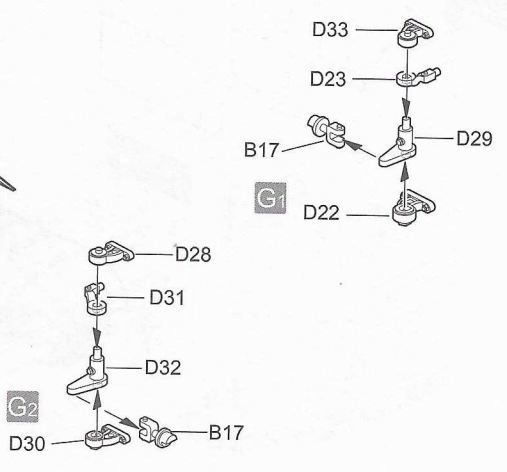
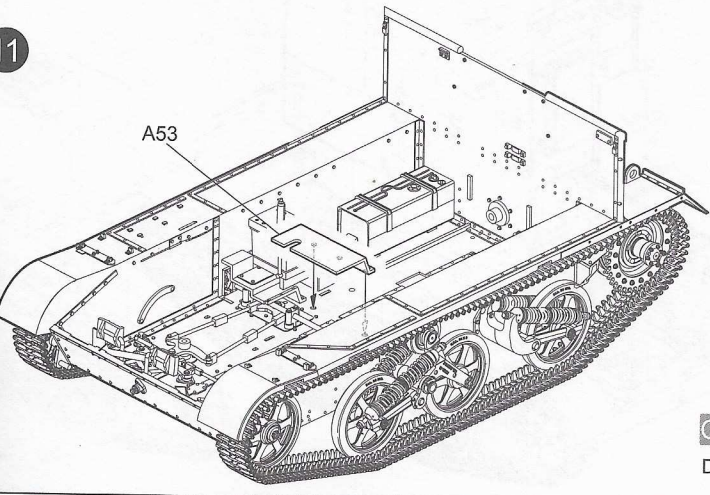

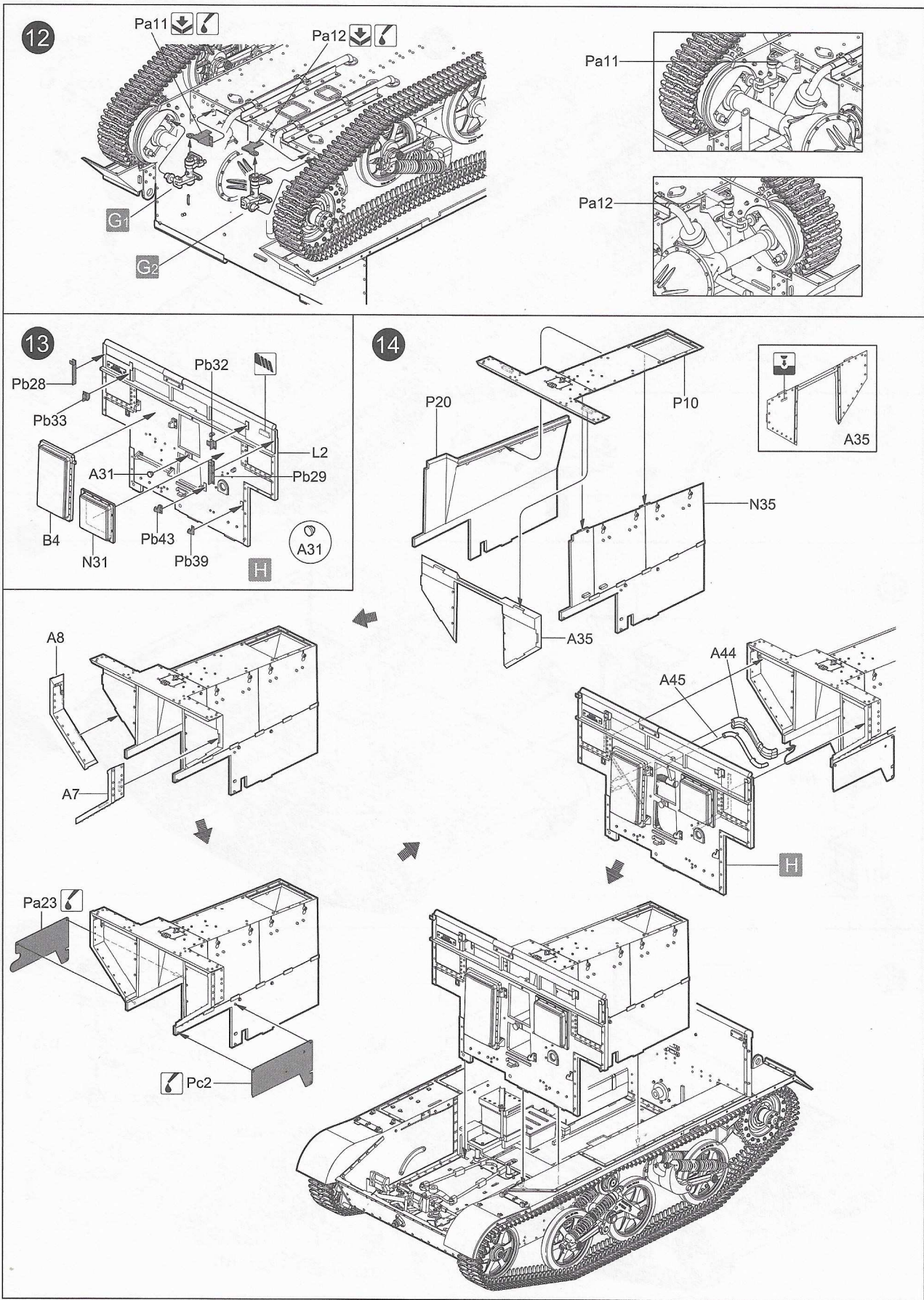



15

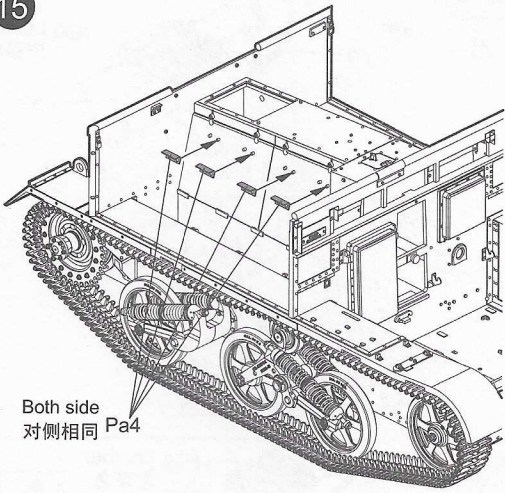

16

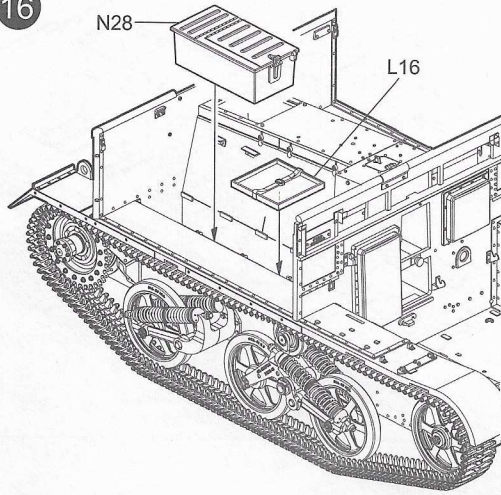

17

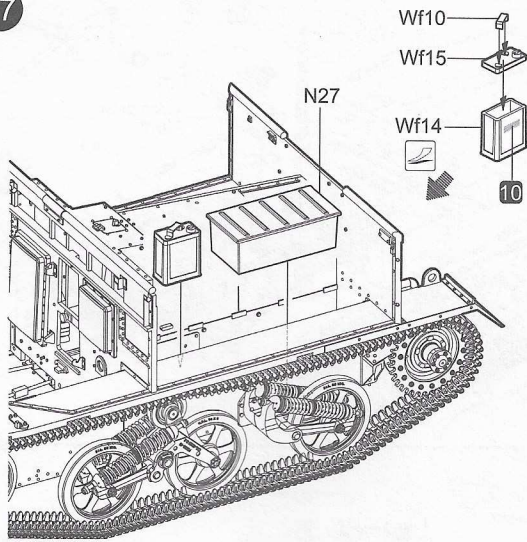

18

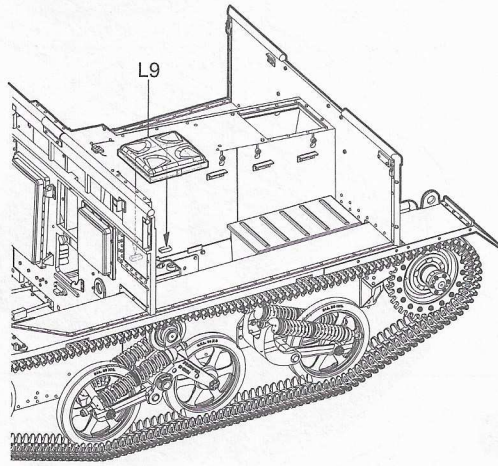

19

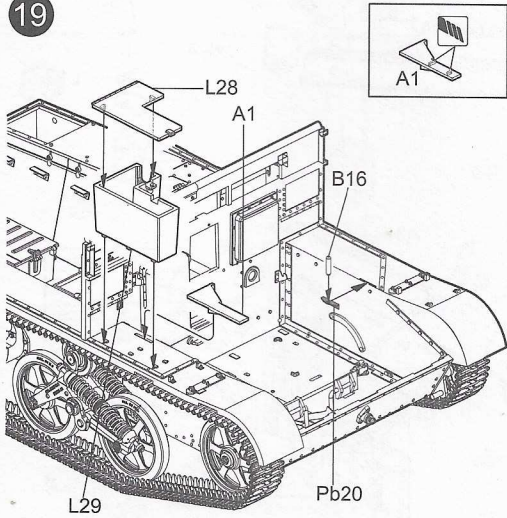

20

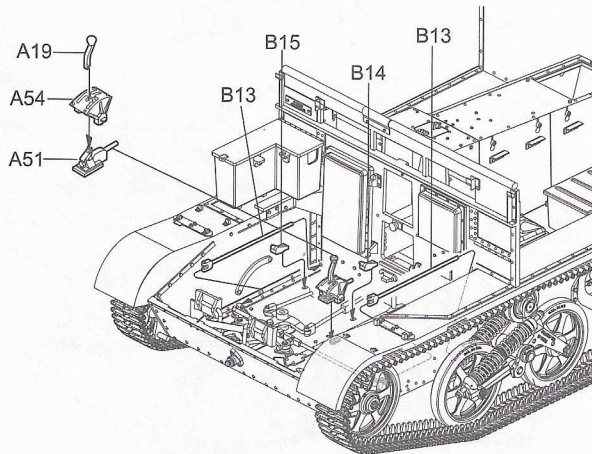

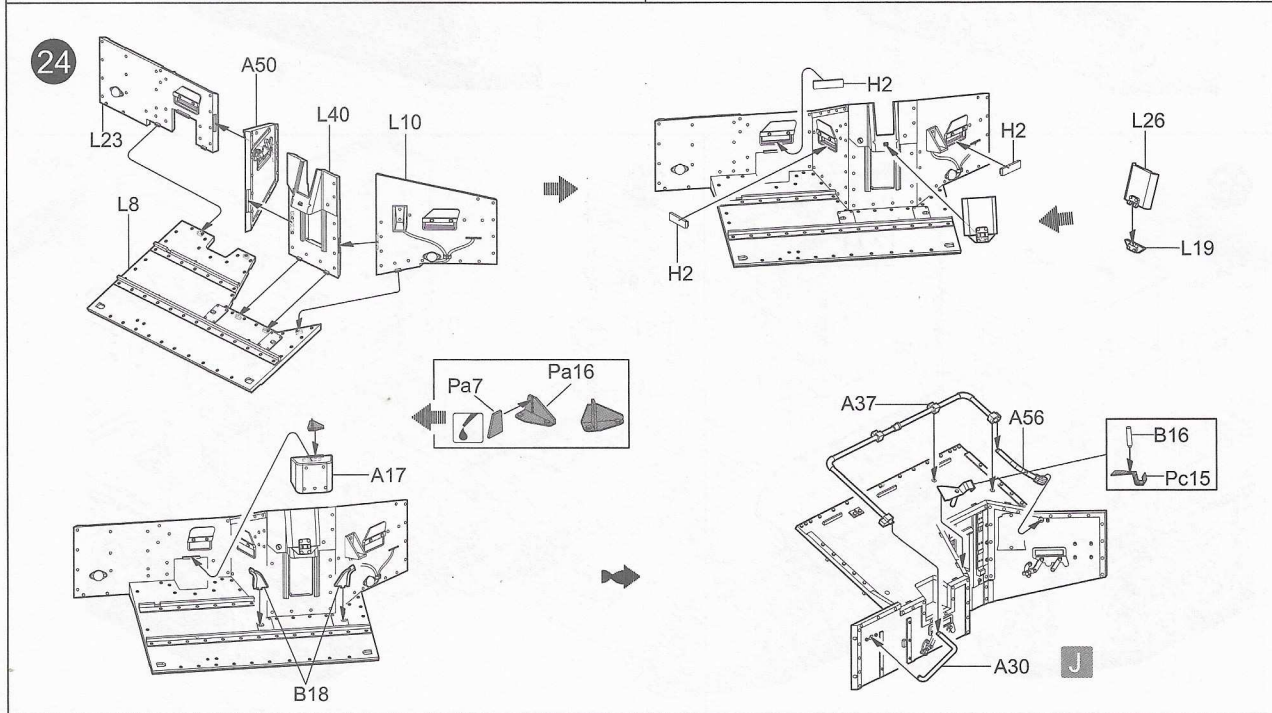
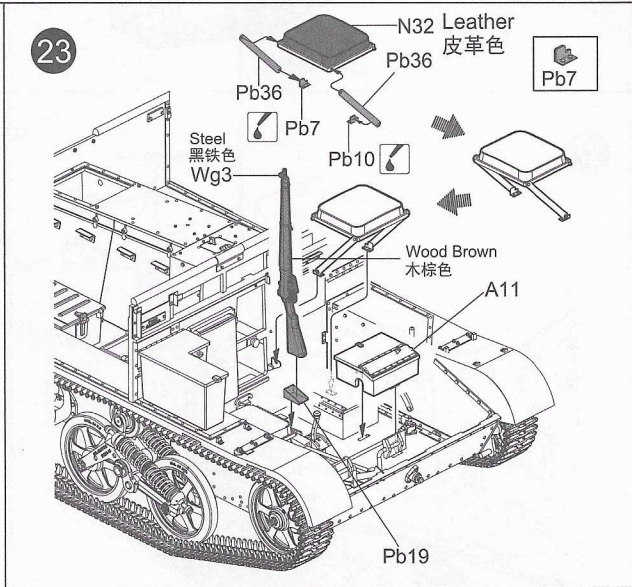
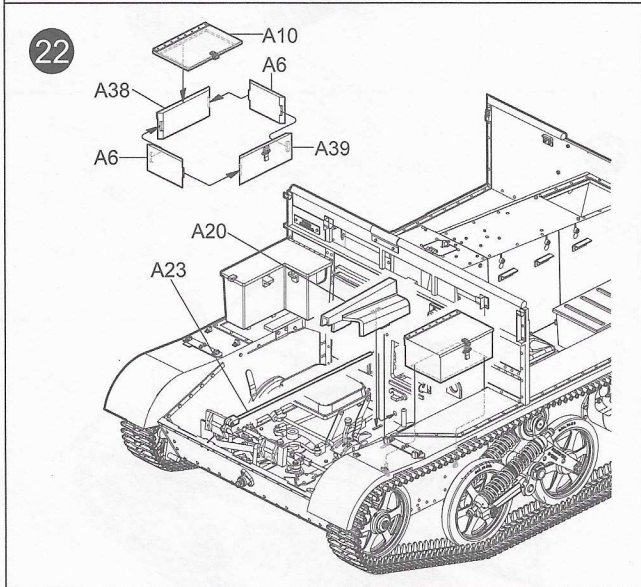
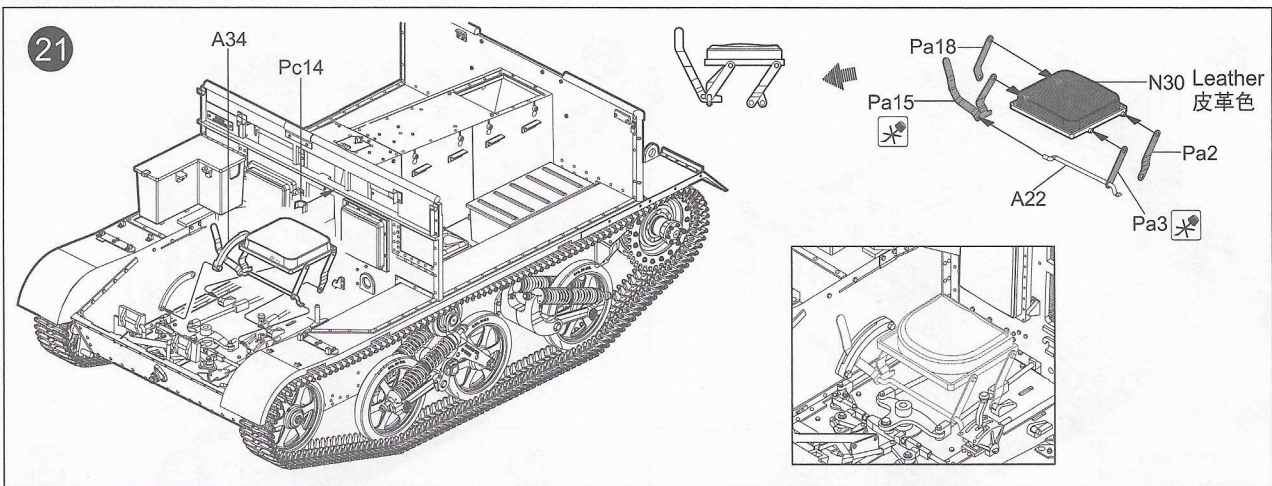

25

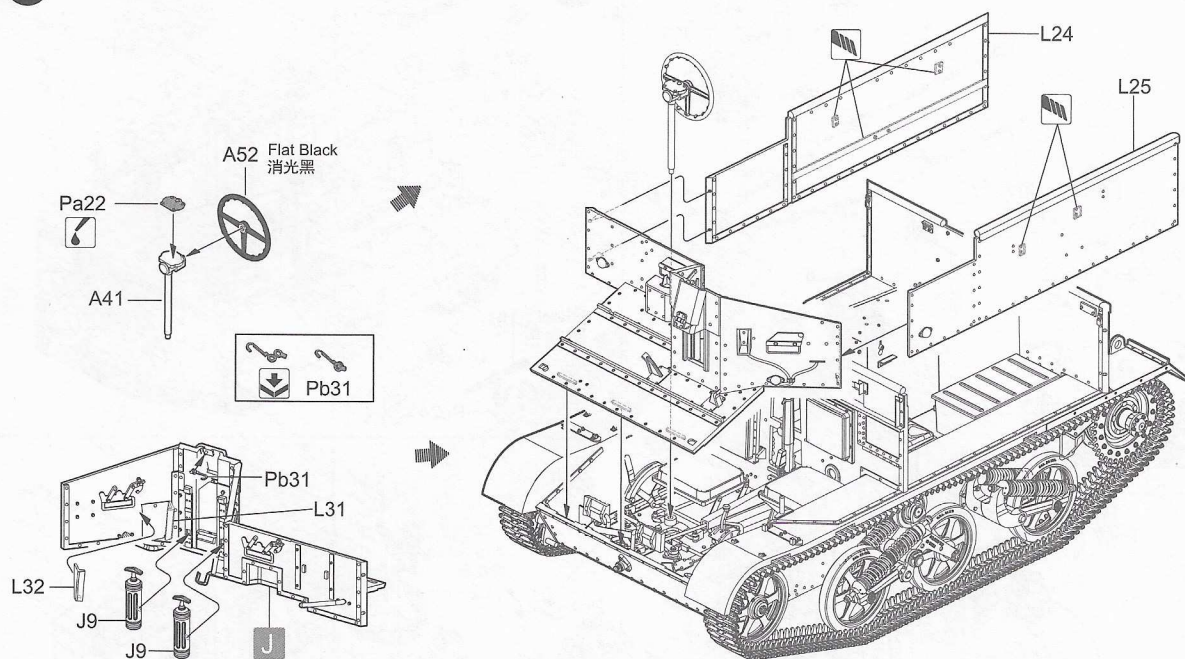

26

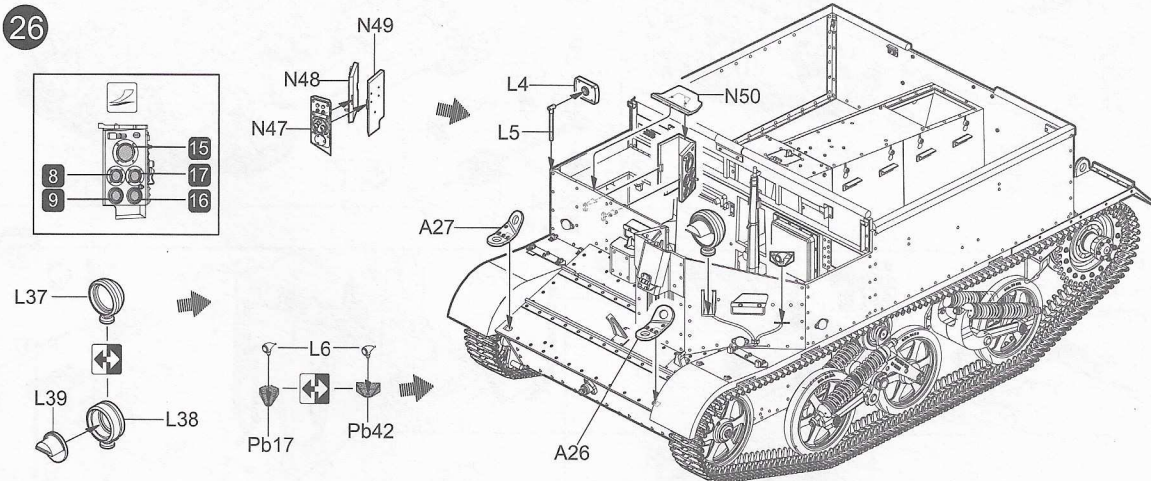

27

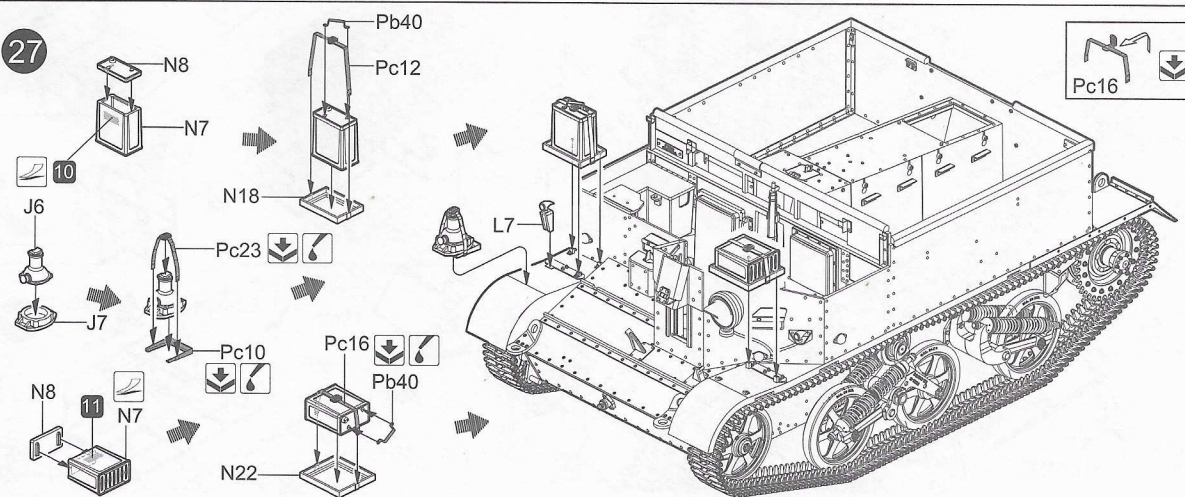

28

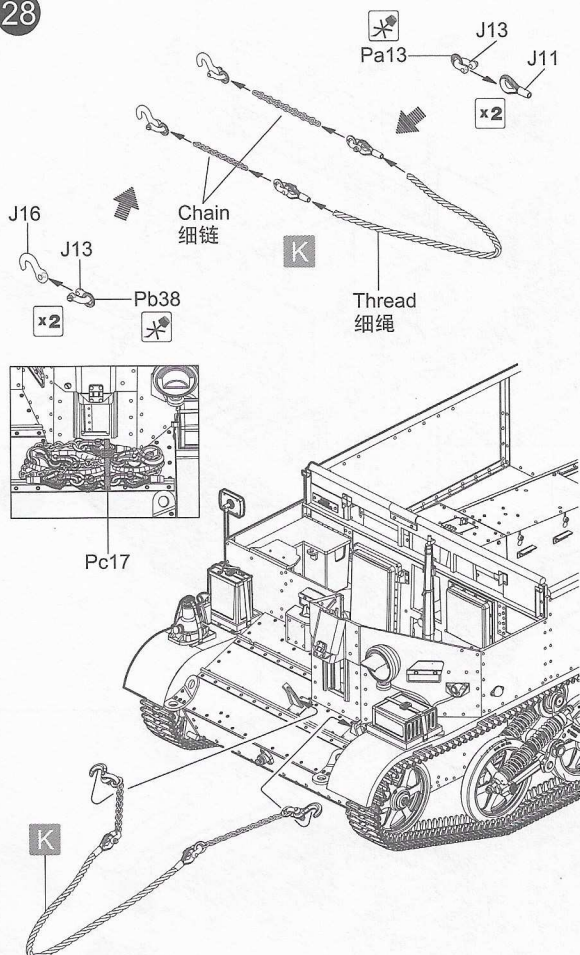

29

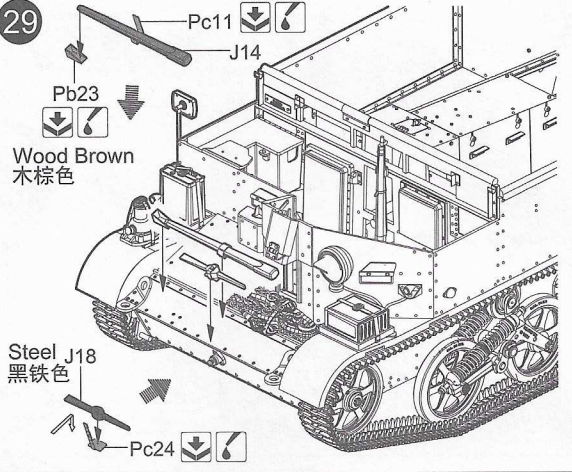

30

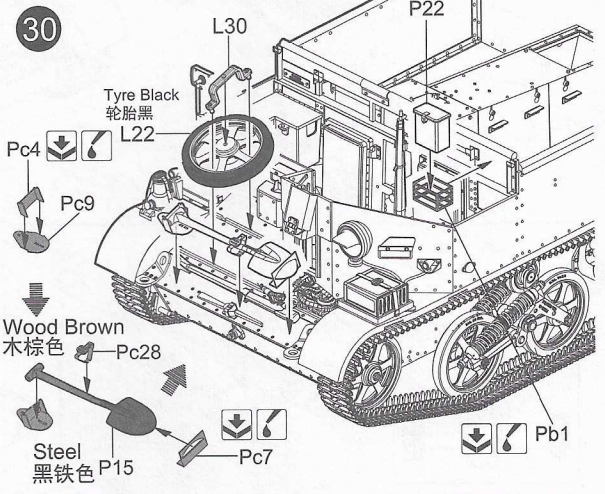

31

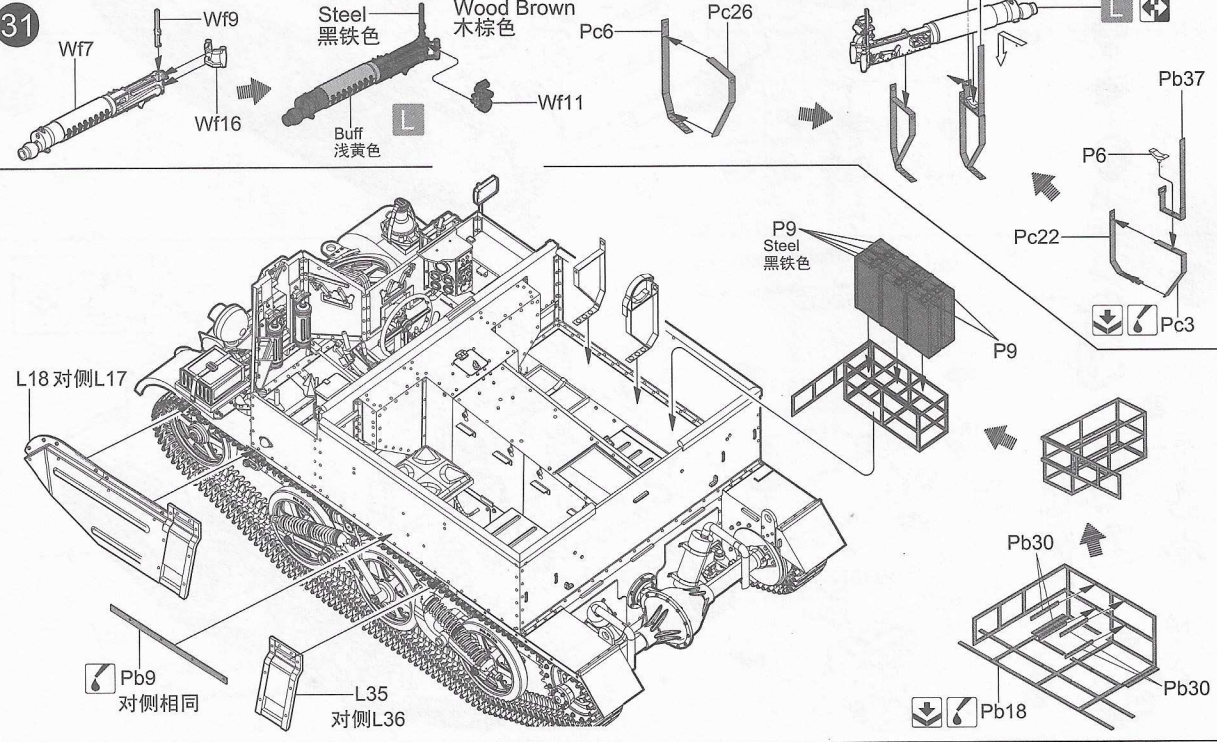

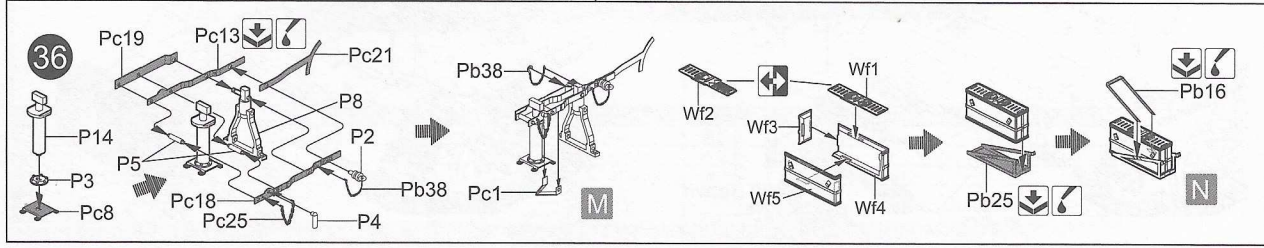
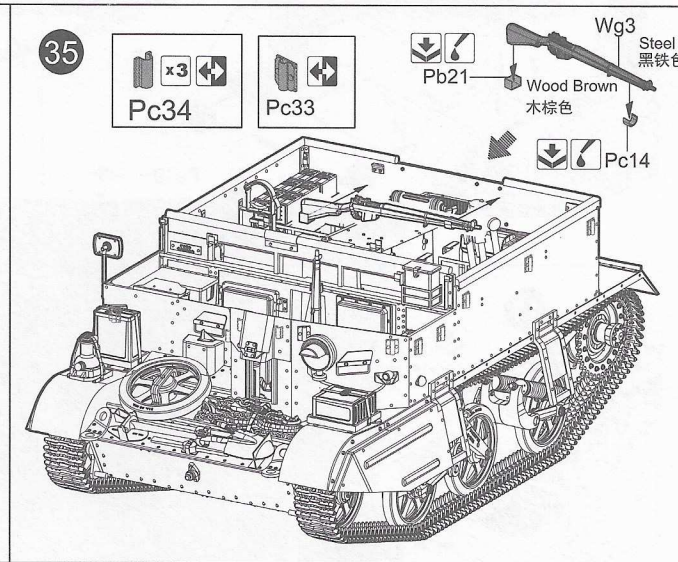
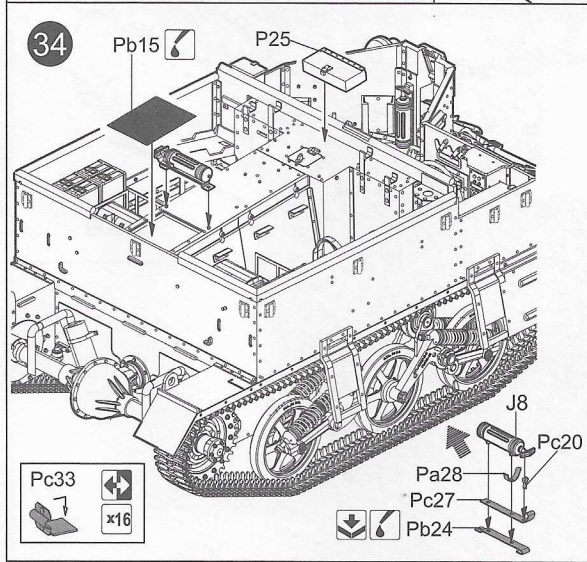
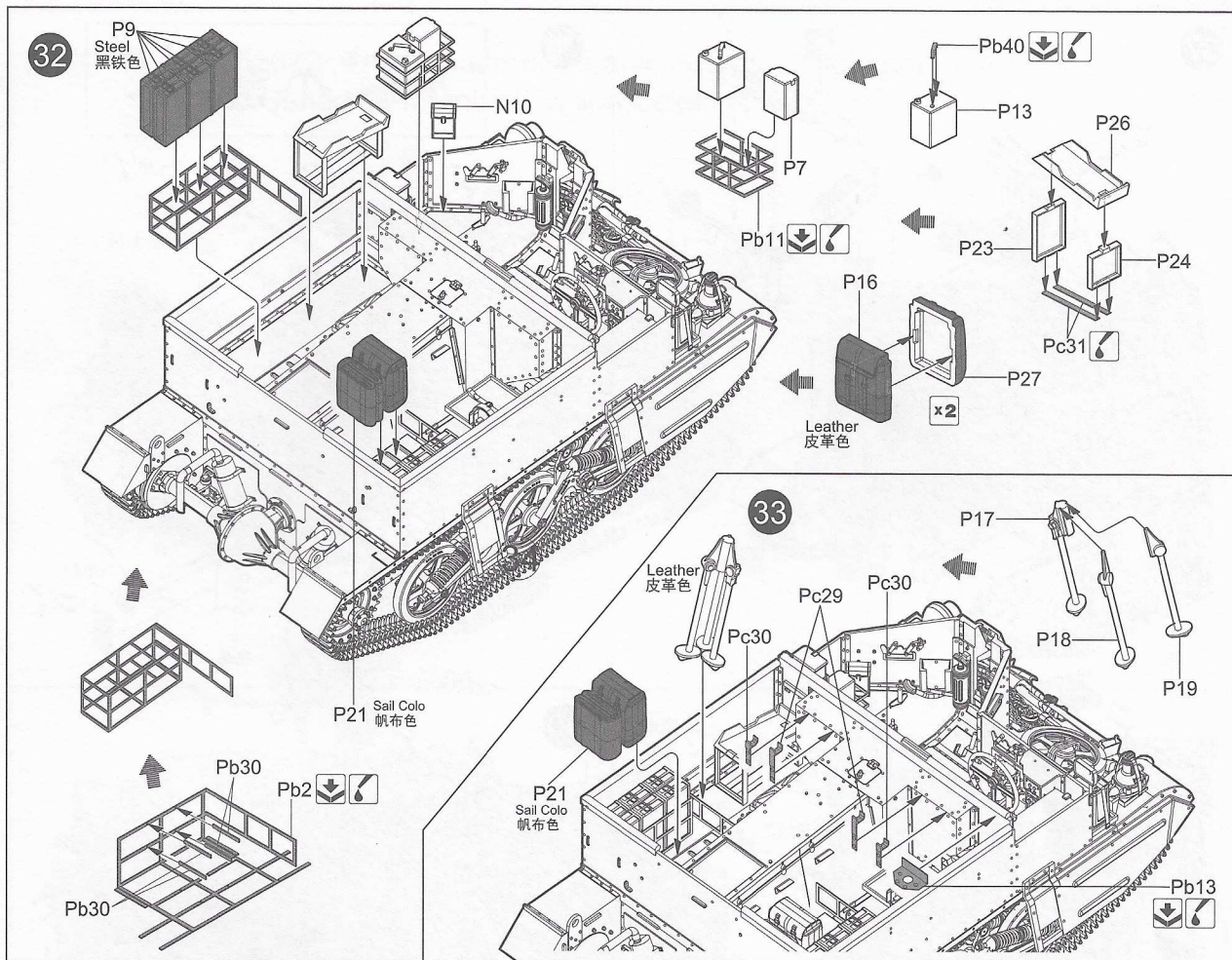

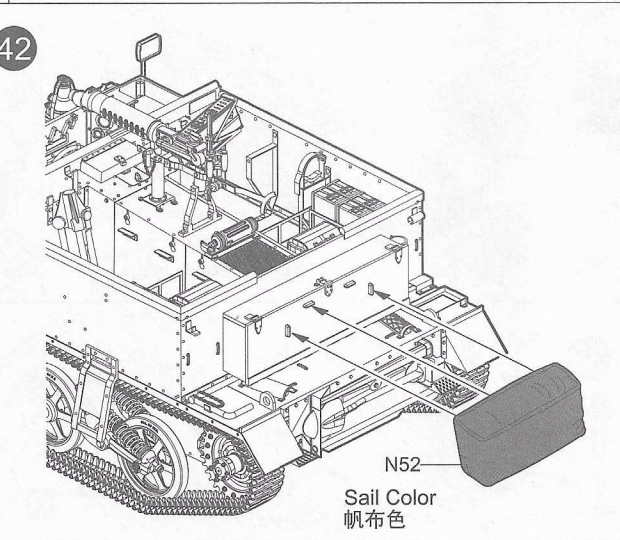
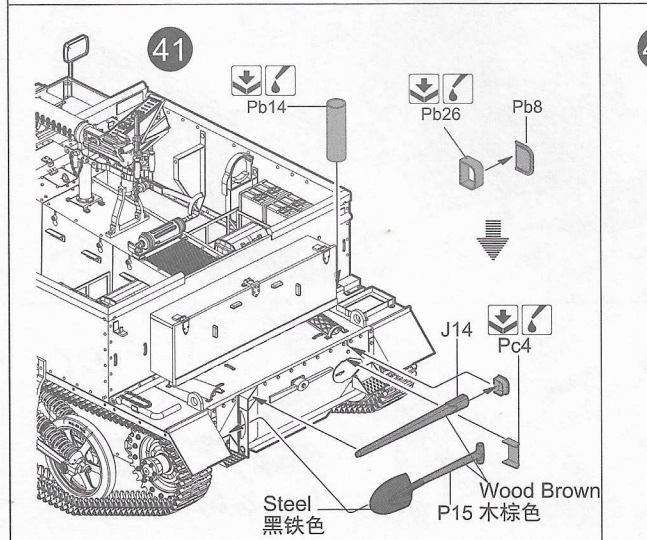
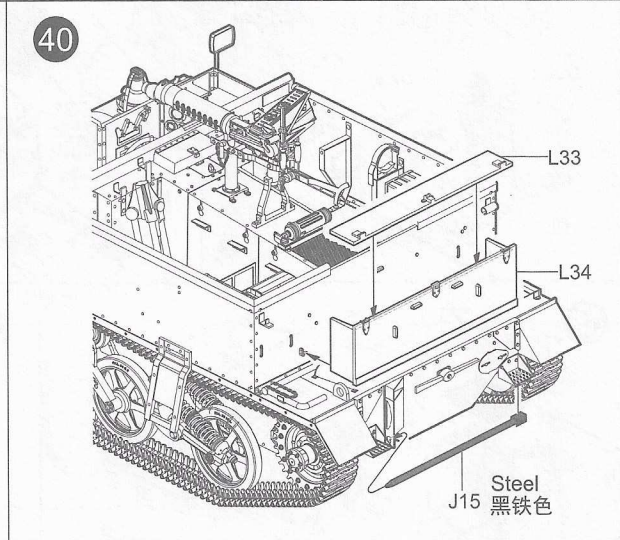
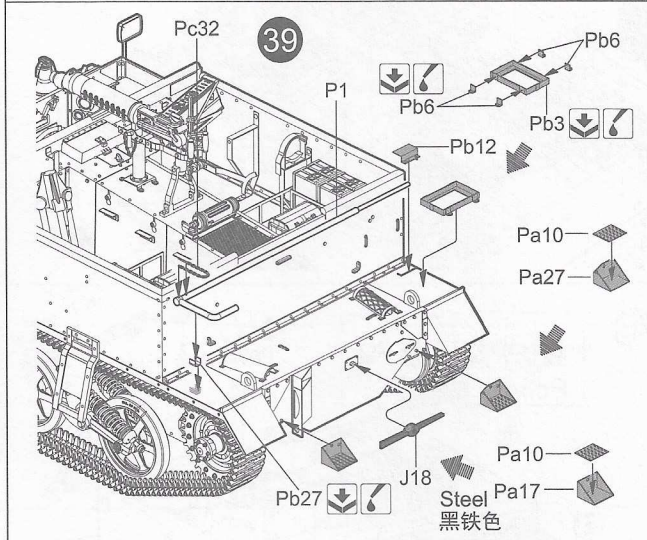
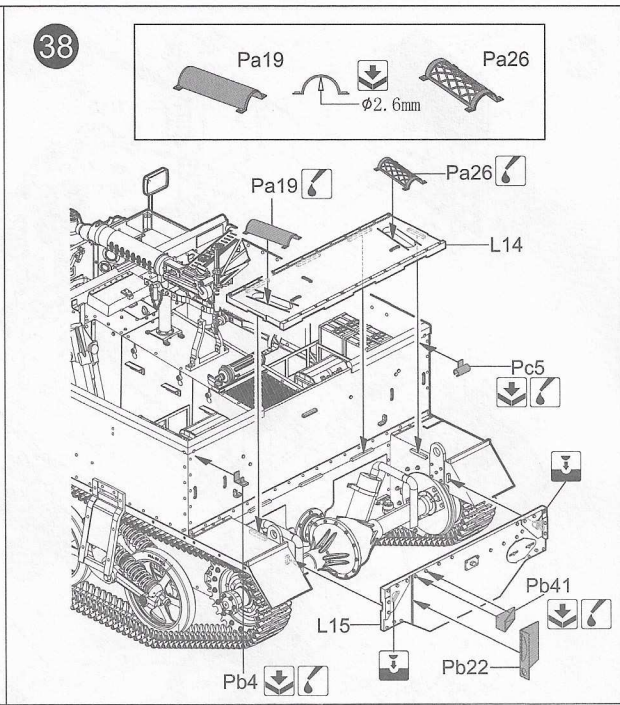
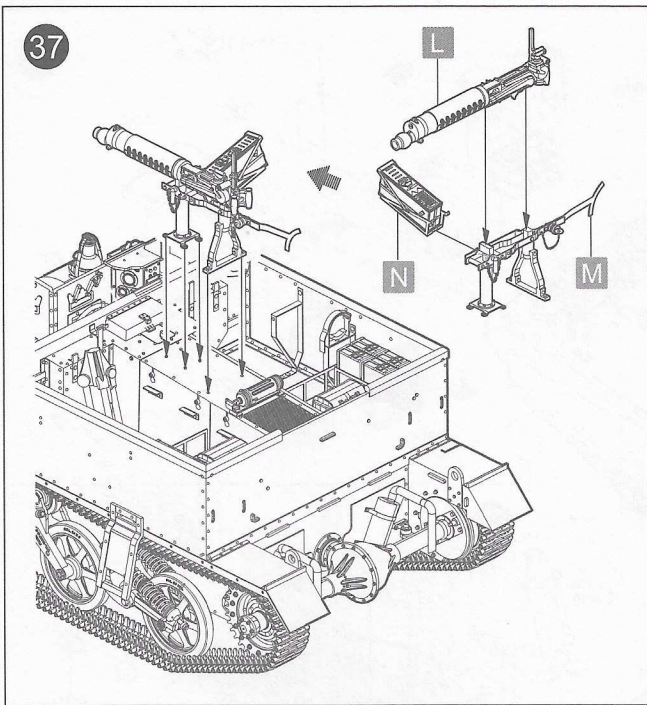

**Option 1:** T252672 , HQ Squadron, Toronto Scottish Regiment, 2nd Canadian Infantry Division, Belgium, 1944.

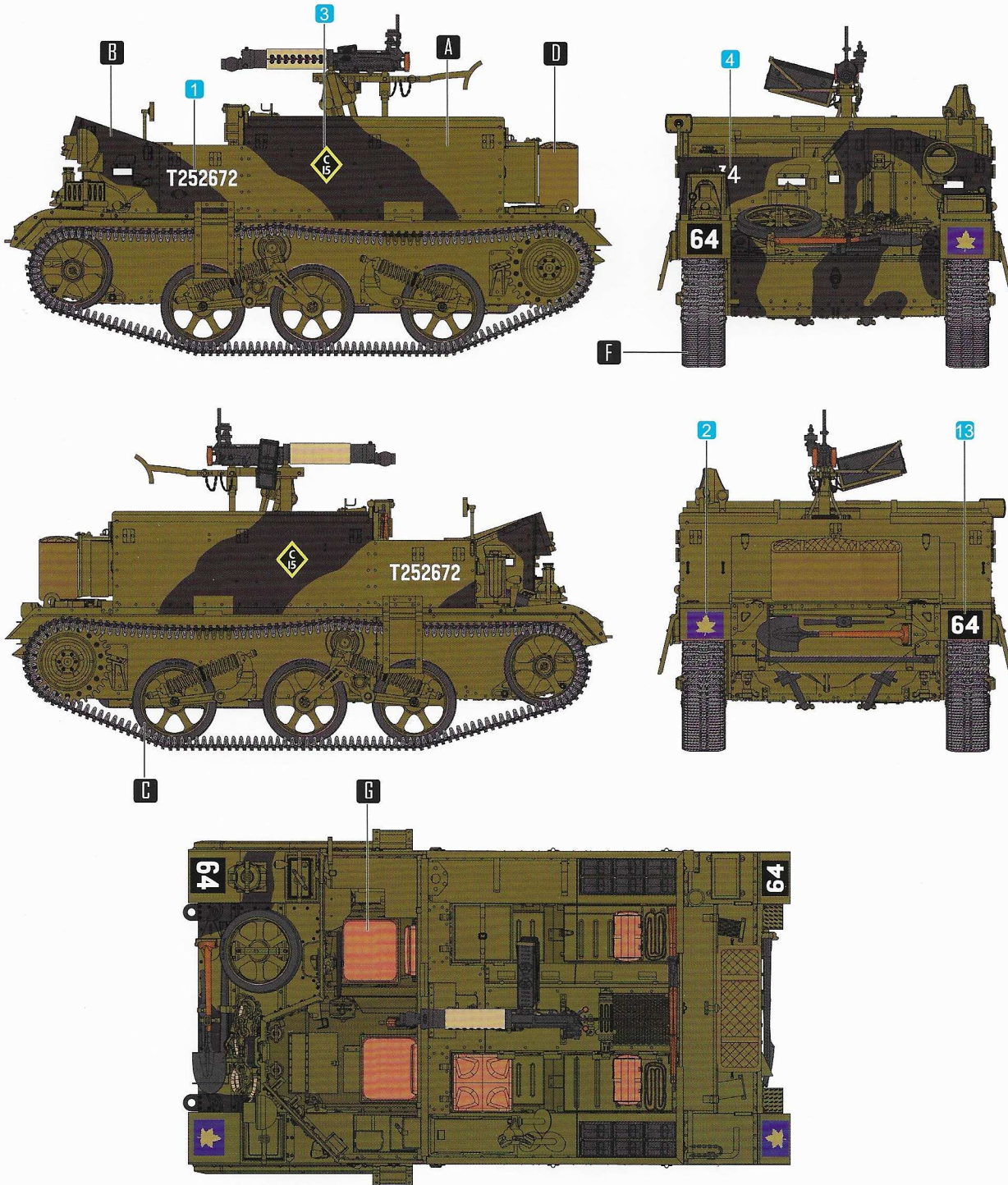

Colour	涂料表	Mr. Hobby	Model Master	Humbrol	Tamiya	Colour	涂料表	Mr. Hobby	Model Master	Humbrol	Tamiya
A	Khaki Green G3 卡其绿G3	H 52 112	2051	66(155)	/	F	Steel 黑铁色	H 810 810	1795	53	X-10
B	Blue Black 蓝黑色	H 83 32	/	/	XF-112+XF-63.1	G	Leather 皮革色	H 78 38	/	119	X-9
C	Tyre Black 轮胎黑	H 77 137	/	33	/	H	Flat Black 消光黑	H 21 33	1749	33	XF-1
D	Sail Colo 帆布色	H 85 45	/	/	/	J	Buff 浅黄色	H 27 44	/	94	XF-57
E	Wood Brown 木棕色	H 37 43	/	110	XF-2.2+XF-64.3	K	Rust 烧铁色	H 76 61	/	53	XF-7.1+XF-56.5

\*Some paints may not be available in your country. Please check your local hobby shop for substitute.

**Option 2:** T246505, A Squadron, 2nd Kensington Regiment,  
49th ( West Riding ) Infantry Div. N.W. Europe.

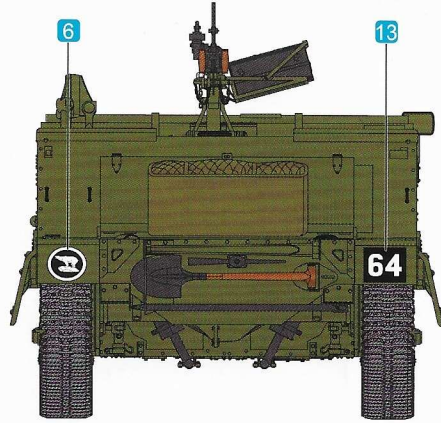
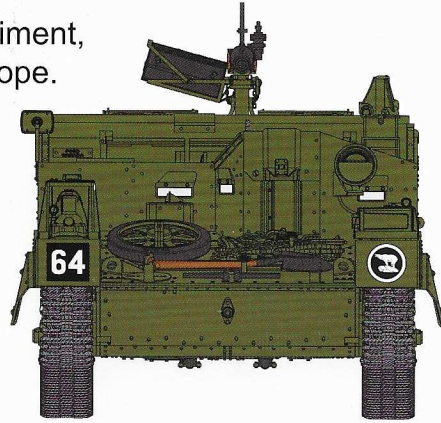
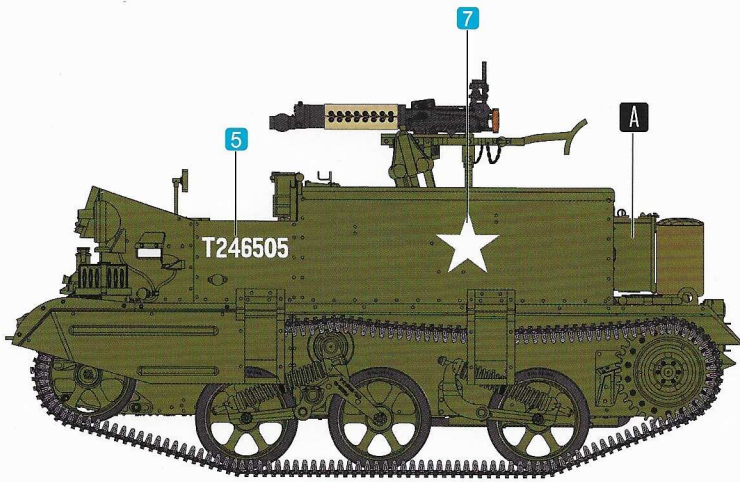

**Option 3:** T80982 ,8th Battalion, Middlesex Regiment,  
43rd ( Wessex ) Infantry Div. N.W. Europe.

