



Churchill Mk IV

Mk5 L/50 6 pounder gun
British Infantry Tank



****SPECIAL THANKS:** Mr. Ossie Orsourn-UK Vis
Tank museum brussels-Belgium

The British tank design concept established in 1930s resulting tanks in three very different aspects: light tanks for reconnaissance, cruiser tanks which were fast and mobile and infantry tanks to accompany infantry to help them break through heavily defended areas in the enemy lines.

Although the Matilda's performance was proven in the Battle of France in 1940, yet its small turret made a heavier gun impossible. Furthermore, its limited off-road speed was never considered satisfied.

Designed as the successor of Matilda, a new tank infantry prototype was introduced in November 1940, and the first batch of mass production tanks saw service in June the following year. This series of tanks was named after Winston Churchill, who was appointed First Lord of the Admiralty at that time, due to his contribution to the development of the tank as a weapon.

As an infantry tank, the Churchill features with heavy armours and reliable suspension systems, equipped with 11 bogies each side, dispersing ground pressure. Initial Mk.I equipped with a 2 pounder gun in the cast turret, also a 3 inch howitzer in the hull. Nevertheless, the 3 inch howitzer was limited by a poor fire arc, therefore was replaced with a 7.92 mm machine gun on Mk.II. The Mk. III was introduced in February 1942, came with a larger welded turret and a upgraded 6 pounder gun. By April, new Mk.III's came with new pattern tracks covered on the top run and new air intakes which improving its fording capability.

Returning to a less costly cast turret (comparing to the welded turret used in Mk III), the Churchill Mk IV also owned superior defensibility. In earlier version a shorter L/43 barrel 6 pounder Mk. III gun was adopted, and in later version it was replaced with a longer L/50 Mk. V. The Churchill Mk IV saw under Commonwealth services in Western Europe theaters after D-Day. The Soviet Union received 301 Churchill Mk III's and Mk IV's under Lend-Lease programme.

To add extra protection, some Churchill tanks in the Western Europe used tracks to be soldered onto the turret and body as one of the field conversions. Such modification normally adopted on the first tank on column.

イギリス陸軍の戦車設計の方針は1930年代に、まったく異なる用途の3種類の戦車によって確立された。すなわち、偵察用の軽戦車、機動性と速度を重視した巡航戦車、そして歩兵に同行し、彼らの敵陣突破を助ける歩兵戦車の3種であった。

1940年のフランス戦において、マチルダ歩兵戦車の問題点が浮き彫りになった。小さな砲塔は大口徑の火砲の搭載ができず、さらに路外速度の低さは到底納得できるものではなかったのである。

マチルダ戦車の後継となる新型歩兵戦車の試作型は、1940年11月に完成し、最初の量産型は、翌年の6月に配備がはじまった。この新型歩兵戦車シリーズは、海軍大臣時代に戦車を兵器として開発することに貢献したウィンストン・チャーチルにちなんで、チャーチル歩兵戦車と名づけられた。

歩兵戦車としてのチャーチル戦車の特徴は、重装甲と信頼性の高いサスペンション(両側面の11個のボギーで接地圧を分散させる)であった。最初の生産型のMk. Iは鑄造砲塔に2ポンド砲を搭載し、車体には3インチ榴弾砲を装備していた。しかし、3インチ榴弾砲は威力に乏しかったため、次のMk. IIでは、7.92mm機銃に取って代わられた。Mk. IIIは、1942年2月に登場、溶接タイプの大口径砲塔に性能の向上した6ポンド砲を装備していた。さらに4月までに、新パターンのキャタピラを履き、足回りの接地面以外を重装甲で覆い、新しい空気取り入れ口を採用することで、渡渉能力を向上させた新型Mk. IIIが導入された。

チャーチルMk. IVは、製造コストの安い鑄造型砲塔に戻ったことで、溶接型砲塔を搭載していたMk. IIIに比べ、より優れた防御力を持つこととなった。初期のバージョンでは短い43口径砲身の6ポンド砲Mk. IIIを搭載していたが、後期バージョンでは長い50口径砲身の6ポンド砲Mk. Vに置き換えられた。チャーチルMk. IVは、ノルマンディ上陸作戦以降の西ヨーロッパ戦線で、英連邦軍によって使用された。また、301輛のチャーチルMk. III及びMk. IVがレンドリース法に基づいて、ソビエト連邦に供給されたのだった。

西ヨーロッパ戦域では、防御力強化のためにチャーチル戦車の砲塔や車体に連結したキャタピラを追加装甲代わりに現地加工で取り付けられたものがあった。このような改装は通常、攻撃を受けやすい、縦隊の先頭車に施されることが多かった。

在1930年代,英國的戰車運用理論中確立了戰車的三種截然不同角色,包括了執行偵查任務的輕戰車、能夠快速突破擴大戰果的巡航戰車,與伴隨步兵能提供步兵火力支援,並清除障礙與工事的步兵戰車。

經過了1940年的法國戰役後,儘管參與戰役的Matilda步兵戰車面對德國戰車有著傑出的表現,但過小的砲塔環限制了將來提升火炮口徑可能,另外它過於緩慢的越野性能也未能讓人滿意。因此英國政府委託設計一種新的步兵戰車用來取代Matilda步兵戰車。1940年的11月新型步兵戰車的試作車完成,1941年6月第一批量產車進入陸軍服役,由於當時的英國首相邱吉爾在擔任海軍大臣期間對戰車這種新武器開發的大力支持,為表章他的貢獻,因此新的步兵戰車遂命以邱吉爾之名。邱吉爾步兵戰車延續著步兵戰車既有的特點,有著厚重的裝甲與可靠的懸吊系統,車身兩側每側均有11組承載輪以分散接地壓,最初的量產車Mk.I型採用鑄造砲塔,砲塔上安裝一門2磅主砲,車身前方同時也配置一門3吋口徑的榴彈砲,由於3吋砲的射界受車體的限制使得使用效率不佳,在隨後的Mk.II型當中便被7.92mm的機槍所取代。1942年2月更換大型焊接砲塔的Mk.III型出現,主要武裝也提升至6磅砲,及至4月,新生產的Mk.III型車體將接地以外的大部履帶包覆在裝甲之下,並藉由引擎進氣系統的改良,也提升了車體的涉水能力。

Mk.IV型與Mk.III型主要差異在於再次恢復採用鑄造砲塔來取代焊接砲塔,新砲塔擁有更佳的防護能力與較低的生產成本。砲塔上所搭載的6磅砲由初期43倍徑短砲身的Mk.3型,到後期更換成50倍徑長砲身的Mk.5型。Mk.IV型參與了諾曼地登陸之後的歐洲戰役,並按租借法案提供東線的蘇聯軍隊使用。

在西歐戰場上的邱吉爾戰車,部份在車體與砲塔上焊接了履帶,作為額外的裝甲使用,這種在戰場上加工的戰車多半安排在部隊行軍序列中的為首車輛,用來承受隨時可能出現的德軍砲火攻擊。

Illustration:圖示說明



Method For Applying Decals:

1. Clean Model Surface With Wet Cloth.
2. Cut Out Of Decal Sheet And Dip Them In Water For 15 Seconds.
3. Place it on proper position on model.
4. Slide off base paper leaving decals On Model With Wet Finger Tip.
5. Move Decals To Exact Position, Push Out Excess Water Under Decal With Soft Cotton Cloth.
6. When Decals Get Dry Then Complete.

水貼紙使用說明:

1. 將模型表面擦乾淨
2. 將貼紙剪下泡入清水中約15秒
3. 將泡濕之貼紙取出置於欲貼處旁
4. 用指尖輕推貼紙表面使其滑出底紙
5. 將貼紙調整至適當位置並輕擦拭水份
6. 待其自然乾燥後即完成

Color list: 塗料表

Color	Brand	Gunze Sangyo			Humbrol	Revell	Lifecolor
		Hobby Color	Mr.Color	Mr.Color Spray			
Khaki green	卡其綠	H80	C54				
Steel	黑鐵	H18	C28	J28	53	91	LC76
Tire black	輪胎黑	H77	C33+C62		85	302	LC02
Red	紅	H3	C3	J3	19	31	LC56
Flat white	消光白	H11	C62	J62	34	05	LC01
Wood brown	木棕	H37	C43		169		FS12
Red brown	紅褐	H47	C41		160	383	UA085
Brass	黃銅	H9	C9	J9	54	92	LC75
Olive drab(2)	橄欖綠	H78	C38	J38	66	46	UA106

Churchill Infantry Tank

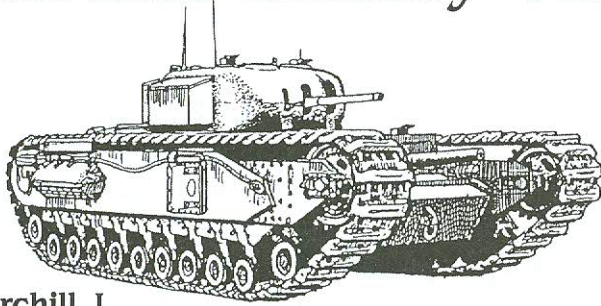

Churchill I
 2-pdr gun x 1
 3 inch howitzer x 1

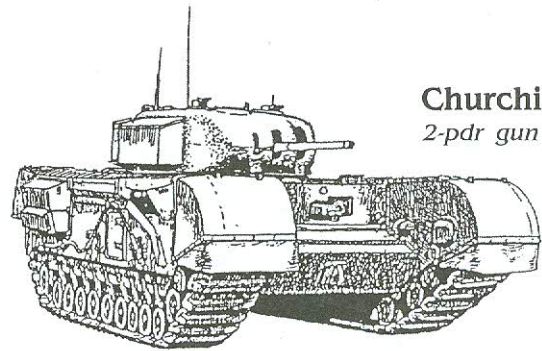

Churchill II
 2-pdr gun x 1

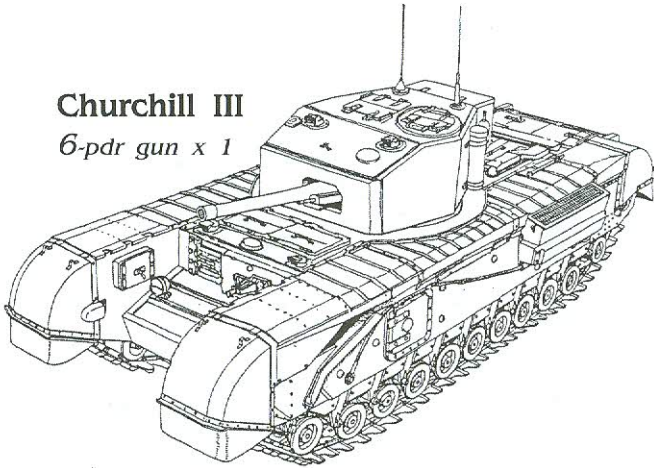

Churchill III
 6-pdr gun x 1

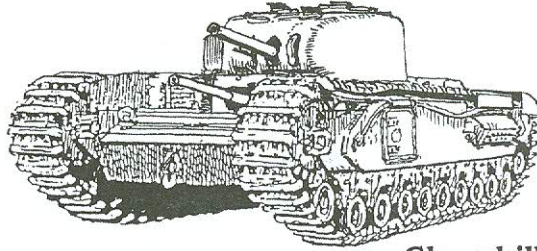

Churchill II CS
 3 inch howitzer x 1
 2-pdr gun x 1

**3 inch howitzer in turret, 2-pdr in hull. Few built.

Churchill IV
 6-pdr gun x 1

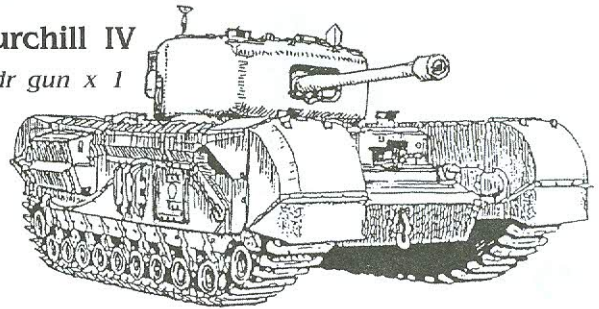

Box Section Spudded

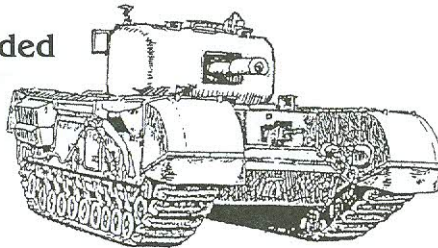
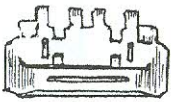

Churchill V
 95mm howitzer x 1



Webbed & Studded

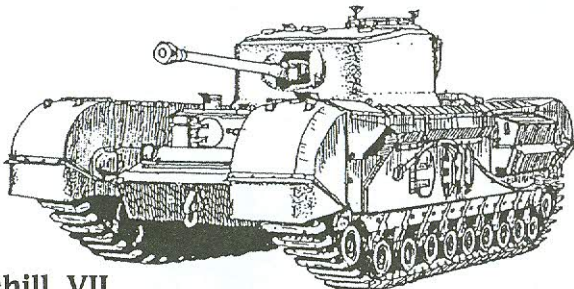

Churchill VII
 75mm gun x 1

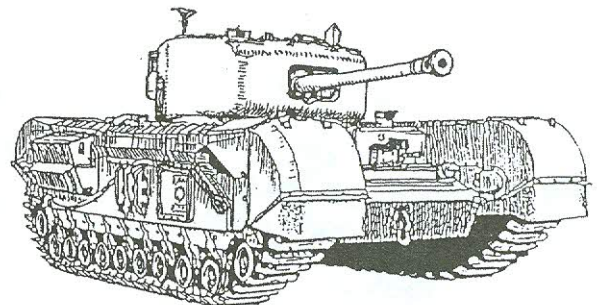

Churchill VI
 75mm gun x 1

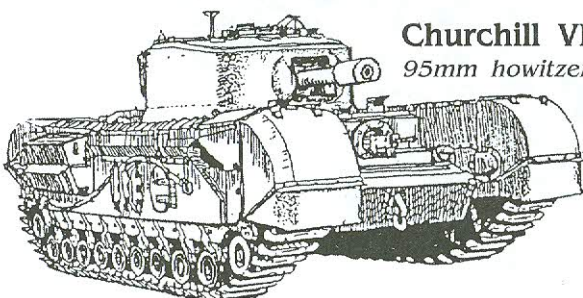

Churchill VIII
 95mm howitzer x 1

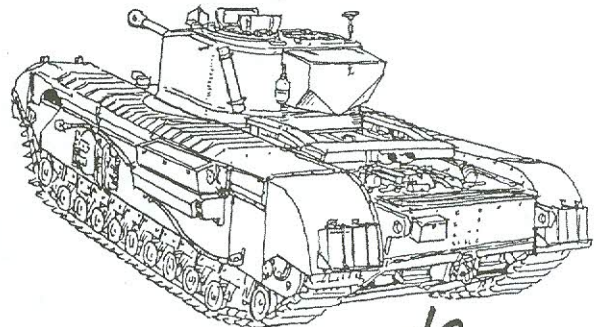

Shin.ueda

上田 信

1

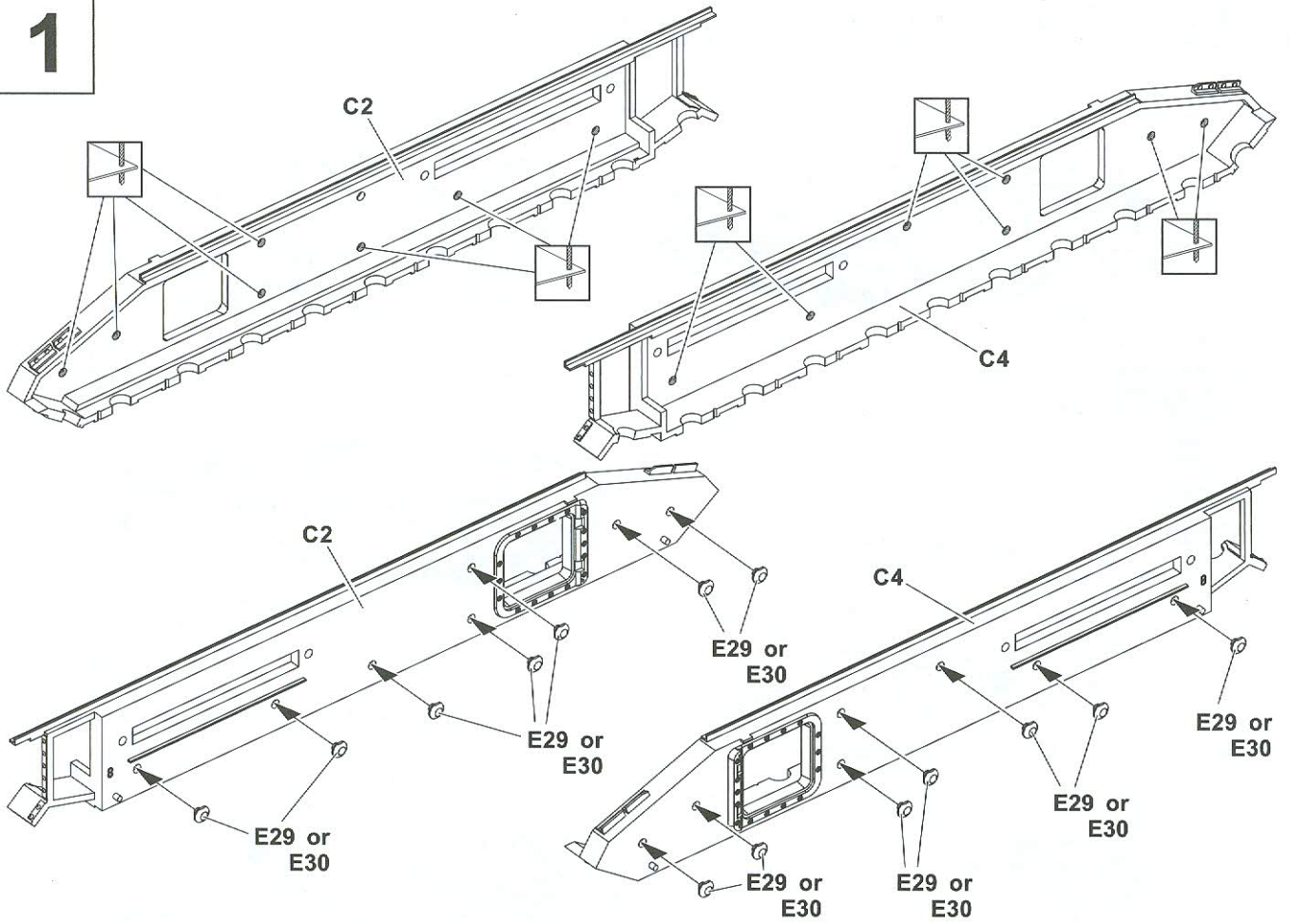

2

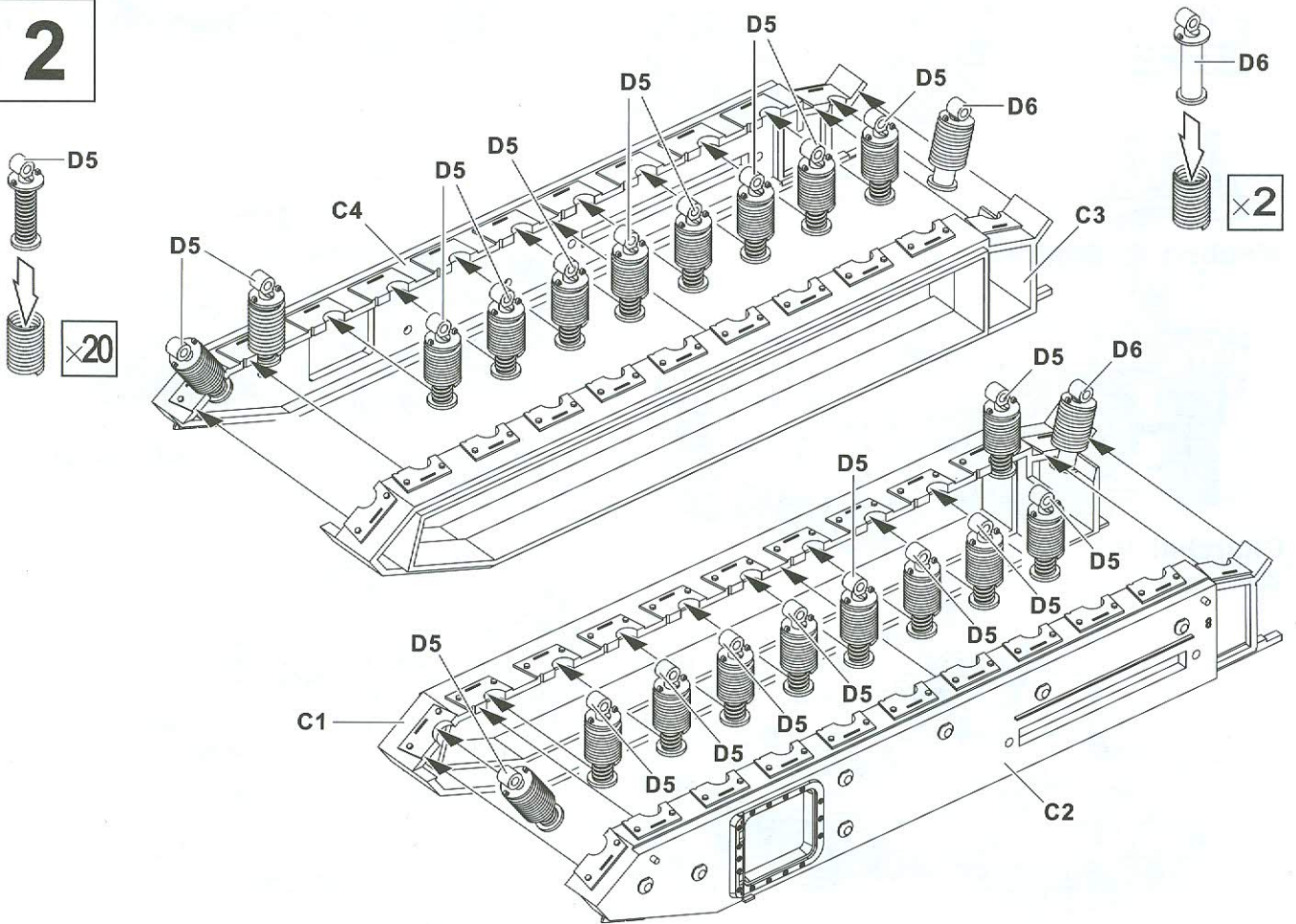

3

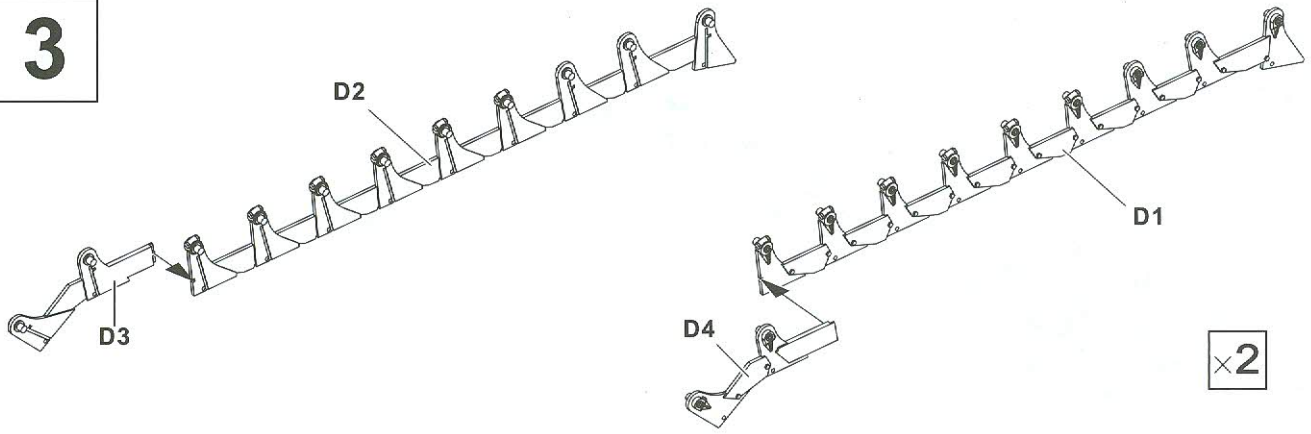

4

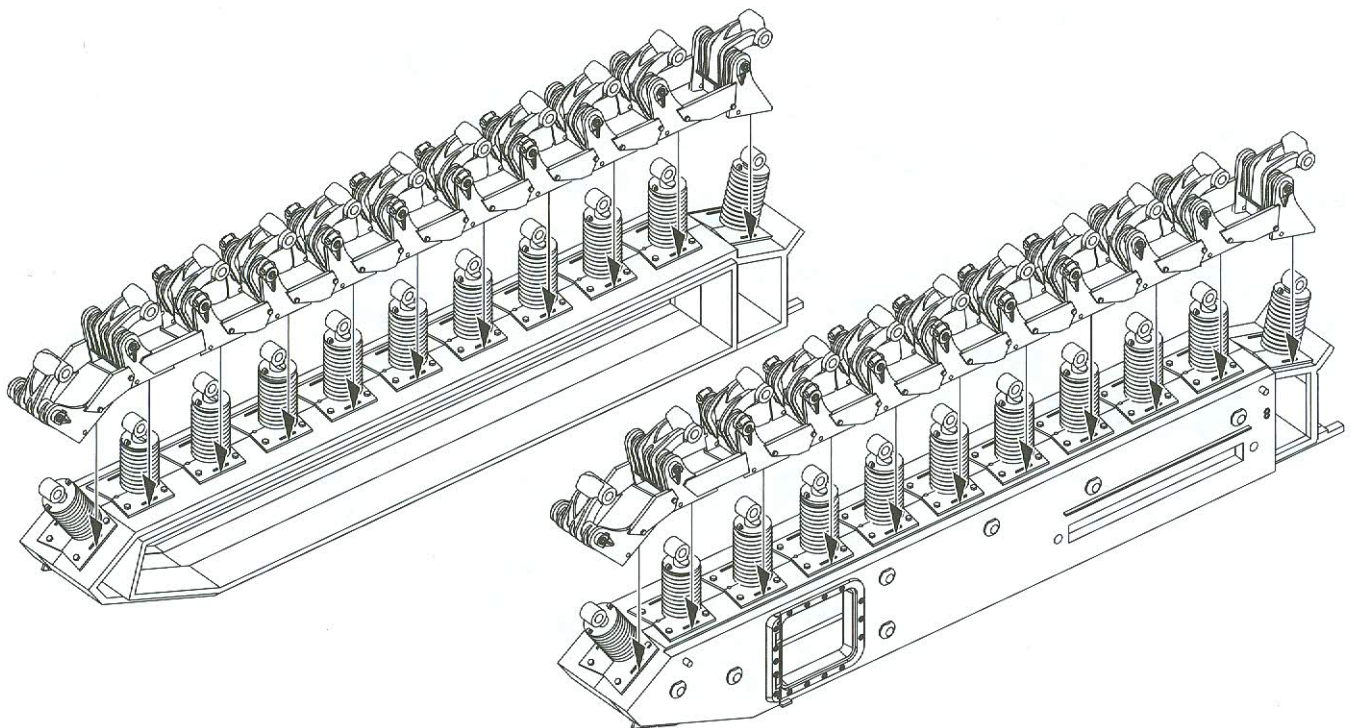
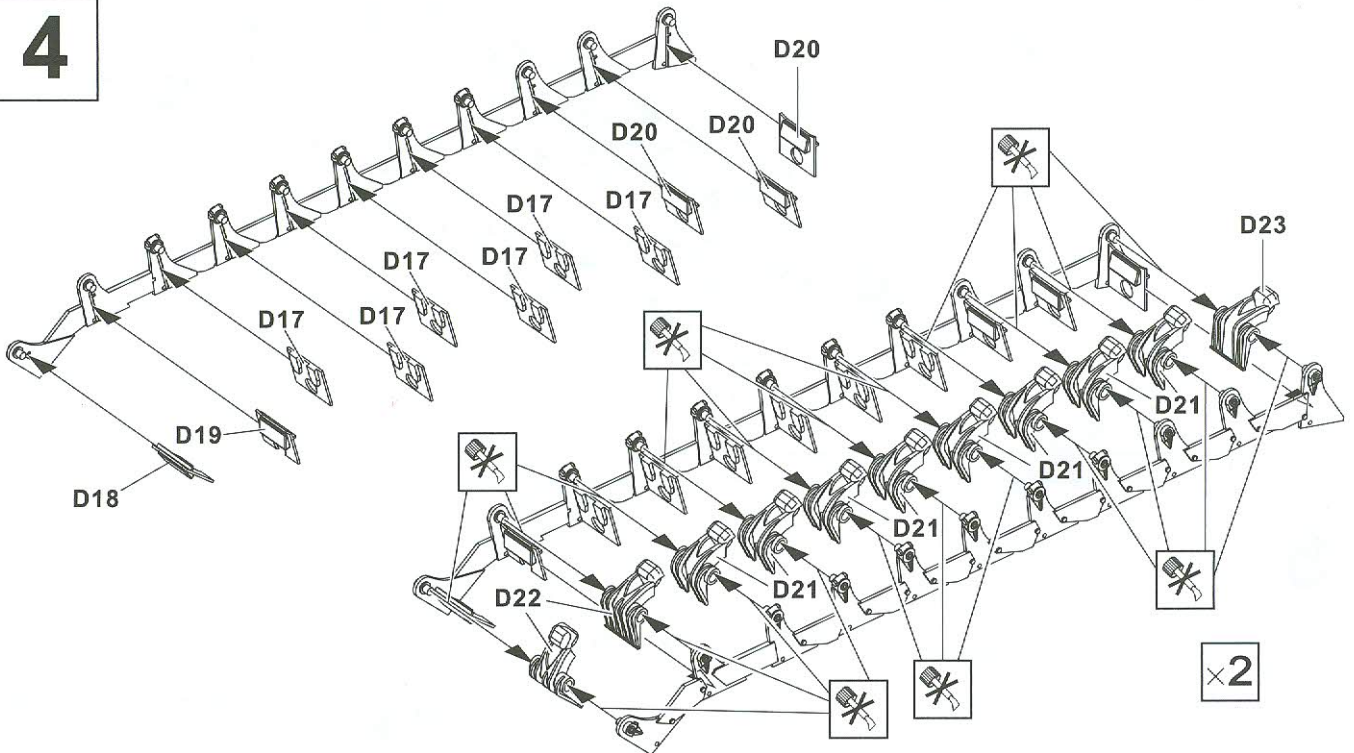

5

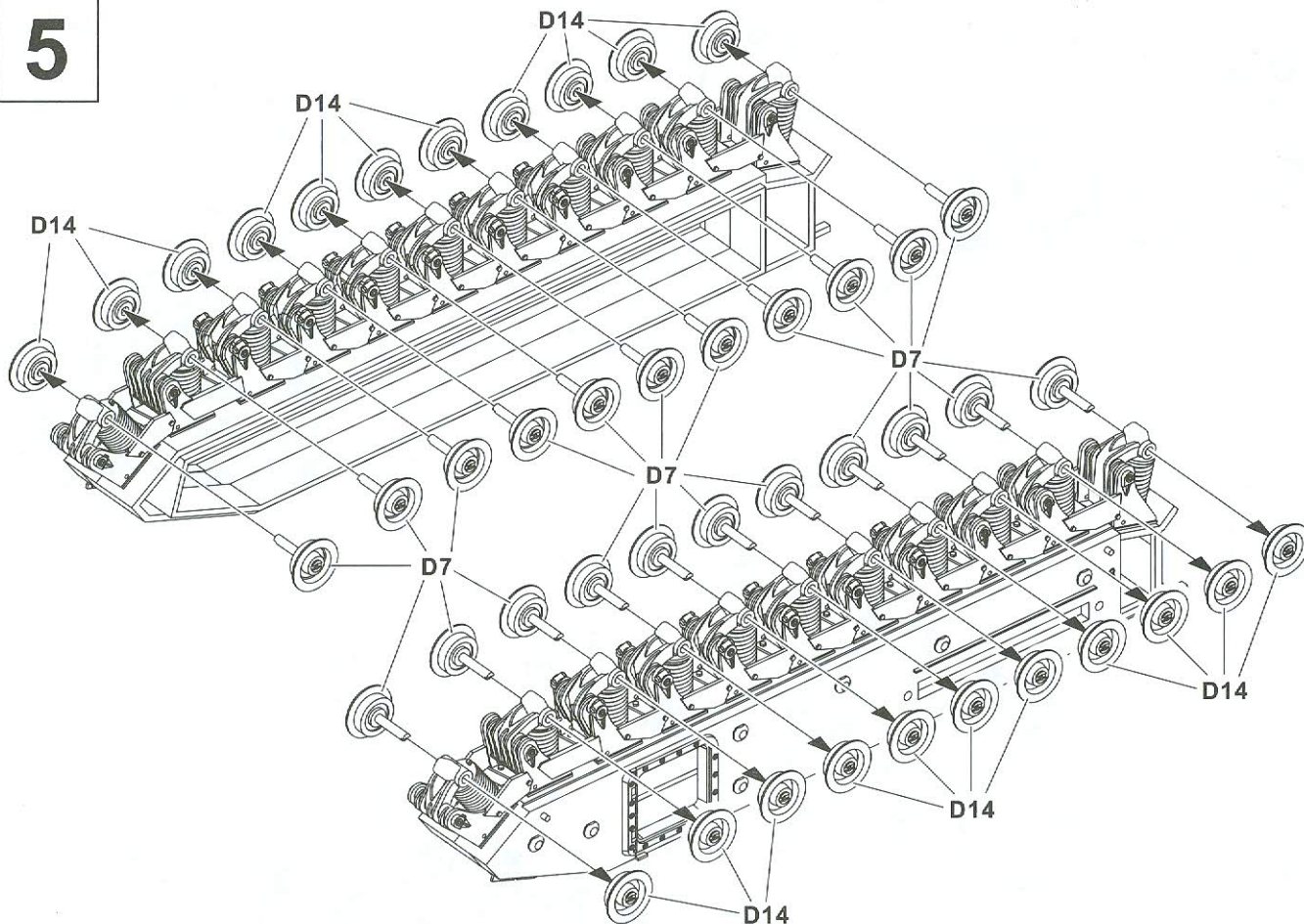

6

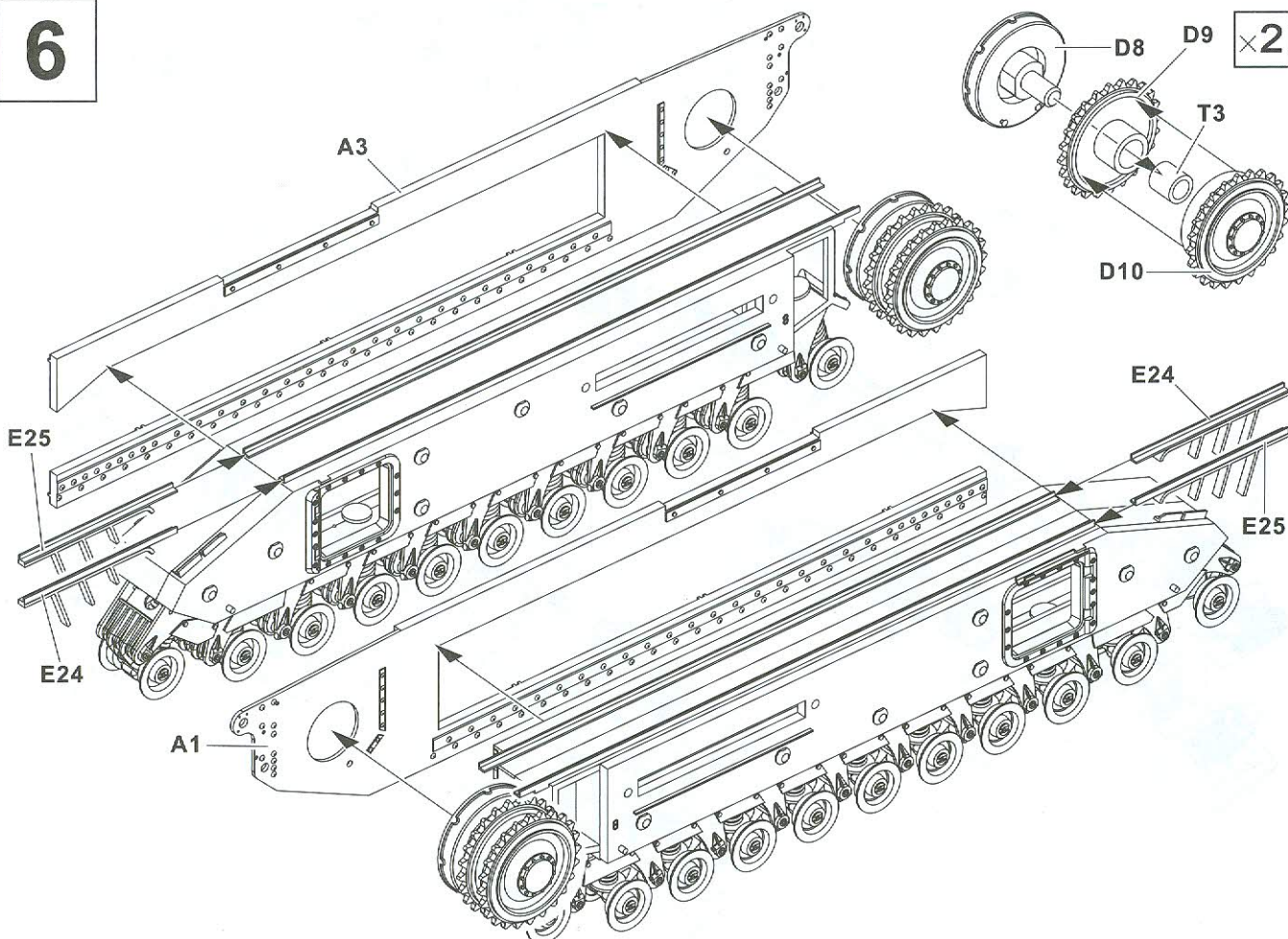

7

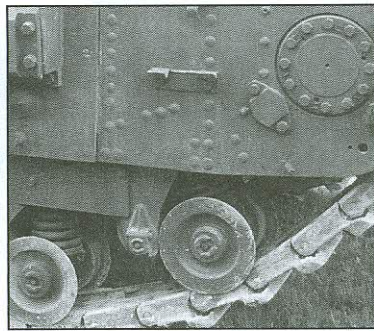
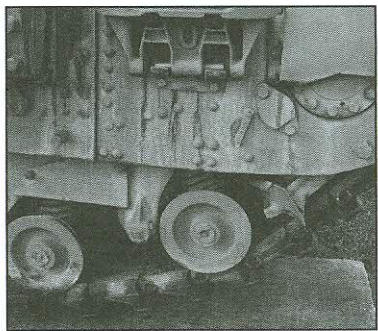
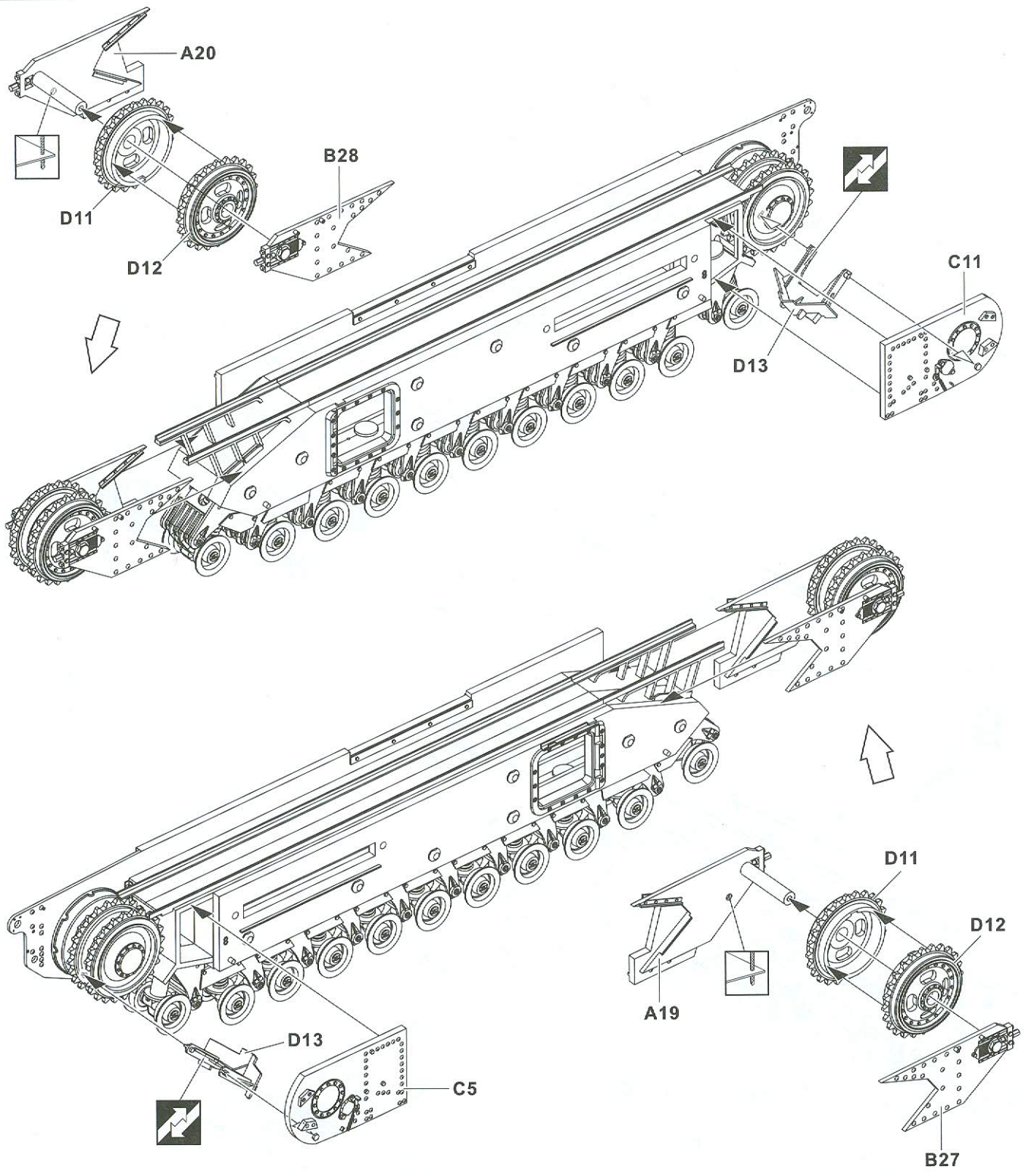

8

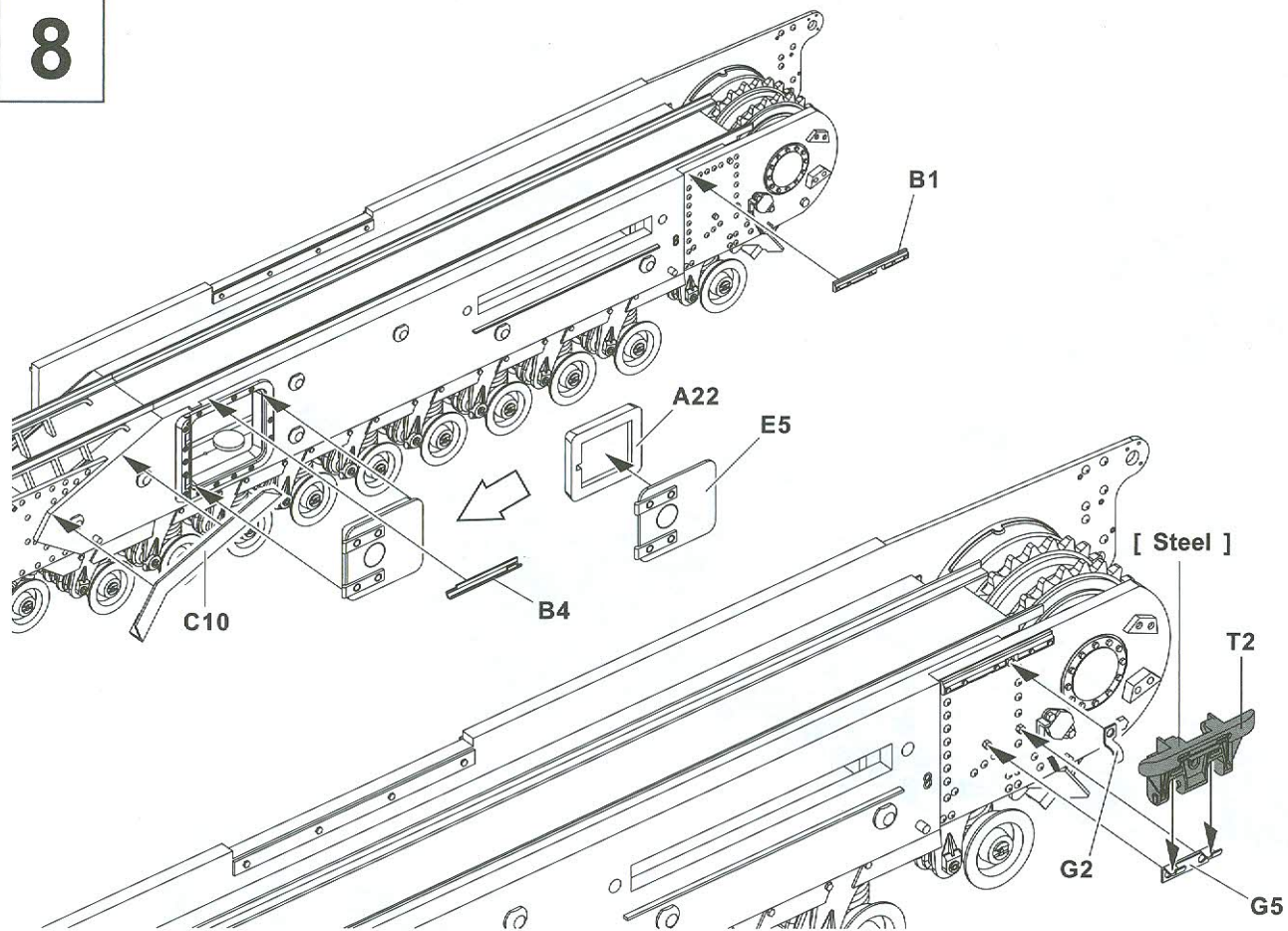

9

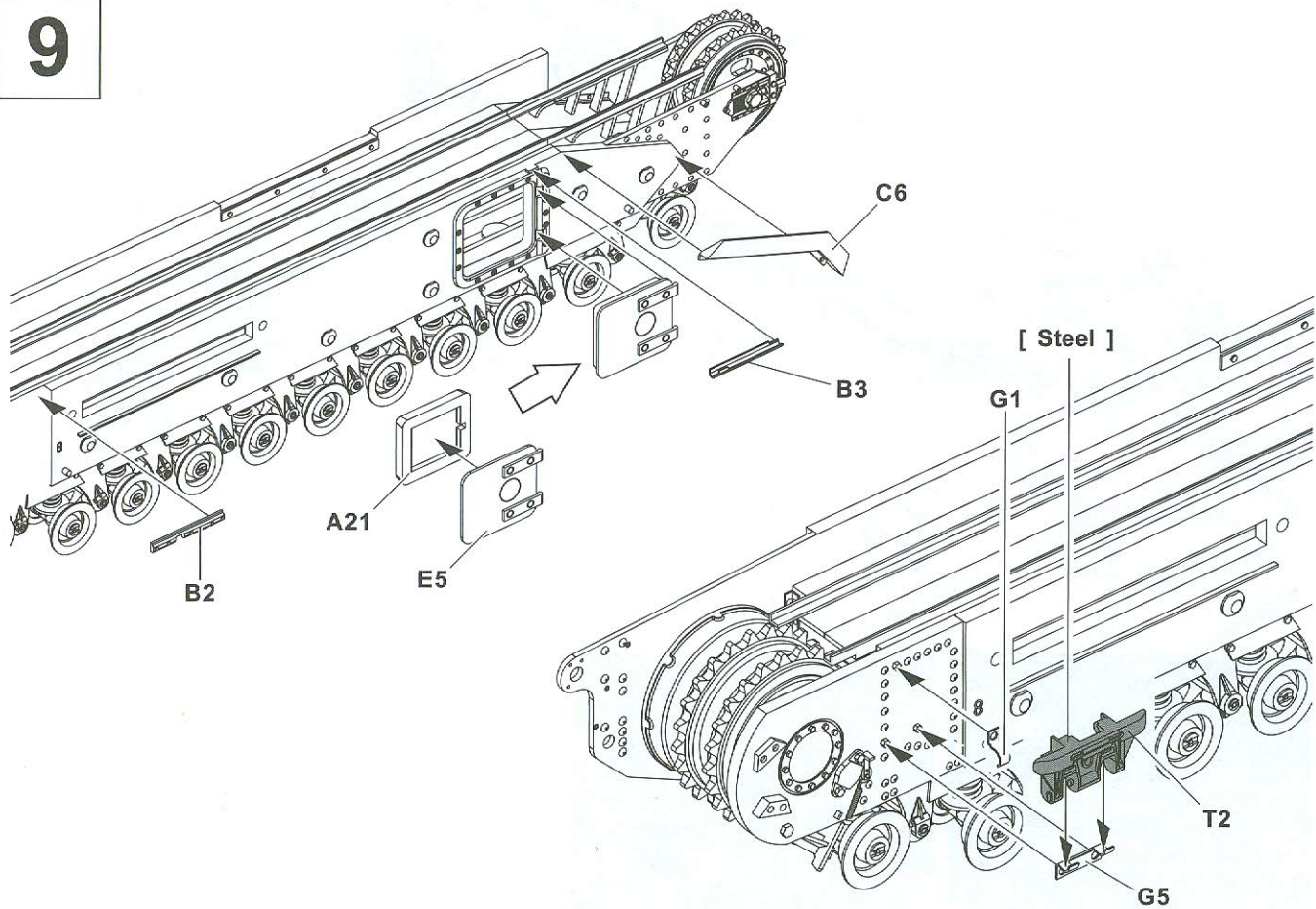

10

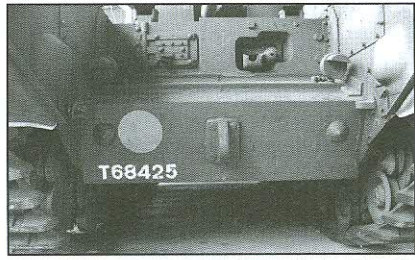
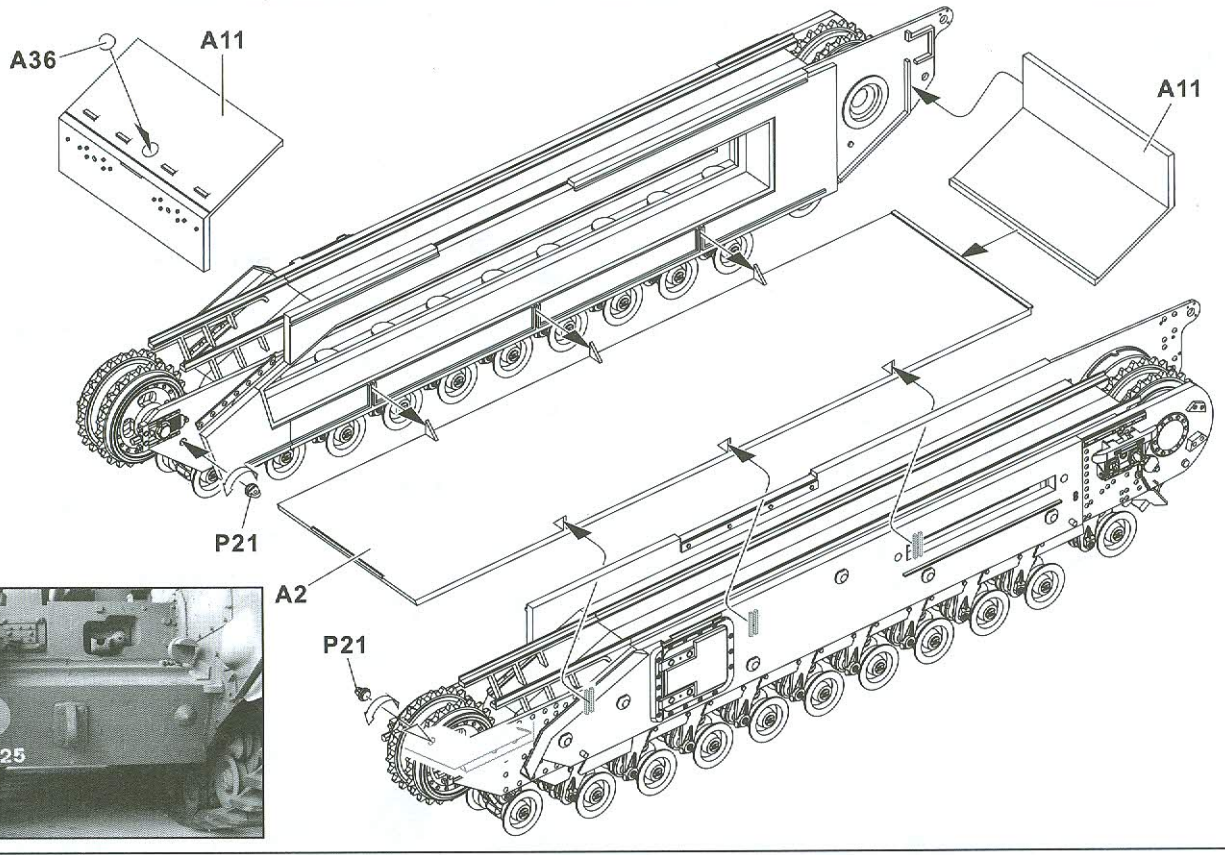

11

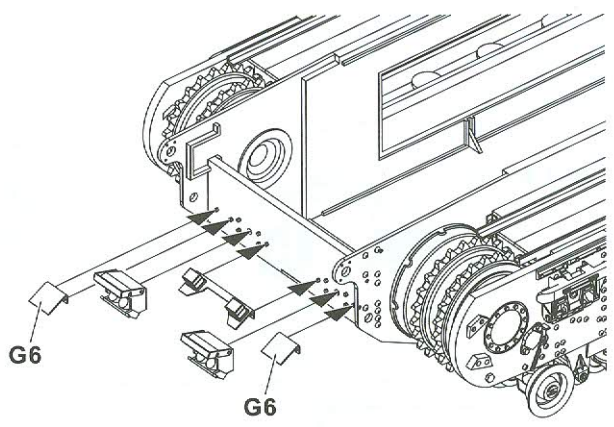
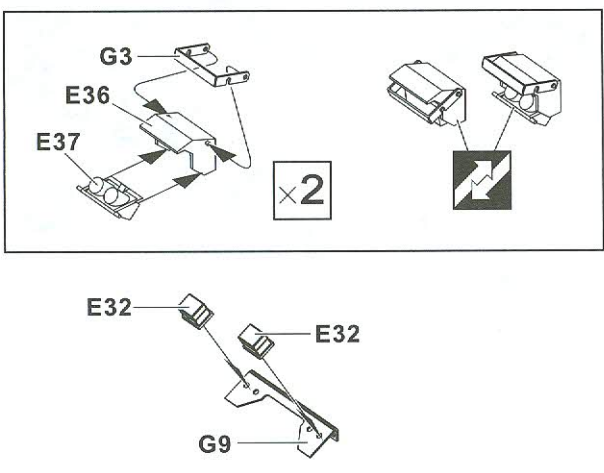

12

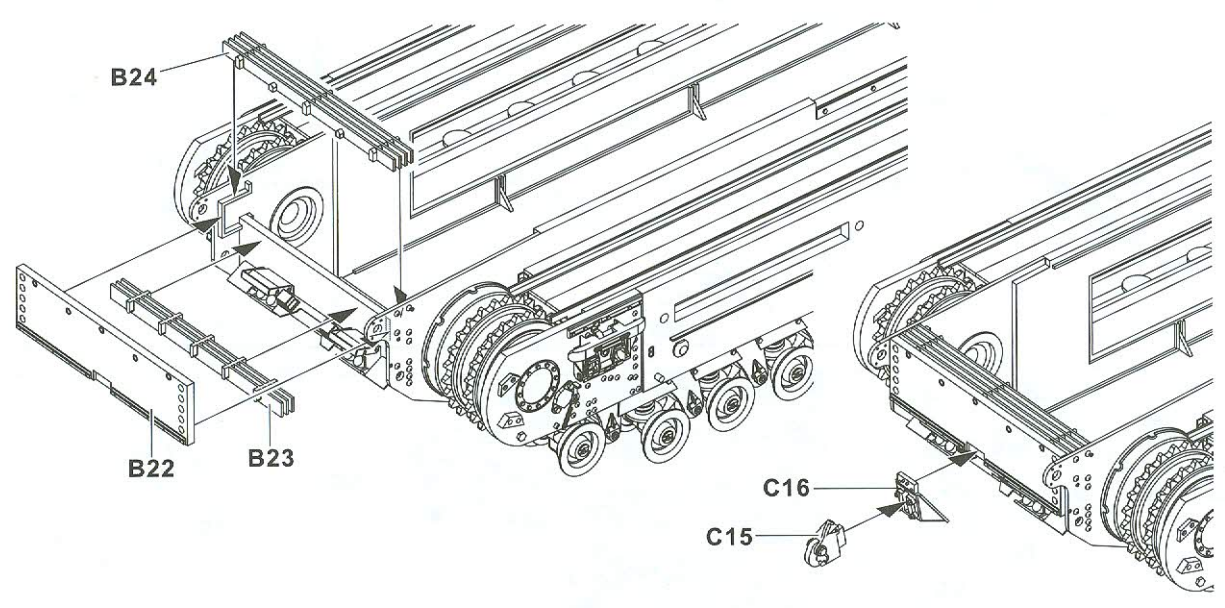

13

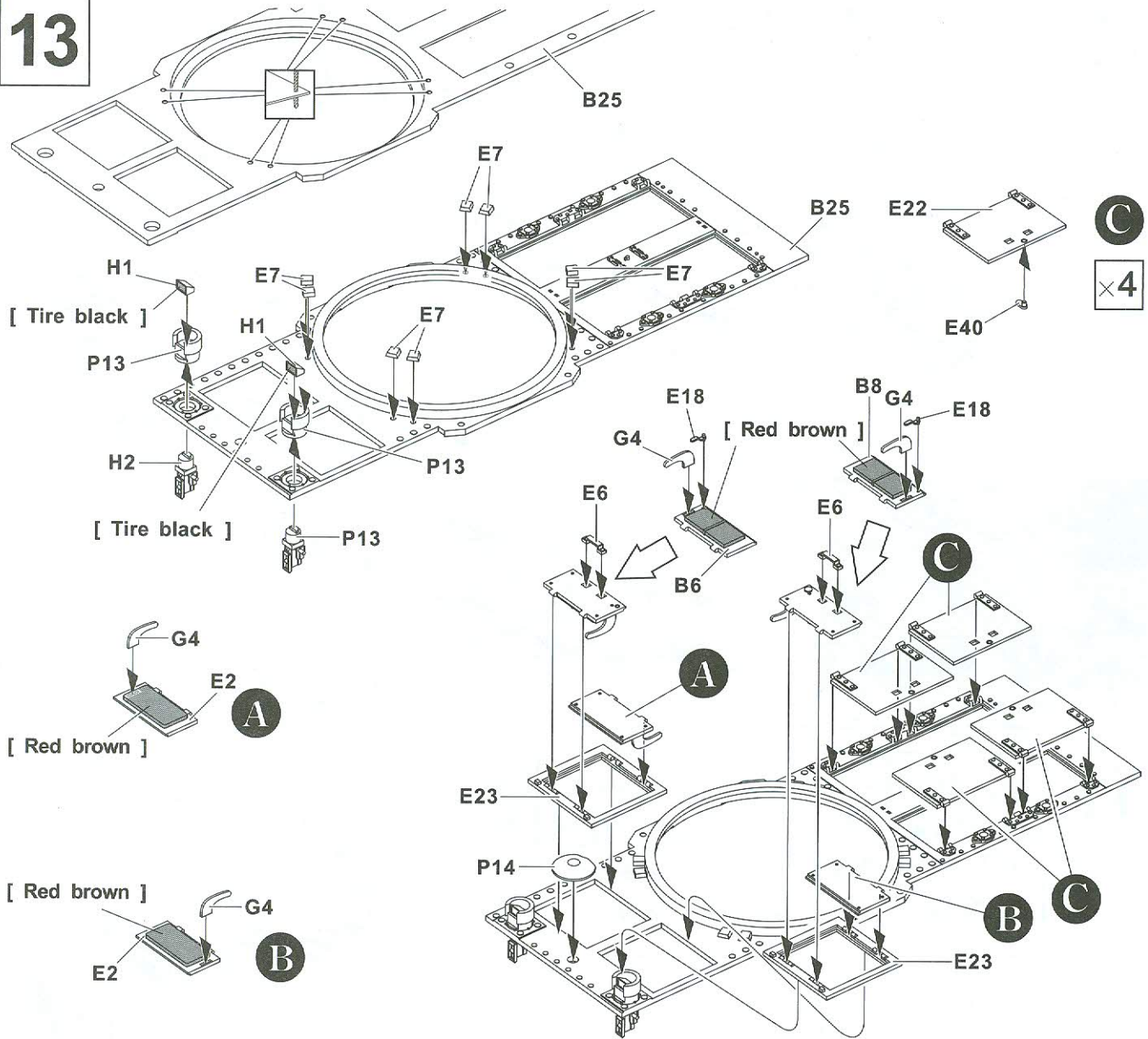

14

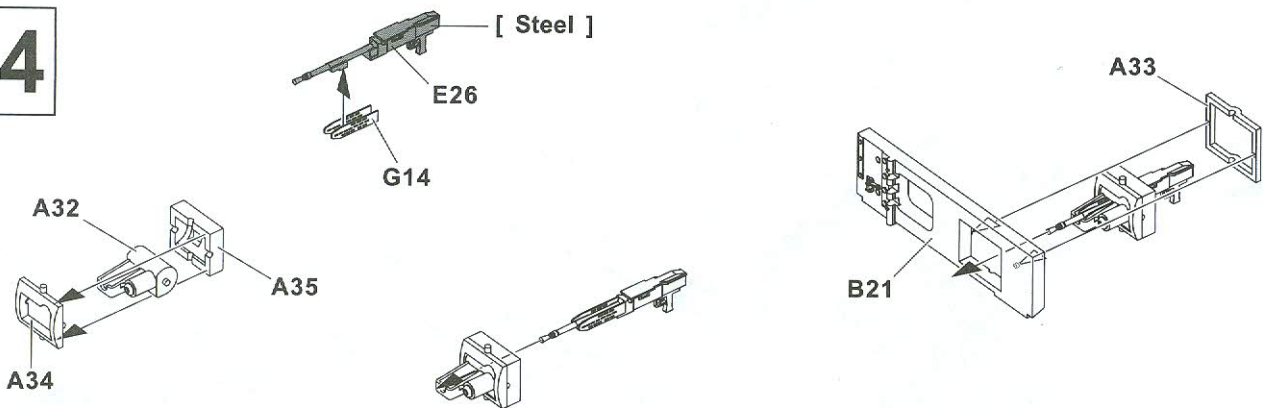

15

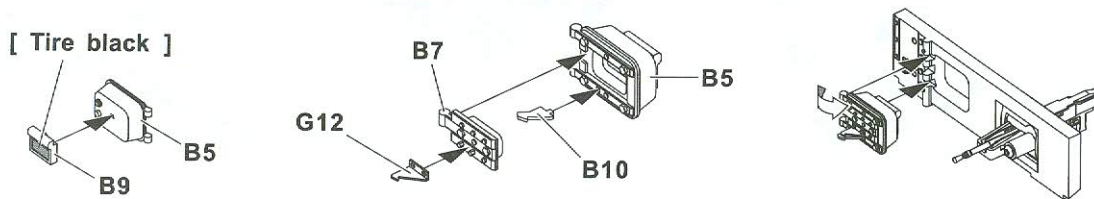

16

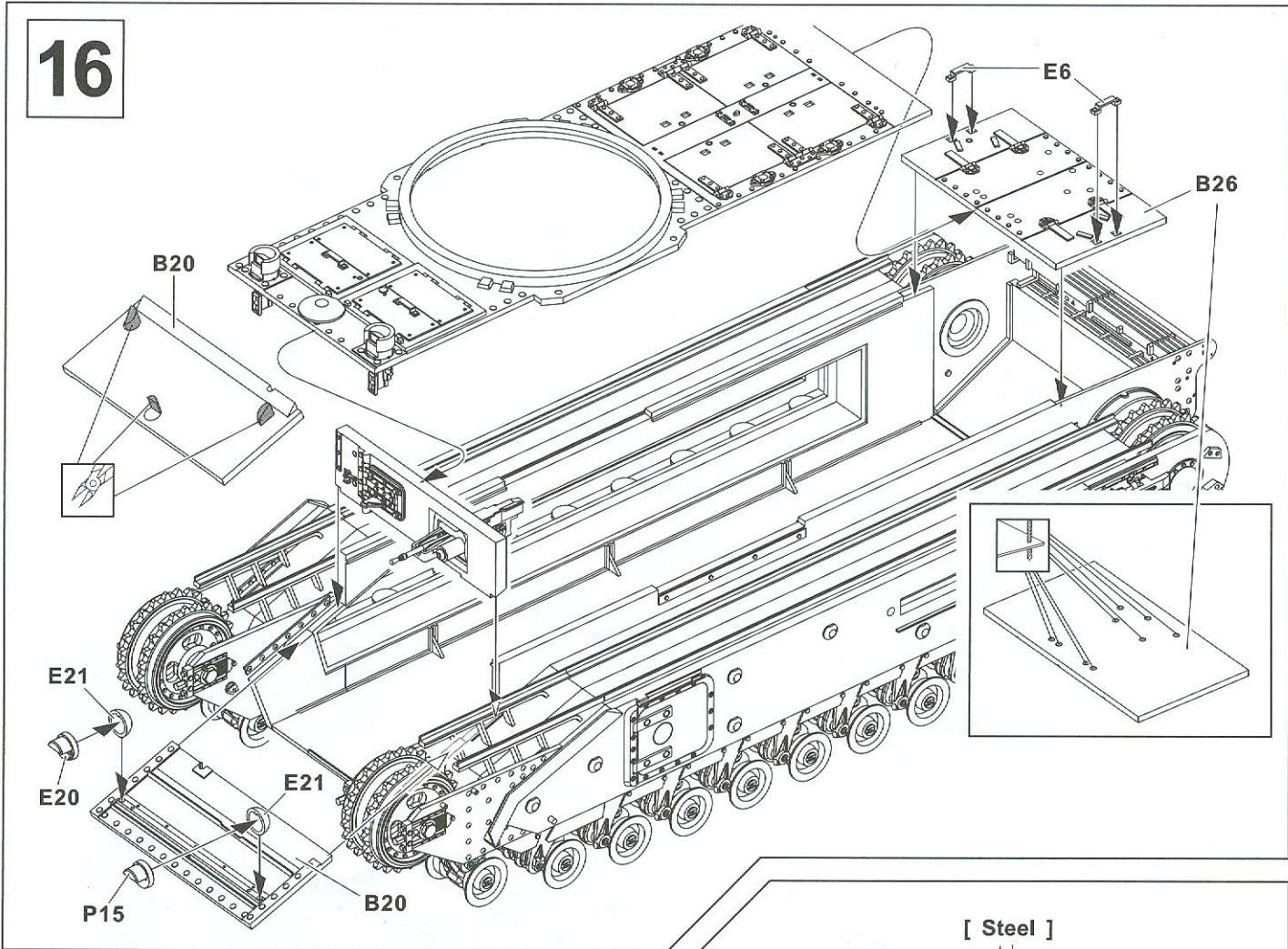

17

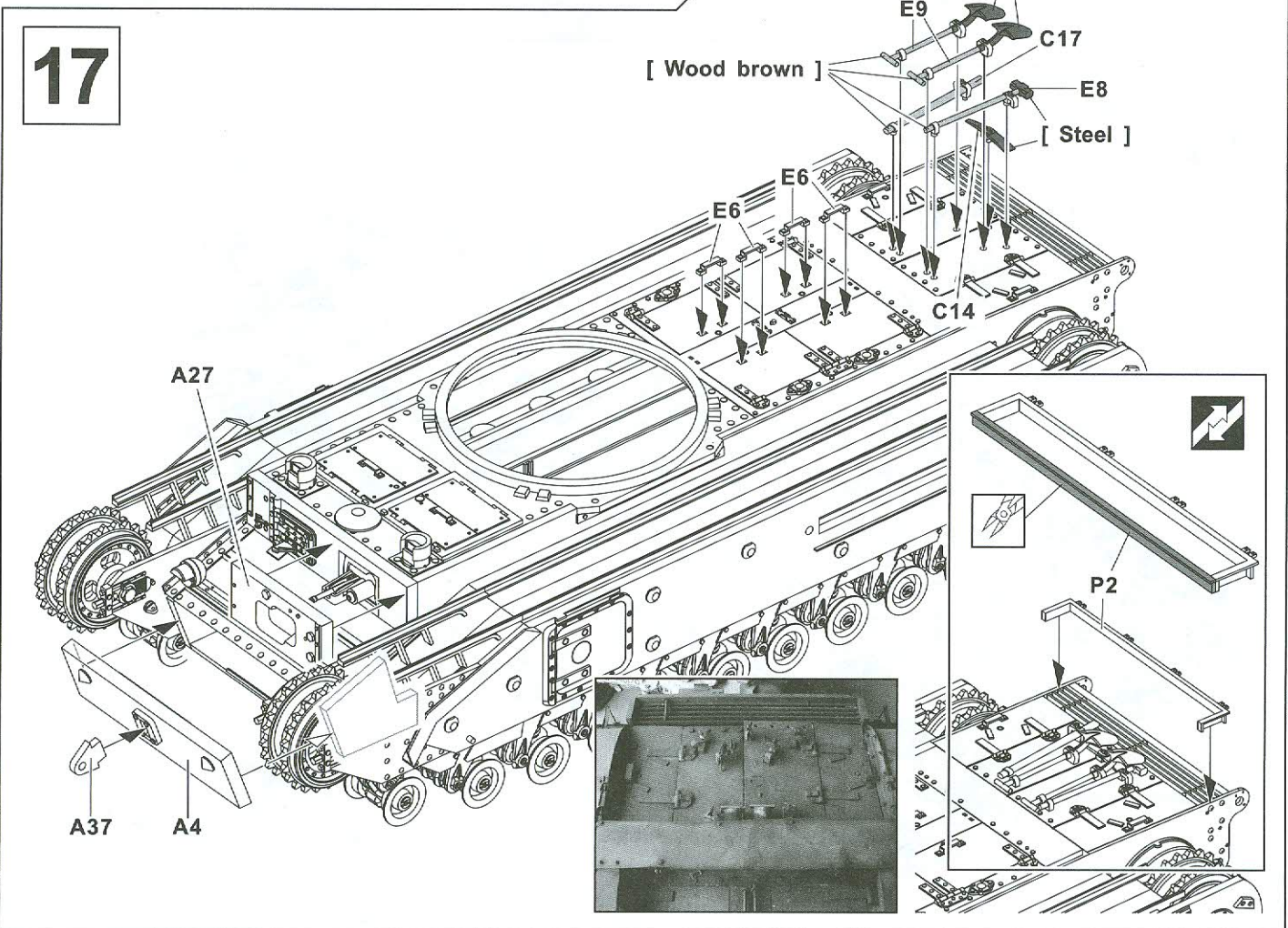

18

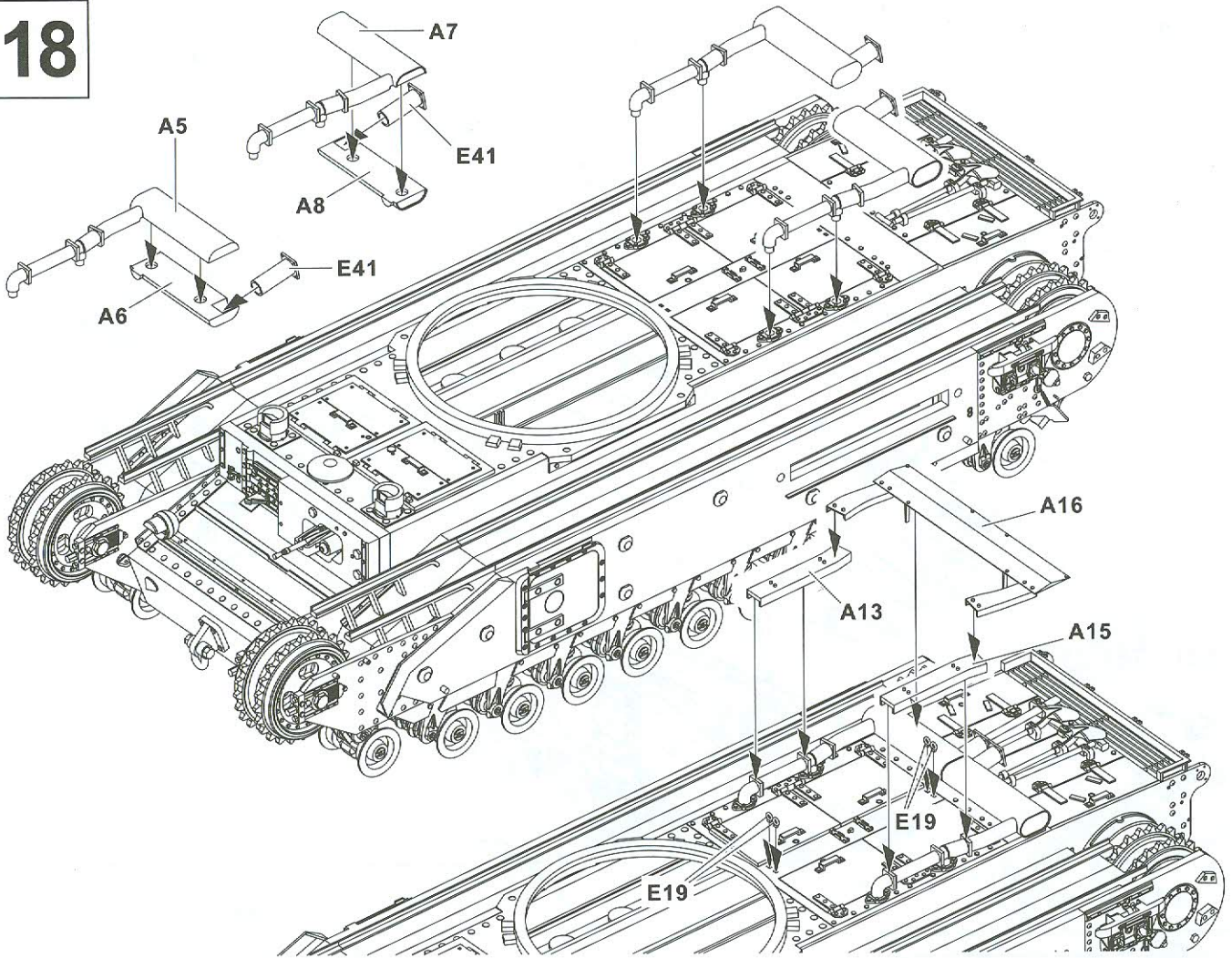

19

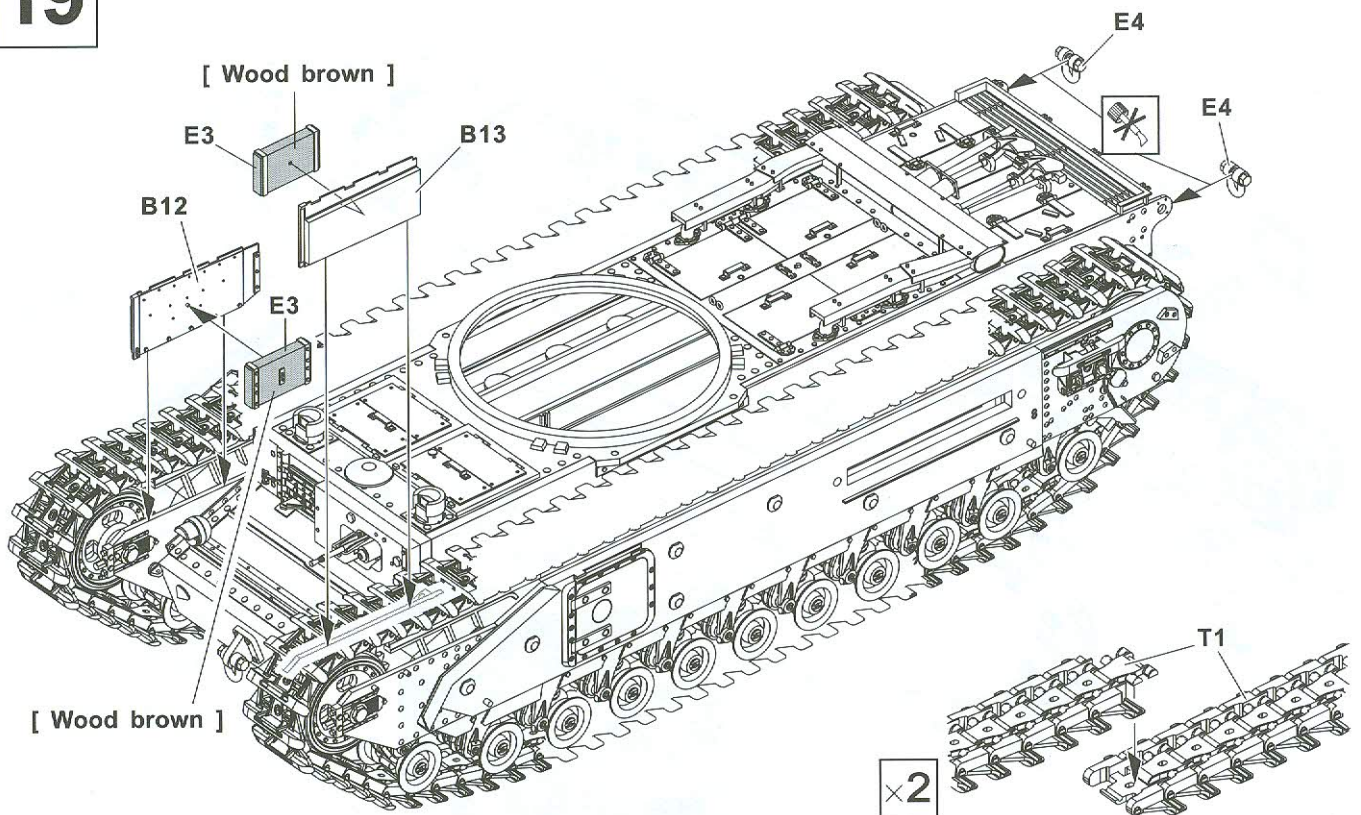

20

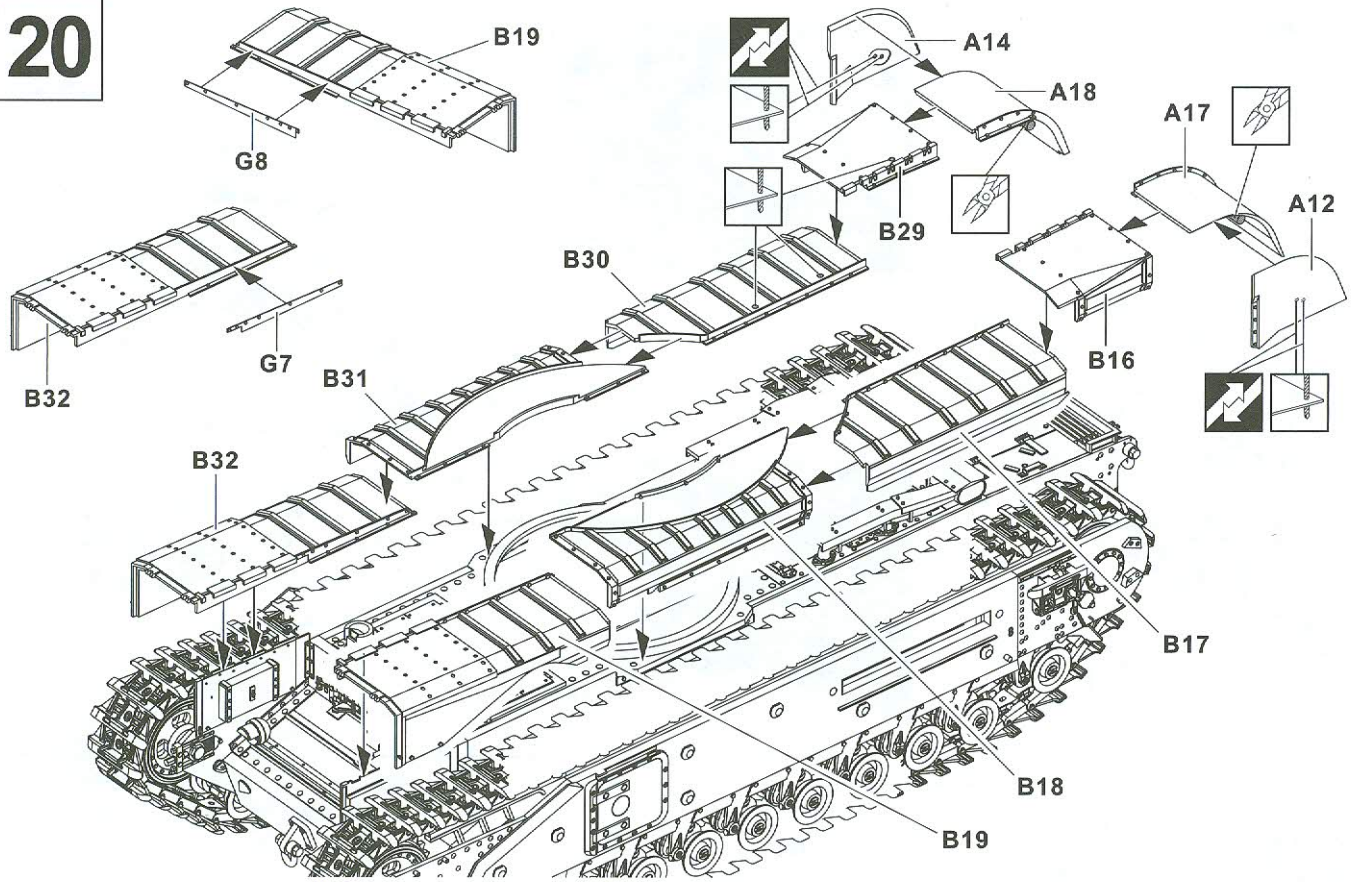

21

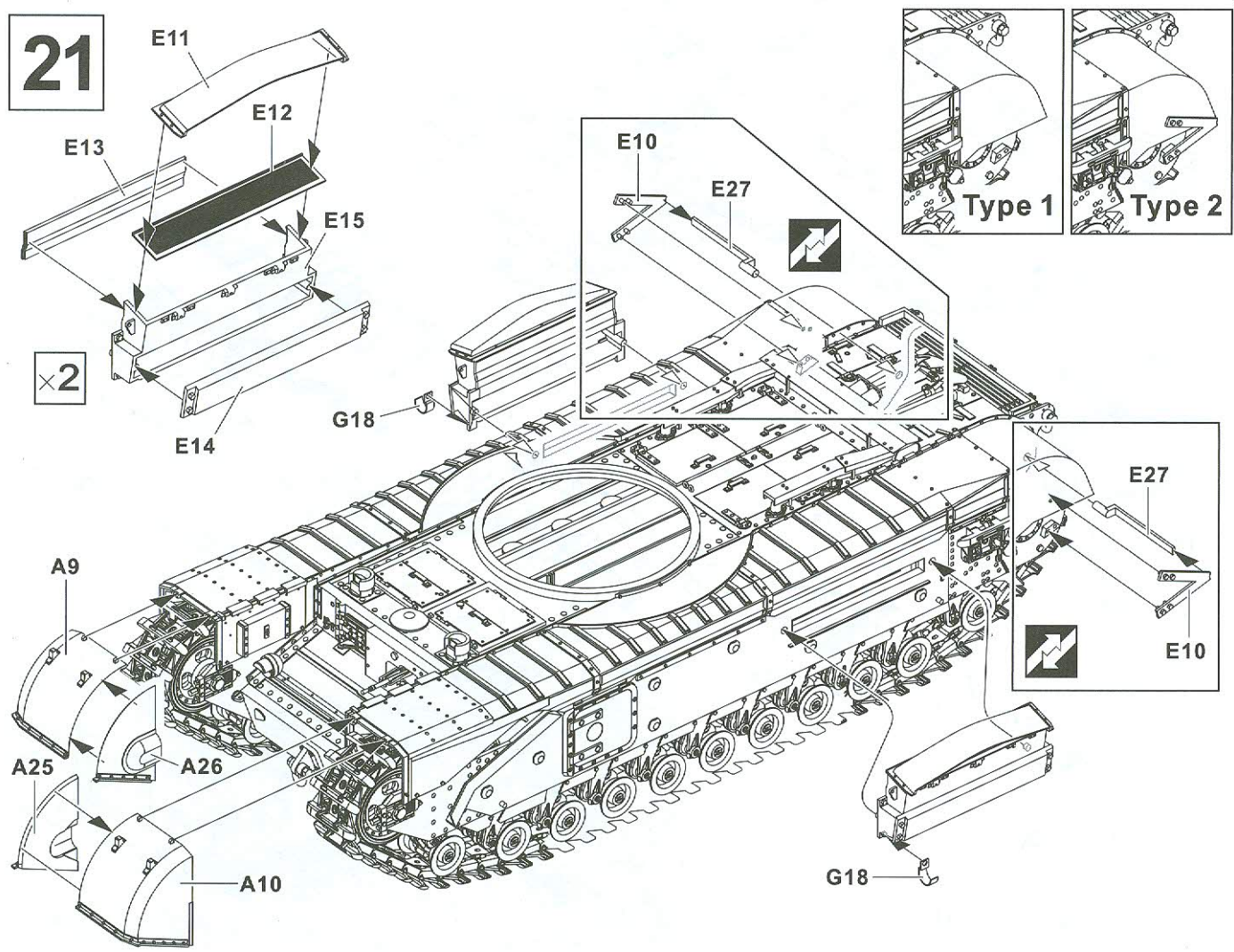

22

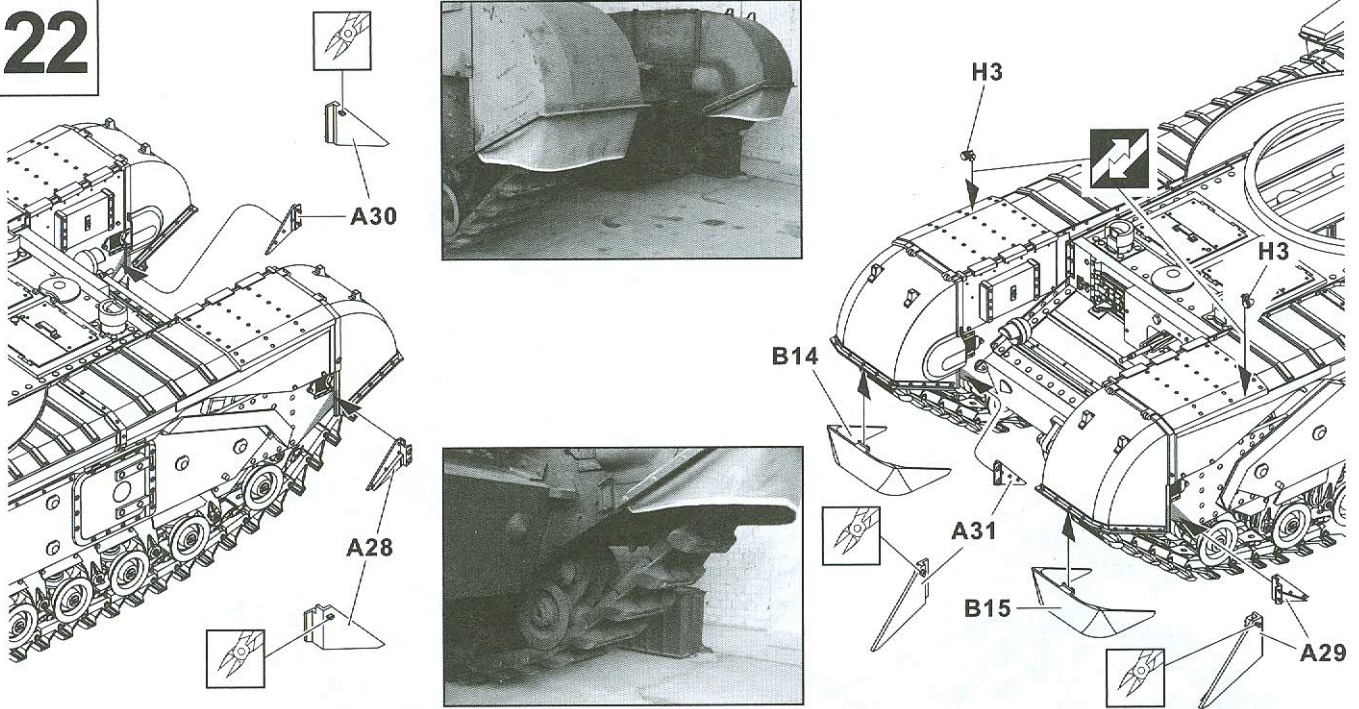

23

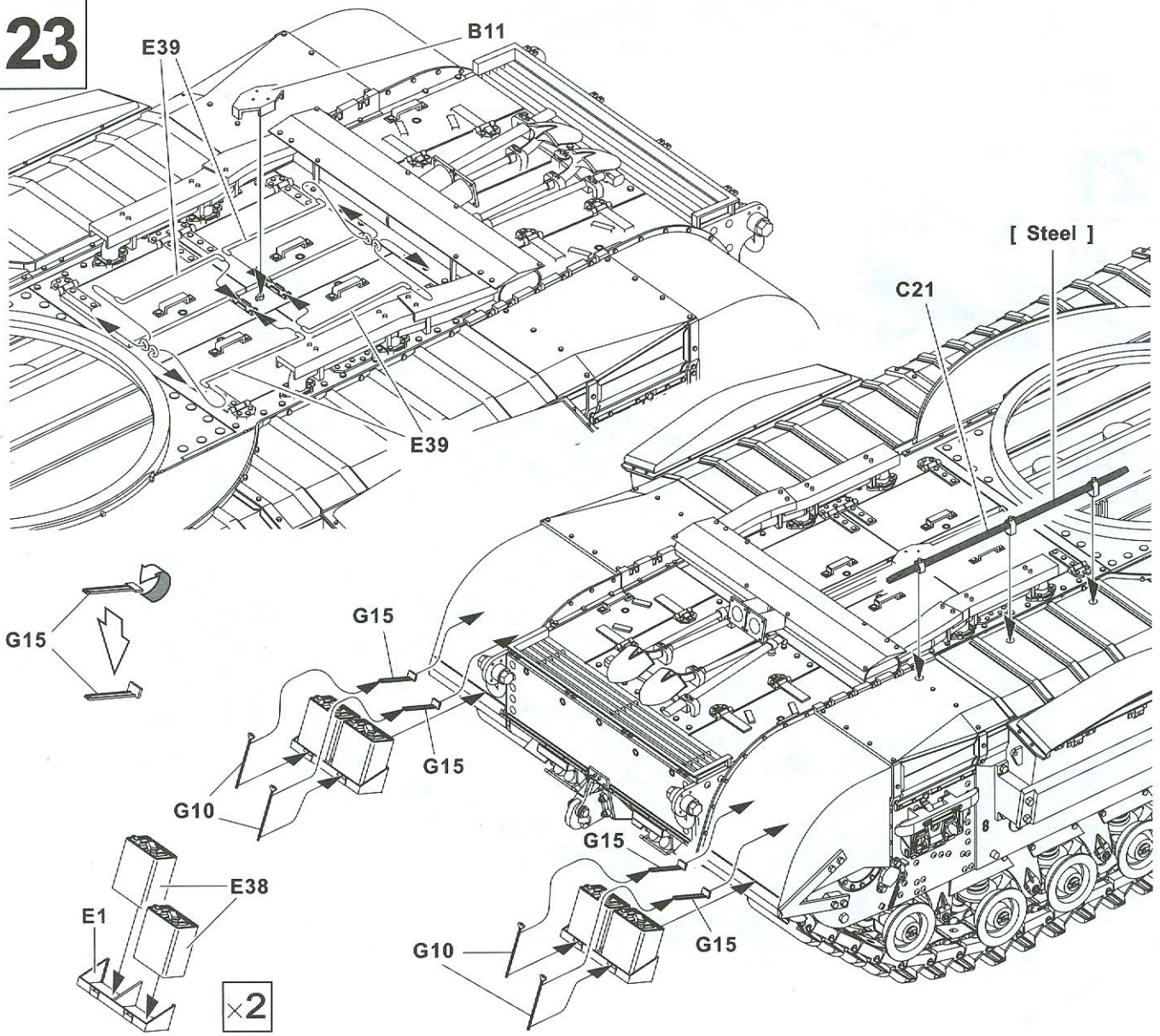

24

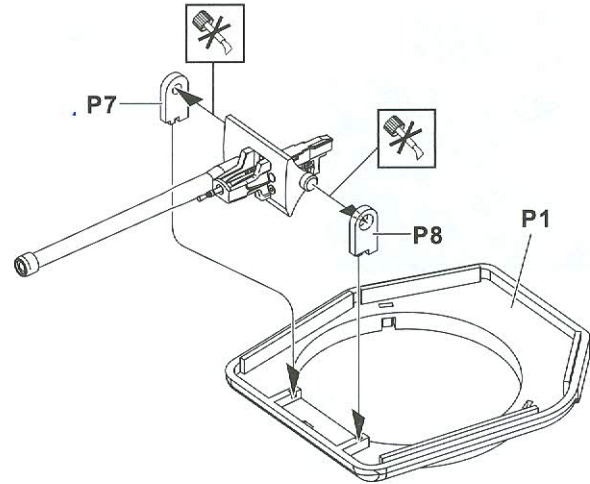
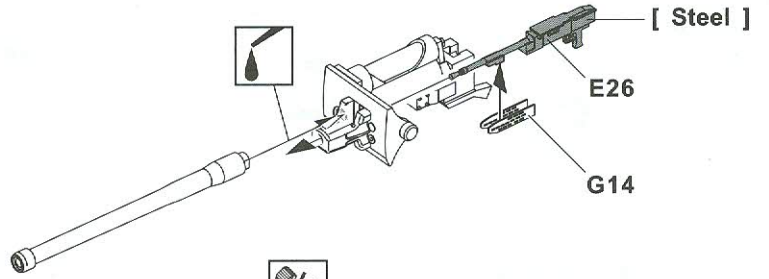
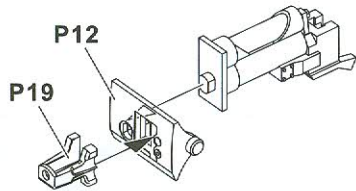
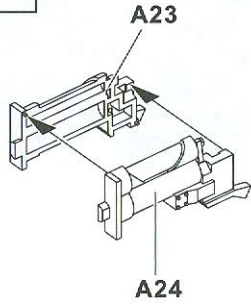

25

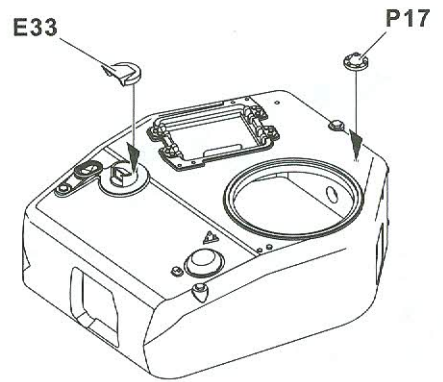
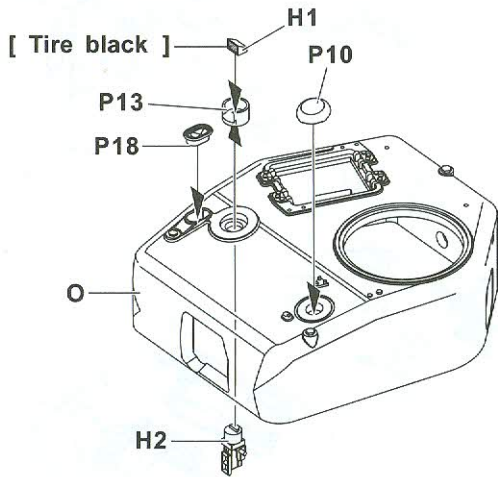

26

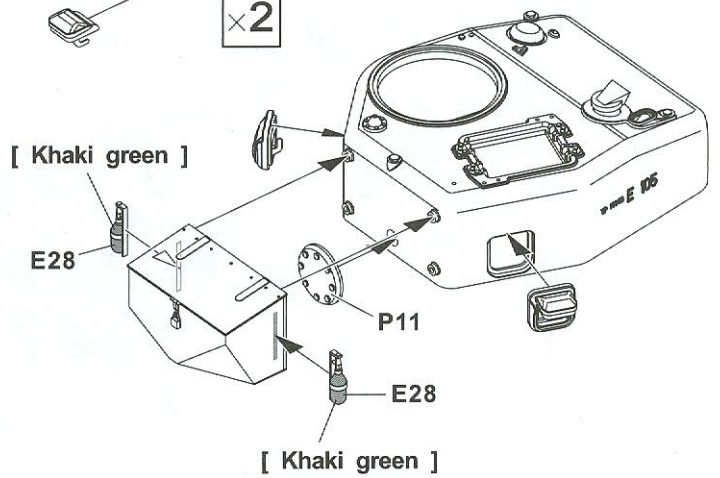
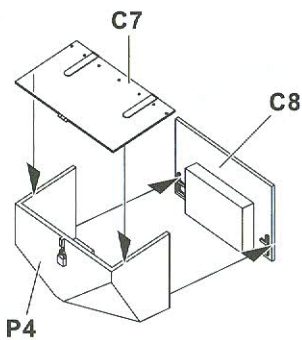
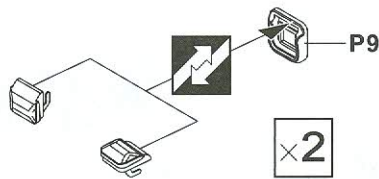
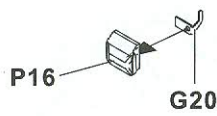

27

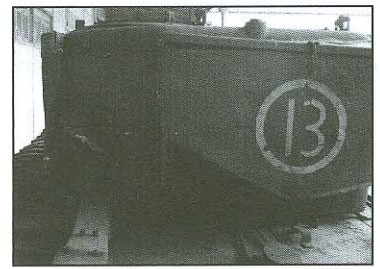
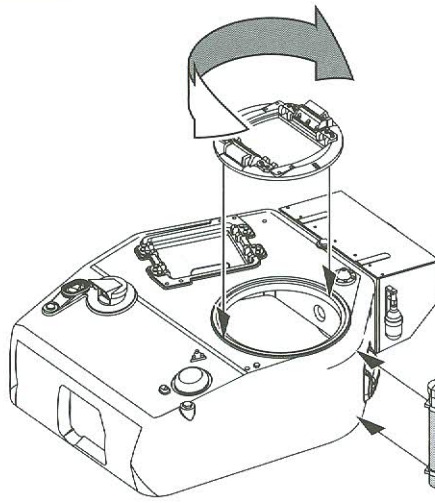
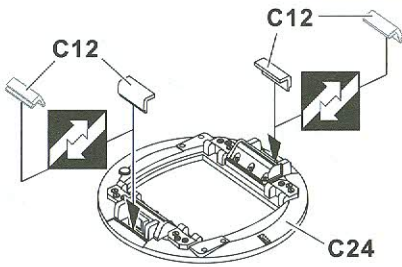

28

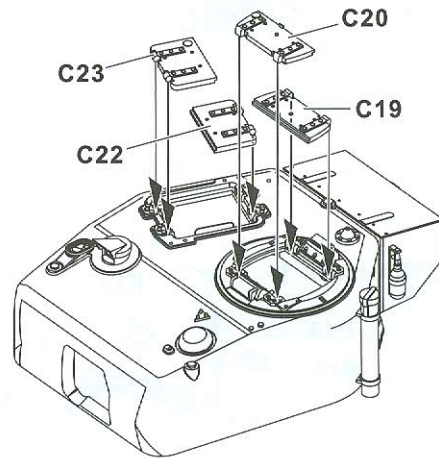
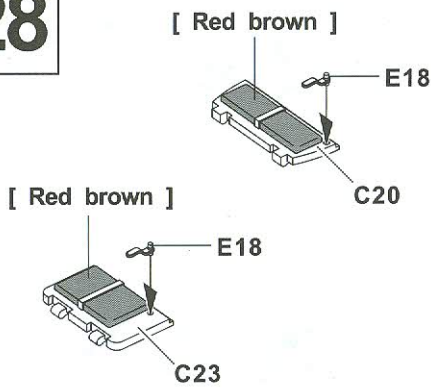

29

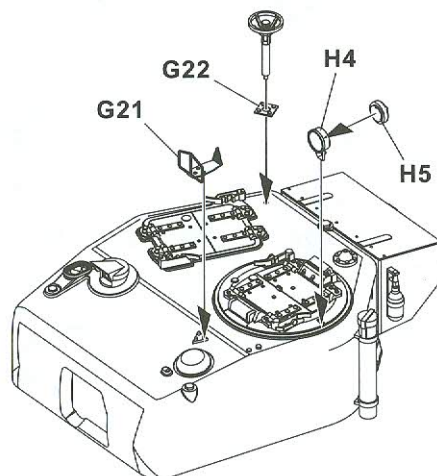
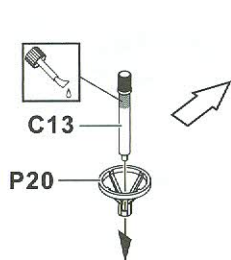
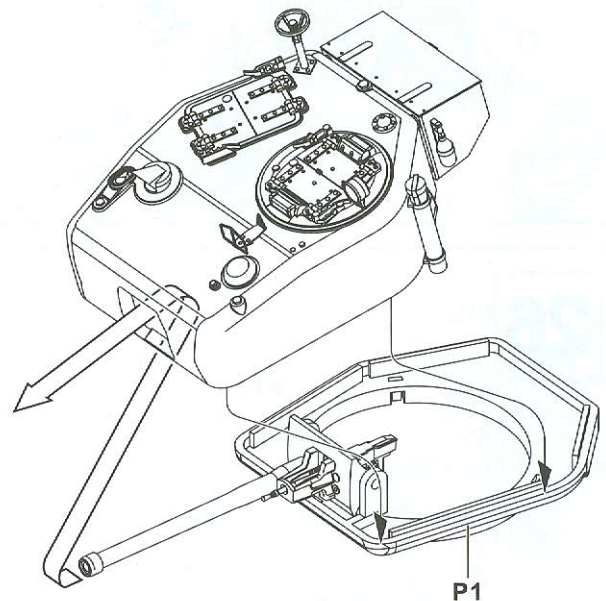
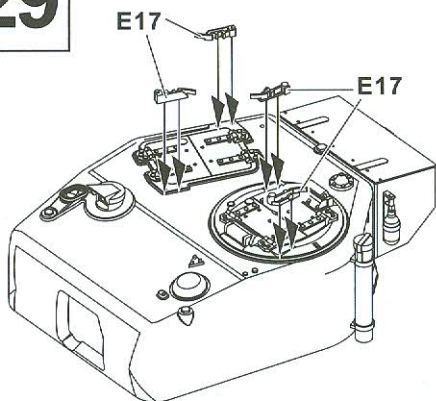

30

0mm

110mm

[Steel]

×2

E42

P6

P5

2cm

5cm

Pull

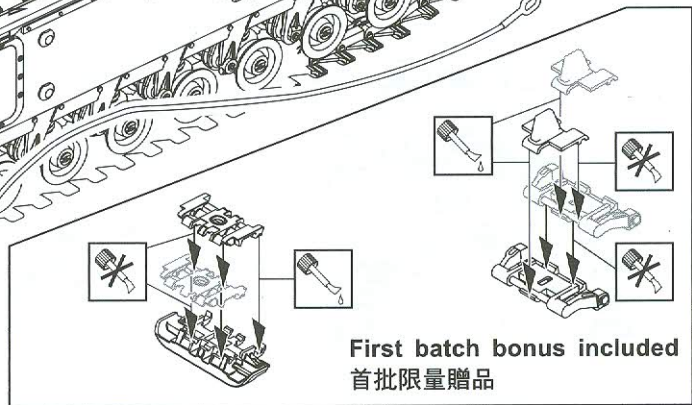
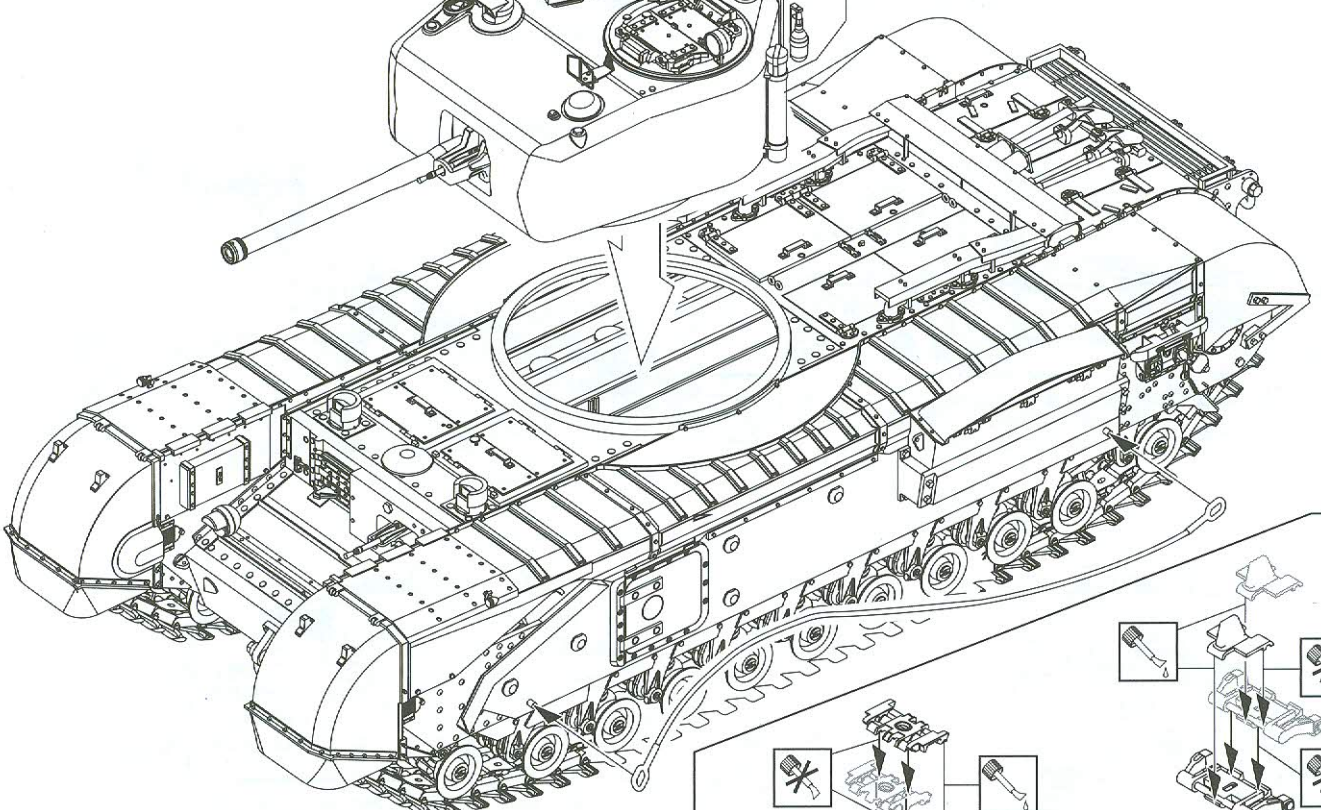
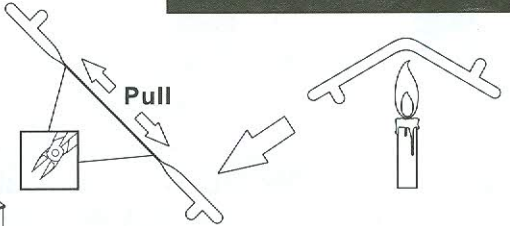
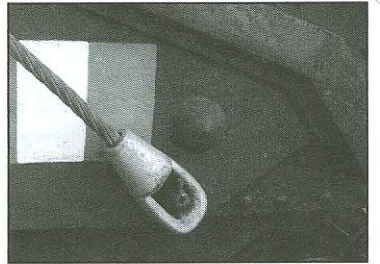
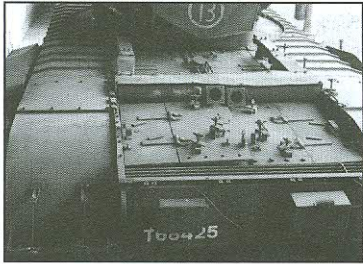

A 6th Guards Tank Brigade Picture ,Munster ,Germany ,April 1945
 第六近衛裝甲旅,德國慕斯特 1945年4月

 Body Color: Dark Green 

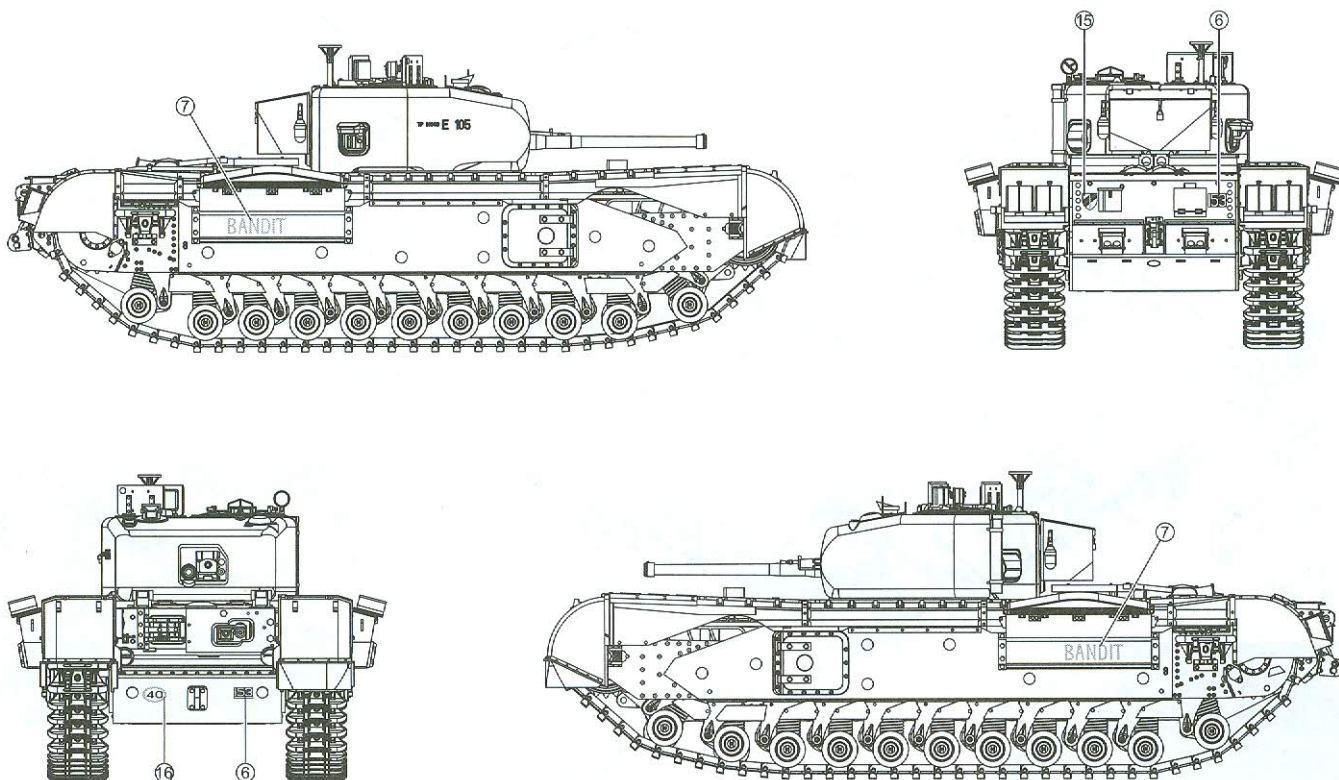

B 79th Armoured Division ,Suffolk ,England ,January 1944
 第七十九裝甲師,英格蘭薩福克郡,1944年元月

 Body Color: Dark Green 

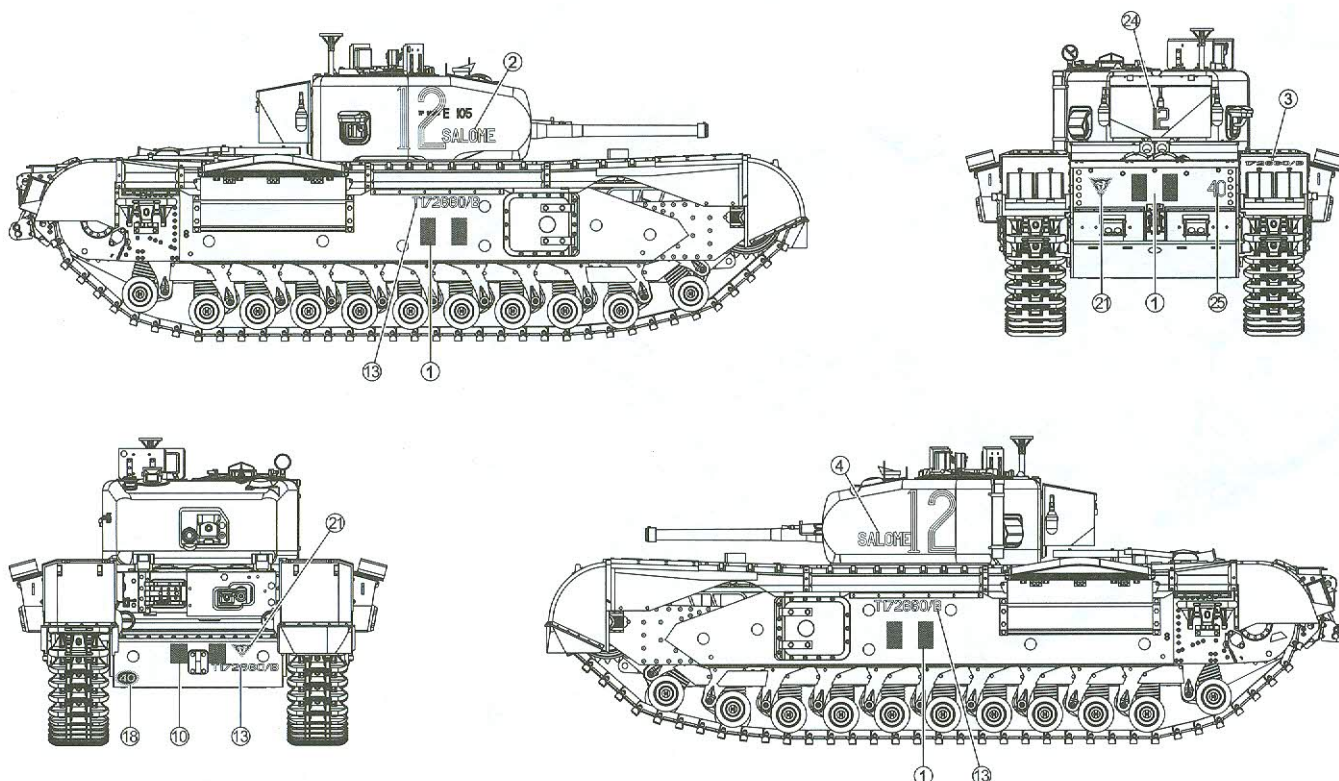

C 6th Guards Tank Brigade Picture ,Munster ,Germany ,April 1945
 第六近衛裝甲旅,德國慕斯特 1945年4月

 Body Color: Dark Green

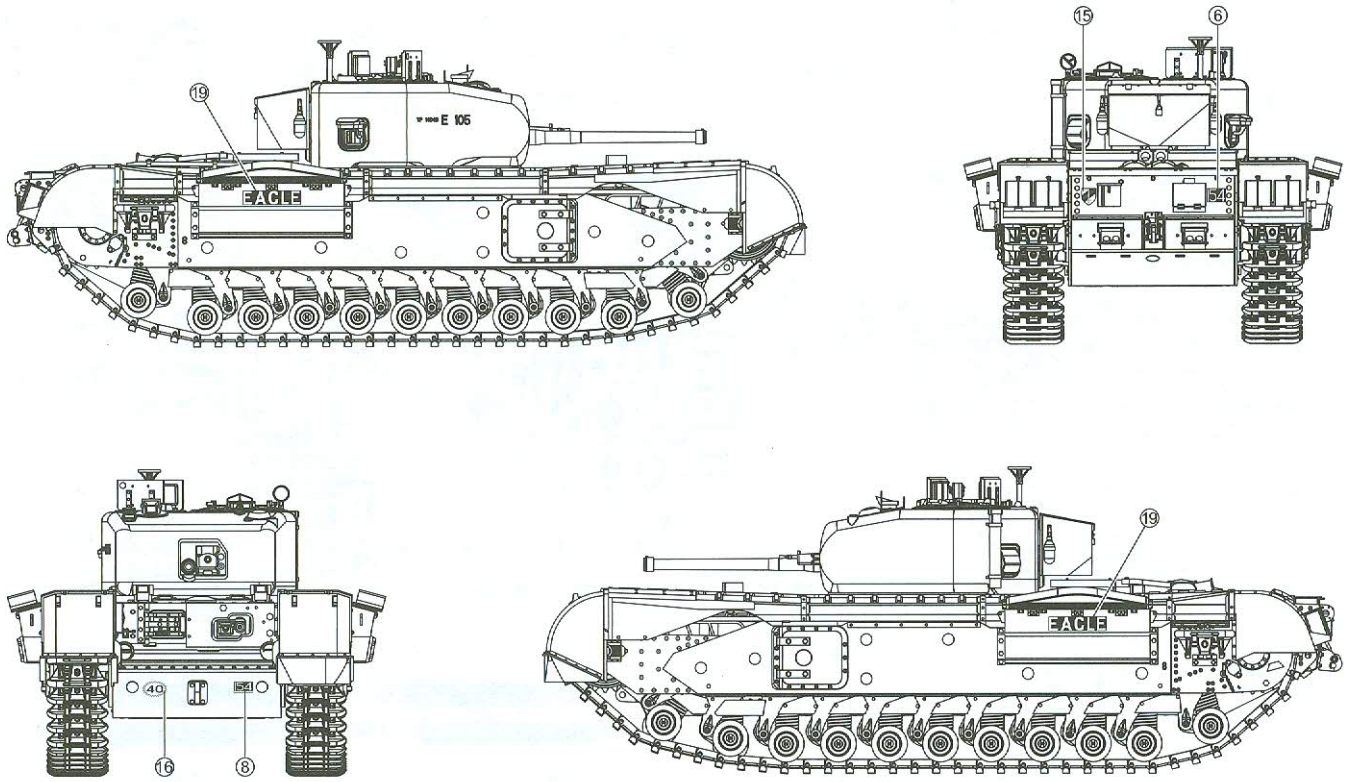

D Tank Museum Brussels ,Belgium
 比利時布魯塞爾戰車博物館

 Body Color: Dark Green

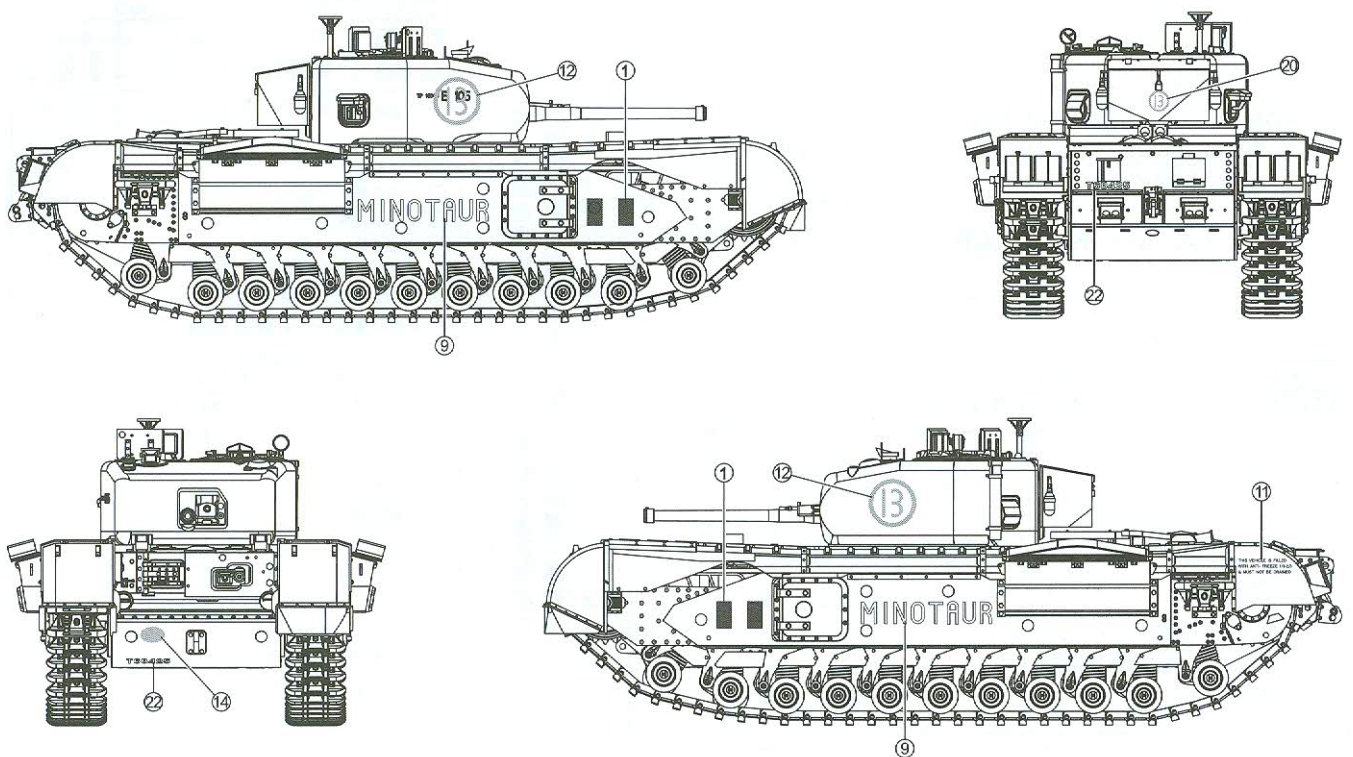

PARTS LIST 零件表

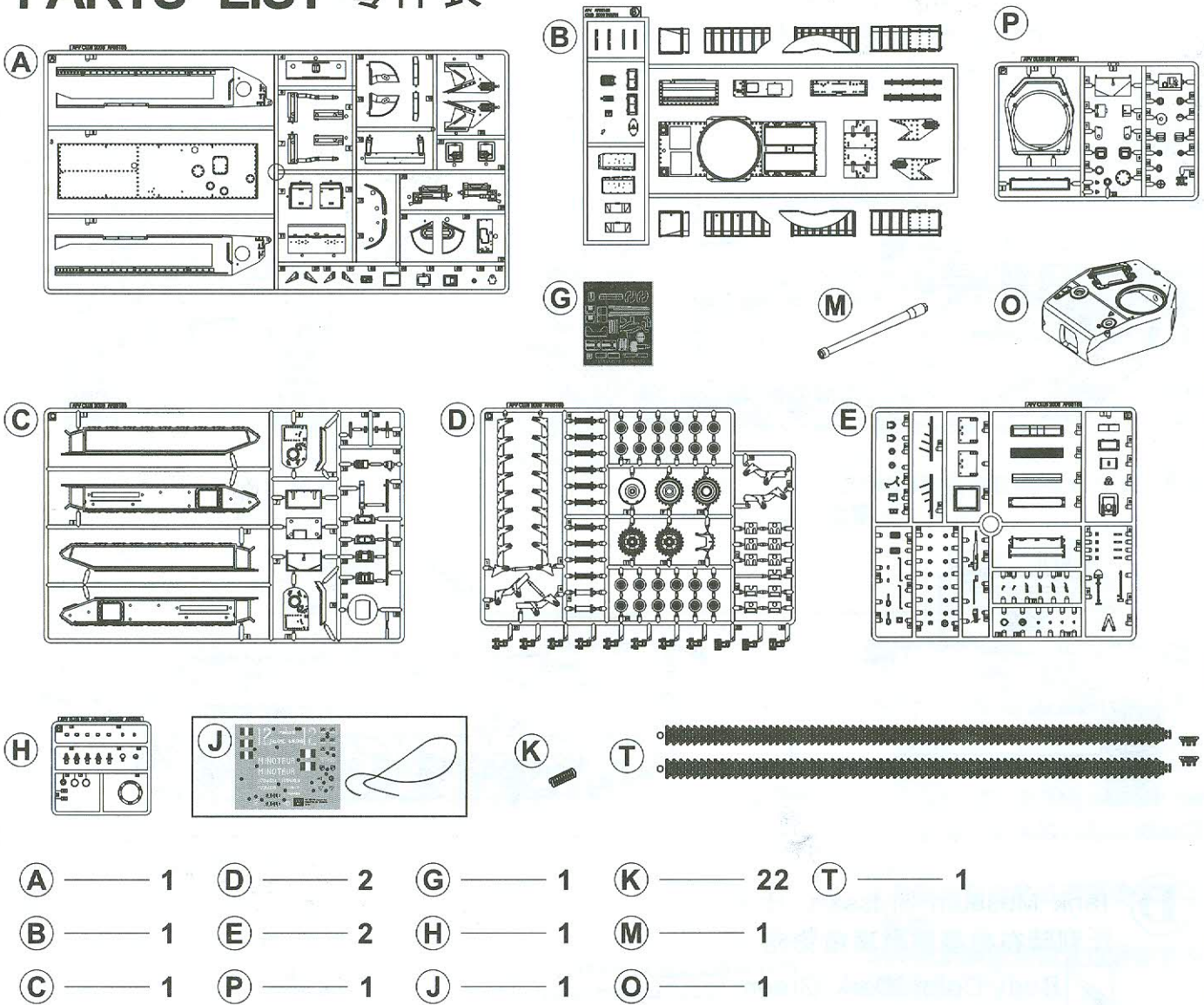

- | | | | | |
|----------------|----------------|----------------|-----------------|----------------|
| A ——— 1 | D ——— 2 | G ——— 1 | K ——— 22 | T ——— 1 |
| B ——— 1 | E ——— 2 | H ——— 1 | M ——— 1 | |
| C ——— 1 | P ——— 1 | J ——— 1 | O ——— 1 | |



Instructions:

If for some reason, you are not fully satisfied or have questions concerning our product; Please use the form provide, and send it to our nearest representative or mail it directly to our office.

We will deal with that A.S.A.P.

限臺灣地區使用 For Taiwanese use only!

 AF 35154 Parts Replacement Form		
<input type="checkbox"/> A parts <input type="checkbox"/> B parts <input type="checkbox"/> C parts <input type="checkbox"/> D parts <input type="checkbox"/> E parts	<input type="checkbox"/> G parts <input type="checkbox"/> H parts <input type="checkbox"/> J parts <input type="checkbox"/> K Parts	<input type="checkbox"/> M parts <input type="checkbox"/> O parts <input type="checkbox"/> P parts <input type="checkbox"/> T parts
Reason for replacement: <input type="checkbox"/> Missing <input type="checkbox"/> Broken		
Signature: _____		

總代理戰鷹企業有限公司收本公司將儘速為您處理。
請將本表與該部品相同金額之郵政匯票一同寄至。

 AF 35154 零件補充申請表	申請人 姓名 地址 電話
<input type="checkbox"/> A 部品零件 ——— NT\$ 280 <input type="checkbox"/> B 部品零件 ——— NT\$ 280 <input type="checkbox"/> C 部品零件 ——— NT\$ 240 <input type="checkbox"/> D 部品零件 ——— NT\$ 320 <input type="checkbox"/> E 部品零件 ——— NT\$ 210 <input type="checkbox"/> G 部品零件 ——— NT\$ 200 <input type="checkbox"/> H 部品零件 ——— NT\$ 150 <input type="checkbox"/> J 部品零件 ——— NT\$ 160 <input type="checkbox"/> K 部品零件 ——— NT\$ 100 <input type="checkbox"/> M 部品零件 ——— NT\$ 200 <input type="checkbox"/> O 部品零件 ——— NT\$ 150 <input type="checkbox"/> P 部品零件 ——— NT\$ 200 <input type="checkbox"/> T 部品零件 ——— NT\$ 280	
+郵寄費 ——— NT\$ 80 (請填)總計NT\$ _____	
零件補充原因:(請於 <input type="checkbox"/> 打√) 原包裝即 <input type="checkbox"/> 遺失或 <input type="checkbox"/> 毀損, 製作途中 <input type="checkbox"/> 遺失或 <input type="checkbox"/> 毀損, 其他原因 _____	